

CONSTRUCTION SUMMARY				
Mountainview Heights 3 (G) - Russell Gardens Building Ltd.				
PURCHASERS: Harpreet Singh VIRDI and Shallu VIRDI // Surinder Singh VIRDI			TEL: RES.: 289-776-8361	
LOT / PHASE 567 / 4	REG. PLAN # 62M-1266	HOUSE TYPE Springfield One (5 Bed with Guest Suite) Elev 3		

CABINETRY

1 - KITCHEN - DELETE CABINETS ABOVE STOVE - VENDOR WILL SUPPLY 6 INCH VENT AS PER CONSTRUCTION SPECIFICATIONS AND VENT MAY NOT BE IN THE APPROPRIATE LOCATION FOR INSTALLATION OF PURCHASER SUPPLIED VENT - PURCHASER TO SUPPLY OWN FAN AFTER CLOSING 06Jun22 Note: TEMPORARY HOOD FAN MAY BE PROVIDED	
1 - CABINETRY - KITCHEN - HARDWARE UPGRADE 2 06Jun22 Note:	
1 - KITCHEN CABINETRY - CROWN MOULDING WITH EXTENDED HEADER 06Jun22 Note: CM11 --- ***NOTE: DO NOT INSTALL ABOVE STOVE /FUTURE CHIMNEY FAN AREA *SEE SKETCH	
1 - ***NOTE - PROVIDE GABLE CUT-OUT FOR PLUG - GABLE FACING KITCHEN SINK 03May22 Note:	

CABINETRY ACCESSORIES

1 - KITCHEN CABINETRY BASE - BUILT-IN - MICROWAVE BASE CABINET WITH SINGLE POT DRAWER - 800MM WIDE - PRICE IS EACH - STANDARD INSTALL AT END OF KITCHEN ISLAND - OPPOSITE FRIDGE *SEE SKETCH 06Jun22 Note:	
1 - KITCHEN CABINETRY UPPER - FULL DEPTH ABOVE FRIDGE - WITH GABLES - 600MM - PRICE IS EACH - STANDARD 06Jun22 Note:	
1 - KITCHEN CABINETRY BASE - PULLOUT RECYCLE 2 BIN - PRICE IS EACH AT KITCHEN ISLAND - SIDE CLOSEST TO KITCHEN SINK 06Jun22 Note:	
1 - KITCHEN CABINETRY - MINI STACKED UPPER CABINETS - PRICE IS PER FOOT - STANDARD CABINETRY ***GOS [REDACTED] 06Jun22 Note: CONSTRUCTION PERMITTING ***NOTE: DO NOT INSTALL MINI STACKED UPPER CABINETS ABOVE STOVE /FUTURE CHIMNEY FAN AREA *SEE SKETCH	

CERAMIC TILE

1 - GROUT COLOUR - UPGRADE GROUT COLOUR THROUGHOUT 06Jun22 Note:	
1 - DELETE ALL CERAMIC BATHROOM ACCESSORIES - DELETE TOWEL BAR, PAPER HOLDER & SOAP DISH THROUGHOUT 06Jun22 Note:	
1 - UPGRADE 4 - WALL TILE AT SHOWER WALLS - ENSUITE BATHROOM 06Jun22 Note:	
1 - TILE - UPGRADE 4 FLOOR TILE - - ENSUITE BATHROOM - FLOOR 06Jun22 Note:	
1 - TILE - UPGRADE 4 FLOOR TILE - - GUEST ENSUITE - FLOOR AREA 06Jun22 Note:	
1 - TILE - UPGRADE 4 FLOOR TILE - - MUD ROOM 06Jun22 Note:	
1 - TILE - UPGRADE 4 FLOOR TILE - - KITCHEN 06Jun22 Note:	
1 - TILE - UPGRADE 4 FLOOR TILE - - FOYER 06Jun22 Note:	

CONSTRUCTION

CONSTRUCTION SUMMARY				
Mountainview Heights 3 (G) - Russell Gardens Building Ltd.				
PURCHASERS: Harpreet Singh VIRDI and Shallu VIRDI // Surinder Singh VIRDI			TEL: RES.: 289-776-8361	
LOT / PHASE	REG. PLAN #	HOUSE TYPE		
567 / 4	62M-1266	Springfield One (5 Bed with Guest Suite) Elev 3		
1 - OAK STAIRS TO BASEMENT FROM MAIN FLOOR-NATURAL FINISH				
16Jun21 Note:				
UPGRADED TO STAIN FINISH (FROM NATURAL)- INVOICE JUNE 6/22				
1 - SMOOTH CEILINGS ON FIRST FLOOR ONLY - DET				
16Jun21 Note:				

COUNTER TOP

1 - UPGRADE COUNTERTOP MATERIAL - Opt Guest	
06Jun22 Note:	
1 - UPGRADE COUNTERTOP MATERIAL - Master	
06Jun22 Note:	
1 - UPGRADE COUNTERTOP MATERIAL - Bdrm 3/4	
06Jun22 Note:	
1 - UPGRADE COUNTERTOP MATERIAL - Shared Ensuite 2/5	
06Jun22 Note:	
1 - WATERFALL LEGS AT KITCHEN ISLAND	
06Jun22 Note:	
1 - UPGRADE COUNTERTOP MATERIAL Full Height Backsplash - Kitchen	
INCLUDES AREA ABOVE STOVE WHERE UPPER CABINET DELETED.	
06Jun22 Note:	
INCLUDES BEHIND FUTURE CHIMNEY HOOD UP TO CEILING	
1 - UPGRADE COUNTERTOP MATERIAL - Kitchen	
06Jun22 Note:	

DOORS AND TRIM

1 - TRIM - UPGRADE 2- 7-¼" BASEBOARD AND 3" CASING - COLONIAL	
06Jun22 Note:	

ELECTICAL

1 - PLUG – ROUGH-IN FOR ELECTRIC CAR PLUG IN GARAGE – FOR FUTURE ELECTRIC CAR – 240V / 40-50 AMPS	
03May22 Note:	

ELECTRICAL

1 - PLUG - ELECTRICAL PLUG - ADD TO ISLAND	
INSTALL PLUG AT SIDE GABLE FACING KITCHEN SINK.	
03May22 Note:	
1 - PLUG - ELECTRICAL PLUG - FOR BUILT-IN MICROWAVE	
AT KITCHEN ISLAND - END CLOSEST TO FRIDGE ***SEE SKETCH***	
03May22 Note:	
1 - PLUG - ELECTRICAL PLUG - FAMILY RM ***SEE SKETCH***	
INSTALL CENTERED ON WALL - AT STANDARD HEIGHT (APPROXIMATELY 18" FROM FINISHED FLOOR).	
03May22 Note:	
2 - PLUG - ELECTRICAL PLUG (X2)	
MASTER BEDROOM - INSTALL ONE OUTLET BELOW EACH WINDOW ***SEE SKETCH***	
03May22 Note:	
1 - LIGHT AND SWITCH - NO FIXTURE INCLUDED - LIVING ROOM	
03May22 Note:	
1 - RELOCATE STANDARD KITCHEN LIGHT TO BE CENTERED OVER ISLAND	
03May22 Note:	

CONSTRUCTION SUMMARY				
Mountainview Heights 3 (G) - Russell Gardens Building Ltd.				
PURCHASERS: Harpreet Singh VIRDI and Shallu VIRDI // Surinder Singh VIRDI			TEL: RES.: 289-776-8361	
LOT / PHASE	REG. PLAN #	HOUSE TYPE		
567 / 4	62M-1266	Springfield One (5 Bed with Guest Suite) Elev 3		
1 - PLUG - ELECTRICAL PLUG WITH GFI AND SWITCH - FOR FESTIVE LIGHTING				
16Jun21 Note:				
1 - 200 AMP ELECTRICAL SERVICE				
16Jun21 Note:				

FIREPLACE AND ACCESSORIES

1 - GAS LINE ROUGH-IN FOR STOVE (INCLUDES ELECTRICAL OUTLET) - FIRST FLOOR	
03May22 Note:	
1 - GAS LINE ROUGH-IN FOR BARBECUE - FIRST FLOOR ***SEE SKETCH	
03May22 Note:	

HARDWOOD FLOORING

1 - HARDWOOD - GROUP B SERIES 6 1/2 INCH - - UPPER HALL	
06Jun22 Note:	
1 - HARDWOOD - GROUP B SERIES 6 1/2 INCH - IN LIEU OF 2 1/4 INCH NATURAL RED OAK - - FAMILY ROOM	
06Jun22 Note:	
1 - HARDWOOD - GROUP B SERIES 6 1/2 INCH - IN LIEU OF 2 1/4 INCH NATURAL RED OAK - - GUEST SUITE	
06Jun22 Note:	
1 - HARDWOOD - GROUP B SERIES 6 1/2 INCH - IN LIEU OF 2 1/4 INCH NATURAL RED OAK - - MAIN HALL	
06Jun22 Note:	
1 - HARDWOOD - GROUP B SERIES 6 1/2 INCH - IN LIEU OF 2 1/4 INCH NATURAL RED OAK - - DINING ROOM	
06Jun22 Note:	
1 - HARDWOOD - GROUP B SERIES 6 1/2 INCH - IN LIEU OF 2 1/4 INCH NATURAL RED OAK - - LIVING ROOM	
06Jun22 Note:	

MIRRORS AND GLASS

4 - SHOWER DOOR HARDWARE- CRL TOWEL BAR/HANDLE COMBO - CHROME	
GUEST ENSUITE MASTER ENSUITE ENSUITE 2/5 ENSUITE 3/4 06Jun22 Note:	
3 - FRAMELESS GLASS SHOWER DOOR FOR 5 FOOT PAN	
GUEST SUITE ENSUITE BATH 2/5 ENSUITE BATH 3/4 06Jun22 Note:	
1 - FRAMELESS GLASS SHOWER DOOR - INCLUDES CHROME KNOB & HINGES	
16Jun21 Note: IN MASTER ENSUITE HARDWARE UPGRADED TO CRL TOWEL BAR/ HANDLE COMBO - CHROME (FROM CHROME KNOB) PER PE DATED JUNE 6/22.	

PAINTING

1 - WHITE TRIM PAINT THROUGHOUT	
06Jun22 Note:	

PLUMBING

1 - SOAP DISPENSER - 3942 BLACK -- **LEFT SIDE OF KITCHEN SINK ***CONSTRUCTION PERMITTING***	
06Jun22 Note:	

CONSTRUCTION SUMMARY				
Mountainview Heights 3 (G) - Russell Gardens Building Ltd.				
PURCHASERS: Harpreet Singh VIRDI and Shallu VIRDI // Surinder Singh VIRDI			TEL: RES.: 289-776-8361	
LOT / PHASE	REG. PLAN #	HOUSE TYPE		
567 / 4	62M-1266	Springfield One (5 Bed with Guest Suite) Elev 3		
1 - ALIGN SINGLE HANDLE PULLDOWN KITCHEN FAUCET - 7565 BLACK				
KITCHEN				
06Jun22 Note:				
1 - TECO KITCHEN UNDERMOUNT SINK #170				
06Jun22 Note:				
1 - MOEN 90 DEGREE POSI-TEMP TUB/SHOWER FAUCET WITH 3 FUNCTION TRANSFER VALVE/TRIM AND SLIDE BAR WITH HAND SHOWER – CHROME #TS2713EP/U361CI/UTS4172/62320/S3879EP/A721				
MASTER ENSUITE				
06Jun22 Note:				
1 - KITCHEN – POT FILLER – DELTA CONTEMPORARY				
*** UPGRADE TO MATT BLACK FINISH #1165LF - BL (IN LIEU OF CHROME)				
06Jun22 Note:				
5 - SINK - UNDERMOUNT SINK - CONTRAC COLLETTE #4220CIY				
06Jun22 Note:				
2 - TOE TESTER - ADD TOE TESTER TO SHOWERS				
MASTER ENSUITE				
SHARED ENSUITE #3/4				
03May22 Note:				
1 - KITCHEN – POT FILLER – DELTA CONTEMPORARY CONTRACT POT FILLER #1105LF				
03May22 Note:				
UPGRADE BLACK FINISH -- 1165LF -BL (IN LIEU OF CHROME) - PER INVOICE DATED JUNE 6/22				
2 - MASTER ENSUITE AND SHARED 2/3 ADD HOT WATER VALVE NEXT TO TOILET				
16Jun21 Note:				
1 - WATER LINE FOR FRIDGE - ROUGH-IN ONLY				
16Jun21 Note:				
2 - 5 FOOT SHOWER WITH SLIDING GLASS CHROME DOORS IN LIEU OF TUB				
16Jun21 Note: ADD IN SHARED BATH AND GUEST BATH				
PROMOTIONAL				
1 - LESS CREDIT FROM PURCHASER EXTRA SHEET IN OFFER				
16Jun21 Note:				
STAIRS AND RAILINGS				
1 - STAINED STAIRS – BASEMENT STAIR (UPGRADED FROM NATURAL OAK COLOUR) - PRICE IS PER SET				
06Jun22 Note:				
1 - STAINED STAIRS – STANDARD STAIRCASE - PRICE IS PER SET				
06Jun22 Note:				
1 - STAIRCASE - BOX POSTS				
06Jun22 Note:				
4X4 BOX POSTS				
1 - V GROOVE HANDRAIL				
06Jun22 Note:				
1 - EUROLINE 0 BLACK IRON PICKETS				
06Jun22 Note:				

CONSTRUCTION SUMMARY

Mountainview Heights 3 (G) - Russell Gardens Building Ltd.

PURCHASERS: Harpreet Singh VIRDI and Shallu VIRDI // Surinder Singh VIRDI

TEL: RES.: 289-776-8361

LOT / PHASE	REG. PLAN #	HOUSE TYPE		
567 / 4	62M-1266	Springfield One (5 Bed with Guest Suite) Elev 3		

EXTRAS AS PER OFFER

(1) The Vendor agrees that notwithstanding any other term or provision in this Agreement included in the Purchase Price and in addition to those items detailed in Schedule GP to the Agreement of Purchase and Sale, the Purchaser is entitled to a credit of <i>Worksheet Note:</i>	
Purchase Price includes 3 enlarged basement windows, and the obligation to construct the house with the enlarged basement windows is subject to the Vendors approval, in its sole and unfettered discretion The Purchaser acknowledges and agrees that the loc <i>Worksheet Note:</i>	
(8?6? Pour) If the Purchaser has purchased or been provided with an 8-foot 6-inch basement concrete pour (being an increase from the Vendor?s standard basement depth) the depth is measured from the top of footing to the top of foundation wall. The incre <i>Worksheet Note:</i>	
10 foot ceiling height on Main Level. The Purchaser acknowledges that as a result of the increased ceiling height from the Vendor?s standard ceiling height, various modifications to the interior and exterior of the dwelling unit may be made, including bu <i>Worksheet Note:</i>	
Granite kitchen counter top, from Vendor?s standard samples <i>Worksheet Note:</i>	
PURCHASER(S) ACKNOWLEDGES THAT THE PURCHASE PRICE IS INCLUSIVE OF ALL CREDITS AND PROMOTIONAL PACKAGES AVAILABLE AT TIME OF PURCHASE. <i>Worksheet Note:</i>	

This Document is Extremely Time Sensitive - Printed 10 Jun 22 at 15:53

Purchasers:

Harpreet Singh VIRDI & Shallu VIRDI // Surinder

Property: 567

Telephone Res. / Bus:

(289) 776-8361 /

Decor Advisor:

Julia Caivano

Model and Elevation: Springfield One (5 Bed with Guest Suite)

Lock Date:

6-Jun-22

6-Jun-22

Plan #: 62M-1266

Layout Changes: ☐ Yes ☒ No

Sketch Attached: ☒ Yes ☐ No

Exterior Colour Scheme:

1. Cabinetry

	Style and Colour	Hardware
Kitchen / Breakfast	MONACO 1048 FLAX	953SC
Laundry Room	ELISSE	STD
Powder Room	N/A	N/A
Master Ensuite Bathroom	MONACO 901 INK	464SA
Ensuite - #2/5	MONACO 901 INK	464SA
Ensuite - #3/4	MONACO 901 INK	464SA
Guest Ensuite	SABRA 823 DRIFTWOOD	464SA
	N/A	N/A
	N/A	N/A

Appliances:

Built In Appliances ☒ Yes ☐ No

Slide In Stove ☐ Yes ☒ No

Dishwasher Cabinet

☐ Closed ☒ Open

41" Upper Cabinets ☒ Yes ☐ No

Please NOTE: Standard Cabinet Height is 30"

Stove Opening

STANDARD 30"

NOTE: If not specified, opening will be set to builder's standard opening of approximately 30" width

Fridge Opening

STANDARD OPENING

NOTE: If not specified, opening will be set to builder's standard opening of approximately 37" width x 74" height

** Refer to Construction Summary

2. Counters

	Counter	Edge
Kitchen / Breakfast	QUARTZ - TIVOLI	#360 EDGE
Laundry Room		
Powder Room	N/A	N/A
Master Ensuite Bathroom	QUARTZ - ARABESCATO NUOVO	#360 EDGE
Ensuite - #2/5	QUARTZ - BELLAGIO	#360 EDGE
Ensuite - #3/4	QUARTZ - BELLAGIO	#360 EDGE
Guest Ensuite	QUARTZ - TRAMONTANA	#360 EDGE

** Refer to Construction Summary

Initials:

Purchasers:

Harpreet Singh VIRDI & Shallu VIRDI // Surinder

Property: 567

Telephone Res. / Bus:

(289) 776-8361 /

Decor Advisor:

Julia Caivano

Model and Elevation: Springfield One (5 Bed with Guest Suite)

Lock Date:

6-Jun-22

6-Jun-22

Plan #: 62M-1266

3. Ceramic Flooring

		At a 45	Threshold-If App.
Entrance Vestibule	CLASSIC CALACATTA MATTE 24X24 #50 TITANIUM	<input type="checkbox"/>	Metal Strip Where Applic.
Main Hall	STRIP	<input type="checkbox"/>	N/A
Kitchen / Breakfast	CLASSIC CALACATTA MATTE 24X24	<input type="checkbox"/>	#50 TITANIUM
Laundry Room	GARDA 570 DARK GREY 13X13	<input type="checkbox"/>	#50 TITANIUM
Powder Room	N/A	<input type="checkbox"/>	N/A
Master Ensuite Bathroom	LITHIUM SILVER POLISHED 24X24	<input type="checkbox"/>	#50 TITANIUM
Ensuite #2/5	GARDA GREY 13X13	<input type="checkbox"/>	#50 TITANIUM
Ensuite #3/4	GARDA GREY 13X13	<input type="checkbox"/>	#50 TITANIUM
Guest Ensuite	CLASSIC CALACATTA MATTE 24X24	<input type="checkbox"/>	#50 TITANIUM
Garage Entry	CLASSIC CALACATTA MATTE 24X24	<input type="checkbox"/>	#50 TITANIUM
		<input type="checkbox"/>	

** Refer to Construction Summary--- #50 TITANIUM GROUT

4. Ceramic Wall Tile

Master Ensuite Bathroom	Selection	Describe
Tub Deck Wall	N/A	
Tub Deck	N/A	
Tub Deck Skirt	N/A	
Shower Stall	LITHIUM SILVER POLISHED 12X24	#50 TITANIUM
Bathtub Enclosure Walls	N/A	
Ensuite #2/5	EXTRA WHITE /BEIGE 8X16 (719)	#50 TITANIUM
Ensuite #3/4	EXTRA WHITE /BEIGE 8X16 (719)	#50 TITANIUM
Guest Ensuite	EXTRA WHITE/GREY 8X16 (722)	#50 TITANIUM
Garage Entry	N/A	N/A
Kitchen Backsplash	QUARTZ - TIVOLI ***FULL HEIGHT - INCLUDES AREA	ABOVE STOVE -UPPER CABINET DELETED

** Refer to Construction Summary - #50 TITANIUM GROUT THROUGHOUT.

5. Plumbing Fixtures

All Bathrooms

White

Whirlpool

☐ Yes ☒ No

Dishwasher Rough-In

☒ Yes ☐ No

Waterline for Fridge

☒ Yes ☐ No

** Refer to Construction Summary

6. Trim Carpentry

Interior Doors	As Per Construction Specifications
Interior Trim	3" BB CASING WITH 7 1/4" BASEBOARD - COLONIAL
Door Handles	As Per Construction Specifications
Exterior Front Door Handle	As Per Construction Specifications

** Refer to Construction Summary

Initials: 

Purchasers:

Harpreet Singh VIRDI & Shallu VIRDI // Surinder

Property: 567

Telephone Res. / Bus:

(289) 776-8361 /

Decor Advisor:

Julia Caivano

Model and Elevation: Springfield One (5 Bed with Guest Suite)

Lock Date:

6-Jun-22

6-Jun-22

Plan #:

62M-1266

7. Outer Flooring

Main Hall	HARDWOOD - MIRAGE SWEET MEMORIES - 6 1/2" TREASURE RED OAK CHARACTER BRUSHED DURAMATT	
Living Room	HARDWOOD - MIRAGE SWEET MEMORIES - 6 1/2" TREASURE RED OAK CHARACTER BRUSHED DURAMATT	
Dining Room	HARDWOOD - MIRAGE SWEET MEMORIES - 6 1/2" TREASURE RED OAK CHARACTER BRUSHED DURAMATT	
Family Room	HARDWOOD - MIRAGE SWEET MEMORIES - 6 1/2" TREASURE RED OAK CHARACTER BRUSHED DURAMATT	
Den / Library / Study	N/A	
Basement Landing(If Applies)	N/A	
Lower Landing (If Applies)	HARDWOOD - MIRAGE SWEET MEMORIES - 6 1/2" TREASURE RED OAK CHARACTER BRUSHED DURAMATT	
Upper Landing	HARDWOOD - MIRAGE SWEET MEMORIES - 6 1/2" TREASURE RED OAK CHARACTER BRUSHED DURAMATT	
Upper Hall	HARDWOOD - MIRAGE SWEET MEMORIES - 6 1/2" TREASURE RED OAK CHARACTER BRUSHED DURAMATT	
Master Bedroom	LAMINATE - LEXINGTON - ROCHEFORT OAK - TL-LW1317-PEFC	
Bedroom #2	LAMINATE - LEXINGTON - ROCHEFORT OAK - TL-LW1317-PEFC	
Bedroom #3	LAMINATE - LEXINGTON - ROCHEFORT OAK - TL-LW1317-PEFC	
Bedroom #4	LAMINATE - LEXINGTON - ROCHEFORT OAK - TL-LW1317-PEFC	
Bedroom #5	LAMINATE - LEXINGTON - ROCHEFORT OAK - TL-LW1317-PEFC	
GUEST SUITE	HARDWOOD - MIRAGE SWEET MEMORIES - 6 1/2" TREASURE RED OAK CHARACTER BRUSHED DURAMATT	
Underpad	Type	Area
	N/A	N/A

** Refer to Construction Summary

8. Railings and Pickets

Railing Type	V-GROOVE / 4x4 BOX POST	Colour	TREASURE
Picket Type	EUROLINE 0	Colour	BLACK
Stringer / Riser	TREASURE	Colour	TREASURE
Treads	TREASURE	Colour	TREASURE

Red Oak Stairs with Semi Gloss Finish

☒ Yes ☐ No

** Refer to Construction Summary THE STAIN COLOURS OR FINISH AVAILABLE ON RISERS, TREADS, PICKETS AND RAILS (STAIRCASES), WILL NOT BE AN EXACT MATCH TO PREFINISHED HARDWOOD OR LAMINATE FLOORS.

9. Wall Paint Flat Finish

Main & Upper Hall	22 WARM GREY	Master Bedroom	22 WARM GREY
Living Room	22 WARM GREY	Bedroom #2	22 WARM GREY
Dining Room	22 WARM GREY	Bedroom #3	22 WARM GREY
Kitchen / Breakfast	22 WARM GREY	Bedroom #4	22 WARM GREY
Family Room	22 WARM GREY	Bedroom #5	22 WARM GREY
Powder Room	N/A	Master Ensuite	22 WARM GREY
Laundry Room	22 WARM GREY	Ensuite 2/5	22 WARM GREY
Den/Library	N/A	Ensuite 3/4	22 WARM GREY
Trim Paint-Semi Gloss	WHITE	Guest Suite	22 WARM GREY
		Garage Entry	22 WARM GREY

Smooth Ceilings First Floor ☒ Yes ☐ No

** Refer to Construction Summary

Purchasers:

Harpreet Singh VIRDI & Shallu VIRDI // Surinder

Property: 567

Telephone Res. / Bus:

(289) 776-8361 /

Decor Advisor:

Julia Caivano

Lock Date:

6-Jun-22

6-Jun-22

Project:

Russell Gardens Building Ltd.

Model and Elevation:

Springfield One (5 Bed with Guest Suite)

Plan #:

62M-1266

10. Plaster Mouldings and Medallions

Entrance Vestibule	N/A	N/A	Kitchen/Breakfast	N/A	N/A
Main Hall	N/A	N/A	Den/Library	N/A	N/A
Living Room	N/A	N/A	Lower Landing	N/A	N/A
Dining Room	N/A	N/A		N/A	N/A
Family Room	N/A	N/A			

** Refer to Construction Summary

11. Fireplace

Living Room			Family Room			Other Room - Specify		
Purchased	As Per Plan	N/A	Purchased	As Per Plan	N/A	Purchased	As Per Plan	N/A
<input type="radio"/>	<input type="radio"/>	<input type="radio"/>	<input type="radio"/>	<input checked="" type="radio"/>	<input type="radio"/>	<input type="radio"/>	<input type="radio"/>	<input type="radio"/>
Fireplace Type			FLAT ON WALL					
Mantle Type			MANTLE M2-STANDARD					
Colour / Stain			WHITE					
Surround			GRIGIO CARNICO					
Hearth			N/A					

** Refer to Construction Summary

12. Heating and Air Conditioning

Air Conditioning	N/A	Gas Provisions Stove	YES
Gas Provisions Dryer	N/A	Gas Provisions Barbecue	YES
Comment			

** Refer to Construction Summary

13. Electrical

Plugs and Switches	<input checked="" type="radio"/> White	DECOR	Above Kitchen Cabinet Light	<input type="radio"/> Yes <input checked="" type="radio"/> No
Hood Fan	STANDARD WHITE TEMP.		Below Kitchen Cabinet Light	<input type="radio"/> Yes <input checked="" type="radio"/> No
Appliances	Built in Cooktop	Built in Oven	Gas Stove	Microwave
	<input type="radio"/> Yes <input checked="" type="radio"/> No	<input type="radio"/> Yes <input checked="" type="radio"/> No	<input checked="" type="radio"/> Yes <input type="radio"/> No	<input checked="" type="radio"/> Yes <input type="radio"/> No
Dishwasher Rough-in	Yes			

** Refer to Construction Summary

14. General Comments

** Refer to Construction Summary

Disclaimers and Notes

- 1) Colours of all materials are as close as possible to builder's selection, but not necessarily identical due to variances in manufacturing.
- 2) Any extras listed above are null and void unless accompanied by a separate invoice/amendment. Said invoice must be paid in full.
- 3) The Purchaser agrees that this colour selection is final and that no changes will be permitted, unless required by the Vendor.
- 4) The Purchaser acknowledges reading and accepting document which contains other miscellaneous disclaimers

Signature:

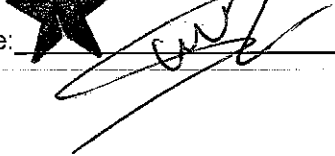

Date: 6/6/22

Signature:

Date:

LOT 564
Russell Gardens Phase 4

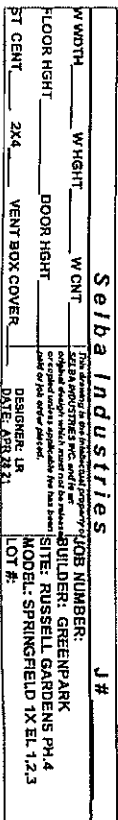

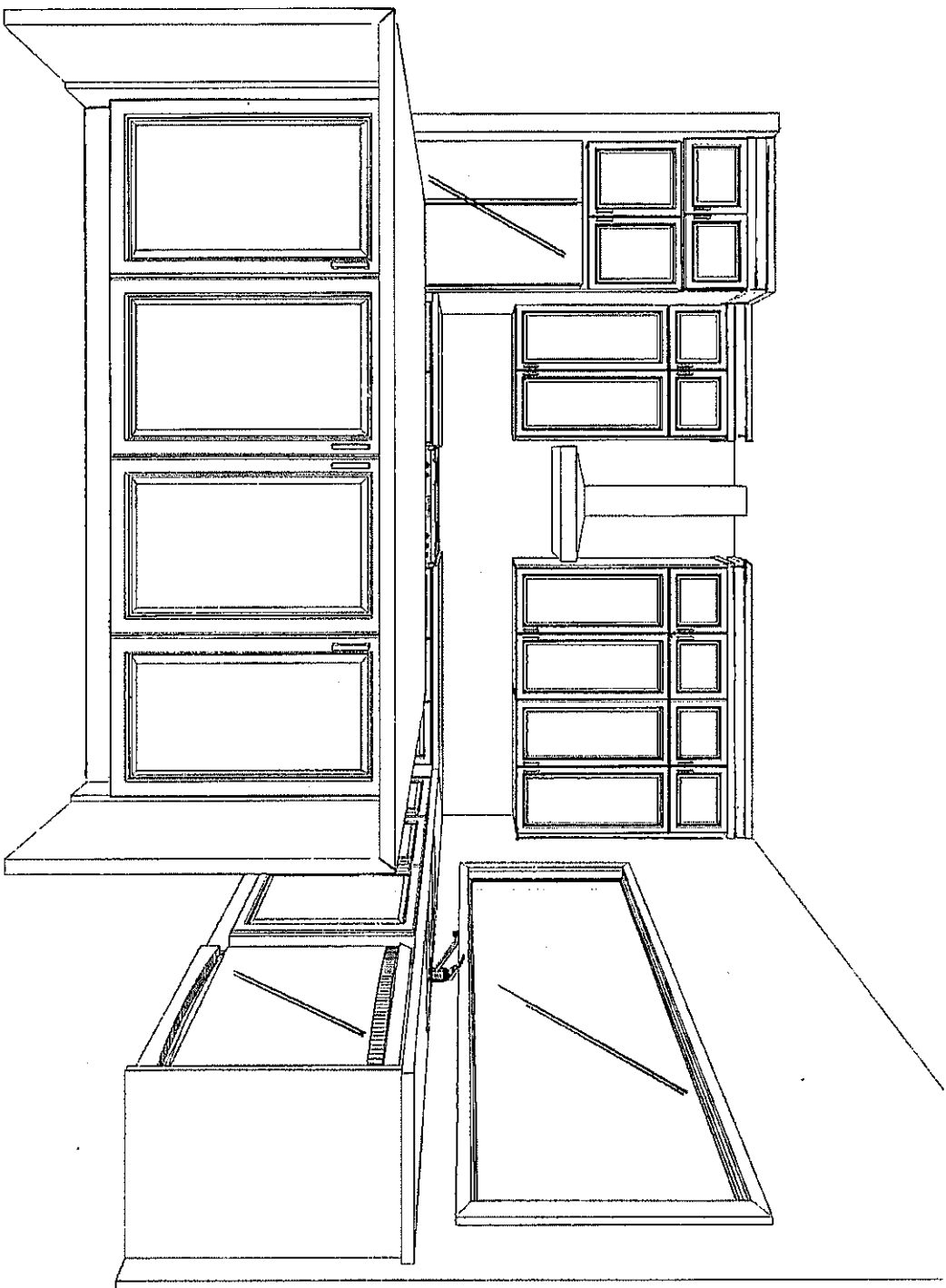

This drawing is the intellectual property of SELBA INDUSTRIES INC. and is an artistic interpretation of the general appearance of the design. It is not meant to be an exact rendition.



Designed: 6/7/2022
Printed: 6/8/2022

RUSSEL GARDENS LOT 567

LAYOUT

Drawing #: 1

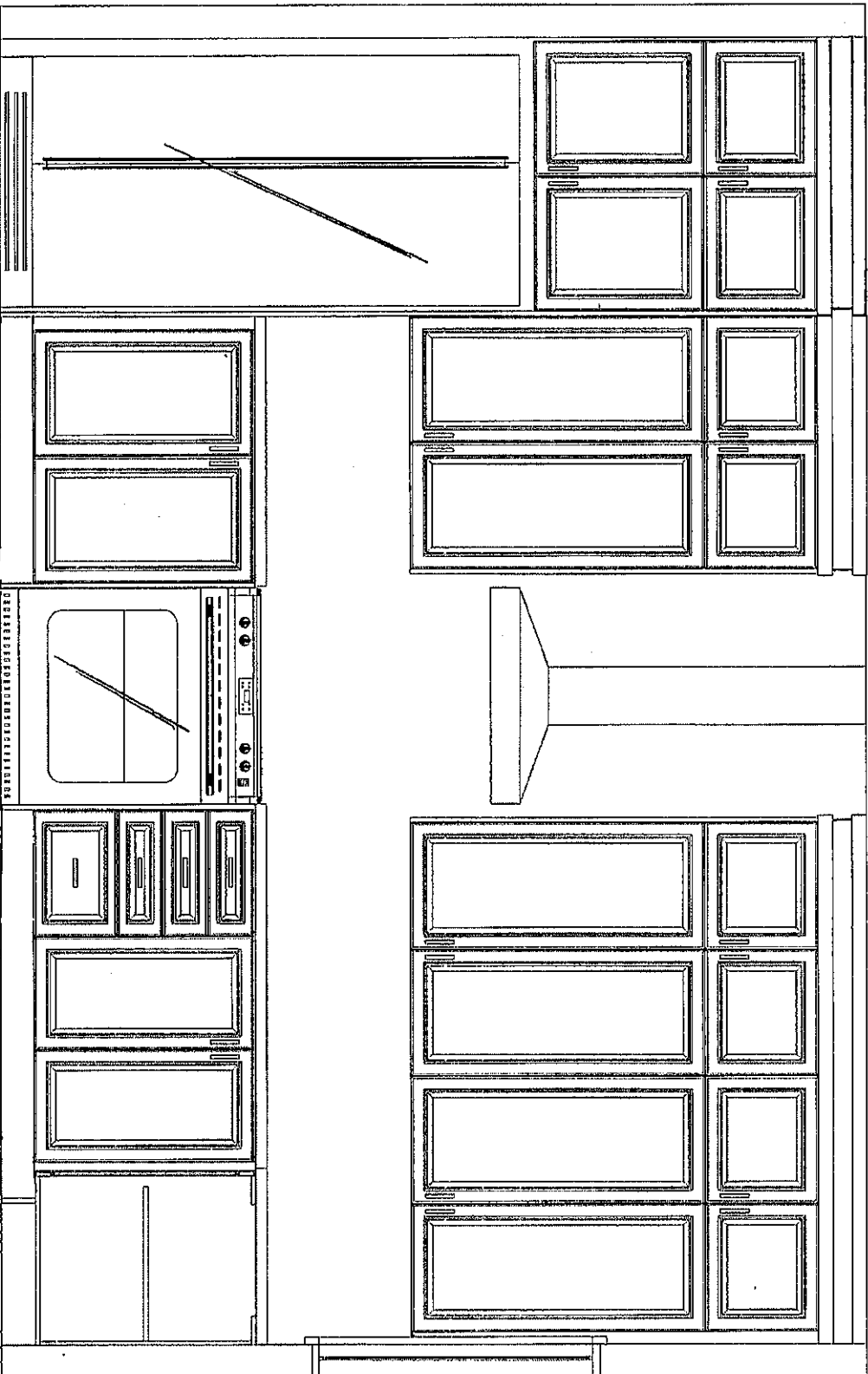

This drawing is the intellectual property of
SELBA INDUSTRIES INC. and is an
artistic
interpretation of the general
appearance of the design. It is
not meant to be an exact rendition.



Kitchen + Bath Designs

Designed: 6/7/2022
Printed: 6/8/2022

RUSSEL GARDENS LOT 567

LAYOUT

Drawing #: 1

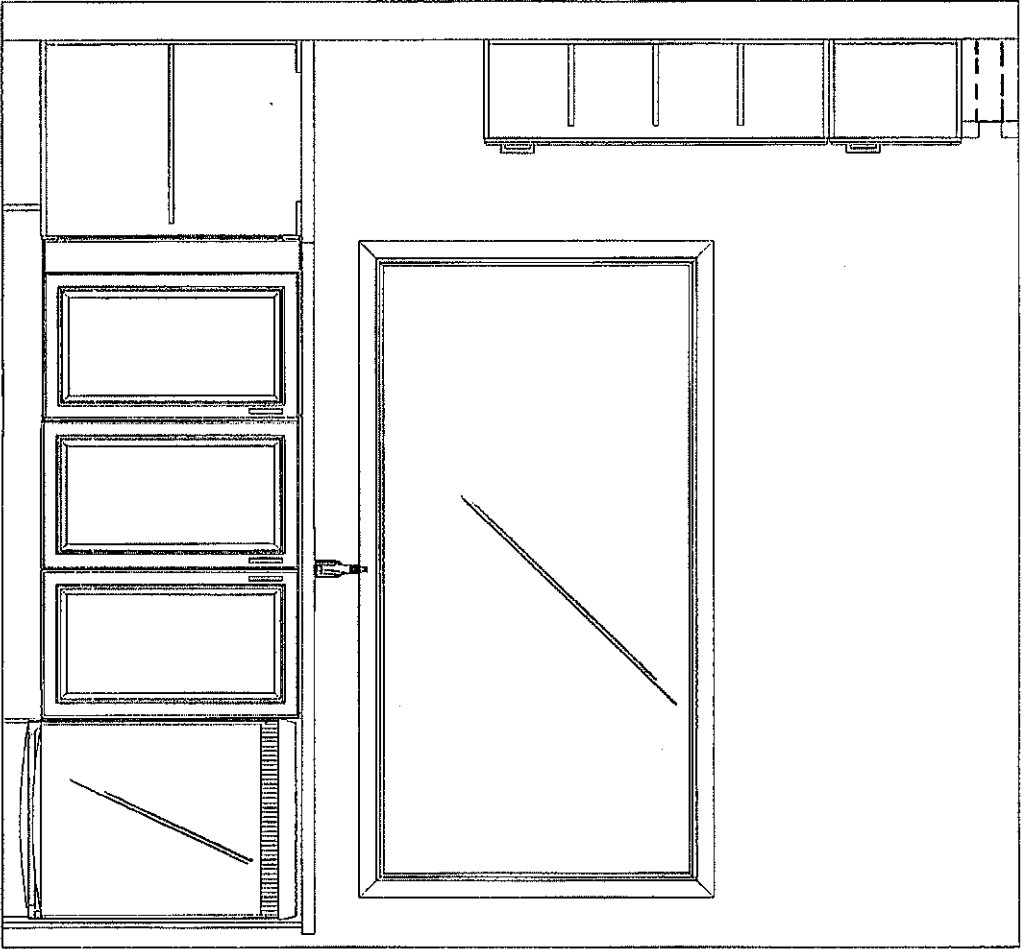

This drawing is the intellectual property of
SELBA INDUSTRIES INC. and is an
artistic
interpretation of the general
appearance of the design. It is
not meant to be an exact rendition.



Designed: 6/7/2022
Printed: 6/8/2022

RUSSEL GARDENS LOT 567

LAYOUT

Drawing #: 1

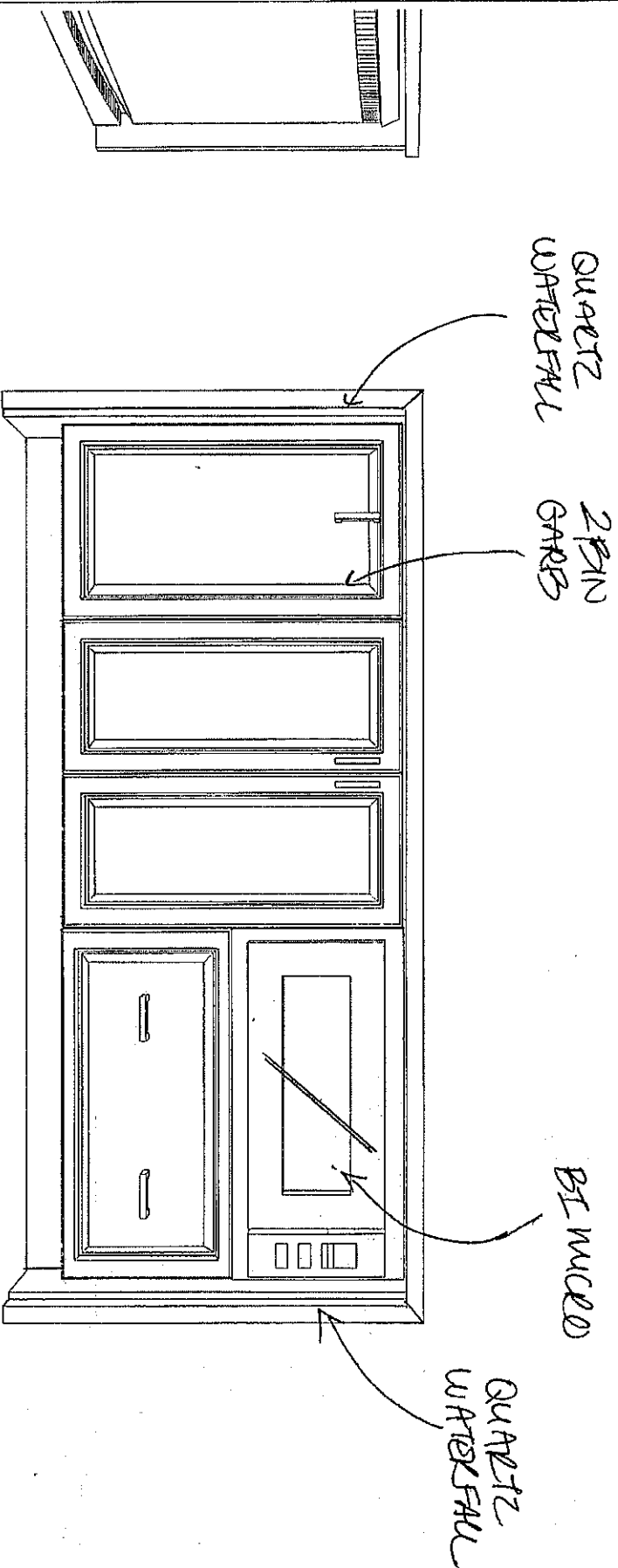

This drawing is the intellectual property of
SELBA INDUSTRIES INC. and is an
artistic
interpretation of the general
appearance of the design. It is
not meant to be an exact rendition.



Designed: 6/7/2022
Printed: 6/8/2022

RUSSEL GARDENS LOT 567

LAYOUT

Drawing #: 1

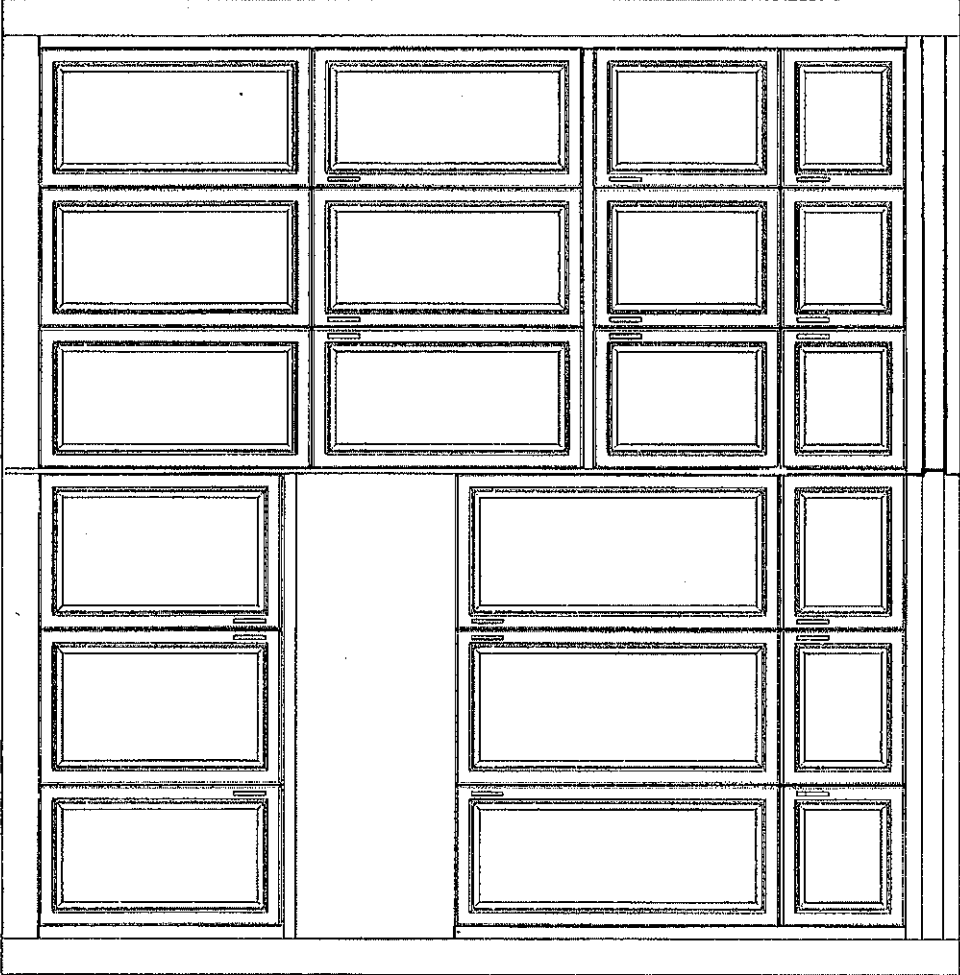

This drawing is the intellectual property of
SELBA INDUSTRIES INC. and is an
artistic
interpretation of the general
appearance of the design. It is
not meant to be an exact rendition.



Designed: 6/7/2022
Printed: 6/8/2022

RUSSEL GARDENS LOT 567

LAYOUT

Drawing #: 1

Café™ 30" Five in One Oven
with 240V Advantium® Technology
CSB923P4NW2 / CSB923P2NS1 / CSB923P3ND1

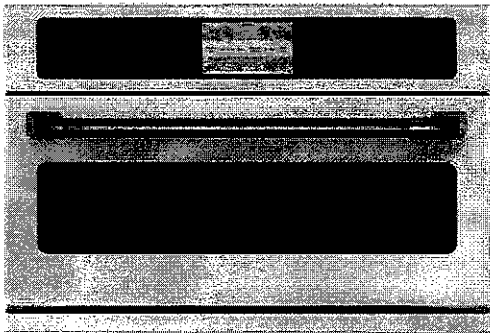

ALSO
AVAILABLE IN



CSB923P2NS1
Stainless Steel
with Brushed
Stainless handle



CSB923P3ND1
Matte Black with
Brushed Stainless
handle

FEATURES & BENEFITS

Unmatched versatility to unleash your imagination - Enjoy a whole new level of cooking flexibility with a single oven that can be used in five different ways. Use it as a Convection Oven, Microwave, Toaster Oven, Warming/Proofing Oven, and Precision Cook Oven with Advantium Technology.

Cook smarter, not longer - Achieve oven-quality results in a fraction of the time as halogen light, microwave energy and True European Convection work together to provide the exact amount and type of heat your food needs, precisely when it needs it

Brighten up life in the kitchen - Easily navigate wall oven settings using a stunning full color display that adds an unexpected touch of style to your kitchen

Say goodbye to rubbery leftovers - Achieve crispy results at microwave speed with more than 20 reheat programs that make leftovers taste like new

The perfect marriage of quality and speed - Eliminate the need for preheating and cook your favorite foods four-to eight-times faster than a conventional oven

Healthy meals without the fuss - Fresh vegetables and rice are perfectly prepared with a steam cook option that simplifies the entire process

Create a look that matches your personal style - Select any combination of premium finishes and hardware options to create a stunning look customized to any owner's taste

Clean-up has never been easier - Keep your oven looking like new at all times with steam clean

The perfect fit you've always dreamed of - When you're updating your kitchen, attention to detail is a priority. That's why Café Advantium wall ovens are guaranteed for an exact fit for an easy and seamless replacement.

APPEARANCE

Color Appearance	Matte White
Handle	Café Pro Style

lot 567
R/G. phase 4.
B/I MICRO @ KITCHEN ISLAND
BELOW COUNTER

PAGE 1 OF 3
CAFE
DISTINCT BY DESIGN™

FEATURES

Cooking Modes	Precision Cook; Crisp Reheat; Convection; Microwave; Proof, Warm
Style	Built-In
Control Type	7" Full Color LCD Touch Control
Interior Oven Light	Yes
Oven Interior	Stainless Steel
Microwave Watts (IEC-70S)	950
Turntable Size	16
Control Features	Add 30 Sec; Over 175 Programmed Menu Selections
Cooking Technology	5 in 1 Oven with 240V Advantium
Grill Pan	Yes
Rack Type	Wire Oven Rack

CAPACITY

Total Capacity (cubic feet)	17
-----------------------------	----

POWER/RATINGS

Electrical Input - 240V Watts	6300
Voltage (MIN)	208
Voltage (MAX)	240
Volts/Hertz	240V; 60Hz
Amps 240V/208V	30
Broiler Wattage	2400W

WEIGHTS & DIMENSIONS

Approximate Shipping Weight	92
Cavity (W x H x D)	20-1/16 x 8-1/2 x 17
Height (Front)	20-1/8
Net Weight	82
Overall Height	20-1/8
Overall Width	29-3/4
Overall Depth	21-1/2
Cabinet Width	30

ACCESSORIES

Metal Oven Pan	Yes - Precision Cooking Tray
----------------	------------------------------



Café™ 30" Five in One Oven
with 240V Advantium® Technology

CSB923P4NW2 / CSB923P2NS1 / CSB923P3ND1

C A F É

DISTINCT BY DESIGN™

WARRANTY

Parts warranty	Limited 1-year entire appliance
Labor warranty	Limited 5-year magnetron tube
Warranty notes	Limited 1-year entire appliance
	See written warranty for full details

B/I MICRO BELOW COUNTER
@ KITCHEN ISLAND

DIMENSIONS AND INSTALLATION INFORMATION

Note: Cabinets installed adjacent to wall ovens must have an adhesion spec of at least a 194°F temperature rating.

Note: 2" minimum between cutouts when installed above warming drawer or single wall oven.

Installation information: Before installing, consult installation instructions packed with product for current dimensional data.

Note: Advantium 240 volt models cannot be installed under 36 inches height.

Note: Use of the accessory drawer will replace the bottom trim piece for applicable installations. Please see installation instructions for full details.

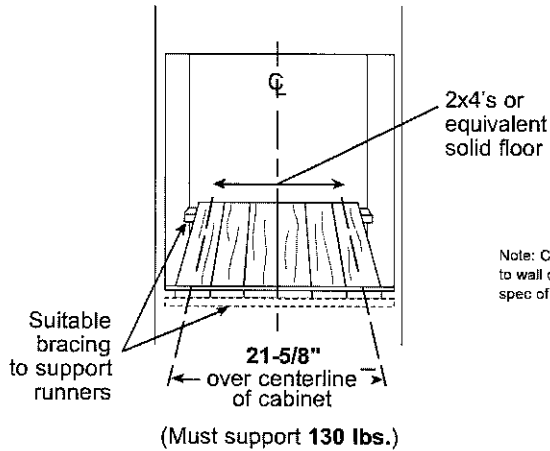
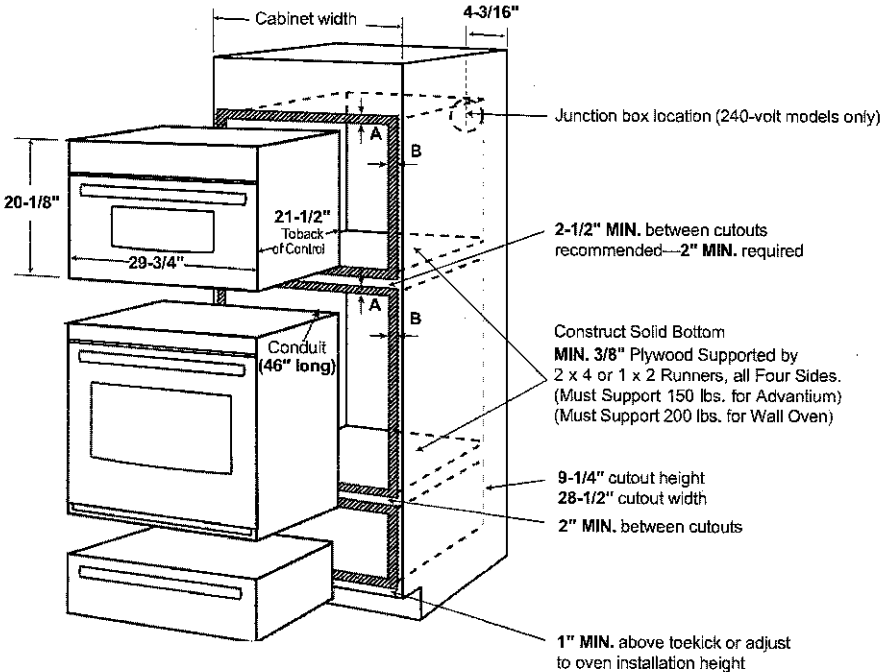

Note: Cabinets installed adjacent to wall ovens must have an adhesion spec of at least 194° F temperature rating.

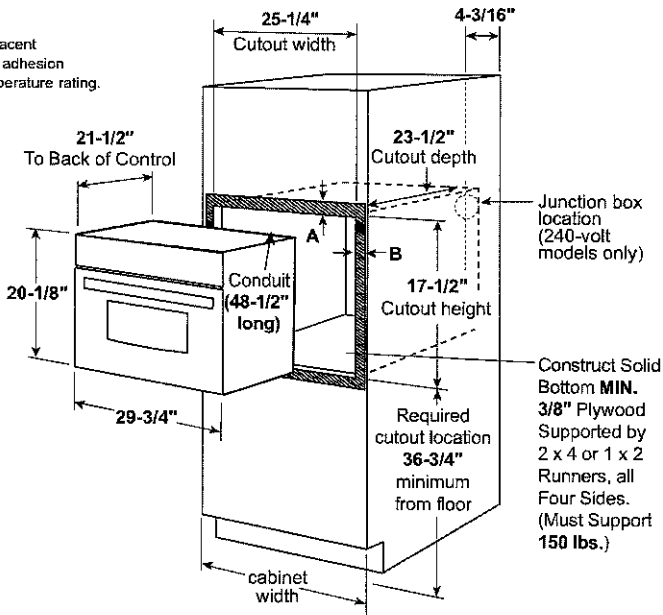

A= Allow 1" overlap of oven over bottom edge of cutout, and allow 2-3/4" overlap at top edge of cutout.
B= Allow 3/4" - 2-1/8" for overlap of oven over side edges of cutout.

For answers to your Café™ product questions, visit our website at cafeappliances.ca.

Café™ 30" Five in One Oven
with 240V Advantium® Technology R-G Phase 4

DISTINCT BY DESIGN™

DIMENSIONS AND INSTALLATION INFORMATION

Preparation with an Accessory Drawer

Prepare the opening: The Advantium 240V can be installed in combination with other GE/Monogram appliances. Always follow each product's Installation Instructions to complete the installation.

Single oven installation: Order a 30" wide single oven cabinet or cut the opening in a wall to the dimensions shown.

- * For existing cutouts, a maximum width of 28-1/2" is acceptable. If the opening is slightly wider, secure a furring strip on each side of the cutout for securing the oven.
- Always maintain 36-3/4" minimum height from the floor to the cutout in any single or combined installation.
- Allow 3/4" to 2-1/8" case trim overlap on the sides and 1" overlap on the bottom of the opening for all models. The amount of overlap on the sides depends on the actual cutout width. Allow 2-1/4" case trim overlap on the top.
- Oven overlaps will conceal cut edges on all sides of the opening.

When installed over a single oven or a warming drawer, allow at least 2" between the two openings. This separation will provide clearance for bottom overlap of the Advantium 240V and the other appliance overlaps. Construct a solid oven floor of 3/8" min. thick plywood supported by 2 x 4 or 2 x 2 runners on all sides.

- the support must be level and rigidly mounted, flush with the bottom edge of the cutout.
- * For existing cutouts, a maximum width of 28-1/2" is acceptable. If the opening is slightly wider, secure a furring strip on each side of the cutout for securing the oven.

Note: Additional clearances between the cutouts may be required. Check to be sure the oven supports above the Warming Drawer location do not obstruct the required interior depth and height. See Warming Drawer installation instructions for details.

Installation Over a Wall Oven and Warming Drawer:

- * For existing cutouts, a maximum width of 28-1/2" is acceptable. If the opening is slightly wider, secure a furring strip on each side of the cutout for securing the oven.

Note: Additional clearances between the cutouts may be required. Check to be sure the oven supports above the Warming Drawer location do not obstruct the required interior depth and height. See Warming Drawer installation instructions for details.

Caution: For personal safety, the mounting surface must be capable of supporting the cabinet load, in addition to the added weight of this approximate 80-pound oven and 30-pound drawer, plus additional oven loads of up to 50 pounds or a total weight of 160 pounds.

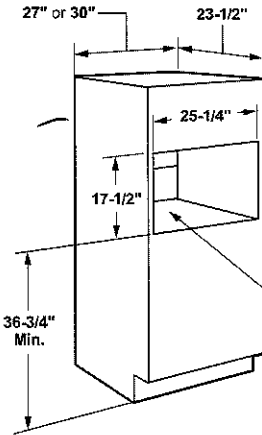

B11 MICRO
BELOW COUNTER
@ KITCHEN ISLAND

Construct base -
Min. 3/8" plywood
supported by 2x4
or 2x2 runners all
four sides.

Installation over Warming Drawer:

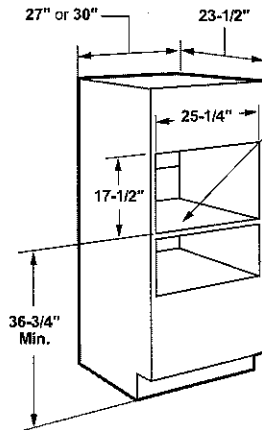

Construct base -
Min. 3/8" plywood
supported by 2x4
or 2x2 runners all
four sides.

2" Min.
(3" recommended)
Per warming
drawer
requirement

Installation over a Wall Oven and Warming Drawer:

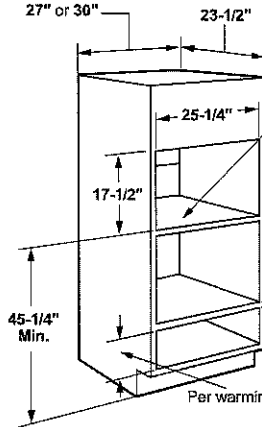

Construct solid
bottom - Min. 3/8"
plywood supported
by 2x4 or 2x2
runners all four
sides

2" Min.
(3" recommended)
Per oven
requirement
2" Min.
Per warming drawer
requirement

ADDITIONAL ACCESSORIES



CXWS0H0PMBZ
Brushed Bronze
1 handle
(standard on Matte White)

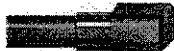

CXWS0H0PMSS
Brushed Stainless
1 handle
(standard on Matte Black)



CXWS0H0PMBT
Brushed Black
1 handle



CXWS0H0PMCU
Brushed Copper
1 handle