

CONSTRUCTION SUMMARY				
Mountainview Heights 3 (G) - Russell Gardens Building Ltd.			RECEIVED	
PURCHASERS: Vijaya Kumar RAYUDU and Bhargavi RAYUDU			JAN 13 2023	TEL:
LOT / PHASE	REG. PLAN #	HOUSE TYPE		
372 / 4	62M-1266	Springfield Three (4 Bed with Guest Suite) Elev 3		

CABINETRY

1 - KITCHEN - CM 11 CROWN MOULDING 09Mar22 Note:	
1 - KITCHEN - LIGHT VALANCE - NO ELECTRICAL 09Mar22 Note:	
1 - KITCHEN CABINETRY - TWO COLOUR KITCHEN - FLAT FEE 09Mar22 Note:	
1 - CABINETRY - KITCHEN - HARDWARE UPGRADE 1 09Mar22 Note:	
1 - CABINETRY - KITCHEN - UPGRADE 2 09Mar22 Note:	
1 - VANITY - GUEST ENSUITE BATHROOM - HARDWARE UPGRADE 1 09Mar22 Note:	
1 - VANITY - ENSUITE 3/4 - HARDWARE UPGRADE 1 09Mar22 Note:	
1 - VANITY - ENSUITE 2 - HARDWARE UPGRADE 1 09Mar22 Note:	
1 - VANITY - ENSUITE - HARDWARE UPGRADE 1 09Mar22 Note:	
1 - CABINETRY PROVISION - PROVISION FOR PLUG ON ISLAND (PLUG EXTRA ORDERED SEPARATELY) 09Mar22 Note:	

CABINETRY ACCESSORIES

1 - KITCHEN - BLU MOTION DRAWERS 09Mar22 Note:	
1 - KITCHEN - SOFT CLOSING CABINETRY 09Mar22 Note:	
1 - KITCHEN HOOD CABINETS - TRANSITIONAL WOOD HOOD (DHB) 800-1000 WIDE - UPGRADE 2 09Mar22 Note:	
1 - KITCHEN CABINETRY BASE - PULLOUT RECYCLE 4 BIN - PRICE IS EACH 09Mar22 Note:	
1 - KITCHEN CABINETRY BASE - POT/PAN DRAWERS (CABINET) - UPGRADE 2 09Mar22 Note:	
1 - KITCHEN CABINETRY BASE - BANK OF DRAWERS - UPGRADE 2 09Mar22 Note:	
2 - KITCHEN CABINETRY BASE - PULLOUT WIRE SPICE RACK - PRICE IS EACH 09Mar22 Note:	

CONSTRUCTION SUMMARY

Mountainview Heights 3 (G) - Russell Gardens Building Ltd.

PURCHASERS: Vijaya Kumar RAYUDU and Bhargavi RAYUDU

TEL:

LOT / PHASE	REG. PLAN #	HOUSE TYPE		
372 / 4	62M-1266	Springfield Three (4 Bed with Guest Suite) Elev 3		
1 - PANTRY UNIT UPGRADE - TO GO FROM 300MM TO 600MM DEEP - UPGRADE 2 09Mar22 Note:				
1 - KITCHEN CABINETRY - BUILT-IN FRIDGE CABINET - PRICE IS EACH 09Mar22 Note:			RECEIVED JAN 13 2023	★
REVISED SPECS ATTACHED				
1 - KITCHEN CABINETRY UPPER - FULL DEPTH ABOVE FRIDGE - WITH GABLES - 600MM - PRICE IS EACH - UPGRADE 2 09Mar22 Note:				
1 - KITCHEN CABINETRY BASE - COOKTOP CABINET WITH POT DRAWERS (2 DRAWERS) - UPGRADE 2 09Mar22 Note:				
NEW SPEC. Attached				
1 - KITCHEN CABINETRY - BUILT-IN MICROWAVE/OVEN COMBO - UPGRADE 2 09Mar22 Note:			RECEIVED JAN 13 2023	★
REVISED SPECS ATTACHED .				
1 - VANITY CABINETRY - RAISE VANITY TO 36" HIGH VANITY IN LIEU OF STANDARD HEIGHT - MASTER ENSUITE BATHROOM 09Mar22 Note:				
1 - VANITY CABINETRY - RAISE VANITY TO 36" HIGH VANITY IN LIEU OF STANDARD HEIGHT - POWDER ROOM 09Mar22 Note:				

CERAMIC TILE

1 - TILE - UPGRADE 4 WALL TILE - - OPTIONAL ENSUITE - SHOWER WALL 09Mar22 Note:	
1 - TILE - UPGRADE 4 FLOOR TILE - - OPTIONAL ENSUITE - FLOOR AREA 09Mar22 Note:	
1 - TILE - UPGRADE 4 FLOOR TILE - - MUD ROOM 09Mar22 Note:	
1 - TILE - UPGRADE 4 FLOOR TILE - - KITCHEN 09Mar22 Note:	
1 - TILE - UPGRADE 4 FLOOR TILE - - FOYER 09Mar22 Note:	
1 - TILE - UPGRADE 6 WALL TILE - - ENSUITE BATHROOM - SHOWER WALL 09Mar22 Note:	
1 - TILE - UPGRADE 6 FLOOR TILE - - ENSUITE BATHROOM - FLOOR 09Mar22 Note:	

CONSTRUCTION

1 - DELETE OR REDUCE BULK HEADS IN KITCHEN TO ACCOMMODATE CROWN MOULDING - IF CONSTRUCTION PERMITS 09Mar22 Note:	
1 - PROVISION FOR SHAMPOO NICHE APPROX. 24" WIDE X 20" HIGH AS PER SKETCH – IF CONSTRUCTION PERMITS - MASTER ENSUITE BATHROOM 09Mar22 Note:	
1 - SMOOTH CEILINGS ON FIRST FLOOR ONLY - DET 09Mar22 Note:	

COUNTER TOP

CONSTRUCTION SUMMARY				
Mountainview Heights 3 (G) - Russell Gardens Building Ltd.				TEL:
PURCHASERS: Vijaya Kumar RAYUDU and Bhargavi RAYUDU				
LOT / PHASE	REG. PLAN #	HOUSE TYPE		
372 / 4	62M-1266	Springfield Three (4 Bed with Guest Suite) Elev 3		
1 - SHOWER SEAT – UPGRADE MATERIAL IN LIEU OF STANDARD MATERIAL - MASTER ENSUITE BATHROOM 09Mar22 Note:				
1 - UPGRADE QUARTZ IN LIEU OF STANDARD GRANITE AS PER OFFER - KITCHEN 09Mar22 Note:				
1 - UPGRADE QUARTZ COUNTERTOP - GUEST ENSUITE BATHROOM 09Mar22 Note:				
1 - ENSUITE BATHROOM 3/4 VANITY COUNTER TOP 09Mar22 Note:				
1 - ENSUITE BATHROOM 2 VANITY COUNTER TOP 09Mar22 Note:				
1 - ENSUITE BATHROOM VANITY COUNTER TOP 09Mar22 Note:				
1 - SHAMPOO NICHE 24" WIDE X 20" HIGH AS PER SKETCH – MARBLE, GRANITE OR QUARTZ – IF CONSTRUCTION PERMITS - REQUIRES PROVISION FROM CONSTRUCTION - MASTER ENSUITE BATHROOM 09Mar22 Note: SUPPLY & INSTALL				
DOORS AND TRIM				
1 - DOORS INTERIOR - LINCON SMOOTH HALLOW IN LIEU OF STANDARD SERIES 09Mar22 Note:				
1 - TRIM - UPGRADE 2- 7-¼" BASEBOARD AND 3" CASING 09Mar22 Note:				
ELECTICAL				
1 - PLUG – ROUGH-IN FOR ELECTRIC CAR PLUG IN GARAGE – FOR FUTURE ELECTRIC CAR – 240V / 40-50 AMPS 09Mar22 Note: SPECIFICATIONS REQUIRED				
ELECTRICAL				
1 - KITCHEN - FAN INSERT FOR UPGRADE 36" HOOD - CYCLONE BX21534 09Mar22 Note:				
1 - BUILT IN OVEN AND COOKTOP PROVISION - PROVISION ONLY - ELECTRICAL ONLY 09Mar22 Note:				
4 - FAN - BATHROOM EXHAUST FAN - ENERGY STAR 80 CFM - IN LIEU OF STANDARD FAN - ALL BATHROOMS 09Mar22 Note:				
1 - PLUG - ELECTRICAL PLUG WITH GFI AND SWITCH - FOR FESTIVE LIGHTING 09Mar22 Note:				
1 - PLUG - ELECTRICAL PLUG - TO BE INSTALLED OVER FIREPLACE 09Mar22 Note:				
1 - PLUG - ELECTRICAL PLUG - ADD TO ISLAND 09Mar22 Note:				
1 - RELOCATE STANDARD KITCHEN LIGHT TO BE CENTERED OVER ISLAND 09Mar22 Note:				

CONSTRUCTION SUMMARY				
Mountainview Heights 3 (G) - Russell Gardens Building Ltd.				
PURCHASERS: Vijaya Kumar RAYUDU and Bhargavi RAYUDU				TEL:
LOT / PHASE 372 / 4	REG. PLAN # 62M-1266	HOUSE TYPE Springfield Three (4 Bed with Guest Suite) Elev 3		
1 - POT LIGHT - LED - FIRST FLOOR INSTALLATION - INSTALLED ON SEPERATE SWITCH FROM STANDARD LIGHT - KITCHEN WORKSPACE 09Mar22 Note:				
1 - POT LIGHT - LED - FIRST FLOOR INSTALLATION - INSTALLED ON SEPERATE SWITCH FROM STANDARD LIGHT - KITCHEN BREAKFAST 09Mar22 Note:				
1 - POT LIGHT - LED - FIRST FLOOR INSTALLATION - INSTALLED ON SEPERATE SWITCH FROM STANDARD LIGHT - FAMILY ROOM 09Mar22 Note:				
1 - POT LIGHT - LED - FIRST FLOOR INSTALLATION - INSTALLED ON SEPERATE SWITCH FROM STANDARD LIGHT - LIVING/DINING ROOM 09Mar22 Note:				
1 - 200 AMP ELECTRICAL SERVICE 09Mar22 Note:				
FIREPLACE AND ACCESSORIES				
1 - OVERMANTEL - CAST STONE - FOR 9 FOOT CEILING 09Mar22 Note:				
1 - MANTEL - CAST STONE - QUALITAS II STYLE MANTEL 09Mar22 Note:				
1 - GAS LINE ROUGH-IN FOR STOVE (INCLUDES ELECTRICAL OUTLET) - FIRST FLOOR 09Mar22 Note:				
HARDWOOD FLOORING				
1 - LAMINATE – UPGRADE TO PARKLANE SERIES IN LIEU OF STANDARD LAMINATE 09Mar22 Note:				
1 - HARDWOOD - GROUP B SERIES 6 1/2 INCH - IN LIEU OF 2 1/4 INCH NATURAL RED OAK - - MAIN HALL 09Mar22 Note:				
1 - HARDWOOD - GROUP B SERIES 6 1/2 INCH - IN LIEU OF 2 1/4 INCH NATURAL RED OAK - - LIVING AND DINING ROOM 09Mar22 Note:				
1 - HARDWOOD - GROUP B SERIES 6 1/2 INCH - IN LIEU OF 2 1/4 INCH NATURAL RED OAK - - GUEST SUITE 09Mar22 Note:				
1 - HARDWOOD - GROUP B SERIES 6 1/2 INCH - IN LIEU OF 2 1/4 INCH NATURAL RED OAK - - FAMILY ROOM 09Mar22 Note:				
MIRRORS AND GLASS				
1 - - GUEST ENSUITE BATHROOM – FRAMELESS GLASS SHOWER ENCLOSURE – INCLUDES CHROME KNOB AND HINGES 14Apr22 Note:				
1 - ***DELETE - FRAMELESS GLASS SHOWER DOOR FOR 5 FOOT PAN - INCLUDES CHROME KNOB & HINGES - GUEST ENSUITE BATHROOM 14Apr22 Note:				
1 - SHOWER DOOR HANDLE - MATTE BLACK D-RING WITH TOWEL BAR - MASTER ENSUITE BATHROOM 09Mar22 Note:				

CONSTRUCTION SUMMARY				
Mountainview Heights 3 (G) - Russell Gardens Building Ltd.				TEL:
PURCHASERS: Vijaya Kumar RAYUDU and Bhargavi RAYUDU				
LOT / PHASE	REG. PLAN #	HOUSE TYPE		
372 / 4	62M-1266	Springfield Three (4 Bed with Guest Suite) Elev 3		
1 - SHOWER DOOR HANDLE - CHROME D-RING & TOWEL BAR - GUEST ENSUITE BATHROOM				
09Mar22 Note:				
1 - FRAMELESS GLASS SHOWER DOOR FOR 5 FOOT PAN - INCLUDES CHROME KNOB & HINGES - GUEST ENSUITE BATHROOM				
09Mar22 Note:				
1 - FRAMELESS GLASS SHOWER DOOR & GLASS PANEL ABOVE VANITY - INCLUDES CHROME KNOB & HINGES - MASTER ENSUITE BATHROOM				
09Mar22 Note:				

PLUMBING

1 - FREESTANDING TUB - TUBCO CIRRUS SR 22 IN LIEU OF STANDARD FREE STANDARD TUB -MASTER ENSUITE BATHROOM	
09Mar22 Note:	
5 - SINK - UNDERMOUNT SINK - CONTRAC EMERY #4220CGY - ALL BATHROOMS	
09Mar22 Note:	
2 - TOILET - CONTRAC VIEIRA 2 PC TOILET #4792BOV/4791BOVU (UNLINED TANK) WITH SMOOTH CLOSE SEAT - GUEST ENSUITE BATHROOM & MASTER ENSUITE BATHROOMS	
09Mar22 Note:	
2 - TOE TESTER - ADD TOE TESTER TO SHOWER - GUEST ENSUITE & MASTER ENSUITE	
09Mar22 Note:	
1 - MASTER ENSUITE BATHROOM - MOEN ARRIS TWO HANDLE ROMAN TUB FACUET WITH HAND SHOWER - MATTE BLACK - TS93004 / 9796 / BL	
09Mar22 Note:	
2 - MASTER ENSUITE BATHROOM - MOEN ARRIS SINGLE HANDLE LAV FAUCET - MATTE BLACK - S43001 / BL	
09Mar22 Note:	
1 - MOEN ARRIS POSI-TEMP TUB/SHOWER FAUCET WITH 3 FUNCTION TRANSFER VALVE/TRIM AND SLIDE BAR WITH HAND SHOWER - MATTE BLACK - #TS22003EP/U361CI/UTS23005/62320/3887EP/A725 / BL	
09Mar22 Note:	
1 - KITCHEN - U BY MOEN SMART FAUCET - SLEEK SINGLE HANDLE PULLDOWN - MATTE BLACK - #7864EVBL	
09Mar22 Note:	
1 - SINK - UNDERMOUNT SINK - BLANCO QUATRUS R15 U SUPER SINGLE #401518	
09Mar22 Note:	
1 - HOT WATER VALVE NEXT TO TOILET - MASTER ENSUITE BATHROOM	
09Mar22 Note:	
1 - 5 FOOT SHOWER WITH SLIDING GLASS CHROME DOORS IN LIEU OF TUB - ENSUITE 3/4 BATHROOM	
09Mar22 Note:	
1 - WATER LINE FOR FRIDGE - ROUGH-IN ONLY	
09Mar22 Note:	

PROMOTIONAL

1 - LESS CREDIT FROM PURCHASER EXTRA SHEET IN OFFER	
09Mar22 Note:	

STAIRS AND RAILINGS

CONSTRUCTION SUMMARY				
Mountainview Heights 3 (G) - Russell Gardens Building Ltd.				
PURCHASERS: Vijaya Kumar RAYUDU and Bhargavi RAYUDU				TEL:
LOT / PHASE	REG. PLAN #	HOUSE TYPE		
372 / 4	62M-1266	Springfield Three (4 Bed with Guest Suite) Elev 3		
1 - STAIRCASE - V GROOVE HANDRAIL 09Mar22 Note: LARGER POST AND HANDRAIL				
1 - STAIRCASE - EUROLINE 0 IRON PICKETS - BLACK 09Mar22 Note:				
1 - STAINED STAIRS – STANDARD STAIRCASE - PRICE IS PER SET 09Mar22 Note:				

EXTRAS AS PER OFFER

(1) The Vendor agrees that notwithstanding any other term or provision in this Agreement included in the Purchase Price and in addition to those items detailed in Schedule GP to the Agreement of Purchase and Sale, the Purchaser is entitled to a credit of Worksheet Note:	
Granite kitchen counter top, from Vendor?s standard samples Worksheet Note:	
Purchase Price includes 3 enlarged basement windows, and the obligation to construct the house with the enlarged basement windows is subject to the Vendors approval, in its sole and unfettered discretion The Purchaser acknowledges and agrees that the loc Worksheet Note:	
PURCHASER(S) ACKNOWLEDGES THAT THE PURCHASE PRICE IS INCLUSIVE OF ALL CREDITS AND PROMOTIONAL PACKAGES AVAILABLE AT TIME OF PURCHASE. Worksheet Note:	

This Document is Extremely Time Sensitive - Printed 21 Dec 22 at 16:18

Purchasers:

Vijaya Kumar RAYUDU & Bhargavi RAYUDU

Property: 372

Telephone Res. / Bus:

/

Project: Russell Gardens Building Ltd.

Decor Advisor:

Candace Forza

Model and Elevation: Springfield Three (4 Bed with Guest Suite)

Lock Date:

9-Mar-22

9-Mar-22

Plan #: 62M-1266

Layout Changes:

☐ Yes ☒ No

Sketch Attached: ☒ Yes ☐ No

Exterior Colour Scheme:

1. Cabinetry

	Style and Colour	Hardware
Kitchen / Breakfast	ARUBA 400 BRIGHT WHITE *** ARUBA 699 PORT BLUE	451SB
Laundry Room	ELISSE	Standard
Powder Room	N/A	N/A
Master Ensuite Bathroom	MONACO 350 PLATINUM SILVER	451SB
Ensuite Bath - Bedroom 2	DORAL H3078 HACIENDA WHITE	451SB
Ensuite Bath - Bedroom 3/4	DORAL H3078 HACIENDA WHITE	451SB
Guest Ensuite Bathroom	MONACO 350 PLATINUM SILVER	451SB
	N/A	N/A
	N/A	N/A

Appliances:

Built In Appliances ☒ Yes ☐ No

Slide In Stove ☐ Yes ☒ No

Dishwasher Cabinet

☐ Closed ☒ Open

41" Upper Cabinets ☒ Yes ☐ No

Please NOTE: Standard Cabinet Height is 30"

Stove Opening

NOTE: If not specified, opening will be set to builder's standard opening of approximately 30" width

Fridge Opening

NOTE: If not specified, opening will be set to builder's standard opening of approximately 37" width x 74" height

** Refer to Construction Summary

2. Counters

	Counter	Edge
Kitchen / Breakfast	QUARTZ-LYSKAMM	#360
Laundry Room	N/A	
Powder Room	N/A	
Master Ensuite Bathroom	QUARTZ-PAPIRO	#360
Ensuite Bath - Bedroom 2	QUARTZ-VIRGINIA	#360
Ensuite Bath - Bedroom 3/4	QUARTZ-VIRGINIA	#360
Guest Ensuite Bathroom	QUARTZ-GRECALE	#360
	N/A	
	N/A	

** Refer to Construction Summary

Initials:

B

R

Purchasers: Vijaya Kumar RAYUDU & Bhargavi RAYUDU

Property: 372

Telephone Res. / Bus: /

Project: Russell Gardens Building Ltd.

Decor Advisor: Candace Forza

Model and Elevation: Springfield Three (4 Bed with Guest Suite)

Lock Date: 9-Mar-22

9-Mar-22

Plan #: 62M-1266

3. Ceramic Flooring

		At a 45	Threshold-If App.
Entrance Vestibule	TILE-VARENNA CARRARA POLISHED-24X24	<input type="checkbox"/>	metal strip where applicable
Main Hall	STRIP	<input type="checkbox"/>	
Kitchen / Breakfast	TILE-VARENNA CARRARA POLISHED-24X24	<input type="checkbox"/>	
Laundry Room	TILE-CONCEPT GREY-13X13	<input type="checkbox"/>	
Powder Room	N/A	<input type="checkbox"/>	
Master Ensuite Bathroom	TILE-MYSTIQ WHITE-24X24	<input type="checkbox"/>	
Ensuite Bath - Bedroom 2	TILE-ESSENZE GRIGIO-13X13	<input type="checkbox"/>	
Ensuite Bath - Bedroom 3/4	TILE-ESSENZE GRIGIO-13X13	<input type="checkbox"/>	
Guest Ensuite Bathroom	TILE-VARENNA CARRARA POLISHED-24X24	<input type="checkbox"/>	
Mud Room	TILE-VARENNA CARRARA POLISHED-24X24	<input type="checkbox"/>	
	N/A	<input type="checkbox"/>	

** Refer to Construction Summary

4. Ceramic Wall Tile

	Selection	Describe
Master Ensuite Bathroom		
Tub Deck Wall	N/A	
Tub Deck	N/A	
Tub Deck Skirt	N/A	
Shower Stall	TILE-MYSTIQ WHITE-12X24	SEAT & NICHE-QUARTZ PAPIRO
Bathtub Enclosure Walls	N/A	
Ensuite Bath - Bedroom 2	TILE-CONCEPT PLUS DARK GREY-8X16	
Ensuite Bath - Bedroom 3/4	TILE-CONCEPT PLUS DARK GREY-8X16	
Guest Ensuite Bathroom	TILE-VARENNA CARRARA POLISHED-12X24	
Mud Room	N/A	
	N/A	
Kitchen Backsplash		

** Refer to Construction Summary - STANDARD GROUT THROUGHOUT UNLESS SPECIFIED

5. Plumbing Fixtures

All Bathrooms

White

N/A

N/A

N/A

N/A

N/A

Whirlpool

N/A

Yes

No

Dishwasher Rough-In

Yes

No

Waterline for Fridge

Yes

No

** Refer to Construction Summary

6. Trim Carpentry

Interior Doors	LINCON-SMOOTH
Interior Trim	3" BB CASING WITH 7 1/4" BASEBOARD - COLONIAL
Door Handles	As Per Construction Specifications
Exterior Front Door Handle	As Per Construction Specifications

** Refer to Construction Summary

Initials:

B

R

Purchasers:

Vijaya Kumar RAYUDU & Bhargavi RAYUDU

Property: 372

Telephone Res. / Bus:

/

Project: Russell Gardens Building Ltd.

Decor Advisor:

Candace Forza

Model and Elevation: Springfield Three (4 Bed with Guest Suite)

Lock Date:

9-Mar-22

9-Mar-22

Plan #: 62M-1266

7. Other Flooring

Main Hall	STRIP-MIRAGE-SWEET MEMORIES-CHARACTER-MAPLE-DURAMATT-GELATO-6 1/2"	
Living Room	STRIP-MIRAGE-SWEET MEMORIES-CHARACTER-MAPLE-DURAMATT-GELATO-6 1/2"	
Dining Room	STRIP-MIRAGE-SWEET MEMORIES-CHARACTER-MAPLE-DURAMATT-GELATO-6 1/2"	
Family Room	STRIP-MIRAGE-SWEET MEMORIES-CHARACTER-MAPLE-DURAMATT-GELATO-6 1/2"	
Den / Library / Study	N/A	
Basement Landing(If Applies)	N/A	
Lower Landing (If Applies)	N/A	
Upper Landing	N/A	
Upper Hall	LAMINATE-PARKLANE-VENICE OAK LIGHT-TL-EL-3990	
Master Bedroom	LAMINATE-PARKLANE-VENICE OAK LIGHT-TL-EL-3990	
Bedroom #2	LAMINATE-PARKLANE-VENICE OAK LIGHT-TL-EL-3990	
Bedroom #3	LAMINATE-PARKLANE-VENICE OAK LIGHT-TL-EL-3990	
Bedroom #4	LAMINATE-PARKLANE-VENICE OAK LIGHT-TL-EL-3990	
Bedroom #5	N/A	
Guest Bedroom	STRIP-MIRAGE-SWEET MEMORIES-CHARACTER-MAPLE-DURAMATT-GELATO-6 1/2"	
	N/A	
	N/A	
Underpad	Type	Area
	N/A	N/A

** Refer to Construction Summary

8. Railings and Pickets

Railing Type	V-GROOVE	Complimenting Colour	MIRAGE GELATO MAPLE
Picket Type	EUROLINE 0	Complimenting Colour	BLACK
Stringer / Riser	AS PER CONSTRUCTION SPECIFICATIO	Complimenting Colour	MIRAGE GELATO MAPLE
Treads	AS PER CONSTRUCTION SPECIFICATIO	Complimenting Colour	MIRAGE GELATO MAPLE

Red Oak Stairs ☒ Yes ☐ No

** Refer to Construction Summary THE STAIN COLOURS OR FINISH AVAILABLE ON RISERS, TREADS, PICKETS AND RAILS (STAIRCASES), WILL NOT BE AN EXACT MATCH TO PREFINISHED HARDWOOD OR LAMINATE FLOORS.

9. Wall Paint Flat Finish

Main & Upper Hall	22 WARM GREY	Master Bedroom	22 WARM GREY
Living Room	22 WARM GREY	Bedroom #2	22 WARM GREY
Dining Room	22 WARM GREY	Bedroom #3	22 WARM GREY
Kitchen / Breakfast	22 WARM GREY	Bedroom #4	22 WARM GREY
Family Room	22 WARM GREY	Bedroom #5	N/A
Powder Room	22 WARM GREY	Master Ensuite	22 WARM GREY
Laundry Room	22 WARM GREY	Ensuite Bath - Bedroom 2	22 WARM GREY
Den/Library	N/A	Ensuite Bath - Bedroom 3/4	22 WARM GREY
Trim & Door Paint-Semi Gloss	BIRCH WHITE	Guest Bedroom	22 WARM GREY
	N/A		N/A
	N/A		N/A

Smooth Ceilings First Floor ☒ Yes ☐ No

** Refer to Construction Summary

Purchasers:Telephone Res. / Bus:Decor Advisor:Lock Date:

Vijaya Kumar RAYUDU & Bhargavi RAYUDUCandace Forza9-Mar-22

Property: 372Project: Russell Gardens Building Ltd.Model and Elevation: Springfield Three (4 Bed with Guest Suite)Plan #: 62M-1266

10. Plaster Mouldings and Medallions

Entrance Vestibule	N/A	N/A	Kitchen/Breakfast	N/A	N/A
Main Hall	N/A	N/A	Den/Library	N/A	N/A
Living Room	N/A	N/A	Lower Landing	N/A	N/A
Dining Room	N/A	N/A		N/A	N/A
Family Room	N/A	N/A			

** Refer to Construction Summary

11. Fireplace

	Living Room			Family Room			Other Room - Specify		
	Purchased	As Per Plan	N/A	Purchased	As Per Plan	N/A	Purchased	As Per Plan	N/A
	<input type="radio"/>	<input type="radio"/>	<input checked="" type="radio"/>	<input type="radio"/>	<input checked="" type="radio"/>	<input type="radio"/>	<input type="radio"/>	<input type="radio"/>	<input checked="" type="radio"/>
Fireplace Type	N/A			FLAT ON WALL			N/A		
Mantle Type	N/A			CASTONE - QUALITAS II			N/A		
Colour / Stain	N/A			NATURAL IVORY			N/A		
Surround	N/A			N/A			N/A		
Hearth	N/A			NO			N/A		

** Refer to Construction Summary

12. Heating and Air Conditioning

Air Conditioning	NO	Gas Provisions Stove	YES
Gas Provisions Dryer	NO	Gas Provisions Barbecue	NO
Comment			

** Refer to Construction Summary

13. Electrical

Plugs and Switches	<input checked="" type="radio"/> White	DECOR	Above Kitchen Cabinet Light	<input type="radio"/> Yes	<input checked="" type="radio"/> No
Hood Fan	CYCLONE INSERT 34" #BX21534		Below Kitchen Cabinet Light	<input type="radio"/> Yes	<input checked="" type="radio"/> No
Appliances	Built in Cooktop	Built in Oven	Gas Stove	Microwave	
	<input checked="" type="radio"/> Yes <input type="radio"/> No	<input checked="" type="radio"/> Yes <input type="radio"/> No	<input checked="" type="radio"/> Yes <input type="radio"/> No	<input checked="" type="radio"/> Yes <input type="radio"/> No	
Dishwasher Rough-in	Yes				

** Refer to Construction Summary

14. General Comments

** Refer to Construction Summary

Disclaimers and Notes

- 1) Colours of all materials are as close as possible to builder's selection, but not necessarily identical due to variances in manufacturing.

2) Any extras listed above are null and void unless accompanied by a separate invoice/amendment. Said invoice must be paid in full.

3) The Purchaser agrees that this colour selection is final and that no changes will be permitted, unless required by the Vendor.

4) The Purchaser acknowledges reading and accepting document which contains other miscellaneous disclaimers.

5) In the event of a conflict between the Standard Features schedule of the Agreement of Purchase and Sale and the Interior Colour Scheme, the Interior Colour Scheme shall prevail.

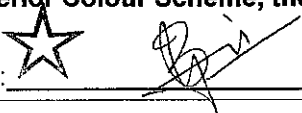
Signature: 

Date: March 9/22

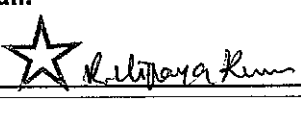
Signature: 

Date: March 9/22

WT 372
RG phase 4

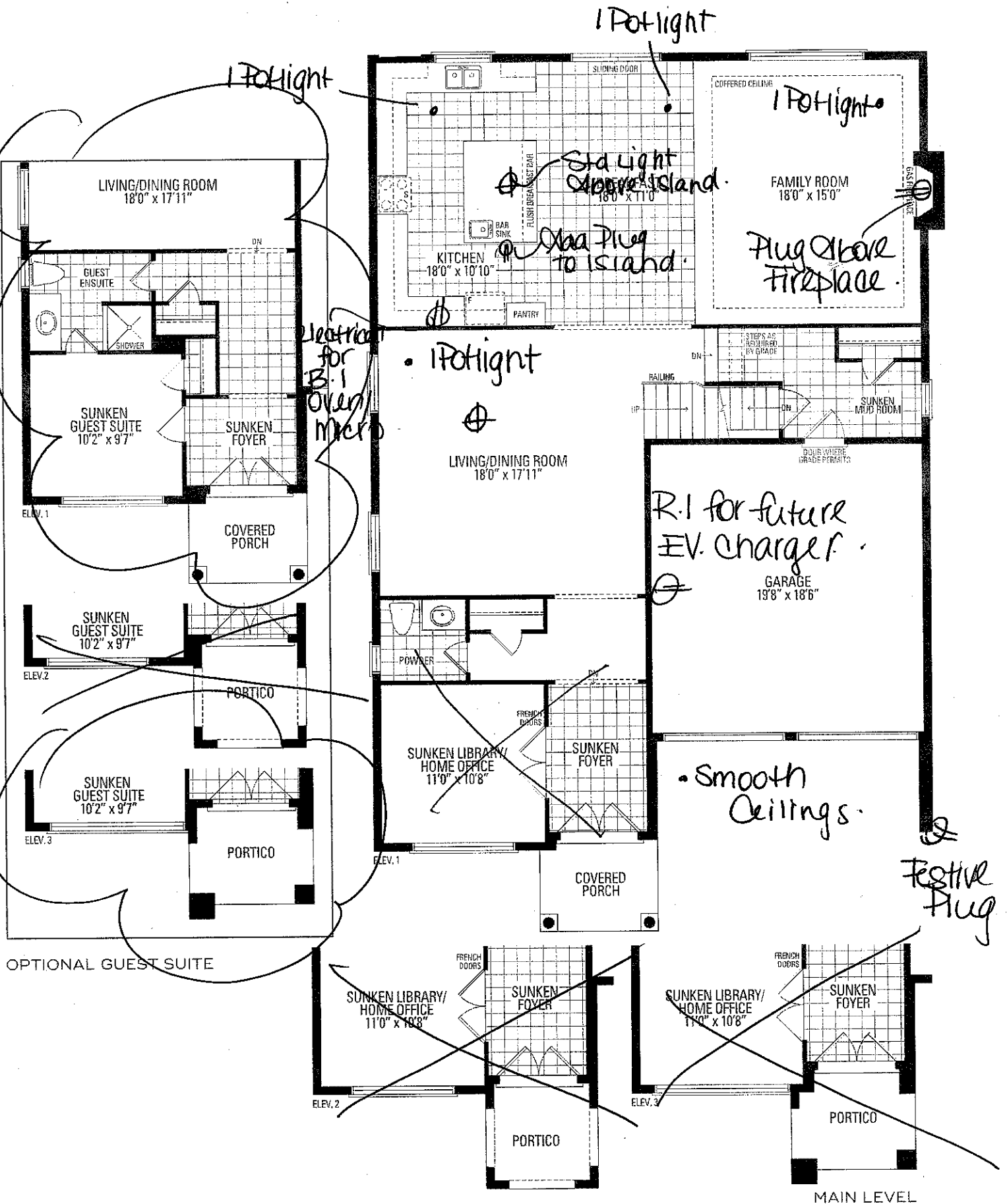

SPRINGFIELD THREE ELEV. 1 • 3,70

Orientation of home may be reversed and purchaser agrees to accept same. Steps and porches may vary stated floor areas. All renderings are artist's concept. Dimensions, specifications and architectural detail are

(B) (R)

R.G. Phase 4

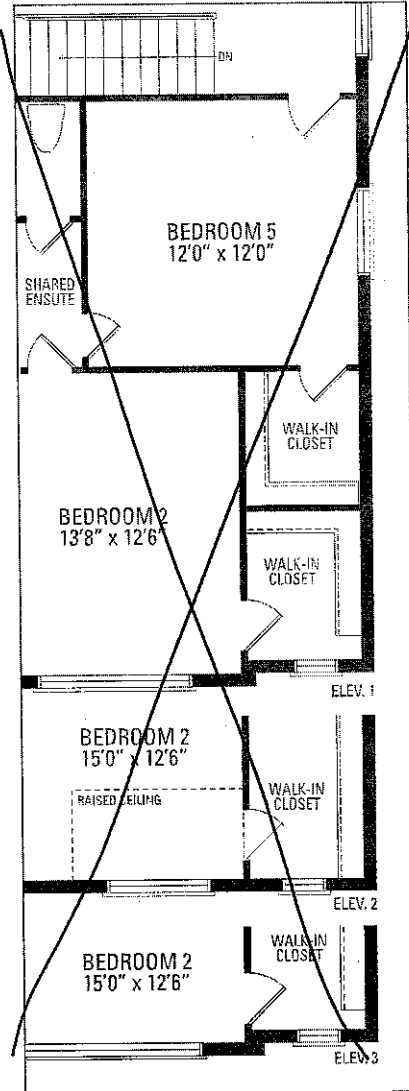

OPTIONAL 5 BEDROOM

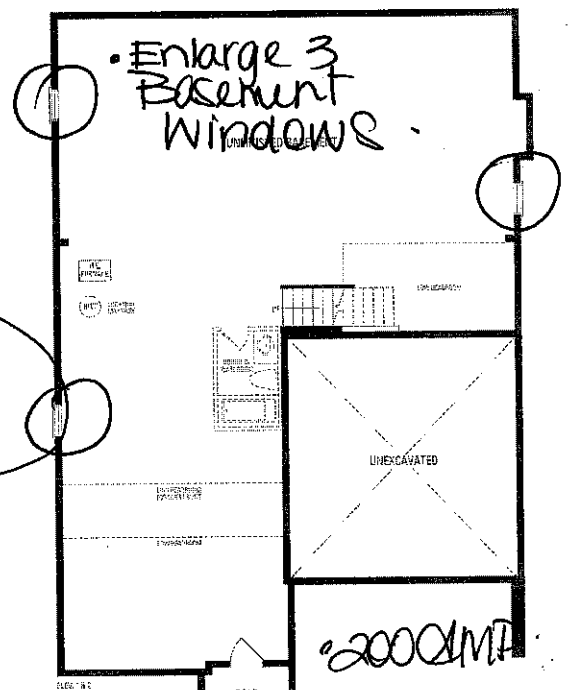

UPPER LEVEL

LOWER LEVEL

5 sq.ft. | ELEV. 2 • 3,744 sq.ft. | ELEV. 3 • 3,720 sq.ft.

at any exterior entrance ways due to grading variance. Actual usable floor space may vary from the subject to modifications. Roofline and adjoining model types may vary due to siting. E. & O.E May 2021



Kitchen

- 4pg. 2 Aruba Cabinetry
- 2nd Colour Cabinetry
 - 400 Bright White on Perimeter.
 - 699 Fort Blue on island, below cooktop + hood.
- 2nd 11 moulding
- Light Valance
- 4pg. 1 Hardware.
- Blue motion Drawers
- Soft closing Cabinetry.

LOT 372 R.G.
phase 4

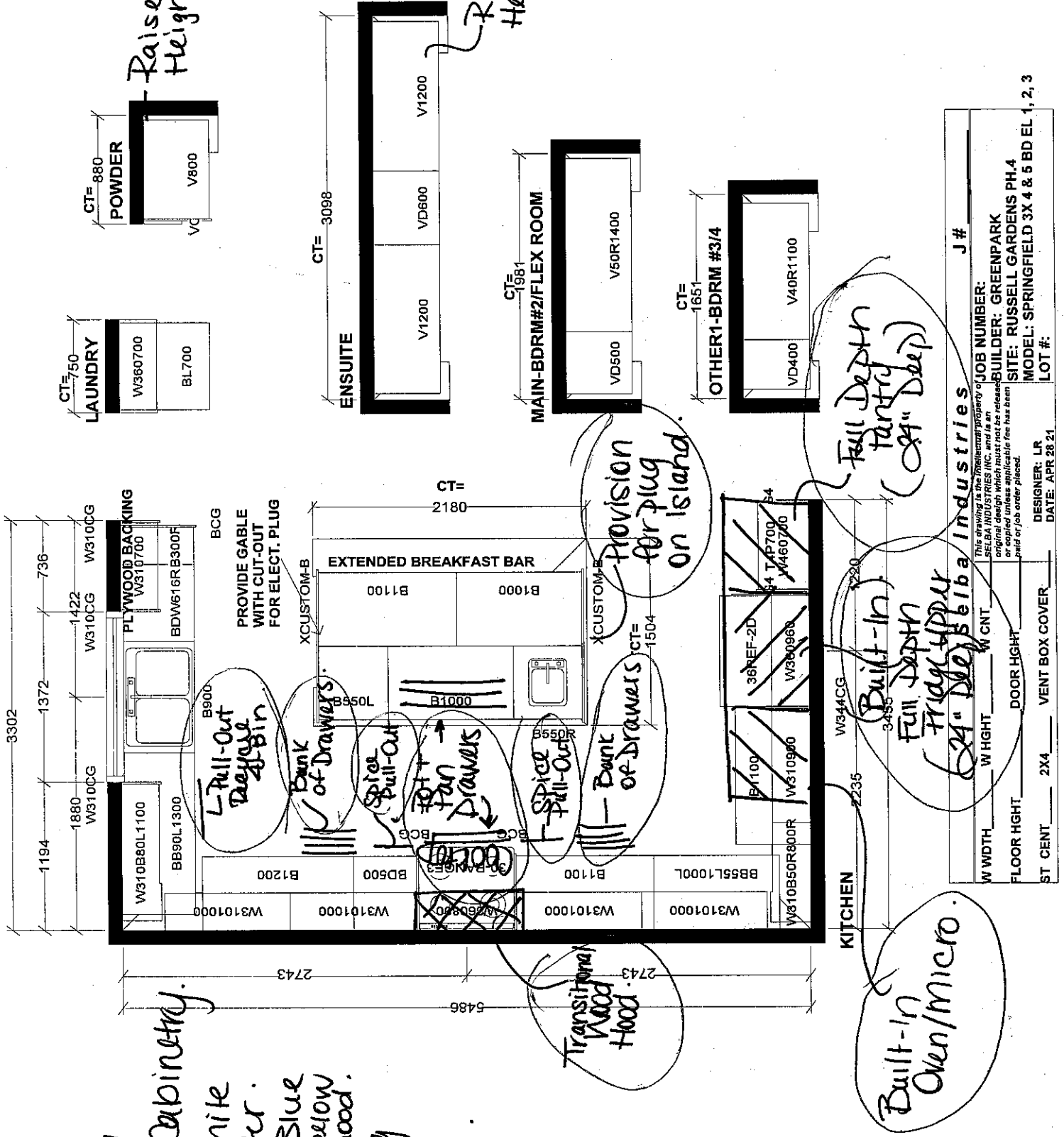



36", 6-BURNER GAS COOKTOP

Signature Features

JGC7636BS

18,000-BTU DUAL-STACKED POWERBURNER

This dual-stacked burner helps you achieve exceptional results with high-heat cooking techniques like searing or wok cooking while also giving you the control for delicate simmering.

ELECTRONIC IGNITION AND FLAME-SENSING™ RE-IGNITION

Gas burners light reliably every time, and if a draft blows the flames out, they are automatically re-ignited.

LOW-PROFILE DESIGN

With an extremely low profile, you can have a minimal look — nearly flush with the countertop — for an integrated transition to the cooktop.

SEMI-FLUSH INSTALLATION

Subtlety that dares to be ignored. Standing semi-flush at 3mm above the countertop, this precision edge is minimalism magnified.

6,000 BTU BRASS SIMMER BURNER

Melt chocolate and butter or simmer sauces just below boiling with a high-precision burner that offers a wide range of power.

9,000 BTU BRASS BURNER

Perfect for everyday cooking, this brass burner also allows you to meet special cooking needs like sautéing and braising.

WHITE LED BURNER INDICATOR

White indicator light glows indicating when a burner is on, providing a modern look and a convenient reminder for cooks.

EURO-STYLE STAINLESS DESIGN

With design elegance, this stainless steel suite combines modern aesthetics and classic flair for a timeless, upscale look.

SINGLE POINT ELECTRONIC IGNITION AND FLAME-SENSING™ RE-IGNITION

If the flame is accidentally blown out by a draft, a spark occurs that automatically re-ignites the extinguished burner.

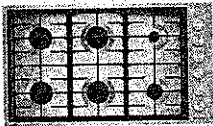

Dimensions

Depth: 53.34 cm

Height: 11.43 cm

Width: 91.44 cm

Controls

Knob Color: Stainless Steel

Infinite Heat Controls: Yes

Control Location: Right Side

Electrical

Power Cord Included: Yes

Design Type

Design Expression: Stainless Steel

Technical Specifications

Configuration and Overview

Size:

- 91.44 cm
- 36 cm

Cooktop Type: Traditional

Fuel Type: Gas

LP Convertible: Yes - Kit Included

Installs Over Built-In Oven: Yes

Power Boost: No

Cooktop Details

Automatic Pan Detection: No

Downdraft Vent: No

Heating Element On Indicator Light: Yes

Hot Surface Indicator Light: No

Number of Open Bays: NA

Cooktop Surface Color: Stainless

Ignition Type: Flame-Sensing™ Re-ignition

Cooktop Details

Grate Details:

- Dishwasher Safe
- Matte Finish
- Continuous
- Cast Iron Grates

Appearance

Digital Display: No

Certifications

Prop 65: Standard

ODS

isBaseUnit: true

GPC Code: 10001951

isConsumerUnit: true

isInvoiceUnit: true

isOrderableUnit: true

Product Type: EA

372 K.G.4

P. 2 of 15

Dec. 21/22

Number of Cooking Element-Burners: 6

UDEX: 1100400623

Number of Grates: 3

Details

Cooktop Surface Material: Stainless Steel

Description

Fuel Type: Gas

Size: 36

JENN-AIR® DETAILED PLANNING DIMENSIONS

1 of 3

36" GAS COOKTOP
JGC7636B – 36" x 5¼" x 21"

PRODUCT DIMENSIONS

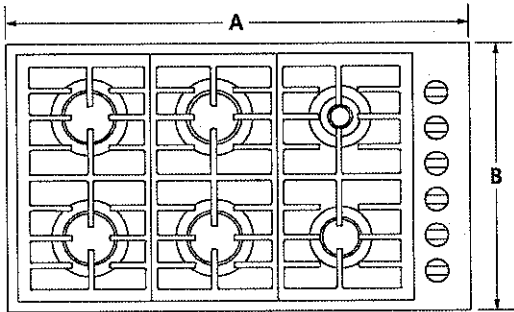

TOP VIEW

MODEL #		JGC7636B	
		in	cm
A	Overall width	36	91.4
B	Depth of cooktop	21	53.3
C	Center of cooktop to center of gas inlet	13½	34.3
D	Width of recessed cooktop	35¼	89.5
E	Height of recessed cooktop	3¼	8.3
F	Height from gas inlet to countertop	5¼	13.3
G	Height with grates	1¼	3.2
H	Depth of recessed cooktop	20¼	51.4

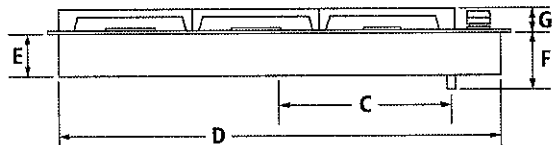

FRONT VIEW

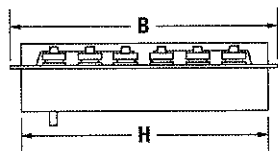

SIDE VIEW

IMPORTANT: Dimensional specifications are provided for planning purposes only.
Do not make any cutouts based on this information. Refer to the Installation Guide *before* selecting cabinetry, verifying electrical/gas connections, making cutouts or beginning installation.
All Jenn-Air® appliances are appropriately UL, CUL or CSA approved.



8559AdZw815

JENN-AIR® DETAILED PLANNING DIMENSIONS

2 of 3

36" GAS COOKTOP
JGC7636B – 36" x 5¼" x 21"

OPENING/CLEARANCE DIMENSIONS

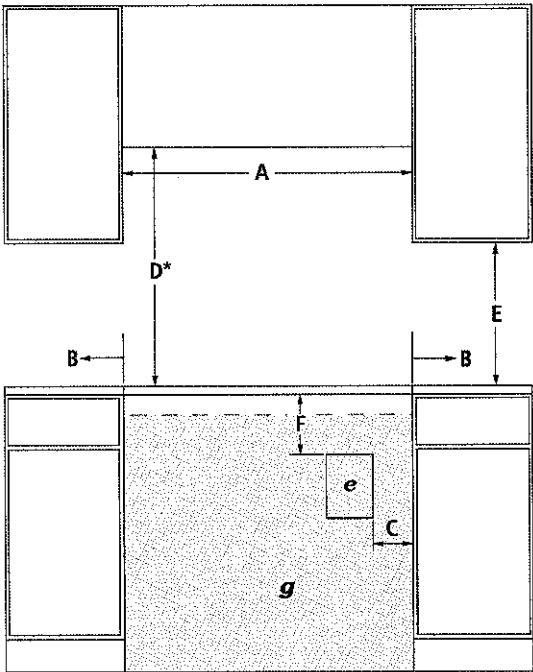

FRONT VIEW

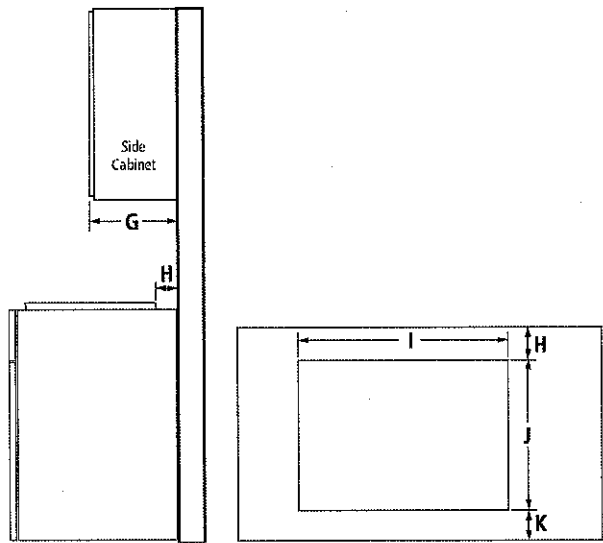

SIDE VIEW

TOP VIEW – CUTOUT

MODEL #		JGC7636B	
		in	cm
A	Width of combustable area above cooking surface (min.)	36	91.4
B	Width from cooktop to fixed wall or other combustable material (min.)	6	15.2
C	Width to outer edge of outlet (max.)	24	61.0
D*	Height to bottom of uncovered wood or metal cabinet above cooking surface (min.)	30	76.2
E	Height to bottom of uncovered wood or metal cabinet (min.)	18	45.7
F	Height to top edge of outlet (min.)	5½	14.0
G	Depth of upper cabinet (recommended)	13	33.0
H	Depth from cutout to wall (min.)	2¾	5.9
I	Width of cutout	35¾	89.9
J	Depth of cutout	20¾	51.8
K	Depth from cutout to front of countertop	2¾	5.9
e	Recommended electrical access location		
g	Recommended gas supply line location		

*Dimension can be reduced by 6" (15.2 cm) when bottom of wood or metal cabinet is covered by not less than ¼" (0.6 cm) flame retardant millboard covered with not less than No. 28 MSG sheet metal, 0.015" (0.4 mm) stainless steel, 0.024" (0.6 mm) aluminum or 0.020" (0.5 mm) copper. If installing a hood or microwave hood combination above the cooktop, follow the hood or microwave hood combination instructions for dimensional clearances above the cooking surface.

GAS REQUIREMENTS

Natural Gas

This cooktop is factory-set for use with natural gas.

LP Gas Conversion

Conversion must be done by a qualified service technician. To convert to LP gas, use an LP gas conversion kit.

ELECTRICAL REQUIREMENTS

120 volt, 60 Hz, AC only, 15-amp fused, electrical circuit is required. A time-delay fuse or dedicated circuit is recommended.

LOCATION REQUIREMENTS

- To ensure cooktop base clearance, cabinet side walls need to be wider than the cutout.
- If cabinet has a drawer, allow a 4" (10.2 cm) minimum clearance between countertop and top of drawer. Drawer depth may need to be shortened to avoid interfering with the regulator.

IMPORTANT: Dimensional specifications are provided for planning purposes only. Do not make any cutouts based on this information. Refer to the Installation Guide before selecting cabinetry, verifying electrical/gas connections, making cutouts or beginning installation. All Jenn-Air® appliances are appropriately UL, CUL or CSA approved.



8559AdZw815

JENN-AIR® DETAILED PLANNING DIMENSIONS

3 of 3

SINGLE WALL OVEN AND COOKTOP COMBINATIONS

For the approved model number combinations, refer to the under counter label located on top of the oven chassis and on the bottom of the cooktop burner box.

APPROVED MODEL NUMBER COMBINATIONS

SINGLE WALL OVENS

30-Inch: JJW3430D, JJW2430D
27-Inch: JJW2427D

INDUCTION COOKTOPS

36-Inch: JIC4536X
30-Inch: JIC4430X

GAS COOKTOPS

36-Inch: JGC7636B, JGC1536B
30-Inch: JGC7530B, JGC1530B

ELECTRIC COOKTOPS

36-Inch: JEC4536B, JEC3536B
30-Inch: JEC4430B, JEC3430B

OPENING/CLEARANCE DIMENSIONS

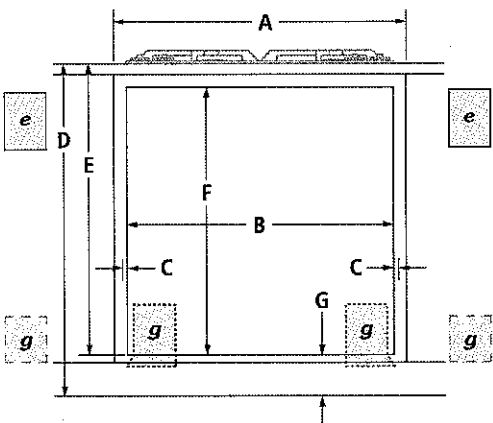

FRONT VIEW –
UNDER COUNTER INSTALLATION
(with cooktop installed above)

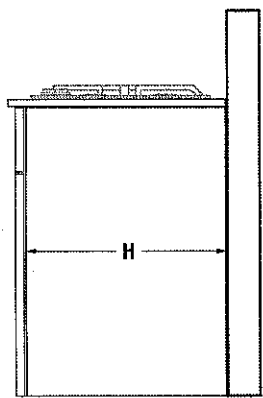

SIDE VIEW –
UNDER COUNTER INSTALLATION
(with cooktop installed above)

MODEL #		JJW3430D JJW2430D		JJW2427D	
		in	cm	in	cm
A	Width of cabinet (min.)	30	76.2	27	68.6
B	Width of cutout (recommended)	28½	72.4	25½	64.8
C	Oven trim overlap	⅝	1.6	⅝	1.6
D	Top of countertop to floor	36	91.4	36	91.4
E	Top of countertop to bottom of cutout				
	Induction cooktop combination	31⅝	79.7	31⅝	79.7
	Gas cooktop combination	31⅝	79.7	31⅝	79.7
	Electric cooktop combination	31⅝	79.7	31⅝	79.7
F	Height of cutout (recommended)	27¾	70.5	27¾	70.5
G	Bottom of cutout to floor				
	Induction cooktop combination	4⅝	11.7	4⅝	11.7
	Gas cooktop combination	4⅝	11.7	4⅝	11.7
	Electric cooktop combination	4⅝	11.7	4⅝	11.7
H	Depth of cabinet (min.)	24	61.0	24	61.0
J	Recommended junction box location				
G	Recommended gas supply line location for gas cooktop				

NOTE: For under counter installation, the junction box should be located in the adjacent right or left cabinet. Drill a 1" (2.5 cm) minimum diameter hole in an upper corner of the side wall for access to the junction box.

CABINET REQUIREMENTS

NOTE: When using under counter installation, check cabinet manufacturer's specifications to verify fit.

IMPORTANT: Dimensional specifications are provided for planning purposes only. Do not make any cutouts based on this information. Refer to the Installation Guide before selecting cabinetry, verifying electrical/gas connections, making cutouts or beginning installation. All Jenn-Air® appliances are appropriately UL, CUL or CSA approved.



8559AdZw815

MULTIMODE® CONVECTION SYSTEM

Steady heat is circulated by whirling metal blades, weaving around every flat tine. Weld your cooking prowess from marbled meats to succulent roasts.

TEMPERATURE PROBE

Know when dinner is done without ever opening the door. 4 points of contact deliver temperature readings visible on the LCD screen.

JET BLACK OVEN INTERIOR

Captivation cloaked in black. Beyond a dark glass expanse, cinematic lighting illuminates smooth racks, flat tines, and an enticing jet black interior.

4.3-INCH FULL COLOR LCD DISPLAY

A highly interactive, full-color LCD touchscreen is packed with dynamic features that allow you to navigate effortlessly through settings and cooking options including temperature and cooking mode.

SPEED-COOK

Renounce accepted limitations of the microwave. Three potent methods converge to deliver convection's steady heat, microwave speed and broiled caramelization in each oven-caliber bite.

CONVECTION & MICROWAVE COMBINATION COOKING

Let your appetite run wild—broil, bake or warm with convection and microwave energy.

GLIDE RACK

Smooth moves. Glides in and out fluidly and quietly, even when fully loaded.

MY CREATIONS

Curate recipe presets at will. Bake for 30 minutes, broil for 4 and keep dishes warm until you're ready to dine—all without lifting a finger.

CINEMATIC LIGHTING

Lights, camera, cook. Halogen lighting increases to full intensity, minimizing shadows and dramatically showcasing food.

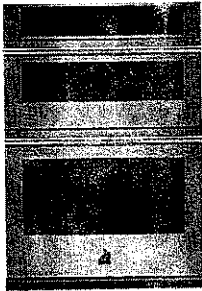

Dimensions

Depth: 59.06 cm

Height: 111.12 cm

Width: 76.20 cm

Electrical

Power Cord Included: No

Design Type

Design Expression: RISE™

Technical Specifications

Description

Fuel Type: Electric

Size: 30

Exterior

Handle Material: Metal

Door Lock: Yes

Flush Installation Approved: Yes

Microwave Details

Microwave Capacity: 1-2/5

Door Swing: Drop Down

Cooking Power: 900

Convection: Yes

Convection Power: 900

Grill: Yes

Grill Power: 1600.0

Details

Oven Capacity: 5.0

Door Broil Position: Closed

Interior Color: Black

Broiler Location: Top of Oven

Oven Rack 2 Type: Gliding Roll-Out

Convection Element Power: 3200

Oven Light Type: Halogen

Oven Interior Depth:

- 48.26 cm
- 19.0 cm

Oven Interior Height:

- 45.72 cm
- 18.0 cm

Oven Interior Width:

- 63.50 cm
- 25.0 cm

Number of Oven Racks: 3

Interior Light: Incandescent

Number of Racks: 1

Turntable: Stoppable

Turntable Diameter Size: 14-1/8

Details

Number of Rack Guides: 6

LOT 372
R.G 4

Hidden Bake Element: Yes

Certifications

Prop 65: Standard

Energy Rating: 390

Features

Language Conversion: English/French

PAGE 7 OF 15

JENNAIR® DETAILED PLANNING DIMENSIONS

1 of 2

30" COMBINATION MICROWAVE/WALL OVENS

JMW2430I JMW3430I – 30" x 43-3/4" x 25-5/16"

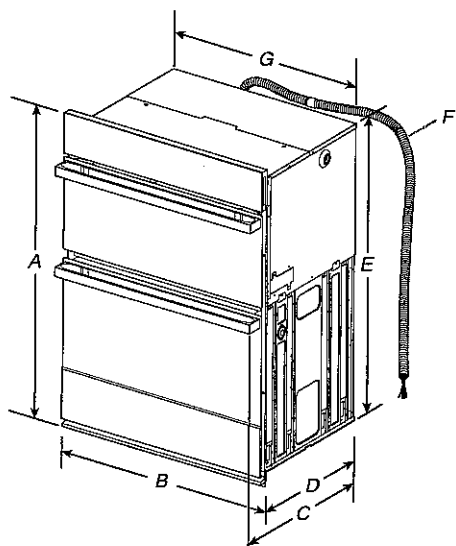

PRODUCT DIMENSIONS

30" (76.2 CM) MODELS

- A. 43-3/4" (111 cm) overall height
- B. 30" (76.2 cm) overall width
- C. JMW2430IM – 26-3/8" (67 cm)
JMW2430IL – 27-3/16" (69 cm)
JMW3430IM – 26-3/8" (67 cm)
JMW3430IL – 27-3/16" (69 cm)
- D. 23-1/4" (59.1 cm) max. recessed depth
- E. 41" (104.1 cm) recessed height
- F. 48" (121.9 cm) flexible conduit length measured from the conduit clamp located at the rear of the oven. Do not remove the conduit clamp.
- G. 28-7/16" (72.2 cm) recessed width

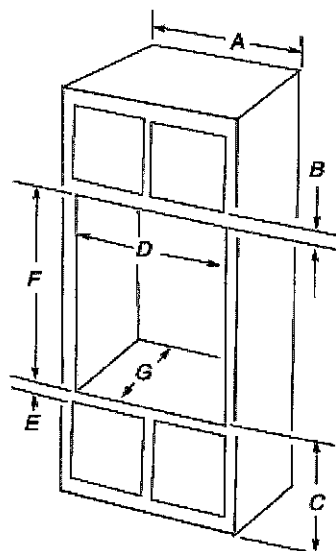

OPENING/CLEARANCE DIMENSIONS

30" (76.2 CM) MODELS

- A. 30" (76.2 cm) min. cabinet width
- B. 2-1/4" (5.7 cm) top of cutout to bottom of upper cabinet door
- C. 19-1/4" (48.9 cm) bottom of cutout to floor is recommended.
4"-19-1/4" (10.2–48.9 cm) bottom of cutout to floor is acceptable.
- D. 28-1/2" (72.4 cm) cutout width
- E. 1-1/2" (3.8 cm) min. bottom of cutout to top of cabinet door
- F. 41-5/16" (105 cm)* recommended cutout height
- G. 24" (60.7 cm) cutout depth

***NOTE:** The cutout height can be between 41" and 41-1/2" (104.1 cm and 105.6 cm) for microwave/oven combination.

IMPORTANT: Dimensional specifications are provided for planning purposes only.

Do not make any cutouts based on this information. Refer to the Installation or Use & Care Guide before selecting cabinetry, verifying electrical/gas connections, making cutouts or beginning installation. All JennAir® appliances are appropriately UL, CUL or CSA approved.

®/™ © 2018 JennAir. All rights reserved. JEN 25280-006.



JENNAIR® DETAILED PLANNING DIMENSIONS

2 of 2

30" COMBINATION MICROWAVE/WALL OVENS

JMW2430I JMW3430I – 30" x 43-3/4" x 25-5/16"

ELECTRICAL REQUIREMENTS

If codes permit and a separate ground wire is used, it is recommended that a qualified electrical installer determine that the ground path and the wire gauge are in accordance with local codes.

Check with a qualified electrical installer if you are not sure the oven is properly grounded.

This oven must be connected to a grounded metal, permanent wiring system.

Be sure that the electrical connection and wire size are adequate and in conformance with the National Electrical Code, ANSI/NFPA 70-latest edition or CSA Standards C22.1-94, Canadian Electrical Code, Part 1 and C22.2 No. 0-M91-latest edition, and all local codes and ordinances.

A copy of the above code standards can be obtained from:

National Fire Protection Association
1 Batterymarch Park
Quincy, MA 02169-7471

CSA International
8501 East Pleasant Valley Road
Cleveland, OH 44131-5575

- Models rated from 7.3 to 9.6 kW at 240 V (5.4 to 7.4 kW at A. Model/Serial/Rating Plate 208 V) require a separate 40 A circuit.
- A circuit breaker is recommended.
- Connect directly to the fused disconnect (or circuit breaker box) through flexible, armored or nonmetallic sheathed, copper cable (with grounding wire).
- Flexible conduit from the oven should be connected directly to the junction box.
- Do not cut the conduit. The length of conduit provided is for serviceability of the oven.
- A UL listed or CSA approved conduit connector must be provided.
- If the house has aluminum wiring, follow the procedure below:
Connect the aluminum wiring using special connectors and/or tools designed and UL listed for joining copper to aluminum. Follow the electrical connector manufacturer's recommended procedure. Aluminum/copper connection must conform with local codes and industry-accepted wiring practices.

For power requirements, refer to the following table:

Model	240 VAC	208 VAC
	kW	kW
JMW2430I	8.0	6.6
JMW3430I	8.2	6.6

ELECTRICAL CONNECTION

To properly install your oven, you must determine the type of electrical connection you will be using and follow the instructions provided for it here.

- Oven must be connected to the proper electrical voltage, amperage and frequency as specified on the model/serial/rating plate. See the following illustration.

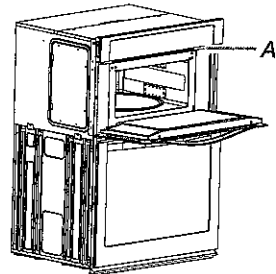

A. Model/Serial/Rating Plate

IMPORTANT: Dimensional specifications are provided for planning purposes only. Do not make any cutouts based on this information. Refer to the Installation or Use & Care Guide before selecting cabinetry, verifying electrical/gas connections, making cutouts or beginning installation. All JennAir® appliances are appropriately UL, CUL or CSA approved.



JAN 12/22

(approved
by selba)



RISE™ 48" BUILT-IN SIDE-BY-SIDE REFRIGERATOR WITH EXTERNAL ICE AND WATER DISPENSER

JBSS48E22L



Signature Features

DARING OBSIDIAN INTERIOR

Inspired by volcanic glass, this industry-exclusive dark finish draws attention with high-contrast style. Fine foods and fresh produce emerge like vibrant art, with LED lighting showcasing your ingredients against the alluring interior.

PRECISION TEMPERATURE MANAGEMENT™ SYSTEM

This sensor-controlled system manages temperatures in the refrigerator and freezer, helping to keep your ingredients at their ideal preservation temperatures. The smooth-running refrigerator avoids abrupt start and stop cycles to maintain quiet tranquility in your space.

SMOOTH CLOSE CRISPER DRAWERS

Each crisper drawer within the refrigerator smoothly opens and closes quietly, even while fully loaded with produce and fresh ingredients.

MULTI-POINT CINEMATIC LIGHTING

Illuminate food items against the Daring Obsidian Interior. Breathtaking Multi-Point Cinematic Lighting ramps up in intensity as you open the door to increase visibility and highlight your ingredients.

QUIETEST LUXURY BUILT-IN SIDE-BY-SIDE REFRIGERATOR

Running at 39 dBA, this refrigerator line-up has the quietest luxury built-in side-by-side refrigerators. With no abrupt start or stop cycles, this refrigerator fades into the background and becomes an unobtrusive piece of your kitchen.

RISE™ CUSTOM-KNURLED HANDLE

Forged for an era of striking proportions, robust lines draw the eye and an asymmetrical, diamond-knurled texture wraps around a strong, postured handle.

EXTERNAL ICE AND WATER DISPENSER

Fill your glass with fresh ice and water from a dispenser conveniently located in the door.

SOLID GLASS AND METAL

Each crisper drawer, shelf and door bin in the refrigerator is made up of solid glass and metal, reflecting and diffusing light against the Obsidian interior to enhance the visibility of your items. Each carefully chosen material is naturally durable and odor resistant.

GLASS SHELVEING

Showcase your ingredients with full-width glass and metal shelves. The clear glass allows light to filter through the substantial shelves, enhancing the visibility of everything inside the refrigerator.

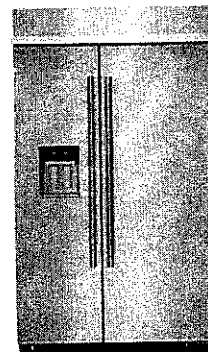

Dimensions

Depth: 70.48 cm

Height: 211.77 cm

Net Weight: 272.61 kg

Width: 122.87 cm

Controls

Door Ajar/Open Alarm: Yes

Automatic Defrost: Yes

Water Filter Indicator/Reset: Yes

Air Filter Indicator/Reset: No

LCD Touch Screen: No

Design Type

Design Expression: RISE™

Technical Specifications

Certifications

Prop 65: Standard

Energy Star® Qualified: ENERGY STAR® Qualified

Star K Certified: Yes

AHAM Volumes And Shelf Area

Freezer Volume: 10-3/10

Total Volume: 29-2/5

Description

Refrigerator Type: Side-by-Side

Refrigerator Compartment

Shelf Supports: Cantilever

Refrigerator Details

Lighting: LED

Freezer Compartment

Freezer Number of Shelves: 6

Freezer Details

Light: LED

Icemaker

Exterior
Hidden Hinge: Yes
Number of Doors: 2
Handle Material: Metal
Refrigerator Compartment
Number of Interior Shelves: 4

Icemaker: Factory Installed
Icemaker Location: Freezer
Filters
Fresh Flow Air Filter Included: No
Produce Preserver: Yes
Compatibility
Works With: No

LOT 372 RG4
PAGE 11 OF 15



Product Dimension Guide for models JBSSS42E22L/48E22L

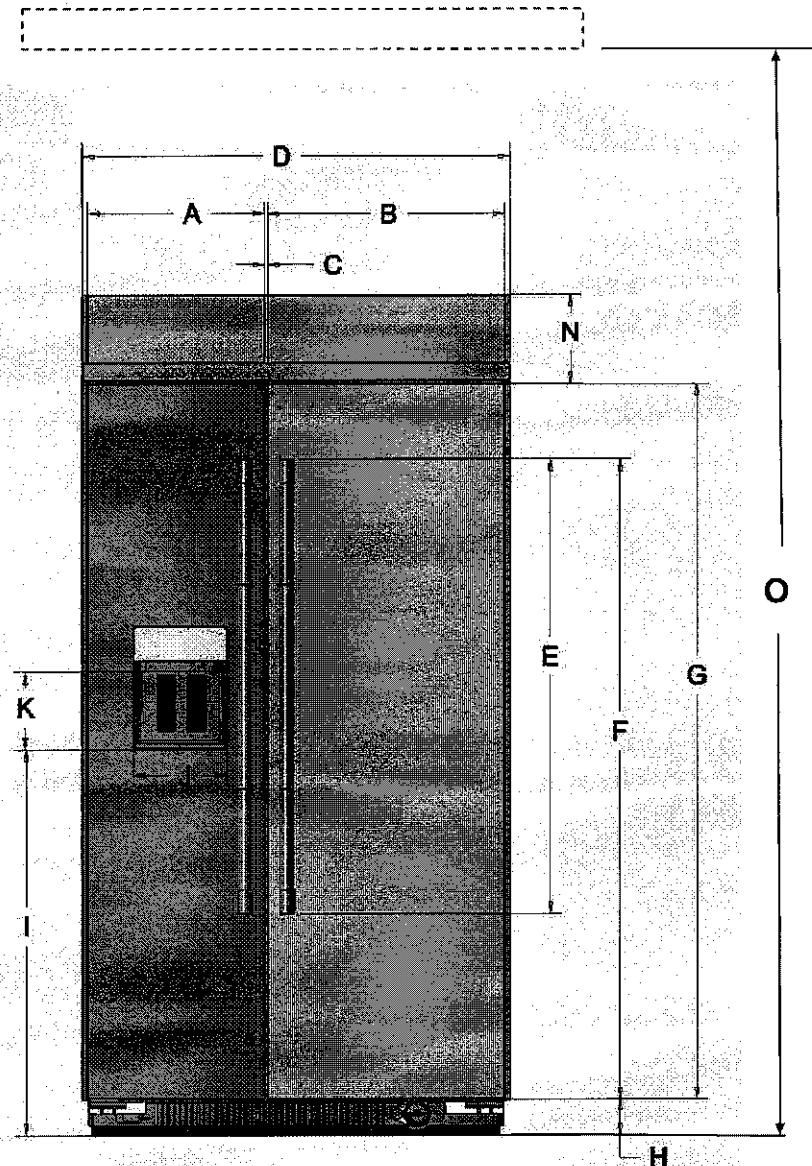

Description		Inches (cm)
A	Width of FC door	
	42"	17½" (44.4)
	48"	20" (50.8)
B	Width of RC door	
	42"	23½" (59.7)
	48"	27" (68.6)
C	Space between doors	1/4" (0.65)
D	Overall width with side trims	
	42"	42¾" (107.6)
	48"	48¾" (122.8)
E	Height of door handles	45" (114.3)
F	Height to top of door handles	63¾" (161.0)
G	Height of doors	70¹⁵⁄₁₆" (180.2)
H	Height of grille	3⁹⁄₁₆" (9.0)
I	Height to bottom of the Dispenser	38⁵⁄₁₆" (97.3)
J	Width of Dispenser	9³⁄₁₆" (23.3)
K	Height of Dispenser	7¹¹⁄₁₆" (19.5)
L	Water line location distance from side	17¾" (45.0)
M	Water line location distance from front	3¼" (8.2)
N	Height of grille (top)	8⁷⁄₈" (22.6)
O	To bottom of solid soffit (minimum/maximum)	83½" (212.1)
		84⁵⁄₈" (215)

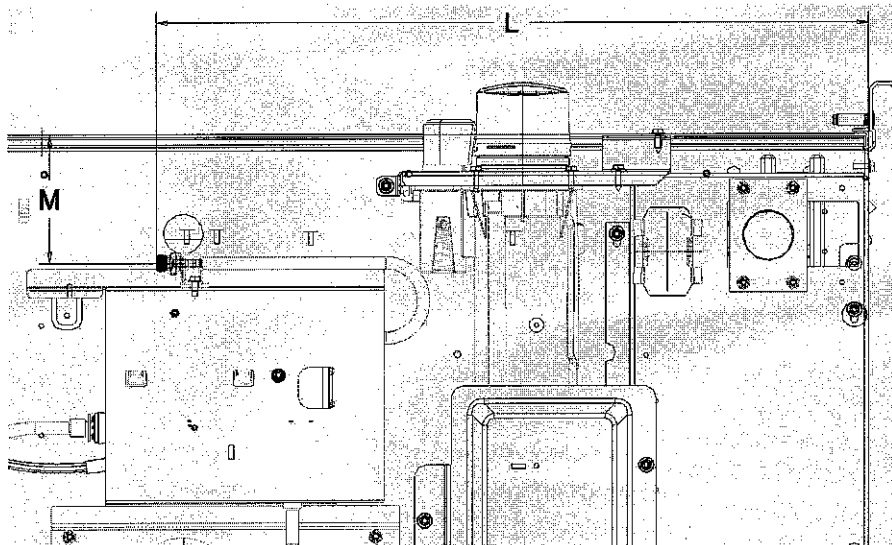

Because Whirlpool Corporation policy includes a continuous commitment to improve our products, we reserve the right to change materials and specifications without notice. Dimensions are for planning purposes only. For complete details, see Installation Instructions packed with product. Specifications subject to change without notice.

W11593506B

Power chord location

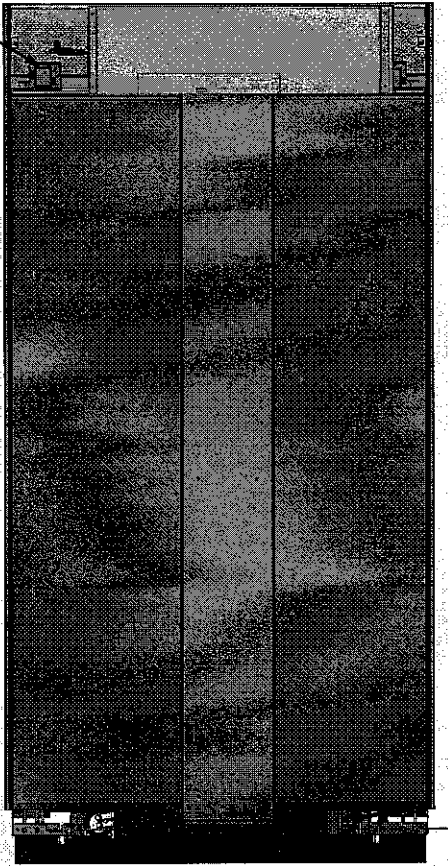

Electrical Requirements

⚠ WARNING



Electrical Shock Hazard

Plug into a grounded 3 prong outlet.

Do not remove ground prong.

Do not use an adapter.

Do not use an extension cord.

Failure to follow these instructions can result in death, fire, or electrical shock.

Electrical: A 115V, 60 Hz AC only, 15A or 20A fused, grounded electrical supply is required. It is recommended that a separate circuit serving only your refrigerator be provided. Use an outlet that cannot be turned off by a switch. Do not use an extension cord.

Because Whirlpool Corporation policy includes a continuous commitment to improve our products, we reserve the right to change materials and specifications without notice. Dimensions are for planning purposes only. For complete details, see Installation Instructions packed with product. Specifications subject to change without notice.

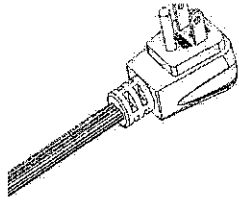
	Power chord	
	Type	Length
		Inches (cm)
	Standard	60" (152.5)

Water: A cold water supply with water pressure of between 30 psi and 120 psi (207 kPa and 827 kPa) is required to operate the water dispenser and ice maker. If you have questions about your water pressure, call a licensed, qualified plumber.

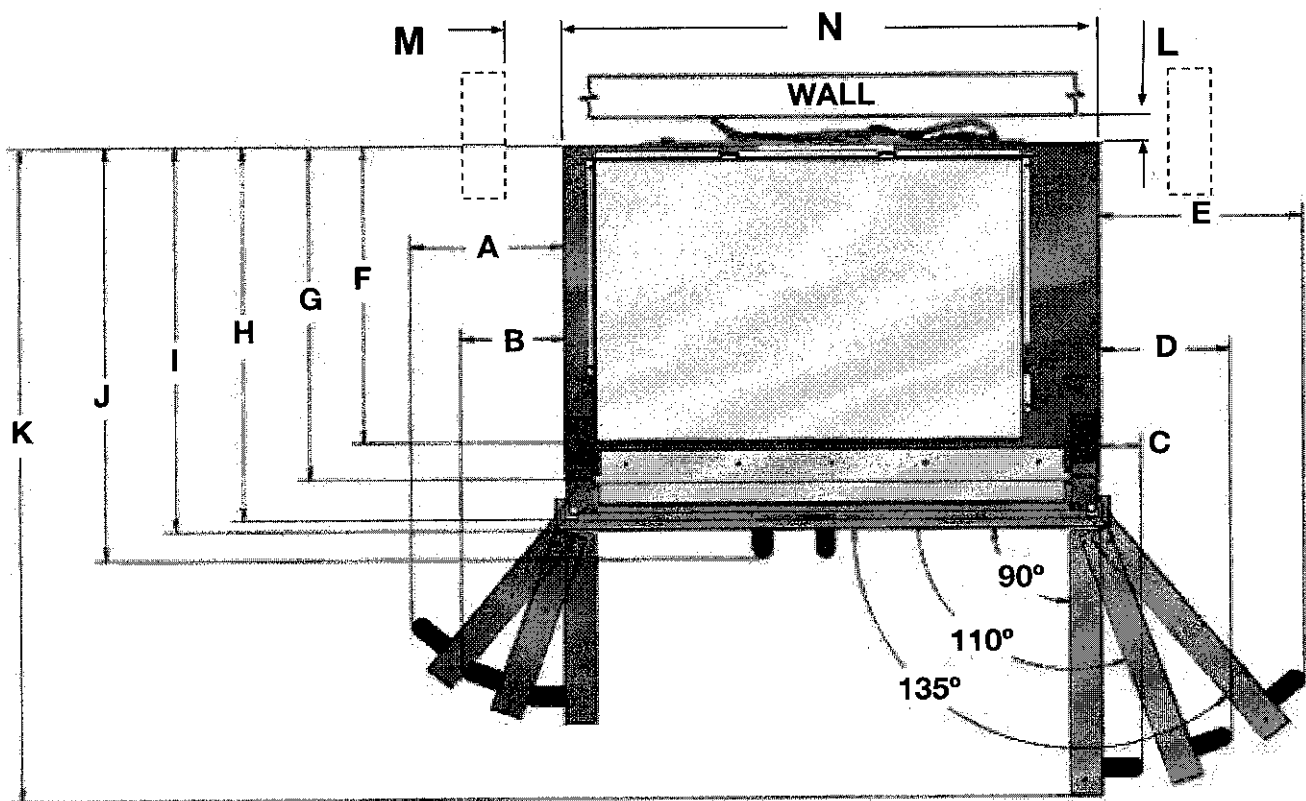

Description		Inches (cm)
A	Width from FC side of refrigerator to handle - door fully open 130°	
	42"	11 ⁵ / ₈ " (29.5)
	48"	13 ¹ / ₄ " (33.6)
B	Width from FC side of refrigerator to handle - door fully open 110°	
	42"	7 ⁵ / ₈ " (19.3)
	48"	8 ⁷ / ₁₆ " (21.5)
C	Width from FC side of refrigerator to handle - door open 90°	2 ¹¹ / ₁₆ " (6.8)
D	Width from RC side of refrigerator to handle - door fully open 110°	
	42"	9 ⁵ / ₈ " (24.5)
	48"	10 ⁷ / ₈ " (27.6)
E	Width from RC side of refrigerator to handle - door fully open 130°	
	42"	15 ¹ / ₂ " (39.3)
	48"	17 ³ / ₄ " (45.1)
F	Depth to machine compartment cover	19 ¹⁵ / ₁₆ " (50.6)
G	Depth without doors	22 ³ / ₈ " (56.8)
H	Depth with doors	25 (63.5)
I	Depth with top grill	25 ¹³ / ₁₆ " (65.5)
J	Depth with handles	27 ¹¹ / ₁₆ " (70.4)
K	Depth with RC door open 90°	
	42"	47 ³ / ₁₆ " (119.9)
	48"	50 ¹¹ / ₁₆ " (128.8)
L	Space required for water lines and power chord	1" (2.54)
M	Space required for side cabinet for the door fully open	6" (15.24)
N	Cabinet Width	
	42"	41" (104.1)
	48"	42" (119.3)



Product Dimension Guide for models JBSSS42E22L/48E22L

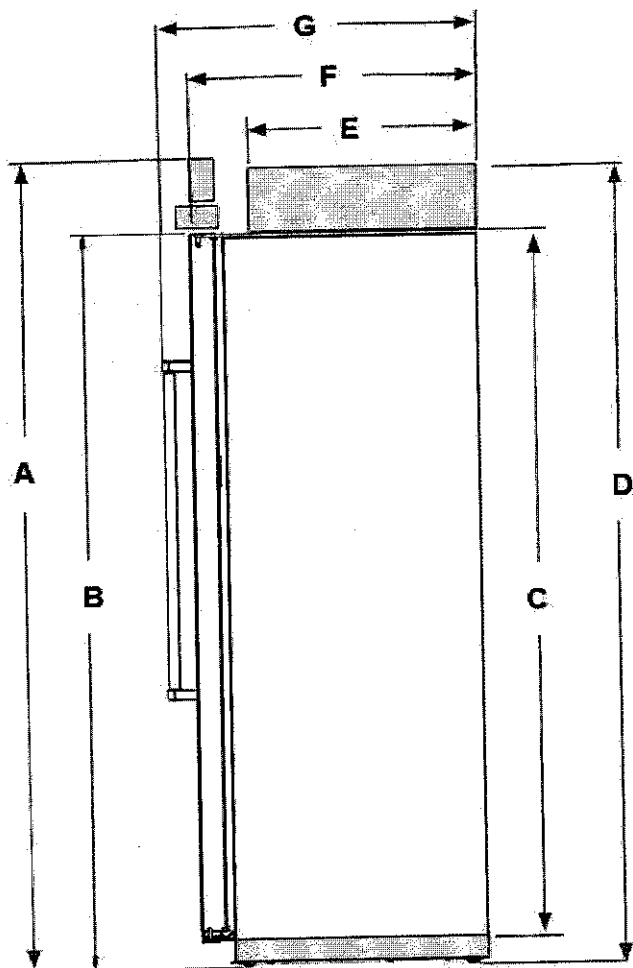

Description		Inches (cm)
A	Total height	83 ³ / ₈ " (211.8)
B	Height to top of doors	74 ¹ / ₂ " (189.2)
C	Height of Cabinet	71" (180.4)
D	Height to top of machine compartment cover	83 ³ / ₁₆ " (211.3)
E	Depth to machine compartment cover	19 ¹⁵ / ₁₆ " (50.6)
F	Depth with doors	25" (63.5)
G	Depth with handles	27 ¹¹ / ₁₆ " (70.4)

Interior dimensions	Width Inches (cm)	Height Inches (cm)
Refrigerator Compartment		
42"	20 ¹³ / ₁₆ " (52.9)	67 ¹ / ₁₆ " (170.4)
48"	24 ⁵ / ₁₆ " (61.8)	
Freezer Compartment		
42"	14 ⁵ / ₁₆ " (36.4)	66 ³ / ₄ " (169.6)
48"	16 ¹³ / ₁₆ " (42.7)	

Location Requirements

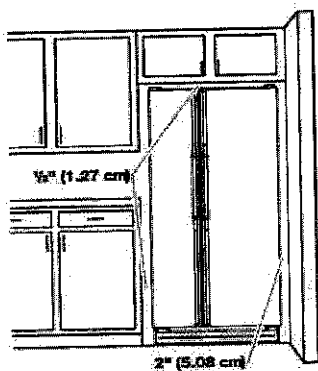

⚠ WARNING

Explosion Hazard
Keep flammable materials and vapors, such as gasoline, away from refrigerator.
Failure to do so can result in death, explosion, or fire.

To ensure proper ventilation for your refrigerator, allow for 1/2" (1.27 cm) of space on each side and at the top. Allow for 1" (2.54 cm) of space behind the refrigerator. If your refrigerator has an ice maker, allow extra space at the back for the water line connections. When installing your refrigerator next to a fixed wall, leave a 2" (5.08 cm) minimum space on each side (depending on your model) to allow the doors to swing open.

- NOTES:**
- This refrigerator is intended for use in a location where the temperature ranges from a minimum of 55°F (13°C) to a maximum of 110°F (43°C). The preferred room temperature range for optimum performance, which reduces electricity usage and provides superior cooling, is between 60°F (15°C) and 90°F (32°C). It is recommended that you do not install the refrigerator near a heat source, such as an oven or radiator.
 - Normal minimum cabinet cut-out width required for product installation is 36" (91.44 cm). However, if the product is placed against an extended wall and the ability to remove the crisper pans is desired, an additional 18" (45.72 cm) of cabinet width is required, so a total cabinet opening width of 54" (137.16 cm) is recommended.

Purchaser:

Lot:

372 . A.G phase 4

Schedule SMART
Russell Gardens Building Ltd. (Phase 4)

Smart Home System includes:

1. One (1) Smart Home Hub installed in a location as determined by the Vendor;
2. One (1) Doorbell camera supplied and installed at front door;
3. One (1) smart home thermostat to be installed in a location as determined by the Vendor;
4. One (1) smart Flood sensor to be installed in a location as determined by the Vendor which is designed to detect water in the location of the sensor only;
5. Smart light switches to be installed in such locations as determined by the Vendor;

Certain devices for The Smart Home System require a fully functioning WiFi network and internet connection and others work on the Zwave wireless network. Provision of WiFi, internet access and functionality shall be the sole responsibility of the Purchaser and the Vendor assumes no responsibility or obligation with respect to the functionality or performance of a homeowner's internet or WiFi network. The Vendor does not guarantee that networks, equipment, or services will meet all homeowner needs.

The Purchaser will be required to download the Homewave Smart Connect App (the "App") in order to configure and set up the Smart Home System devices. The Purchaser is responsible to ensure that they have the appropriate technology to download the App and any charges and fees for download and/or data usage shall be at the Purchaser's sole cost and expense. Access to the App shall be provided free of charge for 1 year from the Closing Date and thereafter the Purchaser may enter into an agreement with Homewave Smart Connect to continue the services for a monthly fee (currently \$10.00/month plus HST). Fees subject to change without notice.

Purchasers are responsible for configuring all security features. The Vendor does not warrant or represent that any network or Smart Home System devices are secure or can prevent all privacy intrusions, malware, or cyber-attacks, even when correctly configured. The products and services for the Smart Home System are provided by third parties, and not the Vendor. The Vendor does not guarantee any equipment or services provided by third parties. If the Purchaser contracts with the third-party provider to upgrade or purchase further devices, the Vendor has no responsibility for same, including but not limited to, the installation, service, safety or functionality of said products.

Energy claims are not based upon specific testing of an individual home but are general assumptions. Savings will vary due to many variables, including but not limited to, actual utility rates and fees, actual construction, floor plan, occupancy, appliance usage, thermostat settings, weather conditions, number of individuals occupying the home and orientation of the home.

The Vendor is providing only those Smart Home System's devices and components listed in this Schedule. Please see the balance of your Agreement of Purchase and Sale for additional information, disclosures, and disclaimers relating to your home and its features. The specific features in a home may vary from home to home and from one community to another. The Vendor reserves the right to substitute equipment, material, appliances and brand names with items of equal or higher value, in its sole and unfettered discretion. The Vendor reserves the right, in its sole and absolute discretion, to omit installation of the Smart Home System, in part or in whole, and the Purchaser shall have no claim for abatement or reduction the Purchase Price or to any delay in closing. Installation of the Smart Home System may result in the elimination of other features listed in Schedule GP or other information material, such as but not limited to set back thermostat, rough-in for alarm or other features deemed redundant as a result of the installation of the Smart Home System.

Purchaser Initials	Purchaser Initials
B	R

APPROVED REVISED APPLIANCE SPECS - LOT 372

Julia Caivano

From: Pauline <Pauline@selba.ca>
Sent: Thursday, January 12, 2023 1:58 PM
To: Julia Caivano
Subject: RE: LOT 372 RUSSELL GARDENS - BUILT-IN APPLIANCE SPECIFICATIONS

No cost

From: Julia Caivano <jcaivano@greenpark.com>
Sent: Thursday, January 12, 2023 1:30 PM
To: Pauline <Pauline@selba.ca>; Liz Fontana <Liz@selba.ca>; Angie Lijoi <Angie@selba.ca>
Cc: Gilbert <Gilbert@selba.ca>
Subject: RE: LOT 372 RUSSELL GARDENS - BUILT-IN APPLIANCE SPECIFICATIONS

Hi Pauline,

Please confirm if there is a cost involved.

Best Regards,

Julia Caivano
Assistant Manager
Greenpark Decor Centre
8700 Dufferin Street, Vaughan, ON L4K 4S6
Tel: (416) 798-7700
Fax: (905) 669-0445
Email: jcaivano@greenpark.com

You may withdraw your consent to receive electronic communications at any time by contacting the sender at the contact information provided.



From: Pauline <Pauline@selba.ca>
Sent: Thursday, January 12, 2023 9:54 AM
To: Julia Caivano <jcaivano@greenpark.com>; Liz Fontana <Liz@selba.ca>; Angie Lijoi <Angie@selba.ca>
Cc: Gilbert <Gilbert@selba.ca>
Subject: RE: LOT 372 RUSSELL GARDENS - BUILT-IN APPLIANCE SPECIFICATIONS

Hi Julia, we need to change the oven panel to suit the new specs. Everything else is fine.
Gilbert will need to pull the order from production to make the changes.
tks

From: Julia Caivano <jcaivano@greenpark.com>
Sent: Monday, January 09, 2023 4:01 PM
To: Liz Fontana <Liz@selba.ca>; Angie Lijoi <Angie@selba.ca>
Cc: Pauline <Pauline@selba.ca>
Subject: LOT 372 RUSSELL GARDENS - BUILT-IN APPLIANCE SPECIFICATIONS

Good Afternoon & Happy New Year!

Please see email chain below. The Purchaser of LOT 372 RUSSELL GARDENS PHASE 4 has changed his b/l wall ovens and b/l fridge specs (as they were no longer available). Revised cooktop specs were sent through portal on Dec 21/22.

The closing for this home is end of February.

Please have a look at the revised appliance specifications we received from the Purchaser. Kindly advise if changes can be made at this point and/or costs associated.

Best Regards,

Julia Caivano

Assistant Manager

Greenpark Decor Centre

8700 Dufferin Street, Vaughan, ON L4K 4S6

Tel: (416) 798-7700

Fax: (905) 669-0445

Email: jcaivano@greenpark.com

You may withdraw your consent to receive electronic communications at any time by contacting the sender at the contact information provided.



Sent from Yahoo Mail for iPhone

On Thursday, December 22, 2022, 3:51 PM, vijay rayudu <vijay_rayudu@yahoo.com> wrote:

Hello Serina,

Thanks for your email.

I kindly request you to understand my request below and do the needful.

It is very unfortunate that the initially confirmed appliance is not available and we came to know about this couple of days before. This is a similar situation where some of the confirmed interiors were not available and we had to adjust to what was available (recent changes to the Laundry and wash room tiles etc). We are now looking for you to make adjustments and looking for your much needed support on this. After opting for so many upgrades in the kitchen, Please imagine how bad it would be to see a hollow space of 12 inches which will not add any value to the other upgrades taken.

We kindly request you to look for options and help us. From our perspective this is mandatory change. We are highly influenced by external factors which are not in our control. Also please do not expect us to take up this

change after closing as we will not be having sufficient funds to adjust after downpayment and bearing the high interest rates.

Looking forward to a positive response.

Have a Holly Jolly Christmas and Happy New Year.

Thank you.

Vijay.

On Wednesday, 21 December 2022, 04:13:39 PM GMT-5, Serina Scalamogna <serina@greenpark.com> wrote:

Hi Vijay,

The kitchen is already complete; we cannot make any modifications to the cabinetry.

We only required the new cooktop information for the countertop company to insure there was no difference in measurement for the cut out.

We have forwarded the new cooktop specifications to the quartz fabricator.

Thank you & Happy Holidays

Serina Scalamogna

Décor Administrative Coordinator

Assistant to the Managing Director

Greenpark Decor Centre

8700 Dufferin Street, Vaughan, Ontario, L4K 4S6

Tel. #: 416-798-7700

Fax #: 905-669-0445

serina@greenpark.com

You may withdraw your consent to receive electronic communications at any time by contacting the sender at the contact information provided.

 **Greenpark**
GROUP

From: vijay rayudu <vijay_rayudu@yahoo.com>
Sent: Wednesday, December 21, 2022 9:26 AM

To: Julia La Rosa <julia@greenpark.com>; Serina Scalamogna <serina@greenpark.com>
Subject: Re: Signed document

Morning Julia/Serina,

Apologies for my late reply.

As discussed with Julia La Rosa, I am sharing the appliances specifications.

Note: The wall woven and refrigerator we initially booked were not available with the store.

Hence the revised specifications are attached.

Please revise and kindly confirm.

Thanks,

Vijay.

On Wednesday, 14 December 2022, 09:05:04 AM GMT-5, Julia La Rosa <julia@greenpark.com> wrote:

Site is awaiting your specs, please send asap

Kind regards,

Julia La Rosa

Greenpark Decor Centre

8700 Dufferin Street, Vaughan, Ontario, L4K 4S6

Tel. #: 416-798-7700

Fax #: 905-669-0445

Email: julia@greenpark.com

You may withdraw your consent to receive electronic communications at any time by contacting the sender at the contact information provided.

Greenpark
GROUP

From: vijay rayudu <vijay_rayudu@yahoo.com>
Sent: Tuesday, December 13, 2022 10:06 PM
To: Julia La Rosa <julia@greenpark.com>
Subject: Re: Signed document

Hello Julia,

I will confirm you in 2 days.

Thanks,

Vijay.

Sent from Yahoo Mail for iPhone

On Tuesday, December 13, 2022, 2:27 PM, Julia La Rosa <julia@greenpark.com> wrote:

Hello

Just following up on the cooktop specs. Please advise

Kind regards,

Julia La Rosa

Greenpark Decor Centre

8700 Dufferin Street, Vaughan, Ontario, L4K 4S6

Tel. #: 416-798-7700

Fax #: 905-669-0445

Email: julia@greenpark.com

You may withdraw your consent to receive electronic communications at any time by contacting the sender at the contact information provided.



From: vijay rayudu <vijay_rayudu@yahoo.com>
Sent: Thursday, December 8, 2022 9:55 AM
To: Julia La Rosa <julia@greenpark.com>
Subject: Re: Signed document

Thank you Julia. I will get back to you on Monday or Tuesday on this.

Have a great day.

Vijay.

Sent from Yahoo Mail for iPhone