

CONSTRUCTION SUMMARY
Red Oaks - Roundel Homes Inc.

PURCHASER: Chi Lei LI		TEL: RES.: 647-871-2968		
LOT / PHASE 84 / 1	REG. PLAN # 65M-4737	HOUSE TYPE Pinetree 3 Elev 3		

CABINETRY ACCESSORIES

1 - VANITY CABINETRY - RAISE VANITY TO 36" HIGH VANITY IN LIEU OF STANDARD HEIGHT - MASTER ENSUITE 28Feb23 Note:	
1 - KITCHEN CABINETRY BASE - BUILT-IN - MICROWAVE BASE CABINET WITH SINGLE POT DRAWER - 800MM WIDE - PRICE IS EACH - STANDARD 30Nov22 Note:	
SEE SKETCH FOR LOCATION	
1 - KITCHEN CABINETRY UPPER - FULL DEPTH ABOVE FRIDGE - WITH GABLES - 600MM - PRICE IS EACH - STANDARD 30Nov22 Note:	

CERAMIC TILE

1 - TILE - UPGRADE 2 FLOOR TILE - KITCHEN/BREAKFAST 28Feb23 Note:	
1 - DELETE ALL CERAMIC BATHROOM ACCESSORIES - DELETE TOWEL BAR, PAPER HOLDER & SOAP DISH THROUGHOUT 28Feb23 Note:	
1 - TILE - UPGRADE 4 FLOOR TILE - PRIMARY ENSUITE - FLOOR 28Feb23 Note:	
1 - TILE - UPGRADE 3 WALL TILE - PRIMARY ENSUITE - SHOWER 28Feb23 Note:	
1 - TILE - UPGRADE 4 FLOOR TILE - FOYER 28Feb23 Note:	

CONSTRUCTION

1 - SMOOTH CEILINGS ON FIRST FLOOR ONLY - DET 30Nov22 Note:	
--	--

COUNTER TOP

1 - UPGRADE COUNTER TOP -KITCHEN - QUARTZ IN LIEU OF STANDARD MATERIAL 28Feb23 Note:	
1 - UPGRADE COUNTER TOP VANITY QUARTZ -PRIMARY ENSUITE 28Feb23 Note:	

ELECTRICAL

1 - PLUG - ELECTRICAL PLUG - FOR BUILT-IN MICROWAVE 30Nov22 Note:	
SEE SKETCH FOR LOCATION	
1 - STANDARD DINING ROOM LIGHT TO BE CENTERED BETWEEN LIVING AND DINING ROOM 30Nov22 Note:	
6 - POT LIGHT - LED - FIRST FLOOR INSTALLATION - LIVING ROOM/DINING ROOM 30Nov22 Note: TO BE ON SEPARATE SWITCH FROM STANDARD LIGHT	
4 - POT LIGHT - LED - FIRST FLOOR INSTALLATION - FAMILY ROOM 30Nov22 Note: TO BE ON SEPARATE SWITCH FROM STANDARD LIGHT	



CONSTRUCTION SUMMARY

Red Oaks - Roundel Homes Inc.

PURCHASER: Chi Lei LI

TEL: RES.: 647-871-2968

LOT / PHASE	REG. PLAN #	HOUSE TYPE		
84 / 1	65M-4737	Pinetree 3 Elev 3		
6 - POT LIGHT - LED - FIRST FLOOR INSTALLATION - KITCHEN/BREAKFAST AREA 30Nov22 Note: TO BE ON SEPARATE SWITCH FROM STANDARD LIGHT				
1 - RELOCATE STANDARD KITCHEN LIGHT TO BE CENTERED OVER ISLAND 30Nov22 Note:				
1 - ELECTRIC VEHICLE ROUGH-IN PROVISION ONLY FOR FUTURE ELECTRIC CAR (CONDUIT FROM BASEMENT INTO JUNCTION BOX IN GARAGE WITH PULL STRING, NO WIRE) 30Nov22 Note: SEE SKETCH FOR REQUESTED LOCATION - IF CONSTRUCTION PERMITS				

FIREPLACE AND ACCESSORIES

1 - GAS LINE ROUGH-IN FOR STOVE (INCLUDES ELECTRICAL OUTLET) - FIRST FLOOR 30Nov22 Note:	
---	--

HARDWOOD FLOORING

1 - HARDWOOD - GROUP C SERIES 5 INCH - - UPPER HALL 28Feb23 Note:	
1 - HARDWOOD - GROUP C SERIES 5 INCH - IN LIEU OF 3 1/4 INCH NATURAL RED OAK - - FIRST FLOOR IN STANDARD HARDWOOD AREAS 28Feb23 Note:	

HEATING AND AIR CONDITIONING

1 - HUMIDIFER 30Nov22 Note:	
--------------------------------	--

MIRRORS AND GLASS

1 - MASTER ENSUITE – FRAMELESS GLASS SHOWER ENCLOSURE – INCLUDES CHROME KNOB AND HINGES 30Nov22 Note:	
1 - SHOWER DOOR HANDLE - CHROME D-RING/TOWEL BAR COMBO 30Nov22 Note: MASTER ENSUITE	

PAINTING

1 - UPGRADE WHITE TRIM AND DOOR PACKAGE 28Feb23 Note:	
--	--

PLUMBING

2 - SINK - UNDERMOUNT SINK - CONTRAC COLLETTE #4220CIY 28Feb23 Note: MASTER ENSUITE	
1 - TOE TESTER - ADD TOE TESTER TO SHOWER 30Nov22 Note: ENSUITE 2	

PROMOTIONAL

1 - LESS CREDIT FROM PURCHASER EXTRA SHEET IN OFFER 30Nov22 Note:	
--	--

STAIRS AND RAILINGS

1 - EUROLINE 1 BLACK PICKETS 28Feb23 Note:	
---	--

CONSTRUCTION SUMMARY

Red Oaks - Roundel Homes Inc.

PURCHASER: Chi Lei LI

TEL: RES.: 647-871-2968

LOT / PHASE 84 / 1	REG. PLAN # 65M-4737	HOUSE TYPE Pinetree 3 Elev 3		
-----------------------	-------------------------	---------------------------------	--	--

1 - STAINED STAIRS – STANDARD STAIRCASE - PRICE IS PER SET
28Feb23 Note:

EXTRAS AS PER OFFER

The Vendor agrees that notwithstanding any other term or provision in this Agreement included in the Purchase Price and in addition to those items detailed in Schedule GP to the Agreement of Purchase and Sale, the Purchaser is entitled to a credit of Ten
Worksheet Note:

This Document is Extremely Time Sensitive - Printed 2 Mar 23 at 14:16

Purchaser: Chi Lei LI

Telephone Res. / Bus: (647) 871-2968 /

Decor Advisor: Giulia Di Girolamo

Lock Date: 28-Feb-23

Property: 84

Project: Roundel Homes Inc.

Model and Elevation: Pinetree 3 Elev 3

28-Feb-23

Plan #: 65M-4737

Layout Changes: ☐ Yes ☒ No

Sketch Attached: ☒ Yes ☐ No

Exterior Colour Scheme:

1. Cabinetry

	Style and Colour	Hardware
Kitchen / Breakfast	MONACO -350 PLATINUM SILVER	464SA
Laundry Room	ELISSE	Standard
Powder Room	DORAL - K44 TITAN GREY	464SA
Master Ensuite Bathroom	DORAL - H3453 LAVA GREY FLEETWOOD	464SA
Ensuite Bath - Bedroom 2	DORAL - K44 TITAN GREY	464SA
Ensuite Bath - Bedroom 3/4	DORAL - K44 TITAN GREY	464SA

Appliances:

Built In Appliances ☒ Yes ☐ No

Slide In Stove ☐ Yes ☒ No

Dishwasher Cabinet ☐ Closed ☒ Open

41" Upper Cabinets ☒ Yes ☐ No

Please NOTE: Standard Cabinet Height is 30"

Stove Opening

NOTE: If not specified, opening will be set to builder's standard opening of approximately 30" width

Fridge Opening

NOTE: If not specified, opening will be set to builder's standard opening of approximately 37" width x 74" height

** Refer to Construction Summary

2. Counters

	Counter	Edge
Kitchen / Breakfast	QUARTZ-MISTRAL	#360 EDGE
Laundry Room	N/A	
Powder Room	LAMINATE-CALCUTTA MARBLE 4925K-07	
Master Ensuite Bathroom	QUARTZ-VIRGINIA	#360 EDGE
Ensuite Bath - Bedroom 2	LAMINATE-CARRARA BIANCO 6696-46	
Ensuite Bath - Bedroom 3/4	LAMINATE-CARRARA BIANCO 6696-46	

** Refer to Construction Summary

Initial:

Property: 84
Project: Roundel Homes Inc.
Elevation: Pinetree 3 Elev 3
Plan #: 65M-4737

–3. Ceramic Flooring

		At a 45	Threshold-If App.
Entrance Vestibule	TILE-DOZZA WHITE 24X24	<input type="checkbox"/>	
Main Hall	HARDWOOD	<input type="checkbox"/>	Metal Strip Where Applic.
Kitchen / Breakfast	TILE-MARMANI BIANCO 12X24	<input type="checkbox"/>	
Laundry Room	TILE-ESSENZE BIANCO 13X13	<input type="checkbox"/>	
Powder Room	TILE-E.B.PETRA CENDRA 12X12	<input type="checkbox"/>	
Master Ensuite Bathroom	TILE-LITIUM SILVER POLISHED 24X24	<input type="checkbox"/>	
Ensuite Bath - Bedroom 2	TILE-ESSENZE BIANCO 13X13	<input type="checkbox"/>	
Ensuite Bath - Bedroom 3/4	TILE-ESSENZE BIANCO 13X13	<input type="checkbox"/>	
Mud Room	TILE-E.B.PETRA CENDRA 12X12	<input type="checkbox"/>	
		<input type="checkbox"/>	
		<input type="checkbox"/>	

**** Refer to Construction Summary**

4. Ceramic Wall Tile

Master Ensuite Bathroom	Selection	Describe
Tub Deck Wall	N/A	
Tub Deck	N/A	
Tub Deck Skirt	N/A	
Shower Stall	TILE- MEDITERRANEO WHITE 12X24	
Bathtub Enclosure Walls	N/A	
Ensuite Bath - Bedroom 2	TILE-SILVIA WHITE 8X16	
Ensuite Bath - Bedroom 3/4	TILE-SILVIA WHITE 8X16	
Mud Room	N/A	
Kitchen Backsplash		

**** Refer to Construction Summary - STANDARD GROUT THROUGHOUT UNLESS SPECIFIED**

5. Plumbing Fixtures

All Bathrooms	White	Whirlpool
N/A		N/A <input type="radio"/> Yes <input checked="" type="radio"/> No
N/A		
N/A		
N/A		
N/A		

Dishwasher Rough-In ☒ Yes ☐ No
Waterline for Fridge ☐ Yes ☒ No

**** Refer to Construction Summary**

6. Trim Carpentry

Interior Doors	CARRARA-SMOOTH
Interior Trim	As Per Construction Specifications
Door Handles	As Per Construction Specifications
Exterior Front Door Handle	As Per Construction Specifications

**** Refer to Construction Summary**

Initial:

Purchaser: .	Chi Lei LI	Property: 84
Telephone Res. / Bus:	(647) 871-2968 /	Project: Roundel Homes Inc.
Decor Advisor:	Giulia Di Girolamo	Model and Elevation: Pinetree 3 Elev 3
Lock Date:	28-Feb-23	28-Feb-23
		Plan #: 65M-4737

7. Other Flooring

Main Hall	HARDWOOD-MIRAGE-SWEET MEMORIES COLLECTION-BUBBLE BATH-WHITE OAK CHARACTER -BRUSHED 5"	
Living Room	HARDWOOD-MIRAGE-SWEET MEMORIES COLLECTION-BUBBLE BATH-WHITE OAK CHARACTER -BRUSHED 5"	
Dining Room	HARDWOOD-MIRAGE-SWEET MEMORIES COLLECTION-BUBBLE BATH-WHITE OAK CHARACTER -BRUSHED 5"	
Family Room	HARDWOOD-MIRAGE-SWEET MEMORIES COLLECTION-BUBBLE BATH-WHITE OAK CHARACTER -BRUSHED 5"	
Den / Library / Study	N/A	
Basement Landing(If Applies)	N/A	
Lower Landing (If Applies)	HARDWOOD-MIRAGE-SWEET MEMORIES COLLECTION-BUBBLE BATH-WHITE OAK CHARACTER -BRUSHED 5"	
Upper Landing	HARDWOOD-MIRAGE-SWEET MEMORIES COLLECTION-BUBBLE BATH-WHITE OAK CHARACTER -BRUSHED 5"	
Upper Hall	HARDWOOD-MIRAGE-SWEET MEMORIES COLLECTION-BUBBLE BATH-WHITE OAK CHARACTER -BRUSHED 5"	
Master Bedroom	LAMINATE-LEXINGTON-CHARLEROI OAK-TL-LW1314	
Bedroom #2	LAMINATE-LEXINGTON-CHARLEROI OAK-TL-LW1314	
Bedroom #3	LAMINATE-LEXINGTON-CHARLEROI OAK-TL-LW1314	
Bedroom #4	LAMINATE-LEXINGTON-CHARLEROI OAK-TL-LW1314	
Bedroom #5	N/A	
Underpad	Type	Area
	N/A	N/A

** Refer to Construction Summary

8. Railings and Pickets

Railing Type	AS PER CONSTRUCTION SPECIFICATIONS	Complimenting Colour	MIRAGE-WHITE OAK- BUBBLE BATH
Picket Type	EUROLINE 1	Complimenting Colour	BLACK
Stringer / Riser	AS PER CONSTRUCTION SPECIFICATIO	Complimenting Colour	MIRAGE-WHITE OAK- BUBBLE BATH
Treads	AS PER CONSTRUCTION SPECIFICATIO	Complimenting Colour	MIRAGE-WHITE OAK- BUBBLE BATH
Red Oak Stairs	<input checked="" type="radio"/> Yes <input type="radio"/> No		

** Refer to Construction Summary THE STAIN COLOURS OR FINISH AVAILABLE ON RISERS, TREADS, PICKETS AND RAILS (STAIRCASES), WILL NOT BE AN EXACT MATCH TO PREFINISHED HARDWOOD OR LAMINATE FLOORS.

9. Wall Paint Flat Finish

Main & Upper Hall	BIRCH WHITE	Master Bedroom	BIRCH WHITE
Living Room	BIRCH WHITE	Bedroom #2	BIRCH WHITE
Dining Room	BIRCH WHITE	Bedroom #3	BIRCH WHITE
Kitchen / Breakfast	BIRCH WHITE	Bedroom #4	BIRCH WHITE
Family Room	BIRCH WHITE	Bedroom #5	N/A
Powder Room	BIRCH WHITE	Master Ensuite	BIRCH WHITE
Laundry Room	BIRCH WHITE	Ensuite Bath - Bedroom 2	BIRCH WHITE
Den/Library	N/A	Ensuite Bath - Bedroom 3/4	BIRCH WHITE
Trim & Door Paint-Semi Gloss	WHITE	Mud Room	BIRCH WHITE
Smooth Ceilings First Floor	<input checked="" type="radio"/> Yes <input type="radio"/> No		

** Refer to Construction Summary

Purchaser: Chi Lei LI

Telephone Res. / Bus: (647) 871-2968 /

Decor Advisor: Giulia Di Girolamo

Lock Date: 28-Feb-23

Property: 84

Project: Roundel Homes Inc.

Model and Elevation: Pinetree 3 Elev 3

28-Feb-23

Plan #: 65M-4737

10. Plaster Mouldings and Medallions

Entrance Vestibule			Kitchen/Breakfast		
Main Hall			Den/Library		
Living Room			Lower Landing		
Dining Room					
Family Room					

** Refer to Construction Summary

11. Fireplace

Living Room	Family Room	Other Room - Specify
Purchased As Per Plan N/A	Purchased As Per Plan N/A	Purchased As Per Plan N/A
<input type="radio"/> <input type="radio"/> <input checked="" type="radio"/>	<input type="radio"/> <input checked="" type="radio"/> <input type="radio"/>	<input type="radio"/> <input type="radio"/> <input checked="" type="radio"/>
Fireplace Type	FLAT ON WALL	
Mantle Type	MANTLE M1-STANDARD	
Colour / Stain	WHITE	
Surround	NERO	
Hearth	NO	

** Refer to Construction Summary

12. Heating and Air Conditioning

Air Conditioning	NO	Gas Provisions Stove	YES
Gas Provisions Dryer	NO	Gas Provisions Barbecue	NO
Comment			

** Refer to Construction Summary

13. Electrical

Plugs and Switches	<input checked="" type="radio"/> White DECOR	Above Kitchen Cabinet Light	<input type="radio"/> Yes <input checked="" type="radio"/> No
Hood Fan	STANDARD WHITE	Below Kitchen Cabinet Light	<input type="radio"/> Yes <input checked="" type="radio"/> No
Appliances	Built in Cooktop Built in Oven	Gas Stove	Microwave
	<input type="radio"/> Yes <input checked="" type="radio"/> No <input type="radio"/> Yes <input checked="" type="radio"/> No	<input checked="" type="radio"/> Yes <input type="radio"/> No	<input checked="" type="radio"/> Yes <input type="radio"/> No
Dishwasher Rough-in	Yes		

** Refer to Construction Summary

14. General Comments

** Refer to Construction Summary

Disclaimers and Notes

- 1) Colours of all materials are as close as possible to builder's selection, but not necessarily identical due to variances in manufacturing.

2) Any extras listed above are null and void unless accompanied by a separate invoice/amendment. Said invoice must be paid in full.

3) The Purchaser agrees that this colour selection is final and that no changes will be permitted, unless required by the Vendor.

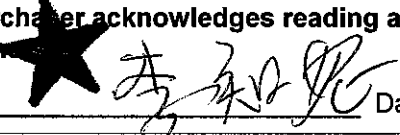
4) The Purchaser acknowledges reading and accepting document which contains other miscellaneous disclaim
- Signature:  Date: Feb 28. 23

LOT 84

6 pot lights
on 1 switch

Bl Micro AT
BASE

Stove-Gas line w/1

Relocate sta.
kitchen light
above island

6 pot lights
on 1 switch

std. dining
light to be
centered

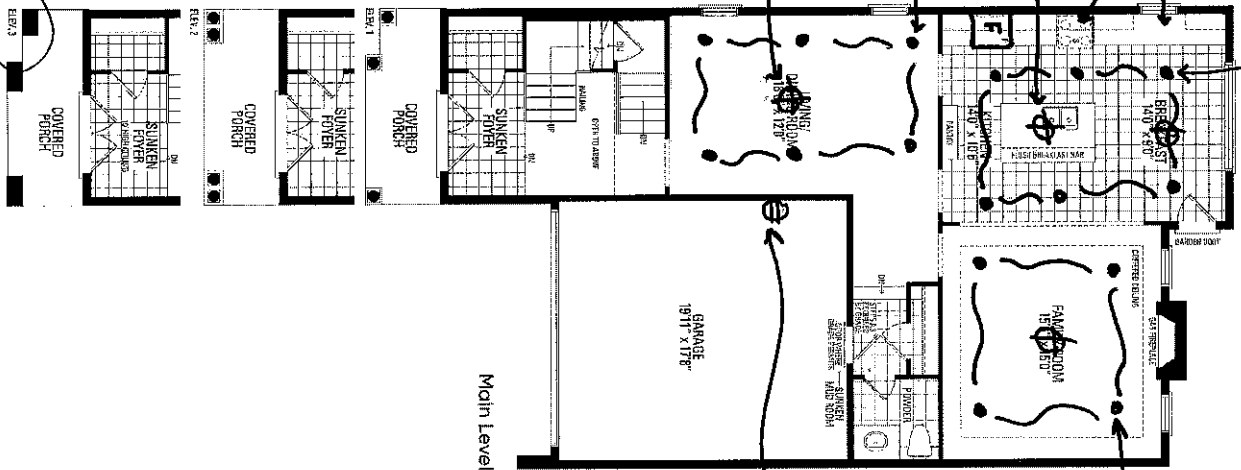
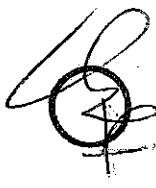

4 pot lights
on 1 switch

Electric
Vehicle
Rough-in
(Conduit)

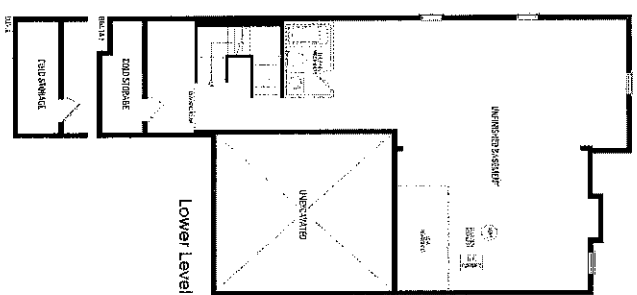

Pinetree 3

ELEV. 1 • 2,682 sq. ft. | ELEV. 2 • 2,673 sq. ft. | ELEV. 3 • 2,686 sq. ft.
Includes 38 sq. ft. of open area.

LOT #84

Frameless
glass shower
enclosure +
D-ring/Towel
Bar combo-
chrome

Refer to purchaser
alteration form

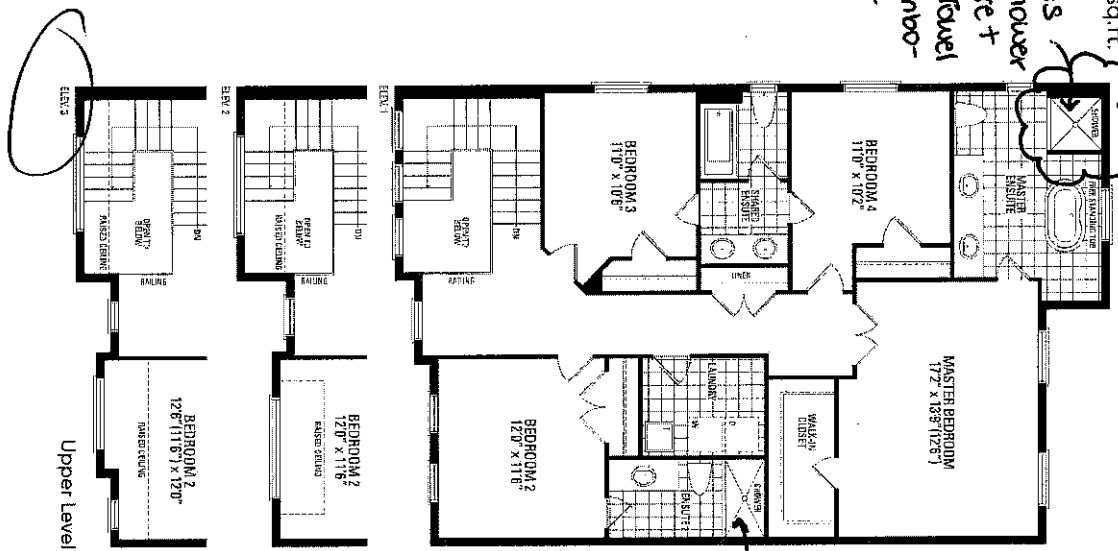

Add the tester

*smooth ceilings-First Floor
*Gas line Rough-in for stove
*Humidifier

Orientation of home may be reversed and purchaser agrees to accept the same. Steps and porches may vary at any exterior entrance ways due to grading variance. Actual usable floor space may vary from the stated floor areas. All renderings are artist's concept. Dimensions, specifications and architectural detailing subject to modifications. Roofline and adjoining model types may vary due to siting. E. & O. E. June 2022

Roundel Lot 84

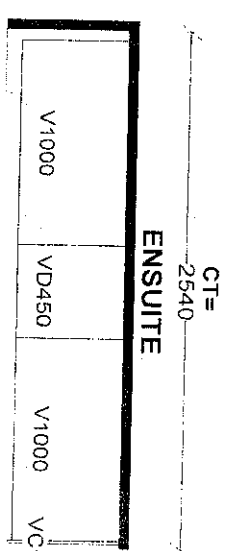
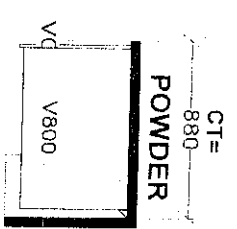
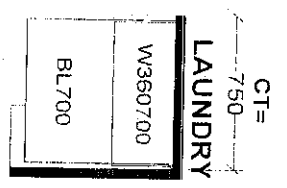
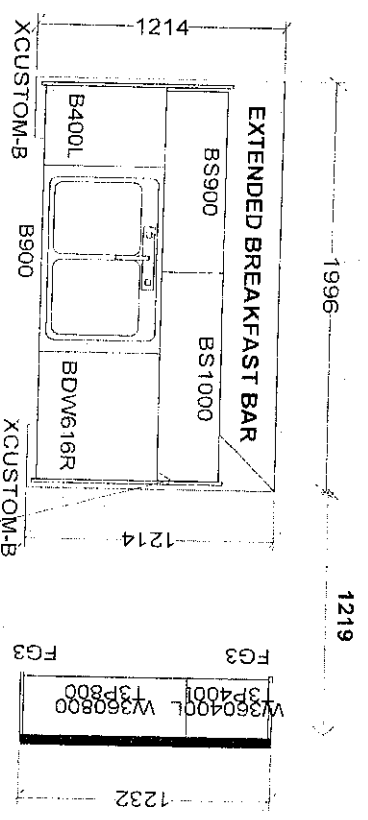

-increase vanity height to 36"

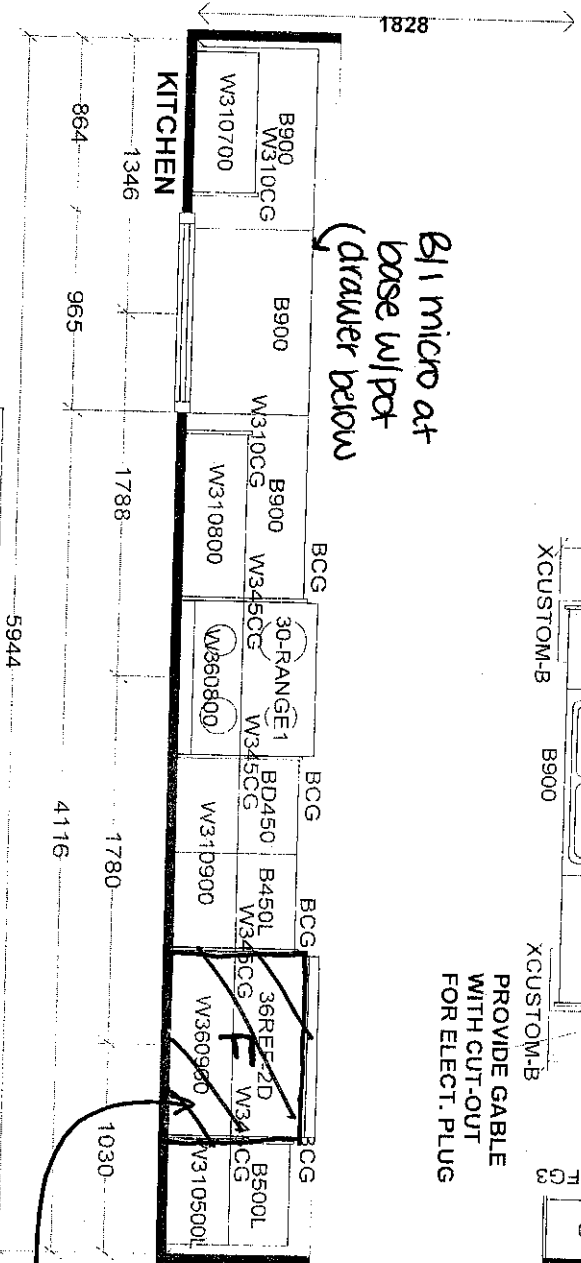
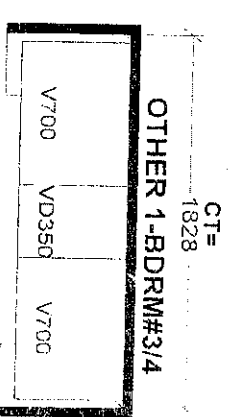
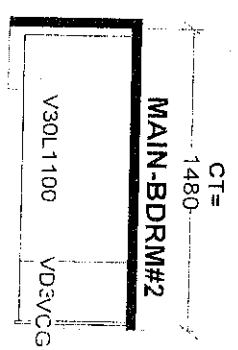

Selba Industries

This drawing is the intellectual property of SELBA INDUSTRIES INC. and is an original design which must not be released or copied unless applicable fee has been paid or job order placed.

W W D T H W H G H T W C N T J #

F L O O R H G H T D O O R H G H T D E S I G N E R : K S D A T E : J U N E 7 2 1

S T C E N T 2 X 4 V E N T B O X C O V E R L O T # : R O U N D E L L O T # 8 4

J O B N U M B E R :
B U I L D E R : G R E E N P A R K
S I T E : R O U N D E L , R I C H M O N D H I L L
M O D E L : P I N E T R E E 3 X E L 1.2.3
L O T # : R O U N D E L L O T # 8 4

LOT 84
ROUNDEL
RED OAKS ON BAYVIEW

PINETREE 3
ELEVATION 3

REVISIONS:

- ADD FRAMELESS GLASS SHOWER TO MASTER ENSUITE.

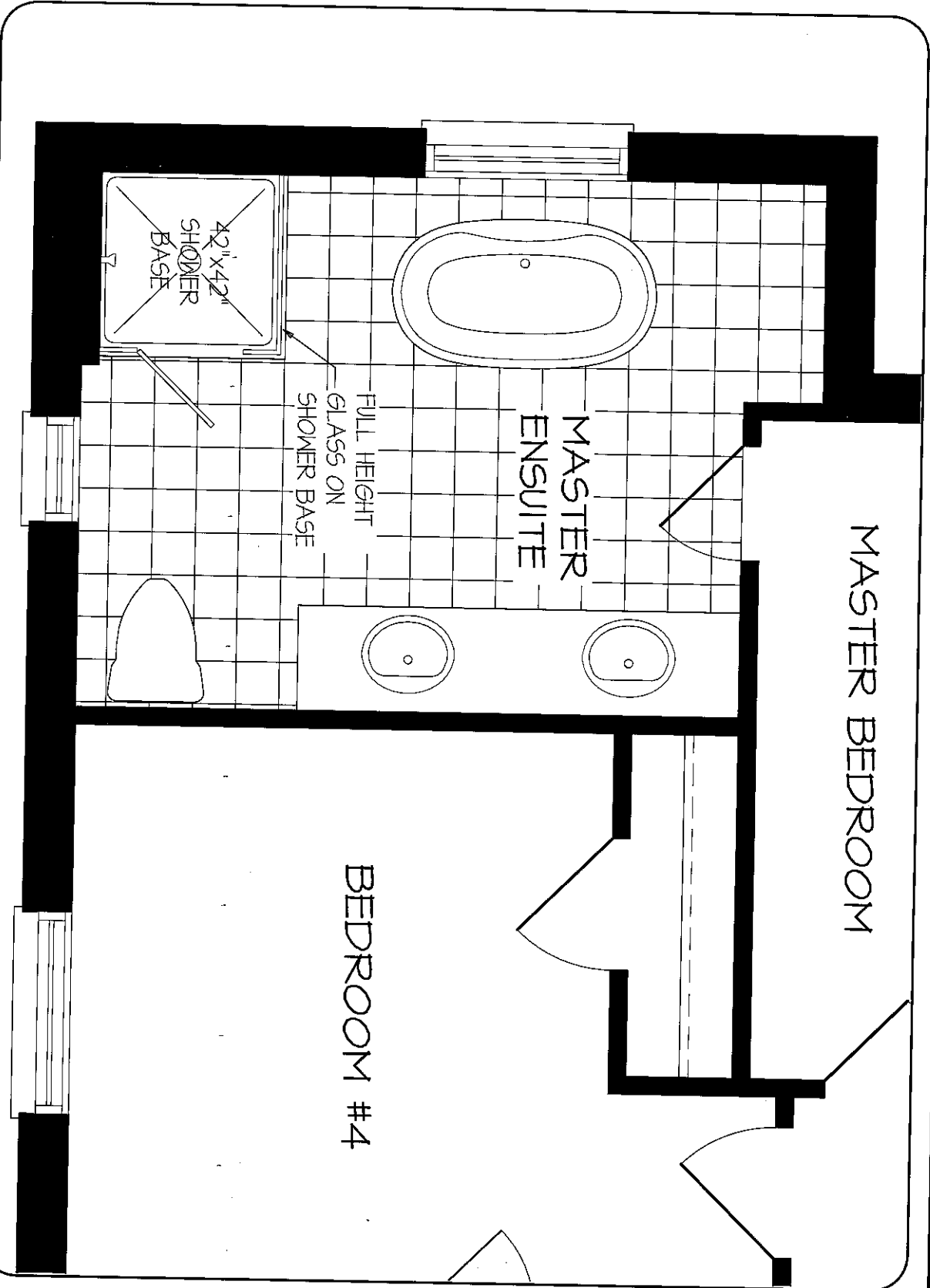

UPPER LEVEL

DISCLAIMERS: SKETCH NOT TO SCALE. DIMENSIONS, SPECIFICATIONS AND ARCHITECTURAL DETAILS SUBJECT TO MODIFICATION BY THE VENDOR. SKETCH IS ONLY FOR THE PURPOSE OF ILLUSTRATING REVISIONS REQUESTED BY THE PURCHASER AND ALL REVISIONS ARE SUBJECT TO VENDOR'S FINAL APPROVAL. ONLY REVISIONS ACCEPTED IN WRITING BY THE PURCHASER AND VENDOR ON A PURCHASER'S EXTRA SHEET WILL BE INCORPORATED INTO THE PLANS FILED WITH THE MUNICIPALITY. E. & O.E.

REGION
DESIGN
INC.

SCALE
BY
MB
N.T.S.
PAGE NO.
1 OF 1

Greenpark



Microwave Ovens Cyclonic Inverter™
Countertop NN-SD965S

MODEL & SIZE	Model Number	NN-SD965S
	Type	Full-size
	Installation	Countertop or built-in
	Oven Capacity	2.2 cu. ft.
	Cooking Power	1200W
	Turntable Diameter	420mm
PANASONIC TECHNOLOGY	Panasonic Inverter	Cyclonic Inverter
	Genius Sensor	Genius®
DESIGN	Color	Stainless Steel
	Control Panel	Dial + Button
	Display Panel	New 6 Digit LCD / Green
STYLE	Door Window	Smoked Glass
	Door Release	Push Open
	Oven Interior	Paint White
PERFORMANCE	Multi-stage Cooking	3 stage
PROGRAMMABLE FEATURES	Sensor Cook	Yes
	Sensor Reheat	Yes
	Auto Cook/Reheat	Yes
	More / Less Control	Yes
	Inverter Turbo Defrost	Yes
	Keep Warm Button	Yes
	Popcorn Button	Yes
	Quick Minute	Yes
SPECIFICATIONS	Cavity Dimensions (W x D x H)	Approx. 469 x 470 x 278 mm

		17.6 x 18.5 x 10.7 inch
Unit Dimensions (W x D x H)		606 x 506 x 356 mm 23.9 x 19.9 x 14 inch
Carton Dimensions (W x D x H)		675 x 540 x 420 mm
ACCESSORIES	TRIM KITS	XXXXXXXXXX
	30" Model Number	NN-TK932S
	Accessory	Glass Tray

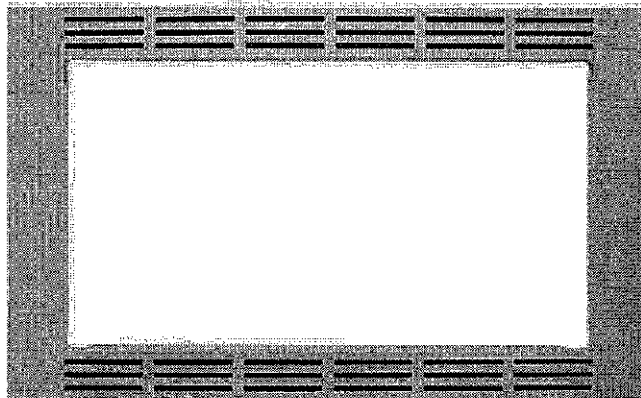

30" Trim Kit for select Microwaves NN-TK932SS

NN-TK932SS

-
- **MORE DETAILS**
 - Compatible Models NN-SE982S, NN-SD997S, NN-SD962S
 - **TRIM KIT OUTER SIZE**
 - Side A 18-9/16"
 - Side B 30"
 - **TRIM KIT INNER SIZE**
 - Side C 24-5/8"
 - Side D 13-11/16"
 - **CABINET OPENING**
 - Side E 28-1/2"
 - Side F 17-3/8"
 - Side G 21" minimum

-
- ◦ **UPC885170073104**
-

2. Installation Diagram
2. Schéma d'installation
2. Diagrama de instalación

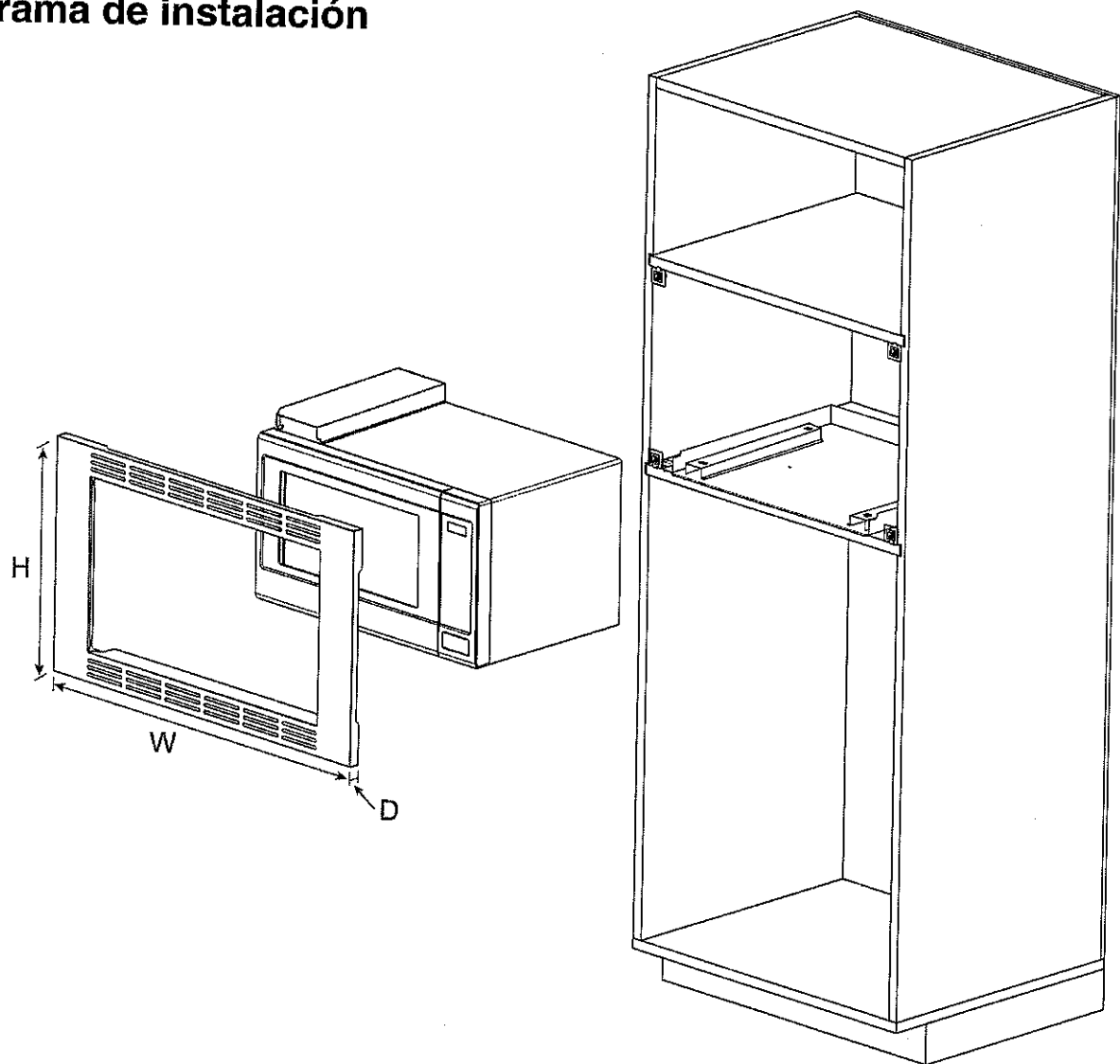

Trim Kit Dimensions				
	TK932S	TK922S	TK732S	TK722S
Width	30" (760 mm)	27" (684 mm)	30" (760 mm)	27" (684 mm)
Height	18 9/16" (472 mm)	18 9/16" (472 mm)	16 1/2" (419 mm)	16 1/2" (419 mm)
Depth (Thickness)	3/4" (20 mm)	3/4" (20 mm)	3/4" (20 mm)	3/4" (20 mm)

Dimensions du nécessaire d'encastrement				
	TK932S	TK922S	TK732S	TK722S
Largeur	760 mm (30 po)	684 mm (27 po)	760 mm (30 po)	684 mm (27 po)
Hauteur	472 mm (18 9/16 po)	472 mm (18 9/16 po)	419 mm (16 1/2 po)	419 mm (16 1/2 po)
Profondeur (épaisseur)	20 mm (3/4 po)	20 mm (3/4 po)	20 mm (3/4 po)	20 mm (3/4 po)

Dimensiones del juego de acabados				
	TK932S	TK922S	TK732S	TK722S
Ancho	30" (760 mm)	27" (684 mm)	30" (760 mm)	27" (684 mm)
Altura	18 9/16" (472 mm)	18 9/16" (472 mm)	16 1/2" (419 mm)	16 1/2" (419 mm)
Profundidad (grosor)	3/4" (20 mm)	3/4" (20 mm)	3/4" (20 mm)	3/4" (20 mm)

3-1. Cabinet Diagram and Dimensions (For TK932S)

3-1. Schéma de l'armoire et dimensions (Pour TK932S)

3-1. Dimensiones y diagrama del gabinete (Para TK932S)

fig 1.

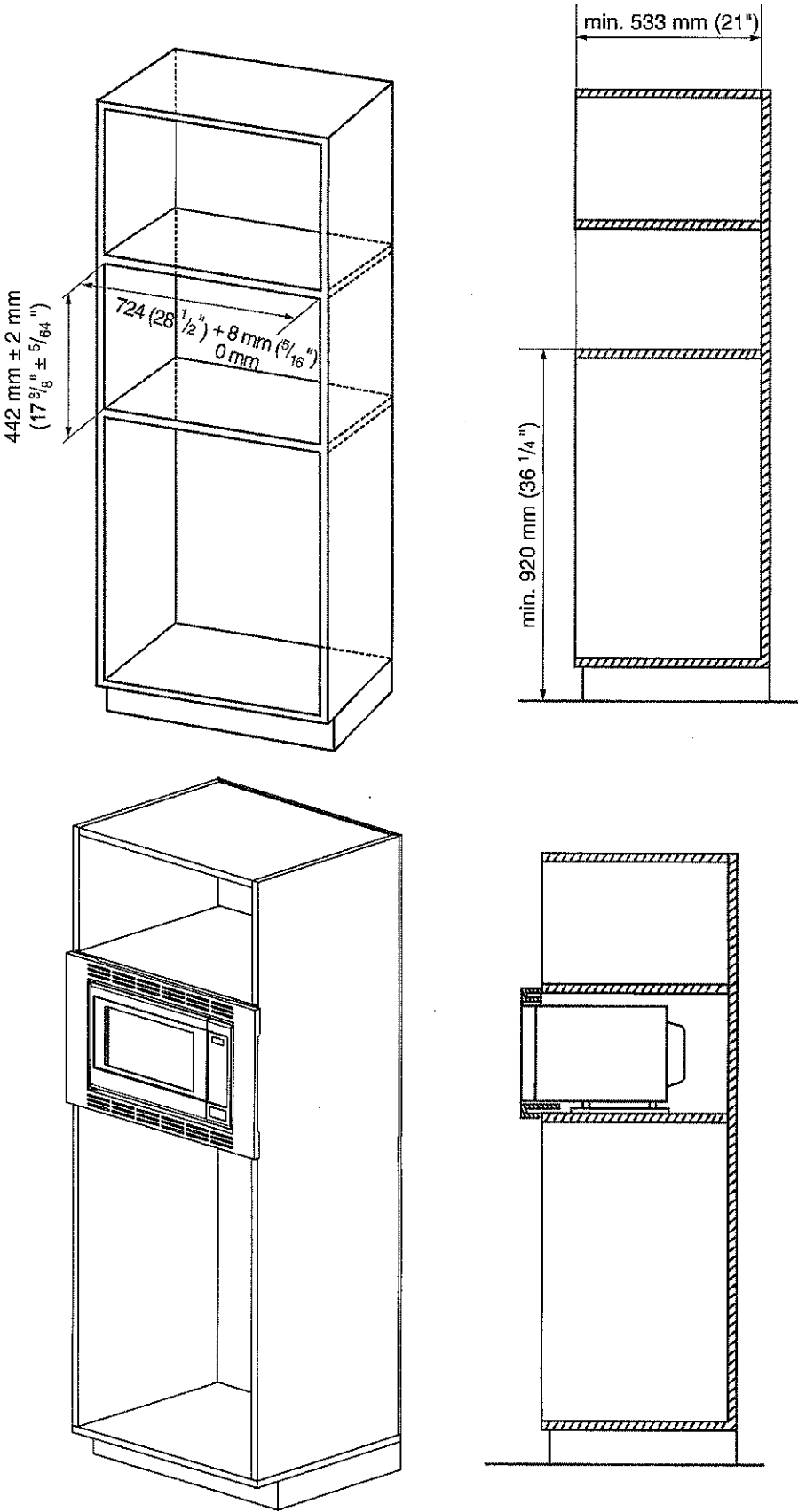

HOME APPLIANCES

LG COOKING

LRGL5825

5.8 cu. ft. Smart Wi-Fi Enabled True Convection
InstaView™ Gas Range with Air Fry

- 5.8 cu. ft. Capacity
InstaView™ Window
Built-In Air Fry with True Convection
EasyClean® + Self Clean
UltraHeat™ 20K BTU Power Burner
LG ThinQ® App with ThinQ Care

AVAILABLE COLORS

- PRINTPROOF™ STAINLESS STEEL
PRINTPROOF™ BLACK STAINLESS STEEL

Proactive Smart Alerts to Keep
Your Appliances Running Smoothly

- Preventative Alerts help you stay a step ahead of potential issues to find proactive solutions before problems arise.
- Avoid preventable repairs and service calls with real-time diagnostics for a hassle-free experience.
- Integrated within LG's ThinQ app—a smart home hub for managing your smart devices and appliances.

ThinQ Care

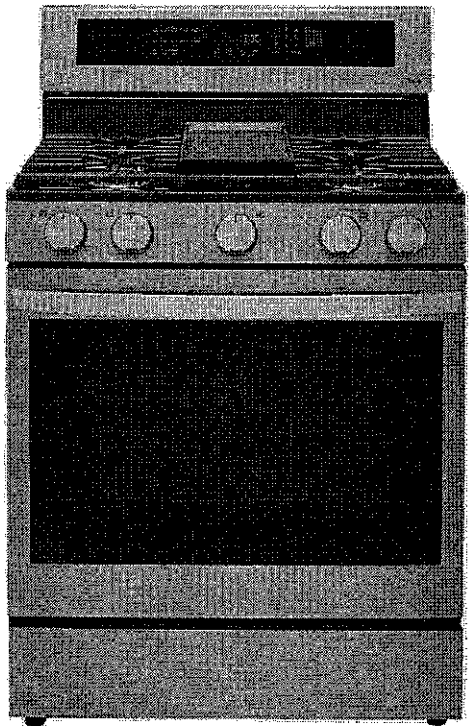

SUMMARY	
Cooktop Type	Sealed
Number of Cooktop Burners	5
Oven Type	Single Oven
Oven Cooking System	True Convection
Oven Capacity (cu. ft.)	5.8
Oven Cleaning Type	EasyClean® + Self Clean
Drawer Type	Storage
Size in Width (in.)	30"
APPEARANCE	
Color	PrintProof™ Stainless Steel PrintProof™ Black Stainless Steel
Control Type	SmoothTouch™ Glass
Knobs	Stainless Steel Appearance, Weighted
Oven Door Feature	InstaView & WideView™ Window
Cooktop Finish	Porcelain Enamel
COOKTOP	
Cooktop Type	Sealed
Number of Cooktop Burners	5
Element/Burner - Left Front	17,000 BTU SuperBoil™
Element/Burner - Left Rear	9,100 BTU
Element/Burner - Right Front	20,000 BTU UltraHeat™
Element/Burner - Right Rear	5,000 BTU
Element/Burner - Center	10,000 BTU Oval
Cooktop Burner Grate Features	Edge-to-edge continuous grates
Cooktop Burner Grate Material	Cast Iron

OVEN	
Oven Type	Single Oven
Oven Cooking System	True Convection
Convection Conversion Auto-Adjust	Yes
Oven Cleaning Type	EasyClean® + Self Clean
Self-Clean Oven Door Lock	Automatic
Oven Capacity (cu. ft.)	5.8
Broiler Element Power	13,500 BTU
Bake Element Power	19,000 BTU
Number of Rack Positions	7
Number of Oven Racks	3
Oven Rack Type	3 Standard
Drawer Type	Storage
Oven Modes	Bake, Broil, Air Fry, Proof, Easy & Self Clean, Convection Bake, Convection Roast Keep Warm & Warm, Frozen Meal, Slow Cook, Favorite
Oven Light Type	Halogen
CONTROL FEATURES	
Kitchen Timer	Yes
Timed Cook	Yes
Oven Control Lock	Yes
Door Lock	Yes
Sabbath Mode	Yes

SMART FEATURES	
Wi-Fi	Yes
ThinQ Care	Yes
Smart Diagnosis™	Yes
Works with	LG ThinQ® Amazon Alexa Google Assistant SIDECHEF
DIMENSIONS & WEIGHT	
Cabinet Width (in.)	30"
Overall Depth (in.) - including handle	28 7/8"
Overall Height (in.)	46 1/2"
Overall Width (in.)	29 7/8"
Product Weight (lb)	169
Shipping Weight (lb)	200
Shipping Dimensions (W x H x D) (in.)	32 1/2" x 51" x 30 1/2"
POWER/RATINGS	
Volts/Hertz/Amps	120V/60-Hz/10.0A
INCLUDED ACCESSORIES	
Cast Iron Griddle	Yes
UPC CODES	
LRGL5825F (PrintProof™ Stainless Steel)	048231341516
LRGL5825D (PrintProof™ Black Stainless Steel)	048231341523

14 INSTALLATION

Installing the Range

Unpacking and Moving the Range



CAUTION

- You should use two or more people to move and install the range. (Excessive Weight Hazard) Failure to do so can result in back or other injury.
- Do not use the door handles to push or pull the range during installation or when moving the range out for cleaning or service. Doing so can result in serious damage to the door of the range.

Remove packing material, protective film, tape and any temporary labels from your range before using. Do not remove any warning-type labels, the model and serial number label, or the Tech Sheet that is located on the back of the range.

To remove any remaining tape or glue, rub the area briskly with your thumb. Tape or glue residue can also be easily removed by rubbing a small amount of liquid dish soap over the adhesive with your fingers. Wipe with warm water and dry.

Do not use sharp instruments, rubbing alcohol, flammable fluids, or abrasive cleaners to remove tape or glue. These products can damage the surface of your range.

Your range is heavy and can be installed on soft floor coverings such as cushioned vinyl or carpeting. Use care when moving the range on this type of flooring. Use a belt when moving the range to prevent damaging the floor. Or slide the range onto cardboard or plywood to avoid damaging the floor covering.

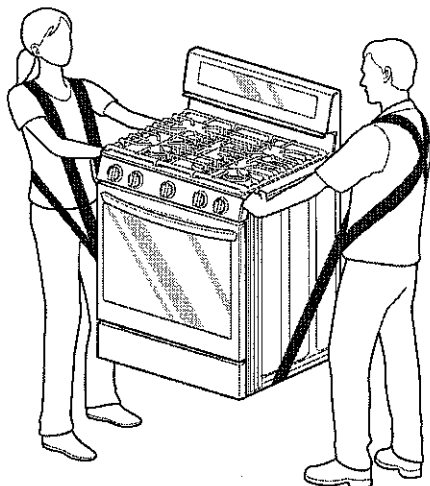

Choosing the Proper Location

Do not locate your range where it may be subject to strong drafts. Any openings in the floor or wall behind the range should be sealed. Make sure the openings around the base of the range that supply fresh air for combustion and ventilation are not blocked by carpeting or woodwork.

Your range, like many other household units, is heavy and can be installed on soft floor coverings such as cushioned vinyl or carpeting. Use care when moving the range on this type of flooring.

This appliance must not be installed with a ventilation system that blows air downward toward the range. This type of ventilation system may cause ignition and combustion problems with the gas cooking appliance resulting in personal injury or unintended operation.

When the floor covering ends at the front of the range, the area that the range will be installed on should be built up with plywood to the same level or higher than the floor covering. This will allow the range to be moved for cleaning and servicing, as well as provide proper air flow to the range.

Also, make sure the floor covering can resist temperatures of at least 167 °F (75 °C). See the Installation Safety Precautions included in this manual.

Make sure the wall coverings around your range can resist the heat generated up to 194 °F (90 °C) by the range. See the Precautions Safety Precautions included in this manual.

Gas Pipe and Electrical Outlet Locations

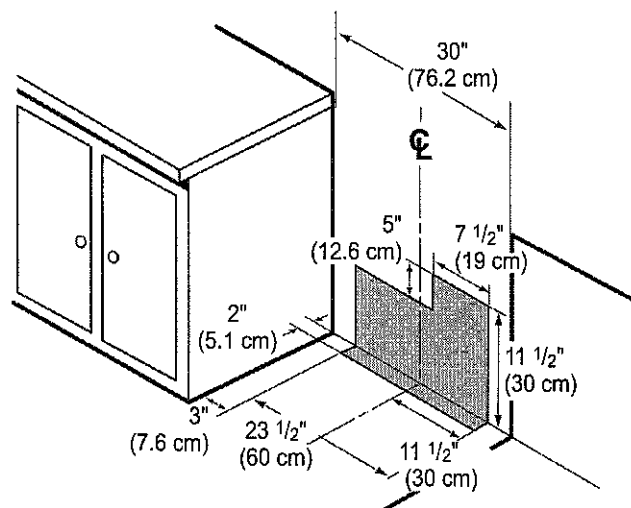

Dimensions and Clearances

Provide proper clearance between the range and adjacent combustible surfaces. These dimensions must be met for safe use of your range. The location of the electrical outlet and pipe opening (see Gas Pipe and Electrical Outlet Locations, page 14) may be adjusted to meet specific requirements. The range may be placed with 0" clearance (flush) at the back wall.

Installation Clearances

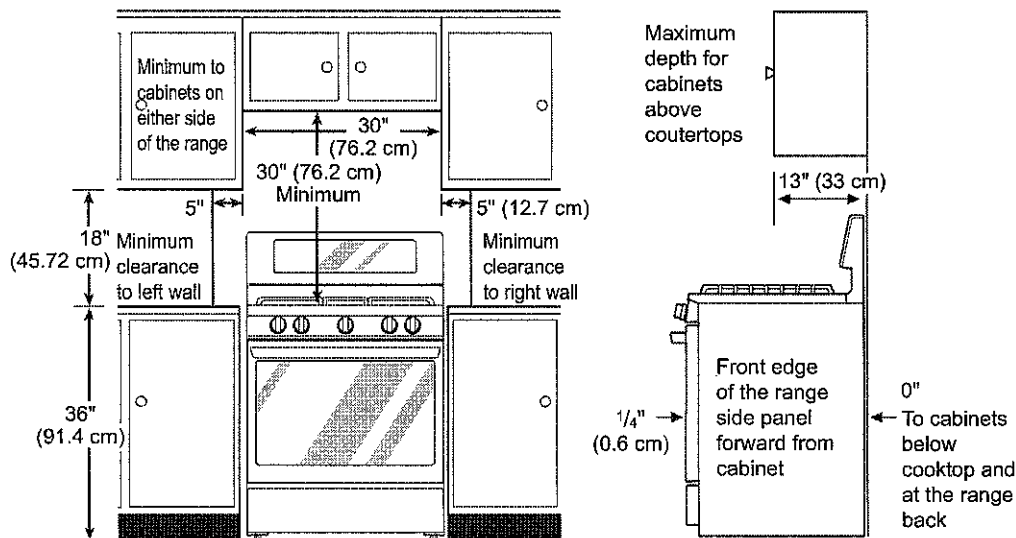

Dimensions

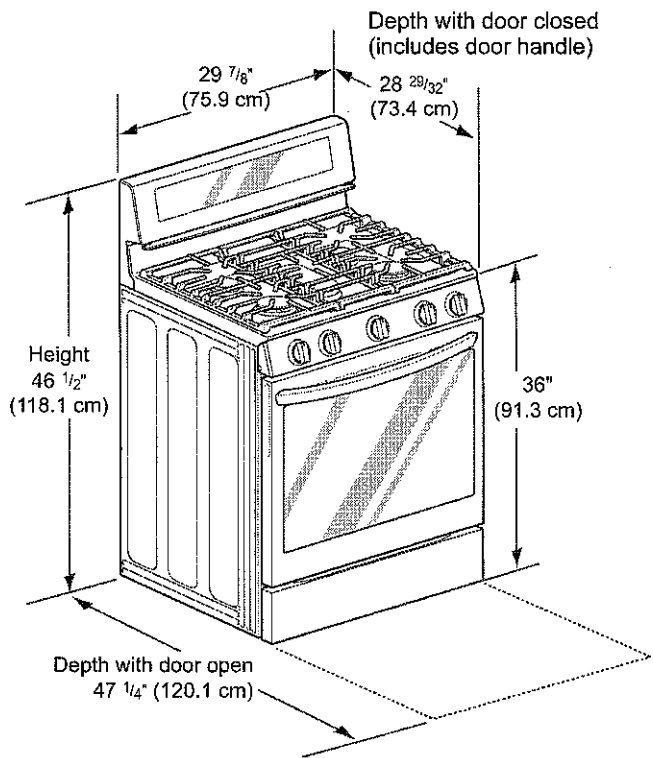

36" Counter-Depth 3-Door Refrigerator

800 Series – Stainless Steel B36CT80SNS

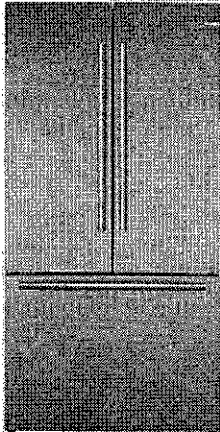

B36CT80SNS
Stainless Steel

Also available in:
Black Stainless Steel
B36CT80SNB

Introducing the revolutionary, new FarmFresh System™, with four freshness technologies designed to work together to keep your food fresher, longer. Enjoy less food waste, new innovative features and more thoughtful design.

Features & Benefits

VitaFreshPro™ provides pre-programmed freshness settings to optimize temperature and humidity to keep meat, fish, and produce fresher, longer.

Interior Water Dispenser is thoughtfully placed inside for refreshing water at the touch of a button or a push of a nozzle.

FlexBar™ utilizes typically unused space in the upper refrigerator cavity.

General Properties	
Full 72" height and true counter depth for built-in appearance	Yes
Easy Clean Stainless Steel	Yes
Lighting	Recessed LED light bars
Number of compressors/evaporators	2 / 2
Defrost process refrigerator section	Frost-free
Number of shelves – refrigerator	5
Adjustable shelves – refrigerator	4 half-width
Shelf material – refrigerator	Tempered glass
Type of shelves – refrigerator	Frameless split shelves with metal trim
Flexible storage bar	FlexBar™
Gallon storage bins	2
Humidity control compartments	2
Full width temp. & humidity controlled drawer	VitaFreshPro™
Ice maker	Yes
Water filter	UltraClarityPro™
Internal water dispenser	Yes
Touch control panel	Yes
AirFresh® filter	Yes
FreshProtect™ ethylene filter	Yes
MultiAirFlow™	Yes
Stainless steel back wall	Yes
Defrost process freezer section	Automatic
Number of drawers – freezer	3
Wi-Fi enabled	Yes, Home Connect™ app

Capacity	
Total capacity (cu. ft.)	20.8
Refrigerator capacity (cu. ft.)	14.8
Freezer capacity (cu. ft.)	6
Technical Details	
Current (A)	15 A
Volts (V)	115 V
Frequency (Hz)	60 Hz
Power cord length (in.)	91
Plug type	120V-3 prong
Dimensions & Weight	
Appliance dimensions with hinges, handles and doors (HxWxD) (in.)	72" x 35 5/8" x 31 1/8"
Appliance dimensions without hinges and doors (HxWxD) (in.)	71 1/2" x 35 5/8" x 24"
Appliance dimensions with hinges and doors, no handles (HxWxD) (in.)	72" x 35 5/8" x 28 3/4"
Required cutout size (HxWxD) (in.)	72" x 36" x 25"
Net weight (lbs)	350 lbs
Efficiency	
Energy consumption (kWh/yr)	570
ENERGY STAR® qualified	Yes
Accessories	
UltraClarityPro™ Water Filter: BORPLFTR50 FlexBar™ Bottle Holder: BOFLEXBOTL FlexBar™ Deep Shelf: BOFLEXLGSH FlexBar™ Shallow Shelf: BOFLEXSM SH Ethylene Filter Refill Kit: FPETHRF50	

Home Connect



*When leveling legs are fully extended, add 5/8" to overall height, total 72 5/8".
**The cutout depth of 25" includes the required 1" airflow. The electrical covers on the back of unit do not require additional depth.
Accessories: To purchase Bosch accessories, cleaners & parts please visit www.bosch-home.com/us/store or call 1-800-944-2904 (Mon to Fri 5 am to 6 pm PST, Sat 6 am to 3 pm PST).
Notes: All height, width and depth dimensions are shown in inches. BSH reserves the absolute and unrestricted right to change product materials and specifications, at any time, without notice. Consult the product's installation instructions for final dimensional data and other details prior to making cutout.
Warranties: Please see Use & Care manual or Bosch website for statement of limited warranty.
For more information on our entire line of products, go to www.bosch-home.com/us or call 1-800-944-2904
© BSH Home Appliances Corporation. All rights reserved. Bosch is a registered trademark of Robert Bosch GmbH.

36" Counter-Depth 3-Door Refrigerator

800 Series – Stainless Steel B36CT80SNS



Installation Details

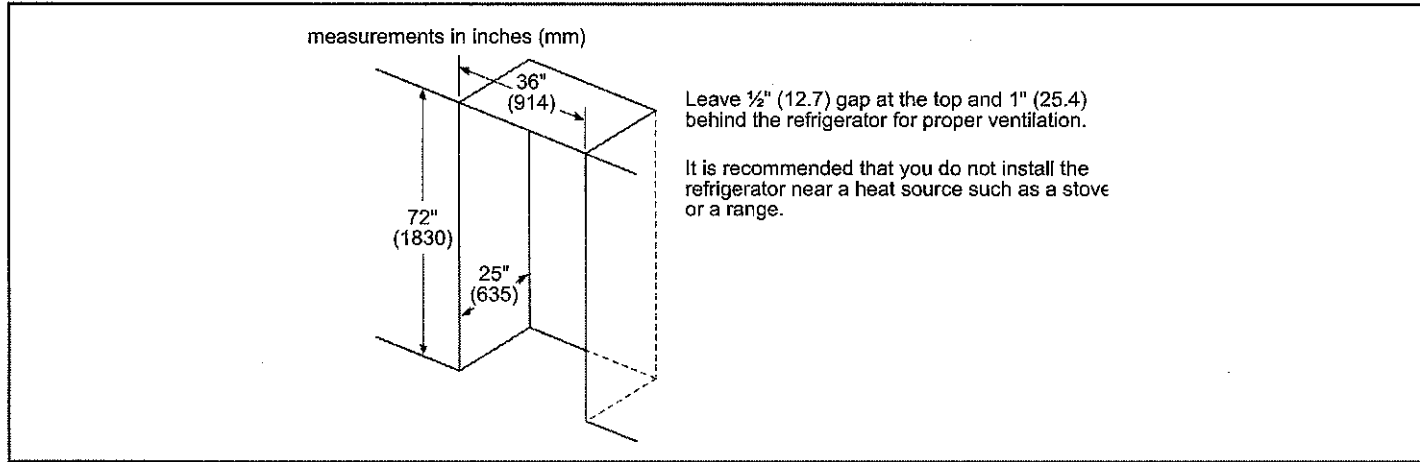
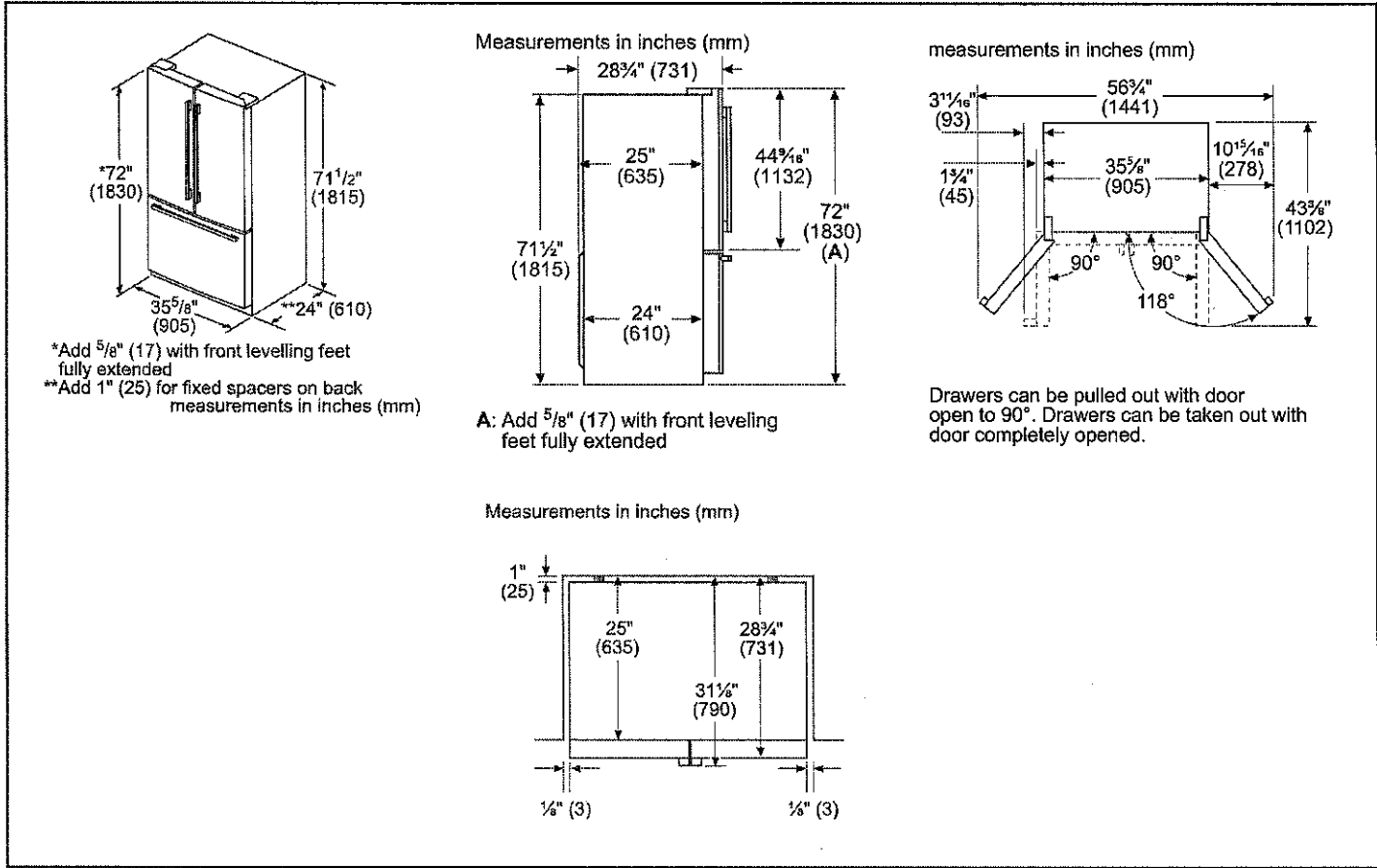

Accessories: To purchase Bosch accessories, cleaners & parts please visit www.bosch-home.com/us/store or call 1-800-944-2904 (Mon to Fri 5 am to 6 pm PST, Sat 6 am to 3 pm PST).

Notes: All height, width and depth dimensions are shown in inches. BSH reserves the absolute and unrestricted right to change product materials and specifications, at any time, without notice. Consult the product's installation instructions for final dimensional data and other details prior to making cutout.

Warranties: Please see Use & Care manual or Bosch website for statement of limited warranty.

For more information on our entire line of products, go to www.bosch-home.com/us or call 1-800-944-2904

© BSH Home Appliances Corporation. All rights reserved. Bosch is a registered trademark of Robert Bosch GmbH.