

CONSTRUCTION SUMMARY

Red Oaks - Roundel Homes Inc.

RECEIVED

APR 18 2023

TEL: RES.: 647-677-9189

PURCHASER: Beatrice Sui Ching TAM

LOT / PHASE	REG. PLAN #	HOUSE TYPE		
119 / 1	65M-4737	Pinetree 1 Elev 1		

CERAMIC TILE

1 - DELETE ALL CERAMIC BATHROOM ACCESSORIES - DELETE TOWEL BAR, PAPER HOLDER & SOAP DISH THROUGHOUT 17Apr23 Note:	
----------------------------------------------------------------------------------------------------------------------	--

ELECTRICAL

1 - RELOCATE STANDARD KITCHEN LIGHT TO BE CENTERED OVER ISLAND 17Apr23 Note:	
1 - PLUG - ELECTRICAL PLUG - TO BE INSTALLED OVER FIREPLACE 17Apr23 Note:	
1 - ELECTRIC VEHICLE ROUGH-IN PROVISION ONLY FOR FUTURE ELECTRIC CAR (CONDUIT FROM BASEMENT INTO JUNCTION BOX IN GARAGE WITH PULL STRING, NO WIRE) 17Apr23 Note:	

HARDWOOD FLOORING

1 - HARDWOOD - GROUP B SERIES 5 INCH - IN LIEU OF 3 1/4 INCH NATURAL RED OAK - - FIRST FLOOR IN STANDARD HARDWOOD AREAS 17Apr23 Note:	
1 - HARDWOOD - GROUP B SERIES 5 INCH - - UPPER HALL 17Apr23 Note:	

PLUMBING

1 - WATER LINE FOR FRIDGE - ROUGH-IN ONLY 17Apr23 Note:	
------------------------------------------------------------	--

PROMOTIONAL

1 - LESS CREDIT FROM PURCHASER EXTRA SHEET IN OFFER 17Apr23 Note:	
----------------------------------------------------------------------	--

STAIRS AND RAILINGS

1 - STAINED STAIRS - STANDARD STAIRCASE - PRICE IS PER SET 17Apr23 Note:	
-----------------------------------------------------------------------------	--

This Document is Extremely Time Sensitive - Printed 17 Apr 23 at 14:57

Purchaser: Beatrice Sui Ching TAM
Telephone Res. / Bus: (647) 677-9189 /
Decor Advisor: Giulia Di Girolamo
Lock Date: 17-Apr-23

Property: 119
Project: Roundel Homes Inc.
Model and Elevation: Pinetree 1 Elev 1
Plan #: 65M-4737

Layout Changes: Yes No **Sketch Attached:** Yes No **Exterior Colour Scheme:**

1. Cabinetry

	Style and Colour	Hardware
Kitchen / Breakfast	DORAL -H3078 HACIENDA WHITE	464SA
Laundry Room	ELISSE	Standard
Powder Room	DORAL - K43 SUMMIT WHITE	468SA
Master Ensuite Bathroom	MONACO -1048 FLAX	468SA
Ensuite Bath - Bedroom 2	DORAL -H3078 HACIENDA WHITE	468SA
Ensuite Bath - Bedroom 3/4	MONACO -350 PLATINUM SILVER	468SA
	<input type="text"/>	<input type="text"/>
	<input type="text"/>	<input type="text"/>
	<input type="text"/>	<input type="text"/>

Appliances: **Built In Appliances** Yes No **Slide In Stove** Yes No

Dishwasher Cabinet Closed Open **41" Upper Cabinets** Yes No Please NOTE: Standard Cabinet Height is 30"

Stove Opening NOTE: If not specified, opening will be set to builder's standard opening of approximately 30" width

Fridge Opening  NOTE: If not specified, opening will be set to builder's standard opening of approximately 37" width x 74" height

**** Refer to Construction Summary**

2. Counters

	Counter	Edge
Kitchen / Breakfast	GRANITE-GRIGIO SARDO	#360 EDGE
Laundry Room	N/A	
Powder Room	LAMINATE-CALCUTTA MARBLE 4925K-07	
Master Ensuite Bathroom	LAMINATE-WHITE CARRARA 4924-38	
Ensuite Bath - Bedroom 2	LAMINATE-ELEMENTAL CONCRETE 8830-58	
Ensuite Bath - Bedroom 3/4	LAMINATE-PALOMA POLAR 6698-46	
	<input type="text"/>	<input type="text"/>
	<input type="text"/>	<input type="text"/>
	<input type="text"/>	<input type="text"/>

**** Refer to Construction Summary**

Initial: 

Purchaser: Beatrice Sui Ching TAM
Telephone Res. / Bus: (647) 677-9189 /
Decor Advisor: Giulia Di Girolamo
Lock Date: 17-Apr-23

Property: 119
Project: Roundel Homes Inc.
Model and Elevation: Pinetree 1 Elev 1
Plan #: 65M-4737

3. Ceramic Flooring

At a 45 Threshold-If App.

Entrance Vestibule	TILE-LOFT GRIS 12.5X12.5	<input type="checkbox"/>	
Main Hall	HARDWOOD	<input type="checkbox"/>	Metal Strip Where Applic.
Kitchen / Breakfast	TILE-E.B. LOFT CENDRA 12.5X12.5	<input type="checkbox"/>	
Laundry Room	TILE-FRIGIA WHITE 13X13	<input type="checkbox"/>	
Powder Room	TILE-E.B. LOFT CENDRA 12.5X12.5	<input type="checkbox"/>	
Master Ensuite Bathroom	TILE-E.B. LOFT CENDRA 12.5X12.5	<input type="checkbox"/>	
Ensuite Bath - Bedroom 2	TILE-ESSENZE BIANCO 13X13	<input type="checkbox"/>	
Ensuite Bath - Bedroom 3/4	TILE-FRIGIA ANTHRACITE13X13	<input type="checkbox"/>	
		<input type="checkbox"/>	
		<input type="checkbox"/>	
		<input type="checkbox"/>	

** Refer to Construction Summary

4. Ceramic Wall Tile

Master Ensuite Bathroom	Selection	Describe
Tub Deck Wall	N/A	
Tub Deck	N/A	
Tub Deck Skirt	N/A	
Shower Stall	TILE-CONCEPT NEVE MATTE 8X16	
Bathtub Enclosure Walls	N/A	
Ensuite Bath - Bedroom 2	TILE-FANTASIA AZZURRO COOR 8X10	
Ensuite Bath - Bedroom 3/4	TILE-FOX GREY (428) 8X16	
Kitchen Backsplash	N/A	

** Refer to Construction Summary - STANDARD GROUT THROUGHOUT UNLESS SPECIFIED

5. Plumbing Fixtures

All Bathrooms	White	Whirlpool <input type="checkbox"/> N/A <input type="radio"/> Yes <input checked="" type="radio"/> No Dishwasher Rough-In <input checked="" type="radio"/> Yes <input type="radio"/> No Waterline for Fridge <input checked="" type="radio"/> Yes <input type="radio"/> No
	<input type="text" value="N/A"/>	
	<input type="text" value="N/A"/>	
	<input type="text" value="N/A"/>	
	<input type="text" value="N/A"/>	

** Refer to Construction Summary

6. Trim Carpentry

Interior Doors	CARRARA-SMOOTH
Interior Trim	3" BB CASING WITH 5 1/4" BASEBOARD - COLONIAL
Door Handles	As Per Construction Specifications
Exterior Front Door Handle	As Per Construction Specifications

** Refer to Construction Summary

Initial: 

Purchaser: Beatrice Sui Ching TAM
Telephone Res. / Bus: (647) 677-9189 /
Decor Advisor: Giulia Di Girolamo
Lock Date: 17-Apr-23

Property: 119
Project: Roundel Homes Inc.
Model and Elevation: Pinetree 1 Elev 1
Plan #: 65M-4737

7. Outer Flooring

Main Hall	HARDWOOD-VINTAGE-NORTHERN SOLID SAWN-SMOOTH-RED OAK CHARACTER-5"-SHALE PEARL
Living Room	N/A
Dining Room	HARDWOOD-VINTAGE-NORTHERN SOLID SAWN-SMOOTH-RED OAK CHARACTER-5"-SHALE PEARL
Family Room	HARDWOOD-VINTAGE-NORTHERN SOLID SAWN-SMOOTH-RED OAK CHARACTER-5"-SHALE PEARL
Den / Library / Study	N/A
Basement Landing(If Applies)	N/A
Lower Landing (If Applies)	HARDWOOD-VINTAGE-NORTHERN SOLID SAWN-SMOOTH-RED OAK CHARACTER-5"-SHALE PEARL
Upper Landing	HARDWOOD-VINTAGE-NORTHERN SOLID SAWN-SMOOTH-RED OAK CHARACTER-5"-SHALE PEARL
Upper Hall	HARDWOOD-VINTAGE-NORTHERN SOLID SAWN-SMOOTH-RED OAK CHARACTER-5"-SHALE PEARL
Master Bedroom	LAMINATE-LEXINGTON-BRUSSELS OAK-TL-LW1316
Bedroom #2	LAMINATE-LEXINGTON-BRUSSELS OAK-TL-LW1316
Bedroom #3	LAMINATE-LEXINGTON-BRUSSELS OAK-TL-LW1316
Bedroom #4	LAMINATE-LEXINGTON-BRUSSELS OAK-TL-LW1316
Bedroom #5	N/A
Underpad	Type Area
	N/A N/A

**** Refer to Construction Summary**

8. Railings and Pickets

Railing Type	AS PER CONSTRUCTION SPECIFICATIONS	Complimenting Colour	VINTAGE-RED OAK-SHALE PEARL
Picket Type	AS PER CONSTRUCTION SPECIFICATIONS	Complimenting Colour	VINTAGE-RED OAK-SHALE PEARL
Stringer / Riser	AS PER CONSTRUCTION SPECIFICATIO	Complimenting Colour	VINTAGE-RED OAK-SHALE PEARL
Treads	AS PER CONSTRUCTION SPECIFICATIO	Complimenting Colour	VINTAGE-RED OAK-SHALE PEARL
Red Oak Stairs	<input checked="" type="radio"/> Yes <input type="radio"/> No		

**** Refer to Construction Summary THE STAIN COLOURS OR FINISH AVAILABLE ON RISERS, TREADS, PICKETS AND RAILS (STAIRCASES), WILL NOT BE AN EXACT MATCH TO PREFINISHED HARDWOOD OR LAMINATE FLOORS.**

9. Wall Paint Flat Finish

Main & Upper Hall	WARM GREY	Master Bedroom	WARM GREY
Living Room	N/A	Bedroom #2	WARM GREY
Dining Room	WARM GREY	Bedroom #3	WARM GREY
Kitchen / Breakfast	WARM GREY	Bedroom #4	WARM GREY
Family Room	WARM GREY	Bedroom #5	N/A
Powder Room	WARM GREY	Master Ensuite	WARM GREY
Laundry Room	WARM GREY	Ensuite Bath - Bedroom 2	WARM GREY
Den/Library	N/A	Ensuite Bath - Bedroom 3/4	WARM GREY
Trim & Door Paint-Semi Gloss	BIRCH WHITE		
Smooth Ceilings First Floor	<input type="radio"/> Yes <input checked="" type="radio"/> No		

**** Refer to Construction Summary**

Initial: _____

Purchaser: Beatrice Sui Ching TAM
Telephone Res. / Bus: (647) 677-9189 /
Decor Advisor: Giulia Di Girolamo
Lock Date: 17-Apr-23

Property: 119
Project: Roundel Homes Inc.
Model and Elevation: Pinetree 1 Elev 1
Plan #: 65M-4737

10. Plaster Mouldings and Medallions

Entrance Vestibule	<input type="text"/>	<input type="text"/>	Kitchen/Breakfast	<input type="text"/>	<input type="text"/>
Main Hall	<input type="text"/>	<input type="text"/>	Den/Library	<input type="text"/>	<input type="text"/>
Living Room	<input type="text"/>	<input type="text"/>	Lower Landing	<input type="text"/>	<input type="text"/>
Dining Room	<input type="text"/>	<input type="text"/>		<input type="text"/>	<input type="text"/>
Family Room	<input type="text"/>	<input type="text"/>		<input type="text"/>	<input type="text"/>

** Refer to Construction Summary

11. Fireplace

	Living Room			Family Room			Other Room - Specify		
	Purchased	As Per Plan	N/A	Purchased	As Per Plan	N/A	Purchased	As Per Plan	N/A
Fireplace Type	<input type="radio"/>	<input type="radio"/>	<input checked="" type="radio"/>	<input type="radio"/>	<input checked="" type="radio"/>	<input type="radio"/>	<input type="radio"/>	<input type="radio"/>	<input checked="" type="radio"/>
Mantle Type	<input type="text"/>			FLAT ON WALL			<input type="text"/>		
Colour / Stain	<input type="text"/>			MANTLE M1-STANDARD			<input type="text"/>		
Surround	<input type="text"/>			BIRCH WHITE			<input type="text"/>		
Hearth	<input type="text"/>			GRIGIO CARNICO			<input type="text"/>		
	<input type="text"/>			NO			<input type="text"/>		

** Refer to Construction Summary

12. Heating and Air Conditioning

Air Conditioning	<input type="text" value="NO"/>	Gas Provisions Stove	<input type="text" value="NO"/>
Gas Provisions Dryer	<input type="text" value="NO"/>	Gas Provisions Barbecue	<input type="text" value="NO"/>
Comment	<input type="text"/>		

** Refer to Construction Summary

13. Electrical

Plugs and Switches	<input checked="" type="radio"/> White	<input type="text" value="DECOR"/>	Above Kitchen Cabinet Light	<input type="radio"/> Yes	<input checked="" type="radio"/> No
Hood Fan	<input type="text" value="STANDARD WHITE"/>		Below Kitchen Cabinet Light	<input type="radio"/> Yes	<input checked="" type="radio"/> No
Appliances	Built in Cooktop	Built in Oven	Gas Stove	Microwave	
	<input type="radio"/> Yes <input checked="" type="radio"/> No	<input type="radio"/> Yes <input checked="" type="radio"/> No	<input type="radio"/> Yes <input checked="" type="radio"/> No	<input type="radio"/> Yes <input checked="" type="radio"/> No	
Dishwasher Rough-in	<input type="text" value="Yes"/>				

** Refer to Construction Summary

14. General Comments

** Refer to Construction Summary

Disclaimers and Notes

- Colours of all materials are as close as possible to builder's selection, but not necessarily identical due to variances in manufacturing.
- Any extras listed above are null and void unless accompanied by a separate invoice/amendment. Said invoice must be paid in full.
- The Purchaser agrees that this colour selection is final and that no changes will be permitted, unless required by the Vendor.
- The Purchaser acknowledges reading and accepting document which contains other miscellaneous disclaimers.
- In the event of a conflict between the Standard Features schedule of the Agreement of Purchase and Sale and the Interior Colour Scheme, the Interior Colour Scheme shall prevail.

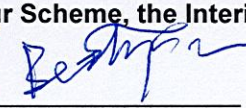
Signature:  

Date: April 17/2023

LOT #119 Roundel

Pinetree 1

ELEV. 1 ~~1~~ 2,365 sq. ft.

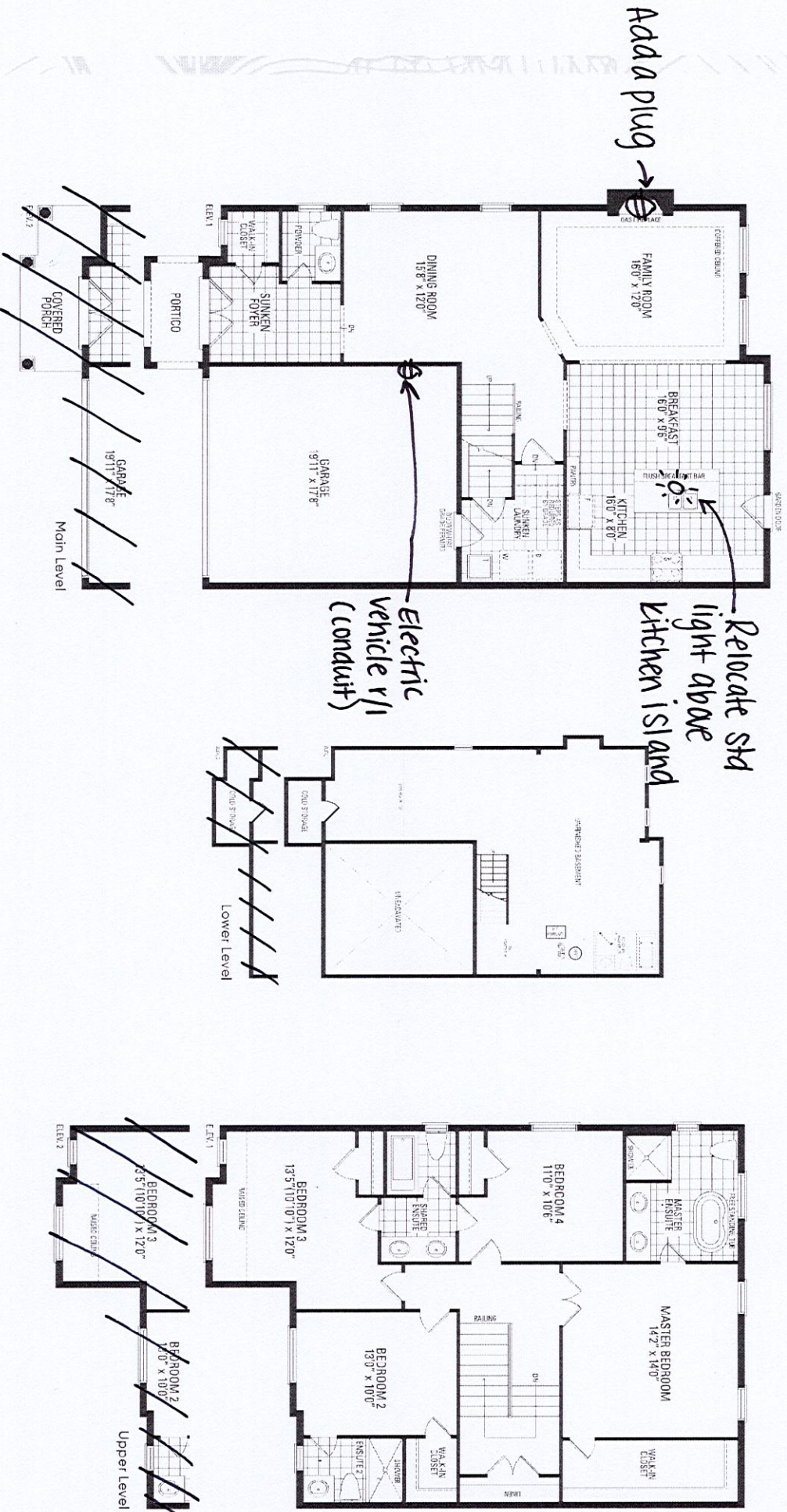

Orientation of home may be reversed and purchaser agrees to accept the same. Steps and porches may vary at any exterior entrance ways due to grading variance. Actual usable floor space may vary from the stated floor areas. All renderings are artist's concept. Dimensions, specifications and architectural detailing subject to modifications. Roofline and adjoining model types may vary due to siting. E. & O. E. June 2022

LOT#119 Roundel -

*NO
upgrades

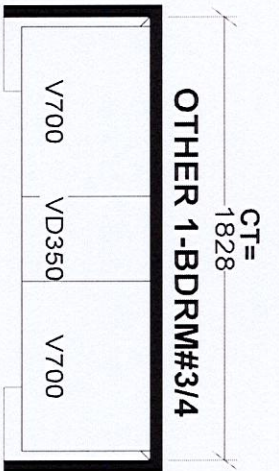
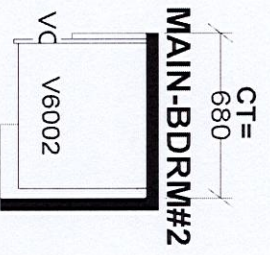
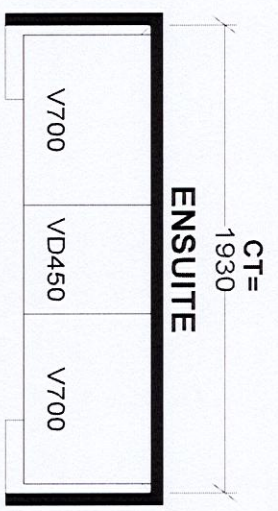
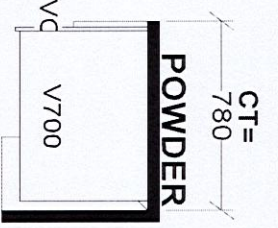
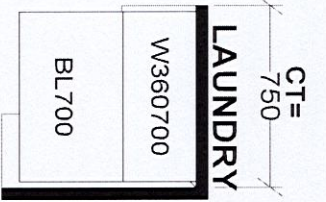
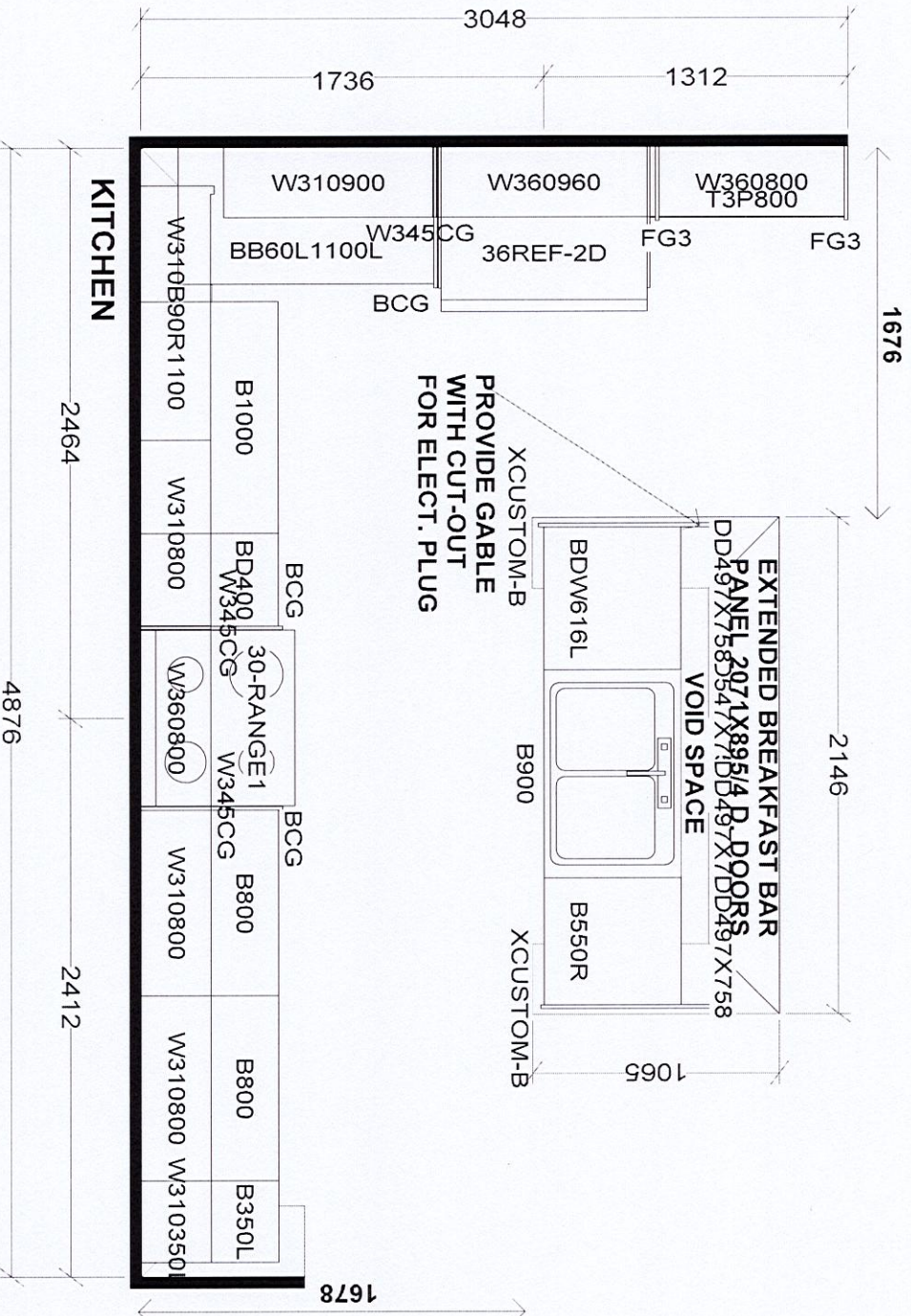

Selba Industries

W WIDTH _____ W HIGHT _____ W CNT _____

FLOOR HIGHT _____ DOOR HIGHT _____

ST CENT _____ 2X4 _____ VENT BOX COVER _____

DESIGNER: KS
DATE: JUNE 7 21

J# _____

Job Information:

- JOB NUMBER: _____
- BUILDER: GREENPARK
- SITE: ROUNDDEL, Richmond Hill
- MODEL: PINETREE 1X EL 12.3
- LOT #: LOT#119 Roundel

This drawing is the Intellectual property of SELBA INDUSTRIES INC. and is an original design which must not be released or copied unless applicable fee has been paid or job order placed.