

CONSTRUCTION SUMMARY - PARTIAL ONLY

Mountainview Heights 3 (G) - Russell Gardens Building Ltd.

RECEIVED

MAY 19 2023

PURCHASER: Angelo PALETTA

TEL:

LOT NUMBER	PHASE	HOUSE TYPE	REG. PLAN #		
593	4	Grandville Three Elev 3	62M-1266		

INV#	QTY	EXTRA / CHANGE	COMMENTS
------	-----	----------------	----------

CABINETRY

27,148 08Sep22	1 - CABINETRY PROVISION - PROVISION FOR PLUG ON ISLAND (PLUG EXTRA ORDERED SEPARATELY) AT EITHER SIDE OF ISLAND Note:
27,148 08Sep22	1 - CABINETRY - KITCHEN - UPGRADE 2 Note:
27,148 08Sep22	1 - VANITY - POWDER ROOM - UPGRADE 5 CABINETRY Note:
27,148 08Sep22	1 - VANITY - GUEST ENSUITE (GROUND FLOOR) - UPGRADE 5 CABINETRY Note:
27,148 08Sep22	1 - VANITY - ENSUITE - BEDROOM #5 - UPGRADE 5 CABINETRY Note:
27,148 08Sep22	1 - VANITY - SHARED ENSUITE - BEDROOM #3 & #4 - UPGRADE 5 CABINETRY Note:
27,148 08Sep22	1 - VANITY - ENSUITE BEDROOM #2 - UPGRADE 5 CABINETRY Note:
27,148 08Sep22	1 - VANITY - ENSUITE - UPGRADE 5 CABINETRY Note:
27,148 08Sep22	1 - PROVIDE 36" STOVE OPENING SHIFT STOVE OPENING TO ACCOMMODATE 42" B/I FRIDGE AND B/I OVEN/MICRO TOWER *IF REQUIRED Note:

CABINETRY ACCESSORIES

27,148 08Sep22	1 - KITCHEN - LIGHT VALENCE SHIELD Note:
27,148 08Sep22	1 - KITCHEN - ADD CROWN AND HEADER - CM11 Note:
27,148 08Sep22	1 - KITCHEN HOOD CABINETS -36" TRANSITIONAL WOOD HOOD (DHB) 800-1000 WIDE - UPGRADE 2 NoteBX600 34 CYCLONE INSERT - PRICED SEPARATELY.
27,148 08Sep22	1 - KITCHEN CABINETRY UPPER - FULL DEPTH ABOVE FRIDGE - WITH GABLES - 600MM - PRICE IS EACH - UPGRADE 2 Note:
27,148 08Sep22	1 - KITCHEN CABINETRY - BUILT-IN MICROWAVE/OVEN COMBO - UPGRADE 2 NEXT TO FRIDGE Note:

CONSTRUCTION SUMMARY - PARTIAL ONLY
Mountainview Heights 3 (G) - Russell Gardens Building Ltd.

PURCHASER: Angelo PALETTA TEL:

LOT NUMBER	PHASE	HOUSE TYPE	REG. PLAN #		
593	4	Grandville Three Elev 3	62M-1266		

INV#	QTY	EXTRA / CHANGE	CLIENTS
------	-----	----------------	---------

CABINETRY ACCESSORIES

27,148 08Sep22	1 - KITCHEN CABINETRY BASE - PULLOUT WIRE SPICE RACK NEXT TO STOVE OPENING Note:
27,148 08Sep22	1 - KITCHEN CABINETRY ACCESSORY - TRAY DIVIDER (MELAMINE) SINGLE DOOR CABINETS - PRICE IS EACH Note:
27,148 08Sep22	1 - KITCHEN CABINETRY BASE - PULLOUT RECYCLE 2 BIN - AT KITCHEN ISLAND (END CLOSEST TO KITCHEN SINK) Note:
27,148 08Sep22	1 - LAUNDRY - EXTENDED UPPERS (WALL TO WALL) ELISSE *** HEIGHT OF THE UPPERS TO BE 30 INCHES *** Note:INCLUDES QUARTZ COUNTERTOP WITH TECO 1022 UNDERMOUNT LAUNDRY SINK
27,148 08Sep22	1 - CABINETRY HARDWARE - UPGRADE 1 GUEST ENSUITE (GROUND FLOOR) Note:
27,148 08Sep22	1 - CABINETRY FEE FOR FLUSH CUTOUT ON WALL OVEN/MICROWAVE COMBO CABINET ONLY Note:
27,148 08Sep22	1 - KITCHEN CABINETRY - BUILT-IN FRIDGE CABINET Note:42 INCH FRIDGE - SEE SPECS ATTACHED



This Document is Extremely Time Sensitive - Printed 18 May 23 at 16:21

30" Built-In Microwave Oven

500 Series – Stainless Steel HMB50152UC

Lot 593
Russell



BOSCH
Invented for life



HMB50152UC
Stainless Steel

Built-in microwave design matched for use in combination with Bosch wall oven.

Features & Benefits

Large cooking interior gives you more flexibility in what types of dishes you can cook.

Built for speed and convenience with 950 watts of microwave cooking power.

Convenient automatic sensor programs simplify cooking for great results every time.

General Properties	
Cavity color	Stainless Steel
Max. microwave power	950 W
Capacity	
Cavity capacity	1.6 cu. ft.
Turntable diameter	14 1/8"
Technical Details	
Watts	1,650 W
Circuit breaker	15 A
Volts	120 V
Frequency	60 Hz
Power cord length	43"
Plug type	NEMA 5-15 3 prong plug



Dimensions & Weight	
Overall appliance dimensions (HxWxD)	19 5/8" x 29 3/4" x 19 5/8"
Required cutout size – Standard (HxWxD)	19 1/4" x 28 1/2" x 19 1/4"
Required cutout size – Flush (HxWxD)	20 1/4" x 30" x 20 3/4"
Oven overall interior dimensions (HxWxD)	9 7/8" x 16 1/2" x 16 1/2"
Net weight	75 lbs
Accessories—Included	
Included	Glass turntable

Accessories: To purchase Bosch accessories, cleaners & parts please visit www.bosch-home.com/us/store or call 1-800-944-2904 (Mon to Fri 5 am to 6 pm PST, Sat 6 am to 3 pm PST).

Notes: All height, width and depth dimensions are shown in inches. BSH reserves the absolute and unrestricted right to change product materials and specifications, at any time, without notice. Consult the product's installation instructions for final dimensional data and other details prior to making cutout.

Warranties: Please see Use & Care manual or Bosch website for statement of limited warranty.

For more information on our entire line of products, go to www.bosch-home.com/us or call 1-800-944-2904

© BSH Home Appliances Corporation. All rights reserved. Bosch is a registered trademark of Robert Bosch GmbH.

30" Built-In Microwave Oven

500 Series – Stainless Steel HMB50152UC

Lot 593
Russell



BOSCH
Invented for life

Installation Details

Under-counter Installation

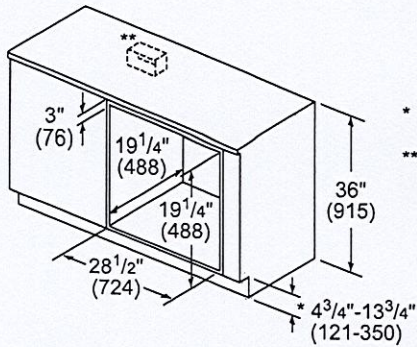

* Includes 3/4" (19) base plate

** Receptacle may be located to the left or right of the unit within reach of the power cable.

measurements in inches (mm)

Flush Installation

Top view

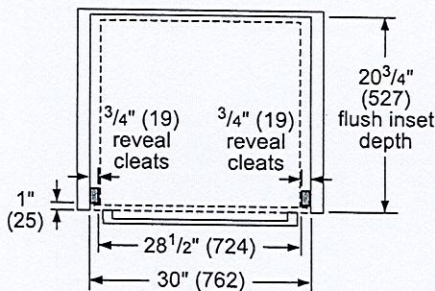

Side view

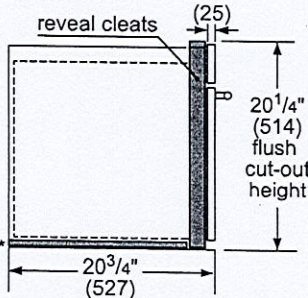

* Flush installation requires a 5/16" (8 mm) high x 28 1/2" (724 mm) wide x 19 3/4" (500 mm) deep base plate underneath the unit body.

measurements in inches (mm)

Flush Installation Over Single Oven

Side View

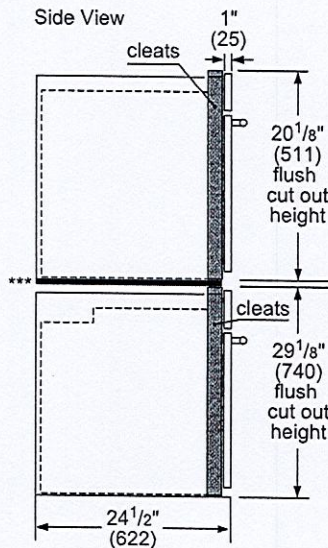

Speed Oven or Microwave

*** Flush installation requires a base plate underneath the body: 30" Products – Dimensions:
H 5/16" (8) x W 28 1/2" (724) x D 22 1/2" (571)

Wall Oven

*IMPORTANT: Base has to be able to support oven weight. Please check oven manual for minimum weight requirements.

**Most combinations available as combo oven (one cut out, one electrical hook up).

measurements in inches (mm)

Accessories: To purchase Bosch accessories, cleaners & parts please visit www.bosch-home.com/us/store or call 1-800-944-2904 (Mon to Fri 5 am to 6 pm PST, Sat 6 am to 3 pm PST).
Notes: All height, width and depth dimensions are shown in inches. BSH reserves the absolute and unrestricted right to change product materials and specifications, at any time, without notice. Consult the product's installation instructions for final dimensional data and other details prior to making cutout.

Warranties: Please see Use & Care manual or Bosch website for statement of limited warranty.

For more information on our entire line of products, go to www.bosch-home.com/us or call 1-800-944-2904

© BSH Home Appliances Corporation. All rights reserved. Bosch is a registered trademark of Robert Bosch GmbH.

30" Built-In Microwave Oven

500 Series – Stainless Steel HMB50152UC

Lot 593

Russell

BOSCH
Invented for life

Installation Details

Flush Installation Over Single Oven with Side-Swing Door

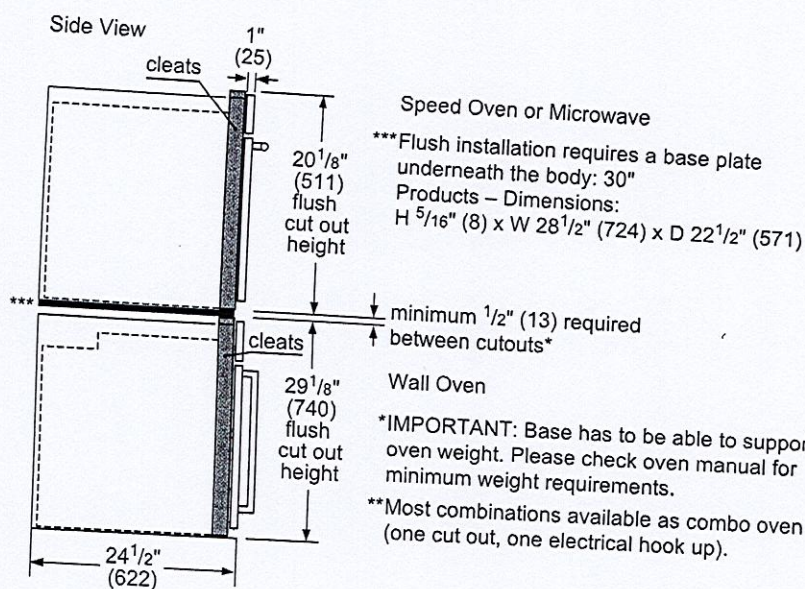

measurements in inches (mm)

Accessories: To purchase Bosch accessories, cleaners & parts please visit www.bosch-home.com/us/store or call 1-800-944-2904 (Mon to Fri 5 am to 6 pm PST, Sat 6 am to 3 pm PST).

Notes: All height, width and depth dimensions are shown in inches. BSH reserves the absolute and unrestricted right to change product materials and specifications, at any time, without notice. Consult the product's installation instructions for final dimensional data and other details prior to making cutout.

Warranties: Please see Use & Care manual or Bosch website for statement of limited warranty.

For more information on our entire line of products, go to www.bosch-home.com/us or call 1-800-944-2904

BSH Home Appliances Corporation. All rights reserved. Bosch is a registered trademark of Robert Bosch GmbH.