

CONSTRUCTION SUMMARY - PARTIAL ONLY

Mountainview Heights 3 (G) - Russell Gardens Building Ltd.

RECEIVED

MAY 19 2023

PURCHASER: Angelo PALETTA

TEL:

LOT NUMBER	PHASE	HOUSE TYPE	REG. PLAN #		
592	4	Grandville Nine Elev 2	62M-1266		

INV#	QTY	EXTRA / CHANGE	COMMENTS
------	-----	----------------	----------

CABINETRY

27,413 07Jul22	1 - CABINETRY PROVISION - PROVISION FOR PLUG ON ISLAND (PLUG EXTRA ORDERED SEPARATELY) Note:
27,398 08Sep22	1 - PROVIDE 36 INCH STOVE OPENING Note:
27,154 20Jun22	1 - CABINETRY - KITCHEN - UPGRADE 5 Note:
27,154 20Jun22	1 - VANITY - ENSUITE - UPGRADE 2 Note:
27,154 20Jun22	1 - VANITY - POWDER ROOM - UPGRADE 5 Note:
27,154 20Jun22	1 - LAUNDRY ROOM- EXTENDED CABINET TO WALL- UPPERS AND BASE- ELISSE with quart countertop Note: INCLUDES TECO 1022 UNDERMOUNT SINK
27,154 20Jun22	1 - KITCHEN- ADD CROWN AND HEADER- Note: CM11
27,154 20Jun22	1 - KITCHEN- ADD LIGHT VALANCE Note:

CABINETRY ACCESSORIES

27,398 08Sep22	1 - DELETE KITCHEN CABINETRY BASE - COOKTOP CABINET WITH POT DRAWERS (2 DRAWERS) Note: Purchaser to install freestanding stove.
27,398 08Sep22	1 - CABINETRY FEE FOR FLUSH CUTOUT ON WALL OVEN/MICROWAVE COMBO CABINET ONLY Note:
27,398 08Sep22	1 - KITCHEN CABINETRY - BUILT-IN FRIDGE CABINET Note: 42 INCH FRIDGE - SEE SPECS ATTACHED 42 INCH - SEE ATTACHED SPECS
27,154 20Jun22	1 - KITCHEN CABINETRY BASE - COOKTOP CABINET WITH POT DRAWERS (2 DRAWERS) UPGRADE 5 Note:
27,154 20Jun22	1 - KITCHEN CABINETRY - BUILT-IN MICROWAVE/OVEN COMBO - UPGRADE 5 Note: NEXT TO FRIDGE
27,154 20Jun22	1 - KITCHEN CABINETRY BASE - PULLOUT WIRE SPICE RACK - PRICE IS EACH Note:
27,154 20Jun22	1 - KITCHEN CABINETRY ACCESSORY - TRAY DIVIDER (MELAMINE) SINGLE DOOR CABINETS - PRICE IS EACH Note:
27,154 20Jun22	1 - KITCHEN HOOD CABINETS - TRANSITIONAL WOOD HOOD (DHB) 800-1000 WIDE - UPGRADE 5 Note: 36 INCH WIDTH / BX60034 CYCLONE INSERT TO BE INSTALLED

Selba, ORION, Cors
Builtin
Devised Micro
Specs
- FLUSH



30" Built-In Microwave Oven

500 Series – Stainless Steel HMB50152UC

Lot 592
Russell



BOSCH
Invented for life

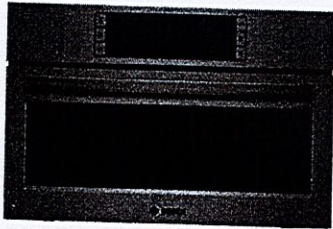

HMB50152UC
Stainless Steel

Built-in microwave design
matched for use in
combination with Bosch
wall oven.

Features & Benefits

Large cooking interior
gives you more flexibility in
what types of dishes you
can cook.

Built for speed and
convenience with 950
watts of microwave
cooking power.

Convenient automatic
sensor programs simplify
cooking for great results
every time.

General Properties	
Cavity color	Stainless Steel
Max. microwave power	950 W
Capacity	
Cavity capacity	1.6 cu. ft.
Turntable diameter	14 1/8"
Technical Details	
Watts	1,650 W
Circuit breaker	15 A
Volts	120 V
Frequency	60 Hz
Power cord length	43"
Plug type	NEMA 5-15 – 3 prong plug



Dimensions & Weight	
Overall appliance dimensions (HxWxD)	19 5/8" x 29 3/4" x 19 5/8"
Required cutout size – Standard (HxWxD)	19 1/4" x 28 1/2" x 19 1/4"
Required cutout size – Flush (HxWxD)	20 1/4" x 30" x 20 3/4"
Oven overall interior dimensions (HxWxD)	9 7/8" x 16 1/2" x 16 1/2"
Net weight	75 lbs
Accessories—Included	
Included	Glass turntable

Accessories: To purchase Bosch accessories, cleaners & parts please visit www.bosch-home.com/us/store or call 1-800-944-2904 (Mon to Fri 5 am to 6 pm PST, Sat 6 am to 3 pm PST).

Notes: All height, width and depth dimensions are shown in inches. BSH reserves the absolute and unrestricted right to change product materials and specifications, at any time, without notice. Consult the product's installation instructions for final dimensional data and other details prior to making cutout.

Warranties: Please see Use & Care manual or Bosch website for statement of limited warranty.

For more information on our entire line of products, go to www.bosch-home.com/us or call 1-800-944-2904

© BSH Home Appliances Corporation. All rights reserved. Bosch is a registered trademark of Robert Bosch GmbH.

30" Built-In Microwave Oven

500 Series – Stainless Steel HMB50152UC

Lot 592

Russell



BOSCH

Invented for life

Installation Details

Under-counter Installation

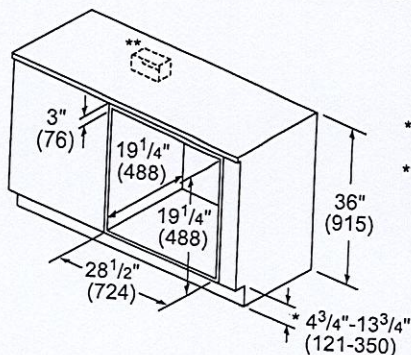

* Includes 3/4" (19) base plate

** Receptacle may be located to the left or right of the unit within reach of the power cable.

measurements in inches (mm)

Flush Installation

Top view

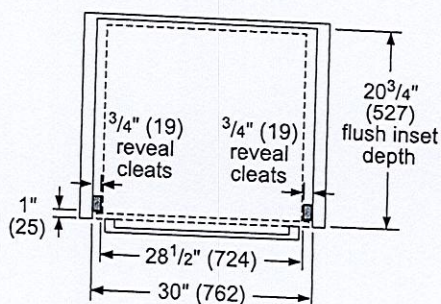

Side view

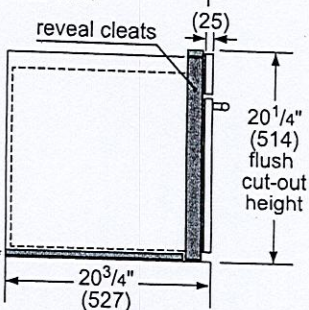

* Flush installation requires a 5/16" (8 mm) high x 28 1/2" (724 mm) wide x 19 3/4" (500 mm) deep base plate underneath the unit body.

measurements in inches (mm)

Flush Installation Over Single Oven

Side View

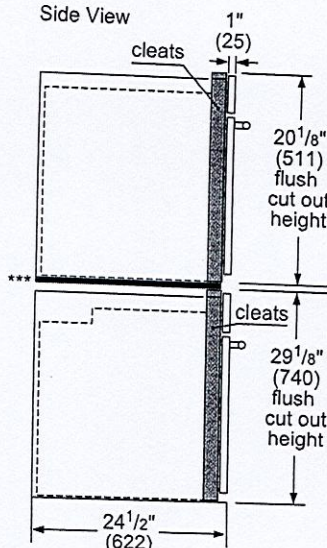

Speed Oven or Microwave

*** Flush installation requires a base plate underneath the body: 30" Products – Dimensions: H 5/16" (8) x W 28 1/2" (724) x D 22 1/2" (571)

minimum 1/2" (13) required between cutouts*

Wall Oven

*IMPORTANT: Base has to be able to support oven weight. Please check oven manual for minimum weight requirements.

**Most combinations available as combo oven (one cut out, one electrical hook up).

measurements in inches (mm)

Accessories: To purchase Bosch accessories, cleaners & parts please visit www.bosch-home.com/us/store or call 1-800-944-2904 (Mon to Fri 5 am to 6 pm PST, Sat 6 am to 3 pm PST).
Notes: All height, width and depth dimensions are shown in inches. BSH reserves the absolute and unrestricted right to change product materials and specifications, at any time, without notice. Consult the product's installation instructions for final dimensional data and other details prior to making cutout.

Warranties: Please see Use & Care manual or Bosch website for statement of limited warranty.

For more information on our entire line of products, go to www.bosch-home.com/us or call 1-800-944-2904

© BSH Home Appliances Corporation. All rights reserved. Bosch is a registered trademark of Robert Bosch GmbH.

30" Built-In Microwave Oven

500 Series – Stainless Steel HMB50152UC

Lot 592
Russell



BOSCH
Invented for life

Installation Details

Flush Installation Over Single Oven with Side-Swing Door

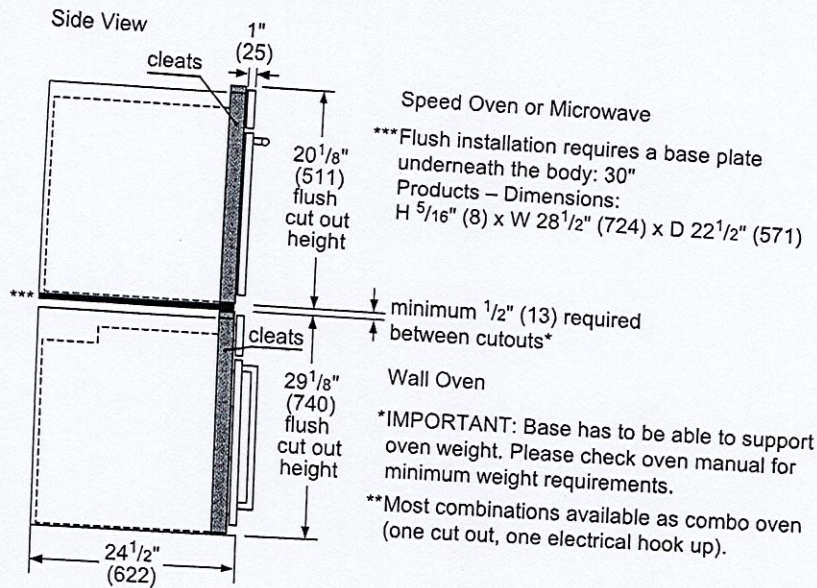

measurements in inches (mm)

Accessories: To purchase Bosch accessories, cleaners & parts please visit www.bosch-home.com/us/store or call 1-800-944-2904 (Mon to Fri 5 am to 6 pm PST, Sat 6 am to 3 pm PST).

Notes: All height, width and depth dimensions are shown in inches. BSH reserves the absolute and unrestricted right to change product materials and specifications, at any time, without notice. Consult the product's installation instructions for final dimensional data and other details prior to making cutout.

Warranties: Please see Use & Care manual or Bosch website for statement of limited warranty.

For more information on our entire line of products, go to www.bosch-home.com/us or call 1-800-944-2904

BSH Home Appliances Corporation. All rights reserved. Bosch is a registered trademark of Robert Bosch GmbH.