

CONSTRUCTION SUMMARY

RECEIVED

Red Oaks - Roundel Homes Inc.

AUG 11 2023

PURCHASER: Chen MA

TEL: RES.: 647-871-2886

LOT / PHASE 60 / 2	REG. PLAN # 65M-4737	HOUSE TYPE Pinetree 1 Elev 2		
-----------------------	-------------------------	---------------------------------	--	--

CERAMIC TILE

1 - DELETE ALL CERAMIC BATHROOM ACCESSORIES - DELETE TOWEL BAR, PAPER HOLDER & SOAP DISH THROUGHOUT 09Aug23 Note:	
--	--

HARDWOOD FLOORING

1 - HARDWOOD - GROUP B SERIES 5 INCH - IN LIEU OF 3 1/4 INCH NATURAL RED OAK - - FIRST FLOOR IN STANDARD HARDWOOD AREAS 09Aug23 Note:	
--	--

PLUMBING

1 - TOE TESTER - ADD TOE TESTER TO SHOWER 27Apr23 Note: MASTER ENSUITE	
---	--

PROMOTIONAL

1 - LESS BALANCE OF CREDIT FROM PURCHASER EXTRA SHEET IN OFFER 09Aug23 Note:	
1 - PARTIAL REDEMPTION OF PROMOTIONAL PACKAGE \$205.00. BALANCE FORWARD TO BE USED AT A LATER DATE \$9,795.00 ORIGINAL PROMOTIONAL PACKAGE OF \$10,000.00 AS PER SCHEDULE PE. 27Apr23 Note:	

STAIRS AND RAILINGS

1 - EUROLINE 0 BLACK PICKETS 09Aug23 Note:	
1 - STAINED STAIRS – STANDARD STAIRCASE - PRICE IS PER SET 09Aug23 Note:	

EXTRAS AS PER OFFER

The Vendor agrees that notwithstanding any other term or provision in this Agreement included in the Purchase Price and in addition to those items detailed in Schedule GP to the Agreement of Purchase and Sale, the Purchaser is entitled to a credit of Ten Worksheet Note:	
10 foot ceiling height on Main Floor. The Purchaser acknowledges that as a result of the increased ceiling height from the Vendor?s standard ceiling height, various modifications to the interior and exterior of the dwelling unit may be made, including Worksheet Note:	
Gas fireplace to project into Family Room due to lot conditions, as per attached Purchaser Alteration Form dated February 15, 2023. Worksheet Note:	

This Document is Extremely Time Sensitive - Printed 9 Aug 23 at 11:48

Purchaser:Chen MA

Telephone Res. / Bus: (647) 871-2886 /

Decor Advisor:Giulia Di Girolamo

Lock Date:9-Aug-23

Property: 60

Project: Roundel Homes Inc.

Model and Elevation: Pinetree 1 Elev 2

9-Aug-23

Plan #: 65M-4737

1. Cabinetry

	Style and Colour	Hardware
Kitchen / Breakfast	DORAL WHITE W500	464SA
Laundry Room	ELISSE	Standard
Powder Room	DORAL WHITE W500	464SA
Master Ensuite Bathroom	DORAL WHITE W500	464SA
Ensuite Bath - Bedroom 2	DORAL WHITE W500	464SA
Ensuite Bath - Bedroom 3/4	DORAL WHITE W500	464SA
Stove Opening	STANDARD	NOTE: If not specified, opening will be set to builder's standard opening of approximately 30" width
Fridge Opening	STANDARD	NOTE: If not specified, opening will be set to builder's standard opening of approximately 37" width x 74" height

** Refer to Construction Summary

2. Counters

	Counter	Edge	Niche
Kitchen / Breakfast	GRANITE-NERO IMPALA	#360 EDGE	
Laundry Room	N/A		
Powder Room	LAMINATE-PORTICO MARBLE 7735-58		
Master Ensuite Bathroom	LAMINATE-PORTICO MARBLE 7735-58		
Ensuite Bath - Bedroom 2	LAMINATE-PORTICO MARBLE 7735-58		
Ensuite Bath - Bedroom 3/4	LAMINATE-PORTICO MARBLE 7735-58		
Kitchen Backsplash	N/A		

** Refer to Construction Summary

Initial: 

Purchaser:Chen MA

Telephone Res. / Bus: (647) 871-2886 /

Decor Advisor:Giulia Di Girolamo

Lock Date:9-Aug-23

Property: 60

Project: Roundel Homes Inc.

Model and Elevation: Pinetree 1 Elev 2

Plan #: 65M-4737

3. Ceramic Flooring

At a 45

Entrance Vestibule	TILE-FRIGIA WHITE 13X13	<input type="checkbox"/>
Main Hall	HARDWOOD	<input type="checkbox"/>
Kitchen / Breakfast	TILE-FRIGIA WHITE 13X13	<input type="checkbox"/>
Laundry Room	TILE-FRIGIA WHITE 13X13	<input type="checkbox"/>
Powder Room	TILE-FRIGIA WHITE 13X13	<input type="checkbox"/>
Master Ensuite Bathroom	TILE-FRIGIA WHITE 13X13	<input type="checkbox"/>
Ensuite Bath - Bedroom 2	TILE-FRIGIA WHITE 13X13	<input type="checkbox"/>
Ensuite Bath - Bedroom 3/4	TILE-FRIGIA WHITE 13X13	<input type="checkbox"/>
		<input type="checkbox"/>
		<input type="checkbox"/>
		<input type="checkbox"/>

** Refer to Construction Summary

4. Ceramic Wall Tile

Master Ensuite Bathroom	Selection	Describe
Tub Deck Wall	N/A	
Shower Stall	TILE-FOX GREY 8X16	
Bathtub Enclosure Walls	N/A	
Ensuite Bath - Bedroom 2	TILE-CONCEPT PLUS (011) DARK GREY 8X16	
Ensuite Bath - Bedroom 3/4	TILE-EXTRA LIGHT GREY (723) 8X16	
Kitchen Backsplash	N/A	

** Refer to Construction Summary - STANDARD GROUT THROUGHOUT UNLESS SPECIFIED

5. Trim Carpentry

Interior Doors	CARRARA-SMOOTH
Interior Trim	As Per Construction Specifications

** Refer to Construction Summary

6. Plaster Mouldings and Medallions

Entrance Vestibule			Kitchen/Breakfast		
Main Hall			Den/Library		
Living Room			Lower Landing		
Dining Room					
Family Room					

** Refer to Construction Summary



Purchaser:	Chen MA	Property:	60
Telephone Res. / Bus:	(647) 871-2886 /	Project:	Roundel Homes Inc.
Decor Advisor:	Giulia Di Girolamo	Model and Elevation:	Pinetree 1 Elev 2
Lock Date:	9-Aug-23	9-Aug-23	Plan #: 65M-4737

7. Other Flooring

Main Hall	HARDWOOD-IMAGINE COLLECTION-RED OAK CHARACTER-5" CORK-DRIFTWOOD-DURAMATT
Living Room	N/A
Dining Room	HARDWOOD-IMAGINE COLLECTION-RED OAK CHARACTER-5" CORK-DRIFTWOOD-DURAMATT
Family Room	HARDWOOD-IMAGINE COLLECTION-RED OAK CHARACTER-5" CORK-DRIFTWOOD-DURAMATT
Den / Library / Study	N/A
Basement Landing(If Applies)	N/A
Lower Landing (If Applies)	N/A
Upper Landing	HARDWOOD-IMAGINE COLLECTION-RED OAK CHARACTER-5" CORK-DRIFTWOOD-DURAMATT
Upper Hall	LAMINATE-LEXINGTON-ROCHEFORT OAK-TL-LW1317
Master Bedroom	LAMINATE-LEXINGTON-ROCHEFORT OAK-TL-LW1317
Bedroom #2	LAMINATE-LEXINGTON-ROCHEFORT OAK-TL-LW1317
Bedroom #3	LAMINATE-LEXINGTON-ROCHEFORT OAK-TL-LW1317
Bedroom #4	LAMINATE-LEXINGTON-ROCHEFORT OAK-TL-LW1317
Bedroom #5	N/A
Underpad	Standard <input type="checkbox"/> Upgrade <input type="checkbox"/> N/A

** Refer to Construction Summary

8. Railings and Pickets

Railing Type	AS PER CONSTRUCTION SPECIFICATIONS	Colour	MIRAGE-RED OAK-DRIFTWOOD
Picket Type	EUROLINE 0	Colour	BLACK
Stringer / Riser	AS PER CONSTRUCTION SPECIFICATIONS	Colour	MIRAGE-RED OAK-DRIFTWOOD
Treads	AS PER CONSTRUCTION SPECIFICATIONS	Colour	MIRAGE-RED OAK-DRIFTWOOD
Red Oak Stairs as Per Vendor's Standard			

** Refer to Construction Summary THE STAIN COLOURS OR FINISH AVAILABLE ON RISERS, TREADS, PICKETS AND RAILS (STAIRCASES), WILL NOT BE AN EXACT MATCH TO PREFINISHED HARDWOOD OR LAMINATE FLOORS.

9. Wall Paint Flat Finish

Main & Upper Hall	22 WARM GREY	Master Bedroom	22 WARM GREY
Living Room	N/A	Bedroom #2	22 WARM GREY
Dining Room	22 WARM GREY	Bedroom #3	22 WARM GREY
Kitchen / Breakfast	22 WARM GREY	Bedroom #4	22 WARM GREY
Family Room	22 WARM GREY	Bedroom #5	N/A
Powder Room	22 WARM GREY	Master Ensuite	22 WARM GREY
Laundry Room	22 WARM GREY	Ensuite Bath - Bedroom 2	22 WARM GREY
Den/Library	N/A	Ensuite Bath - Bedroom 3/4	22 WARM GREY
Trim & Door Paint-Semi Gloss	BIRCH WHITE		

** Refer to Construction Summary



Initial: _____

Purchaser:Chen MA

Telephone Res. / Bus: (647) 871-2886 /

Decor Advisor:Giulia Di Girolamo

Lock Date:9-Aug-23

Property: 60

Project: Roundel Homes Inc.

Model and Elevation: Pinetree 1 Elev 2

9-Aug-23

Plan #: 65M-4737

10. Fireplace

	Living Room			Family Room			Other Room - Specify		
	Purchased	As Per Plan	N/A	Purchased	As Per Plan	N/A	Purchased	As Per Plan	N/A
Fireplace Type	<input type="radio"/>	<input type="radio"/>	<input checked="" type="radio"/>	<input type="radio"/>	<input checked="" type="radio"/>	<input type="radio"/>	<input type="radio"/>	<input type="radio"/>	<input checked="" type="radio"/>
Mantle Type				As Per Construction Specifications					
Colour / Stain				MANTLE M2-STANDARD					
Surround				BIRCH WHITE					
Hearth				GRIGIO CARNICO					
				NO					
** Refer to Construction Summary									

11. Air Conditioning

Air Conditioning

NO

Comment

** Refer to Construction Summary

12. General Comments

** Refer to Construction Summary

Disclaimers and Notes

1) Colours of all materials are as close as possible to builder's selection, but not necessarily identical due to variances in manufacturing.



2) Any extras listed above are null and void unless accompanied by a separate invoice/amendment. Said invoice must be paid in full.

3) The Purchaser agrees that this colour selection is final and that no changes will be permitted, unless required by the Vendor.

4) The Purchaser acknowledges reading and accepting document which contains other miscellaneous disclaimers.

5) In the event of a conflict between the Standard Features schedule of the Agreement of Purchase and Sale and the Interior Colour Scheme, the Interior Colour Scheme shall prevail.

Signature:



Date: Aug 09, 2023

Pinetree 1

[illegible][illegible][illegible]

Orientation of home may be reversed and purchaser agrees to accept the same. Steps and porches may vary at any exterior entrance ways due to grading variance. Actual usable floor space may vary from the stated floor areas. All renderings are artist's concept. Dimensions, specifications and architectural detailing subject to modifications. Roofline and adjoining model types may vary due to siting. E. & O. E. March 2023

LOT#60

* No upgrades *

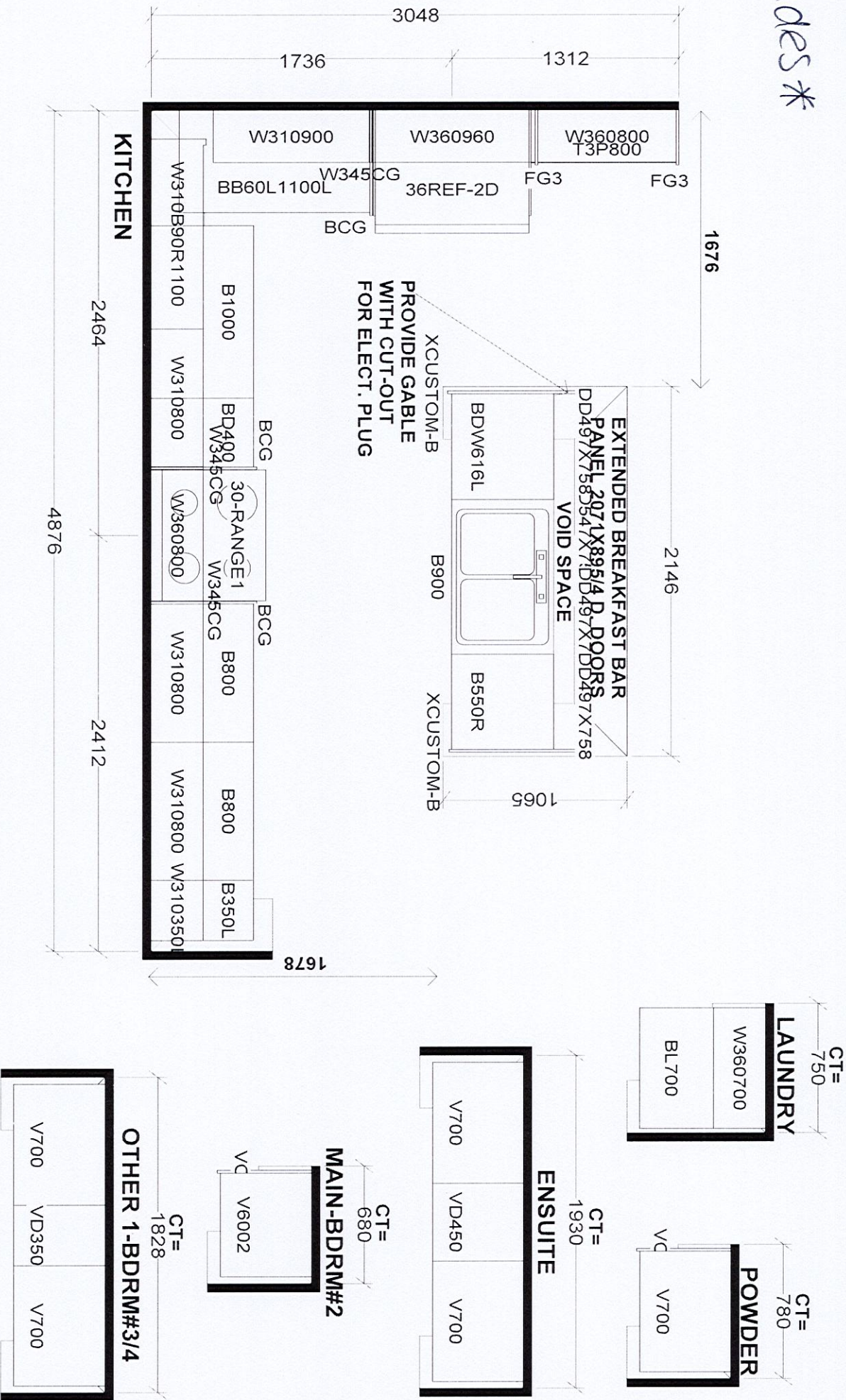

Selba Industries			
W WDT H	W HGHT	W CNT	This drawing is the intellectual property of SELBA INDUSTRIES INC. and is an original design which must not be released or copied unless applicable fee has been paid or job order placed.
FLOOR HGHT	DOOR HGHT		
ST CENT	2X4	VENT BOX COVER	DESIGNER: KS DATE: JUNE 7 21
			JOB NUMBER: BULDER: GREENPARK SITE: ROUNDEL, Richmond Hill MODEL: PINETREE 1X EL 2, 2, 2 LOT #: