

CONSTRUCTION SUMMARY				
Red Oaks - Roundel Homes Inc.				
PURCHASERS: Yu Rong YOU and Guang Hui PAN			TEL: RES.: 647-891-3268	
LOT / PHASE	REG. PLAN #	HOUSE TYPE		
63 / 2	65M-4737	Pinetree 2 Elev 3		

CABINETRY

1 - SHIFT FRIDGE TO ACCOMMODATE B/I TOWER - SEE SKETCH 29Aug23 Note:	
1 - KITCHEN - DELETE CABINETS ABOVE STOVE AND HOOD FAN - VENDOR WILL SUPPLY 6 INCH VENT AS PER CONSTRUCTION SPECIFICATIONS AND VENT MAY NOT BE IN THE APPROPRIATE LOCATION FOR INSTALLATION OF PURCHASER SUPPLIED FAN 29Aug23 Note: PURCHASER TO SUPPLY AND INSTALL OWN FAN AFTER CLOSING	
1 - VANITY - SHARED ENSUITE 2/3 - RAISE VANITY TO 36" HIGH VANITY IN LIEU OF STANDARD HEIGHT 29Aug23 Note:	
1 - VANITY - PRIMARY ENSUITE - RAISE VANITY TO 36" HIGH VANITY IN LIEU OF STANDARD HEIGHT 29Aug23 Note:	
1 - VANITY - POWDER ROOM - RAISE VANITY TO 36" HIGH VANITY IN LIEU OF STANDARD HEIGHT 29Aug23 Note:	
1 - VANITY - ENSUITE 4 - RAISE VANITY TO 36" HIGH VANITY IN LIEU OF STANDARD HEIGHT 29Aug23 Note:	

CABINETRY ACCESSORIES

1 - KITCHEN CABINETRY UPPER - FULL DEPTH ABOVE FRIDGE - WITH GABLES - 650 DEEP - PRICE IS EACH 29Aug23 Note:	
1 - KITCHEN CABINETRY BASE - POT/PAN DRAWERS (CABINET) - STANDARD LEVEL 29Aug23 Note: SEE SKETCH	
1 - KITCHEN CABINETRY BASE - PULLOUT WIRE SPICE RACK - PRICE IS EACH 29Aug23 Note: NEXT TO STOVE - SEE SKETCH	
1 - KITCHEN CABINETRY BASE - PULLOUT RECYCLE 2 BIN - PRICE IS EACH 29Aug23 Note: NEXT TO KITCHEN SINK - SEE SKETCH	
1 - KITCHEN CABINETRY - TALL BUILT-IN MICROWAVE/OVEN COMBO - STANDARD LEVEL 29Aug23 Note:	
1 - KITCHEN CABINETRY BASE - COOKTOP CABINET WITH POT DRAWERS (2 DRAWERS) - STANDARD LEVEL 29Aug23 Note:	
1 - CABINETRY FEE FOR FLUSH CUTOUT ON WALL OVEN/MICROWAVE COMBO CABINET ONLY 29Aug23 Note:	

CONSTRUCTION

3 - PROVISION FOR SHAMPOO NICHE APPROX. 14" WIDE X 20" HIGH AS PER SKETCH -- IF CONSTRUCTION PERMITS 26Apr23 Note: MASTER ENSUITE ENSUITE 2/3 ENSUITE 4	
1 - SMOOTH CEILINGS ON FIRST FLOOR 26Apr23 Note:	

COUNTER TOP

RECEIVED  
AUG 31 2023

CONSTRUCTION SUMMARY				
Red Oaks - Roundel Homes Inc.				
PURCHASERS: Yu Rong YOU and Guang Hui PAN			TEL: RES.: 647-891-3268	
LOT / PHASE	REG. PLAN #	HOUSE TYPE		
63 / 2	65M-4737	Pinetree 2 Elev 3		
1 - KITCHEN - EXTRA AREA FOR QUARTZ BACKSPLASH - EXTRA AREA BEHIND CHIMNEY HOOD FAN TO CEILING - FOR 10 FOOT CEILING 29Aug23 Note:				
1 - UPGRADE STONE COUNTER TOP MATERIAL - KITCHEN BACKSPLASH 29Aug23 Note:				
1 - UPGRADE STONE COUNTER TOP - KITCHEN - IN LIEU OF STANDARD MATERIAL 29Aug23 Note:				
4 - VANITY - 3" BACKSPLASH RETURN 29Aug23 Note: ALL BATHROOM VANITIES				
1 - UPGRADE STONE COUNTER TOP VANITY - SHARED ENSUITE 2/3 29Aug23 Note:				
1 - UPGRADE STONE COUNTER TOP VANITY - PRIMARY ENSUITE 29Aug23 Note:				
1 - UPGRADE STONE COUNTER TOP VANITY - POWDER ROOM 29Aug23 Note:				
1 - UPGRADE STONE COUNTER TOP VANITY - ENSUITE 4 29Aug23 Note:				
3 - SHAMPOO NICHE 14" WIDE X 20" HIGH AS PER SKETCH – MARBLE, GRANITE OR QUARTZ – IF CONSTRUCTION PERMITS - REQUIRES PROVISION FROM CONSTRUCTION  SUPPLY & INSTALL 26Apr23 Note: MASTER ENSUITE ENSUITE 2/3 ENSUITE 4				

ELECTRICAL

1 - BUILT IN OVEN AND COOKTOP PROVISION - PROVISION ONLY - ELECTRICAL ONLY 29Aug23 Note: SHIFT FRIDGE TO ACCOMMODATE B/I TOWER - SEE SKETCH	
2 - FAN - BATHROOM EXHAUST FAN - ENERGY STAR 80 CFM - IN LIEU OF STANDARD FAN 26Apr23 Note: POWDER ROOM ENSUITE 2/3	
1 - PLUG - ELECTRICAL PLUG - TO BE INSTALLED OVER FIREPLACE 26Apr23 Note:	
1 - ABOVE KITCHEN ISLAND - ADD LIGHT AND SWITCH - NO FIXTURE INCLUDED 26Apr23 Note:	
1 - ELECTRIC VEHICLE ROUGH-IN PROVISION ONLY FOR FUTURE ELECTRIC CAR (CONDUIT FROM BASEMENT INTO JUNCTION BOX IN GARAGE WITH PULL STRING, NO WIRE) 26Apr23 Note:	

FIREPLACE AND ACCESSORIES

1 - GAS LINE ROUGH-IN FOR STOVE (INCLUDES ELECTRICAL OUTLET) - FIRST FLOOR 26Apr23 Note:	
---	--

HARDWOOD FLOORING

CONSTRUCTION SUMMARY

Red Oaks - Roundel Homes Inc.

PURCHASERS: Yu Rong YOU and Guang Hui PAN

TEL: RES.: 647-891-3268

LOT / PHASE	REG. PLAN #	HOUSE TYPE		
63 / 2	65M-4737	Pinetree 2 Elev 3		
1 - HARDWOOD - GROUP C SERIES 5 INCH - - BEDROOM 4 29Aug23 Note:				
1 - HARDWOOD - GROUP C SERIES 5 INCH - - BEDROOM 3 29Aug23 Note:				
1 - HARDWOOD - GROUP C SERIES 5 INCH - - BEDROOM 2 29Aug23 Note:				
1 - HARDWOOD - GROUP C SERIES 5 INCH - - PRIMARY BEDROOM 29Aug23 Note:				
1 - HARDWOOD - GROUP C SERIES 5 INCH - - UPPER HALL 29Aug23 Note:				
1 - HARDWOOD - GROUP C SERIES 5 INCH - IN LIEU OF 3 1/4 INCH NATURAL RED OAK - - FIRST FLOOR IN STANDARD HARDWOOD AREAS 29Aug23 Note:				

HEATING AND AIR CONDITIONING

1 - HUMIDIFER 26Apr23 Note:	
--------------------------------	--

PLUMBING

6 - SINK - UNDERMOUNT SINK - CONTRAC EMERY #4220CGY 29Aug23 Note: ALL BATHROOM SINKS	
4 - TOILET - AVENU GLENCAIRN ONE PIECE TOILET #TL-1223HCA-EW 29Aug23 Note: ALL BATHROOMS	
1 - MOEN CHATEAU POSI-TEMP SHOWER ONLY WITH 3 FUNCTION TRANSFER VALVE/TRIM AND SLIDE BAR WITH HAND SHOWER – CHROME TL182EP/U361CI/UT2721/3669EP/A725/62320 26Apr23 Note: MASTER ENSUITE	
1 - HOSE BIB - EXTERIOR FROST FREE 26Apr23 Note: 1 @ REAR OF HOUSE	
1 - WATER LINE FOR FRIDGE - ROUGH-IN ONLY 26Apr23 Note:	
1 - TUB TO SHOWER CONVERSION - 5 FOOT SHOWER WITH SLIDING GLASS CHROME DOORS IN LIEU OF TUB 26Apr23 Note: ENSUITE 2/3	

PROMOTIONAL

1 - LESS CREDIT FROM PURCHASER EXTRA SHEET IN OFFER 26Apr23 Note:	
--	--

STAIRS AND RAILINGS

1 - STAINED STAIRS – STANDARD STAIRCASE - PRICE IS PER SET 29Aug23 Note:	
---	--

CONSTRUCTION SUMMARY

Red Oaks - Roundel Homes Inc.

PURCHASERS: Yu Rong YOU and Guang Hui PAN

TEL: RES.: 647-891-3268

LOT / PHASE 63 / 2	REG. PLAN # 65M-4737	HOUSE TYPE Pinetree 2 Elev 3		
-----------------------	-------------------------	---------------------------------	--	--

EXTRAS AS PER OFFER

The Vendor agrees that notwithstanding any other term or provision in this Agreement included in the Purchase Price and in addition to those items detailed in Schedule GP to the Agreement of Purchase and Sale, the Purchaser is entitled to a credit of Ten <i>Worksheet</i> Note:	
10 foot ceiling height on Main Floor. The Purchaser acknowledges that as a result of the increased ceiling height from the Vendor's standard ceiling height, various modifications to the interior and exterior of the dwelling unit may be made, including <i>Worksheet</i> Note:	
Gas fireplace to project into Family Room due to lot conditions, as per attached Purchaser Alteration Form, dated February 16, 2023. <i>Worksheet</i> Note:	

This Document is Extremely Time Sensitive - Printed 29 Aug 23 at 11:52

Purchasers:Yu Rong YOU & Guang Hui PAN

Property: 63

Telephone Res. / Bus: (647) 891-3268 /

Project: Roundel Homes Inc.

Decor Advisor: Giulia Di Girolamo

Model and Elevation: Pinetree 2 Elev 3

Lock Date: 29-Aug-23

29-Aug-23

Plan #: 65M-4737

1. Cabinetry

	Style and Colour	Hardware
Kitchen / Breakfast	DORAL -K43 SUMMIT WHITE	468SA
Laundry Room	ELISSE	Standard
Powder Room	DORAL-H3078 HACIENDA WHITE	224SA
Master Ensuite Bathroom	DORAL-H3078 HACIENDA WHITE	224SA
Ensuite Bath - Bedroom 2/3	DORAL-H3078 HACIENDA WHITE	224SA
Ensuite Bath - Bedroom 4	DORAL-H3078 HACIENDA WHITE	224SA
Stove Opening	36"-SEE SPECS	NOTE: If not specified, opening will be set to builder's standard opening of approximately 30" width
Fridge Opening	STANDARD	NOTE: If not specified, opening will be set to builder's standard opening of approximately 37" width x 74" height

\*\* Refer to Construction Summary

2. Counters

	Counter	Edge	Niche
Kitchen / Breakfast	QUARTZ-MISTRAL	#360 EDGE	
Laundry Room	N/A		
Powder Room	QUARTZ-VIRGINIA -3" RETURN	#360 EDGE	
Master Ensuite Bathroom	QUARTZ-VIRGINIA -3" RETURN	#360 EDGE	QUARTZ-VIRGINIA
Ensuite Bath - Bedroom 2/3	QUARTZ-VIRGINIA -3" RETURN	#360 EDGE	QUARTZ-VIRGINIA
Ensuite Bath - Bedroom 4	QUARTZ-VIRGINIA -3" RETURN	#360 EDGE	QUARTZ-VIRGINIA
Kitchen Backsplash	QUARTZ-MISTRAL - FULL HEIGHT		

\*\* Refer to Construction Summary

\*\*ADD 3" BACKSPLASH RETURN ON ALL BATHROOM VANITIES

Purchasers:Yu Rong YOU & Guang Hui PAN

Property: 63

Telephone Res. / Bus: (647) 891-3268 /

Project: Roundel Homes Inc.

Decor Advisor: Giulia Di Girolamo

Model and Elevation: Pinetree 2 Elev 3

Lock Date: 29-Aug-23

29-Aug-23

Plan #: 65M-4737

3. Ceramic Flooring

At a 45

Entrance Vestibule	TILE-CONCRETE BEIGE 13X13	<input type="checkbox"/>
Main Hall	HARDWOOD	<input type="checkbox"/>
Kitchen / Breakfast	TILE-CONCRETE BEIGE 13X13	<input type="checkbox"/>
Laundry Room	TILE-CONCRETE BEIGE 13X13	<input type="checkbox"/>
Powder Room	TILE-CONCRETE BEIGE 13X13	<input type="checkbox"/>
Master Ensuite Bathroom	TILE-CONCRETE BEIGE 13X13	<input type="checkbox"/>
Ensuite Bath - Bedroom 2/3	TILE-CONCRETE BEIGE 13X13	<input type="checkbox"/>
Ensuite Bath - Bedroom 4	TILE-CONCRETE BEIGE 13X13	<input type="checkbox"/>
Mud Room	TILE-CONCRETE BEIGE 13X13	<input type="checkbox"/>
		<input type="checkbox"/>
		<input type="checkbox"/>

\*\* Refer to Construction Summary

4. Ceramic Wall Tile

Master Ensuite Bathroom	Selection	Describe
Tub Deck Wall	N/A	
Shower Stall	TILE-MARMO GLOSSY (6038) 8X10	
Bathtub Enclosure Walls	N/A	
Ensuite Bath - Bedroom 2/3	TILE-MARMO GLOSSY (6038) 8X10	
Ensuite Bath - Bedroom 4	TILE-MARMO GLOSSY (6038) 8X10	
Mud Room	N/A	
Kitchen Backsplash	QUARTZ-MISTRAL - FULL HEIGHT	

\*\* Refer to Construction Summary - STANDARD GROUT THROUGHOUT UNLESS SPECIFIED

5. Trim Carpentry

Interior Doors	CARRARA-SMOOTH
Interior Trim	As Per Construction Specifications

\*\* Refer to Construction Summary

6. Plaster Mouldings and Medallions

Entrance Vestibule			Kitchen/Breakfast		
Main Hall			Den/Library		
Living Room			Lower Landing		
Dining Room					
Family Room					

\*\* Refer to Construction Summary

Purchasers:Yu Rong YOU & Guang Hui PAN

Property: 63

Telephone Res. / Bus: (647) 891-3268 /

Project: Roundel Homes Inc.

Decor Advisor: Giulia Di Girolamo

Model and Elevation: Pinetree 2 Elev 3

Lock Date: 29-Aug-23

29-Aug-23

Plan #: 65M-4737

7. Other Flooring

Main Hall	HARDWOOD-MIRAGE-FLAIR COLLECTION-WHITE MIST-WHITE OAK CHARACTER BRUSHED-5"-DURAMATT
Living Room	N/A
Dining Room	HARDWOOD-MIRAGE-FLAIR COLLECTION-WHITE MIST-WHITE OAK CHARACTER BRUSHED-5"-DURAMATT
Family Room	HARDWOOD-MIRAGE-FLAIR COLLECTION-WHITE MIST-WHITE OAK CHARACTER BRUSHED-5"-DURAMATT
Den / Library / Study	N/A
Basement Landing(If Applies)	N/A
Lower Landing (If Applies)	HARDWOOD-MIRAGE-FLAIR COLLECTION-WHITE MIST-WHITE OAK CHARACTER BRUSHED-5"-DURAMATT
Upper Landing	HARDWOOD-MIRAGE-FLAIR COLLECTION-WHITE MIST-WHITE OAK CHARACTER BRUSHED-5"-DURAMATT
Upper Hall	HARDWOOD-MIRAGE-FLAIR COLLECTION-WHITE MIST-WHITE OAK CHARACTER BRUSHED-5"-DURAMATT
Master Bedroom	HARDWOOD-MIRAGE-FLAIR COLLECTION-WHITE MIST-WHITE OAK CHARACTER BRUSHED-5"-DURAMATT
Bedroom #2	HARDWOOD-MIRAGE-FLAIR COLLECTION-WHITE MIST-WHITE OAK CHARACTER BRUSHED-5"-DURAMATT
Bedroom #3	HARDWOOD-MIRAGE-FLAIR COLLECTION-WHITE MIST-WHITE OAK CHARACTER BRUSHED-5"-DURAMATT
Bedroom #4	HARDWOOD-MIRAGE-FLAIR COLLECTION-WHITE MIST-WHITE OAK CHARACTER BRUSHED-5"-DURAMATT
Bedroom #5	N/A
Underpad	Standard <input type="checkbox"/> Upgrade <input type="checkbox"/> N/A

\*\* Refer to Construction Summary

8. Railings and Pickets

Railing Type	AS PER CONSTRUCTION SPECIFICATIONS	Colour	MIRAGE-WHITE OAK-WHITE MIST
Picket Type	AS PER CONSTRUCTION SPECIFICATIONS	Colour	MIRAGE-WHITE OAK-WHITE MIST
Stringer / Riser	AS PER CONSTRUCTION SPECIFICATIONS	Colour	MIRAGE-WHITE OAK-WHITE MIST
Treads	AS PER CONSTRUCTION SPECIFICATIONS	Colour	MIRAGE-WHITE OAK-WHITE MIST
Red Oak Stairs as Per Vendor's Standard			

\*\* Refer to Construction Summary THE STAIN COLOURS OR FINISH AVAILABLE ON RISERS, TREADS, PICKETS AND RAILS (STAIRCASES), WILL NOT BE AN EXACT MATCH TO PREFINISHED HARDWOOD OR LAMINATE FLOORS.

9. Wall Paint Flat Finish

Main & Upper Hall	25 OYSTER	Master Bedroom	25 OYSTER
Living Room	N/A	Bedroom #2	25 OYSTER
Dining Room	25 OYSTER	Bedroom #3	25 OYSTER
Kitchen / Breakfast	25 OYSTER	Bedroom #4	25 OYSTER
Family Room	25 OYSTER	Bedroom #5	N/A
Powder Room	25 OYSTER	Master Ensuite	25 OYSTER
Laundry Room	25 OYSTER	Ensuite Bath - Bedroom 2/3	25 OYSTER
Den/Library	N/A	Ensuite Bath - Bedroom 4	25 OYSTER
Trim & Door Paint-Semi Gloss	BIRCH WHITE	Mud Room	25 OYSTER

\*\* Refer to Construction Summary

Purchasers:Yu Rong YOU & Guang Hui PAN

Property: 63

Telephone Res. / Bus: (647) 891-3268 /

Project: Roundel Homes Inc.

Decor Advisor: Giulia Di Girolamo

Model and Elevation: Pinetree 2 Elev 3

Lock Date: 29-Aug-23

29-Aug-23

Plan #: 65M-4737

10. Fireplace

	Living Room			Family Room			Other Room - Specify		
	Purchased	As Per Plan	N/A	Purchased	As Per Plan	N/A	Purchased	As Per Plan	N/A
	<input type="radio"/>	<input type="radio"/>	<input checked="" type="radio"/>	<input type="radio"/>	<input checked="" type="radio"/>	<input type="radio"/>	<input type="radio"/>	<input type="radio"/>	<input checked="" type="radio"/>
Fireplace Type				As Per Construction Specifications					
Mantle Type				MANTLE M2-STANDARD					
Colour / Stain				BIRCH WHITE					
Surround				BIANCO					
Hearth				NO					
** Refer to Construction Summary									

11. Air Conditioning

Air Conditioning

NO

Comment

\*\* Refer to Construction Summary

12. General Comments

\*\* Refer to Construction Summary

Disclaimers and Notes

1) Colours of all materials are as close as possible to builder's selection, but not necessarily identical due to variances in manufacturing.

2) Any extras listed above are null and void unless accompanied by a separate invoice/amendment. Said invoice must be paid in full.

3) The Purchaser agrees that this colour selection is final and that no changes will be permitted, unless required by the Vendor.

4) The Purchaser acknowledges reading and accepting document which contains other miscellaneous disclaimers.

5) In the event of a conflict between the Standard Features schedule of the Agreement of Purchase and Sale and the Interior Colour Scheme, the Interior Colour Scheme shall prevail.

Signature: 

Date: Aug 29th 2023

Signature:

Date:

36" Gas Cooktop

800 Series – Stainless Steel NGM8656UC

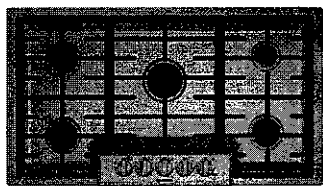

NGM8656UC  
Stainless Steel

Also available in:  
Black w/Black NGM8646UC  
Stainless  
Knobs

Bosch gas cooktops are engineered to perform precisely, offering high heat and low simmer options for optimal cooking flexibility.

Features & Benefits

Powerful 19,000 BTU burner for boiling, searing and stir-frying

OptiSim® Burner – simmer delicate sauces and melt chocolate without scorching

Electronic re-ignition will automatically re-ignite the burner in case the flame goes out

Continuous grates make moving heavy pots easier

Distinctive red LED light indicates burners are on

General Properties	
Knob material	Metal <sup>®</sup>
Sealed burners	Yes
Grate material	Cast iron
Element Performance	
Total BTU load (NG / LP)	58,500 / 47,300
Power of front left burner (NG / LP)	12,000 / 9,100
Power of back left burner (NG / LP)	10,000 / 9,100
Power of center burner (NG / LP)	19,000 / 15,000
Power of back right burner (NG / LP)	5,500 / 5,000
Power of front right burner (NG / LP)	12,000 / 9,100
Technical Details	
Watts	360 W
Circuit breaker	15 A
Volts	120 V
Frequency	60 Hz
Plug type	3 prong
Power cord length	60"
Energy source	Gas
Convertible to LP (kit required)	Yes



Dimensions & Weight	
Overall appliance dimensions (HxWxD)	3 13/16" x 37" x 21 1/4"
Required cutout size (HxWxD)	3 13/16" x 34 15/16" x 19 1/8"
Minimum distance from counter front	1 7/8"
Minimum distance from rear wall	3"
Net weight	39 lbs.
Accessories – Included	
Included	LP conversion kit
Accessories – Optional	



HEZ298102  
Wok ring



HEZGR301  
Griddle

For help and assistance with Bosch accessories please visit: [www.bosch-eshop.com/eshop/bosch/us](http://www.bosch-eshop.com/eshop/bosch/us) or call 1-800-944-2904 Mon-Fri 5am to 6pm PST Sat 6am to 3pm PST

Notes: All height, width and depth dimensions are shown in inches. BSH reserves the absolute and unrestricted right to change product materials and specifications, at any time, without notice. Consult the product's installation instructions for final dimensional data and other details prior to making cutout. Applicable product warranty can be found in accompanying product literature or you may contact your account manager for further details.

Warranties: Bosch warrants that the Product is free from defects in materials and workmanship for a period of three hundred and sixty-five (365) days from the date of purchase. The foregoing timeline begins to run upon the date of purchase, and shall not be stalled, tolled, extended, or suspended, for any reason whatsoever. This Product is also warranted to be free from cosmetic defects in material and workmanship (such as scratches of stainless steel, paint/porcelain blemishes, chip, dents, or other damage) to the finish of the Product, for a period of thirty (30) days from the date of purchase or closing date for new construction. This cosmetic warranty excludes slight color variations due to inherent differences in painted and porcelain parts, as well as differences caused by kitchen lighting, product location, or other similar factors. This cosmetic warranty specifically excludes any display, floor, "As Is", or "B" stock appliances.

For more information on our entire line of products, go to [www.bosch-home.com/us](http://www.bosch-home.com/us) or call 1-800-944-2904

© BSH Home Appliances Corporation. All rights reserved. Bosch is a registered trademark of Robert Bosch GmbH.

Roundel Lot # 63 - Pan/You  
Page 1 of 13



# 36" Gas Cooktop

800 Series – Stainless Steel NGM8656UC



## Installation Details

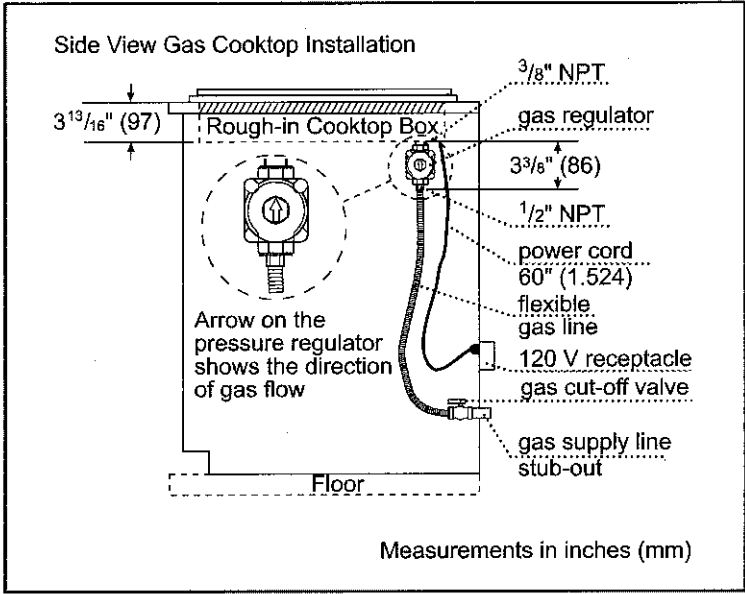
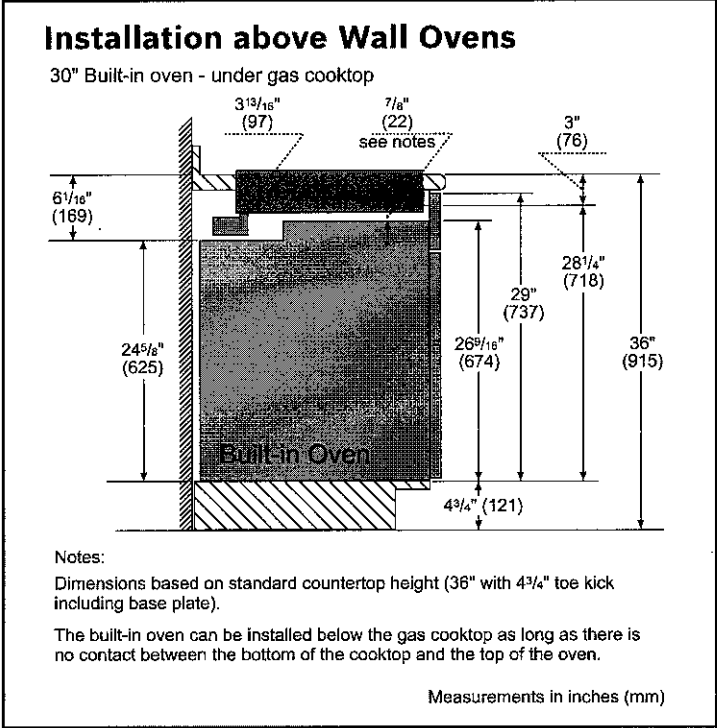
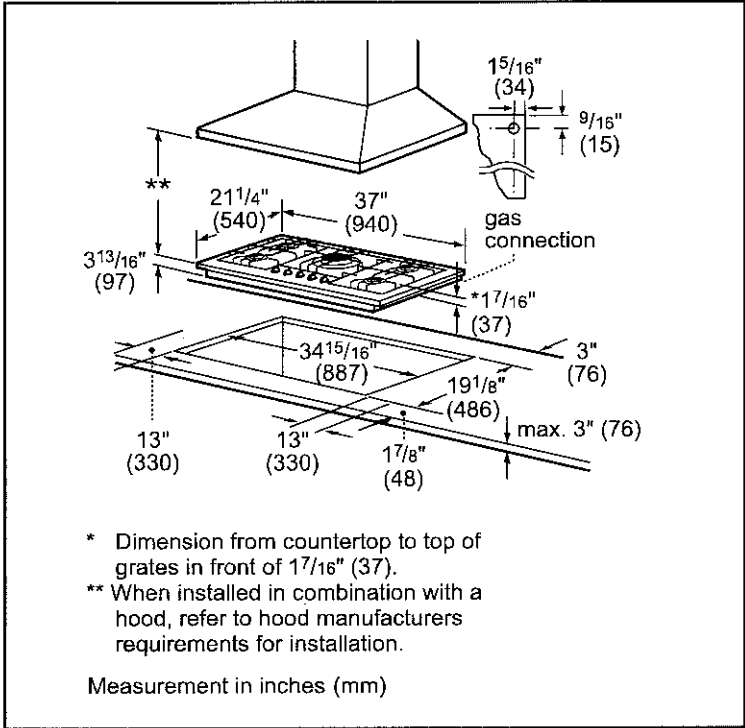

For help and assistance with Bosch accessories please visit: [www.bosch-eshop.com/eshop/bosch/us](http://www.bosch-eshop.com/eshop/bosch/us) or call 1-800-944-2904 Mon-Fri 5am to 6pm PST Sat 6am to 3pm PST

Notes: All height, width and depth dimensions are shown in inches. BSH reserves the absolute and unrestricted right to change product materials and specifications, at any time, without notice. Consult the product's installation instructions for final dimensional data and other details prior to making cutout. Applicable product warranty can be found in accompanying product literature or you may contact your account manager for further details.

Warranties: Bosch warrants that the Product is free from defects in materials and workmanship for a period of three hundred and sixty-five (365) days from the date of purchase. The foregoing timeline begins to run upon the date of purchase, and shall not be stalled, tolled, extended, or suspended, for any reason whatsoever. This Product is also warranted to be free from cosmetic defects in material and workmanship (such as scratches of stainless steel, paint/porcelain blemishes, chip, dents, or other damage) to the finish of the Product, for a period of thirty (30) days from the date of purchase or closing date for new construction. This cosmetic warranty excludes slight color variations due to inherent differences in painted and porcelain parts, as well as differences caused by kitchen lighting, product location, or other similar factors. This cosmetic warranty specifically excludes any display, floor, "As Is", or "B" stock appliances.

For more information on our entire line of products, go to [www.bosch-home.com/us](http://www.bosch-home.com/us) or call 1-800-944-2904

© BSH Home Appliances Corporation. All rights reserved. Bosch is a registered trademark of Robert Bosch GmbH.

02/18

Round Lot #63 - Pan/You  
page 2 of 13



# 36" Gas Cooktop

800 Series – Stainless Steel NGM8656UC



## Installation Details

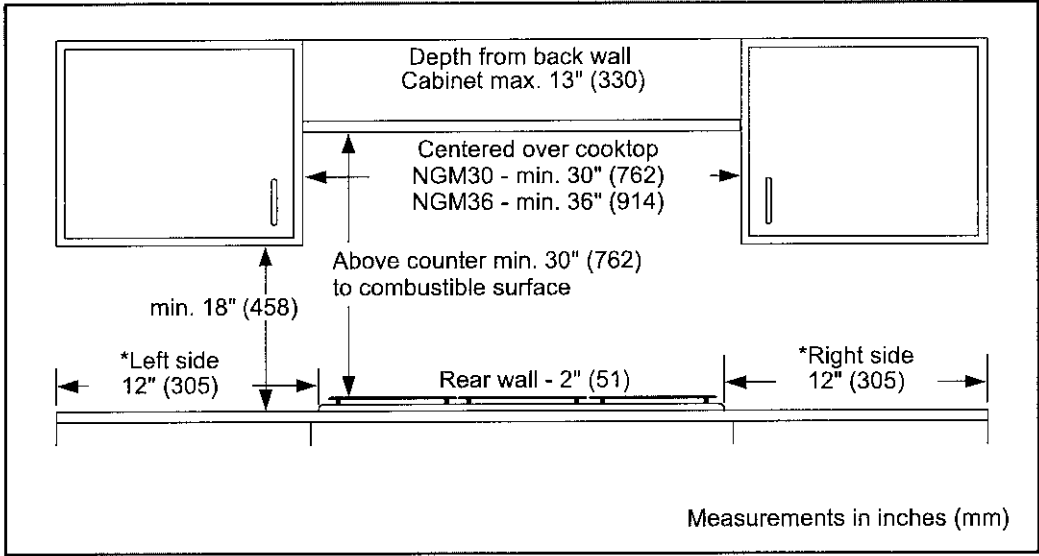

For help and assistance with Bosch accessories please visit: [www.bosch-eshop.com/eshop/bosch/us](http://www.bosch-eshop.com/eshop/bosch/us) or call 1-800-944-2904 Mon-Fri 5am to 6pm PST Sat 6am to 3pm PST

Notes: All height, width and depth dimensions are shown in inches. BSH reserves the absolute and unrestricted right to change product materials and specifications, at any time, without notice. Consult the product's installation instructions for final dimensional data and other details prior to making cutout. Applicable product warranty can be found in accompanying product literature or you may contact your account manager for further details.

Warranties: Bosch warrants that the Product is free from defects in materials and workmanship for a period of three hundred and sixty-five (365) days from the date of purchase. The foregoing timeline begins to run upon the date of purchase, and shall not be stalled, tolled, extended, or suspended, for any reason whatsoever. This Product is also warranted to be free from cosmetic defects in material and workmanship (such as scratches of stainless steel, paint/porcelain blemishes, chip, dents, or other damage) to the finish of the Product, for a period of thirty (30) days from the date of purchase or closing date for new construction. This cosmetic warranty excludes slight color variations due to inherent differences in painted and porcelain parts, as well as differences caused by kitchen lighting, product location, or other similar factors. This cosmetic warranty specifically excludes any display, floor, "As Is", or "B" stock appliances.

For more information on our entire line of products, go to [www.bosch-home.com/us](http://www.bosch-home.com/us) or call 1-800-944-2904

© BSH Home Appliances Corporation. All rights reserved. Bosch is a registered trademark of Robert Bosch GmbH.

Roundel Lot #63-Pan/You  
Page 3 of 13



LG STUDIO

LSHD3089BD / LSHD3689BD  
LSHD3080ST/ LSHD3680ST  
30"/36" Wall Mount Range Hood

Fingerprint & Smudge Resistant

Available in ~~30"~~ 36" Widths

5" Low-Profile Body

22 1/16" Depth

Accommodates Ceilings up to 9'6"

5-Speed IR Touch Controls

Dual Level LED Lighting

Decorative Mesh Filters (2)

wi-fi Capabilities

RoHS Compliant

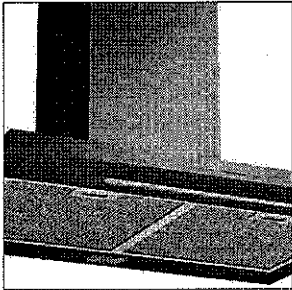
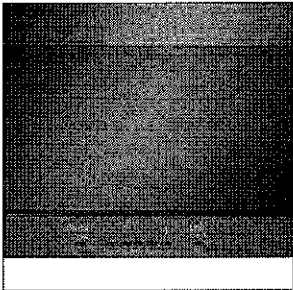
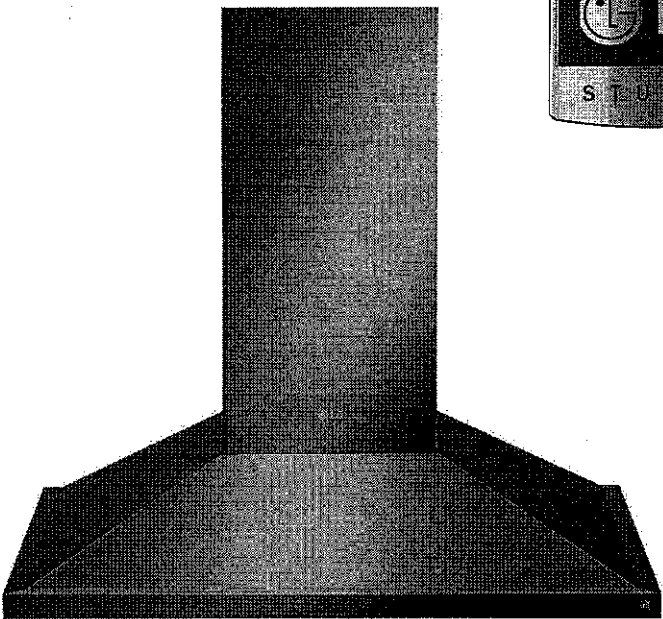

FEATURES	
Controls	IR Touch
Auto Delay-Off	Yes
Lighting	9W LED Light Strip
Dual-Level Lighting	Yes
Filters	Decorative Mesh (2) Dishwasher-Safe
wi-fi Capabilities	Yes (On/Off, Control CFM, Lights, Status)
RoHS Compliant	Yes
BLOWER	
Speed Levels	5
CFM (min-max)	200-600
Sones (min-max)	1-6
DUCTING	
Vertical Internal Blower	6" Round
MATERIALS/FINISHES	
Available Colors	Black Stainless Steel (BD)
Fingerprint & Smudge Resistant	Yes
POWER/RATINGS	
UL Listed	Yes
Ratings/Requirements/Type	120V, 4 Amps ,60Hz
Circuit Breaker Size	15 Amps

MOUNTING HEIGHT	
Distance Over Cooking Surface	26" - 34"
<del>30" DIMENSIONS/WEIGHT</del>	
<del>Product Dimensions (WxHxD)</del>	<del>29 15/16" x 27" to 48 1/2" x 22 1/16"</del>
<del>Carton Dimensions (WxHxD)</del>	<del>34 1/4" x 27 3/8" x 26 5/8"</del>
<del>Weight (Product/Shipping)</del>	<del>35 / 52 lbs</del>
<del>36" DIMENSIONS/WEIGHT</del>	
<del>Product Dimensions (WxHxD)</del>	<del>35 7/16" x 27" to 48 1/2" x 22 1/16"</del>
<del>Carton Dimensions (WxHxD)</del>	<del>39 1/2" x 27 3/8" x 26 5/8"</del>
<del>Weight (Product/Shipping)</del>	<del>37 / 55 lbs</del>
LIMITED WARRANTY	
Limited Warranty	2 years parts and labor
UPC CODES	
LSHD3089BD (30" Black Stainless Steel)	048231338981
LSHD3689BD (36" Black Stainless Steel)	048231338998
LSHD3080ST (30" Stainless Steel)	048231339841
LSHD3680ST (36" Stainless Steel)	048231339858

Roundel Lot #63-Pan/You  
Page 4 of 13

64P

LG STUDIO

LSHD3089BD / LSHD3689BD  
LSHD3080ST/ LSHD3680ST  
30"/36" Wall Mount Range Hood



QUICK INSTALL & CLEARANCES

For full installation directions/clearances please refer to the corresponding User Manual and Installation Guide.

30" DIMENSIONS	
A Width	29 15/16"
B Height	48 1/2"
C Depth	22 1/16"
36" DIMENSIONS	
A Width	35 7/16"
B Height	48 1/2"
C Depth	22 1/16"
POWER RATINGS	
AC Power	120V, 4 Amps, 60Hz

DIMENSIONS

- Tolerances: +1/16", -0 (1.6 mm, -0), unless otherwise stated.

NOTE

- The exhaust duct(s) and electrical wiring can be connected from either the top or the back of the hood.



CABINET LAYOUT

**WARNING**

- Observe all governing codes and ordinances during planning and installation. Contact your local building department for further information.
- Use only duct work deemed acceptable by state, municipal and local codes.

**WARNING**

- To reduce the risk of personal injury caused by reaching over a hot appliance, cabinet storage space located directly above the range should be avoided

**Minimum Cabinet Width:**

		Standard Duct Sizes
Hood Heights	minimum ducted (A)	27"
	minimum recirculating (B)	31"
	maximum (C)	48-172"
Ceiling Heights	minimum ducted (D)	89" (7' 5")
	minimum recirculating (E)	93" (7' 9")
	maximum (F)	118" (9' 10")

DUCTING OPTIONS

- A minimum of 6" round duct must be used to maintain maximum air flow efficiency.
- Always use rigid metal ducts only. Flexible ducts could restrict air flow by up to 50%.
- ALWAYS, when possible, reduce the number of transitions and turns. If long duct run is required, increase duct size from 6" to 7" or 8".
- If turns or transitions are required, install as far away from hood duct output and as far apart as possible.
- Minimum mount height between range top to hood bottom should be no less than 26".
- Maximum mount height should be no higher than 34".
- It is important to install the hood at the proper mounting height. Mounting the hood too low could result in heat damage and fire hazard. Mounting the hood too high will make it hard to reach and reduce its performance and efficiency.
- If available, also refer to the range manufacturer's height clearance requirements and recommended hood mounting height above range.

**WARNING Fire Hazard**

- NEVER exhaust air or terminate duct work into spaces between walls, crawl spaces, ceiling, attics or garages.
- All exhaust must be ducted to the outside.
- Use metal ductwork only.
- Fasten all connections with sheet metal screws and tape all joints with certified Silver Tape or Duct Tape.

Roundel Lot #63 - Pan/You  
Page 5 of 13

54

30" Speed Combination Oven

800 Series – Stainless Steel HBL8753UC

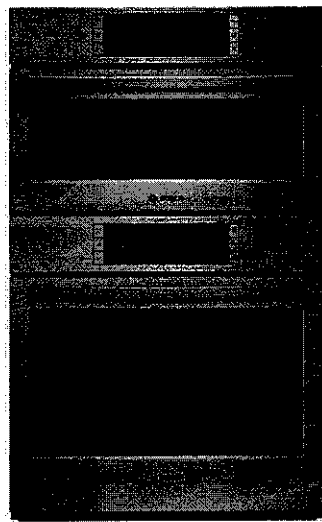

HBL8753UC  
Stainless Steel

Also available in:  
Black HBL8743UC  
Stainless Steel

Bosch speed combination ovens create an all-in-one cooking center with an upper speed oven and a Genuine European Convection oven below.

- Features & Benefits**
- 2-in-1 microwave and convection oven with 9 SpeedChef® programs to simplify cooking with fast results.
- Lower oven’s convection multi-rack mode gives uniform baking results even when using all 3 racks simultaneously.
- Oven is equipped with a self-cleaning cycle that easily cleans itself via 2, 3, and 4 hour cycle options.
- Download the Home Connect app to remotely monitor and control your Bosch wall oven with your smart phone or tablet.

General Properties	
Home Connect™ – lower cavity (WiFi enabled)	Yes
Cooking modes – upper cavity	Speed oven; 12 Auto Programs (including Auto Defrost, Melt Butter, Soften Ice Cream, Pizza), 9 Sensor Cook Programs, 9 SpeedChef® Programs, Hi & Lo Broil, European Convection, Keep Warm, Frozen Foods
Cooking modes – lower cavity	Bake, Variable Broil (hi & low), Roast, Warm, Sabbath-Proof Dough, Convection Bake, Convection Broil, Convection Roast, Pizza, Multi Rack Genuine European Convection, Convection Conversion, Temperature Probe, Fast Preheat
Cleaning type – lower	Self Clean
Telescopic rack	1
Illumination type	LED (Upper) / Incandescent (Lower)
Interior lights	1 Upper / 2 Lower
Oven Performance	
Microwave power – upper cavity	1000 W
Bake / broil element wattages – upper cavity	600 / 1,750 W
Convection element wattages – upper cavity	1,700 W
Bake / broil element wattages – lower cavity	2,400 / 3,800 W
Convection element wattages – lower cavity	2,000 W
Technical Details	
Watts (W)	9,600 W
Circuit breaker (A)	40 A
Volts (V); Frequency (Hz)	240 / 208 V; 60 Hz
Power cord length (in)	50"
Plug type	Fixed Connection, No Plug
Energy source	Electric

Dimensions & Weight	
Overall appliance dimensions (HxWxD)(in)	49" x 29 3/4" x 24 1/2"
Required cutout size – Standard (HxWxD) (in)	48 5/8" x 28 1/2" x 23 1/2"
Required cutout size – Flush (HxWxD) (in)	49 1/8" x 30" x 24 1/2"
Speed oven cavity size – upper	1.6 cu. ft.
Overall upper speed oven interior dimensions (HxWxD) (in.)	9 7/8" x 16 1/2" x 16 1/2"
Metal turntable diameter (in)	14 1/8" dia.
Ceramic tray diameter (in)	13 3/4" dia.
Rack – rectangular cookware max. – upper	15" x 12"
Oven cavity size – lower	4.6 cu. ft.
Overall lower oven interior dimensions (HxWxD) (in)	17 13/16" x 24 1/8" x 18"
Usable lower oven interior dimensions (HxWxD) (in)	12 1/4" x 23 1/4" x 15 1/4"
Net weight (lbs)	259 lbs

- Accessories – Included**
- Upper Oven: Metal Turntable, Square rack, Ceramic Cooking Tray
- Lower Oven: 1 Telescopic and 2 Standard Oven Racks, Meat Probe

Accessories – Optional

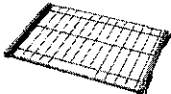

HEZTR301  
30" Telescopic Rack



\*Lower wall oven only

Accessories: To purchase Bosch accessories, cleaners & parts please visit [www.bosch-home.com/us/store](http://www.bosch-home.com/us/store) or call 1-800-944-2904 (Mon to Fri 5 am to 6 pm PST, Sat 6 am to 3 pm PST).  
Notes: All height, width and depth dimensions are shown in inches. BSH reserves the absolute and unrestricted right to change product materials and specifications, at any time, without notice. Consult the product's installation instructions for final dimensional data and other details prior to making cutout.  
Warranties: Please see Use & Care manual or Bosch website for statement of limited warranty.  
For more information on our entire line of products, go to [www.bosch-home.com/us](http://www.bosch-home.com/us) or call 1-800-944-2904  
© BSH Home Appliances Corporation. All rights reserved. Bosch is a registered trademark of Robert Bosch GmbH.

Roundel Lot #63-pan/you  
Page 6 of 13

540

# 30" Speed Combination Oven

800 Series – Stainless Steel HBL8753UC



## Installation Details

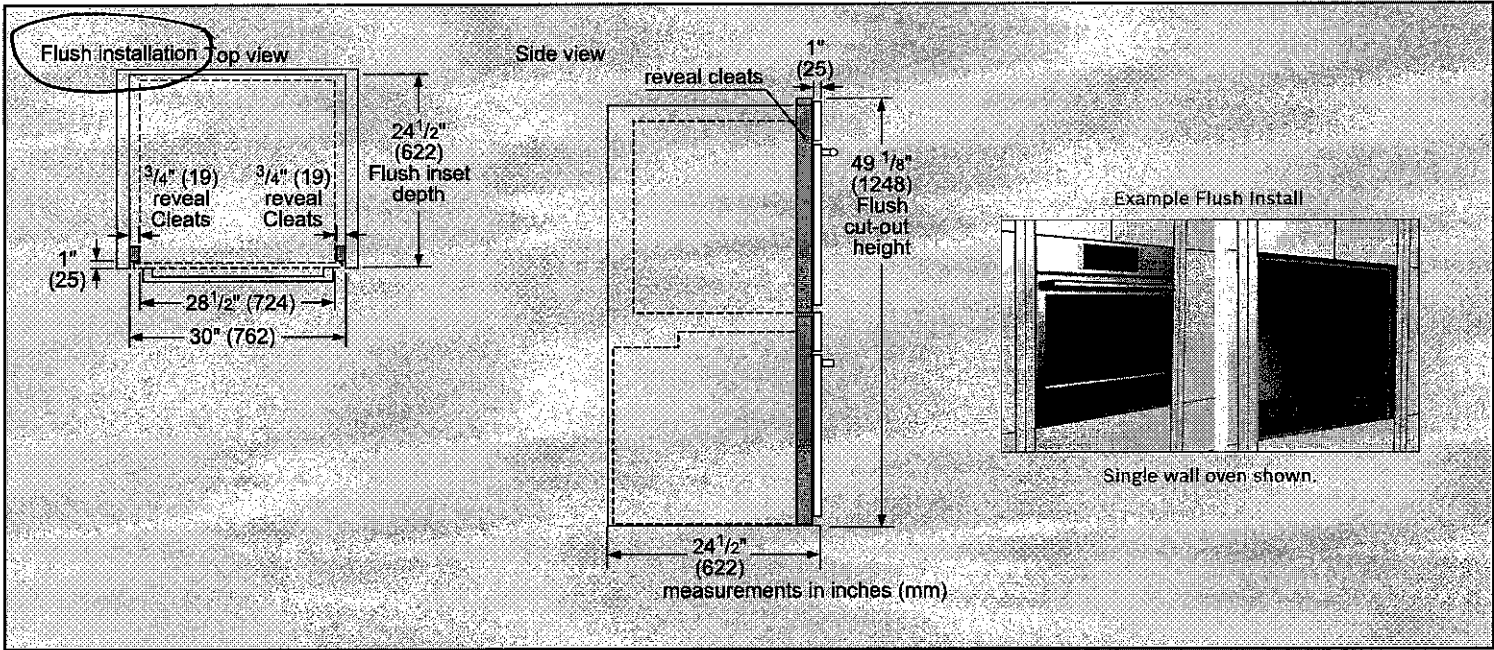
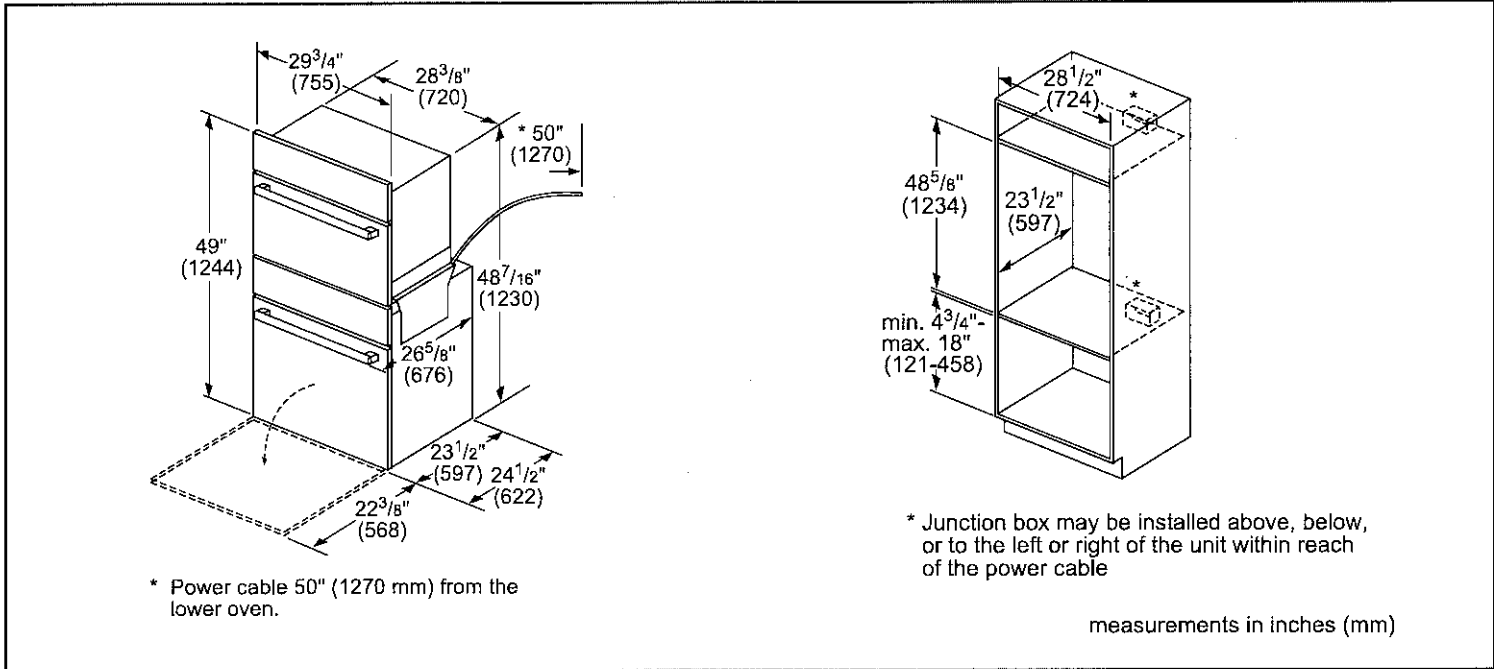

**Accessories:** To purchase Bosch accessories, cleaners & parts please visit [www.bosch-home.com/us/store](http://www.bosch-home.com/us/store) or call 1-800-944-2904 (Mon to Fri 5 am to 6 pm PST, Sat 6 am to 3 pm PST).

**Notes:** All height, width and depth dimensions are shown in inches. BSH reserves the absolute and unrestricted right to change product materials and specifications, at any time, without notice. Consult the product's installation instructions for final dimensional data and other details prior to making cutout.

**Warranties:** Please see Use & Care manual or Bosch website for statement of limited warranty.

For more information on our entire line of products, go to [www.bosch-home.com/us](http://www.bosch-home.com/us) or call 1-800-944-2904

© BSH Home Appliances Corporation. All rights reserved. Bosch is a registered trademark of Robert Bosch GmbH.

06/19

Roundel Lot #63-Pan/you  
Page 7 of 13

644

# 30" Speed Combination Oven

800 Series – Stainless Steel HBL8753UC



## Installation Details

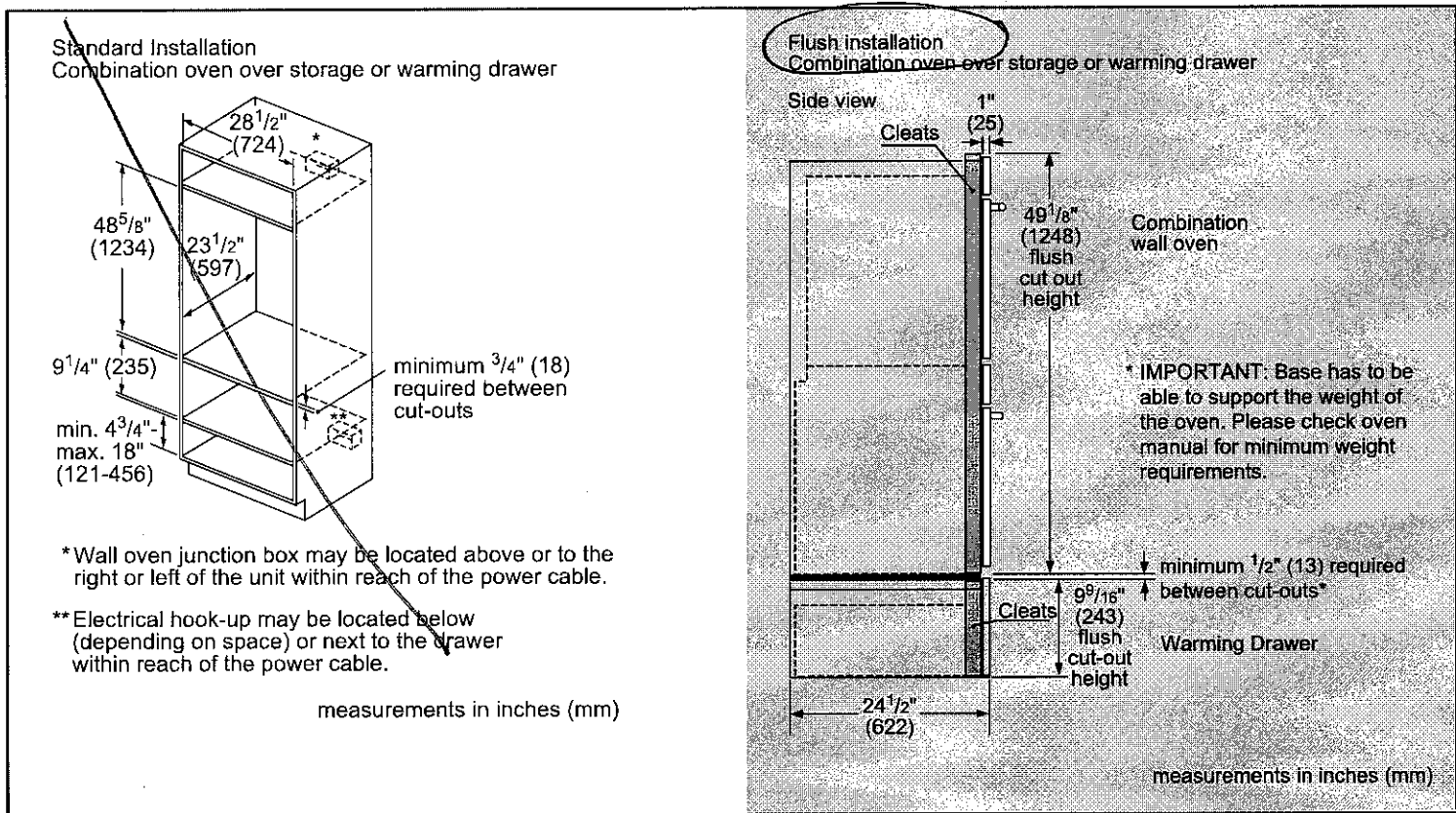

**Accessories:** To purchase Bosch accessories, cleaners & parts please visit [www.bosch-home.com/us/store](http://www.bosch-home.com/us/store) or call 1-800-944-2904 (Mon to Fri 5 am to 6 pm PST, Sat 6 am to 3 pm PST).

**Notes:** All height, width and depth dimensions are shown in inches. BSH reserves the absolute and unrestricted right to change product materials and specifications, at any time, without notice. Consult the product's installation instructions for final dimensional data and other details prior to making cutout.

**Warranties:** Please see Use & Care manual or Bosch website for statement of limited warranty.

For more information on our entire line of products, go to [www.bosch-home.com/us](http://www.bosch-home.com/us) or call 1-800-944-2904

© BSH Home Appliances Corporation. All rights reserved. Bosch is a registered trademark of Robert Bosch GmbH.

06/19

Roundel Lot #63-Pan/Ya  
Page 8 of 13

648

24" Recessed Handle Dishwasher

300 Series – Stainless Steel SHE53C85N

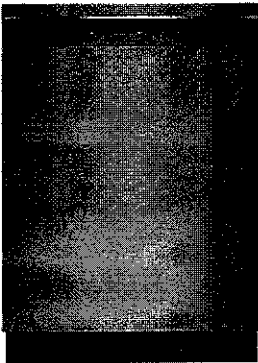

SHE53C85N  
Stainless Steel

Also available in:

- White SHE53C82N
- Black SHE53C86N

The 3rd rack provides the perfect space for silverware and large utensils while its V shape leaves room below for taller items.

Features & Benefits

46 dBA: dishwasher runs quietly so your kitchen conversations aren't interrupted.

With PrecisionWash®, intelligent sensors and precision spray arms target every item of every load, so dishes come out sparkling clean every time.

Enhance your cleaning experience with Wi-Fi enabled Home Connect®. Access additional wash cycles and options or choose the right one for your needs using Smart Cycle.

General Properties	
Number of wash cycles	5 + 3 additional in Home Connect®
Number of options	3 + 2 additional in Home Connect®
dBA	46
Wash system	PrecisionWash®
Drying system	PureDry®
Third rack	Standard 3rd Rack
Rack adjustability	Rackmatic®
Tub material	Stainless Steel
Control type	Touch Controls
Concealed water heating element	Yes
Leak protection system	24/7 AquaStop®
Home Connect® (WiFi enabled)	Yes
NSF®-certified* sanitize option	Yes
Water softener	No
Five-level wash	Yes
Child Lock button suspension	Yes
Anti-Fingerprint Finish	Yes
Special features	Extra Dry Option
Efficiency	
Water usage per cycle	3.5
ENERGY STAR® qualified	No
Total annual energy consumption	269 kWh
Capacity	
Number of place settings	16

Technical Details	
Watts	1440 W
Current	12 Amps
Volts	120 V
Frequency	60 Hz
Power cord full length	67"
Power cord install length from edge of unit when facing the door	Left – 45" Right – 56"
Minimum water pressure	14 lb/sin
Length outlet hose	78 3/4"
Dimensions & Weight	
Overall appliance dimensions (HxWxD)	33 7/8" x 23 9/16" x 23 3/4"
Required cutout size (HxWxD)	33 7/8" x 24" x 24"
Adjustable feet	Yes
Net weight	81 lbs
Accessories—Optional	
Junction Box	SMZPCJB1UC
Junction Box + Supply Hose Kit	SMZ3IN1UC
Bosch Dishwasher Water Supply Hose	SMZSH1ABUC
Drain Hose Extension Kit	SGZ1010UC
Silverware Basket	SMZ4000UC
Dishwasher Accessory Kit	SMZ5000
Anti-Tarnish Silverware Cassette	SMZ5002UC
Edge Protector + Power Cord Clip Install Kit	SMZEPCC1UC

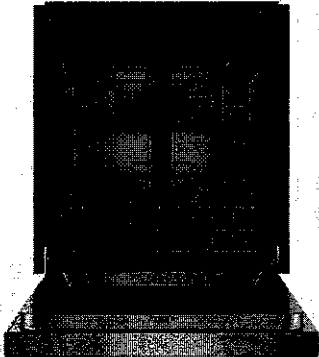

\*Certification to NSF/ANSI Standard 184 for residential dishwashers

Accessories: To purchase Bosch accessories, cleaners & parts please visit [www.bosch-home.com/us/store](http://www.bosch-home.com/us/store) or call 1-800-944-2904 (Mon to Fri 5 am to 6 pm PST, Sat 6 am to 3 pm PST).

Notes: All height, width and depth dimensions are shown in inches. BSH reserves the absolute and unrestricted right to change product materials and specifications, at any time, without notice. Consult the product's installation instructions for final dimensional data and other details prior to making cutout.

Warranties: Please see Use & Care manual or Bosch website for statement of limited warranty.

For more information on our entire line of products, go to [www.bosch-home.com/us](http://www.bosch-home.com/us) or call 1-800-944-2904

© BSH Home Appliances Corporation. All rights reserved. Bosch is a registered trademark of Robert Bosch GmbH.

Roundel Lot # 63 - Pan/you  
Page 9 of 13

6/23

# 24" Recessed Handle Dishwasher

300 Series – Stainless Steel SHE53C85N



## Installation Details

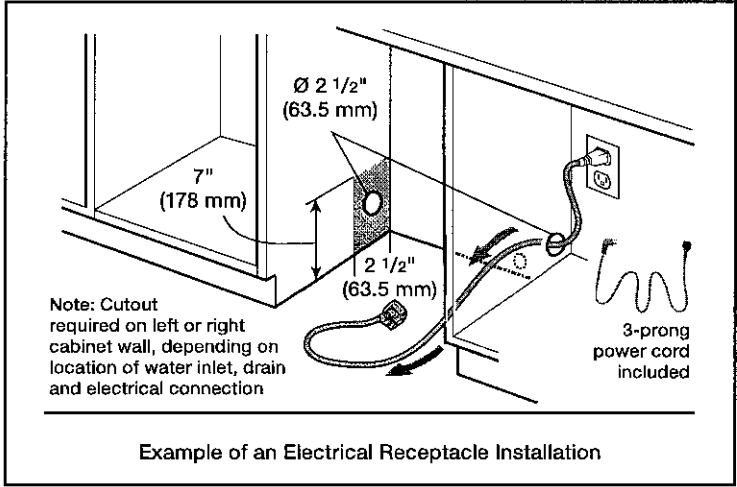
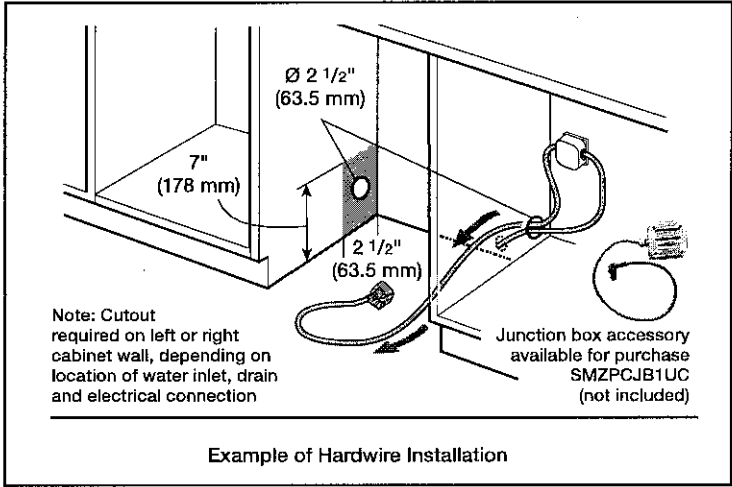
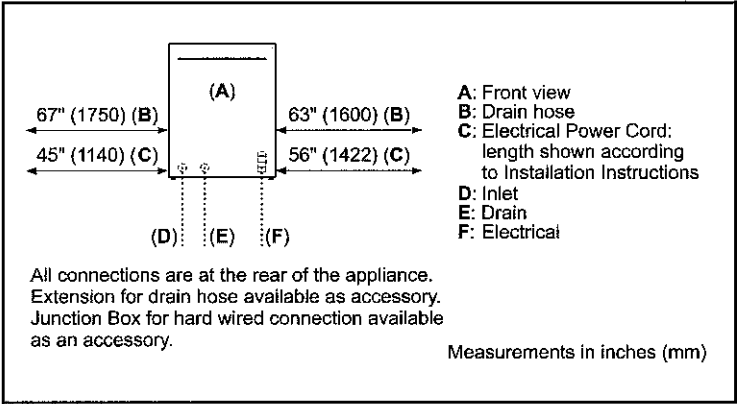
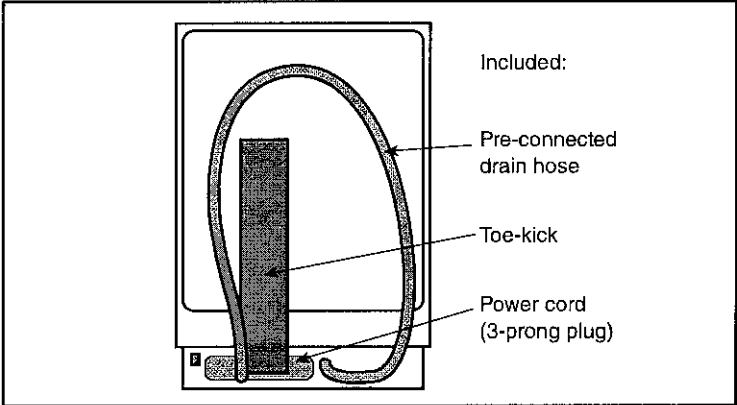
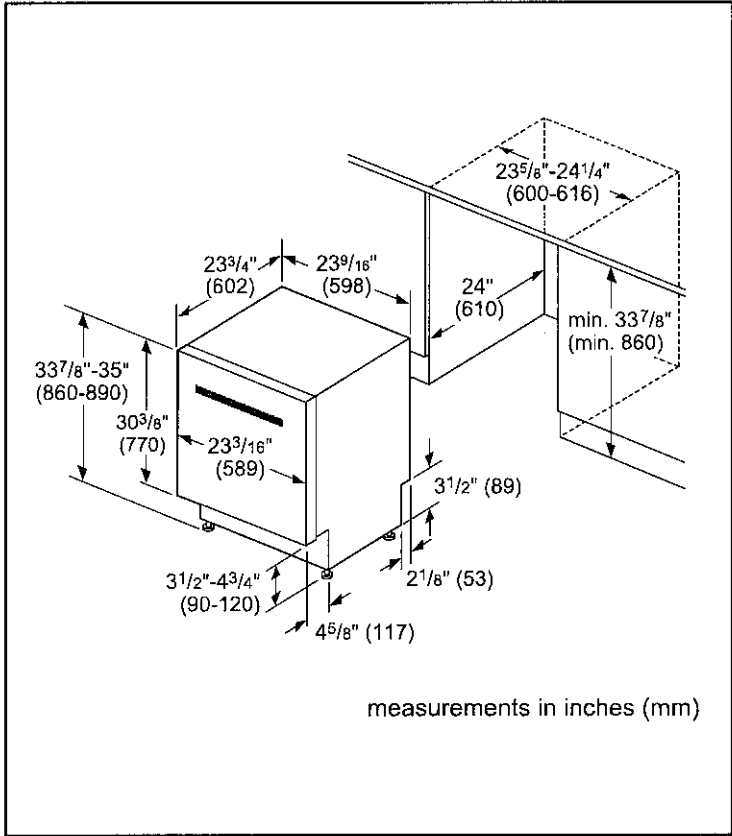

**Accessories:** To purchase Bosch accessories, cleaners & parts please visit [www.bosch-home.com/us/store](http://www.bosch-home.com/us/store) or call 1-800-944-2904 (Mon to Fri 5 am to 6 pm PST, Sat 6 am to 3 pm PST).

**Notes:** All height, width and depth dimensions are shown in inches. BSH reserves the absolute and unrestricted right to change product materials and specifications, at any time, without notice. Consult the product's installation instructions for final dimensional data and other details prior to making cutout.

**Warranties:** Please see Use & Care manual or Bosch website for statement of limited warranty.

**For more information on our entire line of products, go to [www.bosch-home.com/us](http://www.bosch-home.com/us) or call 1-800-944-2904**

© BSH Home Appliances Corporation. All rights reserved. Bosch is a registered trademark of Robert Bosch GmbH.

Roundel Lot #63-pan/ya  
Page 10 of 13

Q  
64P

# 24" Recessed Handle Dishwasher

300 Series – Stainless Steel SHE53C85N



## Installation Details

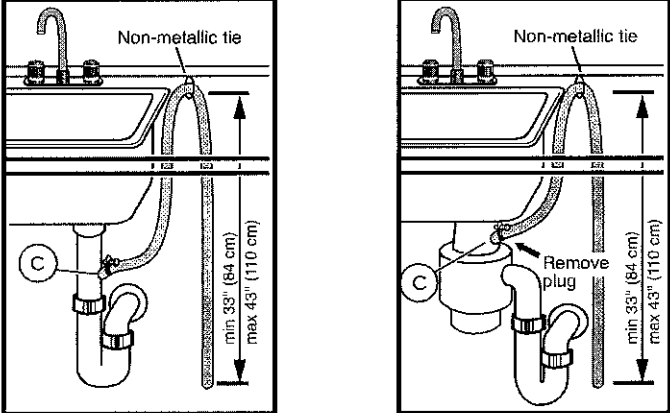

Note: Plumbing installations will vary - refer to local codes. Drain hose included is 79" (201 cm) and can be extended to a maximum of 155 3/4" (396 cm).

Always use the approved drain hose extension kit (SGZ1010UC).

Ensure a portion of the drain hose is raised between min. 33" (84 cm) and max. 43" (110 cm) above the cabinet floor.

**Accessories:** To purchase Bosch accessories, cleaners & parts please visit [www.bosch-home.com/us/store](http://www.bosch-home.com/us/store) or call 1-800-944-2904 (Mon to Fri 5 am to 6 pm PST, Sat 6 am to 3 pm PST).

**Notes:** All height, width and depth dimensions are shown in inches. BSH reserves the absolute and unrestricted right to change product materials and specifications, at any time, without notice. Consult the product's installation instructions for final dimensional data and other details prior to making cutout.

**Warranties:** Please see Use & Care manual or Bosch website for statement of limited warranty.

For more information on our entire line of products, go to [www.bosch-home.com/us](http://www.bosch-home.com/us) or call 1-800-944-2904

© BSH Home Appliances Corporation. All rights reserved. Bosch is a registered trademark of Robert Bosch GmbH.

Roundel Lot #63-pan/you  
Page 11 of 13

54P

36" Counter-Depth 4-Door Refrigerator

800 Series – Stainless Steel B36CL80ENS

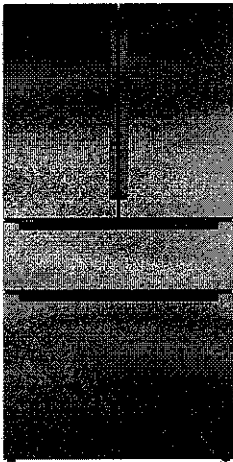

B36CL80ENS  
Stainless Steel w/  
Recessed Handles

Introducing the revolutionary, new FarmFresh System™, with four freshness technologies designed to work together to keep your food fresher, longer. Enjoy less food waste, new innovative features and more thoughtful design.

- Features & Benefits**  
VitaFreshPro™ provides pre-programmed freshness settings to optimize temperature and humidity to keep meat, fish, and produce fresher, longer.
- Interior Water Dispenser is thoughtfully placed inside for refreshing water at the touch of a button or a push of a nozzle.
- FlexBar™ utilizes typically unused space in the upper refrigerator cavity.
- Recessed handle provides flush design to match any sleek kitchen.

General Properties	
Full 72" height and true counter depth for built-in appearance	Yes
Easy Clean Stainless Steel	Yes
Lighting	Recessed LED light bars
Number of compressors/evaporators	2 / 2
Defrost process refrigerator section	Frost-free
Number of shelves – refrigerator	5
Adjustable shelves – refrigerator	4 half-width
Shelf material – refrigerator	Tempered glass
Type of shelves – refrigerator	Frameless split shelves with metal trim
Flexible storage bar	FlexBar™
Gallon storage bins	2
Humidity control compartments	2
Full width temp. & humidity controlled drawer	VitaFreshPro™
Ice maker	Yes
Water filter	UltraClarityPro™
Internal water dispenser	Yes
Touch control panel	Yes
AirFresh® filter	Yes
FreshProtect™ ethylene filter	Yes
MultiAirFlow™	Yes
Stainless steel back wall	Yes
Defrost process freezer section	Automatic
Number of drawers – freezer	3
Wi-Fi enabled	Yes, Home Connect™ app

Capacity	
Total capacity (cu. ft.)	20.5
Refrigerator capacity (cu. ft.)	14.5
Freezer capacity (cu. ft.)	6
Technical Details	
Current (A)	15 A
Volts (V)	115 V
Frequency (Hz)	60 Hz
Power cord length (in.)	91
Plug type	120V-3 prong
Dimensions & Weight	
Appliance dimensions with hinges and doors (H x W x D) (in.)	72" x 35 5/8" x 28 3/4"
Appliance dimensions without hinges and doors (H x W x D) (in.)	71 1/2" x 35 5/8" x 24***
Required cutout size (H x W x D) (in.)	72" x 36" x 25"
Net weight (lbs)	350 lbs
Efficiency	
Energy consumption (kWh/yr)	568
ENERGY STAR® qualified	Yes
Accessories	
UltraClarityPro™ Water Filter: BORPLFTR50 FlexBar™ Bottle Holder: BOFLEXBOTL FlexBar™ Deep Shelf: BOFLEXLGSH FlexBar™ Shallow Shelf: BOFLEXSMSh Ethylene Filter Refill Kit: FPETHRF50	



\*When leveling legs are fully extended, add 5/8" to overall height, total 72 5/8".  
\*\*The cutout depth of 25" includes the required 1" airflow. The electrical covers on the back of unit do not require additional depth.  
**Accessories:** To purchase Bosch accessories, cleaners & parts please visit [www.bosch-home.com/us/store](http://www.bosch-home.com/us/store) or call 1-800-944-2904 (Mon to Fri 5 am to 6 pm PST, Sat 6 am to 3 pm PST).  
**Notes:** All height, width and depth dimensions are shown in inches. BSH reserves the absolute and unrestricted right to change product materials and specifications, at any time, without notice. Consult the product's installation instructions for final dimensional data and other details prior to making cutout.  
**Warranties:** Please see Use & Care manual or Bosch website for statement of limited warranty.  
For more information on our entire line of products, go to [www.bosch-home.com/us](http://www.bosch-home.com/us) or call 1-800-944-2904  
© BSH Home Appliances Corporation. All rights reserved. Bosch is a registered trademark of Robert Bosch GmbH.

Roundel Lot #63 - Pan/You  
Page 12 of 13

SHF

# 36" Counter-Depth 4-Door Refrigerator

800 Series – Stainless Steel B36CL80ENS



## Installation Details

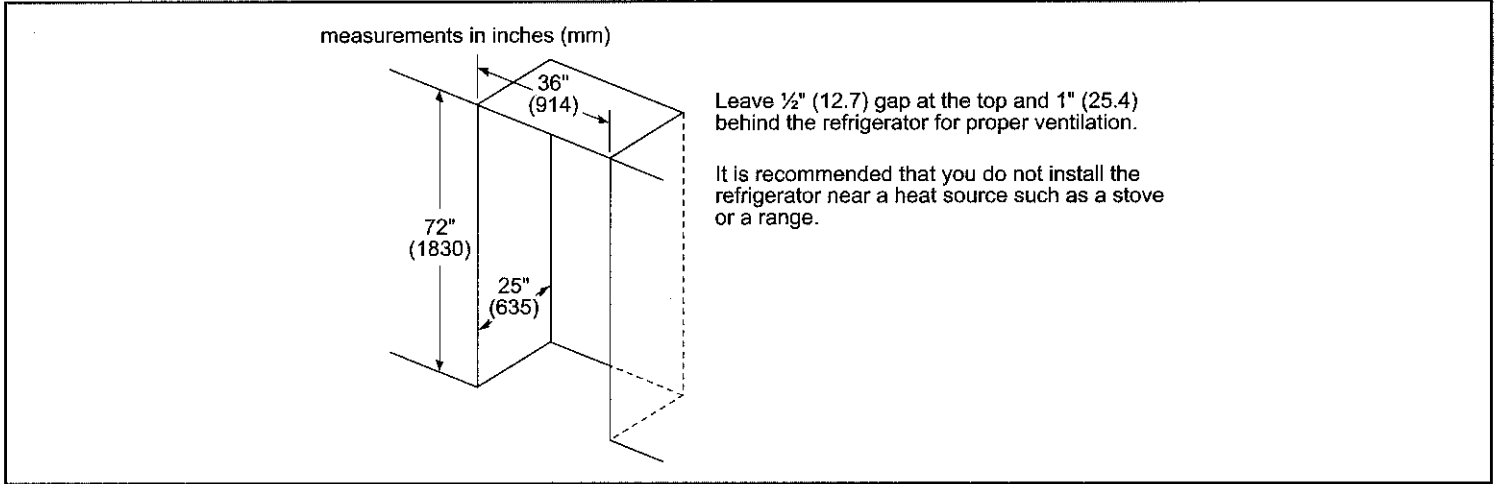
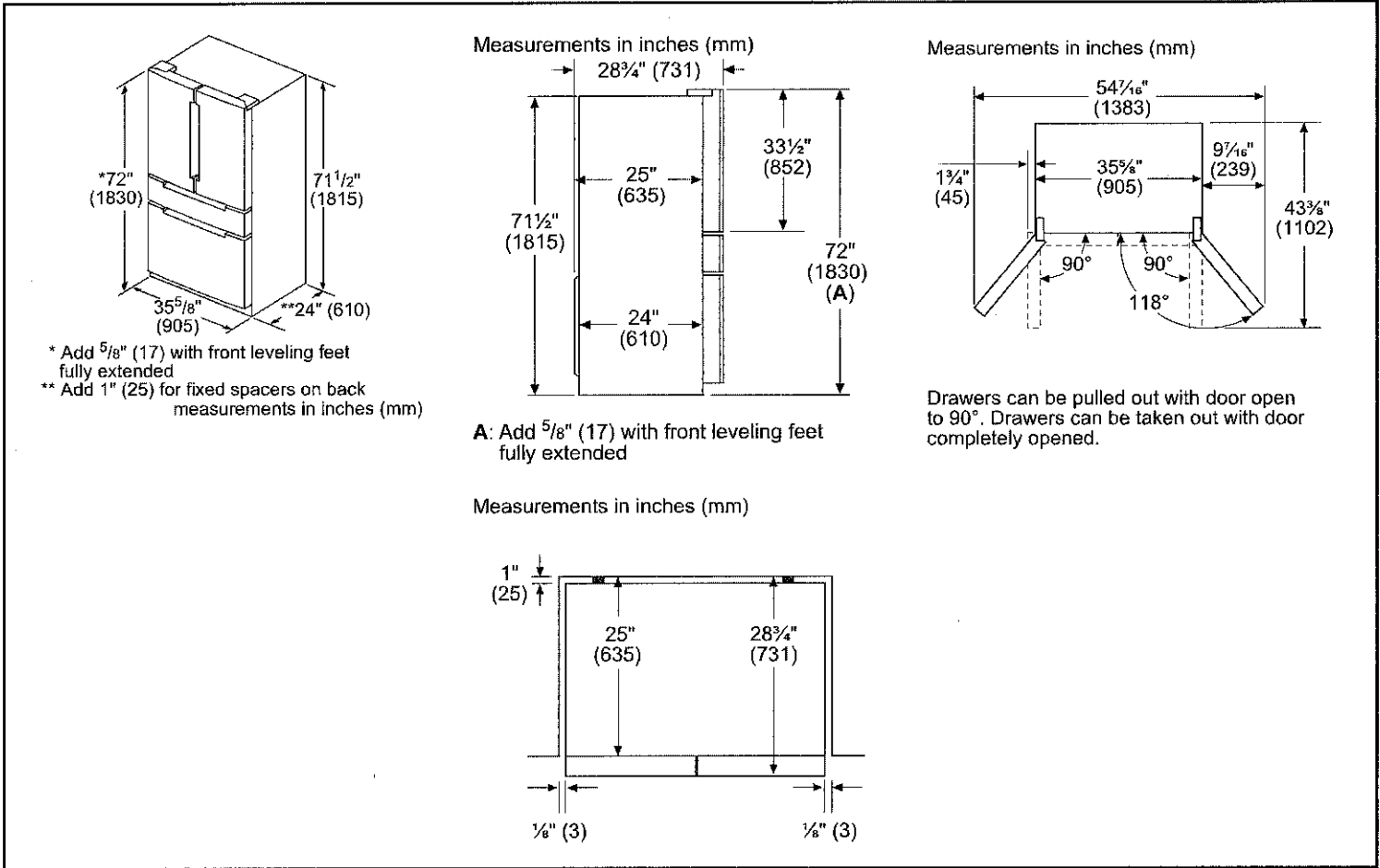

**Accessories:** To purchase Bosch accessories, cleaners & parts please visit [www.bosch-home.com/us/store](http://www.bosch-home.com/us/store) or call 1-800-944-2904 (Mon to Fri 5 am to 6 pm PST, Sat 6 am to 3 pm PST).

**Notes:** All height, width and depth dimensions are shown in inches. BSH reserves the absolute and unrestricted right to change product materials and specifications, at any time, without notice. Consult the product's installation instructions for final dimensional data and other details prior to making cutout.

**Warranties:** Please see Use & Care manual or Bosch website for statement of limited warranty.

**For more information on our entire line of products, go to [www.bosch-home.com/us](http://www.bosch-home.com/us) or call 1-800-944-2904**

© BSH Home Appliances Corporation. All rights reserved. Bosch is a registered trademark of Robert Bosch GmbH.

Round Lot #63-pan/you  
Page 13 of 13

614

LOT#63

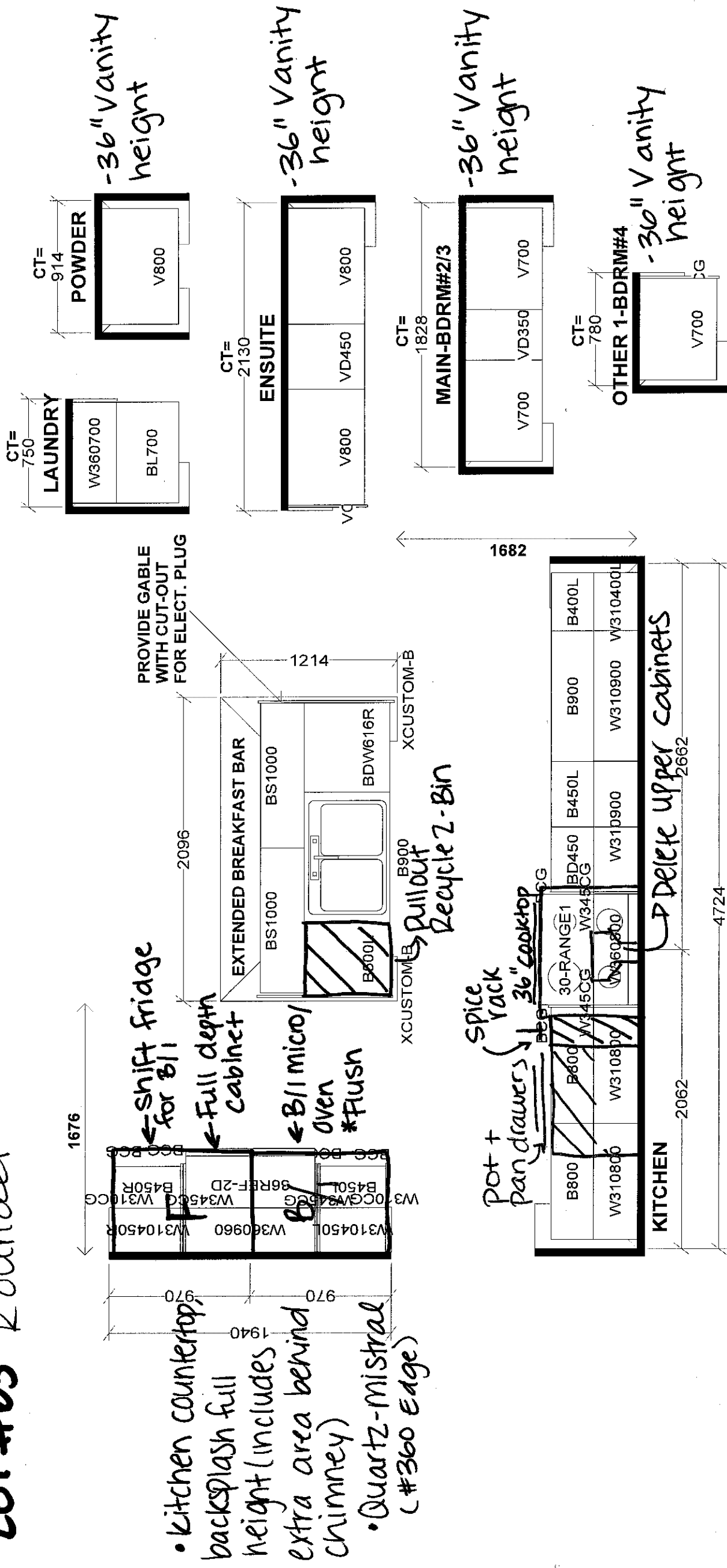

\* All bathroom vanities to include 3" Backsplash  
return

Selba Industries				J #
W WDTH	W HGHT	W CNT	JOB NUMBER: BUILDER: GREENPARK SITE: ROUNDEL, Richmond Hill MODEL: PINETREE 2X EL 43 LOT #:	
FLOOR HGHT	DOOR HGHT	This drawing is the intellectual property of SELBA INDUSTRIES INC. and is an original design which must not be released or copied unless applicable fee has been paid or job order placed.		
ST CENT	2X4	VENT BOX COVER	DESIGNER: KS DATE: JUNE 7 21	

PURCHASER ALTERATION FORM

LOTS ~~54-60~~, 63, ~~64~~  
ROUNDEL HOMES INC.  
RED OAKS ON BAY VIEW

PINETREE 2  
ELEVATION 3

REVISION:

- GAS FIREPLACE TO PROJECT INTO FAMILY ROOM DUE TO LOT CONDITIONS

DocuSigned by:  
*Yu Rang Yu* 06-Apr-23  
0A02CF0C2850427...

4/24/23

The diagram is a floor plan of the main level of a house. It features a large central rectangular area labeled 'FAMILY ROOM'. To the left of the family room is a smaller rectangular area labeled 'BREAKFAST'. On the right side of the family room, there is a fireplace labeled 'GAS FIREPLACE'. The plan shows various walls, doors, and windows. A dashed line indicates a boundary or a specific feature within the family room. The overall layout is simple and functional.

MAIN LEVEL

DESIGN  
INC.

Greenpark

LOT #63 Roundel

\*See Attached sketch for Family Room Fireplace  
Add a plug →

# Pinetree 2

ELEV. 2-503-44 | ELEV. 3 • 2,598 sq.ft.  
Includes 16 sq.ft. of open area.

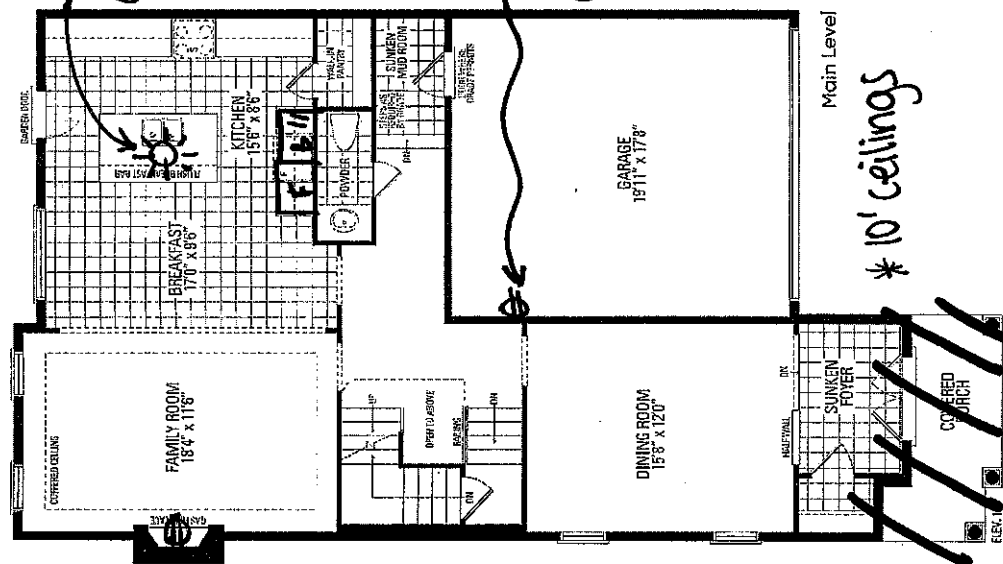

Add light above kitchen island

Electric vehicle r/i (conduit)

\* 10' ceilings

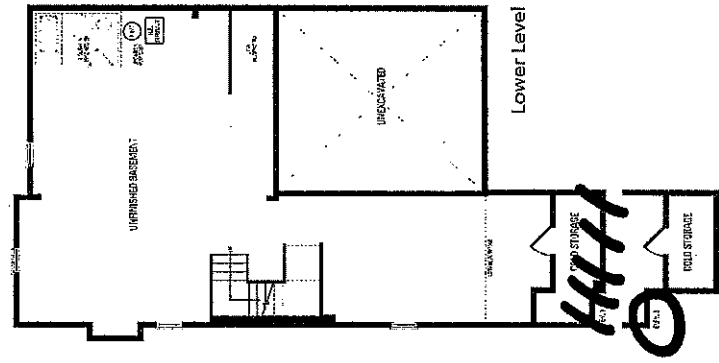
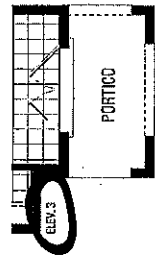

- \*Smooth ceilings on first floor
- \*Eas line r/i for stove
- \*Humidifier
- \*Waterline r/i for fridge

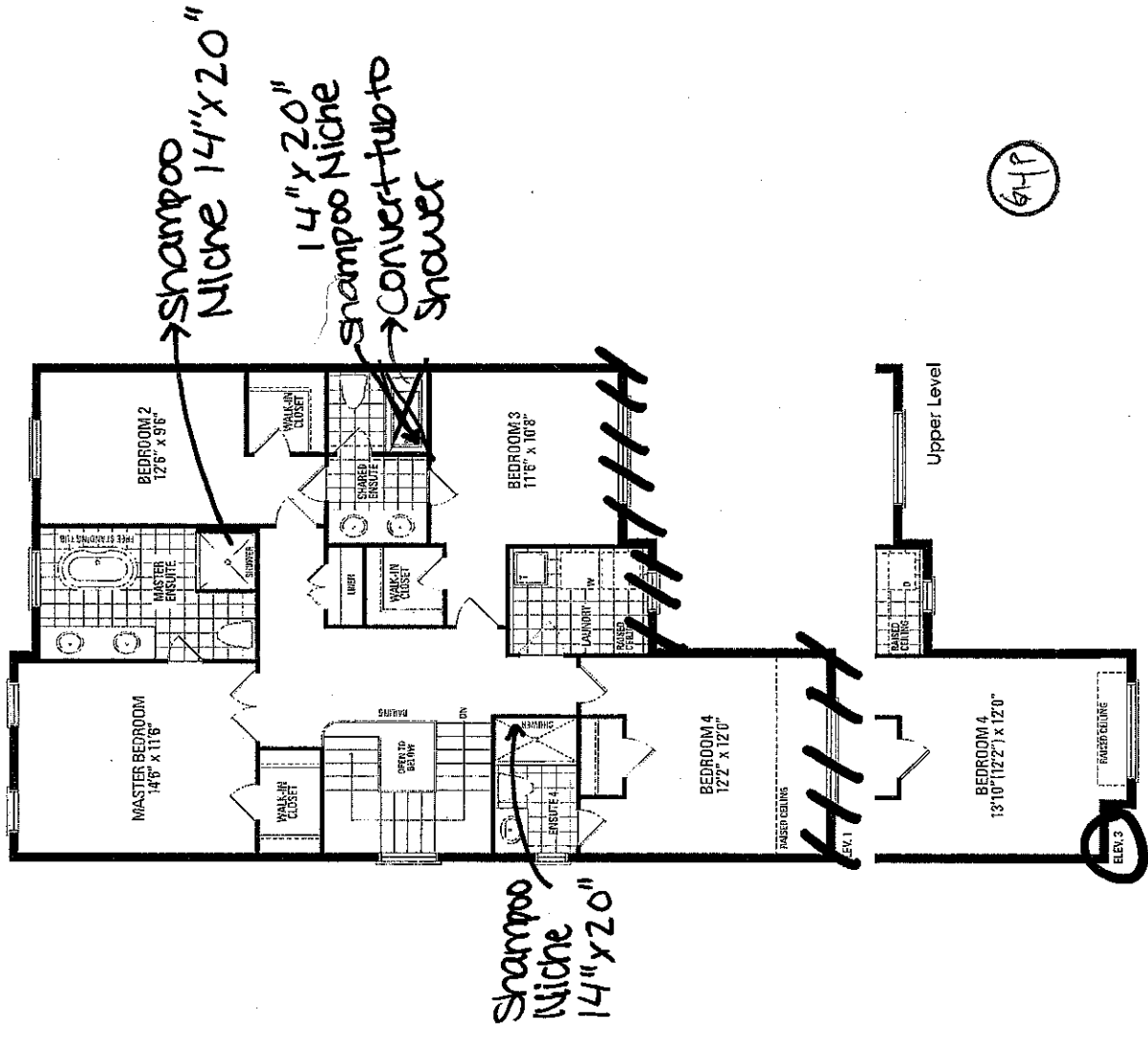

Shampoo Niche 14" x 20"

Shampoo Niche 14" x 20"  
14" x 20"  
Shampoo Niche  
Convert tub to Shower

64P

Orientation of home may be reversed and purchaser agrees to accept the same. Steps and porches may vary at any exterior entrance ways due to grading variance. Actual usable floor space may vary from the stated floor areas. All renderings are artist's concept. Dimensions, specifications and architectural detailing subject to modifications. Roofline and adjoining model types may vary due to siting. E. & O. E. March 2023