

CONSTRUCTION SUMMARY

RECEIVED

Red Oaks - Roundel Homes Inc.

OCT 02 2023

PURCHASERS: Man Yue WAN and Hou Yun Elsa KWAN

TEL: RES.: 647-970-6599

LOT / PHASE 65 / 2	REG. PLAN # 65M-4737	HOUSE TYPE Glenrowan 3 Elev 3		
-----------------------	-------------------------	----------------------------------	--	--

CABINETRY

1 - CABINETRY - KITCHEN - CM11 CROWN MOULDING WITH HEADER 27Sep23 Note:	
1 - CABINETRY - KITCHEN - LIGHT VALANCE - INCLUDING ADDITIONAL CABINET EXTENSION 27Sep23 Note: CABINETRY ONLY - ELECTRICAL PRICED SEPARATELY	
1 - CABINETRY - KITCHEN - UPGRADE 3 27Sep23 Note:	
1 - VANITY - PRIMARY ENSUITE - RAISE VANITY TO 36" HIGH VANITY IN LIEU OF STANDARD HEIGHT 27Sep23 Note:	
1 - EXTEND KITCHEN CABINETRY TO REAR WALL - INCLUDES BASE AND UPPERS CABINETS (STANDARD LEVEL CABINETRY) WITH STONE COUNTERTOP - SEE SKETCH 04May23 Note:	
1 - CABINETRY PROVISION - PROVISION FOR PLUG ON ISLAND (PLUG EXTRA ORDERED SEPARATELY) 04May23 Note:	

CABINETRY ACCESSORIES

1 - CABINETRY FEE FOR FLUSH CUTOUT ON WALL SINGLE OVEN CABINET 27Sep23 Note:	
1 - KITCHEN CABINETRY BASE - PIE CUT CORNER CABINET - BASE CABINETRY - UPGRADE 3 27Sep23 Note:	
1 - KITCHEN CABINETRY BASE - BANK OF DRAWERS - UPGRADE 3 27Sep23 Note: SEE SKETCH FOR LOCATION	
1 - KITCHEN CABINETRY UPPER - FULL DEPTH ABOVE FRIDGE - WITH GABLES - 650 DEEP - PRICE IS EACH 27Sep23 Note:	
1 - KITCHEN CABINETRY - TALL BUILT-IN SINGLE OVEN WITH FULL SET OF POT DRAWERS BELOW - UPGRADE 3 27Sep23 Note:	
1 - KITCHEN CABINETRY BASE - COOKTOP CABINET WITH POT DRAWERS (2 DRAWERS) - UPGRADE 3 27Sep23 Note:	
1 - KITCHEN BASE CABINETRY - BAR FRIDGE PROVISION 27Sep23 Note: SEE SKETCH FOR LOCATION	

CERAMIC TILE

1 - PRICE IS FOR LABOUR ONLY - INSTALL TILE AT A 45 DEGREE ANGLE OR INSTALL TILE IN A STAGGERED PATTERN - KITCHEN/BREAKFAST 27Sep23 Note:	
1 - PRICE IS FOR LABOUR ONLY - INSTALL TILE AT A 45 DEGREE ANGLE OR INSTALL TILE IN A STAGGERED PATTERN - FOYER 27Sep23 Note:	
1 - GROUT COLOUR - UPGRADE GROUT COLOUR THROUGHOUT - FLAT FEE 27Sep23 Note:	

CONSTRUCTION SUMMARY

Red Oaks - Roundel Homes Inc.

PURCHASERS: Man Yue WAN and Hou Yun Elsa KWAN

TEL: RES.: 647-970-6599

LOT / PHASE	REG. PLAN #	HOUSE TYPE		
65 / 2	65M-4737	Glenrowan 3 Elev 3		

1 - TILE - UPGRADE 2 WALL TILE - PRIMARY ENSUITE - SHOWER 27Sep23 Note:	
1 - TILE - UPGRADE 2 FLOOR TILE - PRIMARY ENSUITE - FLOOR 27Sep23 Note:	
1 - PRICE IS FOR LABOUR ONLY - INSTALL TILE IN A STAGGERED PATTERN - PRIMARY ENSUITE - SHOWER 27Sep23 Note:	
1 - PRICE IS FOR LABOUR ONLY - INSTALL TILE IN A STAGGERED PATTERN - PRIMARY ENSUITE - FLOOR 27Sep23 Note:	
1 - TILE - UPGRADE 1 FLOOR TILE - KITCHEN/BREAKFAST 27Sep23 Note:	
1 - TILE - UPGRADE 1 FLOOR TILE - POWDER ROOM 27Sep23 Note:	
1 - TILE - UPGRADE 1 FLOOR TILE - LAUNDRY ROOM 27Sep23 Note:	
1 - TILE - UPGRADE 1 FLOOR TILE - FOYER 27Sep23 Note:	
1 - DELETE ALL CERAMIC BATHROOM ACCESSORIES - DELETE TOWEL BAR, PAPER HOLDER & SOAP DISH THROUGHOUT 27Sep23 Note:	

CONSTRUCTION

1 - PROVISION FOR SHAMPOO NICHE APPROX. 14" WIDE X 20" HIGH AS PER SKETCH – IF CONSTRUCTION PERMITS 04May23 Note: MASTER ENSUITE	
1 - SMOOTH CEILINGS ON SECOND FLOOR 04May23 Note:	
1 - SMOOTH CEILINGS ON FIRST FLOOR 04May23 Note:	

COUNTER TOP

1 - UPGRADE STONE COUNTER TOP - KITCHEN - IN LIEU OF STANDARD MATERIAL 27Sep23 Note:	
1 - SHAMPOO NICHE 14" WIDE X 20" HIGH AS PER SKETCH – MARBLE, GRANITE OR QUARTZ – IF CONSTRUCTION PERMITS - REQUIRES PROVISION FROM CONSTRUCTION 04May23 Note: SUPPLY & INSTALL MASTER ENSUITE	

ELECTRICAL

1 - BUILT IN OVEN AND COOKTOP PROVISION - PROVISION ONLY - ELECTRICAL ONLY 27Sep23 Note:	
1 - KITCHEN - VALANCE LIGHTING - LED LIGHTING 27Sep23 Note: INCLUDING ADDITIONAL CABINET AREA	

CONSTRUCTION SUMMARY

Red Oaks - Roundel Homes Inc.

PURCHASERS: Man Yue WAN and Hou Yun Elsa KWAN

TEL: RES.: 647-970-6599

LOT / PHASE	REG. PLAN #	HOUSE TYPE		
65 / 2	65M-4737	Glenrowan 3 Elev 3		

1 - PLUG - ELECTRICAL PLUG - FOR BAR FRIDGE
27Sep23 Note: SEE SKETCH FOR LOCATION

1 - FAN - BATHROOM EXHAUST FAN - ENERGY STAR 80 CFM - IN LIEU OF STANDARD FAN
04May23 Note: MASTER ENSUITE
ENSUITE 2/3
ENSUITE 4

5 - SWITCH - DIMMER SWITCH IN LIEU OF EXISTING SWITCH - PRICE IS EACH
04May23 Note: KITCHEN
FAMILY ROOM
DINING ROOM
MAIN HALLWAY
MASTER BEDROOM

6 - POT LIGHT - LED - SECOND FLOOR INSTALLATION
04May23 Note: SEE SKETCH

30 - POT LIGHT - LED - FIRST FLOOR INSTALLATION- SEE SKETCH FOR LOCATIONS

* AS PER PURCHASERS REQUEST- POTLIGHTS IN DINING ROOM, FAMILY AND MASTER BEDROOM- TO BE AS CLOSE TO PERIMETER WALLS AS POSSIBLE- IF CONSTRUCTION PERMITS- SEE SKETCH
04May23 Note:

1 - PLUG - ELECTRICAL PLUG - TO BE INSTALLED OVER FIREPLACE
04May23 Note:

1 - PLUG - ELECTRICAL PLUG - ADD TO ISLAND
04May23 Note:

3 - PLUG - ELECTRICAL PLUG WITH GFI - NEXT TO TOILET
04May23 Note: MASTER ENSUITE
ENSUITE 2/3
ENSUITE 4

1 - RELOCATE STANDARD KITCHEN LIGHT TO BE CENTERED OVER ISLAND
04May23 Note:

1 - PLUG - ELECTRICAL PLUG WITH GFI AND SWITCH - FOR FESTIVE LIGHTING
04May23 Note: @ PORTICO

1 - ELECTRIC VEHICLE ROUGH-IN PROVISION ONLY FOR FUTURE ELECTRIC CAR (CONDUIT FROM BASEMENT INTO JUNCTION BOX IN GARAGE WITH PULL STRING, NO WIRE)
04May23 Note:

FIREPLACE AND ACCESSORIES

1 - GAS LINE ROUGH-IN FOR BARBECUE - FIRST FLOOR
04May23 Note:

1 - GAS LINE ROUGH-IN FOR STOVE (INCLUDES ELECTRICAL OUTLET) - FIRST FLOOR
04May23 Note:

HARDWOOD FLOORING

1 - HARDWOOD - GROUP C SERIES 6 1/2 INCH - - UPPER HALL
27Sep23 Note:

CONSTRUCTION SUMMARY

Red Oaks - Roundel Homes Inc.

PURCHASERS: Man Yue WAN and Hou Yun Elsa KWAN

TEL: RES.: 647-970-6599

LOT / PHASE 65 / 2	REG. PLAN # 65M-4737	HOUSE TYPE Glenrowan 3 Elev 3		
-----------------------	-------------------------	----------------------------------	--	--

1 - HARDWOOD - GROUP C SERIES 6 1/2 INCH - IN LIEU OF 3 1/4 INCH NATURAL RED OAK - - FIRST FLOOR IN STANDARD HARDWOOD AREAS
27Sep23 Note:

HEATING AND AIR CONDITIONING

1 - HUMIDIFIER
04May23 Note:

PLUMBING

1 - MOEN- TUB FAUCET - TWO HANDLE ROMAN TUB FAUCET WITH HAND SHOWER T944/9796 -CHROME FINISH
28Sep23 Note: MASTER ENSUITE
EVA T944/9796 -CHROME FINISH

1 - KITCHEN - ADD BAR SINK AND FAUCET - SEE SKETCH
04May23 Note: TECO SINK #201
MOEN ARBOR BAR FAUCET (CHROME) #5995

3 - MOEN CHATEAU POSI-TEMP TUB/SHOWER FAUCET WITH 3 FUNCTION TRANSFER VALVE/TRIM AND SLIDE BAR WITH HAND SHOWER – CHROME TL183EP/U361CI/UT2721/3669EP/A725/62320
04May23 Note: PRICE INCLUDES TO TESTER

MASTER ENSUITE
ENSUITE 2/3
ENSUITE 4

2 - HOSE BIB - EXTERIOR FROST FREE
04May23 Note:

1 - WATER LINE FOR FRIDGE - ROUGH-IN ONLY
04May23 Note:

1 - TUB TO SHOWER CONVERSION - 5 FOOT SHOWER WITH SLIDING GLASS CHROME DOORS IN LIEU OF TUB
04May23 Note: ENSUITE 2/3

PROMOTIONAL

1 - LESS CREDIT FROM PURCHASER EXTRA SHEET IN OFFER
04May23 Note:

STAIRS AND RAILINGS

1 - STAINED STAIRS – STANDARD STAIRCASE - PRICE IS PER SET
27Sep23 Note:

EXTRAS AS PER OFFER

The Vendor agrees that notwithstanding any other term or provision in this Agreement included in the Purchase Price and in addition to those items detailed in Schedule GP to the Agreement of Purchase and Sale, the Purchaser is entitled to a credit of Ten
Worksheet Note:

10 foot ceiling height on Main Floor. The Purchaser acknowledges that as a result of the increased ceiling height from the Vendor's standard ceiling height, various modifications to the interior and exterior of the dwelling unit may be made, including
Worksheet Note:

Purchasers:Man Yue WAN & Hou Yun Elsa KWAN

Property: 65

Telephone Res. / Bus: (647) 970-6599 /

Project: Roundel Homes Inc.

Decor Advisor: Giulia Di Girolamo

Model and Elevation: Glenrowan 3 Elev 3

Lock Date: 27-Sep-23

27-Sep-23

Plan #: 65M-4737

1. Cabinetry

	Style and Colour	Hardware
Kitchen / Breakfast	SENOSAN - 85384 MISTY GREY	464SA
Laundry Room	ELISSE	Standard
Powder Room	MONACO- 350 PLATINUM SILVER	464SA
Master Ensuite Bathroom	MONACO- 350 PLATINUM SILVER	464SA
Ensuite Bath - Bedroom 2/3	MONACO- 350 PLATINUM SILVER	464SA
Ensuite Bath - Bedroom 4	MONACO- 350 PLATINUM SILVER	464SA
Stove Opening	 36" COOKTOP	NOTE: If not specified, opening will be set to builder's standard opening of approximately 30" width
Fridge Opening	STANDARD	NOTE: If not specified, opening will be set to builder's standard opening of approximately 37" width x 74" height

** Refer to Construction Summary

2. Counters

	Counter	Edge	Niche
Kitchen / Breakfast	QUARTZ-MISTRAL	#360 EDGE	
Laundry Room	N/A		
Powder Room	LAMINATE-PORTICO MARBLE 7735-58		
Master Ensuite Bathroom	LAMINATE-PORTICO MARBLE 7735-58		QUARTZ-MISTRAL
Ensuite Bath - Bedroom 2/3	LAMINATE-PORTICO MARBLE 7735-58		
Ensuite Bath - Bedroom 4	LAMINATE-PORTICO MARBLE 7735-58		
Kitchen Backsplash	N/A		

** Refer to Construction Summary



Initials: _____

Purchasers:	Man Yue WAN & Hou Yun Elsa KWAN	Property:	65
Telephone Res. / Bus:	(647) 970-6599 /	Project:	Roundel Homes Inc.
Decor Advisor:	Giulia Di Girolamo	Model and Elevation:	Glenrowan 3 Elev 3
Lock Date:	27-Sep-23	27-Sep-23	Plan #: 65M-4737

3. Ceramic Flooring

Entrance Vestibule	TILE- AXIS BIANCO 12X24- INSTALL TILE IN A STAGGERED PATTERN	At a 45
Main Hall	HARDWOOD	
Kitchen / Breakfast	TILE- AXIS BIANCO 12X24- INSTALL TILE IN A STAGGERED PATTERN	
Laundry Room	TILE- AXIS BIANCO 12X24	
Powder Room	TILE- AXIS BIANCO 12X24	
Master Ensuite Bathroom	TILE-IROC WHITE 12X24- INSTALL TILE IN A STAGGERED PATTERN	
Ensuite Bath - Bedroom 2/3	TILE-FORM LIGHT GREY 12X12	
Ensuite Bath - Bedroom 4	TILE-FORM LIGHT GREY 12X12	

** Refer to Construction Summary **UPGRADE GROUT #50 - TITANIUM**

4. Ceramic Wall Tile

Master Ensuite Bathroom	Selection	Describe
Tub Deck Wall	N/A	
Shower Stall	TILE-IROC WHITE 12X24	INSTALL TILE IN A STAGGERED PATTERN
Bathtub Enclosure Walls	N/A	
Ensuite Bath - Bedroom 2/3	TILE-SILVIA WHITE 8X16	
Ensuite Bath - Bedroom 4	TILE-SILVIA WHITE 8X16	
Kitchen Backsplash	N/A	

** Refer to Construction Summary - **UPGRADE GROUT #50 - TITANIUM**

5. Trim Carpentry

Interior Doors	CARRARA-SMOOTH
Interior Trim	As Per Construction Specifications

** Refer to Construction Summary

6. Plaster Mouldings and Medallions

Entrance Vestibule			Kitchen/Breakfast		
Main Hall			Den/Library		
Living Room			Lower Landing		
Dining Room					
Family Room					

** Refer to Construction Summary

Signature

Initials: _____

Purchasers:Man Yue WAN & Hou Yun Elsa KWAN

Property: 65

Telephone Res. / Bus: (647) 970-6599 /

Project: Roundel Homes Inc.

Decor Advisor: Giulia Di Girolamo

Model and Elevation: Glenrowan 3 Elev 3

Lock Date: 27-Sep-23

27-Sep-23

Plan #: 65M-4737

7. Other Flooring

Main Hall	HARDWOOD-MIRAGE-FLAIR COLLECTION-SNOWDRIFT-WHITE OAK CHARACTER BRUSHED-6 1/2"-DURAMATT
Living Room	N/A
Dining Room	HARDWOOD-MIRAGE-FLAIR COLLECTION-SNOWDRIFT-WHITE OAK CHARACTER BRUSHED-6 1/2"-DURAMATT
Family Room	HARDWOOD-MIRAGE-FLAIR COLLECTION-SNOWDRIFT-WHITE OAK CHARACTER BRUSHED-6 1/2"-DURAMATT
Den / Library / Study	N/A
Basement Landing(If Applies)	N/A
Lower Landing (If Applies)	HARDWOOD-MIRAGE-FLAIR COLLECTION-SNOWDRIFT-WHITE OAK CHARACTER BRUSHED-6 1/2"-DURAMATT
Upper Landing	HARDWOOD-MIRAGE-FLAIR COLLECTION-SNOWDRIFT-WHITE OAK CHARACTER BRUSHED-6 1/2"-DURAMATT
Upper Hall	HARDWOOD-MIRAGE-FLAIR COLLECTION-SNOWDRIFT-WHITE OAK CHARACTER BRUSHED-6 1/2"-DURAMATT
Master Bedroom	LAMINATE-LEXINGTON-BRUSSELS OAK-TL-LW1316
Bedroom #2	LAMINATE-LEXINGTON-BRUSSELS OAK-TL-LW1316
Bedroom #3	LAMINATE-LEXINGTON-BRUSSELS OAK-TL-LW1316
Bedroom #4	LAMINATE-LEXINGTON-BRUSSELS OAK-TL-LW1316
Bedroom #5	N/A
Underpad	Standard <input type="checkbox"/> Upgrade N/A

** Refer to Construction Summary

8. Railings and Pickets

Railing Type	AS PER CONSTRUCTION SPECIFICATIONS	Colour	MIRAGE-WHITE OAK-SNOWDRIFT
Picket Type	AS PER CONSTRUCTION SPECIFICATIONS	Colour	MIRAGE-WHITE OAK-SNOWDRIFT
Stringer / Riser	AS PER CONSTRUCTION SPECIFICATIONS	Colour	MIRAGE-WHITE OAK-SNOWDRIFT
Treads	AS PER CONSTRUCTION SPECIFICATIONS	Colour	MIRAGE-WHITE OAK-SNOWDRIFT
Red Oak Stairs as Per Vendor's Standard			

** Refer to Construction Summary THE STAIN COLOURS OR FINISH AVAILABLE ON RISERS, TREADS, PICKETS AND RAILS (STAIRCASES), WILL NOT BE AN EXACT MATCH TO PREFINISHED HARDWOOD OR LAMINATE FLOORS.

9. Wall Paint Flat Finish

Main & Upper Hall	22 WARM GREY	Master Bedroom	22 WARM GREY
Living Room	N/A	Bedroom #2	22 WARM GREY
Dining Room	22 WARM GREY	Bedroom #3	22 WARM GREY
Kitchen / Breakfast	22 WARM GREY	Bedroom #4	22 WARM GREY
Family Room	22 WARM GREY	Bedroom #5	N/A
Powder Room	22 WARM GREY	Master Ensuite	22 WARM GREY
Laundry Room	22 WARM GREY	Ensuite Bath - Bedroom 2/3	22 WARM GREY
Den/Library	N/A	Ensuite Bath - Bedroom 4	22 WARM GREY
Trim & Door Paint-Semi Gloss	BIRCH WHITE		

** Refer to Construction Summary

Purchasers:Man Yue WAN & Hou Yun Elsa KWAN

Property: 65

Telephone Res. / Bus: (647) 970-6599 /

Project: Roundel Homes Inc.

Decor Advisor: Giulia Di Girolamo

Model and Elevation: Glenrowan 3 Elev 3

Lock Date: 27-Sep-23

27-Sep-23

Plan #: 65M-4737

10. Fireplace

	Living Room			Family Room			Other Room - Specify		
	Purchased	As Per Plan	N/A	Purchased	As Per Plan	N/A	Purchased	As Per Plan	N/A
	<input type="radio"/>	<input type="radio"/>	<input checked="" type="radio"/>	<input type="radio"/>	<input checked="" type="radio"/>	<input type="radio"/>	<input type="radio"/>	<input type="radio"/>	<input checked="" type="radio"/>
Fireplace Type				As Per Construction Specifications					
Mantle Type				MANTLE M2-STANDARD					
Colour / Stain				BIRCH WHITE					
Surround				BIANCO					
Hearth				NO					

** Refer to Construction Summary

11. Air Conditioning

Air Conditioning NO

Comment

** Refer to Construction Summary

12. General Comments

** Refer to Construction Summary

Disclaimers and Notes

- 1) Colours of all materials are as close as possible to builder's selection, but not necessarily identical due to variances in manufacturing.
- 2) Any extras listed above are null and void unless accompanied by a separate invoice/amendment. Said invoice must be paid in full.
- 3) The Purchaser agrees that this colour selection is final and that no changes will be permitted, unless required by the Vendor.
- 4) The Purchaser acknowledges reading and accepting document which contains other miscellaneous disclaimers.
- 5) In the event of a conflict between the Standard Features schedule of the Agreement of Purchase and Sale and the Interior Colour Scheme, the Interior Colour Scheme shall prevail.

Signature:

Date: Sept 27, 2023

Signature: _____

Date: _____

LOT #65

☆ Pts to be as close to covered box as possible

Glenrowan 3

ELEV. 2 & 3 - 2,932 sq. ft.

11 POTS on 11 sq. ft. of open area.

☆ Add bar sink + faucet

→ Add plug

→ relocate std. light

Electric vehicle (conduit)

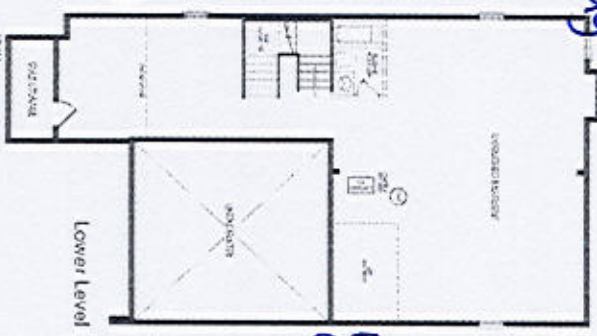

5 spots on 1 dimmer switch

- delete std. light

* Smoke ceilings first + Second Floor
* Gas line r/i for stove
* Humidifier
* Waterline r/i for fridge

Festive plug →

44

MAY 3/23

6 pots on 1 dimmer switch → add gfci plug

Shampoo niche 14" x 20"

☆ Pts to be as close to walls as possible

Convert tub to shower
add gfci plug

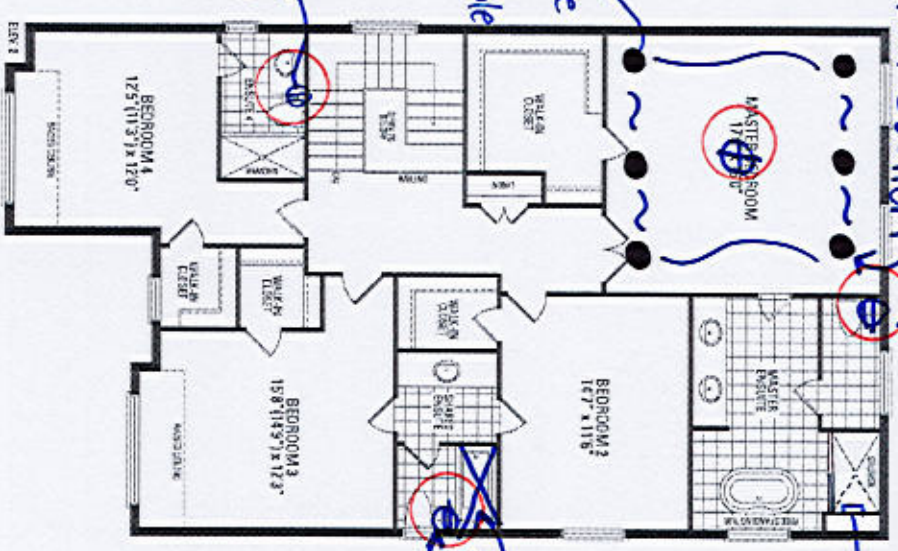

Orientation of home may be reversed and purchaser agrees to accept the same. Steps and porches may vary at any exterior entrance ways due to grading variance. Actual usable floor space may vary from the stated floor areas. All renderings are artist's concept. Dimensions, specifications and architectural detailing subject to modifications. Roofline and adjoining model types may vary due to string. E. & O. E. June 2022

THIS LAYOUT CONTAINS EXTRAS
THAT ARE NOT PART OF CONTRACT

PROTOTYPE FOR EXTRAS

PROTOTYPE FOR EXTRAS

- upgrade 3 cabinetry:

- Light valance

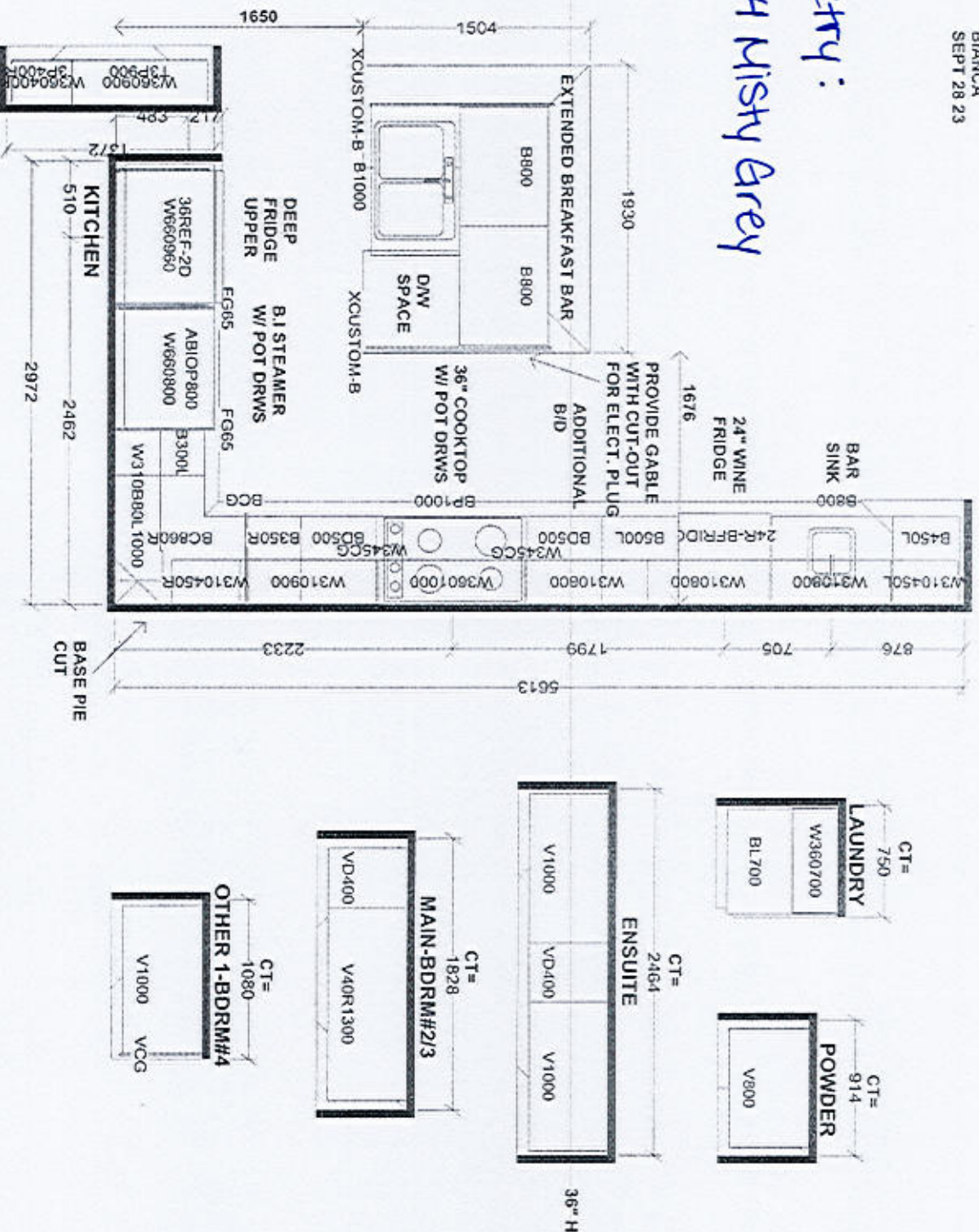

Seiba Industries, Inc.

Job # _____

Job description is the intellectual property of Seiba Industries, Inc. and shall not be reproduced or copied without written permission or a signed release is applicable for fees that Seiba paid for job order placed.

W WIDTH _____ W HGHT _____ W CNT _____

FLOOR HGHT _____ DOOR HGHT _____

SCT CENT _____ 2X4 _____ VENT BOX COVER _____

DESIGNER: KS
DATE: JUNE 7 21

JOB NUMBER: _____
BUILDER: GREENPARK
SITE: ROUND, Richmond Hill
MODEL: GLENROWAN 3X EL 1,2,3
LOT #: 65

LOT # 65 - Roundel

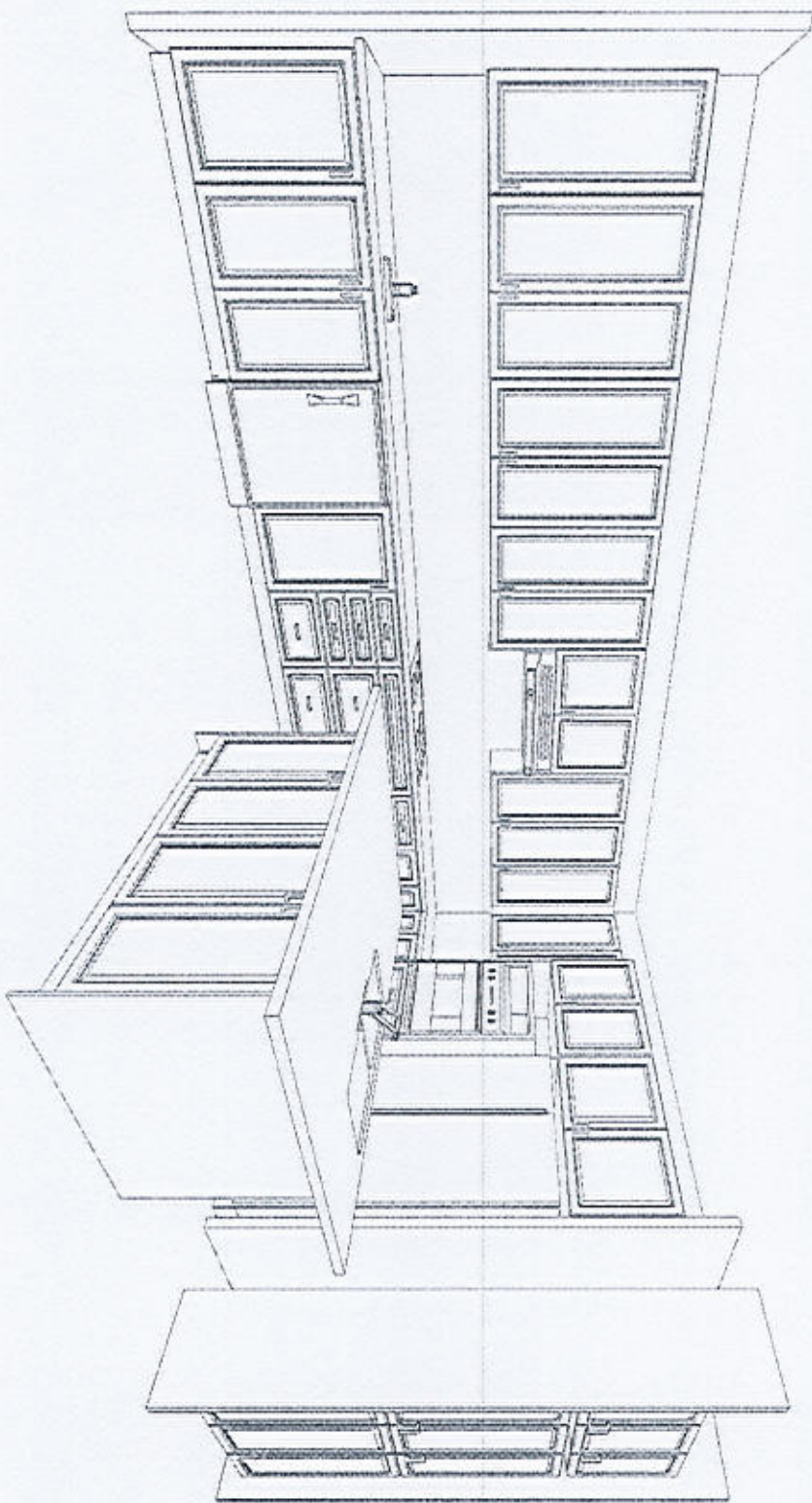

This drawing is the intellectual property of
SELBA INDUSTRIES INC. and is an
artistic
interpretation of the general
appearance of the design. It is
not meant to be an exact rendition.



Designed: 9/28/2023
Printed: 9/28/2023

ROUNDEL PH2 LOT 65 SEPT 28 23

LAYOUT

Drawing #: 1

36" Induction Cooktop

Benchmark® Series – Black with Stainless Steel Frame NITP660SUC



NITP660SUC
Black with Stainless
Steel Frame

Also available in:
Frameless NITP660UC

FlexInduction® cooktop
allows you to place your
cookware wherever you
want on the flexible
cooking zone.

Features & Benefits

FlexInduction® – provides
even more flexibility by
combining two cooking
zones into one larger zone

12" dual-ring center
cooking zone for large pots
and pans

PowerMove™ – divides
FlexInduction® into 3
preset power level zones.
Simply move the cookware
to change the power level

Home Connect™ – the
easy way to connect your
smart device with your
Bosch cooktop

Element Performance

Power of Full Zone Left & Right heating element	3,300 W
Power of Full Zone Left & Right heating element (in boost)	3,600 W
Power of Front Left heating element	2,200 W
Power of Front Left heating element (in boost)	3,600 W
Power of Back Left heating element	2,200 W
Power of Back Left heating element (in boost)	3,600 W
Power of Center heating element	3,300 / 2,200 W
Power of Center heating element (in boost)	3,600 / 3,400 W
Power of Back Right heating element	2,200 W
Power of Back Right heating element (in boost)	3,600 W
Power of Front Right heating element	2,200 W
Power of Front Right heating element (in boost)	3,600 W
Burners with booster	All*

Element Size

Dimension of Front Left heating element	7" x 8"
Dimension of Back Left heating element	7" x 8"
Dimension of Center heating element	12", 9"
Dimension of Back Right heating element	7" x 8"
Dimension of Front Right heating element	7" x 8"

General Properties

Home Connect™ (Wi-Fi Enabled)	Yes
Controls	PreciseSelect® Touch

Technical Details

Watts	12,000 W
Circuit breaker	50 A
Volts	208-240 V
Frequency	60 Hz
Plug type	No plug
Power cord length	37"
Energy source	Electric

Dimensions & Weight

Overall appliance dimensions (HxWxD)	4 1/8" x 37" x 21 1/4"
Required cutout size (HxWxD)	4 1/8" x 34 7/8" x 20"
Minimum distance from counter front	2 1/4"
Minimum distance from rear wall	2"
Net weight	53 lbs

Accessories—Optional



HEZ390210
8" AutoChef® pan



HEZ390220
9" AutoChef® pan



HEZ390230
10" AutoChef® pan



HEZ390512
Tepanyaki



HEZ9GR37UC
17" Non-Stick Induction Grill



Home Connect

*For 36" model Boost function may be used simultaneously in 3 zones only. See User Manual.

Accessories: To purchase Bosch accessories, cleaners & parts please visit www.bosch-home.com/us/store or call 1-800-944-2904 (Mon to Fri 5 am to 6 pm PST, Sat 6 am to 3 pm PST).

Notes: All height, width and depth dimensions are shown in inches. BSH reserves the absolute and unrestricted right to change product materials and specifications, at any time, without notice. Consult the product's installation instructions for final dimensional data and other details prior to making cutout.

Warranties: Please see Use & Care manual or Bosch website for statement of limited warranty.

For more information on our entire line of products, go to www.bosch-home.com/us or call 1-800-944-2904

© BSH Home Appliances Corporation. All rights reserved. Bosch is a registered trademark of Robert Bosch GmbH.

6/22



36" Induction Cooktop

Benchmark® Series – Black with Stainless Steel Frame NITP660SUC



Installation Details

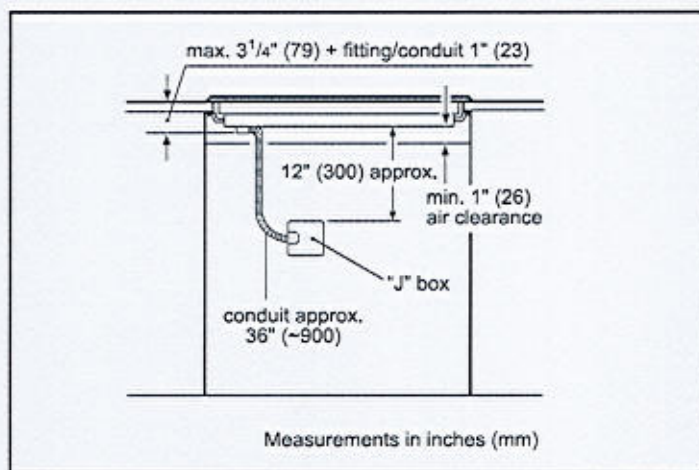
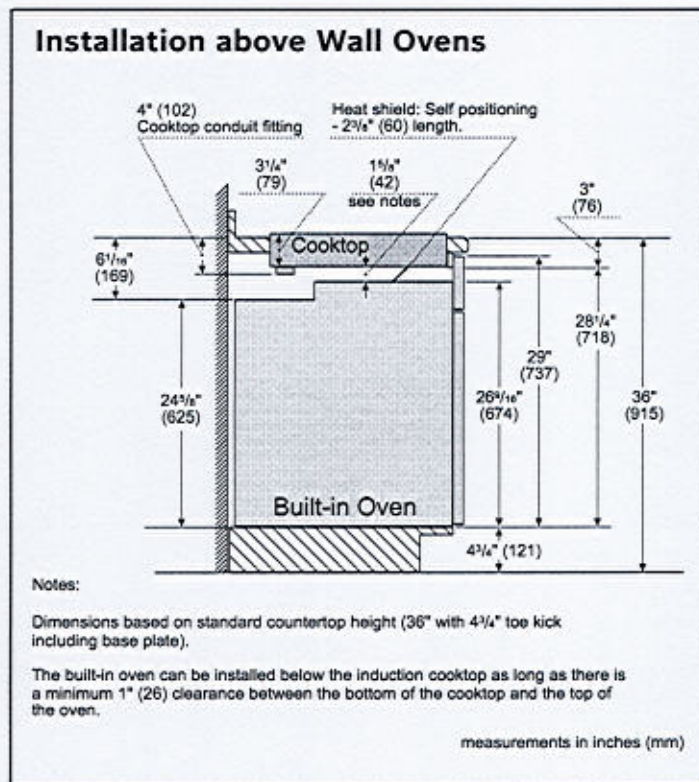
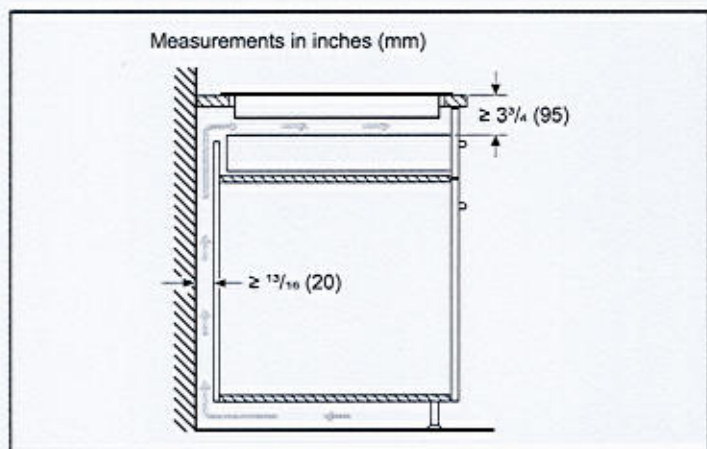
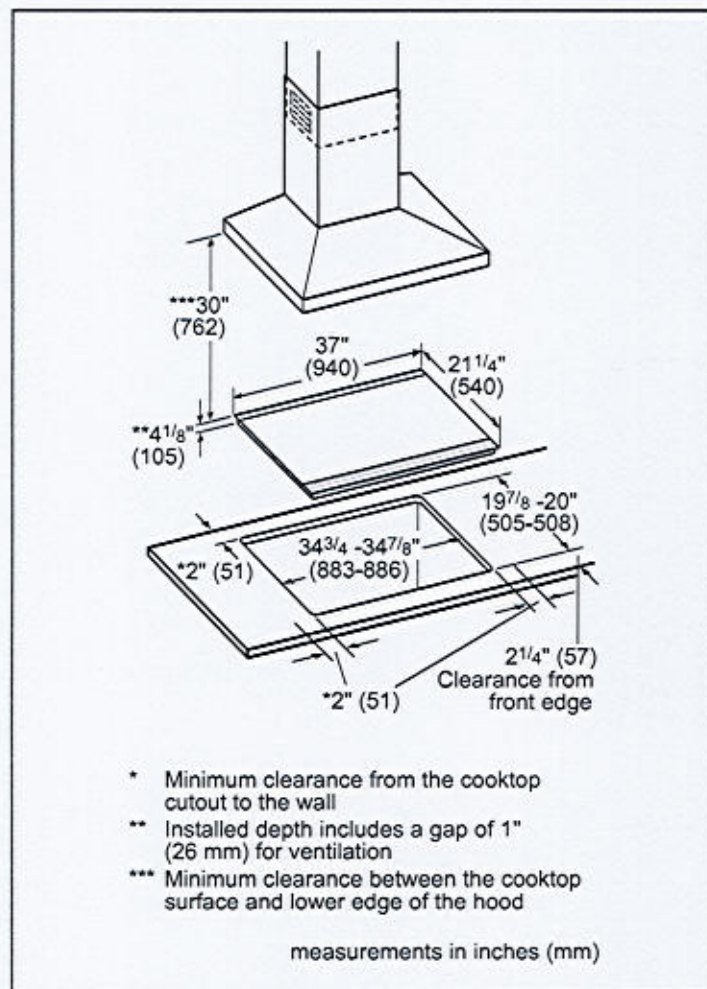

Accessories: To purchase Bosch accessories, cleaners & parts please visit www.bosch-home.com/us/store or call 1-800-944-2904 (Mon to Fri 5 am to 6 pm PST, Sat 6 am to 3 pm PST).

Notes: All height, width and depth dimensions are shown in inches. BSH reserves the absolute and unrestricted right to change product materials and specifications, at any time, without notice. Consult the product's installation instructions for final dimensional data and other details prior to making cutout.

Warranties: Please see Use & Care manual or Bosch website for statement of limited warranty.

For more information on our entire line of products, go to www.bosch-home.com/us or call 1-800-944-2904

© BSH Home Appliances Corporation. All rights reserved. Bosch is a registered trademark of Robert Bosch GmbH.

SL

MEDS301WS
30-INCH STEAM AND CONVECTION SINGLE
BUILT-IN OVEN
MASTERPIECE® SERIES

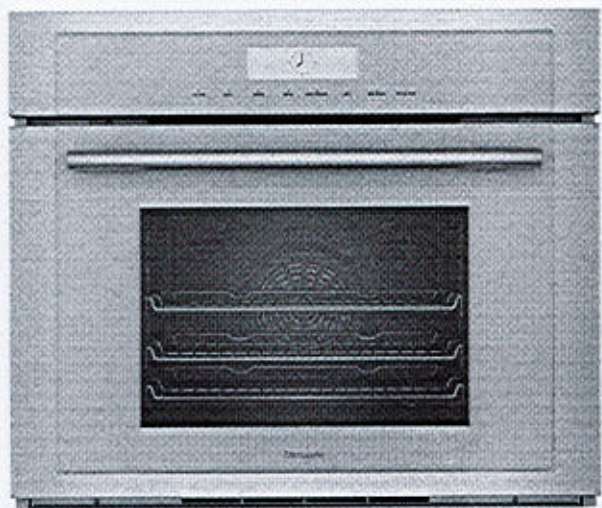

FEATURES & BENEFITS

- ★ - Large Steam and Convection cavity at 2.8 cu. ft.
- Designed for flexibility—standard or flush installation into kitchen cabinets
- Steam and Convection Cooking provides unrivaled taste and quality—food stays moist on the inside and is perfect on the outside
- Steam and Convection Oven offers passionate cooks more cooking solutions—Broil, Steam, True Convection, Steam and Convection
- Specially crafted gray glass on stainless steel for a luxurious look and finish



GENERAL PROPERTIES

Heating Modes	
(17) Bake, Broil, Roast, Convection Bake, Convection Broil, Convection Roast, Proof, Warm, Pizza, True Convection, Dehydrate, Speed Convection, Slow Roast, Steam, Steam Convection, Defrost, Reheat, Steam Programs	
Cleaning Type	Easy Clean / Ecolytic Clean
Telescopic Rack(s)	3
Illumination Type	LED
Interior Lights	3
Home Connect® (Wi-Fi Enabled)	Yes

OVEN PERFORMANCE

Convection Element	2,300 W
Bake Element	1,420 W
Broiler Element	3,050 W

TECHNICAL DETAILS

Watts	4,100 W
Circuit Breaker	20 A
Volts	240 / 208 V
Frequency	60 Hz
Plug Type	Fixed Connection, No Plug
Conduit	50" 3-Wire
Energy Source	Electric
Installation Type	Non-Plumbed

DIMENSIONS & WEIGHT

Oven Cavity Size	2.8 cu. ft.
Overall Appliance Dimensions (HxWxD)	25 13/16" x 29 3/4" x 23 7/16"
Dimensions with Storage Drawer SDS30WC	29" x 29 3/4" x 24 1/2"
Trim Overlaps (Top – Sides – Bottom)	3/8" to 1 5/16" – 9/16" – 0"
Required Cutout Size (HxWxD) – Standard Installation	24 1/2" – 25 7/16" x 28 1/2" x 23 1/2"
Standard Installation with Storage Drawer SDS30WC	27 5/8" – 28 5/8" x 28 1/2" x 23 1/2"
Required Cutout Size (HxWxD) – Flush Installation	25 15/16" x 30" x 24 1/2"
Flush Installation with Storage Drawer SDS30WC	29 1/8" x 30" x 24 1/2"
Overall Oven Interior Dimensions (HxWxD)	14 1/2" x 18 7/8" x 17 3/8"
Usable Oven Interior Dimensions (HxWxD)	11 1/2" x 15 1/2" x 15 5/8"
Net Weight	173 lbs

ACCESSORIES (INCLUDED)

3 Telescopic Racks, Multi-point Meat Probe, Broil Pan, 1 Large Pan, 1 Small Pan, 1 Large Perforated Pan, 1 Small Perforated Pan

WARRANTY

Limited Warranty Parts and Labor	2 Year
----------------------------------	--------

★ THERMADOR® EXCLUSIVE

†To be fully ADA compliant, these units must be installed according to ADA guidelines. Please check current ADA requirements for guidance on installation.

Handwritten signature or mark

MEDS301WS
30-INCH STEAM AND CONVECTION SINGLE
BUILT-IN OVEN
 MASTERPIECE® SERIES



30-INCH STEAM AND CONVECTION SINGLE OVEN

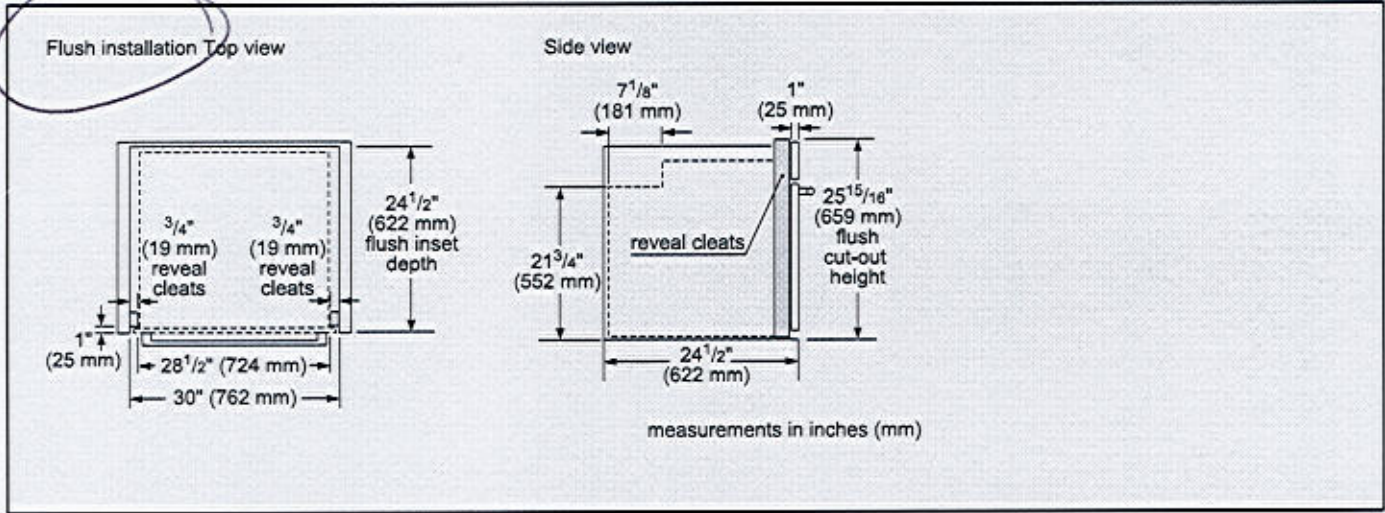
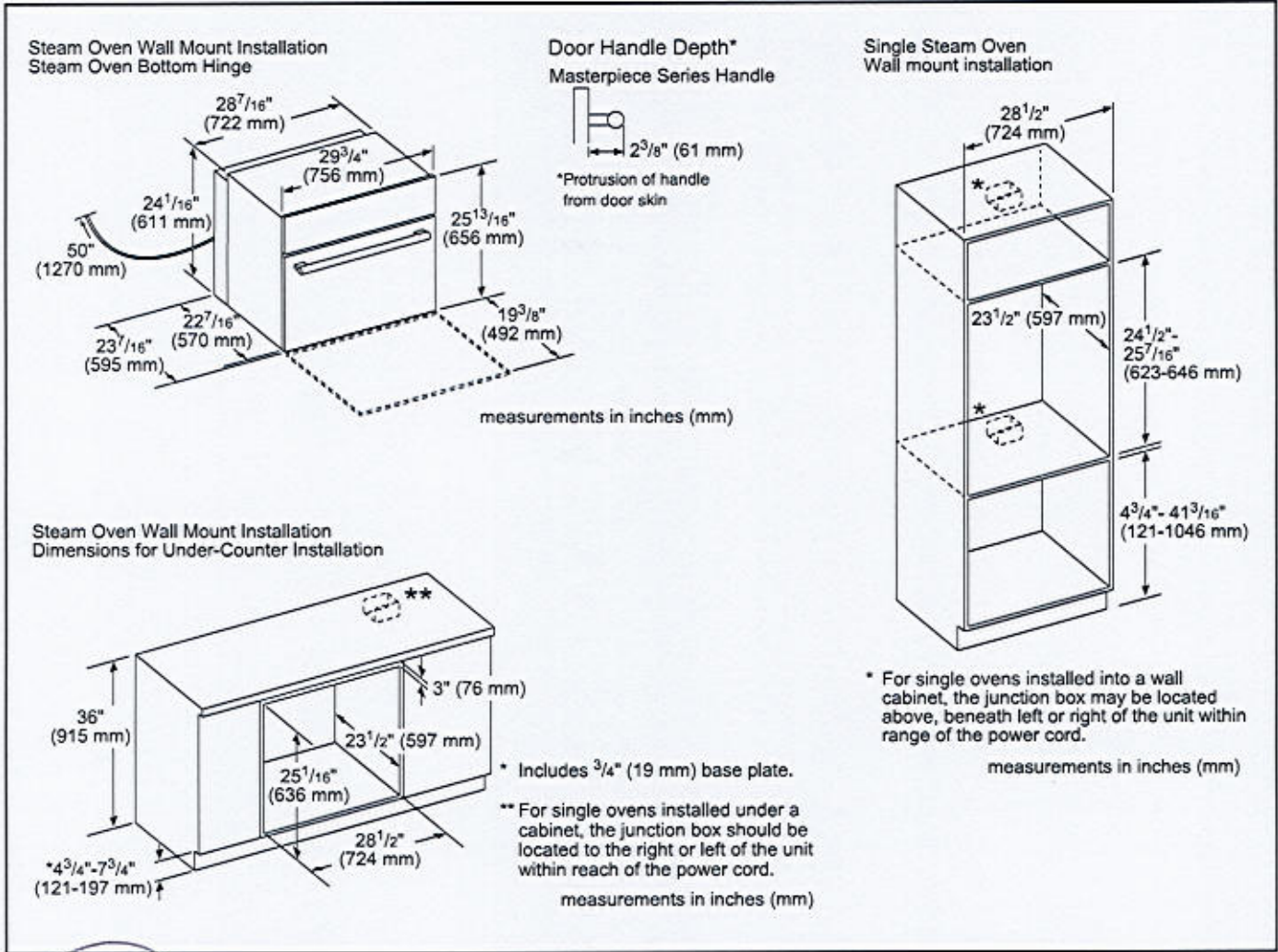

Handwritten signature

MEDS301WS
30-INCH STEAM AND CONVECTION SINGLE
BUILT-IN OVEN
MASTERPIECE® SERIES



INSTALLATION DETAILS

SIDE-BY-SIDE INSTALLATION – TOP VIEW

Standard

IMPORTANT: When installing an oven in combination, a minimum distance between the ovens is required. Refer to the oven installation manual for all other measurements.

measurements in inches (mm)

NOTE: Conventional ovens with a serial number beginning with "FD009" require accessory kit TWO30YS for Standard or Flush side-by-side installation with another oven or with any other approved product. This kit must be purchased separately and installed prior to installing the oven in the cabinetry. Refer to the Oven Installation Guide for additional information.

Flush

measurements in inches (mm)

Combination Type	A Left reveal cleat	B Right reveal cleat	C cut-out width	D cut-out width
Flush Bottom hinge	3/4" (19 mm)	3/4" (19 mm)	29 1/4" (743 mm)	29 1/4" (743 mm)
Flush Side Hinge (Left)	1 1/2" (38 mm)	N/A*	30" (762 mm)	N/A*
Flush Side Hinge (Right)	N/A*	1 1/2" (38 mm)	N/A*	30" (762 mm)

*Installation not recommended

measurements in inches (mm)

THERMADOR SIDE-BY-SIDE BUILT-IN OVEN
COMBINATION GUIDE

The following **OVENs** are approved to be installed side-by-side in combination and the installation has been certified by CSA. This guide is only effective with the use of the Thermador built-in oven side-by-side accessory kit TWO30YS. The built-in oven side-by-side accessory kit is required for approved installation.

BUILT-IN OVENS	
Conventional Ovens*	Steam Ovens
ME301WS	MEDS301WS
MED301WS	PODS301WS
MED301LWS	MEDS301WS w/ SDS30WC
MED301RWS	PODS301WS w/ SDS30WC
PO301W	
POD301W	
POD301LW	
POD301RW	



*Conventional ovens with a serial number beginning with "FD009" require accessory kit TWO30YS for side-by-side installation with another oven or in combination with any other approved product. All parts in the kit may not be required. Refer to the Oven Installation Guide for additional information.

The following **OVENs** and **DRAWERs** are approved by BSH Home Appliances Corporation to be installed in combination. These products, identified in the table below, may be installed in combination with other cooking units. The suitability of the combination has not been evaluated by CSA.

BUILT-IN OVENS			
Conventional Ovens*	Steam Ovens	Microwave Ovens	Speed Ovens
ME301WS	MEDS301WS	MB30WS	MC30WS
MED301WS	PODS301WS	MB30WP	MC30WP
MED301LWS	MEDS301WS w/ SDS30WC	MB30WS w/ SD30WC	MC30WS w/ SD30WC
MED301RWS	PODS301WS w/ SDS30WC	MB30WP w/ SD30WC	MC30WP w/ SD30WC
PO301W		MB30WS w/ WD30WC	MC30WS w/ WD30WC
POD301W		MB30WP w/ WD30WC	MC30WP w/ WD30WC
POD301LW			
POD301RW			



MEDS301WS
30-INCH STEAM AND CONVECTION SINGLE
BUILT-IN OVEN
MASTERPIECE® SERIES



30-INCH STEAM AND CONVECTION SINGLE OVEN WITH STORAGE DRAWER SDS30WC

Steam Oven with Storage Drawer Wall Mount Installation

measurements in inches (mm)

Door Handle Depth*
Masterpiece Series Handle

*Protrusion of handle from door skin

Steam Oven with Storage Drawer Wall Mount Installation

* For single ovens installed into a wall cabinet, the junction box may be located above, beneath, left or right of the unit within reach of the power cord.

measurements in inches (mm)

Steam Oven with Storage Drawer Under-Counter Installation

* Includes 3/4" (19 mm) base plate.
** For single ovens installed under a cabinet, the junction box should be located to the right or left of the unit within reach of the power cord.

measurements in inches (mm)

Flush installation Top view

measurements in inches (mm)

Steam Oven with Storage Drawer – Side View

measurements in inches (mm)



MEDS301WS

30-INCH STEAM AND CONVECTION SINGLE BUILT-IN OVEN

MASTERPIECE® SERIES



30-INCH STEAM AND CONVECTION SINGLE OVEN UNDER SPEED OVEN OR MICROWAVE

Standard installation
30" speed oven or microwave above a steam oven

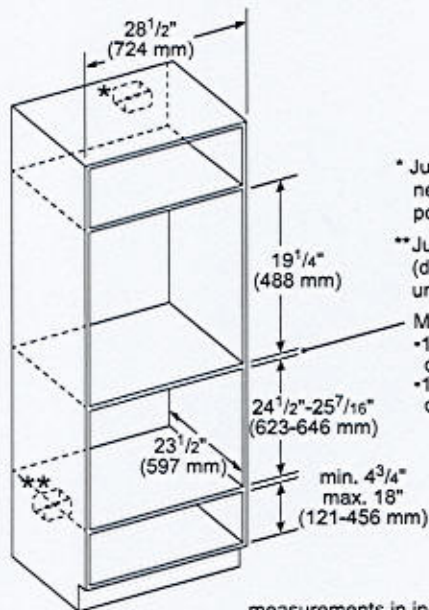

- * Junction box may be located above or next to the unit within the reach of the power cable.
- ** Junction box may be located below (depending on space) or next to the unit within the reach of the power cable.
- Minimum dimensions between cut-outs:
 - 1" (25 mm) for wall steam oven cut-out height of 25 7/16" (646 mm).
 - 1 1/8" (48 mm) for wall steam oven cut-out height of 24 1/2" (623 mm).

measurements in inches (mm)

Flush installation
Speed oven or microwave above a 30" single Steam oven

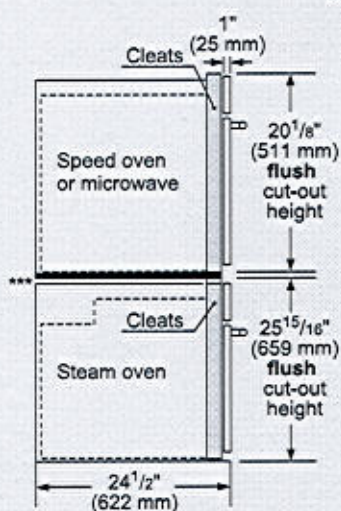

***Flush installation requires a base plate underneath the body: 30" products—Dimensions:
H 5/16" (8 mm) x W 28 1/2" (724 mm) x D 22 1/2" (571 mm)

minimum 1/2" (13 mm) required between cut-outs*

*IMPORTANT: Base has to be able to support the weight of the oven. Please check oven manual for minimum weight requirements.

measurements in inches (mm)

MEDS301WS
30-INCH STEAM AND CONVECTION SINGLE
BUILT-IN OVEN
MASTERPIECE® SERIES



INSTALLATION DETAILS

Standard installation
Single oven, double oven or combo oven over warming or storage drawer

28 1/2" (724 mm)
23 1/2" (597 mm)
9 1/4" (235 mm)
min. 4 3/4" max. 18" (121-457 mm)

* Wall oven junction box may be located above or to the right or left of the unit within reach of the power cable.
** Electrical hook-up may be located below (depending on space) or next to the drawer within reach of the power cable.
Minimum 3/4" (18 mm) required between cut-outs.

measurements in inches (mm)

Flush installation
Single oven over storage or warming drawer

Side view

1" (25 mm)
Cleats
Single oven cut-out height
9 9/16" (243 mm)
flush cut-out height
**24 1/2" (622 mm)

Single wall oven
*IMPORTANT: Base has to be able to support the weight of the oven. Please check oven manual for minimum weight requirements.
minimum 1/2" (13 mm) required between cut-outs*
Warming drawer
**For WD30W, the installed dimension may differ. This drawing based on a 3/4" (19 mm) thick custom panel.

measurements in inches (mm)

These warranties give you specific legal rights and you may have other rights that vary from state to state. Limited warranty from date of delivery. For complete warranty details, refer to your Use & Care manual, or ask your dealer.

Specifications are for planning purposes only. Refer to installation instructions and consult your countertop supplier prior to making counter opening. Consult with a heating and ventilation engineer for your specific ventilation requirements. For the most detailed information, refer to installation instructions accompanying product or write to Thermador indicating the model number. Specifications are correct at time of printing. Thermador reserves the right to change product specifications or design without notice. Some models are certified for use in Canada. Thermador is not responsible for products that are transported from the U.S. for use in Canada.

1 800 735 4328 | USA THERMADOR.COM | CANADA THERMADOR.CA | ©2023 BSH HOME APPLIANCES CORPORATION. ALL RIGHTS RESERVED.



24" Pocket Handle Dishwasher

500 Series – Stainless Steel SHP65CM5N



SHP65CM5N
Stainless Steel

Also available in:

White SHP65CM2N
Black SHP65CM6N

The AutoAir[®] drying option automatically releases the door at the end of the cycle to let moisture escape and fresh air in for drier dishes.

Features & Benefits

So quiet at 44 dBA, InfoLight[®] shines on the floor so you know the dishwasher is running.

The Flexible 3rd Rack with fold down sides adds 30% more* loading area, perfect for utensils and ramekins.

Enhance your cleaning experience with Wi-Fi enabled Home Connect[®]. Access additional wash cycles and options or choose the right one for your needs using Smart Cycle.

General Properties	
Number of wash cycles	5 + 3 additional in Home Connect [®]
Number of options	3 + 2 additional in Home Connect [®]
dBA	44
Wash system	PrecisionWash [®]
Drying system	AutoAir [®]
Third rack	Flexible 3rd Rack
Rack adjustability	Rackmatic [®]
Tub material	Stainless Steel
Control type	Touch Controls
Concealed water heating element	Yes
Leak protection system	24/7 AquaStop [®]
Home Connect [®] (WiFi enabled)	Yes
NSF [®] -certified** sanitize option	Yes
Water softener	No
Five-level wash	Yes
Child Lock button suspension	No
Anti-Fingerprint Finish	Yes
Special features	InfoLight [®] , AutoAir [®] Option
Efficiency	
Water usage per cycle	3.2 gal
ENERGY STAR [®] certified	Yes
Total annual energy consumption	240 kWh
Capacity	
Number of place settings	16

Home Connect



Technical Details	
Watts	1440 W
Current	12 Amps
Volts	120 V
Frequency	60 Hz
Power cord full length	67"
Power cord install length from edge of unit when facing the door	Left – 45" Right – 56"
Minimum water pressure	14 lb/sin
Length outlet hose	78 3/4"

Dimensions & Weight	
Overall appliance dimensions (HxWxD)	33 7/8" x 23 9/16" x 23 3/4"
Required cutout size (HxWxD)	33 7/8" x 24" x 24"
Adjustable feet	Yes
Net weight	85 lbs

Accessories—Optional	
Junction Box	SMZPCJB1UC
Junction Box + Supply Hose Kit	SMZ3IN1UC
Bosch Dishwasher Water Supply Hose	SMZSH1ABUC
Drain Hose Extension Kit	SGZ1010UC
Silverware Basket	SMZ4000UC
Dishwasher Accessory Kit	SMZ5000
Anti-Tarnish Silverware Cassette	SMZ5002UC
Edge Protector + Power Cord Clip Install Kit	SMZEPCC1UC

*Compared to a Bosch dishwasher with 2 racks.

**Certification to NSF/ANSI Standard 184 for residential dishwashers.

Accessories: To purchase Bosch accessories, cleaners & parts please visit www.bosch-home.com/us/store or call 1-800-944-2904 (Mon to Fri 5 am to 6 pm PST, Sat 6 am to 3 pm PST).

Notes: All height, width and depth dimensions are shown in inches. BSH reserves the absolute and unrestricted right to change product materials and specifications, at any time, without notice. Consult the product's installation instructions for final dimensional data and other details prior to making cutout.

Warranties: Please see Use & Care manual or Bosch website for statement of limited warranty.

For more information on our entire line of products, go to www.bosch-home.com/us or call 1-800-944-2904

© BSH Home Appliances Corporation. All rights reserved. Bosch is a registered trademark of Robert Bosch GmbH.

8/23

24" Pocket Handle Dishwasher

500 Series – Stainless Steel SHP65CM5N



Installation Details

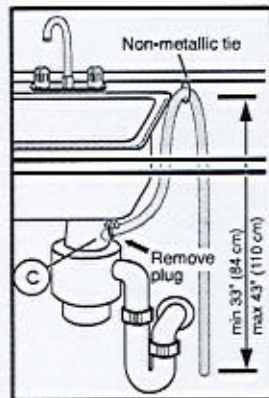
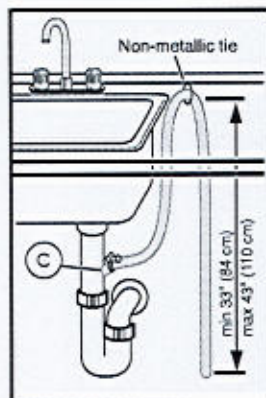

Note: Plumbing installations will vary - refer to local codes. Drain hose included is 79" (201 cm) and can be extended to a maximum of 155 3/4" (396 cm).

Always use the approved drain hose extension kit (SGZ1010UC).

Ensure a portion of the drain hose is raised between min. 33" (84 cm) and max. 43" (110 cm) above the cabinet floor.

Accessories: To purchase Bosch accessories, cleaners & parts please visit www.bosch-home.com/us/store or call 1-800-944-2904 (Mon to Fri 5 am to 6 pm PST, Sat 6 am to 3 pm PST).

Notes: All height, width and depth dimensions are shown in inches. BSH reserves the absolute and unrestricted right to change product materials and specifications, at any time, without notice. Consult the product's installation instructions for final dimensional data and other details prior to making cutout.

Warranties: Please see Use & Care manual or Bosch website for statement of limited warranty.

For more information on our entire line of products, go to www.bosch-home.com/us or call 1-800-944-2904

© BSH Home Appliances Corporation. All rights reserved. Bosch is a registered trademark of Robert Bosch GmbH.

8/23

84

EBS51SS1

Beverage Center | SINGLE DOOR SINGLE ZONE



RISERVA - EBS51SS1 creates the dream conditions for your favorite seltzer drinks. This 24" undercabinet refrigerator has the capacity to fit up to 120 cans (12oz). Featuring 3 adjustable slide out Tempered Glass shelves, 304 Stainless Steel

frame with double layered UV resistant glass door and an exclusive concealed hinge design that delivers a more refined appear and tighter fit within cabinetry.

STORAGE CAPACITY

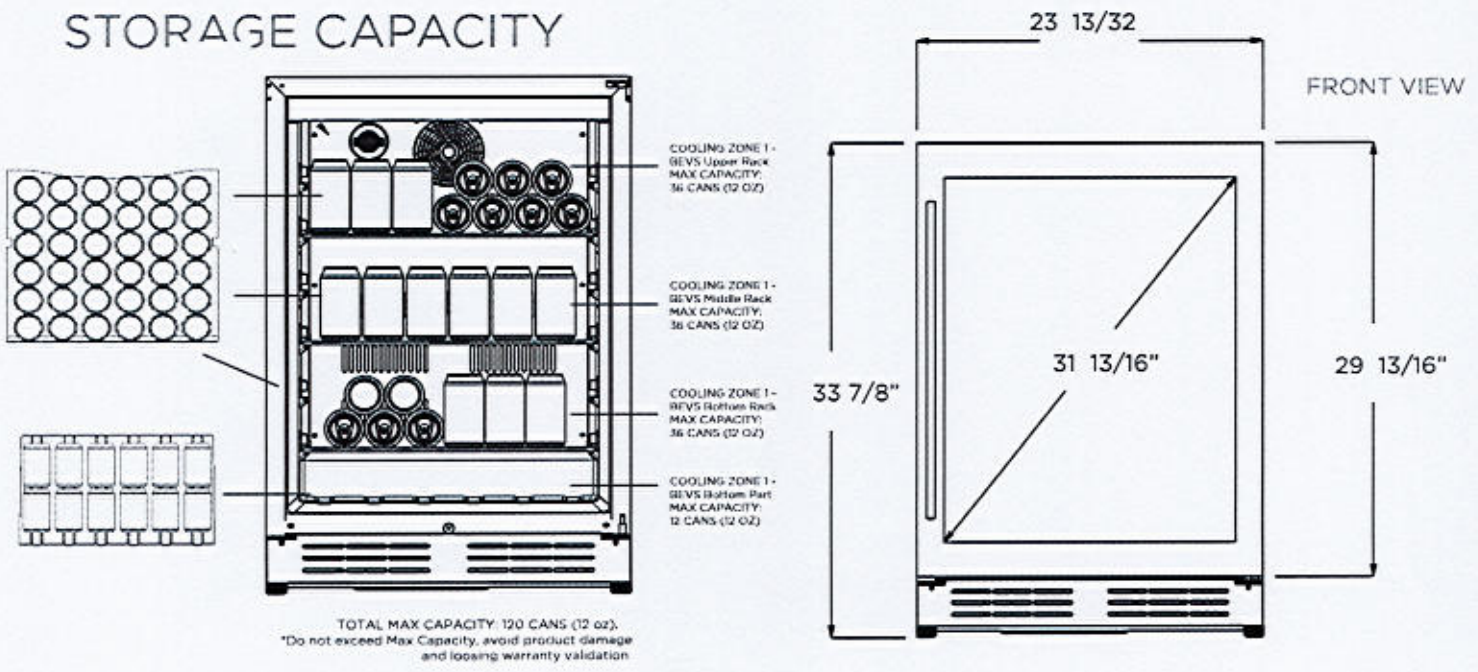

EBS51SS1

Beverage Center | SINGLE DOOR SINGLE ZONE



PRODUCT DESCRIPTION EBS51SS1		ELECTRICAL SPECIFICATIONS	
Width	24"	Compressor Brand	Embraco
Dimensions	23 13/32" W x 33 13/16" H x 23 5/8" D	Min. Circuit Required	15A
Weight	128 lbs	AC Power	110-120V/60HZ
Installation Type	Built-in and Free Standing	Amperage	0.95A
Refrigerant Type	R600a	Plug Type	B
Volume	4.8 cu ft (135L)	OTHER FEATURES	
Total Capacity	> 120 cans (12 oz cans)	Superior Full Extension Racks	
Temperature Range	34 to 65°F	Beverage Shelving made of Tempered Glass	
Sound Level	39 dBA	White LED Lights with 3 level KELVIN shade adjustment	
Door Finish	304 Stainless Steel + Glass	Anti Vibration Technology	
Cabinet Finish	Black	Double Panel Tempered Glass Door, UV coated	
Interior Finish	Black	Sabbath Mode	
Hinge Design	Concealed	Stylish look with tubular handle	
Lighting	3 Level White LED	Carbon Filter Replacement	L00114-1
Shelving	3 Adjustable - Slide Out-Tempered Glass Shelves with Metal front Trim (without rollers)	KITS	
		PRO Handle	KIT0175505
Controls	Capacitive Touch with Display with White Numbers		
DOOR		WARRANTY	
Door Handle	Tubular	2+1 Year Parts and In-Home Labor Warranty. Third year awarded after product registration on www.elica.com	
Door Glass	Tinted Dual Pane, Low-e Argon-filled		
Reversible Door	Yes		

LINE DRAWING

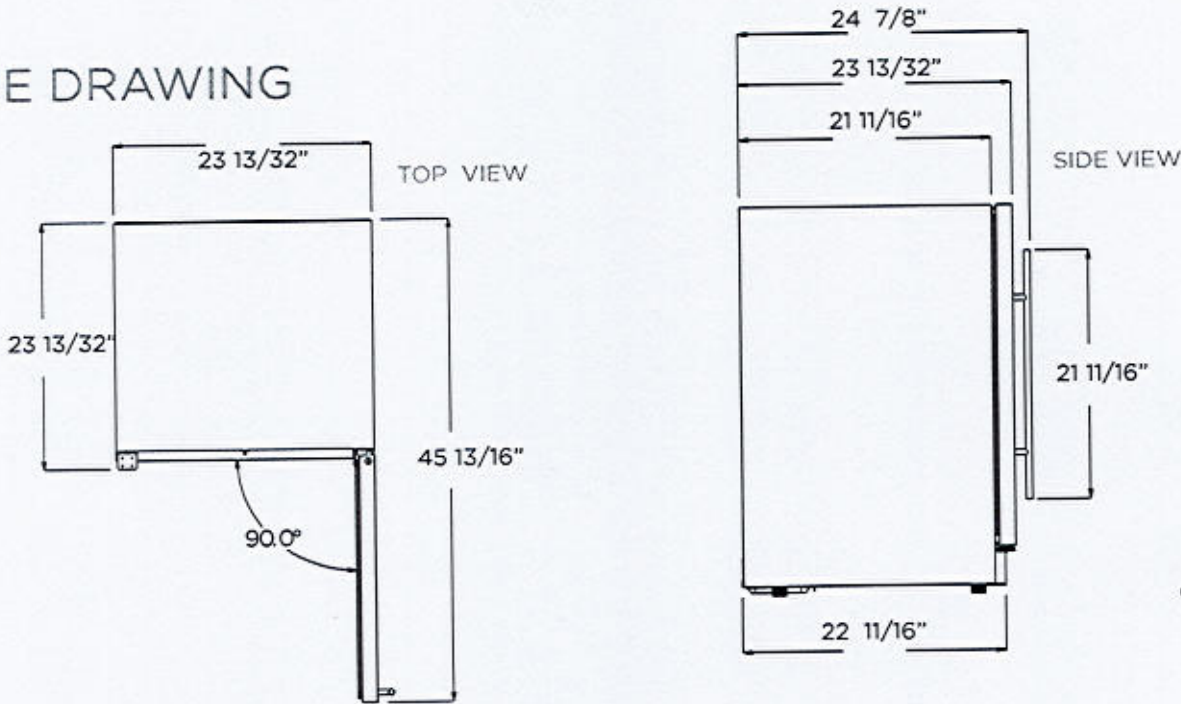

36" Counter-Depth 4-Door Refrigerator

800 Series – Stainless Steel B36CL80ENS

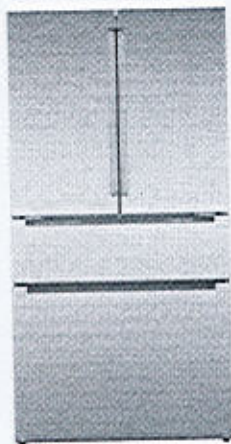

B36CL80ENS
Stainless Steel w/
Recessed Handles

Introducing the revolutionary, new FarmFresh System™, with four freshness technologies designed to work together to keep your food fresher, longer. Enjoy less food waste, new innovative features and more thoughtful design.

Features & Benefits

VitaFreshPro™ provides pre-programmed freshness settings to optimize temperature and humidity to keep meat, fish, and produce fresher, longer.

Interior Water Dispenser is thoughtfully placed inside for refreshing water at the touch of a button or a push of a nozzle.

FlexBar™ utilizes typically unused space in the upper refrigerator cavity.

Recessed handle provides flush design to match any sleek kitchen.

General Properties

Full 72" height and true counter depth for built-in appearance	Yes
Easy Clean Stainless Steel	Yes
Lighting	Recessed LED light bars
Number of compressors/evaporators	2 / 2
Defrost process refrigerator section	Frost-free
Number of shelves – refrigerator	5
Adjustable shelves – refrigerator	4 half-width
Shelf material – refrigerator	Tempered glass
Type of shelves – refrigerator	Frameless split shelves with metal trim
Flexible storage bar	FlexBar™
Gallon storage bins	2
Humidity control compartments	2
Full width temp. & humidity controlled drawer	VitaFreshPro™
Ice maker	Yes
Water filter	UltraClarityPro™
Internal water dispenser	Yes
Touch control panel	Yes
AirFresh® filter	Yes
FreshProtect™ ethylene filter	Yes
MultiAirFlow™	Yes
Stainless steel back wall	Yes
Defrost process freezer section	Automatic
Number of drawers – freezer	3
Wi-Fi enabled	Yes, Home Connect™ app

Capacity

Total capacity	20.5 cu. ft.
Refrigerator capacity	14.5 cu. ft.
Freezer capacity	6 cu. ft.

Technical Details

Current	15 A
Volts	115 V
Frequency	60 Hz
Power cord length	67"
Plug type	120V-3 prong

Dimensions & Weight

Appliance dimensions with hinges and doors (H x W x D)	72** x 35 5/8" x 28 3/4"
Appliance dimensions without hinges and doors (H x W x D)	71 1/2" x 35 5/8" x 24***
Required cutout size (H x W x D)	72" x 36" x 25"
Net weight	350 lbs

Efficiency

Energy consumption	568 kWh/yr
ENERGY STAR® qualified	Yes

Accessories

UltraClarityPro™ Water Filter: BORPLFTR55
Ethylene Filter Kit: FPETHKT50
Ethylene Filter Refill Kit: FPETHRF50
90 Degree Door Stopper: 10012733

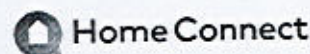

*When leveling legs are fully extended, add 5/8" to overall height, total 72 5/8".

**The cutout depth of 25" includes the required 1" airflow. The electrical covers on the back of unit do not require additional depth.

Accessories: To purchase Bosch accessories, cleaners & parts please visit www.bosch-home.com/us/store or call 1-800-944-2904 (Mon to Fri 5 am to 6 pm PST, Sat 6 am to 3 pm PST).
Notes: All height, width and depth dimensions are shown in inches. BSH reserves the absolute and unrestricted right to change product materials and specifications, at any time, without notice. Consult the product's installation instructions for final dimensional data and other details prior to making cutout.

Warranties: Please see Use & Care manual or Bosch website for statement of limited warranty.

For more information on our entire line of products, go to www.bosch-home.com/us or call 1-800-944-2904

© BSH Home Appliances Corporation. All rights reserved. Bosch is a registered trademark of Robert Bosch GmbH.

Handwritten signature/initials

36" Counter-Depth 4-Door Refrigerator

800 Series – Stainless Steel B36CL80ENS



Installation Details

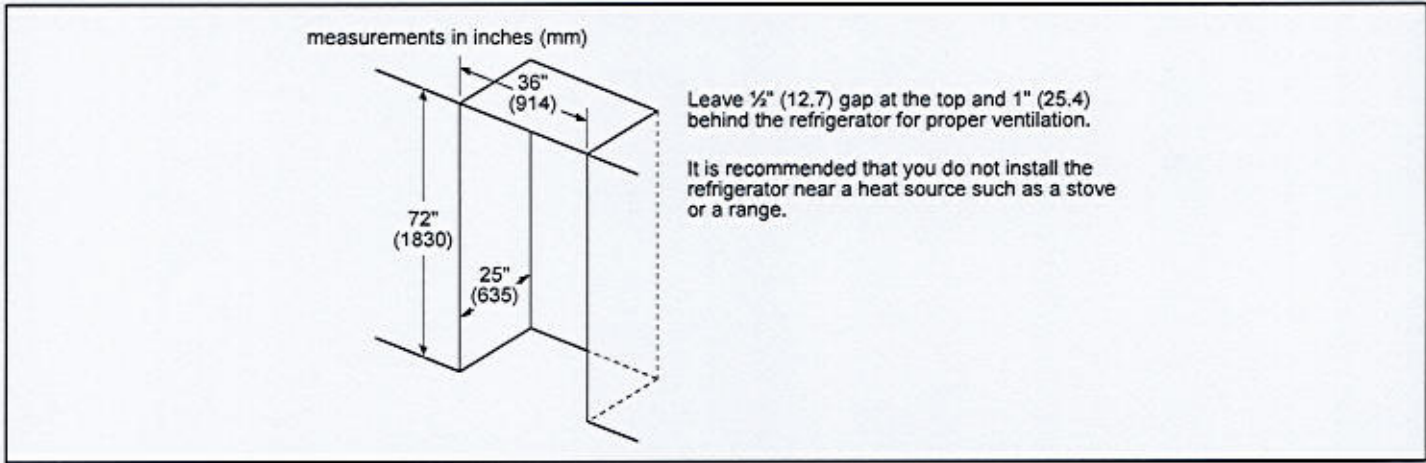
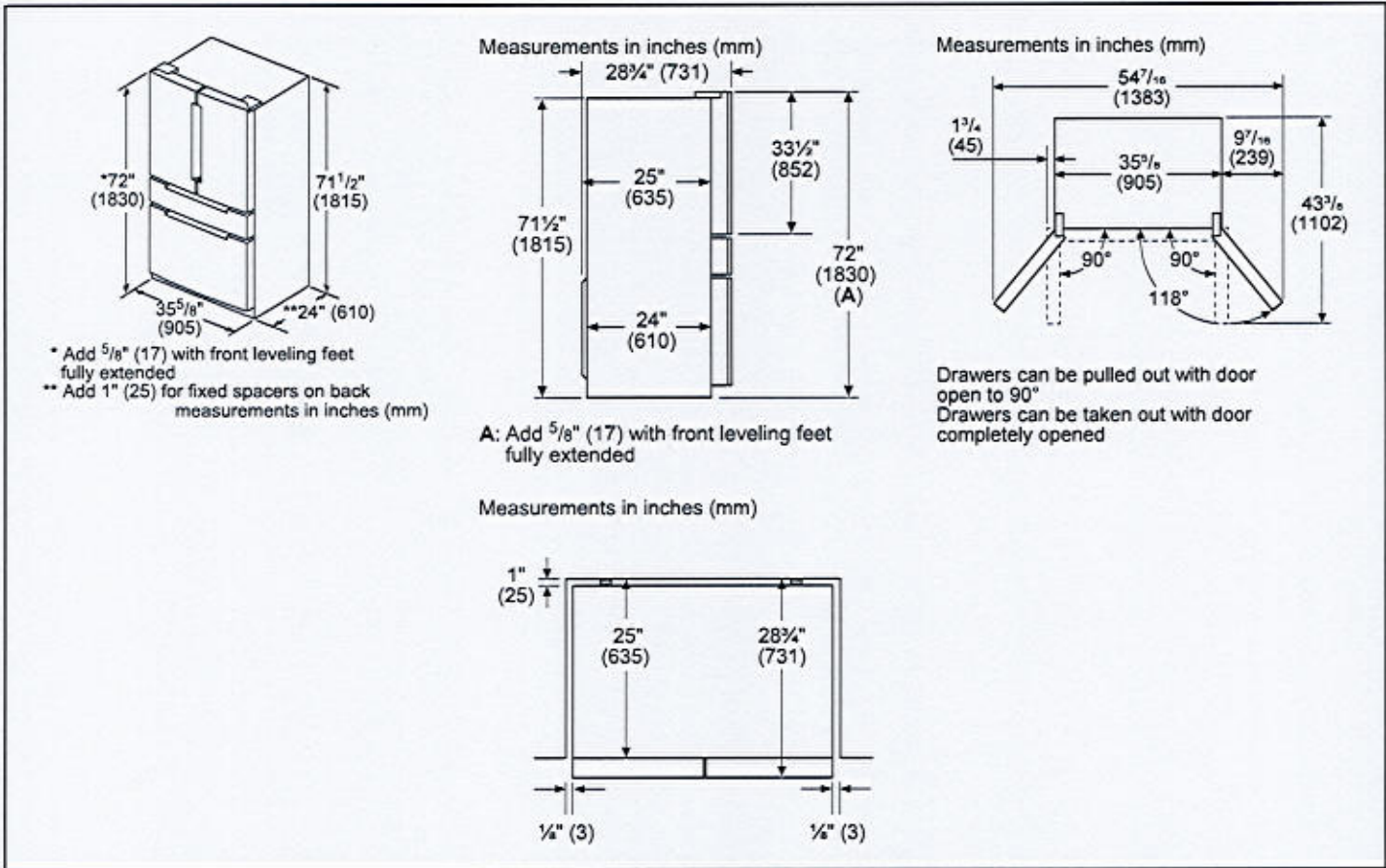

Accessories: To purchase Bosch accessories, cleaners & parts please visit www.bosch-home.com/us/store or call 1-800-944-2904 (Mon to Fri 5 am to 6 pm PST, Sat 6 am to 3 pm PST).
Notes: All height, width and depth dimensions are shown in inches. BSH reserves the absolute and unrestricted right to change product materials and specifications, at any time, without notice. Consult the product's installation instructions for final dimensional data and other details prior to making cutout.
Warranties: Please see Use & Care manual or Bosch website for statement of limited warranty.
For more information on our entire line of products, go to www.bosch-home.com/us or call 1-800-944-2904
© BSH Home Appliances Corporation. All rights reserved. Bosch is a registered trademark of Robert Bosch GmbH.

