

Appliance Specs
+ added gasline

CONSTRUCTION SUMMARY - PARTIAL ONLY

Palmetto - Zadorra Estates Corp.

PURCHASER: INVENTORY HOME_104

RECEIVED

NOV 13 2023

TEL:

LOT NUMBER	PHASE	HOUSE TYPE	REG. PLAN #		
104	1	Penrose 1 Elev 1			
INV#	QTY	EXTRA / CHANGE			

CABINETRY

29,440 08Nov23	1 - CABINETRY - KITCHEN - HARDWARE UPGRADE 2 Note:
29,440 08Nov23	1 - CABINETRY - KITCHEN - LIGHT VALANCE Note:
29,440 08Nov23	1 - CABINETRY - KITCHEN - UPGRADE 2 Note:
29,440 08Nov23	1 - CABINETRY - MASTER ENSUITE VANITY - UPGRADE 2 Note:
29,440 08Nov23	1 - CABINETRY - BEDROOM 2 ENSUITE VANITY - UPGRADE 2 Note:

CABINETRY ACCESSORIES

29,440 08Nov23	1 - KITCHEN CABINETRY BASE - PULLOUT RECYCLE 2 BIN - PRICE IS EACH Note:
29,440 08Nov23	1 - KITCHEN CABINETRY BASE - COOKTOP CABINET WITH POT DRAWERS (2 DRAWERS) - UPGRADE 2 Note36" COOKTOP
29,440 08Nov23	1 - KITCHEN CABINETRY - BUILT-IN MICROWAVE/OVEN COMBO WITH ONE POT DRAWER - UPGRADE 2 NoteSHIFT FRIDGE TO ACCOMODATE - SEE SKETCH
29,440 08Nov23	1 - KITCHEN CABINETRY UPPER - FULL DEPTH ABOVE FRIDGE UPPER WITH GABLES - 650MM DEEP - PRICE IS EACH Note:
29,440 08Nov23	1 - KITCHEN CABINETRY - BUILT-IN FRIDGE FEE - PRICE IS EACH Note:
29,440 08Nov23	1 - KITCHEN CABINETRY - APPLIANCE DOOR PANELS - FRIDGE DOOR PANELS - SUPPLY ONLY, INSTALLATION NOT INCLUDED, HARDWARE NOT INCLUDED - 30"-36" WIDE FRIDGES - UPGRADE 2 Note:
29,440 08Nov23	1 - KITCHEN CABINETRY - APPLIANCE DOOR PANELS - 24" DISHWASHER DOOR PANEL (SUPPLY ONLY, INSTALLATION NOT INCLUDED, HARDWARE NOT INCLUDED) - UPGRADE 2 Note:
29,440 08Nov23	1 - KITCHEN CABINETRY BASE - PULLOUT WIRE SPICE RACK - PRICE IS EACH Note:
29,440 08Nov23	2 - KITCHEN CABINETRY UPPER - GLASS DOOR - BEVELED - FINISHED INTERIOR - FITS TALL UPPER CABINETS - PRICE IS PER DOOR - UPGRADE 2 Note:
29,440 08Nov23	1 - KITCHEN HOOD CABINETS - CONTEMPORARY WOOD HOOD - UPGRADE 2 Note:

CONSTRUCTION SUMMARY - PARTIAL ONLY

Palmetto - Zadorra Estates Corp.

PURCHASER: INVENTORY HOME_104 TEL:

LOT NUMBER	PHASE	HOUSE TYPE	REG. PLAN #		
104	1	Penrose 1 Elev 1			

INV#	QTY	EXTRA / CHANGE	
------	-----	----------------	--

CABINETRY ACCESSORIES

29,440 08Nov23	1 - LAUNDRY CABINETRY - ADD ONE ADDITIONAL STANDARD SERIES LAUNDRY CABINET ABOVE WASHER/DRYER - SEE SKETCH Note:
-------------------	---

FIREPLACE AND ACCESSORIES

29,486 13Nov23	1 - GAS LINE ROUGH-IN FOR STOVE (INCLUDES ELECTRICAL OUTLET) - FIRST FLOOR Note:	
29,440 08Nov23	1 - CASTSTONE FIREPLACE MANTEL - AEQUALITAS 3 - WHITE Note:	

This Document is Extremely Time Sensitive - Printed 13 Nov 23 at 16:18

Full Spec Package

OSHAWA MODEL HOME

Zadorra Estates Corp., .

OSHAWA MODEL HOME

lot 104

OSHAWA, ON TBA TBA

(416) 798-7700

Contents	Page no.
KCGS556ESS KitchenAid Cooktop	3-7
KOCE500ESS KitchenAid Wall Oven	8-9
JB36NFXLE Jenn-Air Refrigeration 36" Panel-Ready Built-In Bottom-Freezer Refrigerator (Left-Hand Door Swing)	10-19
W10663562 Jenn-Air Accessory 36" Refrigerator Armoire Style Door Panel Kit, Obsidian	20-26
KDTF324PPA KitchenAid Dishwasher 44 dBA Panel-Ready Two-Rack Flush Dishwasher with Door-Open Dry System	27-30



Coast Appliances
coastappliances.com

Andrew Haidari
Commercial Sales Representative
905-303-6909

Inv **S03673840**
Version 4.4

Mon, Nov 13, 2023
3:59 PM EST

To ensure a smooth project it is the responsibility of the homeowner / purchaser of appliances for this project to share all the attached specifications to ensure the cabinet provider, contractor, or any other tradesperson have all the information required to complete their work accurately.

Specifications are subject to change. If any tradesperson has questions regarding the attached specifications please contact our sales associate.



enterprise.steelcod.com/sp/csta/999NVC2Z

Note about page numbers:
Because the original manufacturer's documents are not altered in any way, the page numbers displayed on the page may not correspond to the page number within this package.

All specifications are intended for initial planning purposes only.
Manufacturers reserve the right to change specifications at any time without notice. Always consult the installation instructions found on the manufacturer's website or included with the appliances before installation.

KCGS556ESS

36" 5-Burner Gas Cooktop

KitchenAid®

<http://www.kitchenaid.com>

Key Features:

- 20K BTU Professional Dual Ring Burner
- Even-Heat™ 6K BTU Simmer Burner
- CookShield Finish
- Electronic Ignition
- Full-Width Cast-Iron Grates
- Metal Control Knobs
- LP Conversion Kit Included

Product Dimensions:

- Height: 3 11/16
- Width: 36
- Depth: 21

Electrical Requirements:

15.

Additional Information:

- [Use And Care Guide](#)
- [Dimension Guide](#)
- [Installation Guide](#)
- [Warranty Certificate](#)

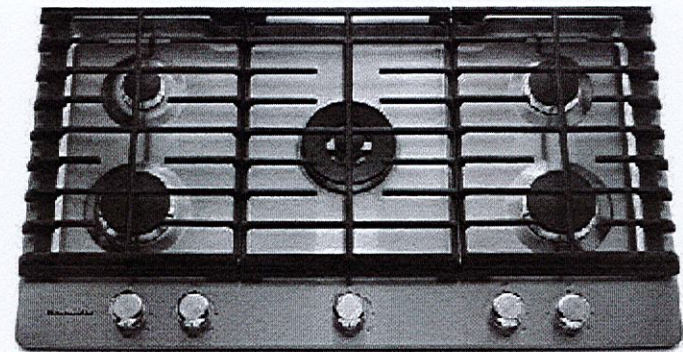

Available in:

● Stainless Steel

INVESTED
IN
AMERICA



©Registered trademark/TM Trademark of Whirlpool, U.S.A. © 2016 Whirlpool Corporation. All Rights Reserved.
All other trademarks are owned by their respective companies.
Because Whirlpool Corporation policy includes a continuous commitment to improve our products, we reserve the right to change materials and specifications without notice. We also reserve the right to discontinue or transition products without notice.
Manufacturer's Suggested Retail Price (MSRP) and Minimum Advertised Price (MAP) provided for reference purposes only. Dealer alone determines advertised and retail prices.
Created On: Friday, March 03, 2017 08:08:02

PRODUCT DIMENSIONS

KCGS550ESS and KCGS950ESS Models

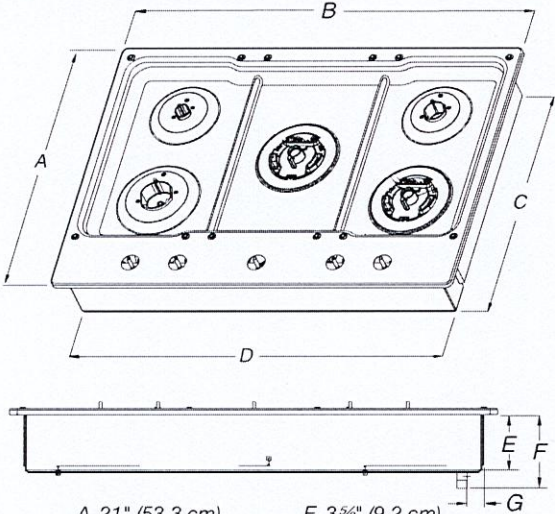

- A. 21" (53.3 cm)
- B. 30" (76.2 cm)
- C. 19 3/8" (49.2 cm)
- D. 28 3/8" (72.1 cm)
- E. 3 5/8" (9.2 cm)
- F. 4 5/16" (11.6 cm)
- G. 1 3/8" (3.4 cm)

KCGS556ESS and KCGS956ESS Models

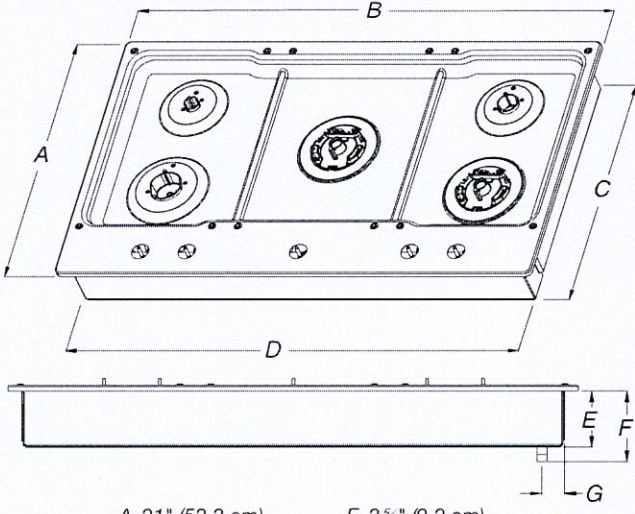

- A. 21" (53.3 cm)
- B. 36 1/4" (92.0 cm)
- C. 19 3/8" (49.2 cm)
- D. 34 3/8" (88.1 cm)
- E. 3 5/8" (9.2 cm)
- F. 4 5/16" (11.6 cm)
- G. 1 7/16" (3.6 cm)

All Other 30" (76.2 cm) Models

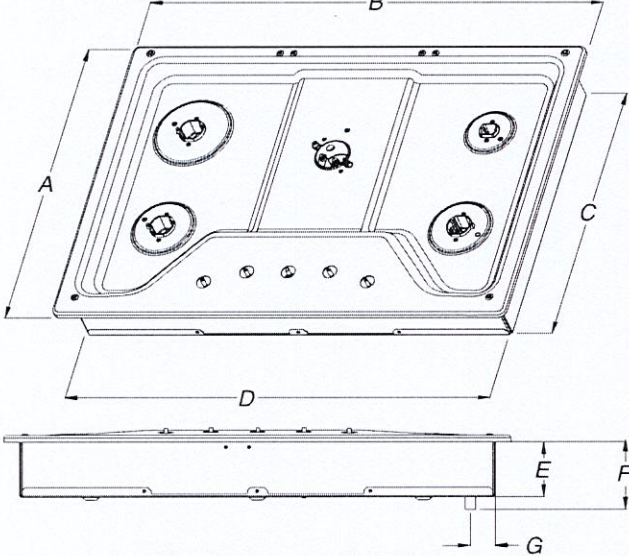

- A. 21" (53.3 cm)
- B. 30" (76.2 cm)
- C. 18 7/8" (48.0 cm)
- D. 28 3/8" (72.1 cm)
- E. 3 3/8" (8.6 cm)
- F. 4 1/8" (10.5 cm)
- G. 1 1/2" (3.8 cm)

All Other 36" (91.4 cm) Models

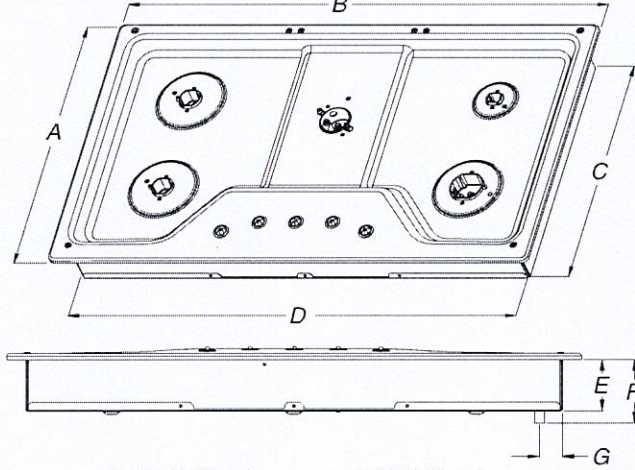

- A. 21" (53.3 cm)
- B. 36" (91.4 cm)
- C. 18 7/8" (48.0 cm)
- D. 33 3/4" (85.7 cm)
- E. 3 3/8" (8.6 cm)
- F. 4 1/8" (10.5 cm)
- G. 1 1/2" (3.8 cm)

CABINET DIMENSIONS

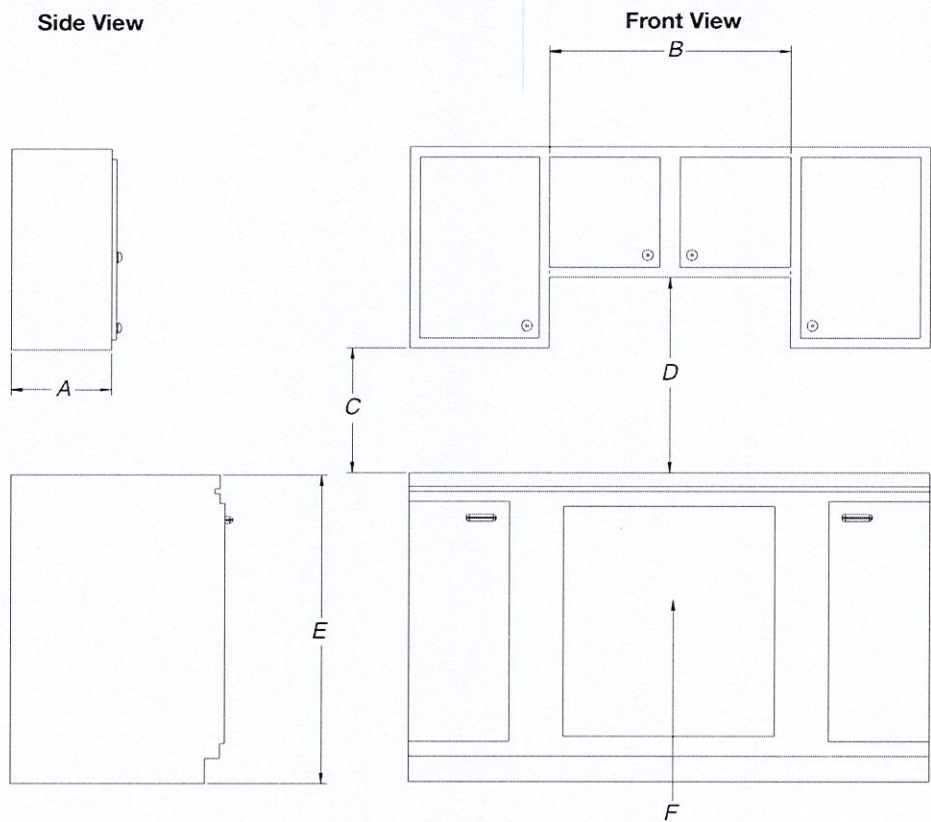

- A. 13" (33.0 cm) recommended upper cabinet depth.
- B. 30" (76.2 cm) for 30" models; 36" (91.4 cm) for 36" models.
- C. 18" (45.7 cm) minimum clearance from upper cabinet to countertop within minimum horizontal clearances to cooktop.
- D. 30" (76.2 cm) minimum clearance between top of cooktop platform and bottom of uncovered wood or metal cabinet. 24" [61 cm] minimum clearance if bottom of wood or metal cabinet is covered by not less than ¼" [0.6 cm] flame retardant millboard covered with not less than No. 28 MSG sheet steel, 0.015" [0.04 cm] stainless steel, or 0.024" [0.06 cm] aluminum or 0.020" [0.05 cm] copper
- E. 36" (91.4 cm) top of countertop to floor.
- F. Gas line opening - Wall: anywhere 5" (12.7 cm) below underside of countertop. Cabinet floor: anywhere within 6" (15.2 cm) of rear wall is recommended.

CABINET DIMENSIONS (cont.)

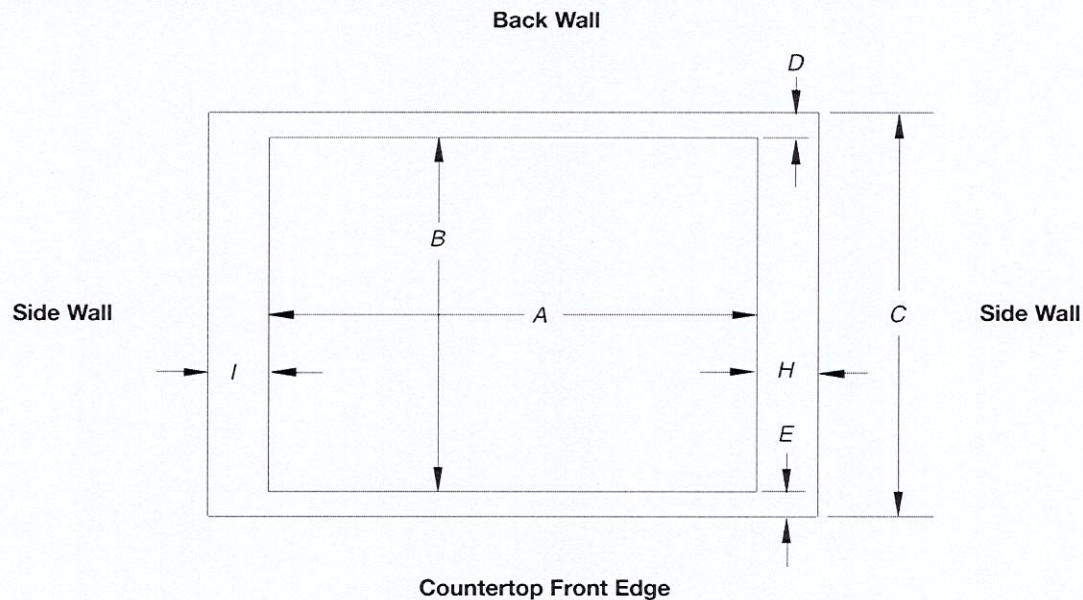

Cutout (Product Opening) Dimensions						
30" (76.2 cm) Models						
Models	A			B		
	Min	Recommended	Max	Min	Recommended	Max
KCGS550 and KCGS950	28 1/2" (72.4 cm)	28 7/8" (73.4 cm)	29 3/16" (74.3 cm)	19 1/2" (49.5 cm)	19 13/16" (50.2 cm)	20" (50.8 cm)
All Other 30" (76.2 cm) Models	28 1/2" (72.4 cm)	28 7/8" (73.4 cm)	29 3/16" (74.3 cm)	19" (48.3 cm)	19 1/2" (49.5 cm)	20" (50.8 cm)
36" (91.4 cm) Models						
KCGS556 and KCGS956	34 7/8" (88.4 cm)	35 3/16" (89.4 cm)	35 3/8" (90.3 cm)	19 1/2" (49.5 cm)	19 13/16" (50.2 cm)	20" (50.8 cm)
All Other 36" (91.4 cm) Models	33 3/8" (86.0 cm)	34 3/16" (87.0 cm)	35 1/4" (89.5 cm)	19" (48.3 cm)	19 1/2" (49.5 cm)	20" (50.8 cm)

Side Walls (Combustible Surfaces)	
Models	H and I
KCGS5 and KCGS9	H and I added together must be at least 48" (122.0 cm), with each side individually being at least 8" (20.3 cm).
KCGS350, KCGS356, MGC9536, WCG97US0, WCG97US6	H and I added together must be at least 48" (122.0 cm), with each side individually being at least 12" (30.5 cm).
All Other Models	Both have to be 8" (20.3 cm) or more.

Back Wall and Countertop Front Dimensions			
Models	C	D	E
KCGS550 and KCGS950	25" (63.5 cm)	2 7/8" (7.3 cm)	2 3/4" (6.9 cm)
All Other Models			3 1/8" (7.9 cm)

NOTES: After making the countertop cutout, some installations may require notching down the base cabinet side walls to clear the cooktop base. To avoid this modification, use a base cabinet with sidewalls wider than the cutout.

If cabinet has a drawer, a 4" (10.2 cm) depth clearance from the countertop to the top of the drawer (or other obstruction) in base cabinet is required. The drawer depth may need to be shortened to avoid interfering with the regulator.

IMPORTANT: If a built-in wall oven is to be installed below this cooktop, the grounded outlet and gas supply piping must be located in an adjacent cabinet.

This cooktop and its gas and electrical supply sources must be installed before the undercounter built-in wall oven is installed.

KOCE500ESS

KitchenAid®

30" Combination Wall Oven with Even-Heat™ True Convection (Lower Oven)

<http://www.kitchenaid.com>



Key Features:

- Even-Heat™ True Convection Oven (lower oven)
- Microwave Convection Cooking (upper oven)
- Professionally-Inspired Design
- Temperature Probe
- EasyConvect™ Conversion System
- 5.0 Cu. Ft. Total Capacity (lower oven)
- 1.4 Cu. Ft. Capacity (upper oven)
- Crispwave™ Microwave Technology and Crisper Pan (upper oven)
- SatinGlide™ Roll-Out Extension Rack (lower oven)

Product Dimensions:

Height: 42 1/2

Width: 30

Depth: 27 1/8

Electrical Requirements:

40 Amps.

Additional Information:

[Use And Care Guide](#)

[Dimension Guide](#)

[Installation Guide](#)

[Warranty Certificate](#)

Available in:

- Black
- Stainless Steel
- White

INVESTED
IN
AMERICA

®Registered trademark/TM Trademark of Whirlpool, U.S.A. © 2016 Whirlpool Corporation. All Rights Reserved.
All other trademarks are owned by their respective companies.
Because Whirlpool Corporation policy includes a continuous commitment to improve our products, we reserve the right to change materials and specifications without notice. We also reserve the right to discontinue or transition products without notice.
Manufacturer's Suggested Retail Price (MSRP) and Minimum Advertised Price (MAP) provided for reference purposes only. Dealer alone determines advertised and retail prices.
Created On: Monday, March 06, 2017 18:50:58

KitchenAid®

27" (68.6 cm) and 30" (76.2 cm) Electric Built-In Microwave/Oven Combination

PRODUCT MODEL NUMBERS

KEMS309E KOCE500E KOCE507E

ELECTRICAL CONNECTION

If codes permit and a separate ground wire is used, it is recommended that a qualified electrical installer determine that the ground path and the wire gauge are in accordance with local codes. Check with a qualified electrical installer if you are not sure the oven is properly grounded.

This oven must be connected to a grounded metal, permanent wiring system.

Be sure that the electrical connection and wire size are adequate and in conformance with the National Electrical Code, ANSI/NFPA 70-latest edition or CSA Standards C22.1-94, Canadian Electrical Code, Part 1 and C22.2 No. O-M91-latest edition, and all local codes and ordinances.

To properly install your oven, you must determine the type of electrical connection you will be using and follow the instructions provided for it here.

- Oven must be connected to the proper electrical voltage and frequency as specified on the model/serial/rating plate. See the following illustration.

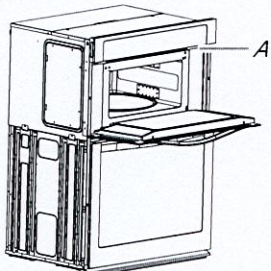

A. Model/serial/rating plate

- Models rated from 7.3 to 9.6 kW at 240 volts (5.4 to 7.4 kW at 208 volts) require a separate 40-amp circuit. Models rated at 4.8 kW and below at 240 volts (3.6 kW and below at 208 volts) require a separate 30-amp circuit.
- A circuit breaker is recommended.
- Connect directly to the fused disconnect (or circuit breaker box) through flexible, armored or nonmetallic sheathed, copper cable (with grounding wire). See "Make Electrical Connection" section.
- Flexible conduit from the oven should be connected directly to the junction box.
- Do not cut the conduit. The length of conduit provided is for serviceability of the oven.
- A UL listed or CSA approved conduit connector must be provided.
- If the house has aluminum wiring, follow the procedure below:
 1. Connect a section of solid copper wire to the pigtail leads.
 2. Connect the aluminum wiring to the added section of copper wire using special connectors and/or tools designed and UL listed for joining copper to aluminum.

Follow the electrical connector manufacturer's recommended procedure. Aluminum/copper connection must conform with local codes and industry accepted wiring practices.

For power requirements, refer to the following table.

Model	Voltage	Amperage (L1)*	Amperage (L2)*	Rating (W)
KOCE507E/KOCE500E	120/240	32	30	8000
KOCE507E/KOCE500E	120/208	30	28	6600

*Amperage values noted above are for information purposes only: the units are rated in watts.

PRODUCT DIMENSIONS

27" (68.6 cm) models

- A. 42⁹/₁₆" (108.0 cm) overall height
- B. 25⁷/₁₆" (64.6 cm) recessed width
- C. 41" (104.1 cm) recessed height
- D. 23¹/₄" (59.1 cm) max. recessed depth
- E. 27" (68.6 cm) overall width
- F. 48" (121.9 cm) flexible conduit length measured from the conduit clamp located at the rear of the oven. Do not remove the conduit clamp.

30" (76.2 cm) models

- A. 42⁹/₁₆" (108.0 cm) overall height
- B. 28⁷/₁₆" (72.3 cm) recessed width
- C. 41" (104.1 cm) recessed height
- D. 23¹/₄" (59.1 cm) max. recessed depth
- E. 30" (76.2 cm) overall width
- F. 48" (121.9 cm) flexible conduit length measured from the conduit clamp located at the rear of the oven. Do not remove the conduit clamp.

Cabinet Dimensions

27" (68.6 cm) models

- A. 27" (68.6 cm) min. cabinet width
- B. 1" (2.5 cm) top of cutout to bottom of upper cabinet door
- C. 19¹/₄" (48.9 cm) bottom of cutout to floor is recommended. 4"-19¹/₄" (10.2-48.9 cm) bottom of cutout to floor is acceptable.
- D. 25¹/₂" (64.8 cm) cutout width
- E. 1¹/₈" (3.8 cm) min. bottom of cutout to top of cabinet door
- F. 41⁹/₁₆" (105 cm)* recommended cutout height
- G. 24" (60.7 cm) cutout depth

30" (76.2 cm) models

- A. 30" (76.2 cm) min. cabinet width
- B. 1" (2.5 cm) top of cutout to bottom
- C. 19¹/₄" (48.9 cm) bottom of cutout to floor is recommended. 4"-19¹/₄" (10.2-48.9 cm) bottom of cutout to floor is acceptable.
- D. 28¹/₂" (72.4 cm) cutout width
- E. 1¹/₈" (3.8 cm) min. bottom of cutout
- F. 41⁹/₁₆" (105 cm)* recommended cutout
- G. 24" (60.7 cm) cutout depth

* **NOTE:** The cabinet height can be between 41" (104.1 cm) and 41¹/₂" (105.6 cm) for microwave/oven combination.

JB36NXXFXLE



36" Panel-Ready Built-In Bottom-Freezer Refrigerator (Left-Hand Door Swing)

<http://www.jennair.com>

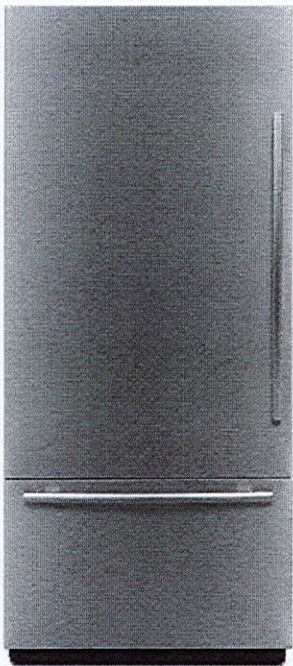

Key Features:

- Obsidian Interior
- Fully Flush, Fully Integrated Design
- Style with Custom Wood Panels or Suite-Coordinating Stainless Steel Panel Kits (not included)
- TwinFresh™ Climate Control System
- Multi-Point LED Theater Lighting
- Light-Guided Capacitive Touch Controls
- Soft-Close Crisper Drawers
- Elegance Shelving
- Produce Preserver
- FreshFlow™ Air Filter
- Variable Capacity Compressor
- Automatic Ice Maker with Storage Drawer

Product Dimensions:

Height: 83 1/8

Width: 35 3/4

Electrical Requirements:

20. 115 V.

Additional Information:

[Owners Manual](#)

[Dimension Guide](#)

[Installation Guide](#)

[Energy Guide](#)

[Warranty Certificate](#)

Available in:

 Panel Ready



©Registered trademark/TM Trademark of Whirlpool, U.S.A. © 2021 Whirlpool Corporation. All Rights Reserved.
All other trademarks are owned by their respective companies.
Because Whirlpool Corporation policy includes a continuous commitment to improve our products, we reserve the right to change materials and specifications without notice. We also reserve the right to discontinue or transition products without notice.
Manufacturer's Suggested Retail Price (MSRP) and Minimum Advertised Price (MAP) provided for reference purposes only. Dealer alone determines advertised and retail prices.
Created On: Monday, May 16, 2022 15:16:31



36" FULLY INTEGRATED BOTTOM FREEZER REFRIGERATORS

DETAILED PLANNING DIMENSIONS GUIDE

(BASE UNIT REQUIRES SUITE-COORDINATING FULL HEIGHT PANEL KIT OR CUSTOM PANELS AND HANDLES)

JB36NFXFRE, JB36NFXLE – 35¾" (W) x 82⅞" (H) x 24" (depth without door panel/handles)

PRODUCT DIMENSIONS

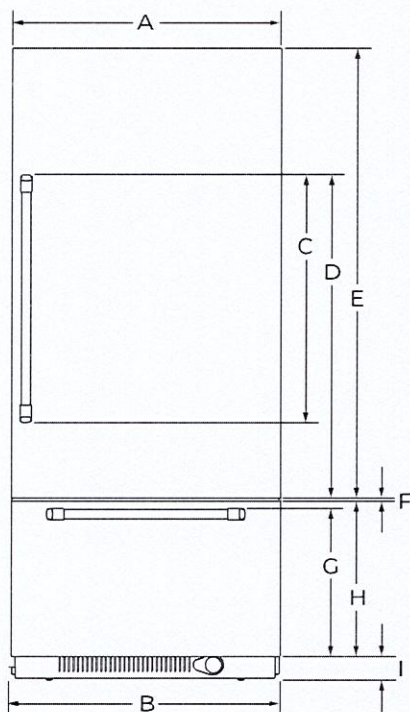

FRONT VIEW

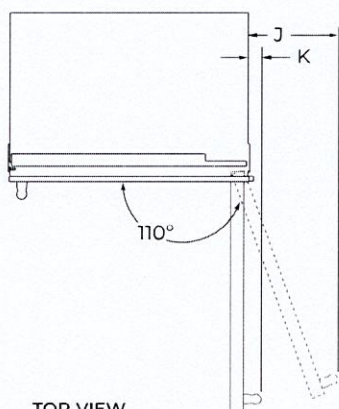

TOP VIEW

DIMENSION	DESCRIPTION	JB36NFXFRE JB36NFXLE
A	Width of door	35¾" (90.8 cm)
B	Overall width (including vinyl side trims)	35¾" (90.8 cm)
C	Height of door handle	
	RISE™ Stainless	40⅞" (103.8 cm)
	NOIR™ Stainless	40⅝" (103.2 cm)
D	Height to top of door handle	
	RISE™ Stainless	49⅝" (126 cm)
	NOIR™ Stainless	47⅞" (121.8 cm)
E	Height of door	59¼" (150.5 cm)
F	Space between door and drawer	⅛" (0.3 cm)
G	Height to top of drawer handle	
	RISE™ Stainless	19⅞" (49.1 cm)
	NOIR™ Stainless	19⅞" (49.2 cm)
H	Height of drawer	20½" (52.1 cm)
I	Height of bottom grille	3" (7.6 cm)
J	Width from side of refrigerator to handle – door fully open 110°	
	RISE™ Stainless	13⅞" (34.2 cm)
	NOIR™ Stainless	12⅞" (32.8 cm)
K	Width from side of refrigerator to handle – door open 90°	
	RISE™ Stainless	2⅞" (6.1 cm)
	NOIR™ Stainless	1⅞" (4.1 cm)

Because Whirlpool Corporation policy includes a continuous commitment to improve our products, we reserve the right to change materials and specifications without notice.

Dimensions are for planning purposes only. For complete details, see Installation Instructions packed with product. Specifications subject to change without notice.



36" FULLY INTEGRATED BOTTOM FREEZER REFRIGERATORS

DETAILED PLANNING DIMENSIONS GUIDE

(BASE UNIT REQUIRES SUITE-COORDINATING FULL HEIGHT PANEL KIT OR CUSTOM PANELS AND HANDLES)

JB36NFXFRE, JB36NFXFLE – 35³/₄" (W) x 82⁷/₈" (H) x 24" (depth without door panel/handles)

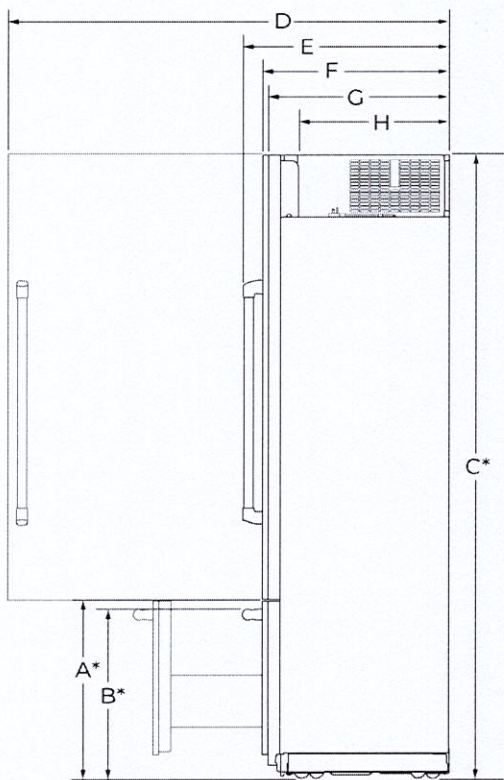

SIDE VIEW

DIMENSION	DESCRIPTION	JB36NFXFRE JB36NFXFLE
A*	Height to top of drawer (min.)	23½" (59.7 cm)
B*	Height to top of drawer handle (min.)	
	RISE™ Stainless	22¾" (56.8 cm)
	NOIR™ Stainless	22¾" (56.8 cm)
C*	Height to top of door (min.)	82⅞" (210.5 cm)
D	Depth with door open 90° (min.)	58⅝" (148.9 cm)
E	Depth with handle (min.)	
	RISE™ Stainless	26⅞" (68.2 cm)
	NOIR™ Stainless	26⅞" (68.2 cm)
F	Depth with door (min.)	
	RISE™ Stainless	24¾" (62.8 cm)
	NOIR™ Stainless	24¾" (62.8 cm)
	Custom panel (¾"/1.9 cm)	24¾" (62.8 cm)
G	Depth without door panel kit (min.)	24" (61 cm)
H	Depth of compressor cover (min.)	19⅞" (50.5 cm)

*Add 1¼" (3.2 cm) to the height dimension when leveling legs are fully extended.

Because Whirlpool Corporation policy includes a continuous commitment to improve our products, we reserve the right to change materials and specifications without notice.

Dimensions are for planning purposes only. For complete details, see Installation Instructions packed with product. Specifications subject to change without notice.



36" FULLY INTEGRATED BOTTOM FREEZER REFRIGERATORS

DETAILED PLANNING DIMENSIONS GUIDE

(BASE UNIT REQUIRES SUITE-COORDINATING FULL HEIGHT PANEL KIT OR CUSTOM PANELS AND HANDLES)

JB36NFXFRE, JB36NFXLE – 35³/₄" (W) x 82⁷/₈" (H) x 24" (depth without door panel/handles)

AIRFLOW VENTING RECOMMENDATIONS

CLOSED SOFFIT CABINET

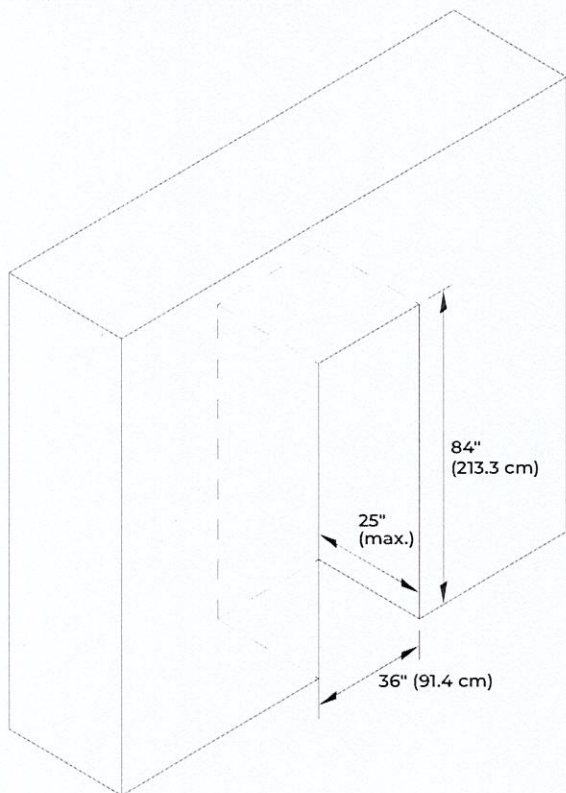

- Depth of cabinet must be less than 25" (63.5 cm).
- Height of soffit must not exceed 84" (213.3 cm).
- Following illustrations explain the cabinet construction (soffit and rear wall positions) required for optimum ventilation and airflow.

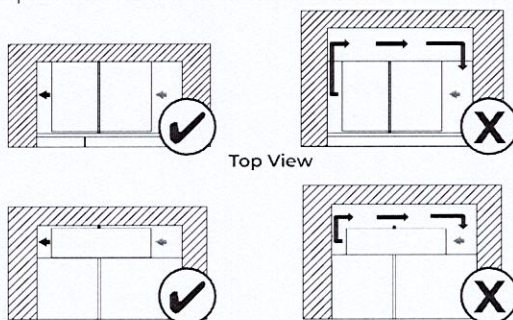

Grey arrow = ambient air; Black arrow = warm air

Cabinet depth 25" and soffit located at 84", provides proper airflow/ventilation to the refrigerator. Efficient cooling is achieved.

Cabinet depth more than 25" and/or soffit located at more than 84", causes air gap at back and/or top of the refrigerator. Air gap allows warm air recirculation causing loss in cooling efficiency.

- If your opening does not meet these requirements, you will need to make modifications.

Because Whirlpool Corporation policy includes a continuous commitment to improve our products, we reserve the right to change materials and specifications without notice.

Dimensions are for planning purposes only. For complete details, see Installation Instructions packed with product. Specifications subject to change without notice.



36" FULLY INTEGRATED BOTTOM FREEZER REFRIGERATORS

DETAILED PLANNING DIMENSIONS GUIDE

(BASE UNIT REQUIRES SUITE-COORDINATING FULL HEIGHT PANEL KIT OR CUSTOM PANELS AND HANDLES)

JB36NFXFRE, JB36NFXFLE – 35³/₄" (W) x 82⁷/₈" (H) x 24" (depth without door panel/handles)

CLEARANCE DIMENSIONS

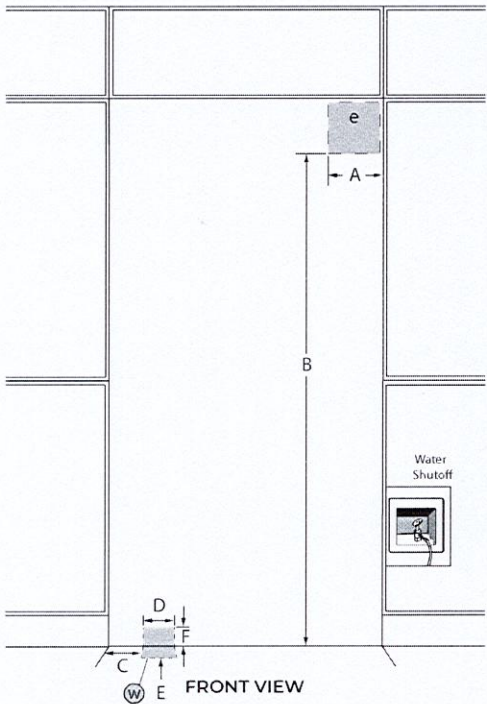

DIMENSION	DESCRIPTION	JB36NFXFRE, JB36NFXFLE
A	Width of recommended electrical location	4" (10.2 cm)
B	Height to recommended electrical location	77" (195.6 cm)
C	Distance from side of cabinet to recommended water connection location	6 ¹ / ₂ " (16.5 cm)
D	Width of recommended water connection location	1 ¹ / ₂ " (3.81 cm)
E	Depth of recommended water connection location (max.)	2" (5 cm)
F	Height of recommended water connection location (behind the unit)	2 ¹ / ₂ " (6.35 cm)
e	Recommended electrical connection location	
w	Recommended water connection location	

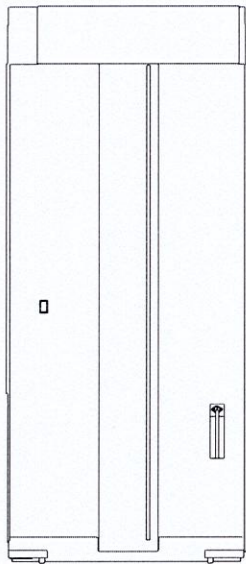

BACK VIEW

Because Whirlpool Corporation policy includes a continuous commitment to improve our products, we reserve the right to change materials and specifications without notice.

Dimensions are for planning purposes only. For complete details, see Installation Instructions packed with product. Specifications subject to change without notice.

SITE PREPARATION
INSTALLATION REQUIREMENTS

PLAN THE INSTALLATION

IMPORTANT:

- Install the handles on the panels prior to panel installation. Follow the instructions received with handle kit to install the handles.
- Plan your installation using these instructions in conjunction with the Installation Instructions provided with the refrigerator. Modifications must be made to the refrigerator to accommodate the Armoire-style door panels.

Required parts

- One of the following built-in refrigerator models:
 - 42" Side-by-Side: JS42NFXDE
 - 48" Side-by-Side: JS48NFXDE
 - 36" Bottom Mount: JB36NFXLE, JB36NFXRE
 - 36" French Door Bottom Mount: JF36NFXDE
 - 42" French Door Bottom Mount: JF42NFXDE
- Accessory Armoire-Style Door Panel Kit which includes (Grille Assembly and Grille Bracket Assembly)
- Custom Panels
NOTE: The required thickness for all panels is 3/4" (1.91 cm).

OPENING REQUIREMENTS

IMPORTANT:

- The width of the opening, from side to side, must be as specified for your model, for at least 3" (7.62 cm) back from the face of the cabinet. If your opening does not meet this requirement, you will need to make modifications.
- The depth of the opening from the front of the cabinet to the back wall must be 25" (63.5 cm) minimum to achieve a flush installation.

CABINET AND PANEL INSTALLATION
OPTIONS

Cabinet Depth - 25" (63.5 cm)

Grille Bracket - Top View

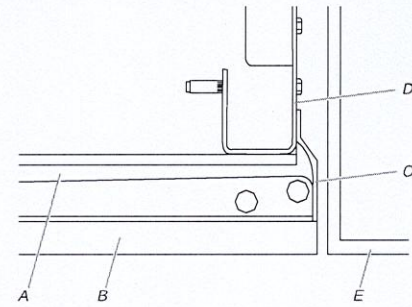

- A. Refrigerator door
- B. Armoire-style door panel
- C. Side trim
- D. Grille bracket
- E. Adjacent cabinet

Grille Bracket - Side View

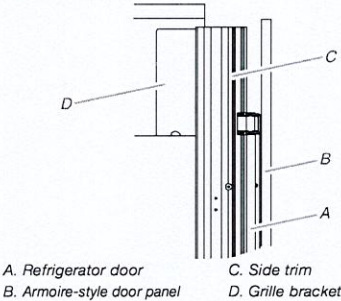

- A. Refrigerator door
- B. Armoire-style door panel
- C. Side trim
- D. Grille bracket

SITE PREPARATION
CABINET CUTOUT OPTIONS

AIRFLOW VENTING RECOMMENDATIONS

IMPORTANT:

- Armoire-style installations recommends a minimum of 1/8" (3.2 mm) of open space above the refrigerator. It is recommended that this space not be blocked in any way, including soffits.
- Models may be installed using either Option 1, Option 2 or option 3.

Option 1 - Open to Ceiling

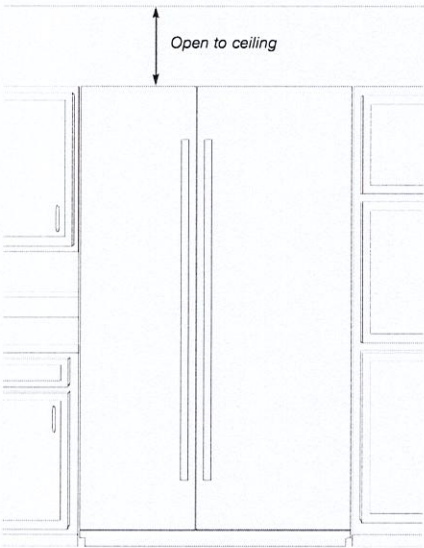

Option 2 - False Front (cabinet face only)

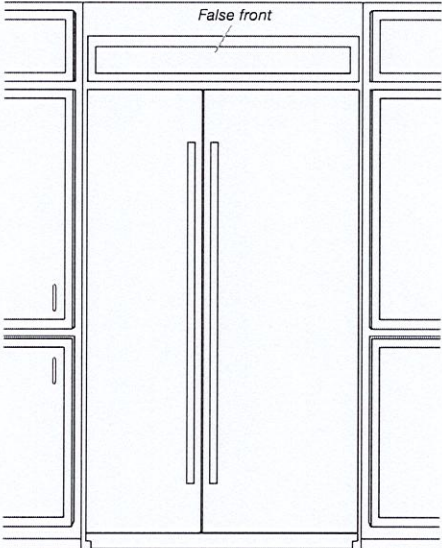

Option 3 - Closed Soffit

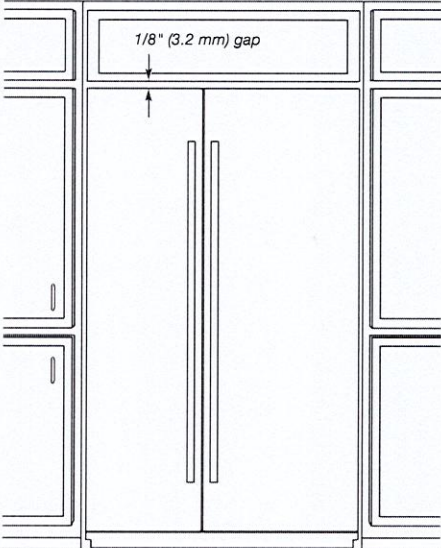

SITE PREPARATION
PANEL DIMENSIONS

BOTTOM MOUNT MODEL

- !
- Maximum allowable weights:

 - Door panel - 60 lbs (27.2 kg)
 - Drawer panel - 25 lbs (11.3 kg)

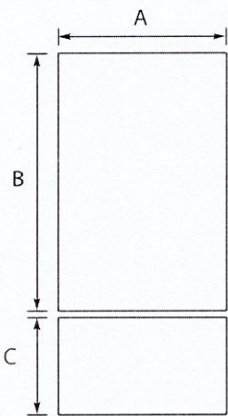

Legend	Model	Dimension
A	36"	35¾" (90.81 cm)
B	36"	59⅞" (150.2 cm)
C	36"	20½" (52.07 cm)

FRENCH DOOR BOTTOM MOUNT
MODELS

- !
- Maximum allowable weights:

 - Door panel - 38 lbs (17.2 kg)
 - Drawer panel (36" model) - 25 lbs (11.3 kg)
 - Drawer panel (42" model) - 30 lbs (13.6 kg)

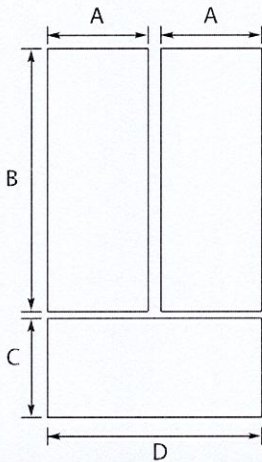

Legend	Model	Dimension
A	36"	17¾" (45.24 cm)
B		59⅞" (150.2 cm)
C		20½" (52.07 cm)
D		35¾" (90.81 cm)
A	42"	20¾" (52.86 cm)
B		59⅞" (150.2 cm)
C		20½" (52.07 cm)
D		41¾" (106.05 cm)

SIDE BY SIDE MODELS

- !
- Maximum allowable weights (42" models):

 - Refrigerator Door panel - 65 lbs (29.5 kg)
 - Freezer Door panel - 49 lbs (22.2 kg)

Maximum allowable weights (48" models):

 - Refrigerator Door panel - 66 lbs (29.9 kg)
 - Freezer Door panel - 50 lbs (23 kg)

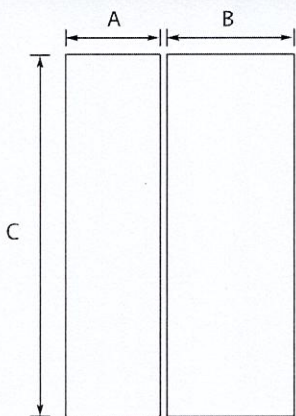

Legend	Model	Dimension
A	42"	17¾" (45.24 cm)
B		23¾" (60.48 cm)
C		81" (205.7 cm)
A	48"	20¼" (51.59 cm)
B		27¼" (69.37 cm)
C		81" (205.7 cm)



36" REFRIGERATOR ARMOIRE STYLE DOOR PANEL KIT, OBSIDIAN

Signature Features

THIS PRODUCT IS A FACTORY CERTIFIED ACCESSORY. THESE THREE WORDS REPRESENT QUALITY PARTS AND ACCESSORIES DESIGNED SPECIFICALLY FOR YOUR APPLIANCE. TIME TESTED ENGINEERING THAT MEETS OUR STRICT QUALITY SPECIFICATIONS

30-DAY RETURN POLICY

Technical Specifications

Certifications

Prop 65: Standard

PACKAGE CONTAINS (1) 36" REFRIGERATOR ARMOIRE STYLE DOOR PANEL KIT, OBSIDIAN. INCLUDES (1) LEFT AND (1) RIGHT GRILLE BRACKETS AND MACHINE COMPARTMENT COVER

TOOLS NEEDED: MULTI SCREWDRIVER

W10663562

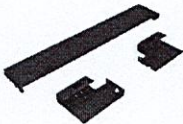

Plan the Installation

Plan your installation using these instructions in conjunction with the Installation Instructions provided with the refrigerator. Modifications must be made to the refrigerator to accommodate the armoire cabinet.

Required parts

- One of the following built-in refrigerator models:
Side-by-Side: JS42NXFXDW, JS42NXFXDE, JS48NXFXDE, JS48NXFXDW
36" Bottom Mount: JB36NXFXLW, JB36NXFXRW, JB36NXFXLE, JB36NXFXRE
36" French Door Bottom Mount: JF36NXFXDE
42" French Door Bottom Mount: JF42NXFXDW, JF42NXFXDE
- Accessory Armoire-Style Door Panel Kit which includes (Grille Assembly and Grille Bracket Assembly)
- Custom Panels

Opening Requirements

IMPORTANT:

- An Armoire installation requires an open soffit. For a fully integrated installation, a minimum of 6" (15.24 cm) of open space above the refrigerator is required. The open space must also extend the width and depth of the unit. See "Fully Integrated Installation." Anti-tip boards are required. See "Install Anti-Tip Boards" in the Installation Instructions provided with the refrigerator for more information.
- The width of the opening, from side to side, must be as specified for your model, for at least 3" (7.62 cm) back from the face of the cabinet. If your opening does not meet this requirement, you will need to make modifications.
- The depth of the opening from the front of the cabinet to the back wall must be 25" (63.5 cm) minimum to achieve a flush installation.
- A grounded 3 prong electrical outlet should be placed within 4" (10.2 cm) of the right side cabinets or end panel. See "Electrical Requirements" in the Installation Instructions provided with the refrigerator.
- The water shutoff should be located in the base cabinets on either side of the refrigerator or some other easily accessible area. If the water shutoff valve is not in the cabinets, the plumbing for the water line can come through the floor. See "Water Supply Requirements" in the Installation Instructions provided with the refrigerator.

Cabinet and Panel Installation Options

Cabinet Depth - 25" (63.5 cm)

Framed Cabinetry Top View - Overlay

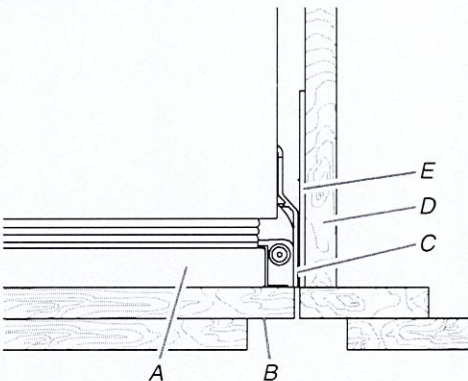

- A. Refrigerator door
- B. Overlay panel
- C. Side trim
- D. Adjacent cabinet
- E. Grille bracket

Top View - Inset

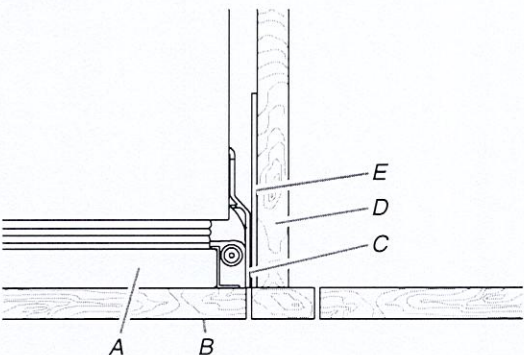

- A. Refrigerator door
- B. Overlay panel
- C. Side trim
- D. Adjacent cabinet
- E. Grille bracket

Frameless Cabinetry

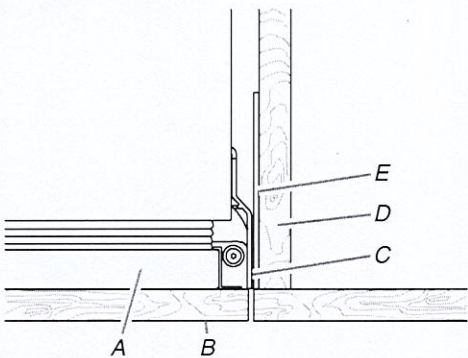

- A. Refrigerator door
- B. Overlay panel
- C. Side trim
- D. Adjacent cabinet
- E. Grille bracket

Armoire Style Installation Requirements

Top Grille - Side View

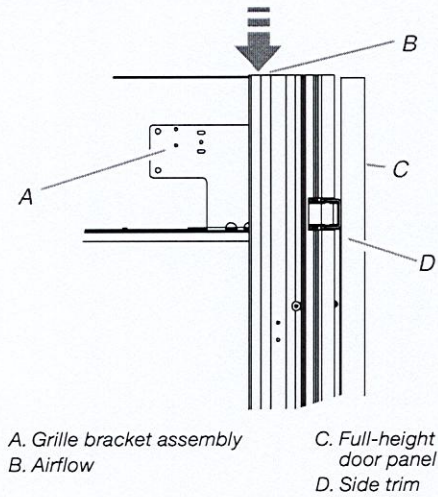

Airflow Venting Requirements

- IMPORTANT:
- Armoire style installations require a minimum of 6" (15.24 cm) of open space above the refrigerator. This space must not be blocked in any way, including soffits.
 - Models may be installed using either Option 1 or Option 2.

Option 1 - Open to Ceiling (all models)

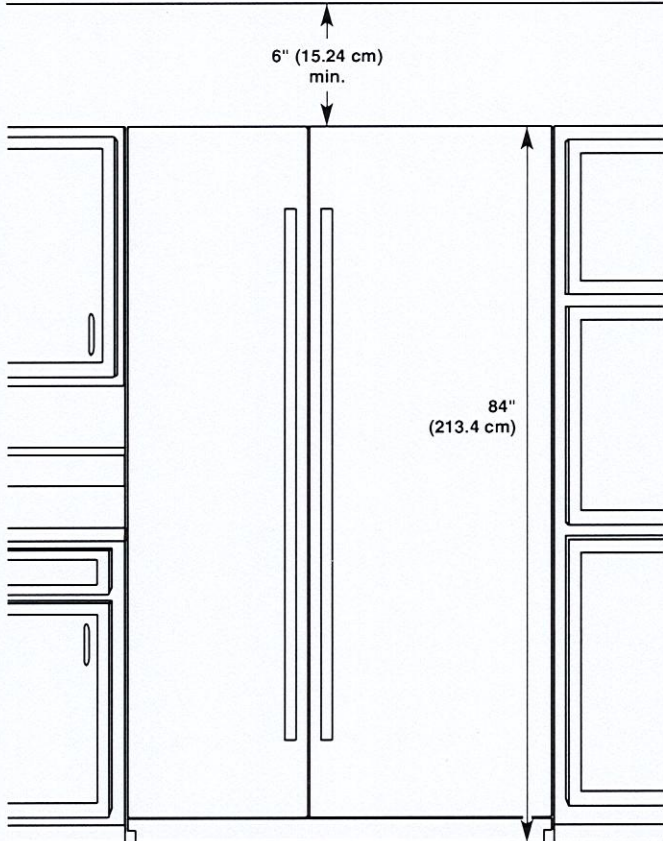

Option 2 - False Front (cabinet face only) (all models)

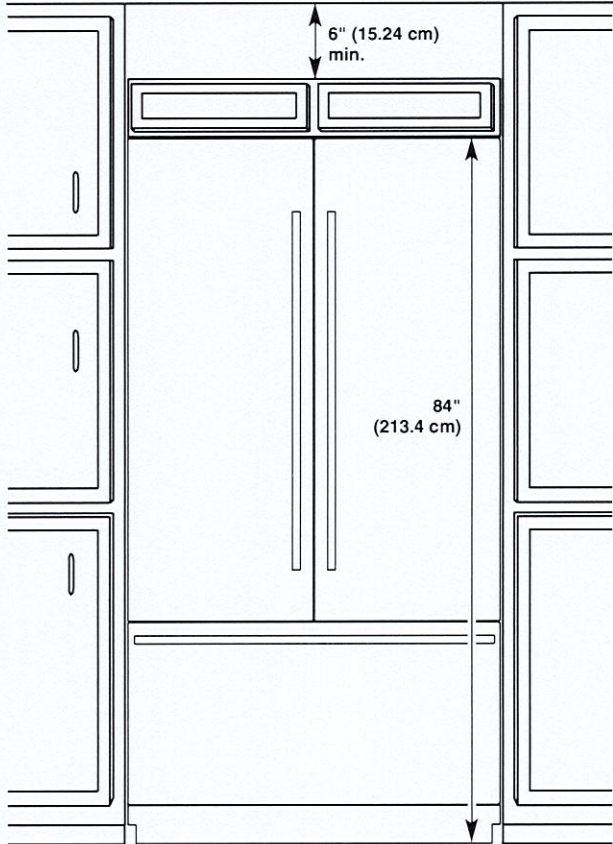

Custom Overlay Panels

Custom overlay panels allow you to blend the exterior of your refrigerator into the overall kitchen décor and to use custom handles for additional design flexibility.

In some cases, your cabinet manufacturer may choose to work with one panel routed for the different dimensions. Follow these panel dimension and placement instructions to be sure that the custom overlay panels will fit properly.

IMPORTANT:

- This installation does not require filler or backer panels.
- The required thickness for all panels is 3/4" (1.91 cm).

Bottom Mount

- For 36" (91.4 cm) Single-door Bottom Mount models, the weight of the refrigerator door overlay panel cannot exceed 60 lbs (27.2 kg) and the freezer drawer overlay panel cannot exceed 25 lbs (11.3 kg).
- For 36 "(91.4 cm) or 42" (106.7 cm) French Door models, the weight of each refrigerator door cannot exceed 38 lbs (17.2 kg) and the freezer drawer overlay panel cannot exceed 30 lbs (13.6 kg).
- For all models, the weight at the top grille overlay panel cannot exceed 7 lbs (3.2 kg).

Side-by-Side

- The weight of the refrigerator door overlay panel cannot exceed 66 lbs (29.9 kg) for 48" models or 65 lbs (29.5 kg) for 42" models.
- The weight of the freezer door overlay panel cannot exceed 50 lbs (23 kg) for 48" models or 49 lbs (22.2 kg) for 42" models.
- The weight of the top grille overlay panel cannot exceed 8 lbs (3.6 kg) for 48" models or 7 lbs (3.2 kg) for 42" models.

CAUTION

Pinch Hazard

Installation of door panels with less than a 3/8" (0.95 cm) gap between the door panel and the adjacent cabinet increases the risk of potential pinching.

Overlay Panel Dimensions

36" (91.4 cm) Single-Door Model - Door and Drawer Panels

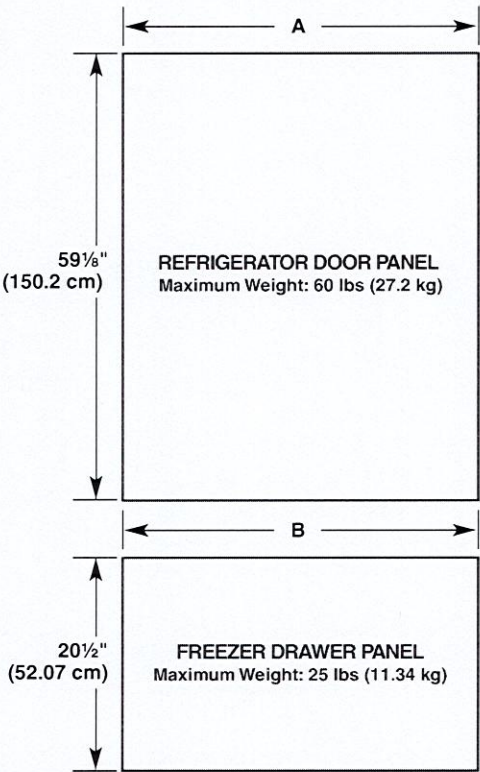

Model	36" Bottom Mount	
Reveal	3/8"	1/8"
A	35 1/4" (89.54 cm)	35 3/4" (90.81 cm)
B	35 1/4" (89.54 cm)	35 3/4" (90.81 cm)

36" (91.4 cm) French Door and 42" (106.7 cm) French Door Model - Door and Drawer Panels

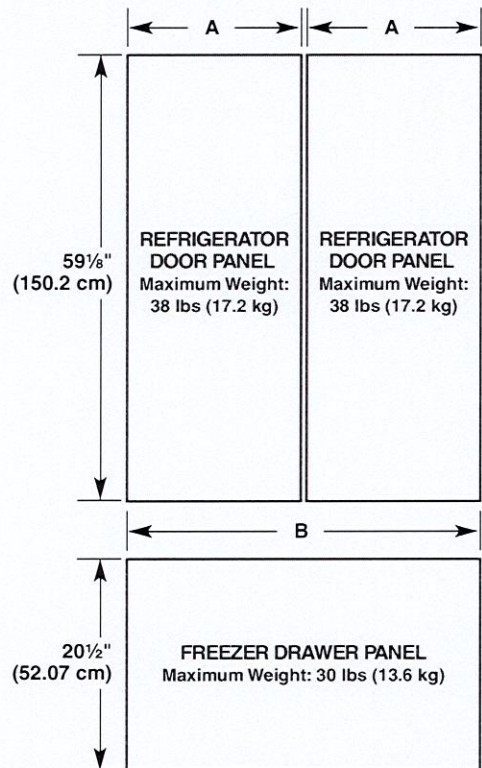

Model	36" French Door Bottom Mount	
Reveal	3/8"	1/8"
A	17 9/16" (44.61 cm)	17 13/16" (45.24 cm)
B	35 1/4" (89.54cm)	35 3/4" (90.81cm)

Model	42" French Door Bottom Mount	
Reveal	3/8"	1/8"
A	20 9/16" (52.23 cm)	20 13/16" (52.86 cm)
B	41 1/4" (104.76 cm)	41 3/4" (106.05 cm)

Side-by-Side - Door Panels

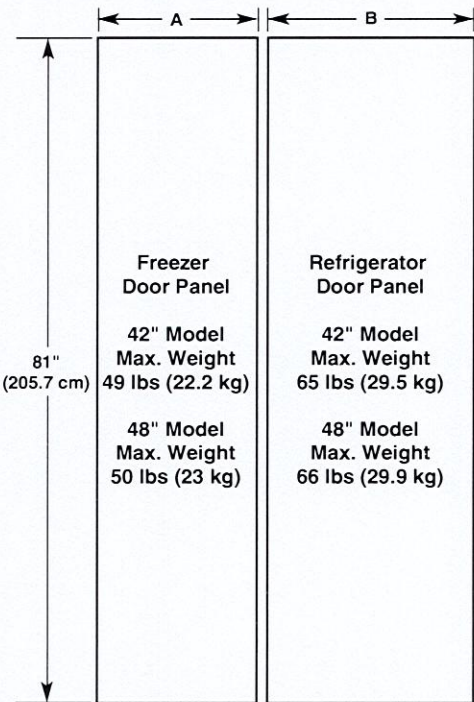

Model	42		48	
Reveal	3/8"	1/8"	3/8"	1/8"
A	17 9/16" (44.61 cm)	17 13/16" (45.24 cm)	20 1/16" (50.96 cm)	20 5/16" (50.17 cm)
B	23 9/16" (59.85 cm)	23 13/16" (60.48 cm)	27 1/16" (68.74 cm)	27 5/16" (69.37 cm)

Prepare Custom Wood Door Panels

IMPORTANT: For an armoire installation, instead of drilling holes along the top edge(s) of the custom door panel(s), you must adjust the placement of the drilling template (provided with the refrigerator).

NOTES:

- No template adjustment is needed for the bottom edge of the door panel(s).
 - No template adjustment is needed for the custom freezer drawer panel.
1. Align the drilling template on the back of the custom refrigerator door panel so that the top of the template is offset 6¾" (17.2 cm) from the top of the refrigerator door panel.

NOTE: The only offset dimension is the 6¾" (17.2 cm) offset from the top of the door panel.

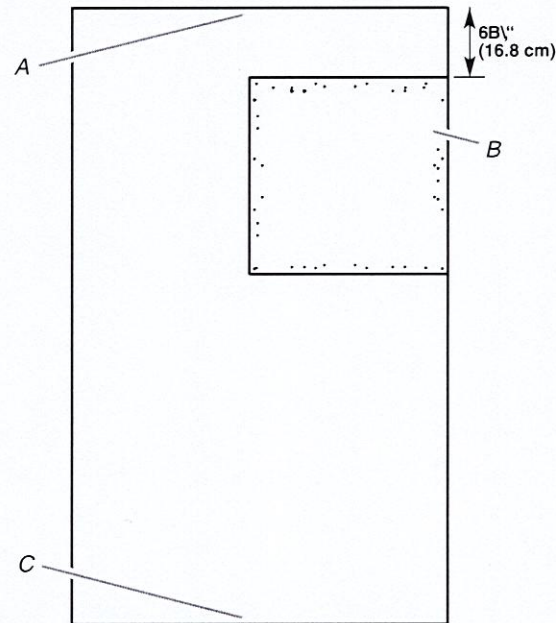

A. Top of custom refrigerator door panel
B. Drilling template
C. Bottom of custom refrigerator door panel

2. Continue to use the template as you normally would along the bottom, handle side of the door panel.

Complete Installation

IMPORTANT: Return to the instructions provided with your refrigerator to complete the installation. See "Prepare Custom Overlay Panels" in the Installation Guide.

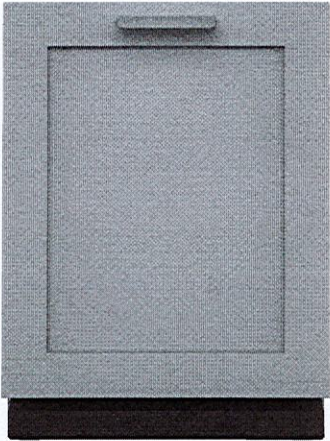

Kitchenaid® 44 dBA Panel-Ready Two-Rack Flush Dishwasher with Door-Open Dry System

KDTF324PPA

Available Finishes/Colours





	KDTF324PPA Panel Ready
---	---------------------------

Dimensions		Cycles and Options	
Depth	21.63	Dishwasher Cycle Selections	ProWash™; Tough; Normal; Express Wash; Rinse
Height	32.31		
Width	23.56		

This KitchenAid® Flush Dishwasher turns dirty work into something beautiful. Adjustable upper and lower racks offer loading flexibility so you can make room for tall and bulky items. Automatic Door-Open Dry System circulates fresh air for enhanced drying power. And the Panel-Ready Design lets you match your cabinetry for a completely seamless look.

Top Features
Flush Design
Door-Open Dry System
Triple Filtration System

Manuals & Literature:

-  [Dimension Guide](#)
-  [Energy Guide](#)
-  [Owner Manual](#)
-  [Warranty Information](#)

Compatibility		Cycles	
Connectivity		Number Of Wash Cycles	5
Works With		Details	
Controls		Drying System Type	Open Door System
Automatic Temperature Controls	Yes	Hoses Included	Drain Hose
Control Location	Top	Interior Light	No
Control Type	Electronic	Number Of Racks	2
End Of Cycle Signal	Yes	Number Of Washarms	3
Specifications		Rack Material	Nylon
Country Of Origin	Poland	Tub Material	Stainless Steel
Optional Accessories	W11365014		

PRODUCT DIMENSIONS

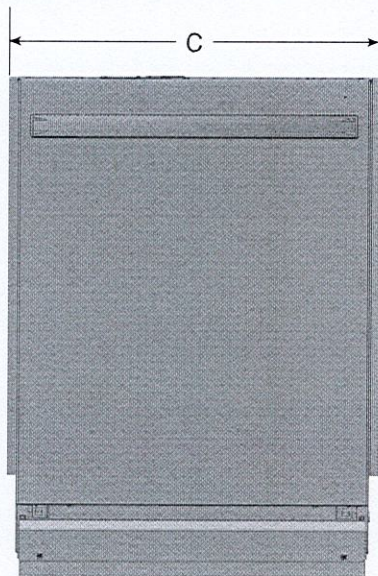

C. 23⁹/₁₆" (599 mm)

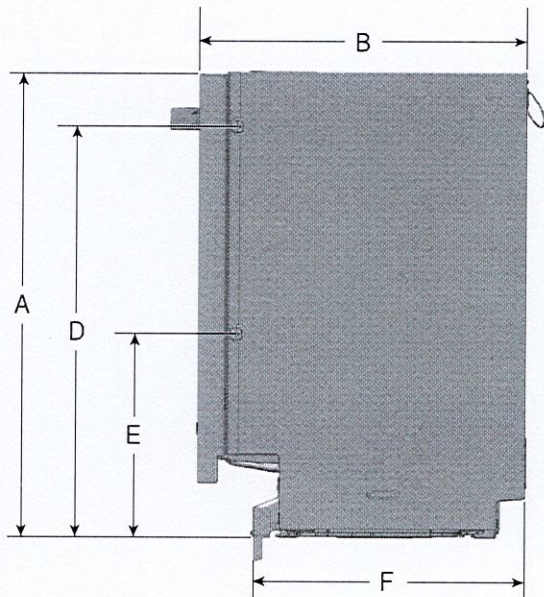

A. 32¹/₄"-35⁷/₁₆" (820-900 mm) E. 14¹/₁₆" (358 mm)
B. 22⁵/₈" (574 mm) F. 18³/₄" (477 mm)
D. 28³/₈" (721 mm)

PRODUCT DIMENSIONS (FOR PANEL READY MODELS)

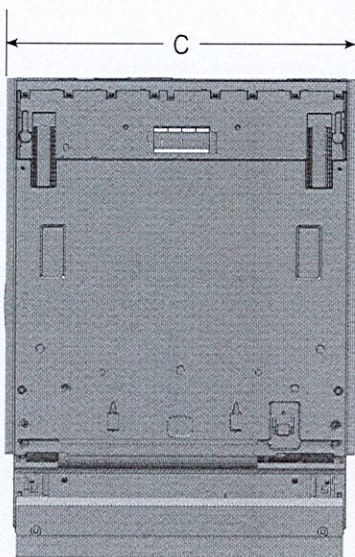

C. 23⁹/₁₆" (599 mm)

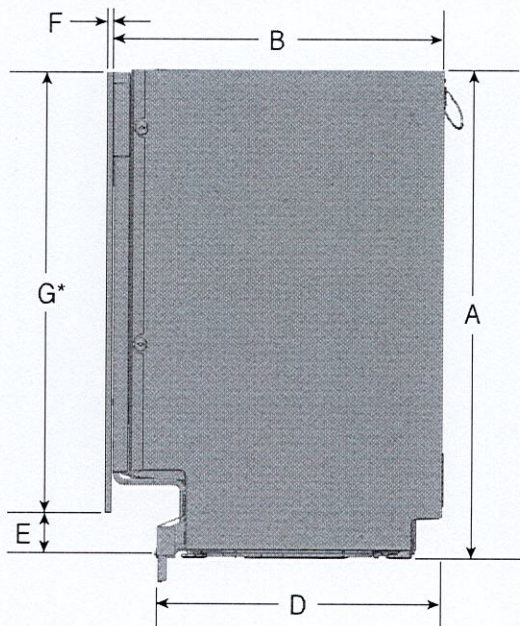

A. 32¹/₄"-35⁷/₁₆" (820-900 mm) E. E = A - G
B. 21⁷/₈" (555 mm) F. 11¹/₁₆"-1³/₄" (18-45 mm)
D. 18³/₄" (477 mm) G. 28³/₈"-29¹⁵/₁₆" (720-760 mm)

***NOTE:** If a custom toe kick is desired to be installed, adjust the thickness of the custom panel to make it flush with the cabinet toe kick. Product's original metal toe kick must remain even if custom toe kick is installed.

Because Whirlpool Corporation policy includes a continuous commitment to improve our products, we reserve the right to change materials and specifications without notice.

Dimensions are for planning purposes only. For complete details, see Installation Instructions packed with product. Specifications subject to change without notice.

CABINET OPENING DIMENSIONS

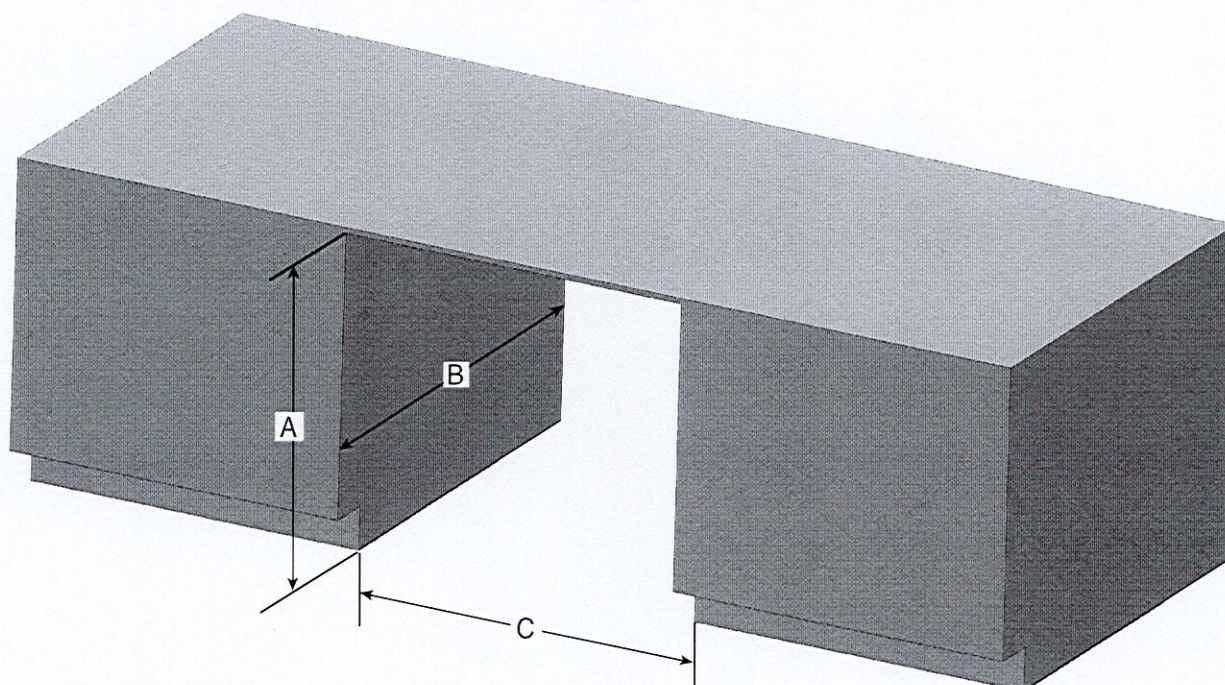

- A. $32\frac{1}{4}"$ - $35\frac{7}{16}"$ (820-900 mm) measured from the lowest point on the underside of the countertop.
- B. 24" (609.6 mm) Minimum
- C. $23\frac{5}{8}"$ - $24\frac{1}{4}"$ (600-616 mm) Minimum, measured from narrowest point of opening.

Because Whirlpool Corporation policy includes a continuous commitment to improve our products, we reserve the right to change materials and specifications without notice.

Dimensions are for planning purposes only. For complete details, see Installation Instructions packed with product. Specifications subject to change without notice.