

CONSTRUCTION SUMMARY

RECEIVED

Palmetto - Zadorra Estates Corp.

JAN 15 2024

TEL: RES.: 416-856-4016

PURCHASER: Balagangadhar MUDILI

LOT / PHASE 20 / 1	REG. PLAN #	HOUSE TYPE Villa 2 Elev 2		
-----------------------	-------------	------------------------------	--	--

CABINETRY

1 - KITCHEN - DELETE CABINETS ABOVE STOVE AND HOOD FAN - VENDOR WILL SUPPLY 6 INCH VENT AS PER CONSTRUCTION SPECIFICATIONS AND VENT MAY NOT BE IN THE APPROPRIATE LOCATION FOR INSTALLATION OF PURCHASER SUPPLIED FAN 11Jan24 Note: PURCHASER TO SUPPLY AND INSTALL OWN FAN AFTER CLOSING	
--	--

CABINETRY ACCESSORIES

1 - KITCHEN CABINETRY - PANTRY UNIT UPGRADE - TO GO FROM 300MM TO 600MM DEEP - PRICE IS PER FOOT - STANDARD LEVEL 11Jan24 Note:	
1 - KITCHEN CABINETRY UPPER - FULL DEPTH ABOVE FRIDGE UPPER WITH GABLES - 650MM DEEP - PRICE IS EACH 11Jan24 Note:	
1 - KITCHEN CABINETRY BASE - POT/PAN DRAWERS (CABINET) - STANDARD LEVEL 11Jan24 Note: NEXT TO STOVE - SEE SKETCH	
1 - KITCHEN CABINETRY BASE - PULLOUT WIRE SPICE RACK - PRICE IS EACH 11Jan24 Note: NEXT TO STOVE - SEE SKETCH	
1 - KITCHEN CABINETRY - BUILT-IN MICROWAVE/OVEN COMBO WITH ONE POT DRAWER - STANDARD LEVEL 11Jan24 Note:	
1 - KITCHEN CABINETRY BASE - COOKTOP CABINET WITH POT DRAWERS (2 DRAWERS) - STANDARD LEVEL 11Jan24 Note:	

CONSTRUCTION

3 - ENLARGED BASEMENT WINDOWS (MAY REQUIRE WINDOW WELLS) - WINDOW IS 30 INCHES X 24 INCHES 20Jun23 Note:	
---	--

ELECTRICAL

1 - BUILT IN OVEN AND COOKTOP PROVISION - PROVISION ONLY - ELECTRICAL ONLY 11Jan24 Note:	
1 - ELECTRIC VEHICLE ROUGH-IN PROVISION ONLY FOR FUTURE ELECTRIC CAR (CONDUIT FROM BASEMENT INTO JUNCTION BOX IN GARAGE WITH PULL STRING, NO WIRE) 25Sep23 Note:	

FIREPLACE AND ACCESSORIES

1 - GAS LINE ROUGH-IN FOR STOVE (INCLUDES ELECTRICAL OUTLET) - FIRST FLOOR 25Sep23 Note:	
---	--

HARDWOOD FLOORING

1 - LAMINATE – UPGRADE TO AVENUE SERIES IN LIEU OF STANDARD LAMINATE 11Jan24 Note:	
---	--

HEATING AND AIR CONDITIONING

1 - HUMIDIFER 25Sep23 Note:	
--------------------------------	--

PLUMBING

CONSTRUCTION SUMMARY

Palmetto - Zadorra Estates Corp.

PURCHASER: Balagangadhar MUDILI

TEL: RES.: 416-856-4016

LOT / PHASE	REG. PLAN #	HOUSE TYPE		
20 / 1		Villa 2 Elev 2		
1 - MOEN KITCHEN POT FILLER – MODERN TWO HANDLE POT FILLER FAUCET WITH DUAL SHUT OFFS – #S665 CHROME 25Sep23 Note:				
1 - WATER LINE FOR FRIDGE - ROUGH-IN ONLY 25Sep23 Note:				

PROMOTIONAL

1 - LESS BALANCE OF CREDIT FROM PURCHASER EXTRA SHEET IN OFFER 11Jan24 Note:	
1 - PARTIAL REDEMPTION OF PROMOTIONAL PACKAGE \$5,650.00. BALANCE FORWARD \$7,400.00 TO BE USED AT A LATER DATE. ORIGINAL PROMOTIONAL PACKAGE OF \$15,000.00 AS PER SCHEDULE PE. 25Sep23 Note:	
1 - PARTIAL REDEMPTION OF PROMOTIONAL PACKAGE \$1,950.00. BALANCE FORWARD \$13,050.00 TO BE USED AT A LATER DATE. ORIGINAL PROMOTIONAL PACKAGE OF \$15,000.00 AS PER SCHEDULE PE. 20Jun23 Note:	

STAIRS AND RAILINGS

1 - STAINED STAIRS - STANDARD STAIRCASE 11Jan24 Note: INCLUDING STEPS TO LOWER LANDING	
---	--

EXTRAS AS PER OFFER

The Vendor agrees that notwithstanding any other term or provision in this Agreement included in the Purchase Price and in addition to those items detailed in Schedule GP to the Agreement of Purchase and Sale, the Purchaser is entitled to a credit of Fif Worksheet Note:	
---	--

This Document is Extremely Time Sensitive - Printed 11 Jan 24 at 11:52

Purchaser: Balagangadhar MUDILI

Property: 20

Telephone Res. / Bus: (416) 856-4016 /

Project: Zadorra Estates Corp.

Decor Advisor: Giulia Di Girolamo

Model and Elevation: Villa 2 Elev 2

Lock Date: 11-Jan-24

11-Jan-24

Plan #:

1. Cabinetry

	Style and Colour	Hardware
Kitchen / Breakfast	DORAL - WHITE W500	464SA
Laundry Room	ELISSE	Standard
Powder Room	MONACO -350 PLATINUM SILVER	464SA
Master Ensuite Bathroom	MONACO -350 PLATINUM SILVER	464SA
Main Bathroom	MONACO -350 PLATINUM SILVER	464SA
Ensuite Bath - Bedroom 3	MONACO -350 PLATINUM SILVER	464SA
Stove Opening	36" COOKTOP	NOTE: If not specified, opening will be set to builder's standard opening of approximately 30" width
Fridge Opening	STANDARD	NOTE: If not specified, opening will be set to builder's standard opening of approximately 37" width x 74" height

** Refer to Construction Summary

2. Counters

	Counter	Edge	Niche
Kitchen / Breakfast	LAMINATE-CARRARA BIANCO 6696-46		
Laundry Room	N/A		
Powder Room	LAMINATE-HIVERNA P-948 CA		
Master Ensuite Bathroom	LAMINATE-HIVERNA P-948 CA		
Main Bathroom	LAMINATE-HIVERNA P-948 CA		
Ensuite Bath - Bedroom 3	LAMINATE-HIVERNA P-948 CA		
Kitchen Backsplash	N/A		

** Refer to Construction Summary

Purchaser:Balagangadhar MUDILI

Property: 20

Telephone Res. / Bus: (416) 856-4016 /

Project: Zadorra Estates Corp.

Decor Advisor: Giulia Di Girolamo

Model and Elevation: Villa 2 Elev 2

Lock Date: 11-Jan-24

11-Jan-24

Plan #:

3. Ceramic Flooring

		At a 45
Entrance Vestibule	TILE-KALMA BLANCO GLOSSY 12.5X12.5	<input type="checkbox"/>
Main Hall	LAMINATE	<input type="checkbox"/>
Kitchen / Breakfast	TILE-KALMA BLANCO GLOSSY 12.5X12.5	<input type="checkbox"/>
Laundry Room	TILE-KALMA BLANCO GLOSSY 12.5X12.5	<input type="checkbox"/>
Powder Room	TILE-KALMA BLANCO GLOSSY 12.5X12.5	<input type="checkbox"/>
Master Ensuite Bathroom	TILE-KALMA BLANCO GLOSSY 12.5X12.5	<input type="checkbox"/>
Main Bathroom	TILE-KALMA BLANCO GLOSSY 12.5X12.5	<input type="checkbox"/>
Ensuite Bath - Bedroom 3	TILE-KALMA BLANCO GLOSSY 12.5X12.5	<input type="checkbox"/>
Mud Room	TILE-KALMA BLANCO GLOSSY 12.5X12.5	<input type="checkbox"/>
		<input type="checkbox"/>
		<input type="checkbox"/>

** Refer to Construction Summary ** METAL STRIP THRESHOLD WHERE APPLICABLE UNLESS SPECIFIED **

4. Ceramic Wall Tile

Master Ensuite Bathroom	Selection	Describe
Tub Deck Wall	N/A	
Shower Stall	TILE-SILVIA WHITE 8X16	
Bathtub Enclosure Walls	N/A	
Main Bathroom	TILE-SILVIA WHITE 8X16	
Ensuite Bath - Bedroom 3	TILE-SILVIA WHITE 8X16	
Mud Room	N/A	
Kitchen Backsplash	N/A	

** Refer to Construction Summary - STANDARD GROUT THROUGHOUT UNLESS SPECIFIED

5. Trim Carpentry

Interior Doors	CARRARA-SMOOTH
Interior Trim	As Per Construction Specifications

** Refer to Construction Summary

6. Plaster Mouldings and Medallions

Entrance Vestibule			Kitchen/Breakfast		
Main Hall			Den/Library		
Living Room			Lower Landing		
Dining Room					
Family Room					

** Refer to Construction Summary

Purchaser:Balagangadhar MUDILI

Property: 20

Telephone Res. / Bus: (416) 856-4016 /

Project: Zadorra Estates Corp.

Decor Advisor: Giulia Di Girolamo

Model and Elevation: Villa 2 Elev 2

Lock Date: 11-Jan-24

11-Jan-24

Plan #:

7. Other Flooring

Main Hall	LAMINATE - AVENUE - VENTURA OAK TL-AV 234 - PEFC
Living Room	LAMINATE - AVENUE - VENTURA OAK TL-AV 234 - PEFC
Dining Room	LAMINATE - AVENUE - VENTURA OAK TL-AV 234 - PEFC
Family Room	LAMINATE - AVENUE - VENTURA OAK TL-AV 234 - PEFC
Den / Library / Study	N/A
Basement Landing(If Applies)	N/A
Lower Landing (If Applies)	N/A
Upper Landing	LAMINATE - AVENUE - VENTURA OAK TL-AV 234 - PEFC
Upper Hall	LAMINATE - AVENUE - VENTURA OAK TL-AV 234 - PEFC
Master Bedroom	LAMINATE - AVENUE - VENTURA OAK TL-AV 234 - PEFC
Bedroom #2	LAMINATE - AVENUE - VENTURA OAK TL-AV 234 - PEFC
Bedroom #3	LAMINATE - AVENUE - VENTURA OAK TL-AV 234 - PEFC
Bedroom #4	LAMINATE - AVENUE - VENTURA OAK TL-AV 234 - PEFC
Bedroom #5	N/A
Flex Area	LAMINATE - AVENUE - VENTURA OAK TL-AV 234 - PEFC

Underpad

Standard☐

Upgrade

** Refer to Construction Summary

8. Railings and Pickets

Railing Type	AS PER CONSTRUCTION SPECIFICATIONS	Colour	TORLYS-VENTURA OAK TL-AV 234
Picket Type	AS PER CONSTRUCTION SPECIFICATIONS	Colour	TORLYS-VENTURA OAK TL-AV 234
Stringer / Riser	AS PER CONSTRUCTION SPECIFICATIONS	Colour	TORLYS-VENTURA OAK TL-AV 234
Treads	AS PER CONSTRUCTION SPECIFICATIONS	Colour	TORLYS-VENTURA OAK TL-AV 234

Red Oak Stairs as Per Vendor's Standard

** Refer to Construction Summary THE STAIN COLOURS OR FINISH AVAILABLE ON RISERS, TREADS, PICKETS AND RAILS (STAIRCASES), WILL NOT BE AN EXACT MATCH TO PREFINISHED HARDWOOD OR LAMINATE FLOORS.

9. Wall Paint Flat Finish

Main & Upper Hall	22 WARM GREY	Master Bedroom	22 WARM GREY
Living Room	22 WARM GREY	Bedroom #2	22 WARM GREY
Dining Room	22 WARM GREY	Bedroom #3	22 WARM GREY
Kitchen / Breakfast	22 WARM GREY	Bedroom #4	22 WARM GREY
Family Room	22 WARM GREY	Bedroom #5	N/A
Powder Room	22 WARM GREY	Master Ensuite	22 WARM GREY
Laundry Room	22 WARM GREY	Main Bathroom	22 WARM GREY
Den/Library	N/A	Ensuite Bath - Bedroom 3	22 WARM GREY
Trim & Door Paint-Semi Gloss	BIRCH WHITE	Mud Room	22 WARM GREY
		Flex Area	22 WARM GREY

** Refer to Construction Summary

Purchaser: Balagangadhar MUDILI

Property: 20

Telephone Res. / Bus: (416) 856-4016 /

Project: Zadorra Estates Corp.

Decor Advisor: Giulia Di Girolamo

Model and Elevation: Villa 2 Elev 2

Lock Date: 11-Jan-24

11-Jan-24

Plan #:

10. Fireplace

	Living Room			Family Room			Other Room - Specify <input type="text"/>		
	Purchased	As Per Plan	N/A	Purchased	As Per Plan	N/A	Purchased	As Per Plan	N/A
Fireplace Type	<input type="radio"/>	<input type="radio"/>	<input checked="" type="radio"/>	<input type="radio"/>	<input checked="" type="radio"/>	<input type="radio"/>	<input type="radio"/>	<input type="radio"/>	<input checked="" type="radio"/>
Mantle Type				As Per Construction Specifications					
Colour / Stain				MANTLE M1-STANDARD					
Surround				BIRCH WHITE					
Hearth				GRIGIO CARNICO					
				NO					
** Refer to Construction Summary									

11. Air Conditioning

Air Conditioning

NO

Comment

** Refer to Construction Summary

12. General Comments

** Refer to Construction Summary

Disclaimers and Notes

1) Colours of all materials are as close as possible to builder's selection, but not necessarily identical due to variances in manufacturing.

2) Any extras listed above are null and void unless accompanied by a separate invoice/amendment. Said invoice must be paid in full.

3) The Purchaser agrees that this colour selection is final and that no changes will be permitted, unless required by the Vendor.

4) The Purchaser acknowledges reading and accepting document which contains other miscellaneous disclaimers.

5) In the event of a conflict between the Standard Features schedule of the Agreement of Purchase and Sale and the Interior Colour Scheme, the Interior Colour Scheme shall prevail.

Signature 

Date: Jan 11/2024

LOT #20 - Zadora

Villa 2 36' LOT

ELEVATION 1 2,527 sq.ft. • ELEVATION 2 2,527 sq.ft. • ELEVATION 3 2,523 sq.ft.
INCLUDES 10 SQ.FT. OF OPEN AREA

Enlarge basement
windows

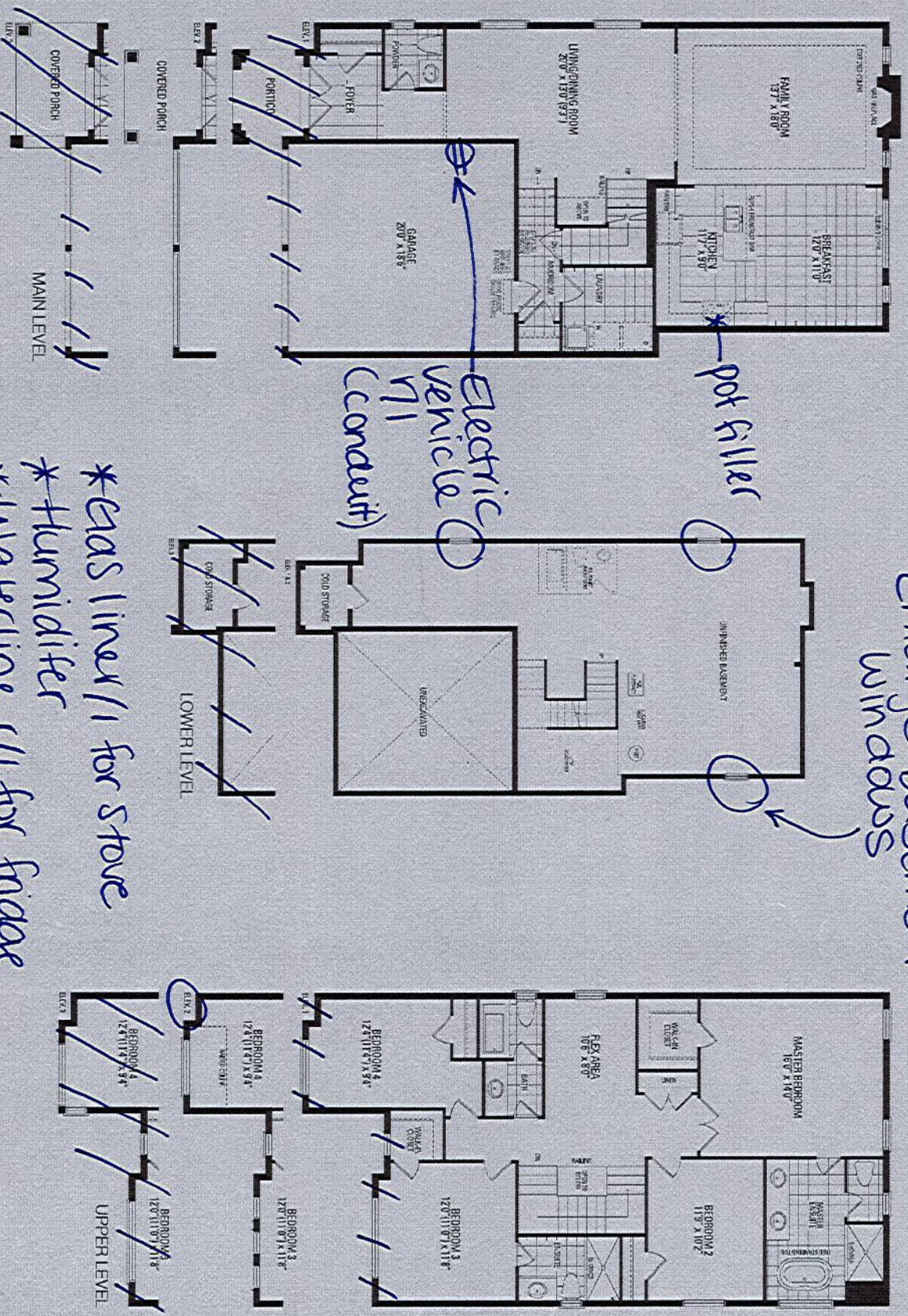

Orientation of home may be reversed and purchaser agrees to accept the same. Steps and porches may vary at any exterior entrance ways due to grading variance. Actual usable floor space may vary from the stated floor areas. All renderings are artist's concept. Dimensions, specifications and architectural detailing subject to modifications. Roofline and adjoining model types may vary due to siting. E. & O. E. May 2023

LOT # 20-Zadora

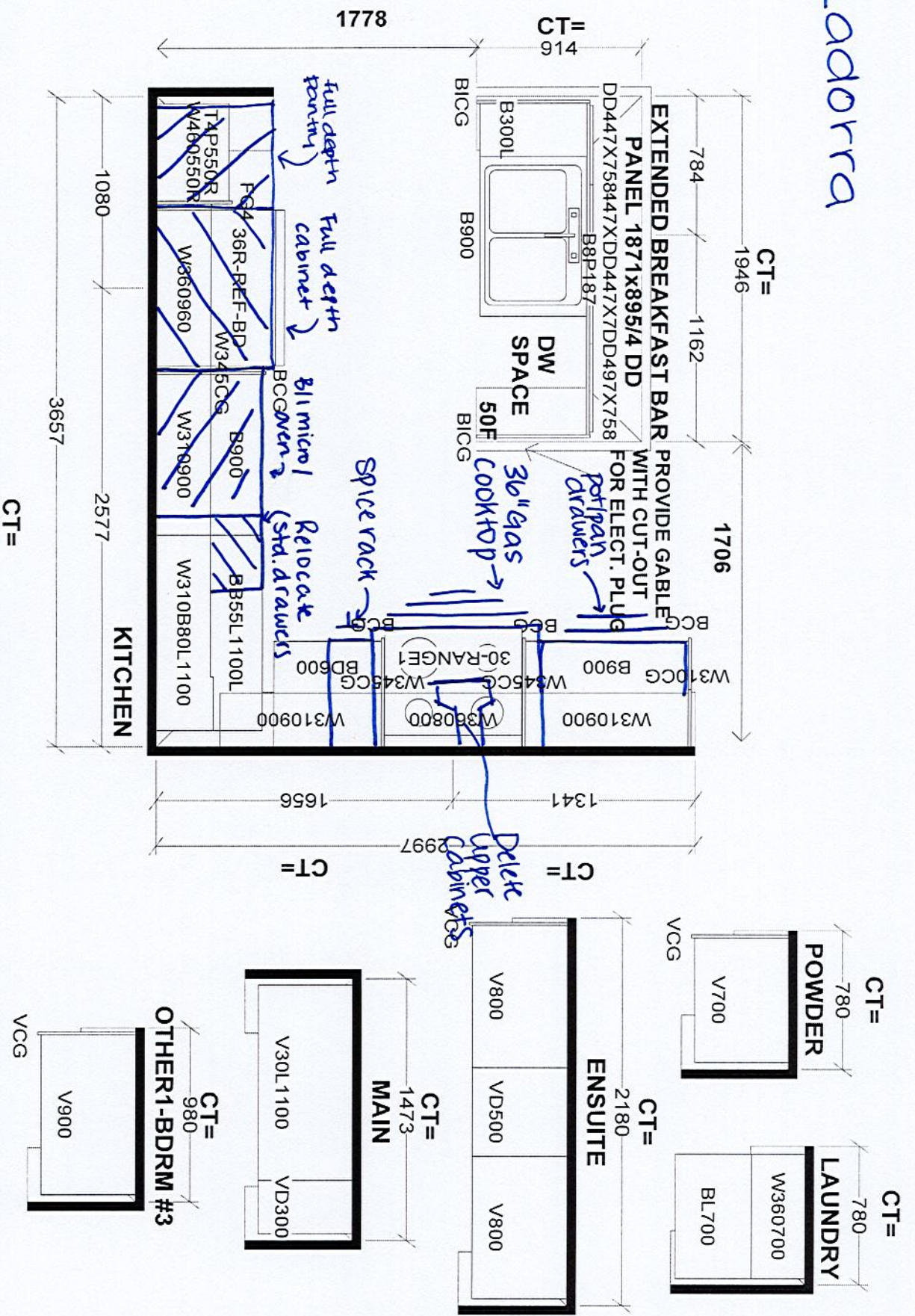

Selba Industries				J #
W WIDTH	W HGHT	W CNT	This drawing is the intellectual property of Selba Industries Inc. and is an original design which must not be released or copied unless applicable fee has been paid or job order placed.	
FLOOR HGHT	DOOR HGHT	BUILDER: GREENPARK HOMES		
ST CENT	2X4	VENT BOX COVER	SITE: ZADORA, Oshawa	
DESIGNER: BM			MODEL: VILLA 2X EL 1,2,3	
DATE: AUG 4 23			LOT #: 20-Zadora	

30" (76.2 CM) AND 36" (91.4 CM) GAS BUILT-IN COOKTOP

PRODUCT MODEL NUMBERS

KCGS350E	KCGS950E	MGC9550D	WCG75US0D
KCGS356E	KCGS956E	MGC9560D	WCG97US0D
KCGS358E	MGC7400D	WCG51US0D	WCG97US0D
KCGS358E	MGC7560D	WCG51US0D	

GAS SUPPLY REQUIREMENTS

Type of Gas

Natural Gas:

This cooktop is design-certified by CSA International for use with Natural gas or, after proper conversion, for use with LP gas.

- This cooktop is factory set for use with Natural gas. If converting to LP gas, see the "LP Gas Conversion" instructions provided in the package containing literature. The model/serial rating plate located on the underside of the cooktop base has information on the types of gas that can be used. If the types of gas listed do not include the type of gas available, check with the local gas supplier.

LP Gas Conversion:

Conversion must be done by a qualified service technician.

No attempt shall be made to convert the cooktop from the gas specified on the model/serial rating plate for use with a different gas without consulting the serving gas supplier. See the Gas Conversion instructions provided in the package containing literature.

Gas Supply Line

- Provide a gas supply line of 3/4" (1.9 cm) rigid pipe to the cooktop location. A smaller size pipe on longer runs may result in insufficient gas supply. Pipe-joint compounds that resist the action of LP gas must be used. Do not use TEFLON[®] tape. With LP gas, piping or tubing size should be 1/2" minimum. Usually, LP gas suppliers determine the size and materials used in the system.

Flexible metal appliance connector:

- If local codes permit, use a 1/2" or 3/4" I.D. flexible stainless steel tubing gas connector, designed by CSA to connect the cooktop to the rigid gas supply line.

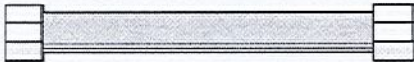

- A 1/2" male pipe thread is needed for connection to the female pipe threads of the inlet to the cooktop pressure regulator.
- Do not kink or damage the flexible metal tubing when moving the cooktop.

- Must include a shutoff valve:
The supply line must be equipped with a manual shutoff valve. This valve should be located in the same room but external to the cooktop opening, such as an adjacent cabinet. It must be accessible without removing the cooktop, and it should be in a location that allows ease of opening and closing. Do not block access to shutoff valve. The valve is for turning on or shutting off gas to the cooktop.

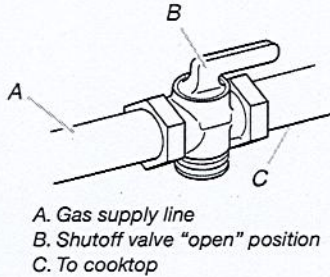

¹TEFLON is a registered trademark of E.I. Du Pont De Nemours and Company.

ELECTRICAL REQUIREMENTS

- A 120 volt, 60 Hz, AC only, 15-amp, fused electrical circuit is required. A time-delay fuse or circuit breaker is also recommended. It is recommended that a separate circuit serving only this cooktop be provided.
- Electronic ignition systems operate within wide voltage limits, but proper grounding and polarity are necessary. Check that the outlet provides 120-volt power and is correctly grounded.

Zadorra Lot # 20
page 1 of 16

PRODUCT DIMENSIONS

KCGS550ESS and KCGS950ESS Models

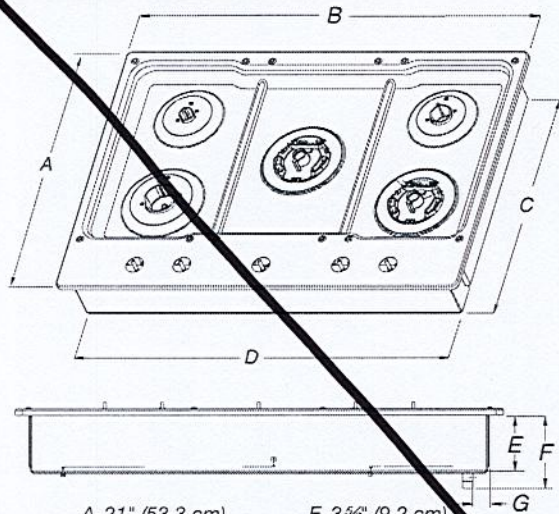

- A. 21" (53.3 cm)
- B. 30" (76.2 cm)
- C. 19 3/8" (49.2 cm)
- D. 28 3/8" (72.1 cm)
- E. 3 3/8" (9.2 cm)
- F. 4 9/16" (11.6 cm)
- G. 1 3/8" (3.4 cm)

KCGS556ESS and KCGS956ESS Models

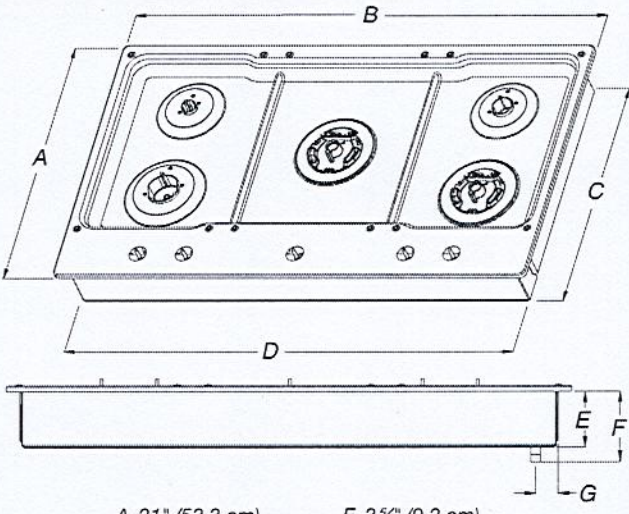

- A. 21" (53.3 cm)
- B. 36 1/4" (92.0 cm)
- C. 19 3/8" (49.2 cm)
- D. 34 3/8" (88.1 cm)
- E. 3 3/8" (9.2 cm)
- F. 4 9/16" (11.6 cm)
- G. 1 7/16" (3.6 cm)

All Other 30" (76.2 cm) Models

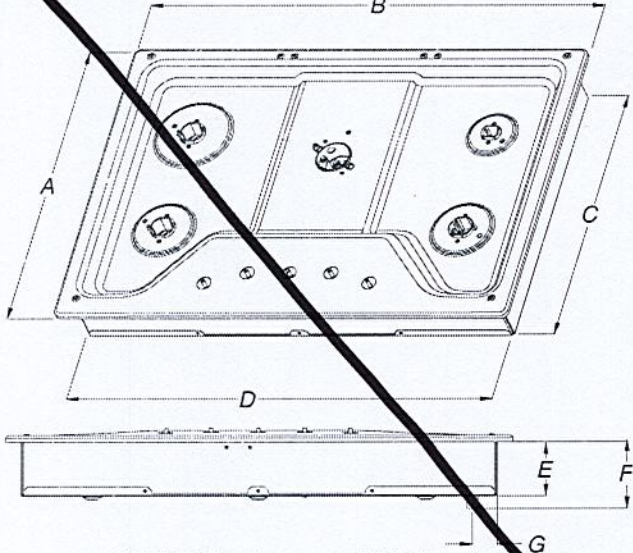

- A. 21" (53.3 cm)
- B. 30" (76.2 cm)
- C. 18 7/8" (48.0 cm)
- D. 28 3/8" (72.1 cm)
- E. 3 3/8" (8.6 cm)
- F. 4 1/8" (10.5 cm)
- G. 1 1/2" (3.8 cm)

All Other 36" (91.4 cm) Models

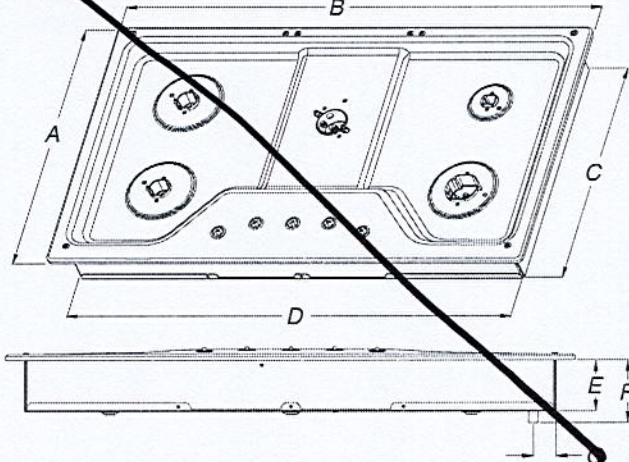

- A. 21" (53.3 cm)
- B. 36" (91.4 cm)
- C. 18 7/8" (48.0 cm)
- D. 33 3/4" (85.7 cm)
- E. 3 3/8" (8.6 cm)
- F. 4 1/8" (10.5 cm)
- G. 1 1/2" (3.8 cm)

Because Whirlpool Corporation policy includes a continuous commitment to improve our products, we reserve the right to change materials and specifications without notice.

Dimensions are for planning purposes only. For complete details, see Installation Instructions packed with product. Specifications subject to change without notice.

Zadorra Lot #20
page 2 of 16

CABINET DIMENSIONS

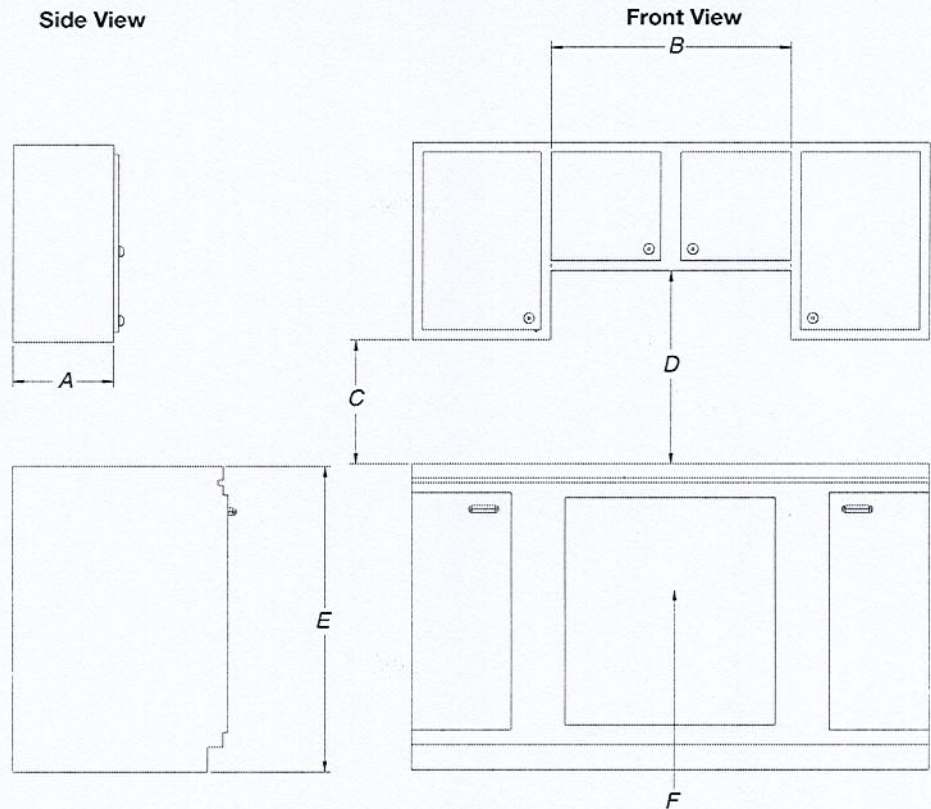

- A. 13" (33.0 cm) recommended upper cabinet depth.
- B. 30" (76.2 cm) for 30" models; 36" (91.4 cm) for 36" models.
- C. 18" (45.7 cm) minimum clearance from upper cabinet to countertop within minimum horizontal clearances to cooktop.
- D. 30" (76.2 cm) minimum clearance between top of cooktop platform and bottom of uncovered wood or metal cabinet. 24" [61 cm] minimum clearance if bottom of wood or metal cabinet is covered by not less than 1/4" [0.6 cm] flame retardant millboard covered with not less than No. 28 MSG sheet steel, 0.015" [0.04 cm] stainless steel, or 0.024" [0.06 cm] aluminum or 0.020" [0.05 cm] copper
- E. 36" (91.4 cm) top of countertop to floor.
- F. Gas line opening - Wall: anywhere 5" (12.7 cm) below underside of countertop. Cabinet floor: anywhere within 6" (15.2 cm) of rear wall is recommended.

Zadorra Lot #20
Page 3 of 16

CABINET DIMENSIONS (cont.)

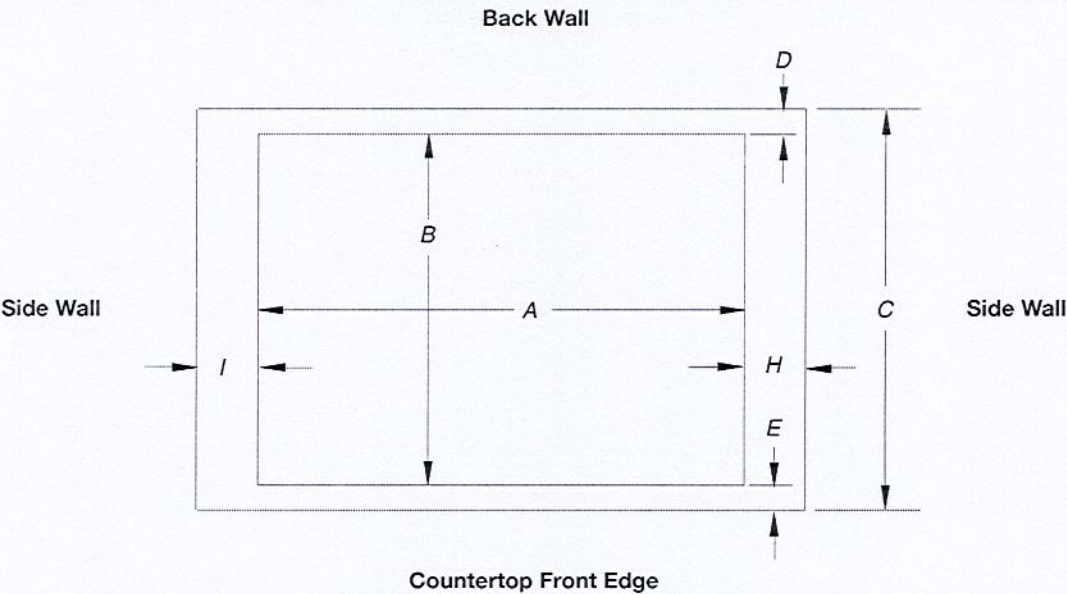

Cutout (Product Opening) Dimensions						
30" (76.2 cm) Models						
Models	A			B		
	Min	Recommended	Max	Min	Recommended	Max
KCGS550 and KCGS950	28 1/2" (72.4 cm)	28 3/4" (73.4 cm)	29 5/8" (74.3 cm)	19 1/8" (49.5 cm)	19 3/8" (50.2 cm)	20" (50.8 cm)
All Other 30" (76.2 cm) Models	28 1/2" (72.4 cm)	28 3/8" (72.4 cm)	29 5/8" (74.3 cm)	19" (48.3 cm)	19 1/2" (49.5 cm)	20" (50.8 cm)
36" (91.4 cm) Models						
KCGS556 and KCGS956	34 7/8" (88.4 cm)	35 5/8" (89.4 cm)	35 5/8" (90.3 cm)	19 1/8" (49.5 cm)	19 3/8" (50.2 cm)	20" (50.8 cm)
All Other 36" (91.4 cm) Models	33 7/8" (86.0 cm)	34 5/8" (87.0 cm)	35 1/4" (89.5 cm)	19" (48.3 cm)	19 1/2" (49.5 cm)	20" (50.8 cm)

Side Walls (Combustible Surfaces)	
Models	H and I
KCGS5 and KCGS9	H and I added together must be at least 48" (122.0 cm), with each side individually being at least 8" (20.3 cm).
KCGS350, KCGS356, MGC9536, WCG97US0, WCG97US6	H and I added together must be at least 48" (122.0 cm), with each side individually being at least 12" (30.5 cm).
All Other Models	Both have to be 8" (20.3 cm) or more.

Back Wall and Countertop Front Dimensions			
Models	C	D	E
KCGS550 and KCGS950	25" (63.5 cm)	2 7/8" (7.3 cm)	2 3/4" (6.9 cm)
All Other Models			3 1/8" (7.9 cm)

NOTES: After making the countertop cutout, some installations may require notching down the base cabinet side walls to clear the cooktop base. To avoid this modification, use a base cabinet with sidewalls wider than the cutout.

If cabinet has a drawer, a 4" (10.2 cm) depth clearance from the countertop to the top of the drawer (or other obstruction) in base cabinet is required. The drawer depth may need to be shortened to avoid interfering with the regulator.

IMPORTANT: If a built-in wall oven is to be installed below this cooktop, the grounded outlet and gas supply piping must be located in an adjacent cabinet.

This cooktop and its gas and electrical supply sources must be installed before the undercounter built-in wall oven is installed.

Zadorra Lot #20
page 4 of 16

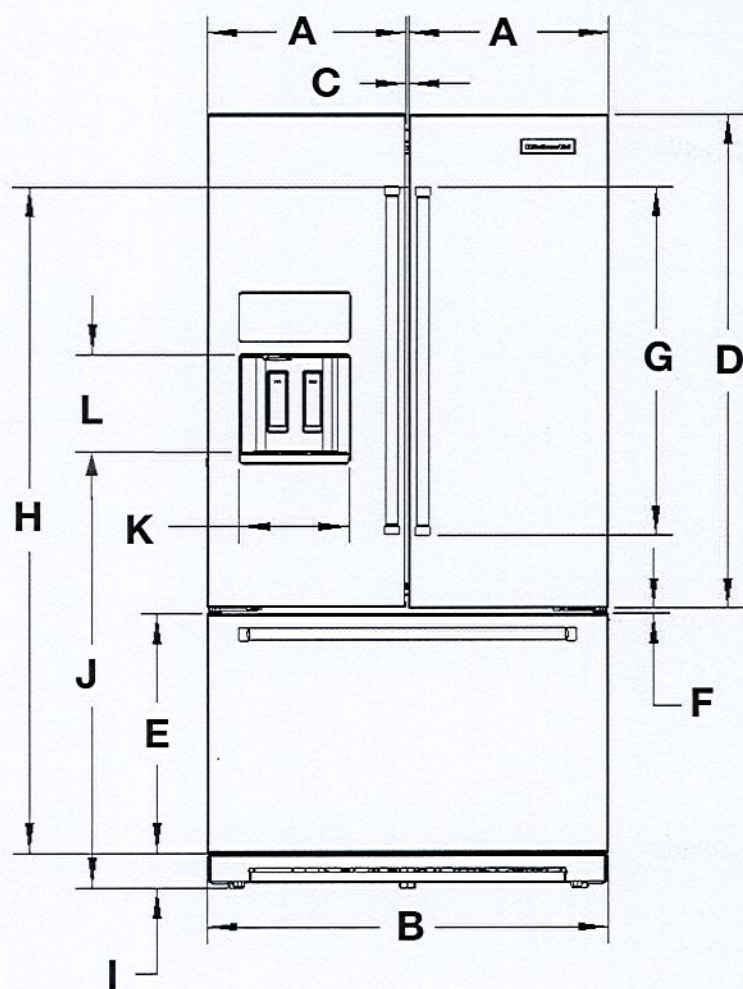

Description		Inches	mm
A	Width of RC door	17 ⁷ / ₈	453.9
B	Width of FC door	35 ¹⁵ / ₁₆	912.6
C	Space between RC doors	3/8	9.18
D	Height of RC door	44 ¹¹ / ₁₆	1135.4
E	Height of FC door	21 ¹¹ / ₁₆	551.5
F	Space between RC and FC doors	1/2	12
G	Height of door handles	31 ⁹ / ₁₆	802.4
H	Height of Top Handle to Floor	63 ⁹ / ₁₆	1614
I	Height of grille	3 ¹ / ₈	79.1
J	Height to bottom of the dispenser	39 ¹ / ₄	996.1
K	Width of Dispenser	9 ¹³ / ₁₆	249.9
L	Height of Dispenser	9	229.4
M	Water line location distance from side	2 ¹ / ₂	63.5
N	Water line location distance from bottom	8 ³ / ₁₆	207.7

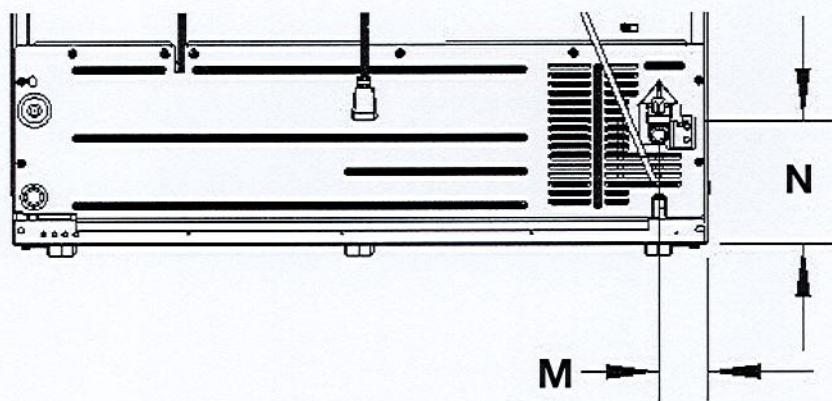

Because Whirlpool Corporation policy includes a continuous commitment to improve our products, we reserve the right to change materials and specifications without notice. Dimensions are for planning purposes only. For complete details, see Installation Instructions packed with product. Specifications subject to change without notice.

W11640023A

Zadorra Lot # 20
page 5 of 16

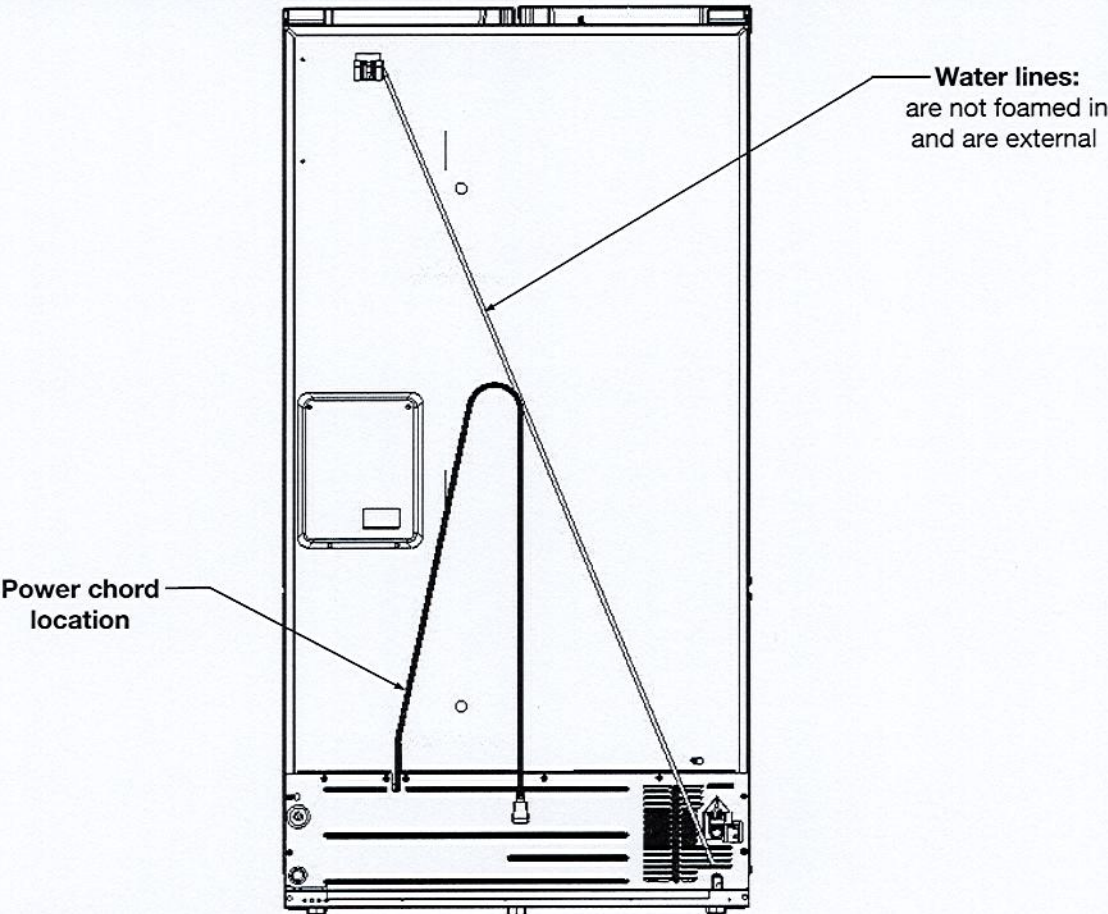

Electrical Requirements

⚠ WARNING

Electrical Shock Hazard

Plug into a grounded 3 prong outlet.

Do not remove ground prong.

Do not use an adapter.

Do not use an extension cord.

Failure to follow these instructions can result in death, fire, or electrical shock.

	Power chord	
	Type	Length
		Inches mm
	Standard	75 ⁵ / ₈ 1920

Electrical: A 115 V, 60 Hz AC only, 15 A or 20 A fused, grounded electrical supply is required. It is recommended that a separate circuit serving only your refrigerator be provided. Use an outlet that cannot be turned off by a switch. Do not use an extension cord.

Because Whirlpool Corporation policy includes a continuous commitment to improve our products, we reserve the right to change materials and specifications without notice. Dimensions are for planning purposes only. For complete details, see Installation Instructions packed with product. Specifications subject to change without notice.

Water: A cold water supply with water pressure of between 30 psi and 120 psi (207 kPa and 827 kPa) is required to operate the water dispenser and ice maker. If you have questions about your water pressure, call a licensed, qualified plumber.

Zadorra Lot #20
page 6 of 16

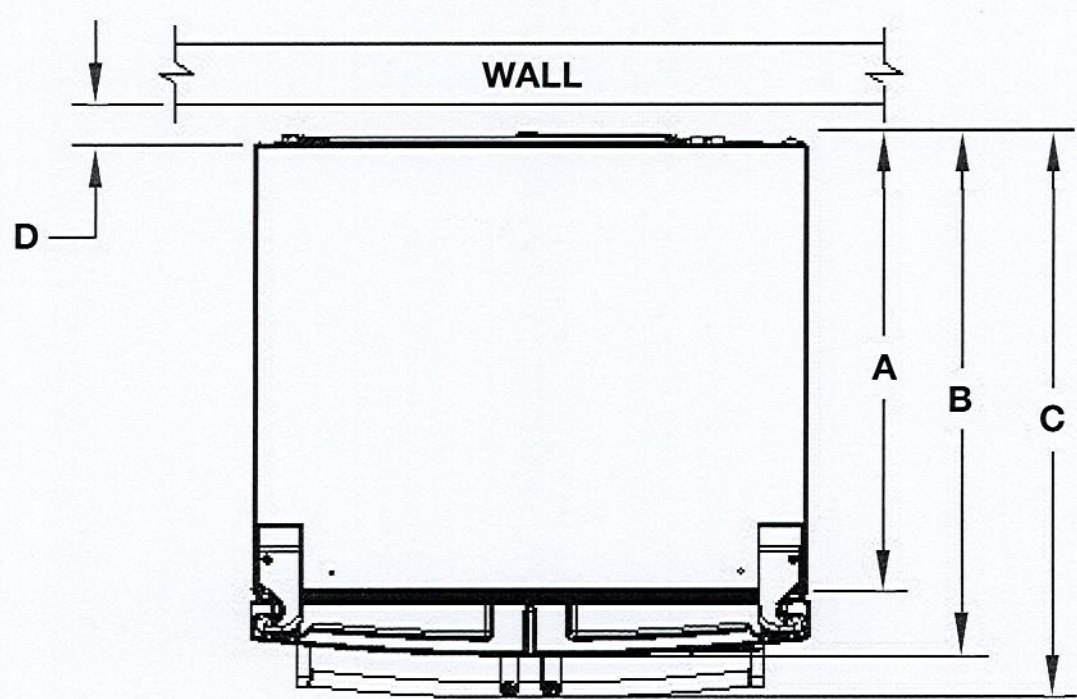

Description		Inches	mm
A	Depth without doors	29¾	755.27
B	Depth with doors	33 ¹⁵ / ₁₆	861.37
C	Depth with handles	36 ⁵ / ₈	930.77
D	Space required for water lines and power chord	2	50.8

Because Whirlpool Corporation policy includes a continuous commitment to improve our products, we reserve the right to change materials and specifications without notice. Dimensions are for planning purposes only. For complete details, see Installation Instructions packed with product. Specifications subject to change without notice.

Zadorra Lot #20
page 7 of 16

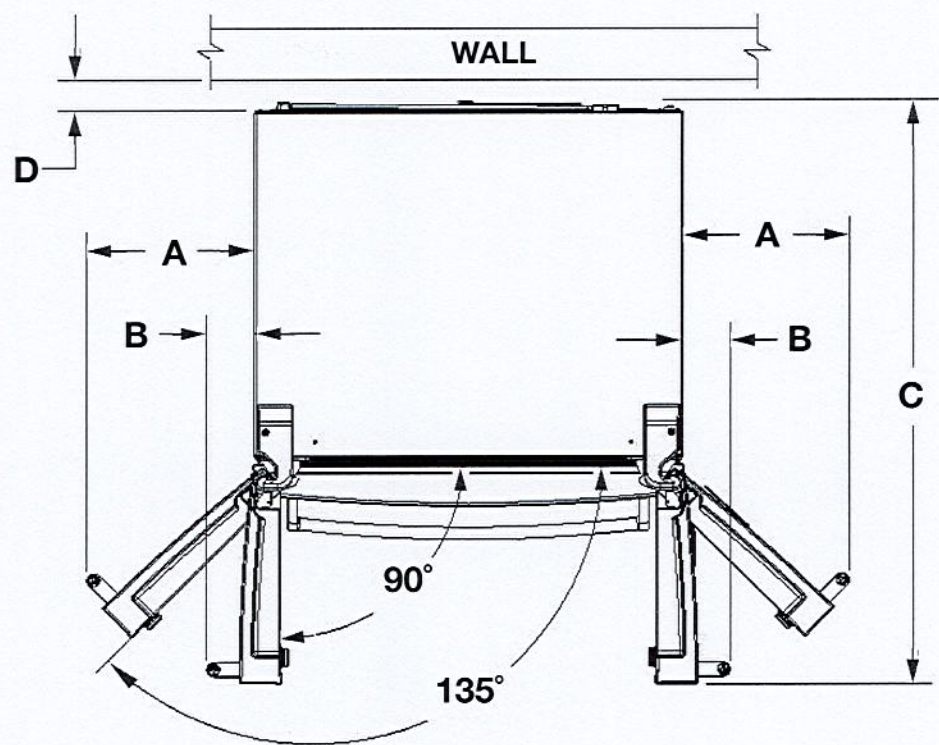

Description		Inches	mm
A	Width from RC side of refrigerator to handle - door fully open 135°	13 ⁷ / ₈	352.63
B	Width from side RC side of refrigerator to handle - door open 90°	4	100.9
C	Depth with RC doors open 90°	48 ⁷ / ₈	1240.87
D	Space required for water lines and power chord	2	50.8

Because Whirlpool Corporation policy includes a continuous commitment to improve our products, we reserve the right to change materials and specifications without notice. Dimensions are for planning purposes only. For complete details, see Installation Instructions packed with product. Specifications subject to change without notice.

Zadorra Lot #20
Page 8 of 16

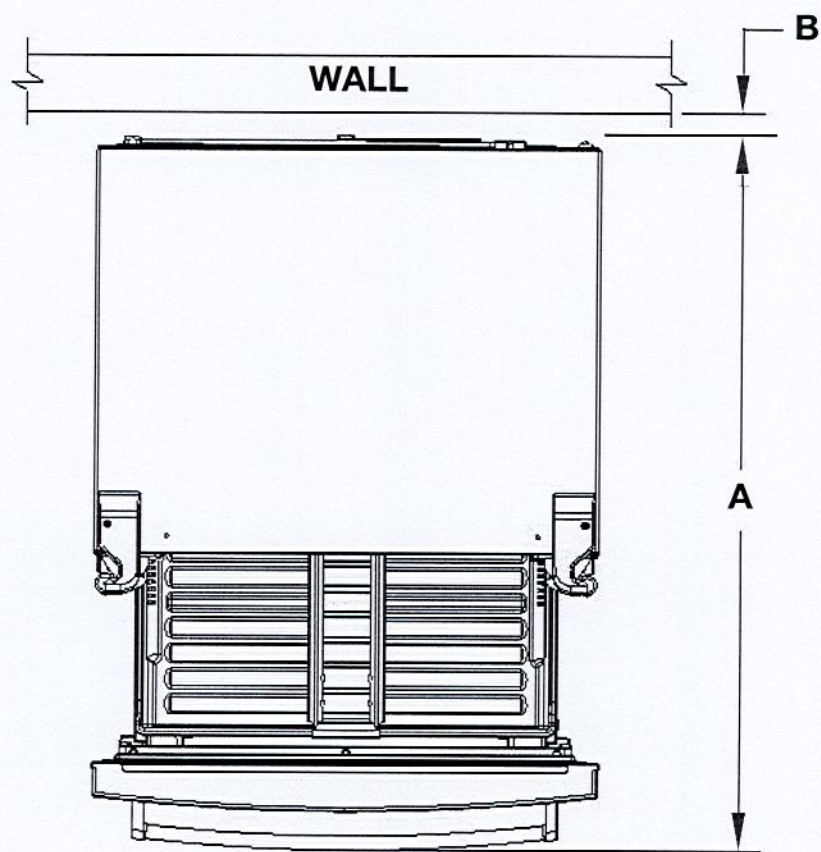

Description		Inches	mm
A	Depth with FC door fully open	54 ⁵ / ₈	1387.92
B	Space required for water lines and power chord	2	50.8

Because Whirlpool Corporation policy includes a continuous commitment to improve our products, we reserve the right to change materials and specifications without notice. Dimensions are for planning purposes only. For complete details, see Installation Instructions packed with product. Specifications subject to change without notice.

Zadorra Lot #20
page 9 of 16

62

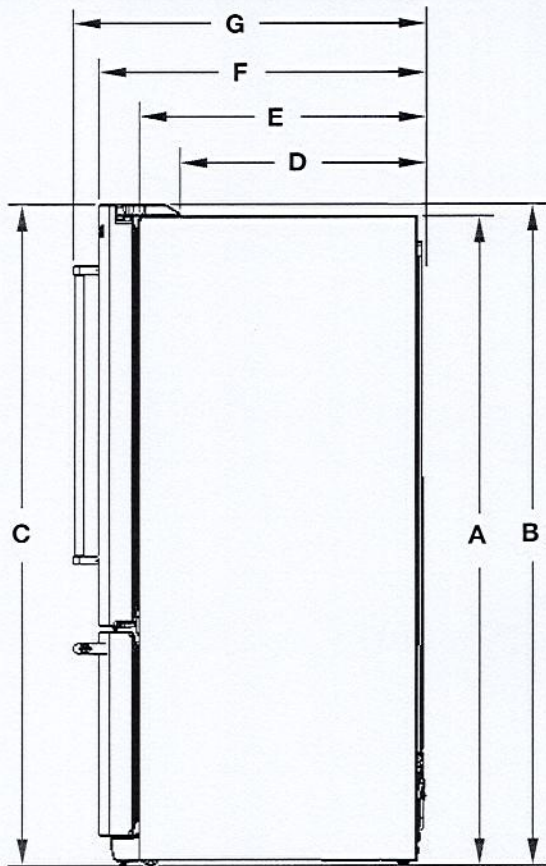

Description		Inches	mm
A	Height of recessed refrigerator	68 ¹¹ / ₁₆	1744.6
B	Height to top of hinges	69 ¹⁵ / ₁₆	1776.6
C	Total Height	70 ¹ / ₁₆	1780.4
D	Depth to back of hinges	25 ³ / ₈	643.77
E	Depth without doors	29 ³ / ₄	755.27
F	Depth with doors	33 ¹⁵ / ₁₆	861.37
G	Depth with handles	36 ⁵ / ₈	930.77

Interior dimensions	Width Inches (mm)	Height Inches (mm)
Refrigerator Compartment	32 ⁹ / ₁₆ " (827.2)	40 ¹ / ₈ " (1019.4)
Freezer Compartment	31 ¹ / ₈ " (790.4)	17 ¹⁵ / ₁₆ " (454.8)

Location Requirements

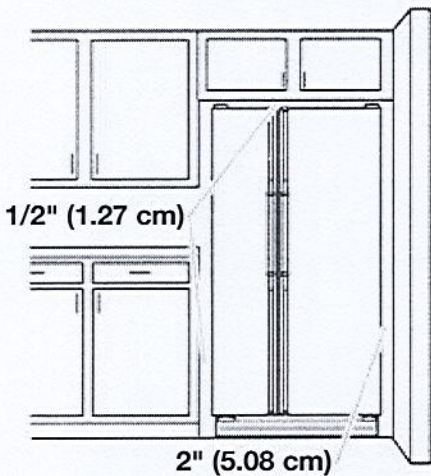

⚠ WARNING

Explosion Hazard
Keep flammable materials and vapors, such as gasoline, away from refrigerator.
Failure to do so can result in death, explosion, or fire.

To ensure proper ventilation for your refrigerator, allow for 1/2" (1.27 cm) of space on each side and at the top. Allow for 1" (2.54 cm) of space behind the refrigerator. If your refrigerator has an ice maker, allow extra space at the back for the water line connections. When installing your refrigerator next to a fixed wall, leave a 2" (5.08 cm) minimum space on each side (depending on your model) to allow the doors to swing open.

NOTES:

- This refrigerator is intended for use in a location where the temperature ranges from a minimum of 55°F (13°C) to a maximum of 110°F (43°C). The preferred room temperature range for optimum performance, which reduces electricity usage and provides superior cooling, is between 60°F (15°C) and 90°F (32°C). It is recommended that you do not install the refrigerator near a heat source, such as an oven or radiator.
- Normal minimum cabinet cut-out width required for product installation is 36" (91.44 cm). However, if the product is placed against an extended wall and the ability to remove the crisper pans is desired, an additional 18" (45.72 cm) of cabinet width is required, so a total cabinet opening width of 54" (137.16 cm) is recommended.

Because Whirlpool Corporation policy includes a continuous commitment to improve our products, we reserve the right to change materials and specifications without notice. Dimensions are for planning purposes only. For complete details, see Installation Instructions packed with product. Specifications subject to change without notice.

Zadorra Lot #20
Page 10 of 16

KitchenAid®

27" (68.6 cm) and 30" (76.2 cm) Electric Built-In Microwave/Oven Combination

PRODUCT MODEL NUMBERS

KOEMS309E KOCE500E KOCE507E

ELECTRICAL CONNECTION

If codes permit and a separate ground wire is used, it is recommended that a qualified electrical installer determine that the ground path and the wire gauge are in accordance with local codes. Check with a qualified electrical installer if you are not sure the oven is properly grounded.

This oven must be connected to a grounded metal, permanent wiring system.

Be sure that the electrical connection and wire size are adequate and in conformance with the National Electrical Code, ANSI/NFPA 70-latest edition or CSA Standards C22.1-94, Canadian Electrical Code, Part 1 and C22.2 No. O-M91-latest edition, and all local codes and ordinances.

To properly install your oven, you must determine the type of electrical connection you will be using and follow the instructions provided for it here.

- Oven must be connected to the proper electrical voltage and frequency as specified on the model/serial/rating plate. See the following illustration.

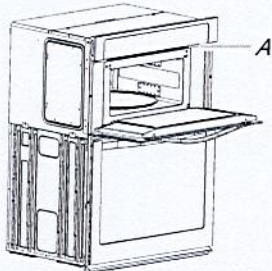

A. Model/serial/rating plate

- Models rated from 7.3 to 9.6 kW at 240 volts (5.4 to 7.4 kW at 208 volts) require a separate 40-amp circuit. Models rated at 4.8 kW and below at 240 volts (3.6 kW and below at 208 volts) require a separate 30-amp circuit.
- A circuit breaker is recommended.
- Connect directly to the fused disconnect (or circuit breaker box) through flexible, armored or nonmetallic sheathed, copper cable (with grounding wire). See "Make Electrical Connection" section.
- Flexible conduit from the oven should be connected directly to the junction box.
- Do not cut the conduit. The length of conduit provided is for serviceability of the oven.
- A UL listed or CSA approved conduit connector must be provided.
- If the house has aluminum wiring, follow the procedure below:
 - Connect a section of solid copper wire to the pigtail leads.
 - Connect the aluminum wiring to the added section of copper wire using special connectors and/or tools designed and UL listed for joining copper to aluminum.

Follow the electrical connector manufacturer's recommended procedure. Aluminum/copper connection must conform with local codes and industry accepted wiring practices.

For power requirements, refer to the following table.

Model	Voltage	Amperage (L1)*	Amperage (L2)*	Rating (W)
KOCE507E/KOCE500E	120/240	32	30	8000
KOCE507E/KOCE500E	120/208	30	28	6600

*Amperage values noted above are for information purposes only: the units are rated in watts.

Because Whirlpool Corporation includes a continues commitment to improve our products, we reserve the right to change materials and specifications without notice.

PRODUCT DIMENSIONS

27" (68.6 cm) models

- A. 42 1/16" (108.0 cm) overall height
- B. 25 7/16" (64.6 cm) recessed width
- C. 41" (104.1 cm) recessed height
- D. 23 1/4" (59.1 cm) max. recessed depth
- E. 27" (68.6 cm) overall width
- F. 48" (121.9 cm) flexible conduit length measured from the conduit clamp located at the rear of the oven. Do not remove the conduit clamp.

30" (76.2 cm) models

- A. 42 3/16" (108.0 cm) overall height
- B. 28 7/16" (72.3 cm) recessed width
- C. 41" (104.1 cm) recessed height
- D. 23 1/4" (59.1 cm) max. recessed depth
- E. 30" (76.2 cm) overall width
- F. 48" (121.9 cm) flexible conduit length measured from the conduit clamp located at the rear of the oven. Do not remove the conduit clamp.

Cabinet Dimensions

27" (68.6 cm) models

- A. 27" (68.6 cm) min. cabinet width
- B. 1" (2.5 cm) top of cutout to bottom of upper cabinet door
- C. 19 1/4" (48.9 cm) bottom of cutout to floor is recommended. 4"-19 1/4" (10.2-48.9 cm) bottom of cutout to floor is acceptable.
- D. 25 1/2" (64.8 cm) cutout width
- E. 1 1/8" (3.8 cm) min. bottom of cutout to top of cabinet door
- F. 41 1/16" (105 cm)* recommended cutout height
- G. 24" (60.7 cm) cutout depth

30" (76.2 cm) models

- A. 30" (76.2 cm) min. cabinet width
- B. 1" (2.5 cm) top of cutout to bottom
- C. 19 1/4" (48.9 cm) bottom of cutout to floor is recommended. 4"-19 1/4" (10.2-48.9 cm) bottom of cutout to floor is acceptable.
- D. 28 1/2" (72.4 cm) cutout width
- E. 1 1/8" (3.8 cm) min. bottom of cutout
- F. 41 1/16" (105 cm)* recommended cutout
- G. 24" (60.7 cm) cutout depth

* NOTE: The cabinet height can be between 41" (104.1 cm) and 41 1/2" (105.6 cm) for microwave/oven combination.

Dimensions are for planning purposes only. For complete details, see Installation Instructions packed with product. Specifications subject to change without notice.

Ref. W10725683B 2/10/15

Zadorra Lot #20
page 11 of 16

BZ



24" Dishwasher

DETAILED PLANNING DIMENSIONS GUIDE

Applies to all model numbers starting with;
KDFE104K, KDTE104K, KDFE204K, KDTE204K, KDTE304LPA,
KDFM404K, KDTM404K, KDPM604K, KDTM604K, KDPM704K,
KDTM704K, KDTM704LPA, KDPM804K, KDTM804K

PRODUCT DIMENSIONS

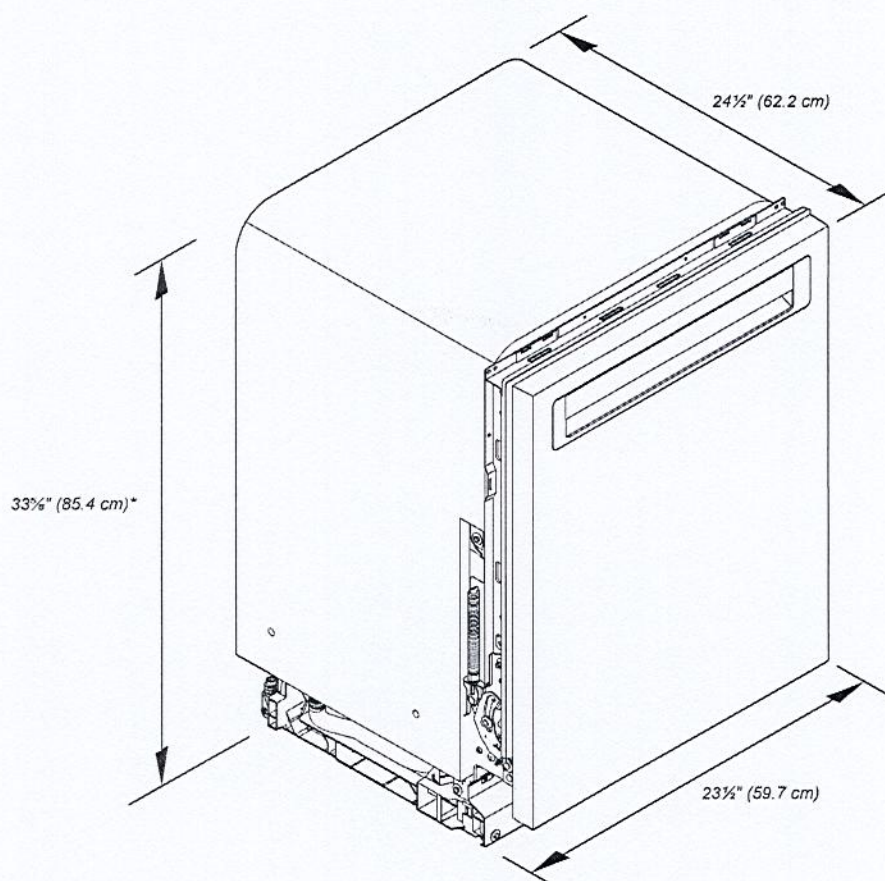

*Dishwasher can be raised 1 1/4" (3.7 cm) with feet fully extended.

Because Whirlpool Corporation policy includes a continuous commitment to improve our products, we reserve the right to change materials and specifications without notice.

Dimensions are for planning purposes only. For complete details, see Installation Instructions packed with product. Specifications subject to change without notice.

KitchenAid®

24" Dishwasher

DETAILED PLANNING DIMENSIONS GUIDE

PRODUCT DIMENSIONS (CONTD.)

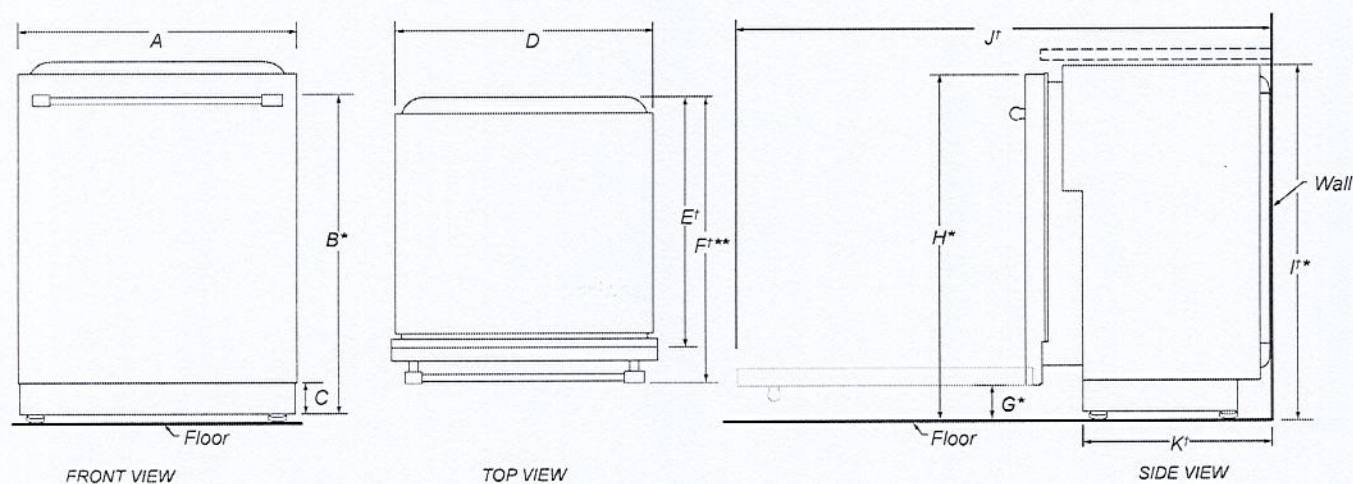

	DESCRIPTION	DIMENSIONS
A	Width of door	23½" (59.7 cm)
B*	Height to top of handle	30⅜" (78.3 cm)
C	Height of adjustable toe kick	3⅞" (8.4 cm) - min. 4⅞" (11.8 cm) - max.
D	Width of recessed dishwasher	22⅝" (57.4 cm)
E†	Depth without door	22⅝" (57.5 cm)
F†**	Depth with Towel Bar Handle	26⅞" (68.3 cm)
	Depth with Pocket Handle	24½" (62.6 cm)
	Depth of Panel-Ready Models	24" (61.0 cm)
G*	Height to bottom of door (min.)	3⅞" (8.4 cm)
H*	Height to top of door (min.)	33⅞" (84.9 cm)
I*	Height of recessed dishwasher (min.)	33⅝" (85.4 cm)
J†	Depth with door fully open (min.)	50⅞" (127.4 cm)
K†	Depth with toe kick (min.)	20⅜" (52.9 cm)

†Insulation blanket thickness not included, can be crushed up to 1/8" (0.3 cm), or removed along the top perforate section for additional clearance.

*Dishwasher can be raised 1⅞" (3.7 cm) with feet fully extended.

**For panel-ready models, dishwasher depth is 24" (61.0 cm), not including the 3/4" (1.9 cm) custom door panel.

Because Whirlpool Corporation policy includes a continuous commitment to improve our products, we reserve the right to change materials and specifications without notice.

Dimensions are for planning purposes only. For complete details, see Installation Instructions packed with product. Specifications subject to change without notice.

Zadora Lot #20
page 13 of 16

(Handwritten signature)

KitchenAid®

24" Dishwasher
DETAILED PLANNING DIMENSIONS GUIDE

OPENING/CLEARANCE DIMENSIONS

IMPORTANT: Check that all surfaces have no protrusions that would prohibit dishwasher installation.

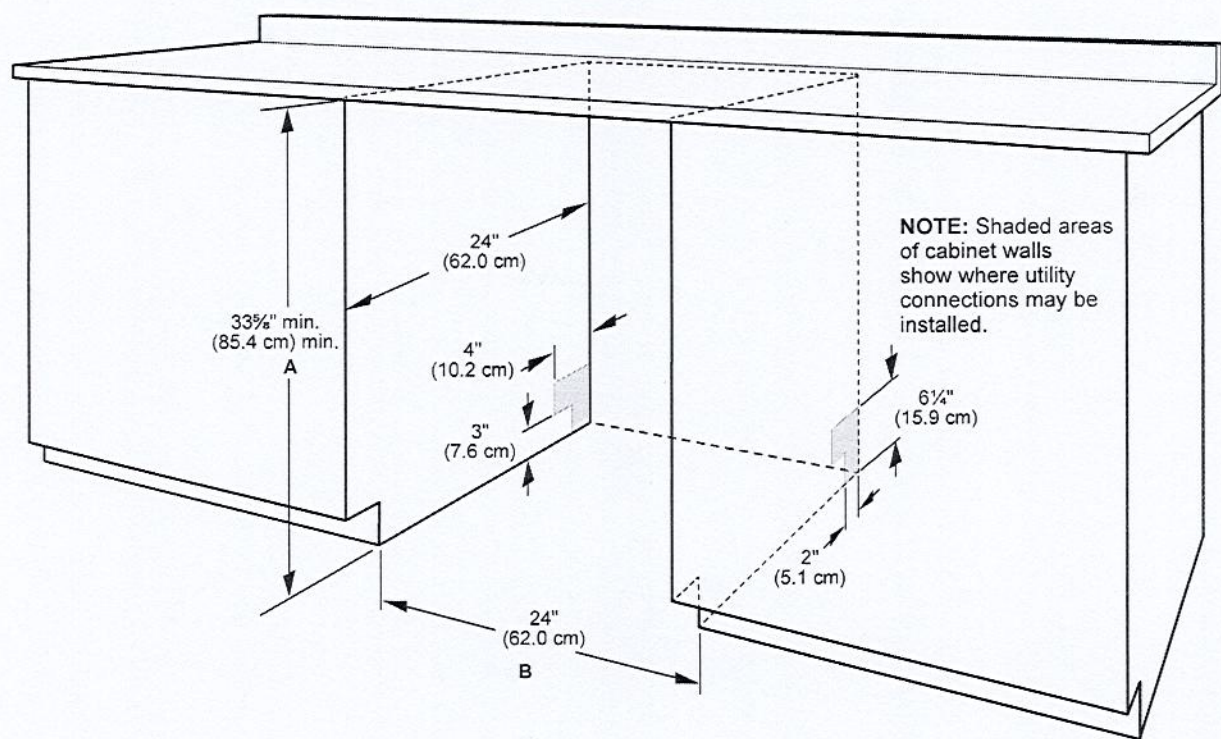

- A. Measured from the lowest point on the underside of the countertop. May be reduced to 33 3/8" min. (85.4 cm) min. by removing the feet and perforated area of insulation (blanket) on dishwasher.
- B. Minimum, measured from narrowest point of opening.
- NOTE:** Corner locations require a 2" (5.1 cm) minimum clearance between the side of the dishwasher door and the wall or cabinet.

Because Whirlpool Corporation policy includes a continuous commitment to improve our products, we reserve the right to change materials and specifications without notice.

Dimensions are for planning purposes only. For complete details, see Installation Instructions packed with product. Specifications subject to change without notice.

Zadorra Lot #20
Page 14 of 16

122

PRODUCT MODEL NUMBERS

KVWB600D KVWB606D

Electrical: A 120 volt, 60 Hz., AC only, 15-amp, fused electrical circuit is required.

VENTING METHODS

This canopy range hood is factory set for venting through the roof or through the wall.

A 6" (15.2 cm) round vent system is needed for installation (not included). The hood exhaust opening is 6" (15.2 cm) round.

NOTE: Flexible vent is not recommended. Flexible vent creates back pressure and air turbulence that greatly reduce performance.

Vent system can terminate either through the roof or wall. To vent through a wall, a 90° elbow is needed.

Rear Discharge

A 90° elbow may be installed immediately above the hood.

For Non-Vented (Recirculating) Installations

If it is not possible to vent cooking fumes and vapors to the outside, the hood can be used in the non-vented (recirculating) version, using a Recirculation Kit (which includes charcoal filters and a deflector). To order, see the "Assistance or Service" section.

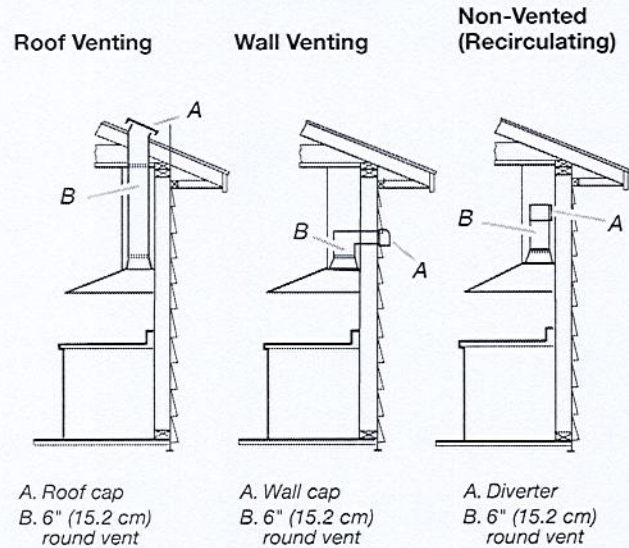

Calculating Vent System Length

To calculate the length of the system you need, add the equivalent feet (meters) for each vent piece used in the system.

Vent System

Vent Piece	6" (15.2 cm) Round
45° elbow	2.5 ft (0.8 m)
90° elbow	5.0 ft (1.5 m)

Maximum equivalent vent length is 35 ft (10.7 m).

Example Vent System

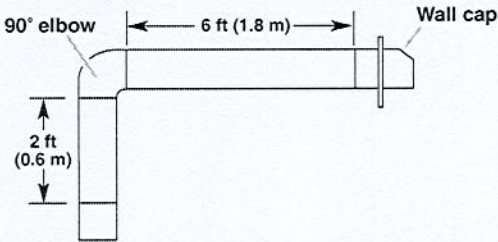

The following example falls within the maximum recommended vent length of 35 ft (10.7 m).

1 - 90° elbow	= 5.0 ft (1.5 m)
1 - wall cap	= 0.0 ft (0.0 m)
8 ft (2.4 m) straight	= 8.0 ft (2.4 m)
Length of system	= 13.0 ft (3.9 m)

PRODUCT DIMENSIONS

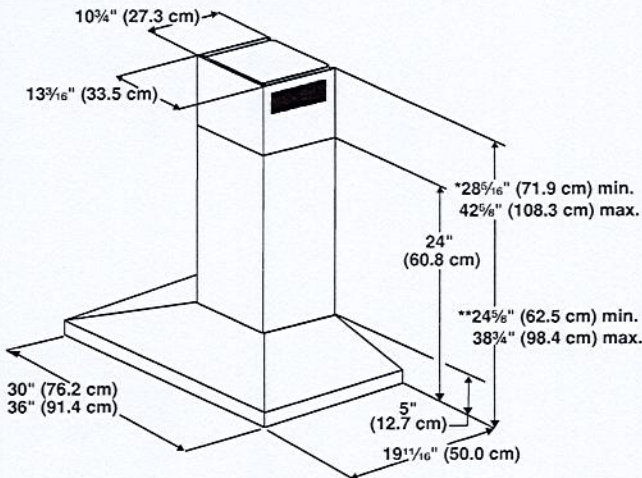

*For non-vented (recirculating) installations

**For vented installations

Zadorra Lot #20
Page 15 of 16



CABINET DIMENSIONS

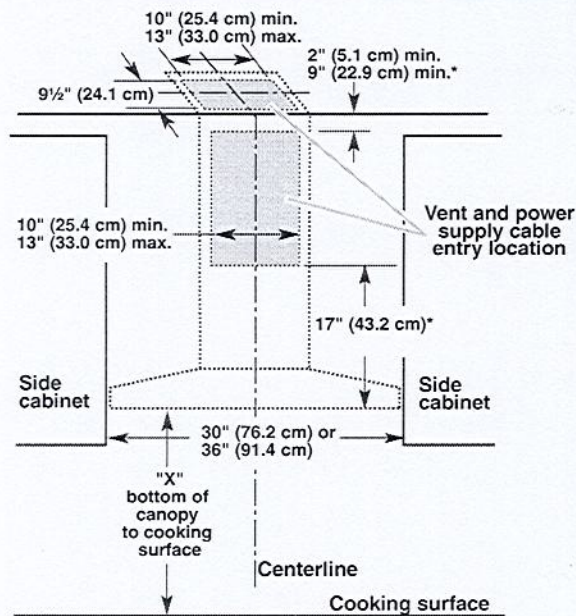

*For non-vented (recirculating) installations

IMPORTANT:

- Minimum distance "X": 24" (61.0 cm) from electric cooking surface.
- Minimum distance "X": 27" (68.6 cm) from gas cooking surfaces.
- Suggested maximum distance "X": 36" (91.4 cm)

The chimneys can be adjusted for different ceiling heights. See the following chart.

Vented Installations		
	Min. ceiling height	Max. ceiling height
Electric cooking surface	7' 1" (2.16 m)	9' 2" (2.79 m)
Gas cooking surface	7' 4" (2.23 m)	9' 2" (2.79 m)

Non-vented (recirculating) Installations		
	Min. ceiling height	Max. ceiling height
Electric cooking surface	7' 1" (2.16 m)	9' 6" (2.9 m)
Gas cooking surface	7' 4" (2.23 m)	9' 6" (2.9 m)

***NOTE:** The range hood chimneys are adjustable and designed to meet varying ceiling or soffit heights depending on the distance "X" between the bottom of the range hood and the cooking surface. For higher ceilings, a Chimney Extension Kit is available from your dealer or an authorized parts distributor. The chimney extension replaces the chimney shipped with the range hood. To order, see the "Assistance or Service" section.

Zadorra Lot #20
Page 16 of 16