

CONSTRUCTION SUMMARY

Palmetto - Zadorra Estates Corp.

RECEIVED  
APR 09 2024

PURCHASERS: Ashwin Chandra PENDYALA and Haarika MADIREDDI

TEL: RES.: 289-387-9173

LOT / PHASE 135 / 1	REG. PLAN # 40M-2763	HOUSE TYPE Villa 12 Elev 2		
------------------------	-------------------------	-------------------------------	--	--

CABINETRY

1 - CABINETRY PROVISION - PROVISION FOR PLUG ON ISLAND (PLUG EXTRA ORDERED SEPARATELY) 13Oct23 Note:	
---	--

CABINETRY ACCESSORIES

1 - KITCHEN CABINETRY - BUILT-IN FRIDGE FEE - PRICE IS EACH 22Mar24 Note:	
1 - KITCHEN CABINETRY BASE - COOKTOP CABINET WITH POT DRAWERS (2 DRAWERS) - STANDARD LEVEL 22Mar24 Note:	
1 - KITCHEN CABINETRY - BUILT-IN MICROWAVE/OVEN COMBO WITH ONE POT DRAWER - STANDARD LEVEL 21Mar24 Note: SHIFT FRIDGE TO ACCOMADATE BUILT IN - SEE SKETCH	
1 - KITCHEN CABINETRY UPPER - FULL DEPTH ABOVE FRIDGE UPPER WITH GABLES - 650MM DEEP - PRICE IS EACH 21Mar24 Note: SHIFT FRIDGE TO ACCOMMADATE BUILT IN - SEE SKETCH	

CERAMIC TILE

1 - DELETE ALL CERAMIC BATHROOM ACCESSORIES - DELETE TOWEL BAR, PAPER HOLDER & SOAP DISH THROUGHOUT 21Mar24 Note:	
--	--

CONSTRUCTION

4 - ENLARGED BASEMENT WINDOWS (MAY REQUIRE WINDOW WELLS) - WINDOW IS 30 INCHES X 24 INCHES 09Jun23 Note:	
---	--

COUNTER TOP

1 - KITCHEN COUNTER TOP - UPGRADE STONE COUNTER TOP 21Mar24 Note:	
--	--

ELECTRICAL

1 - BUILT IN OVEN AND COOKTOP PROVISION - PROVISION ONLY - ELECTRICAL ONLY 21Mar24 Note:	
1 - FAMILY ROOM - SWITCH - DIMMER SWITCH IN LIEU OF EXISTING SWITCH - PRICE IS EACH 13Oct23 Note:	
1 - PLUG - ELECTRICAL PLUG - TO BE INSTALLED OVER FIREPLACE 13Oct23 Note:	
1 - PLUG - ELECTRICAL PLUG - ADD TO ISLAND 13Oct23 Note:	
1 - ABOVE KITCHEN ISLAND - ADD LIGHT AND SWITCH - NO FIXTURE INCLUDED 13Oct23 Note:	
1 - PLUG - ELECTRICAL PLUG WITH GFI AND SWITCH - FOR FESTIVE LIGHTING 13Oct23 Note:	
1 - ELECTRIC VEHICLE ROUGH-IN PROVISION ONLY FOR FUTURE ELECTRIC CAR (CONDUIT FROM BASEMENT INTO JUNCTION BOX IN GARAGE WITH PULL STRING, NO WIRE) 13Oct23 Note:	



CONSTRUCTION SUMMARY

Palmetto - Zadorra Estates Corp.

PURCHASERS: Ashwin Chandra PENDYALA and Haarika MADIREDDI

TEL: RES.: 289-387-9173

LOT / PHASE 135 / 1	REG. PLAN # 40M-2763	HOUSE TYPE Villa 12 Elev 2		
------------------------	-------------------------	-------------------------------	--	--

FIREPLACE AND ACCESSORIES

1 - GAS LINE ROUGH-IN FOR STOVE (INCLUDES ELECTRICAL OUTLET) - FIRST FLOOR 13Oct23    Note:	
--	--

HARDWOOD FLOORING

1 - HARDWOOD - GROUP A SERIES 5 INCH - FIRST FLOOR HARDWOOD AREAS INCLUDING STAIR LANDINGS 21Mar24    Note:	
--	--

HEATING AND AIR CONDITIONING

1 - HUMIDIFER 13Oct23    Note:	
-----------------------------------	--

PLUMBING

1 - SINK - UNDERMOUNT SINK - TECO KITCHEN #170 21Mar24    Note:	
1 - ENSUITE 2/3 - TUB TO SHOWER CONVERSION - 5 FOOT SHOWER WITH SLIDING GLASS CHROME DOORS IN LIEU OF TUB INCLUDES SHOWER POT LIGHT 13Oct23    Note:	

PROMOTIONAL

1 - LESS BALANCE OF CREDIT FROM PURCHASER EXTRA SHEET IN OFFER 21Mar24    Note:	
1 - PARTIAL REDEMPTION OF PROMOTIONAL PACKAGE \$7,495.00 BALANCE FORWARD \$4,905 TO BE USED AT A LATER DATE. ORIGINAL PROMOTIONAL PACKAGE OF \$15,000.00 AS PER SCHEDULE PE. 13Oct23    Note:	
1 - PARTIAL REDEMPTION OF PROMOTIONAL PACKAGE \$2,600.00 BALANCE FORWARD \$12,400.00 TO BE USED AT A LATER DATE. ORIGINAL PROMOTIONAL PACKAGE OF \$15,000.00 AS PER SCHEDULE PE. 09Jun23    Note:	

STAIRS AND RAILINGS

1 - PICKETS - EUROLINE 1 - BLACK PICKETS 21Mar24    Note:	
1 - STAINED STAIRS - STANDARD STAIRCASE 21Mar24    Note: INCLUDING STEPS TO LOWER LANDING	

EXTRAS AS PER OFFER

The Vendor agrees that notwithstanding any other term or provision in this Agreement included in the Purchase Price and in addition to those items detailed in Schedule GP to the Agreement of Purchase and Sale, the Purchaser is entitled to a credit of Fif Worksheet    Note:	
--	--



Purchasers: Ashwin Chandra PENDYALA & Haarika MADIREI

Telephone Res. / Bus: (289) 387-9173 /

Decor Advisor: Ida Viola

Lock Date: 2-Apr-24

Property: 135

Project: Zadorra Estates Corp.

Model and Elevation: Villa 12 Elev 2

Plan #: 40M-2763

1. Cabinetry

	Style and Colour	Hardware
Kitchen / Breakfast	MONACO 823 DRIFTWOOD	464SA
Laundry Room	ELISSE	Standard
Powder Room	DORAL H3078 HACIENDA WHITE	464SA
Master Ensuite Bathroom	DORAL H3078 HACIENDA WHITE	464SA
Ensuite Bath - Bedroom 2/3	DORAL H3078 HACIENDA WHITE	464SA
Ensuite Bath - Bedroom 4	DORAL H3078 HACIENDA WHITE	464SA

Stove Opening

36"

NOTE: If not specified, opening will be set to builder's standard opening of approximately 30" width

Fridge Opening

STANDARD

NOTE: If not specified, opening will be set to builder's standard opening of approximately 37" width x 74" height

\*\* Refer to Construction Summary

2. Counters

	Counter	Edge	Niche
Kitchen / Breakfast	QUARTZ-MISTRAL	#360 EDGE	
Laundry Room	N/A		
Powder Room	LAMINATE-WHITE CARRARA 4924-38		
Master Ensuite Bathroom	LAMINATE-WHITE CARRARA 4924-38		
Ensuite Bath - Bedroom 2/3	LAMINATE-WHITE CARRARA 4924-38		
Ensuite Bath - Bedroom 4	LAMINATE-WHITE CARRARA 4924-38		
Kitchen Backsplash	N/A		

\* Refer to Construction Summary

Initials:



Purchasers: Ashwin Chandra PENDYALA & Haarika MADIREI Property: 135  
Telephone Res. / Bus: (289) 387-9173 / Project: Zadorra Estates Corp.  
Decor Advisor: Ida Viola Model and Elevation: Villa 12 Elev 2  
Lock Date: 2-Apr-24 22-Mar-24 Plan #: 40M-2763

## 3. Ceramic Flooring

Entrance Vestibule	TILE-KALMA BLANCO GLOSSY 12.5X12.5	At a 45
Main Hall	HARDWOOD	<input type="checkbox"/>
Kitchen / Breakfast	TILE-KALMA BLANCO GLOSSY 12.5X12.5	<input type="checkbox"/>
Laundry Room	TILE-KALMA BLANCO GLOSSY 12.5X12.5	<input type="checkbox"/>
Powder Room	TILE-KALMA BLANCO GLOSSY 12.5X12.5	<input type="checkbox"/>
Master Ensuite Bathroom	TILE-KALMA BLANCO GLOSSY 12.5X12.5	<input type="checkbox"/>
Ensuite Bath - Bedroom 2/3	TILE-KALMA BLANCO GLOSSY 12.5X12.5	<input type="checkbox"/>
Ensuite Bath - Bedroom 4	TILE-KALMA BLANCO GLOSSY 12.5X12.5	<input type="checkbox"/>
Mud Room	TILE-KALMA BLANCO GLOSSY 12.5X12.5	<input type="checkbox"/>
		<input type="checkbox"/>
		<input type="checkbox"/>

\*\* Refer to Construction Summary \*\* METAL STRIP THRESHOLD WHERE APPLICABLE UNLESS SPECIFIED \*\*

## 4. Ceramic Wall Tile

Master Ensuite Bathroom	Selection	Describe
Tub Deck Wall		
Shower Stall	TILE- SILVIA WHITE 8X16	
Bathtub Enclosure Walls		
Ensuite Bath - Bedroom 2/3	TILE- SILVIA WHITE 8X16	
Ensuite Bath - Bedroom 4	TILE- SILVIA WHITE 8X16	
Mud Room	N/A	
Kitchen Backsplash	N/A	

\*\* Refer to Construction Summary - STANDARD GROUT THROUGHOUT UNLESS SPECIFIED

## 5. Trim Carpentry

Interior Doors	CARRARA-SMOOTH
Interior Trim	As Per Construction Specifications

\*\* Refer to Construction Summary

## 6. Plaster Mouldings and Medallions

Entrance Vestibule	N/A		Kitchen/Breakfast	N/A	
Main Hall	N/A		Den/Library	N/A	
Living Room	N/A		Lower Landing	N/A	
Dining Room	N/A				
Family Room	N/A				

\*\* Refer to Construction Summary

Initials: 

Page 2 of 4



Purchasers: Ashwin Chandra PENDYALA & Haarika MADIREI

Telephone Res. / Bus: (289) 387-9173 /

Decor Advisor: Ida Viola

Lock Date: 2-Apr-24

Property: 135

Project: Zadorra Estates Corp.

Model and Elevation: Villa 12 Elev 2

22-Mar-24

Plan #: 40M-2763

7. Other Flooring

Main Hall	HARDWOOD - MIRAGE CHARCOAL MAPLE EXCLUSIVE CASHMERE 5"
Living Room	N/A
Dining Room	HARDWOOD - MIRAGE CHARCOAL MAPLE EXCLUSIVE CASHMERE 5"
Family Room	HARDWOOD - MIRAGE CHARCOAL MAPLE EXCLUSIVE CASHMERE 5"
Den / Library / Study	HARDWOOD - MIRAGE CHARCOAL MAPLE EXCLUSIVE CASHMERE 5"
Basement Landing(If Applies)	N/A
Lower Landing (If Applies)	HARDWOOD - MIRAGE CHARCOAL MAPLE EXCLUSIVE CASHMERE 5"
Upper Landing	HARDWOOD - MIRAGE CHARCOAL MAPLE EXCLUSIVE CASHMERE 5"
Upper Hall	LAMINATE-LEXINGTON BEAUMONT OAK TL LW1313 PEFC
Master Bedroom	LAMINATE-LEXINGTON BEAUMONT OAK TL LW1313 PEFC
Bedroom #2	LAMINATE-LEXINGTON BEAUMONT OAK TL LW1313 PEFC
Bedroom #3	LAMINATE-LEXINGTON BEAUMONT OAK TL LW1313 PEFC
Bedroom #4	LAMINATE-LEXINGTON BEAUMONT OAK TL LW1313 PEFC
Bedroom #5	N/A

Underpad

Standard ☐

Upgrade

\*\* Refer to Construction Summary

8. Railings and Pickets

Railing Type	AS PER CONSTRUCTION SPECIFICATIONS	Colour	MIRAGE CHARCOAL MAPLE
Picket Type	EUROLINE 1	Colour	BLACK
Stringer / Riser	AS PER CONSTRUCTION SPECIFICATIONS	Colour	MIRAGE CHARCOAL MAPLE
Treads	AS PER CONSTRUCTION SPECIFICATIONS	Colour	MIRAGE CHARCOAL MAPLE

Red Oak Stairs as Per Vendor's Standard

\*\* Refer to Construction Summary THE STAIN COLOURS OR FINISH AVAILABLE ON RISERS, TREADS, PICKETS AND RAILS (STAIRCASES), WILL NOT BE AN EXACT MATCH TO PREFINISHED HARDWOOD OR LAMINATE FLOORS.

9. Wall Paint Flat Finish

Main & Upper Hall	22 WARM GREY	Master Bedroom	22 WARM GREY
Living Room	N/A	Bedroom #2	22 WARM GREY
Dining Room	22 WARM GREY	Bedroom #3	22 WARM GREY
Kitchen / Breakfast	22 WARM GREY	Bedroom #4	22 WARM GREY
Family Room	22 WARM GREY	Bedroom #5	N/A
Powder Room	22 WARM GREY	Master Ensuite	22 WARM GREY
Laundry Room	22 WARM GREY	Ensuite Bath - Bedroom 2/3	22 WARM GREY
Den/Library	22 WARM GREY	Ensuite Bath - Bedroom 4	22 WARM GREY
Trim & Door Paint-Semi Gloss	BIRCH WHITE	Mud Room	22 WARM GREY

\*\* Refer to Construction Summary

Initials:



Purchasers: Ashwin Chandra PENDYALA & Haarika MADIREI

Telephone Res. / Bus: (289) 387-9173 /

Decor Advisor: Ida Viola

Lock Date: 2-Apr-24

Property: 135

Project: Zadorra Estates Corp.

Model and Elevation: Villa 12 Elev 2

Plan #: 40M-2763

10. Fireplace

	Living Room			Family Room			Other Room - Specify		
	Purchased	As Per Plan	N/A	Purchased	As Per Plan	N/A	Purchased	As Per Plan	N/A
Fireplace Type	<input type="radio"/>	<input type="radio"/>	<input type="radio"/>	<input type="radio"/>	<input checked="" type="radio"/>	<input type="radio"/>	<input type="radio"/>	<input type="radio"/>	<input type="radio"/>
Mantle Type				As Per Construction Specifications					
Colour / Stain				MANTLE M2-STANDARD					
Surround				AS PER CONSTRUCTION SPECIFICATIONS					
Hearth				NERO					
				NO					

\*\* Refer to Construction Summary

11. Air Conditioning

Air Conditioning

Comment

\*\* Refer to Construction Summary

12. General Comments

\*\* Refer to Construction Summary

Disclaimers and Notes

- Colours of all materials are as close as possible to builder's selection, but not necessarily identical due to variances in manufacturing.
- Any extras listed above are null and void unless accompanied by a separate invoice/amendment. Said invoice must be paid in full.
- The Purchaser agrees that this colour selection is final and that no changes will be permitted, unless required by the Vendor.
- The Purchaser acknowledges reading and accepting document which contains other miscellaneous disclaimers.
- In the event of a conflict between the Standard Features schedule of the Agreement of Purchase and Sale and the Interior Colour Scheme, the Interior Colour Scheme shall prevail.

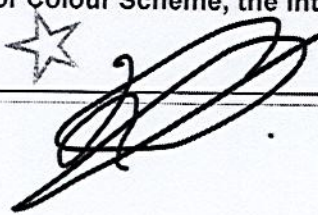
Signature:  Date: \_\_\_\_\_ Signature: \_\_\_\_\_ Date: \_\_\_\_\_



Lot 135 Zadora

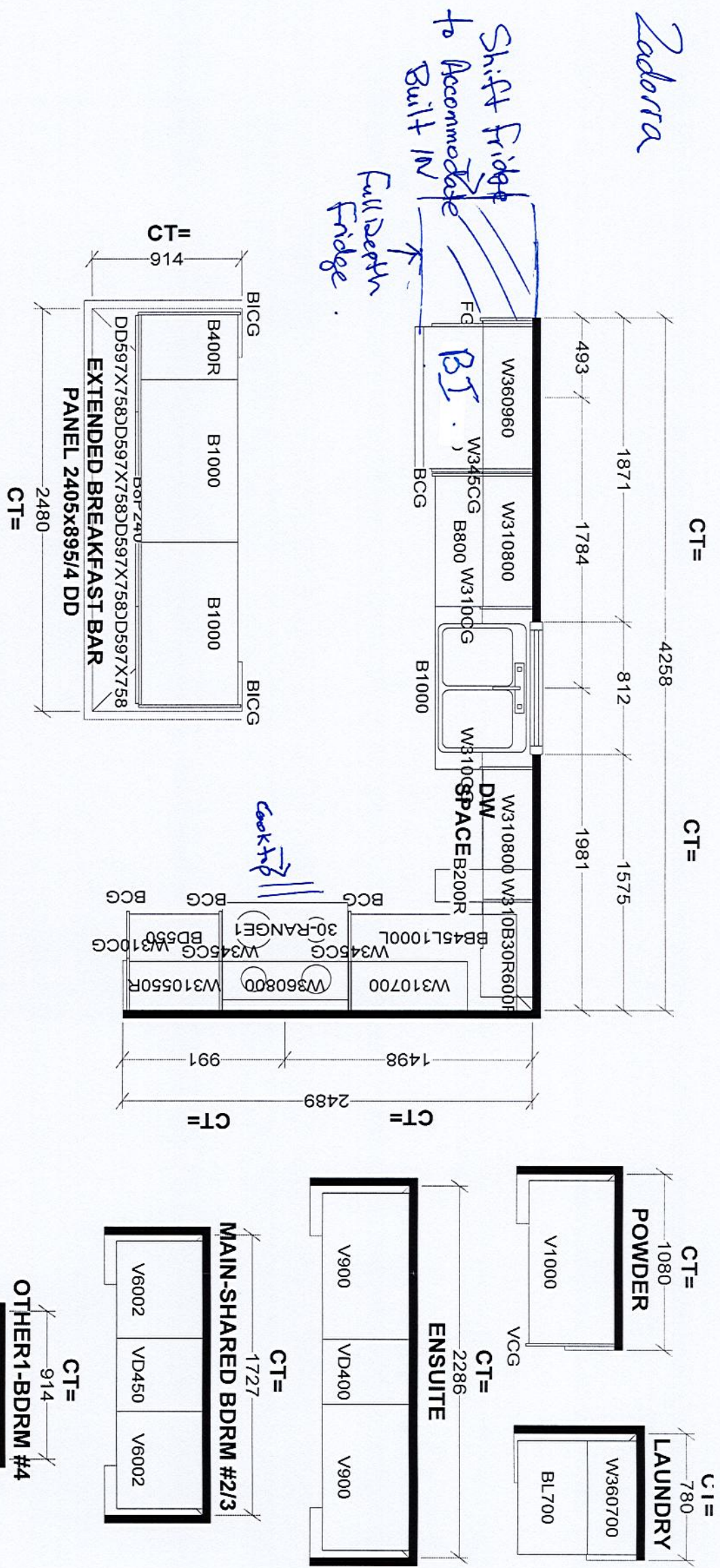

<b>Selba Industries</b>			
W WIDTH		W HGHT	
W CNT		W CNT	
This drawing is the intellectual property of SELBA INDUSTRIES INC. and is an original design which must not be released or copied unless applicable fee has been paid or job order placed.			
FLOOR HGHT		DOOR HGHT	
ST CENT		VENT BOX COVER	
2X4		DESIGNER: BM	
DATE: AUG 4 23		LOT #:	
JOB NUMBER:		J #	
BUILDER: GREENPARK HOMES			
SITE: ZADORA, Oshawa			
MODEL: VILLA 12X EL 1,2			



Villa 12 36' LOT

lot 135 Zadora

ELEVATION 1 2,811 sq.ft. • ELEVATION 2 2,811 sq.ft. • ELEVATION 3 2,784 sq.ft.

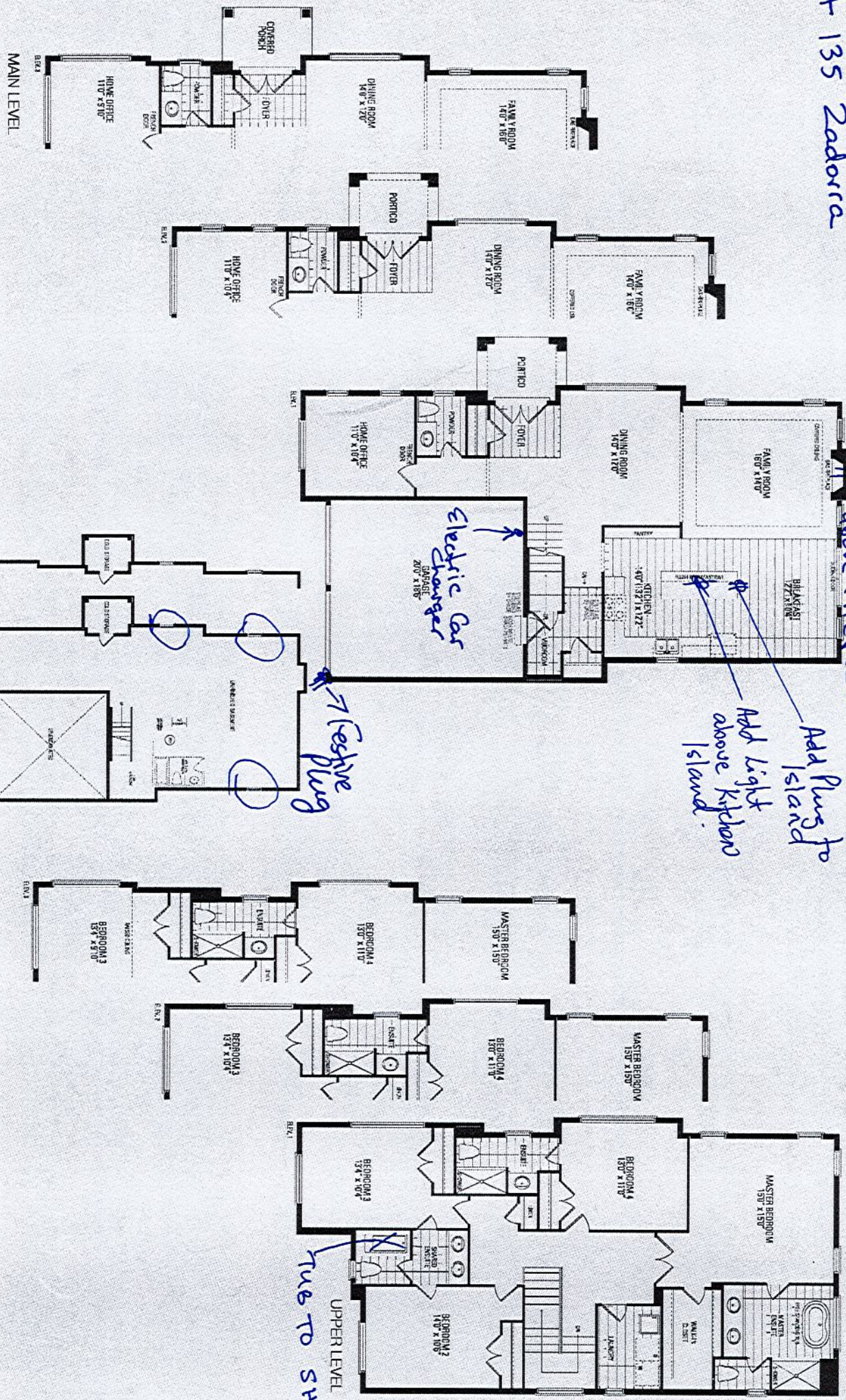



**INSTALLATION INSTRUCTIONS**  
**30" (76.2 CM) AND 36" (91.4 CM)**  
**GAS BUILT-IN COOKTOP**  
**INSTRUCTIONS D'INSTALLATION**  
**DE LA TABLE DE CUISSON À GAZ ENCASTRÉE DE**  
**30" (76,2 CM) ET 36" (91,4 CM)**

**Table of Contents/Table des matières**

<b>COOKTOP SAFETY.....</b>	<b>2</b>	<b>SÉCURITÉ DE LA TABLE DE CUISSON .....</b>	<b>13</b>
<b>INSTALLATION REQUIREMENTS .....</b>	<b>3</b>	<b>EXIGENCES D'INSTALLATION .....</b>	<b>14</b>
Tools and Parts .....	3	Outillage et pièces.....	14
Location Requirements .....	3	Exigences d'emplacement.....	14
Electrical Requirements .....	7	Spécifications électriques .....	18
Gas Supply Requirements .....	7	Spécifications de l'alimentation en gaz .....	18
<b>INSTALLATION INSTRUCTIONS .....</b>	<b>9</b>	<b>INSTRUCTIONS D'INSTALLATION.....</b>	<b>20</b>
Install Cooktop .....	9	Installation de la table de cuisson.....	20
Make Gas Connection .....	9	Raccordement au gaz .....	20
Complete Installation .....	11	Achever l'installation .....	22

**IMPORTANT:**

**Installer:** Leave installation instructions with the homeowner.  
**Homeowner:** Keep installation instructions for future reference.

**IMPORTANT :**

**Installateur :** Remettre les instructions d'installation au propriétaire.  
**Propriétaire :** Conserver les instructions d'installation pour référence ultérieure.

W10597144B



In the State of Massachusetts, the following installation instructions apply:

- Installations and repairs must be performed by a qualified or licensed contractor, plumber, or gasfitter qualified or licensed by the State of Massachusetts.
- If using a ball valve, it shall be a T-handle type.
- A flexible gas connector, when used, must not exceed 3 feet.

## INSTALLATION REQUIREMENTS

### Tools and Parts

Gather the required tools and parts before starting installation.

#### Tools needed

- |                             |   |
|-----------------------------|---|
| ■ Tape measure              | ■ Wrench or pliers                        |
| ■ Flat-blade screwdriver.   | ■ Marker or pencil                        |
| ■ Phillips screwdriver      | ■ Pipe-joint compound resistant to LP gas |
| ■ 15/16" combination wrench | ■ Noncorrosive leak-detection solution    |
| ■ Pipe wrench               |   |

#### Parts supplied

- |                          |                                 |
|--------------------------|---------------------------------|
| ■ Gas pressure regulator | ■ Clamping brackets (2)         |
| ■ Burner grates          | ■ Bracket attachment screws (2) |
| ■ Burner caps            |                                 |
| ■ Burner base            |                                 |

#### Parts needed

Check local codes and consult gas supplier. Check existing gas supply and electrical supply. See "Electrical Requirements" and "Gas Supply Requirements" sections.

### Location Requirements

**IMPORTANT:** Observe all governing codes and ordinances. Do not obstruct flow of combustion and ventilation air.

- It is the installer's responsibility to comply with installation clearances specified on the model/serial rating plate. The model/serial rating plate is located on the underside of the cooktop base.

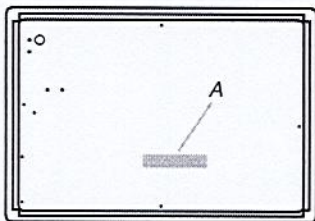

A. Model/serial rating plate

- To eliminate the risk of burns or fire by reaching over heated surface units, cabinet storage space located above the surface units should be avoided. If cabinet storage is to be provided, the risk can be reduced by installing a range hood that projects horizontally a minimum of 5" (12.7 cm) beyond the bottom of the cabinets.

- The cooktop must be a specified cooktop that is approved to be installed either alone or over an undercounter built-in oven. Check the cooktop base approved installation label for your cooktop model number and approved combinations of cooktops and ovens that can be installed. If you do not find this label, your cooktop may not be approved for use over an undercounter built-in oven. Contact your dealer to confirm that your cooktop is approved.
- Ovens approved for this type of installation will have an approval label located on the top of the oven. If you do not find this label, contact your dealer to confirm that your oven is approved. Refer to oven manufacturer's Installation Instructions for approval for built-in undercounter use and proper cutout dimensions.
- The cooktop should be installed in a location away from strong draft areas, such as windows, doors and strong heating vents or fans.
- All openings in the wall or floor where cooktop is to be installed must be sealed.
- Cabinet opening dimensions that are shown must be used. Given dimensions are minimum clearances.
- Grounded electrical supply is required. See "Electrical Requirements" section. Proper gas supply connection must be available. See "Gas Supply Requirements" section.
- The cooktop is designed to hang from the countertop by its side or rear flanges.
- The gas and electric supply should be located as shown in "Cabinet Dimensions" section so that they are accessible without requiring removal of the cooktop.
- Provide cutout in right rear corner of cutout enclosure as shown to provide clearance for gas inlet, power supply cord, and to allow the rating label to be visible.

**IMPORTANT:** To avoid damage, check with your builder or cabinet supplier to make sure that the materials used will not discolor, delaminate or sustain other damage.

#### Mobile Home - Additional Installation Requirements

The installation of this cooktop must conform to the Manufactured Home Construction and Safety Standard, Title 24 CFR, Part 3280 (formerly the Federal Standard for Mobile Home Construction and Safety, Title 24, HUD Part 280). When such standard is not applicable, use the Standard for Manufactured Home Installations, ANSI A225.1/NFPA 501A or with local codes.

In Canada, the installation of this cooktop must conform with the current standards CAN/CSA-A240-latest edition, or with local codes.



Product Dimensions

KCGS550ESS and KCGS950ESS Models

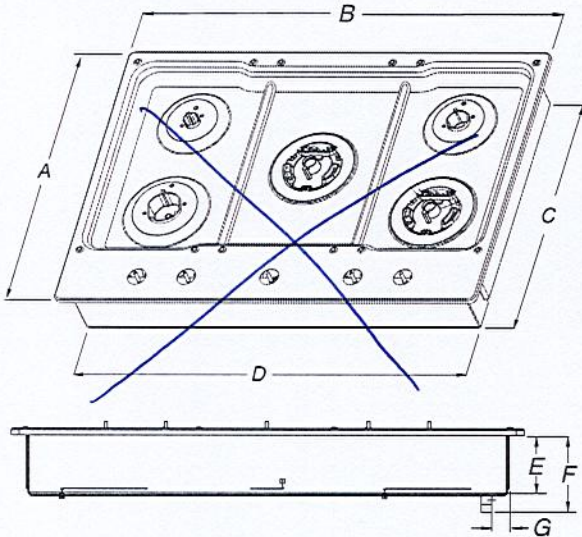

- |                      |                      |
|----------------------|----------------------|
| A. 21" (53.3 cm)     | E. 3 5/8" (9.2 cm)   |
| B. 30" (76.2 cm)     | F. 4 5/16" (11.6 cm) |
| C. 19 3/8" (49.2 cm) | G. 1 5/8" (3.4 cm)   |
| D. 28 3/8" (72.1 cm) |                      |

KCGS556ESS and KCGS956ESS Models

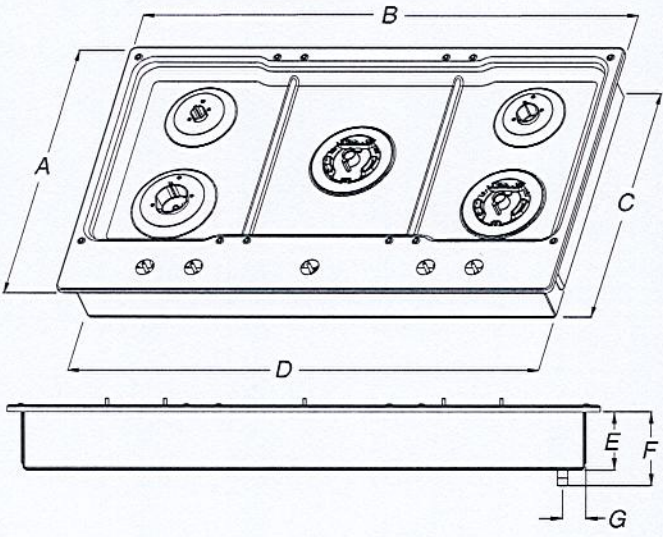

- |                      |                      |
|----------------------|----------------------|
| A. 21" (53.3 cm)     | E. 3 5/8" (9.2 cm)   |
| B. 36 1/4" (92.0 cm) | F. 4 5/16" (11.6 cm) |
| C. 19 3/8" (49.2 cm) | G. 1 7/16" (3.6 cm)  |
| D. 34 3/8" (88.1 cm) |                      |

36"

All Other 30" (76.2 cm) Models

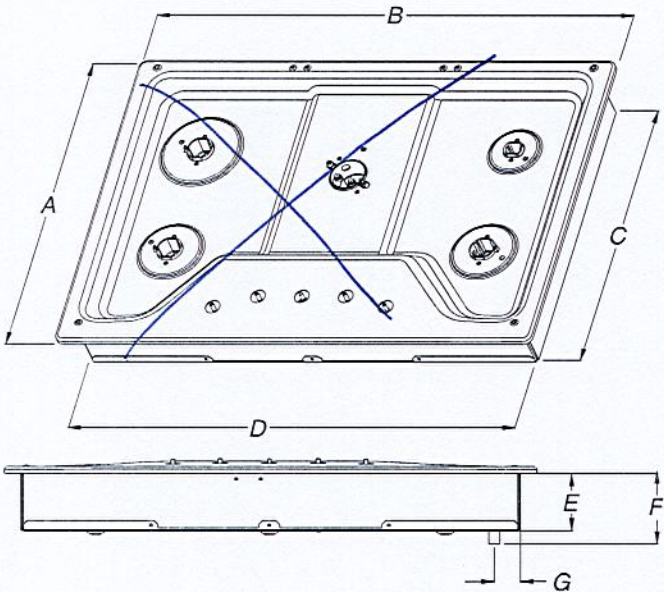

- |                      |                     |
|----------------------|---------------------|
| A. 21" (53.3 cm)     | E. 3 3/8" (8.6 cm)  |
| B. 30" (76.2 cm)     | F. 4 1/8" (10.5 cm) |
| C. 18 7/8" (48.0 cm) | G. 1 1/2" (3.8 cm)  |
| D. 28 3/8" (72.1 cm) |                     |

All Other 36" (91.4 cm) Models

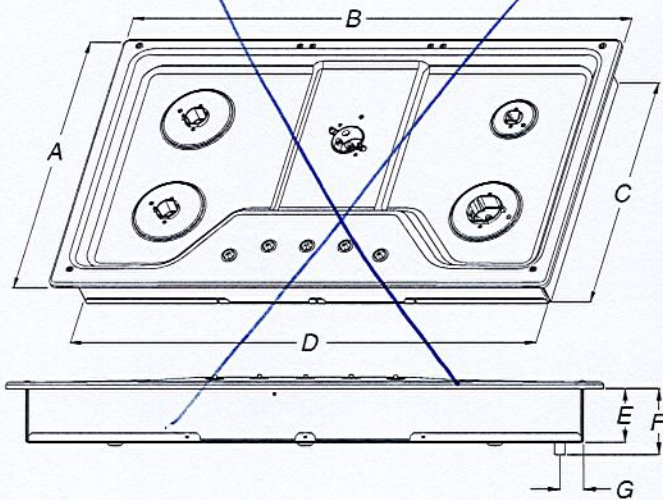

- |                      |                     |
|----------------------|---------------------|
| A. 21" (53.3 cm)     | E. 3 3/8" (8.6 cm)  |
| B. 36" (91.4 cm)     | F. 4 1/8" (10.5 cm) |
| C. 18 7/8" (48.0 cm) | G. 1 1/2" (3.8 cm)  |
| D. 33 3/4" (85.7 cm) |                     |



Cabinet Clearances

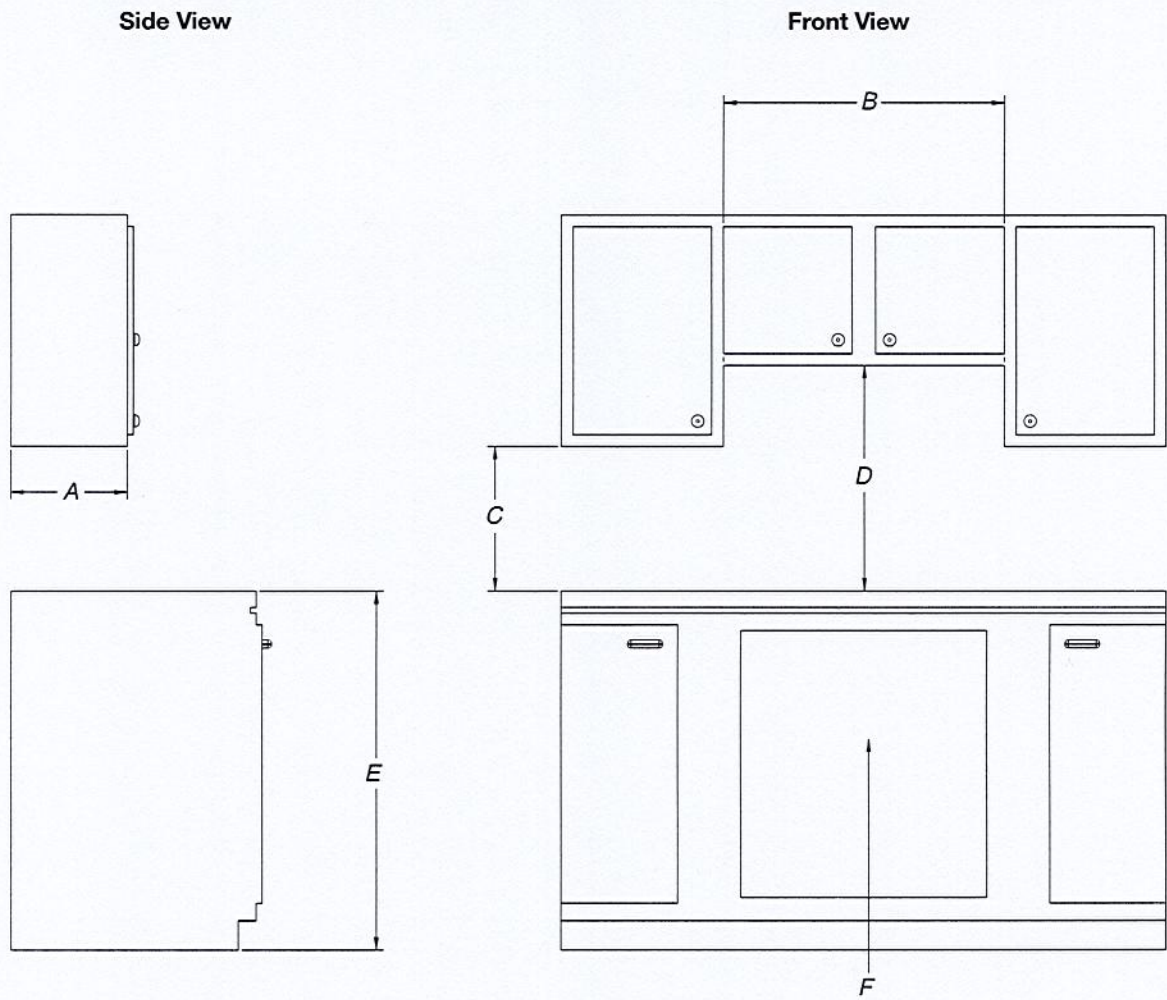

- A. 13" (33.0 cm) recommended upper cabinet depth.
- B. 30" (76.2 cm) for 30" models; 36" (91.4 cm) for 36" models.
- C. 18" (45.7 cm) minimum clearance from upper cabinet to countertop within minimum horizontal clearances to cooktop.
- D. 30" (76.2 cm) minimum clearance between top of cooktop platform and bottom of uncovered wood or metal cabinet.  
24" [61 cm] minimum clearance if bottom of wood or metal cabinet is covered by not less than 1/4" [0.6 cm] flame retardant millboard covered with not less than No. 28 MSG sheet steel, 0.015" [0.04 cm] stainless steel, or 0.024" [0.06 cm] aluminum or 0.020" [0.05 cm] copper.
- E. 36" (91.4 cm) top of countertop to floor.
- F. Gas line opening - Wall: anywhere 5" (12.7 cm) below underside of countertop. Cabinet floor: anywhere within 6" (15.2 cm) of rear wall is recommended.



Cutout Dimensions - Top View

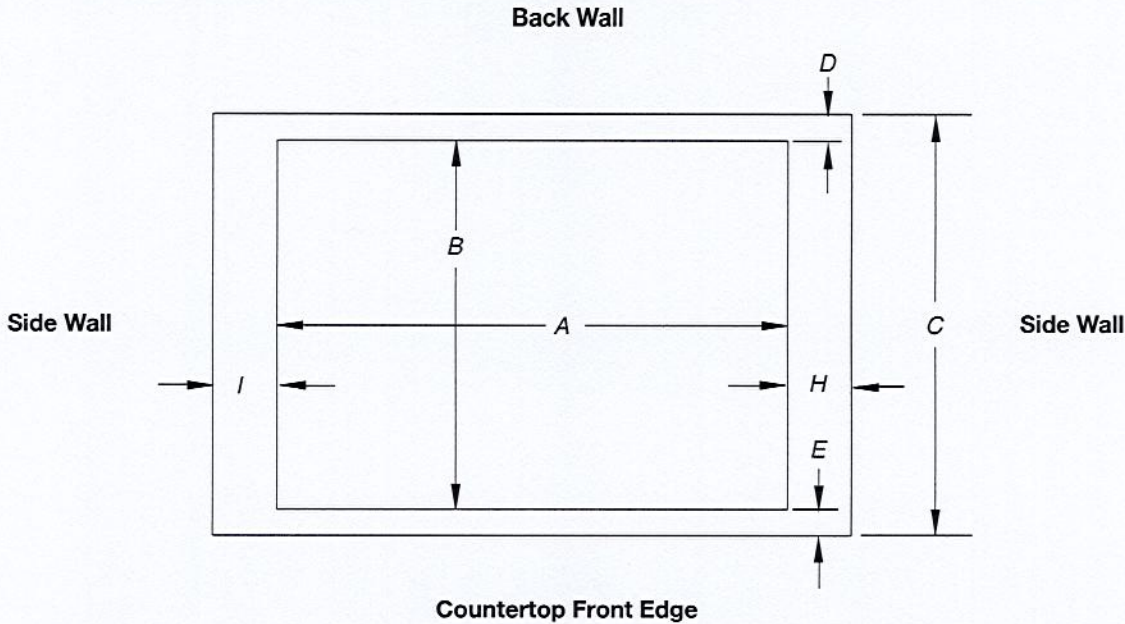

Cutout (Product Opening) Dimensions						
30" (76.2 cm) Models						
Models	A			B		
	Min	Recommended	Max	Min	Recommended	Max
KCGS550 and KCGS950	28 1/2" (72.4 cm)	28 7/8" (73.4 cm)	29 5/16" (74.3 cm)	19 1/2" (49.5 cm)	19 13/16" (50.2 cm)	20" (50.8 cm)
All Other 30" (76.2 cm) Models	28 1/2" (72.4 cm)	28 7/8" (73.4 cm)	29 5/16" (74.3 cm)	19" (48.3 cm)	19 1/2" (49.5 cm)	20" (50.8 cm)
36" (91.4 cm) Models						
KCGS556 and KCGS956	34 7/8" (88.4 cm)	35 3/16" (89.4 cm)	35 5/8" (90.3 cm)	19 1/2" (49.5 cm)	19 13/16" (50.2 cm)	20" (50.8 cm)
All Other 36" (91.4 cm) Models	33 7/8" (86.0 cm)	34 5/16" (87.0 cm)	35 1/4" (89.5 cm)	19" (48.3 cm)	19 1/2" (49.5 cm)	20" (50.8 cm)

Side Walls (Combustible Surfaces)	
Models	H and I
KCGS5 and KCGS9	H and I added together must be at least 48" (122.0 cm), with each side individually being at least 8" (20.3 cm).
KCGS350, KCGS356, MGC9536, WCG97US0, WCG97US6	H and I added together must be at least 48" (122.0 cm), with each side individually being at least 12" (30.5 cm).
All Other Models	Both have to be 8" (20.3 cm) or more.

Back Wall and Countertop Front Dimensions			
Models	C	D	E
KCGS550 and KCGS950	25" (63.5 cm)	2 7/8" (7.3 cm)	2 3/4" (6.9 cm)
All Other Models			3 1/8" (7.9 cm)

**NOTES:** After making the countertop cutout, some installations may require notching down the base cabinet side walls to clear the cooktop base. To avoid this modification, use a base cabinet with sidewalls wider than the cutout.

If cabinet has a drawer, a 4" (10.2 cm) depth clearance from the countertop to the top of the drawer (or other obstruction) in base cabinet is required. The drawer depth may need to be shortened to avoid interfering with the regulator.

**IMPORTANT:** If a built-in wall oven is to be installed below this cooktop, the grounded outlet and gas supply piping must be located in an adjacent cabinet.

This cooktop and its gas and electrical supply sources must be installed before the undercounter built-in wall oven is installed.



## Gas Supply Line

- Provide a gas supply line of  $\frac{3}{4}$ " (1.9 cm) rigid pipe to the cooktop location. A smaller size pipe on longer runs may result in insufficient gas supply. Pipe-joint compounds that resist the action of LP gas must be used. Do not use TEFLON<sup>®</sup> tape. With LP gas, piping or tubing size should be  $\frac{1}{2}$ " minimum. Usually, LP gas suppliers determine the size and materials used in the system.

### Flexible metal appliance connector:

- If local codes permit, use a  $\frac{1}{2}$ " or  $\frac{3}{4}$ " I.D. flexible stainless steel tubing gas connector, designed by CSA to connect the cooktop to the rigid gas supply line.



- A  $\frac{1}{2}$ " male pipe thread is needed for connection to the female pipe threads of the inlet to the cooktop pressure regulator.
- Do not kink or damage the flexible metal tubing when moving the cooktop.
- Must include a shutoff valve:  
The supply line must be equipped with a manual shutoff valve. This valve should be located in the same room but external to the cooktop opening, such as an adjacent cabinet. It must be accessible without removing the cooktop, and it should be in a location that allows ease of opening and closing. Do not block access to shutoff valve. The valve is for turning on or shutting off gas to the cooktop.

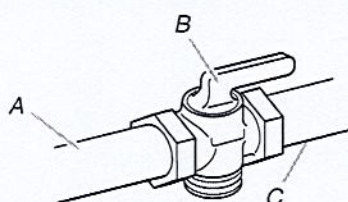

A. Gas supply line  
B. Shutoff valve "open" position  
C. To cooktop

## Gas Pressure Regulator

The gas pressure regulator supplied with this cooktop must be used. The inlet pressure to the regulator should be as follows for proper operation:

### Natural Gas:

Minimum pressure: 5" (12.7 cm) WCP

Maximum pressure: 7" to 14" (17.8 cm to 35.5 cm) WCP

### LP Gas:

Minimum pressure: 10" (25.4 cm) WCP

Maximum pressure: 14" (35.5 cm) WCP

Contact local gas supplier if you are not sure about the inlet pressure.

## Burner Input Requirements

Input ratings shown on the model/serial rating plate are for elevations up to 2,000 ft (609.6 m).

For elevations above 2,000 ft (609.6 m), ratings should be reduced at a rate of 4% for each 1,000 ft (304.8 m) above sea level (not applicable for Canada).

## Gas Supply Pressure Testing

Gas supply pressure for testing regulator must be at least 1" water column pressure above the manifold pressure shown on the model/serial rating plate.

### Line pressure testing above $\frac{1}{2}$ psi gauge (14" WCP)

The cooktop and its individual shutoff valve must be disconnected from the gas supply piping system during any pressure testing of that system at test pressures in excess of  $\frac{1}{2}$  psi (3.5 kPa).

### Line pressure testing at $\frac{1}{2}$ psi gauge (14" WCP) or lower

The cooktop must be isolated from the gas supply piping system by closing its individual manual shutoff valve during any pressure testing of the gas supply piping system at test pressures equal to or less than  $\frac{1}{2}$  psi (3.5 kPa).

†®TEFLON is a registered trademark of E.I. Du Pont De Nemours and Company.



# INSTALLATION INSTRUCTIONS

## Install Cooktop

### ⚠ WARNING

#### Excessive Weight Hazard

Use two or more people to move and install cooktop.  
Failure to do so can result in back or other injury.

Decide on the final location for the cooktop. Avoid drilling into or severing existing wiring during installation.

1. Determine whether your cabinet construction provides clearance for installing clamping brackets at cooktop base ends. This is the recommended location. Clamping brackets can be installed on the front and back of cooktop base bottom, if necessary.

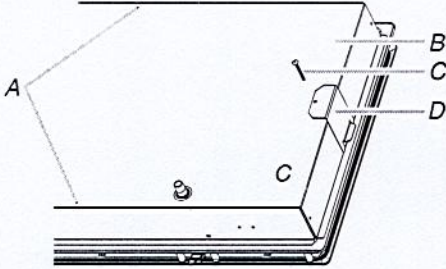

- A. Attachment screw holes for optional front and back location
- B. Cooktop base bottom
- C. Attachment screw
- D. Clamping bracket (end locations recommended)

2. Using 2 or more people, place cooktop right side up into the cutout.

**NOTE:** Make sure that the front edge of the cooktop is parallel to the front edge of the countertop. If repositioning is needed, lift entire cooktop up from cutout to avoid scratching the countertop.

3. Remove the attachment screws for the selected bracket locations from the bottom of the cooktop base.

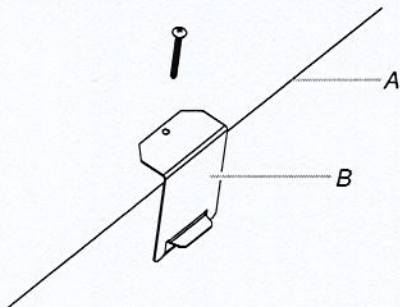

- A. Edge of cooktop base bottom
- B. Clamping bracket

4. Attach brackets to cooktop base bottom with bracket attachment screws. Securely tighten screws.

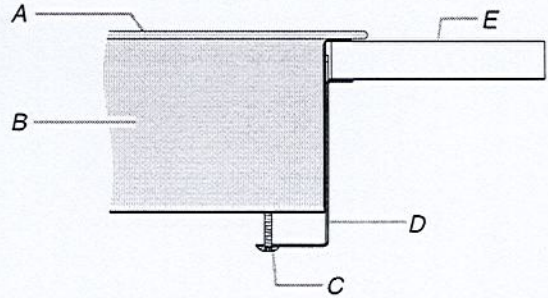

- A. Cooktop
- B. Cooktop base
- C. 2" (5.1 cm) bracket attachment screw
- D. Clamping bracket (extends far enough beyond cooktop base to allow installation of clamping screws)
- E. Countertop

## Make Gas Connection

### ⚠ WARNING



#### Explosion Hazard

Use a new CSA International approved gas supply line.

Install a shut-off valve.

Securely tighten all gas connections.

If connected to LP, have a qualified person make sure gas pressure does not exceed 14" (36 cm) water column.

Examples of a qualified person include:

licensed heating personnel,  
authorized gas company personnel, and  
authorized service personnel.

Failure to do so can result in death, explosion, or fire.

#### Typical flexible connection

1. Apply pipe-joint compound made for use with Natural and LP gas to the smaller thread ends of the flexible connector adapters (see C and G in the following illustration).
2. Attach one adapter to the gas pressure regulator and the other adapter to the gas shutoff valve. Tighten both adapters.



- Use a  $\frac{15}{16}$ " combination wrench and channel lock pliers to attach the flexible connector to the adapters. Check that connector is not kinked.

**IMPORTANT:** All connections must be wrench-tightened. Do not make connections to the gas regulator too tight. Making the connections too tight may crack the regulator and cause a gas leak. Do not allow the regulator to turn when tightening fittings.

No appliance/obstructions below cooktop

Suggested installation to avoid interference below cooktop

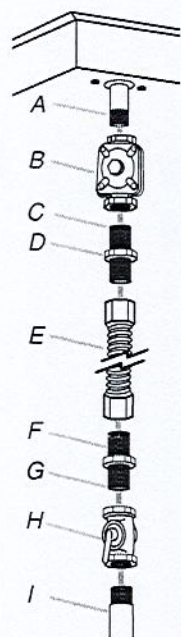

- A. Manifold entrance
- B. Gas pressure regulator
- C. Use pipe-joint compound.
- D. Adapter (must have  $\frac{1}{2}$ " male pipe thread)
- E. Flexible connector
- F. Adapter
- G. Use pipe-joint compound.
- H. Manual gas shutoff valve
- I.  $\frac{1}{2}$ " or  $\frac{3}{4}$ " gas pipe

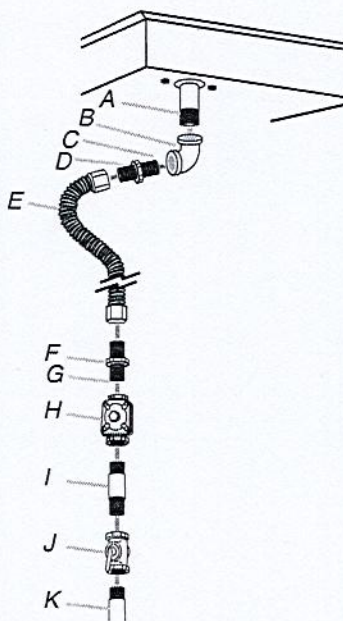

- A. Manifold entrance
- B.  $\frac{3}{8}$ " elbow
- C. Use pipe-joint compound.
- D. Adapter (must have  $\frac{3}{8}$ " male pipe thread)
- E. Flexible connector (pass through wall between cabinets)
- F. Adapter (must have  $\frac{3}{8}$ " male pipe thread)
- G. Use pipe-joint compound.
- H. Appliance pressure regulator (supplied)
- I.  $\frac{1}{2}$ " or  $\frac{3}{4}$ " gas pipe
- J. Manual gas shutoff valve
- K.  $\frac{1}{2}$ " or  $\frac{3}{4}$ " gas pipe

- Install the pressure regulator with the arrow pointing in the direction toward the bottom of the cooktop base and in a position where you can reach the regulator access cap.

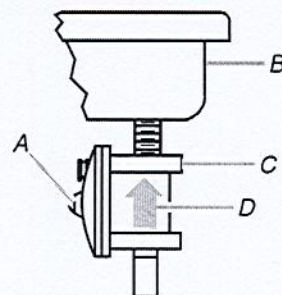

- A. Access cap
- B. Rear of cooktop
- C. Gas pressure regulator
- D. Up arrow. The regulator must be installed with the arrow pointing toward the cooktop bottom.

Use only pipe-joint compound made for use with Natural and LP gas.

Do not use TEFLON® tape. You will need to determine the fittings required depending on your installation.

### Complete Connection

- Open the manual shutoff valve in the gas supply line. The valve is open when the handle is parallel to the gas pipe.

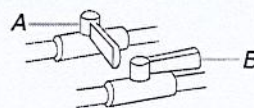

- A. Closed valve
- B. Open valve

- Test all connections by brushing on an approved noncorrosive leak-detection solution. Bubbles will show a leak. Correct any leak found.
- Remove surface burner caps, burner base and grates from parts package. Align notches in burner caps with pins in burner base.

Align orifice holder in burner base with igniter electrode. Burner caps should be level when properly positioned. If burner caps are not properly positioned, surface burners will not light. Place burner grates over burners and caps.

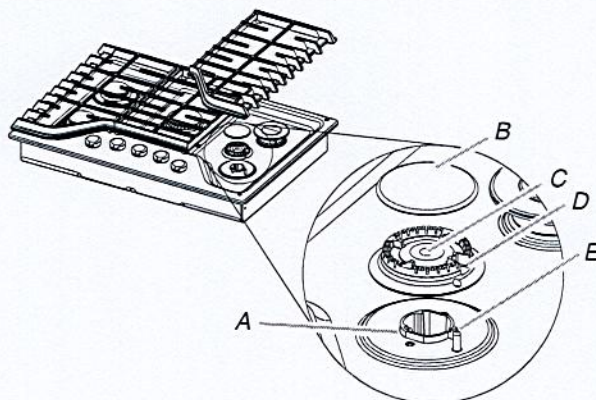

- A. Orifice holder
- B. Burner cap
- C. Gas tube opening
- D. Burner base
- E. Igniter electrode



# NQ70CG600D

SAMSUNG

30" Microwave Combination Wall Oven



Available Colors

-  **Stainless Steel**  
NQ70CG600DSR
-  **Matte Black**  
NQ70CG600DMT

Design

- Drop-Down Door Design
- Transitional Design

Features

- Steam Cook (Oven)
- Air Sous Vide (Oven)
- Air Fry, Tray Included (Oven)
- Convection Vegetable (Oven)
- Wi-Fi Connectivity
- Dual Convection
- Digital Touch Controls
- 7-Inch LCD Display
- Steam Clean & Self-Clean (Oven)
- Halogen Lights
- 2 Heavy-Duty Racks
- Gliding Rack
- Broil Element
- 6 Rack Positions (Oven)

Convenience

- Sabbath Mode (Oven)
- Delay Start (Oven)
- Child Safety Lock
- Warming Mode
- Kitchen Timer

Specifications

- Microwave Capacity: 1.9 cu. ft.**
  - Sensor Cook
  - Speed Convection
  - Speed Broil
  - Air Fry Auto Cook
- Oven Capacity: 5.1 cu. ft.**
  - Hidden Bake Element
  - Convection Bake: 175°F–550°F
  - Convection Roast: 175°F–550°F
  - Convection Vegetables: 350°F–450°F
  - Bake: 175°F–550°F
  - Broil: Low-High
  - Air Sous Vide: 100°F–205°F
  - Air Fry: 350°F–500°F
  - Steam Proof
  - Dehydrate

Dimensions

**Product Dimensions & Weight (WxHxD)**  
Outside (Max) Wall Oven Dimensions:  
29<sup>3</sup>/<sub>4</sub>" x 43<sup>1</sup>/<sub>4</sub>" x 24<sup>3</sup>/<sub>8</sub>"  
Wall Oven Cut-Out Dimensions:  
28<sup>5</sup>/<sub>8</sub>" x 42<sup>1</sup>/<sub>4</sub>" x 23<sup>1</sup>/<sub>2</sub>"  
Weight: 270.1 lbs

**Shipping Dimensions & Weight (WxHxD)**  
Dimensions: 33<sup>3</sup>/<sub>4</sub>" x 48<sup>1</sup>/<sub>4</sub>" x 29<sup>7</sup>/<sub>16</sub>"  
Weight: 299.8 lbs

Warranty

One (1) Year All Parts and Labor

UPC

Microwave Combination Wall Oven	Model #	UPC Code
Stainless Steel	NQ70CG600DSR	887276757605
Matte Black	NQ70CG600DMT	887276757599









# RF30BB6200QLAA

SAMSUNG

BESPOKE French Door Refrigerator with AutoFill Water Pitcher  
30.1 cu. ft.

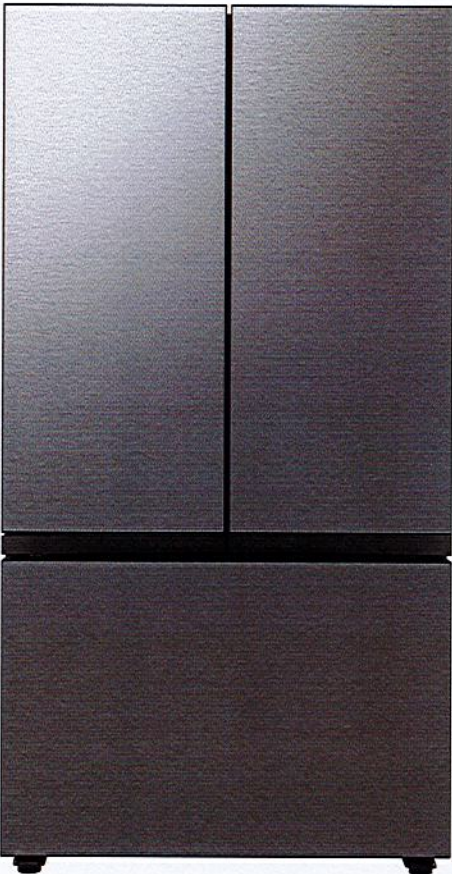

### Signature Features

#### Customizable Door Panels

Customize the colour of your refrigerator. Choose from eleven colours and two finishes to create a space that fits your style.<sup>1</sup>  
This model ships with Stainless Steel panels.

#### AutoFill Water Pitcher

A BPA Free<sup>2</sup> Autofill Water Pitcher located in the fridge door fills up automatically to give you easy access to cold flavoured water.

#### Dual Auto Ice Maker

Be prepared for any occasion with two different types of ice. The Dual auto ice maker makes both cubed ice and ice bites.



AutoFill™ Water Pitcher



Dual Ice Maker with Cubed Ice and IceBites™

### BESPOKE Panel Colour Selection

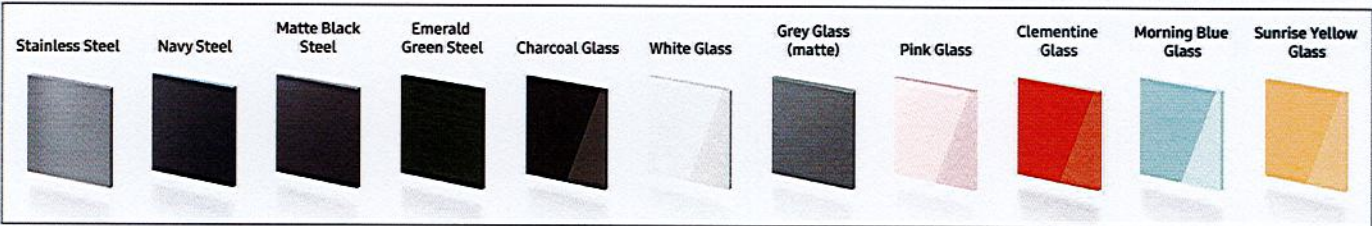

### Features

- 36" Wide
- Large Storage Capacity – 30.1 cu. ft.
- BESPOKE - customizable door panels
- Twin Cooling Plus
- Crisper+
- Tempered Glass Spill-Proof Shelves
- Fingerprint Resistant Finish
- Sabbath Mode
- ADA Compliant

### Convenience

- Autofill Water Pitcher
- Dual Auto Ice Maker
- Door Alarm
- Wi-Fi Connectivity
- Power Cool
- Power Freeze

### Rating



- ENERGY STAR® - Rated
- Energy Consumption (annual) = 695 kWh/yr

<sup>1</sup> Stainless Steel panels included. Other colour door panels sold separately.

<sup>2</sup> Does not contain the chemical Bisphenol A.



# RF30BB6200QLAA

SAMSUNG

BESPOKE French Door Refrigerator with AutoFill Water Pitcher  
30.1 cu. ft.

### Installation Specifications

- 1. Measure the height, width and depth of the opening, making sure to include baseboards, molding tile, countertop overhang, etc. Check to be sure there is enough room to open the door (consider walls, islands or other obstacles when measuring).
- 2. Refer to illustration below to determine dimensions.
- 3. Allow 11 3/8" of clearance on hinge side of refrigerator when installing next to a wall where door may make contact.
- 4. Allow 2" minimum clearance at rear for proper air circulation and water/ electrical connections. Allow a 3/8" minimum clearance at sides and top for ease of installation.
- 5. Ensure each door and entryway in the home is wide enough for the refrigerator to be moved through easily.

For optimal usage and to be able to open refrigerator doors completely, do not install next to a wall.

Please note: The following dimension and cutout information is for planning purposes only. For complete installation details, consult manual packed with product, or download manual online at [samsung.com](http://samsung.com).

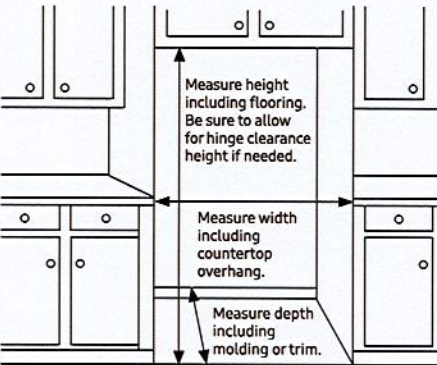

### Dimensions

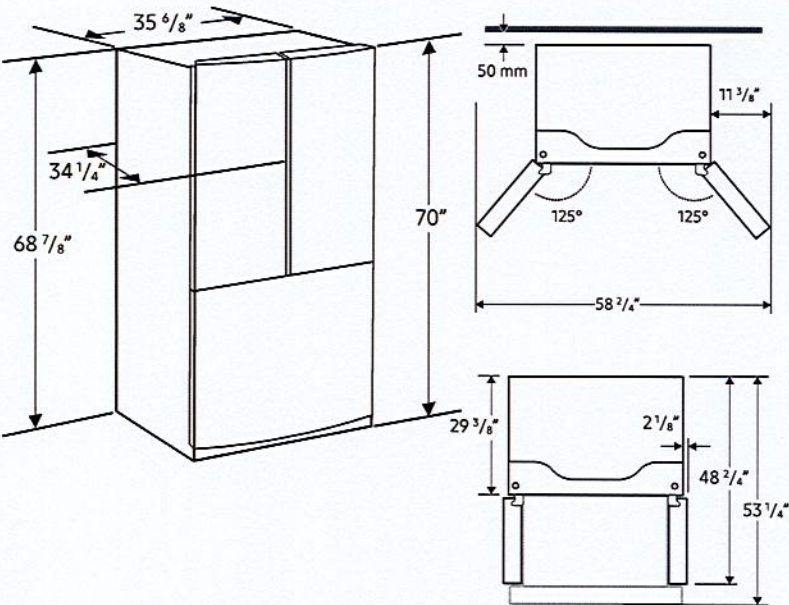

Total Capacity: 30.1 cu. ft.

Refrigerator: 21.1 cu. ft.

- 4 Tempered Glass Spill-Proof Shelves
- 2 Clear Drawers including Crisper+
- 8 Door Bins
  - Right: 1 Gallon Bin, 3 Regular Bins
  - Left: 1 Gallon Bin, 3 Regular Bins
- LED Lighting

Freezer: 9 cu. ft.

- Dual Ice Maker in Freezer (Cubed Ice or Ice Bites)
  - 2 Ice Buckets with Cover and 1 Scoop
- 2 Boxes
- LED Lighting

### Accessories

Water Filter: HAF-QIN

Volt/Amps	115V / 60Hz / 3.5A
Power Cord Length	2 meters

### Warranty

- One (1) Year Parts and Labour on Refrigerator
- Ten (10) Years Parts on Digital Inverter Compressor

### Product Dimensions & Weight (WxHxD)

- Dimensions (WxHxD with hinges, handles and doors): 35 5/8" x 70" x 34 1/4"
- Dimensions (WxHxD without hinges and door): 35 5/8" x 68 7/8" x 29 3/8"
- Dimensions (WxHxD with hinge and door, no handle): 35 5/8" x 70" x 34 1/4"
- Weight: 313.1 lbs (142 kg)

### Shipping Dimensions & Weight (WxHxD)

- Dimensions: 38 1/4" x 76 3/4" x 36 1/4"
- Weight: 337 lbs (153 kg)

Style	Model #	UPC
Pre-Built Stainless		
Steel Panels	RF30BB6200QLAA	887276624396
Without Panels	RE30BB6200APAA	887276624389

Actual colour may vary. Design, specifications and colour availability are subject to change without notice. Non-metric weights and measurements are approximate.  
© 2022 Samsung Electronics Canada Inc. All rights reserved. Samsung is a registered trademark of Samsung Electronics Co., Ltd., used with permission.