

CONSTRUCTION SUMMARY		RECEIVED	
Legacy Hill - Trinigroup Development Inc.		MAY 06 2024	
PURCHASER: May LUI		TEL:	
LOT / PHASE	REG. PLAN #	HOUSE TYPE	
1 / 1		Villa 12 Elev 1	

CABINETRY

1 - CABINETRY PROVISION - PROVISION FOR PLUG ON ISLAND (PLUG EXTRA ORDERED SEPARATELY)	
02May24 Note:	

CONSTRUCTION

1 - PROVISION FOR SHAMPOO NICHE APPROX. 14" WIDE X 20" HIGH AS PER SKETCH – IF CONSTRUCTION PERMITS	
02May24 Note: MASTER ENSUITE	
1 - SMOOTH CEILINGS ON FIRST FLOOR	
02May24 Note:	
1 - FIRST FLOOR INCREASE CEILING HEIGHT FROM 9 FEET TO 10 FEET	
26Jan24 Note:	
1 - LOWER LEVEL - BASEMENT 8 FOOT 6 INCH CONCRETE POUR - MEASURED FROM TOP OF FOOTING TO TOP OF FOUNDATION WALL	
26Jan24 Note:	
4 - ENLARGED BASEMENT WINDOWS (MAY REQUIRE WINDOW WELLS) - WINDOW IS 30 INCHES X 24 INCHES	
26Jan24 Note:	

COUNTER TOP

1 - SHAMPOO NICHE 14" WIDE X 20" HIGH AS PER SKETCH – MARBLE, GRANITE OR QUARTZ – IF CONSTRUCTION PERMITS - REQUIRES PROVISION FROM CONSTRUCTION	
MASTER ENSUITE	
02May24 Note: SUPPLY & INSTALL	

ELECTRICAL

1 - POT LIGHT - TUB/SHOWER POT LIGHT, FLAT PANEL LED	
02May24 Note: SHARED ENSUITE 2/3	
1 - PLUG - ELECTRICAL PLUG - ADD TO ISLAND	
02May24 Note: SEE SKETCH FOR LOCATION - IF CONSTRUCTION PERMITS	
1 - RELOCATE STANDARD KITCHEN LIGHT TO BE CENTERED OVER ISLAND	
02May24 Note:	
1 - ABOVE KITCHEN ISLAND - ADD LIGHT AND SWITCH - NO FIXTURE INCLUDED	
02May24 Note: SEE SKETCH FOR LOCATION - IF CONSTRUCTION PERMITS	
10 - POT LIGHT - EXTERIOR - SOFFIT MOUNT - REGULAR VOLTAGE	
02May24 Note: SEE SKETCH FOR LOCATION - IF CONSTRUCTION PERMITS	
1 - ELECTRIC VEHICLE ROUGH-IN PROVISION ONLY FOR FUTURE ELECTRIC CAR (CONDUIT FROM BASEMENT INTO JUNCTION BOX IN GARAGE WITH PULL STRING, NO WIRE)	
02May24 Note:	
1 - PLUG - ELECTRICAL PLUG WITH GFI AND SWITCH - FOR FESTIVE LIGHTING	
02May24 Note: @ PORTICO SEE SKETCH - IF CONSTRUCTION PERMITS	

FIREPLACE AND ACCESSORIES

1 - GAS LINE ROUGH-IN FOR STOVE (INCLUDES ELECTRICAL OUTLET) - FIRST FLOOR	
02May24 Note:	





CONSTRUCTION SUMMARY

Legacy Hill - Trinigroup Development Inc.

PURCHASER: May LUI

TEL:

LOT / PHASE 1 / 1	REG. PLAN #	HOUSE TYPE Villa 12 Elev 1		
----------------------	-------------	-------------------------------	--	--

HEATING AND AIR CONDITIONING

1 - HUMIDIFER (MANUAL) 02May24 Note:	
---	--

MISCELLANEOUS

1 - GARAGE DOOR OPENER - LIFTMASTER 8155 WITH BELT DRIVE - INCLUDES 1 KEY PAD & 2 HANDHELD CONTROLS - PRICE IS FOR TWO GARAGE DOOR 02May24 Note:	
---	--

PLUMBING

1 - ADD STANDARD HOSE BIB AT SIDE OF HOUSE – SEE SKETCH IF CONSTRUCTION PERMITS 02May24 Note:	
1 - TOE TESTER - ADD TOE TESTER TO SHOWER 02May24 Note: MASTER ENSUITE	
2 - HOSE BIB - EXTERIOR FROST FREE 02May24 Note: REAR OF HOME & SIDE OF HOME	

PROMOTIONAL

1 - LESS CREDIT FROM PURCHASER EXTRA SHEET IN OFFER 26Jan24 Note:	
--	--

EXTRAS AS PER OFFER

The Vendor agrees that notwithstanding any other term or provision in this Agreement included in the Purchase Price and in addition to those items detailed in Schedule GP to the Agreement of Purchase and Sale, the Purchaser is entitled to a credit of Ten Worksheet Note:	
Complete Central Air Conditioning Worksheet Note:	

This Document is Extremely Time Sensitive - Printed 2 May 24 at 14:16



LOT #1

Villa 12 36' Lot

Elev. 1: 2,811 sq.ft. Elev. 2: 2,811 sq.ft. Elev. 3: 2,784 sq.ft.

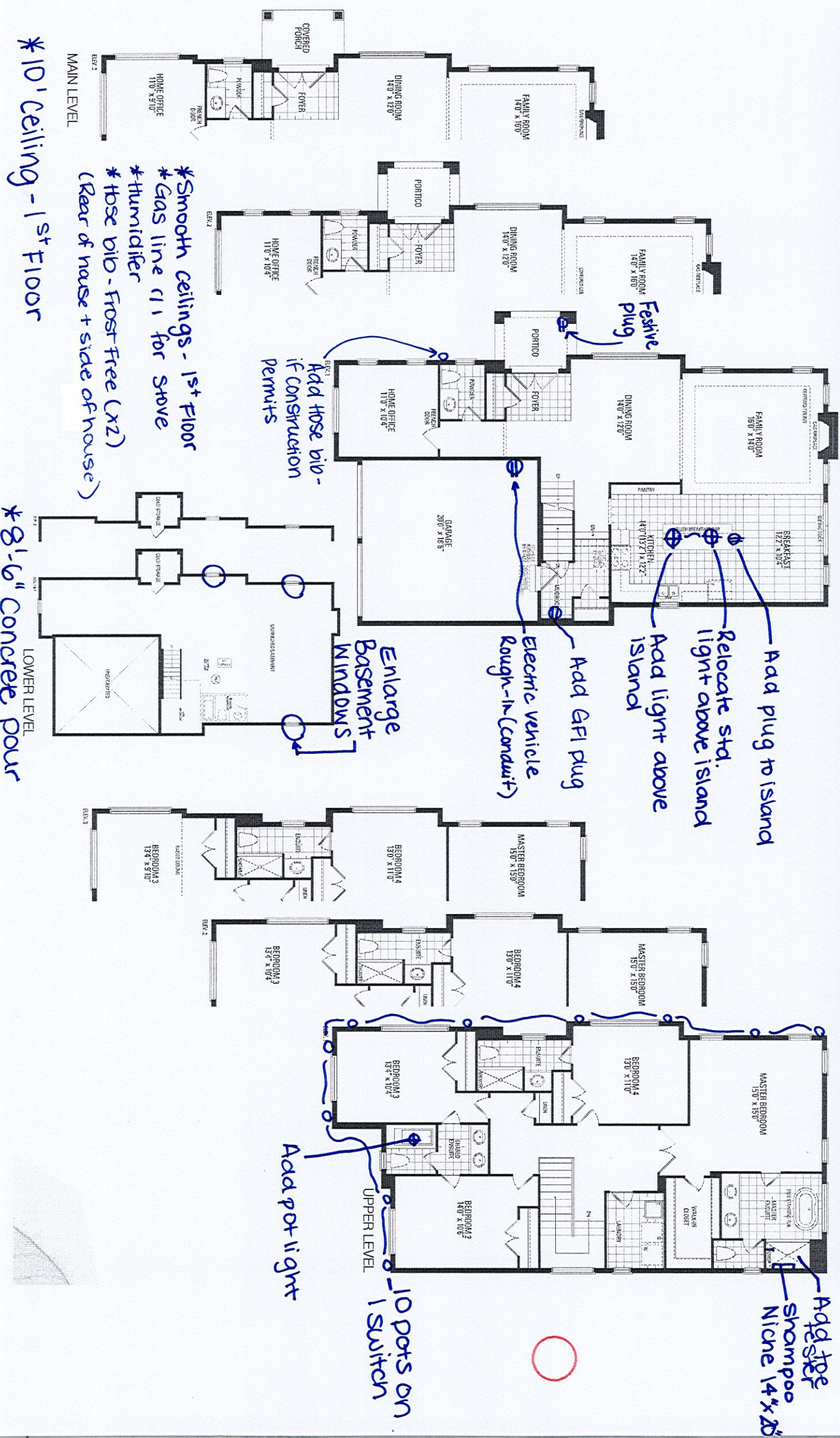



# LOT #1 - Trini group Villa 12/Eker 1

1

Artist's impression

10 pots on  
1 Switch -  
if construction  
permits

