

CONSTRUCTION SUMMARY

Legacy Hill - Trinigroup Development Inc.

PURCHASERS: Lilian S. Z. HANNA and Fady Magdy Geor YOSSEF

TEL:

LOT / PHASE 16 / 1	REG. PLAN # 65M-4818	HOUSE TYPE Rose 2 Elev 3		
-----------------------	-------------------------	-----------------------------	--	--

CABINETRY

1 - CABINETRY - MASTER ENSUITE VANITY - UPGRADE 1 24Oct24 Note:	
1 - CABINETRY - MASTER ENSUITE RAISE VANITY TO 36" HIGH VANITY IN LIEU OF STANDARD HEIGHT 24Oct24 Note:	
1 - CABINETRY - POWDER ROOM RAISE VANITY TO 36" HIGH VANITY IN LIEU OF STANDARD HEIGHT 24Oct24 Note:	
1 - KITCHEN - CUSTOM FULL DEPTH PANTRY UNIT - LEVEL 2 CABINETRY INCLUDES BUILT IN MICROWAVE PROVISION, BAR FRIDGE PROVISION AND COUNTERTOP PROVISION ABOVE BAR FRIDGE WITH FINISHED BACK PANEL 24Oct24 Note:	
1 - CABINETRY - KITCHEN - LIGHT VALANCE 24Oct24 Note:	
1 - CABINETRY - KITCHEN - HARDWARE UPGRADE 2 24Oct24 Note:	
1 - CABINETRY - KITCHEN - UPGRADE 2 24Oct24 Note:	
1 - KITCHEN CABINETRY - TWO COLOUR KITCHEN - FLAT FEE 24Oct24 Note:	

CABINETRY ACCESSORIES

<del>1 - DELETE KITCHEN HOOD CABINETS - TRANSITIONAL WOOD HOOD - UPGRADE 2 24Oct24 Note:</del>	
<del>1 - KITCHEN HOOD CABINETS - TRANSITIONAL WOOD HOOD - UPGRADE 2 29Oct24 Note:</del>	
1 - KITCHEN CABINETRY ACCESSORY - LEMANS CORNER (BASE CABINET MECHANISM) - PRICE IS EACH 24Oct24 Note: MINIMUM 450 WIDE DOOR	
1 - KITCHEN CABINETRY BASE - BANK OF DRAWERS - UPGRADE 2 - ADD TO ISLAND 24Oct24 Note:	
2 - KITCHEN CABINETRY BASE - POT/PAN DRAWERS (CABINET) - UPGRADE 2 24Oct24 Note: 1 SET ON ISLAND AND 1 SET NEXT TO STOVE - SEE SKETCH	
1 - KITCHEN CABINETRY - BUILT-IN FRIDGE FEE - PRICE IS EACH 24Oct24 Note: 48"	
1 - KITCHEN CABINETRY UPPER - FULL DEPTH ABOVE FRIDGE UPPER WITH GABLES - 650MM DEEP - PRICE IS EACH 24Oct24 Note:	
<del>1 - KITCHEN HOOD CABINETS - 30" CONTEMPORARY WOOD HOOD - UPGRADE 2 24Oct24 Note:</del>	
1 - KITCHEN CABINETRY BASE - PULLOUT WIRE SPICE RACK - PRICE IS EACH 24Oct24 Note:	

RECEIVED  
OCT 30 2024



CONSTRUCTION SUMMARY				
Legacy Hill - Trinigroup Development Inc.				
PURCHASERS: Lilian S. Z. HANNA and Fady Magdy Geor YOSSEF				TEL:
LOT / PHASE 16 / 1	REG. PLAN # 65M-4818	HOUSE TYPE Rose 2 Elev 3		
1 - KITCHEN CABINETRY BASE - PULLOUT RECYCLE 2 BIN - PRICE IS EACH 24Oct24    Note: ON ISLAND				

CERAMIC TILE

1 - TILE - UPGRADE 1 WALL TILE - BEDROOM 3/4 SHARED ENSUITE WALL - SHOWER 24Oct24    Note:	
1 - TILE - UPGRADE 1 FLOOR TILE - BEDROOM 3/4 SHARED ENSUITE FLOOR 24Oct24    Note:	
1 - TILE - UPGRADE 1 WALL TILE - BEDROOM 2 ENSUITE WALL - SHOWER 24Oct24    Note:	
1 - TILE - UPGRADE 1 FLOOR TILE - BEDROOM 2 ENSUITE FLOOR 24Oct24    Note:	
1 - TILE - UPGRADE 4 WALL TILE - MASTER ENSUITE WALL - SHOWER 24Oct24    Note:	
1 - TILE - UPGRADE 4 FLOOR TILE - MASTER ENSUITE FLOOR 24Oct24    Note:	
1 - TILE - UPGRADE 4 FLOOR TILE - GARAGE ENTRANCE/MUD ROOM 24Oct24    Note:	
1 - TILE - UPGRADE 4 FLOOR TILE - KITCHEN/BREAKFAST AREA 24Oct24    Note:	
1 - TILE - UPGRADE 4 FLOOR TILE - POWDER ROOM 24Oct24    Note:	
1 - TILE - UPGRADE 4 FLOOR TILE - FOYER 24Oct24    Note:	
1 - DELETE ALL CERAMIC BATHROOM ACCESSORIES - DELETE TOWEL BAR, PAPER HOLDER & SOAP DISH THROUGHOUT 24Oct24    Note:	

CONSTRUCTION

1 - MASTER ENSUITE - PROVISION FOR SHAMPOO NICHE APPROX. 14" WIDE X 20" HIGH AS PER SKETCH – IF CONSTRUCTION PERMITS 08May24    Note:	
1 - SMOOTH CEILING ON SECOND FLOOR 08May24    Note:	
1 - SMOOTH CEILINGS ON FIRST FLOOR 08May24    Note:	
1 - ENLARGED BASEMENT WINDOWS (MAY REQUIRE WINDOW WELLS) - WINDOW IS 30 INCHES X 24 INCHES 23Oct23    Note:	
1 - LOWER LEVEL - BASEMENT 8 FOOT 6 INCH CONCRETE POUR - MEASURED FROM TOP OF FOOTING TO TOP OF FOUNDATION WALL 23Oct23    Note:	



CONSTRUCTION SUMMARY				
Legacy Hill - Trinigroup Development Inc.				
PURCHASERS: Lilian S. Z. HANNA and Fady Magdy Geor YOSSEF				TEL:
LOT / PHASE 16 / 1	REG. PLAN # 65M-4818	HOUSE TYPE Rose 2 Elev 3		
1 - FIRST FLOOR INCREASE CEILING HEIGHT FROM 9 FEET TO 10 FEET 23Oct23 Note:				

COUNTER TOP

1 - BEDROOM 3/4 SHARED ENSUITE COUNTERTOP - UPGRADE STONE COUNTER 24Oct24 Note:	
1 - BEDROOM 2 ENSUITE COUNTERTOP - UPGRADE STONE COUNTERTOP 24Oct24 Note:	
1 - MASTER ENSUITE COUNTERTOP - UPGRADE STONE COUNTERTOP 24Oct24 Note:	
1 - POWDER ROOM COUNTERTOP - UPGRADE STONE COUNTERTOP 24Oct24 Note:	
1 - KITCHEN - ADD QUARTZ SILESTONE LEVEL 2 COUNTERTOP ABOVE BAR FRIDGE AT PANTRY 24Oct24 Note:	
1 - KITCHEN BACKSPLASH FULL HEIGHT - UPGRADE STONE COUNTERTOP - SILESTONE LEVEL 2 24Oct24 Note: DOES NOT INCLUDE AREA BEHIND CHIMNEY HOOD TO CEILING	
1 - KITCHEN COUNTERTOP - UPGRADE STONE COUNTERTOP - SILESTONE LEVEL 2 24Oct24 Note:	
1 - MASTER ENSUITE - SHAMPOO NICHE 14" WIDE X 20" HIGH AS PER SKETCH – MARBLE, GRANITE OR QUARTZ – IF CONSTRUCTION PERMITS - REQUIRES PROVISION FROM CONSTRUCTION 08May24 Note: SUPPLY & INSTALL	

DOORS AND TRIM

1 - TRIM - 5 1/4 INCH BASEBOARD AND 3 1/4 INCH BB CASING - STEP 24Oct24 Note:	
--	--

ELECTRICAL

1 - MASTER ENSUITE - STANDARD VANITY PLUG TO BE ON VANITY SIDE WALL - SEE SKETCH 24Oct24 Note: 1 PLUG ON EACH SIDE OF VANITY WALL IF CONSTRUCTION PERMITS	
1 - MASTER ENSUITE - PLUG - ADD ELECTRICAL PLUG WITH GFI PLUG IN MSTER ENSUITE ON VANITY SIDE WALL- SEE SKETCH FOR LOCATION 24Oct24 Note: NO PLUG TO BE IN VANITY MIRROR	
3 - KITCHEN - ADD ELECTRICAL PLUG FOR BUILT-IN MICROWAVE, BAR FRIDGE, AND COUNTERTOP PLUG - SEE SKETCH 24Oct24 Note:	
1 - KITCHEN – FAN INSERT FOR UPGRADE 36" HOOD – CYCLONE BX600-34 SS INSERT 24Oct24 Note:	
1 - KITCHEN - VALANCE LIGHTING - LED LIGHTING 24Oct24 Note:	
1 - POT LIGHT - LED - FIRST FLOOR INSTALLATION - DINING ROOM  POT LIGHT WITH SEPERATE SWITCH FROM STANDARD LIGHT - SEE SKETCH 08May24 Note:	



CONSTRUCTION SUMMARY				
Legacy Hill - Trinigroup Development Inc.				
PURCHASERS: Lilian S. Z. HANNA and Fady Magdy Geor YOSSEF				TEL:
LOT / PHASE 16 / 1	REG. PLAN # 65M-4818	HOUSE TYPE Rose 2 Elev 3		
1 - POT LIGHT - LED - FIRST FLOOR INSTALLATION - BREAKFAST AREA				
POT LIGHT WITH SEPERATE SWITCH FROM STANDARD LIGHT - SEE SKETCH				
08May24 Note:				
1 - POT LIGHT - LED - FIRST FLOOR INSTALLATION - KITCHEN				
POT LIGHT WITH SEPERATE SWITCH FROM STANDARD LIGHT - SEE SKETCH				
08May24 Note:				
1 - POT LIGHT - LED - FIRST FLOOR INSTALLATION - FAMILY ROOM				
POT LIGHT WITH SEPERATE SWITCH FROM STANDARD LIGHT - SEE SKETCH				
08May24 Note:				
1 - PLUG - ELECTRICAL PLUG - TO BE INSTALLED OVER FIREPLACE				
08May24 Note:				
1 - PLUG - ELECTRICAL PLUG - ADD TO ISLAND				
08May24 Note:				
1 - ABOVE KITCHEN ISLAND - ADD LIGHT AND SWITCH - NO FIXTURE INCLUDED				
08May24 Note:				
1 - PLUG - ELECTRICAL PLUG WITH GFI AND SWITCH - FOR FESTIVE LIGHTING				
08May24 Note:				
1 - ELECTRIC VEHICLE ROUGH-IN PROVISION ONLY FOR FUTURE ELECTRIC CAR (CONDUIT FROM BASEMENT INTO JUNCTION BOX IN GARAGE WITH PULL STRING, NO WIRE)				
08May24 Note:				

FIREPLACE AND ACCESSORIES

1 - GAS LINE ROUGH-IN FOR BARBECUE - FIRST FLOOR	
08May24 Note:	
1 - GAS LINE ROUGH-IN FOR STOVE (INCLUDES ELECTRICAL OUTLET) - FIRST FLOOR	
08May24 Note:	

HARDWOOD FLOORING

1 - HARDWOOD - GROUP B SERIES 5 INCH - BEDROOM 4	
24Oct24 Note:	
1 - HARDWOOD - GROUP B SERIES 5 INCH - BEDROOM 3	
24Oct24 Note:	
1 - HARDWOOD - GROUP B SERIES 5 INCH - BEDROOM 2	
24Oct24 Note:	
1 - HARDWOOD - GROUP B SERIES 5 INCH - MASTER BEDROOM	
24Oct24 Note:	
1 - HARDWOOD - GROUP B SERIES 5 INCH - UPPER HALL AND FLEX AREA	
24Oct24 Note:	
1 - HARDWOOD - GROUP B SERIES 5 INCH - IN LIEU OF 3 1/4 INCH NATURAL RED OAK - FIRST FLOOR HARDWOOD AREAS INCLUDING STAIR LANDINGS	
24Oct24 Note:	



CONSTRUCTION SUMMARY				
Legacy Hill - Trinigroup Development Inc.				
PURCHASERS: Lilian S. Z. HANNA and Fady Magdy Geor YOSSEF				TEL:
LOT / PHASE	REG. PLAN #	HOUSE TYPE		
16 / 1	65M-4818	Rose 2 Elev 3		

MIRRORS AND GLASS

1 - MASTER ENSUITE - FRAMELESS GLASS SHOWER DOOR - INCLUDES CHROME HINGES WITH D-RING TOWEL BAR - CHROME	
24Oct24    Note:	

MISCELLANEOUS

1 - FURTHER VENDOR DISCOUNT	
29Oct24    Note:	
1 - FURTHER VENDOR DISCOUNT	
24Oct24    Note:	

PLUMBING

4 - TOILET - CONTRAC AVENAL #4772HNW/4771HHVU SINGLE FLUSH	
ALL WASHROOMS	
24Oct24    Note:	
5 - SINK - UNDERMOUNT SINK - CONTRAC COLLETTE #4220CIY	
ALL WASHROOMS	
24Oct24    Note:	
1 - KITCHEN - DELTA SOAP DISPENSER - RIGHT SIDE OF FAUCET - #RP1002 CHROME	
24Oct24    Note:	
1 - KITCHEN SINK - UNDERMOUNT - BLANCO PRECIS SILGRANIT U SUPER SINGLE #402884 SOFT WHITE	
24Oct24    Note:	
3 - DELTA - TUB/SHOWER KIT - ROUND SHOWER KIT #DF-TKIT1-PBR/R2200-WS CHROME	
MASTER ENSUITE, ENSUITE 2 & ENSUITE 3/4	
08May24    Note:	
3 - TOE TESTER - ADD TOE TESTER TO SHOWER	
MASTER ENSUITE, ENSUITE 2 & ENSUITE 3/4	
08May24    Note:	
1 - WATER LINE FOR FRIDGE - ROUGH-IN ONLY	
08May24    Note:	
1 - TUB TO SHOWER CONVERSION - 5 FOOT SHOWER WITH SLIDING GLASS CHROME DOORS IN LIEU OF TUB INCLUDES SHOWER POT LIGHT	
08May24    Note:	
ENSUITE 3/4	

PROMOTIONAL

1 - LESS CREDIT FROM PURCHASER EXTRA SHEET IN OFFER	
23Oct23    Note:	

STAIRS AND RAILINGS

1 - PICKETS - EUROLINE 0 - BLACK PICKETS	
24Oct24    Note:	
1 - POSTS - 4X4 POSTS - RING POST	
24Oct24    Note:	



CONSTRUCTION SUMMARY				
Legacy Hill - Trinigroup Development Inc.				
PURCHASERS: Lilian S. Z. HANNA and Fady Magdy Geor YOSSEF				TEL:
LOT / PHASE 16 / 1	REG. PLAN # 65M-4818	HOUSE TYPE Rose 2 Elev 3		
1 - HANDRAIL - V-GROOVE HANDRAIL 24Oct24 Note:				
1 - STAINED STAIRS - STANDARD STAIRCASE 24Oct24 Note:				

EXTRAS AS PER OFFER

The Vendor agrees that notwithstanding any other term or provision in this Agreement included in the Purchase Price and in addition to those items detailed in Schedule GP to the Agreement of Purchase and Sale, the Purchaser is entitled to a credit of Ten Worksheet Note:	
--	--

This Document is Extremely Time Sensitive - Printed 29 Oct 24 at 16:22



Purchasers: Lilian S. Z. HANNA & Fady Magdy Geor YOSSEF

Property: 16

Telephone Res. / Bus: /

Project: Trinigroup Development Inc.

Decor Advisor: Ida Viola

Model and Elevation: Rose 2 Elev 3

Lock Date: 29-Oct-24

24-Oct-24

Plan #: 65M-4818

1. Cabinetry

	Style and Colour	Hardware
Kitchen / Breakfast	SEE BELOW	741SD
Laundry Room	ELISSE	Standard
Powder Room	DORAL K02 SESAME	464SD
Master Ensuite Bathroom	DANA 1048 FLAX	464SD
Ensuite Bath - Bedroom 2	MONACO 1048 FLAX	464SD
Ensuite Bath - Bedroom 3/4	DORAL K38 RIVERSIDE	464SD
Stove Opening	36"	NOTE: If not specified, opening will be set to builder's standard opening of approximately 30" width
Fridge Opening	48"	NOTE: If not specified, opening will be set to builder's standard opening of approximately 37" width x 74" height

\*\* Refer to Construction Summary KITCHEN PERIMETER, WOODHOOD & PANTRY TO BE SONATA SATIN SNOW  
KITCHEN ISLAND TO BE SONATA FOSSIL

2. Counters

	Counter	Edge	Niche
Kitchen / Breakfast	SILESTONE ELECTRIC PEARL POLISHE	#360 EDGE	
Laundry Room	N/A		
Powder Room	QUARTZ-VIRGINIA T5P9	#360 EDGE	
Master Ensuite Bathroom	QUARTZ-VIRGINIA T5P9	#360 EDGE	QUARTZ-VIRGINIA T5P9
Ensuite Bath - Bedroom 2	QUARTZ-VIRGINIA T5P9	#360 EDGE	
Ensuite Bath - Bedroom 3/4	QUARTZ-METROPOLIS OYSTER C14	#360 EDGE	
Kitchen Backsplash	SILESTONE ELECTRIC PEARL POLISHE		

\*\* Refer to Construction Summary



Purchasers: Lilian S. Z. HANNA & Fady Magdy Geor YOSSEF

Property: 16

Telephone Res. / Bus: /

Project: Trinigroup Development Inc.

Decor Advisor: Ida Viola

Model and Elevation: Rose 2 Elev 3

Lock Date: 24-Oct-24

24-Oct-24

Plan #: 65M-4818

3. Ceramic Flooring		At a 45
Entrance Vestibule	TILE-MAINSTONE SILVER POLSIHED 24X24	<input type="checkbox"/>
Main Hall	HARDWOOD	<input type="checkbox"/>
Kitchen / Breakfast	TILE-MAINSTONE SILVER POLSIHED 24X24	<input type="checkbox"/>
Laundry Room	TILE-FRIDGIA LIGHT GREY 13X13	<input type="checkbox"/>
Powder Room	TILE-MAINSTONE SILVER POLSIHED 24X24	<input type="checkbox"/>
Master Ensuite Bathroom	TILE-MAINSTONE SILVER POLSIHED 24X24	<input type="checkbox"/>
Ensuite Bath - Bedroom 2	TILE-AXIS BIANCO WHITE 12X24	<input type="checkbox"/>
Ensuite Bath - Bedroom 3/4	TILE-VIENNA BIANCO 12X24	<input type="checkbox"/>
Mud Room	TILE-MAINSTONE SILVER POLSIHED 24X24	<input type="checkbox"/>
		<input type="checkbox"/>
		<input type="checkbox"/>

\*\* Refer to Construction Summary \*\* METAL STRIP THRESHOLD WHERE APPLICABLE UNLESS SPECIFIED \*\*

4. Ceramic Wall Tile		
Master Ensuite Bathroom	Selection	Describe
Tub Deck Wall		
Shower Stall	TILE-MAINSTONE SILVER POLSIHED 24X24	
Bathtub Enclosure Walls		
Ensuite Bath - Bedroom 2	TILE-AXIS BIANCO WHITE 12X24	
Ensuite Bath - Bedroom 3/4	TILE-VIENNA BIANCO 12X24	
Mud Room		
Kitchen Backsplash	SILESTONE ELECTRIC PEARL POLISHE	

\*\* Refer to Construction Summary - STANDARD GROUT THROUGHOUT UNLESS SPECIFIED

5. Trim Carpentry	
Interior Doors	As Per Construction Specifications
Interior Trim	31/4" BB CASING WITH 5 1/4" BASEBOARD - ONE STEP
** Refer to Construction Summary	

6. Plaster Mouldings and Medallions					
Entrance Vestibule	N/A		Kitchen/Breakfast	N/A	
Main Hall	N/A		Den/Library	N/A	
Living Room	N/A		Lower Landing	N/A	
Dining Room	N/A				
Family Room	N/A				
** Refer to Construction Summary					



Purchasers: Lilian S. Z. HANNA & Fady Magdy Geor YOSSEF

Property: 16

Telephone Res. / Bus: /

Project: Trinigroup Development Inc.

Decor Advisor: Ida Viola

Model and Elevation: Rose 2 Elev 3

Lock Date: 24-Oct-24

24-Oct-24

Plan #: 65M-4818

7. Other Flooring

Main Hall	HARDWOOD-VINTAGE NORTHERN SOLID SWAN SMOOTH WHITE OAK CHARACTER 5" ALABASTER UVF
Living Room	N/A
Dining Room	HARDWOOD-VINTAGE NORTHERN SOLID SWAN SMOOTH WHITE OAK CHARACTER 5" ALABASTER UVF
Family Room	HARDWOOD-VINTAGE NORTHERN SOLID SWAN SMOOTH WHITE OAK CHARACTER 5" ALABASTER UVF
Den / Library / Study	HARDWOOD-VINTAGE NORTHERN SOLID SWAN SMOOTH WHITE OAK CHARACTER 5" ALABASTER UVF
Basement Landing(If Applies)	N/A
Lower Landing (If Applies)	N/A
Upper Landing	N/A
Upper Hall	HARDWOOD-VINTAGE NORTHERN SOLID SWAN SMOOTH WHITE OAK CHARACTER 5" ALABASTER UVF
Master Bedroom	HARDWOOD-VINTAGE NORTHERN SOLID SWAN SMOOTH WHITE OAK CHARACTER 5" ALABASTER UVF
Bedroom #2	HARDWOOD-VINTAGE NORTHERN SOLID SWAN SMOOTH WHITE OAK CHARACTER 5" ALABASTER UVF
Bedroom #3	HARDWOOD-VINTAGE NORTHERN SOLID SWAN SMOOTH WHITE OAK CHARACTER 5" ALABASTER UVF
Bedroom #4	HARDWOOD-VINTAGE NORTHERN SOLID SWAN SMOOTH WHITE OAK CHARACTER 5" ALABASTER UVF
Bedroom #5	N/A
Flex	HARDWOOD-VINTAGE NORTHERN SOLID SWAN SMOOTH WHITE OAK CHARACTER 5" ALABASTER UVF

Underpad

Standard☐

Upgrade

\*\* Refer to Construction Summary

8. Railings and Pickets

Railing Type	V-GROOVE WITH 4X4 RING POST	Colour	VINTAGE ALABASTER WHITE OAK
Picket Type	EUROLINE 0	Colour	BLACK
Stringer / Riser	AS PER CONSTRUCTION SPECIFICATIONS	Colour	VINTAGE ALABASTER WHITE OAK
Treads	AS PER CONSTRUCTION SPECIFICATIONS	Colour	VINTAGE ALABASTER WHITE OAK

Red Oak Stairs as Per Vendor's Standard

\*\* Refer to Construction Summary THE STAIN COLOURS OR FINISH AVAILABLE ON RISERS, TREADS, PICKETS AND RAILS (STAIRCASES), WILL NOT BE AN EXACT MATCH TO PREFINISHED HARDWOOD OR LAMINATE FLOORS.

9. Wall Paint Flat Finish

Main & Upper Hall	22 WARM GREY	Master Bedroom	22 WARM GREY
Living Room	N/A	Bedroom #2	22 WARM GREY
Dining Room	22 WARM GREY	Bedroom #3	22 WARM GREY
Kitchen / Breakfast	22 WARM GREY	Bedroom #4	22 WARM GREY
Family Room	22 WARM GREY	Bedroom #5	N/A
Powder Room	22 WARM GREY	Master Ensuite	22 WARM GREY
Laundry Room	22 WARM GREY	Ensuite Bath - Bedroom 2	22 WARM GREY
Den/Library	22 WARM GREY	Ensuite Bath - Bedroom 3/4	22 WARM GREY
Trim & Door Paint-Semi Gloss	BIRCH WHITE	Mud Room	22 WARM GREY
		Flex	22 WARM GREY

\*\* Refer to Construction Summary



10. Fireplace

Living Room

Purchased

As Per Plan

N/A

Family Room

Purchased

As Per Plan

N/A

Other Room - Specify

Purchased

As Per Plan

N/A

Purchased

As Per Plan

N/A

Purchased

As Per Plan

N/A

Fireplace Type

As Per Construction Specifications

Mantle Type

MANTLE M2-STANDARD

Colour / Stain

AS PER CONSTRUCTION SPECIFICATIONS

Surround

NERO

Hearth

NO

\*\* Refer to Construction Summary

11. Air Conditioning

Air Conditioning

NO

Comment

\*\* Refer to Construction Summary

12. General Comments

\*\* Refer to Construction Summary

Disclaimers and Notes

1) Colours of all materials are as close as possible to builder's selection, but not necessarily identical due to variances in manufacturing.

2) Any extras listed above are null and void unless accompanied by a separate invoice/amendment. Said invoice must be paid in full.

3) The Purchaser agrees that this colour selection is final and that no changes will be permitted, unless required by the Vendor.

4) The Purchaser acknowledges reading and accepting document which contains other miscellaneous disclaimers.

5) In the event of a conflict between the Standard Features schedule of the Agreement of Purchase and Sale and the Interior Colour Scheme, the Interior Colour Scheme shall prevail.

Signature: 

★

Fanny

 Date: 

Oct-24/24

 Signature: 

★

Fady Youssef

 Date: 

Oct 24/24

Page 4 of 4

Printed 10/24/2024 16:42:02



## Elev. 1: 3,005 sq.ft. Elev. 2: 2,999 sq.ft. Elev. 3: 2,998 sq.ft.

Lot 16 TRINITY GROUP - LEACH  
Plugging above  
Fireplace

# Post Lights

Add Piglet above Island

Add Plug -  
to Island

1 pot on 2 on

Electric  
Car Charger

festive light  
→ plus

Shampoo -  
Niche -  
14x20

Tub to Shower:

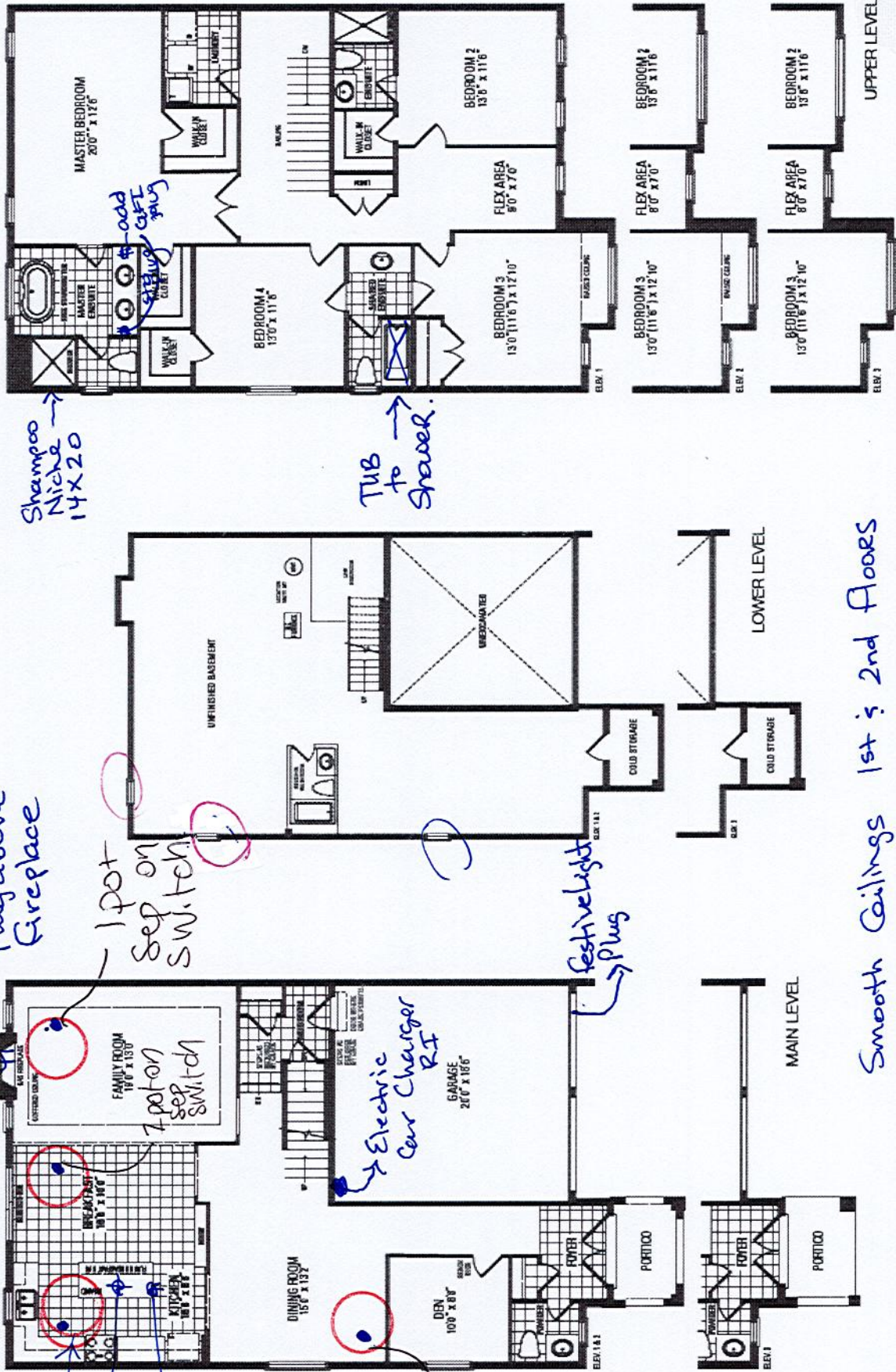

Smooth Ceilings 1st & 2nd floors

Orientation of home may be reversed and purchaser agrees to accept the same. Steps and porches may vary at any exterior entrance ways due to grading variance. Actual usable floor space may vary from the stated floor areas. All renderings are artist's concept. Dimensions, specifications and architectural detailing subject to modifications. Roofline and adjoining model types may vary due to siting. E. & O. E. September 2023



Selba Industries J#			
W WIDTH	W HGT	W CNT	This drawing is the intellectual property of SELBA INDUSTRIES INC. and is an original design which must not be released or copied unless applicable for has been given for job order placed. JOB NUMBER: BUILDER: GREENPARK HOMES SITE: TRINI GROUP, Richmond Hill MODEL: ROSE 2X EL 1,2,3 LOT #: 16 DESIGNER: KS DATE: OCT 19 21
FLOOR HGT	DOOR HGT		
ST CNT	2X4	VENT BOX COVER	



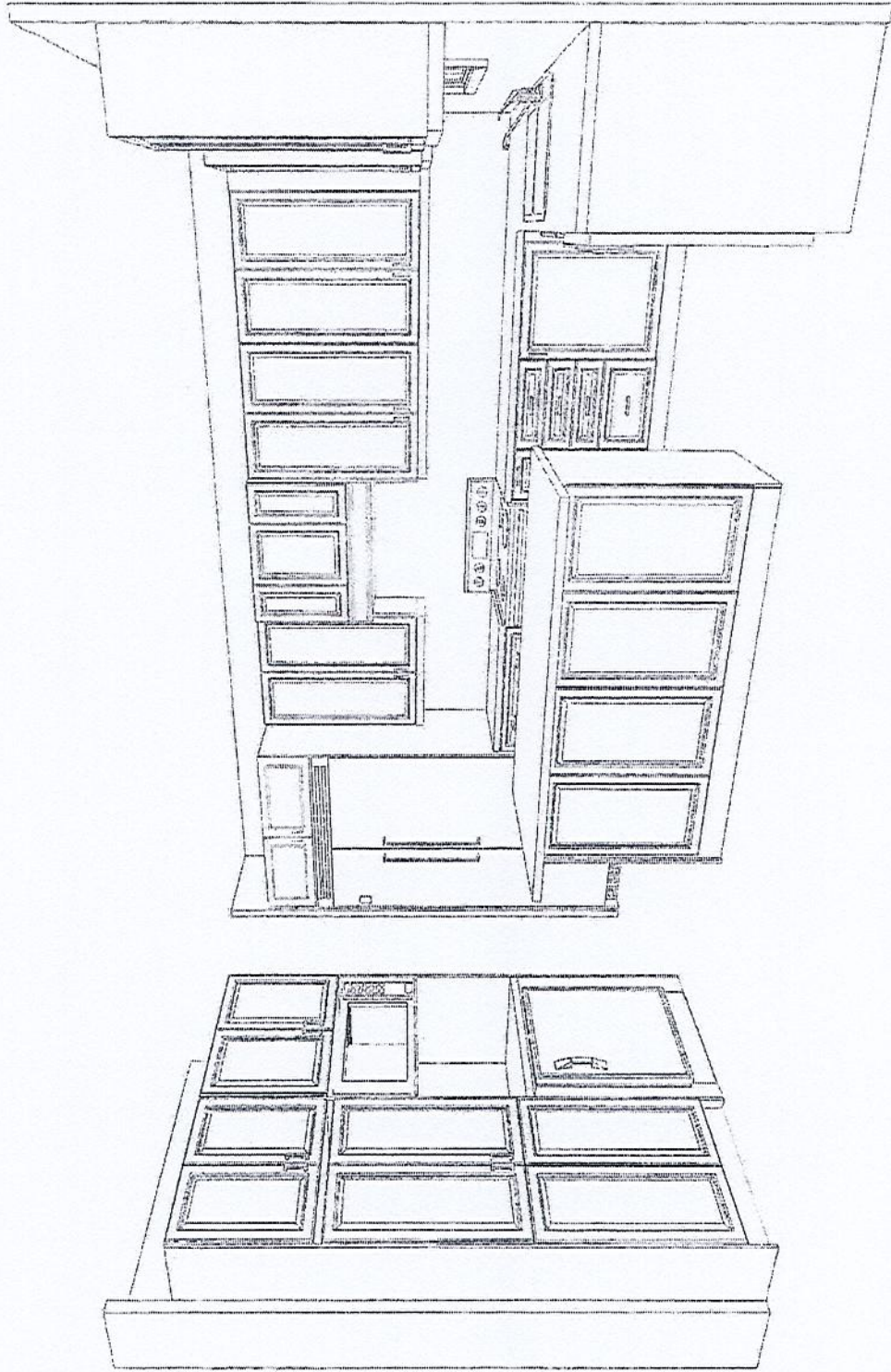



47  
H

This drawing is the intellectual property of SELBA INDUSTRIES INC. and is an artistic interpretation of the general appearance of the design. It is not meant to be an exact rendition.	 Kitchen + Bath Designs	LAYOUT	Drawing #: 1
		TRINIGROUP LOT 16 OCT 28 24	

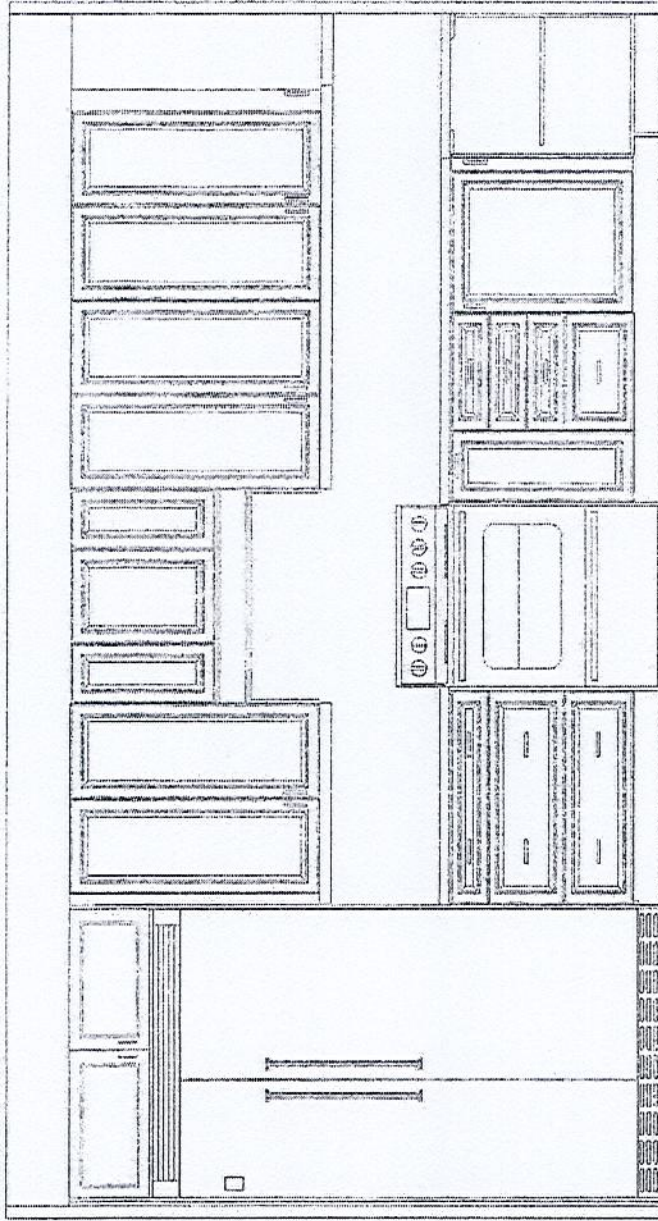





147

Designed: 10/28/2024 Printed: 10/28/2024		Drawing #: 1	
 Kitchen + Bath Designs		LAYOUT	
This drawing is the intellectual property of SELBA INDUSTRIES INC. and is an artistic interpretation of the general appearance of the design. It is not meant to be an exact rendition.		TRINIGROUP LOT 16 OCT 28 24	

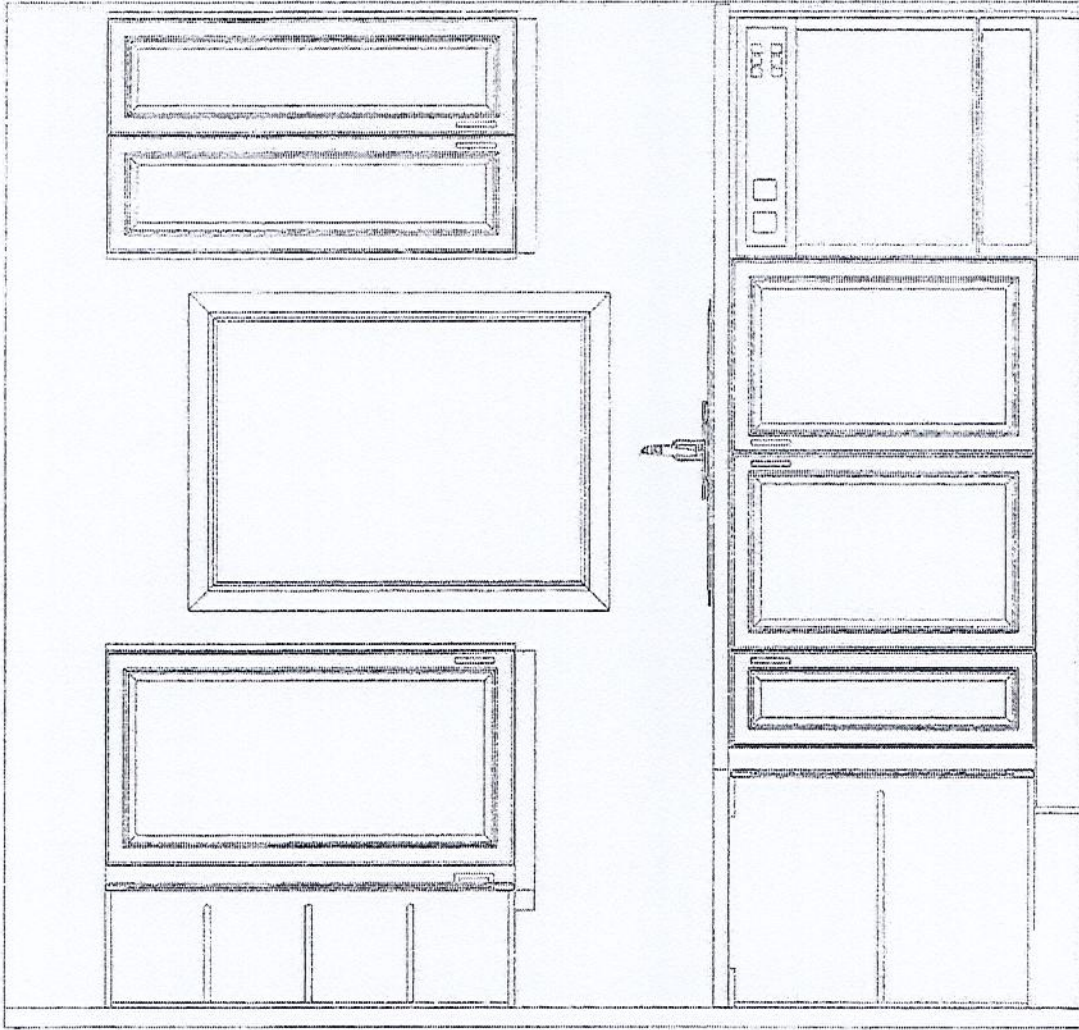



7  
17

This drawing is the intellectual property of SELBA INDUSTRIES INC. and is an artistic interpretation of the general appearance of the design. It is not meant to be an exact rendition.	 Kitchen + Bath Designs	Designed: 10/28/2024 Printed: 10/28/2024	
		LAYOUT	Drawing #: 1
		TRINIGROUP LOT 16 OCT 28 24	



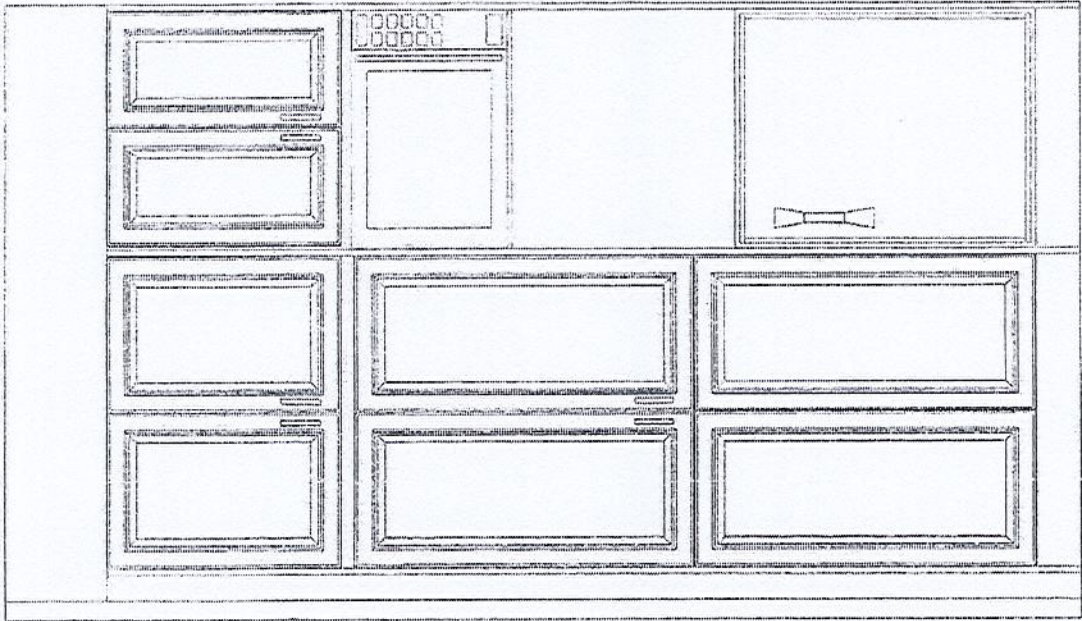

← FINISHED  
BACK PANEL

147  
AE

 Küchen • Bath Designs	Designed: 10/28/2024 Printed: 10/29/2024		
	This drawing is the intellectual property of SELBA INDUSTRIES INC. and is an artistic interpretation of the general appearance of the design. It is not meant to be an exact rendition.		
TRINIGROUP LOT 16 OCT 29 24		LAYOUT	Drawing #: 1



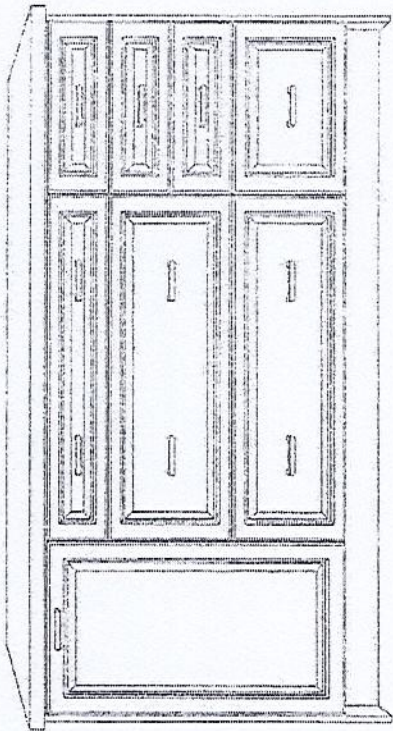

47  
H

This drawing is the intellectual property of SELBA INDUSTRIES INC. and is an artistic interpretation of the general appearance of the design. It is not meant to be an exact rendition.	 Machan + Bath Designs	Designed: 10/28/2024 Printed: 10/28/2024	
		LAYOUT	Drawing #: 1



**KitchenAid®**

## UNDER COUNTER BEVERAGE CENTER

KUBR314KSS, KUBL314KSS, KUBR314KBS,  
KUBL314KBS, KUBR214KSB, KUBL214KSB,  
KUBR214KPA

### Detailed Planning Dimensions Guide

#### Product Dimensions

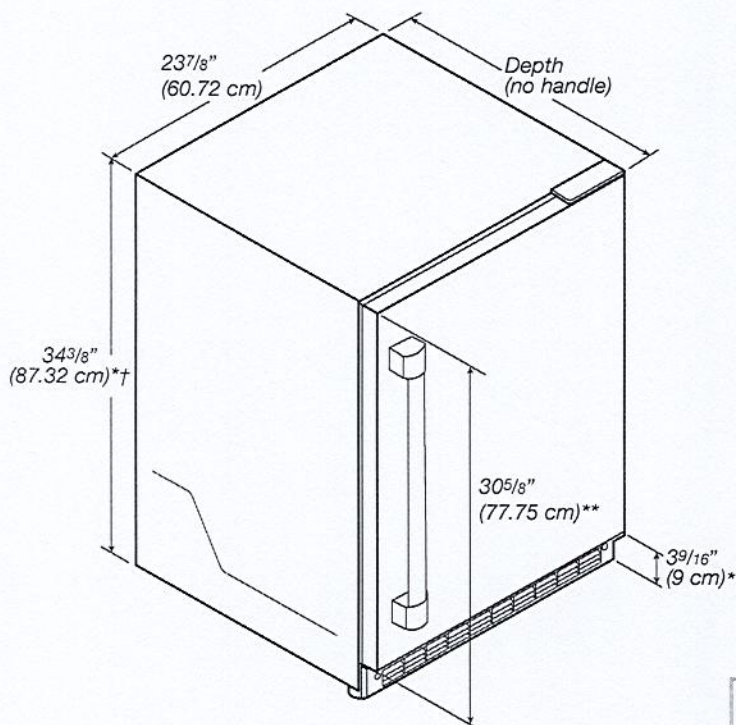

\* Add  $\frac{5}{8}"$  (1.6 cm) to the height dimension when leveling legs are fully extended.

\*\* For custom panel models, this will vary.

† Add  $\frac{1}{4}"$  (6.4 mm) to the height dimension for height with hinge covers.

Variant	Depth (no handle)
Panel ready models (with $\frac{3}{4}"$ panel)	$23\frac{13}{16}"$ (60.7 cm)
Stainless and black stainless	$23\frac{5}{8}"$ (60.2 cm)

Because Whirlpool Corporation policy includes a continuous commitment to improve our products, we reserve the right to change materials and specifications without notice.

Dimensions are for planning purposes only. For complete details, see Installation Instructions packed with product. Specifications subject to change without notice.



Dimension	Description	Panel ready models (with 3/4" panel)	Stainless and black stainless models
A	Width of door	23 <sup>3</sup> / <sub>4</sub> " (60.3 cm)	23 <sup>3</sup> / <sub>4</sub> " (60.3 cm)
B	Width of the grille	23 <sup>13</sup> / <sub>16</sub> " (60.5 cm)	23 <sup>13</sup> / <sub>16</sub> " (60.5 cm)
C	Height to top of handle	**	31 <sup>1</sup> / <sub>8</sub> " (78.85 cm)
D	Width from side of beverage center to handle - door open 90°	**	2 <sup>1</sup> / <sub>3</sub> " (5.95 cm)
E	Depth without door	21 <sup>11</sup> / <sub>16</sub> " (55.1 cm)	21 <sup>11</sup> / <sub>16</sub> " (55.1 cm)
F	Depth with door	23 <sup>13</sup> / <sub>16</sub> " (60.7 cm)	23 <sup>5</sup> / <sub>8</sub> " (60.2 cm)
G	Depth with handle	**	26 <sup>7</sup> / <sub>16</sub> " (67.15 cm)
H	Depth with door open 90°	47 <sup>15</sup> / <sub>16</sub> " (121.8 cm)	47 <sup>15</sup> / <sub>16</sub> " (121.8 cm)

\*\*For custom panel models, this will vary.

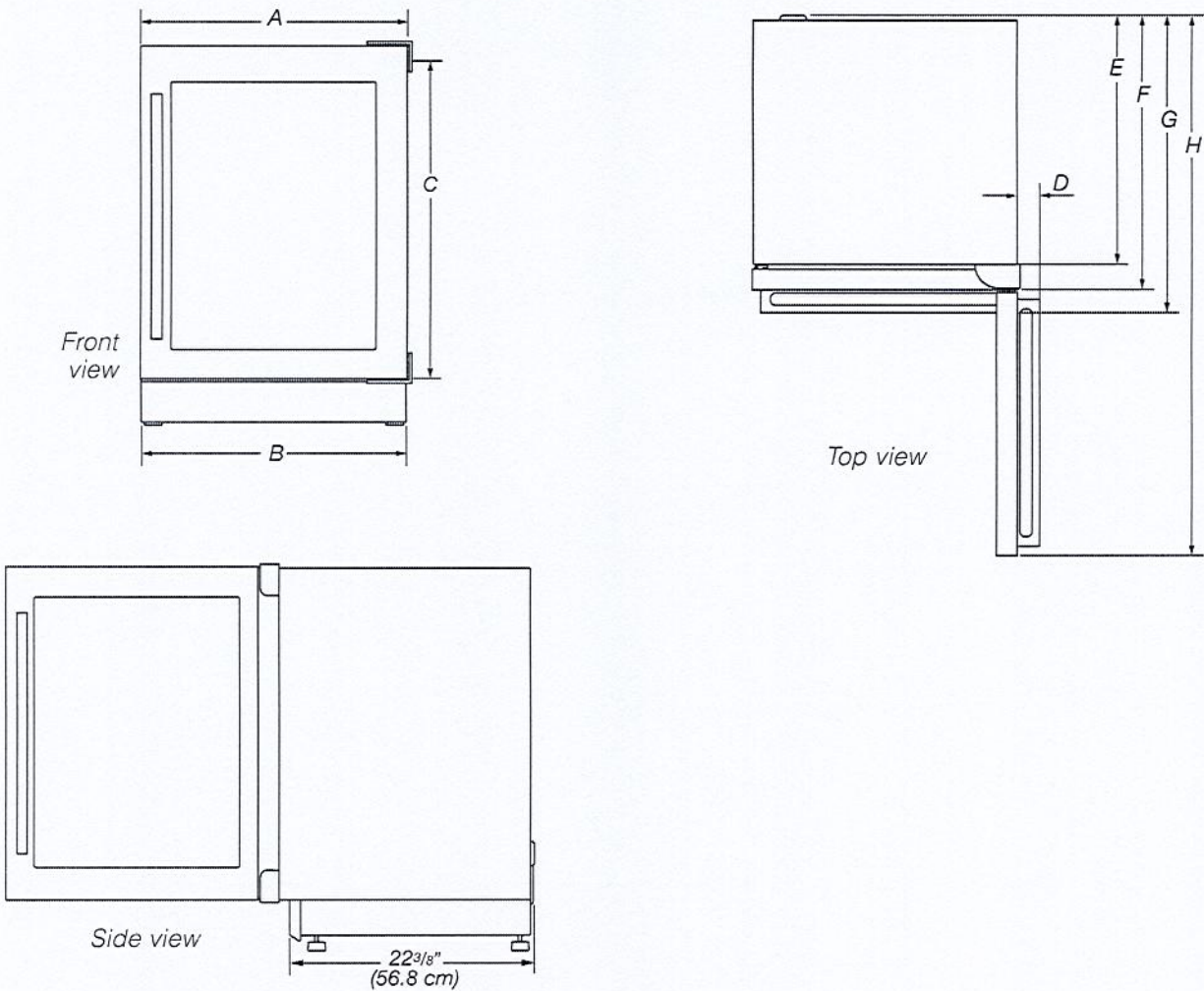

Because Whirlpool Corporation policy includes a continuous commitment to improve our products, we reserve the right to change materials and specifications without notice.

Dimensions are for planning purposes only. For complete details, see Installation Instructions packed with product. Specifications subject to change without notice.



### Opening Dimensions

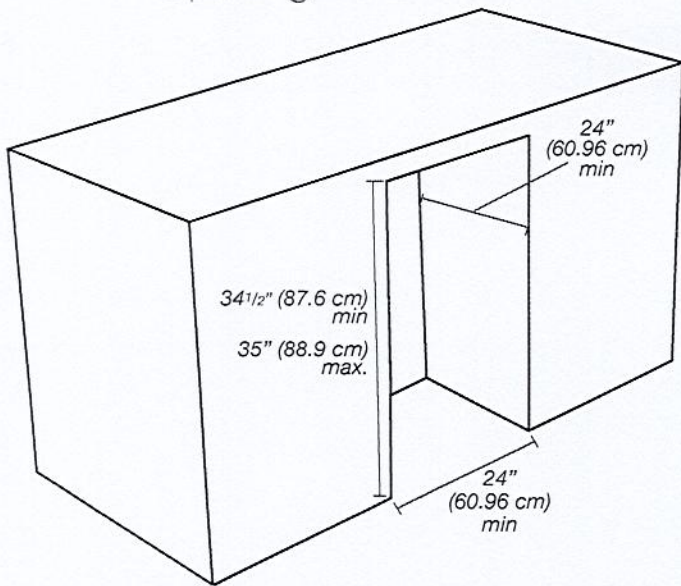

**NOTE:** Make sure there is 3" (7,6 cm) space between beverage center and adjacent appliance/wall for door swing.

### Electrical Requirements

#### ⚠ WARNING



##### Electrical Shock Hazard

**Plug into a grounded 3 prong outlet.**

**Do not remove ground prong.**

**Do not use an adapter.**

**Do not use an extension cord.**

**Failure to follow these instructions can result in death, fire, or electrical shock.**

A 115 V, 60 Hz, AC only, 15 A or 20 A fused, grounded electrical supply is required. It is recommended that a separate circuit serving only your beverage center be provided. Use an outlet that cannot be turned off by a switch. Do not use an extension cord.

### Electrical Supply Location

- Lighter grey area indicates recommended needed power outlet (located behind the beverage center).
- Power cord length is 60" (152.4 cm).

- For flush installation, the power outlet can be installed in adjacent cabinetry with a cutout on the power cord side for routing of the power cord.

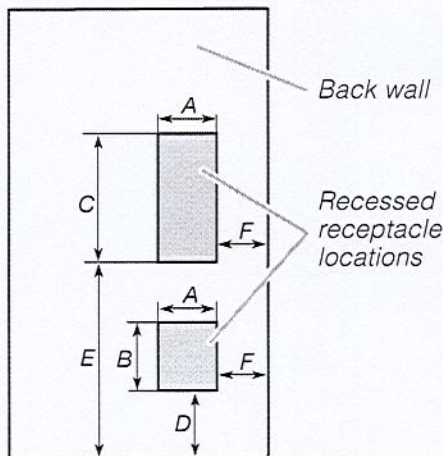

Dimensions			
A	3" (7.55 cm)	D	12 1/16" (30.64 cm)
B	4 1/2" (11.37 cm)	E	21 3/4" (55.16 cm)
C	9 1/4" (23.47 cm)	F	1 3/4" (4.44 cm)

### Location Requirements

#### ⚠ WARNING



##### Explosion Hazard

**Keep flammable materials and vapors, such as gasoline, away from beverage center.**

**Failure to do so can result in death, explosion, or fire.**

For the beverage center to be flush with the front of the base cabinets, remove any baseboards or moldings from the rear of the opening.

Flooring under product must be at the same level as the room. If the floor of the opening is not level with the kitchen floor, shim the opening to make it level with the kitchen floor.

Because Whirlpool Corporation policy includes a continuous commitment to improve our products, we reserve the right to change materials and specifications without notice.

Dimensions are for planning purposes only. For complete details, see Installation Instructions packed with product. Specifications subject to change without notice.



Lot 16 Legacy

48"



Product Dimension Guide for models JBSS42E22L/48E22L

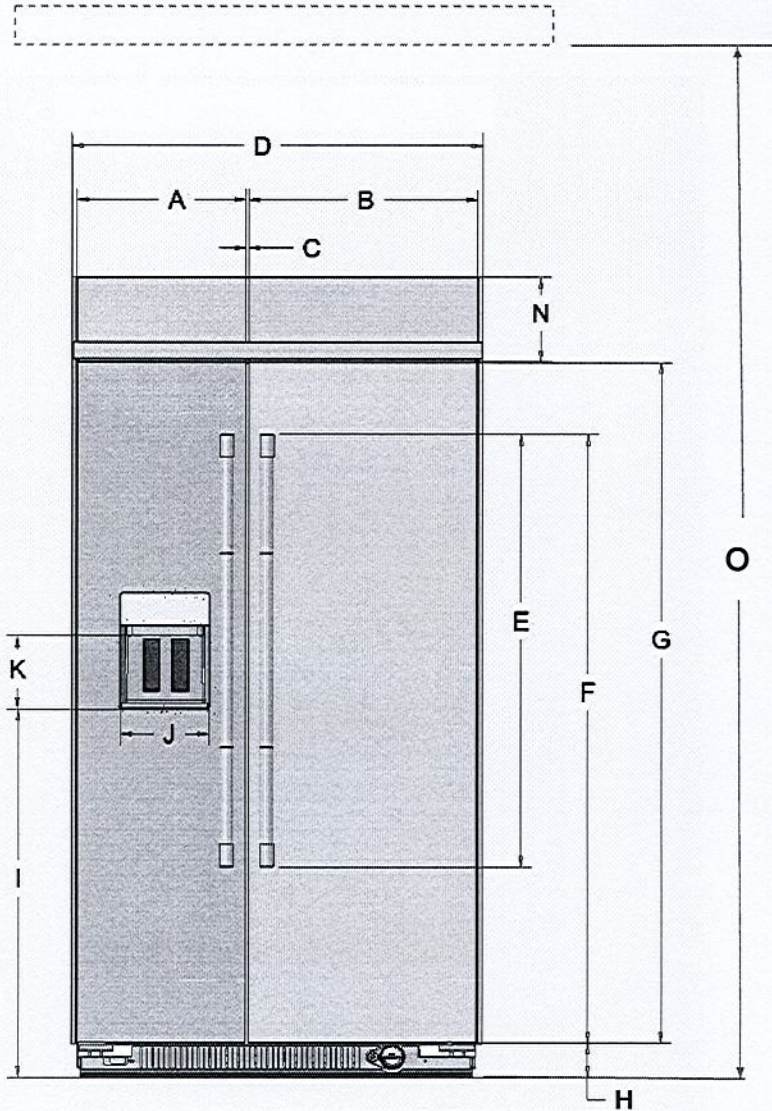

Description		Inches (cm)
A	Width of FC door	
	42"	17½" (44.4)
	48"	20" (50.8)
B	Width of RC door	
	42"	23½" (59.7)
	48"	27" (68.6)
C	Space between doors	¼" (0.65)
D	Overall width with side trims	
	42"	42⅜" (107.6)
	48"	48⅜" (122.8)
E	Height of door handles	45" (114.3)
F	Height to top of door handles	63⅜" (161.0)
G	Height of doors	70⅛" (180.2)
H	Height of grille	3⅞" (9.0)
I	Height to bottom of the Dispenser	38⅝" (97.3)
J	Width of Dispenser	9⅜" (23.3)
K	Height of Dispenser	7⅛" (19.5)
L	Water line location distance from side	17¾" (45.0)
M	Water line location distance from front	3¼" (8.2)
N	Height of grille (top)	8⅞" (22.6)
O	To bottom of solid soffit (minimum/maximum)	83½" (212.1)
		84⅝" (215)

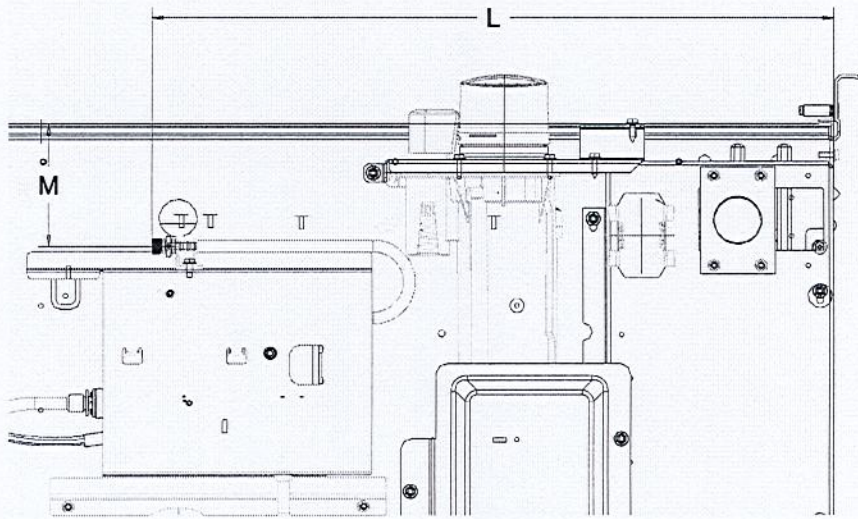

Because Whirlpool Corporation policy includes a continuous commitment to improve our products, we reserve the right to change materials and specifications without notice. Dimensions are for planning purposes only. For complete details, see Installation Instructions packed with product. Specifications subject to change without notice.

W11593506B

4 of 10



Lot 16 Legacy

48"



Product Dimension Guide for models JBSSS42E22L/48E22L

Power chord location

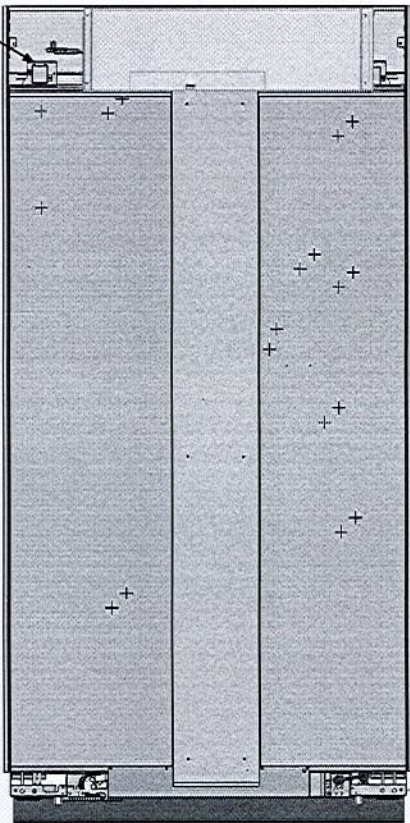

Electrical Requirements

**⚠ WARNING**

**Electrical Shock Hazard**

Plug into a grounded 3 prong outlet.

Do not remove ground prong.

Do not use an adapter.

Do not use an extension cord.

Failure to follow these instructions can result in death, fire, or electrical shock.

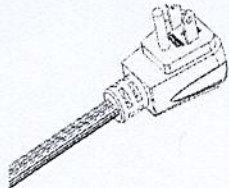
	Power chord	
	Type	Length
		Inches (cm)
	Standard	60" (152.5)

**Electrical:** A 115V, 60 Hz AC only, 15A or 20A fused, grounded electrical supply is required. It is recommended that a separate circuit serving only your refrigerator be provided. Use an outlet that cannot be turned off by a switch. Do not use an extension cord.

**Water:** A cold water supply with water pressure of between 30 psi and 120 psi (207 kPa and 827 kPa) is required to operate the water dispenser and ice maker. If you have questions about your water pressure, call a licensed, qualified plumber.

Because Whirlpool Corporation policy includes a continuous commitment to improve our products, we reserve the right to change materials and specifications without notice. Dimensions are for planning purposes only. For complete details, see Installation Instructions packed with product. Specifications subject to change without notice.

50610



Lot 16 Legacy

48"



Product Dimension Guide for models JBSS42E22L/48E22L

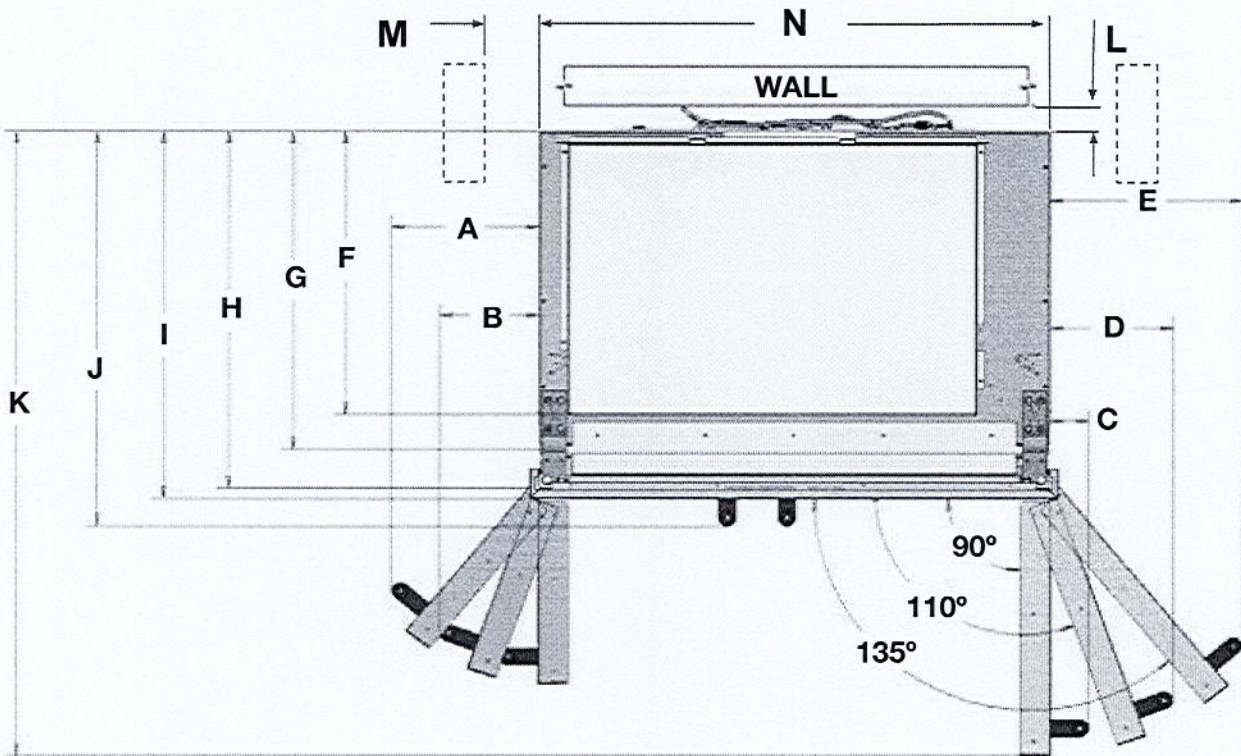

Description		Inches (cm)
A	Width from FC side of refrigerator to handle - door fully open 130°	
	42" 48"	11 <sup>5</sup> / <sub>8</sub> " (29.5) 13 <sup>1</sup> / <sub>4</sub> " (33.6)
B	Width from FC side of refrigerator to handle - door fully open 110°	
	42" 48"	7 <sup>5</sup> / <sub>8</sub> " (19.3) 8 <sup>7</sup> / <sub>16</sub> " (21.5)
C	Width from FC side of refrigerator to handle - door open 90°	2 <sup>11</sup> / <sub>16</sub> " (6.8)
D	Width from RC side of refrigerator to handle - door fully open 110°	
	42" 48"	9 <sup>5</sup> / <sub>8</sub> " (24.5) 10 <sup>7</sup> / <sub>8</sub> " (27.6)
E	Width from RC side of refrigerator to handle - door fully open 130°	
	42" 48"	15 <sup>1</sup> / <sub>2</sub> " (39.3) 17 <sup>3</sup> / <sub>4</sub> " (45.1)
F	Depth to machine compartment cover	19 <sup>15</sup> / <sub>16</sub> " (50.6)
G	Depth without doors	22 <sup>3</sup> / <sub>8</sub> " (56.8)
H	Depth with doors	25 (63.5)
I	Depth with top grill	25 <sup>13</sup> / <sub>16</sub> " (65.5)
J	Depth with handles	27 <sup>11</sup> / <sub>16</sub> " (70.4)
K	Depth with RC door open 90°	
	42" 48"	47 <sup>3</sup> / <sub>16</sub> " (119.9) 50 <sup>1</sup> / <sub>16</sub> " (128.8)
L	Space required for water lines and power chord	1" (2.54)
M	Space required for side cabinet for the door fully open	6" (15.24)
N	Cabinet Width	
	42" 48"	41" (104.1) 42" (119.3)



Lot 16 Legacy

48"



Product Dimension Guide for models JBSS42E22L/48E22L

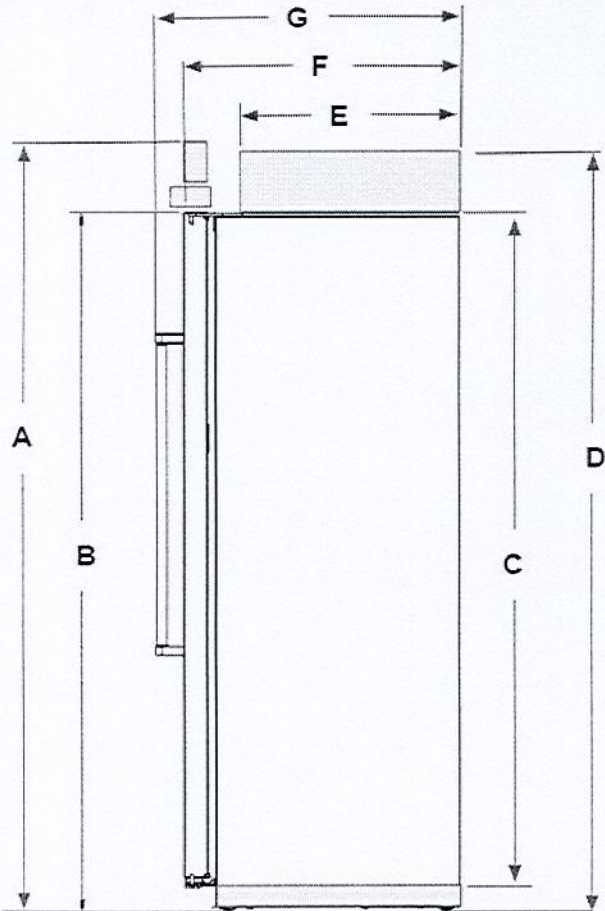

Description		Inches (cm)
A	Total height	83 <sup>3</sup> / <sub>8</sub> " (211.8)
B	Height to top of doors	74 <sup>1</sup> / <sub>2</sub> " (189.2)
C	Height of Cabinet	71" (180.4)
D	Height to top of machine compartment cover	83 <sup>3</sup> / <sub>16</sub> " (211.3)
E	Depth to machine compartment cover	19 <sup>15</sup> / <sub>16</sub> " (50.6)
F	Depth with doors	25" (63.5)
G	Depth with handles	27 <sup>11</sup> / <sub>16</sub> " (70.4)

Interior dimensions	Width Inches (cm)	Height Inches (cm)
Refrigerator Compartment		
42"	20 <sup>13</sup> / <sub>16</sub> " (52.9)	67 <sup>1</sup> / <sub>16</sub> " (170.4)
48"	24 <sup>5</sup> / <sub>16</sub> " (61.8)	
Freezer Compartment		
42"	14 <sup>5</sup> / <sub>16</sub> " (36.4)	66 <sup>3</sup> / <sub>4</sub> " (169.6)
48"	16 <sup>13</sup> / <sub>16</sub> " (42.7)	

Location Requirements

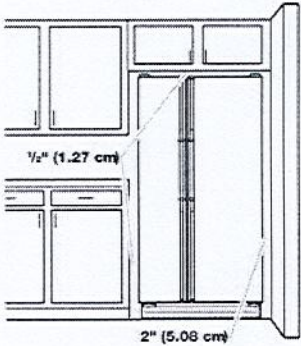

**⚠ WARNING**

**Explosion Hazard**  
Keep flammable materials and vapors, such as gasoline, away from refrigerator.  
Failure to do so can result in death, explosion, or fire.

To ensure proper ventilation for your refrigerator, allow for 1/2" (1.27 cm) of space on each side and at the top. Allow for 1" (2.54 cm) of space behind the refrigerator. If your refrigerator has an ice maker, allow extra space at the back for the water line connections. When installing your refrigerator next to a fixed wall, leave a 2" (5.08 cm) minimum space on each side (depending on your model) to allow the doors to swing open.

NOTES:



- This refrigerator is intended for use in a location where the temperature ranges from a minimum of 55°F (13°C) to a maximum of 110°F (43°C). The preferred room temperature range for optimum performance, which reduces electricity usage and provides superior cooling, is between 60°F (15°C) and 90°F (32°C). It is recommended that you do not install the refrigerator near a heat source, such as an oven or radiator.
- Normal minimum cabinet cut-out width required for product installation is 36" (91.44 cm). However, if the product is placed against an extended wall and the ability to remove the crisper pans is desired, an additional 18" (45.72 cm) of cabinet width is required, so a total cabinet opening width of 54" (137.16 cm) is recommended.

70610



## Installation Instructions

Please Read the Manual Carefully Before Installation

ADJUST SCREW A   
SCREW B   
TRIM-KIT PLASTIC  
COVER 

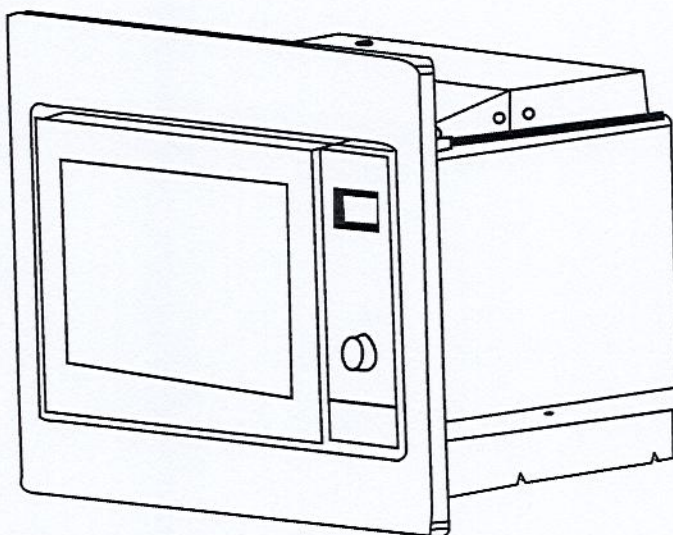

### Please Note

#### Electrical connection

The oven is fitted with a plug and must be only connected to a properly installed earthed socket. In accordance with the appropriate regulations, the socket must only be installed and the connecting cable must only be replaced by a qualified electrician.

If the plug is no longer accessible following installation and all-pole isolating switch must be present on the installation side with a contact gap of at least 3mm.





A. Built-in furniture

The built-in cabinet shall not have a rear wall behind the appliance.  
Minimum installation height is 91.4 cm(36.0 inch).  
Do not cover ventilation slots and air intake points.

1.

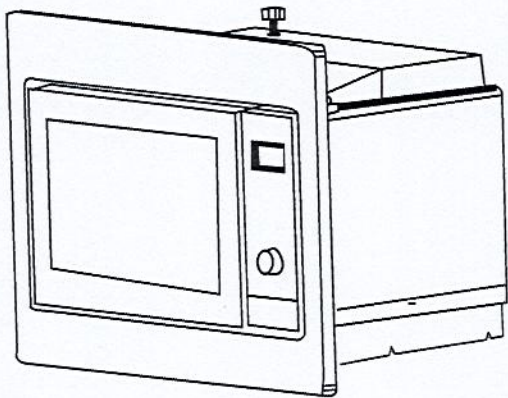
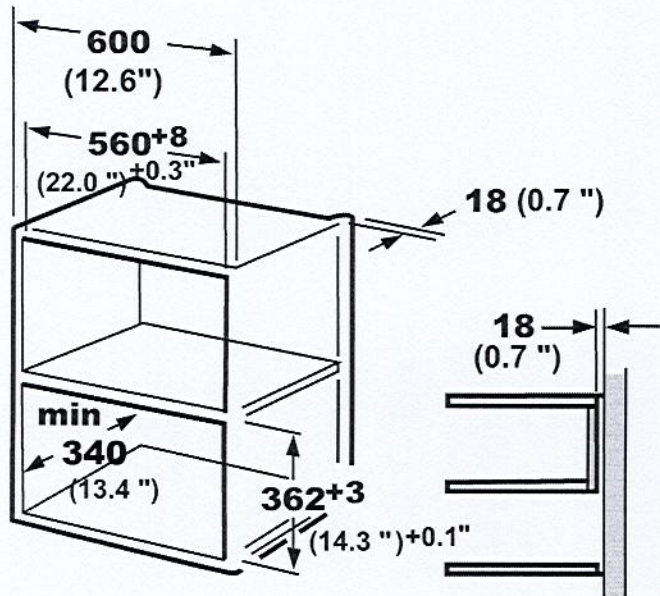

2.

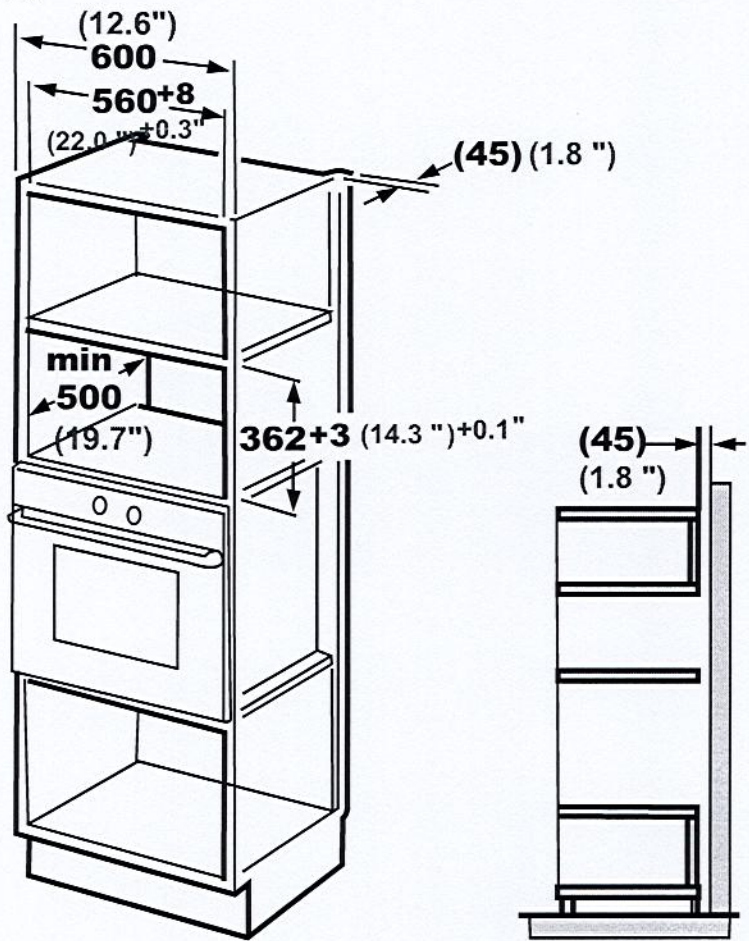



## B. Install the Oven

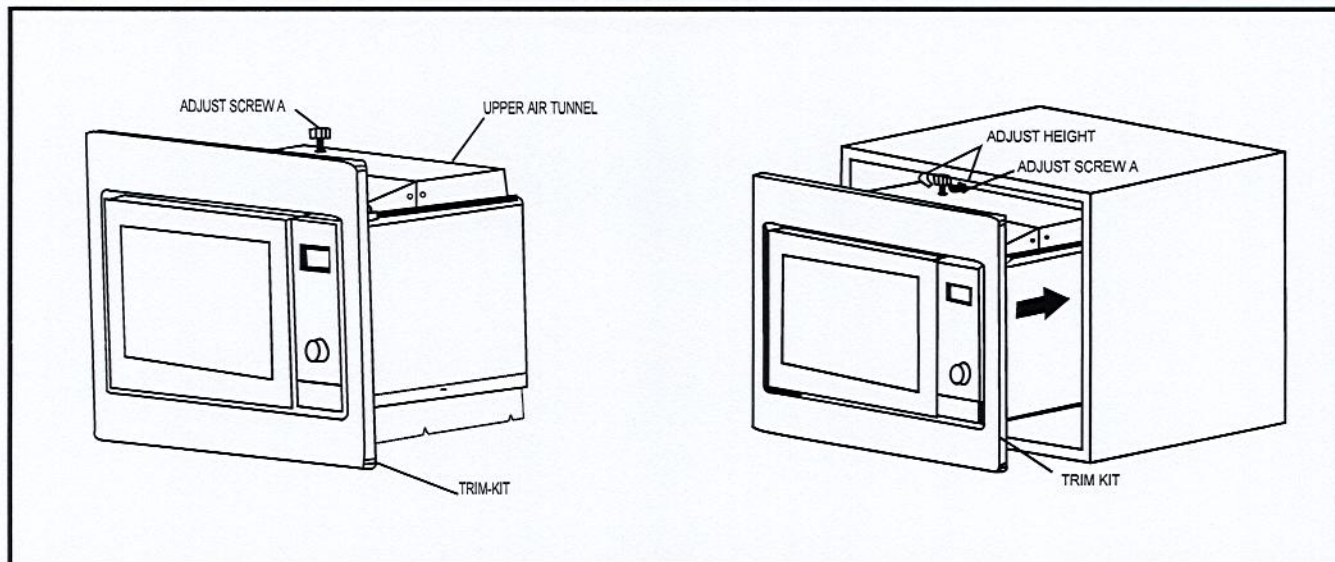

1. Fix ADJSUTSCREW A on the UPPER AIR TUNNEL of the oven, and then install the oven into the cabinet.

- Adjust the height of ADJUST SCREW A to keep 1mm gap between the ADJUST SCREW A and the top plane of cabinet.
- Do not trap or kink the power cord.
- Make sure that the oven is installed in the center of the cabinet.

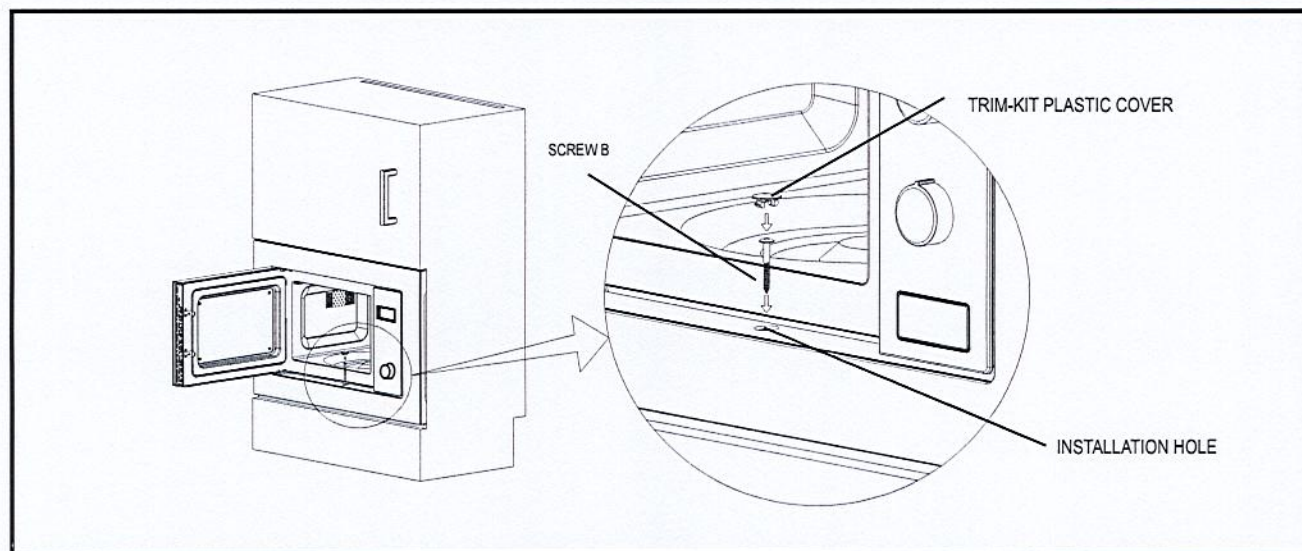

2. Open the door; fix the oven to the cabinet with SCREW B at the INSTALLATION HOLE of TRIM KIT. Then fix the TRIM-KIT PLASTIC COVER to the INSTALLATION HOLE.