



CONSTRUCTION SUMMARY
330 Richmond - Petaluma Building Corp.

PURCHASER: Domenic DEMARIA TEL: RES.: 647-895-3387

Unit 2, Level 9 (1002-1)	Floor Plan B544		
--------------------------	--------------------	--	--

CABINETRY

1 - KITCHEN- 41" UPPER CABINETS 22Nov18 Note:	
--	--

CERAMIC TILE

1 - TUB WALL TILES TO BE LAID IN A STAGGERED PATTERN 22Nov18 Note:	
---	--

CONSTRUCTION

1 - SMOOTH CEILING IN BEDROOM 22Nov18 Note:	
--	--

COUNTER TOP

1 - UPGRADE KITCHEN COUNTERTOP 22Nov18 Note:	
1 - UPGRADE COUNTERTOP EDGE- KITCHEN AND BATHROOM 22Nov18 Note:	

PLUMBING

1 - KITCHEN UPGRADE SINK- BLANCO QUATRUS R15 UT MEDIUM #401517 22Nov18 Note:	
1 - UPGRADE BATHROOM ACCESSORIES- MOEN 90 DEG-TOILET PAPER HOLDER #YB8808 CHROME 90 DEG TOWEL RING #YB8886 CHROME 90 DEG 24" TOWEL BAR #YB8824 CHROME 22Nov18 Note:	

PROMOTIONAL

1 - PURCHASER FOREFITS REMIANDER OF UPGRADE BONUS 22Nov18 Note:	
1 - LESS CREDIT FROM PURCHASERS EXTRA SHEET IN OFFER 22Nov18 Note:	

EXTRAS AS PER OFFER

The Vendor agrees that notwithstanding any other term or provision in this Agreement included in the Purchase Price and in addition to those items detailed in Schedule D to the Agreement of Purchase and Sale, the Purchaser is entitled to a credit of Fiv Worksheet Note:	
--	--

This Document is Extremely Time Sensitive - Printed 22 Nov 18 at 11:08

RECEIVED NOV 26 2018

Purchaser: Domenic DEMARIA

Telephone Res. / Bus: (647) 895-3387 /

Decor Advisor: Natalie Mancuso

Lock Date: 11/22/2018 11:07:58

Const. No.: Unit 2, Level 9

Municipal: 1002

Suite Type: B544

Project/Phase: Petaluma Building Corp./1

Layout Changes: ☐ Yes ☒ No

Sketch Attached: ☒ Yes ☐ No

Exterior Colour Scheme:

1. Kitchen and Vanities

	Style and Colour	Counter	Hardware
Kitchen / Breakfast	SEE BELOW	QUARTZ- VICTORIA #360 EDGE	STD
Main Bath	DORAL H3078 HACIENDA WHITE	QUARTZ- TORRONE- #360 EDGE	STD
Master Ensuite Bathroom			

Appliances:

Built In Appliances ☒ Yes ☐ No

41" Upper Cabinets ☒ Yes ☐ No

Slide In Stove ☐ Yes ☒ No

Comment

KITCHEN UPPER CABINETS- SENOSAN WHITE

KITCHEN BASE CABIENTS- DORAL H3078 HACIENDA WHITE

2. Flooring

		Grout-If App.	At a 45
Entrance Vestibule	HARDWOOD- MIRAGE 4 5/15 LOCK RED OAK- NORDIC- CASHMERE		<input type="checkbox"/>
Main Hall	HARDWOOD- MIRAGE 4 5/15 LOCK RED OAK- NORDIC- CASHMERE		<input type="checkbox"/>
Kitchen / Breakfast	HARDWOOD- MIRAGE 4 5/15 LOCK RED OAK- NORDIC- CASHMERE		<input type="checkbox"/>
Laundry Room	TILE- MATTE WHITE 8X8	STD	<input type="checkbox"/>
Main Bath	TILE- LIFE SILVER 12X24	STD	<input type="checkbox"/>
Master Ensuite Bathroom			<input type="checkbox"/>
			<input type="checkbox"/>
Living Room	HARDWOOD- MIRAGE 4 5/15 LOCK RED OAK- NORDIC- CASHMERE		<input type="checkbox"/>
Dining Room	HARDWOOD- MIRAGE 4 5/15 LOCK RED OAK- NORDIC- CASHMERE		<input type="checkbox"/>
Den / Library / Study			<input type="checkbox"/>
Master Bedroom	HARDWOOD- MIRAGE 4 5/15 LOCK RED OAK- NORDIC- CASHMERE		<input type="checkbox"/>
Bedroom #2			<input type="checkbox"/>
Bedroom #3			<input type="checkbox"/>
			<input type="checkbox"/>

Comment

3. Wall Tile

	Selection	Grout	Describe
Main Bath			
Tub Deck Wall			
Shower Stall			
Bathtub Enclosure Walls	TILE- GLOSSY WHITE 3X6 STAGGERED	STD	
Master Ensuite Bathroom			
Tub Deck Wall			
Shower Stall			
Bathtub Enclosure Walls			
Kitchen Backsplash	PAINTED GLASS BM #OC-16		
Backsplash Behind Fridge			

Comment

** Refer to Construction Summary

4. Misc

Water Line for Fridge

NO

Interior Door Handles

STANDARD

Ceramic Bathroom Accessories

MOEN 90 DEGREE CHROME

☒ Yes ☐ No

Comment

Initial: 

Purchaser: Domenic DEMARIA
Telephone Res. / Bus: (647) 895-3387 /
Decor Advisor: Natalie Mancuso
Lock Date: 11/22/2018 11:07:58

Const. No.: Unit 2, Level 9
Municipal: 1002
Suite Type: B544
Project/Phase: Petaluma Building Corp./1

5. Plaster Mouldings and Medallions

Entrance Vestibule		
Main Hall		
Kitchen/Breakfast		
Laundry Room		
Main Bath		
Master Ensuite Bathroom		

Living Room		
Dining Room		
Den / Library /Study		
Master BedRoom		
BedRoom #2		
BedRoom #3		

Comment

** Refer to Construction Summary

6. Wall Paint

Entrance Vestibule	BIRCH WHITE
Main Hall	BIRCH WHITE
Kitchen / Breakfast	BIRCH WHITE
Laundry Room	BIRCH WHITE
Main Bath	BIRCH WHITE
Master Ensuite	

Living Room	BIRCH WHITE
Dining Room	BIRCH WHITE
Den/Library	
Master Bedroom	BIRCH WHITE
Bedroom #2	
Bedroom #3	

Comment

7. General Comments

** Refer to Construction Summary

Disclaimers and Notes

- 1) Colours of all materials are as close as possible to builder's selection, but not necessarily identical due to variances in manufacturing.
- 2) Any extras listed above are null and void unless accompanied by a separate invoice/amendment. Said invoice must be paid in full.
- 3) The Purchaser agrees that this colour selection is final and that no changes will be permitted, unless required by the Vendor.
- 4) The Purchaser acknowledges reading and accepting document which contains other miscellaneous disclaimers.

Signature: _____ Date: 11/22/18 Signature: _____ Date: _____

Initial: 

Product Specification Sheet
BLANCO QUATRUS R15 U 1 MEDIUM

Satin brushed finish



PRODUCT DIMENSIONS

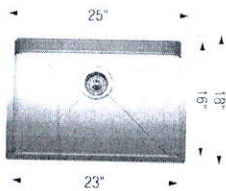

BLANCO QUATRUS R15 U 1 MEDIUM	Colour Finish	Model No.	FEATURES / SPECIFICATIONS
	Satin brushed finish	401517	<ul style="list-style-type: none">• German designed and engineered• Premium 304 series, 18 gauge stainless steel• 18/10 chrome-nickel content for exceptional lustre, durability and strength• Rear-positioned drain hole for maximum usable bowl and cabinet storage space• Compact size, X-pattern drain grooves• 15 mm radius corners for easy cleaning• 3 1/2" (90mm) stainless steel strainer included• Clips, template included• Limited Lifetime Warranty
			DESIGN AND PLANNING TIPS Cabinet Size: 27" (685 mm) Bowl depth: 9" (230 mm) Depending on cabinet construction, a different cabinet size may be required. Consult the cabinet manufacturer.

WARRANTY

Limited Lifetime warranty

Code/Standards Compliance

BLANCO sinks and faucets are third-party tested and certified to CSA, cUPC, ANSI/ASME and NSF standards and listed by applicable certification bodies. For more information on individual product listings, contact our office or listing organization.

BLANCO CANADA 100 Corporation Drive Brampton, ON L6S 6B5	Tel: 905 494 2400 Fax: 905 494 2425 www.blancocanada.com	Toll Free: 1 877 425 2626 Toll Free: 1 877 825 2626
--	--	--

90°™

Traditional | Transitional | Modern

Geometric forms, squared corners and straight lines create an urban focal point for today's contemporary baths



Toilet Tank Lever
Model YB8801

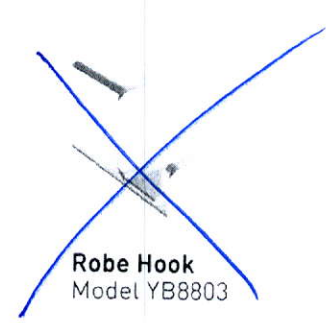

Robe Hook
Model YB8803

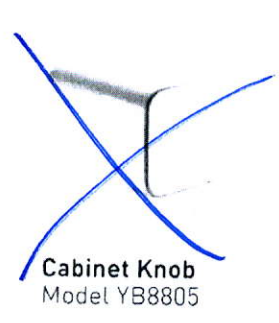

Cabinet Knob
Model YB8805

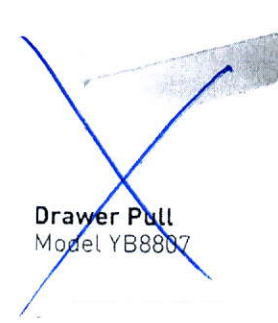

Drawer Pull
Model YB8807

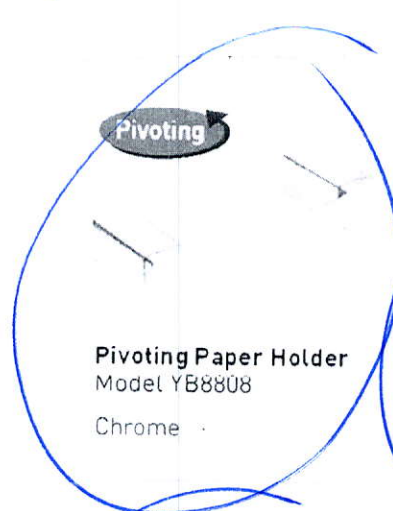

Pivoting Paper Holder
Model YB8808
Chrome

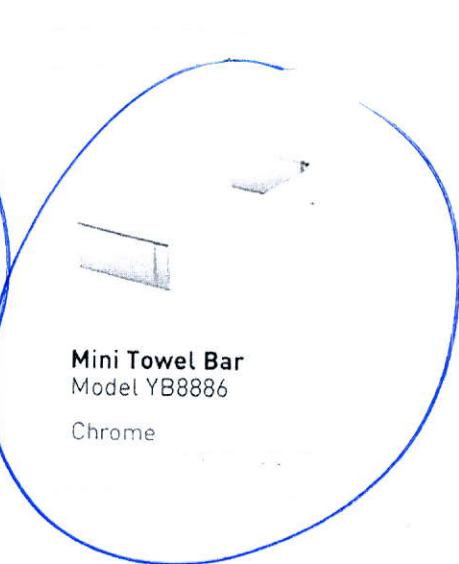

Mini Towel Bar
Model YB8886
Chrome



18" Towel Bar
Model YB8818



24" Towel Bar
Model YB8824



Designer Grab Bar
Models: Chrome Other

FINISH OPTIONS:



To order, combine the model number with one of these finish letter(s):
Chrome (CH), LifeShine® Brushed Nickel (BN).

SCHEDULE 'A'

330

RICHMOND

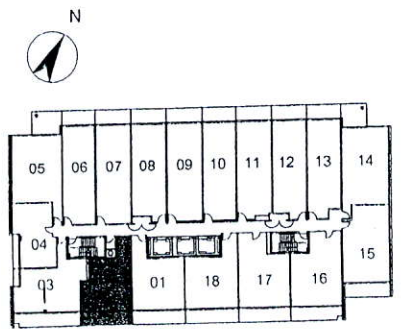
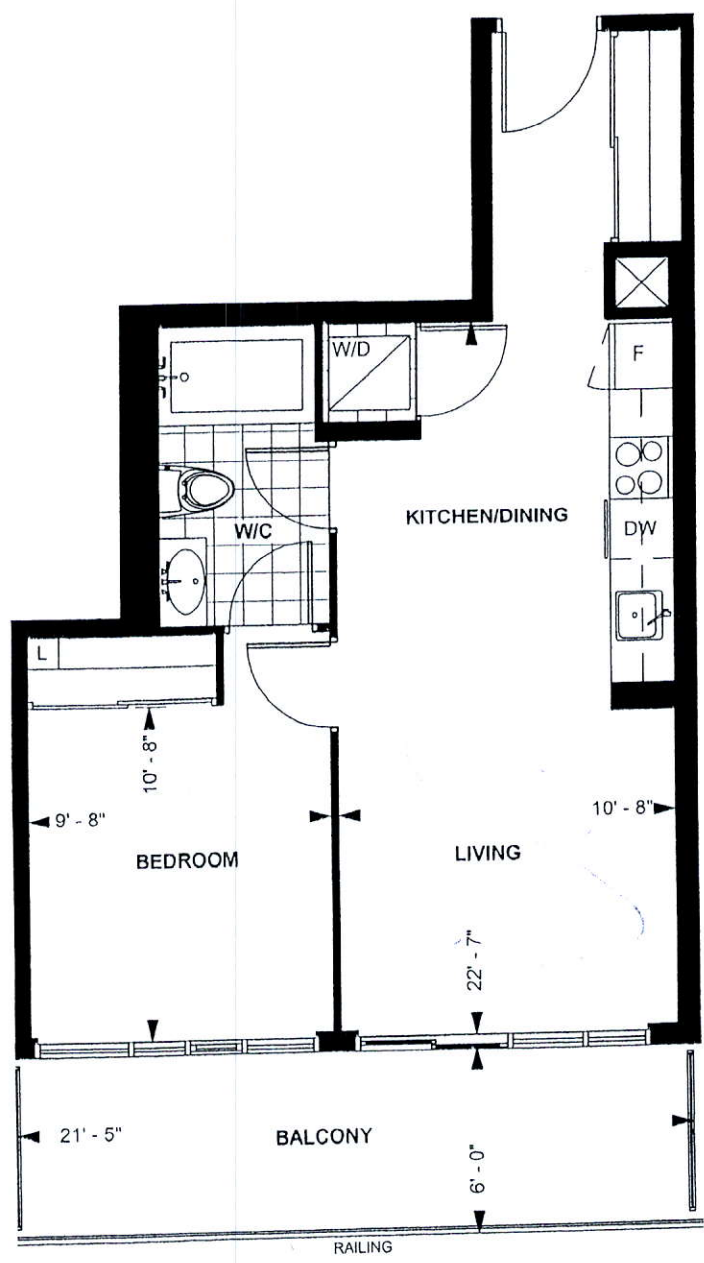

LEVEL 7 - 9

TOWER SUITE
B 544

9' CEILING *

544 sq. ft.
1-BEDROOM

Purchaser Initials Purchaser Initials

Date

Unit No. 2 Level No. 9 Suite No. 1002

Dimensions, specification, tile floor pattern and architectural detailing (including window size and location) are approximate and subject to modifications without notice. Orientation of suite may vary from the stated floor area.
*Ceiling height measured from top of floor slab to underside of slab above before finishes, and excluding bulkheads and required drop ceilings. E.&O.E.

10/27/15

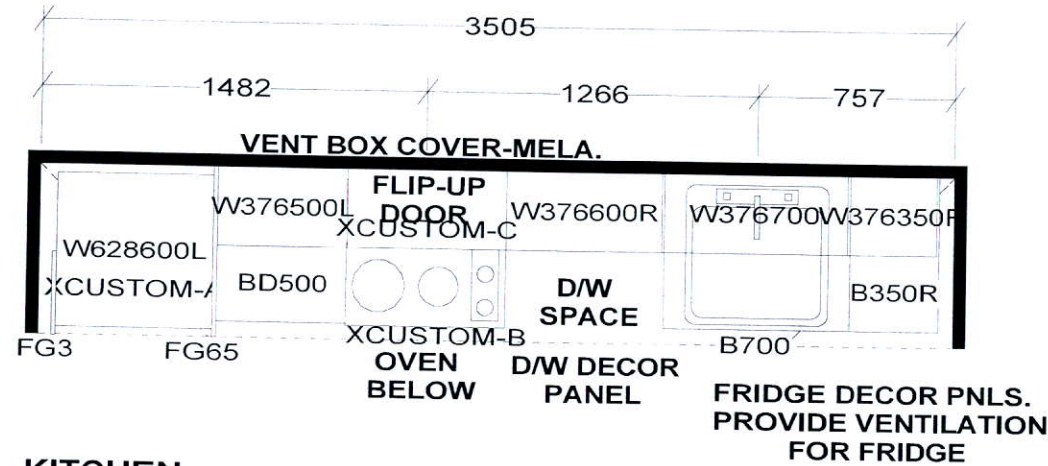

KITCHEN
 - 41" uppers
 - up.counter Edge

APPLIANCE PACKAGE:
 24" INTEGRATED FRIDGE W/ DECOR PNLS
 24" INTEGRATED DISHWASHER W/ DECOR PNL
 24" BUILT-IN OVEN
 24" COOKTOP
 24" MICROWAVE HOOD FAN

S e l b a I n d u s t r i e s

**KITCHEN BASES & VANITIES INSTALLED
 WITH ADJUSTABLE LEGS**

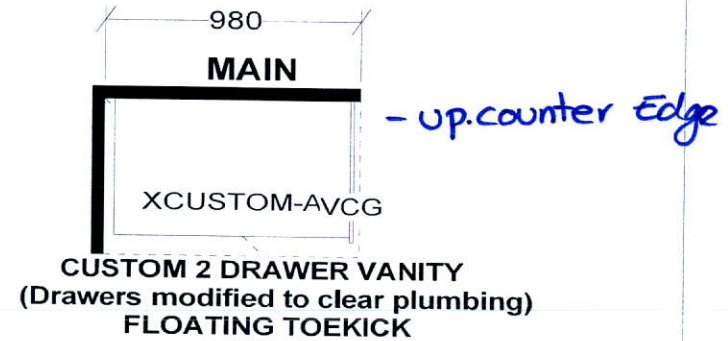

WIDTH	W HGT	W CNT	FL HGT	DWY H	ST CENT	2X4	VENT BOX COVER
TOWER SUITES: 760MM HIGH UPPER CABINETS WHITE STEEL DRAWER BOXES COUNTERTOPS BY OTHERS VENT BOX COVERS CUSTOM VANITIES				<small>This drawing is the intellectual property of SELBA INDUSTRIES INC. and is an original design which must not be released or copied unless applicable fee has been paid or job order placed.</small>		<div style="display: flex; align-items: center;"> <div style="border: 1px solid black; border-radius: 50%; padding: 5px; margin-right: 10px;"> G H A B F E D C </div> <div> JOB NUMBER: BUILDER: GREENPARK SITE NAME: PETALUMA MODEL: 1 BEDROOM - B 544, B 604 LOT #: DESIGNER: KS DATE: JAN 8 18 </div> </div>	