



CONSTRUCTION SUMMARY
330 Richmond - Petaluma Building Corp.

PURCHASER: Edwin PITAMIC

TEL: RES.: 416-533-3380

Unit 7, Level 10 (1108-1)

Floor Plan
B635

CABINETRY

1 - KITCHEN - 41" UPPER CABINETRY

17Oct18 Note:

CERAMIC TILE

1 - BATHROOM - DELETE STANDARD BATHROOM ACCESSORIES - DO NOT INSTALL SOAP DISH, TOWEL RACK OR TISSUE HOLDER

17Oct18 Note:

CONSTRUCTION

1 - BEDROOM - SMOOTH CEILING

17Oct18 Note:

PLUMBING

3 - MOEN MASON BATHROOM ACCESSORIES - CHROME

TISSUE HOLDER-#YB8099/YB8000

TOWEL RING - #YB8086

24" TOWEL BAR - #YB8094 / YB8000

17Oct18 Note:

This Document is Extremely Time Sensitive - Printed 17 Oct 18 at 14:02

RECEIVED OCT 17 2018

Purchaser: Edwin PITAMIC
Telephone Res. / Bus: (416) 533-3380 /
Decor Advisor: Candace Forza
Lock Date: 10/17/2018 14:00:44

Const. No.: Unit 7, Level 10
Municipal: 1108
Suite Type: B635
Project/Phase: Petaluma Building Corp./1

Layout Changes: ☐ Yes ☒ No Sketch Attached: ☒ Yes ☐ No Exterior Colour Scheme:

1. Kitchen and Vanities

	Style and Colour	Counter	Hardware
Kitchen / Breakfast	SEE BELOW	QUARTZ-TORRONE-STRAIGHT POLISHED EDGE	STD
Main Bath	DORAL H3078-HACIENA WHITE	QUARTZ-TORRONE-STRAIGHT POLISHED EDGE	STD
Master Ensuite Bathroom	N/A	N/A	N/A

Appliances: Built In Appliances ☒ Yes ☐ No 41" Upper Cabinets ☒ Yes ☐ No Slide In Stove ☐ Yes ☒ No

Comment

KITCHEN - CABINETRY - BASE DORAL H3078-HACIENA WHITE *** UPPERS - SEMOSAN WHITE

2. Flooring

		Grout-If App.	At a 45
Entrance Vestibule	STRIP-MIRAGE-LOCK-RED OAK-CASHMERE- NORDIC-4 5/16"		<input type="checkbox"/>
Main Hall	STRIP-MIRAGE-LOCK-RED OAK-CASHMERE- NORDIC-4 5/16"		<input type="checkbox"/>
Kitchen / Breakfast	STRIP-MIRAGE-LOCK-RED OAK-CASHMERE- NORDIC-4 5/16"		<input type="checkbox"/>
Laundry Room	TILE-LIFE SILVER-12X24	STANDARD	<input type="checkbox"/>
Main Bath	TILE-LIFE SILVER-12X24	STANDARD	<input type="checkbox"/>
Master Ensuite Bathroom	N/A		<input type="checkbox"/>
	N/A		<input type="checkbox"/>
Living Room	STRIP-MIRAGE-LOCK-RED OAK-CASHMERE- NORDIC-4 5/16"		<input type="checkbox"/>
Dining Room	STRIP-MIRAGE-LOCK-RED OAK-CASHMERE- NORDIC-4 5/16"		<input type="checkbox"/>
Den / Library / Study	N/A		<input type="checkbox"/>
Master Bedroom	STRIP-MIRAGE-LOCK-RED OAK-CASHMERE- NORDIC-4 5/16"		<input type="checkbox"/>
Bedroom #2	N/A		<input type="checkbox"/>
Bedroom #3	N/A		<input type="checkbox"/>

Comment

3. Wall Tile

	Selection	Grout	Describe
Main Bath			
Tub Deck Wall	N/A		
Shower Stall	N/A		
Bathtub Enclosure Walls	TILE-GLOSSY WHITE-3X6	STANDARD	
Master Ensuite Bathroom			
Tub Deck Wall	N/A		
Shower Stall	N/A		
Bathtub Enclosure Walls	N/A		
Kitchen Backsplash	BACK PAINTED GLASS-BM-#OC-16	STANDARD	
Backsplash Behind Fridge	N/A		

Comment

** Refer to Construction Summary

4. Misc

Water Line for Fridge N/A
Interior Door Handles AS PER CONSTRUCTION SPECS
Ceramic Bathroom Accessories NO - UPGRADED MOEN MASON ☐ Yes ☒ No

Comment

Initial: 

Purchaser: Edwin PITAMIC
Telephone Res. / Bus: (416) 533-3380 /
Decor Advisor: Candace Forza
Lock Date: 10/17/2018 14:00:44

Const. No.: Unit 7, Level 10
Municipal: 1108
Suite Type: B635
Project/Phase: Petaluma Building Corp./1

5. Plaster Mouldings and Medallions

Entrance Vestibule	N/A		Living Room	N/A	
Main Hall	N/A		Dining Room	N/A	
Kitchen/Breakfast	N/A		Den / Library /Study	N/A	
Laundry Room	N/A		Master BedRoom	N/A	
Main Bath	N/A		BedRoom #2	N/A	
Master Ensuite Bathroom	N/A		BedRoom #3	N/A	

Comment

** Refer to Construction Summary

6. Wall Paint

Entrance Vestibule	43-BIRCH WHITE	Living Room	43-BIRCH WHITE
Main Hall	43-BIRCH WHITE	Dining Room	43-BIRCH WHITE
Kitchen / Breakfast	43-BIRCH WHITE	Den/Library	N/A
Laundry Room	43-BIRCH WHITE	Master Bedroom	43-BIRCH WHITE
Main Bath	43-BIRCH WHITE	Bedroom #2	N/A
Master Ensuite	N/A	Bedroom #3	N/A
	N/A		

Comment

7. General Comments

** Refer to Construction Summary

Disclaimers and Notes

- Colours of all materials are as close as possible to builder's selection, but not necessarily identical due to variances in manufacturing.
- Any extras listed above are null and void unless accompanied by a separate invoice/amendment. Said invoice must be paid in full.
- The Purchaser agrees that this colour selection is final and that no changes will be permitted, unless required by the Vendor.
- The Purchaser acknowledges reading and accepting document which contains other miscellaneous disclaimers.

Signature:

Date:

0CT17/18

Signature:

Date:

Initial: _____

Mason™

Traditional | Transitional | Modern

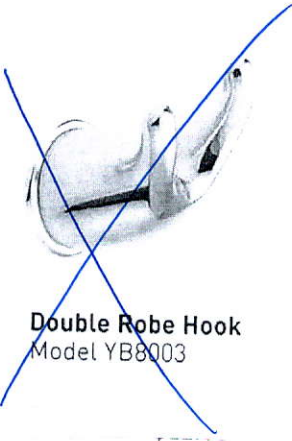

Double Robe Hook
Model YB8003

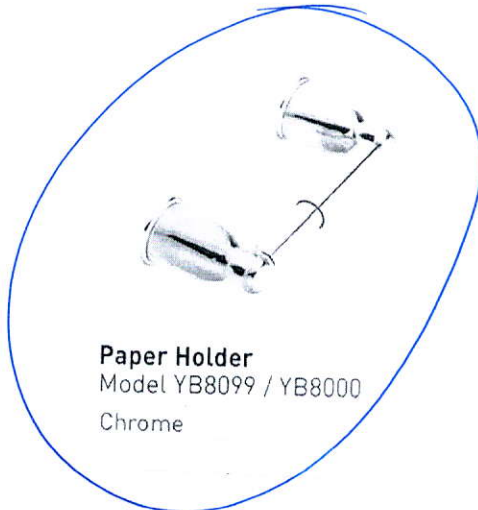

Paper Holder
Model YB8099 / YB8000
Chrome

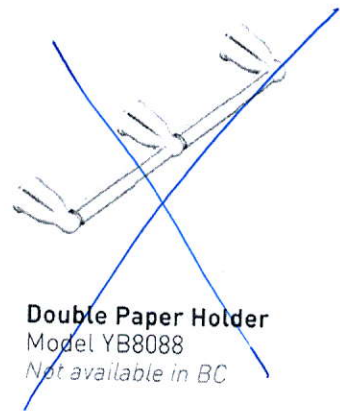

Double Paper Holder
Model YB8088
Not available in BC

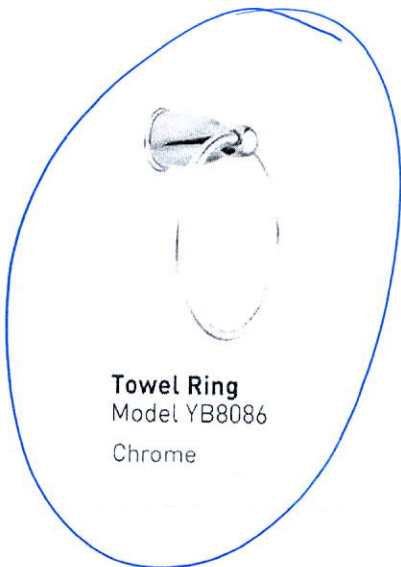

Towel Ring
Model YB8086
Chrome



18" Towel Bar
Model YB8098 / YB8000

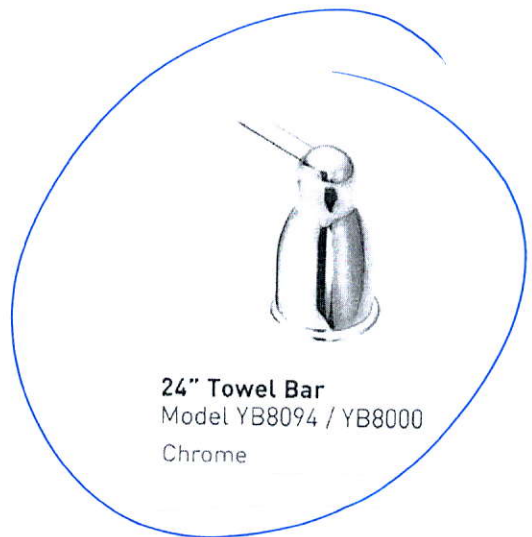

24" Towel Bar
Model YB8094 / YB8000
Chrome

FINISH OPTIONS:

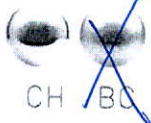

To order, combine the model number with one of these finish letter(s):
Chrome (CH) & Brushed Chrome (BC).

PRO+FIT™
INSTALLATION SYSTEM

SCHEDULE 'A'

330

RICHMOND

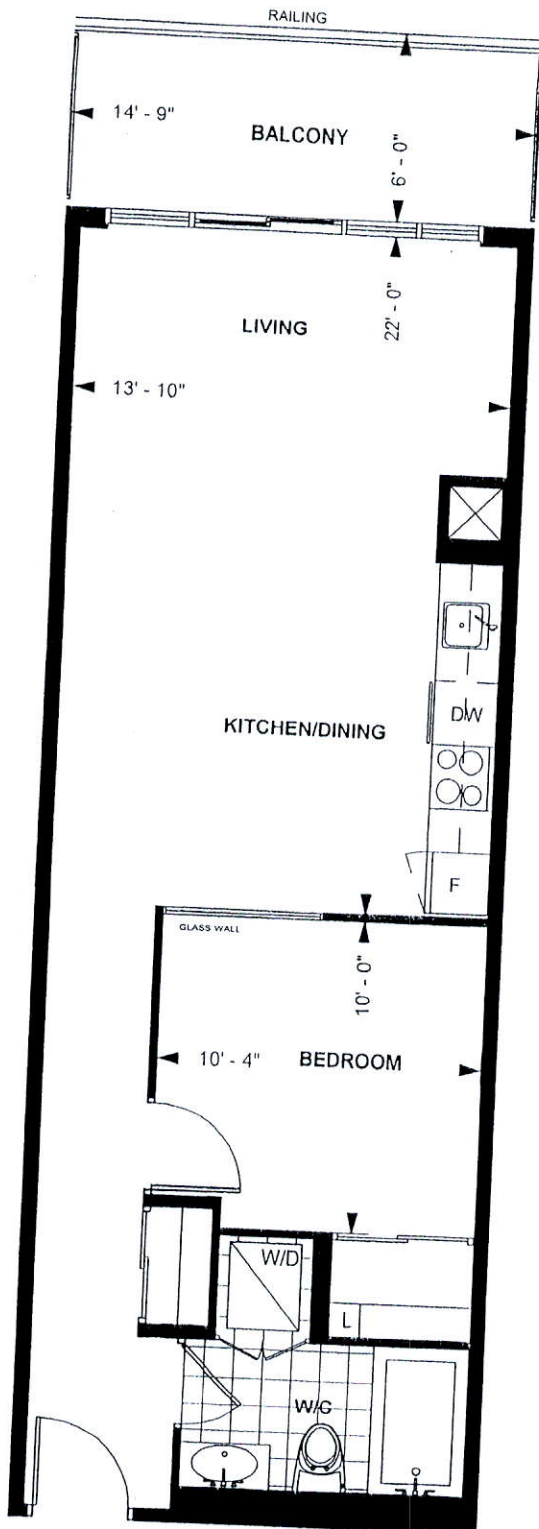

E.L.

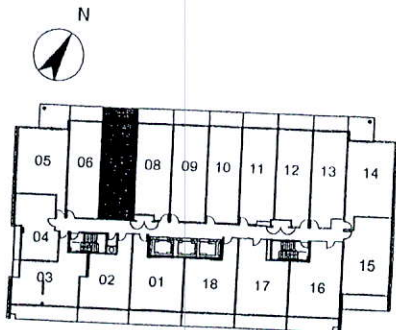

LEVEL 10

TOWER SUITE

B 635

9' CEILING *

635 sq. ft.

1-BEDROOM

Purchaser Initials Purchaser Initials

Date

Unit No. 7 Level No. 10 Suite No. 1108

Dimensions, specification, tile floor pattern and architectural detailing (including window size and location) are approximate and subject to modifications without notice. Orientation of suite may vary from the stated floor area.
*Ceiling height measured from top of floor slab to underside of slab above before finishes, and excluding bulkheads and required drop ceilings. E.&O.E.

• 41" Upper
Cabinetry

41" Upper
Cabinetry

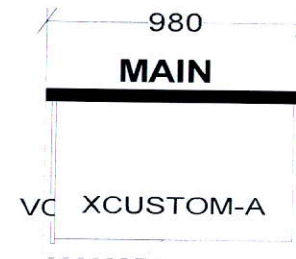
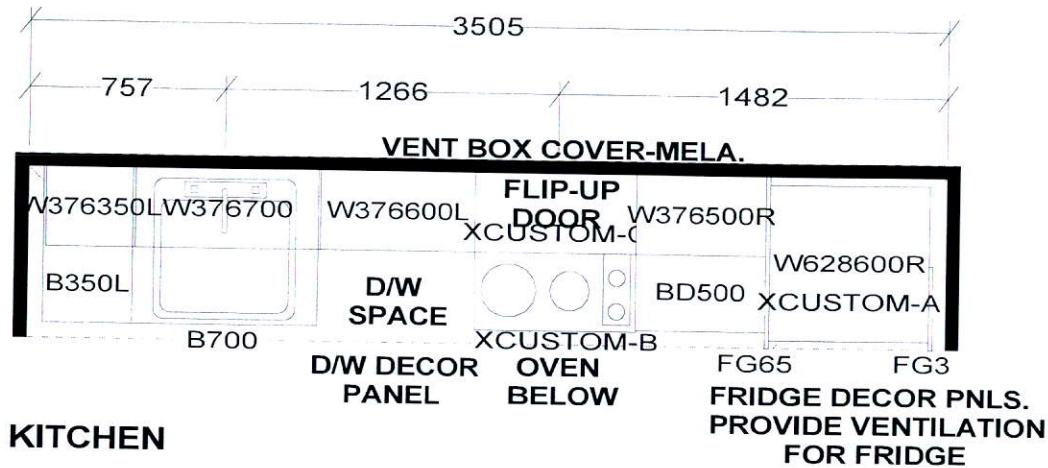

CUSTOM 2 DRAWER VANITY
(Drawers modified to clear plumbing)
FLOATING TOEKICK

KITCHEN BASES & VANITIES INSTALLED
WITH ADJUSTABLE LEGS

APPLIANCE PACKAGE:
24" INTEGRATED FRIDGE W/ DECOR PNLS
24" INTEGRATED DISHWASHER W/ DECOR PNL
24" BUILT-IN OVEN
24" COOKTOP
24" MICROWAVE HOOD FAN

S e l b a I n d u s t r i e s

WDTH _____ W HGHT _____ W CNT _____ FL HGHT _____ DWY H _____ ST CENT _____ 2X4 _____ VENT BOX COVER _____

TOWER SUITES:
760MM HIGH UPPER CABINETS
WHITE STEEL DRAWER BOXES
COUNTERTOPS BY OTHERS
VENT BOX COVERS
CUSTOM VANITIES

This drawing is the intellectual property of
SELBA INDUSTRIES INC. and is an
original design which must not be released
or copied unless applicable fee has been
paid or job order placed.



JOB NUMBER:
BUILDER: GREENPARK
SITE NAME: PETALUMA
MODEL: 1 BEDROOM-B 592, B 609, B 635
LOT #:
DESIGNER: KS
DATE: JAN 8 18