



CONSTRUCTION SUMMARY
330 Richmond - Petaluma Building Corp.

PURCHASER: Kashif REHMAN

TEL: BUS.: 416-670-6377

Unit 12, Level 10 (1115-1)

Floor Plan
B604

CABINETRY

1 - KITCHEN - 41" UPPER CABINETRY
30Oct18 Note:

CERAMIC TILE

1 - BATHROOM - DELETE STANDARD WHITE CERMIAC ACCESSORIES - DO NOT INSTALL SOAP DISH, TOWEL RACK OR TISSUE HOLDER
30Oct18 Note:

CONSTRUCTION

1 - BEDROOM - SMOOTH CEILING
30Oct18 Note:

1 - MAIN BATH - 5 FOOT SHOWER WITH SLIDING CHROME FRAMED GLASS DOORS IN LIEU OF TUB
15Jan18 Note:

MISCELLANEOUS

1 - PURCHASER FORFEITS REMAING BALANCE OF CREDIT IN THE AMOUNT OF \$10.00
30Oct18 Note:

1 - COLOUR CHANGE ADMINISTRATION FEE
30Oct18 Note:

PLUMBING

3 - BATHROOM - MOEN MASON BATHROOM ACCESSORIES - CHROME
TISSUE HOLDER-#YB8099/YB8000
TOWEL RING - #YB8086
24" TOWEL BAR - #YB8094 / YB8000
30Oct18 Note:

PROMOTIONAL

1 - LESS BALANCE OF CREDIT FROM PURCHASERS EXTRA SHEET IN OFFER
30Oct18 Note:

1 - PARTIAL REDEPTION OF PROMOTIONAL PACKAGE \$2,800.00 BALANCE (\$2,200) FORWARD TO BE USED AT A LATER DATE.
ORIGINAL PROMOTIONAL PACKAGE OF \$5,000 AS PER SCHEDULE PE DATED DECEMBER 16, 2015.
15Jan18 Note:

EXTRAS AS PER OFFER

The Vendor agrees that notwithstanding any other term or provision in this Agreement included in the Purchase Price and in addition to those items detailed in Schedule D to the Agreement of Purchase and Sale, the Purchaser is entitled to a credit of Fiv
Worksheet Note:

This Document is Extremely Time Sensitive - Printed 30 Oct 18 at 14:59

RECEIVED OCT 30 2018

Purchaser: Kashif REHMAN
Telephone Res. / Bus: / (416) 670-6377
Decor Advisor: Candace Forza
Lock Date: 10/30/2018 14:59:02

Const. No.: Unit 12, Level 10
Municipal: 1115
Suite Type: B604
Project/Phase: Petaluma Building Corp./1

Layout Changes: ☐ Yes ☒ No Sketch Attached: ☒ Yes ☐ No Exterior Colour Scheme:

1. Kitchen and Vanities

	Style and Colour	Counter	Hardware
Kitchen / Breakfast	SEE BELOW	QUARTZ-TORRONE-STRAIGHT POLISHED EDGE	STD
Main Bath	DORAL 1267-SAND MOLINA ASH	QUARTZ-TORRONE-STRAIGHT POLISHED EDGE	STD
Master Ensuite Bathroom	N/A	N/A	N/A

Appliances: Built In Appliances ☒ Yes ☐ No 41" Upper Cabinets ☒ Yes ☐ No Slide In Stove ☐ Yes ☒ No

Comment

KITCHEN- CABINETRY - BASE DORAL 1267-SAND MOLINA ASH *** UPPERS - SENOSAN WHITE

2. Flooring

		Grout-If App.	At a 45
Entrance Vestibule	STRIP-MIRAGE-LOCK-RED OAK-CASHMERE-RIO-4 5/16"		<input type="checkbox"/>
Main Hall	STRIP-MIRAGE-LOCK-RED OAK-CASHMERE-RIO-4 5/16"		<input type="checkbox"/>
Kitchen / Breakfast	STRIP-MIRAGE-LOCK-RED OAK-CASHMERE-RIO-4 5/16"		<input type="checkbox"/>
Laundry Room	TILE-ASPEN BIANCO-12X24	STANDARD	<input type="checkbox"/>
Main Bath	TILE-ASPEN BIANCO-12X24	STANDARD	<input type="checkbox"/>
Master Ensuite Bathroom	N/A		<input type="checkbox"/>
	N/A		<input type="checkbox"/>
Living Room	STRIP-MIRAGE-LOCK-RED OAK-CASHMERE-RIO-4 5/16"		<input type="checkbox"/>
Dining Room	STRIP-MIRAGE-LOCK-RED OAK-CASHMERE-RIO-4 5/16"		<input type="checkbox"/>
Den / Library / Study	N/A		<input type="checkbox"/>
Master Bedroom	STRIP-MIRAGE-LOCK-RED OAK-CASHMERE-RIO-4 5/16"		<input type="checkbox"/>
Bedroom #2	N/A		<input type="checkbox"/>
Bedroom #3	N/A		<input type="checkbox"/>
			<input type="checkbox"/>

Comment

3. Wall Tile

	Selection	Grout	Describe
Main Bath			
Tub Deck Wall	N/A		
Shower Stall	TILE-GLOSSY WHITE-3X6	STANDARD	
Bathtub Enclosure Walls	N/A		
Master Ensuite Bathroom			
Tub Deck Wall	N/A		
Shower Stall	N/A		
Bathtub Enclosure Walls	N/A		
Kitchen Backsplash	BACK PAINTED GLASS-BM-#OC-16	STANDARD	
Backsplash Behind Fridge	N/A		

Comment

** Refer to Construction Summary

4. Misc

Water Line for Fridge N/A
Interior Door Handles AS PER CONSTRUCTION SPECS
Ceramic Bathroom Accessories NO - UPGRADED - MOEN MASON ☐ Yes ☒ No

Comment

Purchaser: Kashif REHMAN
Telephone Res. / Bus: / (416) 670-6377
Decor Advisor: Candace Forza
Lock Date: 10/30/2018 14:59:02

Const. No.: Unit 12, Level 10
Municipal: 1115
Suite Type: B604
Project/Phase: Petaluma Building Corp./1

5. Plaster Mouldings and Medallions

Entrance Vestibule	N/A		Living Room	N/A	
Main Hall	N/A		Dining Room	N/A	
Kitchen/Breakfast	N/A		Den / Library /Study	N/A	
Laundry Room	N/A		Master Bedroom	N/A	
Main Bath	N/A		BedRoom #2	N/A	
Master Ensuite Bathroom	N/A		BedRoom #3	N/A	
	N/A				

Comment

** Refer to Construction Summary

6. Wall Paint

Entrance Vestibule	43 - BIRCH WHITE	Living Room	43 - BIRCH WHITE
Main Hall	43 - BIRCH WHITE	Dining Room	43 - BIRCH WHITE
Kitchen / Breakfast	43 - BIRCH WHITE	Den/Library	N/A
Laundry Room	43 - BIRCH WHITE	Master Bedroom	43 - BIRCH WHITE
Main Bath	43 - BIRCH WHITE	Bedroom #2	N/A
Master Ensuite	N/A	Bedroom #3	N/A
	N/A		

Comment

7. General Comments

** Refer to Construction Summary

Disclaimers and Notes

- Colours of all materials are as close as possible to builder's selection, but not necessarily identical due to variances in manufacturing.
- Any extras listed above are null and void unless accompanied by a separate invoice/amendment. Said invoice must be paid in full.
- The Purchaser agrees that this colour selection is final and that no changes will be permitted, unless required by the Vendor.
- The Purchaser acknowledges reading and accepting document which contains other miscellaneous disclaimers.

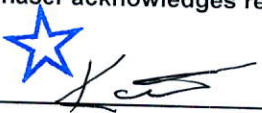
Signature:  Date: Oct. 30, 2018 Signature: _____ Date: _____

Mason™

Traditional | Transitional | Modern

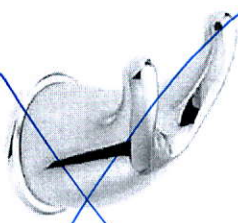

Double Robe Hook
Model YB8003

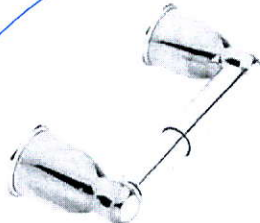

Paper Holder
Model YB8099 / YB8000
Chrome

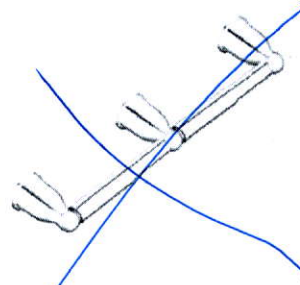

Double Paper Holder
Model YB8088
Not available in BC



Towel Ring
Model YB8086
Chrome

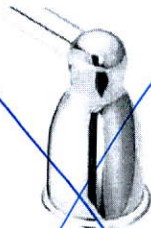

18" Towel Bar
Model YB8098 / YB8000

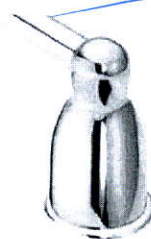

24" Towel Bar
Model YB8094 / YB8000
Chrome

PRO-FIT™
INSTALLATION SYSTEM

FINISH OPTIONS:

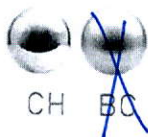

To order, combine the model number with one of these finish letter(s):
Chrome (CH) & Brushed Chrome (BC).

SCHEDULE 'A'

330

RICHMOND

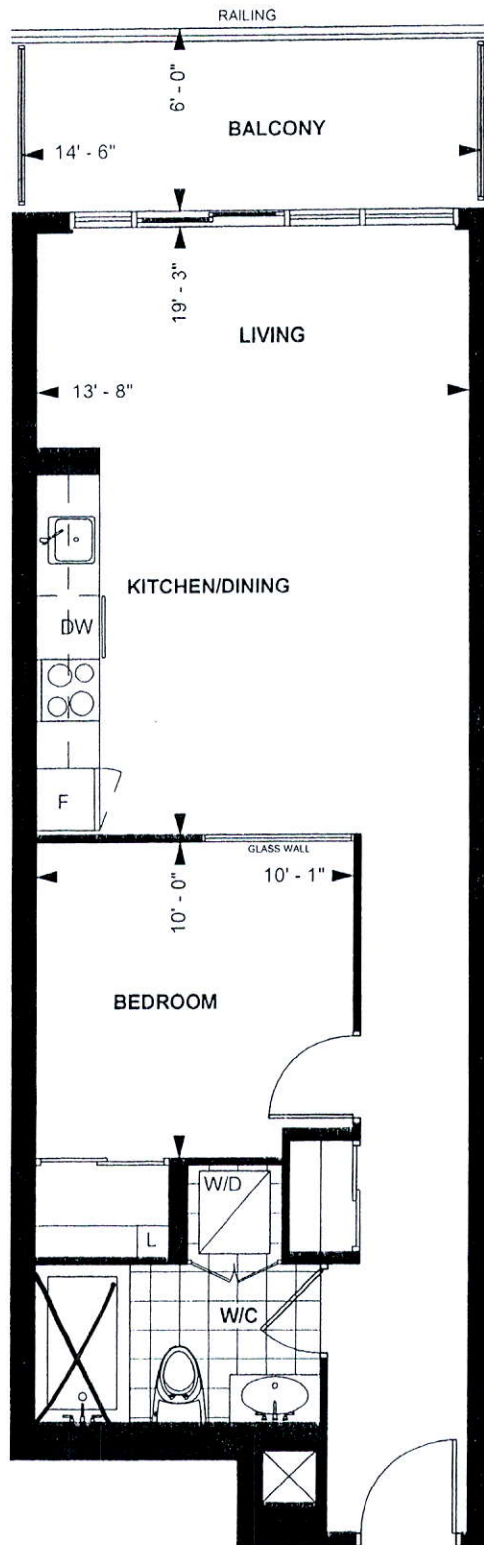

5' Shower
In Lieu of
Tub

KA

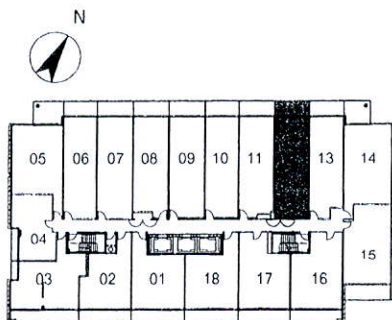

LEVEL 10

TOWER SUITE

B 604

8' CEILING *

604 sq. ft.

1-BEDROOM

Purchaser Initials Purchaser Initials

Date

Unit No. 12 Level No. 10 Suite No. 1115

Dimensions, specification, tile floor pattern and architectural detailing (including window size and location) are approximate and subject to modifications without notice. Orientation of suite may vary from the stated floor area.

*Ceiling height measured from top of floor slab to underside of slab above before finishes, and excluding bulkheads and required drop ceilings. E.&O.E.

41" upper
Cabinetry

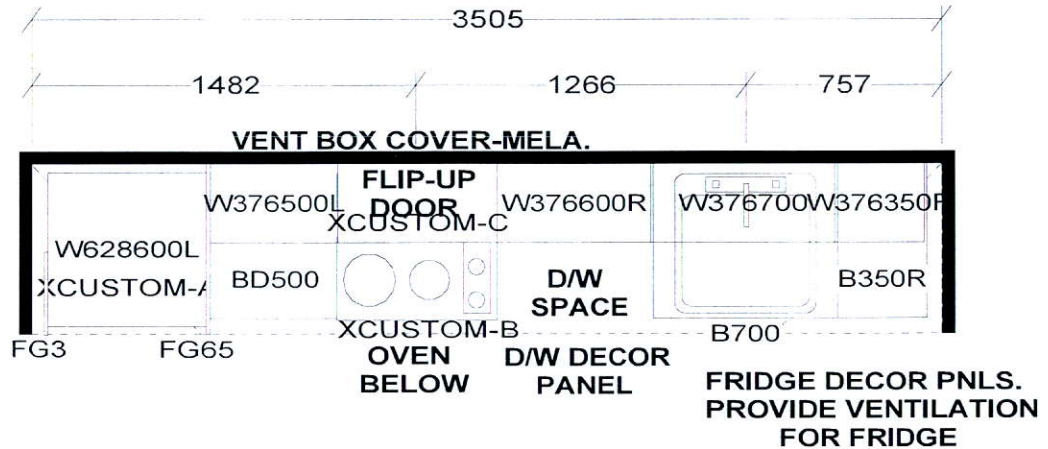

KITCHEN

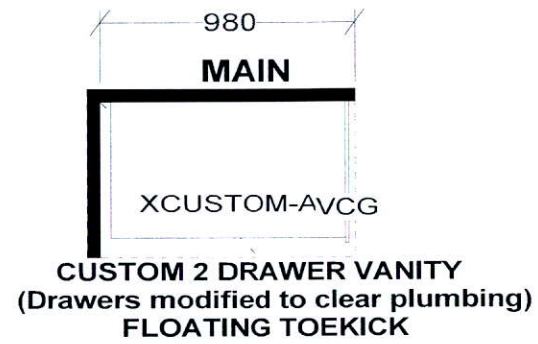

KITCHEN BASES & VANITIES INSTALLED
WITH ADJUSTABLE LEGS

- APPLIANCE PACKAGE:
- 24" INTEGRATED FRIDGE W/ DECOR PNLS
 - 24" INTEGRATED DISHWASHER W/ DECOR PNL
 - 24" BUILT-IN OVEN
 - 24" COOKTOP
 - 24" MICROWAVE HOOD FAN

Selba Industries

WIDTH	W	HGHT	W	CNT	FL	HGHT	DWY	H	ST	CENT	2X4	VENT BOX COVER
TOWER SUITES: 760MM HIGH UPPER CABINETS WHITE STEEL DRAWER BOXES COUNTERTOPS BY OTHERS VENT BOX COVERS CUSTOM VANITIES					This drawing is the intellectual property of SELBA INDUSTRIES INC. and is an original design which must not be released or copied unless applicable fee has been paid or job order placed.					JOB NUMBER: BUILDER: GREENPARK SITE NAME: PETALUMA MODEL: 1 BEDROOM - B 544, B 604 LOT #: DESIGNER: KS DATE: JAN 8 18		

KA