



PURCHASER: Yuet Ping TUNG

CONSTRUCTION SUMMARY
330 Richmond - Petaluma Building Corp.

TEL: RES.: 647-802-8329

Unit 7, Level 4 (508-1)

Floor Plan
B635

CABINETRY

1 - KITCHEN - 41" UPPER CABINETRY
07Sep18 Note:

This Document is Extremely Time Sensitive - Printed 7 Sep 18 at 10:51

RECEIVED SEP 13 2018

Purchaser: Yuet Ping TUNG
Telephone Res. / Bus: (647) 802-8329 /
Decor Advisor: Candace Forza
Lock Date: 9/7/2018 10:50:36

Const. No.: Unit 7, Level 4
Municipal: 508
Suite Type: B635
Project/Phase: Petaluma Building Corp./1

Layout Changes: ☐ Yes ☒ No Sketch Attached: ☒ Yes ☐ No Exterior Colour Scheme:

1. Kitchen and Vanities

| | Style and Colour | Counter | Hardware |
|-------------------------|---------------------------|--------------------------------------|----------|
| Kitchen / Breakfast | SEE BELOW | QUARTZ-AMIATA-STRAIGHT POLISHED EDGE | STD |
| Main Bath | DORAL #3081 HACIENA BLACK | QUARTZ-AMIATA-STRAIGHT POLISHED EDGE | STD |
| Master Ensuite Bathroom | N/A | N/A | N/A |

Appliances: Built In Appliances ☒ Yes ☐ No 41" Upper Cabinets ☒ Yes ☐ No Slide In Stove ☐ Yes ☒ No

Comment
KITCHEN - CABINETRY - BASE DORAL #3081 HACIENA BLACK *** UPPERS SENOSAN LIGHT GREY
H3081

2. Flooring

| | | Grout-If App. | At a 45 |
|-------------------------|---|---------------|---------|
| Entrance Vestibule | STRIP-MIRAGE-LOCK-RED OAK-CASHMERE-GRAPHITE-4 5/16" | | |
| Main Hall | STRIP-MIRAGE-LOCK-RED OAK-CASHMERE-GRAPHITE-4 5/16" | | |
| Kitchen / Breakfast | STRIP-MIRAGE-LOCK-RED OAK-CASHMERE-GRAPHITE-4 5/16" | | |
| Laundry Room | TILE-LIFE ICE - 12X24 - | STANDARD | |
| Main Bath | TILE-LIFE ICE - 12X24 - | STANDARD | |
| Master Ensuite Bathroom | N/A | | |
| | N/A | | |
| Living Room | STRIP-MIRAGE-LOCK-RED OAK-CASHMERE-GRAPHITE-4 5/16" | | |
| Dining Room | STRIP-MIRAGE-LOCK-RED OAK-CASHMERE-GRAPHITE-4 5/16" | | |
| Den / Library / Study | N/A | | |
| Master Bedroom | STRIP-MIRAGE-LOCK-RED OAK-CASHMERE-GRAPHITE-4 5/16" | | |
| Bedroom #2 | N/A | | |
| Bedroom #3 | N/A | | |

Comment

3. Wall Tile

| | Selection | Grout | Describe |
|--------------------------|--------------------------------|----------|----------|
| Main Bath | | | |
| | Tub Deck Wall N/A | | |
| | Shower Stall N/A | | |
| Bathtub Enclosure Walls | TILE-GLOSSY WHITE-3X6 | STANDARD | |
| Master Ensuite Bathroom | | | |
| | Tub Deck Wall N/A | | |
| | Shower Stall N/A | | |
| Bathtub Enclosure Walls | N/A | | |
| Kitchen Backsplash | BACK PAINTED GLASS-BM- #HC-170 | STANDARD | |
| Backsplash Behind Fridge | N/A | | |

Comment
** Refer to Construction Summary

4. Misc

| | |
|-----------------------|---------------------------|
| Water Line for Fridge | N/A |
| Interior Door Handles | AS PER CONSTRUCTION SPECS |
| Fireplace | N/A |

Comment ☐ Yes ☒ No

Purchaser: Yuet Ping TUNG
Telephone Res. / Bus: (647) 802-8329 /
Decor Advisor: Candace Forza
Lock Date: 9/7/2018 10:50:36

Const. No.: Unit 7, Level 4
Municipal: 508
Suite Type: B635
Project/Phase: Petaluma Building Corp./1

5. Plaster Mouldings and Medallions

| | | | |
|-------------------------|-----|----------------------|-----|
| Entrance Vestibule | N/A | Living Room | N/A |
| Main Hall | N/A | Dining Room | N/A |
| Kitchen/Breakfast | N/A | Den / Library /Study | N/A |
| Laundry Room | N/A | Master Bedroom | N/A |
| Main Bath | N/A | BedRoom #2 | N/A |
| Master Ensuite Bathroom | N/A | BedRoom #3 | N/A |

Comment

** Refer to Construction Summary

6. Wall Paint

| | | | |
|---------------------|----------------|----------------|----------------|
| Entrance Vestibule | 43 BIRCH WHITE | Living Room | 43 BIRCH WHITE |
| Main Hall | 43 BIRCH WHITE | Dining Room | 43 BIRCH WHITE |
| Kitchen / Breakfast | 43 BIRCH WHITE | Den/Library | N/A |
| Laundry Room | 43 BIRCH WHITE | Master Bedroom | 43 BIRCH WHITE |
| Main Bath | 43 BIRCH WHITE | Bedroom #2 | N/A |
| Master Ensuite | N/A | Bedroom #3 | N/A |
| | N/A | | |

Comment

7. General Comments

** Refer to Construction Summary

Install Standard Ceramic Bath Accessories .

Disclaimers and Notes

- 1) Colours of all materials are as close as possible to builder's selection, but not necessarily identical due to variances in manufacturing.
- 2) Any extras listed above are null and void unless accompanied by a separate invoice/amendment. Said invoice must be paid in full.
- 3) The Purchaser agrees that this colour selection is final and that no changes will be permitted, unless required by the Vendor.
- 4) The Purchaser acknowledges reading and accepting document which contains other miscellaneous disclaimers.

Signature:  Date: 2018-09-07 Signature: _____ Date: _____

SCHEDULE 'A'

330

RICHMOND

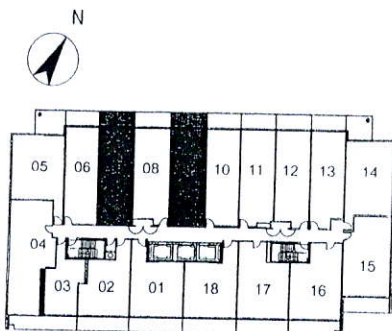
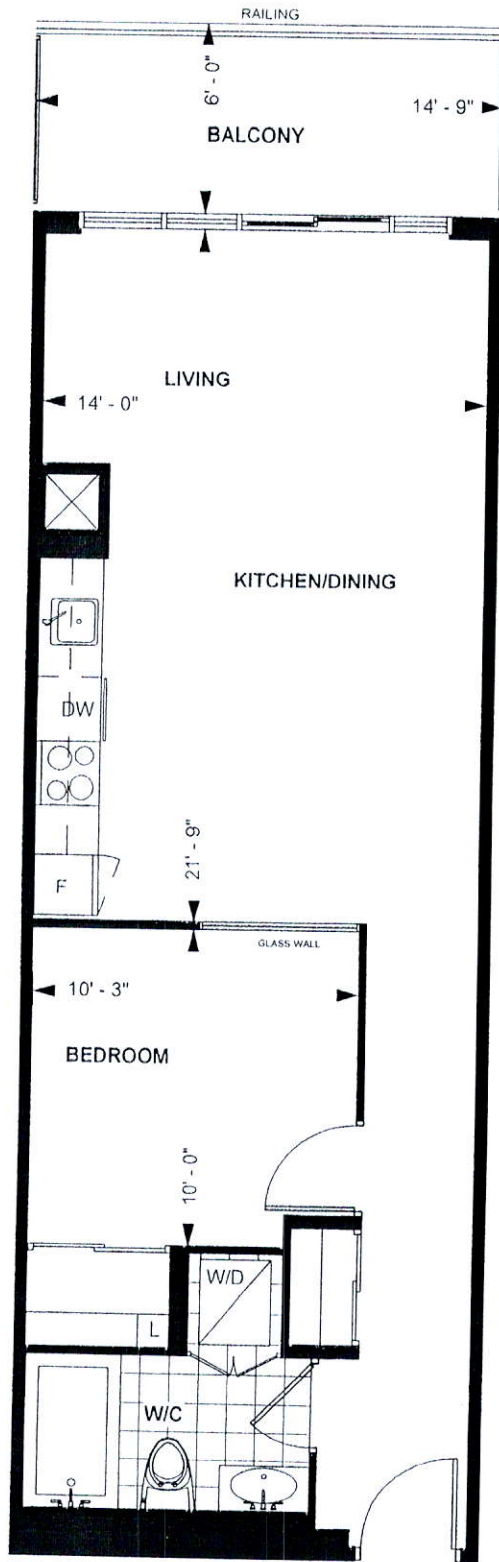

LEVEL 4

TOWER SUITE

B 635

9' CEILING *

635 sq. ft.

1-BEDROOM

Purchaser Initials Y.P. Purchaser Initials 2-1-2016

Date

Unit No. 7 Level No. 4 Suite No. 508

Dimensions, specification, tile floor pattern and architectural detailing (including window size and location) are approximate and subject to modifications without notice. Orientation of suite may vary from the stated floor area.

*Ceiling height measured from top of floor slab to underside of slab above before finishes, and excluding bulkheads and required drop ceilings E & O E

Y.P.

41" Upper
Cabinetry

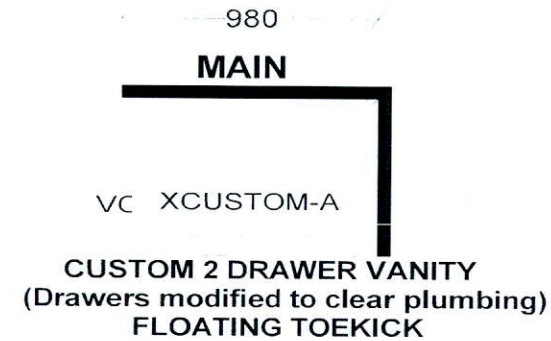
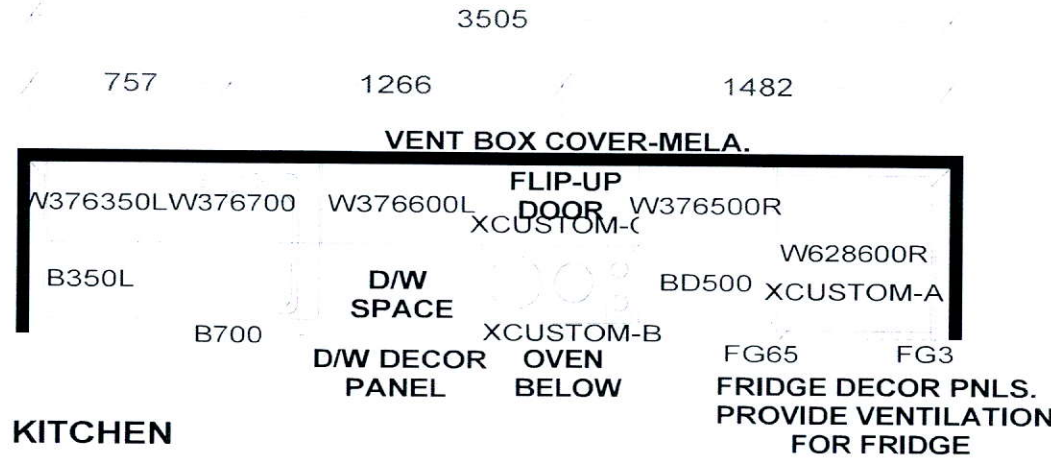

KITCHEN BASES & VANITIES INSTALLED
WITH ADJUSTABLE LEGS

APPLIANCE PACKAGE:
24" INTEGRATED FRIDGE W/ DECOR PNLS
24" INTEGRATED DISHWASHER W/ DECOR PNL
24" BUILT-IN OVEN
24" COOKTOP
24" MICROWAVE HOOD FAN

Selba Industries

WDTH _____ W HGHT _____ W CNT _____ FL HGHT _____ DWY H _____ ST CENT _____ 2X4 _____ VENT BOX COVER _____

TOWER SUITES:
760MM HIGH UPPER CABINETS
WHITE STEEL DRAWER BOXES
COUNTERTOPS BY OTHERS
VENT BOX COVERS
CUSTOM VANITIES

This drawing is the intellectual property of
SELBA INDUSTRIES INC. and is an
original design which must not be released
or copied unless applicable fee has been
paid or job order placed.



JOB NUMBER:
BUILDER: GREENPARK
SITE NAME: PETALUMA
MODEL: 1 BEDROOM-B 592, B 609, B 635
LOT #:
DESIGNER: KS
DATE: JAN 8 18

ty