



CONSTRUCTION SUMMARY
330 Richmond - Petaluma Building Corp.

PURCHASER: Ginna P. CASTRO CUERVO TEL: RES.: 416-768-4499

Unit 11, Level 4 (512-1)	Floor Plan B609		
--------------------------	--------------------	--	--

CABINETRY

1 - KITCHEN- ADD CUSTOM ISLAND- AS PER SKETCH 05Oct18 Note:	
1 - KITCHEN- 41" UPPER CABINETS 05Oct18 Note:	

CONSTRUCTION

1 - SMOOTH CEILING IN BEDROOM 05Oct18 Note:	
--	--

COUNTER TOP

1 - KITCHEN - UPGRADE COUNTERTOP EDGE- INCLUDING ISLAND 05Oct18 Note:	
--	--

HARDWOOD FLOORING

1 - UPGRADE HARDWOOD TO GROUP A MAPLE THROUGHTOUT 05Oct18 Note:	
--	--

This Document is Extremely Time Sensitive - Printed 5 Oct 18 at 11:25

RECEIVED OCT 11 2018

Purchaser: Ginna P. CASTRO CUERVO
Telephone Res. / Bus: (416) 768-4499 /
Decor Advisor: Natalie Mancuso
Lock Date: 10/5/2018 11:25:21

Const. No.: Unit 11, Level 4
Municipal: 512
Suite Type: B609
Project/Phase: Petaluma Building Corp./1

Layout Changes: ☐ Yes ☒ No Sketch Attached: ☒ Yes ☐ No Exterior Colour Scheme:

1. Kitchen and Vanities

	Style and Colour	Counter	Hardware
Kitchen / Breakfast	SEE BELOW	QUARTZ- TORRONE-#360 PENCIL EDGE	STD
Main Bath	DORAL H3078 HACIENDA WHITE	QUARTZ- TORRONE- STRAIGHT POL EDGE	STD
Master Ensuite Bathroom			

Appliances: Built In Appliances ☒ Yes ☐ No 41" Upper Cabinets ☒ Yes ☐ No Slide In Stove ☐ Yes ☒ No

Comment

KITCHEN UPPER CABINETS- SENOSAN WHITE
KITCHEN BASE CABINETS AND ISLAND- DORAL H3078 HACIENDA WHITE

2. Flooring

		Grout-If App.	At a 45
Entrance Vestibule	HARDWOOD- MIRAGE 4 5/16 LOCK MAPLE- PLATINUM- CASHMERE		<input type="checkbox"/>
Main Hall	HARDWOOD- MIRAGE 4 5/16 LOCK MAPLE- PLATINUM- CASHMERE		<input type="checkbox"/>
Kitchen / Breakfast	HARDWOOD- MIRAGE 4 5/16 LOCK MAPLE- PLATINUM- CASHMERE		<input type="checkbox"/>
Laundry Room	TILE- LIFE SILVER 12X24	STD	<input type="checkbox"/>
Main Bath	TILE- LIFE SILVER 12X24	STD	<input type="checkbox"/>
Master Ensuite Bathroom			<input type="checkbox"/>
Living Room	HARDWOOD- MIRAGE 4 5/16 LOCK MAPLE- PLATINUM- CASHMERE		<input type="checkbox"/>
Dining Room	HARDWOOD- MIRAGE 4 5/16 LOCK MAPLE- PLATINUM- CASHMERE		<input type="checkbox"/>
Den / Library / Study			<input type="checkbox"/>
Master Bedroom	HARDWOOD- MIRAGE 4 5/16 LOCK MAPLE- PLATINUM- CASHMERE		<input type="checkbox"/>
Bedroom #2			<input type="checkbox"/>
Bedroom #3			<input type="checkbox"/>

Comment

3. Wall Tile

	Selection	Grout	Describe
Main Bath			
Tub Deck Wall			
Shower Stall			
Bathtub Enclosure Walls	TILE- GLOSSY WHITE 3X6	STD	
Master Ensuite Bathroom			
Tub Deck Wall			
Shower Stall			
Bathtub Enclosure Walls			
Kitchen Backsplash	PAINTED GLASS- BM OC-16		
Backsplash Behind Fridge			

Comment

** Refer to Construction Summary

4. Misc

Water Line for Fridge NO
Interior Door Handles STANDARD
Ceramic Bathroom Accessories DELETE STANDARD - DO NOT INSTALL ☐ Yes ☒ No
Comment

Purchaser: Ginna P. CASTRO CUERVO
Telephone Res. / Bus: (416) 768-4499 /
Decor Advisor: Natalie Mancuso
Lock Date: 10/5/2018 11:25:21

Const. No.: Unit 11, Level 4
Municipal: 512
Suite Type: B609
Project/Phase: Petaluma Building Corp./1

5. Plaster Mouldings and Medallions

Entrance Vestibule		Living Room	
Main Hall		Dining Room	
Kitchen/Breakfast		Den / Library /Study	
Laundry Room		Master BedRoom	
Main Bath		BedRoom #2	
Master Ensuite Bathroom		BedRoom #3	

Comment
** Refer to Construction Summary

6. Wall Paint

Entrance Vestibule	BIRCH WHITE	Living Room	BIRCH WHITE
Main Hall	BIRCH WHITE	Dining Room	BIRCH WHITE
Kitchen / Breakfast	BIRCH WHITE	Den/Library	
Laundry Room	BIRCH WHITE	Master Bedroom	BIRCH WHITE
Main Bath	BIRCH WHITE	Bedroom #2	
Master Ensuite		Bedroom #3	

Comment

7. General Comments

** Refer to Construction Summary

Disclaimers and Notes

- 1) Colours of all materials are as close as possible to builder's selection, but not necessarily identical due to variances in manufacturing.
- 2) Any extras listed above are null and void unless accompanied by a separate invoice/amendment. Said invoice must be paid in full.
- 3) The Purchaser agrees that this colour selection is final and that no changes will be permitted, unless required by the Vendor.
- 4) The Purchaser acknowledges reading and accepting document which contains other miscellaneous disclaimers.

Signature: Ginna Castro Date: Oct 5/18 Signature: _____ Date: _____

Initial: GC Page 2 of 2

SCHEDULE 'A'

330
RICHMOND

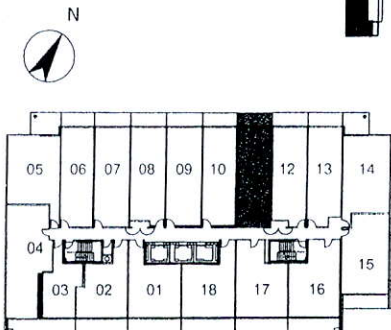
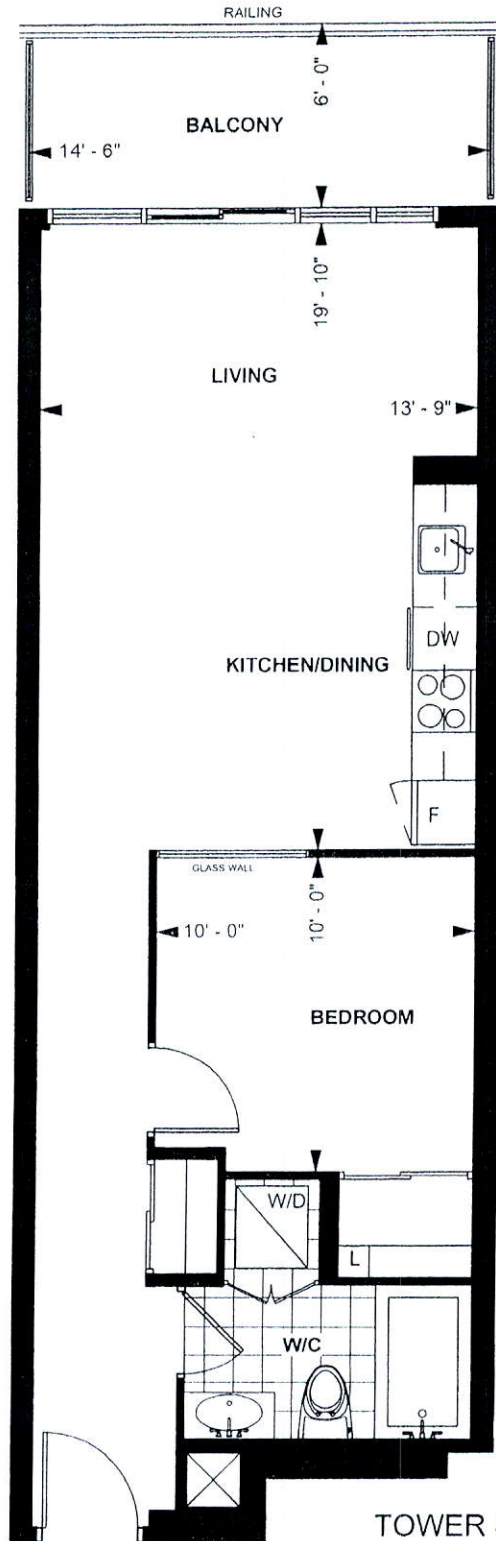

LEVEL 4

TOWER SUITE

B 609

9' CEILING *

609 sq. ft.

1-BEDROOM

CPE _____ *Feb 27/16*
Purchaser Initials Purchaser Initials Date

Unit No. 11 Level No. 4 Suite No. 512

Dimensions, specification, tile floor pattern and architectural detailing (including window size and location) are approximate and subject to modifications without notice. Orientation of suite may vary from the stated floor area.

*Ceiling height measured from top of floor slab to underside of slab above before finishes, and excluding bulkheads and required drop ceilings. E.&O.E.

FILE NAME:
GLOSS CONDO 512

SEP 27 18 FB
REV OCT 5 18 PB

330 RICHMOND UNI. 512
PROTOTYPE FOR EXTRA

THIS LAYOUT CONTAINS EXTRAS
THAT ARE NOT PART OF CONTRACT

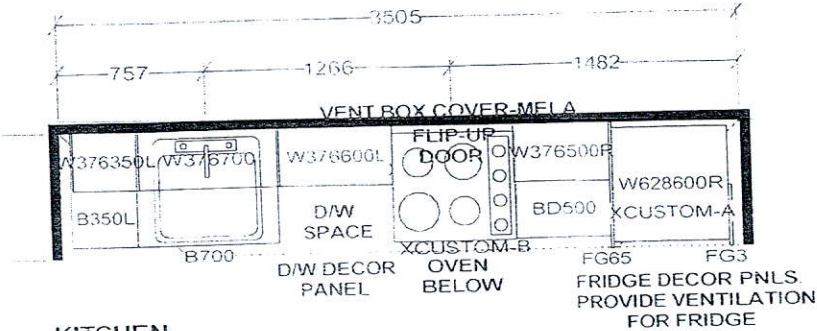

KITCHEN BASES & VANITIES INSTALLED
WITH ADJUSTABLE LEGS

KITCHEN

- up. counter Edge
- 41" uppers

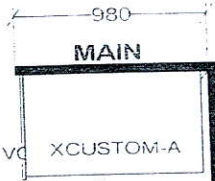
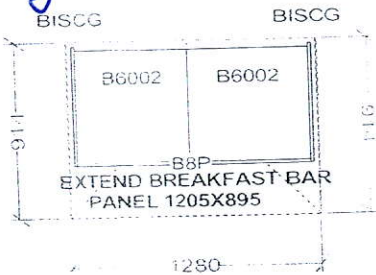

CUSTOM 2 DRAWER VANITY
(Drawers modified to clear plumbing)
FLOATING TOEKICK

APPLIANCE PACKAGE:
24" INTEGRATED FRIDGE W/ DECOR PNLS
24" INTEGRATED DISHWASHER W/ DECOR PNL
24" BUILT-IN OVEN
24" COOKTOP
24" MICROWAVE HOOD FAN

Selba Industries

W WDTH	W HGHT	W CNT	FL HGHT	DWY H	ST CENT	2X4	VENT BOX COVER
TOWER SUITES: 760MM HIGH UPPER CABINETS WHITE STEEL DRAWER BOXES COUNTERTOPS BY OTHERS VENT BOX COVERS CUSTOM VANITIES				This drawing is the intellectual property of SELBA INDUSTRIES INC. and is an original design which must not be released or copied unless applicable fee has been paid or job order placed.			JOB NUMBER: BUILDER: GREENPARK SITE NAME: PETALUMA MODE 512 ROOM-B 592, B 609, B 635 LOT # DESIGNER: KS DATE: JAN 8 18