



CONSTRUCTION SUMMARY
330 Richmond - Petaluma Building Corp.

PURCHASERS: Sammy TITA FOMBANG and Naomi Michele PETERS-TITA TEL: RES.: 647-505-0715 BUS.: 905-551-1924

Unit 14, Level 4 (517-1)	Floor Plan D711		
--------------------------	--------------------	--	--

CABINETRY

1 - KITCHEN - 41" UPPER CABINETRY 24Sep18 Note:	
---	--

CERAMIC TILE

1 - BATHROOM - DELETE STANDARD WHITE CERAMIC ACCESSORIES - DO NOT INSTALL SOAP DISH, TOWEL RACK OR TISSUE HOLDER 24Sep18 Note:	
--	--

CONSTRUCTION

1 - BEDROOM - SMOOTH CEILING 24Sep18 Note:	
--	--

MISCELLANEOUS

1 - ADMINISTRATION FEE FOR COLOUR CHANGES 24Sep18 Note:	
---	--

PLUMBING

3 - BATHROOM - MOEN MASON CHROME ACCESSORIES - TOWEL RING, 24" TOWEL BAR AND TOILET PAPER HOLDER 24Sep18 Note:	
--	--

This Document is Extremely Time Sensitive - Printed 24 Sep 18 at 17:23

RECEIVED OCT 01 2018

Purchasers: Sammy TITA FOMBANG & Naomi Michele PETEI

Const. No.: Unit 14, Level 4

Telephone Res. / Bus: (647) 505-0715 / (905) 551-1924

Municipal: 517

Decor Advisor: Candace Forza

Suite Type: D711

Lock Date: 9/24/2018 17:23:46

Project/Phase: Petaluma Building Corp./1

Layout Changes: ☐ Yes ☒ No

Sketch Attached: ☒ Yes ☐ No

Exterior Colour Scheme:

1. Kitchen and Vanities

	Style and Colour	Counter	Hardware
Kitchen / Breakfast	SEE BELOW	QUARTZ-TORRONE-STRAIGHT POLISHED EDGE	STD
Main Bath	DORAL 1267 - SAND MOLIA ASH	QUARTZ-TORRONE-STRAIGHT POLISHED EDGE	STD
Master Ensuite Bathroom	N/A	N/A	N/A

Appliances:

Built In Appliances ☒ Yes ☐ No

41" Upper Cabinets ☒ Yes ☐ No

Slide In Stove ☐ Yes ☒ No

Comment

KITCHEN CABINETRY - BASE DORAL 1267 - SAND MOLIA ASH *** UPPERS - SENOSAN WHITE

2. Flooring

		Grout-If App.	At a 45
Entrance Vestibule	STRIP-MIRAGE-LOCK-RED OAK-CASHMERE-RIO-4 5/16"		<input type="checkbox"/>
Main Hall	STRIP-MIRAGE-LOCK-RED OAK-CASHMERE-RIO-4 5/16"		<input type="checkbox"/>
Kitchen / Breakfast	STRIP-MIRAGE-LOCK-RED OAK-CASHMERE-RIO-4 5/16"		<input type="checkbox"/>
Laundry Room	TILE-WHITE-8X8	STANDARD	<input type="checkbox"/>
Main Bath	TILE-ASPEN BIANCO-12X24	STANDARD	<input type="checkbox"/>
Master Ensuite Bathroom	N/A		<input type="checkbox"/>
	N/A		<input type="checkbox"/>
Living Room	STRIP-MIRAGE-LOCK-RED OAK-CASHMERE-RIO-4 5/16"		<input type="checkbox"/>
Dining Room	N/A		<input type="checkbox"/>
Den / Library / Study	STRIP-MIRAGE-LOCK-RED OAK-CASHMERE-RIO-4 5/16"		<input type="checkbox"/>
Master Bedroom	STRIP-MIRAGE-LOCK-RED OAK-CASHMERE-RIO-4 5/16"		<input type="checkbox"/>
Bedroom #2	N/A		<input type="checkbox"/>
Bedroom #3	N/A		<input type="checkbox"/>
			<input type="checkbox"/>

Comment

3. Wall Tile

	Selection	Grout	Describe
Main Bath			
Tub Deck Wall	N/A		
Shower Stall	N/A		
Bathtub Enclosure Walls	TILE-GLOSSY WHITE-3X6	STANDARD	
Master Ensuite Bathroom			
Tub Deck Wall	N/A		
Shower Stall	N/A		
Bathtub Enclosure Walls	N/A		
Kitchen Backsplash	BACK PAINTED GLASS-BM-OC-16	STANDARD	
Backsplash Behind Fridge	N/A		

Comment

** Refer to Construction Summary

4. Misc

Water Line for Fridge

N/A

Interior Door Handles

AS PER CONSTRUCTION SPECS

Ceramic Bathroom Accessories

NO - UPGRADED - MOEN MASON

☐ Yes ☒ No

Comment

Purchasers:Sammy TITA FOMBANG & Naomi Michele PETEI

Const. No.:Unit 14, Level 4

Telephone Res. / Bus: (647) 505-0715 / (905) 551-1924

Municipal: 517

Decor Advisor: Candace Forza

Suite Type: D711

Lock Date: 9/24/2018 17:23:46

Project/Phase: Petaluma Building Corp./1

5. Plaster Mouldings and Medallions

Entrance Vestibule	N/A	N/A	Living Room	N/A	N/A
Main Hall	N/A	N/A	Dining Room	N/A	N/A
Kitchen/Breakfast	N/A	N/A	Den / Library /Study	N/A	N/A
Laundry Room	N/A	N/A	Master BedRoom	N/A	N/A
Main Bath	N/A	N/A	BedRoom #2	N/A	N/A
Master Ensuite Bathroom	N/A	N/A	BedRoom #3	N/A	

Comment

** Refer to Construction Summary

6. Wall Paint

Entrance Vestibule	43 BIRCH WHITE	Living Room	43 BIRCH WHITE
Main Hall	43 BIRCH WHITE	Dining Room	N/A
Kitchen / Breakfast	43 BIRCH WHITE	Den/Library	43 BIRCH WHITE
Laundry Room	43 BIRCH WHITE	Master Bedroom	43 BIRCH WHITE
Main Bath	43 BIRCH WHITE	Bedroom #2	N/A
Master Ensuite	N/A	Bedroom #3	N/A
	N/A		

Comment

7. General Comments

** Refer to Construction Summary

Disclaimers and Notes

- 1) Colours of all materials are as close as possible to builder's selection, but not necessarily identical due to variances in manufacturing.
- 2) Any extras listed above are null and void unless accompanied by a separate invoice/amendment. Said invoice must be paid in full.
- 3) The Purchaser agrees that this colour selection is final and that no changes will be permitted, unless required by the Vendor.
- 4) The Purchaser acknowledges reading and accepting document which contains other miscellaneous disclaimers.

Signature:_____Date:_____

Signature:_____Date:_____

Signature:_____Date:_____

Signature:_____Date:_____

Initials:_____

Mason™

Traditional | Transitional | Modern

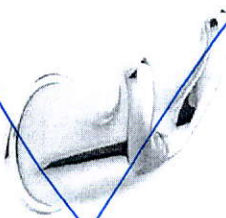

Double Robe Hook
Model YB8003

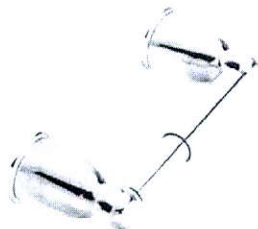

Paper Holder
Model YB8099 / YB8000
Chrome

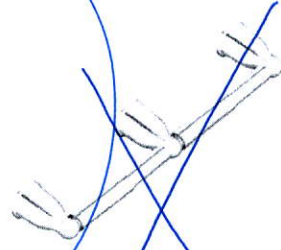

Double Paper Holder
Model YB8088
Not available in BC



Towel Ring
Model YB8086
Chrome

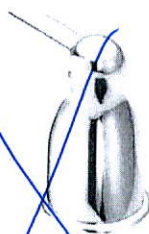

18" Towel Bar
Model YB8098 / YB8000



24" Towel Bar
Model YB8094 / YB8000
Chrome

PRO-FIT™
INSTALLATION SYSTEM

FINISH OPTIONS:

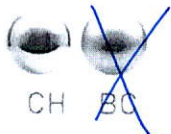

To order, combine the model number with one of these finish letter(s):
Chrome (CH) & Brushed Chrome (BC).

330

and the third and last of the three is the most important one: it is the one that is most likely to be the most important one.

RICHMOND

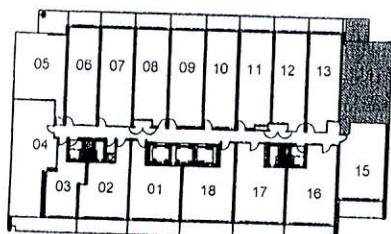

Dimensions, specification, tile floor pattern and architectural detailing (including window size and location) are approximate and subject to modifications without notice. Orientation of suite may vary from the stated floor area.

*Ceiling height measured from top of floor slab to underside of slab above before finishes, and excluding bulkheads and required drop ceilings. E & O E

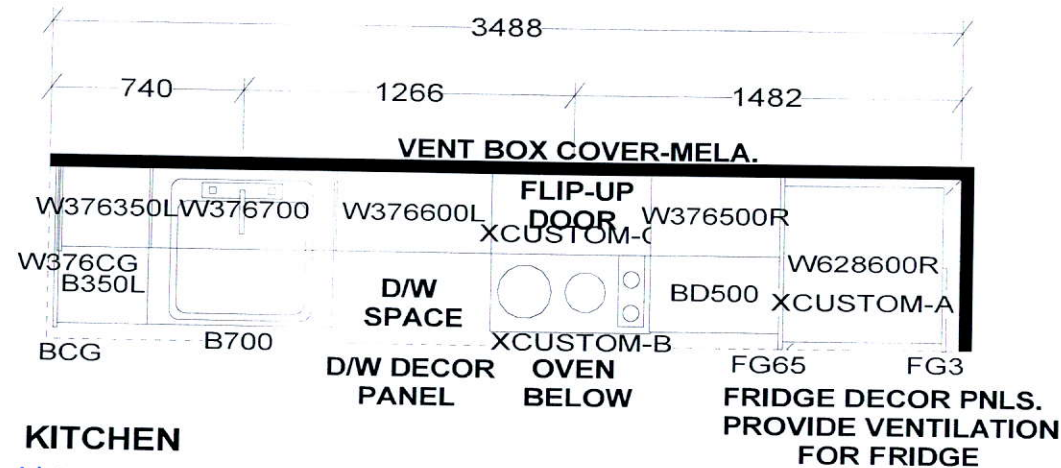

KITCHEN
4" uppers

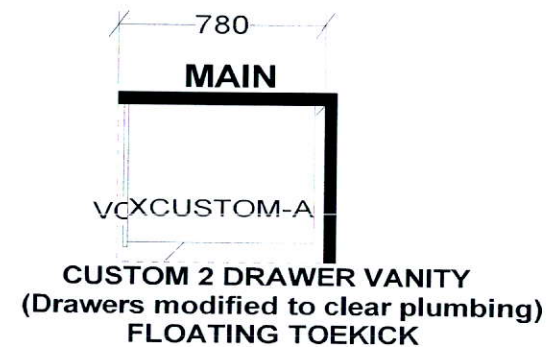

KITCHEN BASES & VANITIES INSTALLED WITH ADJUSTABLE LEGS

- APPLIANCE PACKAGE:**
 24" INTEGRATED FRIDGE W/ DECOR PNLS
 24" INTEGRATED DISHWASHER W/ DECOR PNL
 24" BUILT-IN OVEN
 24" COOKTOP
 24" MICROWAVE HOOD FAN

S e l b a I n d u s t r i e s

WDTH	W HGHT	W CNT	FL HGHT	DWY H	ST CENT	2X4	VENT BOX COVER
TOWER SUITES: 760MM HIGH UPPER CABINETS WHITE STEEL DRAWER BOXES COUNTERTOPS BY OTHERS VENT BOX COVERS CUSTOM VANITIES				<small>This drawing is the intellectual property of SELBA INDUSTRIES INC. and is an original design which must not be released or copied unless applicable fee has been paid or job order placed.</small>		JOB NUMBER: BUILDER: GREENPARK SITE NAME: PETALUMA MODEL: 1 BEDROOM + MEDIA - D 711 LOT #: DESIGNER: KS DATE: JAN 8 18	

