		CONSTRUCTION SUMMARY	
PURCHASER: Ping HUANG		330 Richmond - Petaluma Building Corp.	
		TEL: RES.: 416-726-4297	
Unit 3, Level 8 (903-1)	Floor Plan E771		

CABINETRY

1 - KITCHEN - 41" UPPER CABINETRY 02Nov18 Note:	
1 - KITCHEN CABINETRY - FARMER SINK PROVISION 02Nov18 Note:	

CERAMIC TILE

1 - BATHROOMS - DELETE STANDARD WHITE CERMAIC BATHROOM ACCESSORIES - DO NOT INSTALL SOAP DISH, TOWEL RACK OR TISSUE HOLDER 02Nov18 Note:	
---	--

CONSTRUCTION

2 - BEDROOMS - SMOOTH CEILINGS 02Nov18 Note:	
---	--

DOORS AND TRIM

2 - BEDROOM CLOSETS - SLIDING FRAMELESS MIRROR DOORS 02Nov18 Note: FRAMELESS MIRRIR SLIDER WITH MIRROR FASCIA	
---	--

ELECTRICAL

1 - MASTER ENSUITE BATHROOM - ADD PLUG BESIDE TOILET FOR FUTURE WASHLET - IF CONSTRUCTION PERMITS 02Nov18 Note:	
--	--

HARDWOOD FLOORING

1 - THROUGHOUT - STANDARD NON-TILED AREAS - UPGRADE 2 HARDWOOD FLOORING IN LIEU OF STANDARD AS PER OFFER 02Nov18 Note:	
---	--

PLUMBING

1 - KITCHEN - BLANCO QUATRUS R15 UT MEDIUM APRON UNDERMOUNT SINK - #401869 02Nov18 Note:	
2 - BATHROOMS - MOEN 90 DEGREE BATHROOM ACCESSORIES - CHROME TOILET PAPER HOLDER #YB8808 TOWEL RING #YB8886 TOWEL BAR #YB8824 02Nov18 Note:	

This Document is Extremely Time Sensitive - Printed 2 Nov 18 at 14:56

RECEIVED NOV 02 2018

Purchaser: Ping HUANG

Telephone Res. / Bus: (416) 726-4297 /

Decor Advisor: Candace Forza

Lock Date: 11/2/2018 11:13:45

Const. No.: Unit 3, Level 8

Municipal: 903

Suite Type: E771

Project/Phase: Petaluma Building Corp./1

Layout Changes: ☐ Yes ☒ No

Sketch Attached: ☒ Yes ☐ No

Exterior Colour Scheme:

1. Kitchen and Vanities	Style and Colour	Counter	Hardware
Kitchen / Breakfast	SEE BELOW	QUARTZ-TORRONE-STRAIGHT POLISGHED EDGE	STD
Main Bath	DORAL H3078- HACIENDA WHITE	QUARTZ-TORRONE-STRAIGHT POLISGHED EDGE	STD
Master Ensuite Bathroom	DORAL H3078- HACIENDA WHITE	QUARTZ-TORRONE-STRAIGHT POLISGHED EDGE	STD

Appliances:

Built In Appliances ☒ Yes ☐ No

41" Upper Cabinets ☒ Yes ☐ No

Slide In Stove ☐ Yes ☒ No

Comment

KITCHEN - CABINETRY - BASE DORAL H3078- HACIENDA WHITE *** UPPERS SENOSAN WHITE

2. Flooring		Grout-If App.	At a 45
Entrance Vestibule	STRIP-MIRAGE-LOCK-SWEET MEMORIES-RED OAK-CASHMERE-TREASURE-4 5/16"		
Main Hall	STRIP-MIRAGE-LOCK-SWEET MEMORIES-RED OAK-CASHMERE-TREASURE-4 5/16"		
Kitchen / Breakfast	STRIP-MIRAGE-LOCK-SWEET MEMORIES-RED OAK-CASHMERE-TREASURE-4 5/16"		
Laundry Room	TILE-WHITE-8X8	STANDARD	
Main Bath	TILE-LIFE SILVER-12X24	STANDARD	
Master Ensuite Bathroom	TILE-LIFE SILVER-12X24	STANDARD	
	N/A		
Living Room	STRIP-MIRAGE-LOCK-SWEET MEMORIES-RED OAK-CASHMERE-TREASURE-4 5/16"		
Dining Room	STRIP-MIRAGE-LOCK-SWEET MEMORIES-RED OAK-CASHMERE-TREASURE-4 5/16"		
Den / Library / Study	N/A		
Master Bedroom	STRIP-MIRAGE-LOCK-SWEET MEMORIES-RED OAK-CASHMERE-TREASURE-4 5/16"		
Bedroom #2	STRIP-MIRAGE-LOCK-SWEET MEMORIES-RED OAK-CASHMERE-TREASURE-4 5/16"		
Bedroom #3	N/A		

Comment

3. Wall Tile	Selection	Grout	Describe
Main Bath			
Tub Deck Wall	N/A		
Shower Stall	N/A		
Bathtub Enclosure Walls	TILE-GLOSSY WHITE-3X6	STANDARD	
Master Ensuite Bathroom			
Tub Deck Wall	N/A		
Shower Stall	N/A		
Bathtub Enclosure Walls	TILE-GLOSSY WHITE-3X6	STANDARD	
Kitchen Backsplash	BACK PAINTED GALSS-BM-#OC-16	STANDARD	
Backsplash Behind Fridge	N/A		

Comment

** Refer to Construction Summary

4. Misc	
Water Line for Fridge	N/A
Interior Door Handles	AS PER CONSTRUCTION SPECS
Ceramic Bathroom Accessories	NO - UPGRADED - MOEN 90 DEGREE <input type="radio"/> Yes <input checked="" type="radio"/> No
Comment	

Purchaser:

Ping HUANG

Telephone Res. / Bus:

(416) 726-4297 /

Decor Advisor:

Candace Forza

Lock Date:

11/2/2018 11:13:45

Const. No.:

Unit 3, Level 8

Municipal:

903

Suite Type:

E771

Project/Phase:

Petaluma Building Corp./1

5. Plaster Mouldings and Medallions

Entrance Vestibule	N/A		Living Room	N/A	
Main Hall	N/A		Dining Room	N/A	
Kitchen/Breakfast	N/A		Den / Library /Study	N/A	
Laundry Room	N/A		Master BedRoom	N/A	
Main Bath	N/A		BedRoom #2	N/A	
Master Ensuite Bathroom	N/A		BedRoom #3	N/A	

Comment

** Refer to Construction Summary

6. Wall Paint

Entrance Vestibule	43 - BIRCH WHITE	Living Room	43 - BIRCH WHITE
Main Hall	43 - BIRCH WHITE	Dining Room	43 - BIRCH WHITE
Kitchen / Breakfast	43 - BIRCH WHITE	Den/Library	N/A
Laundry Room	43 - BIRCH WHITE	Master Bedroom	43 - BIRCH WHITE
Main Bath	43 - BIRCH WHITE	Bedroom #2	43 - BIRCH WHITE
Master Ensuite	43 - BIRCH WHITE	Bedroom #3	N/A
	N/A		

Comment

7. General Comments

** Refer to Construction Summary

Disclaimers and Notes

- 1) Colours of all materials are as close as possible to builder's selection, but not necessarily identical due to variances in manufacturing.
- 2) Any extras listed above are null and void unless accompanied by a separate invoice/amendment. Said invoice must be paid in full.
- 3) The Purchaser agrees that this colour selection is final and that no changes will be permitted, unless required by the Vendor.
- 4) The Purchaser acknowledges reading and accepting document which contains other miscellaneous disclaimers.

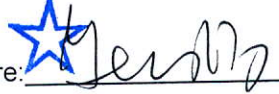
Signature: 

Date: NOV 2/18

Signature: _____

Date: _____

Product Specification Sheet

BLANCO QUATRUS R15 U 1 MEDIUM APRON

Satin brushed finish



PRODUCT DIMENSIONS

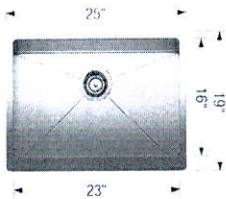

BLANCO	Colour Finish	Model No.	FEATURES / SPECIFICATIONS
QUATRUS R15 U 1			
MEDIUM APRON			
	Satin brushed finish	401869	<ul style="list-style-type: none">• German designed and engineered• Premium 304 series, 18 gauge stainless steel• 18/10 chrome-nickel content for exceptional lustre, durability and strength• Rear-positioned drain hole for maximum usable bowl and cabinet storage space• Compact size, X-pattern drain grooves• 15 mm radius corners for easy cleaning• 3 1/2" (90mm) stainless steel strainer included• Clips included• Limited Lifetime Warranty
DESIGN AND PLANNING TIPS			
Cabinet Size: 27" (685 mm)			
Bowl depth: 9" (230 mm)			
Depending on cabinet construction, a different cabinet size may be required.			
Consult the cabinet manufacturer.			

WARRANTY

Limited Lifetime warranty

Code/Standards Compliance

BLANCO sinks and faucets are third-party tested and certified to CSA, cUPC, ANSI/ASME and NSF standards and listed by applicable certification bodies. For more information on individual product listings, contact our office or listing organization.

90°™

Traditional | Transitional | Modern

Geometric forms, squared corners and straight lines create an urban focal point for today's contemporary baths.

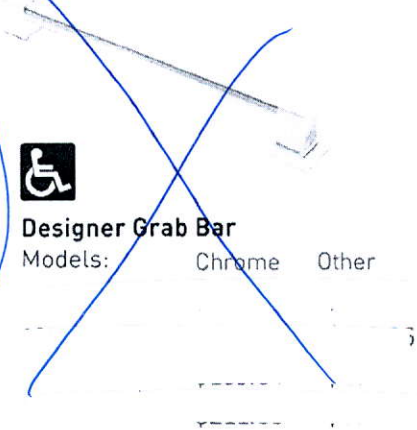
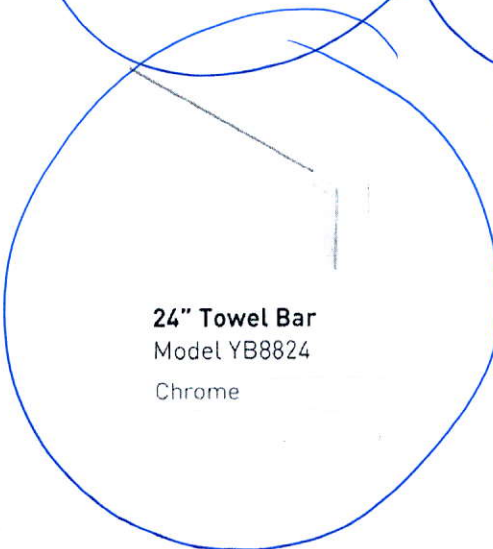
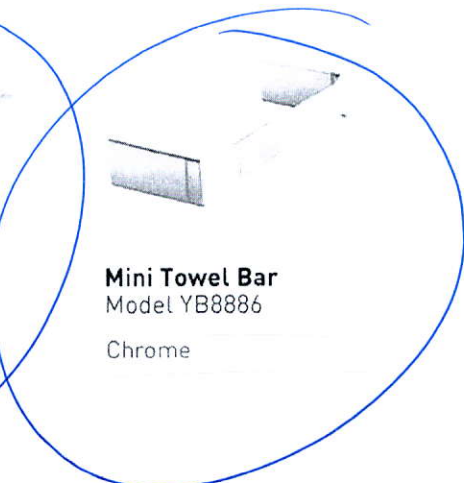
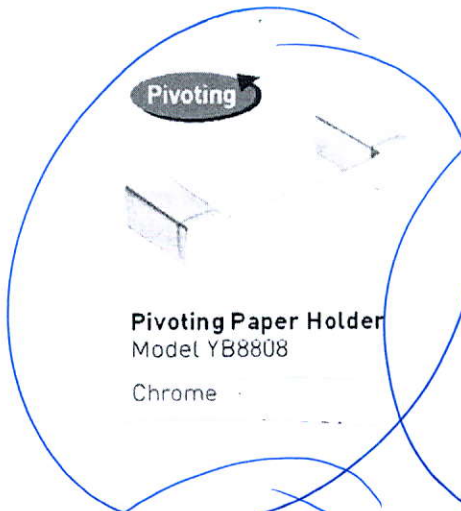
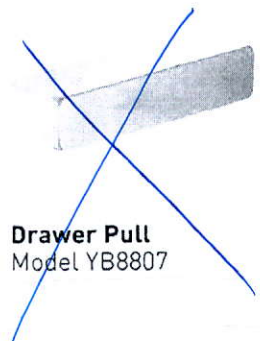
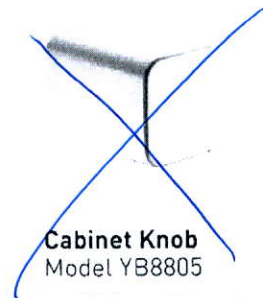

FINISH OPTIONS:

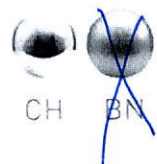

To order, combine the model number with one of these finish letter(s):
Chrome (CH), LifeShine® Brushed Nickel (BN).

SCHEDULE 'A'

330
RICHMOND

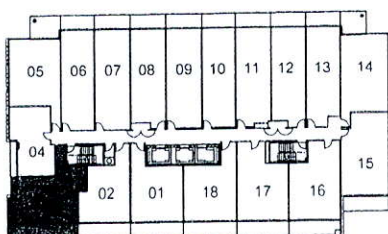
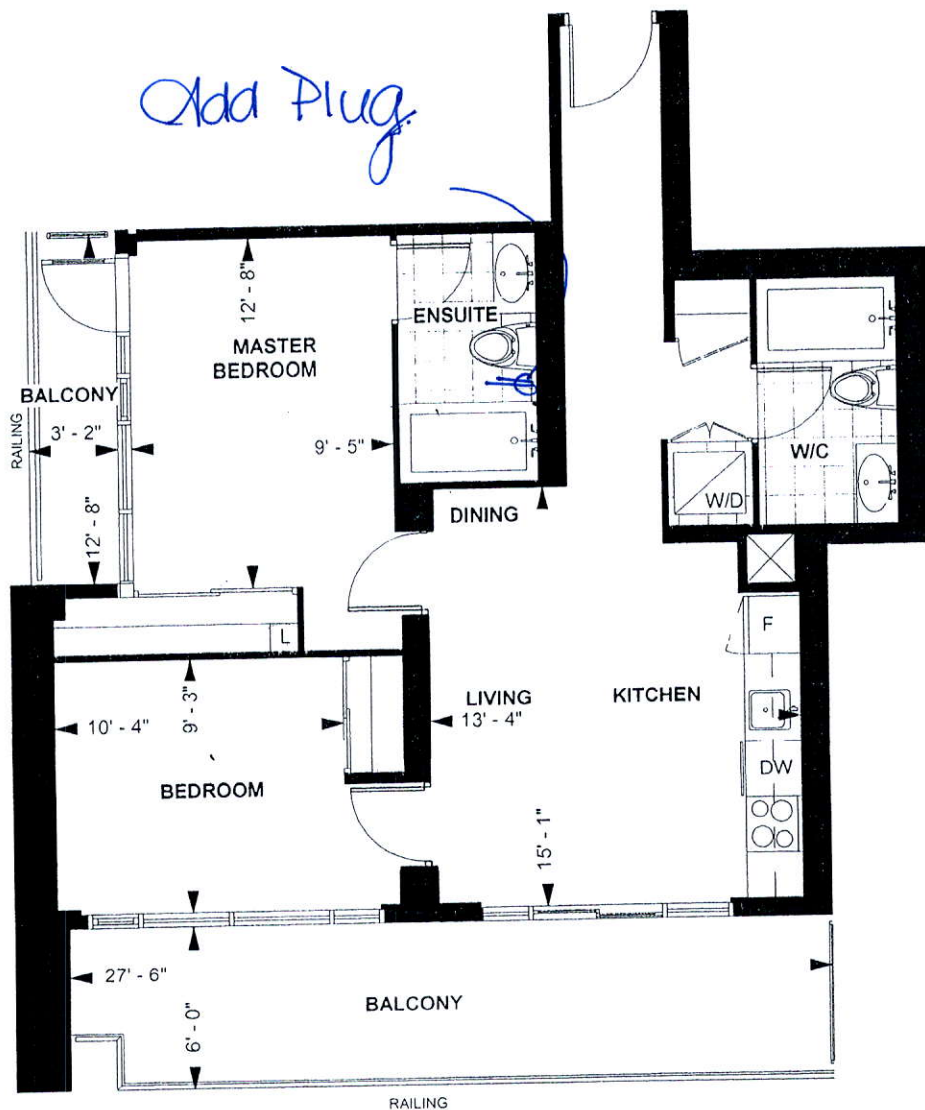

LEVEL 7 - 9

TOWER SUITE

E 771

9' CEILING *

771 sq. ft.

2-BEDROOM

Purchaser Initials *Map* Purchaser Initials _____ Date *Feb 17.16*

Unit No. 3 Level No. 8 Suite No. 903

Dimensions, specification, tile floor pattern and architectural detailing (including window size and location) are approximate and subject to modifications without notice. Orientation of suite may vary from the stated floor area.

*Ceiling height measured from top of floor slab to underside of slab above before finishes, and excluding bulkheads and required drop ceilings. E.&O.E.

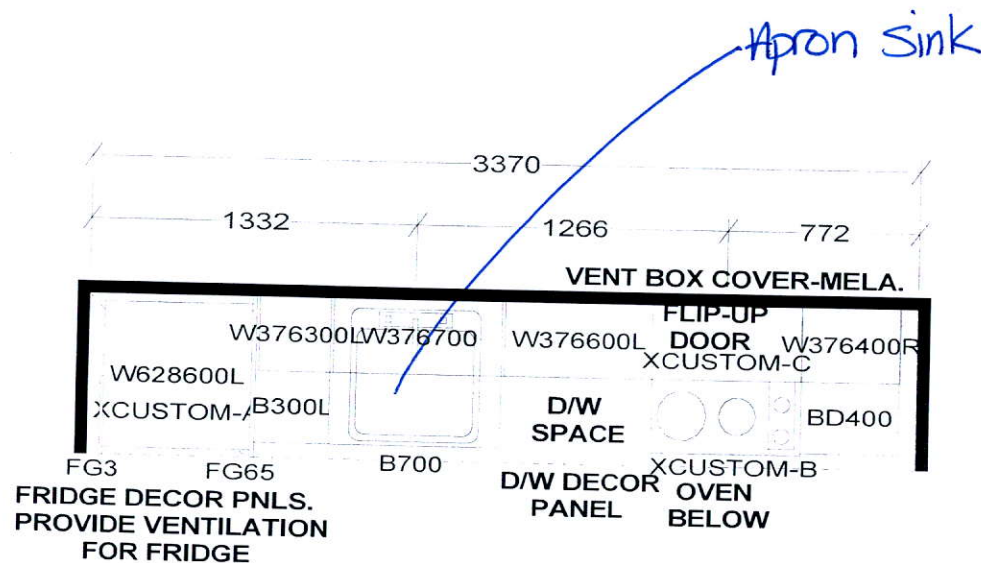

41' upper cabinetry

KITCHEN

KITCHEN BASES & VANITIES INSTALLED WITH ADJUSTABLE LEGS

APPLIANCE PACKAGE:
24" INTEGRATED FRIDGE W/ DECOR PNLS
24" INTEGRATED DISHWASHER W/ DECOR PNL
24" BUILT-IN OVEN
24" COOKTOP
24" MICROWAVE HOOD FAN

Selba Industries

W WIDTH _____ W HGHT _____ W CNT _____ FL HGHT _____ DWY H _____ ST CENT _____ 2X4 _____ VENT BOX COVER _____

TOWER SUITES:
760MM HIGH UPPER CABINETS
WHITE STEEL DRAWER BOXES
COUNTERTOPS BY OTHERS
VENT BOX COVERS
CUSTOM VANITIES

This drawing is the intellectual property of SELBA INDUSTRIES INC. and is an original design which must not be released or copied unless applicable fee has been paid or job order placed.



JOB NUMBER:
BUILDER: GREENPARK
SITE NAME: PETALUMA
MODEL: 2 BEDROOM - E 771
LOT #:
DESIGNER: KS
DATE: JAN 8 18

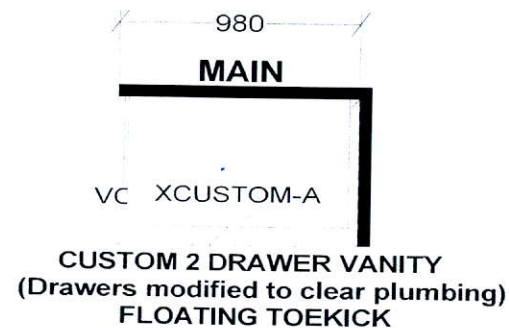
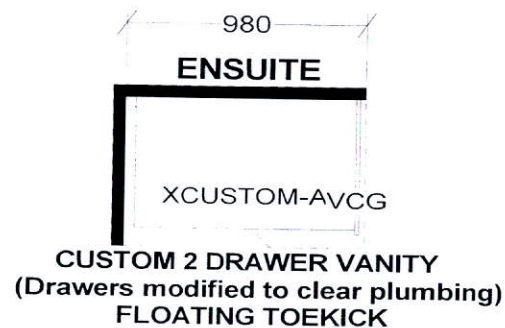

Frameless Mirror Sliding Door with Mirror Fascia - \$680

