



CONSTRUCTION SUMMARY  
330 Richmond - Petaluma Building Corp.

PURCHASER: Lori D. BRAZIER

TEL: BUS.: 416-861-3418

Unit 6, Level 8 (907-1)	Floor Plan B592		
-------------------------	--------------------	--	--

CABINETRY

1 - KITCHEN - 41" UPPER CABINETRY 25Sep18 Note:	
--	--

CONSTRUCTION

1 - MAIN BATH - 5 FOOT SHOWER WITH SLIDING CHROME FRAMED GLASS DOORS IN LIEU OF TUB 07Dec17 Note:	
--	--

This Document is Extremely Time Sensitive - Printed 25 Sep 18 at 14:56

RECEIVED SEP 25 2018

Purchaser: Lori D. BRAZIER  
Telephone Res. / Bus: / (416) 861-3418  
Decor Advisor: Candace Forza  
Lock Date: 9/25/2018 14:56:53

Const. No.: Unit 6, Level 8  
Municipal: 907  
Suite Type: B592  
Project/Phase: Petaluma Building Corp./1

Layout Changes: ☐ Yes ☒ No Sketch Attached: ☒ Yes ☐ No Exterior Colour Scheme:

**1. Kitchen and Vanities**

## Style and Colour

## Counter

## Hardware

Kitchen / Breakfast	SEE BELOW	QUARTZ-TORRONE-STRAIGHT POLISHED EDGE	STD
Main Bath	DORAL H3078- HACIENDA WHITE	QUARTZ-TORRONE-STRAIGHT POLISHED EDGE	STD
Master Ensuite Bathroom	N/A	N/A	N/A

## Appliances:

Built In Appliances ☒ Yes ☐ No 41" Upper Cabinets ☒ Yes ☐ No Slide In Stove ☐ Yes ☒ No

## Comment

KITCHEN CABINETRY - BASE DORAL H3078- HACIENDA WHITE \*\*\* UPPERS - SENOSAN WHITE

**2. Flooring**

		Grout-If App.	At a 45
Entrance Vestibule	STRIP-MIRAGE-LOCK-RED OAK-CASHMERE-NORDIC-4 5/16"		<input type="checkbox"/>
Main Hall	STRIP-MIRAGE-LOCK-RED OAK-CASHMERE-NORDIC-4 5/16"		<input type="checkbox"/>
Kitchen / Breakfast	STRIP-MIRAGE-LOCK-RED OAK-CASHMERE-NORDIC-4 5/16"		<input type="checkbox"/>
Laundry Room	TILE-LIFE SILVER-12X24		<input type="checkbox"/>
Main Bath	TILE-LIFE SILVER-12X24	STANDARD	<input type="checkbox"/>
Master Ensuite Bathroom	N/A	STANDARD	<input type="checkbox"/>
	N/A		<input type="checkbox"/>
Living Room	STRIP-MIRAGE-LOCK-RED OAK-CASHMERE-NORDIC-4 5/16"		<input type="checkbox"/>
Dining Room	STRIP-MIRAGE-LOCK-RED OAK-CASHMERE-NORDIC-4 5/16"		<input type="checkbox"/>
Den / Library / Study	N/A		<input type="checkbox"/>
Master Bedroom	STRIP-MIRAGE-LOCK-RED OAK-CASHMERE-NORDIC-4 5/16"		<input type="checkbox"/>
Bedroom #2	N/A		<input type="checkbox"/>
Bedroom #3	N/A		<input type="checkbox"/>

## Comment

**3. Wall Tile**

	Selection	Grout	Describe
Main Bath			
Tub Deck Wall	N/A		
Shower Stall	TILE-GLOSSY WHITE-3X6	STANDARD	
Bathtub Enclosure Walls	N/A		
Master Ensuite Bathroom			
Tub Deck Wall	N/A		
Shower Stall	N/A		
Bathtub Enclosure Walls	N/A		
Kitchen Backsplash	BACK PAINTED GLASS-BM-#OC-16	STANDARD	
Backsplash Behind Fridge	N/A		

## Comment

\*\* Refer to Construction Summary

**4. Misc**

Water Line for Fridge N/A  
Interior Door Handles AS PER CONSTRUCTION SPECS  
Ceramic Bathroom Accessories YES ☒ Yes ☐ No

## Comment

Initial: 

Page 1 of 2



Purchaser: Lori D. BRAZIER  
Telephone Res. / Bus: / (416) 861-3418  
Decor Advisor: Candace Forza  
Lock Date: 9/25/2018 14:56:53

Const. No.: Unit 6, Level 8  
Municipal: 907  
Suite Type: B592  
Project/Phase: Petaluma Building Corp./1

5. Plaster Mouldings and Medallions

Entrance Vestibule	N/A		Living Room	N/A	
Main Hall	N/A		Dining Room	N/A	
Kitchen/Breakfast	N/A		Den / Library /Study	N/A	
Laundry Room	N/A		Master BedRoom	N/A	
Main Bath	N/A		BedRoom #2	N/A	
Master Ensuite Bathroom	N/A		BedRoom #3	N/A	

Comment

\*\* Refer to Construction Summary

6. Wall Paint

Entrance Vestibule	43 - BIRCH WHITE	Living Room	43 - BIRCH WHITE
Main Hall	43 - BIRCH WHITE	Dining Room	43 - BIRCH WHITE
Kitchen / Breakfast	43 - BIRCH WHITE	Den/Library	N/A
Laundry Room	43 - BIRCH WHITE	Master Bedroom	43 - BIRCH WHITE
Main Bath	43 - BIRCH WHITE	Bedroom #2	N/A
Master Ensuite	N/A	Bedroom #3	N/A
	N/A		

Comment

7. General Comments

\*\* Refer to Construction Summary

Disclaimers and Notes

- 1) Colours of all materials are as close as possible to builder's selection, but not necessarily identical due to variances in manufacturing.
- 2) Any extras listed above are null and void unless accompanied by a separate invoice/amendment. Said invoice must be paid in full.
- 3) The Purchaser agrees that this colour selection is final and that no changes will be permitted, unless required by the Vendor.
- 4) The Purchaser acknowledges reading and accepting document which contains other miscellaneous disclaimers.

Signature:  Date: 25/9/18 Signature: \_\_\_\_\_ Date: \_\_\_\_\_

SCHEDULE 'A'

330

RICHMOND

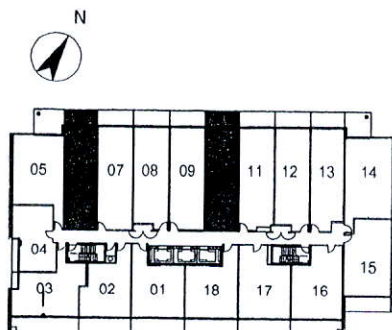
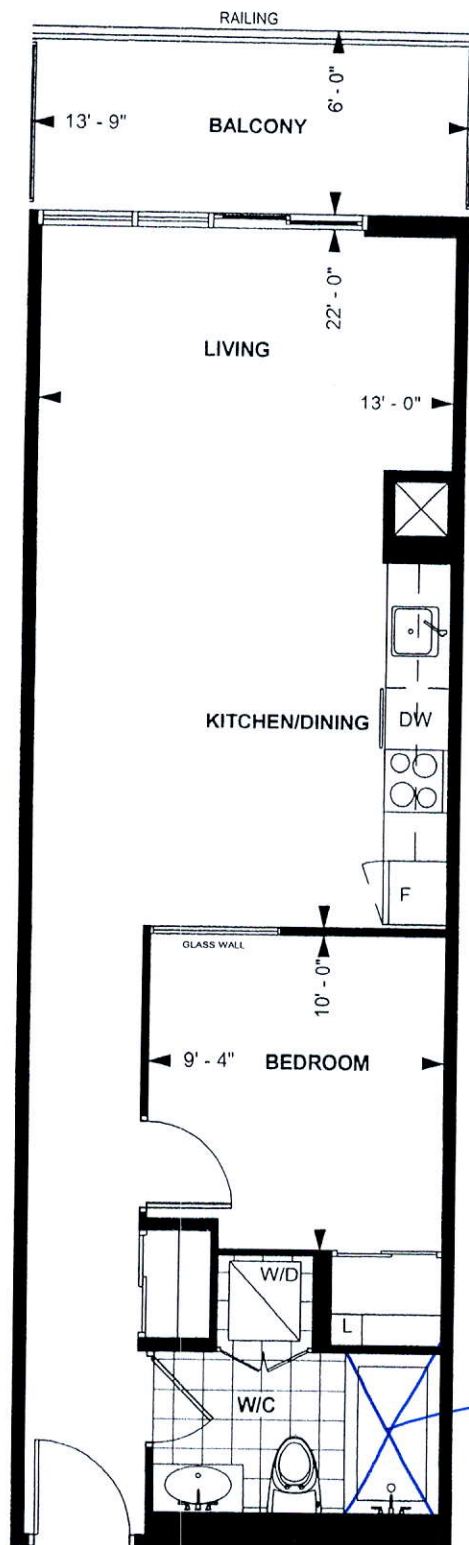

LEVEL 5 - 9

TOWER SUITE  
B 592

9' CEILING \*

592 sq. ft.

1-BEDROOM

Unit No. 6 Level No. 8 Suite No. 907

Dimensions, specification, tile floor pattern and architectural detailing (including window size and location) are approximate and subject to modifications without notice. Orientation of suite may vary from the stated floor area.

\*Ceiling height measured from top of floor slab to underside of slab above before finishes, and excluding bulkheads and required drop ceilings. E.&O.E.

Purchaser Initials Purchaser Initials

Date

Feb 27, 2016

41" Upper  
Cabinetry.

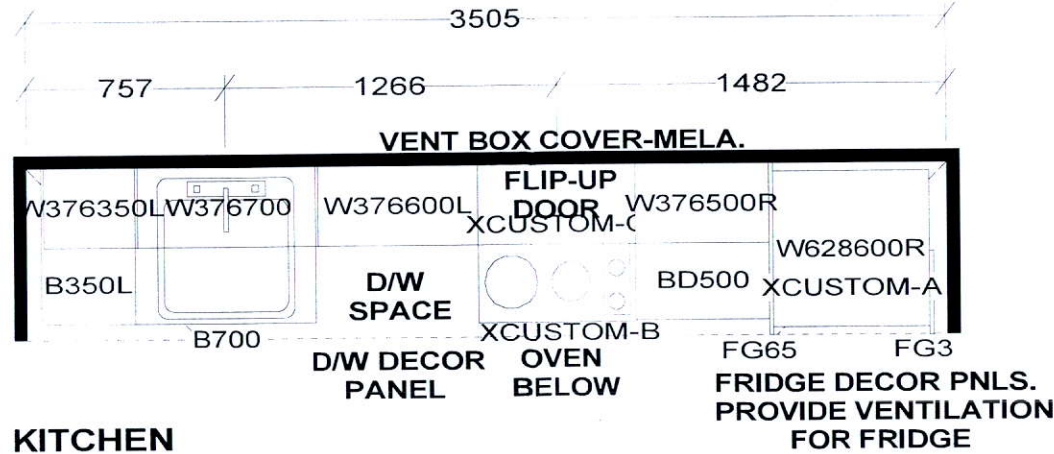

KITCHEN

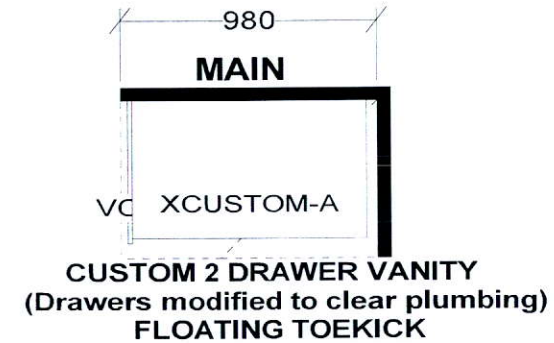

KITCHEN BASES & VANITIES INSTALLED  
WITH ADJUSTABLE LEGS

APPLIANCE PACKAGE:

- 24" INTEGRATED FRIDGE W/ DECOR PNLS
- 24" INTEGRATED DISHWASHER W/ DECOR PNL
- 24" BUILT-IN OVEN
- 24" COOKTOP
- 24" MICROWAVE HOOD FAN

*S e l b a I n d u s t r i e s*

WDTH \_\_\_\_\_ W HGHT \_\_\_\_\_ W CNT \_\_\_\_\_ FL HGHT \_\_\_\_\_ DWY H \_\_\_\_\_ ST CENT \_\_\_\_\_ 2X4 \_\_\_\_\_ VENT BOX COVER \_\_\_\_\_

TOWER SUITES:  
760MM HIGH UPPER CABINETS  
WHITE STEEL DRAWER BOXES  
COUNTERTOPS BY OTHERS  
VENT BOX COVERS  
CUSTOM VANITIES

This drawing is the intellectual property of  
SELBA INDUSTRIES INC. and is an  
original design which must not be released  
or copied unless applicable fee has been  
paid or job order placed.



JOB NUMBER:  
BUILDER: GREENPARK  
SITE NAME: PETALUMA  
MODEL: 1 BEDROOM-B 592, B 609, B 635  
LOT #:  
DESIGNER: KS  
DATE: JAN 8 18