



CONSTRUCTION SUMMARY
330 Richmond - Petaluma Building Corp.

PURCHASER: Andrzej ADAS		TEL:	
Unit 5, Level 19 (2206-1)	Floor Plan B610		

CABINETRY

1 - KITCHEN - 41" UPPER CABINETRY 29Apr19 Note:	
--	--

CERAMIC TILE

1 - BATHROOM - DELETE STANDARD WHITE CERAMIC ACCESSORIES - DO NOT INSTALL SOAP DISH, TOWEL RACK OR TISSUE HOLDER 29Apr19 Note:	
---	--

CONSTRUCTION

1 - BEDROOM - SMOOTH CEILING 29Apr19 Note:	
---	--

COUNTER TOP

1 - BATHROOM - UPGRADED EDGE ON COUNTERTOP 29Apr19 Note:	
1 - KITCHEN - UPGRADED EDGE ON COUNTERTOP 29Apr19 Note:	
1 - KITCHEN - HIGH-END QUARTZ COUNTERTOP IN LIEU OF STANDARD AS PER OFFER 29Apr19 Note:	

MIRRORS AND GLASS

2 - FOYER & BEDROOM - FRAMLESS MIRROR SLIDING CLOSET DOORS WITH MIRROR FASCIA 29Apr19 Note:	
--	--

MISCELLANEOUS

1 - PURCHASER FORFIETS REMAINING BALANCE OF CREDIT IN OFFER IN THE AMOUNT OF \$55.00 29Apr19 Note:	
---	--

PLUMBING

1 - BATHROOM - MOEN 90 DEGREE BATHROOM ACCESSORIES - CHROME TOILET PAPER HOLDER #YB8808 TOWEL RING #YB8886 TOWEL BAR #YB8824 29Apr19 Note:	
--	--

PROMOTIONAL

1 - LESS CREDIT FROM PURCHASERS EXTRA SHEET IN OFFER 29Apr19 Note:	
---	--

EXTRAS AS PER OFFER

The Vendor agrees that notwithstanding any other term or provision in this Agreement included in the Purchase Price and in addition to those items detailed in Schedule D to the Agreement of Purchase and Sale, the Purchaser is entitled to a credit of Fiv Worksheet Note:	
--	--

This Document is Extremely Time Sensitive - Printed 29 Apr 19 at 15:00

RECEIVED APR 30 2019

RECEIVED APR 30 2019

Purchaser: Andrzej ADAS

Telephone Res. / Bus: /

Decor Advisor: Candace Forza

Lock Date: 4/29/2019 15:00:40

Const. No.: Unit 5, Level 19

Municipal: 2206

Suite Type: B610

Project/Phase: Petaluma Building Corp./1

Layout Changes: ☐ Yes ☒ No Sketch Attached: ☒ Yes ☐ No Exterior Colour Scheme:

1. Kitchen and Vanities

	Style and Colour	Counter	Hardware
Kitchen / Breakfast	SEE BELOW	QUARTZ-FROSTY CARRARA-#360 EDGE	STD
Main Bath	DORAL H3081-HACIENDA BLACK	QUARTZ-AMIATA-#360 EDGE	STD
Master Ensuite Bathroom	N/A	N/A	N/A

Appliances: Built In Appliances ☒ Yes ☐ No 41" Upper Cabinets ☒ Yes ☐ No Slide In Stove ☐ Yes ☒ No

Comment

KITCHEN CABINETRY - BASE - DORAL H3081-HACIENDA BLACK *** UPPERS - SENOSAN LIGHT GREY

2. Flooring

		Grout-If App.	At a 45
Entrance Vestibule	STRIP-MIRAGE-LOCK-RED OAK-CASHMERE-GRAPHITE-4 5/16"		<input type="checkbox"/>
Main Hall	STRIP-MIRAGE-LOCK-RED OAK-CASHMERE-GRAPHITE-4 5/16"		<input type="checkbox"/>
Kitchen / Breakfast	STRIP-MIRAGE-LOCK-RED OAK-CASHMERE-GRAPHITE-4 5/16"		<input type="checkbox"/>
Laundry Room	TILE-WHITE-8X8	STANDARD	<input type="checkbox"/>
Main Bath	TILE-LIFE ICE-12X24	STANDARD	<input type="checkbox"/>
Master Ensuite Bathroom	N/A		<input type="checkbox"/>
	N/A		<input type="checkbox"/>
Living Room	STRIP-MIRAGE-LOCK-RED OAK-CASHMERE-GRAPHITE-4 5/16"		<input type="checkbox"/>
Dining Room	STRIP-MIRAGE-LOCK-RED OAK-CASHMERE-GRAPHITE-4 5/16"		<input type="checkbox"/>
Den / Library / Study	N/A		<input type="checkbox"/>
Master Bedroom	STRIP-MIRAGE-LOCK-RED OAK-CASHMERE-GRAPHITE-4 5/16"		<input type="checkbox"/>
Bedroom #2	N/A		<input type="checkbox"/>
Bedroom #3	N/A		<input type="checkbox"/>
			<input type="checkbox"/>

Comment

3. Wall Tile

	Selection	Grout	Describe
Main Bath			
Tub Deck Wall	N/A		
Shower Stall	N/A		
Bathtub Enclosure Walls	TILE-GLOSSY WHITE-3X6	STANDARD	
Master Ensuite Bathroom			
Tub Deck Wall	N/A		
Shower Stall	N/A		
Bathtub Enclosure Walls	N/A		
Kitchen Backsplash	BACK PAINTED GLASS-BM-#HC-170	STANDARD	
Backsplash Behind Fridge	N/A		

Comment

** Refer to Construction Summary

4. Misc

Water Line for Fridge

N/A

Interior Door Handles

AS PER CONSTRUCTION SPECS

Ceramic Bathroom Accessories

NO - UPGRADED - MOEN 90 DEGREE

☐ Yes ☒ No

Comment

Purchaser: Andrzej ADAS
Telephone Res. / Bus: /
Decor Advisor: Candace Forza
Lock Date: 4/29/2019 15:00:40

Const. No.: Unit 5, Level 19
Municipal: 2206
Suite Type: B610
Project/Phase: Petaluma Building Corp./1

5. Plaster Mouldings and Medallions

Entrance Vestibule	N/A		Living Room	N/A	
Main Hall	N/A		Dining Room	N/A	
Kitchen/Breakfast	N/A		Den / Library /Study	N/A	
Laundry Room	N/A		Master BedRoom	N/A	
Main Bath	N/A		BedRoom #2	N/A	
Master Ensuite Bathroom	N/A		BedRoom #3	N/A	

Comment
** Refer to Construction Summary

6. Wall Paint

Entrance Vestibule	43 - BIRCH WHITE	Living Room	43 - BIRCH WHITE
Main Hall	43 - BIRCH WHITE	Dining Room	43 - BIRCH WHITE
Kitchen / Breakfast	43 - BIRCH WHITE	Den/Library	N/A
Laundry Room	43 - BIRCH WHITE	Master Bedroom	43 - BIRCH WHITE
Main Bath	43 - BIRCH WHITE	Bedroom #2	N/A
Master Ensuite	N/A	Bedroom #3	N/A
	N/A		

Comment

7. General Comments

** Refer to Construction Summary

Disclaimers and Notes

- 1) Colours of all materials are as close as possible to builder's selection, but not necessarily identical due to variances in manufacturing.
- 2) Any extras listed above are null and void unless accompanied by a separate invoice/amendment. Said invoice must be paid in full.
- 3) The Purchaser agrees that this colour selection is final and that no changes will be permitted, unless required by the Vendor.
- 4) The Purchaser acknowledges reading and accepting document which contains other miscellaneous disclaimers.

Signature:  Date: 04/29/19 Signature: _____ Date: _____

90°™

Traditional | Transitional | Modern

Geometric forms, squared corners and straight lines create an urban focal point for today's contemporary baths.



Toilet Tank Lever
Model YB8801

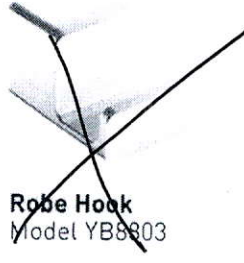

Robe Hook
Model YB8803

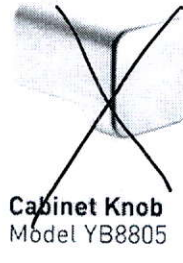

Cabinet Knob
Model YB8805

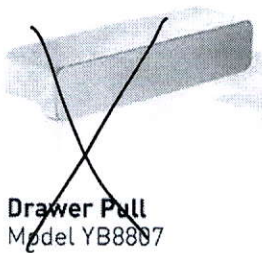

Drawer Pull
Model YB8807

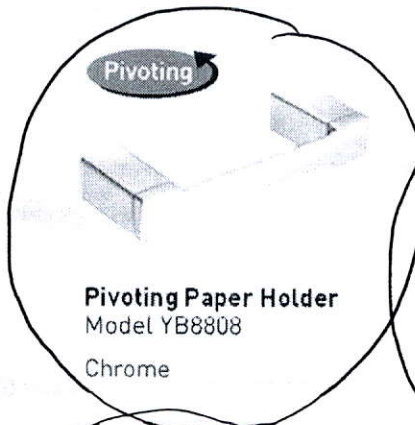

Pivoting Paper Holder
Model YB8808
Chrome



Mini Towel Bar
Model YB8886
Chrome

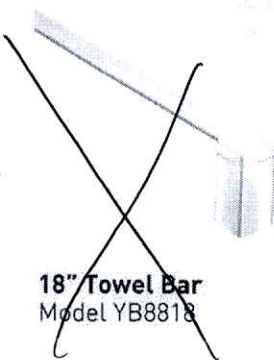

18" Towel Bar
Model YB8818



24" Towel Bar
Model YB8824
Chrome

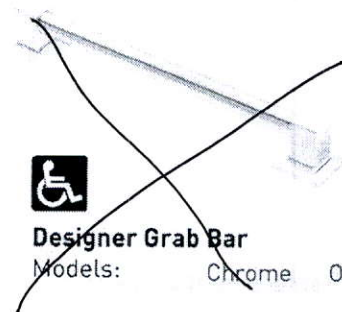

Designer Grab Bar
Models: Chrome Other

FINISH OPTIONS:

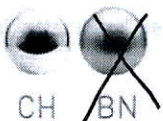

To order, combine the model number with one of these finish letter(s):
Chrome (CH), LifeShine® Brushed Nickel (BN).

SCHEDULE 'A'

330

RICHMOND

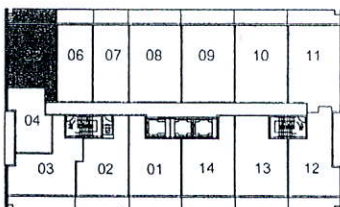
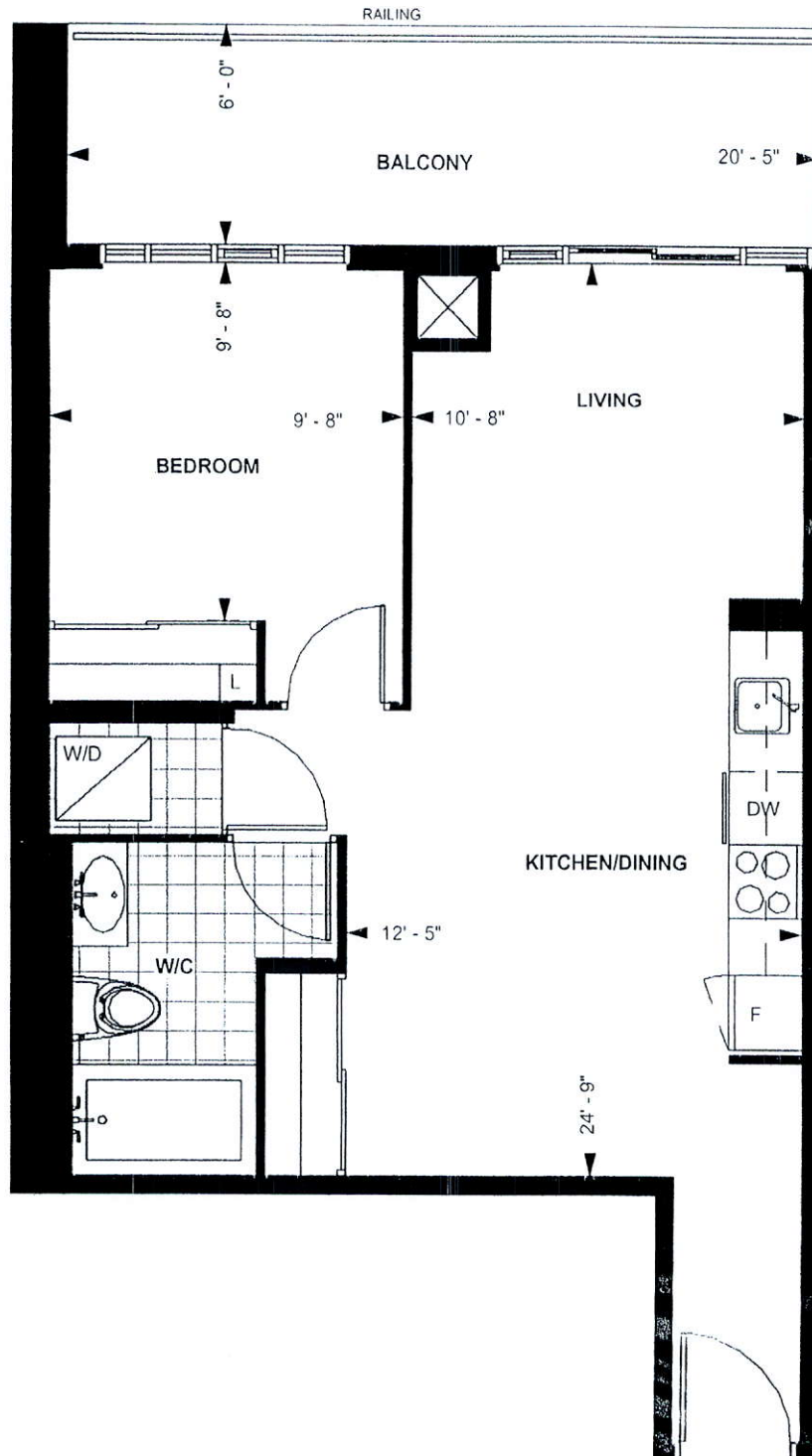

LEVEL 13 - 20

TOWER SUITE

B 610

9' CEILING *

611 sq. ft.

1-BEDROOM

Purchaser Initials AA Purchaser Initials AA

Date Oct 21/15

Unit No. 5 Level No. 19 Suite No. 2206

Dimensions, specification, tile floor pattern and architectural detailing (including window size and location) are approximate and subject to modifications without notice. Orientation of suite may vary from the stated floor area.
 *Ceiling height measured from top of floor slab to underside of slab above before finishes, and excluding bulkheads and required drop ceilings. E.&O.E.

* Upgrade Edge for Kitchen + Baths

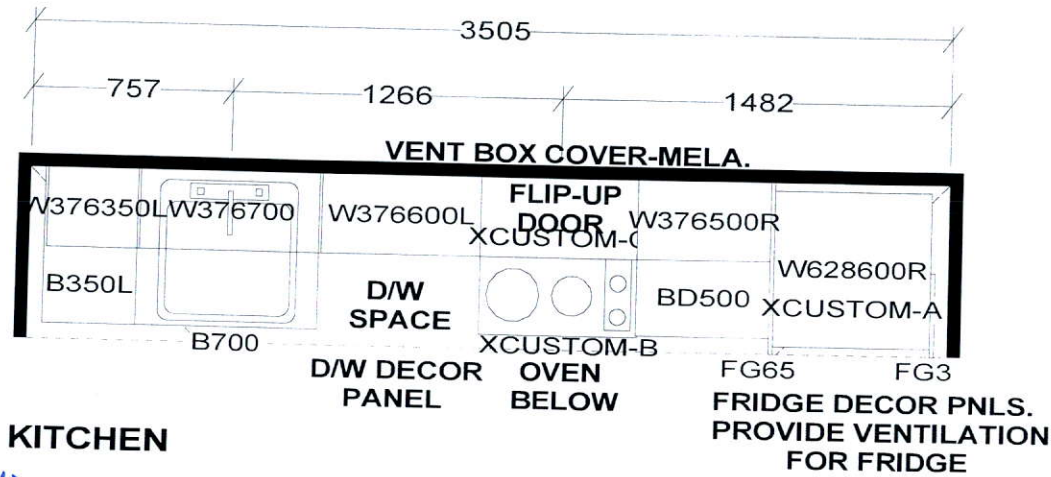

KITCHEN

41" Upper Cabinetry

KITCHEN BASES & VANITIES INSTALLED WITH ADJUSTABLE LEGS

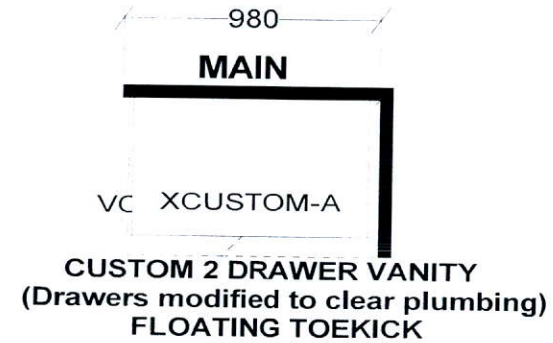

APPLIANCE PACKAGE:
 24" INTEGRATED FRIDGE W/ DECOR PNLS
 24" INTEGRATED DISHWASHER W/ DECOR PNL
 24" BUILT-IN OVEN
 24" COOKTOP
 24" MICROWAVE HOOD FAN

Selba Industries

WDTH _____ W HGHT _____ W CNT _____ FL HGHT _____ DWY H _____ ST CENT _____ 2X4 _____ VENT BOX COVER _____

TOWER SUITES:
 760MM HIGH UPPER CABINETS
 WHITE STEEL DRAWER BOXES
 COUNTERTOPS BY OTHERS
 VENT BOX COVERS
 CUSTOM VANITIES

This drawing is the intellectual property of SELBA INDUSTRIES INC. and is an original design which must not be released or copied unless applicable fee has been paid or job order placed.



JOB NUMBER:
 BUILDER: GREENPARK
 SITE NAME: PETALUMA
 MODEL: 1 BEDROOM-B 463, B 493, B 610
 LOT #:
 DESIGNER: KS
 DATE: JAN 8 18

Frameless Mirror Sliding Door with Mirror Fascia - \$680

