



CONSTRUCTION SUMMARY  
330 Richmond - Petaluma Building Corp.

PURCHASER: Tribeca Property Management Group Inc. TEL: RES.: 416-225-6900

Unit 8, Level 20 (2309-1)	Floor Plan E698		
---------------------------	--------------------	--	--

CABINETRY

1 - 41" UPPER CABINETS IN KITCHEN 12Jun19 Note:	
--	--

CONSTRUCTION

1 - SMOOTH CEILINGS IN BEDROOMS 12Jun19 Note:	
--	--

PLUMBING

2 - UPGRADE BATHROOM ACCESSORIES- MOEN 90 DEGREE CHROME- IN BOTH BAHTROOMS TOILET PAPER HOLDER #YB 8868 TOWEL RING #YB8886 24" TOWEL BAR #YB8824 12Jun19 Note:	
--	--

This Document is Extremely Time Sensitive - Printed 12 Jun 19 at 10:48

RECEIVED JUN 12 2019

Purchaser: Tribeca Property Management Group Inc.  
Telephone Res. / Bus: (416) 225-6900 /  
Decor Advisor: Natalie Mancuso  
Lock Date: 6/12/2019 10:47:44

Const. No.: Unit 8, Level 20  
Municipal: 2309  
Suite Type: E698  
Project/Phase: Petaluma Building Corp./1

Layout Changes: ☐ Yes ☒ No Sketch Attached: ☒ Yes ☐ No Exterior Colour Scheme:

1. Kitchen and Vanities

	Style and Colour	Counter	Hardware
Kitchen / Breakfast	SEE BELOW	QUARTZ- AMIATA- STRAIGHT POLISHED EDGE	STD
Main Bath	DORAL H3081 HACIENDA BLACK	QUARTZ- AMIATA- STRAIGHT POLISHED EDGE	STD
Master Ensuite Bathroom	DORAL H3081 HACIENDA BLACK	QUARTZ- AMIATA- STRAIGHT POLISHED EDGE	STD

Appliances: Built In Appliances ☒ Yes ☐ No 41" Upper Cabinets ☒ Yes ☐ No Slide In Stove ☐ Yes ☒ No

Comment

KITCHEN UPPER CABINETS- SENOSAN LIGHT GREY  
KITCHEN BASE CABINETS- DORAL H3081 HACIENDA BLACK

2. Flooring

		Grout-If App.	At a 45
Entrance Vestibule	HARDWOOD- MIRAGE 4 5/16 LOCK RED OAK- GRAPHITE- CASHMERE		<input type="checkbox"/>
Main Hall	HARDWOOD- MIRAGE 4 5/16 LOCK RED OAK- GRAPHITE- CASHMERE		<input type="checkbox"/>
Kitchen / Breakfast	HARDWOOD- MIRAGE 4 5/16 LOCK RED OAK- GRAPHITE- CASHMERE		<input type="checkbox"/>
Laundry Room	TILE- MATTE WHITE 8X8	STD	<input type="checkbox"/>
Main Bath	TILE-LIFE ICE 12X24	STD	<input type="checkbox"/>
Master Ensuite Bathroom	TILE-LIFE ICE 12X24	STD	<input type="checkbox"/>
			<input type="checkbox"/>
Living Room	HARDWOOD- MIRAGE 4 5/16 LOCK RED OAK- GRAPHITE- CASHMERE		<input type="checkbox"/>
Dining Room	HARDWOOD- MIRAGE 4 5/16 LOCK RED OAK- GRAPHITE- CASHMERE		<input type="checkbox"/>
Den / Library / Study			<input type="checkbox"/>
Master Bedroom	HARDWOOD- MIRAGE 4 5/16 LOCK RED OAK- GRAPHITE- CASHMERE		<input type="checkbox"/>
Bedroom #2	HARDWOOD- MIRAGE 4 5/16 LOCK RED OAK- GRAPHITE- CASHMERE		<input type="checkbox"/>
Bedroom #3			<input type="checkbox"/>
			<input type="checkbox"/>

Comment

3. Wall Tile

	Selection	Grout	Describe
Main Bath			
Tub Deck Wall			
Shower Stall	TILE- GLOSSY WHITE 3X6	STD	
Bathtub Enclosure Walls			
Master Ensuite Bathroom			
Tub Deck Wall			
Shower Stall			
Bathtub Enclosure Walls	TILE- GLOSSY WHITE 3X6	STD	
Kitchen Backsplash	PAINTED GLASS BM #HC-170		
Backsplash Behind Fridge			

Comment

\*\* Refer to Construction Summary

4. Misc

Water Line for Fridge NO  
Interior Door Handles STANDARD  
Ceramic Bathroom Accessories MOEN 90 DEGREE ☒ Yes ☐ No

Comment

RF

Initial: \_\_\_\_\_



Purchaser: Tribeca Property Management Group Inc.  
Telephone Res. / Bus: (416) 225-6900 /  
Decor Advisor: Natalie Mancuso  
Lock Date: 6/12/2019 10:47:44

Const. No.: Unit 8, Level 20  
Municipal: 2309  
Suite Type: E698  
Project/Phase: Petaluma Building Corp./1

5. Plaster Mouldings and Medallions

Entrance Vestibule			Living Room		
Main Hall			Dining Room		
Kitchen/Breakfast			Den / Library /Study		
Laundry Room			Master BedRoom		
Main Bath			BedRoom #2		
Master Ensuite Bathroom			BedRoom #3		

Comment

\*\* Refer to Construction Summary

6. Wall Paint

Entrance Vestibule	BIRCH WHITE	Living Room	BIRCH WHITE
Main Hall	BIRCH WHITE	Dining Room	BIRCH WHITE
Kitchen / Breakfast	BIRCH WHITE	Den/Library	
Laundry Room	BIRCH WHITE	Master Bedroom	BIRCH WHITE
Main Bath	BIRCH WHITE	Bedroom #2	BIRCH WHITE
Master Ensuite	BIRCH WHITE	Bedroom #3	

Comment

7. General Comments

\*\* Refer to Construction Summary

Disclaimers and Notes

- 1) Colours of all materials are as close as possible to builder's selection, but not necessarily identical due to variances in manufacturing.
- 2) Any extras listed above are null and void unless accompanied by a separate invoice/amendment. Said invoice must be paid in full.
- 3) The Purchaser agrees that this colour selection is final and that no changes will be permitted, unless required by the Vendor.
- 4) The Purchaser acknowledges reading and accepting document which contains other miscellaneous disclaimers.

Signature: \_\_\_\_\_ Date: June 12/19 Signature: \_\_\_\_\_ Date: \_\_\_\_\_

Initial: RK

# 90°™

Traditional | Transitional | Modern

*Geometric forms, squared corners and straight lines create an urban focal point for today's contemporary baths.*



**Toilet Tank Lever**  
Model YB8801

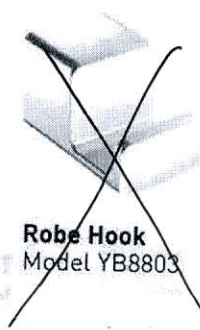

**Robe Hook**  
Model YB8803



**Cabinet Knob**  
Model YB8805

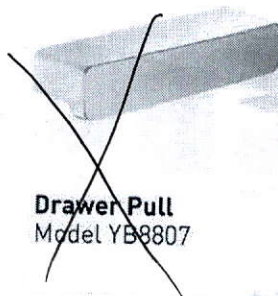

**Drawer Pull**  
Model YB8807

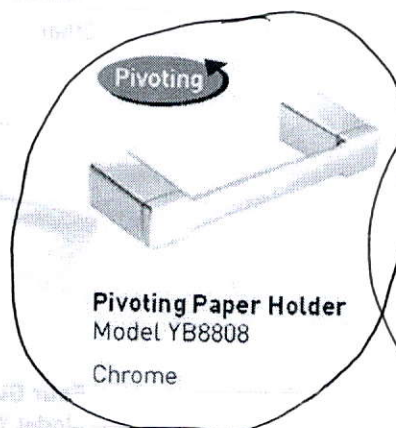

**Pivoting Paper Holder**  
Model YB8808  
Chrome



**Mini Towel Bar**  
Model YB8886  
Chrome

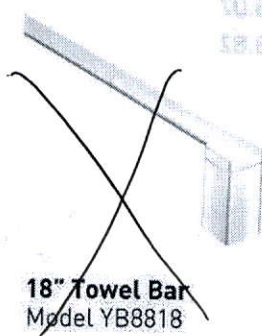

**18" Towel Bar**  
Model YB8818



**24" Towel Bar**  
Model YB8824  
Chrome

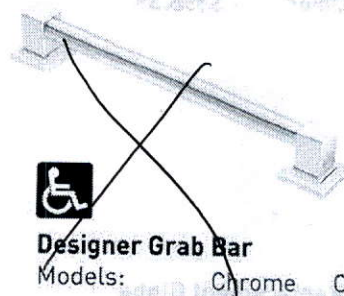

**Designer Grab Bar**  
Models: Chrome Other

## FINISH OPTIONS:

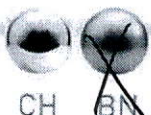

To order, combine the model number with one of these finish letter(s):  
Chrome (CH), LifeShine® Brushed Nickel (BN).



# SCHEDULE 'A'

## 330

RICHMOND

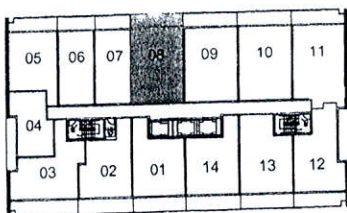
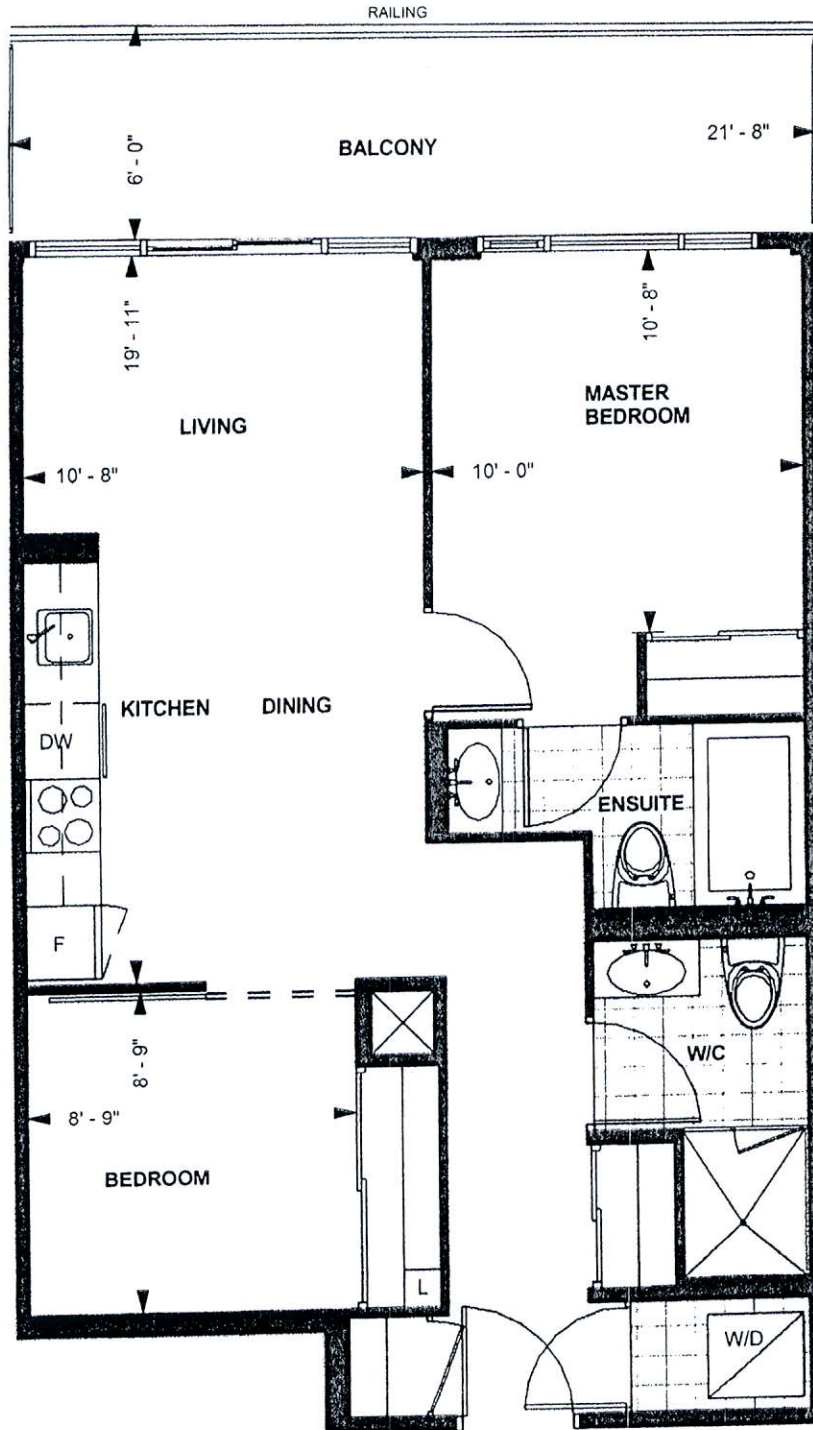

LEVEL 13-20

TOWER SUITE

E 698

9' CEILING \*

698 sq. ft.

2-BEDROOM

Purchaser Initials R.K. Date MAR 24/14

Unit No. 8 Level No. 20 Suite No. 2309

Dimensions, specification, tile floor pattern and architectural detailing (including window size and location) are approximate and subject to modifications without notice. Orientation of suite may vary from the stated floor area.  
\*Ceiling height measured from top of floor slab to underside of slab above before finishes, and excluding bulkheads and required drop ceilings. E.&O.E.

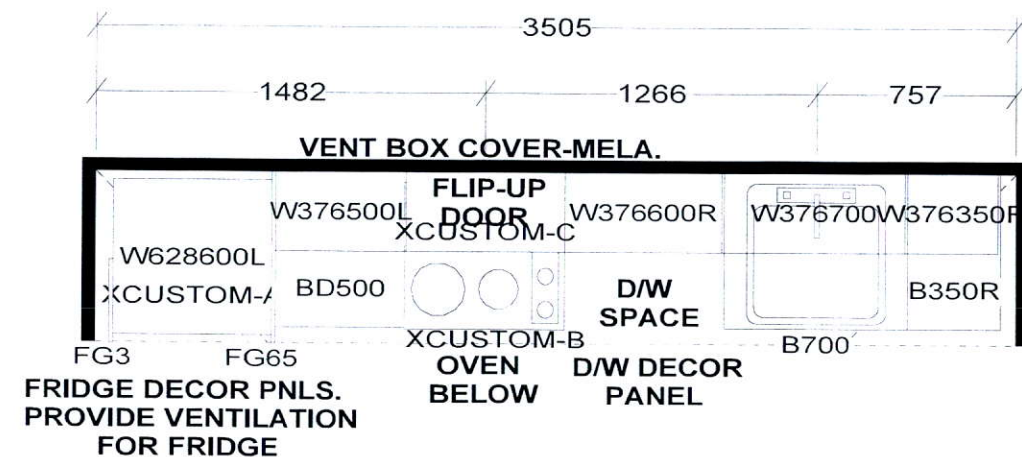

KITCHEN  
- 41" uppers

- APPLIANCE PACKAGE:
- 24" INTEGRATED FRIDGE W/ DECOR PNLS
  - 24" INTEGRATED DISHWASHER W/ DECOR PNL
  - 24" BUILT-IN OVEN
  - 24" COOKTOP
  - 24" MICROWAVE HOOD FAN

KITCHEN BASES & VANITIES INSTALLED  
WITH ADJUSTABLE LEGS

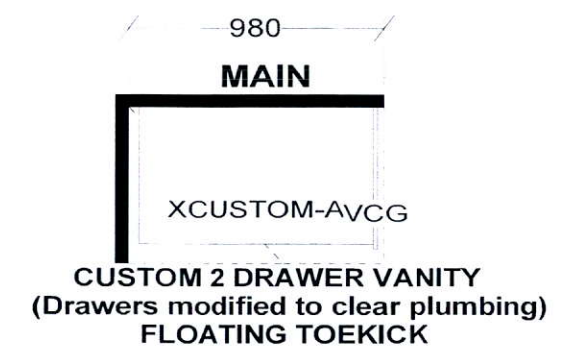
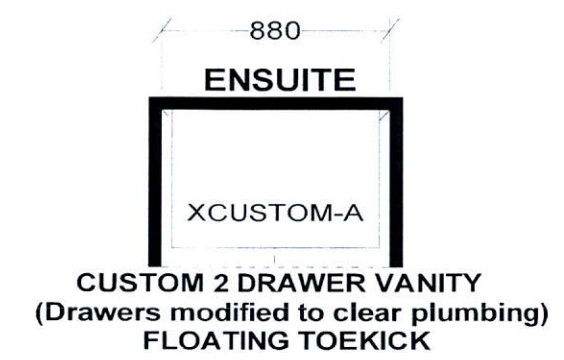

24" MICROWAVE HOOD FAN														Selba Industries													
W DTH		W HGHT		W CNT		FL HGHT		DWY H		ST CENT		2X4		VENT BOX COVER													
TOWER SUITES: 760MM HIGH UPPER CABINETS WHITE STEEL DRAWER BOXES COUNTERTOPS BY OTHERS VENT BOX COVERS CUSTOM VANITIES								This drawing is the intellectual property of SELBA INDUSTRIES INC. and is an original design which must not be released or copied unless applicable fee has been paid or job order placed.										JOB NUMBER: BUILDER: GREENPARK SITE NAME: PETALUMA MODEL: 2 BEDROOM - E 698 LOT #: DESIGNER: KS DATE: JAN 8 18									