

CONSTRUCTION SUMMARY
330 Richmond - Petaluma Building Corp.

DATE: JAN 15 2020

PURCHASER: Giuseppina CUNTRERA

TEL: RES.: 416-662-1203

Unit 3, Level 15 (1803-1)	Floor Plan E771		
---------------------------	--------------------	--	--

CABINETRY

1 - DELETE – 41” INCH UPPERS IN KITCHEN *** INSERT *** – 39” UPPERS IN KITCHEN 14Jan20 Note: The Purchaser acknowledges and agrees that the kitchen cannot accommodate the 41” upper cabinet height, which was chosen by the Purchaser at the time of colour selection, as a result of site conditions. The Purchaser accepts that the kitchen upper cabinets will have a height of approximately 39” and the Purchaser shall not make any claims, including claims to Tarion Warranty Corporation, in respect of the upper kitchen cabinet height being 39”.	RECEIVED JAN 15 2020	
1 - 41" UPPER CABINETS IN KITCHEN 04Mar19 Note:		

CERAMIC TILE

1 - MASTER ENSUITE WALL TILES TO BE STAGGERED IN SHOWER 04Mar19 Note:	
--	--

CONSTRUCTION

1 - ENSUITE - 5 FOOT SHOWER IN LIEU OF TUB - WITH FRAMELESS GLASS DOOR WITH CHROME KNOB AND HINGES 12Mar18 Note:	
---	--

COUNTER TOP

1 - UPGRADE COUNTERTOP EDGE IN KITCHEN 04Mar19 Note:	
1 - SMOOTH CEILINGS IN BEDROOMS 04Mar19 Note:	
* Construction *	

HARDWOOD FLOORING

1 - UPGRADE 2 HARDWOOD THROUGHOUT 04Mar19 Note:	
--	--

PROMOTIONAL

1 - LESS CREDIT FROM PURCHASER EXTRA SHEET IN OFFER 04Mar19 Note:	
1 - BALANCE OWING FOR FRAMELESS GLASS SHOWER IN LIEU OF TUB IN MASTER ENSUITE AS PER PE #22691 04Mar19 Note:	
1 - PARTIAL REDEPTION OF PROMOTIONAL PACKAGE \$2,650 BALANCE OF \$2,350 FORWARD TO BE USED AT A LATER DATE. ORIGINAL PROMOTIONAL PACKAGE OF \$5,000 AS PER SCHEDULE PE DATED OCTOBER 27, 2015. 12Mar18 Note:	

EXTRAS AS PER OFFER

1 Parking Unit Worksheet Note:	
The Vendor agrees that notwithstanding any other term or provision in this Agreement included in the Purchase Price and in addition to those items detailed in Schedule D to the Agreement of Purchase and Sale, the Purchaser is entitled to a credit of Fiv Worksheet Note:	

Purchaser: Giuseppina CUNTRERA
Telephone Res. / Bus: (416) 662-1203 /
Decor Advisor: Natalie Mancuso
Lock Date: 3/4/2019 16:28:03

Const. No.: Unit 3, Level 15
Municipal: 1803
Suite Type: E771
Project/Phase: Petaluma Building Corp./1

Layout Changes: ☒ Yes ☐ No Sketch Attached: ☒ Yes ☐ No Exterior Colour Scheme:

1. Kitchen and Vanities

	Style and Colour	Counter	Hardware
Kitchen / Breakfast	SEE BELOW	QUARTZ- TORRONE- #360 EDGE	STD
Main Bath	DORAL H3078 HACIENDA WHITE	QUARTZ- TORRONE- STRAIGHT POLISHED EDGE	STD
Master Ensuite Bathroom	DORAL H3078 HACIENDA WHITE	QUARTZ- TORRONE- STRAIGHT POLISHED EDGE	STD

Appliances: Built In Appliances ☒ Yes ☐ No 41" Upper Cabinets ☒ Yes ☐ No Slide In Stove ☐ Yes ☒ No

Comment

KITCHEN UPPER CABINETS- SENOSAN WHITE
KITCHEN BASE CABINETS- DORAL H3078 HACIENDA WHITE

39" RECEIVED
JAN 15 2020

2. Flooring

		Grout-If App.	At a 45
Entrance Vestibule	HARDWOOD- MIRAGE 4 5/16 LOCK RED OAK-TREASURE CHAR.BRUSHED-DURAMATT		
Main Hall	HARDWOOD- MIRAGE 4 5/16 LOCK RED OAK-TREASURE CHAR.BRUSHED-DURAMATT		
Kitchen / Breakfast	HARDWOOD- MIRAGE 4 5/16 LOCK RED OAK-TREASURE CHAR.BRUSHED-DURAMATT		
Laundry Room	TILE- MATTE WHITE 8X8	STD	
Main Bath	TILE- LIFE SILVER 12X24	STD	
Master Ensuite Bathroom	TILE- LIFE SILVER 12X24	STD	
Living Room	HARDWOOD- MIRAGE 4 5/16 LOCK RED OAK-TREASURE CHAR.BRUSHED-DURAMATT		
Dining Room	HARDWOOD- MIRAGE 4 5/16 LOCK RED OAK-TREASURE CHAR.BRUSHED-DURAMATT		
Den / Library / Study			
Master Bedroom	HARDWOOD- MIRAGE 4 5/16 LOCK RED OAK-TREASURE CHAR.BRUSHED-DURAMATT		
Bedroom #2	HARDWOOD- MIRAGE 4 5/16 LOCK RED OAK-TREASURE CHAR.BRUSHED-DURAMATT		
Bedroom #3			

Comment

3. Wall Tile

	Selection	Grout	Describe
Main Bath			
Tub Deck Wall			
Shower Stall			
Bathtub Enclosure Walls	TILE- GLOSSY WHITE 3X6	STD	
Master Ensuite Bathroom			
Tub Deck Wall			
Shower Stall	TILE- GLOSSY WHITE 3X6 STAGGERED	STD	
Bathtub Enclosure Walls			
Kitchen Backsplash	PAINTED GLASS BM#OC-16		
Backsplash Behind Fridge			

Comment

** Refer to Construction Summary

4. Misc

Water Line for Fridge NO
Interior Door Handles STANDARD
Ceramic Bathroom Accessories DO NOT INSTALL ☐ Yes ☒ No

Comment

Initial:

Purchaser: Giuseppina CUNTRERA
Telephone Res. / Bus: (416) 662-1203 /
Decor Advisor: Natalie Mancuso
Lock Date: 3/4/2019 16:28:03

Const. No.: Unit 3, Level 15
Municipal: 1803
Suite Type: E771
Project/Phase: Petaluma Building Corp./1

5. Plaster Mouldings and Medallions

Entrance Vestibule		Living Room	
Main Hall		Dining Room	
Kitchen/Breakfast		Den / Library /Study	
Laundry Room		Master BedRoom	
Main Bath		BedRoom #2	
Master Ensuite Bathroom		BedRoom #3	

Comment

** Refer to Construction Summary

6. Wall Paint

Entrance Vestibule	BIRCH WHITE	Living Room	BIRCH WHITE
Main Hall	BIRCH WHITE	Dining Room	BIRCH WHITE
Kitchen / Breakfast	BIRCH WHITE	Den/Library	
Laundry Room	BIRCH WHITE	Master Bedroom	BIRCH WHITE
Main Bath	BIRCH WHITE	Bedroom #2	BIRCH WHITE
Master Ensuite	BIRCH WHITE	Bedroom #3	

Comment

7. General Comments

** Refer to Construction Summary

Disclaimers and Notes

- 1) Colours of all materials are as close as possible to builder's selection, but not necessarily identical due to variances in manufacturing.
- 2) Any extras listed above are null and void unless accompanied by a separate invoice/amendment. Said invoice must be paid in full.
- 3) The Purchaser agrees that this colour selection is final and that no changes will be permitted, unless required by the Vendor.
- 4) The Purchaser acknowledges reading and accepting document which contains other miscellaneous disclaimers.

Signature:  Date: 03/04/2019 Signature: _____ Date: _____

Initial:  Page 2 of 2

330

RICHMOND

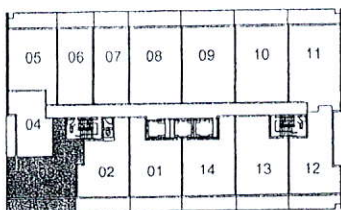

Dimensions, specification, tile floor pattern and architectural detailing (including window size and location) are approximate and subject to modifications without notice. Orientation of suite may vary from the stated floor area.
*Ceiling height measured from top of floor slab to underside of slab above before finishes, and excluding bulkheads and required drop ceilings. E.&O.E.

RECEIVED

JAN 15 2020

39" uppers.

KITCHEN

~~41" uppers~~

- up. countertop Edge

APPLIANCE PACKAGE:

- 24" INTEGRATED FRIDGE W/ DECOR PNLS
- 24" INTEGRATED DISHWASHER W/ DECOR PNL
- 24" BUILT-IN OVEN
- 24" COOKTOP
- 24" MICROWAVE HOOD FAN

Selba Industries

W WIDTH _____ W HGHT _____ W CNT _____ FL HGHT _____ DWY H _____ ST CENT _____ 2X4 _____ VENT BOX COVER _____

TOWER SUITES:

- 760MM HIGH UPPER CABINETS
- WHITE STEEL DRAWER BOXES
- COUNTERTOPS BY OTHERS
- VENT BOX COVERS
- CUSTOM VANITIES

This drawing is the intellectual property of
SELBA INDUSTRIES INC. and is an
original design which must not be released
or copied unless applicable fee has been
paid or job order placed.



JOB NUMBER:

BUILDER: GREENPARK
SITE NAME: PETALUMA
MODEL: 2 BEDROOM - E 771
LOT #:
DESIGNER: KS
DATE: JAN 8 18

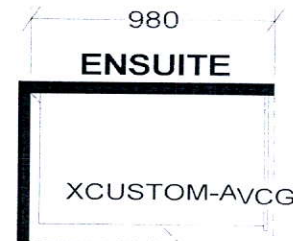
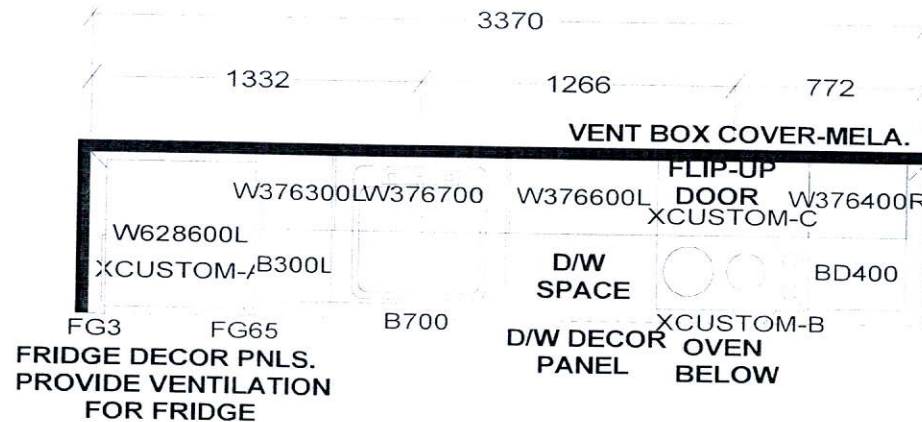

CUSTOM 2 DRAWER VANITY
(Drawers modified to clear plumbing)
FLOATING TOEKICK

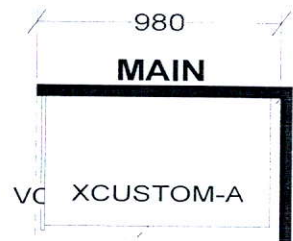

CUSTOM 2 DRAWER VANITY
(Drawers modified to clear plumbing)
FLOATING TOEKICK