

CONSTRUCTION SUMMARY  
DunWest Condo - Perano Residences Ltd.

170746900  
AUG 13 2022

PURCHASER: Izhak ALIASI SINI TEL:

LOT / PHASE 815 / 1	REG. PLAN #	HOUSE TYPE D1442		
------------------------	-------------	---------------------	--	--

CABINETRY

1 - LAUNDRY - HARDWARE - UPGRADE 10Aug22 Note: CODE: BP10746900 MATTE BLACK 162MM	
1 - KITCHEN - CABINETRY - ISLAND - SHALLOW BASE 10Aug22 Note:	
1 - ENSUITE - CABINET HARDWARE - UPGRADE 2 10Aug22 Note: CODE: BP10746900 MATTE BLACK 162MM	
1 - LAUNDRY ROOM - CABINET - UPGRADE - UPPER AND BASE 13Jul22 Note:	
1 - UPGRADE <del>TO 60MM</del> FOR BED 2 ENSUITE - UPGRADE 2 13Jul22 Note: UPGRADE 2 BED 2 ENSUITE CABINET-	
1 - ENSUITE & BEDROOM ENSUITE SOFT CLOSE DOORS AND DRAWERS 13Jul22 Note:	
1 - KITCHEN- BUILT IN FRIDGE PROVISIONS 13Jul22 Note:	
1 - KITCHEN -FULL DEPTH UPPER FOR FRIDGE 13Jul22 Note:	
1 - FEE FOR TWO COLOUR CABINETS IN KITCHEN 13Jul22 Note:	
1 - KITCHEN UPGRADE UPPERS ONLY CABINETS TO ARUBA 13Jul22 Note:	
1 - KITCHEN EXTENTION OF WALL WITH CABINETS 13Jul22 Note:	
1 - MASTER ENSUITE CABINETRY UPGRADE 13Jul22 Note:	
1 - KITCHEN CABINETRY - PROVISION FOR FUTURE WINE FRIDGE - REFER TO SKETCH 13Jul22 Note:	
1 - KITCHEN CABINETRY - ADD DISWASHER PANEL 13Jul22 Note:	
1 - KITCHEN CABINETRY - ADD FRIDGE PANEL - 36 INCH 13Jul22 Note:	
1 - KITCHEN CABINETRY BASE - ISLAND - ADD CABINETS 13Jul22 Note:	
1 - CABINETRY FEE FOR FLUSH CUTOUT ON WALL OVEN/MICROWAVE COMBO CABINET 13Jul22 Note:	
1 - KITCHEN HOOD CABINETS - CONTEMPORARY WOOD HOOD - 13Jul22 Note:	
1 - KITCHEN CABINETRY - BUILT IN MICROWAVE/OVEN COMBO - STANDARD 13Jul22 Note:	
1 - KITCHEN CABINETRY BASE - COOKTOP CABINET WITH POT DRAWERS (2 DRAWERS) - 13Jul22 Note:	
1 - KITCHEN CABINETRY BASE - PULLOUT RECYCLE 2 BIN - PRICE IS EACH 13Jul22 Note:	

CONSTRUCTION SUMMARY  
DunWest Condo - Perano Residences Ltd.

PURCHASER: Izhak ALIASI SINI

TEL:

LOT / PHASE	REG. PLAN #	HOUSE TYPE		
815 / 1		D1442		

1 - KITCHEN CABINETRY BASE - PIE CUT CORNER CABINET - BASE CABINETRY - 13Jul22    Note:	
1 - CABINETRY - KITCHEN - LIGHT VALENCE LED 13Jul22    Note:	
1 - CABINETRY - KITCHEN - MINI STACKED UPPERS 13Jul22    Note:	

CABINETRY ACCESSORIES

1 - KITCHEN - APPLIANCE PULL - PURCHASER TO SUPPLY & INSTALL - FRIDGE & DISHWASHER 10Aug22    Note:	
1 - BEDROOM 1 ENSUITE - CABINET HARDWARE - UPGRADE 2 10Aug22    Note: CODE: BP10746900 MATTE BLACK 162MM	
1 - KITCHEN TOUCH LATCH - UPGRADE 2 10Aug22    Note:	
1 - KITCHEN SOFT CLOSE DOORS AND DRAWERS 13Jul22    Note:	
2 - KITCHEN CABINETRY - SPICE RACK 13Jul22    Note:	

CERAMIC TILE

1 - TILE - UPGRADE 6 FLOOR TILE - PRINCIPAL ENSUITE - SHOWER FLOOR 13Jul22    Note:	
1 - TILE - UPGRADE 6 FLOOR TILE - LAUNDRY - FLOOR 13Jul22    Note:	
1 - TILE - UPGRADE 6 WALL TILE - BEDROOM 1 ENSUITE - WALL & CEILING 13Jul22    Note:	
1 - TILE - UPGRADE 6 FLOOR TILE - BEDROOM 1 ENSUITE - FLOOR 13Jul22    Note:	
1 - TILE - UPGRADE 6 WALL TILE - PRINCIPAL ENSUITE - WALL & CEILING 13Jul22    Note:	
1 - TILE - UPGRADE 6 FLOOR TILE - PRINCIPAL ENSUITE - FLOOR 13Jul22    Note:	
1 - TILE - UPGRADE 6 FLOOR TILE - POWDER 13Jul22    Note:	

CONSTRUCTION

1 - SMOOTH CEILINGS THROUGHOUT 13Jul22    Note:	
1 - DELETE ALL CLOSET SHELVES 13Jul22    Note:	
1 - DELETE ALL FIREPLACE WALLS 13Jul22    Note:	
1 - DELETE ALL STANDARD MIRRORS IN BATHROOMS 13Jul22    Note:	
1 - ATTACHED ALL STRUCTURAL CHANGES - SEE SKETCH 17May22    Note:	

CONSTRUCTION SUMMARY

DunWest Condo - Perano Residences Ltd.

PURCHASER: Izhak ALIASI SINI

TEL:

LOT / PHASE	REG. PLAN #	HOUSE TYPE		
815 / 1		D1442		

1 - ADD HEATED FLOORS IN ALL BATHROOMS FLOORS-  
26Aug21 Note: MAIN BATH, ENSUITE BATH AND POWDER ROOM FLOORS

COUNTER TOP

1 - LAUNDRY ROOM - COUNTERTOP - CASEARSTONE 13Jul22 Note:	
1 - KITCHEN - ISLAND - WATERFALL 13Jul22 Note:	
1 - KITCHEN - UPGRADE - BACKSPLASH - CAESARSTONE 13Jul22 Note:	
1 - KITCHEN - UPGRADE - CAESARSTONE MATERIAL 13Jul22 Note:	
1 - ALL BATH COUNTERTOPS - UPGRADED CAESARSTONE 13Jul22 Note:	
1 - COUNTERTOP - UPGRADED EDGE 13Jul22 Note: KITCHEN, PRINCIPAL ENSUITE & BEDROOM ENSUITE	
1 - POWDER ROOM - ADD CUSTOM COUNTERTOP - SEE SKETCH 13Jul22 Note: 1'-0" HIGH BACKSPLASH AND SIDE RETURN INCLUDED	

DOORS AND TRIM

12 - SOLID CORE INTERIOR DOORS THROUGHOUT CONDO 13Jul22 Note: BERKLEY MASONITE DOOR	
--	--

ELECTRICAL

1 - <del>*** DELETE ***</del> ADD EXTERIOR WALL LIGHTS ON EACH BALCONY - SEE SKETCH 12Aug22 Note: EXTERIOR LIGHTS DELETED	
1 - WINE FRIDGE PROVISION - PROVISION ONLY - ELECTRICAL ONLY 13Jul22 Note:	
1 - ADD ELECTRICAL FOR BUILT IN APPLIANCES 13Jul22 Note:	
4 - <del>ADD EXTERIOR WALL LIGHTS ON EACH BALCONY - SEE SKETCH</del> 13Jul22 Note: DELETED	
1 - KITCHEN - ADD VALENCE LIGHTING - LED 13Jul22 Note:	

FLOORING

1 - UPGRADE LAMINATE - AVENUE SERIES - IN LIEU OF STANDARD 13Jul22 Note:	
---	--

MIRRORS AND GLASS

1 - DELETE ALL STANDARD MIRRORS THROUGHOUT 13Jul22 Note:	
1 - SHOWER ENCLOSURE - FRAMELESS CLEAR GLASS SHOWER DOOR WITH SIDE PANEL TO CEILING FOR 5 FOOT SHOWER - INCLUDES CHROME KNOB & HINGES 13Jul22 Note:	

PAINTING



CONSTRUCTION SUMMARY				
DunWest Condo - Perano Residences Ltd.				
PURCHASER: Izhak ALIASI SINI				TEL:
LOT / PHASE 815 / 1	REG. PLAN #	HOUSE TYPE D1442		
1 - UPGRADE WHITE THROUGHOUT - WALLS, DOORS & TRIM 10Aug22 Note:				

PLUMBING

1 - LAUNDRY - FAUCET - KEELE - SINGLE HANDLE PULL DOWN KITCHEN FAUCET - MODEL # 940LF-BL - MATTE BLACK FINISH 10Aug22 Note:	
2 - MASTER ENSUITE & BEDROOM 1 ENSUITE - SHOWER FIXTURE - BLACK FINISH - REFER TO ATTACHED SPECIFICATIONS 10Aug22 Note: MASTER ENSUITE: SHOWERHEAD TO BE INSTALLED FROM THE CEILING (RAIN SHOWER HEAD W 4" HIGH FLANGE)  SHOWER KIT W SLIDE BAR SHOWER HEAD TRIM W ARM & HEAD ROUGH R10000-UNUS DOVERTER TRIM SLIDE BAR WALL TOE TESTER  *****CONFIRM ABOVE CODES IN BLACK FINISH *****	
3 - MASTER ENSUITE & BEDROOM 1 - PIVOTAL - TWO HANDLE WIDESPREAD BATHROOM FAUCET - MODEL # 3599LF-BLMPU - BLACK FINISH 10Aug22 Note: 3 SINKS TOTAL	
1 - POWDER ROOM - PIVOTAL TWO HANDLE WALL MOUNT BATHROOM FAUCET TRIM - MODEL # T3599LF-BLWL - BLACK FINISH 10Aug22 Note: ROUGH IN R3500-WL	
1 - KITCHEN UNDERMOUNT SINK - BLANCO QUARTUS R15 U MEDIUM #401517 13Jul22 Note: LAUNDRY	
1 - KITCHEN - UNDERMOUNT SINK - BLANCO QUATRUS R15 U I 3/4 13Jul22 Note:	
4 - ALL BATH VANITY UNDERMOUNT SINKS TO BE COLLETTE 422CIY 13Jul22 Note:	
1 - KITCHEN – WATERLINE ROUGH-IN FOR FRIDGE 13Jul22 Note:	
1 - TOE TESTER FOR SHOWER 13Jul22 Note:	
1 - RELOCATE- KITCHEN SINK TO ISLAND- SEE SKETCH 26Aug21 Note:	

EXTRAS AS PER OFFER

1 Parking Unit Worksheet Note:	
-----------------------------------	--

This Document is Extremely Time Sensitive - Printed 19 Aug 22 at 10:47

Purchaser: Izhak ALIASI SINI

Const. No.: Unit 14, Level 8

Telephone Res. / Bus: /

Municipal: 815

Decor Advisor: Aly Aversa

Suite Type: D1442

Lock Date: 8/10/2022 16:09:20

Project/Phase: Perano Residences Ltd./1

Layout Changes: ☒ Yes ☐ NoSketch Attached: ☒ Yes ☐ No

## 1. Kitchen and Vanities

	Style and Colour	Hardware
Kitchen	SEE BELOW	N/A
Main Bathroom	ARUBA 614 CRISP WHITE	SEE BELOW
Master Ensuite Bathroom	DORAL K43 SUMMIT WHITE	SEE BELOW
POWDER ROOM	N/A	N/A
Laundry	DORAL K43 SUMMIT WHITE	SEE BELOW
Built In Appliances <input checked="" type="radio"/> Yes <input type="radio"/> No		Kitchen Extended Upper Cabinets <input checked="" type="radio"/> Yes <input type="radio"/> No

## Comment

\*\* Refer to Construction Summary \*\*\* KITCHEN: UPPER: ARUBA 614 CRISP WHITE / STOVE WALL ONLY: DORAL K43 SUMMIT WHITE / BASE & ISLAND: ARUBA 614 CRISP WHITE

## 2. Counters

	Counter	Edge
Kitchen	CASEARSTONE - ORAGNIC WHITE 4600 INCLUDES ISLAND & WATERFALL	#360
Main Bathroom	CASEARSTONE - ORAGNIC WHITE 4600	#360
Master Ensuite Bathroom	CASEARSTONE - PURE WHITE 1141	#360
POWDER ROOM	CASEARSTONE - ALPINE MIST 5110/12 INCH BACKSPLASH & SIDE SPLASH	SEE SKETCH
Laundry	CASEARSTONE - PURE WHITE 1141	#360
Kitchen Backsplash	CASEARSTONE - ORAGNIC WHITE 4600	

## Comment

\*\* Refer to Construction Summary

## 3. Flooring

	Selection
Vestibule/Main Hall	LAMINATE-AVENUE-MELROSE OAK-TLAV232-PEFC
Kitchen	LAMINATE-AVENUE-MELROSE OAK-TLAV232-PEFC
Living Room/Dining Room	LAMINATE-AVENUE-MELROSE OAK-TLAV232-PEFC
Den/Office	LAMINATE-AVENUE-MELROSE OAK-TLAV232-PEFC
Master Bedroom	LAMINATE-AVENUE-MELROSE OAK-TLAV232-PEFC
Bedroom #2	LAMINATE-AVENUE-MELROSE OAK-TLAV232-PEFC
Bedroom #3	N/A
M.Ensuite Shower Floor	TILE - PURITY MARFIL LUX 12X12 MOSAIC / GROUT: PROMA: 52 FRENCH VANILLA
Laundry Room	TILE - PURITY MARFIL LUX 12X24 / GROUT: PROMA: 52 FRENCH VANILLA
Main Bath	TILE - PURITY MARFIL LUX 12X24 / GROUT: PROMA: 52 FRENCH VANILLA
Master Ensuite Bathroom	TILE - PURITY MARFIL LUX 12X24 / GROUT: PROMA: 52 FRENCH VANILLA
Powder	TILE - PURITY ONYX PEARL LUX 12X24 / GROUT: PROMA: 50 TITANIUM

## Comment

UPGRADE GROUT: SEE ABOVE

## 4. Wall Tile

	Selection	Describe
Main Bath	TILE - PURITY MARFIL LUX 12X24 (INCLUDES CEILING)	GROUT: PROMA: 52 FRENCH VANILLA
Master Ensuite Bathroom	TILE - PURITY MARFIL LUX 12X24 (INCLUDES CEILING)	GROUT: PROMA: 52 FRENCH VANILLA

Kitchen Backsplash CASEARSTONE - ORAGNIC WHITE 4600

## Comment

\*\* Refer to Construction Summary - Standard Grout throughout unless specified

Initial: 

Page 1 of 2



INTERIOR COLOUR SCHEME

Purchaser: Izhak ALIASI SINI  
Telephone Res. / Bus: /  
Decor Advisor: Aly Aversa  
Lock Date: 8/10/2022 16:09:20

Const. No.: Unit 14, Level 8  
Municipal: 815  
Suite Type: D1442  
Project/Phase: Perano Residences Ltd./1

5. Misc

Water Line Rough-in for Fridge ☒ Yes ☐ No  
Upgrade Bathroom Accessories ☐ Yes ☒ No  
Comment  
\*\* Refer to Construction Summary

6. Wall, Trim and Door Paint - Birch White Paint Throughout unless specified below.

Entrance Vestibule	UPGRADE WHITE	Living Room	UPGRADE WHITE
Main Hall	UPGRADE WHITE	Dining Room	UPGRADE WHITE
Kitchen	UPGRADE WHITE	Den/Library	UPGRADE WHITE
Laundry Room	UPGRADE WHITE	Master Bedroom	UPGRADE WHITE
Main Bathroom	UPGRADE WHITE	Bedroom #2	UPGRADE WHITE
Master Ensuite Bathroom	UPGRADE WHITE	Bedroom #3	N/A

Comment

INTERIOR DOORS: BERKLEY SOLID CORE. INTERIOR DOOR HARDWARE: STANDARD.

7. General Comments

\*\* Refer to Construction Summary

Disclaimers and Notes

- 1) Colours of all materials are as close as possible to builder's selection, but not necessarily identical due to variances in manufacturing.
- 2) The selection images are digital photographs of the Vendor's samples at its Decor Centre. Such images when displayed on your computer monitor may not match Decor Centre samples due to the hardware/software configuration of the computer. In the event of conflict between selection images and the Décor Centre samples, Décor Centre samples shall prevail.
- 3) Any extras listed above are null and void unless accompanied by a separate invoice/amendment. Said invoice must be paid in full.
- 4) The Purchaser agrees that this colour selection is final and that no changes will be permitted, unless required by the Vendor.
- 5) The Purchaser acknowledges reading and accepting document which contains other miscellaneous disclaimers.

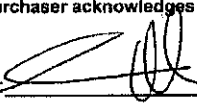
Signature:  Date: \_\_\_\_\_ Signature: \_\_\_\_\_ Date: \_\_\_\_\_

Aug 14/2022

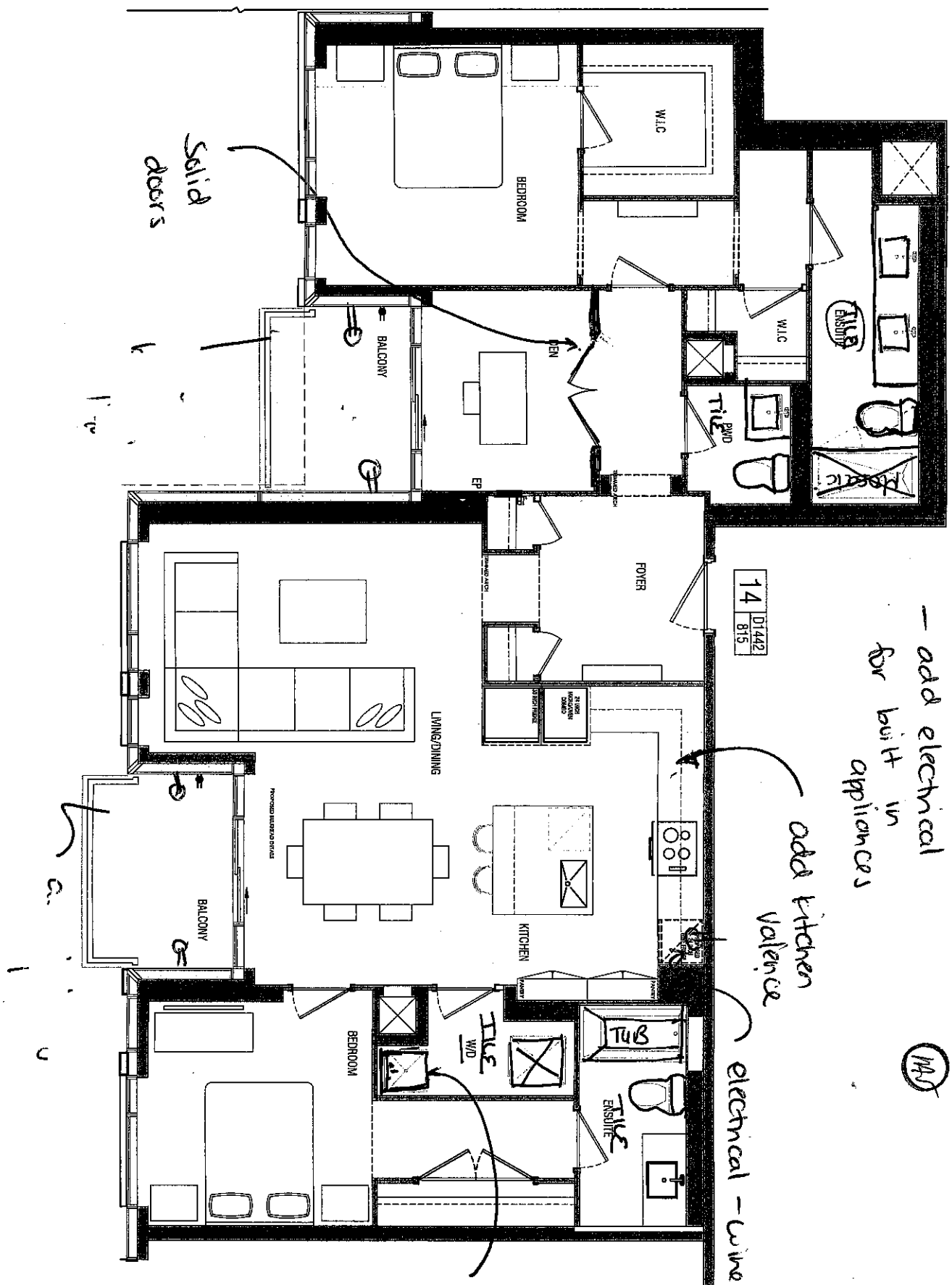

144

add  
sink +  
counter +  
cabinet  
refer to  
construction  
summary

Greepark  
CONSTRUCTION



PROJECT NAME:  
DUNWEST CONDO

LOT: SUITE 815

BY: A.AVENSA

DATE: MAY 18TH 2022

SCALE: 3/16" = 1'-0"

SHEET TITLE:

FLOOR PLAN

SHEET NUMBER:

See Construction Summary - for all Upgrades

1 SoftClose Doors

2. L.V.

3. Mini Stacked Uppers

FILE NAME:

DUNWEST SUITE 815-JUN 8 22

LEIGH C/O PAULINE

CHECKED BY PB-MAR 23 22

REV MAR 31 22 PB

UPPER CABINETS CUSTOM HEIGHT/DEPTH

Suite 815 - Dunwest.

# SUITE 815 Dunwest

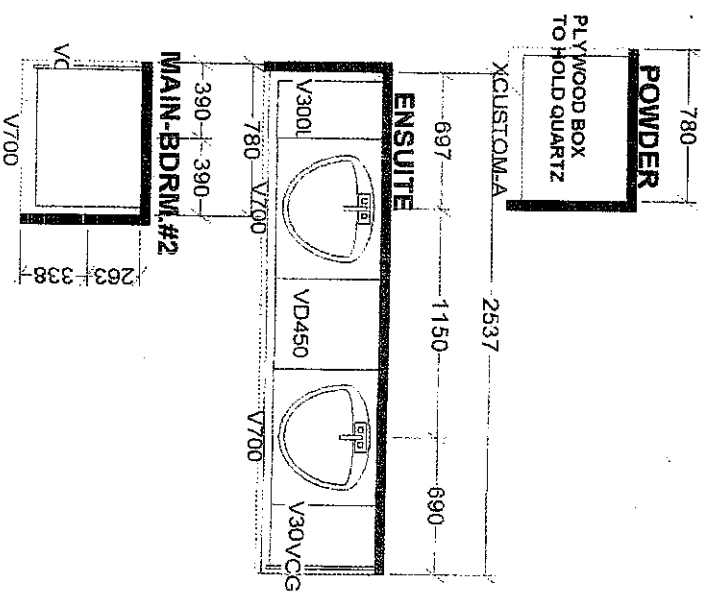
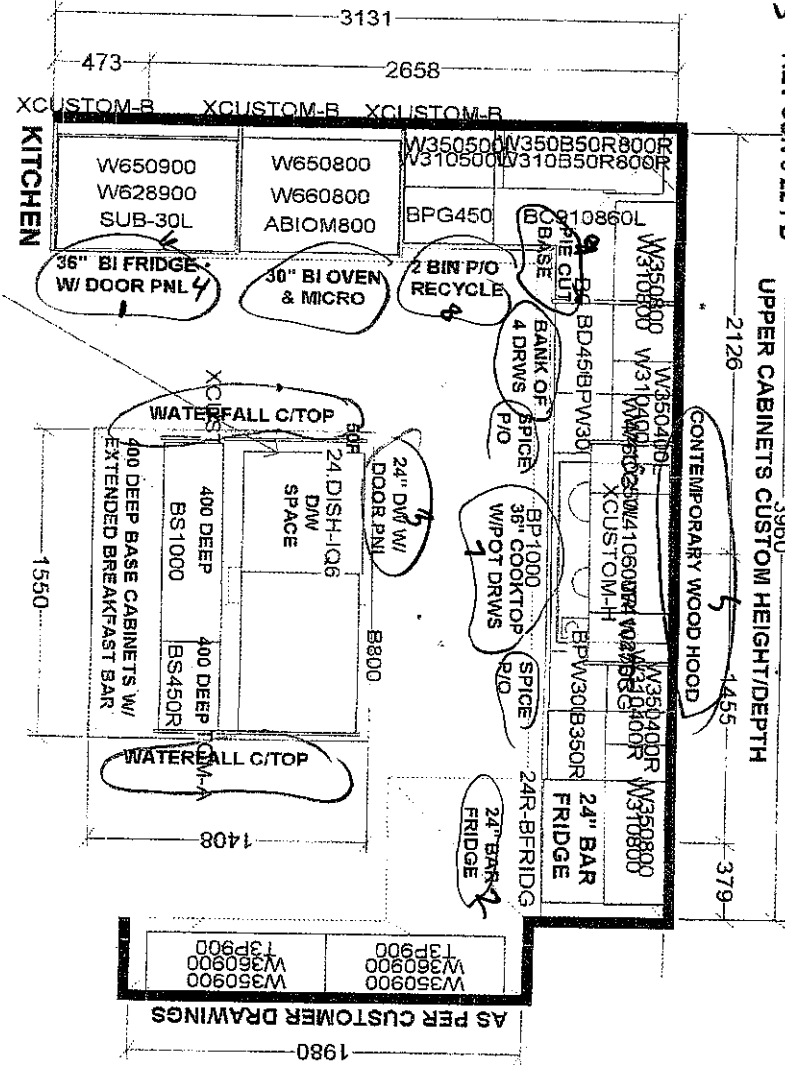

PROVIDE PROVISION FOR PLUG CUT-OUT BOTH ENDS OF ISLAND

SINK & DW/RELOCATED TO ISLAND / SITE INSTRUCTION #38

W WIDTH	W HGT	W CNT	W CHT
FLOOR HGT	DOOR HGT		
ST CENT	2X4	VENT BOX COVER	

**Selba Industries**

This drawing is the intellectual property of SELBA INDUSTRIES INC. and is not to be reproduced, copied, or used in any way without the written permission of Selba Industries Inc. or its affiliates. Original design which must not be released or copied unless applicable fee has been paid.

DESIGNER: KS  
DATE: NOV 24 2016/rev'd NOV 29 21  
REV'd Feb 4 22/arch review  
REV'd Feb 28 22

JOB NUMBER:  
BUILDER: GREENPARK  
SITE: PERANO (Dunwest), Oakville  
MODEL: 2 BD+D-D1442 UNIT #815  
LOT #:

Laundry Room \*

145



Suite 815  
Dunwoody

(x3)

PIVOTAL

# Two Handle Widespread Bathroom Faucet

MODEL#: 3599LF-BLMPU

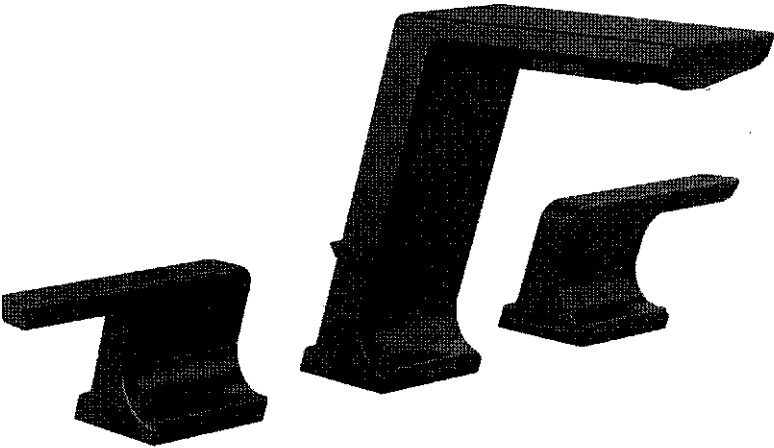

- 3-Hole Installation
- Metal drain pop-up assembly in matching finish included
- Backed by Delta Faucet's Lifetime Limited Warranty



WaterSense® Labeled

Finish: Matte Black



\$

ENSuite X2  
MAIN X1

The confident slant of the Pivotal Bath Collection makes it a striking addition to a bathroom's contemporary geometry for a look that makes a statement. You can install with confidence, knowing that Delta faucets are backed by our Lifetime Limited Warranty. Delta WaterSense labeled faucets, showers and toilets use at least 20% less water than the industry standard-saving you money without compromising performance.

- Fits 3-hole 8-16 in. installations
- Includes matching finish metal pop-up drain assembly
- ADA Compliant
- WaterSense labeled faucet uses at least 20% less water than the industry standard without compromising performance
- Rigid spout

### Special Features

 ADA Compliant ⓘ

 Chat with an Expert

**Anne Federico**

**From:** Deborah Di Giovanni <deb@centonsales.com>  
**Sent:** Wednesday, August 10, 2022 10:20 AM  
**To:** Anne Federico  
**Cc:** Michael Misasi  
**Subject:** RE: PIVOTAL BLACK

You can see the model #s there.

SUITE 815

MAIN  
BATH

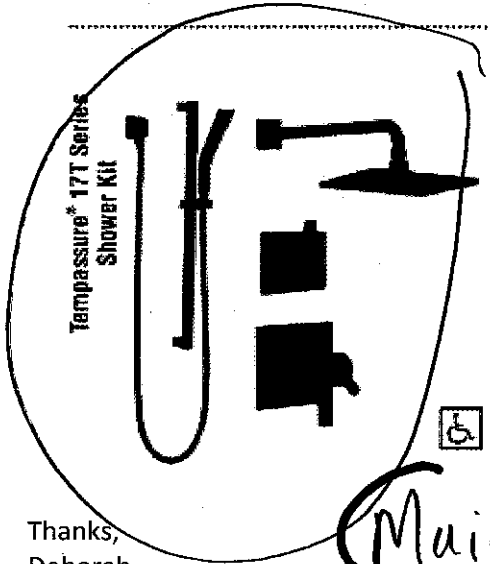

**Pivotal TempAssure 17T Series Shower Kit**

DF-KIT20-BL-WS

Matte Black

**Includes:**

T17T299-BL	Shower only trim
R10000-UNWS	MultiChoice Universal rough-in with stops
T11899-BL	Diverter trim
R11000	Diverter rough
51799-BL	Wallbar hand shower
50570-BL	Wall elbow



Valve control only ADA

Thanks,  
Deborah

DEBORAH DI GIOVANNI  
Centon Sales  
905.629.7072  
[www.centonsales.com](http://www.centonsales.com)

Main Bath:  
Suite 805

Follow us on Social Media



**From:** Michael Misasi <michaelm@centonsales.com>  
**Sent:** Wednesday, August 10, 2022 9:27 AM  
**To:** Deborah Di Giovanni <deb@centonsales.com>  
**Subject:** Fwd: PIVOTAL BLACK

Deb can you please provide the mode  
Numbers for Anne please

Anne Federico

From: Deborah Di Giovanni <deb@centonsales.com>  
Sent: Wednesday, August 10, 2022 10:20 AM  
To: Anne Federico  
Cc: Michael Misasi  
Subject: RE: PIVOTAL BLACK

Suite 801 -  
Dunwest -

Hi Anne,  
Is this the kit? You can see the model #s there. And the ceiling mount shower arm is



RP61058-BL

Install  
From Ceiling: Master Ensuite

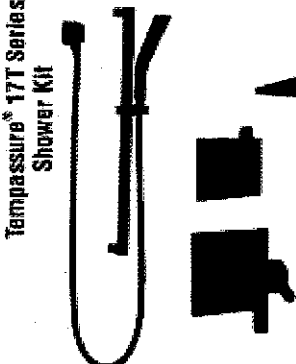

TempAssure® 17T Series Shower Kit

**Pivotal® TempAssure® 17T Series Shower Kit**

DF-KIT20-BL-WS      Matte Black

**Includes:**

T17T299-BL	Shower only trim
R10000-UNWS	MultiChoice® Universal rough-in with stops
T11899-BL	Diverter trim
R11000	Diverter rough
51799-BL	Wallbar hand shower
50570-BL	Wall elbow

 Valve control only ADA

Thanks,  
Deborah

DEBORAH DI GIOVANNI  
Centon Sales  
905.629.7072  
[www.centonsales.com](http://www.centonsales.com)

Follow us on Social Media

From: Michael Misasi <michaelm@centonsales.com>  
Sent: Wednesday, August 10, 2022 9:27 AM  
To: Deborah Di Giovanni <deb@centonsales.com>  
Subject: Fwd: PIVOTAL BLACK

Deb can you please provide the mode  
Numbers for Anne please

Suite 815 Dunbart

Shower Main +  
Master  
(x2)

# Shower Kit

MODEL#: DF-KIT20-BL-WS

Finish: Matte Black

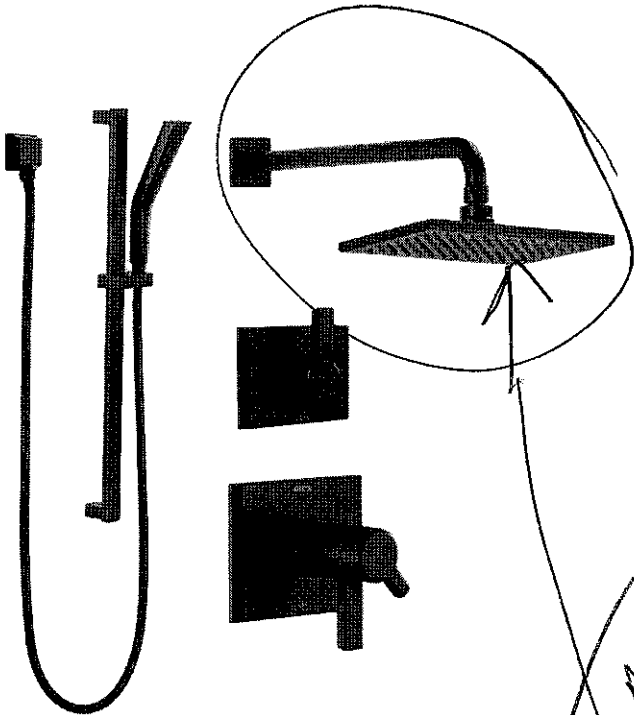

Pivotal.

\$  
Master Ensuite  
to Be Install  
in ceiling

Chat with an Expert

Laundry (x1)

Suite 815  
Dunwoood

KEELE

# Single Handle Pull Down Kitchen Faucet

MODEL#: 940LF-BL

Finish: **Matte Black**

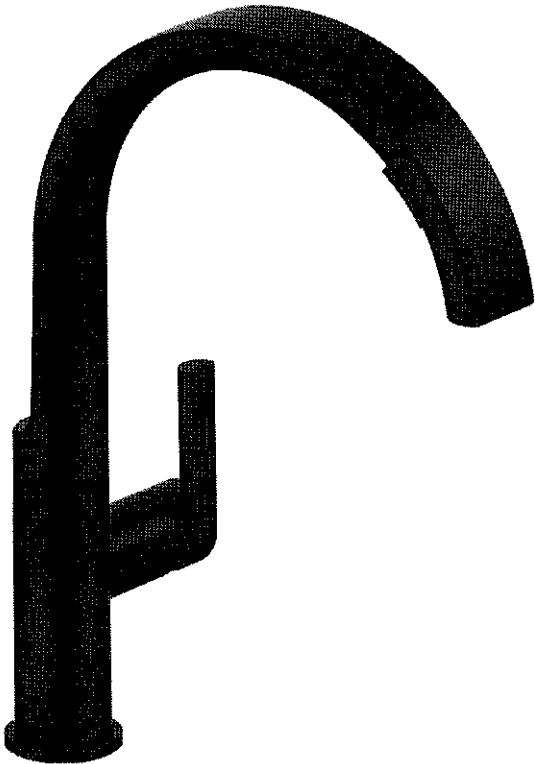
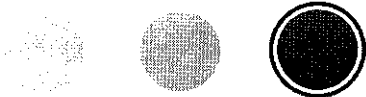

\$

 Chat with an Expert

Powder

PIVOTAL

Suite 815 Dunwoody

# Two-Handle Wall Mount Bathroom Faucet Trim

MODEL#: T3599LF-BLWL

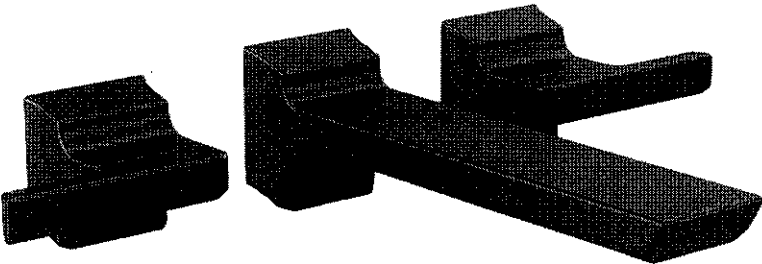

- Must purchase rough-in R3500-WL separately for installation
- Bathroom faucet requires 3-hole 8" wall-mount installation
- Delta bathroom faucet backed by Delta's Lifetime Limited Warranty

\$



WaterSense® Labeled

Finish: **Matte Black**



**Rough Valve**

Chat with an Expert

1A3

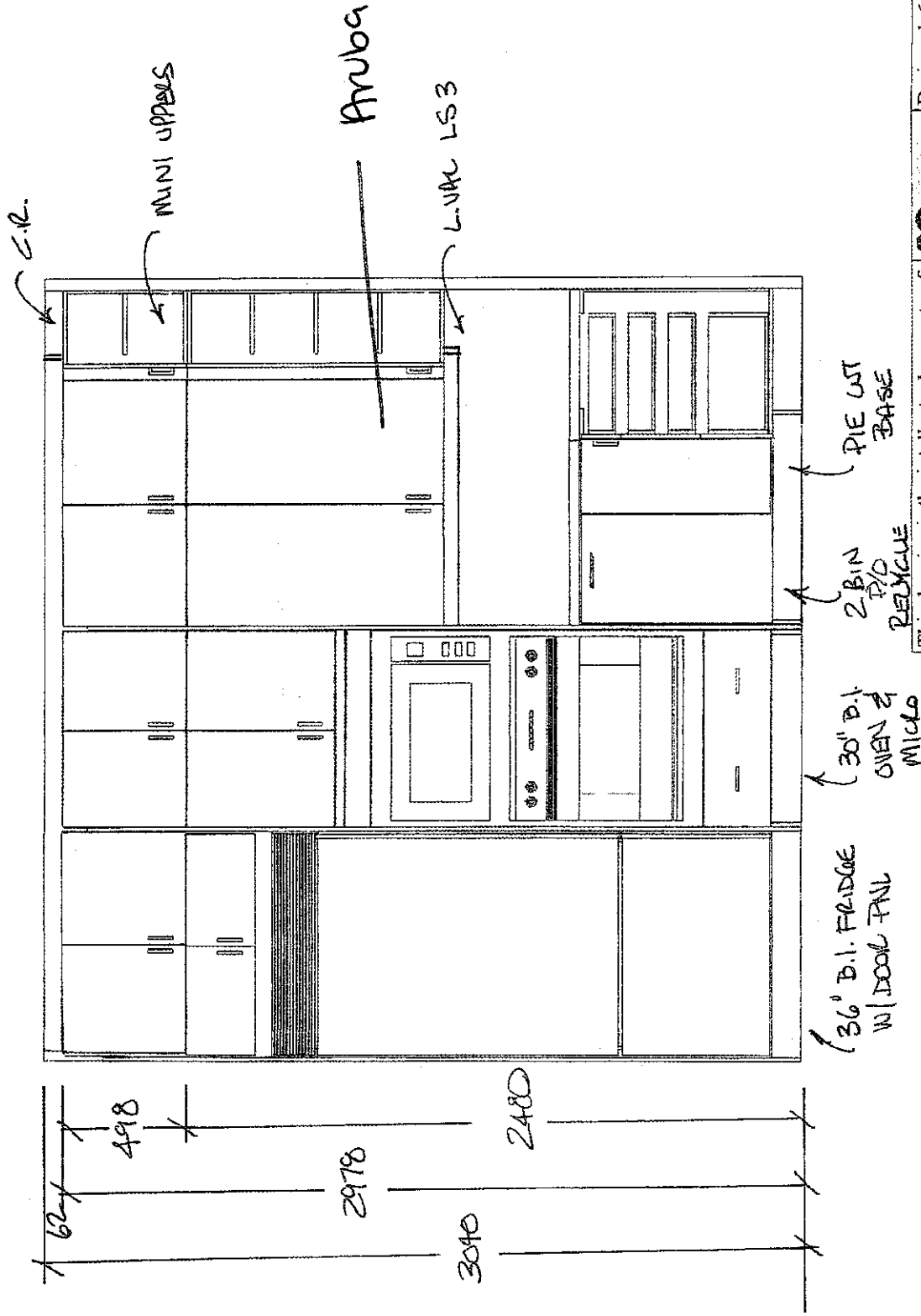

Designed: 6/8/2022  
Printed: 6/9/2022

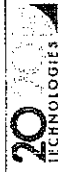

This drawing is the intellectual property of SELBA INDUSTRIES INC. and is an artistic interpretation of the general appearance of the design. It is not meant to be an exact rendition.

FRIDGE WALL

LAYOUT

Drawing #: 1

SUITE 815-JUN 8 22

141

CONTEMPORARY HOOD  
VALANCE X 5

← C.R.

MINI  
UPPERS

Doral

Ambo

← L.VAL L53

← Straight

← 24" BAL  
FRIDGE

← SPICE  
P/O

← 36" COOKTOP  
W/ POT DRAWS

← SPICE  
P/O

← B/D

← PIE CUT  
BASE

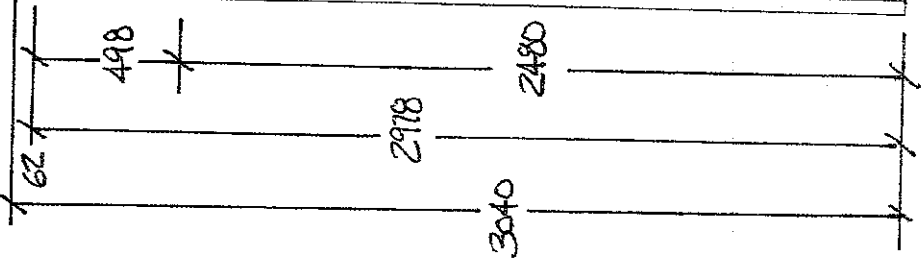

	Designed: 6/8/2022
	Printed: 6/9/2022
This drawing is the intellectual property of SELBA INDUSTRIES INC. and is an artistic interpretation of the general appearance of the design. It is not meant to be an exact rendition.	STONE WALL
	SUITE 815-JUN 8 22
LAYOUT	Drawing #: 1



← C.R.

← MINI UPBES

← Anuba

(A)

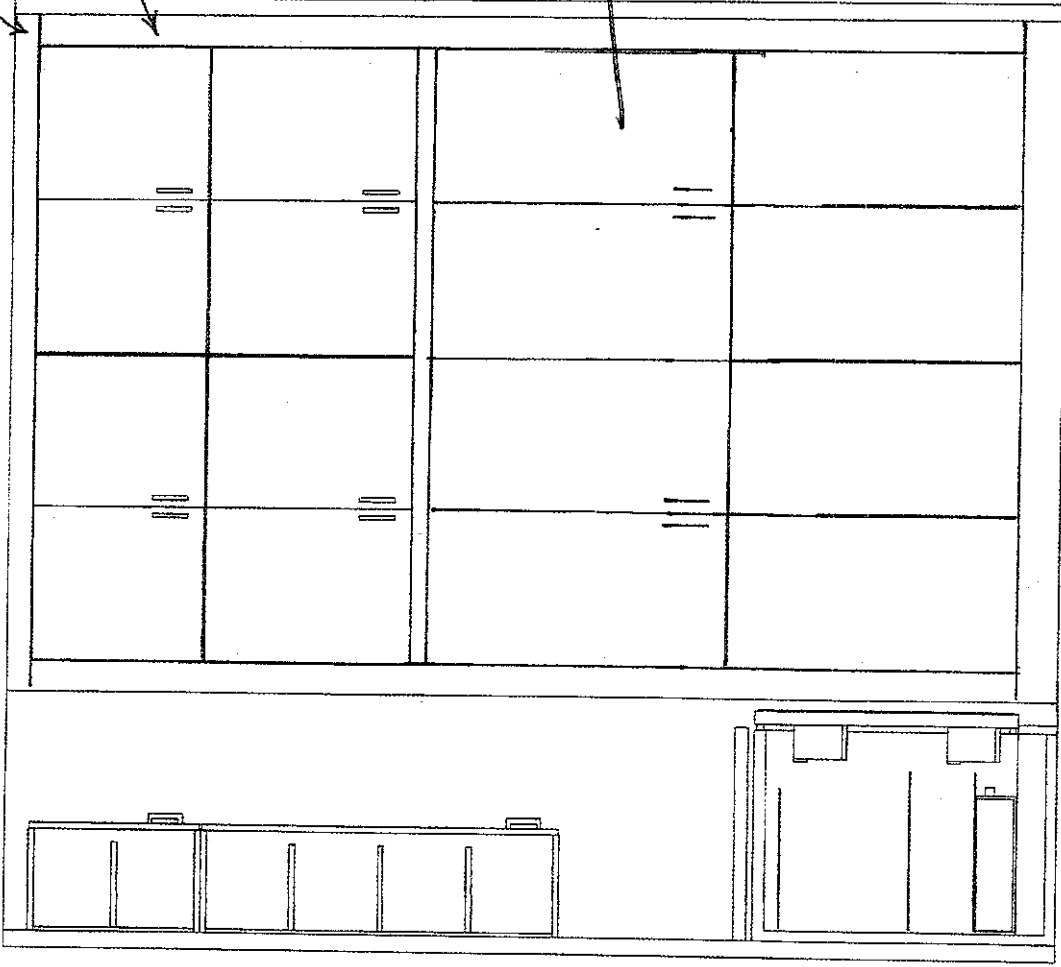

12" DEEP  
PANTRIES

This drawing is the intellectual property of SELBA INDUSTRIES INC. and is an artistic interpretation of the general appearance of the design. It is not meant to be an exact rendition.		Designed: 6/8/2022 Printed: 6/9/2022
		PAINTER WAA
SUITE 815-JUN 8 22		LAYOUT Drawing #: 1

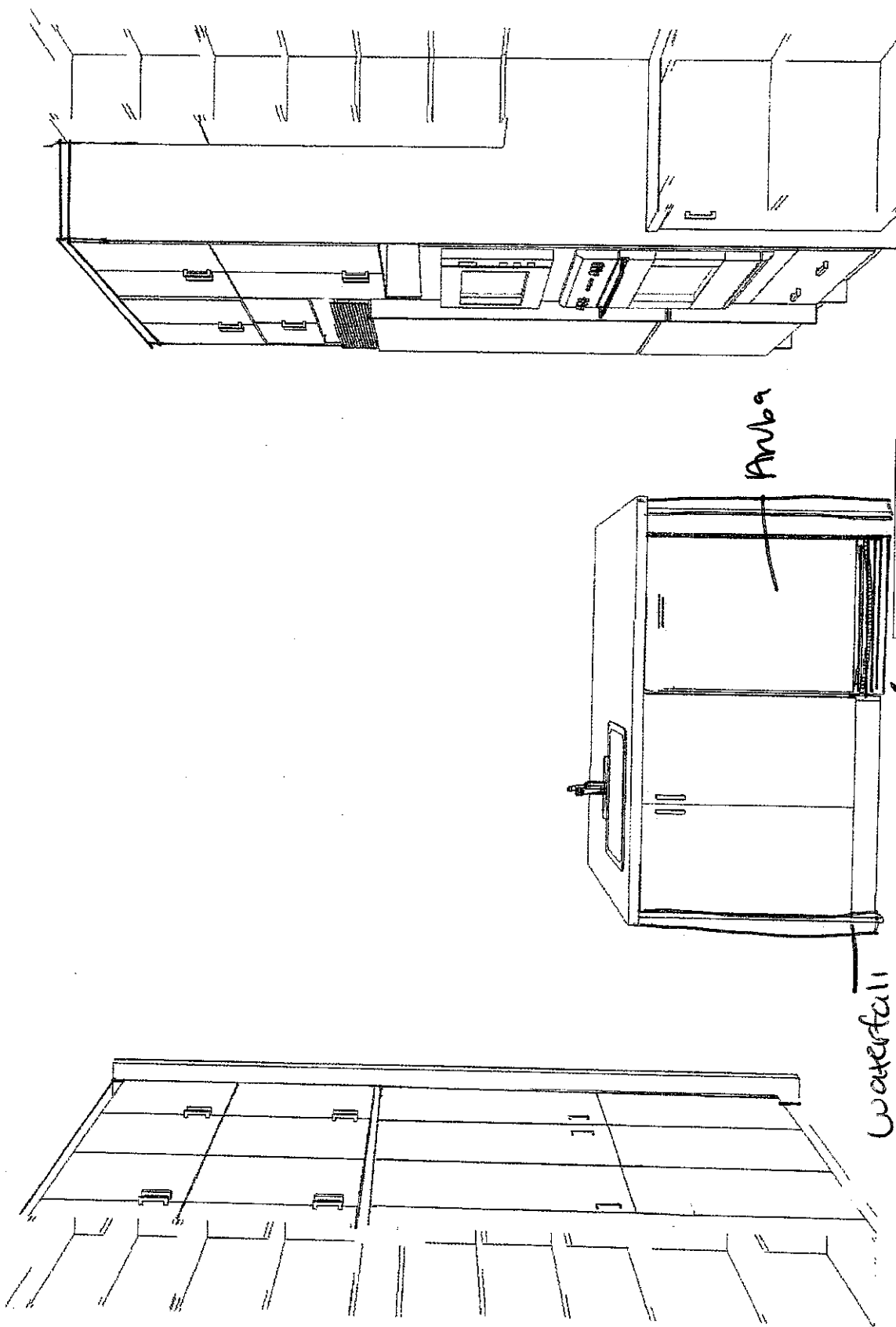

Designed: 6/8/2022  
Printed: 6/9/2022

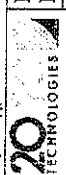

This drawing is the intellectual property of  
SELBA INDUSTRIES INC. and is an  
interpretation of the general  
appearance of the design. It is  
not meant to be an exact rendition.

INSIDE ISLAND  
VIEW

LAYOUT Drawing #: 1

SUITE 815-JUN 8 22

waterfall

Anba

24" DW artistic  
w/door  
PNL

## Suite 815 Dunwest



Specifications for Project

Isaac UNIT 815 DUNWEST

Location

Vaughan

905-303-6909

**i REMINDER:** To ensure a smooth project it is the responsibility of the homeowner / purchaser of appliances for this project to share all the attached specifications to ensure the cabinet provider, contractor, or any other tradesperson have all the information required to complete their work accurately.

Specifications are subject to change. If any tradesperson has questions regarding the attached specifications please contact our sales associate.

Powered by SteelCod

Suite 815  
Dunwest

PAGE 2 of 18

Full Spec Package

Isaac UNIT 815 DUNWEST

Models	Pages
<b>G 7966 SCVi</b> Miele Dishwasher  G 7966 SCVi 24" Fully Integrated Dishwasher K2o	4-5
<b>H 7670 BM</b> Miele Wall Oven	6-8
<b>KM5860208V</b> Miele Cooktop	9-12
<b>H 7680 BP</b> Miele Wall Oven	13-15
<b>KF 2912 Vi</b> Miele Refrigeration  SKU: 11502940	16-22
<b>WKEX200HBA</b> LG Washer-Dryer	23
<b>ETR634SS</b>	24-25

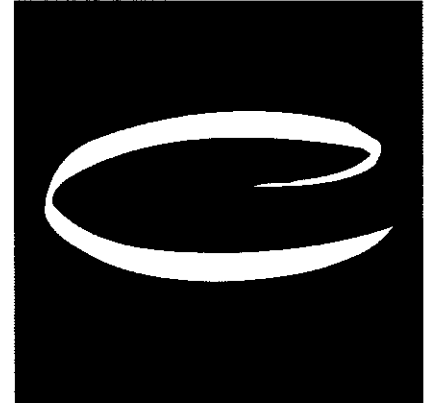

**Coast Appliances**

coastappliances.com

**Andrew Haidari**

Commercial Sales Representative

905-303-6909

Search **20220307174935669SC**

Version 1.1

Mon, Mar 7, 2022

12:49 PM EST

To ensure a smooth project it is the responsibility of the homeowner / purchaser of appliances for this project to share all the attached specifications to ensure the cabinet provider, contractor, or any other tradesperson have all the information required to complete their work accurately.

Specifications are subject to change. If any tradesperson has questions regarding the attached specifications please contact our sales associate.



[enterprise.steelcod.com/sp/csta/MBAQ23Q5](https://enterprise.steelcod.com/sp/csta/MBAQ23Q5)

**Note about page numbers:**

Because the original manufacturer's documents are not altered in any way, the page numbers displayed on the page may not correspond to the page number within this package.

**All specifications are intended for initial planning purposes only.**

Manufacturers reserve the right to change specifications at any time without notice. Always consult the installation instructions found on the manufacturer's website or included with the appliances before installation.

# PAGE 3 of 18

## SUITE 815 Dunwest

Full Spec Package

Elica Insert Hood

Trento 34" 600 cfm

**Note about page numbers:**

Because the original manufacturer's documents are not altered in any way, the page numbers displayed on the page may not correspond to the page number within this package.

**All specifications are intended for initial planning purposes only.** Manufacturers reserve the right to change specifications at any time without notice. Always consult the installation instructions found on the manufacturer's website or included with the appliances before installation.

Suite 815  
Dunwest

PAGE 4 of 18



G 7966 SCVi  
24" Fully Integrated Dishwasher K2o

Features:

- AutoDos - an integrated automatic detergent dispensing system
- M Touch Vi Controls - an intuitive touch display
- QuickIntenseWash - a full wash and dry cycle in 58 minutes
- 40 dBa (38 dBa when using ExtraQuiet)
- 3D MultiFlex Cutlery Tray
- Panel-Ready
- WifiConn@ct
- Knock2Open
- Water Softener
- EnergyStar

MATERIAL #
11388300

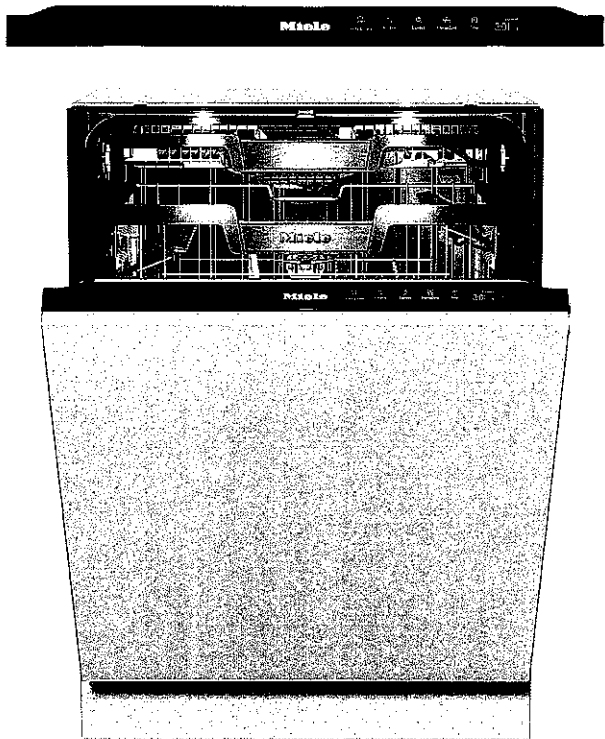

SPECIFICATIONS	
Overall Unit Dimensions	23 <sup>9</sup> / <sub>16</sub> " (598 mm) W x 33 <sup>11</sup> / <sub>16</sub> " - 36 <sup>1</sup> / <sub>4</sub> " (855 - 920 mm) H x 22 <sup>7</sup> / <sub>16</sub> " (570 mm) D [Depth does not include door panel]
Niche	
Minimum Cabinet Niche Opening	23 <sup>5</sup> / <sub>8</sub> " (600 mm) W x 33 <sup>3</sup> / <sub>4</sub> " (857 mm) H x 22 <sup>7</sup> / <sub>16</sub> " (570 mm) D
Plumbing	
Water Supply Requirements	<ul style="list-style-type: none"><li>• Cold or Hot (max 150°F/65°C) water connection</li><li>• Male 3/8" compression fitting</li><li>• Water pressure range 7.25 psi (0.5 bar) and 145 psi (10 bar)</li></ul>
Water Connection Line (Supplied)	Length: 5 ft (1.5 m) Female 3/8" compression.
Drain Hose (Supplied)	Length: 5 ft (1.5 m) 7/8" (22 mm) internal diameter
Electrical	
Electrical Requirements	110V / 120V, 60Hz, 15 Amps
Power Cord (Convertible to hardwire)	NEMA 5-15 plug, 5 ft (1.52 m)
Shipping	
Shipping Weight	121 lbs (55 kg)
Shipping Dimensions	27 <sup>1</sup> / <sub>8</sub> " W x 38 <sup>1</sup> / <sub>8</sub> " H x 26 <sup>3</sup> / <sub>8</sub> " D

PRODUCT DIMENSIONS

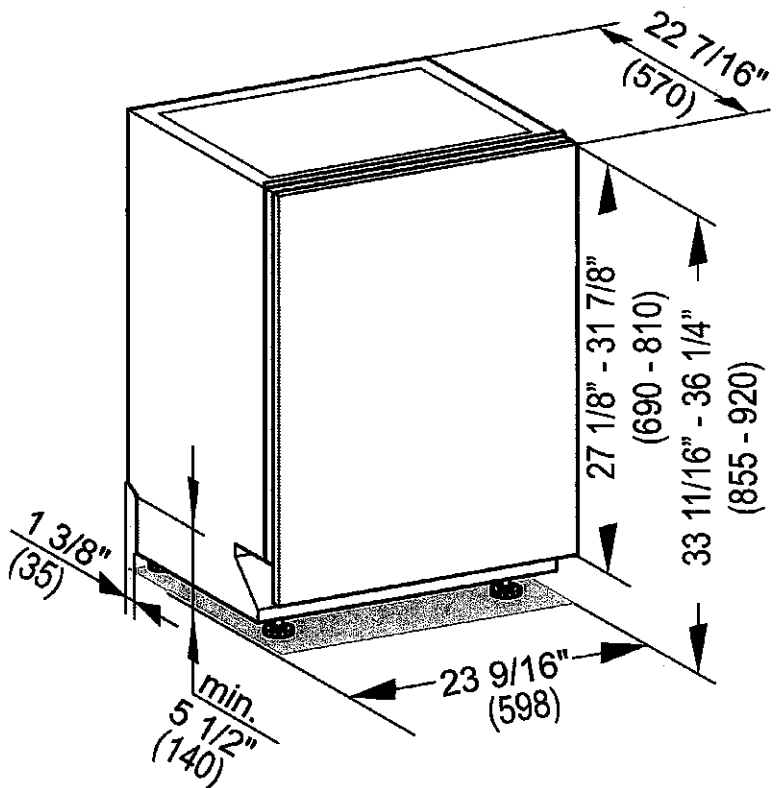

**Miele**

CUTOUT DIMENSIONS

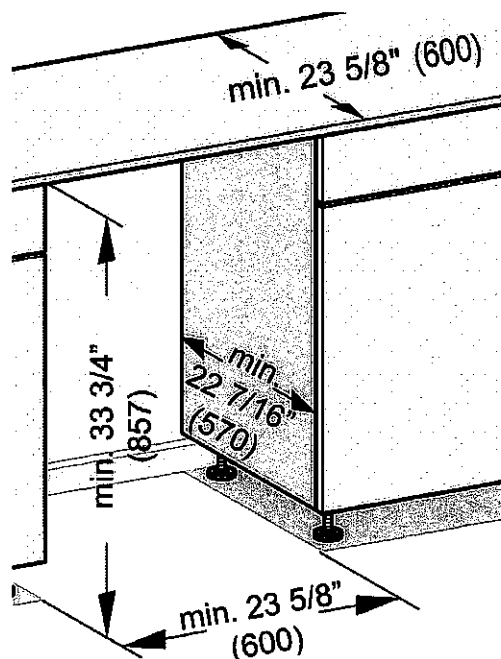

CUSTOM PANEL

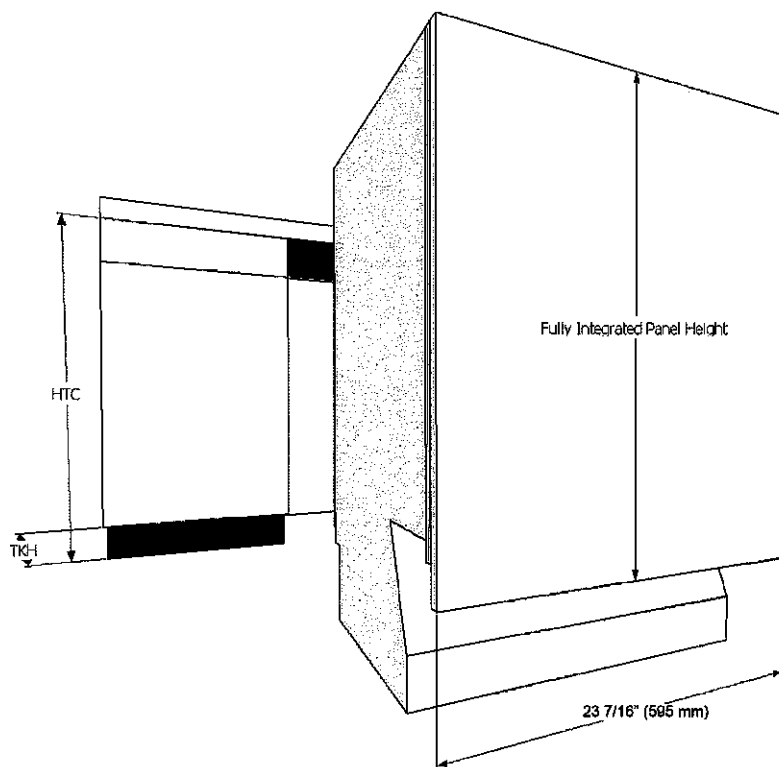

**Width:** 23 7/16" (595 mm) in all Cases  
**Thickness:** 3/4" (19 mm) in all Cases  
**Height:** Determined using the following calculation:

$$\text{Panel Height} = \text{HTC} - \text{TKH}$$

**HTC** = Height to the underside of countertop  
**TKH** = Toe kick height

**Note:** Control panel is along the top edge of the unit. It is not visible when the unit is closed. A handle **MUST** be located on front of panel in order to open unit. (Except K2o models).

Maximum panel height: 31 7/8" (810 mm)

Minimum panel height: 27 1/8" (690 mm)

Maximum panel weight: 24 lbs (11 kg)



H 7670 BM  
30" Speed Oven - PureLine

Features:

- Speed ovens combine the functionality of a microwave and compact convection oven into one appliance
- M-Touch S Display - Simple to use touch controls
- WifiConn@ct - Monitor appliances from your mobile device
- Motion React - Appliance reacts to you when approached
- Roast Probe - Precise temperature control of food
- Automatic programs - easily master new recipes

Included:

- 1 Baking and Roasting Rack with Perfect Clean
- 1 Glass Dish

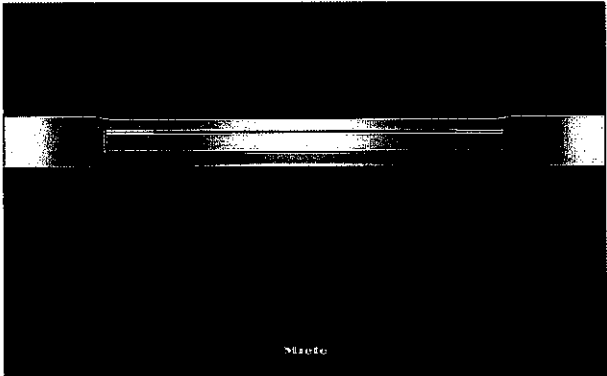

MATERIAL #
11804610

SPECIFICATIONS	
Overall Unit Dimensions	29 <sup>13</sup> / <sub>16</sub> " (757 mm) W x 18 <sup>7</sup> / <sub>8</sub> " (479 mm) H x 21 <sup>1</sup> / <sub>16</sub> " (551 mm) D
Niche	
Minimum Cabinet Niche Opening	18 <sup>1</sup> / <sub>2</sub> " (470 mm) W x 28 <sup>1</sup> / <sub>2</sub> " (724 mm) H x 24" (610 mm) D
Electrical	
Electrical Requirements	120/208-240V, 60Hz, 30 Amps
Power Cord	NEMA 14-30 plug, 5 ft (1.52 m)
Shipping	
Shipping Weight	128 lbs (58 kg)
Shipping Dimensions	30 <sup>5</sup> / <sub>8</sub> " (777 mm) W x 29 <sup>1</sup> / <sub>4</sub> " (743 mm) H x 32 <sup>1</sup> / <sub>8</sub> " (837 mm) D

PRODUCT DIMENSIONS

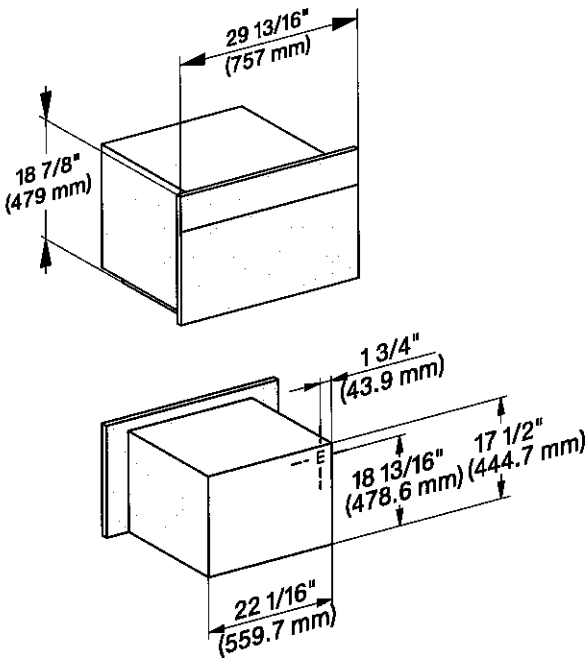

E = Electrical connection



# SUTTE B15 Dunwest

PAGE  
7 of 18

**Miele**

## FLUSH CUTOUT DIMENSIONS

Front View

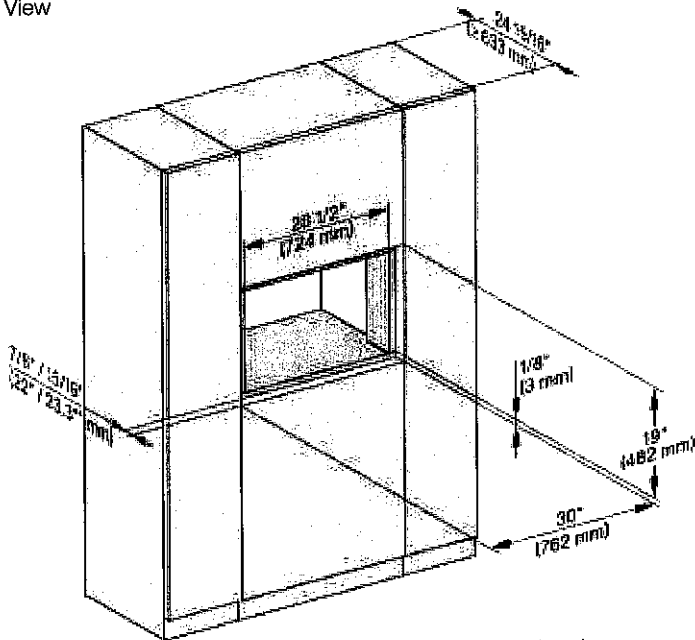

Side View

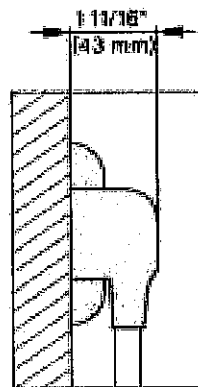
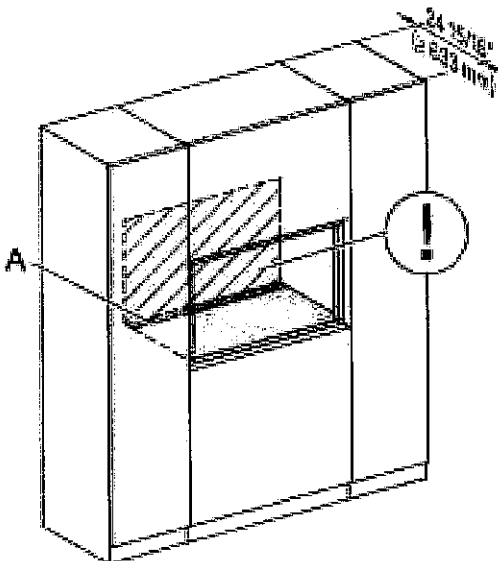
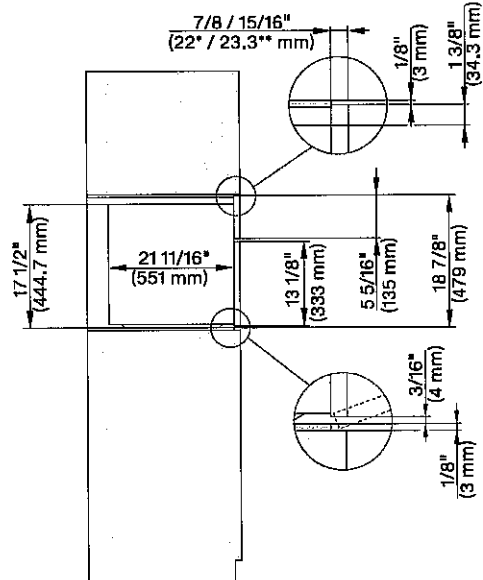

- A - Cut-out (4" x 28" [100 mm x 720 mm]) in the bottom of the cabinet for the power cord and Ventilation  
 ①- Electrical and water supplies are recommended to be placed in adjacent cabinetry.  
 Additional cabinet depth is required when placing the electrical and water supplies behind the appliance.

**Miele**

**PROUD CUTOUT DIMENSIONS**

Front View

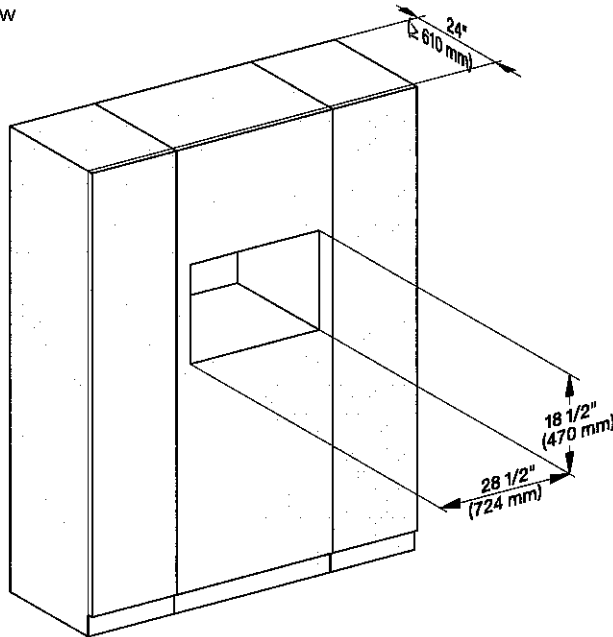

Side View

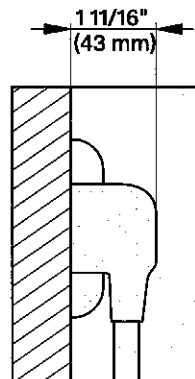
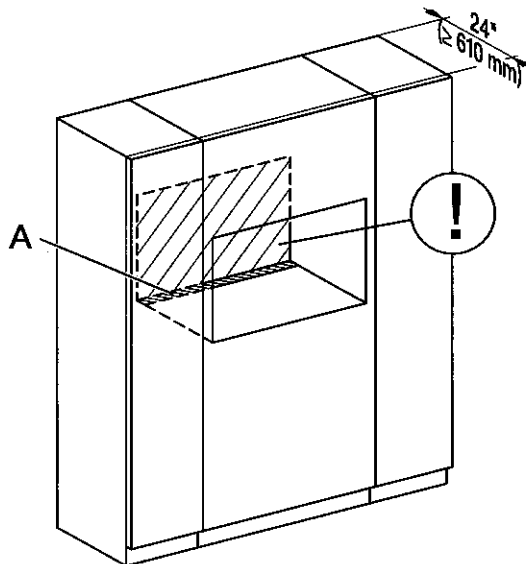
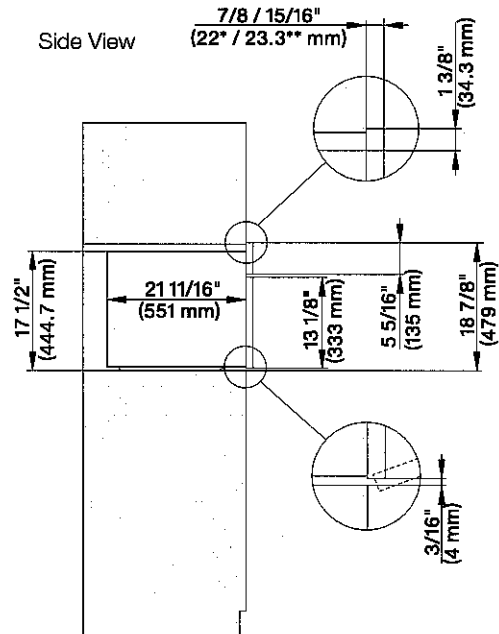

A - Cut-out (4" x 28" [100 mm x 720 mm]) in the bottom of the cabinet for the power cord and Ventilation  
 Ⓢ- Electrical and water supplies are recommended to be placed in adjacent cabinetry.  
 Additional cabinet depth is required when placing the electrical and water supplies behind the appliance.

Suite 815  
Dunwest

PAGE 9 of 18

**Miele**

## 36" 5-Burner Electric Cooktop

KM 5860

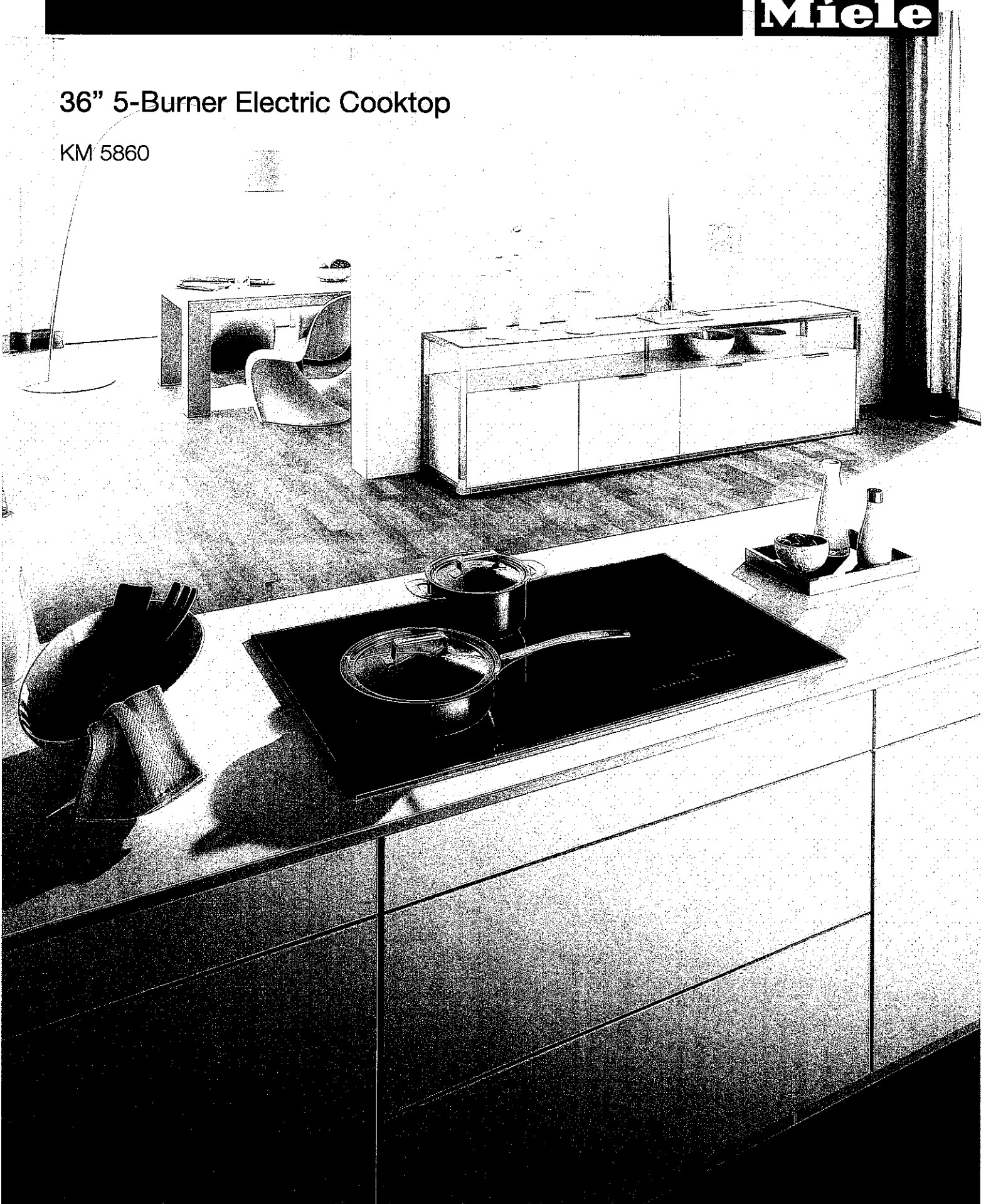

Suite 815  
Dunwest

PAGE 10 of 18

## 36" 5-Burner Electric Cooktop KM 5860

**Miele**

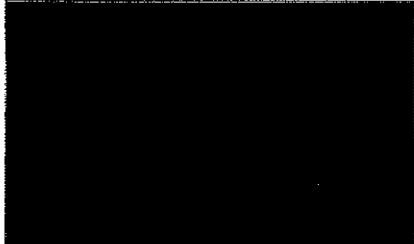

### KM 5860

#### Features:

- New 3D glass design
- Direct Selection Plus touch controls
- High-impact black Ceran glass surface with stainless steel frame
- Residual heat indicators for all zones
- Single and variable zones with over 25% increased power
- Auto-heat reduces heat-up time

#### SPECIFICATIONS

KM 5860 Electric Cooktop (240V)

Item 26586050USA

KM 5860 Electric Cooktop (208V)

Item 26586051USA

#### Product Dimensions

36" (915 mm) W x 2<sup>11</sup>/<sub>16</sub>" (68 mm) H  
x 21<sup>7</sup>/<sub>16</sub>" (544 mm) D

#### Cut-out Dimensions

34<sup>1</sup>/<sub>2</sub>" (876 mm) W x 20<sup>3</sup>/<sub>8</sub>" (518 mm) D

#### Minimum Back Spacing From Wall

2" (50 mm)

#### Minimum Countertop Thickness

1<sup>3</sup>/<sub>16</sub>" (30 mm)

#### Electrical

##### Electrical Requirements

208/240V, 60Hz, 50A

##### Power Cable

4' 8<sup>1</sup>/<sub>16</sub>" (1.44 m)

#### Shipping

##### Shipping Weight

48.5 lbs (22 kg)

##### Shipping Dimensions

26" W x 6<sup>5</sup>/<sub>16</sub>" H x 40<sup>3</sup>/<sub>4</sub>" D

#### Support

##### Call Miele

800.999.1360

##### Miele Website

www.mieleusa.com

##### 20/20 Link

2020technologies.com

KM 5860

Page 2 of 4

Specification Sheets TRS 11212016

Suite 815  
Dunwest

PAGE 11 of 18

36" 5-Burner Electric Cooktop  
KM 5860



PRODUCT VIEWS

Top View

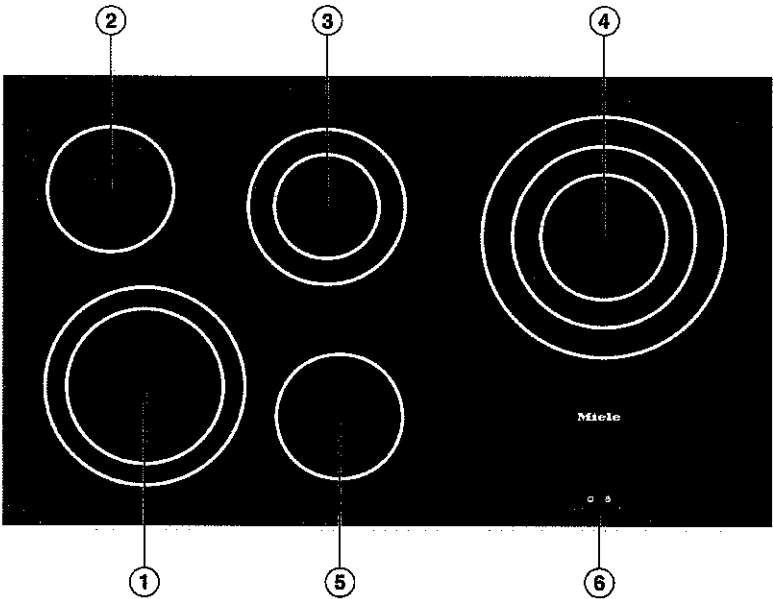

- ①③ Two-zone variable burners
- ②⑤ One-zone burners
- ④ Three-zone variable burner
- ⑥ Control panel

Burner	Ø Diameter		Output in watts at 208 / 240 V
	Inches	cm	
Left front ①	7 1/16"	18	1600
	9 1/16"	23	2500
Left rear ②	5 11/16"	14.5	1200
Center rear ③	4 3/4"	12	700
	7 1/16"	18	1800
Right rear ④	5 11/16"	14.5	1100
	8 1/4"	21	2150
	10 5/8"	27	3100
Center front ⑤	5 11/16"	14.5	1200
			Total: 9800

36" 5-Burner Electric Cooktop  
KM 5860



INSTALLATION DIMENSIONS

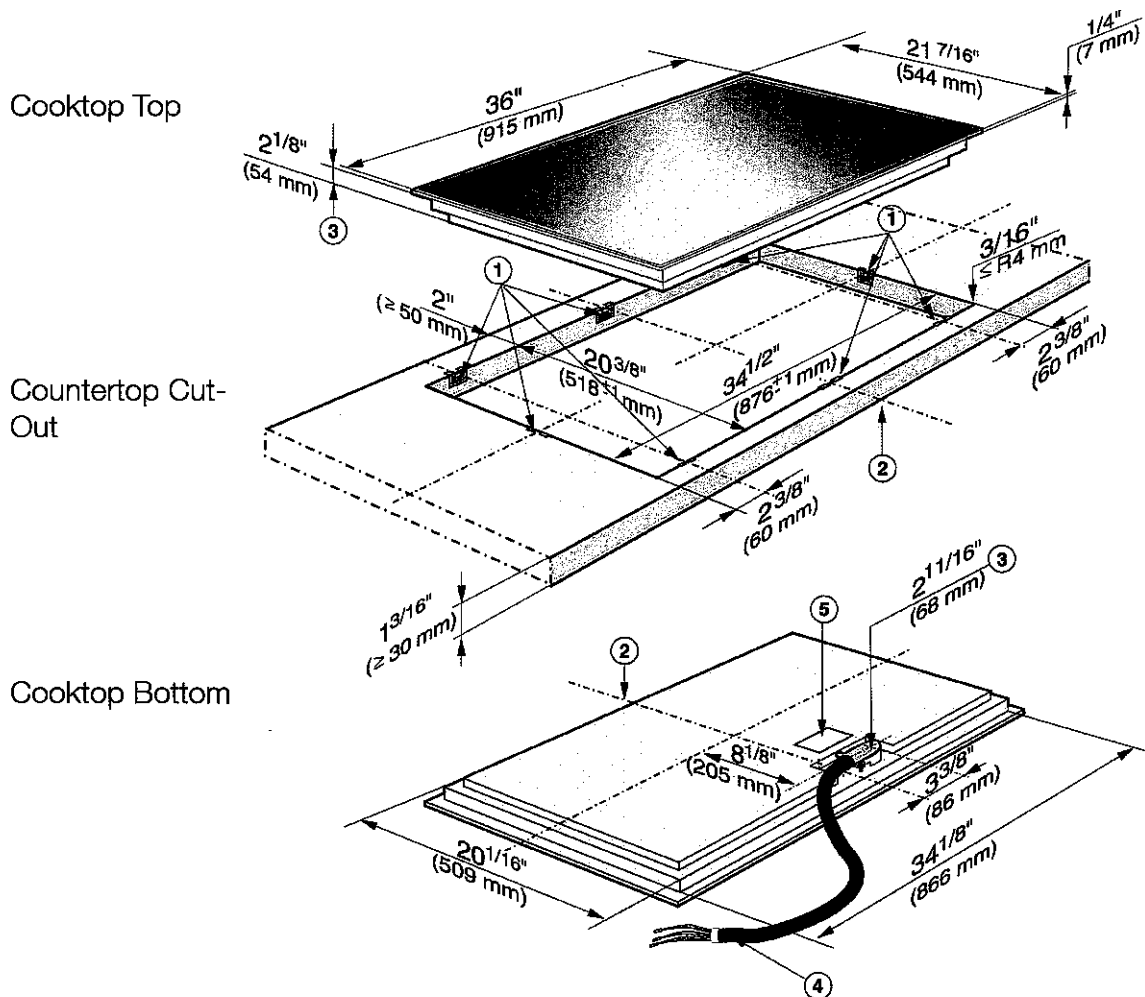

- ① Spring clips
- ② Front
- ③ Installation height
- ④ Connecting cable, Length = 56 11/16" (1440 mm)
- ⑤ Rating label

**Miele**

## H 7680 BP

30" Convection Oven - PureLine

### Features:

- M-Touch S Display with Motion React - Simple to use touch controls
- Miele@Home - Control the appliances with your app
- Moisture Plus - a burst of steam for professional quality cooking results at home
- Taste Control - Prevents overcooked dishes
- Direct Water - No need to fill any water tanks
- Automatic programs - easily master new recipes

### Included:

- 1 Universal baking tray
- 2 Self Clean Ready Baking and Roasting Racks
- 1 Self Clean Ready Rack with rail system

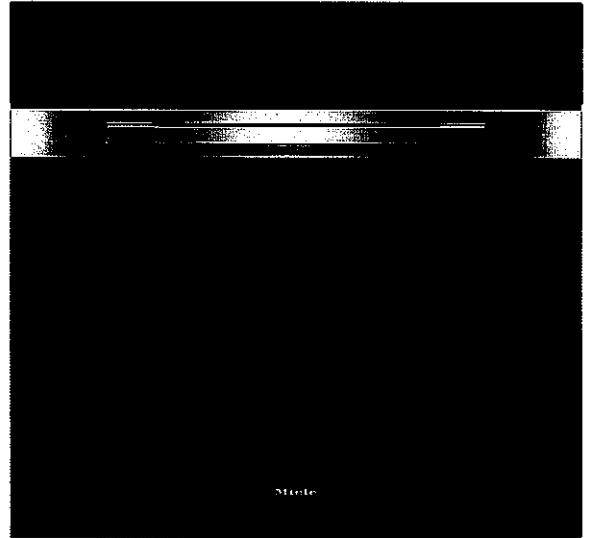

### MATERIAL #

11805550

SPECIFICATIONS	
Overall Unit Dimensions	29 <sup>13</sup> / <sub>16</sub> " (757 mm) W x 28 <sup>5</sup> / <sub>8</sub> " (727 mm) H x 23 <sup>3</sup> / <sub>4</sub> " (603 mm) D
Niche	
Minimum Cabinet Niche Opening	28 <sup>1</sup> / <sub>2</sub> " (724 mm) W x 28 <sup>1</sup> / <sub>4</sub> " (718 mm) H x 24" (610 mm) D
Plumbing	
Water Supply Requirements	<ul style="list-style-type: none"> <li>• Cold water connection</li> <li>• Male 3/8" compression fitting</li> <li>• Water pressure range 7.25 psi (0.5 bar) and 145 psi (10 bar)</li> </ul>
Water Connection Line (Supplied)	Length: 5 ft (1.5 m)
Electrical	Female 3/8" compression.
Electrical Requirements	120/208-240V, 60Hz, 30 Amps
Power Cord	NEMA 14-30 plug, 5 ft (1.52 m)
Shipping	
Shipping Weight	215 lbs (98 kg)
Shipping Dimensions	30 <sup>7</sup> / <sub>16</sub> " (776 mm) W x 35 <sup>3</sup> / <sub>4</sub> " (907 mm) H x 32 <sup>15</sup> / <sub>16</sub> " (836 mm) D

### PRODUCT DIMENSIONS

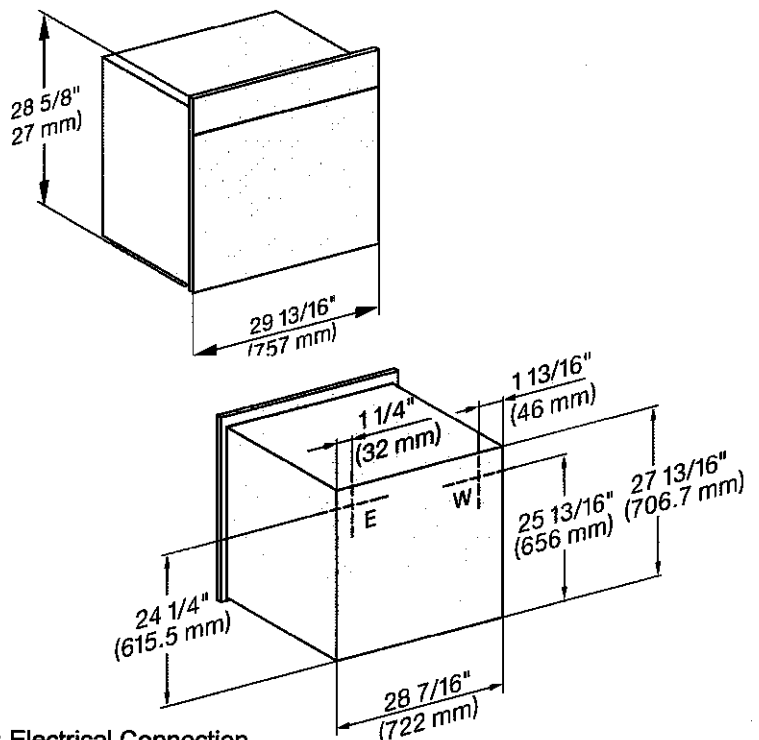

E = Electrical Connection  
W = Water Connection

Suite 815

Dunwest

PAGE

17 of 18

**Miele**

# FLUSH CUTOUT DIMENSIONS

Front View

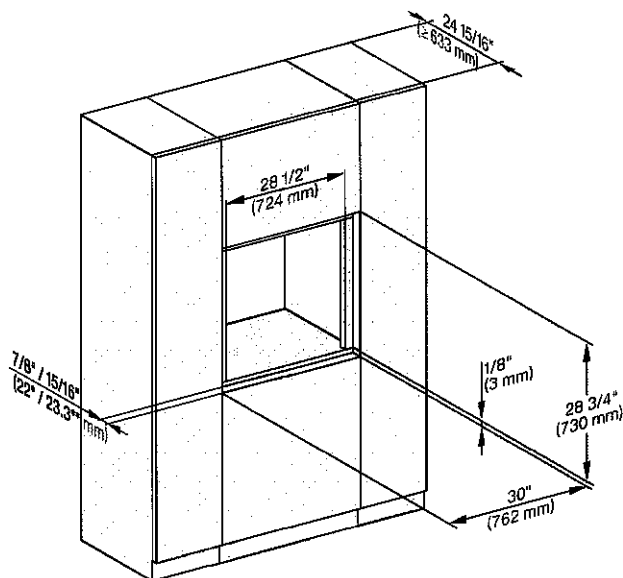

Side View

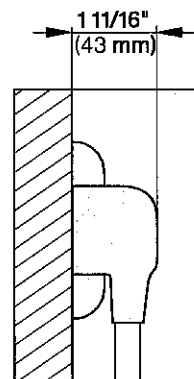
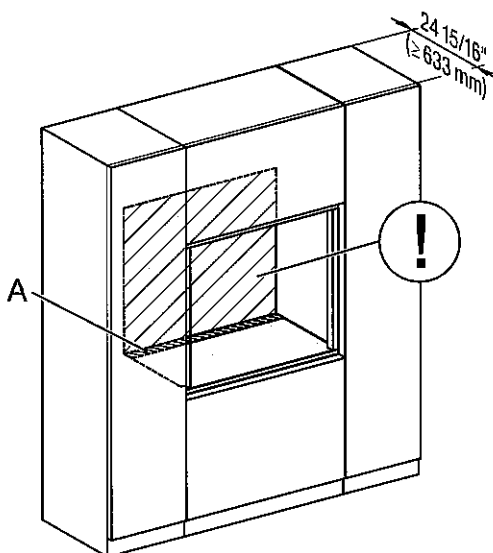
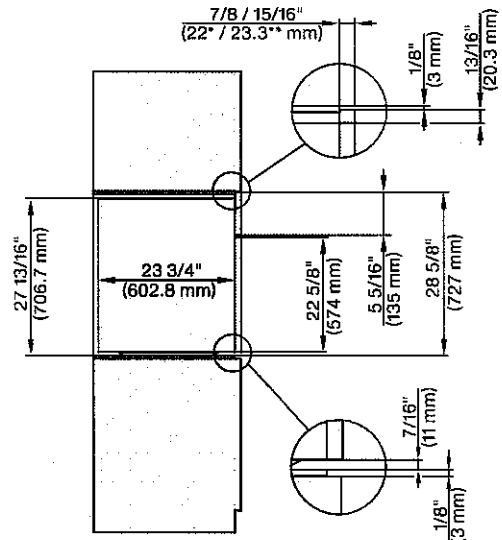

A - Cut-out (4" x 28" [100 mm x 720 mm]) in the bottom of the cabinet for the power cord and Ventilation

①- Electrical and water supplies are recommended to be placed in adjacent cabinetry.

Additional cabinet depth is required when placing the electrical and water supplies behind the appliance.



Suite B15  
Dunwest

PAGE  
15 of 18

**Miele**

PROUD CUTOUT DIMENSIONS

Front View

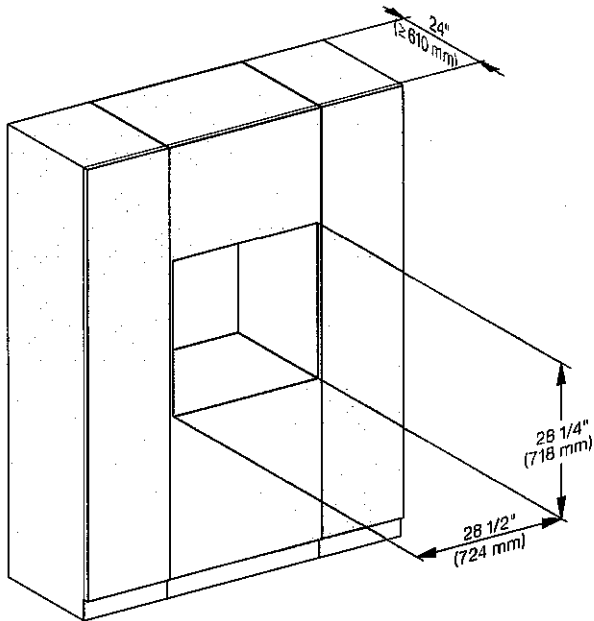

Side View

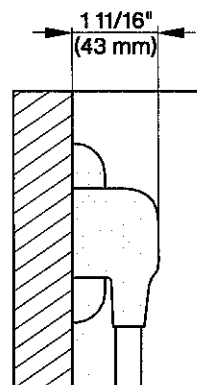
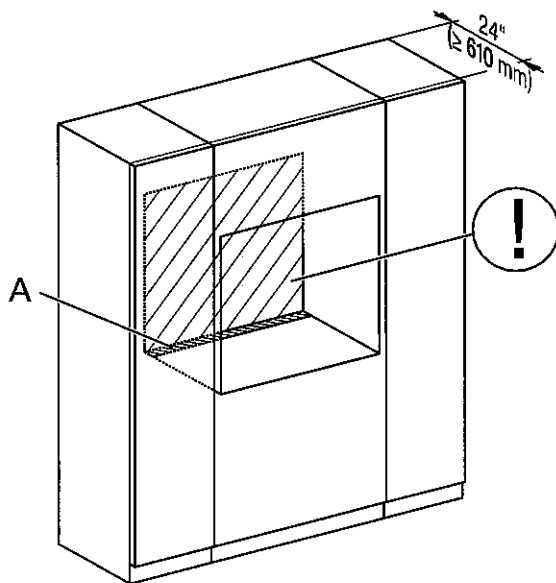
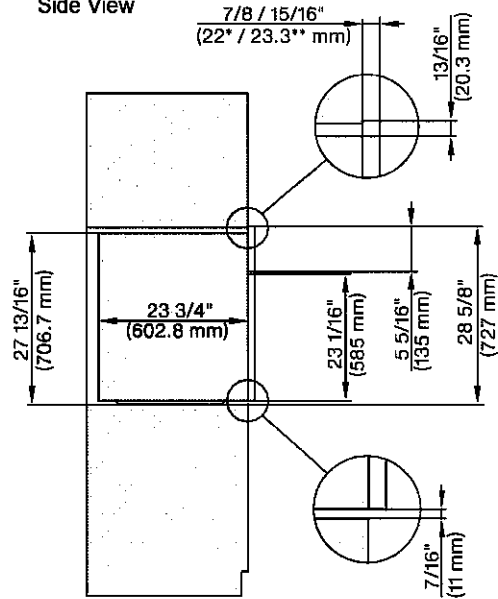

- A - Cut-out (4" x 28" [100 mm x 720 mm]) in the bottom of the cabinet for the power cord and Ventilation  
 ①- Electrical and water supplies are recommended to be placed in adjacent cabinetry.  
 Additional cabinet depth is required when placing the electrical and water supplies behind the appliance.

Suite B15  
Dunwest

PAGE  
16 of 18



HOME APPLIANCES

LG LAUNDRY

WKEX200HBA  
LG WashTower™ with Centre Control™  
5.2 cu.ft. Washer, 7.4 cu.ft. Dryer

Unitary One Body Design with Centre Control™

AIDD™ & AI Sensor Dry™

TurboWash™ 360

TurboSteam™

Wi-Fi Enabled™

Full STS Drums with STS Lifters™

Enjoy new ways to control your home with LG smart appliances

LG ThinQ™

- Start the laundry while you're out shopping
- Get alerts when the cycle is finished
- Works with the LG ThinQ® app

works with the Google Assistant

works with alexa

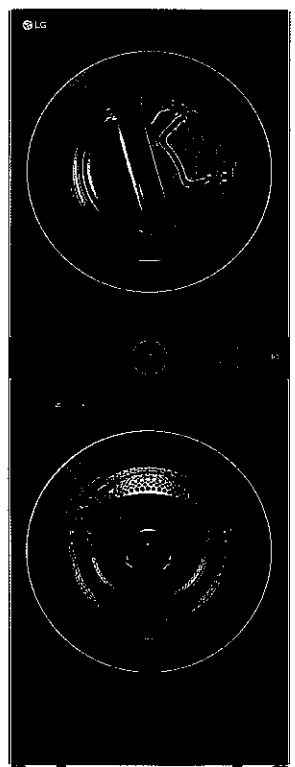

SMART APPLIANCE

SUMMARY	Washer	Dryer
Type	Front Load Washer	Front Load Dryer
Capacity (cu.ft)	5.2	7.4
Colour	Black Steel (B)	
APPEARANCE	Washer	Dryer
Hard Buttons	No	-
Full Touch Electronic Control Panel	-	Yes
ENERGY	Washer	Dryer
ENERGY STAR® Qualified	-	Yes
CEE Tier	Tier2	-
IMEF	2.92	-
IWF	2.9	-
CEF	-	3.94
PROGRAMS	Washer	Dryer
	6	6
No. of Programs	Normal, Bedding, Delicates, Heavy Duty, Speed Wash, Downloaded	Normal, Bedding, Delicates, Heavy Duty, Speed Wash, Downloaded
OPTIONS	Washer	Dryer
	10	10
No. of Options	TurboWash®, Steam, Extra Rinse, Pre-wash, Sanitary, Tub Clean, Drum Light, Child Lock, Signal, Wi-Fi / Remote Start	Wrinkle Care, TurboSteam™, Reduce Static, Energy Saver, Steam Fresh®, Drum Light®, Child Lock®, Signal®, Wi-Fi® / Remote Start
DETAILS	Washer	Dryer
	5	-
No. of Wash/Rinse Temps	Hot, Warm/Hot, Warm, Cold/ Warm, Cold	-
	5	-
No. of Spin Speeds	High, Medium/ High, Medium, Low, No Spin	-
Max RPM	1300	-
Water Levels	Load Sensing	-
No. of Soil Levels	5	-
Temperature Settings	-	High, Medium/ High, Medium, Low/Medium, Low

Drying Levels	-	Very, More, Normal, Less, Damp
Manual Dry Times	-	60 min., 50 min., 40 min., 30 min., 20 min.
FABRIC CARE FEATURES	Washer	Dryer
AI DD	Yes	-
TurboWash™ 360 Technology	Yes	-
TurboWash™ 2.0 Technology	No	-
Steam Technology	Yes	-
Allergiene™ Cycle	Yes	-
Sanitary Cycle	Yes	-
SenseClean™ System	Yes	-
AI Sensor Dry™	-	Yes
Sensor Dry	-	Yes
Precise Temperature Control with Variable Heater	-	Yes
Steam Technology	-	Yes (TurboSteam™)
CONVENIENCE FEATURES	Washer	Dryer
TrueBalance™ Anti-Vibration System	Yes	-
4 Tray Dispenser	-	Prewash, Main Wash (with liquid detergent cup), Bleach, Fabric Softener
LoadSense	Yes	-
Auto Suds Removal	Yes	-
3 Minute Installation Check	-	Yes
Reversible Door	-	No
FlowSense™ Duct Clogging Indicator	-	Yes
Wrinkle Care Option	-	Yes
Venting Option	-	3 Way
End of Cycle Signal	-	Yes
Control Lock*	-	Yes
Drum Light	-	Yes
4 Adjustable Leveling Legs	-	Yes
Remaining Time Display/Status Indicator(s)	-	Yes

THINQ TECHNOLOGY	Washer	Dryer
SmartDiagnosis™ (v3.0)	-	Yes
Wi-Fi	-	Yes
Remote Start and Cycle Monitor	-	Yes
Energy Monitoring	-	Yes
Tub Clean Coach	Yes	-
MOTOR	Washer	Dryer
Motor Type	Inverter Direct Drive Motor	-
Axis	Horizontal	-
MATERIALS AND FINISHES	Washer	Dryer
NeveRust™ Stainless Steel Drum	-	Yes
Control Panel	-	Plastic
Top Plate	-	Steel
Cabinet	-	PCM
Door / Rim	-	Large Circle Chrome Rim
Door Cover	-	Tinted Round Tempered Glass
CERTIFICATION	Washer	Dryer
Asthma Canada	Yes	-
POWER SOURCE	Washer	Dryer
Ratings	CSA Listed	
Electrical Requirements	120V, 10 Amps	240V 30 Amps
Type	Electric	
DIMENSIONS	Washer	Dryer
Product (WxHxD)	27" x 74 3/8" x 30 3/8"	
Depth with Door Open	55" D with door open	
Carton (WxHxD)	30 1/16" x 79 11/32" x 32"	
Weight (Product/Carton)	326 lbs / 361 lbs	
LIMITED WARRANTY	Washer	Dryer
Parts and Labour	1 Year	1 Year
Direct Drive Motor	10 Years	-
Drum	3 Years	10 Years
UPC	Washer	Dryer
WKEX200HBA	772454073670	

© 2020 LG Electronics Canada, Inc. All rights reserved. "LG Life's Good" is a registered trademark of LG Corp. All other product and brand names are trademarks or registered trademarks of their respective owners. Design, features and specifications are subject to change without notice. Non-metric weights and measurements are approximate. Some features may require Internet access. Content and services may vary by product and are subject to change without notice. 12/29/20

Suite 815  
Dunwest

17 of 18

ELICA PRO SERIES  
TRENTO

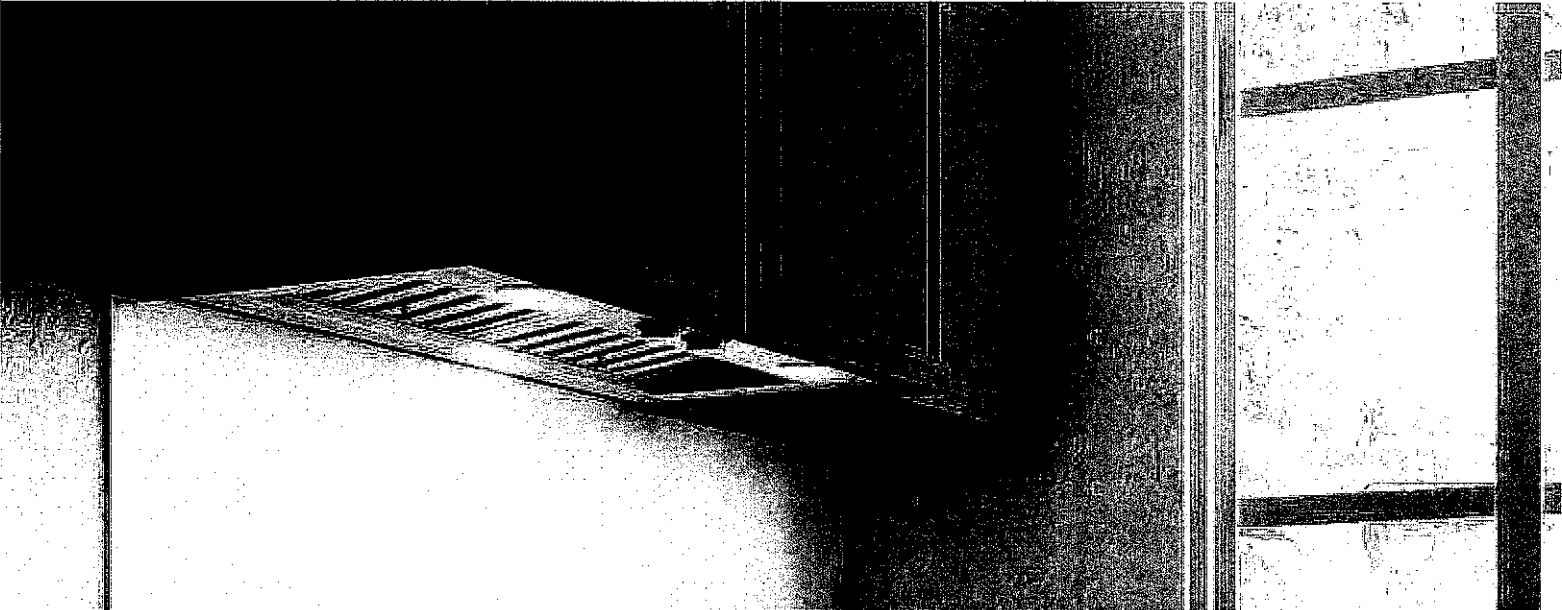

HUSH  
SYSTEM



LED  
REPLACEABLE



SEAMLESS  
LOOK



GREASE  
COLLECTORS



PERFORMANCE



HEAT GUARD

ELICA'S EXCLUSIVE  
PLUS FEATURES

Trento provides professional grade performance, while being discreetly mounted inside the cabinetry. It is available with a 600 CFM or 1200 CFM blower for extraordinary ventilating power. Plus the All-In-One design avoids the need to purchase a stainless liner. Hidden metallic in/out knob controls operate the 4-speed blower and LED lighting. A cleaner kitchen is ensured by Elica's patented angled baffle filters, which capture a higher percentage of contaminants and hold larger volumes of grease than traditional baffle filters.

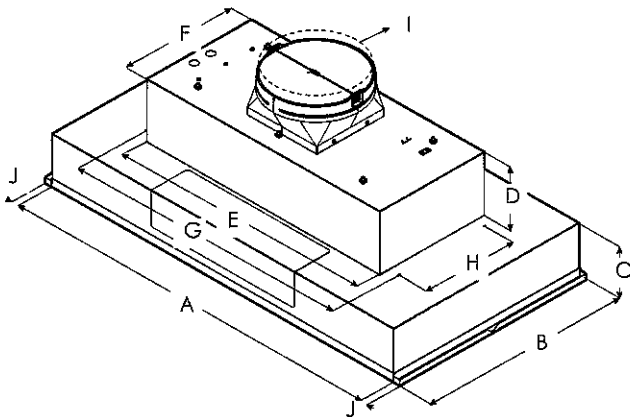

	ETR634SS ETR134S1	ETR146SS
A	34 1/2" (87.5 cm)	46 1/2" (118.5 cm)
B	18" (45.7 cm)	
C	5 7/16" (13.8 cm)	
D	6 1/2" (16.4 cm)	
E	27 9/16" (70 cm)	
F	12 7/16" (31.6 cm)	
G	29 13/16" (75.7 cm)	
H	10 1/8" (25.7 cm)	
I	10" (25.4 cm)	
J	3/4" (1.9 cm)	

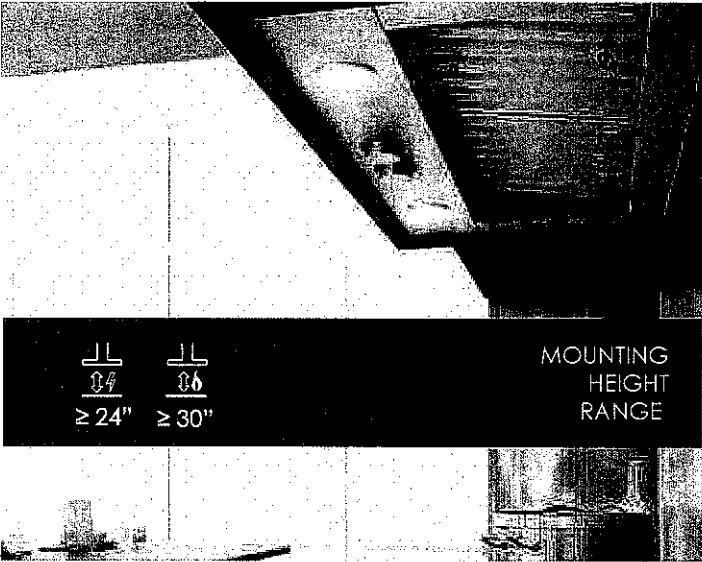

11  
04  
≥ 24"

11  
06  
≥ 30"

MOUNTING  
HEIGHT  
RANGE

ELICA PRO SERIES  
TRENTO

Suite  
815  
Dunwest

18 of 18



SPECIFICATIONS

	34" Unit (600 CFM)	34" Unit (1200 CFM)	46" Unit (1200 CFM)
Model:	ETR634SS	ETR134S1	ETR146SS
Dimensions:	34 1/2"W x 18"D x 11 1/2"H	34 1/2"W x 18"D x 11 1/2"H	46 1/2"W x 18"D x 11 1/2"H
Blower Type(internal):	600 CFM (4-speed)	1200 CFM (4-speed)	1200 CFM (4-speed)
Blower Performance:			
Speed 1	90 CFM	380 CFM	380 CFM
Speed 2	330 CFM	660 CFM	660 CFM
Speed 3	490 CFM	950 CFM	950 CFM
Speed 4	600 CFM	1200 CFM	1200 CFM
Noise (sones):	Min:2 , Max:9.5	Min:2.05, Max:7.5	
Working Speed			
Finish:	Stainless Steel		
Controls:	Fully retractable rotating knobs with blue backlighting		
Illumination:	2 LED, 7.5 W	2 LED, 7.5 W	2 LED, 6.5 W
(replaceable lamps 1 intensity)			
Filter Type:	Dishwasher-Safe, Professional Stainless Steel		
Angled Baffle Filters:	2	2	3
Duct Transition:	10" Round with BackDraft Damper (top only)		
Installation Type:	Ducted Installation Only		
Electrical:	120V - 60 Hz		
CONSUMABLE PARTS:			
Replacement Grease Filter (1):	GRI0140692A	GRI0140692A	GRI0173802
Replacement Light Bulb (1):	LMP0131098A	LMP0131098	LMP0131098A
WARRANTY:	2 YEARS PARTS AND LABOR, EARN A 3RD YEAR OF FULL FACTORY WARRANTY REGISTERING YOUR PRODUCT ON ELICA.COM		

\*Consumable parts are sold in units of one (1). Order accordingly

\*\* For valid warranty extension, register within 3 months from purchase. For USA & Canada Users only

\*The product images shown are for illustration purposes only and may not be an exact representation of the product.

PLUS FEATURES

- 

**HUSH SYSTEM** - An exclusive sound deadening technology that effectively reduces sound levels by over 35%
- 

**LED CONSUMER REPLACEABLE BULB** - High quality LED lighting usually requires a skilled technician to replace lamps. Avoid this expense with Elica's new LED lamps that enable homeowners to replace in seconds
- 

**SEAMLESS CRAFTSMANSHIP** - Heavy gauge stainless steel "Seamless" construction that delivers refined elegance.
- 

**STAINLESS STEEL BAFFLE FILTERS WITH GREASE COLLECTORS** - Designed for high airflow cooking, the "S" shape design traps high volumes of grease
- 

**PROFESSIONAL PERFORMANCE** - Special features and high performances for models with aspiration capacity between 600 and 1200 CFM's
- 

**HEAT GUARD** - Senses extreme temperatures (>158 degrees) and automatically adjusts the blower speed to HIGH