

CONSTRUCTION SUMMARY		RECEIVED	
Charisma Condominiums - Granerola Residences Ltd.		JAN 27 2023	
PURCHASER: Adnan HANNA		TEL:	
Unit 10, Level 13 (1410-North)	Floor Plan C969		

CABINETRY

1 - KITCHEN - EXTENDED UPPER CABINETS 16Jan23 Note:	
1 - KITCHEN ISLAND - EXTEND EXISTING SHALLOW BASE CABINETS AT ISLAND TO 24" DEEP - FLUSH BREAKFASTBAR TO REMAIN 16Jan23 Note:	

COUNTER TOP

1 - KITCHEN - UPGRADE BACKSPLASH - STANDARD 16Jan23 Note:	
--	--

ELECTRICAL

1 - ADD LIGHT IN LIVING ROOM 13Sep22 Note:	
1 - POT LIGHT – ADD SHOWER POT LIGHT TO TUB 13Sep22 Note:	

FLOORING

1 - LAMINATE - AVENUE SERIES IN LIEU OF STANDARD 16Jan23 Note:	
---	--

MISCELLANEOUS

1 - PACKAGE CHANGE FEE 16Jan23 Note:	
---	--

PLUMBING

1 - KITCHEN - WATERLINE ROUGH-IN FOR FRIDGE 16Jan23 Note:	
--	--

This Document is Extremely Time Sensitive - Printed 16 Jan 23 at 15:45

Purchaser:

Adnan HANNA

Telephone Res. / Bus:

/

Decor Advisor:

Ida Viola

Lock Date:

1/16/2023 15:13:22

Const. No.:

Unit 10, Level 13

Municipal:

1410

Suite Type:

C969

Project/Phase:

Granerola Residences Ltd./North

Layout Changes:

☐ Yes ☒ No

Sketch Attached:

☒ Yes ☐ No

1. Kitchen and Vanities

	Style and Colour	Hardware
Kitchen	MONACO 350 PLATINUM SILVER	Standard
Main Bathroom	N/A	
Master Ensuite Bathroom	MONACO 350 PLATINUM SILVER	Standard
Bedroom 2 Ensuite	MONACO 350 PLATINUM SILVER	Standard
Powder Room	MONACO 350 PLATINUM SILVER	Standard
Built In Appliances <input type="radio"/> Yes <input checked="" type="radio"/> No      Kitchen Extended Upper Cabinets <input checked="" type="radio"/> Yes <input type="radio"/> No		

Comment

\*\* Refer to Construction Summary

2. Counters

	Counter	Edge
Kitchen	QUARTZ-ISTRIA	Straight Polished Edge
Main Bathroom	N/A	
Master Ensuite Bathroom	QUARTZ-ISTRIA	Straight Polished Edge
Bedroom 2 Ensuite	QUARTZ-ISTRIA	Straight Polished Edge
Powder Room	QUARTZ-ISTRIA	Straight Polished Edge
Kitchen Backsplash	QUARTZ-ISTRIA	

Comment

\*\* Refer to Construction Summary

3. Flooring

	Selection
Vestibule/Main Hall	LAMINATE-AVENUE ARTESIA OAK TL-AV235PEFC
Kitchen	LAMINATE-AVENUE ARTESIA OAK TL-AV235PEFC
Living Room/Dining Room	LAMINATE-AVENUE ARTESIA OAK TL-AV235PEFC
Den/Office	N/A
Master Bedroom	LAMINATE-AVENUE ARTESIA OAK TL-AV235PEFC
Bedroom #2	LAMINATE-AVENUE ARTESIA OAK TL-AV235PEFC
Bedroom #3	N/A
Powder Room	TILE-STONE WHITE 12X24
Laundry Room	TILE-8X8 WHITE MATTE
Main Bath	N/A
Master Ensuite Bathroom	TILE-STONE WHITE 12X24
Bedroom 2 Ensuite	TILE-STONE WHITE 12X24

Comment

\*\* Refer to Construction Summary - Standard Grout throughout unless specified

4. Wall Tile

	Selection	Describe
Main Bath	N/A	
Master Ensuite Bathroom	TILE-GLOSSY WHITE 8X16	
Bedroom 2 Ensuite	TILE-GLOSSY WHITE 8X16	
Kitchen Backsplash	QUARTZ-ISTRIA	

Comment

\*\* Refer to Construction Summary - Standard Grout throughout unless specified

Purchaser: Adnan HANNA  
Telephone Res. / Bus: /  
Decor Advisor: Ida Viola  
Lock Date: 1/16/2023 15:13:22

Const. No.: Unit 10, Level 13  
Municipal: 1410  
Suite Type: C969  
Project/Phase: Granerola Residences Ltd./North

5. Misc

Water Line Rough-in for Fridge ☒ Yes ☐ No  
Upgrade Bathroom Accessories ☐ Yes ☒ No

Comment  
\*\* Refer to Construction Summary

6. Wall, Trim and Door Paint - Birch White Paint Throughout unless specified below.

Entrance Vestibule		Living Room	
Main Hall		Dining Room	
Kitchen		Den/Library	
Laundry Room		Master Bedroom	
Main Bathroom		Bedroom #2	
Master Ensuite Bathroom		Bedroom #3	

Comment  
\*\* Refer to Construction Summary

7. General Comments

\*\* Refer to Construction Summary

Disclaimers and Notes

- 1) Colours of all materials are as close as possible to builder's selection, but not necessarily identical due to variances in manufacturing.
- 2) The selection images are digital photographs of the Vendor's samples at its Decor Centre. Such images when displayed on your computer monitor may not match Decor Centre samples due to the hardware/software configuration of the  
In the event of conflict between selection images and the Décor Centre samples, Décor Centre samples shall prevail.
- 3) Any extras listed above are null and void unless accompanied by a separate invoice/amendment. Said invoice must be paid in full.
- 4) The Purchaser agrees that this colour selection is final and that no changes will be permitted, unless required by the Vendor.
- 5) The Purchaser acknowledges reading and accepting document which contains other miscellaneous disclaimers.

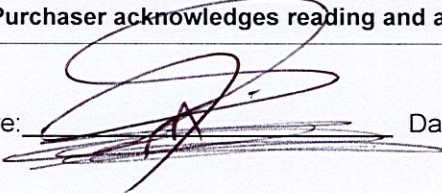
Signature:  Date: Jan 16 2023

Signature:  Date:

May 01, 2019

# SCHEDULE 'A'

## Charisma<sup>2</sup>

ON THE PARK

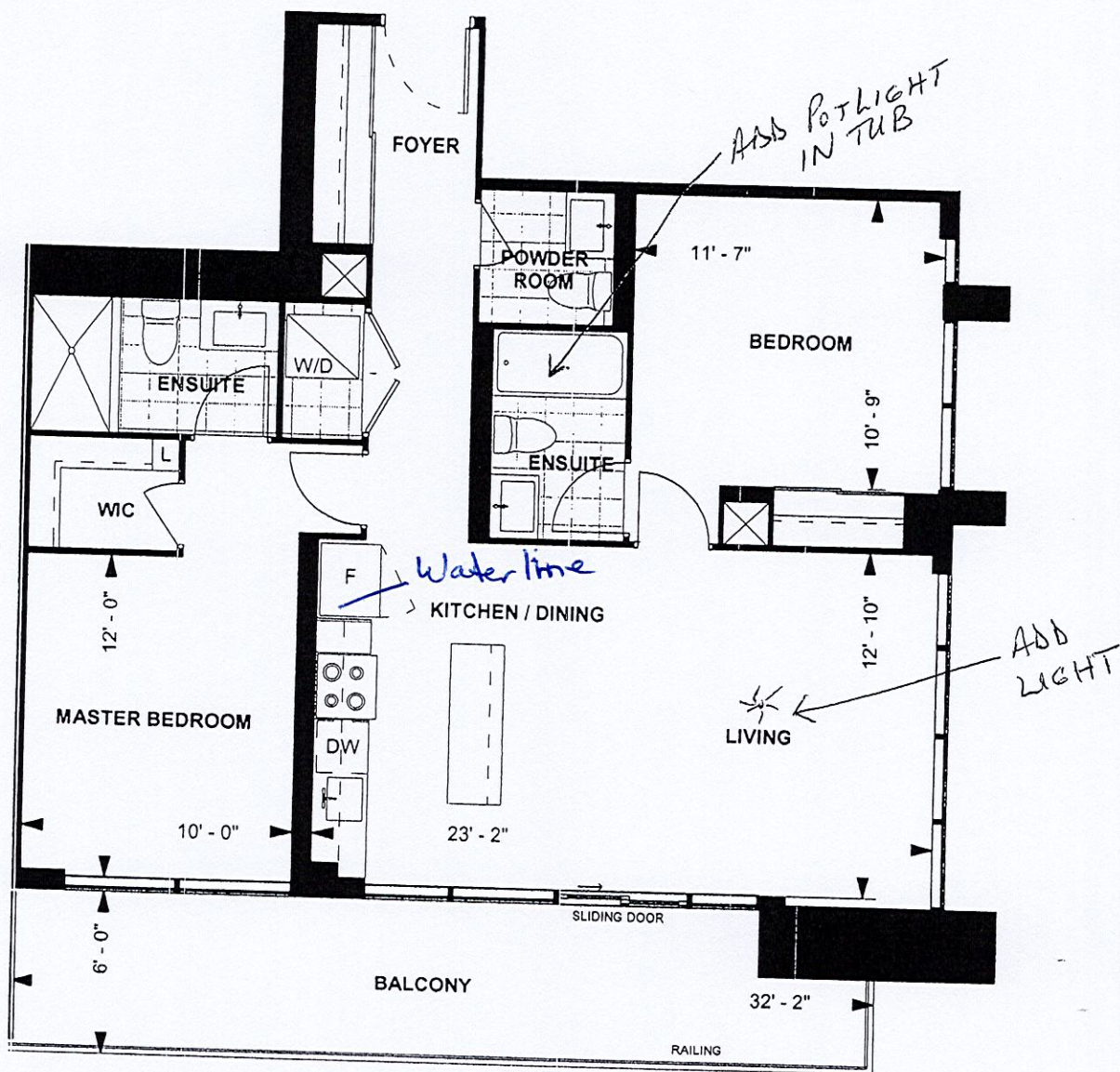

**C 969**  
**TOWER SUITE**  
**NORTH TOWER**  
**9' CEILING**

969 sq. ft.  
2-BEDROOM

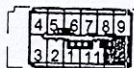

LEVEL 9-22

Purchaser Initials

Purchaser Initials

Date

Unit No. 10 Level No. 13 Suite No. 1410

Dimensions, specifications, layouts, location of materials and fixtures, tile floor patterns and architectural detailing (including window size and location and door size, location and swing) are approximate only and are subject to change or modifications, without notice. Actual usable floor space varies from stated floor area. Ceiling height measured from top of floor slab to underside of floor slab above and excludes finishes, bulkheads and drop ceilings. Orientation of suite may be reversed and Purchaser agrees to accept same. Balconies decks and terraces are exclusive use common elements shown for display purposes only and location and size are subject to change without notice. All illustrations are artist concept only. The provisions of the Agreement of purchase and sale apply to this Schedule. E. & O.E.

Site 1410 Granerola North.

-Extended Uppers.

-Extend Island to 24" Deep

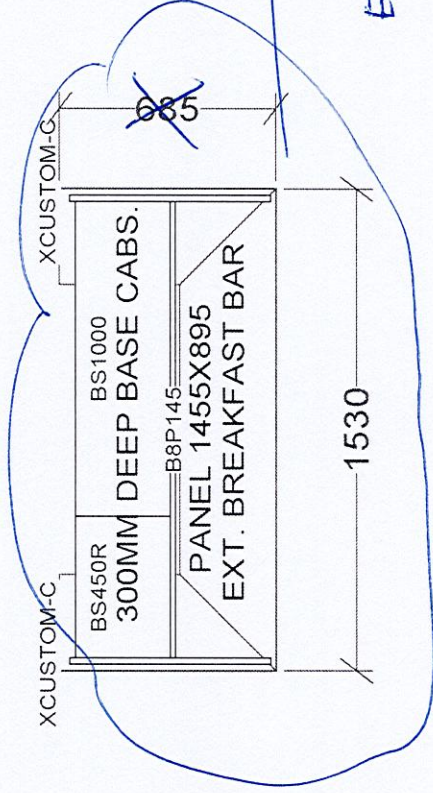
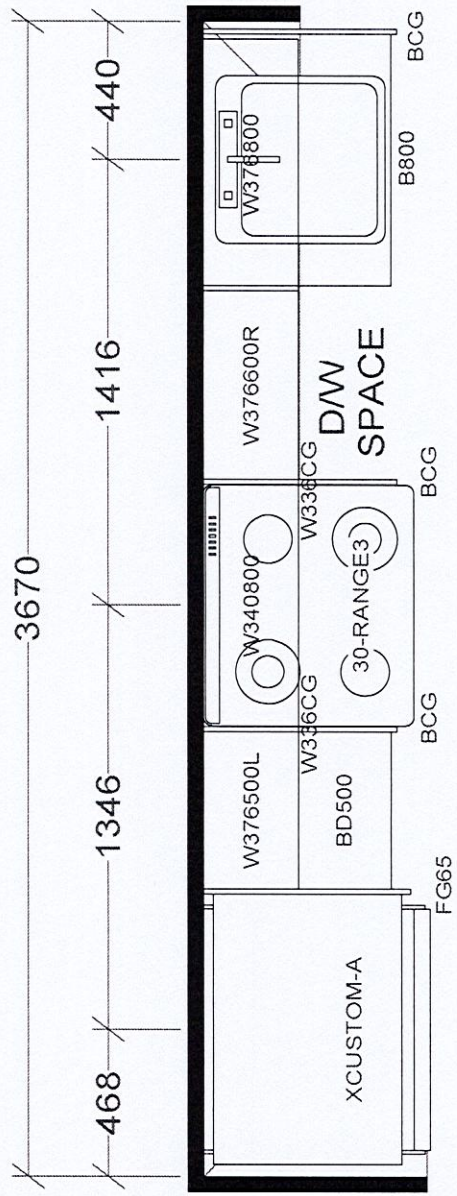

Extended Island. 24"  
Breakfast bar to remain

KITCHEN

BASE & VANITY CABINETS ON ADJUSTABLE LEGS

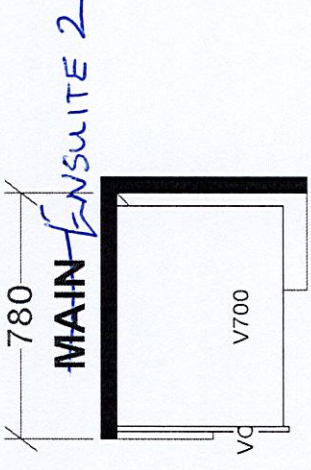
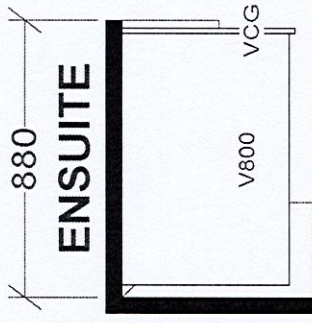
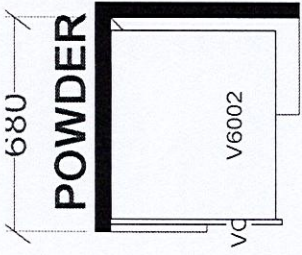

TOWER & PODIUM SUITES  
NORTH TOWER X14  
SOUTH TOWER X18

Selba Industries			J #
W WDTH	W HGHT	W CNT	This drawing is the intellectual property of SELBA INDUSTRIES INC. and is an original design which must not be released or copied unless applicable fee has been paid or job order placed.
FLOOR HGHT	DOOR HGHT		
ST CENT	2X4	VENT BOX COVER	
		DESIGNER: KS DATE: JAN 6 22	
JOB NUMBER:			BUILDER: GREENPARK
			SITE: GRANEROLA NORTH & SOUTH
			MODEL: C969
			LOT #:

Charizma unit 1410 north tower ,Adnan  
hanna



Contents	Page no.
<b>LRMXC1803S</b>	<b>3-4</b>
LG Refrigeration	

**Coast Appliances**  
coastappliances.com

**Alex Flamengo**  
Assistant General Manager  
905-303-6909

Search **20230126150710809SC**  
Version 1.1

Thu, Jan 26, 2023  
10:07 AM EST

To ensure a smooth project it is the responsibility of the homeowner / purchaser of appliances for this project to share all the attached specifications to ensure the cabinet provider, contractor, or any other tradesperson have all the information required to complete their work accurately.

Specifications are subject to change. If any tradesperson has questions regarding the attached specifications please contact our sales associate.



[enterprise.steelcod.com/sp/csta/C7AX5T27](https://enterprise.steelcod.com/sp/csta/C7AX5T27)

**Note about page numbers:**  
Because the original manufacturer's documents are not altered in any way, the page numbers displayed on the page may not correspond to the page number within this package.

**All specifications are intended for initial planning purposes only.**  
Manufacturers reserve the right to change specifications at any time without notice. Always consult the installation instructions found on the manufacturer's website or included with the appliances before installation.

LG REFRIGERATION

LRMXC1803\_

33" Counter Depth 4-Door Refrigerator, 18.3 cu.ft.

- Slim SpacePlus® Ice System
- Inverter Linear Compressor with 10 Year Warranty
- Smudge Resistant Stainless Steel Finish
- SmartThinQ® Wi-Fi Connectivity
- Smart Cooling System with Door Cooling+
- Counter Depth Design
- Fresh Air Filter
- ENERGY STAR® Qualified



SmartThinQ®

Enjoy new ways to control your home with LG smart appliances

- Get an alert when kids forget to close the door
- Make more ice while you're at work
- Works with the LG SmartThinQ® app



works with the Google Assistant



WORKS WITH alexa

CAPACITY	
Refrigerator (cu.ft.)	10.5
Freezer (cu.ft.)	7.8
Total Capacity (cu.ft.)	18.3
ENERGY	
Energy Consumption (kWh/Year)	636
ENERGY STAR® Qualified	Yes
WATER & ICE SYSTEM	
Ice & Water Dispenser	Yes
Dispenser Type	Integrated Tall Ice & Water
Ice System	Slim SpacePlus®
Dual Ice	No
Dispenser Light	Yes
Water Filter	LT1000P
COOLING	
Inverter Linear Compressor	Yes
Smart Cooling® System	Yes
Multi-Air Flow Cooling	Yes
Temperature Sensors	5
Fresh Air Filter	Yes
CONVENIENCE	
Display Type	Membrane / White LED
Temperature Controls	Electronic/Digital
Door Alarm	Yes
Child Lock	Yes
Auto Closing Door Hinge	Yes
Sabbath Mode	Yes
LoDecibel™ Quiet Operation	Yes
REFRIGERATOR	
No. of Shelves	1 Full, 2 Half (1 Folding)
Cantilevered Shelves	Hybrid Cantilevered
Shelf Construction	Spill Protector™ Tempered Glass
Crisper Bins	2 Humidity Crispers
Glide N' Serve® Pantry Drawer	No
Refrigerator Light	Ceiling LED
REFRIGERATOR DOOR	
No. of Bins	5 Total
Door Bin Construction	1 Piece (Clear)

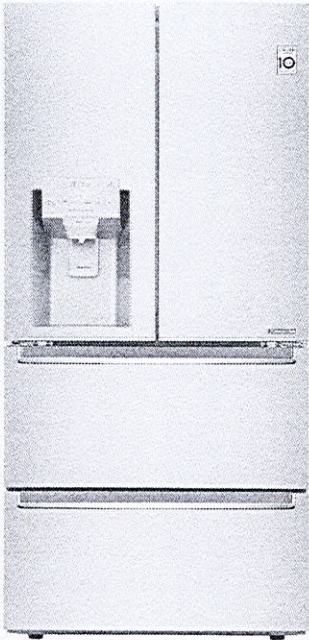

FREEZER	
Door Type	Pull Drawer
Drawers	2-Tier Organization
DuraBase™ Solid Drawer Base	Yes
Freezer Light	Yes
SmartThinQ® SMART FEATURES	
Wi-Fi Enabled	Yes
Voice Activation	Yes
Works with	Google Assistant and Amazon Alexa
SmartDiagnosis™	Yes
MATERIALS AND FINISHES	
Contour Door	Yes
Hidden Hinges	Yes
Surface	Smooth
Available Colour	Smudge Resistant Stainless Steel
DIMENSIONS/CLEARANCES/WEIGHTS	
Depth with Handles	28 3/4"
Depth without Handles	28 3/4"
Depth without Door	24"
Depth (Total with Door Open)	41 7/8"
Height to Top of Case	68 5/8"
Height to Top of Door Hinge	70 3/8"
Width	32 7/8"
Width (Door Open 90° with Handle)	36 7/8"
Width (Door Open 90° without Handle)	36 7/8"
Door Edge Clearance with Handle	3 1/8"
Door Edge Clearance without Handle	3 1/8"
Installation Clearance	Sides 1/8", Top 1", Back 2"
Weight (Unit/Carton)	262 lbs. / 284 lbs.
Carton Dimensions (WxHxD)	37 1/2" x 71 7/8" x 37"
LIMITED WARRANTY	
Parts & Labor	1 Year
Sealed System	7 Years
Inverter Linear Compressor	10 Years
UPC CODES	
LRMXC1803S.ASTCNA0	772454071669

## LG REFRIGERATION

## LRMXC1803\_

33" Counter Depth 4-Door Refrigerator, 18.3 cuft.

## QUICK INSTALL &amp; CLEARANCES

For full installation directions/clearances please refer to the corresponding User Manual and Installation Guide.

## DIMENSIONS/CLEARANCES/WEIGHTS

A Depth without Handles	28 3/4"
B Width	32 7/8"
C Height to Top of Case	68 5/8"
D Height to Top of Door Hinge	70 3/8"
E Back Clearance	2"
F Depth without Door	24"
G Depth (Total with Door Open)	41 7/8"
M Depth with Handles	28 3/4"
Width (Door Open 90° with Handle)	36 7/8"
Width (Door Open 90° without Handle)	36 7/8"
Door Edge Clearance with Handle	3 1/8"
Door Edge Clearance without Handle	3 1/8"
Installation Clearance	Sides 1/8", Top 1", Back 2"
Carton Dimensions (WxHxD)	37 1/2" x 71 7/8" x 37"
<b>ENERGY</b>	
Energy Consumption (kWh/Year)	637
ENERGY STAR® Qualified	Yes

## CHOOSING THE PROPER LOCATION

## WATER

Select a place where a water supply can be easily connected for the automatic

## NOTE

- The water pressure must be 20 – 120 psi or 138 – 827 kPa or 1.4 – 8.4 kgf/cm<sup>2</sup>. If the refrigerator is installed in an area with low water pressure (below 20 psi), you can install a booster pump to compensate for the low pressure.

## ELECTRICITY

The refrigerator should always be plugged into its own individual properly grounded electrical outlet rated for 115 Volts, 60 Hz, AC only, and fused at 15 or 20 amperes. This provides the best performance and also prevents overloading house wiring circuits which could cause a fire hazard from overheated wires. It is recommended that a separate circuit serving only this appliance be provided.

## WARNING

- To reduce the risk of electric shock, do not install the refrigerator in a wet or damp area.

## FLOORING

To avoid noise and vibration, the unit must be leveled and installed on a solidly constructed floor. If required, adjust the leveling legs to compensate for the unevenness of the floor. The front should be slightly higher than the rear to aid in door closing. Leveling legs can be turned easily by tipping the cabinet slightly. Turn the leveling legs to the left to raise the unit or to the right to lower it.

## NOTE

- Installing on carpeting, soft tile surfaces, a platform or weakly supported structure is not recommended.

## AMBIENT TEMPERATURE

Install this appliance in an area where the temperature is between 55°F (13°C) and 110°F (43°C). If the temperature around the appliance is too low or high, cooling ability may be adversely affected.

## PRODUCT DIMENSIONS

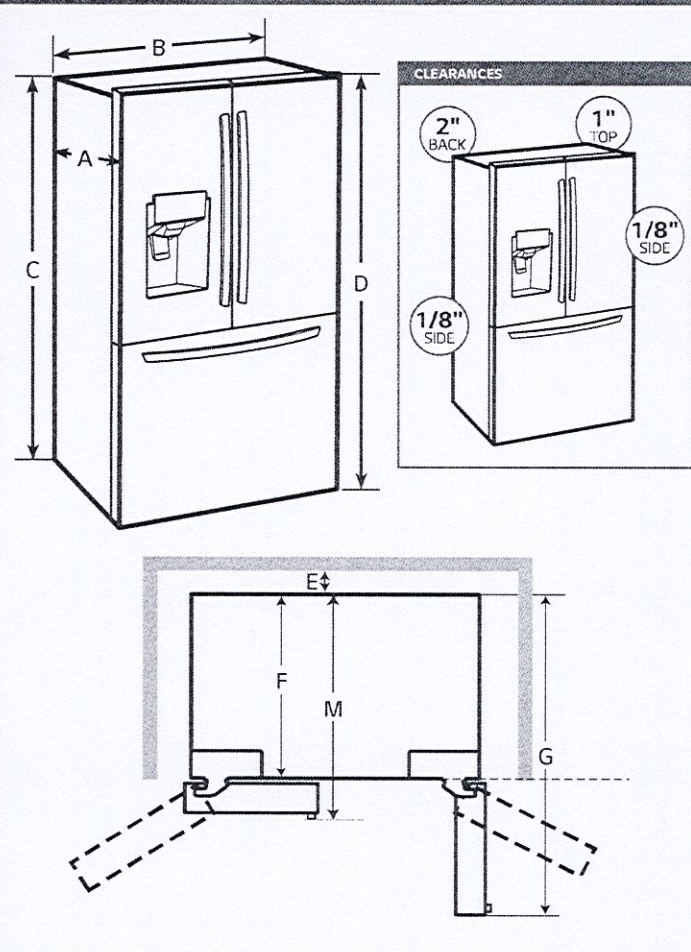

## CONNECTING POWER AND SECURING SPACE FOR WATER SUPPLY PIPE

- Make sure the location of the water supply pipe is within the marked range.
- Before connecting the power, always make sure to ground the product. (If the product is not grounded, the user may be able to feel the electricity due to the minute leakage current when touching the refrigerator door handle or side corner even when there is no issue with the product.)
- Do not ground the product to gas pipe, plastic water pipe or telephone wire etc. It can cause electric shock and explosion.

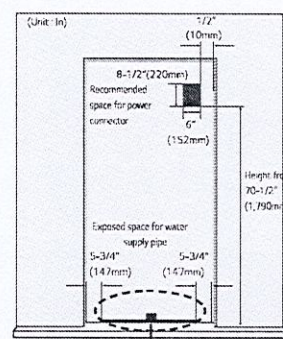

## Power connection

The location of the 115V 60Hz power connector must be located on the rear side of the product as shown in the picture.

When installing the product, make sure to check whether the cord is hung on the hook on the rear side so that it is not pressed on the refrigerator. Damaged power cord can cause a fire.

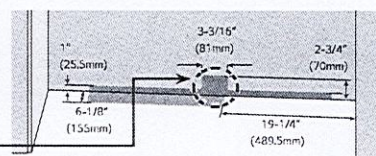

## Installation space for water supply pipe

Place the water hose for ice maker and water dispenser as shown in the picture, and prepare hose to come up from the floor. (Copper pipe with diameter of 5/16" (8mm) is recommended for the water hose.) If the water pipe and water hose is located far from the product, bury the water hose on the floor and provide appropriate treatment.

