

"PRELIMINARY"

<div>CONSTRUCTION SUMMARY</div> <div>Charisma Condominiums - Dulcina Investments Inc.</div> <div>PURCHASERS: Diana Firas DAWOOD and Nwora K. HANNA</div>				<div>RECEIVED</div> <div>MAY - 9 2023</div> <div>TEL:</div>
Unit 3, Level 3 (303-5)	Floor Plan B786			

ELECTRICAL

I - LIVING ROOM - LIGHT - ADD CEILING LIGHT COMPLETE WITH FIXTURE AND SWITCH 29Apr23 Note:	
---	--

EXTRAS AS PER OFFER

1 Parking Unit - location to be selected by the Vendor at their sole discretion. Worksheet Note:	
---	--

This Document is Extremely Time Sensitive - Printed 8 May 23 at 10:07



NOVEMBER 15, 2022

SCHEDULE 'A'



LEVEL 6

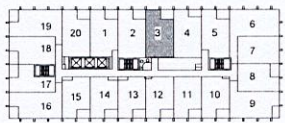

LEVEL 3 - 5



**B786**  
**PODIUM SUITE**  
**9' CEILING**  
**786 sq. ft.**  
**1-BEDROOM+DEN**

Purchaser Initials	Purchaser Initials	Date
Unit No. <u>3</u>	Level No. <u>3</u>	Suite No. <u>303</u>

Dimensions, specifications, layouts, location of materials and fixtures, tile floor patterns and architectural detailing (including window size and location and door size, location and swing) are approximate only and are subject to change or modifications, without notice. Actual usable floor space varies from stated floor area. Ceiling height measured from top of floor slab to underside of floor slab above and excludes finishes, bulkheads and drop ceilings. Orientation of suite may be reversed and Purchaser agrees to accept same. Balconies decks and terraces are exclusive use common elements shown for display purposes only and location and size are subject to change without notice. All illustrations are artist concept only. The provisions of the Agreement of purchase and sale apply to this Schedule. E. & O.E.