



CONSTRUCTION SUMMARY		RECEIVED	
Charisma Condominiums - Dulcina Investments Inc.			
PURCHASER: Ezio E. L. BERARDELLI		AUG 28 2024	
TEL:			
Unit 4, Level 18 (1904-5)	Floor Plan A586		

MISCELLANEOUS

1 - PACKAGE CHANGE FEE 27Aug24 Note:	
---	--

EXTRAS AS PER OFFER

1 Parking Unit - location to be selected by the Vendor at their sole discretion. Worksheet Note:	
---	--

This Document is Extremely Time Sensitive - Printed 27 Aug 24 at 13:30

Purchaser: Ezio E. L. BERARDELLI

Telephone Res. / Bus: /

Decor Advisor: Ida Viola

Lock Date: 8/27/2024 13:20:49

Const. No.: Unit 4, Level 18

Municipal: 1904

Suite Type: A586

Project/Phase: Dulcina Investments Inc./5

1. Kitchen and Vanities

	Style and Colour	Hardware
Kitchen	MONACO 350 PLATINUM SILVER	Standard
Primary Ensuite Bathroom	MONACO 350 PLATINUM SILVER	Standard
Powder Room	MONACO 350 PLATINUM SILVER	Standard

Kitchen Extended Upper Cabinets ☐ Yes ☒ No

Comment

** Refer to Construction Summary

2. Counters

	Counter	Edge
Kitchen	QUARTZ ISTRIA	Standard
Primary Ensuite Bathroom	QUARTZ ISTRIA	Standard
Powder Room	QUARTZ ISTRIA	Standard
Kitchen Backsplash	TILE-GLOSSY WHITE 4X12	

Comment

** Refer to Construction Summary

3. Flooring - In all Non-Tiled Areas where Applicable

LAMINATE LEXINGTON ROCHFORD OAK TL LW1317

Comment

** Refer to Construction Summary

4. Tile

	Floor Tile	Wall Tile
Primary Ensuite Bathroom	TILE-ULTRA BIANO 12X24	TILE-GLOSSY WHITE 8X16
Powder Room	TILE-ULTRA BIANO 12X24	
Laundry	TLE-WHITE MATTE 8X8	
Kitchen Backsplash	TILE-GLOSSY WHITE 4X12	

Comment

** Refer to Construction Summary - STANDARD GROUT THROUGHOUT UNLESS SPECIFIED

5. Wall, Trim and Door Paint - Standard paint as per constuction specificationThroughout.

Comment

** Refer to Construction Summary

Purchaser:	Ezio E. L. BERARDELLI	Const. No.:	Unit 4, Level 18
Telephone Res. / Bus:	/	Municipal:	1904
Decor Advisor:	Ida Viola	Suite Type:	A586
Lock Date:	8/27/2024 13:20:49	Project/Phase:	Dulcina Investments Inc./5

6. General Comments

Revision Detail

Disclaimers and Notes

The following disclaimers apply to all of the Purchaser's Extra, Purchaser's Estimate Request and all Interior Colour Selection Schedules. The Purchaser(s) acknowledges that the following items may affect matters relating to their unit:

Natural Stone
The Purchaser acknowledges that natural stone products such as granite, marble and quartz that are installed in their dwelling may vary in shading, pattern, texture, veining, pores, colour and fissures from the sample in the Vendor's Décor Centre despite having the same name. Marble is not recommended in high traffic areas, such as the kitchen, as marble is a more porous stone

Ceramic Tile
any variables affect tile colour, pattern and/or design which means that installed tiles may not be identical to the samples. As a result of the manufacturing process, tiles with the same name but of different sizes, may have different colours, pattern or and will not be an exact match to each other. Furthermore, the staggered pattern of the laid tiles will vary due to size of the tile. Purchaser accepts tiles as laid by Vendor.

Hardwood/Laminate Flooring
Cupping and shrinkage are characteristics of hardwood/laminate flooring normally appearing some time after installation, and warranty is provided by the flooring supplier with respect to such cupping and shrinkage. Purchaser acknowledges that hardwood

Appliances
All appliance openings are set to Vendor's standard width. Please advise Décor Centre at time of colour appointment if custom sizing of cabinets and openings are required for any appliance. The Purchaser is responsible for costs and fees associated with changes to standard kitchen cabinets and openings and shall provide the Vendor with appliance specifications prior to of colour chart.

If applicable, where appliances are supplied by the Vendor, the model may vary according to availability and the Purchaser acknowledges that the Vendor may substitute appliances for same or better quality as determined by the Vendor in its sole unfettered discretion.

The Purchaser(s) acknowledge that all measurements and locations are approximate only and are subject to verification on site and may be adjusted to accommodate site conditions. Purchaser acknowledges that not all of the above modifications were available or offered to the Purchaser.

- 1) Colours of all materials are as close as possible to builder's selection, but not necessarily identical due to variances in manufacturing.
- 2) The selection images are digital photographs of the Vendor's samples at its Decor Centre. Such images when displayed on your computer monitor may not match Decor Centre samples due to the hardware/software configuration of the computer.
In the event of conflict between selection images and the Décor Centre samples, Décor Centre samples shall prevail.
- 3) Any extras listed above are null and void unless accompanied by a separate invoice/amendment. Said invoice must be paid in full.
- 4) The Purchaser agrees that this colour selection is final and that no changes will be permitted, unless required by the Vendor.
- 5) The Purchaser acknowledges reading and accepting document which contains other miscellaneous disclaimers.

Signature:  Date: Aug 27/24

Signature: _____ Date: _____

SCHEDULE "A"
Agreement of Purchase and Sale

May 28, 2021

THE FIFTH
AT CHARISMA

POWDER ROOM

ENSUITE

WIC

FOYER

KITCHEN / DINING

LIVING

BEDROOM

BALCONY

SLIDING DOOR

RAILING

Dimensions: 10' - 7", 10' - 0", 5' - 10", 11' - 5", 20' - 7", 11' - 10"

A 586
TOWER SUITE
9' CEILING
586 sq. ft.
1-BEDROOM

LEVEL 08-09 , 12-13 , 18-19 , 22-23

Dimensions, specifications, layouts, location of materials and fixtures, tile floor patterns and architectural detailing (including window size and location and door size, location and swing) are approximate only and are subject to change or modifications, without notice. Actual usable floor space varies from stated floor area. Ceiling height measured from top of floor slab to underside of floor slab above and excludes finishes, bulkheads and drop ceilings. Orientation of suite may be reversed and Purchaser agrees to accept same. Balconies, patios and terraces are exclusive use common elements shown for display purposes only and location and size are subject to change without notice. All illustrations are artist concept only. The provisions of the Agreement of purchase and sale apply to this Schedule. E. & O.E.

Unit 4, Level 18 Suite 1904

Dimensions, specifications, layouts, location of materials and fixtures, tile floor patterns and architectural detailing (including window size and location and door size, location and swing) are approximate only and are subject to change or modifications, without notice. Actual usable floor space varies from stated floor area. Ceiling height measured from top of floor slab to underside of floor slab above and excludes finishes, bulkheads and drop ceilings. Orientation of suite may be reversed and Purchaser agrees to accept same. Balconies, patios and terraces are exclusive use common elements shown for display purposes only and location and size are subject to change without notice. All illustrations are artist concept only. The provisions of the Agreement of purchase and sale apply to this Schedule.

E. & O.E. Oct 23, 2021

DS

Initials: _____

Suite 1904 Dulcinea

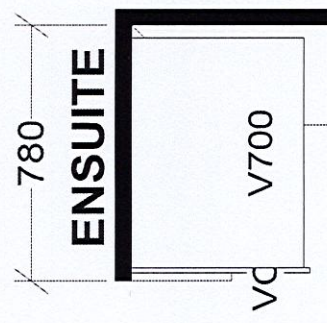
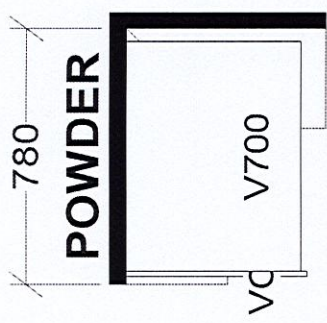
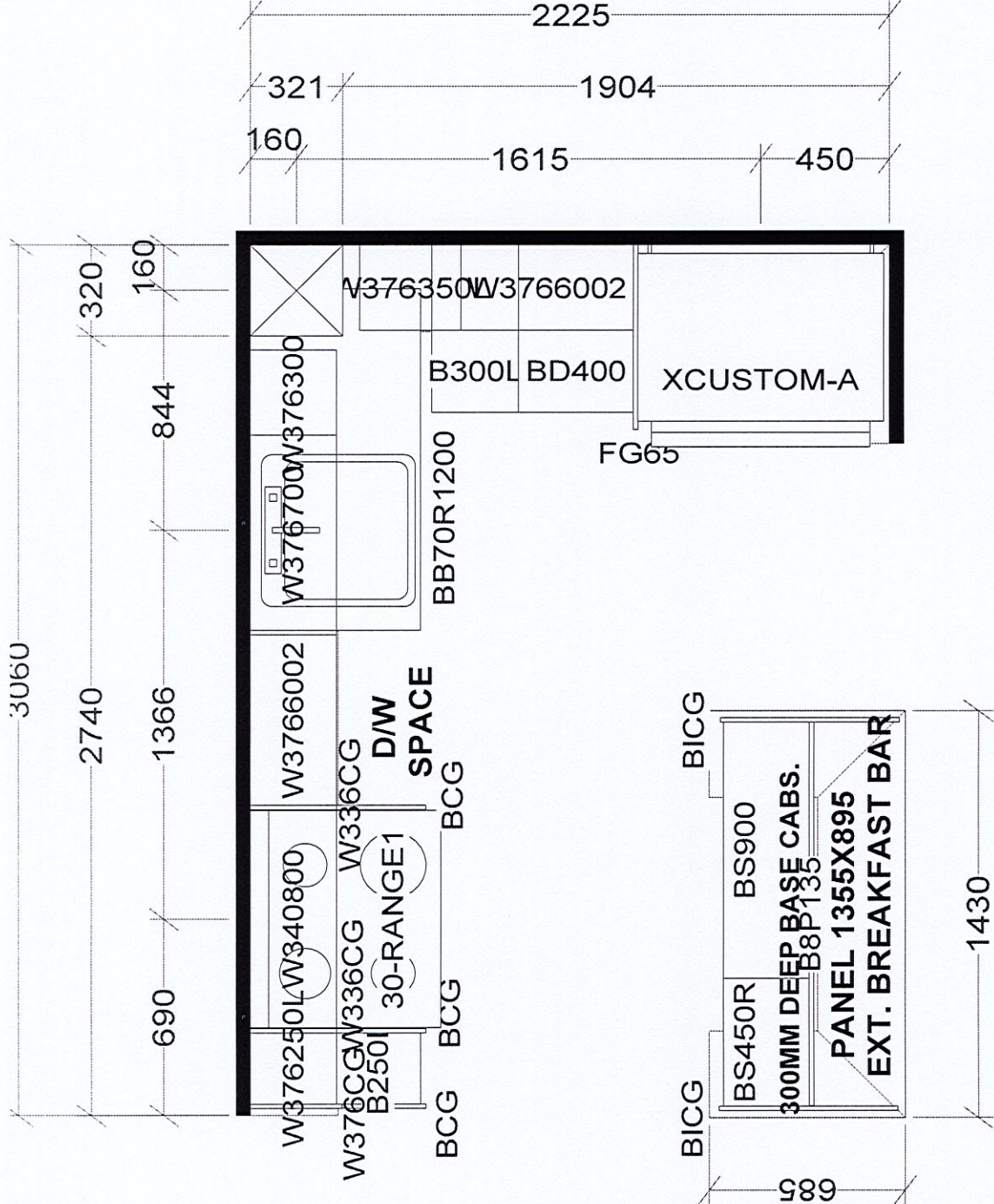

KITCHEN

X 20 UNITS

Selba Industries		J #
This drawing is the intellectual property of SELBA INDUSTRIES INC. and is an original design which must not be released or copied unless applicable fee has been paid or job order placed.		
JOB NUMBER:		BUILDER: GREENPARK
SITE: DULCINA (Charisma C)		MODEL: A586X
LOT #:		
N WDT H	W HGT	W CNT
FLOOR HGT	DOOR HGT	
ST CNT	2X4	VENT BOX COVER
DESIGNER: KS		DATE: APR 20 23