



CONSTRUCTION SUMMARY			
Charisma Condominiums - Dulcina Investments Inc.			
PURCHASERS: Mitchell Shane ATKINS and MARQUIS REAL ESTATE INVESTMENT CORPORATI			TEL:
Unit 11, Level 20 (2111-5)	Floor Plan C891 (5th)		

EXTRAS AS PER OFFER

1 Parking Unit - location to be selected by the Vendor at their sole discretion. <i>Worksheet</i> Note:	
--	--

This Document is Extremely Time Sensitive - Printed 9 Sep 24 at 15:35

RECEIVED
SEP 11 2024

Purchasers:

Telephone Res. / Bus:

Decor Advisor:

Lock Date:

Mitchell Shane ATKINS & MARQUIS REAL ESTA`
/
Ida Viola
9/9/2024 15:30:35

Const. No.:

Municipal:

Suite Type:

Project/Phase:

Unit 11, Level 20
2111
C891 (5th)
Dulcina Investments Inc./5

1. Kitchen and Vanities

	Style and Colour	Hardware
Kitchen	DORAL W500	Standard
Primary Ensuite Bathroom	DORAL W500	Standard
Bedroom 2 Ensuite	DORAL W500	Standard
Powder Room	DORAL W500	Standard

Kitchen Extended Upper Cabinets ☐ Yes ☒ No

Comment

** Refer to Construction Summary

2. Counters

	Counter	Edge
Kitchen	QUARTZ-ISTRIA	Standard
Primary Ensuite Bathroom	QUARTZ-ISTRIA	Standard
Bedroom 2 Ensuite	QUARTZ-ISTRIA	Standard
Powder Room	QUARTZ-ISTRIA	Standard
Kitchen Backsplash	TILE-GLOSSY WHITE 4X12	

Comment

** Refer to Construction Summary

3. Flooring - In all Non-Tiled Areas where Applicable

LAMINATE LEXINGTON - LANEFFE OAK TL LW1311

Comment

** Refer to Construction Summary

4. Tile

	Floor Tile	Wall Tile
Primary Ensuite Bathroom	TILE-CITY WHITE MATTE 12X24	TILE-GLOSSY WHITE 8X16
Bedroom 2 Ensuite	TILE-CITY WHITE MATTE 12X24	TILE-GLOSSY WHITE 8X16
Powder Room	TILE-CITY WHITE MATTE 12X24	
Laundry	TILE-WHITE MATTE 8X8	
Kitchen Backsplash	TILE-GLOSSY WHITE 4X12	

Comment

** Refer to Construction Summary - STANDARD GROUT THROUGHOUT UNLESS SPECIFIED

5. Wall, Trim and Door Paint - Standard paint as per constuction specificationThroughout.

Comment

** Refer to Construction Summary

Initials:

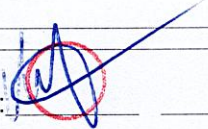

Purchasers:	Mitchell Shane ATKINS & MARQUIS REAL ESTA	Const. No.:	Unit 11, Level 20
Telephone Res. / Bus:	/	Municipal:	2111
Decor Advisor:	Ida Viola	Suite Type:	C891 (5th)
Lock Date:	9/9/2024 15:30:35	Project/Phase:	Dulcina Investments Inc./5

6. General Comments

Revision Detail

Disclaimers and Notes

The following disclaimers apply to all of the Purchaser's Extra, Purchaser's Estimate Request and all Interior Colour Selection Schedules. The Purchaser(s) acknowledges that the following items may affect matters relating to their unit:

Natural Stone
The Purchaser acknowledges that natural stone products such as granite, marble and quartz that are installed in their dwelling may vary in shading, pattern, texture, veining, pores, colour and fissures from the sample in the Vendor's Décor Centre despite having the same name. Marble is not recommended in high traffic areas, such as the kitchen, as marble is a more porous stone

Ceramic Tile
any variables affect tile colour, pattern and/or design which means that installed tiles may not be identical to the samples. As a result of the manufacturing process, tiles with the same name but of different sizes, may have different colours, pattern or and will not be an exact match to each other. Furthermore, the staggered pattern of the laid tiles will vary due to size of the tile. Purchaser accepts tiles as laid by Vendor.

Hardwood/Laminate Flooring
Cupping and shrinkage are characteristics of hardwood/laminate flooring normally appearing some time after installation, and warranty is provided by the flooring supplier with respect to such cupping and shrinkage. Purchaser acknowledges that hardwood

Appliances
All appliance openings are set to Vendor's standard width. Please advise Décor Centre at time of colour appointment if custom sizing of cabinets and openings are required for any appliance. The Purchaser is responsible for costs and fees associated with changes to standard kitchen cabinets and openings and shall provide the Vendor with appliance specifications prior to of colour chart.

If applicable, where appliances are supplied by the Vendor, the model may vary according to availability and the Purchaser acknowledges that the Vendor may substitute appliances for same or better quality as determined by the Vendor in its sole unfettered discretion.

The Purchaser(s) acknowledge that all measurements and locations are approximate only and are subject to verification on site and may be adjusted to accommodate site conditions. Purchaser acknowledges that not all of the above modifications were available or offered to the Purchaser.

- 1) Colours of all materials are as close as possible to builder's selection, but not necessarily identical due to variances in manufacturing.
- 2) The selection images are digital photographs of the Vendor's samples at its Decor Centre. Such images when displayed on your computer monitor may not match Decor Centre samples due to the hardware/software configuration of the computer. In the event of conflict between selection images and the Décor Centre samples, Décor Centre samples shall prevail.
- 3) Any extras listed above are null and void unless accompanied by a separate invoice/amendment. Said invoice must be paid in full.
- 4) The Purchaser agrees that this colour selection is final and that no changes will be permitted, unless required by the Vendor.
- 5) The Purchaser acknowledges reading and accepting document which contains other miscellaneous disclaimers.

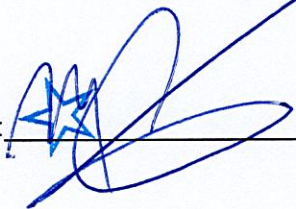
Signature: 

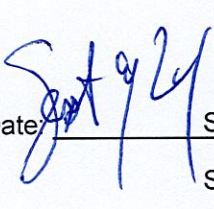
Date: 

Signature: _____

Date: _____

Signature: _____

Date: _____

Technical drawing of a kitchen island layout showing dimensions and component labels.

Dimensions:

- Overall width: 2225
- Overall depth: 3320
- Top section width: 1904
- Top section depth: 321
- Bottom section width: 1615
- Bottom section depth: 160
- Island width: 840
- Island depth: 1416
- Island top width: 3000
- Island top depth: 320
- Island bottom width: 904
- Island bottom depth: 160

Components and Labels:

- W376350 (Top left corner)
- W3766002 (Top right corner)
- B700 (Top right section)
- XCUSTOM-A (Top right section)
- FG65 (Top right section)
- BB80R1200 (Top right section)
- W376800 (Top left section)
- W376300 (Top left section)
- W3766002 (Middle left section)
- W340800 (Middle left section)
- W336CG (Middle left section)
- BD400 (Middle left section)
- 30-RANGE1 (Middle left section)
- W336CG (Middle left section)
- SPACE (Middle left section)
- BCG (Bottom left section)
- BS450R (Bottom left section)
- BS1000 (Bottom left section)
- 300MM DEEP BASE CAB. (Bottom left section)
- B8P145 (Bottom left section)
- PANEL 1455X895 (Bottom left section)
- EXT. BREAKFAST BAR (Bottom left section)
- BICG (Bottom left section)

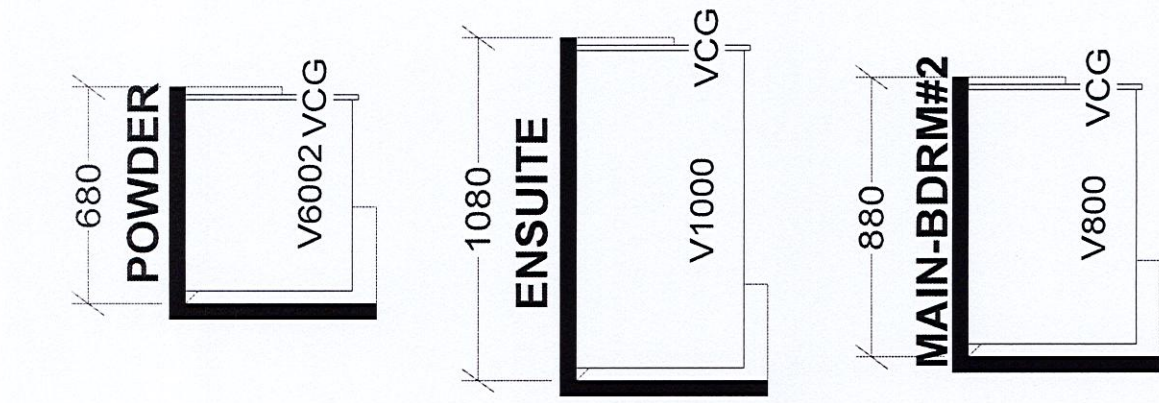
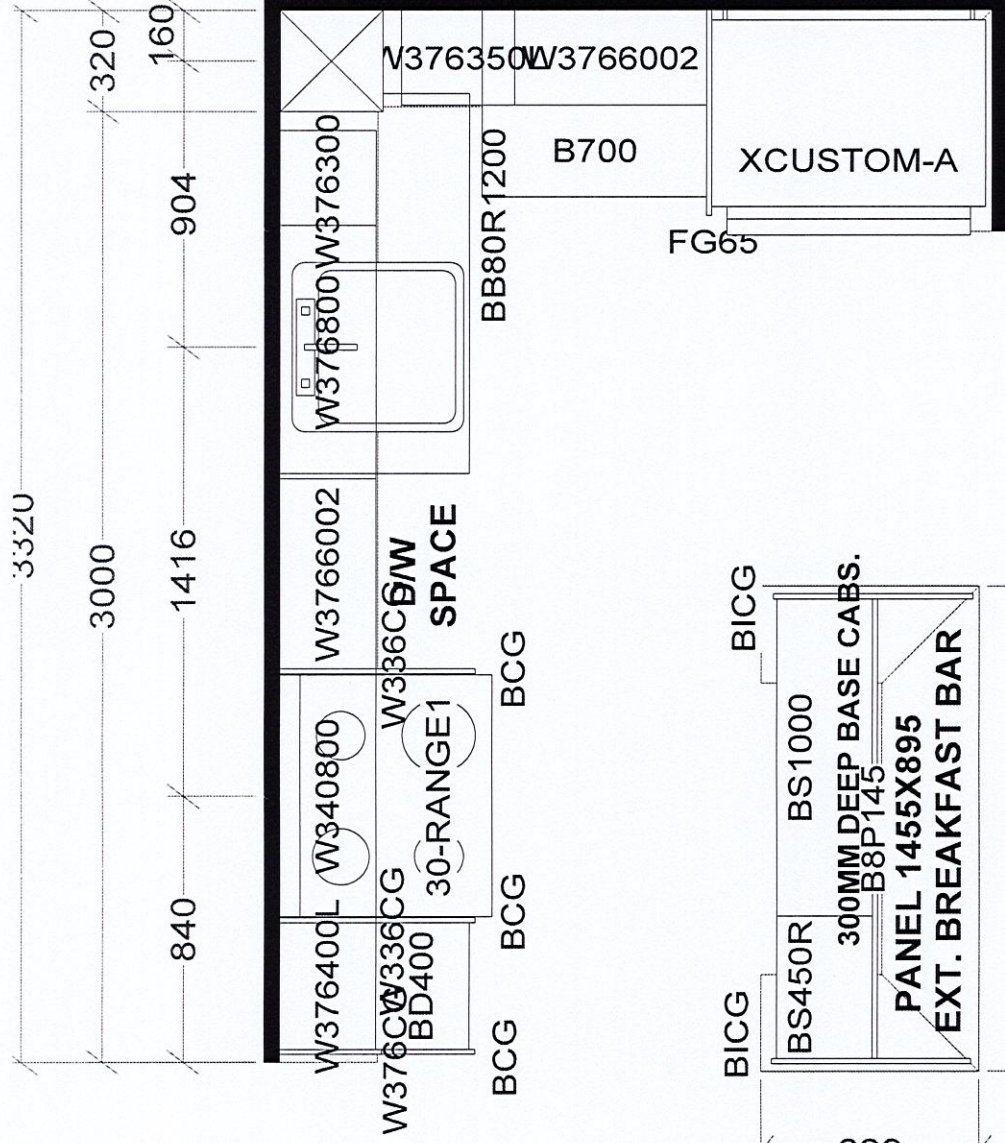
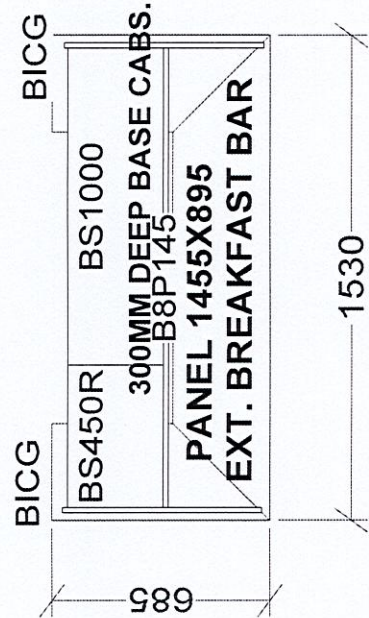

KITCHEN

X 40 UNITS

Selba Industries

W WIDTH _____	W HGHT _____	W CNT _____	This drawing is the intellectual property of SELBA INDUSTRIES INC. and is an original design which must not be released or copied unless applicable fee has been paid or job order placed.	JOB NUMBER:
FLOOR HGHT _____	DOOR HGHT _____			BUILDER: GREENPARK
				SITE: DULCINA (Charisma C)
ST CENT _____	2X4 _____	VENT BOX COVER _____		MODEL: C891X
				LOT #:
			DESIGNER: KS	
			DATE: APR 20 23	

Initials: DS
MSA