

CONSTRUCTION SUMMARY

Charisma Condominiums - Dulcina Investments Inc.

PURCHASER: Yasir KILLU

TEL:

Unit 1, Level 26 (2701-5)

Floor Plan
B695

CABINETRY

1 - KITCHEN CABINETRY HARDWARE - DELETE HARDWARE NO HOLES DRILLED
31Jan25 Note: KITCHEN AND BATHROOM

1 - KITCHEN CABINETRY - EXTENDED UPPER CABINETS - STANDARD LEVEL
31Jan25 Note:

COUNTER TOP

1 - KITCHEN COUNTERTOP - UPGRADE STONE COUNTERTOP IN LIEU OF VENDOR STANDARD QUARTZ
31Jan25 Note:

1 - MAIN BATH/ENSUITE VANITY COUNTERTOP - UPGRADE STONE COUNTERTOP IN LIEU OF VENDOR STANDARD QUARTZ
31Jan25 Note:

ELECTRICAL

1 - LIGHT - ADD CEILING LIGHT COMPLETE WITH FIXTURE AND SWITCH
31Jan25 Note: LIVING ROOM



HARDWOOD FLOORING

1 - LAMINATE - AVENUE SERIES IN LIEU OF STANDARD LAMINATE
31Jan25 Note:

EXTRAS AS PER OFFER

1 Parking Unit - location to be selected by the Vendor at their sole discretion.
Worksheet Note:

This Document is Extremely Time Sensitive - Printed 31 Jan 25 at 14:00

RECEIVED

FEB 06 2025

Purchaser: Yasir KILLU
Telephone Res. / Bus: /
Decor Advisor: Julia L Rosa
Lock Date: 1/31/2025 14:00:17

Const. No.: Unit 1, Level 26
Municipal: 2701
Suite Type: B695
Project/Phase: Dulcina Investments Inc./5

1. Kitchen and Vanities

| | Style and Colour | Hardware |
|--------------------------|------------------|----------|
| Kitchen | DORAL W-500 | N/A |
| Primary Ensuite Bathroom | N/A | N/A |
| Main Bathroom | DORAL W-500 | N/A |
| | | |
| | | |

Kitchen Extended Upper Cabinets ☒ Yes ☐ No

Comment

** Refer to Construction Summary

2. Counters

| | Counter | Edge |
|--------------------------|--------------------------|----------|
| Kitchen | QUARTZ - CALACATTA WAVE | Standard |
| Primary Ensuite Bathroom | N/A | N/A |
| Main Bathroom | QUARTZ - CALACATTA WAVE | Standard |
| | | |
| | | |
| Kitchen Backsplash | TILE - GLOSSY WHITE 4X12 | |

Comment

** Refer to Construction Summary

3. Flooring - In all Non-Tiled Areas where Applicable

LAMINATE-AVENUE-BOWERY OAK-TL-AV229

Comment

** Refer to Construction Summary

4. Tile

| | Floor Tile | Wall Tile |
|--------------------------|-------------------------------|--------------------------|
| Primary Ensuite Bathroom | N/A | N/A |
| Main Bathroom | TILE - CITY WHITE MATTE 12X24 | TILE - GLOSSY WHITE 8X16 |
| Laundry Room | TILE - WHITE MATTE 8X8 | N/A |
| | | |
| | | |
| Kitchen Backsplash | TILE - GLOSSY WHITE 4X12 | |

Comment

** Refer to Construction Summary - STANDARD GROUT THROUGHOUT UNLESS SPECIFIED

5. Wall, Trim and Door Paint - Standard paint as per constuction specificationThroughout.

Comment

** Refer to Construction Summary

| | | | |
|-----------------------|--------------------|----------------|----------------------------|
| Purchaser: | Yasir KILLU | Const. No.: | Unit 1, Level 26 |
| Telephone Res. / Bus: | / | Municipal: | 2701 |
| Decor Advisor: | Julia L Rosa | Suite Type: | B695 |
| Lock Date: | 1/31/2025 14:00:17 | Project/Phase: | Dulcina Investments Inc./5 |

6. General Comments

Revision Detail

Disclaimers and Notes

The following disclaimers apply to all of the Purchaser's Extra, Purchaser's Estimate Request and all Interior Colour Selection Schedules. The Purchaser(s) acknowledges that the following items may affect matters relating to their unit:

Natural Stone
The Purchaser acknowledges that natural stone products such as granite, marble and quartz that are installed in their dwelling may vary in shading, pattern, texture, veining, pores, colour and fissures from the sample in the Vendor's Décor Centre despite having the same name. Marble is not recommended in high traffic areas, such as the kitchen, as marble is a more porous stone

Ceramic Tile
any variables affect tile colour, pattern and/or design which means that installed tiles may not be identical to the samples. As a result of the manufacturing process, tiles with the same name but of different sizes, may have different colours, pattern or and will not be an exact match to each other. Furthermore, the staggered pattern of the laid tiles will vary due to size of the tile. Purchaser accepts tiles as laid by Vendor.

Hardwood/Laminate Flooring
Cupping and shrinkage are characteristics of hardwood/laminate flooring normally appearing some time after installation, and warranty is provided by the flooring supplier with respect to such cupping and shrinkage. Purchaser acknowledges that hardwood

Appliances
All appliance openings are set to Vendor's standard width. Please advise Décor Centre at time of colour appointment if custom sizing of cabinets and openings are required for any appliance. The Purchaser is responsible for costs and fees associated with changes to standard kitchen cabinets and openings and shall provide the Vendor with appliance specifications prior to of colour chart.

If applicable, where appliances are supplied by the Vendor, the model may vary according to availability and the Purchaser acknowledges that the Vendor may substitute appliances for same or better quality as determined by the Vendor in its sole unfettered discretion.

The Purchaser(s) acknowledge that all measurements and locations are approximate only and are subject to verification on site and may be adjusted to accommodate site conditions. Purchaser acknowledges that not all of the above modifications were available or offered to the Purchaser.

- Colours of all materials are as close as possible to builder's selection, but not necessarily identical due to variances in manufacturing.
- The selection images are digital photographs of the Vendor's samples at its Decor Centre. Such images when displayed on your computer monitor may not match Decor Centre samples due to the hardware/software configuration of the computer. In the event of conflict between selection images and the Décor Centre samples, Décor Centre samples shall prevail.
- Any extras listed above are null and void unless accompanied by a separate invoice/amendment. Said invoice must be paid in full.
- The Purchaser agrees that this colour selection is final and that no changes will be permitted, unless required by the Vendor.
- The Purchaser acknowledges reading and accepting document which contains other miscellaneous disclaimers.

Signature: _____ Date: Jan 31/25 Signature: _____ Date: _____

extended
uppers



Seiba Industries

3

| W | WDTH | W | HGHT | W | CNT | This drawing is the intellectual property of SEIRA INDUSTRIES INC. and is an | JOB NUMBER: |
|---|------|---|------|---|-----|---|-------------|
| | | | | | | | |

BUILDER: GREENPARK

SITE: DULCINA (Charisma C)

MODEL: B695-BFX

LOT#:

| W | WDTH | W HGHT | W CNT |
|-----|------|--------|-------|
| 1 | 1 | 1 | 1 |
| 2 | 2 | 2 | 2 |
| 3 | 3 | 3 | 3 |
| 4 | 4 | 4 | 4 |
| 5 | 5 | 5 | 5 |
| 6 | 6 | 6 | 6 |
| 7 | 7 | 7 | 7 |
| 8 | 8 | 8 | 8 |
| 9 | 9 | 9 | 9 |
| 10 | 10 | 10 | 10 |
| 11 | 11 | 11 | 11 |
| 12 | 12 | 12 | 12 |
| 13 | 13 | 13 | 13 |
| 14 | 14 | 14 | 14 |
| 15 | 15 | 15 | 15 |
| 16 | 16 | 16 | 16 |
| 17 | 17 | 17 | 17 |
| 18 | 18 | 18 | 18 |
| 19 | 19 | 19 | 19 |
| 20 | 20 | 20 | 20 |
| 21 | 21 | 21 | 21 |
| 22 | 22 | 22 | 22 |
| 23 | 23 | 23 | 23 |
| 24 | 24 | 24 | 24 |
| 25 | 25 | 25 | 25 |
| 26 | 26 | 26 | 26 |
| 27 | 27 | 27 | 27 |
| 28 | 28 | 28 | 28 |
| 29 | 29 | 29 | 29 |
| 30 | 30 | 30 | 30 |
| 31 | 31 | 31 | 31 |
| 32 | 32 | 32 | 32 |
| 33 | 33 | 33 | 33 |
| 34 | 34 | 34 | 34 |
| 35 | 35 | 35 | 35 |
| 36 | 36 | 36 | 36 |
| 37 | 37 | 37 | 37 |
| 38 | 38 | 38 | 38 |
| 39 | 39 | 39 | 39 |
| 40 | 40 | 40 | 40 |
| 41 | 41 | 41 | 41 |
| 42 | 42 | 42 | 42 |
| 43 | 43 | 43 | 43 |
| 44 | 44 | 44 | 44 |
| 45 | 45 | 45 | 45 |
| 46 | 46 | 46 | 46 |
| 47 | 47 | 47 | 47 |
| 48 | 48 | 48 | 48 |
| 49 | 49 | 49 | 49 |
| 50 | 50 | 50 | 50 |
| 51 | 51 | 51 | 51 |
| 52 | 52 | 52 | 52 |
| 53 | 53 | 53 | 53 |
| 54 | 54 | 54 | 54 |
| 55 | 55 | 55 | 55 |
| 56 | 56 | 56 | 56 |
| 57 | 57 | 57 | 57 |
| 58 | 58 | 58 | 58 |
| 59 | 59 | 59 | 59 |
| 60 | 60 | 60 | 60 |
| 61 | 61 | 61 | 61 |
| 62 | 62 | 62 | 62 |
| 63 | 63 | 63 | 63 |
| 64 | 64 | 64 | 64 |
| 65 | 65 | 65 | 65 |
| 66 | 66 | 66 | 66 |
| 67 | 67 | 67 | 67 |
| 68 | 68 | 68 | 68 |
| 69 | 69 | 69 | 69 |
| 70 | 70 | 70 | 70 |
| 71 | 71 | 71 | 71 |
| 72 | 72 | 72 | 72 |
| 73 | 73 | 73 | 73 |
| 74 | 74 | 74 | 74 |
| 75 | 75 | 75 | 75 |
| 76 | 76 | 76 | 76 |
| 77 | 77 | 77 | 77 |
| 78 | 78 | 78 | 78 |
| 79 | 79 | 79 | 79 |
| 80 | 80 | 80 | 80 |
| 81 | 81 | 81 | 81 |
| 82 | 82 | 82 | 82 |
| 83 | 83 | 83 | 83 |
| 84 | 84 | 84 | 84 |
| 85 | 85 | 85 | 85 |
| 86 | 86 | 86 | 86 |
| 87 | 87 | 87 | 87 |
| 88 | 88 | 88 | 88 |
| 89 | 89 | 89 | 89 |
| 90 | 90 | 90 | 90 |
| 91 | 91 | 91 | 91 |
| 92 | 92 | 92 | 92 |
| 93 | 93 | 93 | 93 |
| 94 | 94 | 94 | 94 |
| 95 | 95 | 95 | 95 |
| 96 | 96 | 96 | 96 |
| 97 | 97 | 97 | 97 |
| 98 | 98 | 98 | 98 |
| 99 | 99 | 99 | 99 |
| 100 | 100 | 100 | 100 |

FLOOR HGHT _____ DOOR HGHT _____

ST CENT _____ 2X4 _____ VENT BOX COVER _____

DESIGNER: KS
DATE: APR 20 2

June 1, 2023

SCHEDULE 'A'

THE FIFTH
AT CHARISMA

Add
Light

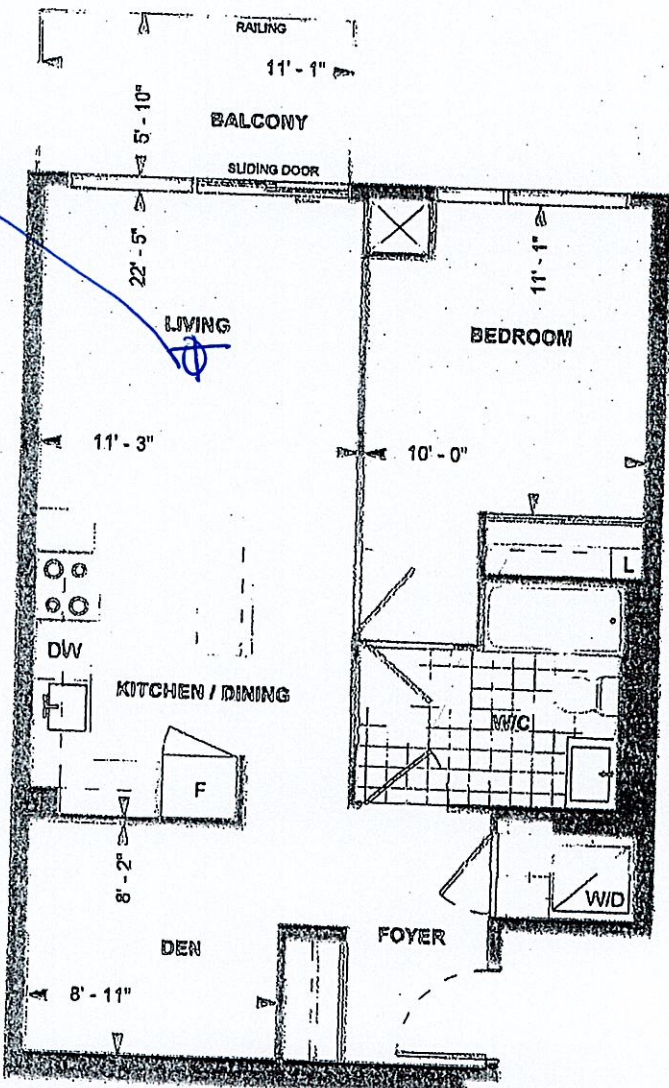

B695
TOWER SUITE
9' CEILING
695 sq. ft.
1-BEDROOM+DEN

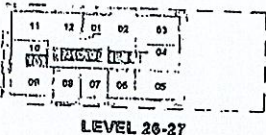

DS
Purchaser Initials [Signature] Date 07-Jun-24
Unit No. 01 Level No. 26 Suite No. 2701

Dimensions, specifications, layouts, location of materials and fixtures, tile floor patterns and architectural detailing (including window size and location and door size, location and swing) are approximate only and are subject to change or modifications, without notice. Actual usable floor space varies from stated floor area. Ceiling height measured from top of floor slab to underside of floor slab above and excludes finishes, bulkheads and drop ceilings. Orientation of suite may be reversed and Purchaser agrees to accept same. Balconies decks and terraces are exclusive use common elements shown for display purposes only and location and size are subject to change without notice. All illustrations are artist concept only. The provisions of the Agreement of purchase and sale apply to this Schedule, E. & O.E.