

CONSTRUCTION SUMMARY

Rise and Rose - Golden Ambra Highrise Inc.

RECEIVED

PURCHASERS: Gehan Adieb ABADER and Nadir Joseph ZAKI // AGIA CORP.

JUL 15 2025

TEL:

Unit 15, Level 2 (216-North)

Floor Plan
D987

CONSTRUCTION

1 - TUB TO SHOWER CONVERSION - INCLUDES CLEAR GLASS FRAMED SLIDING DOORS CHROME FINISH, PREFORMED SHOWER BASE AND SHOWER POT LIGHT

14Jul25 Note:

bedroom 2 ensuite

ELECTRICAL

1 - LIGHT - ADD CEILING LIGHT COMPLETE WITH FIXTURE AND SWITCH

14Jul25 Note:

living area

PLUMBING

2 - DELTA TRINSIC KIT DFKIT3 - TUB/SHOWER WITH TUB SPOUT - CHROME

14Jul25 Note: both bathrooms

This Document is Extremely Time Sensitive - Printed 15 Jul 25 at 9:42

SCHEDULE "A"
Agreement of Purchase and Sale

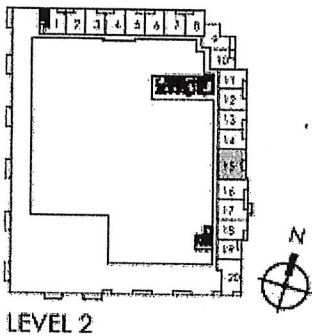

D987
987 SQ. FT.
PODIUM SUITE

Unit 15, Level 2 Suite 216

Dimensions, specifications, layouts, location of materials and fixtures, tile floor patterns and architectural detailing (including window size and location and door size, location and swing) are approximate only and are subject to change or modifications, without notice. Actual usable floor space varies from stated floor area. Ceiling height measured from top of floor slab to underside of floor slab above and excludes finishes, bulkheads and drop ceilings. Orientation of suite may be reverse and Purchaser agrees to accept same. Balconies, terraces and patios are exclusive use common elements shown for display purposes only and location and size are subject to change without notice. All illustrations are artist concept only. The provisions of the Agreement of Purchase and Sale apply to this Schedule.

E. & O. E.

DS DS
N ZG A
Initials: _____