

## CONSTRUCTION SUMMARY

The Enclave at Castlemore Village - Baltrio Construction Inc.

PURCHASERS: JAGMOHAN GREWAL and JASVIR KAUR GREWAL

TEL:

LOT / PHASE	REG. PLAN #	HOUSE TYPE		
23 / 1	43M-2013	York 2 Elev A		

### CABINETRY

1 - KITCHEN - DELETE CABINETS ABOVE STOVE - VENDOR WILL SUPPLY 6 INCH VENT AS PER STANDARD CONSTRUCTION SPECIFICATIONS AND VENT MAY NOT BE IN THE APPROPRIATE LOCATION FOR INSTALLATION OF PURCHASER SUPPLIED VENT 10Apr18 Note: TEMPORARY HOOD FAN TO BE INSTALLED FOR OCCUPANCY PURPOSES ONLY - PURCHASER TO SUPPLY OWN CHIMNEY FAN AFTER CLOSING	
1 - KITCHEN- UPGRADE 1 HARDWARE - INCLUDING SERVERY 10Apr18 Note:	

### CABINETRY ACCESSORIES

1 - DELETE SPACE FOR BEVERAGE FRIDGE - PURCHASE CANCELLED FRIDGE- INSTALL CABINETS 12Apr18 Note:	
1 - KITCHEN CABINETRY BASE - POT/PAN DRAWERS (CABINET) - UPGRADE 3-UNDER COOKTOP 10Apr18 Note:	
1 - KITCHEN CABINETRY BASE - COOKTOP CABINET WITH POT AND PAN UNDER- UPGRADE 3 10Apr18 Note:	
1 - OVEN CABINET - BUILT-IN - MICROWAVE COMBO - PRICE IS EACH - UPGRADE 3 10Apr18 Note:	
1 - KITCHEN CABINETRY UPPER - FULL DEPTH ABOVE FRIDGE - WITH GABLES - 600MM - PRICE IS EACH - UPGRADE 3 10Apr18 Note:	
1 - KITCHEN- LEAVE SPACE FOR BEVERAGE CENTER AS PER SPECS ATTACHED- 10Apr18 Note:	

### CERAMIC TILE

1 - UPGRADE 2 TILES- MASTER ENSUITE- FLOOR 10Apr18 Note:	
---	--

### COUNTER TOP

1 - UPGRADE COUNTERTOP- HARDSURFACE- ENSUITE 4/5 10Apr18 Note:	
1 - UPGRADE COUNTERTOP- HARDSURFACE-ENSUITE 2/3 10Apr18 Note:	
1 - UPGRADE COUNTERTOP- HARDSURFACE- POWDER ROOM 10Apr18 Note: GRANITE- QUARTZ OR MARBLE	
1 - UPGRADE COUNTERTOP TO QUARTZ IN LIEU OF STANDARD GRADE GRANITE- MASTER ENSUITE 10Apr18 Note:	
1 - UPGRADE COUNTERTOP TO QUARTZ IN LIEU OF STANDARD GRADE GRANITE- KITCHEN 10Apr18 Note:	

### ELECTRICAL

1 - DELETE PLUG - ELECTRICAL PLUG-PURCHASER CANCELLED BEVERAGE FRIDGE 12Apr18 Note:	
1 - BUILT IN OVEN AND COOKTOP PROVISION - PROVISION ONLY - ELECTRICAL ONLY 10Apr18 Note:	
1 - PLUG - ELECTRICAL PLUG 10Apr18 Note:	

### FIREPLACE AND ACCESSORIES



CONSTRUCTION SUMMARY

The Enclave at Castlemore Village - Baltrio Construction Inc.

PURCHASERS: JAGMOHAN GREWAL and JASVIR KAUR GREWAL

TEL:

LOT / PHASE	REG. PLAN #	HOUSE TYPE		
23 / 1	43M-2013	York 2 Elev A		
1 - GAS LINE ROUGH-IN FOR STOVE (INCLUDES ELECTRICAL OUTLET) - FIRST FLOOR 10Apr18 Note:				
1 - MANTEL - CAST STONE - AEQUALITAS STYLE MANTEL- TIMELESS GRAY 10Apr18 Note:				

HARDWOOD FLOORING

1 - FIRST FLOOR AND UPPER HALL- UPGRADE 5 "HARDWOOD GROUP B 10Apr18 Note:	
--	--

PLUMBING

3 - SINK - UNDERMOUNT SINK - CONTRAC COLLETTE #4220CIY 10Apr18 Note:	
1 - WATER LINE FOR FRIDGE - ROUGH-IN ONLY 10Apr18 Note:	

PROMOTIONAL

1 - LESS CREDIT FROM PURCHASER EXTRA SHEET IN OFFER 10Apr18 Note:	
--	--

EXTRAS AS PER OFFER

THE PURCHASERS ACKNOWLEDGE AND ACCEPT THAT THE PURCHASE PRICE INCLUDES ALL CREDITS AND PROMOTIONAL PACKAGES AVAILABLE AT THE TIME OF PURCHASE. Worksheet Note:	
The Vendor agrees that notwithstanding any other term or provision in this Agreement included in the Purchase Price and in addition to those items detailed in Schedule GP to the Agreement of Purchase and Sale, the Purchaser is entitled to a credit of THI Worksheet Note:	
THE PURCHASERS ACKNOWLEDGE AND ACCEPT ALL EXTERIOR COLOUR SELECTIONS AS BUILT. Worksheet Note:	

This Document is Extremely Time Sensitive - Printed 12 Apr 18 at 13:13



Purchasers:

Telephone Res. / Bus:

Decor Advisor:

Lock Date:

JAGMOHAN GREWAL & JASVIR KAUR GREW/Property: 23  
/Project: Baltrio Construction Inc.  
Natalie MancusoModel and Elevation: York 2 Elev A  
10-Apr-1810-Apr-18Plan #: 43M-2013

Layout Changes: ☐ Yes ☐ NoSketch Attached: ☐ Yes ☐ NoExterior Colour Scheme:

1. Cabinetry

	Style and Colour	Hardware
Kitchen / Breakfast	LEGACY L614XZ4	428SB
Laundry Room	ELISSE	
Powder Room	HAMPTON W350XZ4	1001
Master Ensuite Bathroom	ARCADIA D23	2004
Ensuite Bath - Bedroom 2/3	ARCADIA H1486	2004
Ensuite Bath - Bedroom 4/5	HAMPTON W826XZ4	1004

Appliances:

Dishwasher Cabinet

Stove Opening

Fridge Opening

Built In Appliances ☒ Yes ☐ No

☐ Closed ☒ Open

41" Upper Cabinets ☒ Yes ☐ No

Slide In Stove ☐ Yes ☒ No

36"

NOTE: If not specified, opening will be set to builder's standard opening of approximately 30" width

NOTE: If not specified, opening will be set to builder's standard opening of approximately 37" width x 74" height

Please NOTE: Standard Cabinet Height is 30"

\*\* Refer to Construction Summary

2. Counters

	Counter	Edge
Kitchen / Breakfast	QUARTZITE-SUPER WHITE	PENCIL ROUND #320
Laundry Room		
Powder Room	MARBLE-GRIS PULPIS	PENCIL ROUND #320
Master Ensuite Bathroom	MARBLE-GRIS PULPIS	PENCIL ROUND #320
Ensuite Bath - Bedroom 2/3	MARBLE-ICE DROP SILVER	PENCIL ROUND #320
Ensuite Bath - Bedroom 4/5	QUARTZ-ISTRIA	PENCIL ROUND #320

\*\* Refer to Construction Summary

Initials: 



**Purchasers:** JAGMOHAN GREWAL & JASVIR KAUR GREW/**Property:** 23  
**Telephone Res. / Bus:** / **Project:** Baltrio Construction Inc.  
**Decor Advisor:** Natalie Mancuso **Model and Elevation:** York 2 Elev A  
**Lock Date:** 10-Apr-18 10-Apr-18 **Plan #:** 43M-2013

3. Ceramic Flooring

		At a 45	Threshold-If App.
Entrance Vestibule	TILE-VERSAILLES CHESNAY GREY BRILL 12X24	<input type="checkbox"/>	METAL STRIP WERE APPL.
Main Hall	HARDWOOD	<input type="checkbox"/>	
Kitchen / Breakfast	TILE-VERSAILLES CHESNAY GREY BRILL 12X24	<input type="checkbox"/>	
Laundry Room	TILE-VERSAILLES CHESNAY GREY BRILL 12X24	<input type="checkbox"/>	
Powder Room	TILE-VERSAILLES CHESNAY GREY BRILL 12X24	<input type="checkbox"/>	
Master Ensuite Bathroom	TILE-PRY200 ROYAL CARRARA 10X24	<input type="checkbox"/>	
Ensuite Bath - Bedroom 2/3	TILE-RAINBOW WHITE 13X13	<input type="checkbox"/>	
Ensuite Bath - Bedroom 4/5	TILE-HABITAT SILVER GREY 12X12	<input type="checkbox"/>	
		<input type="checkbox"/>	
		<input type="checkbox"/>	
		<input type="checkbox"/>	

\*\* Refer to Construction Summary

4. Ceramic Wall Tile

Master Ensuite Bathroom	Selection	Describe
Tub Deck Wall		
Tub Deck		
Tub Deck Skirt		
Shower Stall	TILE-BLANC GROENLANDIA LUC 8X16	
Bathtub Enclosure Walls		
Ensuite Bath - Bedroom 2/3	TILE-CONCEPT LUC. NEVE 8X16	
Ensuite Bath - Bedroom 4/5	TILE-BEIGE SAT. AMERICA 8X16	
Kitchen Backsplash		

\*\* Refer to Construction Summary - STANDARD GROUT THROUGHOUT UNLESS SPECIFIED

5. Plumbing Fixtures

All Bathrooms	White	<div>Whirlpool</div> <div><input type="text"/> <input type="radio"/> Yes <input checked="" type="radio"/> No</div> <div>Dishwasher Rough-In <input checked="" type="radio"/> Yes <input type="radio"/> No</div> <div>Waterline for Fridge <input checked="" type="radio"/> Yes <input type="radio"/> No</div>
	<input type="text"/>	
	<input type="text"/>	
	<input type="text"/>	
	<input type="text"/>	

\*\* Refer to Construction Summary

6. Trim Carpentry

Interior Doors	CARRARA-SMOOTH
Interior Trim	STANDARD
Door Handles	As Per Construction Specifications
Exterior Front Door Handle	As Per Construction Specifications

\*\* Refer to Construction Summary

Initials: 



**Purchasers:** JAGMOHAN GREWAL & JASVIR KAUR GREW/**Property:** 23  
**Telephone Res. / Bus:** / **Project:** Baltrio Construction Inc.  
**Decor Advisor:** Natalie Mancuso **Model and Elevation:** York 2 Elev A  
**Lock Date:** 10-Apr-18 10-Apr-18 **Plan #:** 43M-2013

7. Other Flooring

Main Hall	MIRAGE MAPLE 5" CHARACTER PEPPERMINT CASHMERE-
Living Room	MIRAGE MAPLE 5" CHARACTER PEPPERMINT CASHMERE-
Dining Room	MIRAGE MAPLE 5" CHARACTER PEPPERMINT CASHMERE-
Family Room	MIRAGE MAPLE 5" CHARACTER PEPPERMINT CASHMERE-
Den / Library / Study	MIRAGE MAPLE 5" CHARACTER PEPPERMINT CASHMERE-
Basement Landing(If Applies)	Lexington; Hazelwood Oak TL 21016-M.
Lower Landing (If Applies)	MIRAGE MAPLE 5" CHARACTER PEPPERMINT CASHMERE-
Upper Landing	MIRAGE MAPLE 5" CHARACTER PEPPERMINT CASHMERE-
Upper Hall	MIRAGE MAPLE 5" CHARACTER PEPPERMINT CASHMERE-
Master Bedroom	CARPET-SHAW - E0949 NEWBERN CLASSIC - TAUPE 55105
Bedroom #2	CARPET-SHAW - E0949 NEWBERN CLASSIC - TAUPE 55105
Bedroom #3	CARPET-SHAW - E0949 NEWBERN CLASSIC - TAUPE 55105
Bedroom #4	CARPET-SHAW - E0949 NEWBERN CLASSIC - TAUPE 55105
Bedroom #5	CARPET-SHAW - E0949 NEWBERN CLASSIC - TAUPE 55105
Underpad	Type Area

\*\* Refer to Construction Summary

8. Railings and Pickets

Railing Type	V-GROOVE	Colour	MIRAGE PEPPERMINT
Picket Type	EUROLINE 1	Colour	BLACK
Stringer / Riser	STANDARD	Colour	MIRAGE PEPPERMINT
Treads	STANDARD	Colour	MIRAGE PEPPERMINT
Red Oak Stairs with Semi Gloss Finish		<input checked="" type="radio"/> Yes <input type="radio"/> No	

\*\* Refer to Construction Summary

9. Wall Paint Flat Finish

Main & Upper Hall	25 OYSTER	Master Bedroom	25 OYSTER
Living Room	25 OYSTER	Bedroom #2	25 OYSTER
Dining Room	25 OYSTER	Bedroom #3	25 OYSTER
Kitchen / Breakfast	25 OYSTER	Bedroom #4	25 OYSTER
Family Room	25 OYSTER	Bedroom #5	25 OYSTER
Powder Room	25 OYSTER	Master Ensuite	25 OYSTER
Laundry Room	25 OYSTER	Ensuite Bath - Bedroom 4/5	25 OYSTER
Den/Library	25 OYSTER		
Trim Paint-Semi Gloss	BIRCH WHITE		

Smooth Ceilings First Floor ☒ Yes ☐ No

\*\* Refer to Construction Summary

Initials: 



Purchasers: JAGMOHAN GREWAL & JASVIR KAUR GREW/Property: 23  
Telephone Res. / Bus: / Project: Baltrio Construction Inc.  
Decor Advisor: Natalie Mancuso Model and Elevation: York 2 Elev A  
Lock Date: 10-Apr-18 10-Apr-18 Plan #: 43M-2013

**10. Plaster Mouldings and Medallions**

Entrance Vestibule			Kitchen/Breakfast		
Main Hall			Den/Library		
Living Room			Lower Landing		
Dining Room					
Family Room					

**\*\* Refer to Construction Summary****11. Fireplace**

	Living Room			Family Room			Other Room - Specify		
	Purchased	As Per Plan	N/A	Purchased	As Per Plan	N/A	Purchased	As Per Plan	N/A
Fireplace Type	<input type="radio"/>	<input type="radio"/>	<input type="radio"/>	<input type="radio"/>	<input checked="" type="radio"/>	<input type="radio"/>	<input type="radio"/>	<input type="radio"/>	<input type="radio"/>
Mantle Type				AEQUALITAS TIMELESS GREY					
Colour / Stain									
Surround									
Hearth									

**\*\* Refer to Construction Summary****12. Heating and Air Conditioning**

Air Conditioning	NO	Gas Provisions Stove	YES
Gas Provisions Dryer	NO	Gas Provisions Barbecue	NO
Comment			

**\*\* Refer to Construction Summary****13. Electrical**

Plugs and Switches	<input checked="" type="radio"/> White	DECOR	Above Kitchen Cabinet Light	<input type="radio"/> Yes	<input checked="" type="radio"/> No
Hood Fan	-after closing		Below Kitchen Cabinet Light	<input type="radio"/> Yes	<input checked="" type="radio"/> No
Appliances	Built in Cooktop	Built in Oven	Gas Stove	Microwave	
	<input checked="" type="radio"/> Yes <input type="radio"/> No	<input checked="" type="radio"/> Yes <input type="radio"/> No	<input checked="" type="radio"/> Yes <input type="radio"/> No	<input checked="" type="radio"/> Yes <input type="radio"/> No	
Dishwasher Rough-in	Yes				

**\*\* Refer to Construction Summary****14. General Comments****\*\* Refer to Construction Summary****Disclaimers and Notes**

- Colours of all materials are as close as possible to builder's selection, but not necessarily identical due to variances in manufacturing.
- Any extras listed above are null and void unless accompanied by a separate invoice/amendment. Said invoice must be paid in full.
- The Purchaser agrees that this colour selection is final and that no changes will be permitted, unless required by the Vendor.
- The Purchaser acknowledges reading and accepting document which contains other miscellaneous disclaimers.

Signature: Jagmohan Grewal Date: \_\_\_\_\_ Signature: \_\_\_\_\_ Date: \_\_\_\_\_



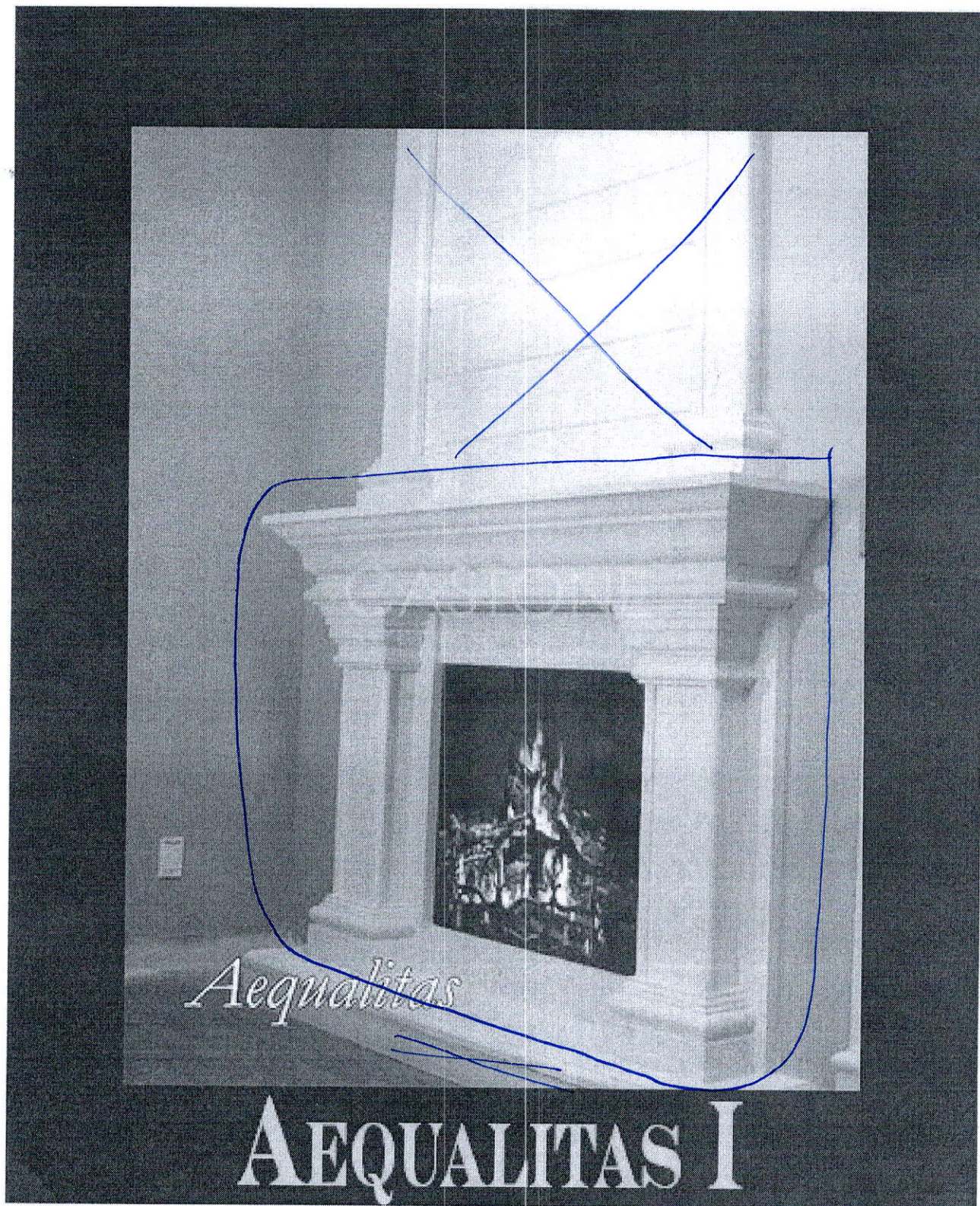

no hearth, no overhead  
mantel only.



**KitchenAid®**  
FOR THE WAY IT'S MADE.®

**30" (72.6 cm) and 36" (91.4 cm) Wall-Mount Canopy Range Hood**

**PRODUCT MODEL NUMBERS**

KVWB600D **KVWB606D**

**Electrical:** A 120 volt, 60 Hz., AC only, 15-amp, fused electrical circuit is required.

**VENTING METHODS**

This canopy range hood is factory set for venting through the roof or through the wall.

A 6" (15.2 cm) round vent system is needed for installation (not included). The hood exhaust opening is 6" (15.2 cm) round.

**NOTE:** Flexible vent is not recommended. Flexible vent creates back pressure and air turbulence that greatly reduce performance.

Vent system can terminate either through the roof or wall. To vent through a wall, a 90° elbow is needed.

**Rear Discharge**

A 90° elbow may be installed immediately above the hood.

**For Non-Vented (Recirculating) Installations**

If it is not possible to vent cooking fumes and vapors to the outside, the hood can be used in the non-vented (recirculating) version, using a Recirculation Kit (which includes charcoal filters and a deflector). To order, see the "Assistance or Service" section.

**Roof Venting**

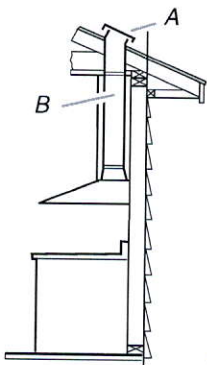

A. Roof cap  
B. 6" (15.2 cm) round vent

**Wall Venting**

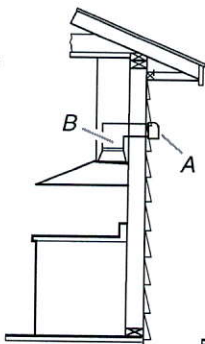

A. Wall cap  
B. 6" (15.2 cm) round vent

**Non-Vented (Recirculating)**

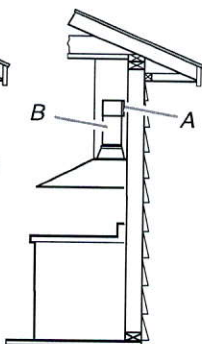

A. Diverter  
B. 6" (15.2 cm) round vent

**Calculating Vent System Length**

To calculate the length of the system you need, add the equivalent feet (meters) for each vent piece used in the system.

**Vent System**

Vent Piece	6" (15.2 cm) Round
45° elbow	2.5 ft (0.8 m)
90° elbow	5.0 ft (1.5 m)

Maximum equivalent vent length is 35 ft (10.7 m).

**Example Vent System**

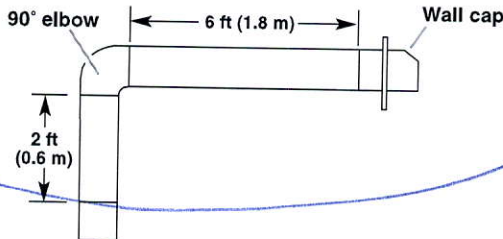

The following example falls within the maximum recommended vent length of 35 ft (10.7 m).

1 - 90° elbow = 5.0 ft (1.5 m)

1 - wall cap = 0.0 ft (0.0 m)

8 ft (2.4 m) straight = 8.0 ft (2.4 m)

Length of system = 13.0 ft (3.9 m)

**PRODUCT DIMENSIONS**

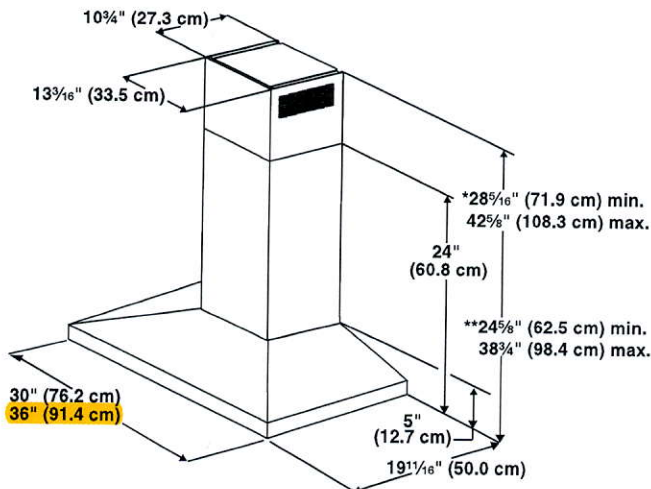

\*For non-vented (recirculating) installations

\*\*For vented installations



CABINET DIMENSIONS

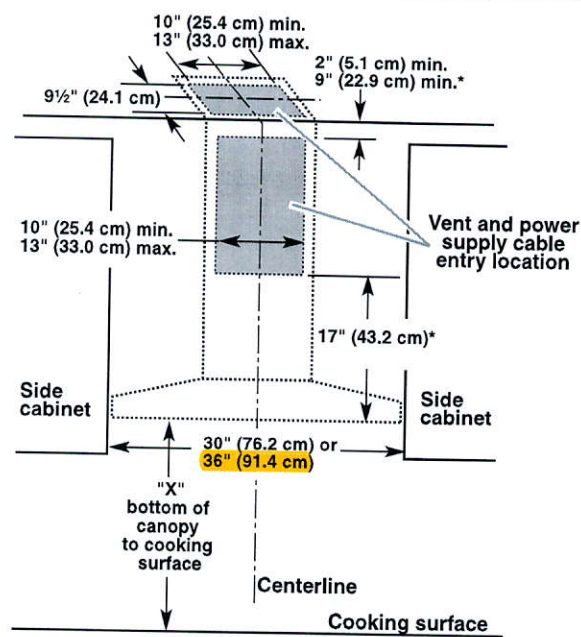

\*For non-vented (recirculating) installations

IMPORTANT:

- Minimum distance "X": 24" (61.0 cm) from electric cooking surface.
- Minimum distance "X": 27" (68.6 cm) from gas cooking surfaces.
- Suggested maximum distance "X": 36" (91.4 cm)

The chimneys can be adjusted for different ceiling heights. See the following chart.

Vented Installations		
	Min. ceiling height	Max. ceiling height
Electric cooking surface	7' 1" (2.16 m)	9' 2" (2.79 m)
Gas cooking surface	7' 4" (2.23 m)	9' 2" (2.79 m)

Non-vented (recirculating) Installations		
	Min. ceiling height	Max. ceiling height
Electric cooking surface	7' 1" (2.16 m)	9' 6" (2.9 m)
Gas cooking surface	7' 4" (2.23 m)	9' 6" (2.9 m)

**\*NOTE:** The range hood chimneys are adjustable and designed to meet varying ceiling or soffit heights depending on the distance "X" between the bottom of the range hood and the cooking surface. For higher ceilings, a Chimney Extension Kit is available from your dealer or an authorized parts distributor. The chimney extension replaces the chimney shipped with the range hood. To order, see the "Assistance or Service" section.



JENN-AIR® DETAILED PLANNING DIMENSIONS

36" GAS COOKTOP

JGC2536EB – 36" x 4<sup>3</sup>/<sub>16</sub>" x 21"

PRODUCT DIMENSIONS

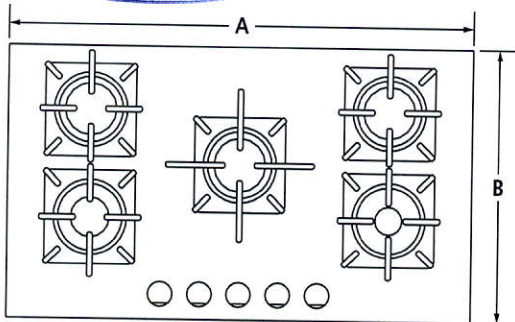

TOP VIEW

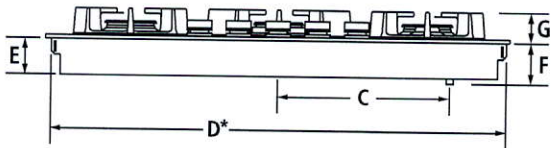

FRONT VIEW

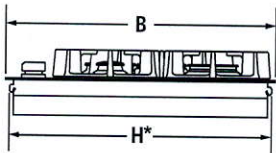

SIDE VIEW

MODEL #		JGC2536EB	
		in	cm
A	Overall width	36	91.4
B	Overall depth	21	53.3
C	Center of cooktop to center of gas inlet	15 <sup>3</sup> / <sub>16</sub>	38.6
D*	Width of recessed cooktop	35 <sup>5</sup> / <sub>16</sub>	89.7
E	Height of recessed cooktop	3 <sup>3</sup> / <sub>16</sub>	8.1
F	Height from gas inlet to countertop	4 <sup>3</sup> / <sub>16</sub>	10.6
G	Height with grates	2 <sup>5</sup> / <sub>16</sub>	5.9
H*	Depth of recessed cooktop	20 <sup>5</sup> / <sub>16</sub>	51.6

\*Measured from tab to tab. Tabs should not be bent during installation.

**IMPORTANT:** Dimensional specifications are provided for planning purposes only.  
**Do not make any cutouts based on this information.** Refer to the Installation Guide *before* selecting cabinetry, verifying electrical/gas connections, making cutouts or beginning installation.  
All Jenn-Air® appliances are appropriately UL, CUL or CSA approved.



8765AdZw416



JENN-AIR® DETAILED PLANNING DIMENSIONS

36" GAS COOKTOP

JGC2536EB – 36" x 4<sup>3</sup>/<sub>16</sub>" x 21"

OPENING/CLEARANCE DIMENSIONS

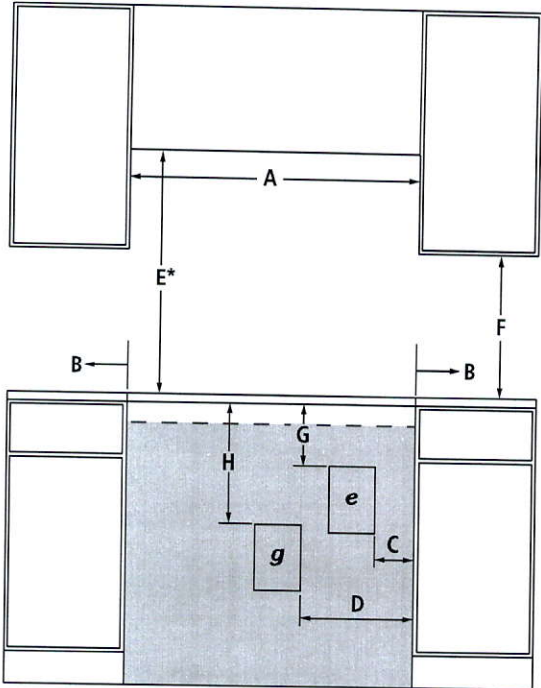

FRONT VIEW

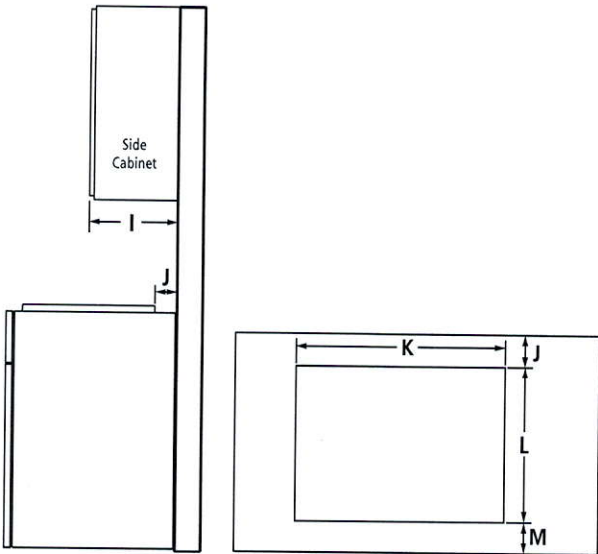

SIDE VIEW

TOP VIEW – CUTOUT

MODEL #		JGC2536EB	
		in	cm
A	Width of combustable area above cooking surface (min.)	36	91.4
B	Width from cooktop to fixed wall or other combustable material (min.)	6	15.2
C	Width to outer edge of electrical outlet (recommended)	9	22.9
D	Width to gas supply line location (recommended)	12	30.5
E*	Height to bottom of uncovered wood or metal cabinet above cooking surface (min.)	30	76.2
F	Height to bottom of uncovered wood or metal cabinet (min.)	18	45.7
G	Height to top edge of electrical outlet (recommended)	9	22.9
H	Height to gas supply line location (recommended)	18	45.7
I	Depth of upper cabinet (recommended)	13	33.0
J	Depth from cutout to wall (min.)	2 <sup>5</sup> / <sub>16</sub>	5.9
K	Width of cutout	35 <sup>3</sup> / <sub>8</sub>	89.9
L	Depth of cutout	20 <sup>3</sup> / <sub>8</sub>	51.8
M	Depth from cutout to front of countertop (recommended)	2 <sup>5</sup> / <sub>16</sub>	5.9
e	Recommended electrical access location		
g	Recommended gas supply line location		

\*Dimension can be reduced by 6" (15.2 cm) when bottom of wood or metal cabinet is covered by not less than ¼" (0.6 cm) flame retardant millboard covered with not less than No. 28 MSG sheet metal, 0.015" (0.4 mm) stainless steel, 0.024" (0.6 mm) aluminum or 0.020" (0.5 mm) copper. If installing a hood or microwave hood combination above the cooktop, follow the hood or microwave hood combination instructions for dimensional clearances above the cooking surface.

GAS REQUIREMENTS

Natural Gas

This cooktop is factory-set for use with natural gas.

LP Gas Conversion

Conversion must be done by a qualified service technician. To convert to LP gas, use an LP gas conversion kit.

ELECTRICAL REQUIREMENTS

120 volt, 60 Hz, AC only, 15-amp fused, electrical circuit is required. A time-delay fuse or dedicated circuit is recommended.

LOCATION REQUIREMENTS

- To ensure cooktop base clearance, cabinet side walls need to be wider than the cutout.
- If cabinet has a drawer, allow a 4" (10.2 cm) minimum clearance between countertop and top of drawer. Drawer depth may need to be shortened to avoid interfering with the gas connection or regulator.

**IMPORTANT:** Dimensional specifications are provided for planning purposes only. Do not make any cutouts based on this information. Refer to the Installation Guide before selecting cabinetry, verifying electrical/gas connections, making cutouts or beginning installation. All Jenn-Air® appliances are appropriately UL, CUL or CSA approved.



8765AdZw416



# KitchenAid®

## 27" (68.6 cm) and 30" (76.2 cm) Electric Built-In Convection Microwave Oven

### PRODUCT MODEL NUMBERS

KMBP100E

KMBP107E

### ELECTRICAL CONNECTION

- Microwave oven must be connected to the proper electrical voltage and frequency as specified on the model/serial number rating plate. The model/serial/rating plate is located underneath the control panel, along the oven vent.

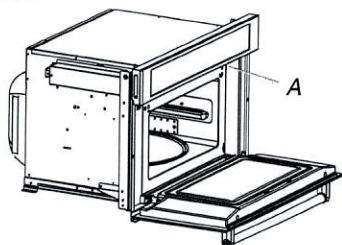

A. Model/serial/rating plate

- The microwave oven rated 120/240 volt, 20-amp, has 4 wires (L1, L2, N and G) in the flex conduit and should be connected to a 20-amp maximum rated circuit, overcurrent protected on both the L1 and L2 circuits.
- A time-delay fuse or circuit breaker is recommended.

### PRODUCT DIMENSIONS

#### 27" (68.6 cm) and 30" (76.2 cm) Microwave Ovens

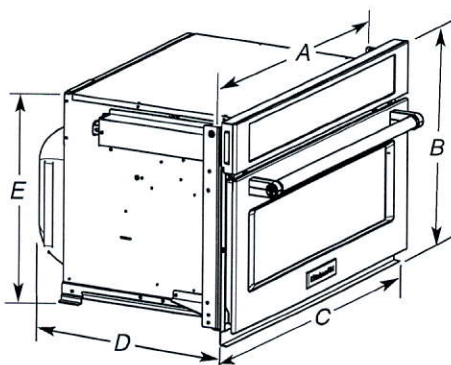

##### 27" (68.6 cm) models

- A. 25 1/8" (64.5 cm)
- B. 18 5/8" (47.3 cm) overall height
- C. 26 3/4" (67.9 cm) overall width
- D. 21 1/2" (54.6 cm)
- E. 17 3/8" (44.1 cm)

##### 30" (76.2 cm) models

- A. 28 3/8" (72.1 cm)
- B. 18 5/8" (47.3 cm) overall height
- C. 29 3/4" (75.6 cm) overall width
- D. 21 1/2" (54.6 cm)
- E. 17 3/8" (44.1 cm)

#### 27" (68.6 cm) and 30" (76.2 cm) Microwave Oven Spacer Kit

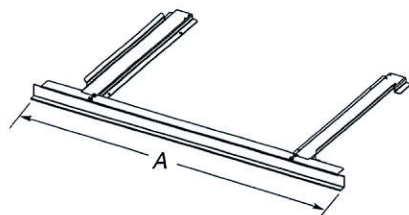

##### 27" (68.6 cm) models

- A. 26 3/4" (67.9 cm) overall width

##### 30" (76.2 cm) models

- A. 29 3/4" (75.6 cm) overall width

**NOTE:** The microwave oven spacer kit will allow the microwave oven to be installed in a 17 3/8"-17 3/4" (44.1-45.1 cm) maximum cutout height.

A microwave oven spacer kit is available from your dealer that will allow the microwave oven to be installed in a 19"-19 1/8" (48.3-50.2 cm) maximum cutout height. Match the oven size to the following kits:

- 27" (68.6 cm) Stainless Steel - Model W10469901
- 30" (76.2 cm) Stainless Steel - Model W10469903

To order, see the "Assistance or Service" section of the Use and Care Guide.

### CABINET DIMENSIONS

#### 27" (68.6 cm) and 30" (76.2 cm) Microwave Ovens

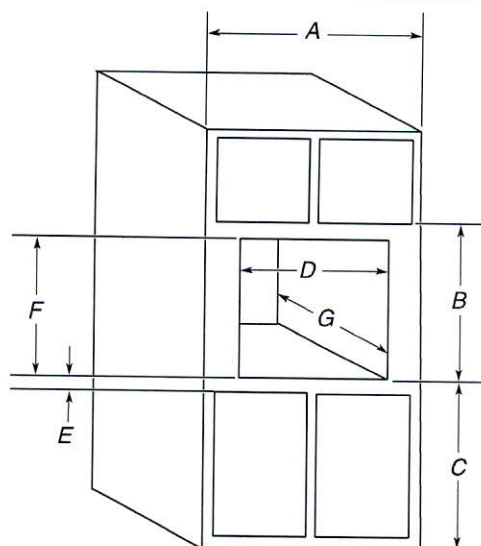

##### 27" (68.6 cm) models

- A. 27" (68.6 cm) min. cabinet width
- B. 18 5/8" (47.3 cm) from bottom of cutout to bottom of upper cabinet door
- C. 40" (101.6 cm) bottom of cutout to floor (recommended)
- D. 25 1/2" (64.8 cm) cutout width
- E. 1 1/8" (3.8 cm) min. bottom of cutout to top of cabinet door
- F. 17 3/8" (44.7 cm) recommended cutout height (will fit cutout height from 17 3/8" [44.1 cm] to 17 3/4" [45.1 cm])
- G. 21 1/8" (55.5 cm) min. cutout depth

##### 30" (76.2 cm) models

- A. 30" (76.2 cm) min. cabinet width
- B. 18 5/8" (47.3 cm) from bottom of cutout to bottom of upper cabinet door
- C. 40" (101.6 cm) bottom of cutout to floor (recommended)
- D. 28 1/2" (72.4 cm) cutout width
- E. 1 1/8" (3.8 cm) min. bottom of cutout to top of cabinet door
- F. 17 3/8" (44.7 cm) recommended cutout height (will fit cutout height from 17 3/8" [44.1 cm] to 17 3/4" [45.1 cm])
- G. 21 1/8" (55.5 cm) min. cutout depth

### MINIMUM INSTALLATION CLEARANCES

For proper installation, the following minimum clearances must exist above and below the cabinet opening.

#### Installation Above Single Built-In Oven

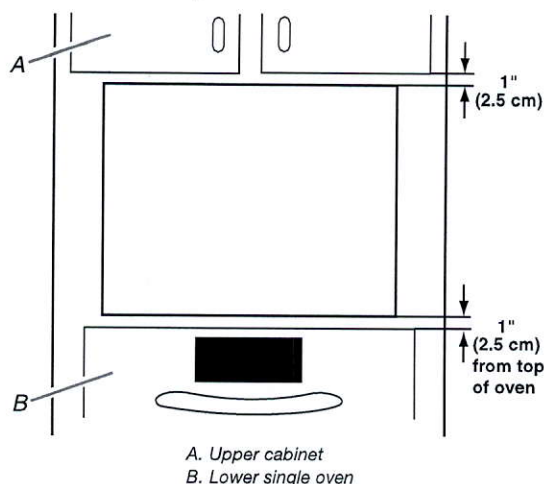

- A. Upper cabinet
- B. Lower single oven

Approved models: KMBP100E and KMBP107E.



CABINET DIMENSIONS - SINGLE OVENS

Single Oven Undercounter (without cooktop installed above)

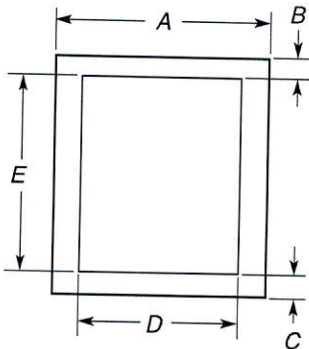

27" (68.6 cm) models

- A. 27" (68.6 cm) min. cabinet width
- B. 1½" (3.8 cm) min. top of cutout to underside of countertop
- C. 5¼" (13.3 cm) bottom of cutout to floor
- D. 25½" (64.8 cm) cutout width
- E. 28" (71.2 cm) min. cutout height

30" (76.2 cm) models

- A. 30" (76.2 cm) min. cabinet width
- B. 1½" (3.8 cm) min. top of cutout to underside of countertop
- C. 5¼" (13.3 cm) bottom of cutout to floor
- D. 28½" (72.4 cm) cutout width
- E. 28" (71.2 cm) min. cutout height

Single Ovens Installed in Cabinet

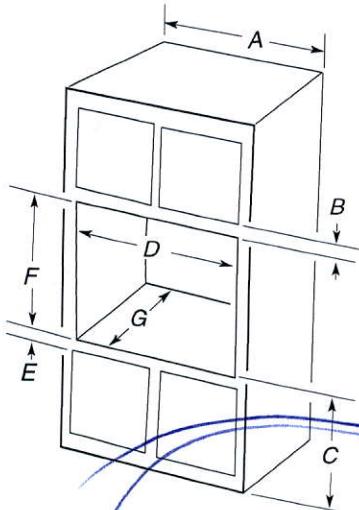

27" (68.6 cm) models

- A. 27" (68.6 cm) min. cabinet width
- B. 1" (2.5 cm) top of cutout to bottom of upper cabinet door
- C. 32" (81.3 cm) bottom of cutout to floor
- D. 25½" (64.8 cm) cutout width
- E. 1½" (3.8 cm) min. bottom of cutout to top of cabinet door
- F. 28" (71.2 cm)\* recommended cutout height
- G. 24" (60.7 cm) cutout depth

30" (76.2 cm) models

- A. 30" (76.2 cm) min. cabinet width
- B. 1" (2.5 cm) top of cutout to bottom of upper cabinet door
- C. 32" (81.3 cm) bottom of cutout to floor
- D. 28½" (72.4 cm) cutout width
- E. 1½" (3.8 cm) min. bottom of cutout to top of cabinet door
- F. 28" (71.2 cm)\* recommended cutout height
- G. 24" (60.7 cm) cutout depth

\*NOTE: The cutout height can be between 26½" (68.4 cm) and 29⅞" (74.8 cm) for single ovens.

CABINET DIMENSIONS - SINGLE OVENS

Double Ovens Installed in Cabinet

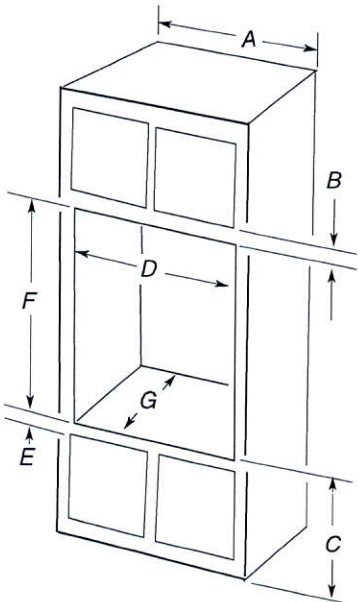

27" (68.6 cm) models

- A. 27" (68.6 cm) min. cabinet width
- B. 1" (2.5 cm) top of cutout to bottom of upper cabinet door
- C. 14¾" (37.5 cm) bottom of cutout to floor is recommended. 4"-14¾" (10.2-37.5 cm) bottom of cutout to floor is acceptable.
- D. 25½" (64.8 cm) cutout width
- E. 1½" (3.8 cm) min. bottom of cutout to top of cabinet door
- F. 50¼" (127.6 cm)\* recommended cutout height
- G. 24" (60.7 cm) cutout depth

30" (76.2 cm) models

- A. 30" (76.2 cm) min. cabinet width
- B. 1" (2.5 cm) top of cutout to bottom of upper cabinet door
- C. 14¾" (37.5 cm) bottom of cutout to floor is recommended. 4"-14¾" (10.2-37.5 cm) bottom of cutout to floor is acceptable.
- D. 28½" (72.4 cm) cutout width
- E. 1½" (3.8 cm) min. bottom of cutout to top of cabinet door
- F. 50¼" (127.6 cm)\* recommended cutout height
- G. 24" (60.7 cm) cutout depth

\*NOTE: The cutout height can be between 48⅞" (124.1 cm) and 52⅞" (132.6 cm) for double ovens.



27" (68.6 CM) AND 30" (76.2 CM) ELECTRIC SINGLE AND DOUBLE BUILT-IN OVEN

PRODUCT MODEL NUMBERS

KODE300E	KODT100E	KOST100E
KODE307E	KODT107E	KOST107E
KODE500E	KOSE500E	KEBS109E
KODE507E	KOSE507E	KEBS209E
		KEBS207E

**Electrical:** To properly install your oven, you must determine the type of electrical connection you will be using and follow the instructions provided for it here.

- Oven must be connected to the proper electrical voltage and frequency as specified on the model/serial number rating plate. The model/serial number rating plate is located under the control panel on single ovens and under the control panel on the upper oven cavity on double ovens. See the following illustrations.

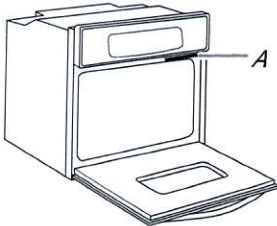

Single Oven

A. Model/serial number plate

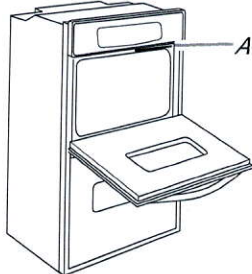

Double Oven

A. Model/serial number plate

- Models rated from 7.3 to 9.6 kW at 240 volts (5.4 to 7.4 kW at 208 volts) require a separate 40-amp circuit. Models rated at 4.8 kW and below at 240 volts (3.6 kW and below at 208 volts) require a separate 20-amp circuit.
- A circuit breaker is recommended.
- Connect directly to the circuit breaker box (or fused disconnect) through flexible, armored or nonmetallic sheathed, copper cable (with grounding wire). See "Make Electrical Connection" section.
- Flexible conduit from the oven should be connected directly to the junction box.
- Fuse both sides of the line.
- Do not cut the conduit. The length of conduit provided is for serviceability of the oven.
- A UL listed or CSA approved conduit connector must be provided.
- If the house has aluminum wiring, follow the procedure below:
  - Connect a section of solid copper wire to the ends of the flexible conduit leads.
  - Connect the aluminum wiring to the added section of copper wire using special connectors and/or tools designed and UL listed for joining copper to aluminum.

Follow the electrical connector manufacturer's recommended procedure. Aluminum/copper connection must conform with local codes and industry accepted wiring practices.

For power requirements for models KOST107E, KOST100E, KOSE507E, KOSE500E, KODE307E, KODE300E, KODE507E, KODE500E, KODT100E and KODT107E, refer to the following table.

Voltage	Single Thermal	Single Convect	Double Thermal	Double Convect	Double Convect/Thermal
240 VAC	4100 W	4100 W	8163 W	8300 W	8300 W
208 VAC	3100 W	3100 W	6300 W	6300 W	6300 W
240 VAC	17.2 A	17.2 A	34.2 A	34.2 A	34.2 A
208 VAC	15.0 A	15.0 A	29.9 A	29.9 A	29.9 A

PRODUCT DIMENSIONS

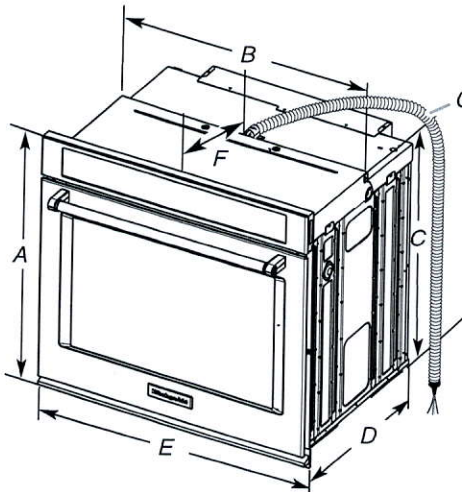

27" (68.6 cm) models

- A. 28<sup>3</sup>/<sub>4</sub>" (72.8 cm) max. overall height
- B. 25<sup>7</sup>/<sub>16</sub>" (64.6 cm) max. recessed width
- C. 26<sup>3</sup>/<sub>4</sub>" (67.9 cm) recessed height
- D. 23<sup>1</sup>/<sub>4</sub>" (59.1 cm) max. recessed depth
- E. 27" (68.6 cm) overall width
- F. 12" (30.5 cm) from back of control panel to start of strain relief
- G. 48" (121.9 cm) flexible conduit length

30" (76.2 cm) models

- A. 28<sup>3</sup>/<sub>4</sub>" (72.8 cm) max. overall height
- B. 28<sup>1</sup>/<sub>2</sub>" (72.4 cm) max. recessed width
- C. 26<sup>3</sup>/<sub>4</sub>" (67.9 cm) recessed height
- D. 23<sup>1</sup>/<sub>4</sub>" (59.1 cm) max. recessed depth
- E. 30" (76.2 cm) overall width
- F. 12" (30.5 cm) from back of control panel to start of strain relief
- G. 48" (121.9 cm) flexible conduit length

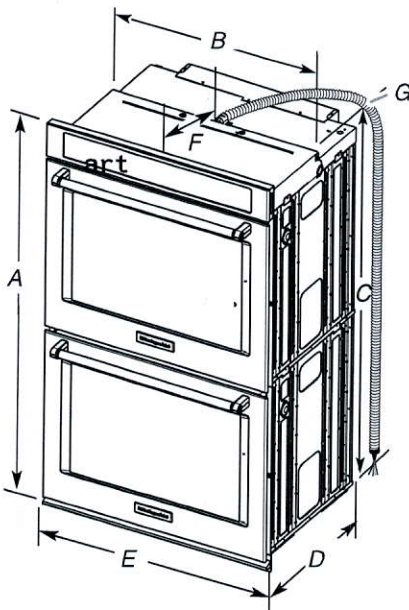

27" (68.6 cm) models

- A. 51<sup>1</sup>/<sub>16</sub>" (130.0 cm) max. overall height
- B. 25<sup>7</sup>/<sub>16</sub>" (64.6 cm) max. recessed width
- C. 48<sup>13</sup>/<sub>16</sub>" (124.0 cm) recessed height
- D. 23<sup>1</sup>/<sub>4</sub>" (59.1 cm) max. recessed depth
- E. 27" (68.6 cm) overall width
- F. 12" (30.5 cm) from back of control panel to start of strain relief
- G. 66" (167.6 cm) flexible conduit length

30" (76.2 cm) models

- A. 51<sup>1</sup>/<sub>16</sub>" (130.0 cm) max. overall height
- B. 28<sup>1</sup>/<sub>2</sub>" (72.4 cm) max. recessed width
- C. 48<sup>13</sup>/<sub>16</sub>" (124.0 cm) recessed height
- D. 23<sup>1</sup>/<sub>4</sub>" (59.1 cm) max. recessed depth
- E. 30" (76.2 cm) overall width
- F. 12" (30.5 cm) from back of control panel to start of strain relief
- G. 66" (167.6 cm) flexible conduit length



KitchenAid®

French Door w/Ice Dispenser Refrigerator

PRODUCT MODEL NUMBERS

KRFC704F    KRFC604F

**Electrical:** A 115-volt, 60 Hz, AC-only 15- or 20-amp fused, grounded electrical supply is required. It is recommended that a separate circuit serving only your refrigerator and approved accessories be provided. Use an outlet that cannot be turned off by a switch. Do not use an extension cord.

**Water:** A cold water supply with water pressure between 35 and 120 psi (241 and 827 kPa) is required to operate the water dispenser and ice maker. If you have questions about your water pressure, call a licensed, qualified plumber.

**NOTE:** If the water pressure is less than what is required, the flow of water from the water dispenser could decrease or ice cubes could be hollow or irregular shaped.

Reverse Osmosis Water Supply:

**IMPORTANT:** The pressure of the water supply coming out of a reverse osmosis system going to the water inlet valve of the refrigerator needs to be between 35 and 120 psi (241 and 827 kPa).

If a reverse osmosis water filtration system is connected to your cold water supply, the water pressure to the reverse osmosis system needs to be a minimum of 40 to 60 psi (276 to 414 kPa).

PRODUCT DIMENSIONS

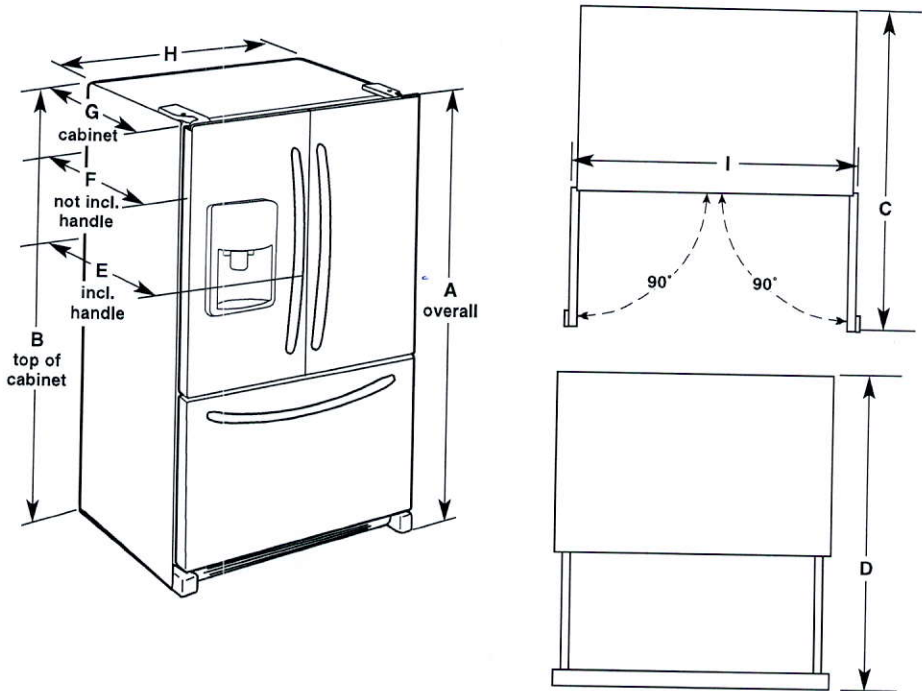

Model Size	Height - Overall "A"	Height - Top of Cabinet "B"	Depth - Door Open 90° "C"	Depth - Drawer Open "D"	Depth - With Handles "E"	Depth - Without Handles "F"	Depth - Cabinet Only "G"	Width - Cabinet "H"	Width - Door Open 90° "I"
23.8 cu. ft	71 <sup>7</sup> / <sub>8</sub> " (182.6 cm)	70 <sup>7</sup> / <sub>8</sub> " (180.0 cm)	43 <sup>3</sup> / <sub>4</sub> " (111.1 cm)	45 <sup>7</sup> / <sub>8</sub> " (116.5 cm)	31 <sup>1</sup> / <sub>2</sub> " (80.0 cm)	28 <sup>7</sup> / <sub>8</sub> " (73.3 cm)	24 <sup>3</sup> / <sub>8</sub> " (61.9 cm)	35 <sup>5</sup> / <sub>8</sub> " (90.5 cm)	43 <sup>5</sup> / <sub>8</sub> " (110.8 cm)

LOCATION REQUIREMENTS

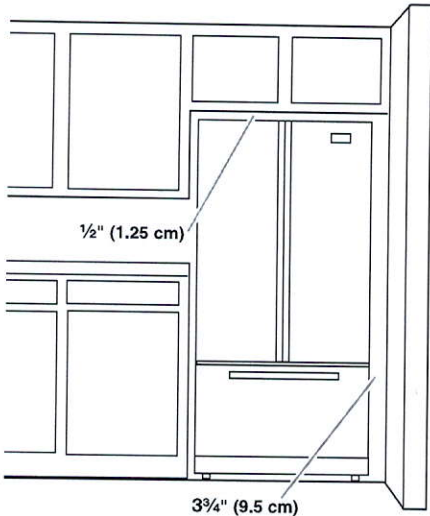

**IMPORTANT:** This refrigerator is designed for indoor, household use only.

To ensure proper ventilation for your refrigerator, allow for a 1/2" (1.25 cm) of space on each side and at the top. Allow for a 1" (2.54 cm) space behind the refrigerator. If your refrigerator has an ice maker, allow extra space at the back for the water line connections. When installing your refrigerator next to a fixed wall, leave a 3/4" (9.5 cm) minimum space between the refrigerator and wall to allow the door to swing open.

**NOTE:** This refrigerator is intended for use in a location where the temperature ranges from a minimum of 55°F (13°C) to a maximum of 110°F (43°C). The preferred room temperature range for optimum performance, which reduces electricity usage and provides superior cooling, is between 60°F (15°C) and 90°F (32°C). It is recommended that you do not install the refrigerator near a heat source, such as an oven or radiator.



## Undercounter Dishwasher

# DISHWASHER

### PRODUCT MODEL NUMBERS

KDFE204E, KDTE104E, KDTE204E, KDTE254E, KDTM354E, KDTM384E, KDTM404E, KDTM504E, KDTM704E, KDTM804E

**Electrical Requirements:** 120-volt, 60 Hz, AC-only, 15- or 20-amp. fused electrical supply. Copper wire only. A time delay fuse or circuit breaker and separate circuit is recommended.

**If direct wiring dishwasher:** Use flexible, armored or nonmetallic, sheathed copper wire with grounding wire that meets the wiring requirements for your home and local codes and ordinances. Use a UL Listed or CSA Approved conduit connector.

**If connecting dishwasher with a power supply cord:**

Use power supply cord kit (Part Number 4317824) marked for use with dishwashers. Follow the kit instructions for installing the power supply cord.

Power supply cord must plug into a grounded three-prong outlet located in the cabinet next to the dishwasher opening. Outlet must meet all local codes and ordinances.

**Water Supply Requirements:** A hot water line with 20 to 120 psi (138 to 862 kPa) water pressure. Water temperature must be 120°F (49°C) water at dishwasher. Use 3/8" O.D. copper tubing with compression fitting or flexible braided water supply line

**Note:** 1/2" minimum plastic tubing is not recommended.

Use a 90° elbow with 3/4" hose connection with rubber washer (part number W10273460). Do not solder within 6" (15.2 cm) from water inlet valve.

**Drain Requirements:** A new drain hose is supplied with your dishwasher. If this is not long enough, use a new drain hose with a maximum length of 12' (3.7 m) (Part No. 3385556) that meets all current AHAM/IAPMO test standards, is resistant to heat and detergent, and fits the 1" (2.5 cm) drain connector of the dishwasher.

Make sure to connect the drain hose to waste tee or disposer inlet above drain trap in house plumbing and 20" (50.8 cm) minimum above the floor. It is recommended that the drain hose either be looped up and securely fastened to the underside of the counter, or be connected to an air gap. Make sure to use an air gap if the drain hose is connected to house plumbing lower than 20" (50.8 cm) above subfloor or floor.

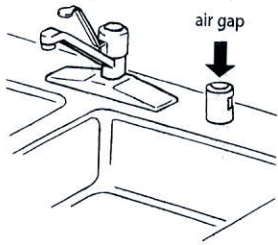

Use 1/2" (1.3 cm) minimum I.D. drain line fittings.

If required, the air gap should be installed in accordance with the air gap installation instructions. When connecting the air gap a rubber hose (not provided) will be needed to connect to the waste tee or disposer inlet.

### PRODUCT DIMENSIONS

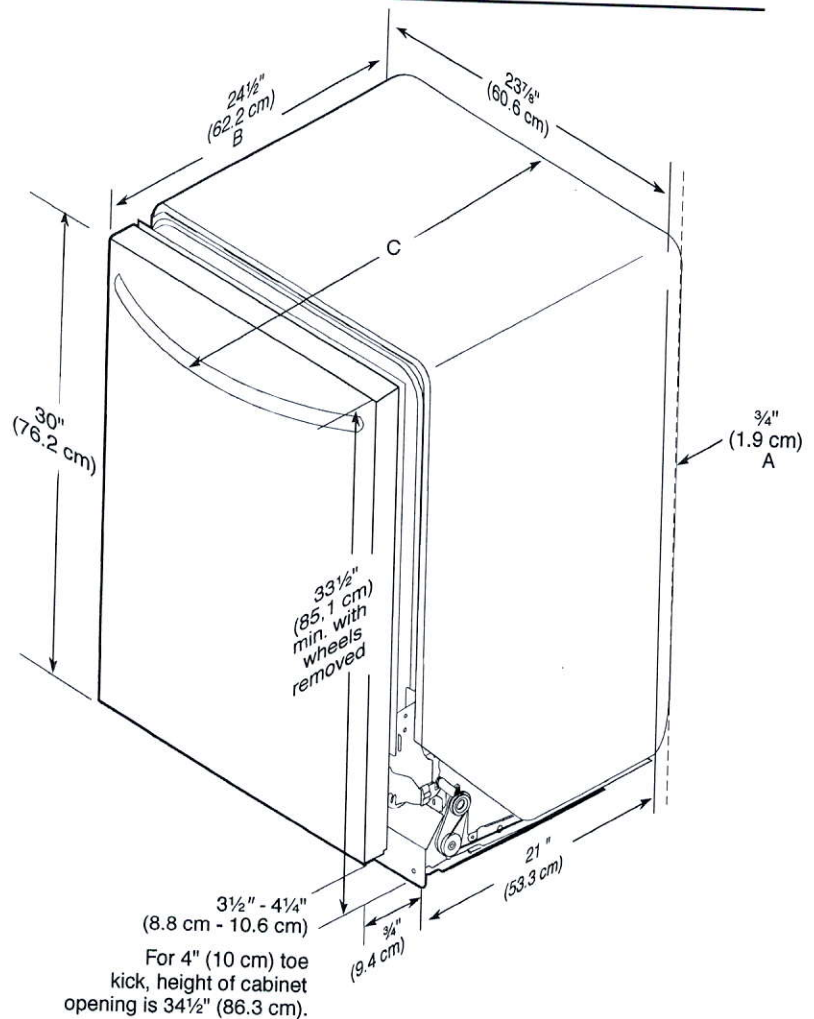

- A. Insulation may be compressed (not used on all models).
- B. For panel-ready models, dishwasher depth is 24" (60 cm) not including the 3/4" (1.9 cm) custom door panel.
- C. Door handles may protrude forward of the face of the dishwasher; varies by model.



CABINET CUTOUT DIMENSIONS

NOTE: Shaded areas of cabinet walls show where utility connections may be installed.

\*Measure from the lowest point on the underside of the countertop. May be reduced to 33½" (85.1 cm) be removing the rear leveling legs from dishwasher.

\*\*Minimum, measured from narrowest point of opening.

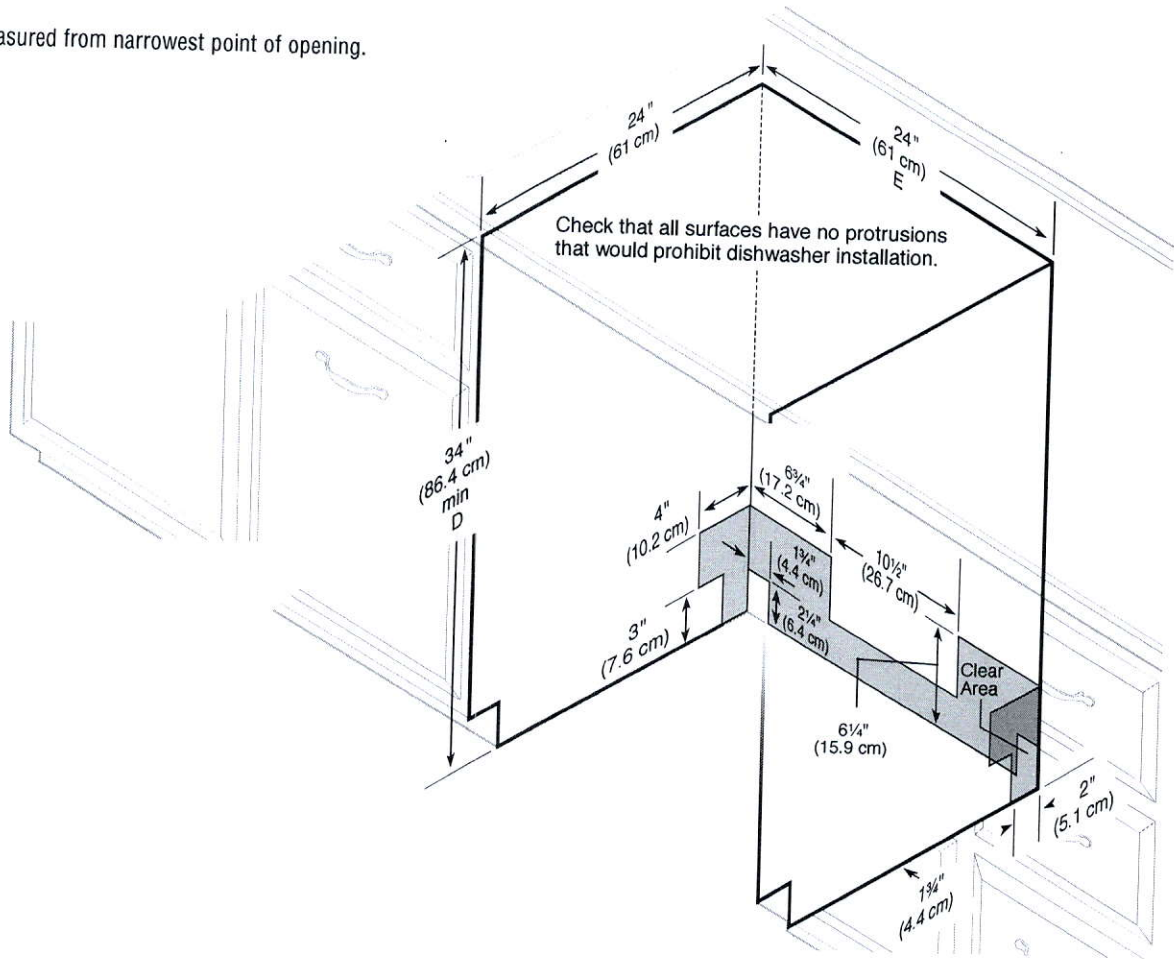



23 BALTRIO

RECEIVED APR 12 2018

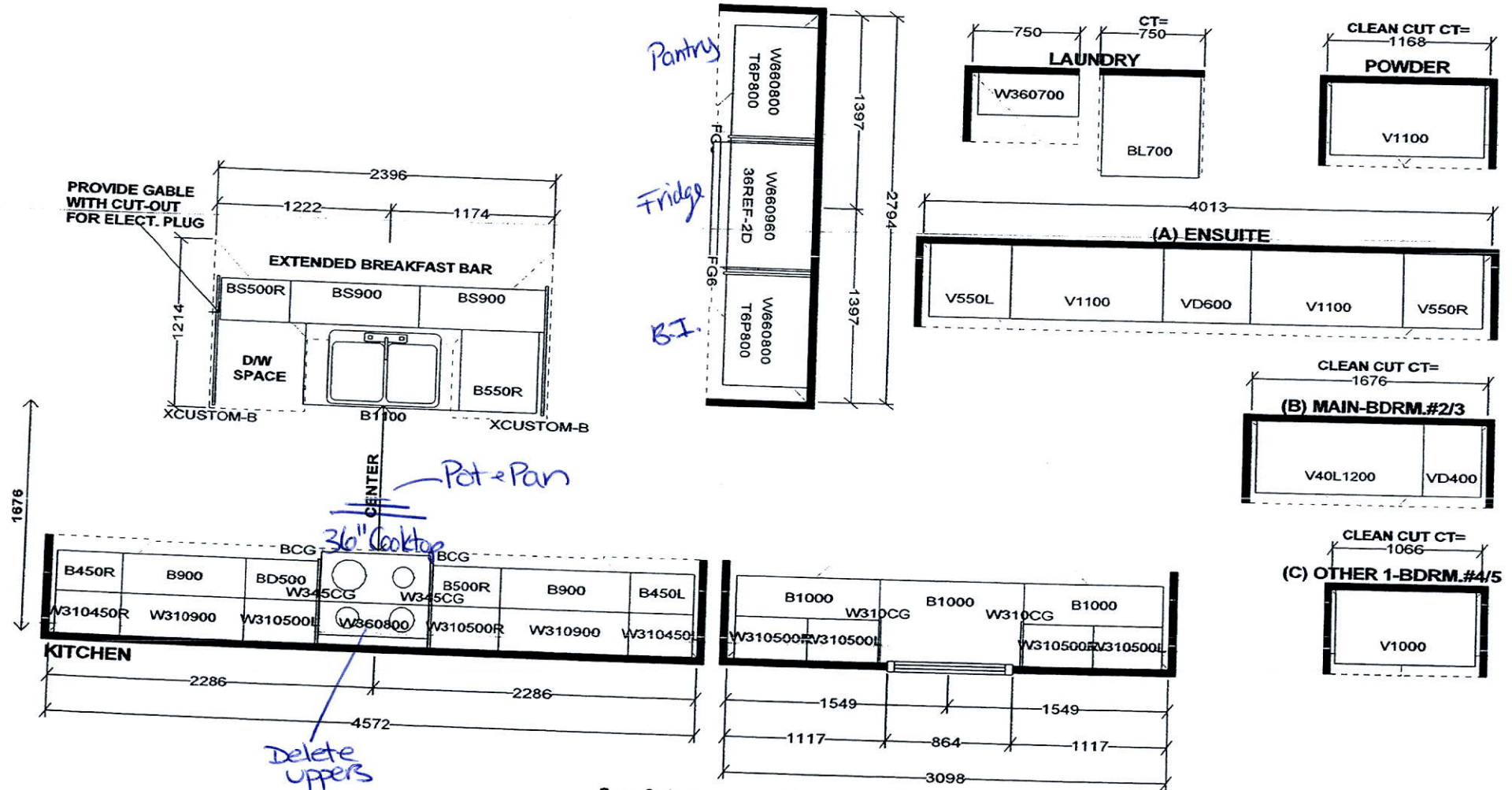

Selba Industries

1040MM HIGH UPPERS  
 LIGHT VALANCE  
 DISHWASHER SPACE  
 GRANITE KITCHEN & ENSUITE COUNTERTOPS BY OTHERS  
 CLEAN CUT LAMINATE VANITY COUNTERTOPS

This drawing is the intellectual property of SELBA INDUSTRIES INC. and is an original design which must not be released or copied unless applicable fee has been paid or job order placed.



JOB NUMBER:  
 BUILDER: GREENYORK  
 SITE NAME: BALTRIO CONST.  
 MODEL: YORK 2X ELEV A  
 LOT #:  
 DESIGNER: KS  
 DATE: APR 26 17



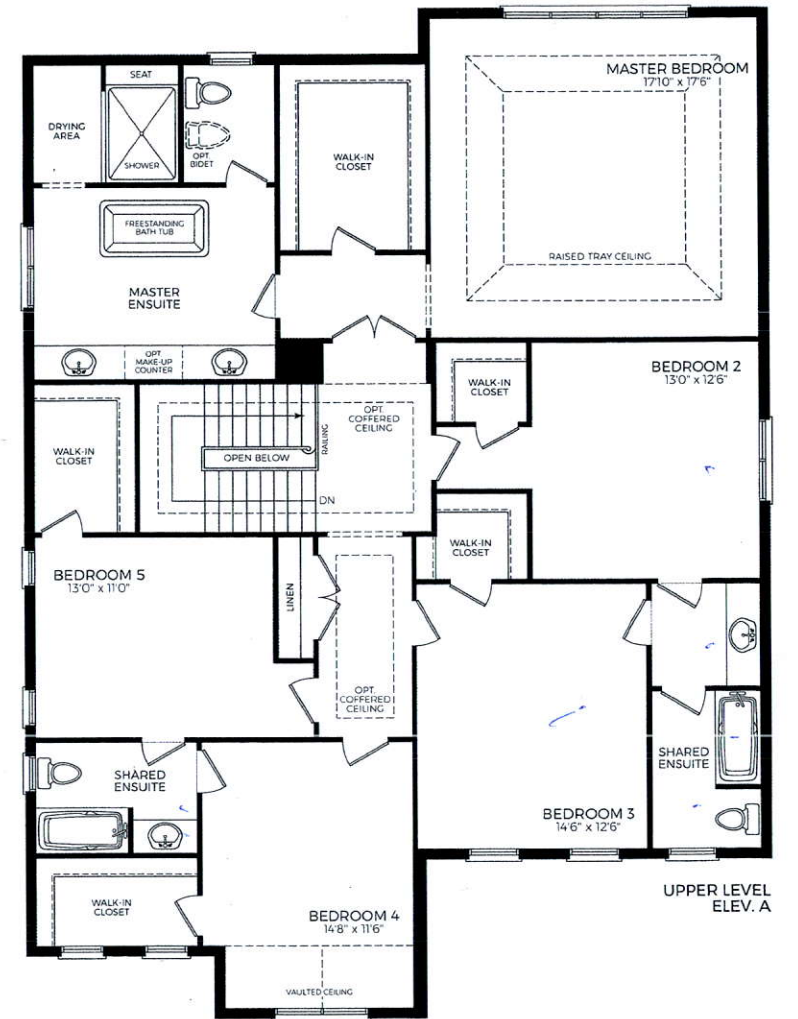
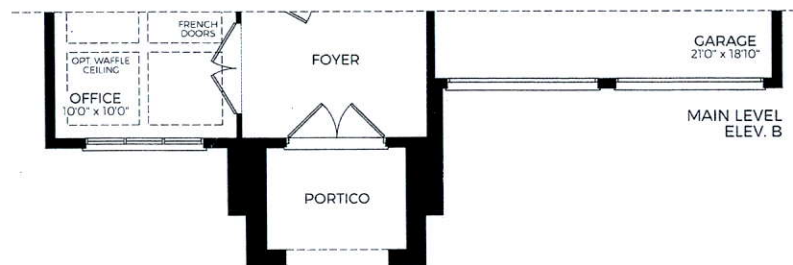
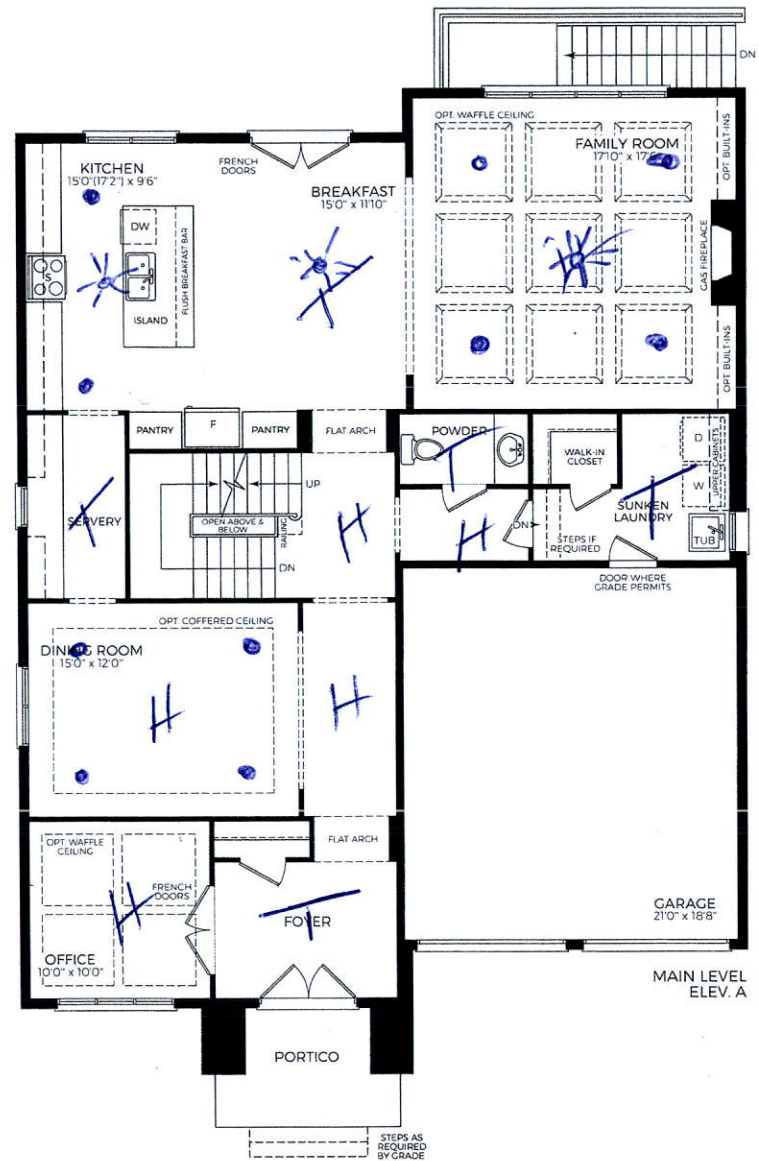



## York 2

3810 sq. ft. Elev. A with 80 sq. ft. of basement area

3784 sq. ft. Elev. B with 80 sq. ft. of basement area

