

PRE-Sales Selection Sheet
Checklist

1 OF 41

LOT 256 Model: 25-2140 ALT C The Wallace

PURCHASERS: CARLOS, FERNANDO TORRES MAHECHA/DEICY PRIETO SANABF

VENDOR: Heathwood Homes (Huron) Limited

ALT PLAN MODIFIED MAIN FLOOR MUDROOM

- ☒ FINISHED BASEMENT
☐ COLD CELLAR

UPGRADED / MODIFIED ELEVATION

- ☐ CORNER UPGRADE
☐ REAR UPGRADE

CEILING UPGRADE - SMOOTH

- ☐ MAIN FLOOR
☐ SECOND FLOOR
☐ BASEMENT

ADDITIONAL ROUGH-INS

- ☒ 200 AMP SERVICE
☐ WET BAR ROUGH-IN
☐ HUMIDIFIER
☒ AIR CONDITIONING

GAS ROUGH-IN

- ☐ STOVE
☐ DRYER
☐ BBQ
☐ ADDITIONAL FIREPLACE

KITCHEN: HOODFAN VENTING SIZE

- ☒ 6 IN ROUND DUCT
☐ 7 IN ROUND DUCT

FULL BASEMENT STAIRS:	N/A
UPPER BASEMENT STAIRS:	All Oak
LOWER BASEMENT STAIRS:	Carpet Grade
MAIN STAIRS:	All Oak
MEDIA STAIRS (if applicable):	N/A
LOFT STAIRS (if applicable):	N/A

Aug 28/20
Date Purchaser: *on file*

Aug 28/20
Date Decor Consultant: IRIT SALEM

Date Purchaser:

- APPROVED -
-08- 28 2020
Date Approved
Heathwood Homes (Huron) Limited

Locked Date:



Sales Selection Sheet
Wallaceton

2 OF 41

PURCHASERS: CARLOS, FERNANDO TORRES MAHECHA and DEICY
PRIETO SANABRIA

TEL:

LOT / UNIT 256	PHASE 2	MODEL 25-2140 ALT C The Wallace	
-------------------	------------	------------------------------------	--

It is herein understood and agreed between the undersigned parties hereto that the following changes shall be made to the above mentioned Agreement of Purchase and Sale in accordance with the agreement and except for such changes noted below, all other terms and conditions in the Agreement of Purchase and Sale shall remain as stated herein: It is further understood that and agreed that all changes and additions shall be installed as per builder's specifications, location and available selections. The Purchaser hereby agrees to purchase the following extras:

APPLIANCES

1	SCHEDULE E: FIVE APPLIANCES: SS FRIDGE, STOVE, CHIMNEY HOOD FAN, DISHWASHER. WHITE FRONT LOADER WASHER / DRYER- (SINGLES)	Qty: 1	
32,448	Note: SEE SPECS PAGES 27-41		

MISC.

2	SCHEDULE "E": FINISH LOWER LEVEL - 589 SQ FT (THE WALLACE)	Qty: 1	
32,447	Note:		

MODIFICATION

3	SCHEDULE E: ALTERNATE MAIN FLOOR WITH MODIFIED TO MUDROOM	Qty: 1	
32,449	Note: SKETCH # 2 PAGE 17		

Sub Total
HST
Total

1. This Sales Selection Sheet when properly executed forms part of our Agreement of Purchase and Sale.
2. All extras and upgrades listed above are subject to Construction Progress and Architectural and Municipal requirements.
3. In the event the Vendor is unable to incorporate the work approved above in the construction of the house for any reason whatsoever, the Vendor will not be liable to the Purchaser in any way. The monies paid for any changes or optional extras not proceeded with shall be returned to the Purchaser, without interest. The cost of options or extras is non-refundable in all other circumstances. If for any reason whatsoever the Agreement of Purchase and Sale is not completed, the total cost of work approved above will be retained by the Vendor.
4. The Vendor reserves the right to substitute above materials and equipment with that of equal or better quality.
5. Purchaser acknowledges that items may not be exactly as shown. Variations from the Vendor's samples may occur in finished materials due to normal production processes. Vendor is not responsible for shade difference which may occur from different dye lots or wood grains. Variations from the Vendor's samples will occur with natural materials such as wood, marble, granite, hardwood and brick.
6. The Vendor reserves the right to select Grout & Thresholds that best suits the Tile selected.
7. Selections will not be processed unless signed by Heathwood Homes Head Office.
8. The selections made on this schedule are final and cannot be changed once submitted.
9. The Purchaser has checked and acknowledges the accuracy of this schedule.

Payment Summary	
<u>Paid By</u>	<u>Amount</u>
<u>Total Payment:</u>	

Initials: MR



Sales Selection Sheet
Wallaceton

3 of 41

PURCHASERS: CARLOS, FERNANDO TORRES MAHECHA and DEICY
PRIETO SANABRIA

TEL:

LOT / UNIT 256	PHASE 2	MODEL 25-2140 ALT C The Wallace	
-------------------	------------	------------------------------------	--

PURCHASER:

signatures on file
CARLOS, FERNANDO TORRES MAHECI

28-Aug-20
DATE

IRIT SALEM
Decor Consultant 28-Aug-20
DATE

PURCHASER:

file
DEICY PRIETO SANABRIA

28-Aug-20
DATE

APPROVE
-08- 28 2020 *M. Roen*

Date Approved Heathwood Homes (Huron) Limited

TAX#:1

PREPARED BY: Irit Salem

PE 427-2

S\invoice.rpt 28may19

CARLOS, FERNANDO TORRES MAHECHA/DEICY PRIETO SANABRIA
Project: Wallaceton
Unit: 256, Phase: 2
Model: 25-2140 ALT C The Wallace

Created: 8/10/2020 10:12:53
Locked:
Closed:

4 of 41

Kitchen

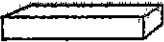
Cabinet Colour/Style	9166	Viking III-CHARLESTON-ORCHID-3DL ***STD***
Countertop	9069	MSI Quartz GROUP 1 ICED WHITE ***STD***
Countertop Edge	4010	SINGLE POLISHED STRAIGHT EDGE 3/4 INCH ***STD*** 
Cabinet Hardware	7667	12881-HARDWARE ***STD***
Island Cabinet Colour/Style	9166	Viking III-CHARLESTON-ORCHID-3DL ***STD***
Island Countertop	9069	MSI Quartz GROUP 1 ICED WHITE ***STD***
Backsplash	1111	N/A *****
Backsplash Grout	1111	N/A *****
Backsplash Tile Pattern	1111	N/A *****

HoodFan	9117	SCB50030-CYCLONE 30 inch CANOPY CHIMNEY HOODFAN-SS PAGES 25-26
Appliance	0	Purchasers have been advised: standard fridge opening is a minimum 37 3/8 x 73 3/8". Ice Waterline Rough-In is included.
Appliance	0	Standard stove opening is 30" and standard dishwasher opening is 24". Any gas stove will require backsplash or stainless steel backing to avoid fire hazards.
Appliance	0	Purchasers acknowledge: Heathwood Homes and its contractors will not be responsible for any kitchen cabinet changes due to appliances dimension changes after
Comment		

Kitchen/Breakfast

Flooring	9242	OV.ET.VLK.1224.PL-ETERNA VOLKAS POLISHED12X24 Tile Direction Sketch **5** SKETCH # 2 PAGE 5
Floor Tile Grout	2225	Grout-(27) Silver ***STD***
Floor Tile Pattern	3050	SIDE TO SIDE ***STD***

485
01/2/21

CARLOS, FERNANDO TORRES MAHECHA/DEICY PRIETO SANABRIA
Project: Wallaceton
Unit: 256, Phase: 2
Model: 25-2140 ALT C The Wallace

Created: 8/10/2020 10:12:53
Locked:
Closed:

5 of 41

Comment

Foyer

Flooring	9242	OV.ET.VLK.1224.PL-ETERNA VOLKAS POLISHED12X24 Tile Direction Sketch **5** SKETCH # 2 PAGE 17
Floor Tile Grout	2225	Grout-(27) Silver ***STD***
Floor Tile Pattern	3050	SIDE TO SIDE ***STD***

Comment

Laundry Room

Flooring	9071	GE.BY.AZR.1313 New Byzantine Azzuro 13
Floor Tile Grout	7704	Grout-(19) Pearl Gray ***STD***
Floor Tile Pattern	3000	STANDARD SQUARE ***STD***

Comment

Laundry Room Opt.

Cabinet - Uppers	1111	N/A *****
Cabinet Hardware	1111	N/A *****

Comment

Mud Room

Flooring	9242	OV.ET.VLK.1224.PL-ETERNA VOLKAS POLISHED12X24 Tile Direction Sketch **5** SKETCH # 2 PAGE 17
----------	------	--

7/15
2/15/21

CARLOS, FERNANDO TORRES MAHECHA/DEICY PRIETO SANABRIA
Project: Wallaceton
Unit: 256, Phase: 2
Model: 25-2140 ALT C The Wallace

Created: 8/10/2020 10:12:53
Locked:
Closed:

6 of 41



Floor Tile Grout	2225	Grout-(27) Silver ***STD***
Floor Tile Pattern	3050	SIDE TO SIDE ***STD***

Comment

Powder Room

Flooring	9242	OV.ET.VLK.1224.PL-ETERNA VOLKAS POLISHED12X24 Tile Direction Sketch **5** SKETCH # 2 PAGE 17
Floor Tile Grout	2225	Grout-(27) Silver ***STD***
Floor Tile Pattern	3050	SIDE TO SIDE ***STD***

Plumbing Fixture (Colour)	1737	Plumbing Fixtures-WHITE ***STD***
Comment		

Dining Room/Hall

Flooring	7498	Red Oak Pearl-Vintage Engineered-IRONGATE-3/4 inch x 3 1/4 inch ***STD***
Comment		

Dining Room/Hall

Flooring	1111	N/A *****
Comment		

Great Room

Flooring	7498	Red Oak Pearl-Vintage Engineered-IRONGATE-3/4 inch x 3 1/4 inch ***STD***
Comment		

2/5
4/15

CARLOS, FERNANDO TORRES MAHECHA/DEICY PRIETO SANABRIA
Project: Wallaceton
Unit: 256, Phase: 2
Model: 25-2140 ALT C The Wallace

Created: 8/10/2020 10:12:53
Locked:
Closed:

7 of 41

Upper Hall

Flooring 9248 DY 89418 -Dynasty Tex-BLACK ICE-40 oz Poly***STD***

Comment

Opt. Finished Basement (Rec) Room/Hall

Flooring 9248 DY 89418 -Dynasty Tex-BLACK ICE-40 oz Poly***STD***

Comment 9248

Master Bedroom

Flooring 9248 DY 89418 -Dynasty Tex-BLACK ICE-40 oz Poly***STD***

Comment

Bedroom 2

Flooring 9248 DY 89418 -Dynasty Tex-BLACK ICE-40 oz Poly***STD***

Comment

Bedroom 3

Flooring 9248 DY 89418 -Dynasty Tex-BLACK ICE-40 oz Poly***STD***

Comment

Bedroom 4

Flooring 9248 DY 89418 -Dynasty Tex-BLACK ICE-40 oz Poly***STD***

Comment 9166



DPS
CHITN

CARLOS, FERNANDO TORRES MAHECHA/DEICY PRIETO SANABRIA
Project: Wallaceton
Unit: 256, Phase: 2
Model: 25-2140 ALT C The Wallace

Created: 8/10/2020 10:12:53
Locked:
Closed:

8 of 11

Master Ensuite

Cabinet Colour/Style	9166	Viking III-CHARLESTON-ORCHID-3DL ***STD***
Countertop	9069	MSI Quartz GROUP 1 ICED WHITE ***STD***
Countertop Edge	4010	GROUP 1 - SINGLE POLISHED STRAIGHT EDGE 3/4 INCH ***1***
Cabinet Hardware	2093	 9671-HARDWARE ***STD***
Floor Tile	8262	TR.ST.GRY.1313-Serpentine-Grey-13x13 See Tile Line Pattern on Sketch 3 Page 18 ***STD***
Floor Tile Grout	7704	Grout-(19) Pearl Gray ***STD***
Floor Tile Pattern	3000	STANDARD SQUARE ***STD***
Shower Floor Tile	8661	OD.ON.SWT.0202.MT.N-Ontario Series Mosaic-Snow White Matte-2 x 2 ***STD***
Shower Floor Tile Grout	2226	Grout-(00) White ***STD***
Shower Floor Tile Pattern	3000	STANDARD SQUARE ***STD***
Shower Wall Tile	9020	QT.WV.WHT.0810-Weave-White-8 x 10 ***STD***
Shower Wall Tile Grout	2226	Grout-(00) White ***STD***
Shower Wall Tile Pattern	3090	VERTICAL STACKED ***STD*** 
Shower Jamb(s) and Sill(s)	8923	Shower Jamb / Sill-Thassos White ***STD***
Plumbing Fixture (colour)	1737	Plumbing Fixtures-WHITE ***STD***
Comment		

DPS
2/1/21

CARLOS, FERNANDO TORRES MAHECHA/DEICY PRIETO SANABRIA
Project: Wallaceton
Unit: 256, Phase: 2
Model: 25-2140 ALT C The Wallace

Created: 8/10/2020 10:12:53
Locked:
Closed:

9 of 41

Main Bathroom

Cabinet Colour/Style	9166	Viking III-CHARLESTON-ORCHID-3DL ***STD***								
Countertop	8796	6698-46-Countertop-PALOMA POLAR ETCHINGS FINISH-Formica ***STD***								
Countertop Edge	1111	N/A *****								
Cabinet Hardware	2093	9671-HARDWARE ***STD***								
Flooring	8262	TR.ST.GRY.1313-Serpentine-Grey-13x13 See Tile Line Pattern on Sketch 3 Page 18 ***STD***								
Floor Tile Grout	7704	Grout-(19) Pearl Gray ***STD***								
Floor Tile Pattern	3000	STANDARD SQUARE ***STD***								
Wall Tile	9020	QT.WV.WHT.0810-Weave-White-8 x 10 ***STD***								
Wall Tile Grout	2226	Grout-(00) White ***STD***								
Main Bathroom Tile Pattern	3090	VERTICAL STACKED ***STD*** <table><tr><td></td><td></td><td></td><td></td></tr><tr><td></td><td></td><td></td><td></td></tr></table>								
Plumbing Fixture (Colour)	1737	Plumbing Fixtures-WHITE ***STD***								
Comment										

Opt. Shower Floor Tile	8661	OD.ON.SWT.0202.MT.N-Ontario Series Mosaic-Snow White Matte-2 x 2 ***STD***
Shower Floor Tile Grout	2226	Grout-(00) White ***STD***
Shower Floor Tile Pattern	3000	STANDARD SQUARE ***STD***
Shower Wall Tile	9020	QT.WV.WHT.0810-Weave-White-8 x 10 ***STD***
Shower Wall Tile Grout	2226	Grout-(00) White ***STD***

21/11/20

CARLOS, FERNANDO TORRES MAHECHA/DEICY PRIETO SANABRIA
Project: Wallaceton
Unit: 256, Phase: 2
Model: 25-2140 ALT C The Wallace

Created: 8/10/2020 10:12:53
Locked:
Closed:

10 of 41

Shower Wall Tile Pattern	3090	VERTICAL STACKED ***STD*** <div><div></div><div></div><div></div><div></div><div></div><div></div><div></div><div></div></div>
Shower Jamb(s)	8923	Shower Jamb / Sill-Thassos White ***STD***
Cabinet Colour/Style	9166	Viking III-CHARLESTON-ORCHID-3DL ***STD***
Countertop	8796	6698-46-Countertop-PALOMA POLAR ETCHINGS FINISH-Formica ***STD***
Countertop Edge	1111	N/A *****
Cabinet Hardware	2093	9671-HARDWARE ***STD***
Flooring	9071	GE.BY.AZR.1313 New Byzantine Azzuro 13
Floor Tile Grout	7705	Grout-(01) Alabaster ***UPG***
Floor Tile Pattern	3000	STANDARD SQUARE ***STD***
Plumbing Fixture (Colour)	1737	Plumbing Fixtures-WHITE ***STD***
Comment		

Great Room Fireplace

Type	8869	Majestic MERC32 ***STD***
Mantle	9114	NF 15-Paint Grade Mantle- Cabinet (Per Plan)-WHITE ***STD*** PAGE 19
Surround Opt.	1111	N/A *****
Note	0	Purchasers have been advised: heat from the FP can damage TV above a FP and items placed on mantle.
Note	0	Heathwood and its contractors will not be liable for any damage on items placed/installed above a FP after closing.
Comment		

Basement Stairs

Type	1714	Carpet Grade Stairs ***STD BASEMENT STAIRS***
------	------	---

DRS
2/1/21

CARLOS, FERNANDO TORRES MAHECHA/DEICY PRIETO SANABRIA
Project: Wallaceton
Unit: 256, Phase: 2
Model: 25-2140 ALT C The Wallace

Created: 8/10/2020 10:12:53
Locked:
Closed:

1 of 4

Colour	7912	Irongate (Gryphon) STAIN TO COMPLIMENT HARDWOOD AND WILL VARY FROM FLOORING
Carpet Runner	1111	N/A *****
Handrail/Pickets/Post Type	9119	Handrail only on closed walls (one or two sides per building code) ***STD***
Handrail/Pickets/Post Colours	1729	Carpet Grade-Stain handrail, pickets, stringers, nosing_pos
Carpet	9248	DY 89418 -Dynasty Tex-BLACK ICE-40 oz Poly***STD***
Custom Stain/Paint	1111	N/A *****
Comment		

Landing to Basement

Flooring	7498	Red Oak Pearl-Vintage Engineered-IRONGATE-3/4 inch x 3 1/4 inch ***STD***
Comment		

Main Stairs

Type	1712	Oak Stairs ***STD MAIN STAIRS***
Colour	7912	Irongate (Gryphon) STAIN TO COMPLIMENT HARDWOOD AND WILL VARY FROM FLOORING
Carpet Runner	1111	N/A *****
Handrail/Pickets/Posts Type	7652	1 5/16 inch Square pickets with 3 1/2" Square/Cap Post(s)-ALL OAK ***STD***
Handrail/Pickets/Posts Colour	1728	Oak Grade-Stain handrail,oak pickets,stringers,treads,risers
Custom Stain/Paint	1111	N/A *****
Comment		

Hall

Flooring	7498	Red Oak Pearl-Vintage Engineered-IRONGATE-3/4 inch x
----------	------	--

Handwritten initials/signature

CARLOS, FERNANDO TORRES MAHECHA/DEICY PRIETO SANABRIA
Project: Wallaceton
Unit: 256, Phase: 2
Model: 25-2140 ALT C The Wallace

Created: 8/10/2020 10:12:53
Locked:
Closed:

12 of 41

3 1/4 inch ***STD***

Comment

Throughout

Walls - Paint Colour	1717	22-Wall-WARM GREY ***STD***	✓
Underpad	1079	500 Series-Underpad ***STD***	✓
Thresholds	2232	Metal Thresholds ***STD***	
Switches and Plug	5796	Decora White Switches and Plugs ***STD***	
Trim Size	8705	4 1/4 Baseboard and 2 3/4 Casings ***STD***	
Trim - Paint Colour	1716	Trim-WHITE ***STD***	

Comment

Purchaser: 
CARLOS, FERNANDO TORRES

Aug 20 / 20
Date

Decor Consultant

Aug 20 . 20
Date

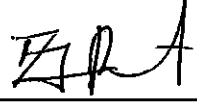
Purchaser: 
DEICY PRIETO SANABRIA

Aug 20 / 20
Date

Wallaceton

APPROVE
-08- 2 8 2020
Date Approved



Sales Selection Sheet

Wallaceton

13 of 41

PURCHASERS: CARLOS, FERNANDO TORRES MAHECHA and DEICY PRIETO SANABRIA

TEL:

LOT / UNIT	PHASE	MODEL	
256	2	25-2140 ALT C The Wallace	

It is herein understood and agreed between the undersigned parties hereto that the following changes shall be made to the above mentioned Agreement of Purchase and Sale in accordance with the agreement and except for such changes noted below, all other terms and conditions in the Agreement of Purchase and Sale shall remain as stated herein: It is further understood that and agreed that all changes and additions shall be installed as per builder's specifications, location and available selections. The Purchaser hereby agrees to purchase the following extras:

Cabinetry

1 189,343 32,410	CABINETRY - 11A-UPPER ANGLE CORNER PER UNIT - UPGRADE 1 Note: KITCHEN SEE SPEC# 2 PAGE# 17	Qty: 1	
2 189,216 32,411	CABINETRY - 32H-BASE CABINET FOR UNDER-COUNTER MICROWAVE WITH DRAWER BELOW (FINISHED INTERIOR) (SUPPLY SPECS) - UPGRADE 1 BESIDE FRIDGE SKETCH#2 PAGE 17 Note: KITCHEN: MICROWAVE DRAWER SEE SPEC. PAGE# SPECS TO FOLLOW	Qty: 1	

CERAMIC

3 32,413	CERAMICS - FLOOR TILE - UPGRADE # 5 - GARAGE ENTRY/MUD ROOM (Alt . Dining Room Layout) Note: MUD ROOM CERAMIC FLOOR UPG 5 24X12"	Qty: 1	
4 32,414	UPG GROUT Note: LAUNDRY ROOM	Qty: 1	
5 32,415	UPG. GROUT Note: BASEMENT FLOOR GROUT	Qty: 1	
6 32,416	KITCHEN CERAMIC FLOOR UPG. 5 12" X 24" Note: KITCHEN CERAMIC FLOOR UPG. 5 12" X 24"	Qty: 1	
7 32,417	CERAMIC FLOOR UPG. 5 12" X 24" Note: FOYER: CERAMIC FLOOR UPG. 5 12" X 24"	Qty: 1	
8 32,418	CERAMICS - FLOOR TILE - UPGRADE # - POWDER ROOM (Alt . Dining Room Layout) FLOOR UPG. 5 12" X 24" Note: POWDER ROOM ALT CERAMIC FLOOR UPG. 5 12" X 24"	Qty: 1	

Electrical

9 189,451 32,403	ELECTRICAL - ADDITIONAL SWITCH Note: KITCHEN: TO BE USED WITH THE KITCHEN R/I CAP LIGHT SEE SKETCH# 2 PAGE# 17	Qty: 1	
------------------------	--	--------	--

Initials: MT PS

TAX#:1

PREPARED BY: Irit Salem

PE 425-1

S\invoice.rpt 28may19



Sales Selection Sheet
Wallaceton

14 of 41

PURCHASERS: CARLOS, FERNANDO TORRES MAHECHA and DEICY
PRIETO SANABRIA

TEL:

LOT / UNIT 256	PHASE 2	MODEL 25-2140 ALT C The Wallace	
-------------------	------------	------------------------------------	--

Electrical

10 189,448 32,404	ELECTRICAL - EXTRA WALL INTERIOR OUTLET ON EXISTING CIRCUIT (DOES NOT INCLUDE KITCHEN OUTLETS) Note: ONE IN BASEMENT FAMILY ROOM ONE IN GREAT ROOM-ABOVE THE FIRE PLACE ONE IN MASTER BEDROOM ALL TO BE 67" FROM FLOOR SEE SKETCH # 1, 2, 3 PAGE# 16, 17, 18	Qty: 3
11 189,45C 32,405	ELECTRICAL - CEILING ROUGH-IN (CAPPED) Note: KITCHEN: TO BE ABOVE ISLAND IN THE KITCHEN USE EXTRA SWITCH GREAT ROOM: IN THE CENTRE OF THE ROOM USE EXISTING SWITCH PLUG SEE SKETCH # 2 PAGE# 17	Qty: 2
12 189,44C 32,412	ELECTRICAL - EXTRA WALL INTERIOR OUTLET (120V/15A) ON A SEPARATE CIRCUIT (ON ARCFAULT) Note: TO BE USED FOR THE MICROWAVE DRAWER SEE SKETCH # 2 PSGE# 17	Qty: 1

Plumbing

13 189,694 32,408	PLUMBING - OPTION FROM ONE SINK TO DOUBLE SINKS, INCLUDING STD CHATEAU FAUCET AND UNDERMOUNT OVALYN INCLUDING STD CHATEAU FAUCET AND UNDERMOUNT OVALYN SINK INCLUDING CABINET CONVERSION 2D VIKING, ONE EXTRA CUTOUT AND ONE EXTRA VANITY LIGHT Note: MASTER BATHROOM SKETCH #3 PAGE 18	Qty: 1
14 189,768 32,409	PLUMBING - MOEN -CHATEAU - 2 HANDLE WIDESPREAD LAVATORY CHROME FAUCET WITH POP-UP DRAIN (MODEL#4945) IN LIEU OF STANDARD SINGLE LEVER - Note: 2 IN MASTER BATHROOM 1 IN MAIN BATHROOM PAGE 23	Qty: 3

Structured Wiring

15 189,78E 32,407	STRUCTURED WIRING - CONDUIT PIPE (BASEMENT TO ATTIC, CAPPED AND PULL STRING ROUGH-IN). Note:	Qty: 1
16 189,787 32,419	STRUCTURED WIRING - CONDUIT PIPE TO ABOVE FIREPLACE ROUGH-IN Note: GREAT ROOM: TO BE INSTALL APPROX. 67" FROM FLOOR IN THE CENTRE OF THE FIRE PLACE SEE SKETCH # 2 PAGE# 17	Qty: 1

Sub Total
HST
Total

Initials: AK TPS

TAX#:1

PREPARED BY: Irit Salem

PE 425-2

SInvoice.rpt 28may19



Sales Selection Sheet

Wallaceton

15 of 41





TEL:

PURCHASERS: CARLOS, FERNANDO TORRES MAHECHA and DEICY PRIETO SANABRIA

LOT / UNIT 256	PHASE 2	MODEL 25-2140 ALT C The Wallace	
-------------------	------------	------------------------------------	--

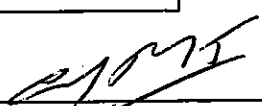
1. This Sales Selection Sheet when properly executed forms part of our Agreement of Purchase and Sale.
2. All extras and upgrades listed above are subject to Construction Progress and Architectural and Municipal requirements.
3. In the event the Vendor is unable to incorporate the work approved above in the construction of the house for any reason whatsoever, the Vendor will not be liable to the Purchaser in any way. The monies paid for any changes or optional extras not proceeded with shall be returned to the Purchaser, without interest. The cost of options or extras is non-refundable in all other circumstances. If for any reason whatsoever the Agreement of Purchase and Sale is not completed, the total cost of work approved above will be retained by the Vendor.
4. The Vendor reserves the right to substitute above materials and equipment with that of equal or better quality.
5. Purchaser acknowledges that items may not be exactly as shown. Variations from the Vendor's samples may occur in finished materials due to normal production processes. Vendor is not responsible for shade difference which may occur from different dye lots or wood grains. Variations from the Vendor's samples will occur with natural materials such as wood, marble, granite, hardwood and brick.
6. The Vendor reserves the right to select Grout & Thresholds that best suits the Tile selected.
7. Selections will not be processed unless signed by Heathwood Homes Head Office.
8. The selections made on this schedule are final and cannot be changed once submitted.
9. The Purchaser has checked and acknowledges the accuracy of this schedule.

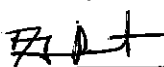
Payment Summary	
<u>Paid By</u>	<u>Amount</u>
<u>Total Payment:</u>	

PURCHASER:		21-Aug-20		21-Aug-20
	CARLOS, FERNANDO TORRES MAHECHA	DATE	Decor Consultant	DATE
PURCHASER:		21-Aug-20	- APPROVED -	
	DEICY PRIETO SANABRIA	DATE	-08- 28 2020	
			Date Approved	Heathwood Homes (Huron) Limited

UK-75 WALLACETON
LOT 256
25-2140 ALT C
THE WALLACE

16 of 41

THE WALLACE
ELEVATION B, C D & E | 2,133 SQ. FT.
500 sq. ft. of opt. finished lower level

25-2140 ALT ELEV.C

WALLACETON
REV. 10/00

Sketch # 1

ELECT 67" +/-
FROM FLOOR
CABLE STD
HIGHT

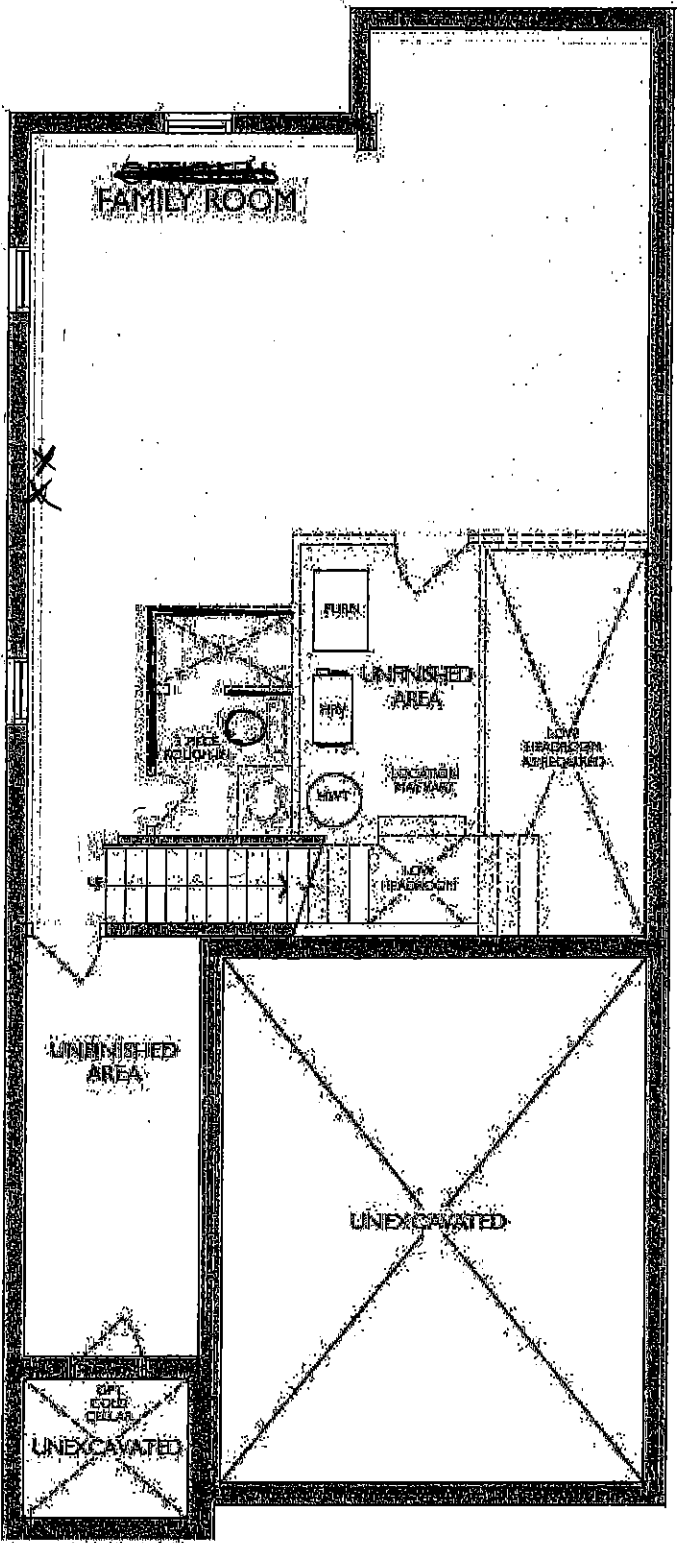

LOWER LEVEL
ELEVATION A, B, C, D & E

July 14, 2020

WPS

UK-75 WALLACETON
LOT 256
25-2140 ALT C
THE WALLACE

17 of 41

THE WALLACE
ELEVATION B, C D & E | 2,139 SQ. FT.

589 Sq. Ft. of sq. ft. Finished Lower Level

25-2140 ALT ELEV.C

WALLACETON
EST. 1919

Sketch # 2

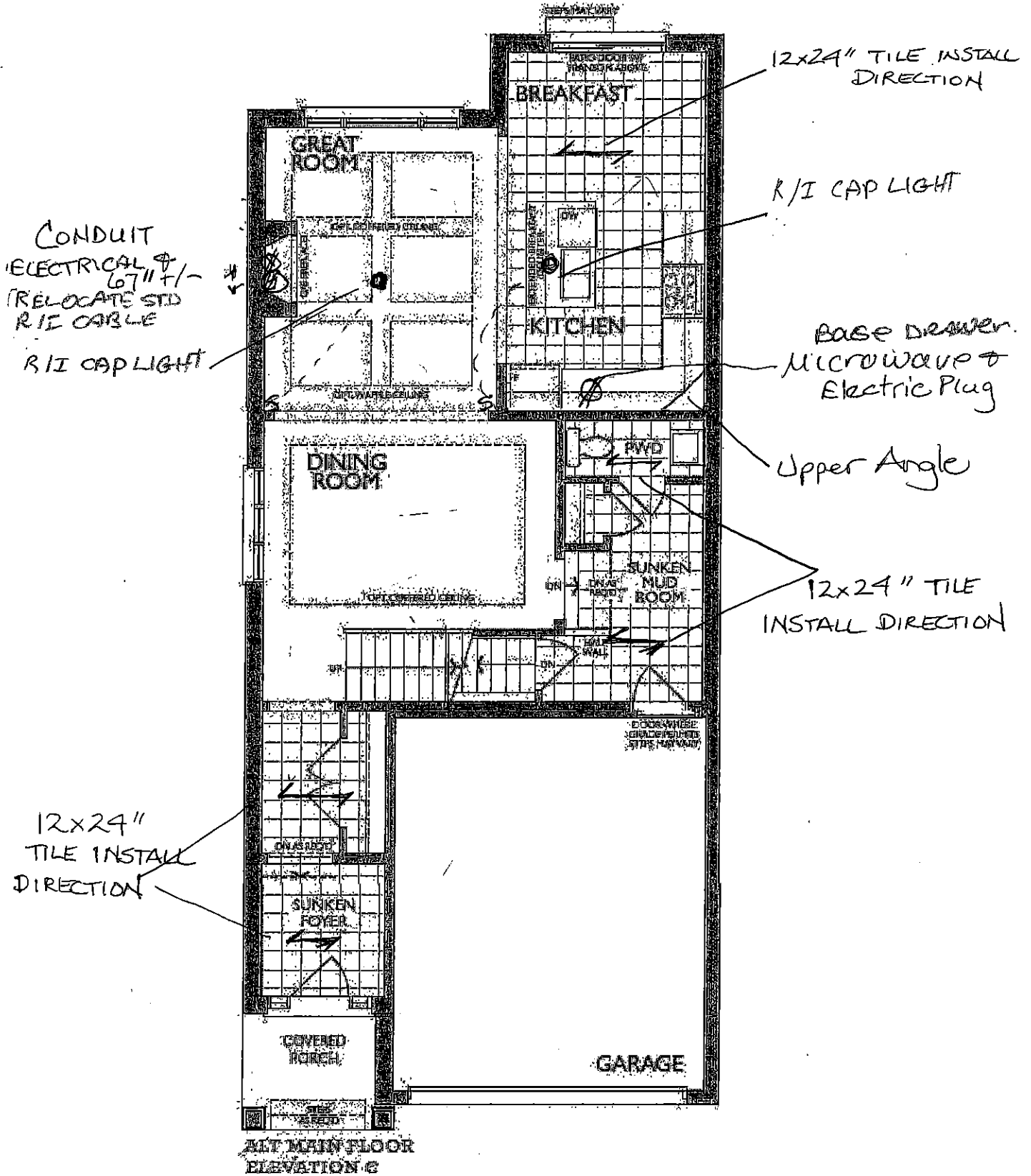

July 14, 2020

WTPS

UK-75 WALLACETON
LOT 256
25-2140 ALT C
THE WALLACE

18 of 41

THE WALLACE
ELEVATION B, C D & E | 2,133 SQ. FT.
500 sq. ft. of opt. finished lower level
WALLACETON
RET. 1830

25-2140 ALT ELEV.C

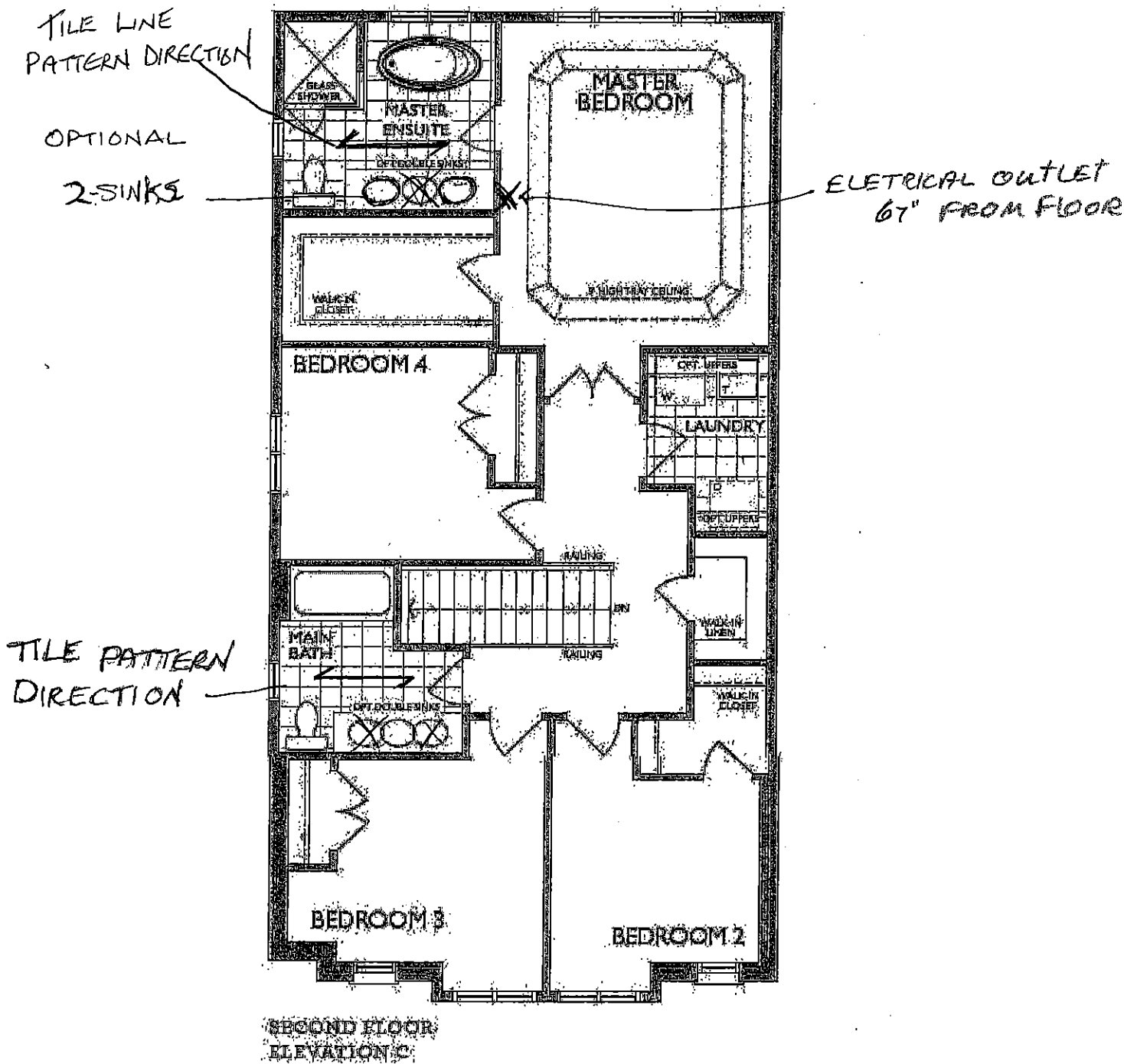

WPS

UK-75 WALLACETON
LOT 256
25-2140 ALT C
THE WALLACE

9 of 41

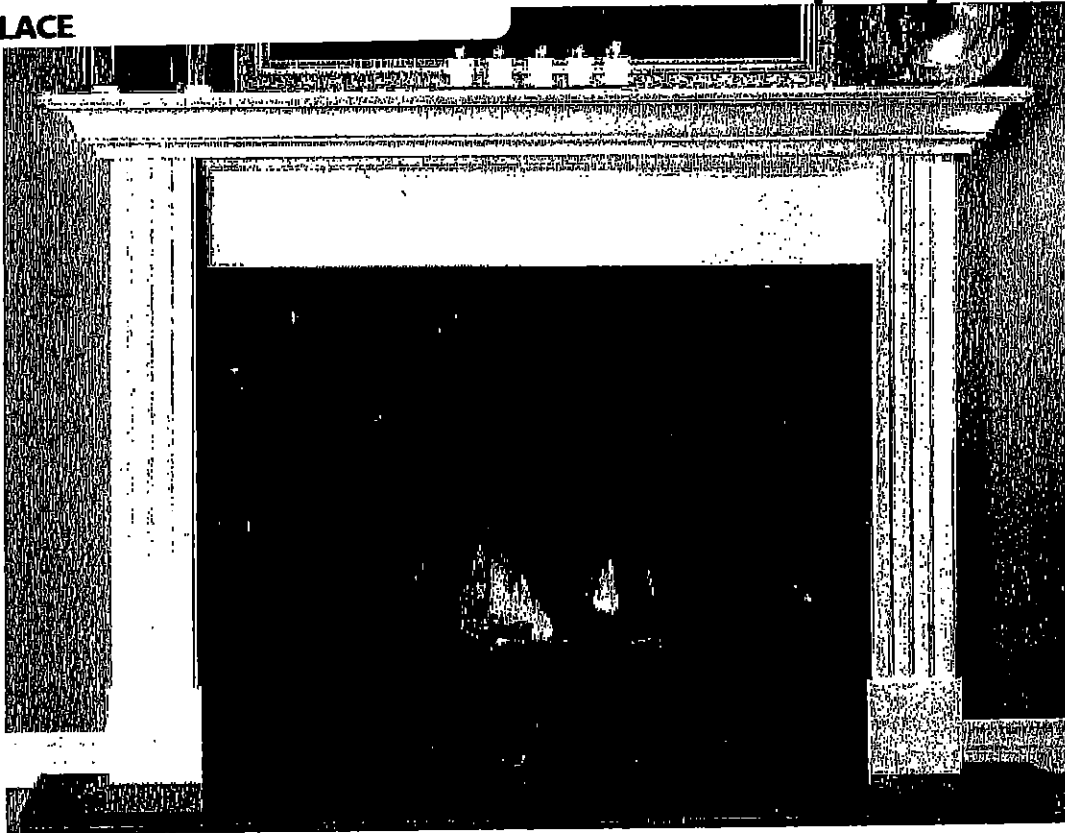

CABINET
STANDARD NF 15 Mantel

Clean apron finish with fluted legs

WHITE PAINT GRADE FINISH

(PICTURE SHOWN WITH UPGRADE SURROUND AND HEARTH -PRICED SEPARATELY)

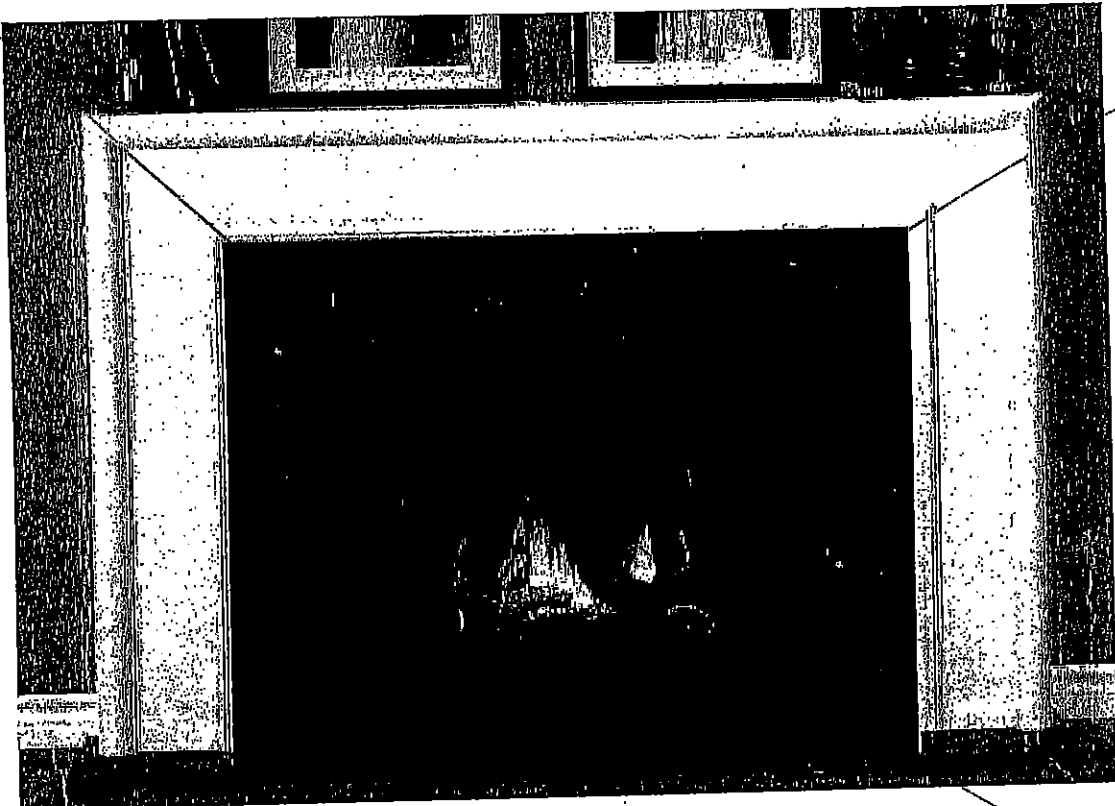

STANDARD NF 17 Mantel

WHITE PAINT GRADE FINISH

(PICTURE SHOWN WITH UPGRADE SURROUND AND HEARTH -PRICED SEPARATELY)

21/1/17
DPS

UK-75 WALLACETON
 LOT 256
 25-2140 ALT C
 THE WALLACE

20 of 41

Regener

STANDARD KITCHEN SINK

ND1831UA/9

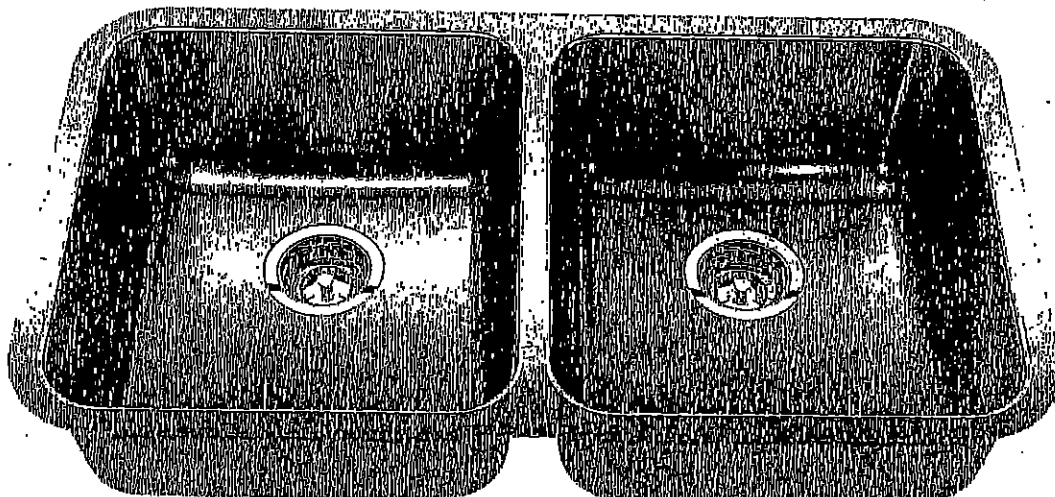

Optional Accessories



BG10S



BG10S



MB100



CA1W



DBR10S

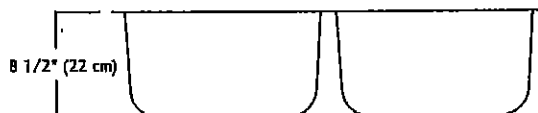
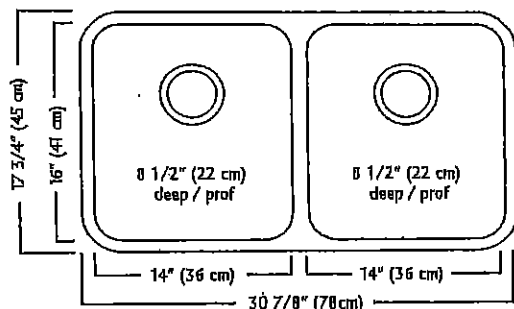

ND1831UA/9 SPECIFICATION

Model ND1831UA/9 is a double (two equal size) bowl undermount sink manufactured by Franke Kindred Canada Limited from 18 gauge stainless steel. Product has silk finished rims and linear brush finished bowls. Sink is fully undercoated. Basket strainer waste fittings (3 1/2", 89 mm) are included. Sink is backed with a limited lifetime warranty.

- O.D. 17 3/4" x 30 7/8" x 8 1/2" (45 x 78 x 22 cm)
- Recommended for minimum 36" cabinet

Franke Kindred Canada Limited

P.O. Box 190, 1000 Franke Kindred Road, Midland, Ontario, Canada, L4R 4K9 Phone: 866-687-7465 Fax: 800-361-8408

Franke Kindred Canada Limited

Printed in Canada

1117

WET
DPS

UK-75 WALLACETON
LOT 256
25-2140 ALT C
THE WALLACE

21 of 41

STANDARD KITCHEN FAUCET

Align

Modern

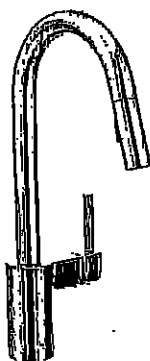

Single Handle Pull-Down Kitchen
Faucet*

Model 7565+

UK-75
DPS

UK-75 WALLACETON
LOT 256
25-2140 ALT C
THE WALLACE

Chateau

Transitional

22 of 41

POWDER ROOM &
BASEMENT
BATH ONLY

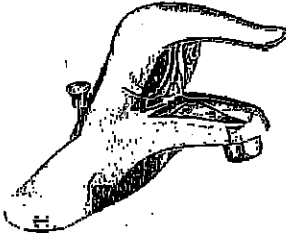

Lavatory Faucet with Pop-Up Drain
Model L4621†

VANITY SINKS AND PEDESTAL

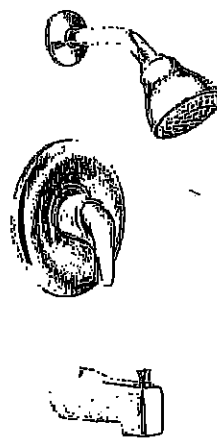

Posi-Temp® Pressure Balancing Tub/Shower
Model 62320 / TL183†
OR

Posi-Temp Valve and Tub/Shower Trim
with Eco-Performance Easy Clean® XL
Model 62320 / TL183EP†
(TL183EP not available in BC)

SHOWER AND 5' TUB FAUCETS

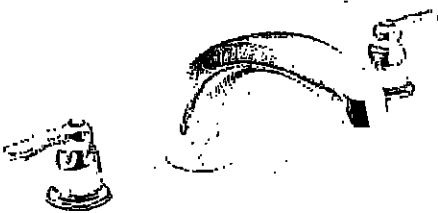

2 Handle Roman Tub with 9" Spout
Model 4796 / T990†

FREESTANDING TUB FAUCETS

1/22
DPS

23 of 41

2- MASTER BATHROOM
 1- MAIN BATHROOM



Buy it for looks. Buy it for life.®

Specifications

DESCRIPTION

- Quick connect system
- Metal construction with various finishes identified by suffix
- 1/2" IPS shanks
- Designed to be installed on 8" to 16" centers
- Includes metal pop-up type waste assembly

OPERATION

- Lever style handles with hot and cold color indicators
- Hot side counterclockwise to open (clockwise to close)
- Cold side clockwise to open (counterclockwise to close)

FLOW

- Flow is limited to 1.5 gpm max (5.7 L/min) at 60 psi, for products made before October 2008 flow is limited to 2.2 gpm max (8.3 L/min)

CARTRIDGE

- 1224 cartridge design
- Nonmetallic and stainless steel material

STANDARDS

- Third party certified to WaterSense®, ASME A112.18.1/CSA B125.1 and all applicable requirements referenced therein
- Certified to NSF 61/9 & 372
- Complies with California Proposition 65 and with the Federal Safe Drinking Water Act

- ADA for lever handles

WARRANTY

- Lifetime limited warranty against leaks, drips and finish defects to the original consumer purchaser
- 5 year warranty if used in commercial installations

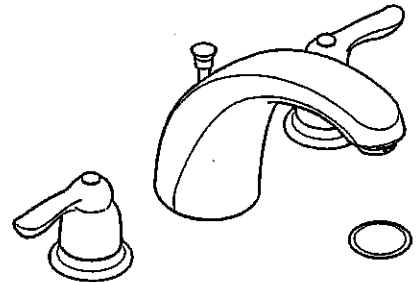

CHATEAU® Two-Handle Widespread Lavatory Faucet

Models: 4945 series

- NOTE:** SPOUT DESIGNED TO BE INSTALLED THROUGH 1" MIN. DIA. HOLE. VALVES INSTALL THROUGH 1-1/8" MIN. DIA. HOLE.
- NOTE:** FOR DECK THICKNESS 1-1/2" TO 3", USE SERVICE KIT #115001. VALVES INSTALL THROUGH 1-1/4" DIA. HOLE.

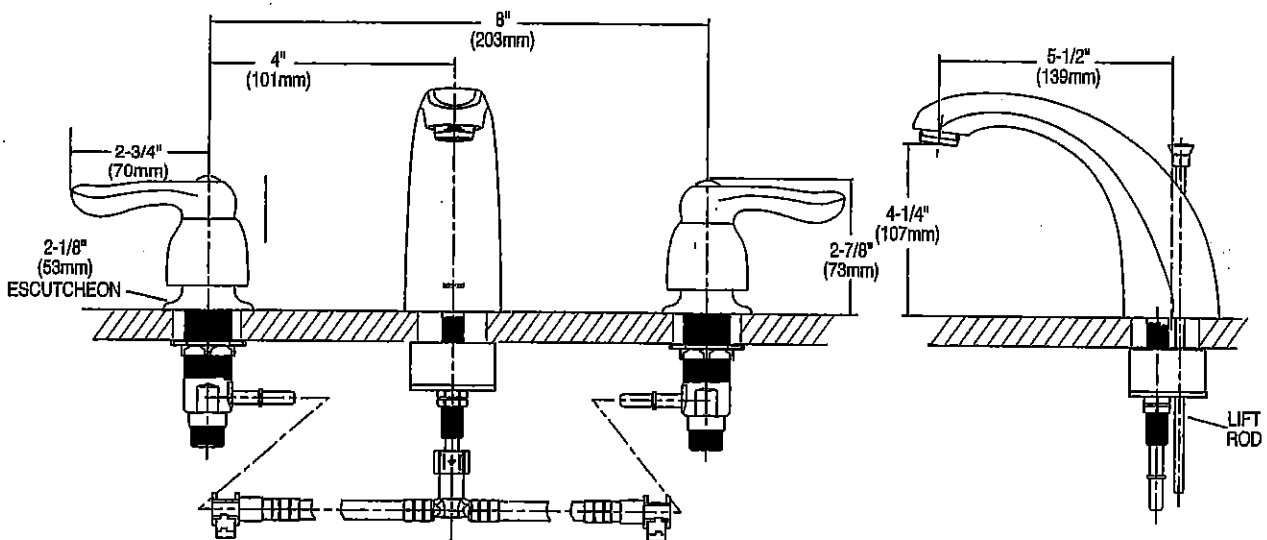

CRITICAL DIMENSIONS

(DO NOT SCALE)

Rev. 8/15

FOR MORE INFORMATION CALL: 1-800-BUY-MOEN

www.moen.com

4/15
 TFS

UK-75 WALLACETON
LOT 256
25-2140 ALT C
THE WALLACE

24 of 41

2X MASTER BATHROOM

American Standard

Style That Works Better

BARRIER FREE

OVALYN™ UNDERCOUNTER SINK

- Classic oval undermount sink
- Made from vitreous china
- Front overflow
- Supplied with mounting kit (047194-0070A) and template

0496.221 Unglazed rim
489 x 413mm
(19-1/4" x 16-1/4")

Bowl size:
432mm (17") wide
356mm (14") front to back
140mm (5-1/2") deep

OVALYN™
UNDERCOUNTER SINK
VITREOUS CHINA

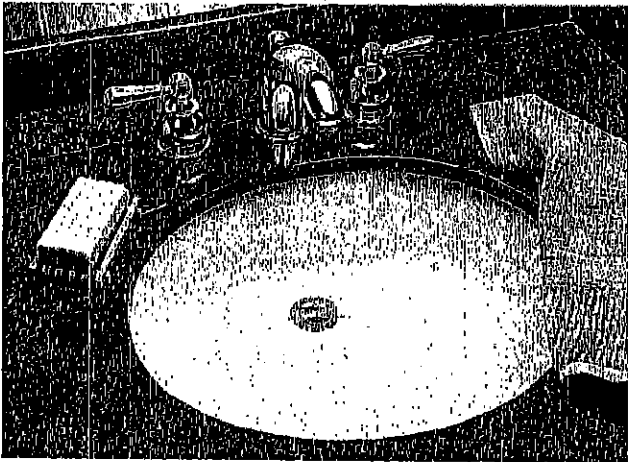

Compliance Certifications -
Meets or Exceeds the Following Specifications:
• ASME A112.19.2M for Vitreous China Fixtures
• CAN/CSA B45 series

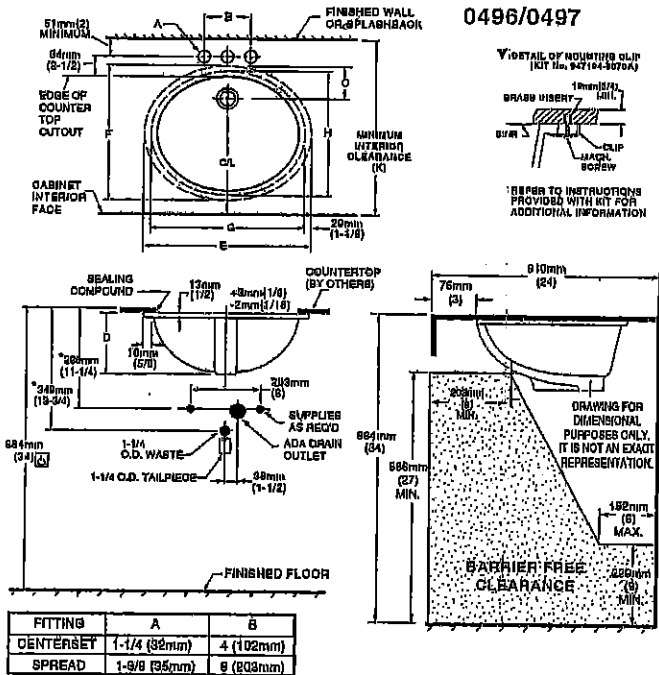

24 of 41
JPS

UK-75 WALLACETON
LOT 256
25-2140 ALT C
THE WALLACE

25 of 41

SC(B)500 | ALITO Collection

Cyclone®
Breathe Better

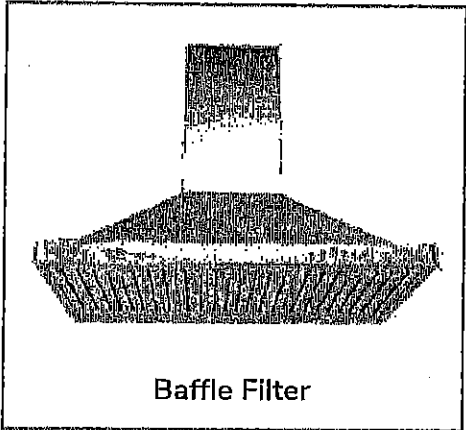

Wall Mount

Strong and sturdy with attractive lines and an imposing frame, the SC(B)500 is fitted with time-delay OFF feature up to nine minutes, 550 CFM fan, bright LED lights and a digital three-speed push button control panel.

Green Features



3 Speed Push Button
Control Panel



Dishwasher
Safe Filters



Long-Lasting
LED Light



Time-Delay
OFF Feature



Model	Colour	Ducting	Filters	Size	CFM
SC50024	Stainless Steel	6"	Mesh	24"	550
SC50030	Stainless Steel	6"	Mesh	30"	550
SC50036	Stainless Steel	6"	Mesh	36"	550
SCB50024	Stainless Steel	6"	Baffle	24"	550
SCB50030	Stainless Steel	6"	Baffle	30"	550
SCB50036	Stainless Steel	6"	Baffle	36"	550

Cyclone Range Hoods Inc.
1361 Huntingwood Drive, Unit 16, Toronto, ON M1S 3J1, Canada
Toll Free 1-888-293-5662 Tel: (416) 293-0933 Fax: (416) 293-4795 Website: www.CycloneRangeHoods.com

APL
DPS

UK-75 WALLACETON
LOT 256
25-2140 ALT C
THE WALLACE

26 of 41

SC(B)500 | ALITO Collection

1225
Cyclone[®]
Breathe Better

Features

- Wall mount range hood
- 6" round duct adapter
- Non-stick aluminum fan blades
- 3 speed push button control
- 2 LED lights (2 x 1.4W)
- Dishwasher-safe mesh or baffle filters
- Standard chimney fits up to 9 ft. ceiling
- Up to 9 minute time-delay OFF feature
- Plug-in connection

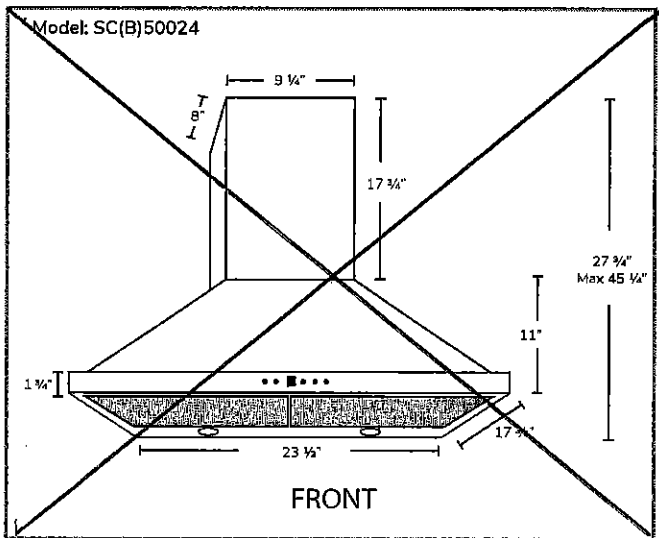
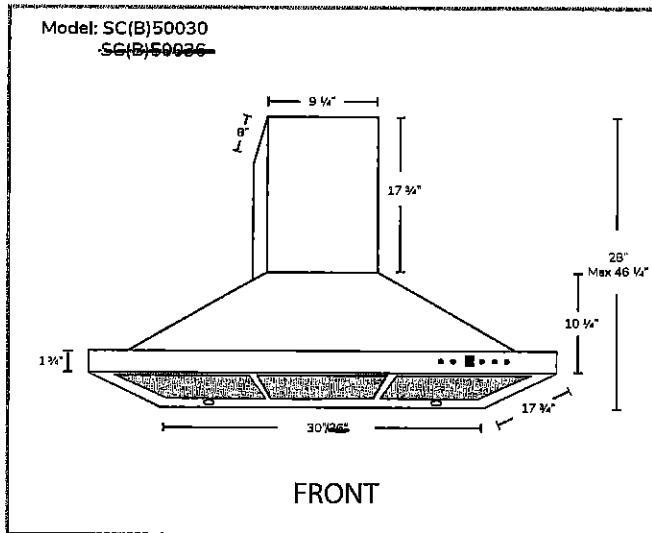

Options

- Filters: SC500 - Quick Release Aluminum Mesh Filters
SCB500 - Quick Release Stainless Steel Baffle Filters
- Available Chimney Flues:
Short (7 ft. - 8 ft. A1.CH10)
Standard (8 ft. - 9 ft. A1.CH18)
Extended (9 ft. - 11 ft. A1.CH30)
- Widths: 24", 30", 36"

Specifications

- Air Flow Volume: 550 CFM
- Electrical Connection: 120V/60Hz
- Power Consumption: 210 Watts
- Current: 2.5 Amps
- Fan Speed: 1600RPM
- Fan Type: Centrifugal Blower

- Finishes: Stainless Steel
- Ducting: 6" Round
- Dimensions: Width: 24", 30", 36"
Height: 46"
Depth: 18"

- Noise Level: Min. 2 Sones
Max. 6 Sones



Toronto • Vancouver • Boston
www.CycloneRangeHoods.com

Whirlpool® Bottom Mount Refrigerator

PRODUCT MODEL NUMBERS

WRF532SMB WRF535SWB
WRF535SMB WRF540CWB

Electrical: A 115-volt, 60-Hz, AC-only, 15- or 20-amp fused, grounded electrical supply is required. It is recommended that a separate circuit serving only your refrigerator be provided. Use an outlet that cannot be turned off by a switch. Do not use an extension cord.

NOTE: Before performing any type of installation, cleaning, or removing a light bulb, turn the control (Thermostat, Refrigerator or Freezer Control depending on the model) to OFF and then disconnect the refrigerator from the electrical source. When you are finished, reconnect the refrigerator to the electrical source and reset the control (Thermostat, Refrigerator or Freezer Control depending on the model) to the desired setting. See "Using the Controls."

Water: A cold water supply with water pressure between 30 and 120 psi (207 and 827 kPa) is required to operate the ice maker and water dispenser. If you have questions about your water pressure, call a licensed, qualified plumber.

IMPORTANT: The pressure of the water coming out of a reverse osmosis system going to the water inlet valve of the refrigerator needs to be between 35 and 120 psi (241 and 827 kPa).

Reverse Osmosis Water Supply: If a reverse osmosis water filtration system is connected to your cold water supply, the water pressure to the reverse osmosis system needs to be a minimum of 40 to 60 psi (276 to 414 kPa).

PRODUCT DIMENSIONS

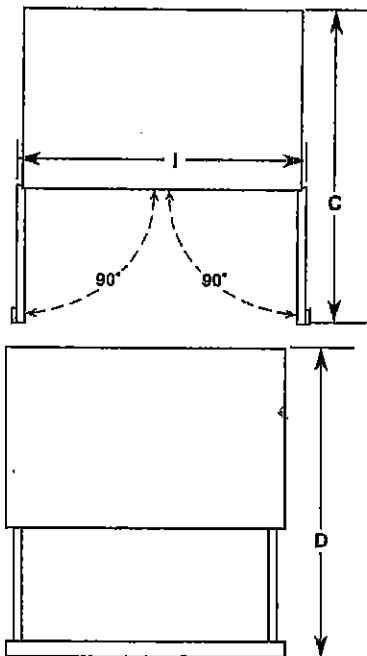
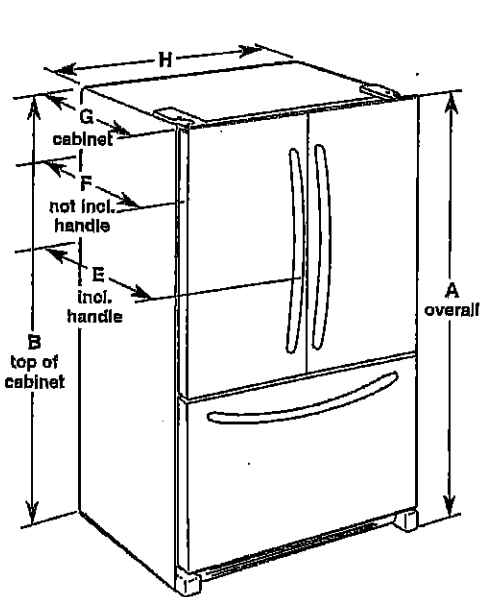

Model Number/Size	Height - Overall "A"	Height - Top of Cabinet "B"	Depth - Doors Open 90° "C"	Depth - Drawer Open "D"	Depth - With Handles "E"	Depth - Without Handles "F"	Depth - Cabinet Only "G"	Width - Cabinet "H"	Width - Door Open 90° "I"
WRF535SWB 25.2 cu. ft.	70 1/8" (178.1 cm)	68 1/8" (174.8 cm)	48 1/8" (122.1 cm)	53 1/8" (135 cm)	35 1/8" (90 cm)	32 1/8" (83.7 cm)	29 1/8" (74 cm)	35 1/8" (90.5 cm)	43 1/8" (110.2 cm)
WRF535SMB 25.2 cu. ft.	70 1/8" (178.1 cm)	68 1/8" (174.8 cm)	48 1/8" (122.1 cm)	53 1/8" (135 cm)	35 1/8" (90 cm)	32 1/8" (83.7 cm)	29 1/8" (74 cm)	35 1/8" (90.5 cm)	43 1/8" (110.2 cm)
WRF532SMB 22.1 cu. ft.	70 1/8" (178.1 cm)	68 1/8" (174.8 cm)	47 1/8" (119.5 cm)	52 1/8" (132.4 cm)	34 1/8" (87.5 cm)	31 1/8" (81.1 cm)	28 1/8" (71.4 cm)	32 1/8" (82.9 cm)	42 1/8" (107.6 cm)
WRF540CWB 20 cu. ft.	70 1/8" (178.1 cm)	68 1/8" (174.8 cm)	48" (121.9 cm)	44 1/8" (113.0 cm)	29 1/8" (74.6 cm)	28" (71.1 cm)	24 1/8" (61.3 cm)	35 1/8" (90.5 cm)	39 1/8" (100.0 cm)

LOCATION REQUIREMENTS

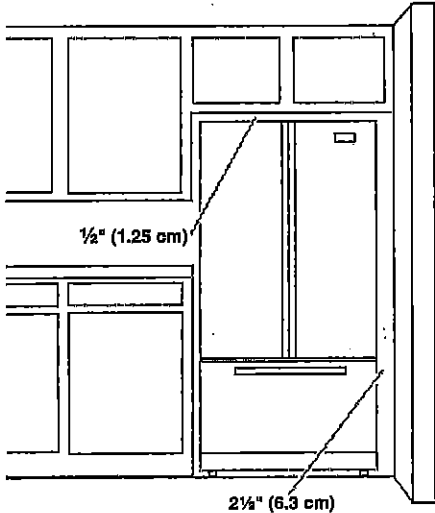

To ensure proper ventilation for your refrigerator, allow for a 1/2" (1.25 cm) space on each side and at the top. Allow for 1" (2.54 cm) of space behind the refrigerator. If your refrigerator has an ice maker, make sure you leave some extra space at the back for the water line connections.

If you are installing your refrigerator next to a fixed wall, leave 2 1/4" (6.3 cm) minimum on the hinge side (some models require more) to allow for the door to swing open.

NOTE: This refrigerator is intended for use in a location where the temperature ranges from a minimum of 55°F (13°C) to a maximum of 110°F (43°C). The preferred room temperature range for optimum performance, which reduces electricity usage and provides superior cooling, is between 60°F (15°C) and 90°F (32°C). It is recommended that you do not install the refrigerator near a heat source, such as an oven or radiator.

Handwritten signature and initials.

UK-75 WALLACETON
LOT 256
25-2140 ALT C
THE WALLACE

28 of 41

4.8 cu. ft. guided Electric Front Control Range
with the easy-wipe ceramic glass cooktop

YWEE510S0FS

Whirlpool

Home > Kitchen Appliances > Cooking Appliances > Ranges > Slide-In Ranges > YWEE510S0FS

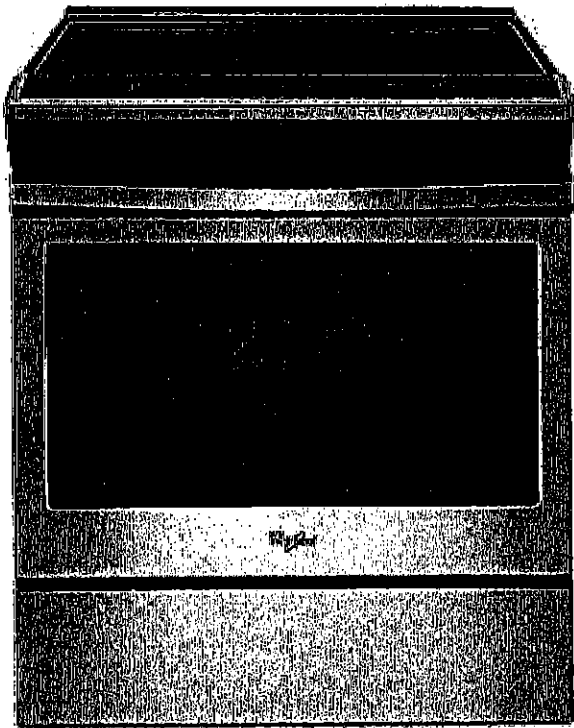

AKT
DS

29 of 41

WHIRLPOOL YWEE510S0FS

4.8 cu. ft. guided Electric Front Control Range with the easy-wipe ceramic glass cooktop

Mobile Home - Additional Installation Requirements

The Installation of this range must conform to the Manufactured Home Construction and Safety Standard, Title 24 CFR, Part 3280 (formerly the Federal Standard for Mobile Home Construction and Safety, Title 24, HUD Part 280). When such standard is not applicable, use the Standard for Manufactured Home Installations, ANSI A225.1/NFPA 501A or with local codes.

In Canada, the installation of this range must conform with the current standards CAN/CSA-A240-latest edition, or with local codes.

Mobile Home Installations Require:

- When this range is installed in a mobile home, it must be secured to the floor during transit. Any method of securing the range is adequate as long as it conforms to the standards listed above.

Product Dimensions

This manual covers several models. Your model may appear different from the models depicted. Dimensions given are maximum dimensions across all models.

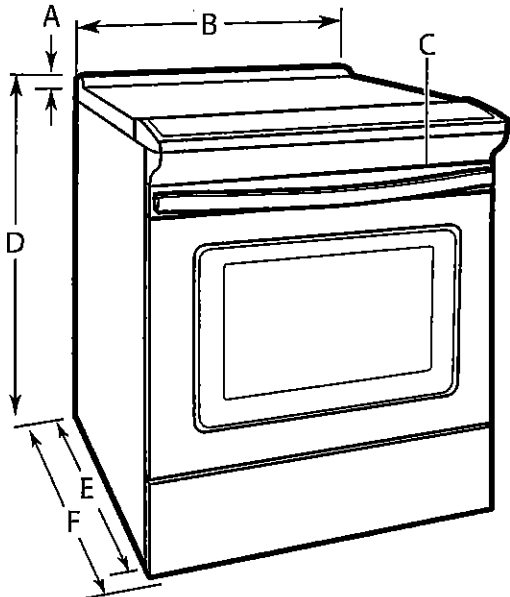

- A. 1 1/8" (3.0 cm) height from cooktop to top of vent
- B. 29 7/8" (75.9 cm)
- C. Model/serial/rating plate (located behind the oven door on the top right-hand side of the oven frame)
- D. 36" (91.4 cm) height to top of cooktop edge with leveling legs screwed all the way in*
- E. 28 5/8" (72.1 cm) max. depth from front of console to back of range
- F. 29 1/4" (73.7 cm) max. depth from handle to back of range

IMPORTANT: Range must be level after installation. Follow the instructions in the "Level Range" section. Using the cooktop as a reference for leveling the range is not recommended.

*Range can be raised approximately 1" (2.5 cm) by adjusting the leveling legs.

Cabinet Dimensions

Cabinet opening dimensions shown are for 25" (64.0 cm) countertop depth, 24" (61.0 cm) base cabinet depth, and 36" (91.4 cm) countertop height.

IMPORTANT: If installing a range hood or microwave hood combination above the range, follow the range hood or microwave hood combination installation instructions for dimensional clearances above the cooktop surface.

Range may be installed next to combustible walls with zero clearance.

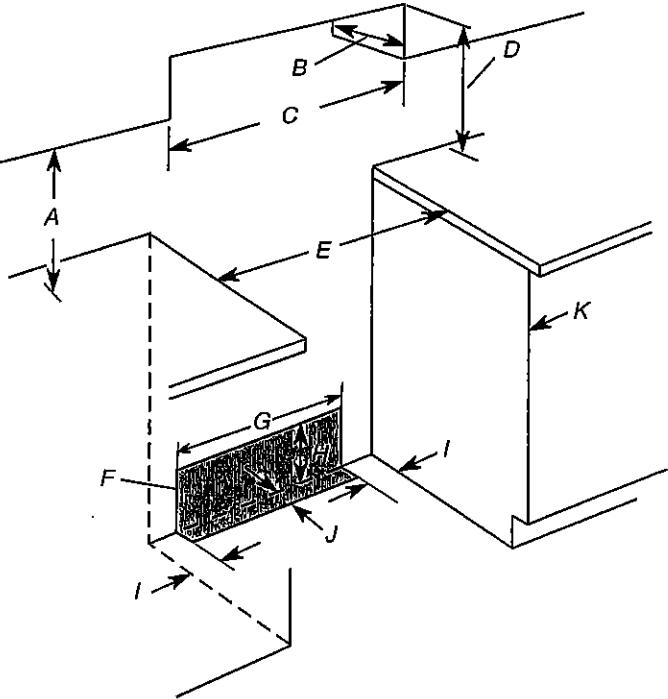

- A. 18" (45.7 cm) upper side cabinet to countertop
 - B. 13" (33 cm) max. upper cabinet depth
 - C. 30" (76.2 cm) min. opening width
 - D. For minimum clearance to top of cooktop, see NOTE*.
 - E. 30" (76.2 cm) min. opening width
 - F. The shaded area is recommended for installation of grounded outlet.
 - G. 13 1/8" (33.3 cm)
 - H. 7 1/8" (19.5 cm)
 - I. 4 1/8" (12.2 cm)
 - J. 3 1/8" (9.4 cm)
 - K. Cabinet door or hinges should not extend into the cutout.
- *NOTE:** 24" (61.0 cm) minimum when bottom of wood or metal cabinet is shielded by not less than 1/4" (0.64 cm) flame retardant millboard covered with not less than No. 28 MSG sheet steel, 0.015" (0.4 mm) stainless steel, 0.024" (0.6 mm) aluminum or 0.020" (0.5 mm) copper.
- 30" (76.2 cm) minimum clearance between the top of the cooking platform and the bottom of an uncovered wood or metal cabinet.

41-41
205

UK-75 WALLACETON
LOT 256
25-2140 ALT C
THE WALLACE

30 of 41

WHIRLPOOL YWEE510S0FS
4.8 cu. ft. guided Electric Front Control Range with the easy-wipe ceramic glass cooktop

INSTALLATION REQUIREMENTS

Tools and Parts

Gather the required tools and parts before starting installation. Read and follow the instructions provided with any tools listed here.

Tools Needed

- Tape measure
- Phillips screwdriver
- Level
- Hand or electric drill
- Wrench or pliers
- Marker or pencil
- 1/8" (3.2 mm) drill bit (for wood floors)
- Flashlight

Parts Supplied

Check that all parts are included.

- #10 x 1 1/8" (4.1 cm) screws (for mounting anti-tip bracket) (2)
- Anti-tip bracket (inside oven cavity)

Anti-tip bracket must be securely mounted to the back wall or floor. Thickness of flooring may require longer screws to anchor bracket to subfloor. Longer screws are available from your local hardware store.

Location Requirements

IMPORTANT: Observe all governing codes and ordinances.

- It is the installer's responsibility to comply with installation clearances specified on the model/serial/rating plate. The model/serial/rating plate is located behind the oven door on the top right-hand side of the oven frame.
- The range should be located for convenient use in the kitchen.
- Recessed installations must provide complete enclosure of the sides and rear of the range.
- To eliminate the risk of burns or fire by reaching over the heated surface units, cabinet storage space located above the surface units should be avoided. If cabinet storage is to be provided, the risk can be reduced by installing a range hood or microwave hood combination that projects horizontally a minimum of 5" (12.7 cm) beyond the bottom of the cabinets.
- All openings in the wall or floor where range is to be installed must be sealed.
- Cabinet opening dimensions that are shown must be used. Given dimensions are minimum clearances.
- The anti-tip bracket must be installed. To install the anti-tip bracket shipped with the range, see "Install Anti-Tip Bracket" section.
- Grounded electrical supply is required. See the appropriate "Electrical Requirements" section.
- Contact a qualified floor covering installer to check that the floor covering can withstand at least 200°F (93°C).
- Use an insulated pad or 1/4" (0.64 cm) plywood under range if installing range over carpeting.

IMPORTANT: To avoid damage to your cabinets, check with your builder or cabinet supplier to make sure that the materials used will not discolor, delaminate, or sustain other damage. This oven has been designed in accordance with the requirements of UL and CSA International and complies with the maximum allowable wood cabinet temperatures of 194°F (90°C).

16245
TPS

UK-75 WALLACETON
LOT 256
25-2140 ALT C
THE WALLACE

31 of 41

WHIRLPOOL YWEE510S0FS

4.8 cu. ft. guided Electric Front Control Range with the easy-wipe ceramic glass cooktop

Electrical Requirements - Canada Only

⚠ WARNING



Electrical Shock Hazard

Electrically ground range.

Failure to do so can result in death, fire, or electrical shock.

If codes permit and a separate ground wire is used, it is recommended that a qualified electrical installer determine that the ground path is adequate and wire gauge are in accordance with local codes.

Be sure that the electrical connection and wire size are adequate and in conformance with CSA Standard C22.1, Canadian Electrical Code, Part 1 - latest edition, and all local codes and ordinances.

A copy of the above code standards can be obtained from:

Canadian Standards Association
178 Rexdale Blvd.
Toronto, ON M9W 1R3 CANADA

- Check with a qualified electrical installer if you are not sure the range is properly grounded.

Range Rating*		Specified Rating of Power Supply Cord Kit and Circuit Protection
120/240 Volts	120/208 Volts	Amps
8.8 - 16.5 KW	7.8 - 12.5 KW	40 or 50**
16.6 - 22.5 KW	12.6 - 18.5 KW	50

*The NEC calculated load is less than the total connected load listed on the model/serial/rating plate.

**If connecting to a 50-amp circuit, use a 50-amp rated cord with kit. For 50-amp rated cord kits, use kits that specify use with a nominal 1 1/2" (3.5 cm) diameter connection opening.

- A circuit breaker is recommended.
- This range is equipped with a CSA International Certified Power Cord Intended to be plugged into a standard 14-50R wall receptacle. Be sure the wall receptacle is within reach of range's final location.

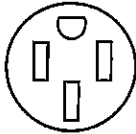

- Do not use an extension cord.
- The tech sheet and wiring diagram are located on the back of the range in a plastic bag.

CHILL
TR5

32 of 41

WHIRLPOOL YWEE510S0FS

4.8 cu. ft. guided Electric Front Control Range with the easy-wipe ceramic glass cooktop

INSTALLATION INSTRUCTIONS

Unpack Range

⚠ WARNING

Excessive Weight Hazard

Use two or more people to move and install range.
Failure to do so can result in back or other injury.

1. Remove shipping materials, tape, and film from the range. Keep cardboard bottom under range. Do not dispose of anything until the installation is complete.
2. Remove oven racks and parts package from oven and shipping materials.
3. To remove cardboard bottom, first take 4 cardboard corners from the carton. Stack 1 cardboard corner on top of another. Repeat with the other 2 corners. Place them lengthwise on the floor behind the range to support the range when it is laid on its back.
4. Using 2 or more people, firmly grasp the range and gently lay it on its back on the cardboard corners.
5. Remove cardboard bottom.

The leveling legs can be adjusted while the range is on its back. See the "Adjust Leveling Legs" section.

NOTE: To place range back up into a standing position, put a sheet of cardboard or hardboard on the floor in front of range to protect the flooring. Using 2 or more people, stand range back up onto the cardboard or hardboard.

Install Anti-Tip Bracket

⚠ WARNING



Tip Over Hazard

A child or adult can tip the range and be killed.

Install anti-tip bracket to floor or wall per installation instructions.

Slide range back so rear range foot is engaged in the slot of the anti-tip bracket.

Re-engage anti-tip bracket if range is moved.

Do not operate range without anti-tip bracket installed and engaged.

Failure to follow these instructions can result in death or serious burns to children and adults.

1. Remove the anti-tip bracket from the inside of the oven.
2. Determine which mounting method to use: floor or wall.
If you have a stone or masonry floor, you can use the wall mounting method. If you are installing the range in a mobile home, you must secure the range to the floor.
This anti-tip bracket and screws can be used with wood or metal studs.
3. Determine and mark centerline of the cutout space. The mounting bracket can be installed on either the left-hand or right-hand side of the cutout. Position mounting bracket against the wall in the cutout so that the V-notch of the bracket is 12½" (31.8 cm) from centerline as shown.

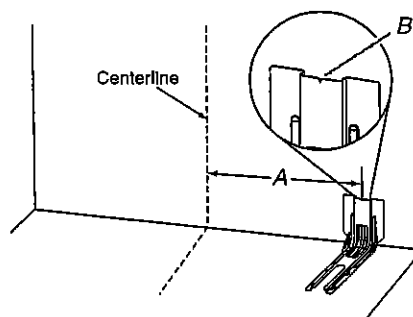

A. 12½" (31.8 cm)

B. Bracket V-notch

2152
775

33 of 41

WHIRLPOOL YWEE510S0FS

4.8 cu. ft. guided Electric Front Control Range with the easy-wipe ceramic glass cooktop

4. Drill two 1/8" (3 mm) holes that correspond to the bracket holes of the determined mounting method. See the following illustrations.

Floor Mounting

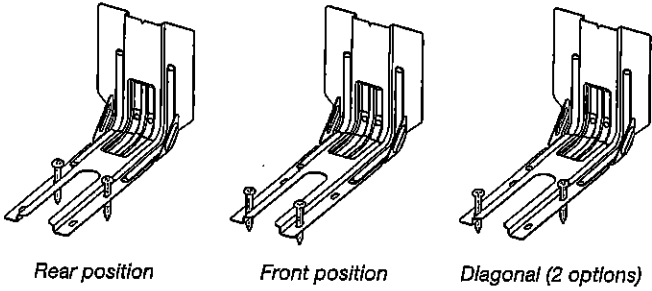

Wall Mounting

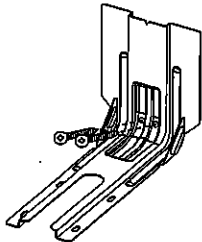

5. Using the two #10 x 1 1/2" (4.1 cm) Phillips-head screws provided, mount anti-tip bracket to the wall or floor.
6. Move range close enough to opening to allow for final electrical connections. Remove shipping base, cardboard, or hardboard from under range.
7. Move range into its final location, making sure rear leveling leg slides into anti-tip bracket.

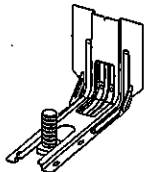

8. Move range forward onto shipping base, cardboard, or hardboard to continue installing the range, using the following installation instructions.

Adjust Leveling Legs

1. If range height adjustment is necessary, use a wrench or pliers to loosen the 4 leveling legs.
- This may be done with the range on its back or with the range supported on 2 legs after the range has been placed back to a standing position.

NOTE: To place range back up into a standing position, put a sheet of cardboard or hardboard in front of range. Using 2 or more people, stand range back up onto the cardboard or hardboard.

WARNING



Tip Over Hazard

A child or adult can tip the range and be killed.

Install anti-tip bracket to floor or wall per installation instructions.

Slide range back so rear range foot is engaged in the slot of the anti-tip bracket.

Re-engage anti-tip bracket if range is moved.

Do not operate range without anti-tip bracket installed and engaged.

Failure to follow these instructions can result in death or serious burns to children and adults.

2. Measure the distance from the top of the counter to the floor.
3. Measure the distance from the top of the cooktop to the bottom of the leveling legs. This distance should be the same. If it is not, adjust the leveling legs to the correct height. The leveling legs can be loosened to add up to a maximum of 1" (2.5 cm). A minimum of 3/16" (5 mm) is needed to engage the anti-tip bracket.

NOTE: If height adjustment is made when range is standing, tilt the range back to adjust the front legs, and then tilt forward to adjust the rear legs.

4. When the range is at the correct height, check that there is adequate clearance under the range for the anti-tip bracket. Before sliding range into its final location, check that the anti-tip bracket will slide under the range and onto the rear leveling leg prior to anti-tip bracket installation.

NOTE: If a Trim Kit will be used, the top of the cooktop should be higher than the counter. See the Installation Instructions included with the Trim Kit for the correct height.

Level Range

1. Place level on the oven bottom, as indicated in one of the 2 figures below, depending on the size of the level. Check with the level side to side and front to back.

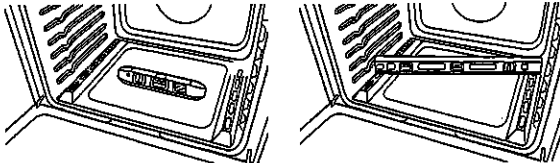

2. If range is not level, use a wrench or pliers to adjust leveling legs up or down until the range is level.

WALLACE
TAS

34 of 41

Whirlpool® Undercounter Dishwasher

PRODUCT MODEL NUMBERS

WDF110PAB	WDF310PLA	WDE530PSV
WDF111PAB	WDF320PAD	WDF540PAD
WDF120PAF	WDF510PAY	WDF730PAY
WDF121PAF	WDF520PAD	WDT710PAY
WDF310PAA	WDF530PAY	WDT720PAD
WDF310PCA	WDF530PLY	WDT770PAY

Electrical Requirements: 120-volt, 60-Hz, AC only, 15- or 20-amp. fused electrical supply. Copper wire only. A time delay fuse or circuit breaker and separate circuit is recommended.

If direct wiring dishwasher: Use flexible, armored, or nonmetallic, sheathed copper wire with grounding wire that meets the wiring requirements for your home and local codes and ordinances. Use a UL listed or CSA approved conduit connector.

If connecting dishwasher with a power supply cord: Use Power Supply Cord Kit (Part No. 4317824) marked for use with dishwashers. Follow the kit instructions for installing the power supply cord.

Power supply cord must plug into a grounded 3 prong, outlet, located in the cabinet next to the dishwasher opening. Outlet must meet all local codes and ordinances.

Water Supply Requirements: A hot water line with 20 to 120 psi (138 to 862 kPa) water pressure. Water temperature must be 120°F (49°C) water at dishwasher. Use 3/8" O.D. copper tubing with compression fitting or flexible braided water supply line (1/2" minimum plastic tubing is not recommended). Use a 90° elbow with 1/4"N.P.T. external pipe threads on one end. Do not solder within 6" (15.2 cm) from water inlet valve.

Drain Requirements: A new drain hose is supplied with your dishwasher. If this is not long enough, use a new drain hose with a maximum length of 12' (3.7 m) (Part No. 3385556) that meets all current AHAM/IAPMO test standards, is resistant to heat and detergent, and fits the 1" (2.5 cm) drain connector of the dishwasher.

Make sure to connect the drain hose to waste tee or disposer inlet above drain trap in house plumbing and 20" (50.8 cm) minimum above the floor. It is recommended

that the drain hose either be looped up and securely fastened to the underside of the counter or be connected to an air gap. Make sure to use an air gap if the drain hose is connected to house plumbing lower than 20" (50.8 cm) above subfloor or floor.

Use 1/2" (1.3 cm) minimum I.D. drain line fittings. If required, the air gap should be installed in accordance with the air gap installation instructions. When connecting the air gap, a rubber hose (not provided) will be needed to connect to the waste tee or disposer inlet.

PRODUCT DIMENSIONS

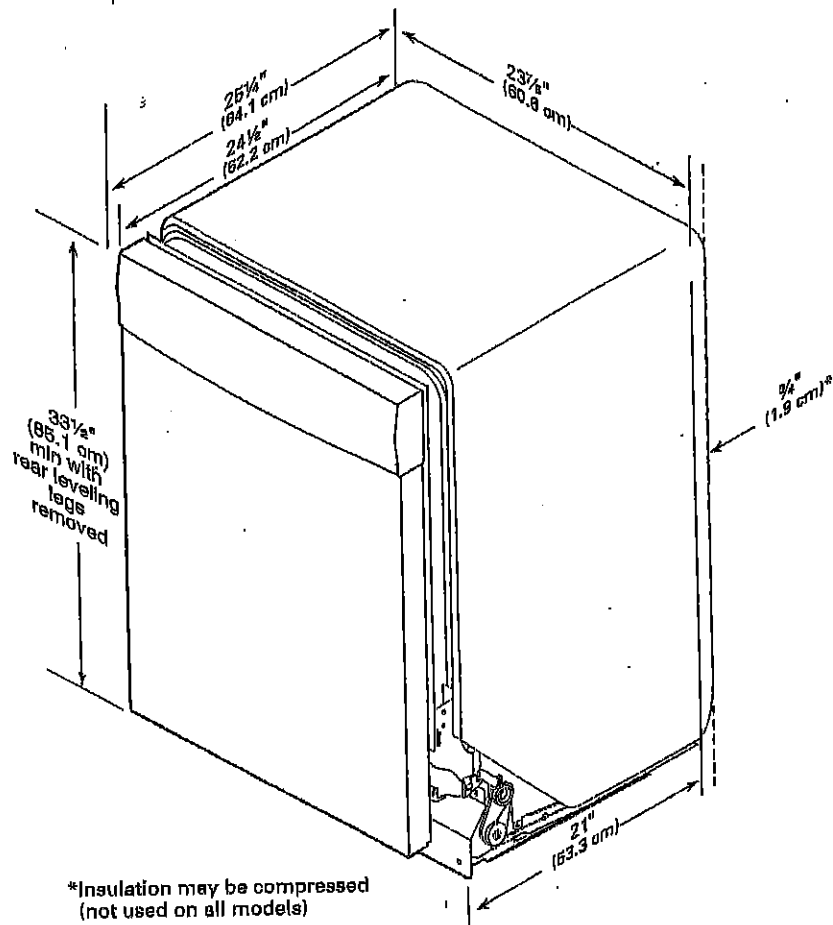

*Insulation may be compressed (not used on all models)

Handwritten signature and initials.

35 of 41^{1, 2}

UK-75 WALLACETON
LOT 256
25-2140 ALT C
THE WALLACE

CABINET CUTOUT DIMENSIONS

NOTE: Shaded areas of cabinet walls show where utility connections may be installed.

*Measure from the lowest point on the underside of the countertop. May be reduced to 33½" (85.1 cm) by removing the rear leveling legs from dishwasher.

**Minimum, measured from narrowest point of opening.

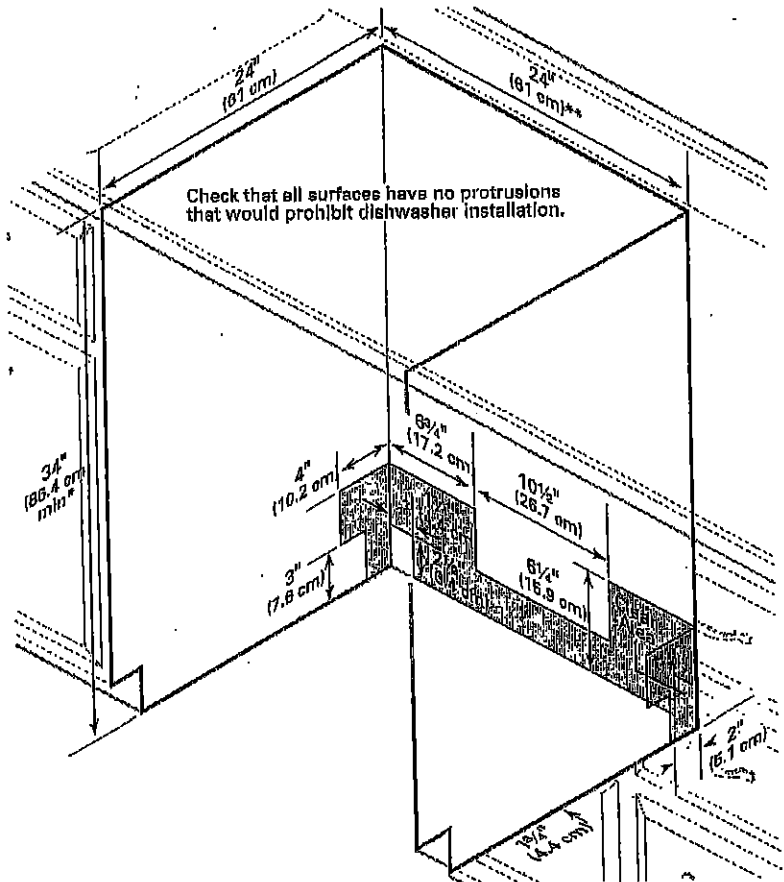

OK
PPS

UK-75 WALLACETON
LOT 256
25-2140 ALT C
THE WALLACE

36 of 41

WHIRLPOOL WASHER Model #: WFW5620HW

Whirlpool Brand Canada English | Washer and Dryers | Washers | Front Load Washers | WFW5620HW

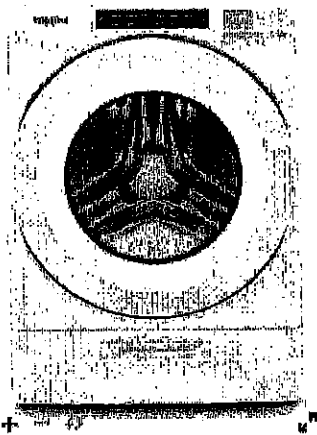

5.2 cu. ft. I.E.C. Closet-Depth
Front Load Washer with
Load & Go™ Dispenser



5.2 cu. ft. I.E.C. Closet-Depth Front Load Washer with Load & Go™
Dispenser
Model #: WFW5620HW

Dimensions

Depth	80.17 cm, 31-9/16 in
Depth With Door Open 90 Degree	143.51 cm, 56-1/2 in
Minimum Height	98.11 cm, 38-5/8 in
Width	68.58 cm, 27.0 in

Appearance

LCD Touch Screen	No
Window	Yes

Details

Drum Material	Stainless Steel
---------------	-----------------

Cycles and Options

Number of Wash Cycles	37
-----------------------	----

Electrical

Hz	60
Power Cord Included	Yes

AKT
DPS

37 of 41

WHIRLPOOL WASHER Model #: WFW5620HW

LOCATION REQUIREMENTS

Proper installation is your responsibility.

You will need:

- A water heater set to 120°F (49°C).
- A grounded electrical outlet located within 6 ft (1.8 m) of power cord on back of washer.
- Hot and cold water faucets located within 4 ft (1.2 m) of hot and cold water fill valves on washer, and water pressure of 20–100 psi (137.9–689.6 kPa).
- A level floor with maximum slope of 1" (25 mm) under entire washer. Installing on carpet or surfaces with foam backing is not recommended.
- Floor must support washer's total weight (with water and load) of 315 lbs (143 kgs).

IMPORTANT: Do not install, store, or operate washer where it will be exposed to weather or in temperatures below 32°F (0°C). Water remaining in washer after use may cause damage in low temperatures. See "Washer Care" in your Use and Care Guide for winterizing information.

Whirlpool Models*

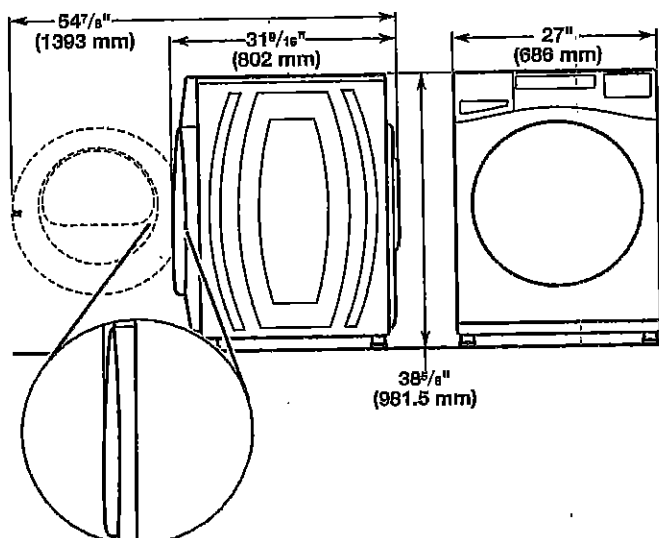
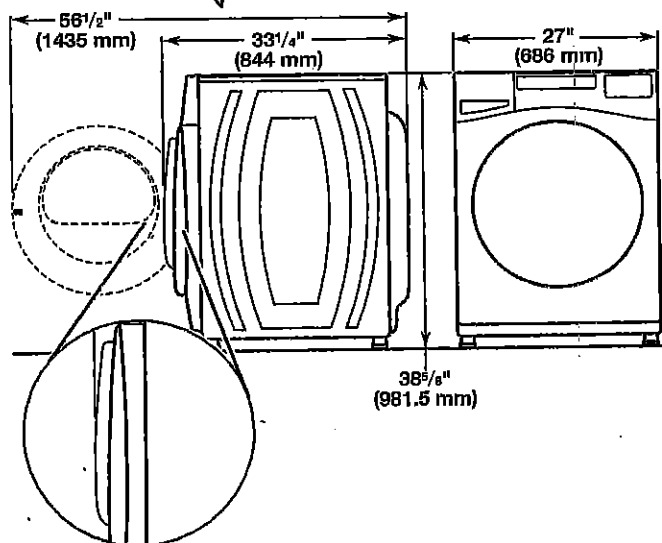

*For additional details (or information) specific to your model, refer to the 'Dimensions' listed for your model at www.whirlpool.com.

Maytag Models

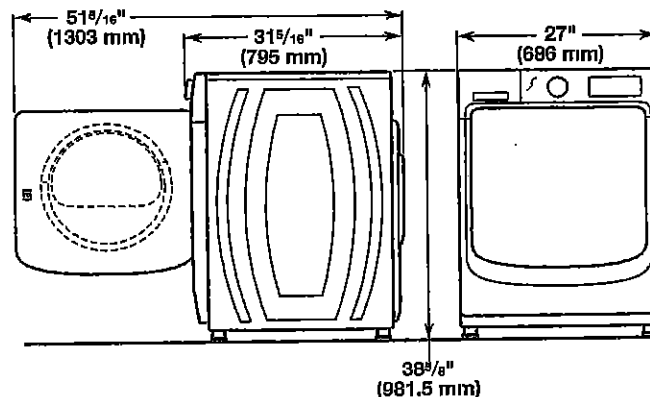
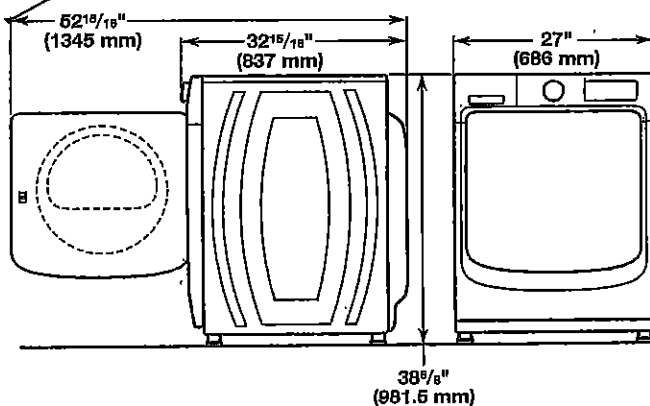

All dimensions show minimum spacing allowed. For each arrangement, consider allowing more space for ease of installation and servicing, and spacing for companion appliances and clearances for walls, doors, and floor moldings. Space must be large enough to allow door to fully open. Add spacing of 1" (25 mm) on all sides of washer to reduce noise transfer. If a closet door or louvered door is installed, top and bottom air openings in door are required.

Recessed area or closet installation (stacked washer and dryer):

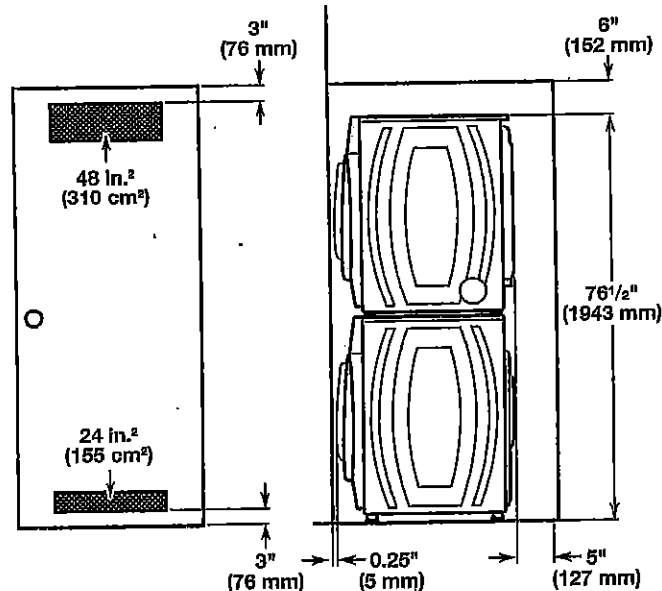

WPS

**UK-75 WALLACETON
LOT 256
25-2140 ALT C
THE WALLACE**

38 of 41

WHIRLPOOL WASHER Model #: WFW5620HW

Custom under-counter installation:

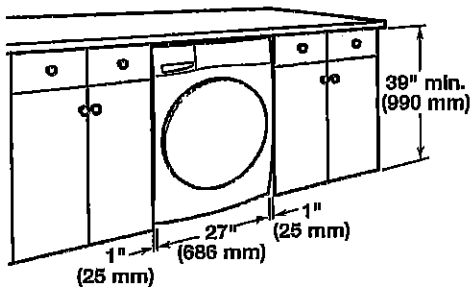

Recessed area or closet installation:

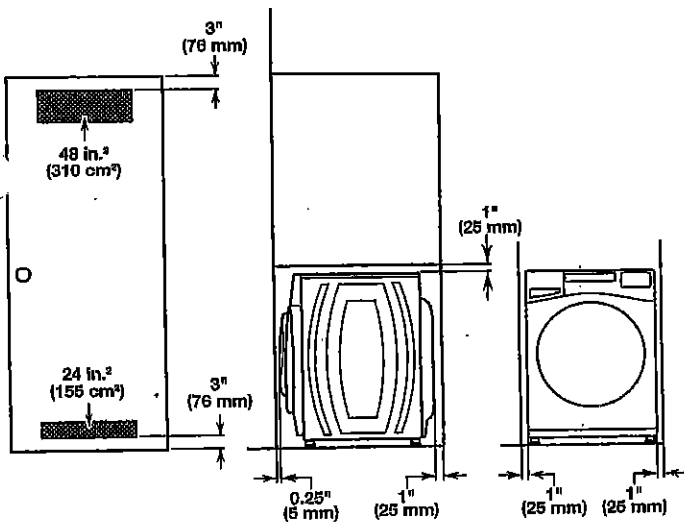

Custom cabinet installation:

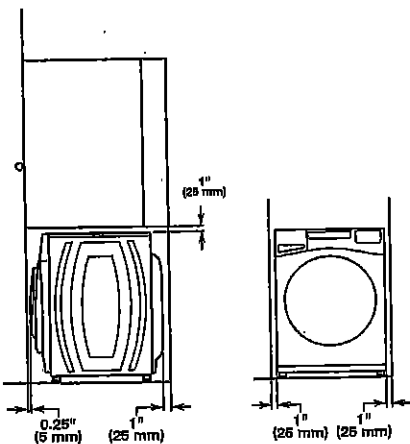

DRAIN SYSTEM

The drain system can be installed using a floor drain, wall standpipe, floor standpipe, or laundry tub. Select the method you need.

IMPORTANT: To avoid siphoning, only 4.5" (114 mm) of drain hose should be inside standpipe. Always secure drain hose with cable tie.

Floor standpipe drain system

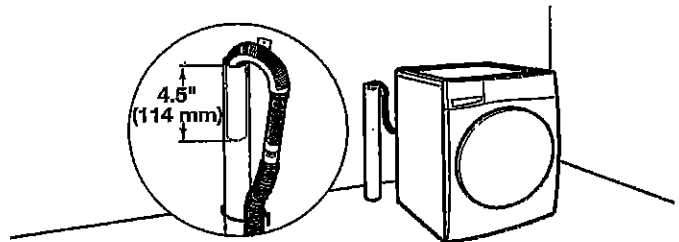

Minimum diameter for a standpipe drain: 2" (51 mm). Minimum carry-away capacity: 17 gal. (64 L) per minute. A 1/4" (6 mm) diameter to 1" (25 mm) diameter Standpipe Adapter Kit is available (Part Number 3363920). Top of standpipe must be at least 30" (762 mm) high; install no higher than 96" (2.44 m) from bottom of washer. If you have an overhead sewer and need to pump higher than 96" (2.44 m), a sump pump and associated hardware are needed. See "Alternate parts."

Wall standpipe drain system

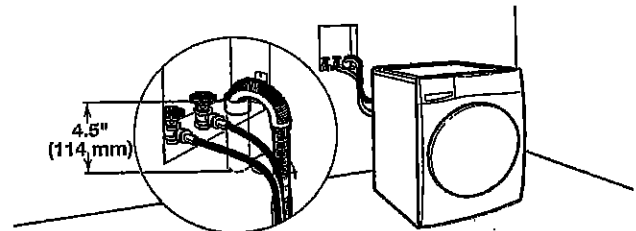

See requirements for floor standpipe drain system.

Laundry tub drain system

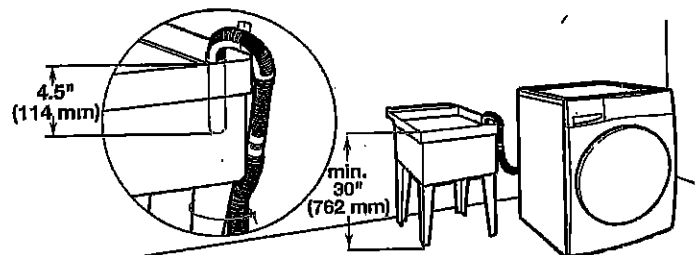

Minimum capacity: 20 gal. (76 L). Top of laundry tub must be at least 30" (762 mm) above floor; install no higher than 96" (2.44 m) from bottom of washer.

17/11/15 17/11/15

UK-75 WALLACETON
LOT 256
25-2140 ALT C
THE WALLACE

39 of 41

WHIRLPOOL DRYER Model #: YWED5620HW

Whirlpool Brand Canada English | Washer and Dryers | Dryers | Electric Dryers | YWED5620HW

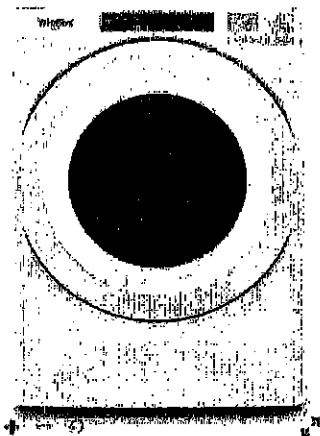

7.4 cu. ft. Front Load Electric
Dryer with Intuitive Touch
Controls



Whirlpool 7.4 cu. ft. Front Load Electric Dryer with Intuitive Touch Controls
Model #: YWED5620HW

Dimensions

Depth	78.74 cm, 31.0 in
Depth With Door Open 90 Degree	138.43 cm, 54-1/2 in
Height	98.42 cm, 38-3/4 in
Width	68.58 cm, 27.0 in

Configuration and Overview

Fuel Type	Electric
-----------	----------

Cycles and Options

Cycle Time Remaining	Yes
Lint Filter Indicator	No
Number of Dryer Cycles	98
Number of Dryness Levels	3

Ventilation System

Long Vent	No
Maximum Vent Length	64
Venting Direction	Left, Right, Bottom, Rear

Electrical

Hz	60
Power Cord Included	Yes

4/24/15
AKS

UK-75 WALLACETON
LOT 256
25-2140 ALT C
THE WALLACE

40 of 41

WHIRLPOOL DRYER Model #: YWED5620HW

Additional parts may be required, depending on your installation. Check local codes. Check existing electrical supply and venting. Read "Electrical Requirements" and "Venting Requirements" before purchasing parts.

If using a power supply cord:

Use a UL Listed power supply cord kit marked for use with clothes dryers. The kit should contain:

- A UL Listed 30 amp power supply cord, rated 120/240 volt minimum. The cord should be type SRD or SRDT and be at least 4 ft. (1.22 m) long. The wires that connect to the dryer must end in ring terminals or spade terminals with upturned ends.
- A UL Listed strain relief.

Optional Equipment (not supplied with dryer):

Refer to your Use and Care Guide for information about accessories available for your dryer.

LOCATION REQUIREMENTS

Check code requirements. Some codes limit, or do not permit, installing dryer in garages, closets, mobile homes, or sleeping quarters. Contact your local building inspector.

WARNING



Explosion Hazard

Keep flammable materials and vapors, such as gasoline, away from dryer.

Place dryer at least 18 inches (460 mm) above the floor for a garage installation.

Failure to do so can result in death, explosion, or fire.

You will need:

- A location allowing for proper exhaust installation. See "Venting Requirements."
- A separate 15 or 20 amp circuit for a gas dryer or 30 amp circuit for an electric dryer.
- If using power supply cord, a grounded electrical outlet located within 2 ft. (610 mm) of either side of dryer. See "Electrical Requirements."
- Floor must support dryer weight of 200 lbs. (90.7 kg). Also consider weight of companion appliance.
- Cold water faucets located within 4 ft. (1.2 m) of the water fill valves, and water pressure of 20-120 psi (138-827 kPa). You may use your washer's water supply by purchasing the necessary parts noted in "Parts needed."
- Level floor with maximum slope of 1" (25 mm) under entire dryer. If slope is greater than 1" (25 mm), install Extended Dryer Feet Kit, Part Number 279810. If not level, clothes may not tumble properly and automatic sensor cycles may not operate correctly.
- For garage installation, place dryer at least 18" (460 mm) above floor. If using a pedestal, you will need 18" (460 mm) to bottom of dryer.
- The dryer must not be installed or stored in an area where it will be exposed to water and/or weather.

IMPORTANT: Do not operate, install, or store dryer where it will be exposed to water, weather, or at temperatures below 40°F (4°C). Lower temperatures may cause dryer not to shut off at end of automatic sensor cycles, resulting in longer drying times.

DRYER DIMENSIONS

Front view:

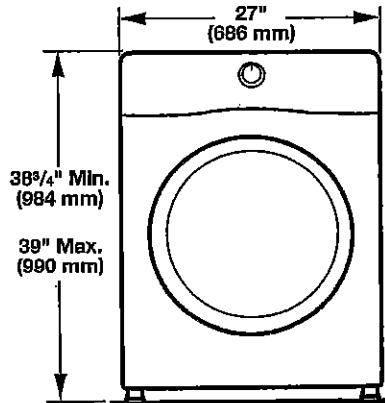

Side view:

Whirlpool Models

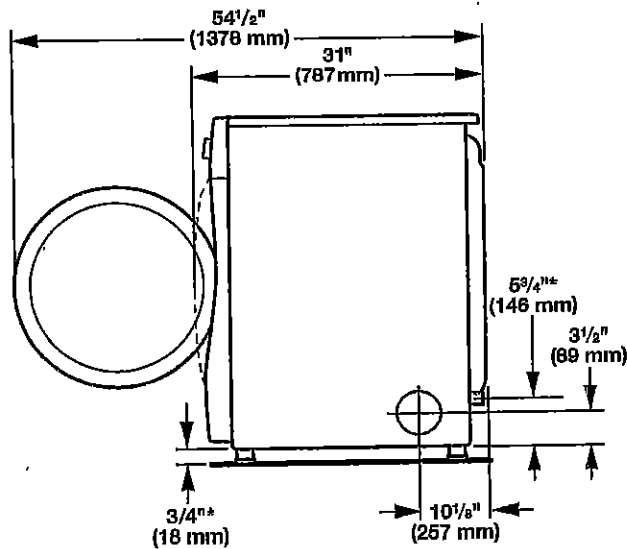

*Approx. measurement

Maytag Models

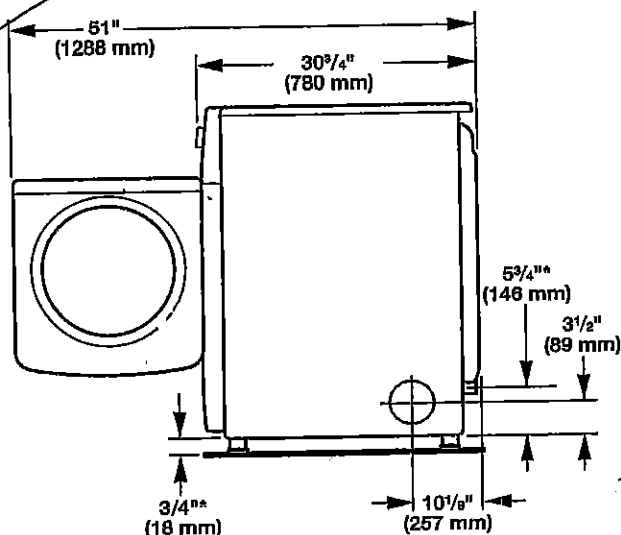

*Approx. measurement

41 of 41

41 OF 41

WHIRLPOOL DRYER Model #: YWED5620HW

Back view:

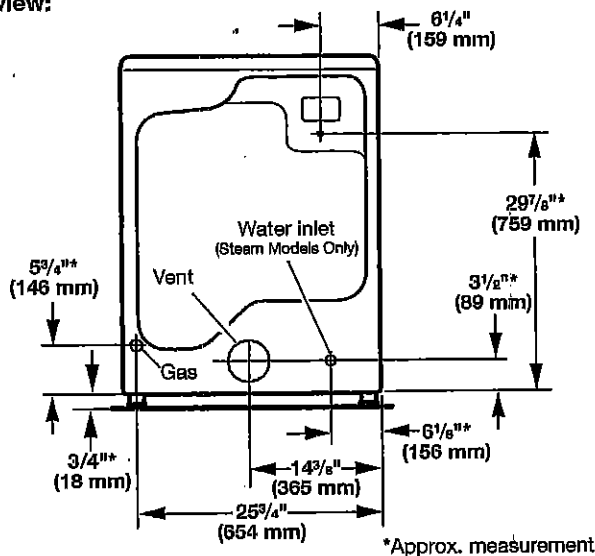

NOTE: Most installations require a minimum of 5" (127 mm) clearance behind dryer for exhaust vent with elbow. See "Venting Requirements."

Installation Clearances

For each arrangement, consider allowing more space for ease of installation and servicing, spacing for companion appliances, and clearances for walls, doors, and floor moldings. Space must be large enough to allow door to fully open. Add spacing on all sides of dryer to reduce noise transfer. If a closet door or louvered door is installed, top and bottom air openings in door are required.

Check code requirements. Some codes limit, or do not permit, installation of the dryer in garages, closets, mobile homes, or sleeping quarters. Contact your local building inspector.

NOTE: No other fuel-burning appliance can be installed in the same closet as a dryer.

Installation spacing for recessed area or closet installation

All dimensions show recommended and minimum spacing allowed.

- Additional spacing should be considered for ease of installation and servicing.
- Additional clearances might be required for wall, door, floor moldings, dryer venting, and gas line.
- Additional spacing should be considered on all sides of the dryer to reduce noise transfer.
- For closet installation with a door, minimum ventilation openings in the top and bottom of the door are required. Louvered doors with equivalent ventilation openings are acceptable.
- Companion appliance spacing should also be considered.

Recommended installation clearances (dryer only):

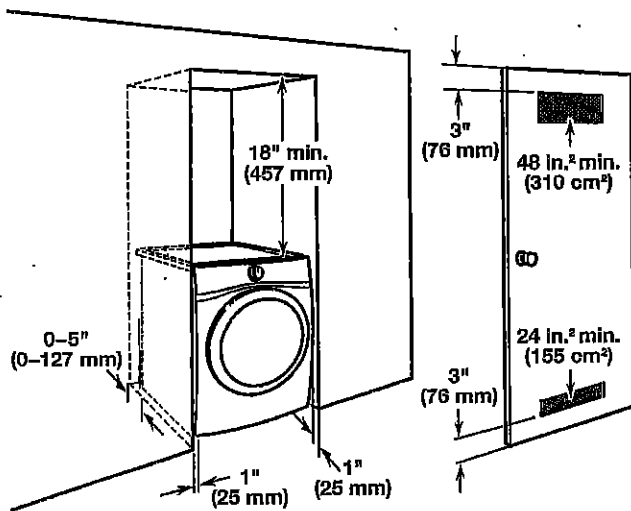

0" (0 mm) rear spacing is allowed for straight back venting only. For steam models only, inlet hose must not be kinked.

Custom under-counter installation:

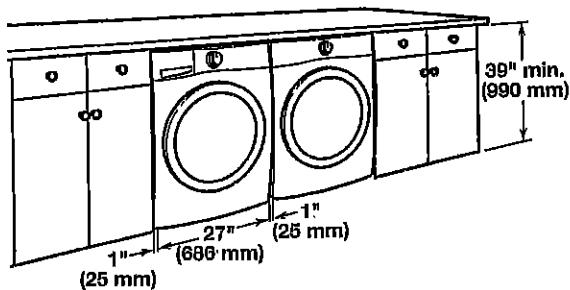

Mobile home – Additional installation requirements:

This dryer is suitable for mobile home installations. The installation must conform to the Manufactured Home Construction and Safety Standard, Title 24 CFR, Part 3280 (formerly the Federal Standard for Mobile home construction and Safety, Title 24, HUD Part 280) or Standard CAN/CSA-Z240 MH.

Mobile home installations require:

- Metal exhaust system hardware, available for purchase from your dealer. For further information, see "Assistance or Service" in your Use and Care Guide.
- Special provisions must be made in mobile homes to introduce outside air into dryer. Openings (such as a nearby window) should be at least twice as large as dryer exhaust opening.

For mobile home installation of gas dryers:

- Mobile Home Installation Hold-down Kit Part Number 346764 is available to order. For further information, see "Assistance or Service" in your Use and Care Guide.

41 OF 41