

PRE-Sales Selection Sheet
Checklist

1 of 25

LOT 206 Model: 27-2587 CRN C The Maxwell

PURCHASERS: AMANDEEP SINGH/RAJNI DEVI

VENDOR: Heathwood Homes (Huron) Limited

CONDUIT FROM ATTIC TO BASEMENT

- ☐ FINISHED BASEMENT
☐ COLD CELLAR

UPGRADED / MODIFIED ELEVATION

- ☐ CORNER UPGRADE
☐ REAR UPGRADE

CEILING UPGRADE - SMOOTH

- ☒ MAIN FLOOR
☐ SECOND FLOOR
☐ BASEMENT

ADDITIONAL ROUGH-INS

- ☒ 200 AMP SERVICE
☐ WET BAR ROUGH-IN
☐ HUMIDIFIER
☒ AIR CONDITIONING

GAS ROUGH-IN

- ☐ STOVE
☐ DRYER
☒ BBQ
☐ ADDITIONAL FIREPLACE

KITCHEN: HOODFAN VENTING SIZE

- ☒ 6 IN ROUND DUCT
☐ 7 IN ROUND DUCT

FULL BASEMENT STAIRS:

Paint Grade

UPPER BASEMENT STAIRS:

N/A

LOWER BASEMENT STAIRS:

N/A

MAIN STAIRS:

All Oak

MEDIA STAIRS (if applicable):

N/A

LOFT STAIRS (if applicable):

N/A

OCT 15/20

Date

Purchaser:

Signatures on file

OCT 15/20

Date

Decor Consultant:

BRENDA LUKER

APPROVED

-10- 15 2020

Date

Heathwood Homes (Huron) Limited

M. Rosen

Approved

Locked Date:



Sales Selection Sheet

Wallaceton
SCHEDULE E

2 of 25

PURCHASERS: AMANDEEP SINGH and RAJNI DEVI

TEL:

LOT / UNIT	PHASE	MODEL	
206	2	27-2587 CRN C The Maxwell	

It is herein understood and agreed between the undersigned parties hereto that the following changes shall be made to the above mentioned Agreement of Purchase and Sale in accordance with the agreement and except for such changes noted below, all other terms and conditions in the Agreement of Purchase and Sale shall remain as stated herein: It is further understood that and agreed that all changes and additions shall be installed as per builder's specifications, location and available selections. The Purchaser hereby agrees to purchase the following extras:

MISC.

1	SCHEDULE E- TEN THOUSAND DOLLARS (\$10,000) AT DECOR (NO CASH VALUE)- SINGLES	Qty: 1	
40,540	Note:		

Sub Total

HST

Total

1. This Sales Selection Sheet when properly executed forms part of our Agreement of Purchase and Sale.
2. All extras and upgrades listed above are subject to Construction Progress and Architectural and Municipal requirements.
3. In the event the Vendor is unable to incorporate the work approved above in the construction of the house for any reason whatsoever, the Vendor will not be liable to the Purchaser in any way. The monies paid for any changes or optional extras not proceeded with shall be returned to the Purchaser, without interest. The cost of options or extras is non-refundable in all other circumstances. If for any reason whatsoever the Agreement of Purchase and Sale is not completed, the total cost of work approved above will be retained by the Vendor.
4. The Vendor reserves the right to substitute above materials and equipment with that of equal or better quality.
5. Purchaser acknowledges that items may not be exactly as shown. Variations from the Vendor's samples may occur in finished materials due to normal production processes. Vendor is not responsible for shade difference which may occur from different dye lots or wood grains. Variations from the Vendor's samples will occur with natural materials such as wood, marble, granite, hardwood and brick.
6. The Vendor reserves the right to select Grout & Thresholds that best suits the Tile selected.
7. Selections will not be processed unless signed by Heathwood Homes Head Office.
8. The selections made on this schedule are final and cannot be changed once submitted.
9. The Purchaser has checked and acknowledges the accuracy of this schedule.

Payment Summary

Paid By Amount

Total Payment:

PURCHASER:

Signatures on
AMANDEEP SINGH

15-Oct-20

DATE

BRENDA LUKER
Decor Consultant

15-Oct-20

DATE

PURCHASER:

file
RAJNI DEVI

15-Oct-20

DATE

APPROVED

-10- 15 2020

M. Rosen
Date Approved Heathwood Homes (Huron) Limited

TAX#:1

PREPARED BY: Marilyn Rosen

PE 553-1

SInvoice.rpt 28may19

AMANDEEP SINGH/RAJNI DEVI
Project: Wallaceton
Unit: 206, Phase: 2
Model: 27-2587 CRN C The Maxwell

Created: 10/5/2020 09:24:47
Locked:
Closed:

3 of 25

Kitchen

Cabinet Colour/Style	9166	Viking III-CHARLESTON-ORCHID-3DL ***STD***
Countertop	9122	MSI Quartz GROUP 1 ICED GREY 3/4 inch with double mitre edge ***1***
Countertop Edge	4005	DOUBLE MITRE 1 1/2 INCH ***UPG*** 
Cabinet Hardware	7667	12881-HARDWARE ***STD***
Island Cabinet Colour/Style	9166	Viking III-CHARLESTON-ORCHID-3DL ***STD***
Island Countertop	9122	MSI Quartz GROUP 1 ICED GREY 3/4 inch with double mitre edge ***1***
Backsplash	1111	N/A *****
Backsplash Grout	1111	N/A *****
Backsplash Tile Pattern	1111	N/A *****
HoodFan	9117	SCB50030-CYCLONE 30 inch CANOPY CHIMNEY HOODFAN-SS Pages 24-25
Appliance	9117	Purchasers have been advised: standard fridge opening is a minimum 37 3/8 x 73 3/8". Ice Waterline Rough-In is included.
Appliance	9117	Standard stove opening is 30" and standard dishwasher opening is 24". Any gas stove will require backsplash or stainless steel backing to avoid fire hazards.
Appliance	9117	Purchasers acknowledge: Heathwood Homes and its contractors will not be responsible for any kitchen cabinet changes due to appliances dimension changes after
Flooring	8261	TR.ST.BYZ.1313-Serpentine-Beyaz/White-13x13 See Tile Line Pattern on Sketch 2 Page 17 ***STD***
Floor Tile Grout	2222	Grout-(105) Driftwood ***STD***
Floor Tile Pattern	3000	STANDARD SQUARE ***STD***

FoyeComment 0

Flooring 8261 TR.ST.BYZ.1313-Serpentine-Beyaz/White-13x13 See Tile Line Pattern on Sketch 2 Page 17 ***STD***

Handwritten signature

AMANDEEP SINGH/RAJNI DEVI
Project: Wallaceton
Unit: 206, Phase: 2
Model: 27-2587 CRN C The Maxwell

Created: 10/5/2020 09:24:47
Locked:
Closed:

4 of 25

	Line Pattern on Sketch	Page	STD
		Sketch #2	Page 17

Floor Tile Grout	2222	Grout-(105) Driftwood ***STD***
Floor Tile Pattern	3000	STANDARD SQUARE ***STD***

Comment	
---------	--

Laundry Room

Flooring	8627	TR.AD.BLK.1313-Andes-Black-13 x 13 ***STD***
Floor Tile Grout	7704	Grout-(19) Pearl Gray ***STD***
Floor Tile Pattern	3000	STANDARD SQUARE ***STD***

Comment	
---------	--

Laundry Room Opt.

Cabinet - Uppers	9156	Viking III-SIMCOE-RAIN CLOUD-3DL ***STD***
Cabinet Hardware	2093	9671-HARDWARE ***STD***
Comment		

Mud Room

Flooring	8261	TR.ST.BYZ.1313-Serpentine-Beyaz/White-13x13 See Tile Line Pattern on Sketch 2 Page 17 ***STD***
Floor Tile Grout	2222	Grout-(105) Driftwood ***STD***
Floor Tile Pattern	3000	STANDARD SQUARE ***STD***

Comment	
---------	--

Handwritten signature

AMANDEEP SINGH/RAJNI DEVI
Project: Wallaceton
Unit: 206, Phase: 2
Model: 27-2587 CRN C The Maxwell

Created: 10/5/2020 09:24:47
Locked:
Closed:

5 of 25

Powder Room

Flooring 8261 TR.ST.BYZ.1313-Serpantine-Beyaz/White-13x13 See Tile
Line Pattern on Sketch 2 Page 17 ***STD***

Floor Tile Grout 2222 Grout-(105) Driftwood ***STD***

Floor Tile Pattern 3000 STANDARD SQUARE ***STD***

Plumbing Fixture (Colour) 1737 Plumbing Fixtures-WHITE ***STD***

Comment

Dining Room

Flooring 7498 Red Oak Pearl-Vintage Engineered-IRONGATE-3/4 inch x
3 1/4 inch ***STD***

Comment

Great Room

Flooring 7498 Red Oak Pearl-Vintage Engineered-IRONGATE-3/4 inch x
3 1/4 inch ***STD***

Comment

Upper Hall

Flooring 9245 DY 87354-Dynasty Tex-OVERCAST-40 oz Poly***STD***

Comment

Study

Flooring 7498 Red Oak Pearl-Vintage Engineered-IRONGATE-3/4 inch x
3 1/4 inch ***STD***

Comment

A

AMANDEEP SINGH/RAJNI DEVI
Project: Wallaceton
Unit: 206, Phase: 2
Model: 27-2587 CRN C The Maxwell

Created: 10/5/2020 09:24:47
Locked:
Closed:

6 of 25

Opt. Finished Basement (Rec) Room/Hall

Flooring	1111	N/A *****
Comment		

Master Bedroom

Flooring	9245	DY 87354-Dynasty Tex-OVERCAST-40 oz Poly***STD***
Comment		

Bedroom 2

Flooring	9245	DY 87354-Dynasty Tex-OVERCAST-40 oz Poly***STD***
Comment		

Bedroom 3

Flooring	9245	DY 87354-Dynasty Tex-OVERCAST-40 oz Poly***STD***
Comment		

Bedroom 4

Flooring	9245	DY 87354-Dynasty Tex-OVERCAST-40 oz Poly***STD***
Comment		

Ensuite 4

Cabinet Colour/Style	9158	Viking III-SIMCOE-NAVY BLUE-3DL ***STD***
Countertop	8806	4987K-07-Countertop-LECHE VESTA-Wilsonart ***STD***

A

AMANDEEP SINGH/RAJNI DEVI
Project: Wallaceton
Unit: 206, Phase: 2
Model: 27-2587 CRN C The Maxwell

Created: 10/5/2020 09:24:47
Locked:
Closed:

7 of 25

Countertop Edge	1111	N/A *****								
Cabinet Hardware	7676	12843-HARDWARE ***STD***								
Floor Tile	5494	GE.NA.GRY.1313-New Albion-Grey-13 x 13 ***STD***								
Floor Tile Grout	2225	Grout-(27) Silver ***STD***								
Floor Tile Pattern	3000	STANDARD SQUARE ***STD***								
Plumbing Fixture (colour)	1737	Plumbing Fixtures-WHITE ***STD***								
Wall Tile	5420	QT.SP.DGR.0810-Splendour-Dark Grey-8 inch x 10 inch ***STD***								
Wall Tile Grout	2226	Grout-(00) White ***STD***								
Wall Tile Pattern	3070	HORIZONTAL STACKED ***STD*** <table><tr><td></td><td></td></tr><tr><td></td><td></td></tr><tr><td></td><td></td></tr><tr><td></td><td></td></tr></table>								
Comment										

Master Ensuite

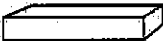
Cabinet Colour/Style	9157	Viking III-SIMCOE-MOONLIGHT-3DL ***STD***
Countertop	9069	MSI Quartz GROUP 1 ICED WHITE ***STD***
Countertop Edge	4010	GROUP 1 - SINGLE POLISHED STRAIGHT EDGE 3/4 INCH ***1*** 
Cabinet Hardware	7676	12843-HARDWARE ***STD***
Floor Tile	7676	GE.BY.AZR.1313 New Byzantine Azzuro 13
Floor Tile Grout	2225	Grout-(27) Silver ***STD***
Floor Tile Pattern	3000	STANDARD SQUARE ***STD***

myR

AMANDEEP SINGH/RAJNI DEVI
Project: Wallaceeton
Unit: 206, Phase: 2
Model: 27-2587 CRN C The Maxwell

Created: 10/5/2020 09:24:47
Locked:
Closed:

8 of 25

Shower Floor Tile	8661	OD.ON.SWT.0202.MT.N-Ontario Series Mosaic-Snow White Matte-2 x 2 ***STD***								
Shower Floor Tile Grout	2226	Grout-(00) White ***STD***								
Shower Floor Tile Pattern	3000	STANDARD SQUARE ***STD***								
Shower Wall Tile	8258	TR.ST.GRY.0810-Serpentine-Grey-8 x 10 ***STD***								
Shower Wall Tile Grout	2226	Grout-(00) White ***STD***								
Shower Wall Tile Pattern	3070	HORIZONTAL STACKED ***STD*** <table><tr><td></td><td></td></tr><tr><td></td><td></td></tr><tr><td></td><td></td></tr><tr><td></td><td></td></tr></table>								
Shower Jamb(s) and Sill(s)	8923	Shower Jamb / Sill-Thassos White ***STD***								
Plumbing Fixture (colour)	1737	Plumbing Fixtures-WHITE ***STD***								
Comment										

Shared Bathroom

Cabinet Colour/Style	9166	Viking III-CHARLESTON-ORCHID-3DL ***STD***
Countertop	8827	4925K-07-Countertop-CALCUTTA MARBLE-Wilsonart ***STD***
Countertop Edge	1111	N/A *****
Cabinet Hardware	7676	12843-HARDWARE ***STD***
Flooring	8071	GE.RF.EXP.1313-Reflex-Expresso-13 x 13 See Tile Line Pattern on Sketch 4 Page 19 ***STD***
Floor Tile Grout	2221	Grout-(47) Charcoal ***UPG***
Floor Tile Pattern	3000	STANDARD SQUARE ***STD***
Wall Tile	9020	QT.WV.WHT.0810-Weave-White-8 x 10 ***STD***

A

AMANDEEP SINGH/RAJNI DEVI
Project: Wallaceton
Unit: 206, Phase: 2
Model: 27-2587 CRN C The Maxwell

Created: 10/5/2020 09:24:47
Locked:
Closed:

9 of 25



Wall Tile Grout 2226 Grout-(00) White ***STD***

Shared Bathroom Floor Tile Pattern 3070 HORIZONTAL STACKED ***STD***

Plumbing Fixture (Colour) 1737 Plumbing Fixtures-WHITE ***STD***

Shower Floor Tile 8661 OD.ON.SWT.0202.MT.N-Ontario Series Mosaic-Snow White Matte-2 x 2 ***STD***

Shower Floor Tile Grout 2226 Grout-(00) White ***STD***

Shower Floor Tile Pattern 3000 STANDARD SQUARE ***STD***

Shower Jamb(s) 8923 Shower Jamb / Sill-Thassos White ***STD***

Comment

Opt. Finished Basement Bathroom

Shower Floor Tile Grout 1111 N/A *****

Shower Floor Tile Pattern 1111 N/A *****

Shower Wall Tile 1111 N/A *****

Shower Wall Tile Grout 1111 N/A *****

Shower Wall Tile Pattern 1111 N/A *****

Shower Jamb(s) 1111 N/A *****

Cabinet Colour/Style 1111 N/A *****

Countertop 1111 N/A *****



Handwritten signature

AMANDEEP SINGH/RAJNI DEVI
Project: Wallaceton
Unit: 206, Phase: 2
Model: 27-2587 CRN C The Maxwell

Created: 10/5/2020 09:24:47
Locked:
Closed:

10 of 25

Countertop Edge	1111	N/A *****
Cabinet Hardware	1111	N/A *****
Flooring	1111	N/A *****
Floor Tile Grout	1111	N/A *****
Floor Tile Pattern	1111	N/A *****
Plumbing Fixture (Colour)	1111	N/A *****
Comment	1	

Great Room Fireplace

Type	8869	Majestic MERC32 ***STD***
Mantle	1439	NF 17-Paint Grade Mantle-Flat Wall-WHITE ***STD*** PAGE 20
Surround Opt.	1111	N/A *****
Note	1111	Purchasers have been advised: heat from the FP can damage TV above a FP and items placed on mantle.
Note	1111	Heathwood and its contractors will not be liable for any damage on items placed/installed above a FP after closing.
Comment		

Basement Stairs

Type	1713	Paint Grade Stairs ***STD BASEMENT STAIR ***
Colour	1111	N/A *****
Carpet Runner	1111	N/A *****
Handrail/Pickets/Post Type	1111	N/A *****
Handrail/Pickets/Post Colours	1111	N/A *****
Carpet	1111	N/A *****

MP

AMANDEEP SINGH/RAJNI DEVI
Project: Wallaceston
Unit: 206, Phase: 2
Model: 27-2587 CRN C The Maxwell

Created: 10/5/2020 09:24:47

Locked:

Closed:

11 of 25

Custom Stain/Paint 1111 N/A *****

Comment 1

Main Stairs

Type 1712 Oak Stairs ***STD MAIN STAIRS***

Colour 7912 Irongate (Gryphon) STAIN TO COMPLIMENT HARDWOOD AND WILL VARY FROM FLOORING

Carpet Runner 1111 N/A *****

Handrail/Pickets/Posts Type 7652 1 5/16 inch Square pickets with 3 1/2" Square/Cap Post(s)-ALL OAK ***STD***

Handrail/Pickets/Posts Colour 1728 Oak Grade-Stain handrail,oak pickets,stringers,treads,risers

Custom Stain/Paint 1111 N/A *****

Comment

Throughout

Walls - Paint Colour 1717 22-Wall-WARM GREY ***STD***

Underpad 1079 500 Series-Underpad ***STD***

Thresholds 2232 Metal Thresholds ***STD***

Switches and Plug 5796 Decora White Switches and Plugs ***STD***

Trim Size 8705 4 1/4 Baseboard and 2 3/4 Casings ***STD***

Trim - Paint Colour 1716 Trim-WHITE ***STD***

Comment

Purchaser: AMANDEEP SINGH Date Brenda Huber Decor Consultant Oct 7/20 Date

AMANDEEP SINGH/RAJNI DEVI
Project: Wallacetan
Unit: 206, Phase: 2
Model: 27-2587 CRN C The Maxwell

Created: 10/5/2020 09:24:47
Locked:
Closed:

12 of 25

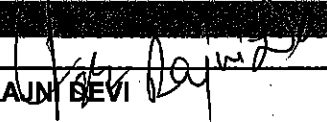
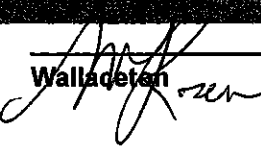
Purchaser:		Date		APPROVED Date Approved -10- 15 2020
	RAJNI DEVI		Wallacetan	



Sales Selection Sheet

Wallaceton

13 of 25

PURCHASERS: AMANDEEP SINGH and RAJNI DEVI

TEL:

LOT / UNIT 206	PHASE 2	MODEL 27-2587 CRN C The Maxwell	
-------------------	------------	------------------------------------	--

It is herein understood and agreed between the undersigned parties hereto that the following changes shall be made to the above mentioned Agreement of Purchase and Sale in accordance with the agreement and except for such changes noted below, all other terms and conditions in the Agreement of Purchase and Sale shall remain as stated herein: It is further understood that and agreed that all changes and additions shall be installed as per builder's specifications, location and available selections. The Purchaser hereby agrees to purchase the following extras:

APPLIANCES

1	CHIMNEY HOOD CYCLONE SC 500	Qty: 1
38,976	Note: SPEC PAGES 24-25	

Cabinetry

2	CABINETRY - 12B-POTS AND PANS DRAWERS (WIDTH MIN. 60CM/MAX. 90CM) (SIZE SUBJECT TO FLOOR PLAN) - UPGRADE 2	Qty: 2
189,006		
38,984	Note: EACH SIDE OF STOVE SKETCH #'S 2 AND 3 PAGES 17 AND 18	
3	CABINETRY - VIKING M/III - OPT. LAUNDRY ROOM UPPERS - STANDARD SERIES	Qty: 1
187,957		
38,993	Note: SKETCH # 4 PAGE 19	

Ceramics

4	CERAMICS - ADD WALL TILE ON TUB CEILING (15SQFT PER TUB) - STANDARD SERIES	Qty: 1
189,369		
38,991	Note: ENS. 4 SKETCH # 4 PAGE 19	
5	CERAMICS - FLOOR GROUT - SHARED ENSUITE - GROUT	Qty: 1
187,983		
38,995	Note:	

Drywall

6	DRYWALL - SMOOTH CEILING IN MAIN FLOOR	Qty: 1
188,292		
38,981	Note:	

Electrical

7	ELECTRICAL - CEILING ROUGH-IN (CAPPED)	Qty: 5
189,450	SKETCH # 2 PAGE 17	
38,982	Note: 3 X OVER ISLAND ON SEPARATE SWITCH 2 X GREAT RM USE EXISTING SWITCH PLUG	
8	ELECTRICAL - ADDITIONAL SWITCH	Qty: 1
189,451		
38,983	Note: FOR CAPPED LIGHTS OVER ISLAND SKETCH # 2 PAGE 17	
9	ELECTRICAL - RELOCATION OF SWITCHES/LIGHTS (MUST SPECIFY LOCATION) - NOTE: PLUGS CANNOT BE RELOCATED- MUST PURCHASE ADDITIONAL OUTLET.	Qty: 1
189,417	SKETCH # 2 PAGE 17	
38,986	Note: RELOCATE PHONE (CAT 5) ROUGH IN FROM KITCHEN TO SDTUDY	
10	ELECTRICAL - REINFORCE CELING BOX TO HOLD A LIGHT FIXTURE UP TO 75LBS	Qty: 3
189,420	SKETCH #'S 2 AND 4 PAGES 17 AND 19	
38,987	Note: GREAT RM, DINING RM & MASTER BDRM	

Initials:

TAX#:1

PREPARED BY: Brenda Luker

PE 535-1

Invoice.rpl 28may19



Sales Selection Sheet

Wallaceton

14 of 25

PURCHASERS: AMANDEEP SINGH and RAJNI DEVI

TEL:

LOT / UNIT 206	PHASE 2	MODEL 27-2587 CRN C The Maxwell	
-------------------	------------	------------------------------------	--

Electrical

11 189,449 38,989	ELECTRICAL - EXTRA WALL INTERIOR OUTLET ON EXISTING CIRCUIT (DOES NOT INCLUDE KITCHEN OUTLETS) <i>SKETCH # 2 PAGE 17</i> Note: GREAT ROOM OVER FIREPLACE <i>70" +/- FROM FLOOR</i>	Qty: 1
-------------------------	--	--------

Granite

12 188,300 38,980	GRANITE - COUNTERTOP - 3/4" GROUP 1 WITH MITRE EDGE - KITCHEN / ISLAND - UPGRADE 1 Note:	Qty: 1
-------------------------	---	--------

Heating/Air

13 189,472 38,985	HEATING/AIR - ROUGH-IN GAS LINE FOR BBQ AT MAIN FLOOR UP TO 40' (QUICK CONNECT NOT INCLUDED); ELECTRICAL OUTLET PRICED SEPARATELY IF REQUIRED Note: <i>SKETCH # 2 PAGE 17</i>	Qty: 1
-------------------------	--	--------

MISC.

14 38,957	Note: TEN THOUSAND (\$10,000-) IN DECOR DOLLARS	Qty: 1
--------------	---	--------

Structured Wiring

15 189,786 38,990	STRUCTURED WIRING - CONDUIT PIPE (BASEMENT TO ATTIC, CAPPED AND PULL STRING ROUGH-IN). Note:	Qty: 1
-------------------------	---	--------

Sub Total
HST
Total

- 1. This Sales Selection Sheet when properly executed forms part of our Agreement of Purchase and Sale.
- 2. All extras and upgrades listed above are subject to Construction Progress and Architectural and Municipal requirements.
- 3. In the event the Vendor is unable to incorporate the work approved above in the construction of the house for any reason whatsoever, the Vendor will not be liable to the Purchaser in any way. The monies paid for any changes or optional extras not proceeded with shall be returned to the Purchaser, without interest. The cost of options or extras is non-refundable in all other circumstances. If for any reason whatsoever the Agreement of Purchase and Sale is not completed, the total cost of work approved above will be retained by the Vendor.
- 4. The Vendor reserves the right to substitute above materials and equipment with that of equal or better quality.
- 5. Purchaser acknowledges that items may not be exactly as shown. Variations from the Vendor's samples may occur in finished materials due to normal production processes. Vendor is not responsible for shade difference which may occur from different dye lots or wood grains. Variations from the Vendor's samples will occur with natural materials such as wood, marble, granite, hardwood and brick.
- 6. The Vendor reserves the right to select Grout & Thresholds that best suits the Tile selected.
- 7. Selections will not be processed unless signed by Heathwood Homes Head Office.
- 8. The selections made on this schedule are final and cannot be changed once submitted.
- 9. The Purchaser has checked and acknowledges the accuracy of this schedule.

Initials:



Sales Selection Sheet
Wallaceton





15 of 25

PURCHASERS: AMANDEEP SINGH and RAJNI DEVI

TEL:

LOT / UNIT 206	PHASE 2	MODEL 27-2587 CRN C The Maxwell	
-------------------	------------	------------------------------------	--

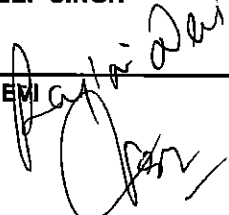
Payment Summary	
<u>Paid By</u>	<u>Amount</u>
<u>Total Payment:</u>	

PURCHASER:		07-Oct-20		07-Oct-20
	AMANDEEP SINGH	DATE	Decor Consultant	DATE
PURCHASER:		07-Oct-20	APPROVED	
	RAJNI DEVI	DATE	10-15-2020 Date Approved	Heathwood Homes (Huron) Limited

UK-75 WALLACETON
LOT 206
27-2787 C-CRN
THE MAXWELL

16 of 25

THE MAXWELL

ELEVATION C | 2,600 SQ. FT.

735 sq. ft. of opt. finished Lower Level

27-2587 CRN ELEV. C

Sketch #1

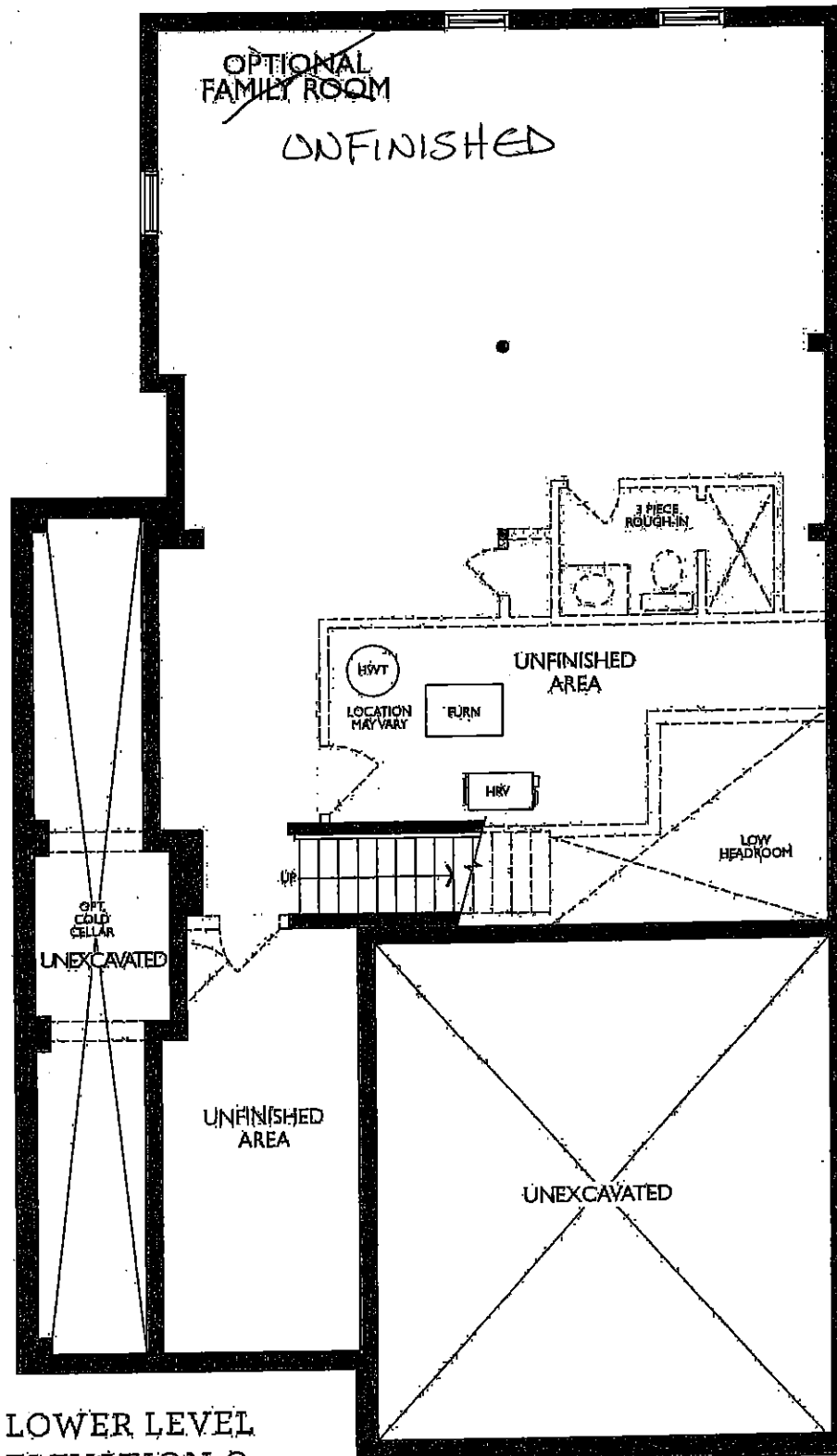

LOWER LEVEL
ELEVATION C

UK-75 WALLACETON
LOT 206
27-2587 C-CRN
THE MAXWELL

17 of 25

THE MAXWELL

ELEVATION C | 2,600 SQ. FT.

795 sq. ft. of opt. finished Lower Level

27-2587 CRN ELEV. C

Sketch #2

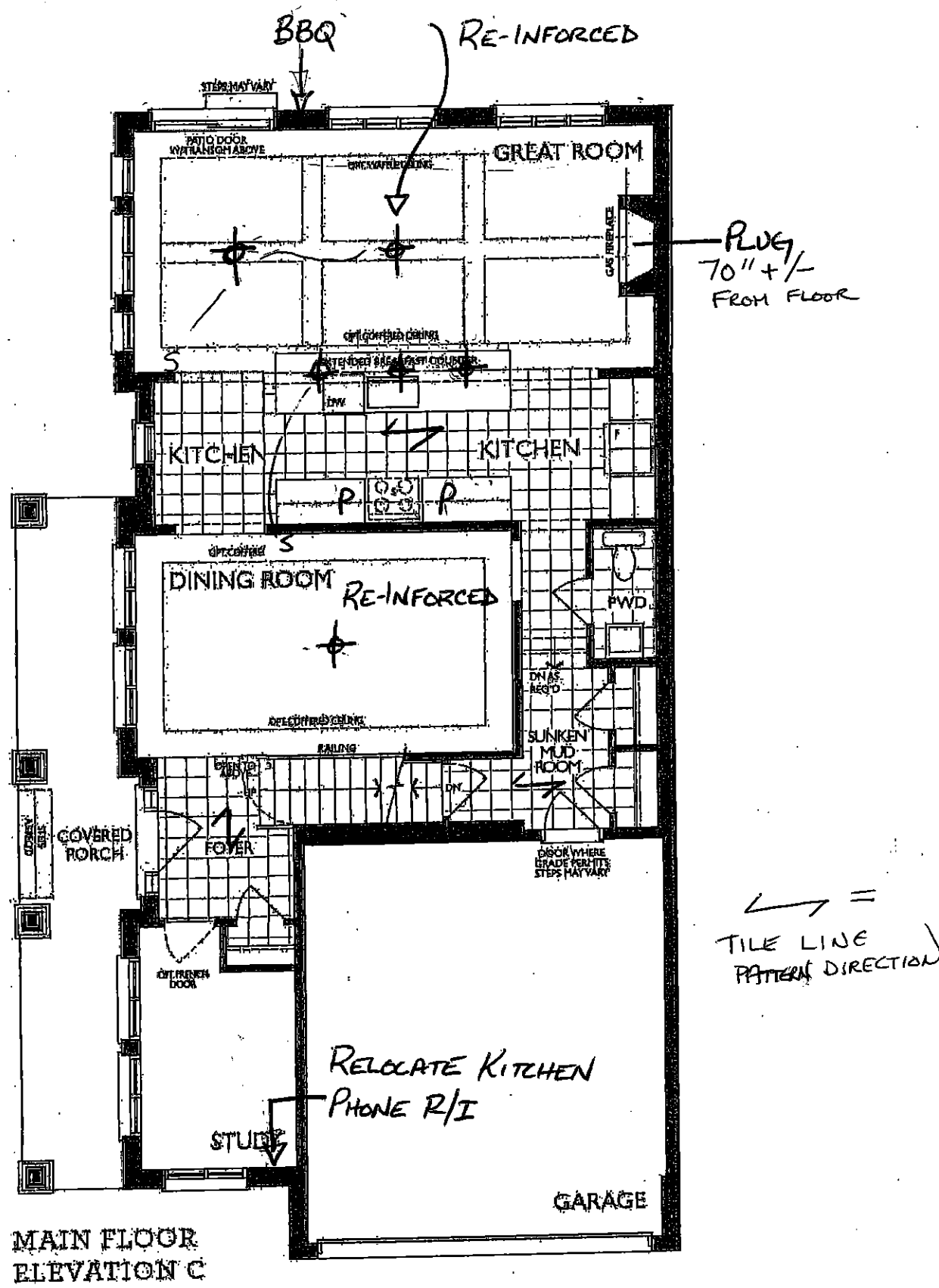

MAIN FLOOR
ELEVATION C

UK-75 WALLACETON
 LOT 206
 27-2587 'C' CRN
 THE MAXWELL



HEATHW
WALLACETON
MODEL: 27-2

Sketch # 3

STANDARD CONTR

Appliance Opening

- Hood Opening:
- Fridge Opening
- Fridge cabinet
- Stove Opening:
- Dishwasher Op

Standard Kitchens

- 100cm H wall cc
- Std. Blumotion Hinges- soft close doors
- Std. Metabox Drawers- not soft close
- Min 40cm W drawer
- Base pie cut corner cabinets
- Backing on all cabinets
- Countertop by others
- Upgrade applied paneled fridge & dishwashers supply only (appliance hardware by others)

Standard Vanity & Laundry Scope:

- Powder by others, pedestal
- Master Ens. - Top by others
- Remaining vanities inc. laminate top
- Std. Blumotion Hinges- not soft close
- Std. Metabox Drawers- not soft close
- Master Ens: Top drawers (Sink Full height)
- Mains: Full height doors (top drawers added if Masters can't accommodate)
- Optional laundry base & wall cabinets

THIS DRAWING IS FOR DESIGN PURPOSES ONLY.
 IT IS NOT AN EXACT REPRESENTATION.

OPT. BASEMENT BATH

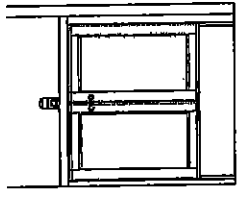

OPT. LAUNDRY UPPERS
 OPT. LAUNDRY BASE
 (2ND FLR)

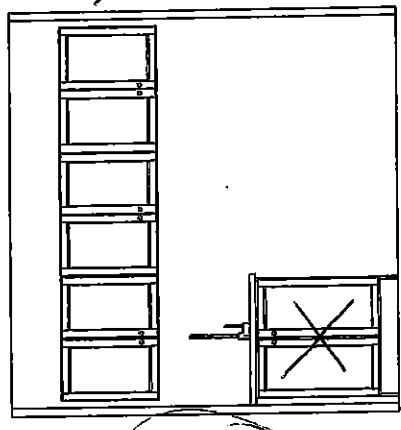

SHARED BATH A (2ND FLR - ELEV. A) OR ALT. SHARED BATH B (2ND FLR - ELEV. B) OR ALT. SHARED BATH C & D (2ND FLR - ELEV. C)

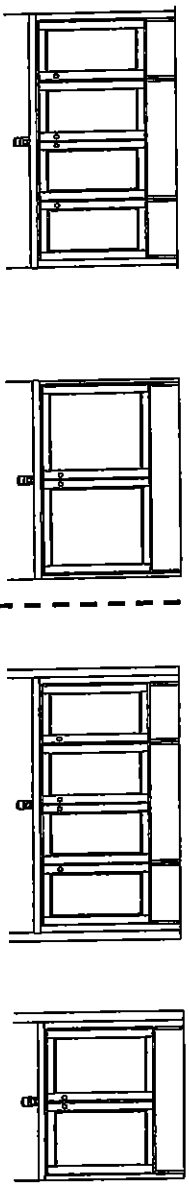

BED 4 BATH (2ND FLR)

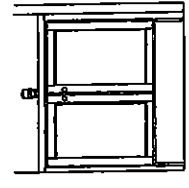

MASTER ENSUITE (2ND FLR)

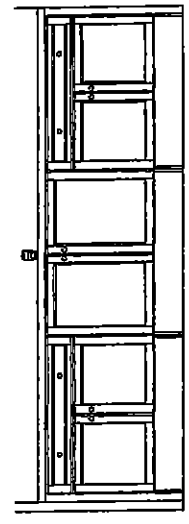

(OPT. DBL SINK V90+VT90+V90)

KITCHEN

(GROUND FLOOR)

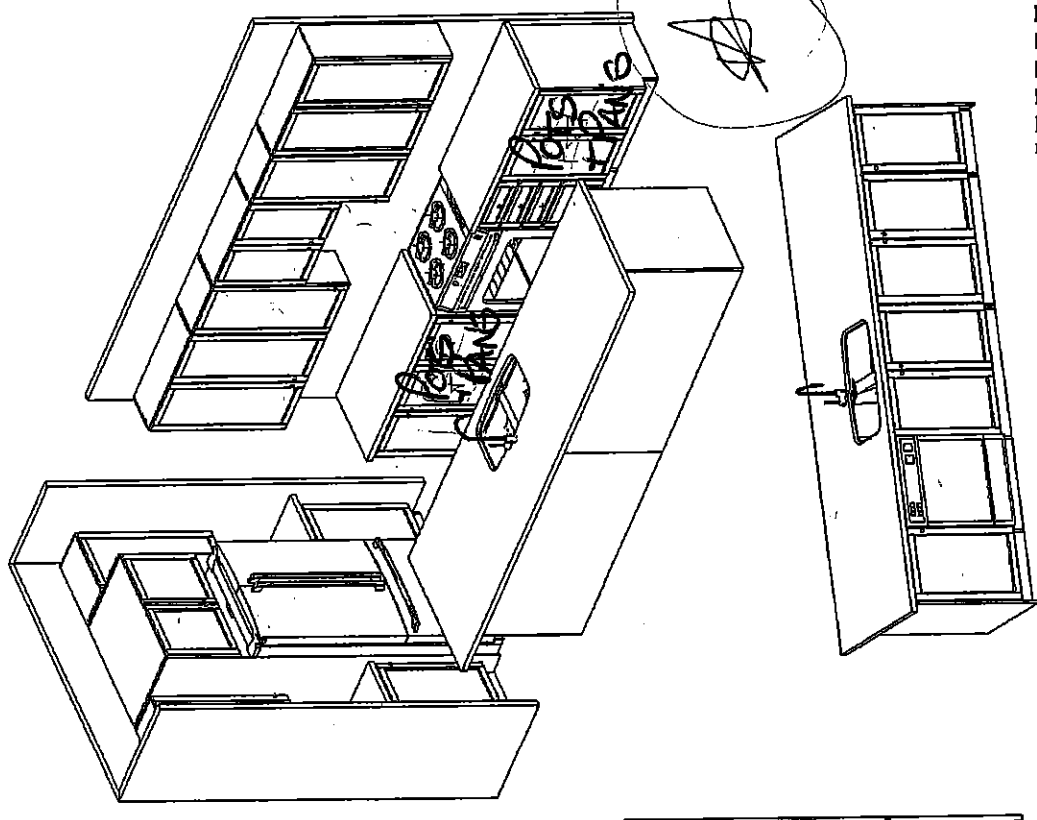
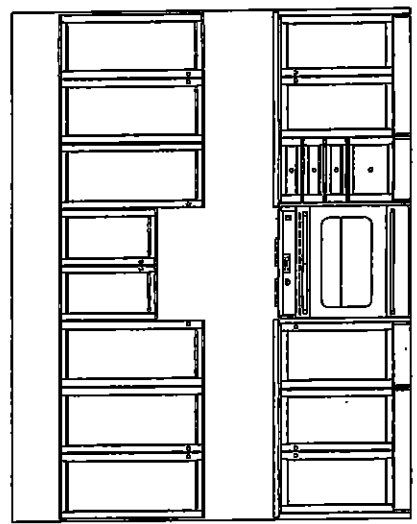
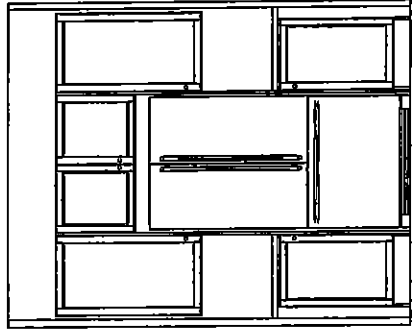

UK-75 WALLACETON
LOT 206
27-2587 'C' CRN
THE MAXWELL

19 of 25

THE MAXWELL

ELEVATION C | 2,600 SQ. FT.

736 sq. ft. of opt. finished Lower Level

27-2587 CRN ELEV. C

Sketch #4

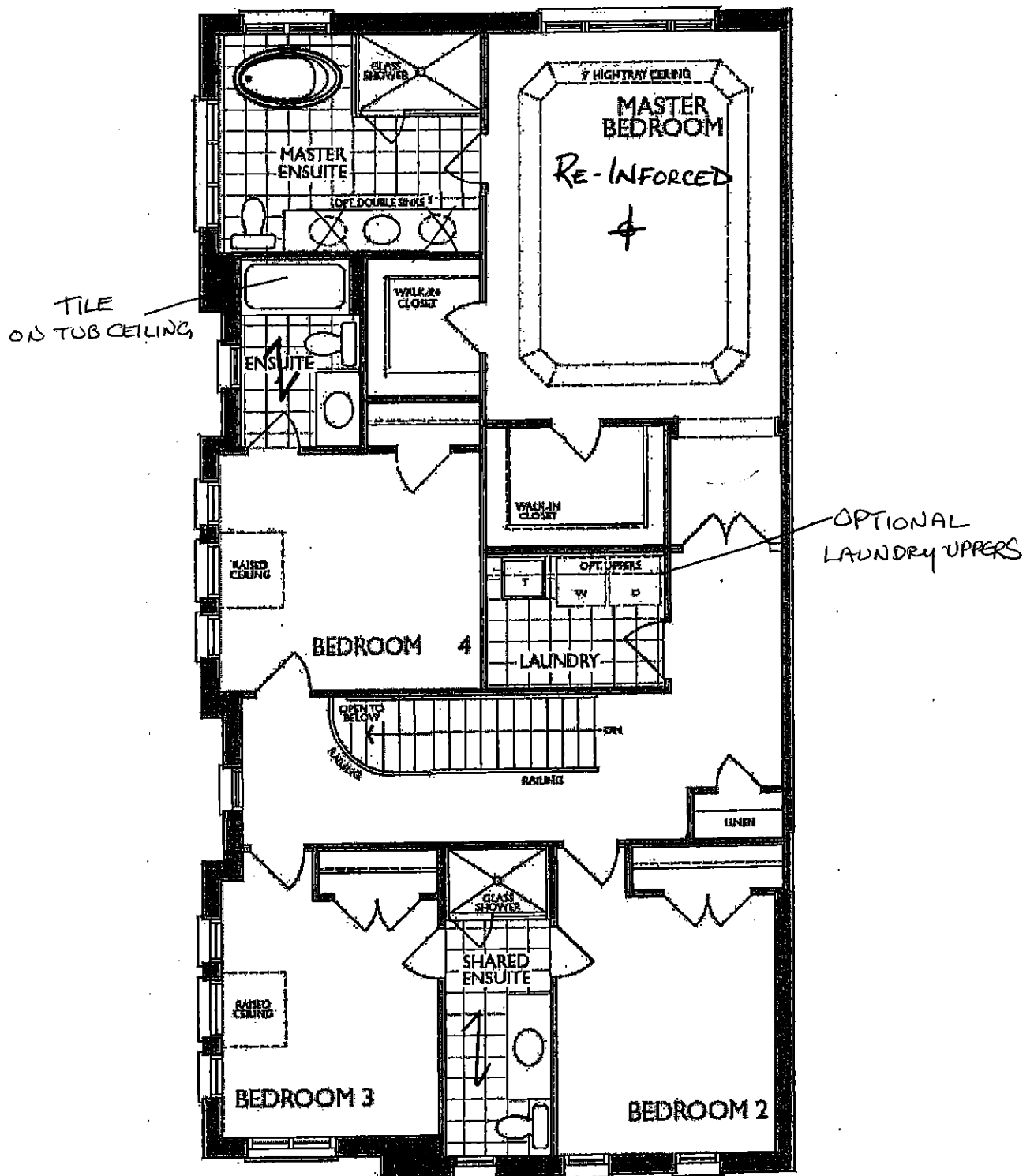

SECOND FLOOR
ELEVATION C

July 14, 2020

20 of 25

UK-75 WALLACETON
LOT 206
27-2787 C CRN
THE MAXWELL

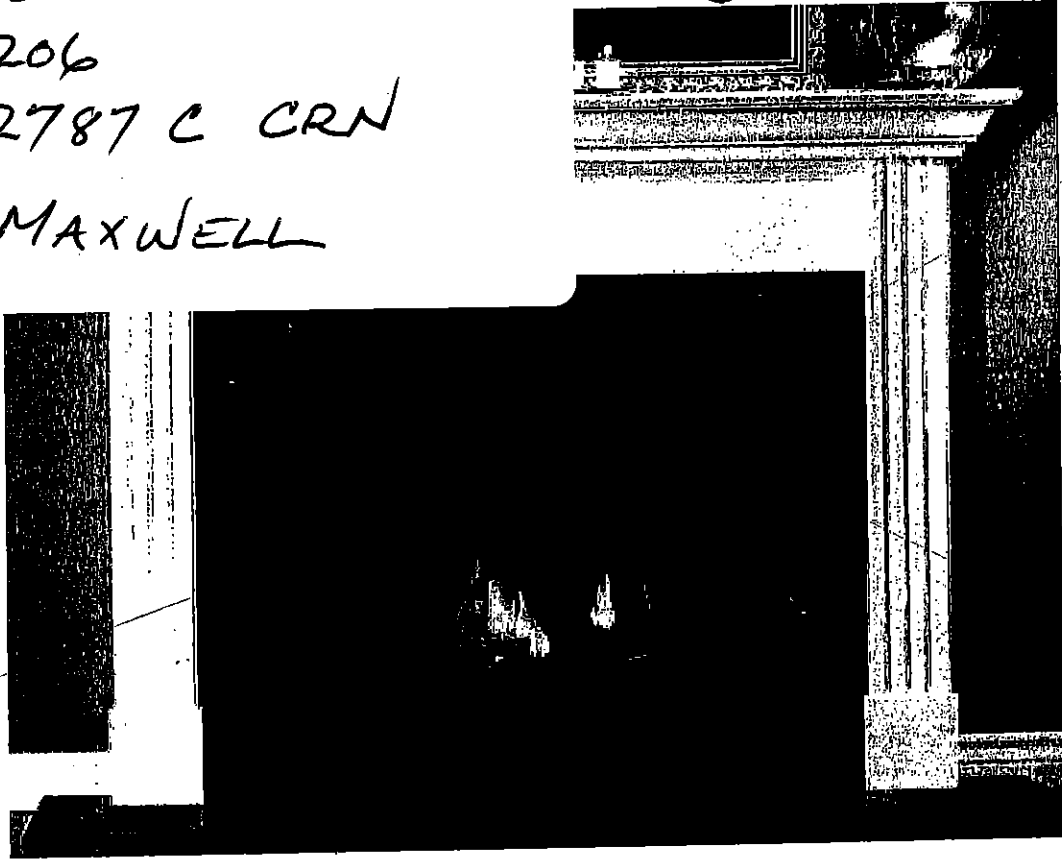

STANDARD NF 15 Mantel

Clean apron finish with fluted legs

WHITE PAINT GRADE FINISH

(PICTURE SHOWN WITH UPGRADE SURROUND AND HEARTH -PRICED SEPARATELY)



STANDARD NF 17 Mantel

WHITE PAINT GRADE FINISH

(PICTURE SHOWN WITH UPGRADE SURROUND AND HEARTH -PRICED SEPARATELY)

JK-75 WALLACETON
 LOT 206
 27-2787 - C - CRN

21 of 25

THE MAXWELL

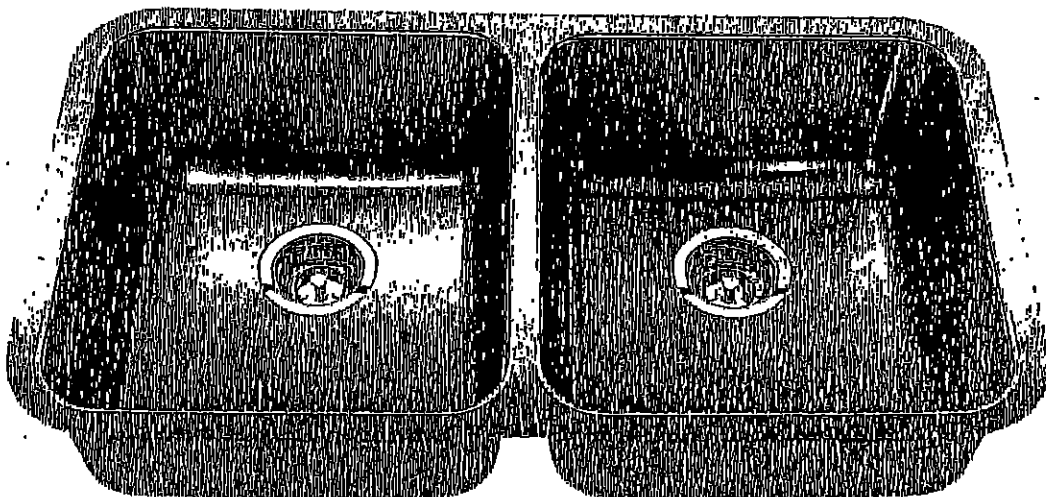

Optional Accessories



BG105



BG105



MB100



CATW



DBR105

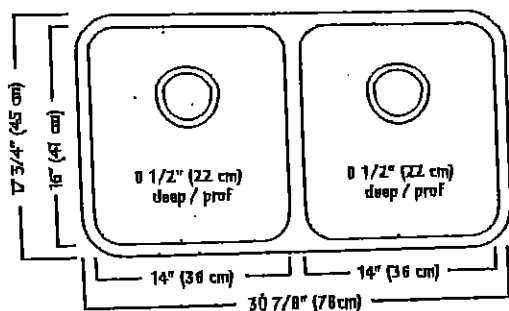

ND1831UA/9 SPECIFICATION

Model ND1831UA/9 is a double (two equal size) bowl undermount sink manufactured by Franke Kindred Canada Limited from 18 gauge stainless steel. Product has silk finished rims and linear brush finished bowls. Sink is fully undercoated. Basket strainer waste fittings (3 1/2", 89 mm) are included. Sink is backed with a limited lifetime warranty.

- O.D. 17 3/4" x 30 7/8" x 8 1/2" (45 x 78 x 22 cm)
- Recommended for minimum 36" cabinet

Franke Kindred Canada Limited
 P.O. Box 190, 1000 Franke Kindred Road, Midland, Ontario, Canada, L4R 4K9 Phone: 866-687-7465 Fax: 800-361-8408

Franke Kindred Canada Limited

Printed in Canada

117

K.Y

UK-75 WALLACETON
LOT 206
27-2787 'C' - CRN
THE MAXWELL

22 of 25

STANDARD KITCHEN FAUCET

Align

Modern

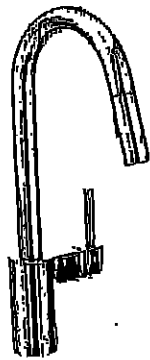

Single Handle Pull-Down Kitchen
Faucet*

Model 7565+

Key

UK-75 WALLACETON
LOT 206
27-2787 C - CRN
THE MAXWELL

23 of 25

Chateau

Transitional

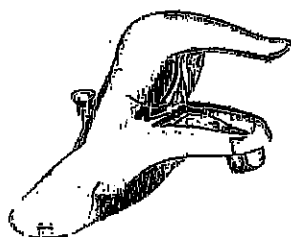

Lavatory Faucet with Pop-Up Drain
Model L4621†

VANITY SINKS AND PEDESTAL

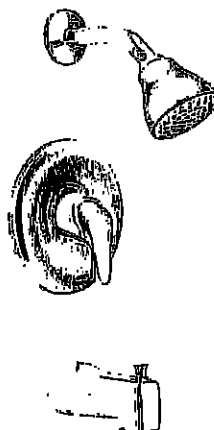

Posi-Temp® Pressure Balancing Tub/Shower
Model 62320 / TL183†

OR

Posi-Temp Valve and Tub/Shower Trim
with Eco-Performance Easy Clean® XL
Model 62320 / TL183EP†
(TL183EP not available in BC)

SHOWER AND 5' TUB FAUCETS



2 Handle Roman Tub with 9" Spout
Model 4796 / T990†

FREESTANDING TUB FAUCETS

UK-75 WALLACETON
LOT 206
27-2787 C-CRN
THE MAXWELL

24 of 25

SC(B)500 | ALITO Collection

Cyclone®
Breathe Better

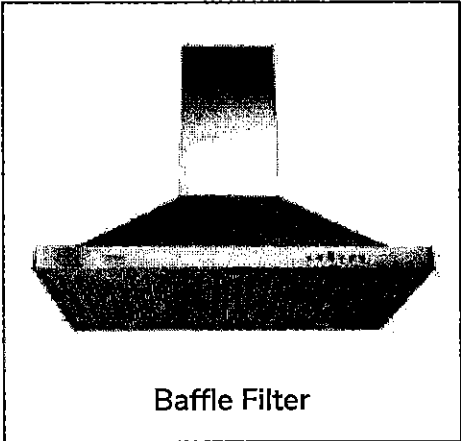

Wall Mount

Strong and sturdy with attractive lines and an imposing frame, the SC(B)500 is fitted with time-delay OFF feature up to nine minutes, 550 CFM fan, bright LED lights and a digital three-speed push button control panel.

Green Features



3 Speed Push Button
Control Panel



Dishwasher
Safe Filters



Long-Lasting
LED Light



Time-Delay
OFF Feature



Model	Colour	Ducting	Filters	Size	CFM
SC50024	Stainless Steel	6"	Mesh	24"	550
SC50030	Stainless Steel	6"	Mesh	30"	550
SC50036	Stainless Steel	6"	Mesh	36"	550
SCB50024	Stainless Steel	6"	Baffle	24"	550
SCB50030	Stainless Steel	6"	Baffle	30"	550
SCB50036	Stainless Steel	6"	Baffle	36"	550

Cyclone Range Hoods Inc.

1361 Huntingwood Drive, Unit 16, Toronto, ON, M1S 3J1, Canada

Toll Free: 1-888-293-5662 Tel: (416) 293-0933 Fax: (416) 293-4793 Website: www.CycloneRangeHoods.com

UK-75 WALLACETON
LOT 206
27-2787 - 'C' - CRN
THE MAXWELL

25 of 25

SC(B)500 | ALITO Collection

1225
Cyclone[®]
Breathe Better

Features

- Wall mount range hood
- 6" round duct adapter
- Non-stick aluminum fan blades
- 3 speed push button control
- 2 LED lights (2 x 1.4W)
- Dishwasher-safe mesh or baffle filters
- Standard chimney fits up to 9 ft. ceiling
- Up to 9 minute time-delay OFF feature
- Plug-in connection

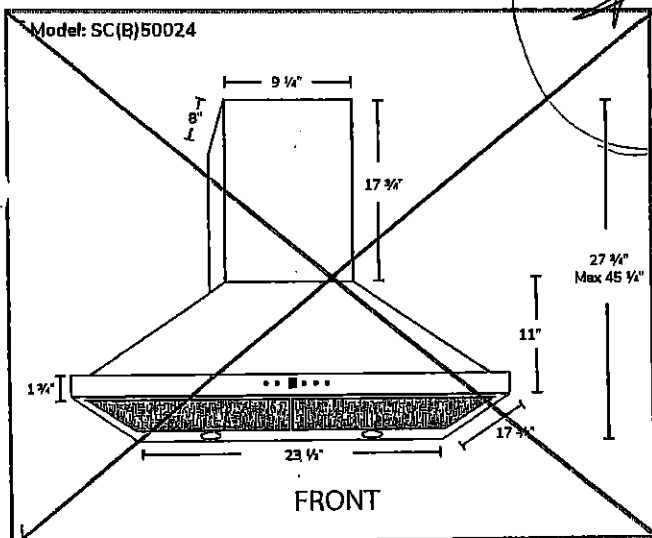
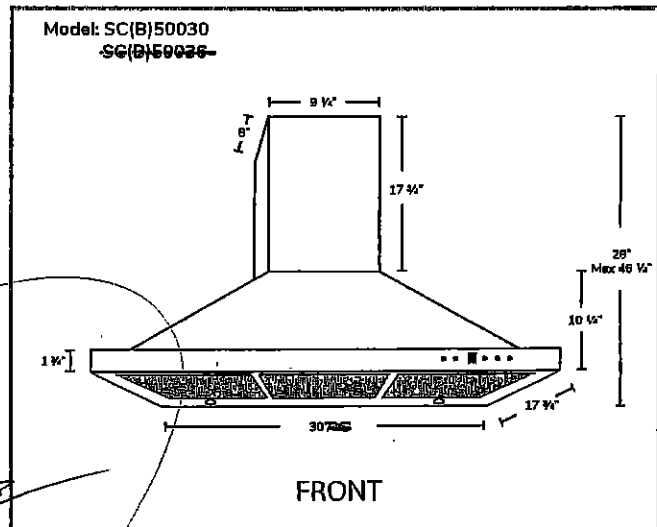

Options

- Filters: SC500 - Quick Release Aluminum Mesh Filters
SCB500 - Quick Release Stainless Steel Baffle Filters
- Available Chimney Flues:
Short (7 ft. - 8 ft. A1.CH10)
Standard (8 ft. - 9 ft. A1.CH18)
Extended (9 ft. - 11 ft. A1.CH30)
- Widths: 24", **30"**, 36"

Specifications

- Air Flow Volume: 550 CFM
- Electrical Connection: 120V/60Hz
- Power Consumption: 210 Watts
- Current: 2.5 Amps
- Fan Speed: 1600RPM
- Fan Type: Centrifugal Blower

- Finishes: Stainless Steel
- Ducting: 6" Round
- Dimensions: Width: 24", **30"**, 36"
Height: 46"
Depth: 18"

- Noise Level: Min. 2 Sones
Max. 6 Sones



Toronto | Vancouver | Boston
www.CycloneRangeHoods.com