

PRE-Sales Selection Sheet
Checklist

1 of 21

LOT 284C-13 Model: 20-1456 A The Hampton

PURCHASERS: SANDEEP, KAUR SANDHU/JASVINDER SINGH SANDHU

VENDOR: Heathwood Homes (Huron) Limited

- ☒ FINISHED BASEMENT
☐ COLD CELLAR

UPGRADED / MODIFIED ELEVATION

- ☐ CORNER UPGRADE
☐ REAR UPGRADE

CEILING UPGRADE - SMOOTH

- ☐ MAIN FLOOR
☐ SECOND FLOOR
☐ BASEMENT

ADDITIONAL ROUGH-INS

- ☐ 200 AMP SERVICE
☐ WET BAR ROUGH-IN
☐ HUMIDIFIER
☒ AIR CONDITIONING

GAS ROUGH-IN

- ☐ STOVE
☐ DRYER
☐ BBQ
☐ ADDITIONAL FIREPLACE

KITCHEN: HOODFAN VENTING SIZE

- ☐ 6 IN ROUND DUCT
☒ 7 IN ROUND DUCT

FULL BASEMENT STAIRS:	N/A
UPPER BASEMENT STAIRS:	All Oak
LOWER BASEMENT STAIRS:	Carpet Grade
MAIN STAIRS:	All Oak
MEDIA STAIRS (if applicable):	N/A
LOFT STAIRS (if applicable):	N/A

OCT. 19/20 *Signatures*
Date Purchaser:
on file

OCT 19/20 BRENDA LUKER
Date Decor Consultant:

Date Purchaser:

APPROVED
-10- 26 2020 *M. Rosen*
Date Heathwood Homes (Huron) Limited
Approved

Locked Date:



Sales Selection Sheet

Wallaceton

2 of 21

PURCHASERS: SANDEEP, KAUR SANDHU and JASVINDER SINGH SANDHU

TEL:

LOT / UNIT	PHASE	MODEL	
284C-13	2	20-1456 A The Hampton	

It is herein understood and agreed between the undersigned parties hereto that the following changes shall be made to the above mentioned Agreement of Purchase and Sale in accordance with the agreement and except for such changes noted below, all other terms and conditions in the Agreement of Purchase and Sale shall remain as stated herein: It is further understood that and agreed that all changes and additions shall be installed as per builder's specifications, location and available selections. The Purchaser hereby agrees to purchase the following extras:

MISC.

1	SCHEDULE E- FIVE THOUSAND DOLLARS (\$5,000) AT DECOR (NO CASH VALUE) Changed from Appliance Package s per Revised Schedule E by Amendment dated October 19/20	Qty: 1	
43,195	Note:		

Sub Total

HST

Total

1. This Sales Selection Sheet when properly executed forms part of our Agreement of Purchase and Sale.
2. All extras and upgrades listed above are subject to Construction Progress and Architectural and Municipal requirements.
3. In the event the Vendor is unable to incorporate the work approved above in the construction of the house for any reason whatsoever, the Vendor will not be liable to the Purchaser in any way. The monies paid for any changes or optional extras not proceeded with shall be returned to the Purchaser, without interest. The cost of options or extras is non-refundable in all other circumstances. If for any reason whatsoever the Agreement of Purchase and Sale is not completed, the total cost of work approved above will be retained by the Vendor.
4. The Vendor reserves the right to substitute above materials and equipment with that of equal or better quality.
5. Purchaser acknowledges that items may not be exactly as shown. Variations from the Vendor's samples may occur in finished materials due to normal production processes. Vendor is not responsible for shade difference which may occur from different dye lots or wood grains. Variations from the Vendor's samples will occur with natural materials such as wood, marble, granite, hardwood and brick.
6. The Vendor reserves the right to select Grout & Thresholds that best suits the Tile selected.
7. Selections will not be processed unless signed by Heathwood Homes Head Office.
8. The selections made on this schedule are final and cannot be changed once submitted.
9. The Purchaser has checked and acknowledges the accuracy of this schedule.

Payment Summary

<u>Paid By</u>	<u>Amount</u>
----------------	---------------

Total Payment:

PURCHASER:

Signature on file
SANDEEP KAUR SANDHU

26-Oct-20
DATE

BRENDA LUKER
Decor Consultant

26-Oct-20
DATE

PURCHASER:

JASVINDER SINGH SANDHU

26-Oct-20
DATE

APPROVED

-10- 26 2020

Date Approved Heathwood Homes (Huron) Limited

TAX#:1

PREPARED BY: Marilyn Rosen

PE 581-1

SlInvoice.rpt 26may19

SANDEEP, KAUR SANDHU/JASVINDER SINGH SANDHU
Project: Wallaceton
Unit: 284C-13, Phase: 2
Model: 20-1456 A The Hampton

Created: 10/19/2020 08:04:27
Locked:
Closed:

3 of 21

Kitchen

Cabinet Colour/Style	9111	VIKING III SIMCOE ORCHID 3DL ***STD***
Countertop	9121	MSI Quartz GROUP 1 ICED WHITE 3/4 inch with double mitre edge ***1***
Countertop Edge	4005	DOUBLE MITRE 1 1/2 INCH ***UPG*** 
Cabinet Hardware	7667	12881-HARDWARE ***STD***
Island Cabinet Colour/Style	9111	VIKING III SIMCOE ORCHID 3DL ***STD***
Island Countertop	9121	MSI Quartz GROUP 1 ICED WHITE 3/4 inch with double mitre edge ***1***
Backsplash	1111	N/A *****
Backsplash Grout	1111	N/A *****
Backsplash Tile Pattern	1111	N/A *****
HoodFan	34	AV1308 Air King 30 PAGE 21
Appliance	9117	Purchasers have been advised: standard fridge opening is a minimum 37 3/8 x 73 3/8". Ice Waterline Rough-In is included.
Appliance	9117	Standard stove opening is 30" and standard dishwasher opening is 24". Any gas stove will require backsplash or stainless steel backing to avoid fire hazards.
Appliance	9117	Purchasers acknowledge: Heathwood Homes and its contractors will not be responsible for any kitchen cabinet changes due to appliances dimension changes after
Comment		

Kitchen/Breakfast

Flooring	8913	UN.BL.BIA.1224-Biel-Bianco (White)-12 x 24 See Tile Direction on Sketch 2 Page 15 ***2***
Floor Tile Grout	7705	Grout-(01) Alabaster ***UPG***
Floor Tile Pattern	3040	FRONT TO BACK ***STD***

SANDEEP, KAUR SANDHU/JASVINDER SINGH SANDHU
Project: Wallaceton
Unit: 284C-13, Phase: 2
Model: 20-1456 A The Hampton

Created: 10/19/2020 08:04:27
Locked:
Closed:

4 of 21

Comment

Hall

Flooring

7498

Red Oak Pearl-Vintage Engineered-IRONGATE-3/4 inch x 3 1/4 inch ***STD***

Comment

Foyer

Flooring

5494

GE.NA.GRY.1313-New Albion-Grey-13 x 13 ***STD***

Floor Tile Grout

2225

Grout-(27) Silver ***STD***

Floor Tile Pattern

3000

STANDARD SQUARE ***STD***

Comment

Mud Room

Flooring

5494

GE.NA.GRY.1313-New Albion-Grey-13 x 13 ***STD***

Floor Tile Grout

2225

Grout-(27) Silver ***STD***

Floor Tile Pattern

3000

STANDARD SQUARE ***STD***

Comment

Powder Room

Flooring

8913

UN.BL.BIA.1224-Biel-Bianco (White)-12 x 24 See Tile Direction on Sketch 2 Page 15 ***2***

Floor Tile Grout

7705

Grout (01) Alabaster ***LPG***

SANDEEP, KAUR SANDHU/JASVINDER SINGH SANDHU
Project: Wallaceton
Unit: 284C-13, Phase: 2
Model: 20-1456 A The Hampton

Created: 10/19/2020 08:04:27
Locked:
Closed:

5 of 21

Floor Tile Grout 7705 Grout (6.1) Arabaster OFB

Floor Tile Pattern 3050 SIDE TO SIDE ***STD***

Plumbing Fixture (Colour) 1737 Plumbing Fixtures-WHITE ***STD***

Comment

Great Room

Flooring 7498 Red Oak Pearl-Vintage Engineered-IRONGATE-3/4 inch x 3 1/4 inch ***STD***

Comment

Upper Hall

Flooring 9245 DY 87354-Dynasty Tex-OVERCAST-40 oz Poly***STD***

Comment

Finished Basement (Rec) Room/Hall

Flooring 9245 DY 87354-Dynasty Tex-OVERCAST-40 oz Poly***STD***

Comment

Master Bedroom

Flooring 9245 DY 87354-Dynasty Tex-OVERCAST-40 oz Poly***STD***

Comment

Bedroom 2

Flooring 9245 DY 87354-Dynasty Tex-OVERCAST-40 oz Poly***STD***

20

SANDEEP, KAUR SANDHU/JASVINDER SINGH SANDHU
Project: Wallaceton
Unit: 284C-13, Phase: 2
Model: 20-1456 A The Hampton

Created: 10/19/2020 08:04:27
Locked:
Closed:

6 of 21

Comment	
---------	--

Bedroom 3

Flooring	9245	DY 87354-Dynasty Tex-OVERCAST-40 oz Poly***STD***
----------	------	---

Comment	
---------	--

Master Ensuite

Cabinet Colour/Style	9111	VIKING III SIMCOE ORCHID 3DL ***STD***
----------------------	------	--

Countertop	8822	4924-38-Countertop-WHITE CARRARA-Wilsonart ***STD***
------------	------	--

Countertop Edge	1111	N/A *****
-----------------	------	-----------

Cabinet Hardware	7672	135-HARDWARE ***STD***
------------------	------	------------------------

Floor Tile	8913	UN.BL.BIA.1224-Biel-Bianco (White)-12 x 24 See Tile Direction on Sketch 3 Page 16 ***2***
------------	------	---

Floor Tile Grout	7705	Grout-(01) Alabaster ***UPG***
------------------	------	--------------------------------

Floor Tile Pattern	3040	FRONT TO BACK ***STD***
--------------------	------	-------------------------

Shower Floor Tile	8661	OD.ON.SWT.0202.MT.N-Ontario Series Mosaic-Snow White Matte-2 x 2 ***STD***
-------------------	------	--

Shower Floor Tile Grout	2226	Grout-(00) White ***STD***
-------------------------	------	----------------------------

Shower Floor Tile Pattern	3000	STANDARD SQUARE ***STD***
---------------------------	------	---------------------------

Shower Wall Tile	9020	QT.WV.WHT.0810-Weave-White-8 x 10 ***STD***
------------------	------	---

Shower Wall Tile Grout	2226	Grout-(00) White ***STD***
------------------------	------	----------------------------

Shower Wall Tile Pattern	3090	VERTICAL STACKED ***STD***								
		<table><tr><td></td><td></td><td></td><td></td></tr><tr><td></td><td></td><td></td><td></td></tr></table>								

Handwritten signature

SANDEEP, KAUR SANDHU/JASVINDER SINGH SANDHU
Project: Wallaceton
Unit: 284C-13, Phase: 2
Model: 20-1456 A The Hampton

Created: 10/19/2020 08:04:27
Locked:
Closed:

7 of 21



--	--	--	--

Shower Jamb(s) and Sill(s) 8923 Shower Jamb / Sill-Thassos White ***STD***

Plumbing Fixture (colour) 1737 Plumbing Fixtures-WHITE ***STD***

Comment

Main Bathroom

Cabinet Colour/Style 9156 Viking III-SIMCOE-RAIN CLOUD-3DL ***STD***

Countertop 8827 4925K-07-Countertop-CALCUTTA MARBLE-Wilsonart ***STD***

Countertop Edge 1111 N/A *****

Cabinet Hardware 7672 135-HARDWARE ***STD***

Flooring 7672 GE.MD.WHT.1224.MT Madison Series White Matte 12
TILE INSTALL DIRECTION SKETCH #3 PAGE 16

Floor Tile Grout 2225 Grout-(27) Silver ***STD***

Floor Tile Pattern 3050 SIDE TO SIDE ***STD***

Tub Wall Tile 5420 QT.SP.DGR.0810-Splendour-Dark Grey-8 inch x 10 inch ***STD***

Tub Wall Tile Grout 2226 Grout-(00) White ***STD***

Tub Wall Tile Pattern 3090 VERTICAL STACKED ***STD***

Plumbing Fixture (Colour) 1737 Plumbing Fixtures-WHITE ***STD***

Comment

Finished Basement Bathroom

Cabinet Colour/Style 9156 Viking III-SIMCOE-RAIN CLOUD-3DL ***STD***

Countertop 8827 4925K-07-Countertop-CALCUTTA MARBLE-Wilsonart

Handwritten signature or initials.

SANDEEP, KAUR SANDHU/JASVINDER SINGH SANDHU
Project: Wallaceton
Unit: 284C-13, Phase: 2
Model: 20-1456 A The Hampton

Created: 10/19/2020 08:04:27
Locked:
Closed:

8 of 21

		STD
Countertop Edge	1111	N/A *****
Cabinet Hardware	7672	135-HARDWARE ***STD***
Flooring	7672	GE.BY.AZR.1313 New Byzantine Azzuro 13
Floor Tile Grout	2225	Grout-(27) Silver ***STD***
Floor Tile Pattern	3000	STANDARD SQUARE ***STD***
Shower Floor Tile	8661	OD.ON.SWT.0202.MT.N-Ontario Series Mosaic-Snow White Matte-2 x 2 ***STD***
Shower Floor Tile Grout	2226	Grout-(00) White ***STD***
Shower Floor Tile Pattern	3000	STANDARD SQUARE ***STD***
Shower Wall Tile	5411	QT.SP.WHT.0810-Splendour-White-8 inch x 10 inch ***STD***
Shower Wall Tile Grout	2226	Grout-(00) White ***STD***
Shower Wall Tile Pattern	3090	VERTICAL STACKED ***STD*** <div><div></div><div></div><div></div><div></div><div></div><div></div><div></div><div></div></div>
Shower Jamb(s)	8923	Shower Jamb / Sill-Thassos White ***STD***
Plumbing Fixture (Colour)	1737	Plumbing Fixtures-WHITE ***STD***
Comment		

Great Room Fireplace

Type	8865	Dimplex-Electric Fireplace-PF3033HL ***STD***
Mantle	8891	NF-17-Paint Grade Mantle- Cabinet (Per Plan)-WHITE ***STD***
Surround Opt.	1111	N/A *****

RB

SANDEEP, KAUR SANDHU/JASVINDER SINGH SANDHU
Project: Wallaceton
Unit: 284C-13, Phase: 2
Model: 20-1456 A The Hampton

Created: 10/19/2020 08:04:27
Locked:
Closed:

9 of 21

Note	1111	Purchasers have been advised: heat from the FP can damage TV above a FP and items placed on mantle.
Note	1111	Heathwood and its contractors will not be liable for any damage on items placed/installed above a FP after closing.
Comment		

Basement Stairs

Type	1714	Carpet Grade Stairs ***STD BASEMENT STAIRS***
Colour	7912	Irongate (Gryphon) STAIN TO COMPLIMENT HARDWOOD AND WILL VARY FROM FLOORING
Carpet Runner	1111	N/A *****
Handrail/Pickets/Post Type	8148	Single Collar Alt. Plain w/ Shoes with 3 1/2" Square/Cap Post(s)-BLACK ***2***
Handrail/Pickets/Post Colours	7762	Carpet Grade-Stain handrail, stringers, nosing _post(s). (Me
Carpet	9245	DY 87354-Dynasty Tex-OVERCAST-40 oz Poly***STD***
Custom Stain/Paint	1111	N/A *****
Comment		

Basement Stairs Landing(s)

Flooring	7498	Red Oak Pearl-Vintage Engineered-IRONGATE-3/4 inch x 3 1/4 inch ***3***
Comment		

Main Stairs

Type	1712	Oak Stairs ***STD MAIN STAIRS***
Colour	7912	Irongate (Gryphon) STAIN TO COMPLIMENT HARDWOOD AND WILL VARY FROM FLOORING
Carpet Runner	1111	N/A *****
Handrail/Pickets/Posts Type	8148	Single Collar Alt. Plain w/ Shoes with 3 1/2" Square/Cap Post(s)-BLACK ***2***

SANDEEP, KAUR SANDHU/JASVINDER SINGH SANDHU
Project: Wallaceton
Unit: 284C-13, Phase: 2
Model: 20-1456 A The Hampton

Created: 10/19/2020 08:04:27
Locked:
Closed: 10 of 21

Handrail/Pickets/Posts Colour 7761 Oak Grade-Stain handrail,stringers,treads,risers,nosingpost

Custom Stain/Paint 1111 N/A *****

Comment

Main Stairs Landing(s)

Flooring 7498 Red Oak Pearl-Vintage Engineered-IRONGATE-3/4 inch x 3 1/4 inch ***STD***

Comment

Throughout

Walls - Paint Colour 1717 22-Wall-WARM GREY ***STD***

Underpad 1079 500 Series-Underpad ***STD***

Thresholds 2232 Metal Thresholds ***STD***

Switches and Plug 5796 Decora White Switches and Plugs ***STD***

Trim Size 8705 4 1/4 Baseboard and 2 1/4 Casings ***STD***

Trim - Paint Colour 1716 Trim-WHITE ***STD***

Comment

Purchaser: Sandeep Sandhu Date SANDEEP, KAUR SANDHU Decor Consultant Date Oct-19-20

Purchaser: Jasvinder Singh Sandhu Date Oct-19-20 JASVINDER SINGH SANDHU Date Wallaceton -10- 26 2020 Date Approved



Sales Selection Sheet

Wallaceton

11 of 21

PURCHASERS: SANDEEP, KAUR SANDHU and JASVINDER SINGH SANDHU

TEL:

LOT / UNIT 284C-13	PHASE 2	MODEL 20-1456 A The Hampton	
-----------------------	------------	--------------------------------	--

It is herein understood and agreed between the undersigned parties hereto that the following changes shall be made to the above mentioned Agreement of Purchase and Sale in accordance with the agreement and except for such changes noted below, all other terms and conditions in the Agreement of Purchase and Sale shall remain as stated herein: It is further understood that and agreed that all changes and additions shall be installed as per builder's specifications, location and available selections. The Purchaser hereby agrees to purchase the following extras:

Cabinetry

1 189,343 41,071	CABINETRY - 11A-UPPER ANGLE CORNER PER UNIT - UPGRADE 1 Note: SKETCH # 2 PAGE 15	Qty: 1
2 189,308 41,072	CABINETRY - 04H-66CM DEEP FRIDGE ENCLOSURE (COUNTER DEPTH) WITH (1) WALL ([1] 66CM DEEP GABLE AND [1] 66CM DEEP CABINET) (THIS IS NOT A ZERO CLEARANCE ENCLOSURE. STANDARD HEIGHTS AND WIDTHS WILL BE USED.) ; PRICE ALL THE SAME FOR ALL LINES - KITCHEN Note: SKETCH # 2 PAGE 15	Qty: 1

Ceramics

3 175,938 41,076	CERAMICS - FLOOR - KITCHEN - UPGRADE 2 Note:	Qty: 1
4 175,954 41,077	CERAMICS - FLOOR - ENSUITE MASTER - UPGRADE 2 Note:	Qty: 1
5 175,946 41,078	CERAMICS - FLOOR - MAIN BATHROOM - UPGRADE 2 Note:	Qty: 1
6 175,922 41,080	CERAMICS - FLOOR - POWDER ROOM - UPGRADE 2 Note:	Qty: 1
7 175,825 41,082	CERAMICS - FLOOR GROUT - ENSUITE MASTER - GROUT Note:	Qty: 1
8 175,822 41,083	CERAMICS - FLOOR GROUT - POWDER ROOM - GROUT Note:	Qty: 1
*9 175,828 41,085	CERAMICS - FLOOR GROUT - KITCHEN - GROUT Note:	Qty: 1

Electrical

10 189,45C 41,073	ELECTRICAL - CEILING ROUGH-IN (CAPPED) SKETCH # 2 PAGE 15 Note: 1 X OVER ISLAND - 1 SWITCH 1 X GREAT ROOM - EXISTING SWITCH	Qty: 2
-------------------------	--	--------

Initials:

TAX#:1

PREPARED BY: Brenda Luker



Sales Selection Sheet

Wallaceton

12 of 21

PURCHASERS: SANDEEP, KAUR SANDHU and JASVINDER SINGH SANDHU

TEL:

LOT / UNIT 284C-13	PHASE 2	MODEL 20-1456 A The Hampton	
-----------------------	------------	--------------------------------	--

Electrical

11 189,451 41,074	ELECTRICAL - ADDITIONAL SWITCH FOR CAPPED CEILING ABOVE KITCHEN ISLAND Note: SKETCH # 2 PAGE 15	Qty: 1
-------------------------	---	--------

Granite

12 176,016 41,075	GRANITE - COUNTERTOP - 3/4" GROUP 1 WITH MITRE EDGE - KITCHEN / ISLAND - UPGRADE 1 Note:	Qty: 1
-------------------------	---	--------

Interior Railing

13 176,090 41,081	INTERIOR RAILING - BLACK METAL - SINGLE COLLAR ALT. PLAIN W/ SHOES WITH 3 1/2" SQUARE/CAP POST(S) AS PER PLAN - THOUGHOUT - UPGRADE 2 Note:	Qty: 1
-------------------------	--	--------

MISC.

14 41,084	FIVE THOUSAND DOLLARS (\$5000) TO BE USED AT DECOR Note:	Qty: 1
--------------	---	--------

Sub Total

HST

Total

1. This Sales Selection Sheet when properly executed forms part of our Agreement of Purchase and Sale.
2. All extras and upgrades listed above are subject to Construction Progress and Architectural and Municipal requirements.
3. In the event the Vendor is unable to incorporate the work approved above in the construction of the house for any reason whatsoever, the Vendor will not be liable to the Purchaser in any way. The monies paid for any changes or optional extras not proceeded with shall be returned to the Purchaser, without interest. The cost of options or extras is non-refundable in all other circumstances. If for any reason whatsoever the Agreement of Purchase and Sale is not completed, the total cost of work approved above will be retained by the Vendor.
4. The Vendor reserves the right to substitute above materials and equipment with that of equal or better quality.
5. Purchaser acknowledges that items may not be exactly as shown. Variations from the Vendor's samples may occur in finished materials due to normal production processes. Vendor is not responsible for shade difference which may occur from different dye lots or wood grains. Variations from the Vendor's samples will occur with natural materials such as wood, marble, granite, hardwood and brick.
6. The Vendor reserves the right to select Grout & Thresholds that best suits the Tile selected.
7. Selections will not be processed unless signed by Heathwood Homes Head Office.
8. The selections made on this schedule are final and cannot be changed once submitted.
9. The Purchaser has checked and acknowledges the accuracy of this schedule.

Payment Summary

Paid By Amount

Total Payment:

Initials: SP

TAX#:1

PREPARED BY: Brenda Luker

PE 561-2

SInvoice.rpt 28may19



Sales Selection Sheet

Wallaceton

13 of 21

PURCHASERS: SANDEEP, KAUR SANDHU and JASVINDER SINGH SANDHU

TEL:

LOT / UNIT 284C-13	PHASE 2	MODEL 20-1456 A The Hampton	
-----------------------	------------	--------------------------------	--

PURCHASER: Sandeep Sandhu
SANDEEP, KAUR SANDHU

19-Oct-20
DATE

[Signature]
Decor Consultant

19-Oct-20
DATE

APPROVED

PURCHASER: Jasvinder Singh Sandhu
JASVINDER SINGH SANDHU

19-Oct-20
DATE

-10- 2 6 2020

[Signature]

Date Approved Heathwood Homes (Huron) Limited

TAX#:1

PREPARED BY: Brenda Luker

PE 561-3

Si\volce.rpt 28may19

UK-75 WALLACETON
LOT 284C-13
20-1456 A
THE HAMPTON

14 of 21

20-1456 ELEV. A

THE HAMPTON

ELEVATION A | 1,785 SQ. FT.

Includes 320 square feet of finished lower level

Sketch #1

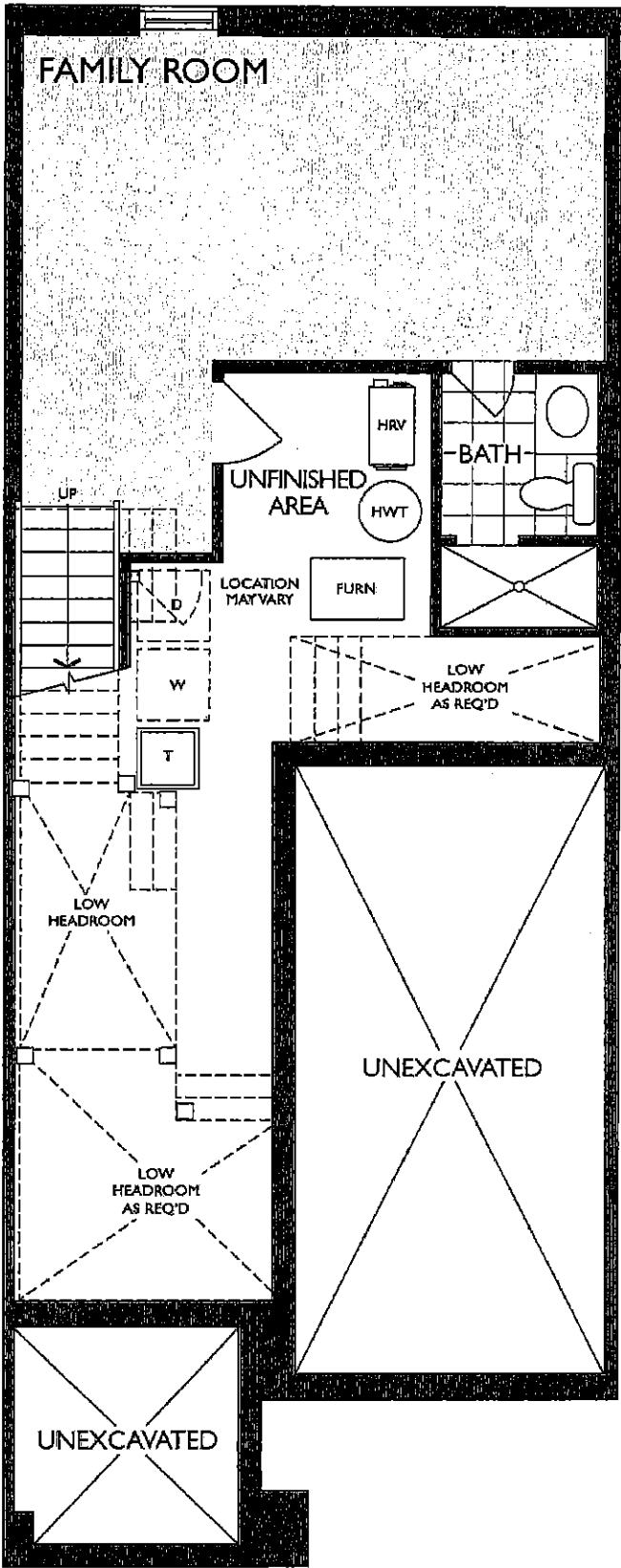

LOWER LEVEL
ELEVATION A

MR

July 7, 2020

UK-75 WALLACETON
LOT 284C-13
20-1456 A
THE HAMPTON

15 of 21

20-1456 ELEV. A

THE HAMPTON
ELEVATION A | 1,785 SQ. FT.
Includes 329 square feet of finished lower level

Sketch # 2

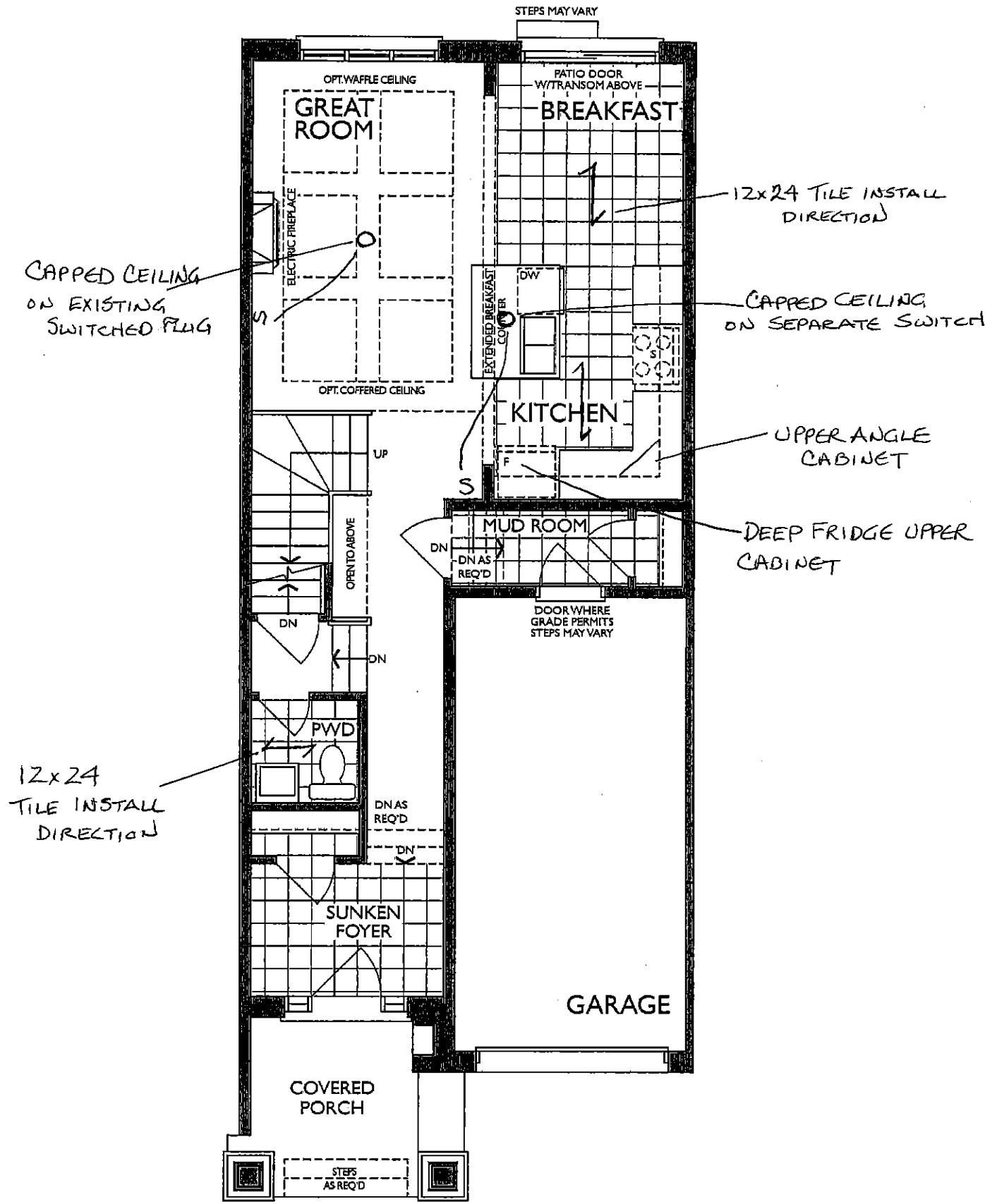

MAIN FLOOR
ELEVATION A

Handwritten signature

UK-75 WALLACETON
LOT 284C-13
20-1456 A
THE HAMPTON

16 of 21

20-1456 ELEV. A

THE HAMPTON

ELEVATION A | 1,785 SQ. FT.

Includes 329 square feet of finished lower level

Sketch #3

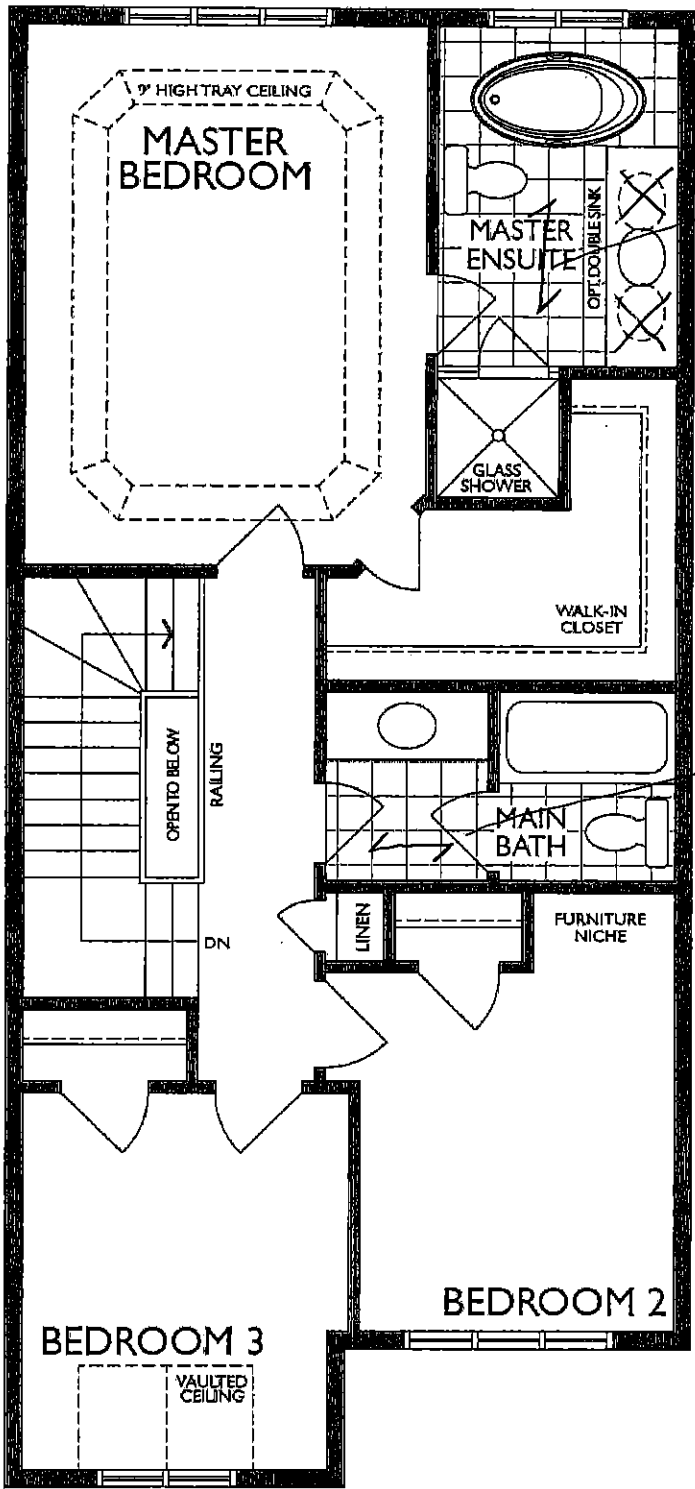

12x24 TILE
INSTALL DIRECTION

12x24 TILE
INSTALL DIRECTION

SECOND FLOOR
ELEVATION A

MR

July 7, 2020

UK - 75 WALLACETON
LOT 284C-13
20-1456 A
THE HAMPTON

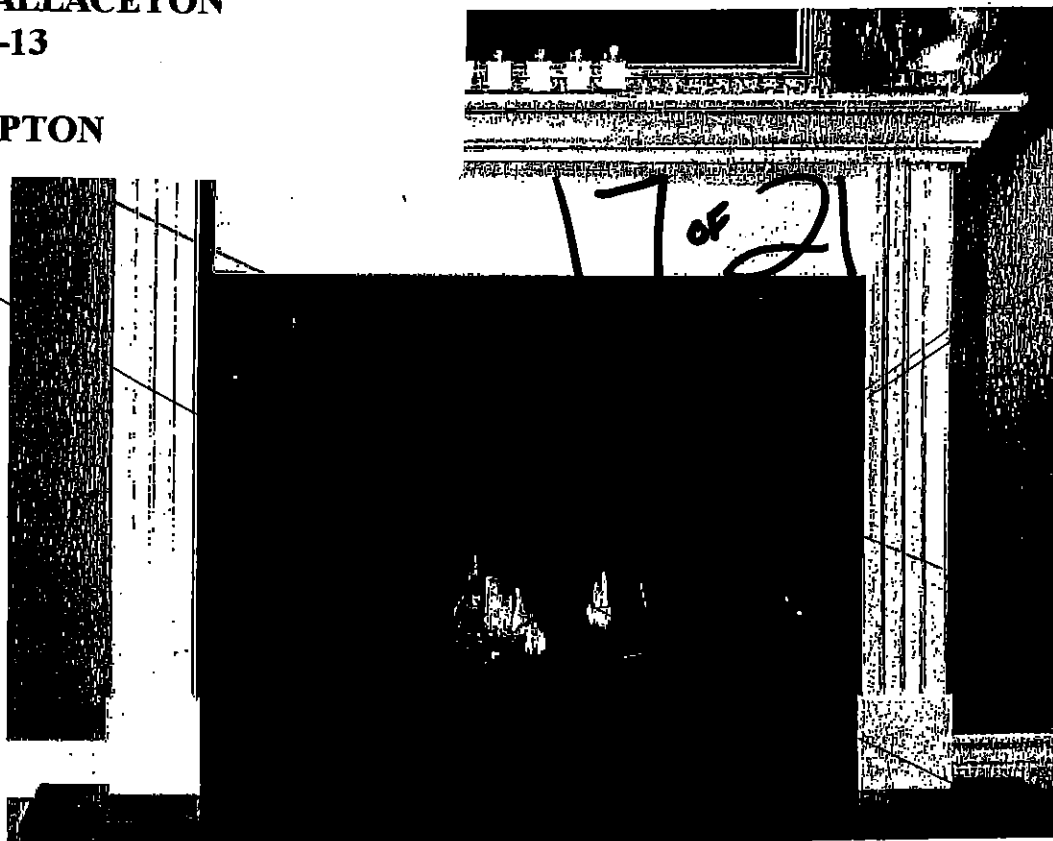

STANDARD NF 15 Mantel

Clean apron finish with fluted legs

WHITE PAINT GRADE FINISH

(PICTURE SHOWN WITH UPGRADE SURROUND AND HEARTH -PRICED SEPARATELY)

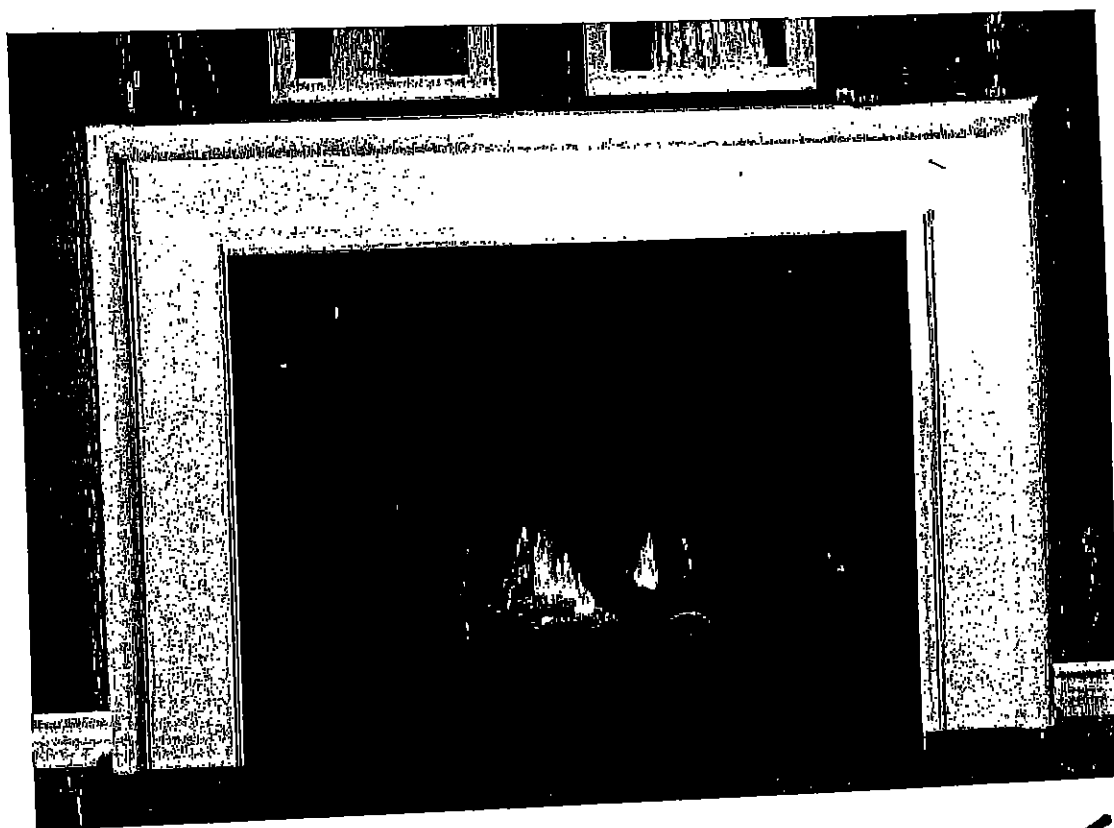

CABINET

STANDARD NF 17 Mantel

WHITE PAINT GRADE FINISH

(PICTURE SHOWN WITH UPGRADE SURROUND AND HEARTH -PRICED SEPARATELY)

UK - 75 WALLACETON
 LOT 284C-13
 20-1456 A
 THE HAMPTON

18 of 21

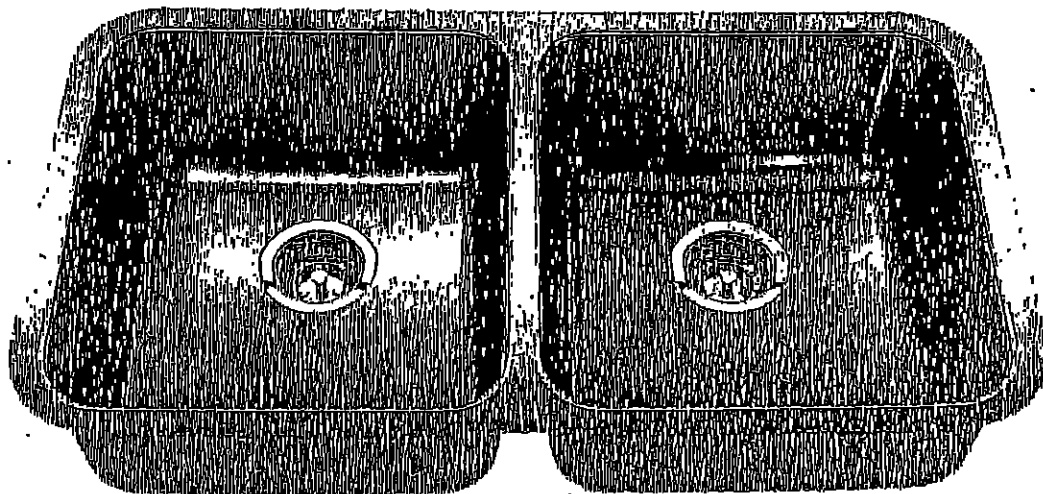

Optional Accessories

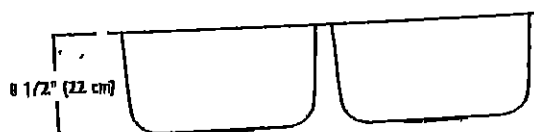
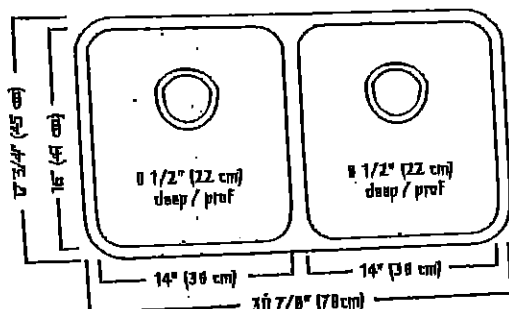

ND1831UA/9 SPECIFICATION

Model ND1831UA/9 is a double (two equal size) bowl undermount sink manufactured by Franke Kindred Canada Limited from 18 gauge stainless steel. Product has silk finished rims and linear brush finished bowls. Sink is fully undercoated. Basket strainer waste fittings (3 1/2", 89 mm) are included. Sink is backed with a limited lifetime warranty.

- O.D. 17 3/4" x 30 7/8" x 8 1/2" (45 x 78 x 22 cm)
- Recommended for minimum 36" cabinet

Franke Kindred Canada Limited
 P.O. Box 190, 1000 Franke Kindred Road, Midland, Ontario, Canada, L4R 4K9 Phone: 866-687-7465 Fax: 800-361-8408

Franke Kindred Canada Limited

Printed in Canada

1117

[Handwritten signature] K.Y.

UK - 75 WALLACETON
LOT 284C-13
20-1456 A
THE HAMPTON

19 or 21

STANDARD KITCHEN FAUCET

Align

Modern

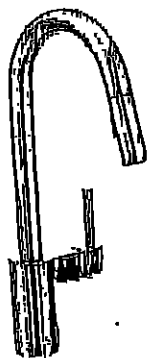

Single Handle Pull-Down Kitchen
Faucet*

Model 7565+

Handwritten signature or initials.

UK - 75 WALLACETON
LOT 284C-13
20-1456 A
THE HAMPTON

20 of 21

Chateau

Transitional

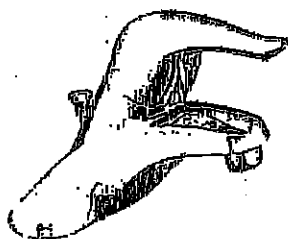

Lavatory Faucet with Pop-Up Drain
Model L4621†

VANITY SINKS AND PEDESTAL

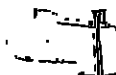

Posi-Temp® Pressure Balancing Tub/Shower
Model 62320 / TL183†

OR

Posi-Temp Valve and Tub/Shower Trim
with Eco-Performance Easy Clean® XL
Model 62320 / TL183EP†
(TL183EP not available in BC)

SHOWER AND 5' TUB FAUCETS

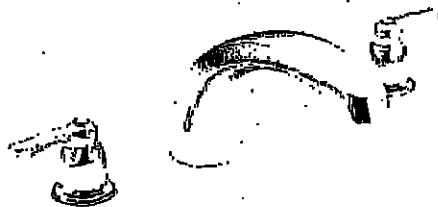

2 Handle Roman Tub with 9" Spout
Model 4796 / T990†

FREESTANDING TUB FAUCETS

UK - 75 WALLACETON
LOT 284C-13
20-1456 A
THE HAMPTON

HOODFAN FOR
TOWNS AND SINGLES

21 of 21



SPECIFICATIONS
AV SERIES
RANGE HOODS

HVI 180 CFM/7.0 Sones @ 0.10" SP. Horizontal
CERTIFIED 180 CFM/7.5 Sones @ 0.10" SP. Vertical

- Dimensions**
Overall bottom projection - 18 3/4"
Overall top projection - 12"
Height - 6"
Available widths: 21", 24", 30", 36" & 42"
- Hood Body**
Stainless Steel: 24 gauge, grade 430 stainless steel.
Painted: 23 gauge cold rolled commercial grade (CRCG) steel, auto welded, coated with a baked enamel finish.
- Motor**
2 speed, single coil, thermally protected, permanently lubricated.
Rated 120 volts, 60 hz. Complete with 200°C lead wires.
- Lighting**
Single 80 watt cook light capacity (bulb not included).
- Ducting Options**
Horizontal ducting: 3 1/4"x10" (duct adapter and damper included).
Vertical ducting: 3 1/4"x10" (duct adapter and damper included).
Vertical ducting: 7" round (duct adapter and damper not included).
Ductless: removable front vent (charcoal filter not included).
- Fan Blade**
One piece polymeric, electronically balanced blade, 6 5/8" diameter with 6 paddles.
- Electrical connection**
Hood top - 7/8" knockout hole for use with 1/2" cable clamp
Hood back - 7/8" knockout hole for use with 1/2" cable clamp

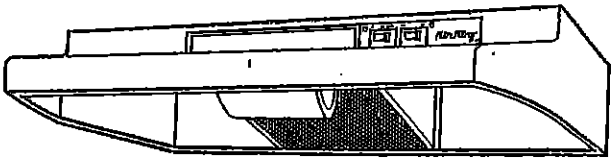

AV SERIES

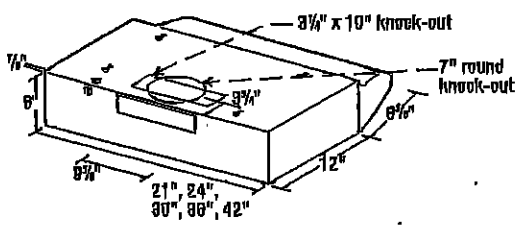

- Filters**
UL rated, class 2 filter.
Grease Filter: RF35 - 8 7/8"x10 3/8" (included).
Charcoal Filter: RF34 (not included).
Combo Grease/Charcoal: RF55 (not included).
- Available Finishes**
White, Blacult, Almond, Black & Stainless Steel.

EXPANDED PERFORMANCE										
Air Flow - CFM	Static Pressure (inches of w.g.)						Sones @ .1 SP	Fan Speed RPM	Power Watts	Amps
	0	0.05	0.1	0.15	0.2	0.25				
Vertical Ducting High	248	232	218	203	181	147	7.6	2873	87.0	2.1
Horizontal Ducting High	225	210	180	175	155	120	7.0	3024	87.0	2.1

PROJECT		ARCHITECT								
LOCATION		ENGINEER								
CONTRACTOR		SUBMITTED BY	DATE							
FAN NUMBER	MODEL NUMBER	CFM	IN. W.G.	HPM	WATTS	AMPS	SONES	QTY	OPTIONAL EQUIPMENT & REMARKS	



Air King: 820 Lincoln Avenue
West Chester, Pennsylvania 19380-4488
Tel: (610) 892-7400 • 877-304-3785
Fax: (610) 898-8048

Canada:
Brampton, Ontario
Tel: 905-456-2033
Fax: (905) 456-1015

Specifications subject to change without notice.