

PRE-Sales Selection Sheet
Checklist

1 of 23

LOT 284A-5 Model: 20-2095 END ALT A The Forbes

PURCHASERS: SHIV, K JAISWAL/SURINDER JAISWAL

VENDOR: Heathwood Homes (Huron) Limited

COFFERED CEILING IN GREAT ROOM

R/I WET BAR IN FINISHED LOWER LEVEL FAMILY ROOM

- ☒ FINISHED BASEMENT
☐ COLD CELLAR

UPGRADED / MODIFIED ELEVATION

- ☐ CORNER UPGRADE
☐ REAR UPGRADE

CEILING UPGRADE - SMOOTH

- ☐ MAIN FLOOR
☐ SECOND FLOOR
☐ BASEMENT

ADDITIONAL ROUGH-INS

- ☐ 200 AMP SERVICE
☐ WET BAR ROUGH-IN
☐ HUMIDIFIER
☒ AIR CONDITIONING

GAS ROUGH-IN

- ☐ STOVE
☐ DRYER
☐ BBQ
☐ ADDITIONAL FIREPLACE

KITCHEN: HOODFAN VENTING SIZE

- ☒ 6 IN ROUND DUCT
☐ 7 IN ROUND DUCT

FULL BASEMENT STAIRS:

Carpet Grade

UPPER BASEMENT STAIRS:

N/A

LOWER BASEMENT STAIRS:

N/A

MAIN STAIRS:

All Oak

MEDIA STAIRS (if applicable):

N/A

LOFT STAIRS (if applicable):

N/A

Oct 21/20

Date

Purchaser:

on file

Oct 21/20

Date

Decor Consultant:

Brenda Luker

APPROVE?

-10- 26 2020

Date

Heathwood Homes (Huron) Limited

M. Rosen

Approved

Locked Date:



Sales Selection Sheet

Wallaceton
SCHEDULE 'E'

2 of 23

PURCHASERS: SHIV, K JAISWAL and SURINDER JAISWAL

TEL:

LOT / UNIT	PHASE	MODEL	
284A-5	2	20-2095 END ALT A The Forbes	

It is herein understood and agreed between the undersigned parties hereto that the following changes shall be made to the above mentioned Agreement of Purchase and Sale in accordance with the agreement and except for such changes noted below, all other terms and conditions in the Agreement of Purchase and Sale shall remain as stated herein: It is further understood that and agreed that all changes and additions shall be installed as per builder's specifications, location and available selections. The Purchaser hereby agrees to purchase the following extras:

MISC.

1	SCHEDULE E- FIVE THOUSAND DOLLARS (\$5,000) AT DECOR (NO CASH VALUE) As per Amendment to Schedule E dated October 21/20	Qty: 1	
42,665	Note:		

Sub Total

HST

Total

1. This Sales Selection Sheet when properly executed forms part of our Agreement of Purchase and Sale.
2. All extras and upgrades listed above are subject to Construction Progress and Architectural and Municipal requirements.
3. In the event the Vendor is unable to incorporate the work approved above in the construction of the house for any reason whatsoever, the Vendor will not be liable to the Purchaser in any way. The monies paid for any changes or optional extras not proceeded with shall be returned to the Purchaser, without interest. The cost of options or extras is non-refundable in all other circumstances. If for any reason whatsoever the Agreement of Purchase and Sale is not completed, the total cost of work approved above will be retained by the Vendor.
4. The Vendor reserves the right to substitute above materials and equipment with that of equal or better quality.
5. Purchaser acknowledges that items may not be exactly as shown. Variations from the Vendor's samples may occur in finished materials due to normal production processes. Vendor is not responsible for shade difference which may occur from different dye lots or wood grains. Variations from the Vendor's samples will occur with natural materials such as wood, marble, granite, hardwood and brick.
6. The Vendor reserves the right to select Grout & Thresholds that best suits the Tile selected.
7. Selections will not be processed unless signed by Heathwood Homes Head Office.
8. The selections made on this schedule are final and cannot be changed once submitted.
9. The Purchaser has checked and acknowledges the accuracy of this schedule.

Payment Summary

Paid By Amount

Total Payment:

PURCHASER:

Signature on file
SHIV, K JAISWAL

26-Oct-20

DATE

Brenda Huber 26-Oct-20
Decor Consultant DATE

PURCHASER:

SURINDER JAISWAL

26-Oct-20

DATE

APPROVED

-10- 26 2020

Date Approved Heathwood Homes (Huron) Limited

TAX#:1

PREPARED BY: Marilyn Rosen

PE 579-1

SInvoice.rpt 28may19

SHIV, K JAISWAL/SURINDER JAISWAL
Project: Wallaceton
Unit: 284A-5, Phase: 2
Model: 20-2095 END ALT A The Forbes

Created: 10/20/2020 14:26:58
Locked:
Closed:

3 of 23

Kitchen

Cabinet Colour/Style	6247	Viking III-CAMDEN-SHALE GREY CL-MAPLE ***STD***
Countertop	9121	MSI Quartz GROUP 1 ICED WHITE 3/4 inch with double mitre edge ***1***
Countertop Edge	4005	DOUBLE MITRE 1 1/2 INCH ***UPG*** 
Cabinet Hardware	7667	12881-HARDWARE ***STD***
Island Cabinet Colour/Style	6247	Viking III-CAMDEN-SHALE GREY CL-MAPLE ***STD***
Island Countertop	9121	MSI Quartz GROUP 1 ICED WHITE 3/4 inch with double mitre edge ***1***
Backsplash	1111	N/A *****
Backsplash Grout	1111	N/A *****
Backsplash Tile Pattern	1111	N/A *****

HoodFan	9117	SCB50030-CYCLONE 30 inch CANOPY CHIMNEY HOODFAN-SS PAGES 22-23
Appliance	0	Purchasers have been advised: standard fridge opening is a minimum 37 3/8 x 73 3/8". Ice Waterline Rough-In is included.
Appliance	0	Standard stove opening is 30" and standard dishwasher opening is 24". Any gas stove will require backsplash or stainless steel backing to avoid fire hazards.
Appliance	0	Purchasers acknowledge: Heathwood Homes and its contractors will not be responsible for any kitchen cabinet changes due to appliances dimension changes after
Comment		

Kitchen/Breakfast

Flooring	7498	Red Oak Pearl-Vintage Engineered-IRONGATE-3/4 inch x 3 1/4 inch ***8***
Floor Tile Grout	1111	N/A *****
Floor Tile Pattern	1111	N/A *****

Handwritten signature or mark.

SHIV, K JAISWAL/SURINDER JAISWAL
Project: Wallaceton
Unit: 284A-5, Phase: 2
Model: 20-2095 END ALT A The Forbes

Created: 10/20/2020 14:26:58
Locked:
Closed:

4 of 23

Comment

Foyer

Flooring	9071	GE.BY.AZR.1313 New Byzantine Azzuro 13
Floor Tile Grout	2225	Grout-(27) Silver ***STD***
Floor Tile Pattern	3000	STANDARD SQUARE ***STD***

Comment

Laundry Room

Flooring	9071	GE.BY.AZR.1313 New Byzantine Azzuro 13
Floor Tile Grout	2225	Grout-(27) Silver ***STD***
Floor Tile Pattern	3000	STANDARD SQUARE ***STD***

Comment

Laundry Room Opt.

Cabinet - Uppers	9156	Viking III-SIMCOE-RAIN CLOUD-3DL ***STD***
Cabinet Hardware	7667	12881-HARDWARE ***STD***

Comment

Mud Room

Flooring	9071	GE.BY.AZR.1313 New Byzantine Azzuro 13
----------	------	--

✓

Customer Colours

221

SHIV, K JAISWAL/SURINDER JAISWAL
Project: Wallaceton
Unit: 284A-5, Phase: 2
Model: 20-2095 END ALT A The Forbes

Created: 10/20/2020 14:26:58
Locked:
Closed:

5 of 23



Floor Tile Grout	2225	Grout-(27) Silver ***STD***
Floor Tile Pattern	3000	STANDARD SQUARE ***STD***

Comment

Powder Room

Flooring	9071	GE.BY.AZR.1313 New Byzantine Azzuro 13
Floor Tile Grout	2225	Grout-(27) Silver ***STD***
Floor Tile Pattern	3000	STANDARD SQUARE ***STD***

Plumbing Fixture (Colour)	1737	Plumbing Fixtures-WHITE ***STD***
---------------------------	------	-----------------------------------

Comment

Hall

Flooring		
Grout	1111	N/A *****
Floor Tile Pattern	1111	N/A *****

Comment

HARDWOOD - VINTAGE - 3-1/4" RED OAK ENGINEERED - KITCHEN / BREAKFAST - HALL
STANDARD SERIES - IRONGATE

Great Room

Flooring	7498	Red Oak Pearl-Vintage Engineered-IRONGATE-3/4 inch x 3 1/4 inch ***STD***
----------	------	---

Comment



4

SHIV, K JAISWAL/SURINDER JAISWAL
Project: Wallaceon
Unit: 284A-5, Phase: 2
Model: 20-2095 END ALT A The Forbes

Created: 10/20/2020 14:26:58
Locked:
Closed:

6 of 23

Upper Hall

Flooring 9248 DY 89418 -Dynasty Tex-BLACK ICE-40 oz Poly***STD***

Comment

Finished Basement (Rec) Room/Hall

Flooring 9248 DY 89418 -Dynasty Tex-BLACK ICE-40 oz Poly***STD***

Comment

Master Bedroom

Flooring 9248 DY 89418 -Dynasty Tex-BLACK ICE-40 oz Poly***STD***

Comment

Bedroom 2

Flooring 9248 DY 89418 -Dynasty Tex-BLACK ICE-40 oz Poly***STD***

Comment

Bedroom 3

Flooring 9248 DY 89418 -Dynasty Tex-BLACK ICE-40 oz Poly***STD***

Comment

Bedroom 4

Flooring 9248 DY 89418 -Dynasty Tex-BLACK ICE-40 oz Poly***STD***

Comment

S

Customer Colours

221

SHIV, K JAISWAL/SURINDER JAISWAL
Project: Wallaceton
Unit: 284A-5, Phase: 2
Model: 20-2095 END ALT A The Forbes

Created: 10/20/2020 14:26:58
Locked:
Closed:

7 of 23

Ensuite 2

Cabinet Colour/Style	9156	Viking III-SIMCOE-RAIN CLOUD-3DL ***STD***
Countertop	8796	6698-46-Countertop-PALOMA POLAR ETCHINGS FINISH-Formica ***STD***
Countertop Edge	1111	N/A *****
Cabinet Hardware	7667	12881-HARDWARE ***STD***
Floor Tile	9071	GE.BY.AZR.1313 New Byzantine Azzuro 13
Floor Tile Grout	2225	Grout-(27) Silver ***STD***
Floor Tile Pattern	3000	STANDARD SQUARE ***STD***

Plumbing Fixture (colour)	1737	Plumbing Fixtures-WHITE ***STD***
Tub Wall Tile	5411	QT.SP.WHT.0810-Splendour-White-8 inch x 10 inch ***STD***
Tub Wall Tile Grout	2226	Grout-(00) White ***STD***
Tub Wall Tile Pattern	3090	VERTICAL STACKED ***STD*** <div><div></div><div></div><div></div><div></div><div></div><div></div><div></div><div></div></div>

Comment

Master Ensuite

Cabinet Colour/Style	9157	Viking III-SIMCOE-MOONLIGHT-3DL ***STD***
Countertop	8796	6698-46-Countertop-PALOMA POLAR ETCHINGS FINISH-Formica ***STD***
Countertop Edge	1111	N/A *****
Cabinet Hardware	7667	12881-HARDWARE ***STD***

4

Customer Colours

221

SHIV, K JAISWAL/SURINDER JAISWAL
Project: Wallacetown
Unit: 284A-5, Phase: 2
Model: 20-2095 END ALT A The Forbes

Created: 10/20/2020 14:26:58

Locked:

Closed:

8 of 23

Floor Tile	9071	GE.BY.AZR.1313 New Byzantine Azzuro 13
Floor Tile Grout	2225	Grout-(27) Silver ***STD***
Floor Tile Pattern	3000	STANDARD SQUARE ***STD***
Shower Floor Tile	8661	OD.ON.SWT.0202.MT.N-Ontario Series Mosaic-Snow White Matte-2 x 2 ***STD***
Shower Floor Tile Grout	2226	Grout-(00) White ***STD***
Shower Floor Tile Pattern	3000	STANDARD SQUARE ***STD***
Shower Wall Tile	5411	QT.SP.WHT.0810-Splendour-White-8 inch x 10 inch ***STD***
Shower Wall Tile Grout	2226	Grout-(00) White ***STD***
Shower Wall Tile Pattern	3090	VERTICAL STACKED ***STD*** <div><div></div><div></div><div></div><div></div><div></div><div></div><div></div><div></div></div>
Shower Jamb(s) and Sill(s)	8923	Shower Jamb / Sill-Thassos White ***STD***
Plumbing Fixture (colour)	1737	Plumbing Fixtures-WHITE ***STD***
Comment		

Main Bathroom

Cabinet Colour/Style	9156	Viking III-SIMCOE-RAIN CLOUD-3DL ***STD***
Countertop	8796	6698-46-Countertop-PALOMA POLAR ETCHINGS FINISH-Formica ***STD***
Countertop Edge	1111	N/A *****
Cabinet Hardware	7667	12881-HARDWARE ***STD***
Flooring	9071	GE.BY.AZR.1313 New Byzantine Azzuro 13

2

Customer Colours

221

SHIV, K JAISWAL/SURINDER JAISWAL
Project: Wallaceton
Unit: 284A-5, Phase: 2
Model: 20-2095 END ALT A The Forbes

Created: 10/20/2020 14:26:58
Locked:
Closed:

9 of 23

Floor Tile Grout	2225	Grout-(27) Silver ***STD***
Floor Tile Pattern	3000	STANDARD SQUARE ***STD***
Wall Tile	5411	QT.SP.WHT.0810-Splendour-White-8 inch x 10 inch ***STD***
Wall Tile Grout	2226	Grout-(00) White ***STD***
Main Bathroom Tile Pattern	3090	VERTICAL STACKED ***STD*** <div><div></div><div></div><div></div><div></div><div></div><div></div><div></div><div></div></div>
Plumbing Fixture (Colour)	1737	Plumbing Fixtures-WHITE ***STD***
Comment		

Finished Basement Bathroom

Cabinet Colour/Style	9156	Viking III-SIMCOE-RAIN CLOUD-3DL ***STD***
Countertop	8796	6698-46-Countertop-PALOMA POLAR ETCHINGS FINISH-Formica ***STD***
Countertop Edge	1111	N/A *****
Cabinet Hardware	7667	12881-HARDWARE ***STD***
Flooring	9071	GE.BY.AZR.1313 New Byzantine Azzuro 13
Floor Tile Grout	2225	Grout-(27) Silver ***STD***
Floor Tile Pattern	3000	STANDARD SQUARE ***STD***
Shower Floor Tile	8661	OD.ON.SWT.0202.MT.N-Ontario Series Mosaic-Snow White Matte-2 x 2 ***STD***
Shower Floor Tile Grout	2226	Grout-(00) White ***STD***
Shower Floor Tile Pattern	3000	STANDARD SQUARE ***STD***

Handwritten signature

SHIV, K JAISWAL/SURINDER JAISWAL
Project: Wallacetown
Unit: 284A-5, Phase: 2
Model: 20-2095 END ALT A The Forbes

Created: 10/20/2020 14:26:58
Locked:
Closed:

10 of 23

Shower Wall Tile	5411	QT.SP.WHT.0810-Splendour-White-8 inch x 10 inch ***STD***								
Shower Wall Tile Grout	2226	Grout-(00) White ***STD***								
Shower Wall Tile Pattern	3090	VERTICAL STACKED ***STD*** <table><tr><td></td><td></td><td></td><td></td></tr><tr><td></td><td></td><td></td><td></td></tr></table>								
Shower Jamb(s)										
Plumbing Fixture (Colour)	1737	Plumbing Fixtures-WHITE ***STD***								
Comment										

Great Room Fireplace

Type	8865	Dimplex-Electric Fireplace-PF3033HL ***STD***
Mantle	8891	NF-17-Paint Grade Mantle- Cabinet (Per Plan)-WHITE ***STD*** PAGE 18
Surround Opt.	1111	N/A *****
Note	1111	Purchasers have been advised: heat from the FP can damage TV above a FP and items placed on mantle.
Note	1111	Heathwood and its contractors will not be liable for any damage on items placed/installed above a FP after closing.
Comment		

Basement Stairs

Type	1714	Carpet Grade Stairs ***STD BASEMENT STAIRS***
Colour	7912	Irongate (Gryphon) STAIN TO COMPLIMENT HARDWOOD AND WILL VARY FROM FLOORING
Carpet Runner	1111	N/A *****
Handrail/Pickets/Post Type	7652	1 5/16 inch Square pickets with 3 1/2" Square/Cap Post(s)-ALL OAK ***STD***
Handrail/Pickets/Post Colours	1729	Carpet Grade-Stain handrail, pickets, stringers, nosing .post
Carpet	9248	DY 89418 -Dynasty Tex-BLACK ICE-40 oz Poly***STD***

[Handwritten signature]

Customer Colours

221

SHIV, K JAISWAL/SURINDER JAISWAL
Project: Wallaceton
Unit: 284A-5, Phase: 2
Model: 20-2095 END ALT A The Forbes

Created: 10/20/2020 14:26:58
Locked:
Closed:

11 of 23.



Custom Stain/Paint 1111 N/A *****

Comment

Basement Stairs Landings (Upper and Lower)

Flooring 7498 Red Oak Pearl-Vintage Engineered-IRONGATE-3/4 inch x 3 1/4 inch ***3***

Comment

Main Stairs

Type 1712 Oak Stairs ***STD MAIN STAIRS***

Colour 7912 Irongate (Gryphon) STAIN TO COMPLIMENT HARDWOOD AND WILL VARY FROM FLOORING

Carpet Runner 1111 N/A *****

Handrail/Pickets/Posts Type 7652 1 5/16 inch Square pickets with 3 1/2" Square/Cap Post(s)-ALL OAK ***STD***

Handrail/Pickets/Posts Colour 1728 Oak Grade-Stain handrail,oak pickets,stringers,treads,risers

Custom Stain/Paint 1111 N/A *****

Comment

Main Stairs Landing(s) (Lower)

Flooring 7498 Red Oak Pearl-Vintage Engineered-IRONGATE-3/4 inch x 3 1/4 inch ***STD***

Comment

Throughout

Walls - Paint Colour 1717 22-Wall-WARM GREY ***STD***

Underpad 1079 500 Series-Underpad ***STD***

Thresholds 2232 Metal Thresholds ***STD***



2

SHIV, K JAISWAL/SURINDER JAISWAL
Project: Wallaceton
Unit: 284A-5, Phase: 2
Model: 20-2095 END ALT A The Forbes

Created: 10/20/2020 14:26:58
Locked:
Closed:

12 of 23

Switches and Plug	5796	Decora White Switches and Plugs ***STD***
Trim Size	8705	4 ¼ Baseboard and 2 ¾ Casings ***STD***
Trim - Paint Colour	1716	Trim-WHITE ***STD***
Comment		

Purchaser: SHIV, K JAISWAL Oct 21.20 *[Signature]* Oct 21/20
Date Decor Consultant Date

Purchaser: Surinder Jaiswal Wallaceton -10- 26 2020
Date Date Approved

APPROVED

[Signature]



Sales Selection Sheet

Wallaceton

13 of 23.

PURCHASERS: SHIV, K JAISWAL and SURINDER JAISWAL

TEL:

LOT / UNIT	PHASE	MODEL	
284A-5	2	20-2095 END ALT A The Forbes	

It is herein understood and agreed between the undersigned parties hereto that the following changes shall be made to the above mentioned Agreement of Purchase and Sale in accordance with the agreement and except for such changes noted below, all other terms and conditions in the Agreement of Purchase and Sale shall remain as stated herein: It is further understood that and agreed that all changes and additions shall be installed as per builder's specifications, location and available selections. The Purchaser hereby agrees to purchase the following extras:

APPLIANCES

1	CYCLONE 30 SC 500 CHIMNEY HOOD	Qty: 1
41,712	Note: SPECS PAGES 22-23	

CABINETRY

2	CABINETRY - VIKING I/II/III - OPT. LAUNDRY ROOM UPPERS - STANDARD SERIES	Qty: 1
178,391		
41,720	Note: SKETCH # 3 PAGE 17	

COFFERED CEILII

3	COFFERED CEILING - OPT. COFFERED CEILING - GREAT ROOM	Qty: 1
178,621		
41,719	Note: SKETCH # 2 PAGE 16	

ELECTRICAL

4	ELECTRICAL - CEILING ROUGH-IN (CAPPED)	Qty: 2
189,45C	SKETCH # 2 PAGE 16	
41,713	Note: 1 X GREAT ROOM - USE EXISTING SWITCH 1 X OVER ISLAND - 1 SWITCH	
5	ELECTRICAL - ADDITIONAL SWITCH	Qty: 1
189,451		
41,714	Note: FOR CAPPED OVER ISLAND SKETCH # 2 PAGE 16	
6	ELECTRICAL - EXTRA WALL INTERIOR OUTLET ON EXISTING CIRCUIT (DOES NOT INCLUDE KITCHEN OUTLETS)	Qty: 1
189,44E	66" +/- CENTERED ABOVE GREAT ROOM FIREPLACE	
41,724	Note: SKETCH # 2 PAGE 16	

GRANITE

7	GRANITE - COUNTERTOP - 3/4" GROUP 1 WITH MITRE EDGE - KITCHEN / ISLAND - UPGRADE 1	Qty: 1
178,653		
41,717	Note:	

HARDWOOD

8	HARDWOOD - VINTAGE - 3-1/4" RED OAK ENGINEERED - KITCHEN / BREAKFAST - STANDARD SERIES	Qty: 1
178,71E		
41,715	Note:	
9	HARDWOOD - VINTAGE - 3-1/4" RED OAK ENGINEERED - KITCHEN / BREAKFAST HALL	Qty: 1
41,716	Note: MAIN FLOOR HALLWAY	

MISC.

Initials:

TAX#:1

PREPARED BY: Brenda Luker

PE 568-1

SInvoice.rpt 28may19



Sales Selection Sheet

Wallaceton

14 of 23

PURCHASERS: SHIV, K JAISWAL and SURINDER JAISWAL

TEL:

LOT / UNIT	PHASE	MODEL	
284A-5	2	20-2095 END ALT A The Forbes	

MISC.

10	DECOR DOLLARS \$5000	Qty: 1
41,718	Note:	

PLUMBING

11	PLUMBING - OPTIONAL EXTRA - ROUGH- IN FOR FUTURE WET BAR -	Qty: 1
189,543		
41,723	Note: SKETCH # 1 PAGE 15	

Sub Total

HST

Total

1. This Sales Selection Sheet when properly executed forms part of our Agreement of Purchase and Sale.
2. All extras and upgrades listed above are subject to Construction Progress and Architectural and Municipal requirements.
3. In the event the Vendor is unable to incorporate the work approved above in the construction of the house for any reason whatsoever, the Vendor will not be liable to the Purchaser in any way. The monies paid for any changes or optional extras not proceeded with shall be returned to the Purchaser, without interest. The cost of options or extras is non-refundable in all other circumstances. If for any reason whatsoever the Agreement of Purchase and Sale is not completed, the total cost of work approved above will be retained by the Vendor.
4. The Vendor reserves the right to substitute above materials and equipment with that of equal or better quality.
5. Purchaser acknowledges that items may not be exactly as shown. Variations from the Vendor's samples may occur in finished materials due to normal production processes. Vendor is not responsible for shade difference which may occur from different dye lots or wood grains. Variations from the Vendor's samples will occur with natural materials such as wood, marble, granite, hardwood and brick.
6. The Vendor reserves the right to select Grout & Thresholds that best suits the Tile selected.
7. Selections will not be processed unless signed by Heathwood Homes Head Office.
8. The selections made on this schedule are final and cannot be changed once submitted.
9. The Purchaser has checked and acknowledges the accuracy of this schedule.

Payment Summary

Paid By Amount

Total Payment:

PURCHASER:

SHIV, K JAISWAL

21-Oct-20

DATE

Decor Consultant

21-Oct-20

DATE

PURCHASER:

SURINDER JAISWAL

21-Oct-20

DATE

APPROVED

-10- 26 2020

Date Approved Heathwood Homes (Huron) Limited

TAX#:1

PREPARED BY: Brenda Luker

PE 568-2

SInvoice.rpt 28may19

UK - 75 WALLACETON
LOT 284A-5
20-2095 END ALT A
THE FORBES

15 of 23

20-2095 END ALT ELEV. A

THE FORBES

ELEVATION A | 2,733 SQ. FT.

Includes 638 square feet of finished lower level

Sketch #1

WET BAR
R/I

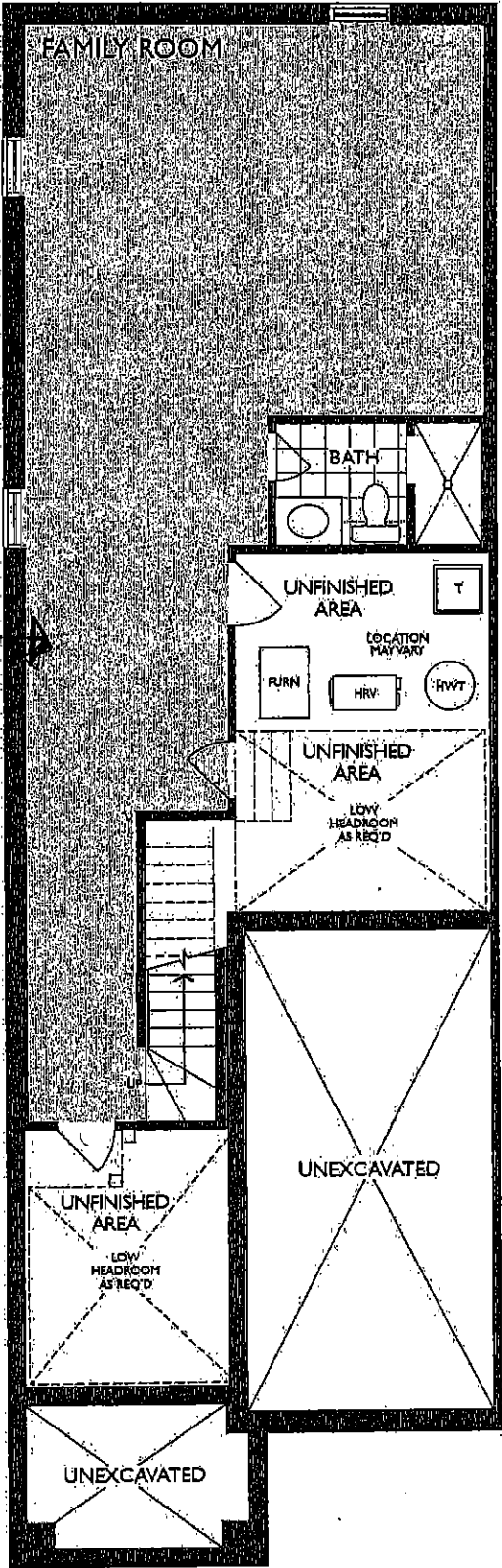

LOWER LEVEL
ELEVATION A & B

September 9, 2020

16.23

ELEVATION A | 2,733 SQ. FT.

Includes 638 square feet of finished lower level

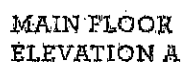

WPK

September 9, 2020

UK-75 WALLACETON
LOT 284A-5
20-2095 END ALT A
THE FORBES

17 of 23

20-2095 END ALT ELEV. A

THE FORBES

ELEVATION A | 2,733 SQ. FT.

Includes 638 square feet of finished lower level

Sketch #3

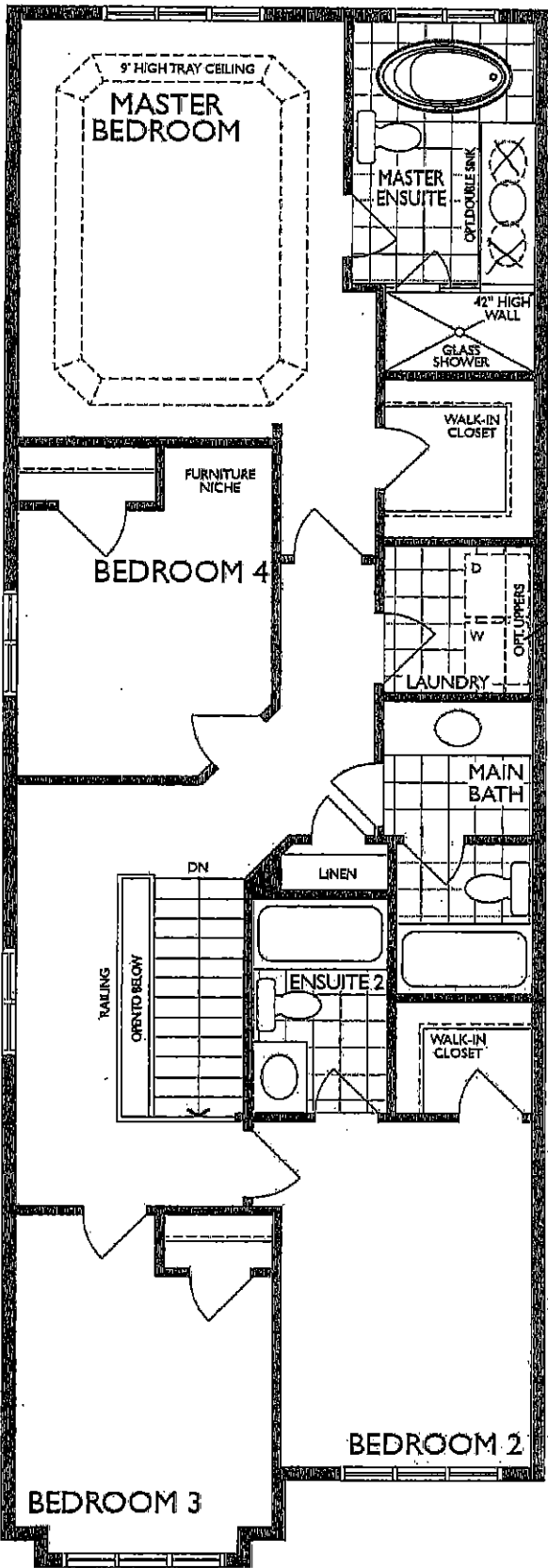

PROVIDE OPTIONAL
LAUNDRY UPPERS

ALT. SECOND FLOOR
ELEVATION A

W.F.

UK - 75 WALLACETON
LOT 284A-5
20-2095 END ALT A
THE FORBES

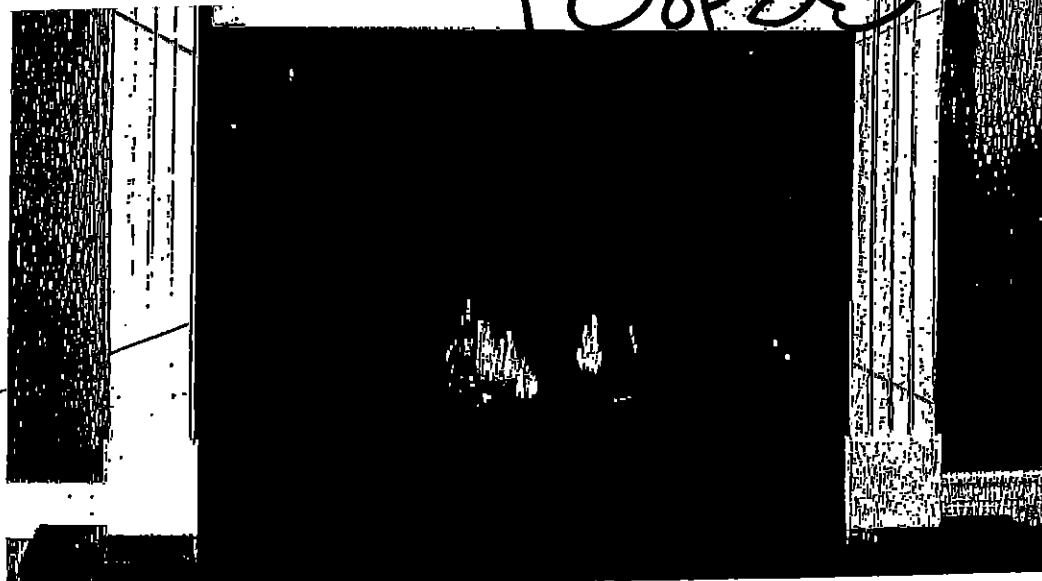

STANDARD NF 15 Mantel

Clean apron finish with fluted legs

WHITE PAINT GRADE FINISH

(PICTURE SHOWN WITH UPGRADE SURROUND AND HEARTH -PRICED SEPARATELY)



CABINET

STANDARD NF 17 Mantel

WHITE PAINT GRADE FINISH

(PICTURE SHOWN WITH UPGRADE SURROUND AND HEARTH -PRICED SEPARATELY)

UK - 75 WALLACETON
 LOT 284A-5
 20-2095 END ALT A
 THE FORBES

19 of 23

STANDARD KITCHEN SINK

ND1831UA/9

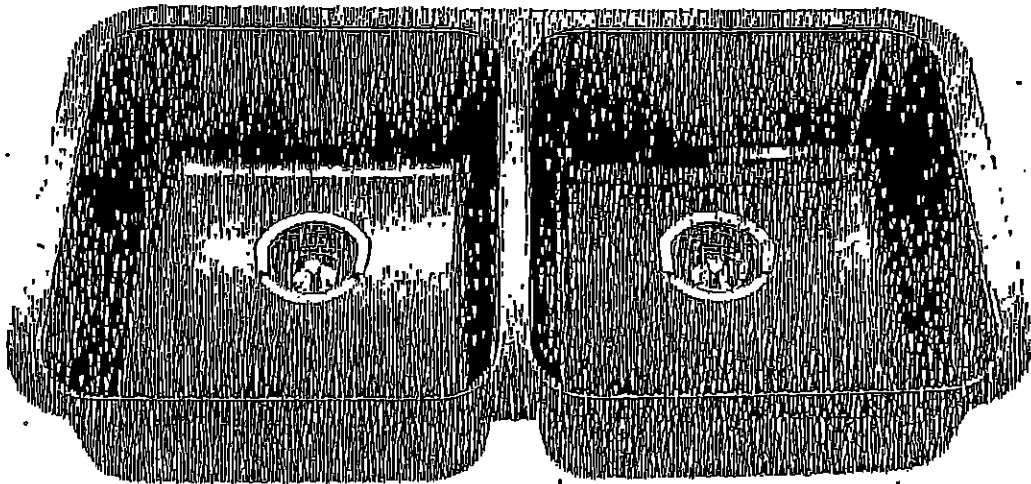

Optional Accessories

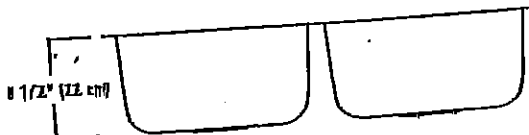
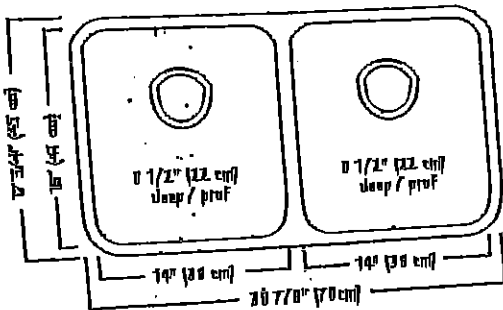

ND1831UA/9 SPECIFICATION

Model ND1831UA/9 is a double (two equal size) bowl undermount sink manufactured by Franke Kindred Canada Limited from 18 gauge stainless steel. Product has silk-finished rims and linear brush finished bowls. Sink is fully undercoated. Basket strainer waste fittings (3 1/2", 89 mm) are included. Sink is backed with a limited lifetime warranty.

- * O.D. 17 3/4" x 30 7/8" x 1 1/2" (45 x 78 x 38 mm)
- * Recommended for minimum 36" cabinet

Franke Kindred Canada Limited
 P.O. Box 190, 1000 Franke Kindred Road, Midland, Ontario, Canada, L4R 4K9 Phone: 866-687-7465 Fax: 800-361-8408

K.Y.

✓

UK - 75 WALLACETON
LOT 284A-5
20-2095 END ALT A
THE FORBES

20 of 23

STANDARD KITCHEN FAUCET

Align

Modern

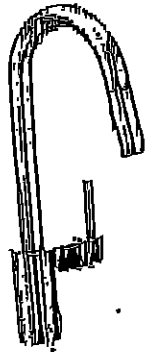

Single Handle Pull-Down Kitchen
Faucet
Model 7568+

Kyle

3

UK - 75 WALLACETON
LOT 284A-5
20-2095 END ALT A
THE FORBES

21 of 23

Chateau

Transitional

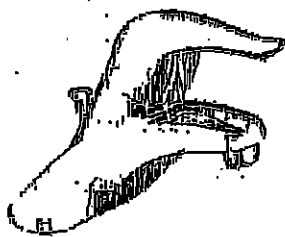

Lavatory Faucet with Pop-Up Drain
Model L4621+

VANITY SINKS AND PEDESTAL

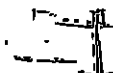

Post-Temp® Pressure Balancing Tub/Shower
Model 62320 / TL183+

OR

Post-Temp Valve and Tub/Shower Trim
with Eco-Performance Easy Clean® XL

Model 62320 / TL183EP+

(TL183EP not available in BC)

SHOWER AND 5' TUB FAUCETS

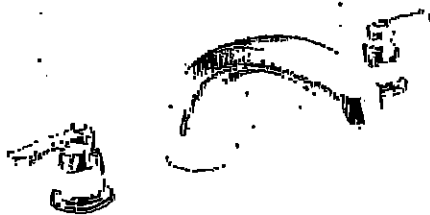

2 Handle Roman Tub with 9" Spout
Model 4796 / T990+

FREESTANDING TUB FAUCETS

C

UK-75 WALLACETON
LOT 284A-5
20-2096 END ALT A
THE FORBES

22 of 23

SC(B)500 | ALITO Collection

Cyclone®
Breathe Better

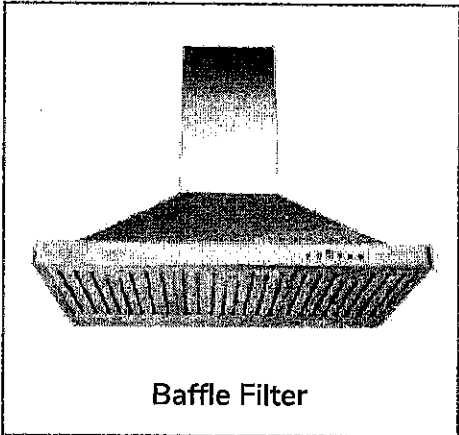

Baffle Filter

Wall Mount

Strong and sturdy with attractive lines and an imposing frame, the SC(B)500 is fitted with time-delay OFF feature up to nine minutes, 550 CFM fan, bright LED lights and a digital three-speed push button control panel.

Green Features



3 Speed Push Button
Control Panel



Dishwasher
Safe Filters



Long-Lasting
LED Light



Time-Delay
OFF Feature



Model	Colour	Ducting	Filters	Size	CFM
SC50024	Stainless Steel	6"	Mesh	24"	550
SC50030	Stainless Steel	6"	Mesh	30"	550
SC50036	Stainless Steel	6"	Mesh	36"	550
SCB50024	Stainless Steel	6"	Baffle	24"	550
SCB50030	Stainless Steel	6"	Baffle	30"	550
SCB50036	Stainless Steel	6"	Baffle	36"	550

Cyclone Range Hoods Inc.

1361 Huntingwood Drive, Unit 16, Toronto, ON, M1S 3J1, Canada
Toll Free: 1-888-293-5662 Tel: (416) 293-0933 Fax: (416) 293-4793 Website: www.CycloneRangeHoods.com

UK - 75 WALLACETON
 LOT 284A-5
 20-2095 END ALT A
 THE FORBES

SC(B)500 | ALITO Collection

23 of 23
 1225

Cyclone®
 Breathe Better

Features

- Wall mount range hood
- 6" round duct adapter
- Non-stick aluminum fan blades
- 3 speed push button control
- 2 LED lights (2 x 1.4W)
- Dishwasher-safe mesh or baffle filters
- Standard chimney fits up to 9 ft. ceiling
- Up to 9 minute time-delay OFF feature
- Plug-In connection

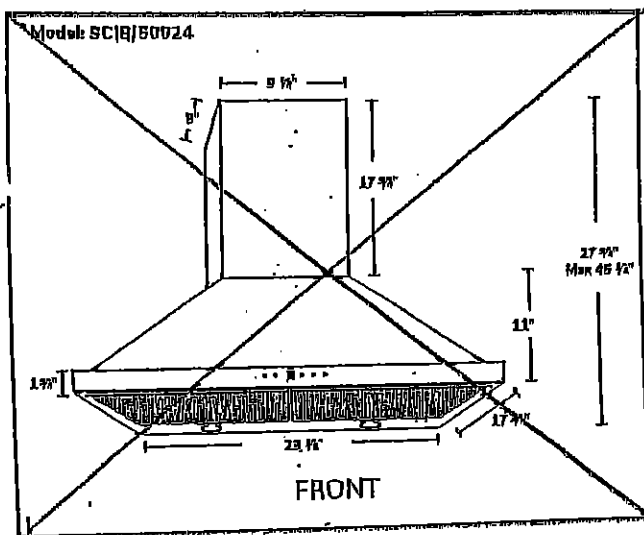
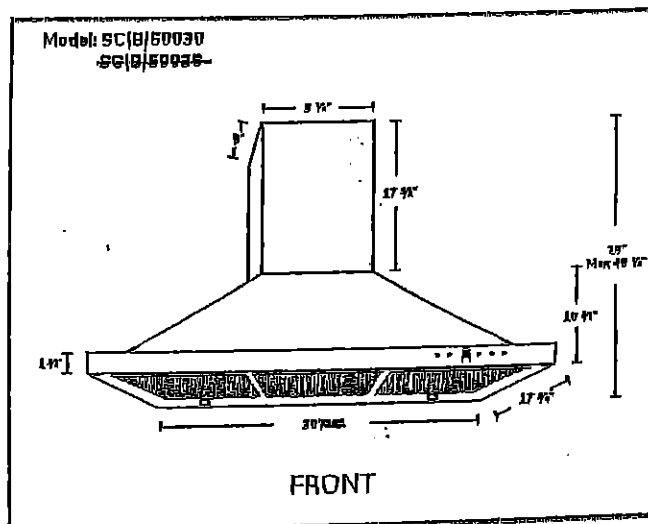

Options

- Filters: ~~SC500~~ - Quick Release Aluminum Mesh Filters
- ✓ **SCB500** - Quick Release Stainless Steel Baffle Filters
- Available Chimney Flues:
 - Short (7 ft. - 8 ft. A1.CH10)
 - Standard (8 ft. - 9 ft. A1.CH18)
 - Extended (9 ft. - 11 ft. A1.CH30)
- Widths: 24", **30"**, 36"

Specifications

- Air Flow Volume: 550 CFM
- Electrical Connection: 120V/60Hz
- Power Consumption: 210 Watts
- Current: 2.5 Amps
- Fan Speed: 1600RPM
- Fan Type: Centrifugal Blower

- Finishes: Stainless Steel
- Ducting: 6" Round
- Dimensions: Width: 24" **30"** 36"
 Height: 46"
 Depth: 18"

- Noise Level: Min. 2 Sones
 Max. 6 Sones

