

PRE-Sales Selection Sheet
Checklist

11 of 52

LOT 257 Model: 27-2587 CRN C The Maxwell

PURCHASERS: NOAMAN ZAHEER/MUNNAZA NOAMAN

VENDOR: Heathwood Homes (Huron) Limited

COFFERED CEILING IN GREAT ROOM

COFFERED CEILING IN DINING ROOM

~~MASTER ENSUITE- OPTIONAL DOUBLE SINKS~~ No double sinks

- ☒ FINISHED BASEMENT
☐ COLD CELLAR

UPGRADED / MODIFIED ELEVATION

- ☐ CORNER UPGRADE
☐ REAR UPGRADE

CEILING UPGRADE - SMOOTH

- ☐ MAIN FLOOR
☐ SECOND FLOOR
☐ BASEMENT

ADDITIONAL ROUGH-INS

- ☒ 200 AMP SERVICE
☐ WET BAR ROUGH-IN
☐ HUMIDIFIER
☒ AIR CONDITIONING

GAS ROUGH-IN

- ☒ STOVE 
☐ DRYER
☐ BBQ
☐ ADDITIONAL FIREPLACE

KITCHEN: HOODFAN VENTING SIZE

- ☒ 6 IN ROUND DUCT
☐ 7 IN ROUND DUCT

FULL BASEMENT STAIRS:	N/A
UPPER BASEMENT STAIRS:	All Oak
LOWER BASEMENT STAIRS:	Carpet Grade
MAIN STAIRS:	All Oak
MEDIA STAIRS (if applicable):	N/A
LOFT STAIRS (if applicable):	N/A

Aug. 19/20 Signatures
Date Purchaser: on file

Date Purchaser:

Locked Date:

Aug. 19/20 IRIT SALEM
Date Decor Consultant:

- APPROVED -

-08- 19 2020

Date Heathwood Homes (Huron) Limited
Approved

NOAMAN ZAHEER/MUNNAZA NOAMAN
Project: Wallaceton
Unit: 257, Phase: 2
Model: 27-2587 CRN C The Maxwell

Created: 6/29/2020 14:21:29
Locked:
Closed:

12 of 52

Kitchen

Cabinet Colour/Style	9166	Viking III-CHARLESTON-ORCHID-3DL ***STD***
Countertop	8595	Group 2-Quartz-Caesarstone-OCEAN FOAM #6141-3/4 inch with built-up edge ***2***
Countertop Edge	4005	DOUBLE MITRE 1 1/2 INCH ***UPG*** 
Cabinet Hardware	7667	12881-HARDWARE ***STD***
Island Cabinet Colour/Style	9167	Viking III-CHARLESTON-RAIN CLOUD-3DL ***STD***
Island Countertop	8595	Group 2-Quartz-Caesarstone-OCEAN FOAM #6141-3/4 inch with built-up edge ***2***
Backsplash	1111	N/A *****
Backsplash Grout	1111	N/A *****
Backsplash Tile Pattern	1111	N/A *****
HoodFan	8909	KVWB600DSS-KITCHEN AID 30 inch STAINLESS CHIMNEY HOOD-STAINLESS STEEL-30 inch ***Upg*** PAGE 36
Appliances		
Appliances		
Appliances	8909	Purchasers acknowledge: Heathwood Homes and its contractors will not be responsible for any kitchen cabinet changes due to appliances dimension changes after
Flooring	8499	Red Oak UVF-Vintage Red Oak Solid Sculpted Character UVF-PEWTER-3/4 inch X 5 inch ***9***
Floor Tile Grout	1111	N/A *****
Floor Tile Pattern	1111	N/A *****

FoyeComment C

Flooring	8294	OV.CD.IVO.1224.PL-Concorde-Ivory Polished-12x24 See Tile Direction on Sketch Page ***5***
----------	------	---

Handwritten signature

NOAMAN ZAHEER/MUNNAZA NOAMAN
Project: Wallaceon
Unit: 257, Phase: 2
Model: 27-2587 CRN C The Maxwell

Created: 6/29/2020 14:21:29
Locked:
Closed:

3 of 52

File Direction on Sketch Page
Sketch #5 PAGE 27

Floor Tile Grout 7707 Grout-(39) Ivory ***UPG***

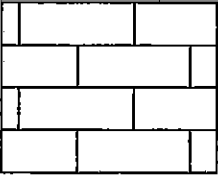
Floor Tile Pattern 3060 HORIZONTAL BRICK ***UPG***

Comment OR ~~STACKED~~

Laundry Room

Flooring 8261 TR.ST.BYZ.1313-Serpantine-Beyaz/White-13x13 See Tile Line Pattern on Sketch 7 Page 29 ***STD***

Floor Tile Grout 7705 Grout-(01) Alabaster ***UPG***

Floor Tile Pattern 3000 STANDARD SQUARE ***STD***

Comment

Laundry Room Opt.

Cabinet - Uppers 1111 N/A *****

Cabinet Hardware 1111 N/A *****

Comment

Mud Room

Flooring 5589 GE.BY.PEN.1313-New Byzantine-Pentallic (Grey)-13 x 13 ***1***

Floor Tile Grout 7705 Grout-(01) Alabaster ***UPG***

Floor Tile Pattern 3000 STANDARD SQUARE ***STD***

Comment

af
an

NOAMAN ZAHEER/MUNNAZA NOAMAN
Project: Wallaceton
Unit: 257, Phase: 2
Model: 27-2587 CRN C The Maxwell

Created: 6/29/2020 14:21:29
Locked:
Closed:

14 of 52

Powder Room

Flooring	5589	GE.BY.PEN.1313-New Byzantine-Pentallic (Grey)-13 x 13 ***1***
Floor Tile Grout	7705	Grout-(01) Alabaster ***UPG***
Floor Tile Pattern	3000	STANDARD SQUARE ***STD***

Plumbing Fixture (Colour)	1737	Plumbing Fixtures-WHITE ***STD***
Comment		

Dining Room

Flooring	8499	Red Oak UVF-Vintage Red Oak Solid Sculpted-PEWTER-3/4 inch X 5 inch **UPG**
Comment		

Great Room

Flooring	8499	Red Oak UVF-Vintage Red Oak Solid Sculpted-PEWTER-3/4 inch X 5 inch **UPG**
Comment		

Upper Hall

Flooring	8499	Red Oak UVF-Vintage Red Oak Solid Sculpted Character UVF-PEWTER-3/4 inch X 5 inch ***4***
Comment		

Study

Flooring	8499	Red Oak UVF-Vintage Red Oak Solid Sculpted-PEWTER-3/4 inch X 5 inch **UPG**
Comment		

Ref
New

NOAMAN ZAHEER/MUNNAZA NOAMAN
Project: Wallaceton
Unit: 257, Phase: 2
Model: 27-2587 CRN C The Maxwell

Created: 6/29/2020 14:21:29
Locked:
Closed:

15 of 52

Opt. Finished Basement (Rec) Room/Hall

Flooring 9252 DY 16787 -Dynasty Tex-MYSTIC BEIGE-40 oz
Poly***STD***

Comment

Master Bedroom

Flooring 9252 DY 16787 -Dynasty Tex-MYSTIC BEIGE-40 oz
Poly***STD***

Comment

Bedroom 2

Flooring 9252 DY 16787 -Dynasty Tex-MYSTIC BEIGE-40 oz
Poly***STD***

Comment

Bedroom 3

Flooring 9252 DY 16787 -Dynasty Tex-MYSTIC BEIGE-40 oz
Poly***STD***

Comment

Bedroom 4

Flooring 9252 DY 16787 -Dynasty Tex-MYSTIC BEIGE-40 oz
Poly***STD***

Comment

Ensuite 4

Cabinet Colour/Style 9166 Viking III-CHARLESTON-ORCHID-3DL ***STD***

Countertop 8801 P-344 LM-Countertop-INUKSHUK GREY-Arborite
STD

af
nu

NOAMAN ZAHEER/MUNNAZA NOAMAN
Project: Wallaceston
Unit: 257, Phase: 2
Model: 27-2587 CRN C The Maxwell

Created: 6/29/2020 14:21:29
Locked:
Closed:

16 of 52

Countertop Edge	1111	N/A *****
Cabinet Hardware	7667	12881-HARDWARE ***STD***
Floor Tile	8264	TR.ST.SRK.1313-Serpentine-Syrak/Charcoal-13x13 See Tile Line Pattern on Sketch 7 Page 29 ***STD***
Floor Tile Grout	7704	Grout-(19) Pearl Gray ***STD***
Floor Tile Pattern	3000	STANDARD SQUARE ***STD***
Plumbing Fixture (colour)	1737	Plumbing Fixtures-WHITE ***STD***
Wall Tile	9020	QT.WV.WHT.0810-Weave-White-8 x 10 ***STD***
Wall Tile Grout	2226	Grout-(00) White ***STD***
Wall Tile Pattern	3090	VERTICAL STACKED ***STD*** 
Comment		

Master Ensuite

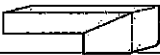
Cabinet Colour/Style	9166	Viking III-CHARLESTON-ORCHID-3DL ***STD***
Countertop	9121	MSI Quartz GROUP 1 ICED WHITE 3/4 inch with double mitre edge ***1***
Countertop Edge	4006	GROUP 1 - DOUBLE MITRE 1 1/2 INCH ***2*** 
Cabinet Hardware	7667	12881-HARDWARE ***STD***
Floor Tile	8262	TR.ST.GRY.1313-Serpentine-Grey-13x13 See Tile Line Pattern on Sketch 7 Page 29 ***STD***
Floor Tile Grout	7704	Grout-(19) Pearl Gray ***STD***
Floor Tile Pattern	3000	STANDARD SQUARE ***STD***

ag
mm

Customer Colours

NOAMAN ZAHEER/MUNNAZA NOAMAN
Project: Wallaceton
Unit: 257, Phase: 2
Model: 27-2587 CRN C The Maxwell

Created: 6/29/2020 14:21:29
Locked:
Closed:

17 of 52

Shower Floor Tile	8103	OD.ON.SWT.02.HEX.MT-ONTARIO HEXAGON MATTE-SNOW WHITE ***2***
Shower Floor Tile Grout	2226	Grout-(00) White ***STD***
Shower Floor Tile Pattern	1111	N/A *****
Shower Wall Tile	8258	TR.ST.GRY.0810-Serpentine-Grey-8 x 10 ***STD***
Shower Wall Tile Grout	7704	Grout-(19) Pearl Gray ***UPG***
Shower Wall Tile Pattern	3090	VERTICAL STACKED ***STD*** <div><div></div><div></div><div></div><div></div><div></div><div></div><div></div><div></div></div>
Shower Jamb(s) and Sill(s)	8923	Shower Jamb / Sill-Thassos White ***STD***
Plumbing Fixture (colour)	1737	Plumbing Fixtures-WHITE ***STD***
Comment	9167	

Shared Bathroom

Cabinet Colour/Style	9167	Viking III-CHARLESTON-RAIN CLOUD-3DL ***STD***
Countertop	8796	6698-46-Countertop-PALOMA POLAR ETCHINGS FINISH-Formica ***STD***
Countertop Edge	1111	N/A *****
Cabinet Hardware	7667	12881-HARDWARE ***STD***
Flooring	7667	GE.BY.AZR.1313 New Byzantine Azzuro 13
Floor Tile Grout	7705	Grout-(01) Alabaster ***UPG***
Floor Tile Pattern	3000	STANDARD SQUARE ***STD***
Wall Tile	5420	QT.SP.DGR.0810-Splendour-Dark Grey-8 inch x 10 inch ***STD***

✓
mu

NOAMAN ZAHEER/MUNNAZA NOAMAN
Project: Wallaceston
Unit: 257, Phase: 2
Model: 27-2587 CRN C The Maxwell

Created: 6/29/2020 14:21:29
Locked:
Closed:

18 of 52



Wall Tile Grout 2226 Grout-(00) White ***STD***

Shared Bathroom Floor Tile Pattern 3090 VERTICAL STACKED ***STD***

Plumbing Fixture (Colour) 1737 Plumbing Fixtures-WHITE ***STD***

Shower Floor Tile 8661 OD.ON.SWT.0202.MT.N-Ontario Series Mosaic-Snow White Matte-2 x 2 ***STD***

Shower Floor Tile Grout 2226 Grout-(00) White ***STD***

Shower Floor Tile Pattern 3000 STANDARD SQUARE ***STD***

Shower Jamb(s) 8923 Shower Jamb / Sill-Thassos White ***STD***

Comment

Opt. Shower Floor Tile 8661 OD.ON.SWT.0202.MT.N-Ontario Series Mosaic-Snow White Matte-2 x 2 ***STD***

Shower Floor Tile Grout 2226 Grout-(00) White ***STD***

Shower Floor Tile Pattern 3000 STANDARD SQUARE ***STD***

Shower Wall Tile 8257 TR.ST.BYZ.0810-Serpentine-Beyaz/White-8 x 10 ***STD***

Shower Wall Tile Grout 2226 Grout-(00) White ***STD***

Shower Wall Tile Pattern 3090 VERTICAL STACKED ***STD***

Shower Jamb(s) 8923 Shower Jamb / Sill-Thassos White ***STD***

Cabinet Colour/Style 6261 Viking III-MANCHESTER-OYSTER CL-MAPLE ***STD***

Countertop 8796 6698-46-Countertop-PALOMA POLAR ETCHINGS FINISH-Formica ***STD***

✓

me



NOAMAN ZAHEER/MUNNAZA NOAMAN
Project: Wallaceton
Unit: 257, Phase: 2
Model: 27-2587 CRN C The Maxwell

Created: 6/29/2020 14:21:29
Locked:
Closed:

19 of 52

Countertop Edge	1111	N/A *****
Cabinet Hardware	7667	12881-HARDWARE ***STD***
Flooring	8261	TR.ST.BYZ.1313-Serpentine-Beyaz/White-13x13 See Tile Line Pattern on Sketch 4 Page 26 ***STD***
Floor Tile Grout	7705	Grout-(01) Alabaster ***UPG***
Floor Tile Pattern	3000	STANDARD SQUARE ***STD***
Plumbing Fixture (Colour)	1737	Plumbing Fixtures-WHITE ***STD***
Comment		

Great Room Fireplace

Type	8869	Majestic MERC32 ***STD***
Mantle	1435	NF 15-Paint Grade Mantle- Flat (Per Plan)-WHITE ***STD*** PAGE 30
Surround Opt.	1111	N/A *****
Note	1111	Purchasers have been advised: heat from the FP can damage TV above a FP and items placed on mantle.
Note	1111	Heathwood and its contractors will not be liable for any damage on items placed/installed above a FP after closing.
Comment		

Basement Stairs

Type	1714	Carpet Grade Stairs ***STD BASEMENT STAIRS***
Colour	7922	Eclipse (Pewter) STAIN TO COMPLIMENT HARDWOOD AND WILL VARY FROM FLOORING ***99***
Carpet Runner	1111	N/A *****
Handrail/Pickets/Post Type	9119	Handrail only on closed walls (one or two sides per building code) ***STD***
Handrail/Pickets/Post Colours	7762	Carpet Grade-Stain handrail, stringers, nosing _post(s). (Me
Carpet	9252	DY 16787 -Dynasty Tex-MYSTIC BEIGE-40 oz Poly***STD***

ay
m

NOAMAN ZAHEER/MUNNAZA NOAMAN
Project: Wallaceton
Unit: 257, Phase: 2
Model: 27-2587 CRN C The Maxwell

Created: 6/29/2020 14:21:29
Locked:
Closed:

20 of 52

Custom Stain/Paint	1111	N/A *****
Comment		

Main Stairs

Type	1712	Oak Stairs ***STD MAIN STAIRS***
Colour	7922	Eclipse (Pewter) STAIN TO COMPLIMENT HARDWOOD AND WILL VARY FROM FLOORING ***99***
Carpet Runner	1111	N/A *****
Handrail/Pickets/Posts Type	8148	Single Collar Alt. Plain w/ Shoes with 3 1/2" Square/Cap Post(s)-BLACK ***2***
Handrail/Pickets/Posts Colour	7761	Oak Grade-Stain handrail,stringers,treads,risers,nosingpost
Custom Stain/Paint	1111	N/A *****
Comment		

Throughout

Walls - Paint Colour	1717	22-Wall-WARM GREY ***STD***
Underpad	1079	500 Series-Underpad ***STD***
Thresholds	2232	Metal Thresholds ***STD***
Switches and Plug	5796	Decora White Switches and Plugs ***STD***
Trim Size	8705	4 1/4 Baseboard and 2 3/4 Casings ***STD***
Trim - Paint Colour	1716	Trim-WHITE ***STD***
Comment		



Purchaser:	2020-08-14		
NOAMAN ZAHEER	Date	Decor Consultant	Date

NOAMAN ZAHEER/MUNNAZA NOAMAN
Project: Wallaceton
Unit: 257, Phase: 2
Model: 27-2587 CRN C The Maxwell

Created: 6/29/2020 14:21:29
Locked:
Closed:

21 of 52



Purchaser:	<u></u>	<u>2020/08/14</u>	<u>Wallaceton</u>	<u></u>	<u>APPROVED</u>
	MUNNAZA NOAMAN	Date			
					-08- 19 2020





Sales Selection Sheet

Wallaceton

22 of 52
TEL:

PURCHASERS: NOAMAN ZAHEER and MUNNAZA NOAMAN

LOT / UNIT	PHASE	MODEL	
257	2	27-2587 CRN C The Maxwell	

It is herein understood and agreed between the undersigned parties hereto that the following changes shall be made to the above mentioned Agreement of Purchase and Sale in accordance with the agreement and except for such changes noted below, all other terms and conditions in the Agreement of Purchase and Sale shall remain as stated herein: It is further understood that and agreed that all changes and additions shall be installed as per builder's specifications, location and available selections. The Purchaser hereby agrees to purchase the following extras:

ADMIN FEE

1		Qty: (1)
28,645	Note: PROMO AND REFFRAL 10,500.00 SCHEDULE 'E' PAGE 2 OF 10	

APPLIANCES

2	SEE SPECS PAGES 37-52	Qty: 1
31,440	Note: SEE SPEC #	

Cabinetry

3 189,185 29,286	CABINETRY - 18H-BUILT-IN TALL APPLIANCE CABINET WITH DRAWER(S) BELOW FOR PANEL-MOUNT, PROUD, OR TRIMKIT INSTALLATIONS (TRIM KIT REQUIRED, SUPPLY ALL SPECS AND INSTALLATION GUIDES) (COUNTER DEPTH) - UPGRADE 1 Note: SEE SPEC PAGE# 37-52 INCL. STD. GAS STOVE SPEC PAGES 37-38	Qty: 1
4 189,236 30,254	CABINETRY - 19B-45CM WIDE PULL-OUT DOOR BASE CABINET WASTE/RECYCLE CENTRE WITH SOFT-CLOSE ([2] 35L BINS) (AVAILABLE ONLY WITH 45CM WIDE CABINET) ; PRICE ALL THE SAME FOR ALL LINES - KITCHEN Note: TO BE INSTALLED IN THE ISLAND BESIDE THE SINK WITH TOP DRAWER SEE SKETCH # 5 AND 6 PAGE# 27 AND 28	Qty: 1
5 188,994 30,257	CABINETRY - 09B-TOP DRAWER PRICE (PER DRAWER) (METABOX STANDARD LEVELS 1-7, TANDEMBOX STANDARD LEVELS 8-13) - UPGRADE 1 Note: KITCHEN; ON EACH SIDE OF THE FRIDGE SKETCH #5 AND 6 PAGES 27 AND 28	Qty: 2
6 189,325 30,286	CABINETRY - 40J-TWO-TONE COLOUR/STYLE SELECTION FOR ISLAND (MUST BE OF EQUAL OR LOWER LEVEL TO MAIN Note:	Qty: 1
7 189,005 30,868	CABINETRY - 12B-POTS AND PANS DRAWERS (WIDTH MIN. 60CM/MAX. 90CM) (SIZE SUBJECT TO FLOOR PLAN) - UPGRADE 1 Note: SEE SKETCH # 5 AND 6 PAGE# 27 AND 28	Qty: 2
*8 189,316 31,441	CABINETRY - 12J-VALANCE (PER 8 foot LENGTH PRICE) (FOR CLARIFICATION OF STYLES SEE MOULDING MATRIX) (LIGHT VALANCE IS NOW APPROXIMATELY 2" [50MM] HIGH. PLEASE ENSURE LIGHT FIXTURES USED WILL BE CONCEALED BY THE VALANCE.) ; Note: PRICE ALL THE SAME FOR ALL LINES - KITCHEN	Qty: 2

Ceramics

9 188,191 28,646	CERAMICS - FLOOR - FOYER - UPGRADE 5 Note:	Qty: 1
------------------------	---	--------

Initials: m nn



Sales Selection Sheet
Wallaceton

23 of 52
TEL:

PURCHASERS: NOAMAN ZAHEER and MUNNAZA NOAMAN

LOT / UNIT 257	PHASE 2	MODEL 27-2587 CRN C The Maxwell	
-------------------	------------	------------------------------------	--

Ceramics

10 188,194 28,647	CERAMICS - FLOOR - INSTALL IN SPECIFIC PATTERN - FOYER - PATTERN Note: OFFSET 1/2 x 2/3 BRICK PATTERN	Qty: 1
11 187,978 30,200	CERAMICS - FLOOR GROUT - FOYER - GROUT Note:	Qty: 1
12 187,980 30,201	CERAMICS - FLOOR GROUT - GARAGE ENTRY / MUD ROOM - GROUT Note:	Qty: 1
13 187,979 30,202	CERAMICS - FLOOR GROUT - POWDER ROOM - GROUT Note:	Qty: 1
14 187,982 30,278	CERAMICS - FLOOR GROUT - LAUNDRY ROOM - GROUT Note:	Qty: 1
15 188,176 30,281	CERAMICS - SHOWER FLOOR - ENSUITE MASTER - UPGRADE 2 Note:	Qty: 1
16 187,975 30,282	CERAMICS - SHOWER WALL AND CEILING GROUT - ENSUITE MASTER - GROUT Note:	Qty: 1
17 187,983 30,283	CERAMICS - FLOOR GROUT - SHARED ENSUITE - GROUT Note:	Qty: 1
18 187,986 30,284	CERAMICS - FLOOR GROUT - OPTIONAL BASEMENT BATHROOM - GROUT Note:	Qty: 1

ELECTRICAL

19 32,358	RECREATION ROOM- ADDITIONAL OUTLET TO BE AT STANDARD HEIGHT FROM FLOOR SEE SKETCH # 4 PAGE 26 Note: REVISED FROM ORIGINAL SKETCH # 1 PAGE 7 OF 10 SHOWING 70" +/- FROM FLOOR	Qty: 1
------------------	--	--------

Granite

20 188,294 30,255	GRANITE - COUNTERTOP - 3/4" GROUP 2 WITH MITRE EDGE - KITCHEN / ISLAND - UPGRADE 2 Note:	Qty: 1
21 188,307 31,450	GRANITE - COUNTERTOP WITH 4" BACKSPLASH - 3/4" GROUP 1 WITH MITRE EDGE - ENSUITE MASTER - UPGRADE 1 Note:	Qty: 1

Initials: DL JUE



Sales Selection Sheet
Wallaceton

24 of 52
TEL:

PURCHASERS: NOAMAN ZAHEER and MUNNAZA NOAMAN

LOT / UNIT 257	PHASE 2	MODEL 27-2587 CRN C The Maxwell	
-------------------	------------	------------------------------------	--

HARDWOOD

22 31,449	5" WHITE red OAK HARDWOOD IN POWDER ROOM LANDING Note: PRICE DIFFERENCE FROM 3" HARDWOOD	Qty: 1
23 188,340 31,457	HARDWOOD - VINTAGE - 5" RED OAK UVF OIL - STUDY - UPGRADE 1 Note:	Qty: 1
24 188,370 31,458	HARDWOOD - VINTAGE - 5" RED OAK UVF OIL - KITCHEN - UPGRADE 1 Note:	Qty: 1
25 188,332 31,459	HARDWOOD - VINTAGE - 5" RED OAK UVF OIL - GREAT ROOM - UPGRADE 1 Note:	Qty: 1
26 188,336 31,460	HARDWOOD - VINTAGE - 5" RED OAK UVF OIL - DINING ROOM - UPGRADE 1 Note:	Qty: 1
27 188,365 31,462	HARDWOOD - VINTAGE - 5" RED OAK UVF OIL - UPPER HALL - UPGRADE 1 Note:	Qty: 1

Heating/Air

*28 189,474 32,357	HEATING/AIR - ROUGH-IN GAS LINE FOR GAS STOVE AT MAIN FLOOR (SEE SPECS) (HOOK-UP NOT INCLUDED) LEAVE STANDARD 120 VOLT ELECTRICAL OUTLET ON A SEPARATE CIRCUIT. * STANDARD 220V TO BE RELOCATED TO BUILT-IN OVEN LOCATION SEE SKETCH # 5, 6 PAGE 27, 28 Note:	Qty: 1
--------------------------	---	--------

Interior Railing

*29 188,376 28,619	INTERIOR RAILING - BLACK METAL - SINGLE COLLAR ALT. PLAIN W/ SHOES WITH 3 1/2" SQUARE/CAP POST(S) ASPER PLAN - THOUGHOUT - UPGRADE 2 Note:	Qty: 1
--------------------------	--	--------

Mirrors/Glass Pro

30 188,378 31,456	MIRRORS/GLASS PRODUCTS - UPGRADE TO FRAMELESS CLEAR GLASS WITH D-RING HANDLE IN CHROME - ENSUITE MASTER Note:	Qty: 1
-------------------------	---	--------

STRUCTURED WI

31 32,359	RECREATION ROOM- ADDITIONAL TELEPHONE /DATA CAT 5E AS PER SSS PAGE 5 OF 10 TO BE INSTALLED AT STANDARD PLUG HEIGHT FROM FLOOR SEE SKETCH # 4 PAGE 26 Note: REVISED FROM ORIGINAL SKETCH # 1 PAGE 7 OF 10 AT 70" +/- FROM FLOOR	Qty: 1
--------------	--	--------

Initials: DDZ/LE



Sales Selection Sheet

Wallaceton

25 of 52

PURCHASERS: NOAMAN ZAHEER and MUNNAZA NOAMAN

TEL:

LOT / UNIT 257	PHASE 2	MODEL 27-2587 CRN C The Maxwell	
-------------------	------------	------------------------------------	--

Sub Total

HST

Total

1. This Sales Selection Sheet when properly executed forms part of our Agreement of Purchase and Sale.
2. All extras and upgrades listed above are subject to Construction Progress and Architectural and Municipal requirements.
3. In the event the Vendor is unable to incorporate the work approved above in the construction of the house for any reason whatsoever, the Vendor will not be liable to the Purchaser in any way. The monies paid for any changes or optional extras not proceeded with shall be returned to the Purchaser, without interest. The cost of options or extras is non-refundable in all other circumstances. If for any reason whatsoever the Agreement of Purchase and Sale is not completed, the total cost of work approved above will be retained by the Vendor.
4. The Vendor reserves the right to substitute above materials and equipment with that of equal or better quality.
5. Purchaser acknowledges that items may not be exactly as shown. Variations from the Vendor's samples may occur in finished materials due to normal production processes. Vendor is not responsible for shade difference which may occur from different dye lots or wood grains. Variations from the Vendor's samples will occur with natural materials such as wood, marble, granite, hardwood and brick.
6. The Vendor reserves the right to select Grout & Thresholds that best suits the Tile selected.
7. Selections will not be processed unless signed by Heathwood Homes Head Office.
8. The selections made on this schedule are final and cannot be changed once submitted.
9. The Purchaser has checked and acknowledges the accuracy of this schedule.

Payment Summary

Paid By

Amount

Total Payment:

PURCHASER:

Signature on file
NOAMAN ZAHEER

19-Aug-20

DATE

IRIT SALEM
Decor Consultant

19-Aug-20

DATE

PURCHASER:

MUNNAZA NOAMAN

19-Aug-20

DATE

APPROVED

-08- 19 2020

Date Approved Heathwood Homes (Huron) Limited

TAX#:1

PREPARED BY: Irit Salem

PE 334-4

S\invoice.rpt 28may19

UK-75 WALLACETON
LOT 257
27-2587 CRN ELE C
THE MAXWELL

26 of 52 THE MAXWELL

ELEVATION C | 2,600 SQ. FT.

735 sq. ft. of opt. finished Lower Level

27-2587 ELEV. C

Sketch #4

ELECTRICAL OUTLET
AND PHONE/DATA CAT 5E
AT STANDARD HEIGHT FROM FLOOR

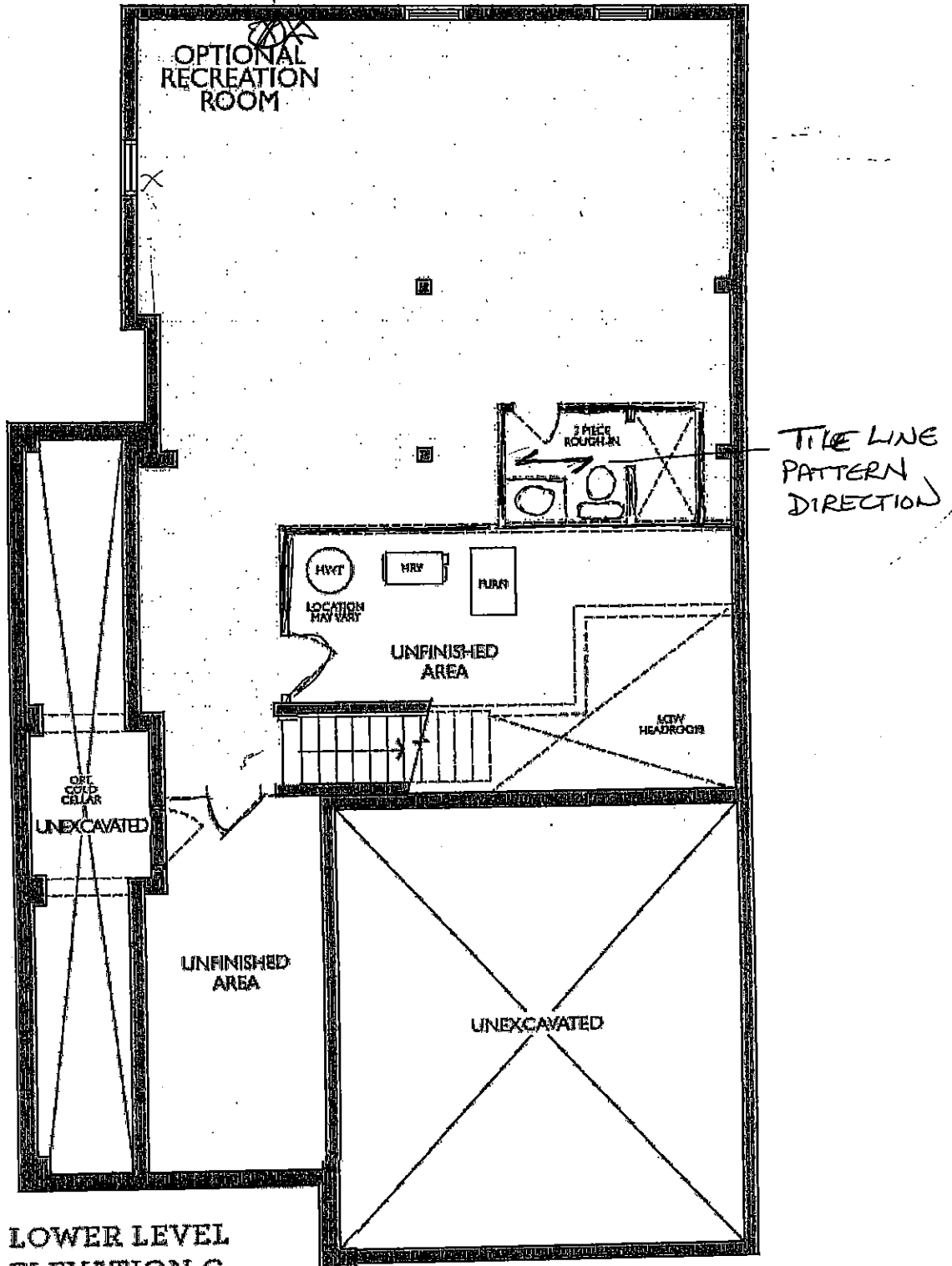

mm 2/

27 of 52
THE MAXWELL

ELEVATION C | 2,600 SQ. FT.

735 sq. ft. of opt. finished Lower Level

27-2587 ELEV. C

Sketch #5

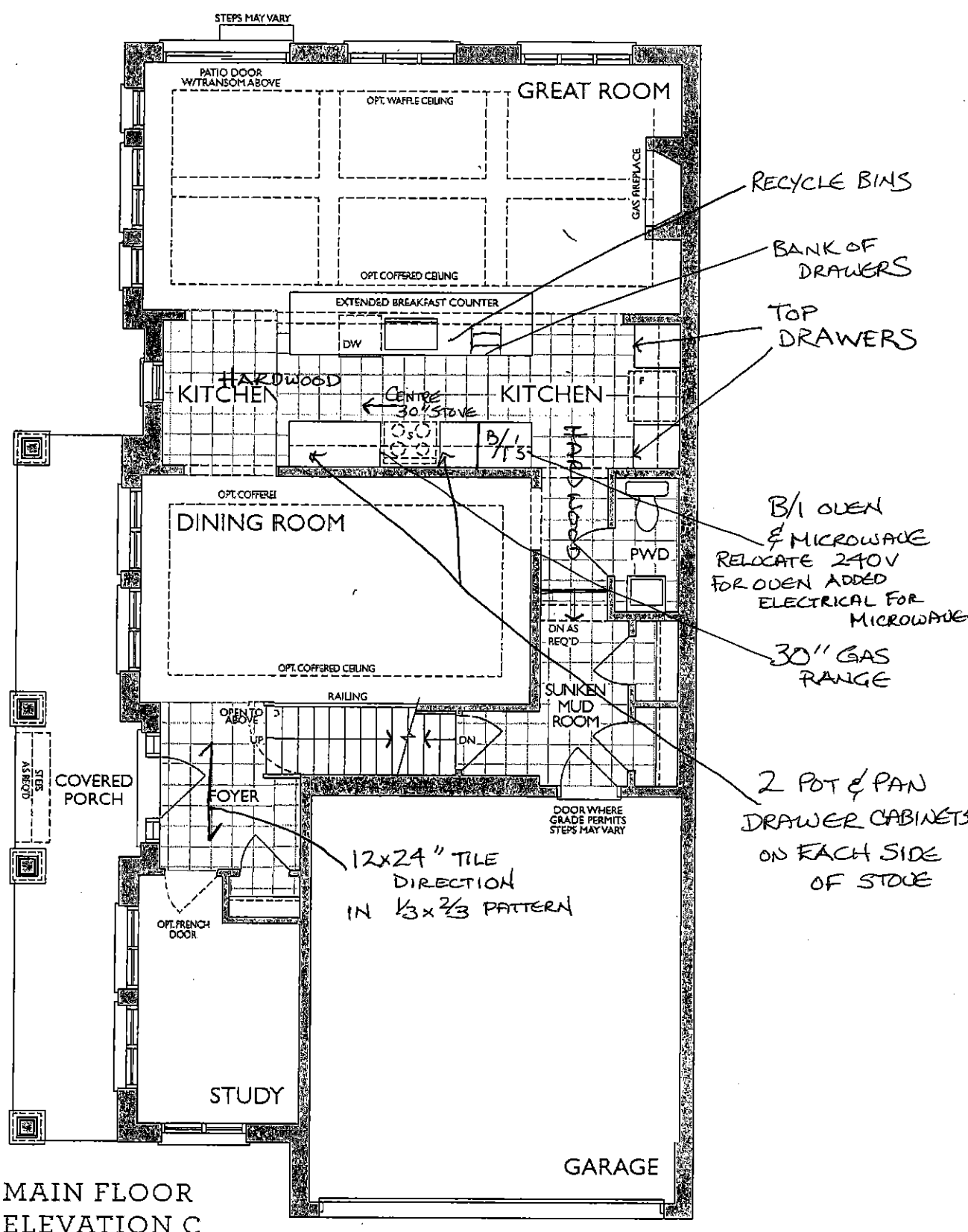

MAIN FLOOR
ELEVATION C

see also

KITCHEN
(GROUND FLOOR)

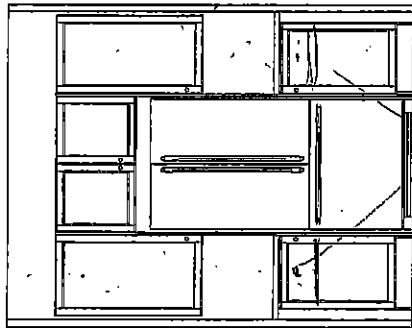

2 TOP DRAWERS

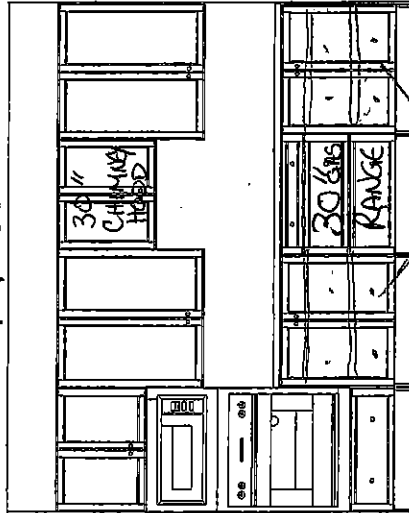

2 POT & PAN DRAWERS

① MASTER ENSUITE
(2ND FLR)

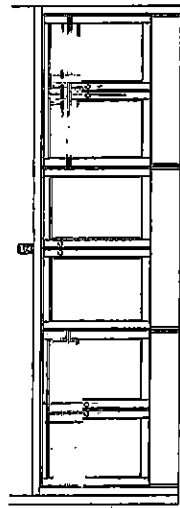

(OPT. DBL SINK V90+VT90+V90)

10/23/2019

OPT. BASEMENT BATH

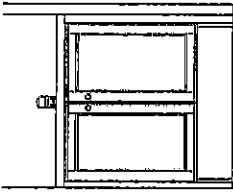

OPT. LAUNDRY UPPERS
OPT. LAUNDRY BASE
(2ND FLR)

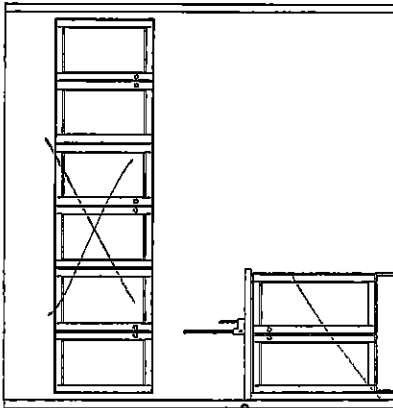

2 POT & PAN DRAWERS

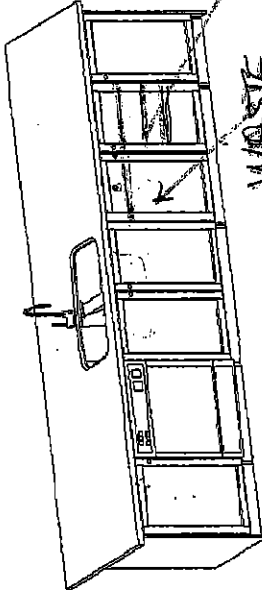

STD BANK OF DRAWERS

WASTE
RECYCLE BINS

SHARED BATH A (2ND FLR - ELEV. A) OR ALT. SHARED BATH B (2ND FLR - ELEV. B) ALT. SHARED BATH C & D (2ND FLR - ELEV. C)

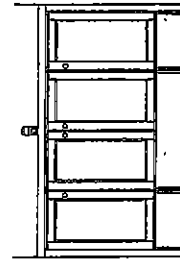
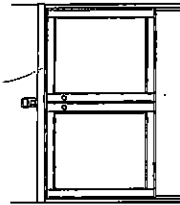
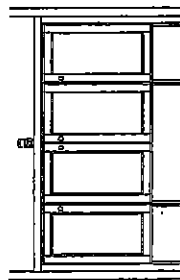
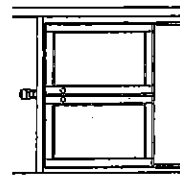

aym



FRENDEI
KITCHENS LIMITED
1350 Stawson Drive, Mississauga, ON L4W 1C5

UK-75 WALLACETON
LOT 257
27-2587 CRN ELEV. C

THE MAXWELL
HEATHWOOD HOMES
WALLACETON, KITCHENER
MODEL: 27-2587 CRN (310)

STANDARD CONTRACT INCLUDES:

Appliance Openings

- Hood Opening: 30"W Chimney h
- Fridge Opening: 37 3/8 "W X 73 3
- Fridge cabinet & gables: 66cm D
- Stove Opening: 30" Freestanding
- Dishwasher Opening: 24"

Standard Kitchens Scope:

- 100cm H wall cabinets
- Std. Blumotion Hinges- soft close doors
- Std. Metabox Drawers- not soft close
- Min 40cm W drawer
- Base pie cut corner cabinets
- Backing on all cabinets
- Countertop by others
- Upgrade applied paneled fridge & dishwashers supply only (appliance hardware by others)

Standard Vanity & Laundry Scope:

- Powder by others, pedestal
- Master Ens. - Top by others
- Remaining vanities inc. laminate top
- Std. Blumotion Hinges- not soft close
- Std. Metabox Drawers- not soft close
- Master Ens: Top drawers (Sink Full height)
- Mains: Full height doors (top drawers added if Masters can't accommodate)
- Optional laundry base & wall cabinets

THIS DRAWING IS FOR DESIGN PURPOSES ONLY.
IT IS NOT AN EXACT RENDITION.

Sketch #6

28 OF 52

UK - 75 WALLACETON
LOT 257
27-2587 CRN ELEV. C
THE MAXWELL

29 of 52
THE MAXWELL

ELEVATION C | 2,600 SQ. FT.

735 sq. ft. of opt. finished Lower Level

27-2587 ELEV. C

Sketch #7

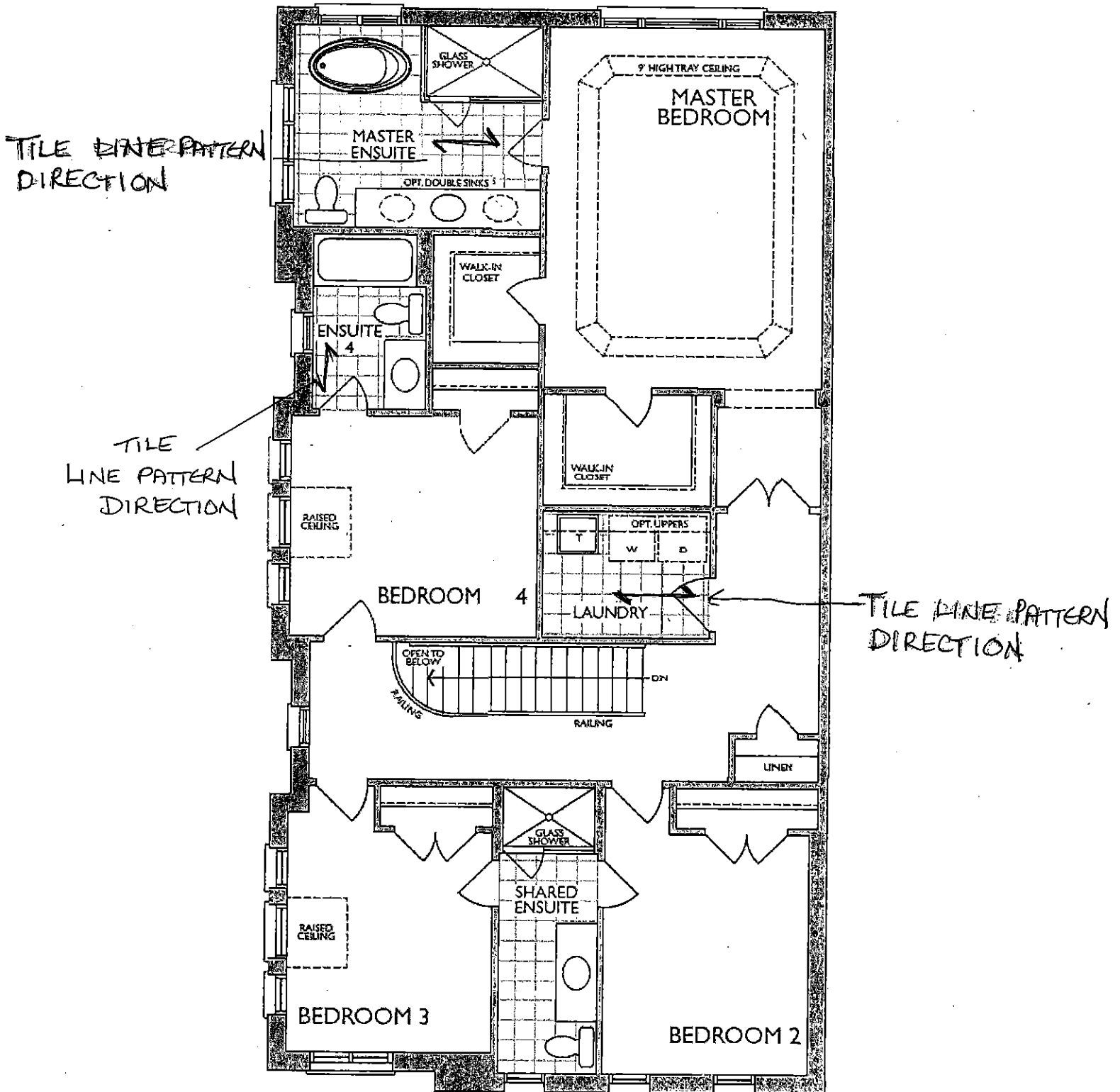

SECOND FLOOR
ELEVATION C

mu ay

UK-75 WALLACETON
LOT 257
27-2587 CRN ELEV. C
THE MAXWELL

30 of 52

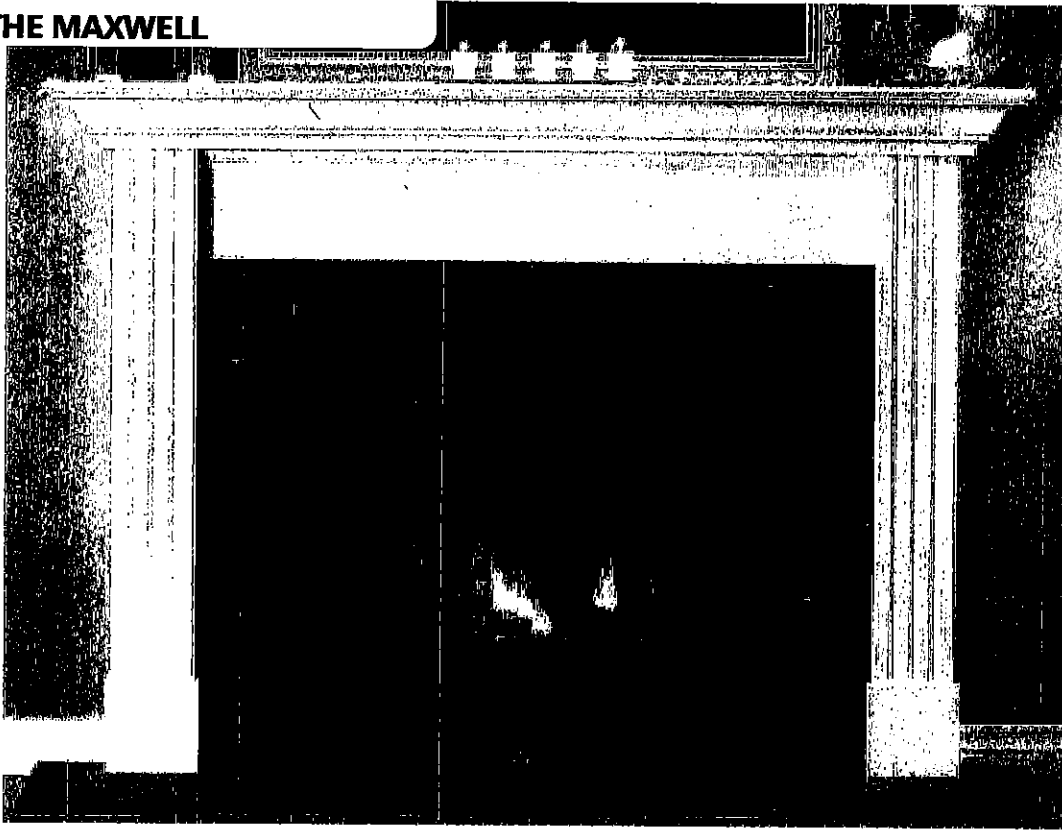

STANDARD NF 15 Mantel

Clean apron finish with fluted legs

WHITE PAINT GRADE FINISH

(PICTURE SHOWN WITH UPGRADE SURROUND AND HEARTH -PRICED SEPARATELY)

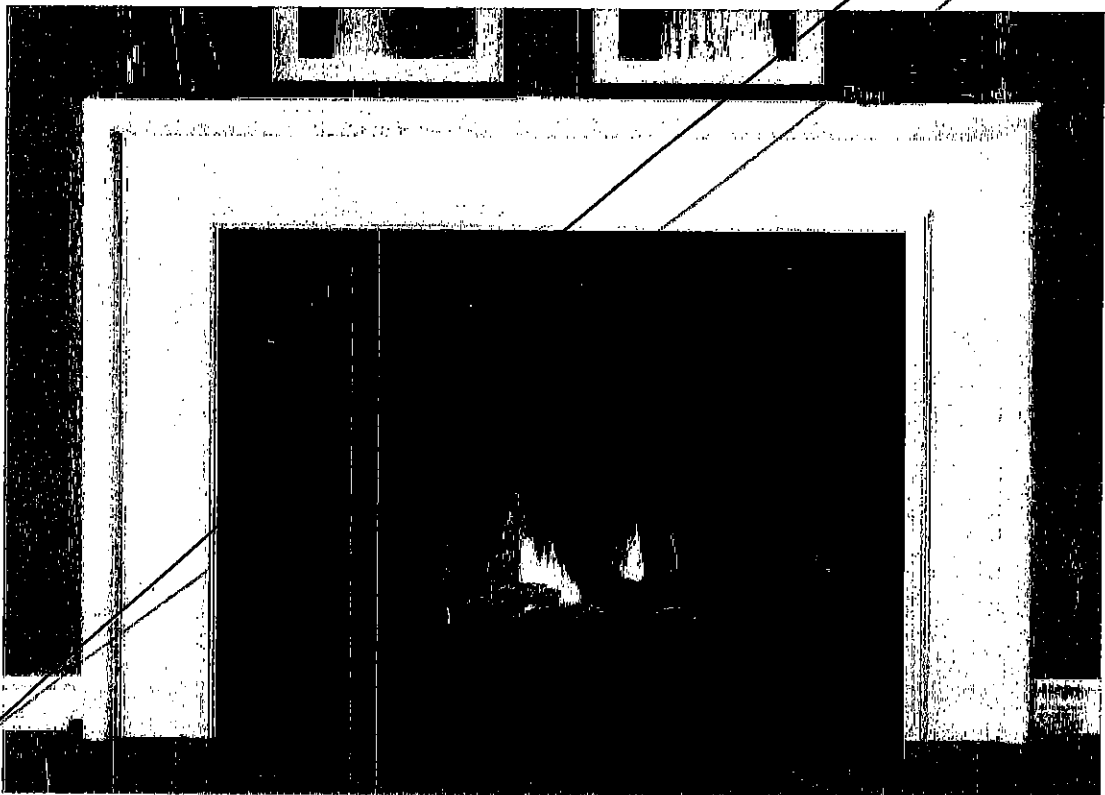

STANDARD NF 17 Mantel

WHITE PAINT GRADE FINISH

(PICTURE SHOWN WITH UPGRADE SURROUND AND HEARTH -PRICED SEPARATELY)

un B

UK - 75 WALLACETON
LOT 257
27-2587 CRN ELEV. C
THE MAXWELL

31 of 52

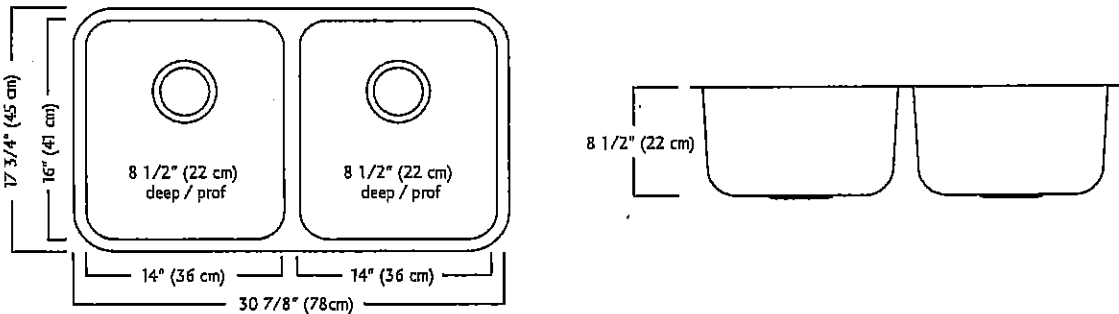
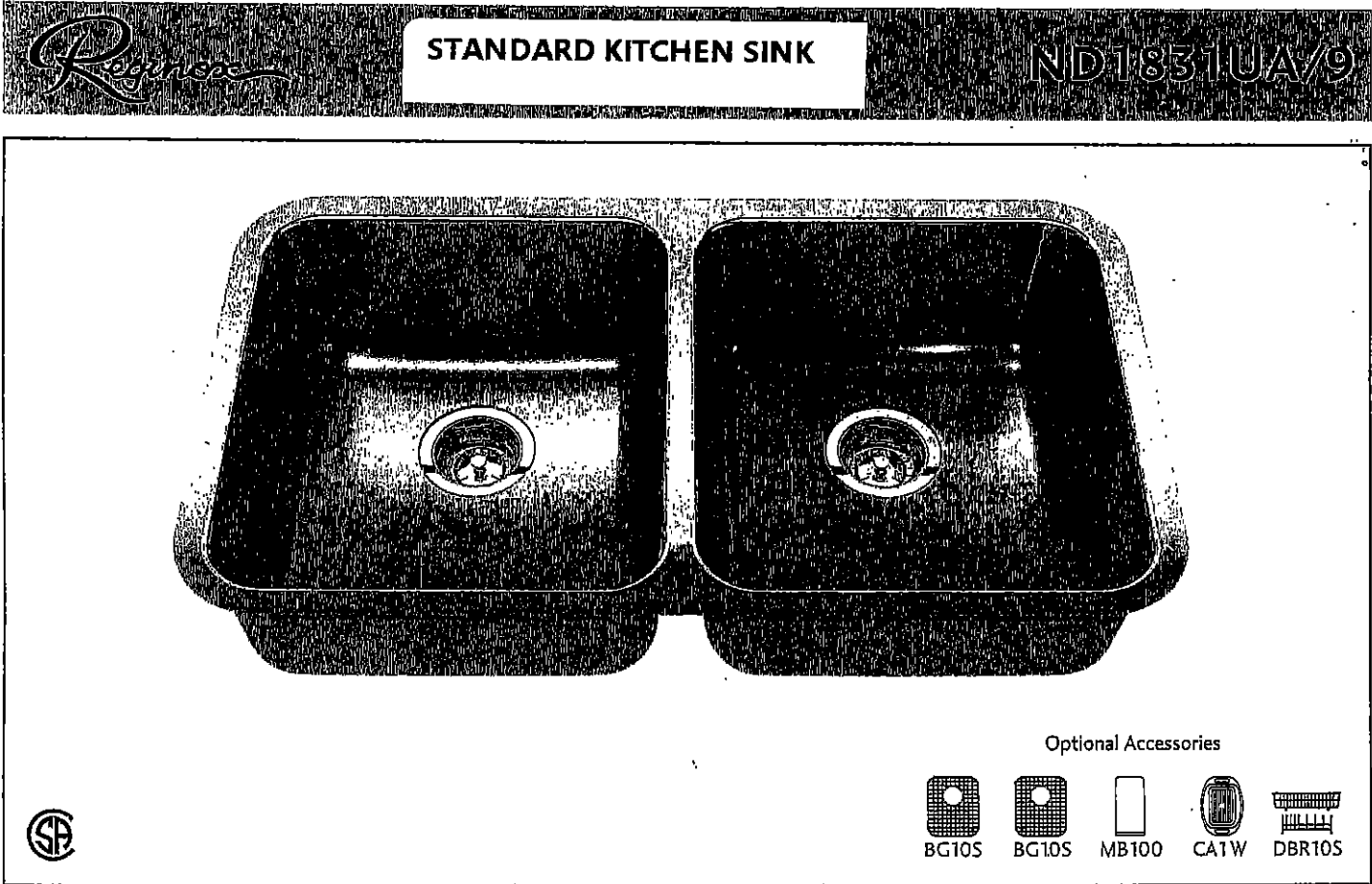

ND1831UA/9 SPECIFICATION

Model ND1831UA/9 is a double (two equal size) bowl undermount sink manufactured by Franke Kindred Canada Limited from 18 gauge stainless steel. Product has silk finished rims and linear brush finished bowls. Sink is fully undercoated. Basket strainer waste fittings (3 1/2", 89 mm) are included. Sink is backed with a limited lifetime warranty.

- O.D. 17 3/4" x 30 7/8" x 8 1/2" (45 x 78 x 22 cm)
- Recommended for minimum 36" cabinet

Franke Kindred Canada Limited
P.O. Box 190, 1000 Franke Kindred Road, Midland, Ontario, Canada, L4R 4K9 Phone: 866-687-7465 Fax: 800-361-8408

UK-75 WALLACETON
LOT 257
27-2587 CRN ELEV. C
THE MAXWELL

32 of 52

STANDARD KITCHEN FAUCET

Align

Modern

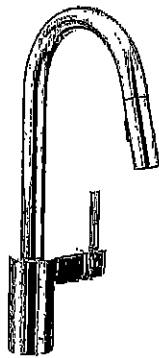

Single Handle Pull-Down Kitchen
Faucet*

Model 7565†

Handwritten signature or initials.

UK-75 WALLACETON
LOT 257
27-2587 CRN ELEV. C
THE MAXWELL

33 of 52

American Standard
Style That Works Better

 BARRIER FREE

OVALYN™ UNDERCOUNTER SINK

- Classic oval undermount sink
- Made from vitreous china
- Front overflow
- Supplied with mounting kit (047194-0070A) and template

☐ 0496.221 Unglazed rim
489 x 413mm
(19-1/4" x 16-1/4")

Bowl size:
432mm (17") wide
356mm (14") front to back
140mm (5-1/2") deep

OVALYN™
UNDERCOUNTER SINK
VITREOUS CHINA

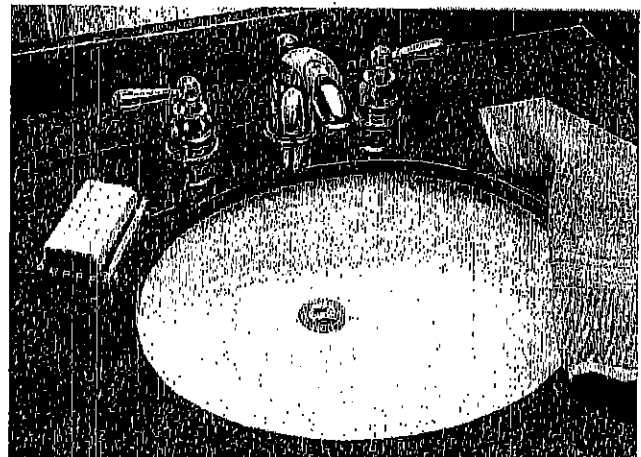

Compliance Certifications -
Meets or Exceeds the Following Specifications:
• ASME A112.19.2M for Vitreous China Fixtures
• CAN/CSA B45 series

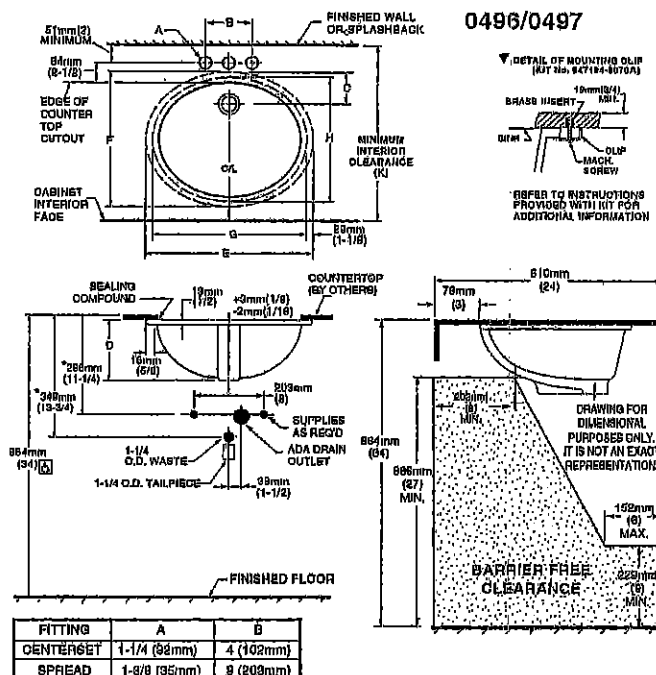

Handwritten signature

UK-75 WALLACETON
LOT 257
27-2587 CRN ELEV. C
THE MAXWELL

34 of 52

Chateau

Transitional

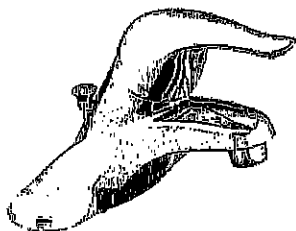

Lavatory Faucet with Pop-Up Drain
Model L4621†

VANITY SINKS AND PEDESTAL



Posi-Temp® Pressure Balancing Tub/Shower
Model 62320 / TL183†

OR

Posi-Temp Valve and Tub/Shower Trim
with Eco-Performance Easy Clean® XL

Model 62320 / TL183EP†

(TL183EP not available in BC)

SHOWER AND 5' TUB FAUCETS



2 Handle Roman Tub with 9" Spout
Model 4796 / T990†

FREESTANDING TUB FAUCETS

Mr. [Signature]

UK-75 WALLACETON
LOT 257
27-2587 CRN ELEV. C
THE MAXWELL

35 of 52



Buy it for looks. Buy it for life.®

There is more than 1 version of this model.
Page down to identify the version you have.

DESCRIPTION

- Metal construction with various finishes identified by suffix
- 1/2" IPS connections
- Includes metal or 50/50 pop-up type waste assembly where noted

OPERATION

- Pivot action lever style handle
- Temperature controlled through 100° degree arc of handle travel

FLOW

- Water usage is limited to these maximum flow rates as indicated by the corresponding product markings
 - 1.2 gpm max (4.5L/min) at 60 psi
 - 1.5 gpm max (5.7L/min) at 60 psi

CARTRIDGE

- 1255™ Duralast™ cartridge
- Nonmetallic/nonferrous and stainless steel material

STANDARDS

- Third party certified to WaterSense®, ASME A112.18.1/CSA B125.1 and all applicable requirements referenced therein
- Certified to NSF 61/9 & 372
- Products marked with 1.2 gpm are compliant with California water efficiency regulations
- Complies with California Proposition 65 and with the Federal Safe Drinking Water Act

- ADA  for lever handle

WARRANTY

- Lifetime limited warranty against leaks, drips and finish defects to the original consumer purchaser
- 5 year warranty if used in commercial installations

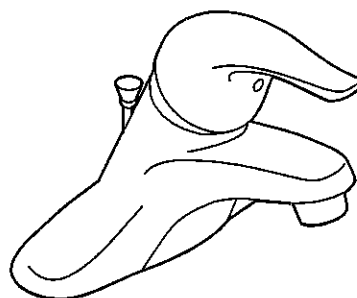

CHATEAU®
Single-Handle Lavatory Faucet

with Metal Waste Assembly
Models: L4621 series

Bulk Pack Models (12 Per Carton):
L64620 series

with 50/50 Waste Assembly
Bulk Pack Model (12 Per Carton): L64621 series

Less Waste
Model: L4601 series

Bulk Pack Model (12 Per Carton):
L64601 series

NOTE: THIS FAUCET IS DESIGNED TO BE
INSTALLED THRU 3-1" DIA. HOLES, 2" ON CENTER

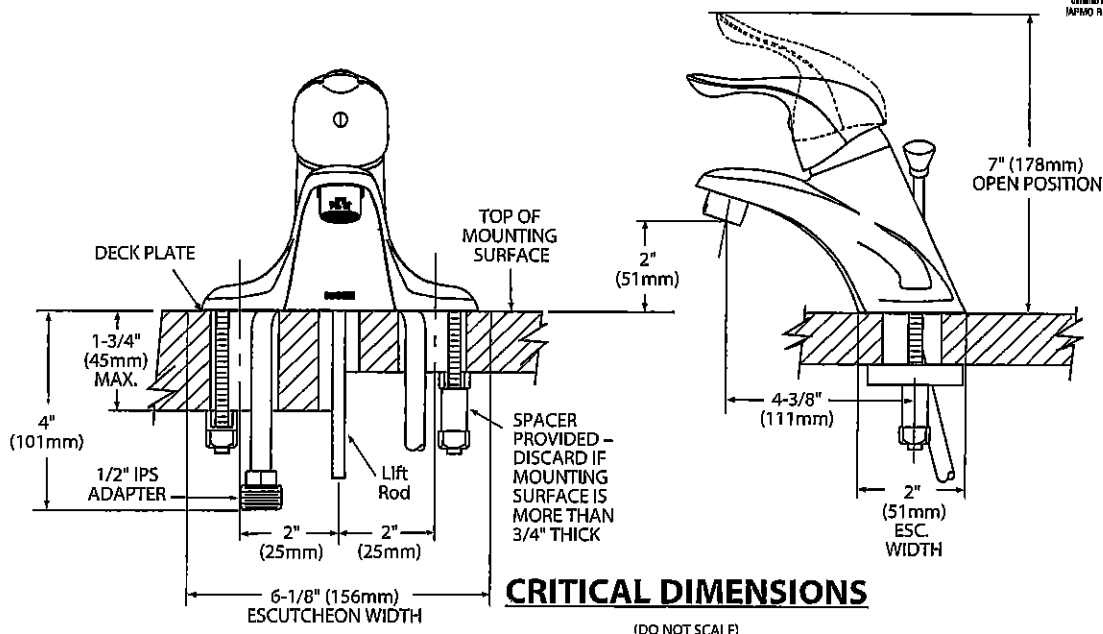

Rev. 1/16

FOR MORE INFORMATION CALL: 1-800-BUY-MOEN
www.moen.com



FOR THE WAY IT'S MADE®
FOR THE MAXIMUM VALUE

MODEL: KVWB600DSS

30-In. Width | Wall-Mount Canopy | 600 CFM Motor

This 3-speed vent hood has power to effectively vent an output of up to 65K BTUs. Auto speed sensing keeps the vent at the proper fan speed by sensing the amount of heat coming from the cooktop. This 30-inch wall-mount canopy hood has both LED and halogen lights to brighten almost any work area.

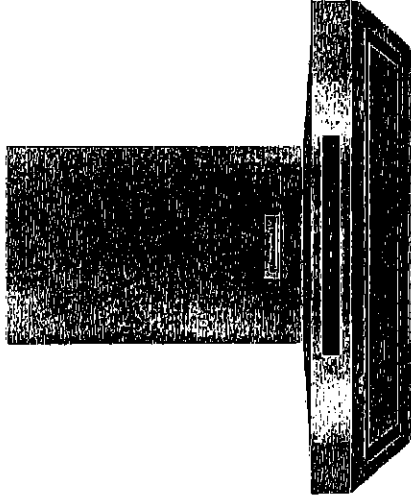

PRODUCT FEATURES

- 600 CFM/65K BTU Threshold
- Allows installation over any KitchenAid regular 30-inch range or cooktop, and some commercial-style cooking surfaces with outputs up to 65K BTU
- Perimeter Ventilation
- Increases ventilation system efficiency by pulling air from the edges of the hood and speeding up the movement of air at the center, allowing it to efficiently handle up to a 65K BTU total output
- Auto Speed Setting
- Takes the guesswork out of protecting cabinets from steam, grease, and moisture by automatically adjusting fan speed to ventilation needs depending on the heat being produced
- LED Task Lights
- Provide extra lighting over the cooking surface to help in the cooking process
- Halogen Night Lights
- Enhances the style of the ventilation system by providing soft, accent lighting in the kitchen

PERFORMANCE

Duct Outlet Type Round
Duct Outlet Size 6"

ELECTRICAL

15amp, 60 Hz, 120 V.

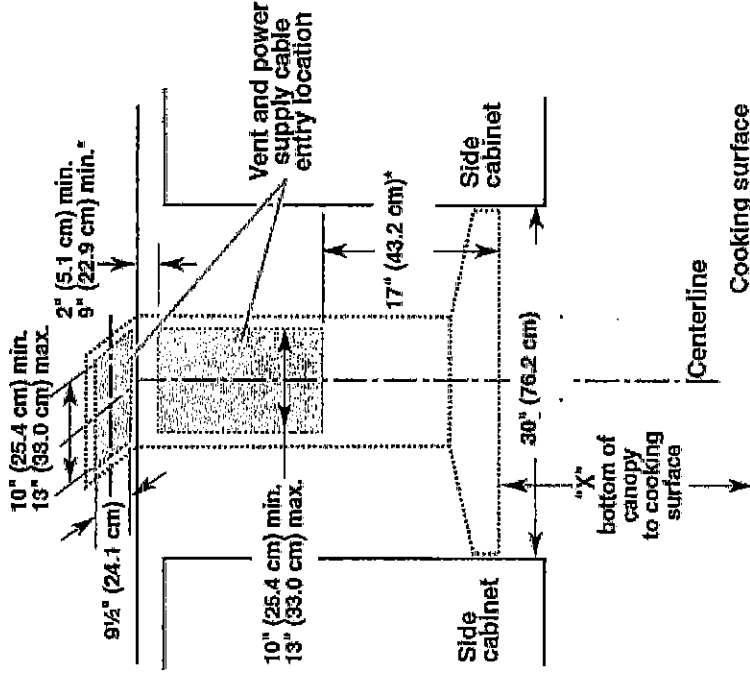

*For non-vented (recirculating) installations

IMPORTANT:

- Minimum distance "X": 24" (61.0 cm) from electric cooking surface.
- Minimum distance "X": 27" (68.6 cm) from gas cooking surfaces.
- Suggested maximum distance "X": 36" (91.4 cm)

*For non-vented (recirculating) installations

**For vented installations

36 of 52

UK-75 WALLACETON
LOT 257
27-2587 CRN ELEV. C
THE MAXWELL

37 of 52

Café™ 30" Slide-In Front Control
Gas Convection Range

CGS700P4MW2 / CGS700P3MD1 (CGS700P2MS1)

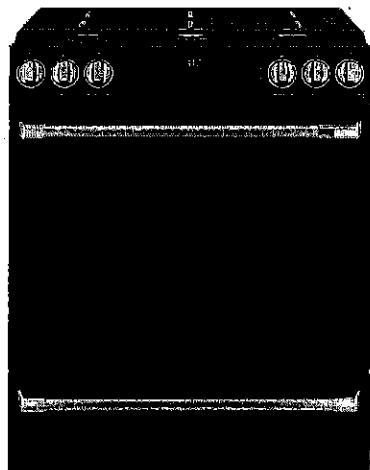

ALSO
AVAILABLE IN



CGS700P2MS1
Stainless Steel with
Brushed Stainless
handles and knobs

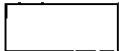

CGS700P4MW2
Matte White with
Brushed Bronze
handles and knobs



FEATURES & BENEFITS

Expansive six-burner cooktop helps you entertain with ease - Entertaining for large groups is easy with the industry's first six burner, edge-to-edge cooktop that can accommodate cookware of all sizes and a cast-iron integrated griddle that provides enough room to perfectly flip crab cakes, arepas and other crowd favorites

Enjoy total control in the kitchen and beyond - Control your oven with your smart device or simply your voice using WiFi Connect

Share favorite creations with your favorite people - Create an unforgettable dinner, using a 21K tri-ring burner to do everything from searing scallops to simmering a lemon caper white wine sauce and a 15K power boil burner to boil water quickly for al dente angel hair pasta

Precise control delivers consistently delicious results - Achieve perfectly even desserts with accurate heat circulation thanks to True European Convection with Precise Air

Prepare foods to perfect doneness - Get roasts and meats just right with a temperature probe that lets you monitor progress without opening the oven door

An attractive appearance at all times - Every detail of your kitchen is designed to delight, thanks to a sleek backlit glass touch control panel that visually disappears when not in use and wakes up when prompted

Create a look that matches your personal style - Select any combination of premium finishes and hardware options to create a stunning look customized to any owner's taste

Never scrub racks - Easily remove everything from heavy roasts to delicate desserts with never scrub racks that stay in the oven during the self-clean cycle

Allow your appliances to interact with one another - Create a chef-like experience with Chef Connect, which can synchronize your appliance clocks and surface lights and vent when a range burner is in use, and even your microwave and range clocks

APPEARANCE

Cooktop Burner Grate Color	Matte Black
Oven Door Features	Big Clear View Oven Window; Matte Black Frameless Oven Door
Handle	Professional Style; Customizable; Consumer Removable
Handle Design	Café
Control Knobs	Weighted Stainless Steel Appearance

FEATURES

Configuration	Range with Storage Drawer
Cooking System	True Convection
Cooking Technology	Convection
Oven Cleaning Type	Self-Clean with Steam Clean Option
Burner - Left Front	21,000 BTU Tri-ring Burner
Burner - Left Rear	5,000 BTU Precise Simmer
Burner - Right Front	15,000 BTU
Burner - Right Rear	12,000 BTU
Burner - Center	9,500 BTU Front / 9,500 BTU Rear
Cooktop Burner Type	Sealed
Cooktop Surface	Deep Recessed; Porcelain-Enamel; Gray
Dishwasher Safe Knobs	Yes
Control Location	Front controls
Control Type	Backlit; Glass Touch
Valves (Degree of Turn)	270

Oven Control Features	Audible Preheat Signal; Automatic Oven Timer (Time Bake); Auto Oven Shut-Off; Auto Self Clean; Certified Sabbath Mode; Chef Connect; Control Lock Capability; Delay Bake Option (Time Bake); Delay Clean Option; DigiPad Numeric Entry; Electronic Clock and Timer; Front Controls; In-Oven Broiling; Temperature Probe; Self-Clean Cool Down Time Display
-----------------------	--

Oven Cooking Modes	Baked Goods (No Preheat); Convection Bake; Convection Roast; Frozen Pizza Multi Rack (No Preheat); Frozen Pizza Single Rack (No Preheat); Frozen Snacks Multi Rack (No Preheat); Frozen Snacks Single Rack (No Preheat); Proof; Warming
--------------------	---

Cooktop Burner Grate Features	Heavy-Cast Edge-to-Edge Grates
-------------------------------	--------------------------------

Cooktop Burner Grate Material	Cast-Iron
-------------------------------	-----------

Cleaning Time	Variable with Delay Clean Option
---------------	----------------------------------

Self-Clean Oven Door Lock	Automatic
---------------------------	-----------

Oven Rack Features	3 Self-Clean Oven Racks; 6 Rack Positions
--------------------	---

Fuel Type	Natural Gas (factory set)
-----------	---------------------------

Ignition System	Electronic
-----------------	------------

Leveling System	4 Leveling Legs
-----------------	-----------------

Style	Commercial
-------	------------

Oven Interior	1 Oven Interior Light; Black
---------------	------------------------------

Connected Capabilities	Amazon Alexa; The Google Assistant; IFTTT; Nest; Drop; Innit; DiGiorno
------------------------	--

WiFi Connect	Built-In
--------------	----------

CAPACITY

Total Capacity (cubic feet)	5.6 cu ft
-----------------------------	-----------

ACCESSORIES

Grates	Included Center Grate
Grill	Optional; Integrated Cast Iron; JXCGRILL1
LP Conversion Kit	Included
Trim Kit	Optional; JXFILLRIDD; JXFILLRISS
Griddle	Included; Integrated Cast Iron

WEIGHTS & DIMENSIONS

Depth with Door Open	47-1/2 in
Approximate Shipping Weight	244 lb
Net Weight	224 lb
Height to Top of Rear Vent Trim	37-3/8 in
Overall Height	37-3/8 in
Height to Cooking Surface (in.)	36-1/4 +/- 1/4
Overall Width	29-7/8 in
Cabinet Width	30 in
Overall Depth	29-1/2 in
Depth Without Handle	26-7/8 in
Oven Interior Dimensions (W x H x D) (in.)	24 x 19-1/2 x 20-5/8

C A F É

DISTINCT BY DESIGN™

mm 24

UK-75 WALLACETON
LOT 257
27-2587 CRN ELEV. C
THE MAXWELL

38 of 52

Café™ 30" Slide-In Front Control
Gas Convection Range

CGS700P4MW2 / CGS700P3MD1 / **CGS700P2MS1**



POWER / RATINGS

Convection Wattage	1200W
Top Burner BTU Rating - LP (000's BTU's)	(1) 18.0 Tri-Ring; (1) 15.0; (1) 12.0; (2) 9.5; (1) 5.0
Top Burner BTU Rating - Nat. Gas (000's BTU's)	(1) 21.0 Tri-Ring; (1) 15.0; (1) 12.0; (2) 9.5; (1) 5.0
Volts/Hertz/Amps	120v; 60Hz; 15A
Bake/Broiler BTU Rating - LP (000's BTU's)	16.0 Bake / 13.5 Broiler
Bake/Broiler BTU Rating - Nat. Gas (000's BTU's)	16.0 Bake / 16.5 Broiler

WARRANTY

Parts warranty	Limited 1-year entire appliance
Labor warranty	Limited 1-year entire appliance

DIMENSIONS AND INSTALLATION

Electrical Requirements: 120v; 60Hz, 15A

Installation Information: Before installing, consult
Installation Instructions packed with product for current
dimensional data.

For all installations, install the required rear trim to back
of range with 4 screws provided.

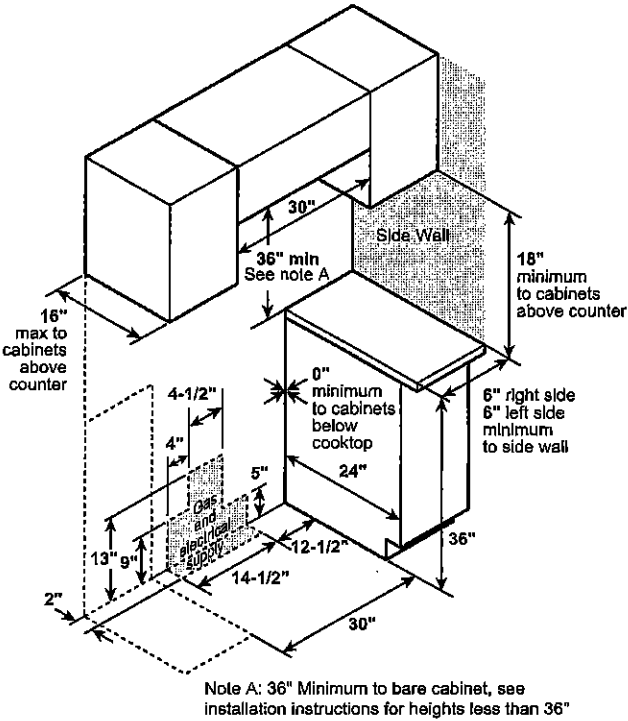
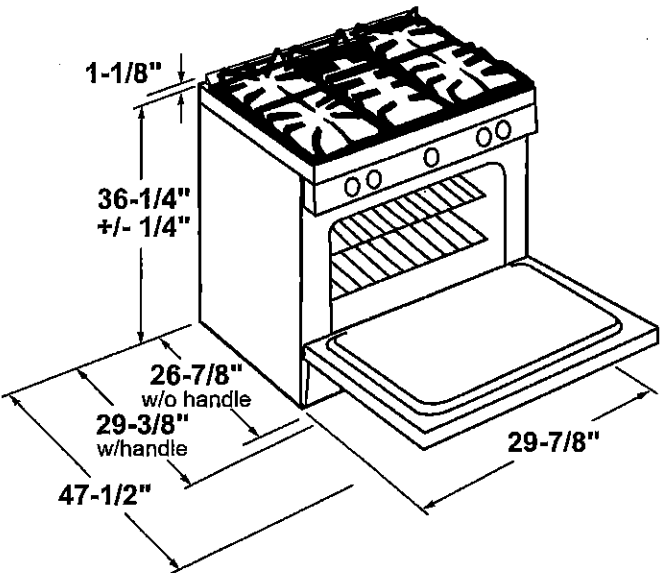

ADDITIONAL ACCESSORIES



CXFCGHKPMBZ
Brushed Bronze
2 handles; 6 knobs



CXFCGHKPMSS
Brushed Stainless
2 handles; 6 knobs



CXFCGHKPMBT
Brushed Black
2 handles; 6 knobs



CXFCGHKPMCU
Brushed Copper
2 handles; 6 knobs

Handwritten signature/initials.

UK-75 WALLACETON
LOT 257
27-2587 CRN ELEV. C
THE MAXWELL

39 of 52

Café™ Professional Series 30" Built-In
Single Electric Convection Wall Oven
CTS70DP2NS1 ✓

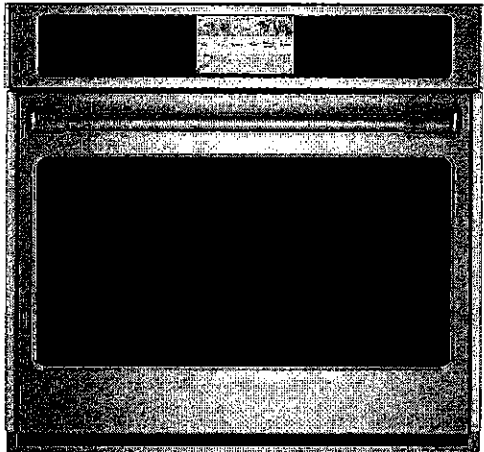

FEATURES & BENEFITS

Precision is the name of your cooking game - Confidently try new recipes and perfectly execute your favorites, using a smart system that automatically tracks progress, modifies temperatures and adjusts cook times

Brighten up life in the kitchen - Easily navigate wall oven settings using a stunning full color display that adds an unexpected touch of style to your kitchen

The perfect bake is now perfectly easy - Achieve unrivaled performance with the only system that delivers top-down true convection for consistent results on special occasion favorites like roasts, chicken, turkey and more

No preheat, no hassle - Save time with a variety of precision cooking modes that eliminate the need for preheating

Fried taste. Crisp texture. Less oil. - Make your favorite "fried" foods healthy, thanks to a mode that crisps without using oil for frying

Enjoy convenient temperature control from anywhere - Preheat while running errands or change oven temperatures while doing yard work with the Café Appliances Kitchen app

Create a look that matches your personal style - Select any combination of premium finishes and hardware options to create a stunning look customized to any owner's taste

The oven rack that handles it all - Easily remove heavy dishes with a roller rack that is specially designed to glide smoothly and stay in the oven during the self-clean cycle, so you never have to handle cumbersome racks again

The perfect fit you've always dreamed of - When you're updating your kitchen, attention to detail is a priority. That's why Café wall ovens are guaranteed for an exact fit or Café Appliances will pay up to \$300 toward modifications.

APPEARANCE

Color Appearance	Stainless Steel
Oven Door Features	Big View Oven Window
Handle	Café Pro Style; Brushed Stainless; Customizable
Installation	Above Warming Drawer; Undercounter; Under Cooktop; Side-by-Side; Under Built-In Advantium; Under Built-In Microwave

FEATURES

Configuration	Single Oven
Cooking System	True European Convection with Direct Air
Oven Cleaning Type	Self-Clean with Steam Clean Option
Cleaning Time	Variable with Delay Clean Option
Oven Cooking Modes	Convection Bake; Convection bake Multi-Rack; Convection Broil Hi/Lo; Convection Roast; Thermal Bake; Thermal Broil Hi/Lo; Hot-Air Frying; Keep Warm; Proof; Precision Cooking Modes; Scan-To-Cook
Self-Clean Oven Door Lock	Automatic
Control Type	7" Full-Color Touch LCD Screen
Oven Features	10-Pass Bake Element; 10-Pass Dual Broil Element; Closed Door Broiling
Oven Rack Features	1 Never Scrub Roller Rack; 1 Never Scrub Flat Rack; 6 Embossed Rack Positions
Oven Control Features	12-Hour Shut-Off Capability; Audible Preheat Signal; Auto Recipe Conversion; C° or F° Programmable; Certified Sabbath Mode; Control Lock Capability; Cook Time; Delay Time; Electronic Clock & Kitchen Timer; Temperature Probe
WiFi Connect	Built-In
Connected Capabilities	Amazon Alexa; The Google Assistant; IFTTT; Nest; Drop; Innit
Cooking Technology	Convection
Oven Interior	2 Halogen Interior Oven Lights; Black Gloss Finish; Hidden Bake

CAPACITY

Total Capacity (cubic feet)	5.0 cu ft
-----------------------------	-----------

POWER / RATINGS

Amp Rating at 208V	20
Amp Rating at 240V	20
Bake Wattage	2850W
Broiler Wattage	4300W
Convection Wattage	2400W
KW Rating at 208V	3.2
KW Rating at 240V	4.2

WEIGHTS & DIMENSIONS

Approximate Shipping Weight	177 lb
Net Weight	161 lb
Overall Height	28-5/8 in
Overall Width	29-3/4 in
Overall Depth	26-3/4 in
Cabinet Width	30 in
Cutout Dimensions (w x h x d) (in.)	28-5/8 x 27-5/16 x 23-1/2
Oven Interior Dimensions (W x H x D) (in.)	25 x 17-3/8 x 20-1/4

OPTIONAL ACCESSORIES

30" Never Scrub Roller Rack	UXWORXR30
Large Broiler Pan	WB48X10056
60" Replacement Electrical Conduit	WB18T10581
72" Replacement Electrical Conduit	WB18T10578

mm 3

UK-75 WALLACETON
LOT 257
27-2587 CRN ELEV. C
THE MAXWELL

40 of 52

Café™ Professional Series 30" Built-In
Single Electric Convection Wall Oven
CTS70DP2NS1



WARRANTY

Parts warranty	Limited 1-year entire appliance
Labor warranty	Limited 1-year entire appliance
Warranty notes	See written warranty for full details

WITH MICROWAVE ABOVE

DIMENSIONS AND INSTALLATION INFORMATION

Single wall ovens are NOT approved for stacking above or below another single wall oven.

Wall coverings, countertops and cabinets surrounding the wall oven must be able to withstand a temperature of up to 200°F (94°C).

If the cabinet in which the wall oven is installed does not have a solid bottom, two braces or runners must be installed to support the weight of the oven. The runners and braces must support up to 220 lbs (99 kg).

Door handle protrudes 3" from door face. Cabinets and drawers on adjacent 45° and 90° walls should be placed to avoid interference with the handle.

ATTENTION INSTALLER: Electric wall ovens are NOT approved for installation with a plug and receptacle. They must be hard wired into an approved junction box.

IMPORTANT: Before installing, consult installation instructions packed with product for current dimensional data.

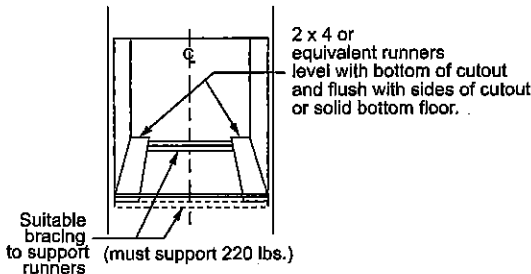
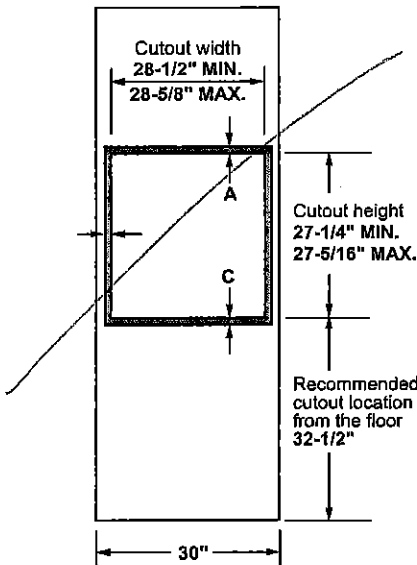
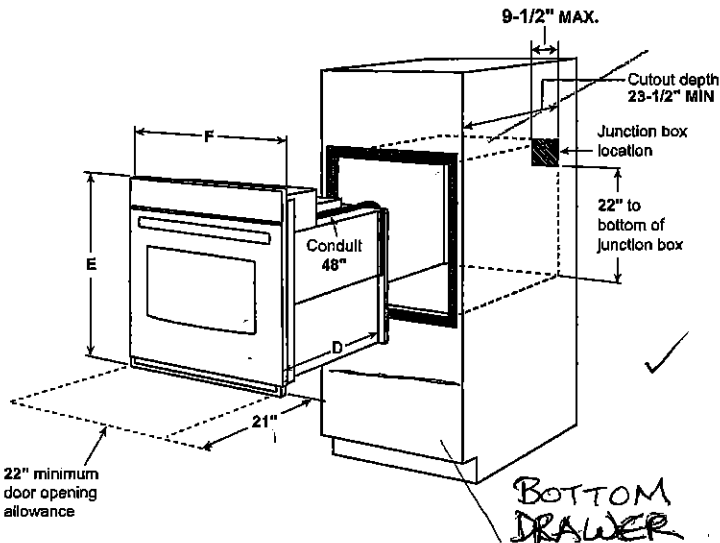

Cabinet	30"
A - Overlap of oven at top of cutout	1-1/4"
B - Overlap of oven other side of edge of cutout	3/4"
C - Overlap of oven at bottom of cutout	1-1/4"
Oven	
D - Install depth	23-1/2"
E - Overall height with trim	28-5/8"
F - Overall width	29-3/4"

Dimension and installation information are shown in inches.

For answers to your Café™ product questions, visit our website at cafeappliances.com.

Handwritten signature/initials.

UK-75 WALLACETON
LOT 257
27-2587 CRN ELEV. C
THE MAXWELL

41 of 52

Café™ Professional Series 30" Built-In
Single Electric Convection Wall Oven

CTS70DP2NS1

C A F É

DISTINCT BY DESIGN™

DIMENSIONS AND INSTALLATION INFORMATION

30" Single electric wall ovens are approved for installation below a countertop, and below certain gas and electric cooktops. Refer to the Approved Combinations Matrix available at cafeappliances.com for specific information.

30" Single electric wall ovens are approved for installation above 27" and 30" warming drawers.

ATTENTION INSTALLER: Electric wall ovens are NOT approved for installation with a plug and receptacle. They must be hard wired into an approved junction box.

IMPORTANT: Before installing, consult installation instructions packed with ALL products for current dimensional and combination data.

~~SIDE-BY-SIDE INSTALLATION
(TWO OVENS IN SEPARATE CUTOUTS)~~

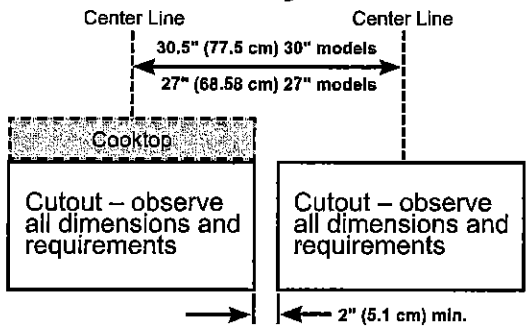

NOTE: One cooktop may be centered over either oven in the side-by-side installation.

~~INSTALLATION BELOW A COOKTOP~~

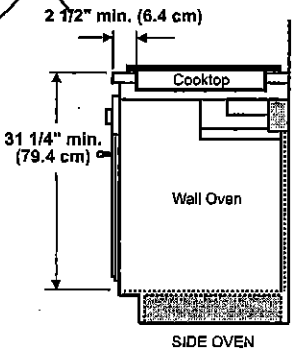

IMPORTANT: Maintain a minimum distance of 31 1/4" from the top surface of the countertop to the wall oven platform to ensure that the cooktop and wall oven do not interfere with each other (see picture).

~~UNDERCOUNTER INSTALLATION~~

Gas or Electric Cooktops May Be Installed Over This Oven. See Cooktop Installation Instructions for Cutout Size. See Label on Top of Oven for Approved Models.

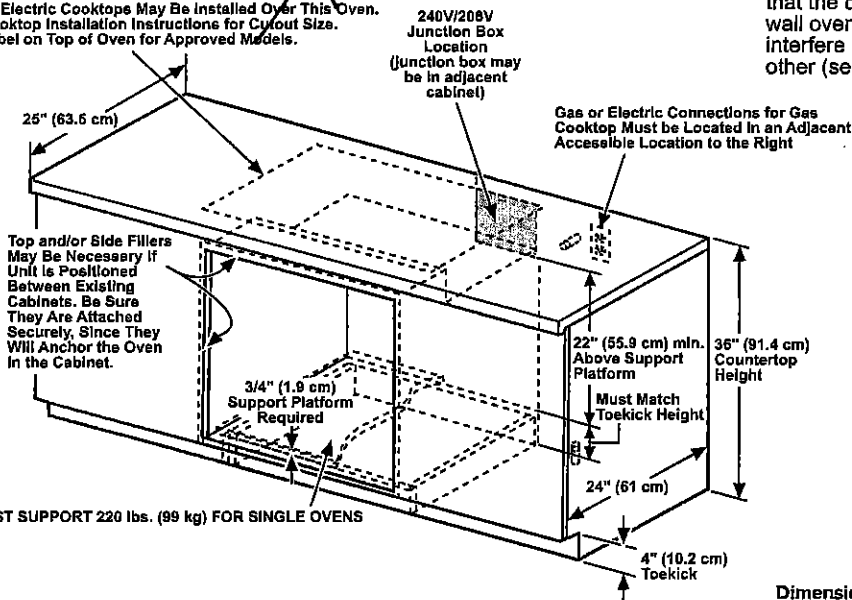

Dimension and Installation information are shown in inches.

ADDITIONAL ACCESSORIES



CXWS0H0PMBZ
Brushed Bronze
1 handle



CXWS0H0PMSS
Brushed Stainless
1 handle



CXWS0H0PMBT
Brushed Black
1 handle



CXWS0H0PMCU
Brushed Copper
1 handle

Handwritten signature.

UK-75 WALLACETON
LOT 257
27-2587 CRN ELEV. C
THE MAXWELL

MENTS ONLY - CALL TO BOOK

Tasco Appliances

Search here...

42.52

Home COOKING MICROWAVE BUILT-IN CGMO226NUF

FRIGIDAIRE GALLERY CGMO226NUF

FRIGIDAIRE
GALLERY

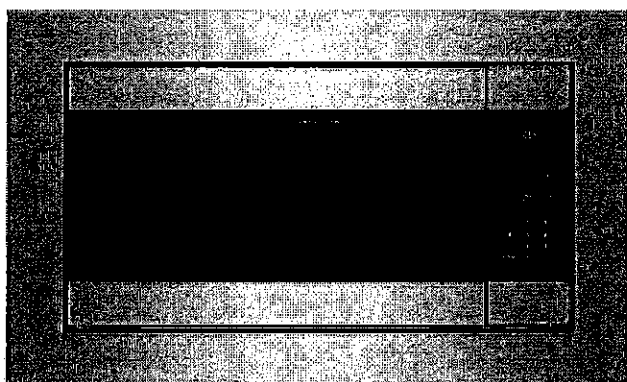

o o o o o

Frigidaire Gallery 2.2 Cu. Ft. Built-In Microwave

MSRP:

\$849

SALE Ends September 9, 2020:

-\$150

Tasco's Sale Price:

\$699

Extended Warranty

☐ 4 Year Product Protection

\$177

Total Price:

\$699

Add to compare

ADD TO CART

UK-75 WALLACETON
LOT 257
27-2587 CRN ELEV. C
THE MAXWELL

FIND LOCATION	
CONTACT US	

4352
OF

Available Colors



DETAILS & FEATURES

TECH SPECS

MANUALS

GENERAL SPECIFICATIONS

Product Weight (lbs)	44
Shipping Weight (lbs)	49
Power Type	Electric
Size	2.2 Cu. Ft.
Installation Type	Built-In
Collection	Frigidaire Gallery

AUTO FEATURE SPECIFICATIONS

Auto Cook Options	4 Options - Bacon Dinner Plate Frozen Entrée Rice
Defrost - Keep Warm	Yes
Auto Defrost Options	6 Options (Ground Meat Steaks/Chops/Fish Chicken Pieces Roast Casserole Soup)
Melt/Soften Options	4 Options - Melt Butter Melt Chocolate Soften Ice Cream Soften Cream Cheese
Auto Reheat Options	3 Options - Fresh Rolls Frozen Rolls Pasta
Snack Menu Options	4 Options - Frozen Microwave Pizza (6-8 oz.) Hot Dog 1-6 Meal in a Cup Frozen Kids Meal



MICROWAVE OVEN SPECIFICATIONS

Frequency (MHZ)	2450
-----------------	------

Handwritten signature

UK-75 WALLACETON
LOT 257
27-2587 CRN ELEV. C
THE MAXWELL
Watts

16.5"
1100

44 of 52

CAPACITIES

Total Capacity - Cu. Ft. 2.2

SENSOR FEATURE SPECIFICATIONS

Baked Potato	Yes
Chicken Nuggets	No
Popcorn Button	Yes
Reheat Button	Yes
Cook Options	4 Options - Frozen Entrees Ground Meat Fish/Seafood Chicken Breast
Snack Button	Yes
Vegetable Cook	Frozen and Fresh Veggies

USER MODES

On/Off Signal	On / Off
Auto Start	Yes
Child Lock	Yes
Clock	Yes
Language (Eng/Fr/Sp)	Yes
User Preferences	Yes
Selectable Weight (lb/kg)	Yes
Demo Mode	Yes

DIMENSIONS: EXTERIOR

Depth	19-5/8"
Height	13-5/8"
Width	24-7/16"



ELECTRICAL SPECIFICATIONS

Amps @ 120 Volts	14.2
Connected Load @ 120V	1.7
Connection Location	Right Rear Top
Voltage Rating	120V 60Hz

mm G

UK-75 WALLACETON
LOT 257
27-2587 CRN ELEV. C
THE MAXWELL

45 of 52

ProductLaunch NA
BrandFamilyFrigidaireGallery Yes

CONTROLS

Add 30 Seconds With Start pad
Numeric Touch Pad Yes
Power Levels High / 1-9
Quick Settings - Time Yes 1 - 9
Turntable On/Off No
Touch Pad Buttons 25
Display Type LED
Timer Function Yes
Electronic Clock Yes
Stop/Cancel Button Yes
Timer Format 99:99 (MM:SS)
Display Color White
Control Type Acrylic Touch
Start Button Yes with 30 sec add feature

INTERNAL DIMENSIONS

Microwave Interior Depth 19-1/8"
Microwave Interior Heigh 11-1/4"
Microwave Interior Width 17-7/8"

*While we place great care into preparing product descriptions and prices, sometimes technical and typographical errors or omissions may occur. Tasco Appliances cannot be held responsible for such errors and we apologize for any inconvenience this may cause.



Welcome
to Tasco Appliances! We're here
to help.

Privacy - Terms



46 of 52

Home > Appliances > Appliance Accessories > Microwave/Micro Hood Accessories > Frigidaire MWTK30FGUF

Frigidaire 30" Stainless Steel
Microwave Trim Kit - MWTK30FGUF

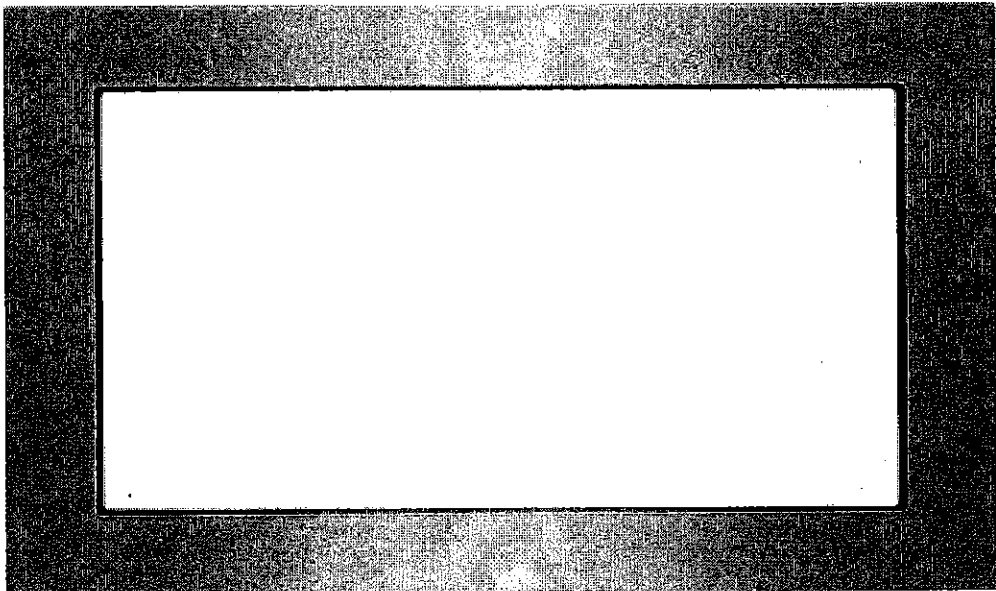

FRIGIDAIRE
Abt Model: MWTK30FGSS | UPC: 012505564246



Quick Specs

- Color : Stainless Steel
- Type : Trim Kit
- Height (inches) : 18
- Width (inches) : 30

What We Offer

-  Free Shipping on most orders over \$35
-  Low Price Guarantee
-  Free Tech Support

Available For Delivery 7 To 14 Days

◆ Low price guarantee

Color: Stainless Steel

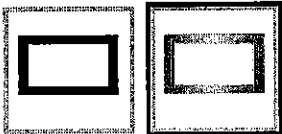

 Share

 Add To

 Print

Product Overview

Key Features

Built-In Trim Kit Allows For The Installation Of Microwaves To Be Built Into A Cabinet Or Wall,
Microwave Models: FGMO226NSS,Stainless Steel Finish,

Frigidaire 30" Stainless Steel Microwave Trim Kit - MWTK30FGUF

Features:

- Stainless Steel Trim Kit

47 of 52

Specifications:

- Built-In Trim Kit allows for the installation of microwaves to be built into a cabinet or wall by itself or over an electric wall oven
- Compatibility:
 - FGMO226NSS Microwave Oven

Please Note: For proper installation, please follow the manufacturer's specific dimensions with special attention to clearances, overlaps, and all other important instructions.

Included:

- Front Frame Assembly- QTY 1
- Exhaust Duct - QTY 1
- Bottom Mounting Rail - QTY 2
- Screw A- QTY11+3 extra
- Screw B - QTY 4 + 2 extra

Approximate Dimensions:

- Height: 18"
- Width: 30"
- Depth: 1-1/2"

Approximate Weight:

- Shipping: 20 lbs

California customers: Proposition 65 WARNING

Specifications	+
Guides & Documents	+
From The Manufacturer	+
Questions & Answers	+
Articles	+

What Our Customers Say About Us

See All Customer Testimonials

“

The communication and professionalism was OUTSTANDING. I will buy my next appliance from you.

August 3, 2020 - F. Andoh

© Copyright 1997-2020, Abt Electronics Inc. 1200 N. Milwaukee, Glenview, IL 60025

Sign up for our newsletter

Get \$25 off your next order of \$250 or more. Exclusions apply.

Enter email address

mm [Signature]

UK-75 WALLACETON

LOT 257

27-2587 CRN ELE C
THE MAXWELL

Outlet Center

Builders & Designers · Rebates

Free Nationwide

Live Chat · Help

Delivery*

FAQ

Se

Need help? 1-800-570-3355

Sign in

Order Status

Washers & Dryers Refrigerators Cooktops Dishwashers Outdoor Kitchens Air Conditioners Sinks & Faucets Smart Appliances Packages & Sale & Clearance

QUICKSHIP

Quick Ship

New items arriving daily!

Home > Refrigeration > Refrigerators > French Door Refrigerators > MFT2772HEZ

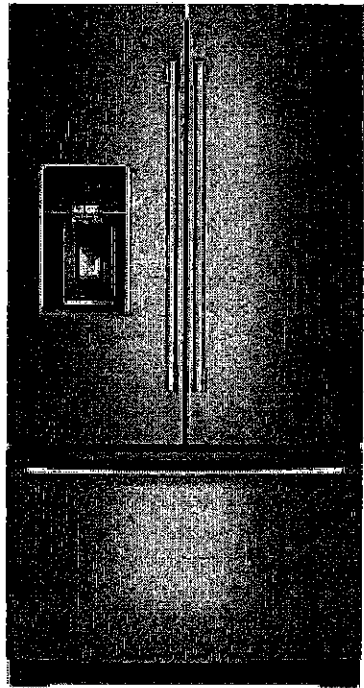

Image Disclaimer



Maytag MFT2772HEZ
36 Inch French Door Refrigerator with 27 cu. ft. Capacity, 5 Adjustable Shelves, 6 Door Bins, PowerCold Feature, Store-N-Door® Ice Dispensing, BrightSeries™ LED Lighting, FreshLock™ Crispers, External Dispenser and Fingerprint Resistant

★★★★☆ 4.5
Average rating of 49 reviews

quick specs

Refrigerator Capacity: 19.03 Cu. Ft.
Freezer Capacity: 7.77 Cu. Ft.
Total Capacity: 26.8 Cu. Ft.
Width: 35 11/16 Inch
Depth: 35 5/8 Inch
Depth with Door at 90°: 48 Inch
Height: 69 7/8 Inch
WiFi: No
Stainless Steel Interior: No
Fingerprint Resistant: Yes
No. of Shelves: 5
Gallon Door Storage: Yes
ADA Compliant: No
Water Dispenser: External
Sabbath Mode: No
Ice Maker: Yes

View more >

This item qualifies for free delivery!

List Price: \$2,887.00

SALE PRICE: \$2,593.30

You save \$293.70 (10%)

Additional Rebate(s): -\$50.00

As low as \$192.42/month with No Interest for 12 months. Learn More.

You will also need:

☐ 6 Foot Stainless Steel Refrigerator Waterline Kit + \$29.99

Qty 1

ADD TO CART

Lower Price in Cart - Ends Today!

Price Match Guarantee

Current Offers

Maytag - August & September Savings - Save Up to \$800 !

Protect Your Investment

☐ 3 Year In Home Service +\$139.99

☐ 5 Year In Home Service - 50% Cash Back! +\$229

☒ Decline Protection

Product Information
Brand: Maytag
Model: MFT2772HEZ
Appearance
Type: Freestanding
Style: French Door
Size: Full Size
French Door Style: 3 Door

Description
Specifications
Features
Rebates
Reviews
Specifications
Capacity
27 Cu. Ft.

Manuals & Guides
Energy Guide
user guide

UK-75 WALLACETON
LOT 257
27-2587 CRN ELE C
THE MAXWELL

Refrigerator with 27 cu. ft. Capacity, 5 Adj... Page 2 of 5

49 of 52

Double Freezer Drawers: No
Counter Depth: No
Glass Door: No
Freezer: Yes
Microfridge: No
Undercounter: No
Door Finish: Smooth
Accepts Custom Panels: No
Color: Stainless Steel
Door Color: Stainless Steel
Cabinet Color: Stainless Steel
Freezer Drawers: Single
Door Hinge Covers/Hidden Hinges: Yes
Rollers: No
Leveling Legs: No
Capacity
Refrigerator Capacity: 19.03 Cu. Ft.
Freezer Capacity: 7.77 Cu. Ft.
Total Capacity: 26.8 Cu. Ft.
Dimensions
Width: 35 11/16 Inch
Depth: 35 5/8 Inch
Depth without Door and Handles: 28 7/8 Inch
Depth without Handles: 33 1/4 Inch
Depth with Door at 90°: 48 Inch
Height: 69 7/8 Inch
Smart
WiFi: No
Features
Column: No
Stainless Steel Interior: No
Fingerprint Resistant: Yes
Refrigerator Features
Type of Shelves: Glass
No. of Shelves: 5
Slide-out Shelves: Yes
Spill Safe Shelves: Yes
Split Shelves: Yes
No. of Door Bins: 6
Adjustable Door Bins: Yes
Gallon Door Storage: Yes
Humidity Controlled Crispers: 3
Keurig Brewing System: No

Total Capacity:
Refrigerator19 Cu. Ft. Capacity:
Freezer7.7 Cu. Ft. Capacity:
Certifications
Energy StarYes Rated:
Electric Specifications
Amps: 20A
Volts: 115V
Warranty
Parts and10 Year Labor:
Dimensions and Weight
Width: 35 11/16"
Depth: 35 5/8"
Depth with48" Door Open 90:
Height: 69 7/8"
Shipping324 Lbs. Weight:

ku

UK-75 WALLACETON
LOT 257
27-2587 CRN ELE C
THE MAXWELL

50 of 52

Defrost: Automatic

No. of Baskets: 2

No. of Drawers: 1

Technical Details

Energy Star Rated: Yes

Star-K Certified: No

ADA Compliant: No

Approved for Commercial Use:
No

Approved for Medical Use: No

Approved for Outdoor Use: No

Amps: 15

Voltage: 115 Volts

Water

Water Dispenser: External

Hot Water Dispenser: No

Sparkling Water Dispenser: No

Water Filtration: Yes

Settings

Digital Temperature Control:
Yes

Sabbath Mode: No

Ice

Ice Dispenser: Yes

Ice Maker: Yes

Secondary Ice Maker: No

Warranty

Parts: 10

Labor: 1

GTIN

UPC: 883049473499

EAN: 0883049473499

ARE YOU A
BUILDER?

Contact us for
special pricing &
volume discounts

Get Quote

Shop By Category

 Cooking Appliances

 Laundry

Handwritten signature

UK-75 WALLACETON
LOT 257
27-2587 CRN ELEV. C
THE MAXWELL

51 of 52

Café™ Stainless Interior Built-In Dishwasher
with Hidden Controls

C A F É

CDT845P4NW2 / CDT845P3ND1 / CDT845P2NS1

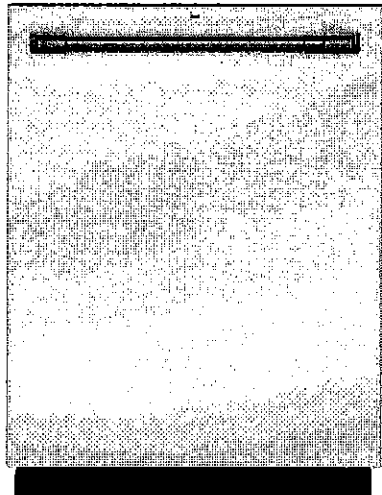

CDT845P4NW2
Matte White with Brushed
Bronze handle



ALSO
AVAILABLE IN



CDT845P3ND1
Matte Black with
Brushed Stainless
handle



CDT845P2NS1
Stainless Steel with
Brushed Stainless
handle

FEATURES & BENEFITS

Ultra-Wash & Dry – Unload sparkling clean, table-ready dishes thanks to our 90+ cleaning jets and an Ultra-Dry system that deliver excellent results

Loading Flexibility – Load the dishes your way: Our lower wash arm provides excellent coverage for the largest of loads. The fold down tines accommodate wide or oddly shaped items and our third rack provides extra space for your silverware and kitchen utensils

Adjustable Upper Racks – You'll have room for your finest stemware and space for tall bakeware with a rack that can be moved two inches up or down, creating ultimate loading flexibility

Wash Zones – Save time and use less water when you don't have a full dish load with a fully customizable cycle that lets you wash a true half load in the upper or lower rack

Steam + Sani - Eliminate the need to pre-wash dishes at the end of every meal, thanks to a Steam + Sani feature that easily loosens lingering traces of food with an added bonus of complete sanitization

Create a look that matches your personal style – Select any combination of premium finishes and hardware options to create a stunning look customized to any owner's taste

APPEARANCE

Door Style	Long Door with Top Controls
Installation	Side Installation or Top Installation Included; Built-Up Floor Capable; Flush Cabinet Installation
Door Appearance	Full-length flat door

FEATURES

Style	Built-In
Tub and Door Liner	Stainless Steel
Tub Type	Tall Tub
Control Type	Top Controls; Cap Touch Controls; 12 Touchpads
Dishwasher Control Features	Cycle Countdown with Bi-Color LED Status Light on door; 1 "Clean" Light; 1 "Sanitized" Light; 1 "Low Rinse Aid" Light; Last Cycle Memory; Audible End-of-Cycle Signal
Wash System	3-Level; 800 Series
Wash System Features	Dual Pumps and Motors; Automatic Temperature Control; Drain Pump; Hard Food Disposer with removable filter; Reversing Quad Blade Lower Wash Arm; Quad Blade Middle Wash Arm; 90 Spray Jet Wash System; Deep Clean Silverware Jets; Automatic HotStart; Bottle Jets (4)
Sensor	Clean Sensor
Wash Arms	3 Wash Levels; Lower- Reversing Quad Blade; Middle - Quad Blade; Bottle Jets; Deep Clean Silverware Jets
Water Filtration System	100% Filtration with Hard Food Disposer and Removable Filter
Dispenser	Rinse Aid with Indicator and Adjustment
Number of Cycles	5
Dishwasher Cycles	Auto; Pots; Normal; China; Express
Number of Options	12
Dishwasher Options	Delay Start 1-12 Hr; Lock Controls; Hi-Temp Wash; Presoak + Sanitize; Heated Dry Off; Normal Dry; Ultra Dry; Wash Zone Upper Only; Wash Zone Lower Only; Start/Reset; Bottle Jets
Rack Features	Ball-Tipped Tines; Adjustable Upper Rack; 3-Piece Silverware Basket with Cell Covers; Full Extension Slides - Upper; 2 short articulating plastic utility shelves w/Stemsafe and chop-stick slots
Racking Material	Nylon
Racking System	Full 3rd rack
Rack Color	Black Pearl
Number of Place Settings	Up to 16
Upper Rack	Premium Height Adjustable; Ball-Tip Tines; 1/2 fixed tines, 1/2 fold down tines; Fixed tines with Bottle Jets; 1 Rack handle; 2 Stem Safe Shelves; Chop stick slots
Lower Rack	Ball-Tip Tines; 1/2 fixed tines, 1/2 fold down tines
Additional Protection	Active Flood Protect
Dishwasher Drying Features	Multi-Wattage Wash & Dry Element; Heated Dry - Ultra/On/Off; Fan Assist Dry
Cutlery Tray	One piece removable 3rd rack
Levelling System	4 Levelling Legs
Latch	Pull with Handle
WiFi Connect	Optional (Requires part no. PBX23W00Y0)
Exterior Style	Traditional

ECONOMICAL/QUIET

Quiet Package	45 dBA
Quiet Features	Quiet Water Valve; Sealed Toe Kick; Tub Collar Trim
Motor Type	Single Speed
Outer Wrap	Full-wrap Blanket; Bitumen
Door Insulation	Insulation; Mastic

WEIGHTS & DIMENSIONS

Cabinet Width	24 in
Approximate Shipping Weight	118 lb
Net Weight	105 lb
Overall Height	34 in
Height w/ Legs Retracted - Minimum Height	33-3/8 in
Height w/Legs Extended - Maximum Height	34-5/8 in
Overall Depth	24 in
Overall Width	23-3/4 in

mu sig

UK-75 WALLACETON
LOT 257
27-2587 CRN ELE C
THE MAXWELL

52 of 52

Café™ Stainless Interior Built-In Dishwasher
with Hidden Controls

CDT845P4NW2 / CDT845P3ND1 CDT845P2NS1

C A F É

TECHNICAL DETAILS

Calrod Heater Watts	800/500
Power Connection	Optional cord kit (GPFCORD - WX09X70910, WX09X70911)
Volts/Hertz/Amps	120v; 60Hz; 6.6A

WARRANTY

Parts warranty	Limited 1-year entire appliance
Labor warranty	Limited 1-year entire appliance
Warranty notes	See written warranty for full details

DIMENSIONS

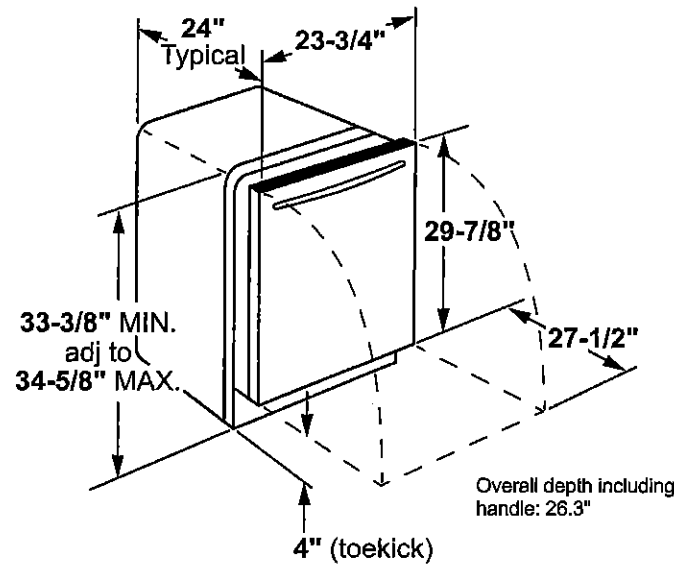

INSTALLATION DIMENSIONS

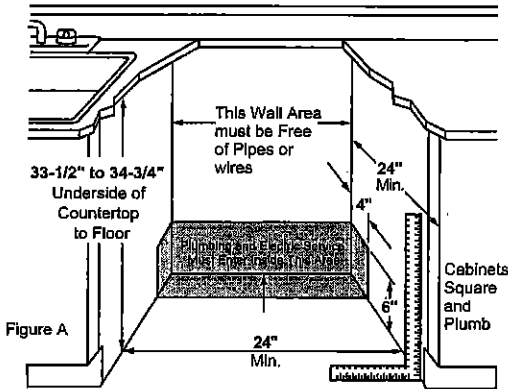

ADDITIONAL ACCESSORIES



Brushed Bronze
CXADTH1PMBZ



Brushed Stainless
CXADTH1PMSS



Brushed Black
CXADTH1PMBT



Brushed Copper
CXADTH1PMCU

For answers to your Café™ product questions, visit our website at cafeappliances.com.

© 2020 GE Appliances 04/20

Handwritten signature