

PRE-Sales Selection Sheet  
Checklist

1 of 31

LOT 2 Model: 25-2269 A The Walden

PURCHASERS: SMITKUMAR, VIJAYBHAI SUKHADIA/MINAL, HARISHBHAI SUKHAI

VENDOR: Heathwood Homes (Huron) Limited

- ☐ FINISHED BASEMENT  
☐ COLD CELLAR

UPGRADED / MODIFIED ELEVATION

- ☐ CORNER UPGRADE  
☐ REAR UPGRADE

CEILING UPGRADE - SMOOTH

- ☐ MAIN FLOOR  
☐ SECOND FLOOR  
☐ BASEMENT

ADDITIONAL ROUGH-INS

- ☒ 200 AMP SERVICE  
☐ WET BAR ROUGH-IN  
☐ HUMIDIFIER  
☒ AIR CONDITIONING

GAS ROUGH-IN

- ☒ STOVE  
☐ DRYER  
☐ BBQ  
☐ ADDITIONAL FIREPLACE

KITCHEN: HOODFAN VENTING SIZE

- ☒ 6 IN ROUND DUCT  
☐ 7 IN ROUND DUCT

FULL BASEMENT STAIRS:

Paint Grade

UPPER BASEMENT STAIRS:

N/A

LOWER BASEMENT STAIRS:

N/A

MAIN STAIRS:

All Oak

MEDIA STAIRS (if applicable):

N/A

LOFT STAIRS (if applicable):

N/A

Oct 7/20  
Date

Purchaser:

Oct 7/20  
Date

Decor Consultant:

IRIT SALEM

- APPROVED -

Date

Purchaser:

-10- 07 2020

Date

Heathwood Homes (Huron) Limited

Locked Date:

Approved



# Sales Selection Sheet

Wallaceton

2 of 31

PURCHASERS: SMITKUMAR, VIJAYBHAI SUKHADIA and MINAL,  
HARISHBHAI SUKHADIA

TEL: RES.: 647-226-7935

LOT / UNIT	PHASE	MODEL	
2	1	25-2269 A The Walden	

It is herein understood and agreed between the undersigned parties hereto that the following changes shall be made to the above mentioned Agreement of Purchase and Sale in accordance with the agreement and except for such changes noted below, all other terms and conditions in the Agreement of Purchase and Sale shall remain as stated herein: It is further understood that and agreed that all changes and additions shall be installed as per builder's specifications, location and available selections. The Purchaser hereby agrees to purchase the following extras:

## MISC.

1	SCEDULE "E" TEN THOUSAND DOLLARS (\$10,000.00) AT DECOR (NO CASH VALUE) SINGLES	Qty: 1	
36,834	Note:		

Sub Total  
HST  
Total

1. This Sales Selection Sheet when properly executed forms part of our Agreement of Purchase and Sale.
2. All extras and upgrades listed above are subject to Construction Progress and Architectural and Municipal requirements.
3. In the event the Vendor is unable to incorporate the work approved above in the construction of the house for any reason whatsoever, the Vendor will not be liable to the Purchaser in any way. The monies paid for any changes or optional extras not proceeded with shall be returned to the Purchaser, without interest. The cost of options or extras is non-refundable in all other circumstances. If for any reason whatsoever the Agreement of Purchase and Sale is not completed, the total cost of work approved above will be retained by the Vendor.
4. The Vendor reserves the right to substitute above materials and equipment with that of equal or better quality.
5. Purchaser acknowledges that items may not be exactly as shown. Variations from the Vendor's samples may occur in finished materials due to normal production processes. Vendor is not responsible for shade difference which may occur from different dye lots or wood grains. Variations from the Vendor's samples will occur with natural materials such as wood, marble, granite, hardwood and brick.
6. The Vendor reserves the right to select Grout & Thresholds that best suits the Tile selected.
7. Selections will not be processed unless signed by Heathwood Homes Head Office.
8. The selections made on this schedule are final and cannot be changed once submitted.
9. The Purchaser has checked and acknowledges the accuracy of this schedule.

## Payment Summary

Paid By Amount

Total Payment:

PURCHASER:

SMITKUMAR, VIJAYBHAI SUKHADIA

25-Sep-20

DATE

Decor Consultant

25-Sep-20

DATE

PURCHASER:

MINAL, HARISHBHAI SUKHADIA

25-Sep-20

DATE

**APPROVED**

-10- 07 2020

Date Approved Heathwood Homes (Huron) Limited

TAX#:1

PREPARED BY: Irit Salem

PE 512-1

SlInvoice.rpt 28may19

SMITKUMAR, VIJAYBHAI SUKHADIA/MINAL, HARISHBHAI SUKHADIA  
Project: Wallaceton  
Unit: 2, Phase: 1  
Model: 25-2500 ALT C The Bridgeport

Created: 9/1/2020 14:42:28  
Locked:  
Closed:

3 of 31

Kitchen

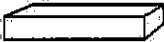
Cabinet Colour/Style	9156	Viking III-SIMCOE-RAIN CLOUD-3DL ***STD***
Countertop	9069	MSI Quartz GROUP 1 ICED WHITE ***STD***
Countertop Edge	4010	SINGLE POLISHED STRAIGHT EDGE 3/4 INCH ***STD*** 
Cabinet Hardware	7667	12881-HARDWARE ***STD***
Island Cabinet Colour/Style	9156	Viking III-SIMCOE-RAIN CLOUD-3DL ***STD***
Island Countertop	9069	MSI Quartz GROUP 1 ICED WHITE ***STD***
Backsplash	1111	N/A *****
Backsplash Grout	1111	N/A *****
Backsplash Tile Pattern	1111	N/A *****
HoodFan	8896	SCB51436-CYCLONE 36 inch STAINLESS CANOPY CHIMNEY HOODFAN-STAINLESS STEEL ***Upg*** PAGE 26
CERAMIC	1111	OV.ET.1224.PL-ETERNA VOLKAS POLISHED 12X24 UPG 5 SEE TILE DIRECTION SKETCH # 2 PAGE 17
CERAMIC	1111	UPG. ALABASTER UPG GROUT
Appliance	1111	Purchasers have been advised: standard fridge opening is a minimum 37 3/8 x 73 3/8". Ice Waterline Rough-In is included.
Appliance	1111	Standard stove opening is 30" and standard dishwasher opening is 24". Any gas stove will require backsplash or stainless steel backing to avoid fire hazards.
Appliance	1111	Purchasers acknowledge: Heathwood Homes and its contractors will not be responsible for any kitchen cabinet changes due to appliances dimension changes after
Comment		

Foyer

Flooring	9242	OV.ET.VLK.1224.PL-ETERNA VOLKAS POLISHED12X24 Tile Direction Sketch **5** SKETCH # 2 PAGE 17
----------	------	---

SMITKUMAR, VIJAYBHAI SUKHADIA/MINAL, HARISHBHAI SUKHADIA  
Project: Wallaceeton  
Unit: 2, Phase: 1  
Model: 25-2269 A The Walden

Created: 9/1/2020 14:42:28  
Locked:  
Closed:

4 of 31

Floor Tile Grout 7705 Grout-(01) Alabaster \*\*\*UPG\*\*\*

Floor Tile Pattern 3050 SIDE TO SIDE \*\*\*STD\*\*\*

Comment 9157

Laundry Room

Flooring 8913 UN.BL.BIA.1224-Biel-Bianco (White)-12 x 24 See Tile Direction on Sketch 4 Page 19 \*\*\*2\*\*\*

Floor Tile Grout 7705 Grout-(01) Alabaster \*\*\*UPG\*\*\*

Floor Tile Pattern 3040 FRONT TO BACK \*\*\*STD\*\*\*

Comment

Laundry Room Opt.

Cabinet 1111 N/A \*\*\*\*\*

Cabinet Hardware 1111 N/A \*\*\*\*\*

Comment

Mud Room

Flooring 9242 OV.ET.VLK.1224.PL-ETERNA VOLKAS POLISHED12X24 Tile Direction Sketch \*\*5\*\* SKETCH # 2 PAGE 17

Floor Tile Grout 7705 Grout-(01) Alabaster \*\*\*UPG\*\*\*

Floor Tile Pattern 3050 SIDE TO SIDE \*\*\*STD\*\*\*

Comment

ms  
85

SMITKUMAR, VIJAYBHAI SUKHADIA/MINAL, HARISHBHAI SUKHADIA  
Project: Wallaceton  
Unit: 2, Phase: 1  
Model: 25-2269 A The Walden

Created: 9/1/2020 14:42:28  
Locked:  
Closed:

5 of 31

Powder Room

Flooring	9242	OV.ET.VLK.1224.PL-ETERNA VOLKAS POLISHED12X24 Tile Direction Sketch **5** SKETCH # 2 PAGE 17
Floor Tile Grout	7705	Grout-(01) Alabaster ***UPG***
Floor Tile Pattern	3050	SIDE TO SIDE ***STD***

Plumbing Fixture (Colour)	1737	Plumbing Fixtures-WHITE ***STD***
Comment		

Dining Room

Flooring	7498	Red Oak Pearl-Vintage Engineered-IRONGATE-3/4 inch x 3 1/4 inch ***STD***
Comment		

Great Room/Breakfast

Flooring	7498	Red Oak Pearl-Vintage Engineered-IRONGATE-3/4 inch x 3 1/4 inch ***STD***
Comment		

Upper Hall

Flooring	9248	DY 89418 -Dynasty Tex-BLACK ICE-40 oz Poly***STD***
Comment		

Finished Basement (Rec) Room/Hall

Flooring	1111	N/A *****
Comment		

mlg  
8/28

SMITKUMAR, VIJAYBHAI SUKHADIA/MINAL, HARISHBHAI SUKHADIA  
Project: Wallace-ton  
Unit: 2, Phase: 1  
Model: 25-2269 A The Walden

Created: 9/1/2020 14:42:28  
Locked:  
Closed:

6 of 31

Master Bedroom

Flooring	9248	DY 89418 -Dynasty Tex-BLACK ICE-40 oz Poly***STD***
Comment		

Bedroom 2

Flooring	9248	DY 89418 -Dynasty Tex-BLACK ICE-40 oz Poly***STD***
Comment		

Bedroom 3

Flooring	9248	DY 89418 -Dynasty Tex-BLACK ICE-40 oz Poly***STD***
Comment		

Bedroom 4

Flooring	9248	DY 89418 -Dynasty Tex-BLACK ICE-40 oz Poly***STD***
Comment		

Ensuite 4

Cabinet Colour/Style	6265	Viking III-MANCHESTER-SHALE GREY CL-MAPLE ***STD***
Countertop	8822	4924-38-Countertop-WHITE CARRARA-Wilsonart ***STD***
Countertop Edge	1111	N/A *****
Cabinet Hardware	7672	135-HARDWARE ***STD***
Floor Tile	8293	OV.CD.GRY.1224.PL-Concorde-Grey Polished-12x24 See Tile Direction on Sketch 4 Page 19 ***5***
Floor Tile Grout	7705	Grout-(01) Alabaster ***UPG***

mbg

8/8

SMITKUMAR, VIJAYBHAI SUKHADIA/MINAL, HARISHBHAI SUKHADIA  
Project: Wallaceton  
Unit: 2, Phase: 1  
Model: 25-2269 A The Walden

Created: 9/1/2020 14:42:28  
Locked:  
Closed:

7 of 31

Floor Tile Pattern	3050	SIDE TO SIDE ***STD***
Wall Tile	9025	QT.UW.TGR.0810-Uniwall-Tender Grey-8 x 10 ***STD***
Wall Tile Grout	2225	Grout-(27) Silver ***UPG***
Wall Tile Pattern	3090	VERTICAL STACKED ***STD*** 
Plumbing Fixture (colour)		
Comment		

Master Ensuite

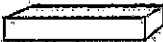
Cabinet Colour/Style	9157	Viking III-SIMCOE-MOONLIGHT-3DL ***STD***
Countertop	9069	MSI Quartz GROUP 1 ICED WHITE ***STD***
Countertop Edge	4010	GROUP 1 - SINGLE POLISHED STRAIGHT EDGE 3/4 INCH ***1*** 
Cabinet Hardware	7672	135-HARDWARE ***STD***
Floor Tile	5691	NY.RG.SLW.1224.PL.N.-Regal Polished-Shell White-12 x 24 See Tile Direction on Sketch 4 Page 19 ***4***
Floor Tile Grout	7705	Grout-(01) Alabaster ***UPG***
Floor Tile Pattern	3040	FRONT TO BACK ***STD***
Shower Floor Tile	8661	OD.ON.SWT.0202.MT.N-Ontario Series Mosaic-Snow White Matte-2 x 2 ***STD***
Shower Floor Tile Grout	2226	Grout-(00) White ***STD***
Shower Floor Tile Pattern	3000	STANDARD SQUARE ***STD***

mbg  
84

SMITKUMAR, VIJAYBHAI SUKHADIA/MINAL, HARISHBHAI SUKHADIA  
Project: Wallaceton  
Unit: 2, Phase: 1  
Model: 25-2269 A The Walden

Created: 9/1/2020 14:42:28  
Locked:  
Closed:

8 of 31

Shower Wall Tile	5411	QT.SP.WHT.0810-Splendour-White-8 inch x 10 inch ***STD***								
Shower Wall Tile Grout	2226	Grout-(00) White ***STD***								
Shower Wall Tile Pattern	3090	VERTICAL STACKED ***STD*** <table><tr><td></td><td></td><td></td><td></td></tr><tr><td></td><td></td><td></td><td></td></tr></table>								
Shower Jamb(s) and Sill(s)	8923	Shower Jamb / Sill-Thassos White ***STD***								
Plumbing Fixture (colour)	1737	Plumbing Fixtures-WHITE ***STD***								
Comment										

Main Bathroom

Cabinet Colour/Style	6265	Viking III-MANCHESTER-SHALE GREY CL-MAPLE ***STD***								
Countertop	8796	6698-46-Countertop-PALOMA POLAR ETCHINGS FINISH-Formica ***STD***								
Countertop Edge	1111	N/A *****								
Cabinet Hardware	7672	135-HARDWARE ***STD***								
Floor Tile	8293	OV.CD.GRY.1224.PL-Concorde-Grey Polished-12x24 See Tile Direction on Sketch 4 Page 19 ***5***								
Floor Tile Grout	7705	Grout-(01) Alabaster ***UPG***								
Floor Tile Pattern	3040	FRONT TO BACK ***STD***								
Wall Tile	9025	QT.UW.TGR.0810-Uniwall-Tender Grey-8 x 10 ***STD***								
Wall Tile Grout	2225	Grout-(27) Silver ***UPG***								
Wall Tile Pattern	3090	VERTICAL STACKED ***STD*** <table><tr><td></td><td></td><td></td><td></td></tr><tr><td></td><td></td><td></td><td></td></tr></table>								
Plumbing Fixture (Colour)	1737	Plumbing Fixtures-WHITE ***STD***								

mbg

8/



SMITKUMAR, VIJAYBHAI SUKHADIA/MINAL, HARISHBHAI SUKHADIA  
Project: Wallaceton  
Unit: 2, Phase: 1  
Model: 25-2269 A The Walden

Created: 9/1/2020 14:42:28  
Locked:  
Closed:

9 of 31

Comment

Opt. Finished Basement Bathroom

Cabinet Colour/Style1111N/A \*\*\*\*\*

Countertop1111N/A \*\*\*\*\*

Countertop Edge1111N/A \*\*\*\*\*

Cabinet Hardware1111N/A \*\*\*\*\*

Floor Tile1111N/A \*\*\*\*\*

Floor Tile Grout1111N/A \*\*\*\*\*

Floor Tile Pattern1111N/A \*\*\*\*\*

Shower Floor Tile1111N/A \*\*\*\*\*

Shower Floor Tile Grout1111N/A \*\*\*\*\*

Shower Floor Tile Pattern1111N/A \*\*\*\*\*

Shower Wall Tile1111N/A \*\*\*\*\*

Shower Wall Tile Grout1111N/A \*\*\*\*\*

Shower Wall Tile Pattern1111N/A \*\*\*\*\*

Shower Jamb(s)1111N/A \*\*\*\*\*

Plumbing Fixture (Colour)1111N/A \*\*\*\*\*

Comment

ms  
8/8

SMITKUMAR, VIJAYBHAI SUKHADIA/MINAL, HARISHBHAI SUKHADIA  
Project: Wallaceton  
Unit: 2, Phase: 1  
Model: 25-2500 ALT C The Bridgeport

Created: 9/1/2020 14:42:28  
Locked:  
Closed:

10 of 31

Great Room Fireplace

Type	8869	Majestic MERC32 ***STD***
Mantle	1439	NF 17-Paint Grade Mantle-Flat Wall-WHITE ***STD*** PAGE 20
Surround	1111	N/A *****
Note	1111	Purchasers have been advised: heat from the FP can damage TV above a FP and items placed on mantle.
Note	1111	Heathwood and its contractors will not be liable for any damage on items placed/installed above a FP after closing.
Comment		

Basement Stairs

Type	1713	Paint Grade Stairs ***STD BASEMENT STAIR ***
Carpet	1111	N/A *****
Carpet Runner	1111	N/A *****
Handrail/Pickets/Post Type	1111	N/A *****
Handrail/Pickets/Post Colour	1111	N/A *****
Handrail/Pickets/Post Locations	1111	N/A *****
Custom Stain/Paint	1111	N/A *****
Comment	2	

Main Stairs

Type	1712	Oak Stairs ***STD MAIN STAIRS***
Carpet Runner	1111	N/A *****
Handrail/Pickets/Posts Type	7652	1 5/16 inch Square pickets with 3 1/2" Square/Cap Post(s)-ALL OAK ***STD***
Handrail/Pickets/Posts Colour	7912	Irongate (Gryphon) STAIN TO COMPLIMENT HARDWOOD AND WILL VARY FROM FLOORING

mf

SMITKUMAR, VIJAYBHAI SUKHADIA/MINAL, HARISHBHAI SUKHADIA  
Project: Wallaceton  
Unit: 2, Phase: 1  
Model: 25-2269 A The Walden

Created: 9/1/2020 14:42:28  
Locked:  
Closed:

11 of 31



Handrail/Pickets/Posts Locations 1728 Oak Grade-Stain handrail,oak pickets,stringers,treads,risers

Custom Stain/Paint 1111 N/A \*\*\*\*\*

Comment

Main Stairs Landing(s)

Flooring 7498 Red Oak Pearl-Vintage Engineered-IRONGATE-3/4 inch x 3 1/4 inch \*\*\*3\*\*\*

Comment

Throughout

Walls - Paint Colour 1717 22-Wall-WARM GREY \*\*\*STD\*\*\*

Underpad 1079 500 Series-Underpad \*\*\*STD\*\*\*



Thresholds 2232 Metal Thresholds \*\*\*STD\*\*\*

Switches and Plug 5796 Decora White Switches and Plugs \*\*\*STD\*\*\*

Trim Size 8705 4 1/4 Baseboard and 2 3/4 Casings \*\*\*STD\*\*\*

Trim - Paint Colour 1716 Trim-WHITE \*\*\*STD\*\*\*

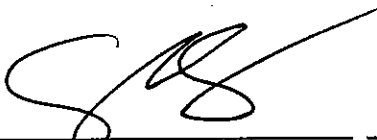
Comment

Purchaser:  1<sup>st</sup> Oct 20 Date Decor Consultant  Oct. 1. 2020 Date

SMITKUMAR, VIJAYBHAI SUK

Date

Decor Consultant

Date

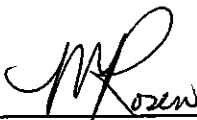
Purchaser:  1<sup>st</sup> oct 20 Date Wallaceton  -10- 07 2020 Date Approved

MINAL, HARISHBHAI SUKHAI

Date

Wallaceton

Date Approved

APPROVED



Sales Selection Sheet  
Wallaceton

12 of 31

PURCHASERS: SMITKUMAR, VIJAYBHAI SUKHADIA and MINAL,  
HARISHBHAI SUKHADIA

TEL:

LOT / UNIT	PHASE	MODEL	
2	1	25-2500 ALT C The Bridgeport	

It is herein understood and agreed between the undersigned parties hereto that the following changes shall be made to the above mentioned Agreement of Purchase and Sale in accordance with the agreement and except for such changes noted below, all other terms and conditions in the Agreement of Purchase and Sale shall remain as stated herein: It is further understood that and agreed that all changes and additions shall be installed as per builder's specifications, location and available selections. The Purchaser hereby agrees to purchase the following extras:

ADMIN FEE

1	PROMO	Qty: (1)
35,309	Note:	

APPLIANCES

2	SCB51436 CYCLONE 36" WALLMOUNT HOOD 36"	Qty: 1
38,916	Note: 36" CYCLONE SCB51436 CHIMNY HOOD FAN	PAGE 26

Cabinetry

3	CABINETRY - 11A-UPPER ANGLE CORNER PER UNIT - UPGRADE 1	Qty: 1
189,343		
35,282	Note: SKETCH # 2 AND 3 PAGES 17 AND 18	
4	CABINETRY - 12B-POTS AND PANS DRAWERS (WIDTH MIN. 60CM/MAX. 90CM) (SIZE SUBJECT TO FLOOR PLAN) - UPGRADE 1	Qty: 1
189,005		
35,283	Note: SEE SKETCH# 3 PAGE# 18	
5	CABINETRY - 12J-LIGHT VALANCE (PER 8 foot LENGTH PRICE) (FOR CLARIFICATION OF STYLES SEE MOULDING MATRIX) (LIGHT VALANCE IS NOW APPROXIMATELY 2" [50MM] HIGH. PLEASE ENSURE LIGHT FIXTURES USED WILL BE CONCEALED BY THE VALANCE.);	Qty: 3
189,316		
35,284	Note: PRICE ALL THE SAME FOR ALL LINES - KITCHEN	
*6	CABINETRY - 22H-BUILT-IN OVEN IN BASE CABINET WITH COOKTOP ABOVE (SUPPLY SPEC)	Qty: 1
189,311	SKETCH 3 PAGE 18	
38,016	Note: SEE SPEC PAGE # 27 ~ 31	
7	MOVE FRIDGE TO THE END- ADD GABLE AND FILLERS	Qty: 1
38,017	Note: SEE SKETCH # 2 AND 3 PAGE# 17 AND 18	

Ceramics

8	CERAMICS - FLOOR - KITCHEN - UPGRADE 5	Qty: 1
190,508		
35,297	Note:	
*9	CERAMICS - FLOOR - FOYER - UPGRADE 5	Qty: 1
190,645		
35,298	Note: FOYER - UPGRADE 5	
10	CERAMICS - FLOOR GROUT - FOYER - GROUT	Qty: 1
190,569		
35,304	Note:	

Initials: MR

TAX#:1

PREPARED BY: Bei Liu

PE 449-1



Sales Selection Sheet

Wallaceton

13 of 31

PURCHASERS: SMITKUMAR, VIJAYBHAI SUKHADIA and MINAL,  
HARISHBHAI SUKHADIA

TEL:

LOT / UNIT	PHASE	MODEL	
2	1	25-2500 ALT C The Bridgeport	

Ceramics

11 190,571 35,305	CERAMICS - FLOOR GROUT - GARAGE ENTRY / MUD ROOM - GROUT  <b>Note:</b>	Qty: 1
12 190,573 35,306	CERAMICS - FLOOR GROUT - KITCHEN - GROUT  <b>Note:</b>	Qty: 1
13 190,570 35,307	CERAMICS - FLOOR GROUT - POWDER ROOM - GROUT  <b>Note:</b>	Qty: 1
14 190,576 35,308	CERAMICS - FLOOR GROUT - ENSUITE MASTER - GROUT  <b>Note:</b>	Qty: 1
15 190,533 36,832	CERAMICS - FLOOR - ENSUITE MASTER - UPGRADE 4  <b>Note:</b>	Qty: 1
16 190,566 36,835	CERAMICS - TUB WALL GROUT - ENSUITE 4 - GROUT  <b>Note:</b>	Qty: 1
17 190,565 36,836	CERAMICS - TUB WALL GROUT - MAIN BATHROOM - GROUT  <b>Note:</b>	Qty: 1
18 190,574 36,837	CERAMICS - FLOOR GROUT - LAUNDRY ROOM - GROUT  <b>Note:</b>	Qty: 1
19 190,513 36,838	CERAMICS - FLOOR - LAUNDRY ROOM - UPGRADE 2  <b>Note:</b>	Qty: 1
20 190,525 36,843	CERAMICS - FLOOR - MAIN BATHROOM - UPGRADE 5  <b>Note:</b>	Qty: 1
21 190,543 38,019	CERAMICS - FLOOR - ENSUITE 4 - UPGRADE 5  <b>Note:</b>	Qty: 1
22 190,666 38,020	CERAMICS - FLOOR - GARAGE ENTRY / MUD ROOM - UPGRADE 5  <b>Note:</b>	Qty: 1

Initials:

TAX#:1

PREPARED BY: Bei Liu

PE 449-2

Slinvoice.rpt 28may19



Sales Selection Sheet  
Wallaceton

14 of 31

PURCHASERS: SMITKUMAR, VIJAYBHAI SUKHADIA and MINAL,  
HARISHBHAI SUKHADIA

TEL:

LOT / UNIT	PHASE	MODEL	
2	1	25-2500 ALT C The Bridgeport	

Ceramics

23 190,657 38,021	CERAMICS - FLOOR - POWDER ROOM - UPGRADE 5  <b>Note:</b>	Qty: 1
-------------------------	--	--------

Electrical

24 189,450 35,273	ELECTRICAL - CEILING ROUGH-IN (CAPPED)  <b>Note:</b> 1 KITCHEN; TO BE INSTALL ABOVE THE BREAKFAST BAR-USE SEPARATE SWITCH 1 TO BE INSTALL IN THE CENTRE OF THE GREAT ROOM- USE EXISTING SWITCH PLUG SEE SKETCH # 2 PAGE# 17	Qty: 2
25 189,448 35,274	ELECTRICAL - EXTRA WALL INTERIOR OUTLET ON EXISTING CIRCUIT (DOES NOT INCLUDE KITCHEN OUTLETS)  <b>Note:</b> GREAT ROOM: TO BE INSTALLED ABOVE THE CENTRE OF THE FIRE PLACE 70"+ FROM FLOOR SEE SKETCH # 2 PAGE# 17	Qty: 1
26 189,451 35,275	ELECTRICAL - ADDITIONAL SWITCH  <b>Note:</b> KITCHEN; TO BE USED FOR THE R/ I CAP LIGHT SEE SKETCH # 2 PAGE# 17	Qty: 1

GRANITE

27 36,829	GRANITE - DRILL HOLE ON COUNTERTOP FOR FUTURE SOAP DISPENSER LOCATION - PAGE 21 SOAP SPEC PAGE 23 WATER DISPENSER PAGE 24 <b>Note:</b> DRILL 2 HOLES ((SOAP DISPENSER WAS NOT PURCHASED WITH HEATHWOOD) SEE SKETCH # PAGE#	Qty: 2
28 189,464 38,018	GRANITE - GRANITE CUTOUT W/ STRAIGHT EDGE POLISH TO ACCOMMODATE COOK TOP SKETCH # 3 PAGE 18 <b>Note:</b> SEE SPEC PAGE# 27	Qty: 1

Heating/Air

29 189,474 35,285	HEATING/AIR - ROUGH-IN GAS LINE FOR GAS STOVE AT MAIN FLOOR (SEE SPECS) (HOOK-UP NOT INCLUDED) LEAVE STANDARD 120 VOLT ELECTRICAL OUTLET ON A SEPARATE CIRCUIT. * SPECIFY IF STANDARD 220V WILL STAY OR BE RELOCATED <b>Note:</b> KEEP STD. STOVE ELECTRICAL	Qty: 1
-------------------------	---	--------

Structured Wiring

*30 189,775 35,276	STRUCTURED WIRING - RELOCATION OF TV AND CAT 5E  <b>Note:</b> GREAT ROOM: TO BE RELOCATED TO ABOVE THE CENTRE OF THE FIRE PLACE 70"+ FROM FLOOR SEE SKETCH # 2 PAGE# 17	Qty: 2
--------------------------	--	--------

Sub Total
HST
Total

Initials:



Sales Selection Sheet  
Wallaceton

15 of 31

PURCHASERS: SMITKUMAR, VIJAYBHAI SUKHADIA and MINAL,  
HARISHBHAI SUKHADIA

TEL:

LOT / UNIT	PHASE	MODEL	
2	1	25-2500 ALT C The Bridgeport	

1. This Sales Selection Sheet when properly executed forms part of our Agreement of Purchase and Sale.
2. All extras and upgrades listed above are subject to Construction Progress and Architectural and Municipal requirements.
3. In the event the Vendor is unable to incorporate the work approved above in the construction of the house for any reason whatsoever, the Vendor will not be liable to the Purchaser in any way. The monies paid for any changes or optional extras not proceeded with shall be returned to the Purchaser, without interest. The cost of options or extras is non-refundable in all other circumstances. If for any reason whatsoever the Agreement of Purchase and Sale is not completed, the total cost of work approved above will be retained by the Vendor.
4. The Vendor reserves the right to substitute above materials and equipment with that of equal or better quality.
5. Purchaser acknowledges that items may not be exactly as shown. Variations from the Vendor's samples may occur in finished materials due to normal production processes. Vendor is not responsible for shade difference which may occur from different dye lots or wood grains. Variations from the Vendor's samples will occur with natural materials such as wood, marble, granite, hardwood and brick.
6. The Vendor reserves the right to select Grout & Thresholds that best suits the Tile selected.
7. Selections will not be processed unless signed by Heathwood Homes Head Office.
8. The selections made on this schedule are final and cannot be changed once submitted.
9. The Purchaser has checked and acknowledges the accuracy of this schedule.

Payment Summary

Paid By Amount

Total Payment:

PURCHASER:

Signature on file  
SMITKUMAR, VIJAYBHAI SUKHADIA

07-Oct-20  
DATE

Decor Consultant

07-Oct-20  
DATE

PURCHASER:

MINAL, HARISHBHAI SUKHADIA

07-Oct-20  
DATE

**APPROVED**

10-07-2020  
Date Approved Heathwood Homes (Huron) Limited

TAX#:1

PREPARED BY: Bei Liu

PE 449-4

S\invoice.rpt 28may19

UK-75 WALLACETON  
LOT 2  
25-2269 ELEV. A  
THE WALDEN

16 of 31

THE WALDEN

25-2269 ELEV.A

ELEVATION A | 2,269 SQ. FT.  
896 sq. ft. of opt. finished Lower Level

WALLACETON  
EST. 1870

Sketch #1

UNFINISHED

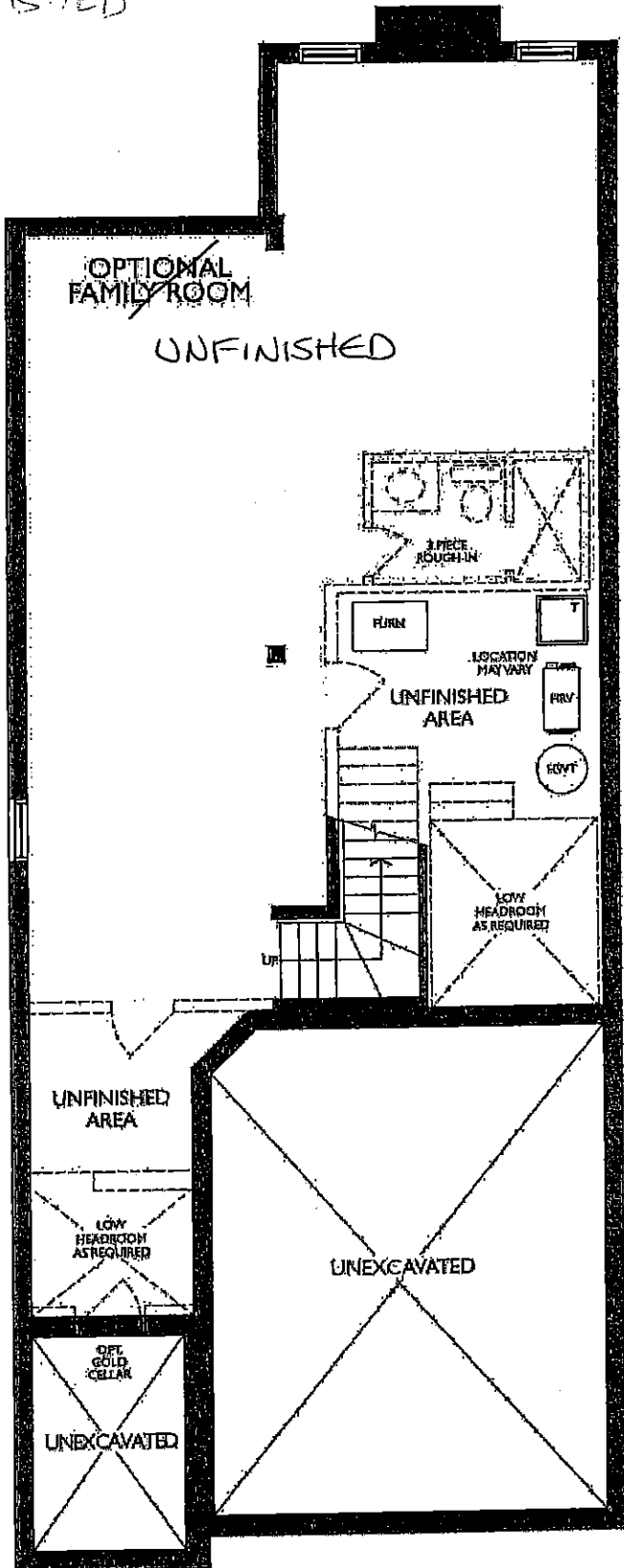

LOWER LEVEL  
ELEVATION A, B, C & D

mk  
SJS



UK-75 WALLACETON  
LOT 2  
25-2269 ELEV. A  
THE WALDEN

17 of 31

THE WALDEN

25-2269 ELEV.A

ELEVATION A | 2,269 SQ. FT.  
695 sq. ft. of opt. finished Lower Level

WALLACETON  
EST. 1870

Sketch #2

RELOCATE STD R/I CABLE AND PHONE CAT 5E +  
ELECTRICAL OUTLET  
ALL 70" +/-  
FROM FLOOR

UPPER  
ANGLE CABINET

36" HOODFAN

R/I CAPLIGHT  
& ABOVE ISLAND

MOVE FRIDGE  
TO THE END

12x24"  
TILE INSTALL  
DIRECTION

R/I CAPLIGHT  
USE EXISTING  
SWITCHED PLUGS

12x24" TILE  
INSTALL  
DIRECTION

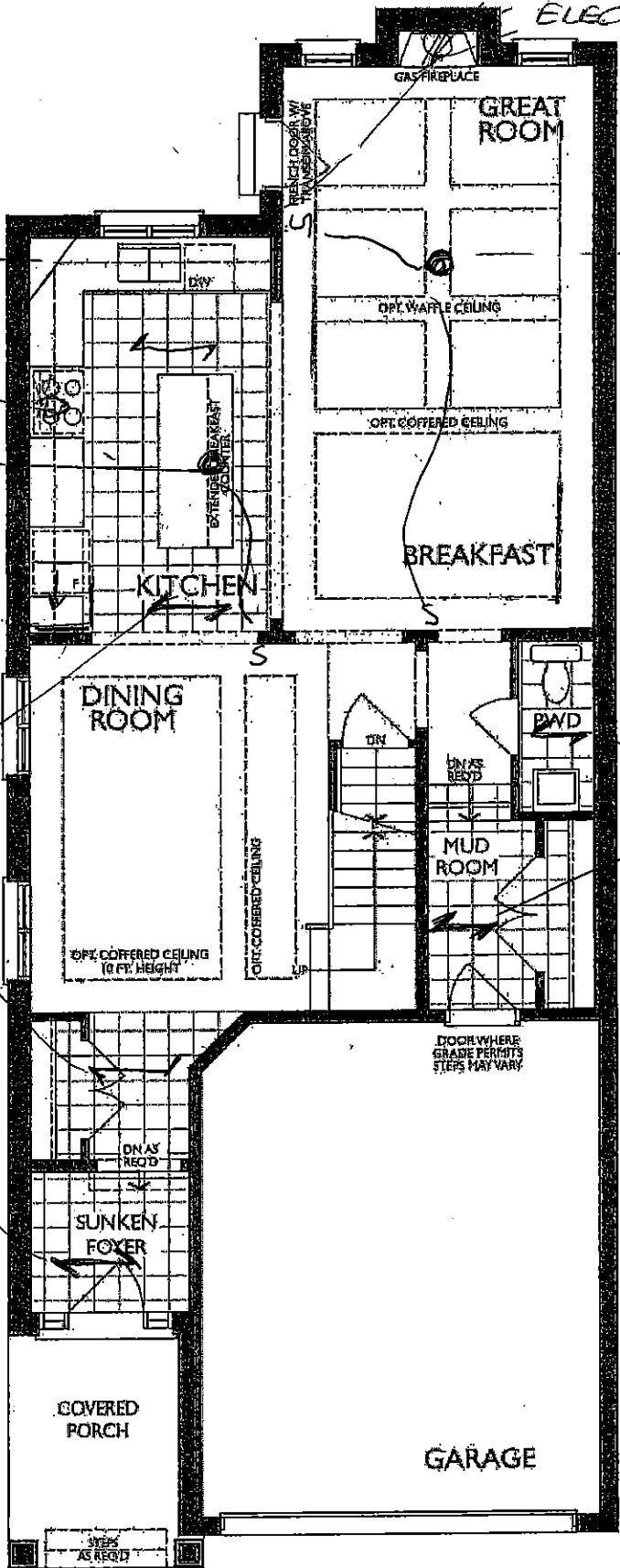

MAIN FLOOR  
ELEVATION A

ms  
SLS



FRENDE  
KITCHENS LTD  
1301 Shawson Drive, Mississauga, ON L4W

HEATHWOOD HOMI  
WALLACETON, KITCHENE  
MODEL: 25-2269 (310)

STANDARD CONTRACT INCLUDES:

Appliance Openings

- Hood Opening: 30"W Chimney hood
- Fridge Opening: 37 3/8 "W X 73 3/8"
- Fridge cabinet & gables: 66cm Deep
- Stove Opening: 30" Freestanding
- Dishwasher Opening: 24"

Standard Kitchens Scope:

- 100cm H wall cabinets
- Std. Blumotion Hinges- soft close doors
- Std. Metabox Drawers- not soft close
- Min 40cm W drawer
- Base pie cut corner cabinets
- Backing on all cabinets
- Countertop by others
- Upgrade applied paneled fridge & dishwashers supply only (appliance hardware by others)

Standard Vanity & Laundry Scope:

- Powder by others, pedestal
- Master Ens. - Top by others
- Remaining vanities inc. laminate top
- Std. Blumotion Hinges- not soft close
- Std. Metabox Drawers- not soft close
- Master Ens: Top drawers(Sink Full height)
- Mains: Full height doors (top drawers added if Masters can't accommodate)
- Optional laundry base & wall cabinets

THIS DRAWING IS FOR DESIGN PURPOSES ONLY.  
IT IS NOT AN EXACT REPRESENTATION.

Sketch #3

18 of 31

OPT. BASEMENT BATH

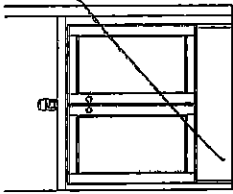

OPT. LAUNDRY UPPERS  
(2ND FLR)

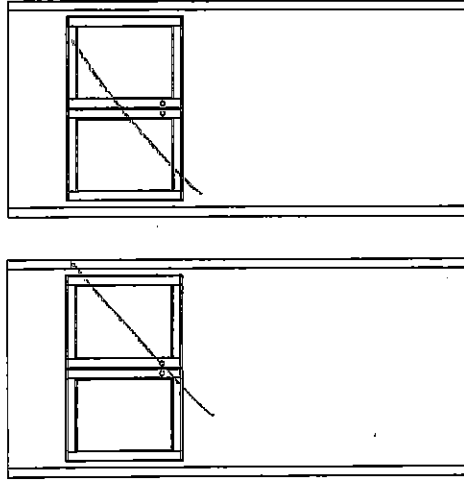

ENSUITE 4  
(2ND FLR)

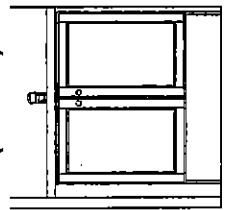

MAIN BATH  
(2ND FLR)

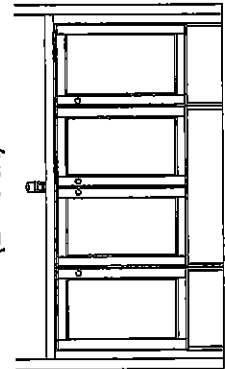

MASTER ENSUITE  
(2ND FLR)

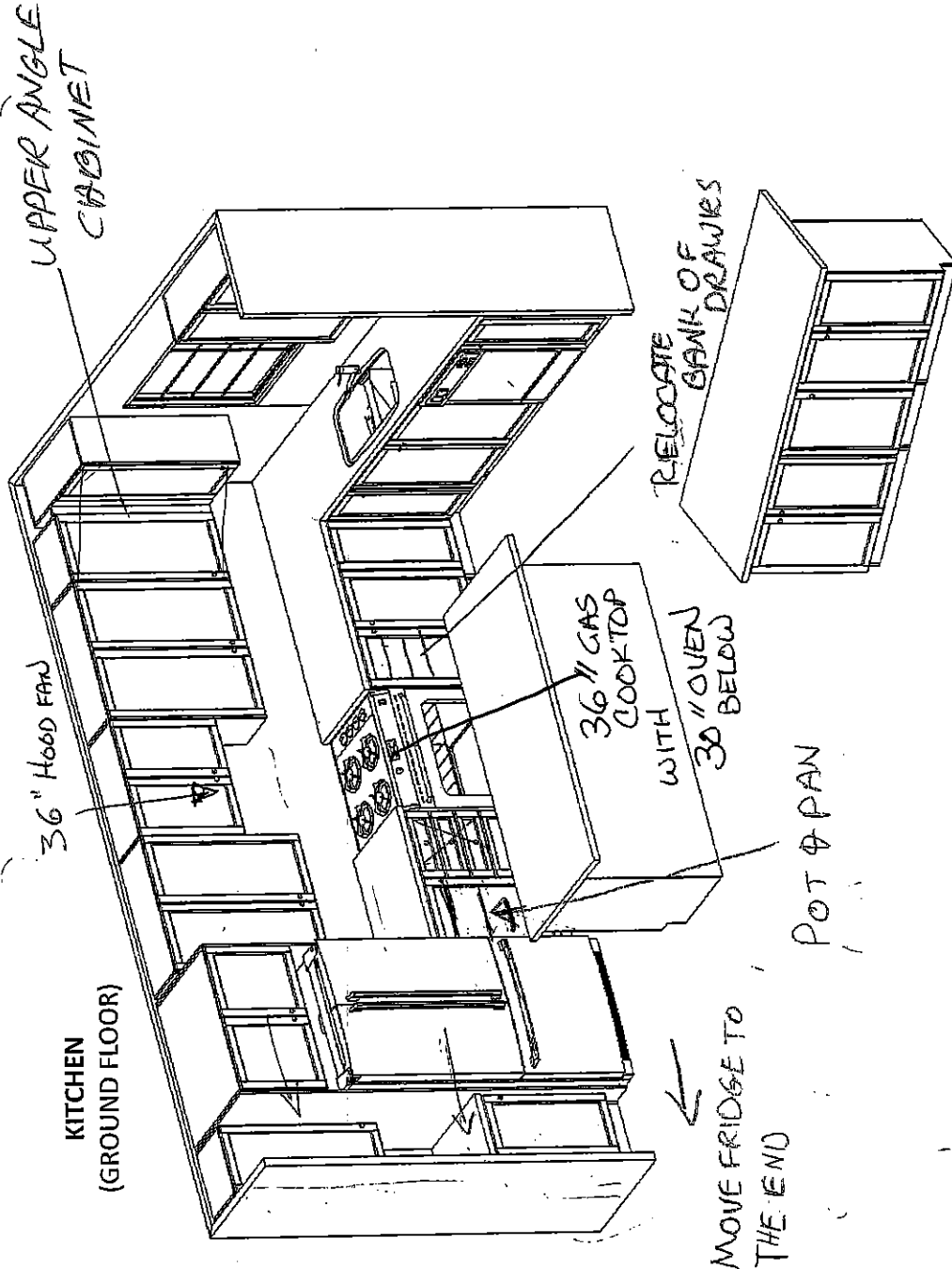
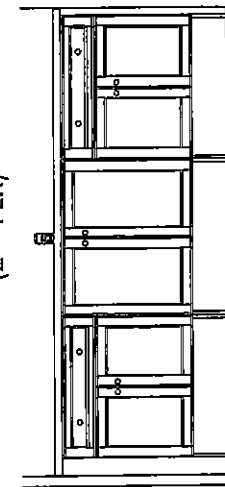

19 of 31

25-2269 ELEV.A

## Sketch #4

**SECOND FLOOR**

The floor plan includes the following rooms and features:

- MASTER BEDROOM:** Located at the top right, featuring a 6" HIGH TRAY CEILING.
- MASTER ENSUITE:** Adjacent to the Master Bedroom, containing a glass shower, bathtub, toilet, and optional double sinks.
- ENSUITE 4:** Located near the top left, containing a toilet and bathtub.
- WALK-IN CLOSET:** Two located near the top right, and one near the bottom right.
- LAUNDRY:** Located on the right side, featuring optional upper and lower storage.
- WALK-IN LINEN:** Located near the laundry room.
- MAIN BATH:** Located in the center, containing a toilet, bathtub, and a central staircase labeled "DN" (down) with a railing.
- BEDROOM 4:** A large bedroom located in the center-left.
- BEDROOM 3:** Located at the bottom left.
- BEDROOM 2:** Located at the bottom right.



SH

DR 75 WALLACE ION  
LOT 2  
25-2269 ELEV. A  
THE WALDEN

20 of 31

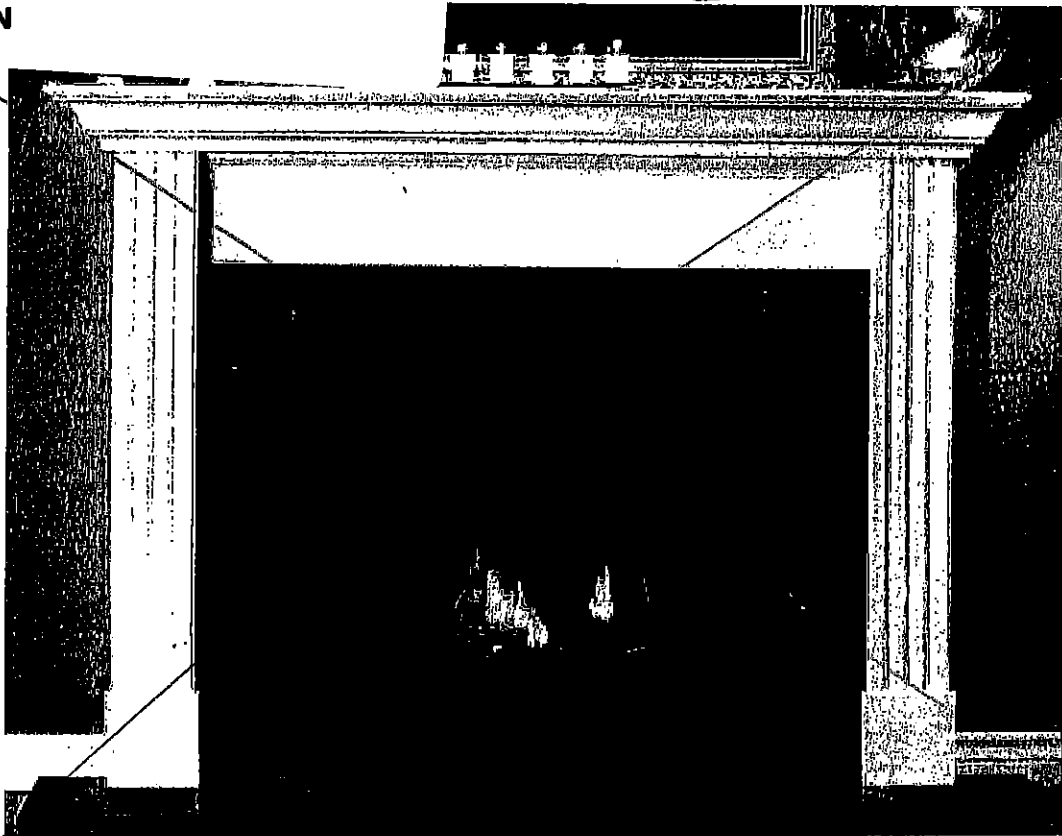

## STANDARD NF 15 Mantel

Clean apron finish with fluted legs

**WHITE PAINT GRADE FINISH**

(PICTURE SHOWN WITH UPGRADE SURROUND AND HEARTH -PRICED SEPARATELY)

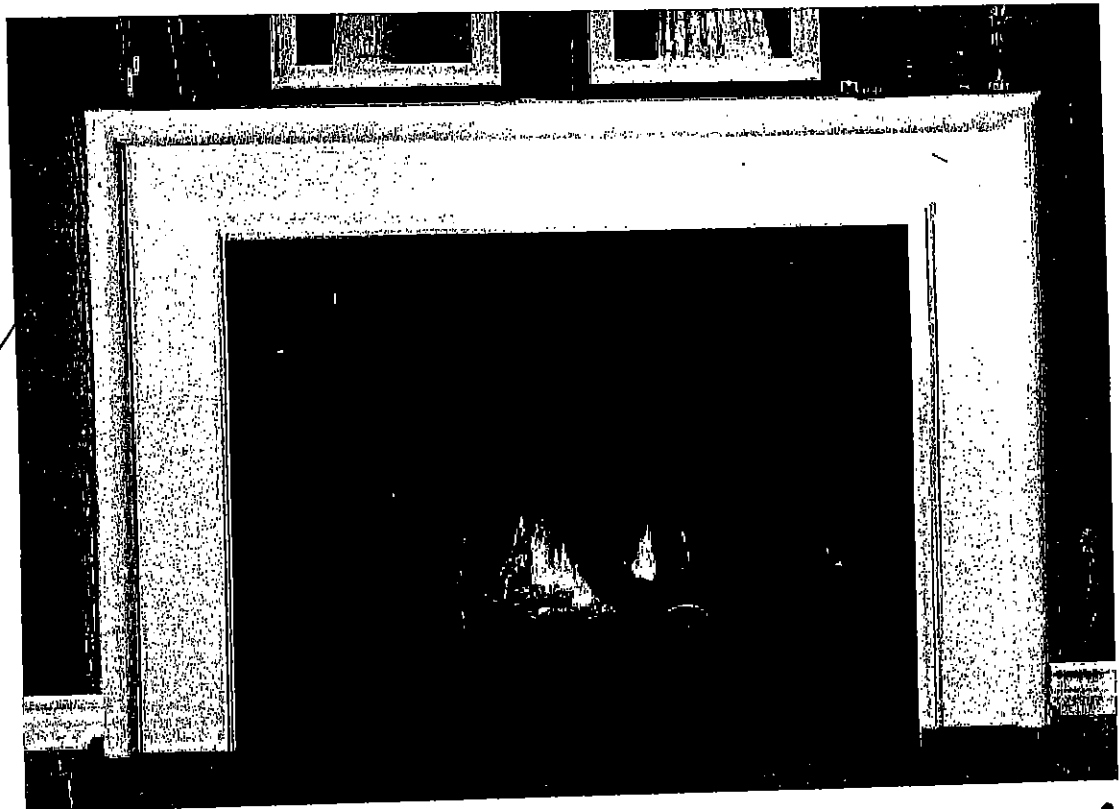

## STANDARD NF 17 Mantel

**WHITE PAINT GRADE FINISH**

(PICTURE SHOWN WITH UPGRADE SURROUND AND HEARTH -PRICED SEPARATELY)

my

SPB

UK-75 WALLACETON  
 LOT 2  
 25-2269 ELEV. A  
 THE WALDEN

21 of 31

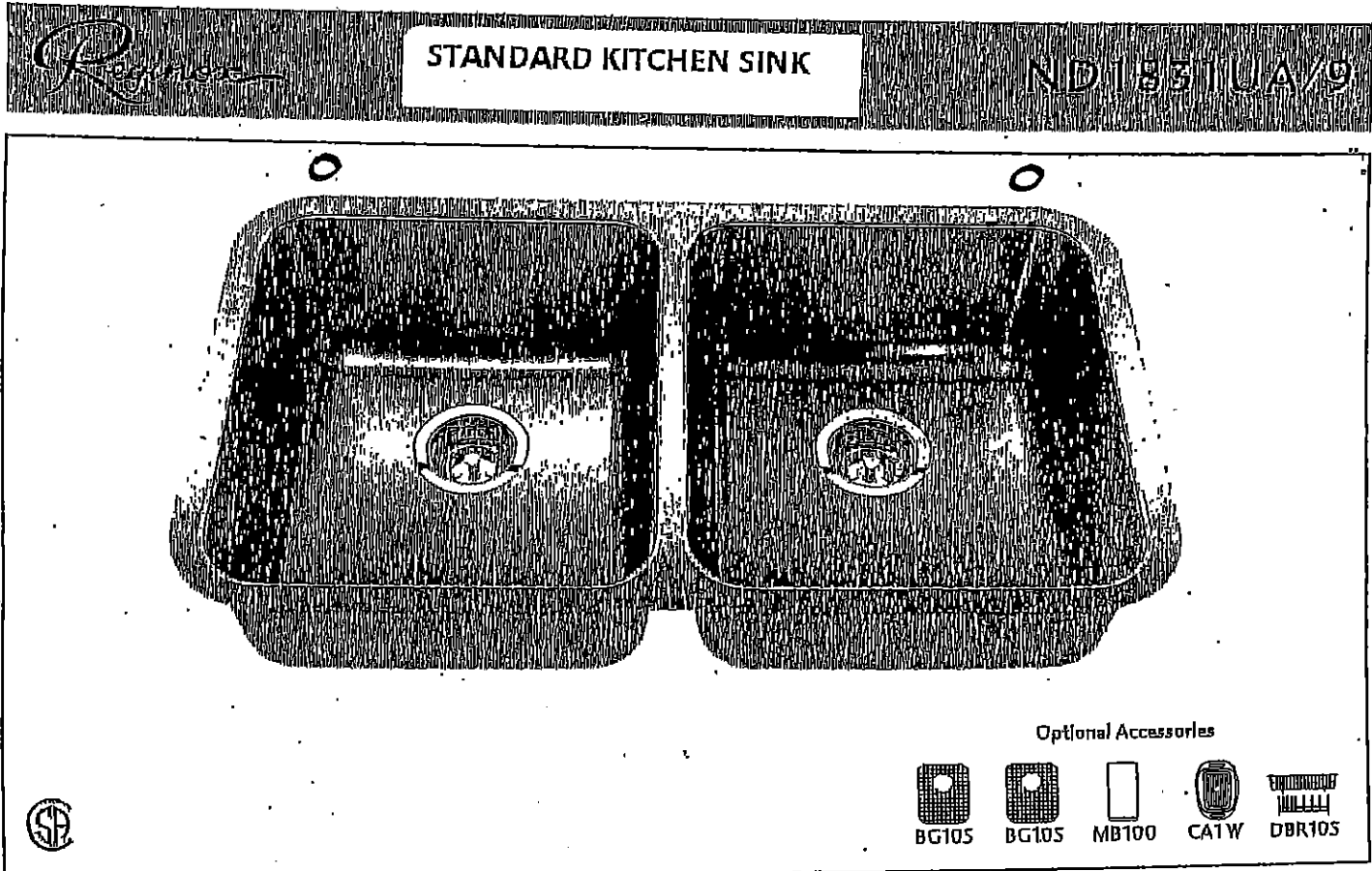

DRILL HOLE FOR FUTURE  
 SOAP  
 PAGE 23

DRILL  
 HOLE FOR FUTURE  
 WATER DISPENSER (PAGE 24)

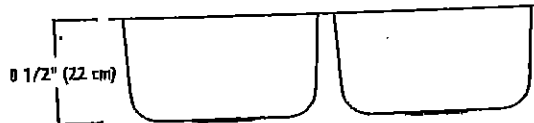
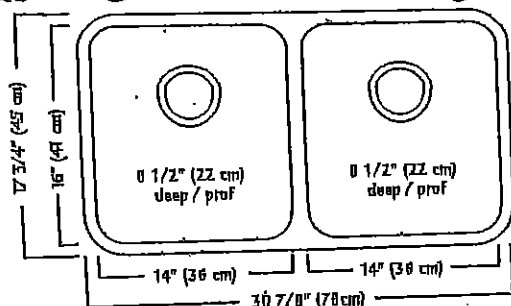

### ND1831UA/9 SPECIFICATION

Model ND1831UA/9 is a double (two equal size) bowl undermount sink manufactured by Franke Kindred Canada Limited from 18 gauge stainless steel. Product has silk finished rims and linear brush finished bowls. Sink is fully undercoated. Basket strainer waste fittings (3 1/2", 89 mm) are included. Sink is backed with a limited lifetime warranty.

- O.D. 17 3/4" x 30 7/8" x 18 3/4" (45 x 78 x 47.5 cm)
- Recommended for minimum 36" cabinet

Franke Kindred Canada Limited  
 P.O. Box 190, 1000 Franke Kindred Road, Midland, Ontario, Canada, L4R 4K9 Phone: 866-687-7465 Fax: 800-361-8408

*Handwritten signatures and initials:*  
 K.Y.  
 M.B.  
 S.M.

UK-75 WALLACETON

LOT 2

25-2269 ELEV. A

THE WALDEN

22 of 31

STANDARD KITCHEN FAUCET

Align

Modern



Single Handle Pull-Down Kitchen  
Faucet\*

Model 7565+

Kip

gib

23 of 31



Buy it for looks. Buy it for life.®

Specifications

DESCRIPTION

- Available in various finishes identified by suffix

OPERATION

- Press down, pump action

STANDARDS

- Designed and manufactured to comply with the requirements of: CSA B15.1 and ASME A112.18.1 and all requirements referenced therein

WARRANTY

- Lifetime limited warranty against manufacturing and finish defects to the original consumer purchaser
- 5 year warranty if used in commercial installations

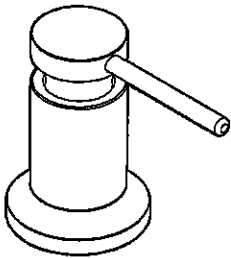

LIQUID DISPENSER

Model: 3942 series

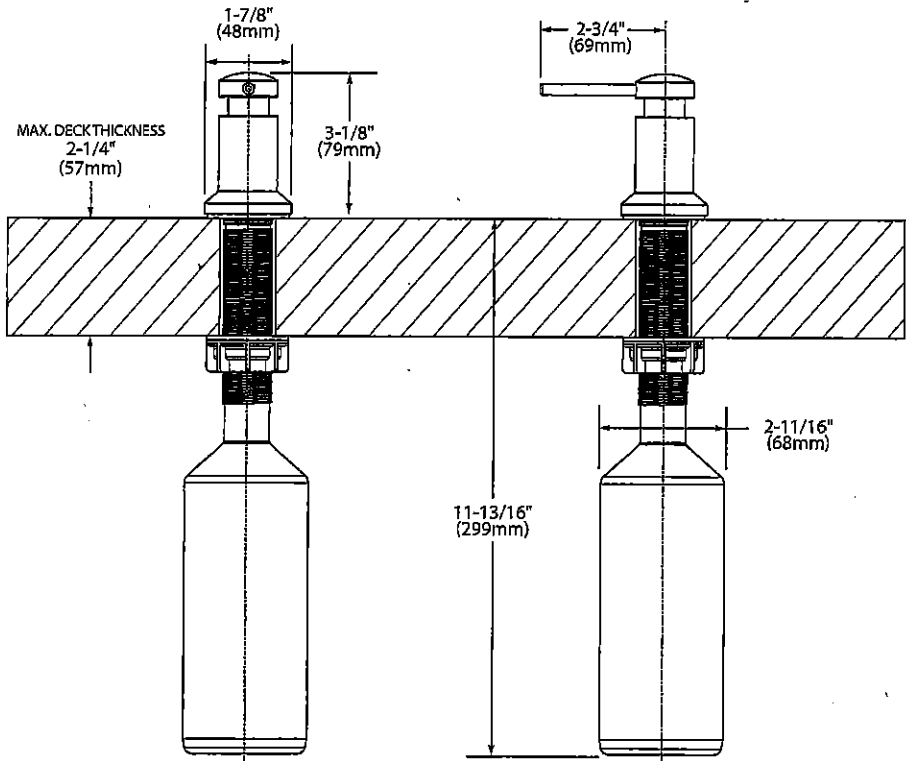

NOTE: DESIGNED TO BE INSTALLED THROUGH 1 HOLE 1-1/8" DIAMETER

CRITICAL DIMENSIONS

(DO NOT SCALE)

TO BE INSTALLED AFTER  
CLOSING - FOR HOLE ONLY

Installing the Drinking Water Faucet

1. If your kitchen sink does not have an existing 1/2" hole, you will have to drill one. (Refer to How to drill a Hole in Your Sink or Counter-top in our RO User Manual). Wipe clean and dry the area.

SAMPLE CONNECTION

Quick Fitting

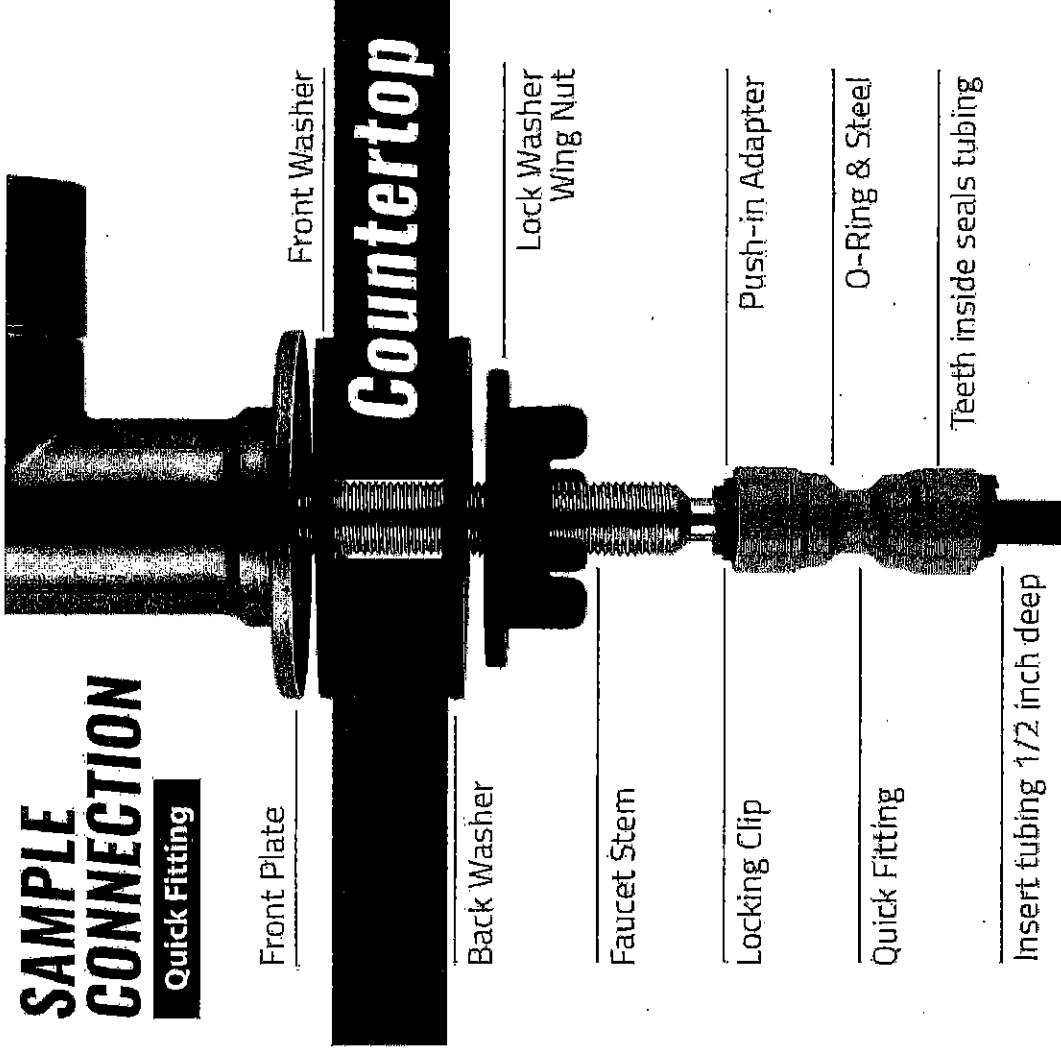

TO BE INSTALLED AFTER  
CLOSING FOR HOLE ONLY

2. Slide the front plate and front washer onto the faucet stem. Insert the faucet stem into the hole on the countertop. Under the sink, insert back washer and tighten the wing nut (you may apply a few rounds of Teflon tape to the threads to get a better grip).

3. Slide the quick connect fitting up the push-in adapter on the base so that it seats securely into the faucet stem, then lock it in place by sliding the blue clip under the collet. Insert the **BLUE** tubing about 1/2 inch into the push-in fitting, and again, secure it with the blue clip.

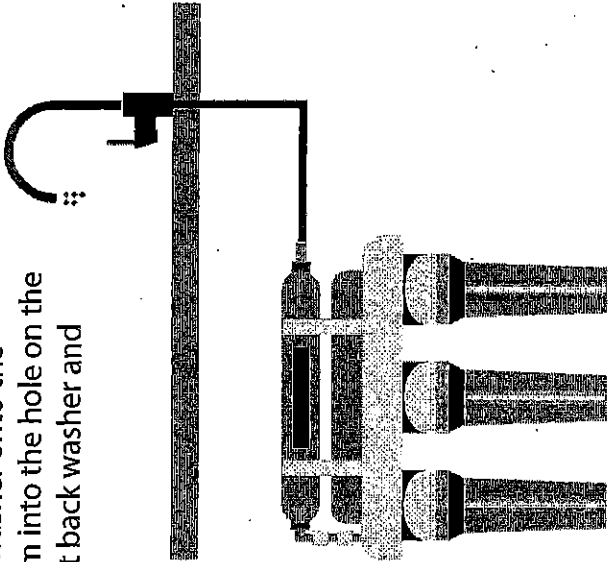

\* 1/4" and 3/8" adapters are included. Pick one that fits your plumbing.

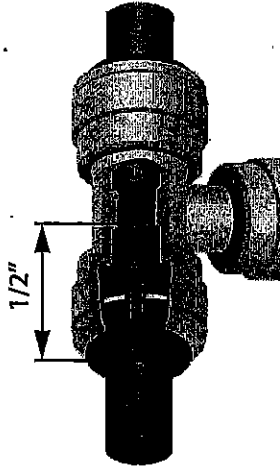

\*To connect, insert the tubing 1/2 inch deep until it's sealed by o-ring and locked by spider teeth.

\*To disconnect, remove blue clip, pull the tubing while pushing down the collet to release the spider teeth.

3020 Trotters Parkway,  
Alpharetta, GA 30004  
www.i23filter.com  
(678) 261-7611



Scan to Register and  
Activate Your 3-Year  
Manufacturer  
Warranty Today!



UK-75 WALLACETON  
LOT 2  
25-2269 ELEV. A  
THE WALDEN

24 of 31



UK-75 WALLACETON  
LOT 2  
25-2269 ELEV. A  
THE WALDEN

25 of 31

## Chateau

Transitional

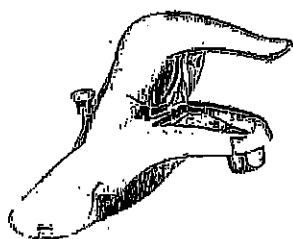

Lavatory Faucet with Pop-Up Drain  
Model L4621†

VANITY SINKS AND PEDESTAL

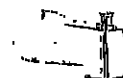

Posi-Temp® Pressure Balancing Tub/Shower  
Model 62320 / TL183†

OR

Posi-Temp Valve and Tub/Shower Trim  
with Eco-Performance Easy Clean® XL

Model 62320 / TL183EP†

(TL183EP not available in BC)

SHOWER AND 5' TUB FAUCETS



2 Handle Roman Tub with 9" Spout  
Model 4796 / T990†

FREESTANDING TUB FAUCETS

gub mls

Cyclone®

## SCB51436 Canopy Hood

### Alito Collection

Makes a statement of strength and power as the stainless steel frame gleams under your kitchen lights. It features baffle filters, tow bright LED lights in each corner, a three-speed control panel, and a quiet, powerful motor. The bold design and strong stainless steel frame encasing the fan will make this machine the focus of your kitchen. Fitted with time-delay "OFF" options up to nine minutes.

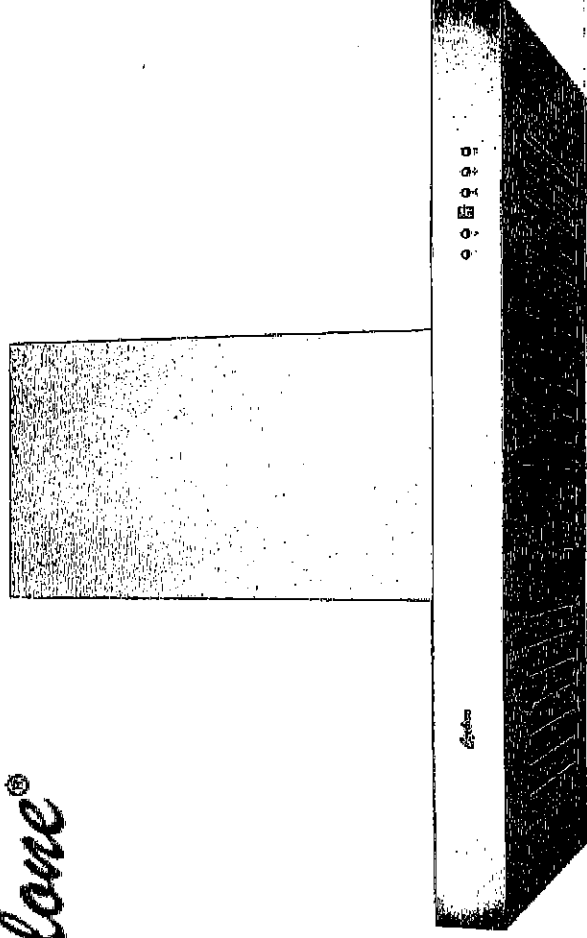

#### Specifications

**Air Flow Volume:** 550 CFM  
**Colours:** Stainless Steel  
**Dimensions:** W:36" H:44.5" D:19.5"  
**Electrical Connection:** 120V/60Hz  
**Electrical Consumption:** 200 watts  
**Fan Speed:** 1254 RPM  
**Sones:** Min. at 2 and Max at 6  
**Venting:** 6" Round (Top Only)

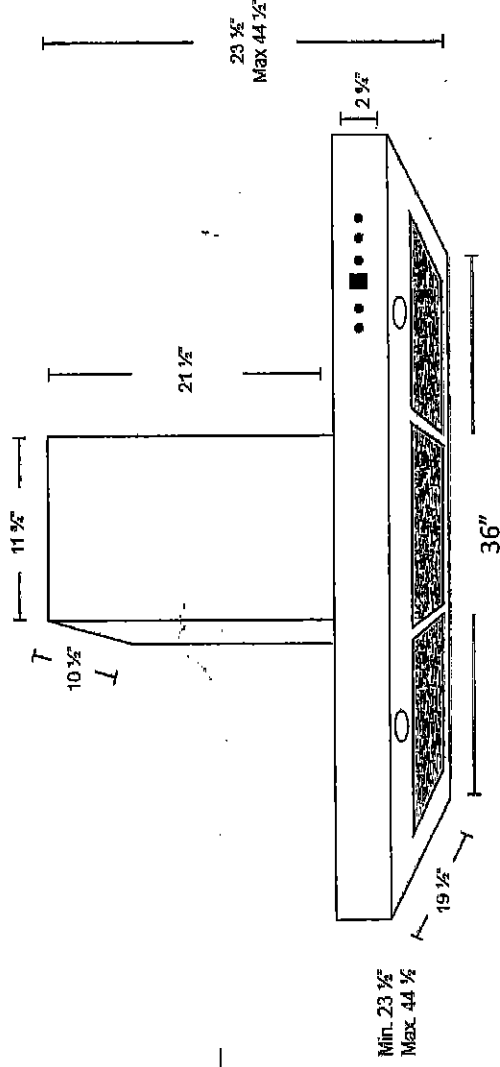
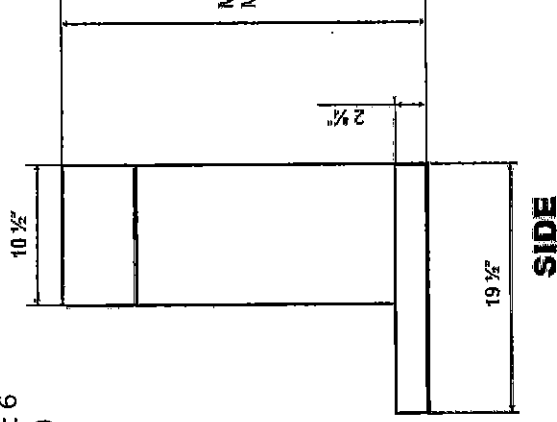
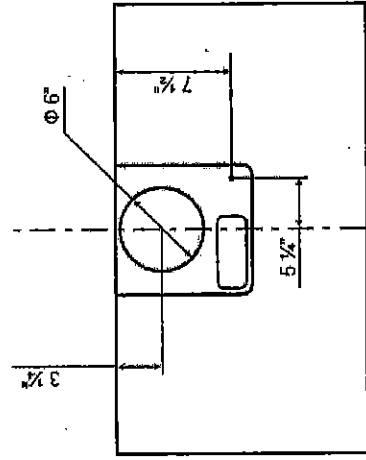

26 of 31

UK-75 WALLACETON  
LOT 2  
25-2269 ELEV. A  
THE WALDEN

27 of 31  
36"

GAS COOKTOP INSTALLATION INSTRUCTIONS  
(For 30" & 36" Models)



INSTALLATION AND SERVICE MUST BE PERFORMED BY A QUALIFIED INSTALLER.  
IMPORTANT: SAVE FOR LOCAL ELECTRICAL INSPECTOR'S USE.  
READ AND SAVE THESE INSTRUCTIONS FOR FUTURE REFERENCE.



**! WARNING** If the information in this manual is not followed exactly, a fire or explosion may result causing property damage, personal injury or death.

FOR YOUR SAFETY:

- Do not store or use gasoline or other flammable vapors and liquids in the vicinity of this or any other appliance.
- WHAT TO DO IF YOU SMELL GAS:
  - Do not try to light any appliance.
  - Do not touch any electrical switch; do not use any phone in your building.
  - Immediately call your gas supplier from a neighbor's phone.Follow the gas supplier's instructions.
- If you cannot reach your gas supplier, call the fire department.
- Installation and service must be performed by a qualified installer, service agency or the gas supplier.

Appliances Installed in the state of Massachusetts:

This Appliance can only be installed in the state of Massachusetts by a Massachusetts licensed plumber or gas fitter. This appliance must be installed with a three (3) foot / 36 in. long flexible gas connector. A "T" handle type manual gas valve must be installed in the gas supply line to this appliance.

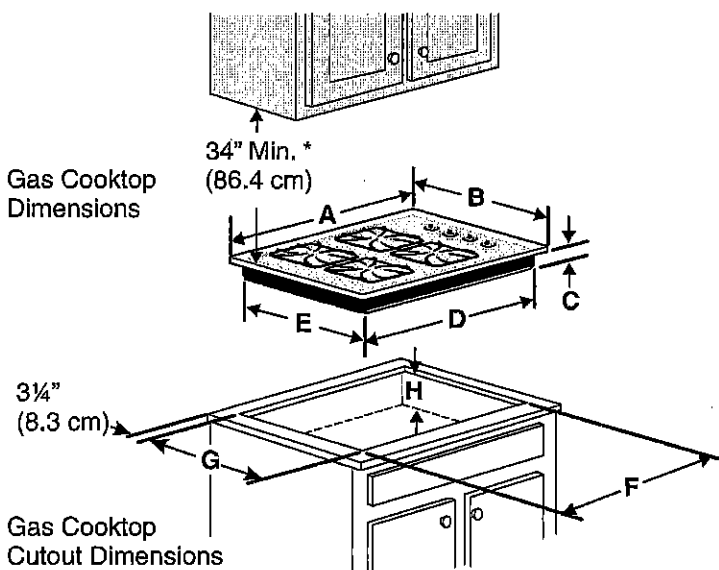

Figure 1

PRODUCT DIMENSIONS					
MODEL	A. WIDTH	B. DEPTH	C. HEIGHT	D. BOX WIDTH	E. BOX DEPTH
30" Gas Cooktop	30 (76.2)	21 3/4 (55.2)	4 1/4 (10.8)	28 (71.1)	19 3/8 (49.2)
36" Gas Cooktop	36 (91.4)	21 3/4 (55.2)	4 1/4 (10.8)	33 5/8 (85.4)	19 (48.3)
CUTOUT DIMENSIONS					
MODEL	F. WIDTH		G. DEPTH		H. HEIGHT BELOW COOKTOP
	MINIMUM	MAXIMUM	MINIMUM	MAXIMUM	
30" Gas Cooktop	28 1/4 (71.8)	28 5/8 (72.7)	19 3/8 (49.2)	19 3/4 (50.2)	8 (20.3)
36" Gas Cooktop	33 7/8 (86)	34 1/4 (87)	19 3/8 (49.2)	19 3/4 (50.2)	8 (20.3)

All dimensions are stated in inches and (cm).

Dimension H includes a 5" (12.7 cm) space underneath the cooktop for connection to gas supply line.

NOTE: Wiring diagrams for this cooktop are enclosed in this booklet

Printed in China

A01705101 (1509) Rev. D

English - pages 1-9

Español - páginas 10-18

Français - pages 19-26

Wiring Diagram 27-28

36" GAS COOKTOP  
WITH 30" OVEN BELOW

GAS COOKTOP INSTALLATION INSTRUCTIONS  
(For 30" & 36" Models)

Typical Under Counter Installation of an Electric Built-in Oven  
with a Cooktop Mounted Above

Only certain cooktop models may be installed over certain built-in electric oven models. Approved cooktops and built-in ovens are listed by the MFG ID number and product code (see the insert sheet included in the literature package and cooktop installation instructions for the dimensions).

Cabinet side filler panels are necessary to isolate the unit from adjoining cabinets. Cabinet side filler height should allow for installation of approved cooktop models

⚠ WARNING

To reduce the risk of personal injury and tipping of the wall oven, the wall oven must be secured to the cabinet (s) by mounting brackets.

208/240 Volt junction box for built-in oven.

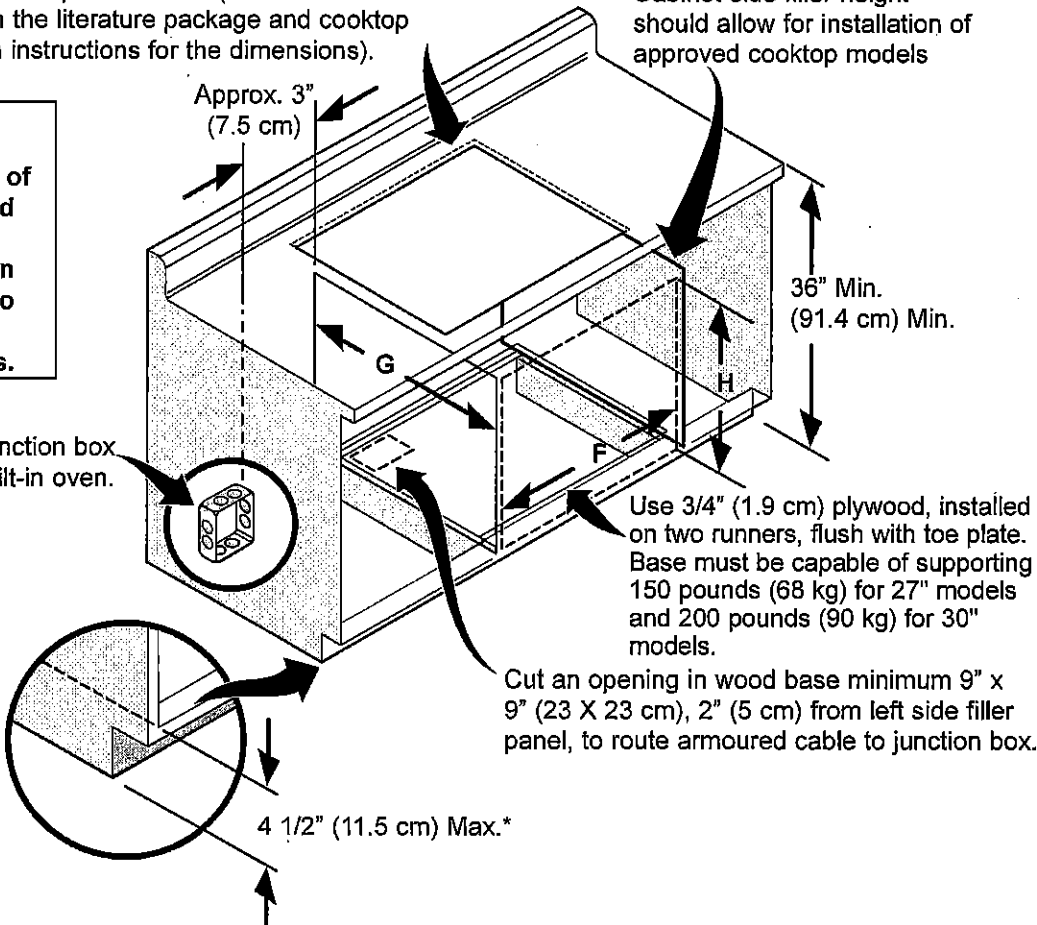

\* If no cooktop is installed directly over the oven unit, 5" (12.7 cm) maximum is allowed above the floor.

OVEN SIZE	CUTOUT DIMENSIONS (INCHES (CM))				
	F. WIDTH		G. DEPTH	H. HEIGHT	
	Min.	Max.	Min.	Min.	Max.
27" (68.6)	24 <sup>7</sup> / <sub>8</sub> " (63.1)	25 <sup>1</sup> / <sub>4</sub> " (64.1)	23 <sup>1</sup> / <sub>2</sub> " (59.7)	27 <sup>1</sup> / <sub>4</sub> " (69.2)	28 <sup>1</sup> / <sub>2</sub> " (72.4)
30" (76.2)	28 <sup>1</sup> / <sub>2</sub> " (72.4)	29" (73.7)	23 <sup>1</sup> / <sub>2</sub> " (59.7)	27 <sup>1</sup> / <sub>4</sub> " (69.2)	28 <sup>1</sup> / <sub>2</sub> " (72.4)

Figure 3

30" OVEN<sup>4</sup> BELOW  
36" GAS COOKTOP

UNDER COUNTER OVEN

ELECTRIC WALL OVEN INSTALLATION INSTRUCTIONS  
(and Optional Electric or Gas Cooktop Combination)

INSTALLATION AND SERVICE MUST BE PERFORMED BY A QUALIFIED INSTALLER.  
IMPORTANT: SAVE FOR LOCAL ELECTRICAL INSPECTOR'S USE.  
READ AND SAVE THESE INSTRUCTIONS FOR FUTURE REFERENCE.

United States  
and Canada



**⚠ WARNING** FOR YOUR SAFETY: Do not store or use gasoline or other flammable vapors and liquids in the vicinity of this or any other appliance.

Your new wall oven has been designed to fit a limited variety of cutout sizes to make the job of installing easier. The first step of your installation should be to measure your current cutout dimensions and compare them to the cutout dimensions chart below for your model. You may find little or no cabinet work being necessary.

**⚠ WARNING** Do not remove spacers (if equipped) on the side walls of the built-in oven. These spacers center the oven in the space provided. The oven must be centered to prevent excess heat buildup that may result in heat damage or fire.

NOTES:

1. Base must be capable of supporting 150 pounds (68 kg) for 27" models and 200 pounds (90 kg) for 30" models.
2. Allow at least 21" (53.3 cm) clearance in front of oven for door depth when it is open.
3. Dimension G (cutout depth) is critical to the proper installation of the built-in oven. If the oven decorative trim does not butt against the cabinet, or if noise is heard on convection models, verify dimension G to assure it is the required depth.
4. For a cutout height greater than 28 1/4" (71.8 cm) add one 2" (5 cm) wide wood shim of appropriate height to each side of the opening under the appliance side rails.
5. For a cutout height (H) greater than 28 1/4" (71.8 cm) you can order a larger bottom trim through a Service Center.

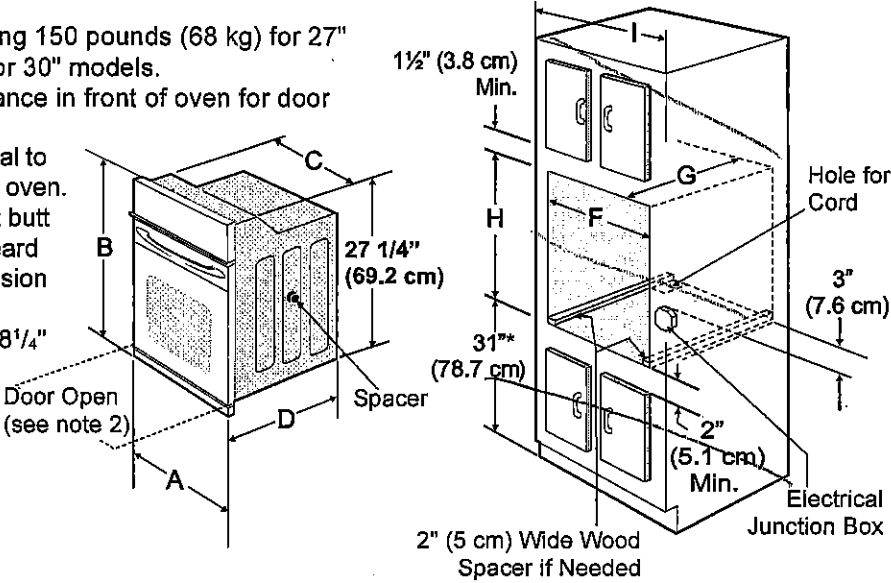

\* Suggested distance from floor is 31" (78.7cm).  
Minimum required distance is 4 1/2" (11.4cm).

Figure 1  
27" and 30" Single Wall Ovens (Double ovens see Figure 2)

PRODUCT DIMENSIONS						
MODEL	A		B	C		D
27" (68.6 cm) Wall Oven	27 (68.6)		29 (73.7)	24 <sup>5</sup> / <sub>8</sub> (62.5)		24 <sup>3</sup> / <sub>4</sub> (62.9)
30" (76.2 cm) Wall Oven	30 (76.2)		29 (73.7)	28 <sup>1</sup> / <sub>4</sub> (71.8)		24 <sup>3</sup> / <sub>4</sub> (62.9)
CUTOUT DIMENSIONS AND CABINET WIDTH						
MODEL	F		G (Min.)	H. Standard Height (*Others, see notes 4 & 5)		I
	Min.	Max.		Min.	Max.	
27" (68.6 cm) Wall Oven	24 <sup>3</sup> / <sub>8</sub> (63.2)	25 <sup>1</sup> / <sub>4</sub> (64.1)	24 (61.0)	27 <sup>1</sup> / <sub>4</sub> (69.2)	28 <sup>1</sup> / <sub>4</sub> (71.8)	27 <sup>1</sup> / <sub>8</sub> (68.9) Min
30" (76.2 cm) Wall Oven	28 <sup>1</sup> / <sub>2</sub> (72.4)	29 (73.7)	24 (61.0)	27 <sup>1</sup> / <sub>4</sub> (69.2)	28 <sup>1</sup> / <sub>4</sub> (71.8)	30 <sup>1</sup> / <sub>8</sub> (76.5) Min

All dimensions are in inches (cm).  
Printed In U.S.A.

PN 807153701 Rev. D (16/05)  
English – pages 1-8  
Español – páginas 9-16  
Français – pages 17-24

30" OVEN BELOW  
36" GAS COOKTOP

UK-75 WALLACETON  
LOT 2  
25-2269 ELEV. A  
THE WALDEN

30 of 31

ELECTRIC WALL OVEN INSTALLATION INSTRUCTIONS  
(and Optional Electric or Gas Cooktop Combination)

**⚠ WARNING** Do not remove spacers (if equipped) on the side walls of the built-in oven. These spacers center the oven in the space provided. The oven must be centered to prevent excess heat buildup that may result in heat damage or fire.

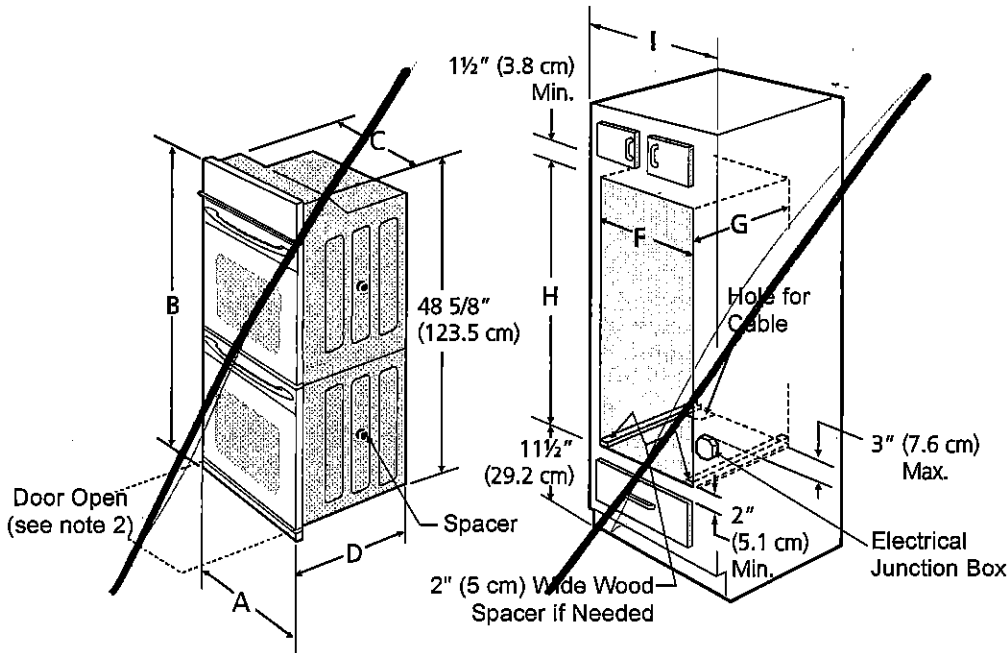

NOTES:

1. Base must be capable of supporting 300 pounds (136 kg) for 27" models and 375 pounds (170 kg) for 30" models.

2. Allow at least 21" (53.3 cm) clearance in front of oven for door depth when it is open.

3. Dimension G (cutout depth) is critical to the proper installation of the built-in oven. If the oven decorative trim does not butt against the cabinet, or if noise is heard on convection models, verify dimension G to assure it is according to the required dimension.
4. For a cutout height greater than 49 5/8" (126 cm) add a 2" (5 cm) wide wood shim of appropriate height to each side of the opening under the appliance side rails.

5. For a cutout height (H) greater than 49 5/8" (126 cm) you can order a larger bottom trim through a Service Center.

Figure 2  
27" AND 30" DOUBLE OVENS (Single Ovens see Figure 1)

PRODUCT DIMENSIONS						
MODEL	A		B	C		D
<del>27" (68.6 cm) Wall Oven</del>	<del>27 (68.6)</del>		<del>50<sup>7</sup>/<sub>16</sub> (128.1)</del>	<del>24<sup>5</sup>/<sub>8</sub> (62.5)</del>		<del>21<sup>1</sup>/<sub>4</sub> (52.9)</del>
30" (76.2 cm) Wall Oven	30 (76.2)		50 <sup>7</sup> / <sub>16</sub> (128.1)	28 <sup>1</sup> / <sub>4</sub> (71.8)		24 <sup>3</sup> / <sub>4</sub> (62.9)
CUTOUT DIMENSIONS AND CABINET WIDTH						
MODEL	F		G (Min.)	H: Standard Height (**Others, see notes 4 & 5)		I
	Min.	Max.		Min.	Max.	
<del>27" (68.6 cm) Wall Oven</del>	<del>24<sup>1</sup>/<sub>2</sub> (63.2)</del>	<del>25<sup>1</sup>/<sub>4</sub> (64.1)</del>	<del>24 (61.0)</del>	<del>48<sup>7</sup>/<sub>8</sub> (124.1)</del>	<del>49<sup>5</sup>/<sub>8</sub> (126)</del>	<del>27<sup>1</sup>/<sub>8</sub> (68.9) Min</del>
30" (76.2 cm) Wall Oven	28 <sup>1</sup> / <sub>2</sub> (72.4)	29 (73.7)	24 (61.0)	48 <sup>7</sup> / <sub>8</sub> (124.1)	49 <sup>5</sup> / <sub>8</sub> (126)	30 <sup>1</sup> / <sub>8</sub> (76.5) Min

All dimensions are in inches (cm).

30" OVEN  
BELOW 36" GAS COOKTOP

31 of 31

## ELECTRIC WALL OVEN INSTALLATION INSTRUCTIONS

(and Optional Electric or Gas Cooktop Combination)

If oven is used in a new branch circuit installation (1996 NEC), mobile home, recreational vehicle, or where local codes DO NOT permit grounding through the neutral (white) wire, the appliance frame MUST NOT be connected to the neutral wire of the 4-wire electrical system. (see figure 4):

1. Disconnect the power supply.
2. Separate the green (or bare copper) and white appliance cable wires.
3. In the junction box: connect appliance and power supply cable wires as shown in Figure 4.

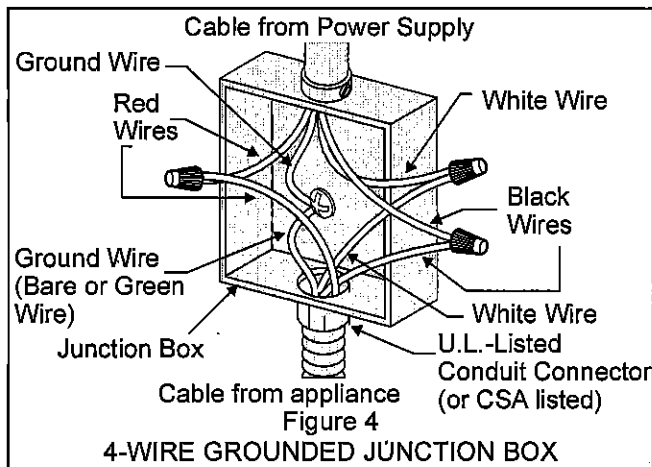

### Model and Serial Number Location

The serial plate is located along the interior side trim of the oven and visible when the door is opened.

When ordering parts for or making inquiries about your oven, always be sure to include the model and serial numbers and a lot number or letter from the serial plate on your oven.

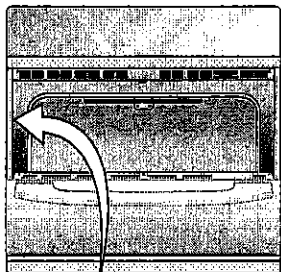

Single Wall Oven  
Serial Plate Location

Double Wall Oven  
Serial Plate Location

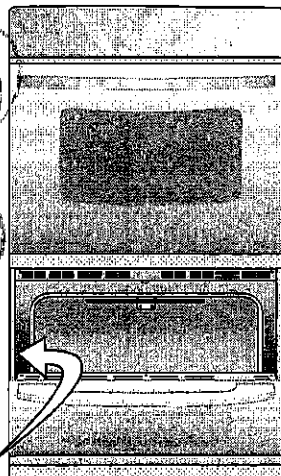

## 5. Cabinet Installation

### IMPORTANT!

Do not lift or manipulate the oven by the door handle or the control panel.

### WARNING

#### Heavy Weight Hazard

- Use 2 or more people to move and install wall oven.
- Failure to follow this instruction can result in injury or damage to the unit.

1. Unpack the wall oven. Remove the bottom trim taped on the oven top panel.
2. Find the 2 anti-tip mounting screws included in the literature package.
3. Insert the oven into the cabinet opening. Slide oven inward leaving 1½" (3.8 cm) clearance between the oven and front of cabinet (see Figure 5).
4. Pull the armored cable through the hole for it in the cabinet and toward the junction box while moving the appliance inward.
5. Push the oven in and against the cabinet.

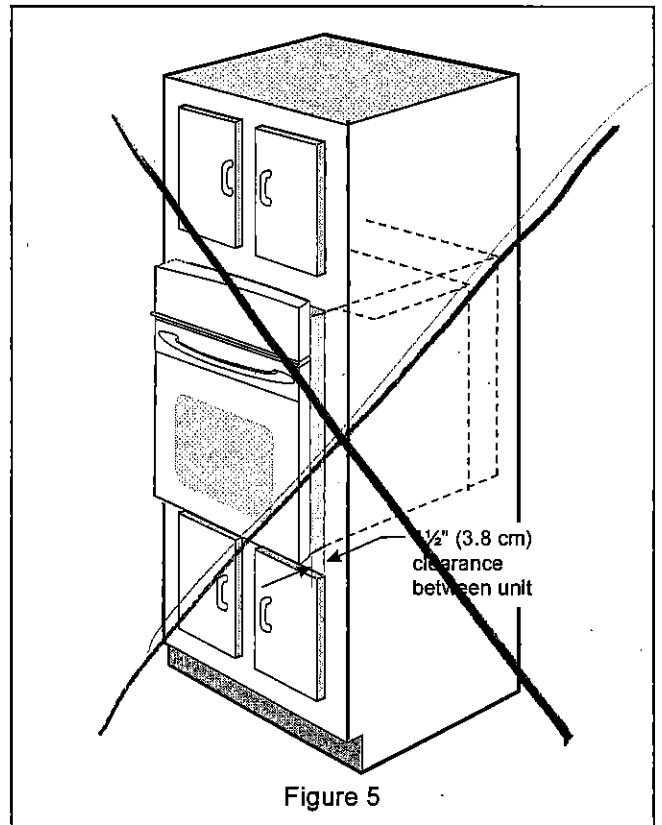

Figure 5

30" SINGLE OVEN BELOW  
 36" GAS COOKTOP