

PRE-Sales Selection Sheet
Checklist

1 of 33

LOT 286B-15 Model: 20-1790 A The Dunmore
PURCHASERS: GIRAY SOKULMEZ/ARMAGAN UNAY
VENDOR: Heathwood Homes (Huron) Limited

- FINISHED BASEMENT
- COLD CELLAR

UPGRADED / MODIFIED ELEVATION

- CORNER UPGRADE
- REAR UPGRADE

CEILING UPGRADE - SMOOTH

- MAIN FLOOR
- SECOND FLOOR
- BASEMENT

ADDITIONAL ROUGH-INS

- 200 AMP SERVICE
- WET BAR ROUGH-IN
- HUMIDIFIER
- AIR CONDITIONING

GAS ROUGH-IN

- STOVE
- DRYER
- BBQ
- ADDITIONAL FIREPLACE

KITCHEN: HOODFAN VENTING SIZE

- 6 IN ROUND DUCT
- 7 IN ROUND DUCT

FULL BASEMENT STAIRS:

UPPER BASEMENT STAIRS:

LOWER BASEMENT STAIRS:

MAIN STAIRS:

MEDIA STAIRS (if applicable):

LOFT STAIRS (if applicable):

N/A
All Oak
Carpet Grade
All Oak
N/A
N/A

Dec 4/20 Date Purchaser: *Signatures on file*

DEC 4 20 Date Decor Consultant: *myRosen*

APPROVED
-12-07-2020 Date Approved
Heathwood Homes (Huron) Limited

Date Purchaser:

Locked Date:



Sales Selection Sheet

Wallaceton

2 of 33

PURCHASERS: GIRAY SOKULMEZ and ARMAGAN UNAY

TEL:

LOT / UNIT 286B-15	PHASE 2	MODEL 20-1790 A The Dunmore
-----------------------	------------	--------------------------------

It is herein understood and agreed between the undersigned parties hereto that the following changes shall be made to the above mentioned Agreement of Purchase and Sale in accordance with the agreement and except for such changes noted below, all other terms and conditions in the Agreement of Purchase and Sale shall remain as stated herein: It is further understood that and agreed that all changes and additions shall be installed as per builder's specifications, location and available selections. The Purchaser hereby agrees to purchase the following extras:

ADMIN FEE

1	- SCHEDULE "E" FIVE APPLIANCES: SS FRIDGE, STOVE, DISHAWASHER, WHITE FRONT LOADER WASHER AND DRYER-TOWNHOMES	Qty: 1
51,117	Note: SPECS PAGES 22-33	

Sub Total
HST
Total

1. This Sales Selection Sheet when properly executed forms part of our Agreement of Purchase and Sale.
2. All extras and upgrades listed above are subject to Construction Progress and Architectural and Municipal requirements.
3. In the event the Vendor is unable to incorporate the work approved above in the construction of the house for any reason whatsoever, the Vendor will not be liable to the Purchaser in any way. The monies paid for any changes or optional extras not proceeded with shall be returned to the Purchaser, without interest. The cost of options or extras is non-refundable in all other circumstances. If for any reason whatsoever the Agreement of Purchase and Sale is not completed, the total cost of work approved above will be retained by the Vendor.
4. The Vendor reserves the right to substitute above materials and equipment with that of equal or better quality.
5. Purchaser acknowledges that items may not be exactly as shown. Variations from the Vendor's samples may occur in finished materials due to normal production processes. Vendor is not responsible for shade difference which may occur from different dye lots or wood grains. Variations from the Vendor's samples will occur with natural materials such as wood, marble, granite, hardwood and brick.
6. The Vendor reserves the right to select Grout & Thresholds that best suits the Tile selected.
7. Selections will not be processed unless signed by Heathwood Homes Head Office.
8. The selections made on this schedule are final and cannot be changed once submitted.
9. The Purchaser has checked and acknowledges the accuracy of this schedule.

Payment Summary	Amount
<u>Paid By</u>	
<u>Total Payment:</u>	

PURCHASER: Giray Sokulmez 05-Dec-20 DATE 05-Dec-20 05-Dec-20 DATE
 PURCHASER: ARMAGAN UNAY 05-Dec-20 DATE 05-Dec-20 DATE
 Decor Consultant Ms. Sokulmez 05-Dec-20 DATE
APPROVED - M. Loren 12-07-2020

Date Approved Heathwood Homes (Huron) Limited

TAX#:1

PREPARED BY: Irit Salem

PE 690-1

Slinvoice.rpt.26may19

Customer Colours

274

GIRAY SOKULMEZ/ARMAGAN UNAY
Project: Wallaceston
Unit: 286B-15, Phase: 2
Model: 20-1790 A The Dunmore

Created: 12/1/2020 10:01:47

Locked:

Closed:

3 of 33

Kitchen

Cabinet Colour/Style	9166	Viking III-CHARLESTON-ORCHID-3DL ***STD***
Countertop	9069	MSI Quartz GROUP 1 ICED WHITE ***STD***
Countertop Edge	4010	SINGLE POLISHED STRAIGHT EDGE 3/4 INCH ***STD*** 
Cabinet Hardware	2093	9671-HARDWARE ***STD***
Island Cabinet Colour/Style	9166	Viking III-CHARLESTON-ORCHID-3DL ***STD***
Island Countertop	9069	MSI Quartz GROUP 1 ICED WHITE ***STD***
Backsplash	1111	N/A *****
Backsplash Grout	1111	N/A *****
Backsplash Tile Pattern	1111	N/A *****

HoodFan	8909	KVWB600DSS-KITCHEN AID 30 inch STAINLESS CHIMNEY HOOD-STAINLESS STEEL-30 inch ***Upg*** PAGE 21
Appliance	8894	Purchasers have been advised: standard fridge opening is a minimum 37 3/8 x 73 3/8". Ice Waterline Rough-In is included.
Appliance	8894	Standard stove opening is 30" and standard dishwasher opening is 24". Any gas stove will require backsplash or stainless steel backing to avoid fire hazards.
Appliance	8894	Purchasers acknowledge: Heathwood Homes and its contractors will not be responsible for any kitchen cabinet changes due to appliances dimension changes after
Comment		

Kitchen/Breakfast

Flooring	8894	GE.MD.WHT.1818.MT Madison Series White Matte 18
Floor Tile Grout	2225	Grout-(27) Silver ***STD***
Floor Tile Pattern	3000	STANDARD SQUARE ***STD***

88 AU

GIRAY SOKULMEZ/ARMAGAN UNAY

Project: Wallaceston

Unit: 286B-15, Phase: 2

Model: 20-1790 A The Dunmore

Created: 12/1/2020 10:01:47

Locked:

Closed:

4 of 33

Comment

Foyer

Flooring

3000 GE.MD.WHT.1818.MT Madison Series White Matte 18

Floor Tile Grout

2225 Grout-(27) Silver ***STD***

Floor Tile Pattern

3000 STANDARD SQUARE ***STD***

Comment

Laundry Room

Flooring

3000 GE.BY.AZR.1313 New Byzantine Azzuro 13

Floor Tile Grout

2225 Grout-(27) Silver ***STD***

Floor Tile Pattern

3000 STANDARD SQUARE ***STD***

Comment

Laundry Room Opt.

Cabinet - Uppers

1111 N/A *****

Cabinet Hardware

1111 N/A *****

Comment

Mud Room

Flooring

1111 GE.MD.WHT.1818.MT Madison Series White Matte 18

8 AU

Customer Colours

274

GIRAY SOKULMEZ/ARMAGAN UNAY
Project: Wallaceton
Unit: 286B-15, Phase: 2
Model: 20-1790 A The Dunmore

Created: 12/1/2020 10:01:47

Locked:

Closed:

5 of 33

Floor Tile Grout

2225

Grout-(27) Silver ***STD***

Floor Tile Pattern

3000

STANDARD SQUARE ***STD***

Comment

Powder Room

Flooring

3000

GE.MD.WHT.1818.MT Madison Series White Matte 18

Floor Tile Grout

2225

Grout-(27) Silver ***STD***

Floor Tile Pattern

3000

STANDARD SQUARE ***STD***

Plumbing Fixture (Colour)

1737

Plumbing Fixtures-WHITE ***STD***

Comment

Hall

Flooring

7498

Red Oak Pearl-Vintage Engineered-IRONGATE-3/4 inch x
3 1/4 inch ***STD***

Comment

Dining Room

Flooring

7498

Red Oak Pearl-Vintage Engineered-IRONGATE-3/4 inch x
3 1/4 inch ***STD***

Comment

Great Room

Flooring

7498

Red Oak Pearl-Vintage Engineered-IRONGATE-3/4 inch x
3 1/4 inch ***STD***

Comment

gdu AU

Customer Colours

GIRAY SOKULMEZ/ARMAGAN UNAY
Project: Wallaceon
Unit: 286B-15, Phase: 2
Model: 20-1790 A The Dunmore

Created: 12/1/2020 10:01:47

Locked:

Closed:

6 of 33

Upper Hall

Flooring

9248

DY 89418 -Dynasty Tex-BLACK ICE-40 oz Poly***STD***

Comment

Finished Basement (Rec) Room/Hall

Flooring

9248

DY 89418 -Dynasty Tex-BLACK ICE-40 oz Poly***STD***

Comment

Master Bedroom

Flooring

9248

DY 89418 -Dynasty Tex-BLACK ICE-40 oz Poly***STD***

Comment

Bedroom 2

Flooring

7498

Red Oak Pearl-Vintage Engineered-IRONGATE-3/4 inch x
3 1/4 inch ****3***

Comment

Bedroom 3

Flooring

7498

Red Oak Pearl-Vintage Engineered-IRONGATE-3/4 inch x
3 1/4 inch ****3***

Comment

Master Ensuite

Cabinet Colour/Style

9166

Viking III-CHARLESTON-ORCHID-3DL ***STD***

Countertop

8827

4925K-07-Countertop-CALCUTTA MARBLE-Wilsonart
STD

85 Au

Customer Colours

GIRAY SOKULMEZ/ARMAGAN UNAY
 Project: Wallaceston
 Unit: 286B-15, Phase: 2
 Model: 20-1790 A The Dunmore

Created: 12/1/2020 10:01:47

Locked:

Closed:

7 of 33

Countertop Edge	1111	N/A *****
Cabinet Hardware	2093	9671-HARDWARE ***STD***
Floor Tile	2093	GE.BY.AZR.1313 New Byzantine Azzuro 13
Floor Tile Grout	2225	Grout-(27) Silver ***STD***
Floor Tile Pattern	3000	STANDARD SQUARE ***STD***
Shower Floor Tile	8661	OD.ON.SWT.0202.MT.N-Ontario Series Mosaic-Snow White Matte-2 x 2 ***STD***
Shower Floor Tile Grout	2226	Grout-(00) White ***STD***
Shower Floor Tile Pattern	3000	STANDARD SQUARE ***STD***
Shower Wall Tile	9020	QT.WV.WHT.0810-Weave-White-8 x 10 ***STD***
Shower Wall Tile Grout	2226	Grout-(00) White ***STD***
Shower Wall Tile Pattern	3090	VERTICAL STACKED ***STD***
Shower Jamb(s) and Sill(s)	8923	Shower Jamb / Sill-Thassos White ***STD***
Plumbing Fixture (colour)	1737	Plumbing Fixtures-WHITE ***STD***
Comment		

Main Bathroom

B AU

Cabinet Colour/Style	9166	Viking III-CHARLESTON-ORCHID-3DL ***STD***
Countertop	8827	4925K-07-Countertop-CALCUTTA MARBLE-Wilsonart ***STD***
Countertop Edge	1111	N/A *****

Customer Colours

274

GIRAY SOKULMEZ/ARMAGAN UNAY
Project: Wallaceston
Unit: 286B-15, Phase: 2
Model: 20-1790 A The Dunmore

Created: 12/1/2020 10:01:47

Locked:

Closed:

8 of 33

Cabinet Hardware 2093 9671-HARDWARE ***STD***

Flooring 2093 GE.BY.AZR.1313 New Byzantine Azzuro 13

Floor Tile Grout 2225 Grout-(27) Silver ***STD***

Floor Tile Pattern 3000 STANDARD SQUARE ***STD***

Wall Tile 9020 QT.WV.WHT.0810-Weave-White-8 x 10 ***STD***

Wall Tile Grout 2226 Grout-(00) White ***STD***

Main Bathroom Tile Pattern 3090 VERTICAL STACKED ***STD***

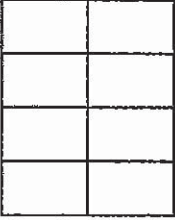

Plumbing Fixture (Colour) 1737 Plumbing Fixtures-WHITE ***STD***

Comment

Finished Basement Bathroom

Cabinet Colour/Style 9166 Viking III-CHARLESTON-ORCHID-3DL ***STD***

Countertop 8827 4925K-07-Countertop-CALCUTTA MARBLE-Wilsonart ***STD***

Countertop Edge 1111 N/A *****

Cabinet Hardware 2093 9671-HARDWARE ***STD***

Flooring 2093 GE.BY.AZR.1313 New Byzantine Azzuro 13

Floor Tile Grout 2225 Grout-(27) Silver ***STD***

Floor Tile Pattern 3000 STANDARD SQUARE ***STD***

Shower Floor Tile 8661 OD.ON.SWT.0202.MT.N-Ontario Series Mosaic-Snow White Matte-2 x 2 ***STD***

8 AU

Customer Colours

274

GIRAY SOKULMEZ/ARMAGAN UNAY
Project: Wallaceton
Unit: 286B-15, Phase: 2
Model: 20-1790 A The Dunmore

Created: 12/1/2020 10:01:47

Locked:

Closed:

9 of 33

Shower Floor Tile Grout 2226 Grout-(00) White ***STD***

Shower Floor Tile Pattern 3000 STANDARD SQUARE ***STD***

Shower Wall Tile 9022 QT.WV.TGR.0810-Weave-Tender Grey-8 x 10 ***STD***

Shower Wall Tile Grout 2226 Grout-(00) White ***STD***

Shower Wall Tile Pattern 3090 VERTICAL STACKED ***STD***



Shower Jamb(s) 8923 Shower Jamb / Sill-Thassos White ***STD***

Plumbing Fixture (Colour) 1737 Plumbing Fixtures-WHITE ***STD***

Comment

Great Room Fireplace

Type 8865 Dimplex-Electric Fireplace-PF3033HL ***STD***

Mantle 8891 NF-17-Paint Grade Mantle- Cabinet (Per Plan)-WHITE ***STD***

PAGE 17

Surround Opt. 1111 N/A *****

Note 1111 Purchasers have been advised: heat from the FP can damage TV above a FP and items placed on mantle.

Note

Comment

Basement Stairs

Type 1714 Carpet Grade Stairs ***STD BASEMENT STAIRS***

Colour 7912 Irongate (Gyphon) STAIN TO COMPLIMENT HARDWOOD AND WILL VARY FROM FLOORING

Carpet Runner 1111 N/A *****

Handrail/Pickets/Post Type 9119 Handrail only on closed walls (one or two sides per building code) ***STD***

SA

Customer Colours

274

GIRAY SOKULMEZ/ARMAGAN UNAY

Created: 12/1/2020 10:01:47

Project: Wallaceton

Unit: 286B-15, Phase: 2

Model: 20-1790 A The Dunmore

10.33

Job: [REDACTED]

Handrail/Pickets/Post Colours

1729 Carpet Grade-Stain handrail, pickets, stringers, nosing_pos

Carpet

9248 DY 89418 -Dynasty Tex-BLACK ICE-40 oz Poly***STD***

Custom Stain/Paint

1111 N/A *****

Comment

[REDACTED]

Basement Stairs Landings (Upper and Lo

Flooring

7498 Red Oak Pearl-Vintage Engineered-IRONGATE-3/4 inch x 3 1/4 inch ****3****

Comment

[REDACTED]

Main Stairs

Type

1712 Oak Stairs ***STD MAIN STAIRS***

Colour

7912 Irongate (Gryphon) STAIN TO COMPLIMENT HARDWOOD AND WILL VARY FROM FLOORING

Carpet Runner

1111 N/A *****

Handrail/Pickets/Posts Type

7652 1 5/16 inch Square pickets with 3 1/2" Square/Cap Post(s)-ALL OAK ***STD***

Handrail/Pickets/Posts Colour

1728 Oak Grade-Stain handrail,oak pickets,stringers,treads,risers

Custom Stain/Paint

1111 N/A *****

Comment

[REDACTED]

Main Stairs Landing(s)

Flooring

7498 Red Oak Pearl-Vintage Engineered-IRONGATE-3/4 inch x 3 1/4 inch ***STD***

Comment

[REDACTED]

88 Au

Throughout

[REDACTED]

Customer Colours

274

GIRAY SOKULMEZ/ARMAGAN UNAY
Project: Wallaceton
Unit: 286B-15, Phase: 2
Model: 20-1790 A The Dunmore

Created: 12/1/2020 10:01:47

Locked:

Closed:

1 of 33

Walls - Paint Colour	1717	22-Wall-WARM GREY ***STD***
Underpad	1079	500 Series-Underpad ***STD***
Thresholds	2232	Metal Thresholds ***STD***
Switches and Plug	5796	Decora White Switches and Plugs ***STD***
Trim Size	8705	4 1/4 Baseboard and 2 3/4 Casings ***STD***
Trim - Paint Colour	1716	Trim-WHITE ***STD***

Comment

Purchaser:

GIRAY SOKULMEZ

Dec 01/20
Date

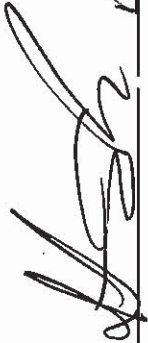
Decor Consultant

Dec 4. 2020
Date

APPROVED

Purchaser:

ARMAGAN UNAY

Dec 04/20
Date

Wallaceton

Dec- 07 2020
Date Approved



Sales Selection Sheet

12 of 33

Wallaceton

PURCHASERS: GIRAY SOKULMEZ and ARMAGAN UNAY

TEL:

LOT / UNIT	PHASE	MODEL
286B-15	2	20-1790 A The Dunmore

It is herein understood and agreed between the undersigned parties hereto that the following changes shall be made to the above mentioned Agreement of Purchase and Sale in accordance with the agreement and except for such changes noted below, all other terms and conditions in the Agreement of Purchase and Sale shall remain as stated herein: It is further understood that and agreed that all changes and additions shall be installed as per builder's specifications, location and available selections. The Purchaser hereby agrees to purchase the following extras:

APPLIANCES

1	- KWVB6000DSS KITCHEN AID 30" SS	Qty: 1
50,858	Note: KITCHENAID 30" PAGE 21	

CABINETRY

2	- CABINERY - 04H-66CM DEEP FRIDGE ENCLOSURE (COUNTER DEPTH) WITH (1) WALL (1) 66CM DEEP GABLE AND (1) 66CM DEEP CABINET) (THIS IS NOT A ZERO CLEARANCE ENCLOSURE. STANDARD HEIGHTS AND WIDTHS WILL BE USED.) ; PRICE ALL THE SAME FOR ALL LINES - KITCHEN	Qty: 1
50,857	Note: SKETCH # 2 PAGE 15	

CERAMICS

3	- CERAMICS - FLOOR - FOYER - UPGRADE 1	Qty: 1
177,186		
50,849	Note:	
4	- CERAMICS - FLOOR - KITCHEN - UPGRADE 1	Qty: 1
177,221		
50,850	Note:	
5	- CERAMICS - FLOOR - MUD ROOM - UPGRADE 1	Qty: 1
177,205		
50,851	Note:	
6	- CERAMICS - FLOOR - POWDER ROOM - UPGRADE 1	Qty: 1
177,197		
50,852	Note:	

ELECTRICAL

7	- ELECTRICAL - EXTRA WALL INTERIOR OUTLET ON EXISTING CIRCUIT (DOES NOT INCLUDE KITCHEN OUTLETS)	Qty: 2
189,448		
50,854	Note: GREAT ROOM- TO BE INSTALL ABOVE THE FIRE PLACE 70" FROM FLOOR FAMILY ROOM- 70 FROM FLOOR SEE SKETCH # 2 PAGE# 15	
8	- ELECTRICAL - CEILING ROUGH-IN (CAPPED)	Qty: 2
189,450		
50,855	Note: GREAT ROOM-USE EXISTING SWITCH PLUG KITCHEN- ABOVE THE BREAKFAST BAR-USE SEPARATE SWITCH SEE SKETCH # 2 PAGE# 15	
9	- ELECTRICAL - ADDITIONAL SWITCH	Qty: 1
189,451		
50,856	Note: KITCHEN- TO BE USED FOR THE R/ CAP LIGHT SKETCH # 2 PAGE 15	

TAX#:1

PREPARED BY: Irit Salem

PE 686-1

Slmvoice.rpt.28may19

Initials: GS AJ



Sales Selection Sheet

Wallaceton

13 of 33

PURCHASERS: GIRAY SOKULMEZ and ARMAGAN UNAY

TEL:

LOT / UNIT 286B-15	PHASE 2	MODEL 20-1790 A The Dunmore
-----------------------	------------	--------------------------------





PLUMBING

10 189,689	- PLUMBING - OPTION FROM ONE SINK TO DOUBLE SINKS INCLUDING STD CHATEAU FAUCET, STD COLONY SINK, INCLU INCLUDING CABINET CONVERSION 2D VIKING AND ONE EXTRA VANITY LIGHT Note: MASTER BATHROOM SKETCH # 3 PAGE 16	Qty: 1
50,853		
11 189,689	- PLUMBING - OPTION FROM ONE SINK TO DOUBLE SINKS INCLUDING STD CHATEAU FAUCET, STD COLONY SINK, INCLU INCLUDING CABINET CONVERSION 2D VIKING AND ONE EXTRA VANITY LIGHT Note: MAIN BATHROOM SKETCH # 3 PAGE 16	Qty: 1
50,859		

Sub Total
HST
Total

1. This Sales Selection Sheet when properly executed forms part of our Agreement of Purchase and Sale.
2. All extras and upgrades listed above are subject to Construction Progress and Architectural and Municipal requirements.
3. In the event the Vendor is unable to incorporate the work approved above in the construction of the house for any reason whatsoever, the Vendor will not be liable to the Purchaser in any way. The monies paid for any changes or optional extras not proceeded with shall be returned to the Purchaser, without interest. The cost of options or extras is non-refundable in all other circumstances. If for any reason whatsoever the Agreement of Purchase and Sale is not completed, the total cost of work approved above will be retained by the Vendor.
4. The Vendor reserves the right to substitute above materials and equipment with that of equal or better quality.
5. Purchaser acknowledges that items may not be exactly as shown. Variations from the Vendor's samples may occur in finished materials due to normal production processes. Vendor is not responsible for shade difference which may occur from different dye lots or wood grains. Variations from the Vendor's samples will occur with natural materials such as wood, marble, granite, hardwood and brick.
6. The Vendor reserves the right to select Grout & Thresholds that best suits the Tile selected.
7. Selections will not be processed unless signed by Heathwood Homes Head Office.
8. The selections made on this schedule are final and cannot be changed once submitted.
9. The Purchaser has checked and acknowledges the accuracy of this schedule.

Payment Summary	Amount
<u>Paid By</u>	
<u>Total Payment:</u>	

PURCHASER:  GIRAY SOKULMEZ
 DATE: 04-Dec-20
DECOR CONSULTANT:  DATE: 04-Dec-20
PURCHASER:  ARMAGAN UNAY
 DATE: 04-Dec-20
APPROVED:  DATE: 12-07-2020
 Date Approved: Heathwood Homes (Huron) Limited

TAX#:1

PREPARED BY: Irit Salem

PE 686-2

SI Invoice.rpt.26May19

UK-75 WALLACETON
LOT 286B-15
20-1790 ELEV. A
THE DUNMORE

14 of 33

THE DUNMORE

ELEVATION A | 2,233 SQ. FT.

20-1790 ELEV. A

Includes 443 square feet of finished lower level
Sketch #1

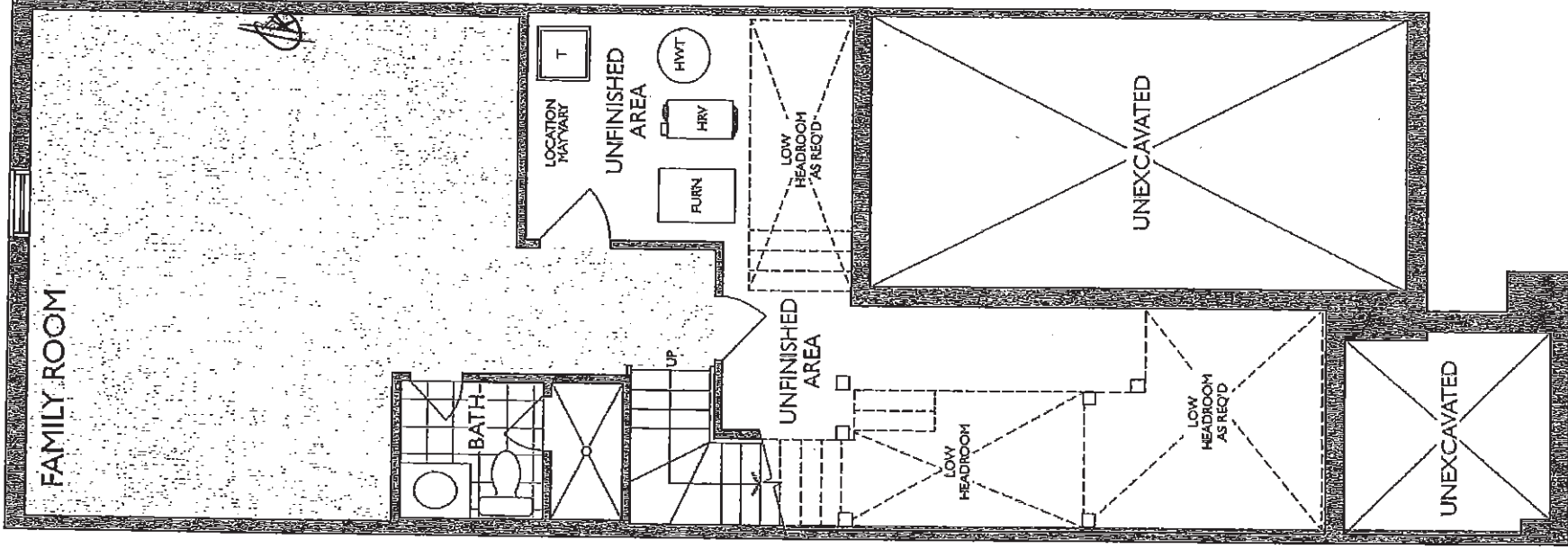

LOWER LEVEL
ELEVATION A



UK-75 WALLACETON
LOT 2868-15
20-1790 ELEV. A
THE DUNMORE

15 of 33

THE DUNMORE

ELEVATION A | 2,233 SQ. FT.

20-1790 ELEV. A

Includes 443 square feet of finished lower level

Sketch #2

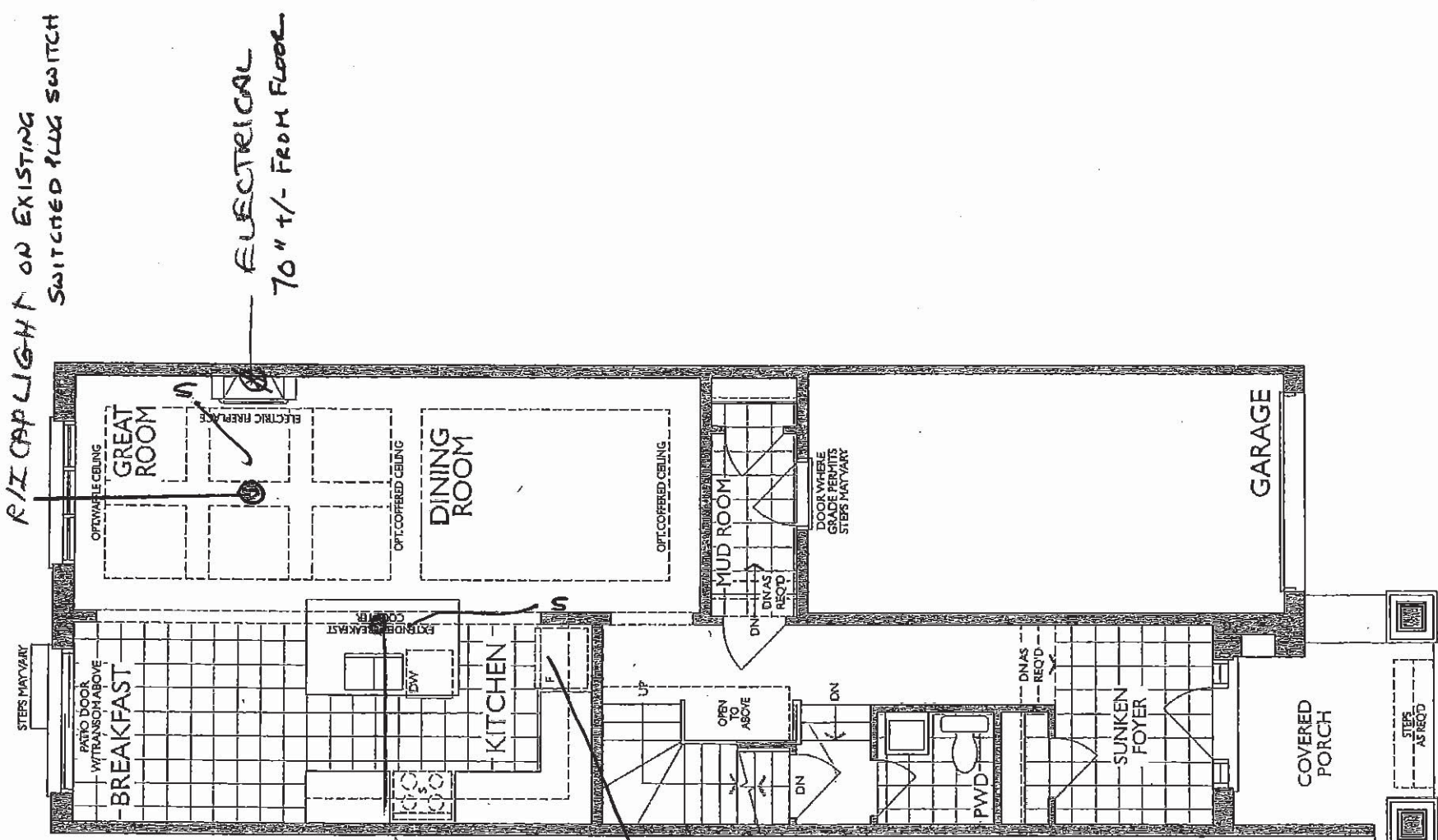

MAIN FLOOR
ELEVATION A

UK-75 WALLACETON
LOT 286B-15
20-1790 ELEV. A
THE DUNMORE

16 of 33

THE DUNMORE

Sketch #3

ELEVATION A | 2,233 SQ. FT.

20-1790 ELEV. A

Includes 443 square feet of finished lower level

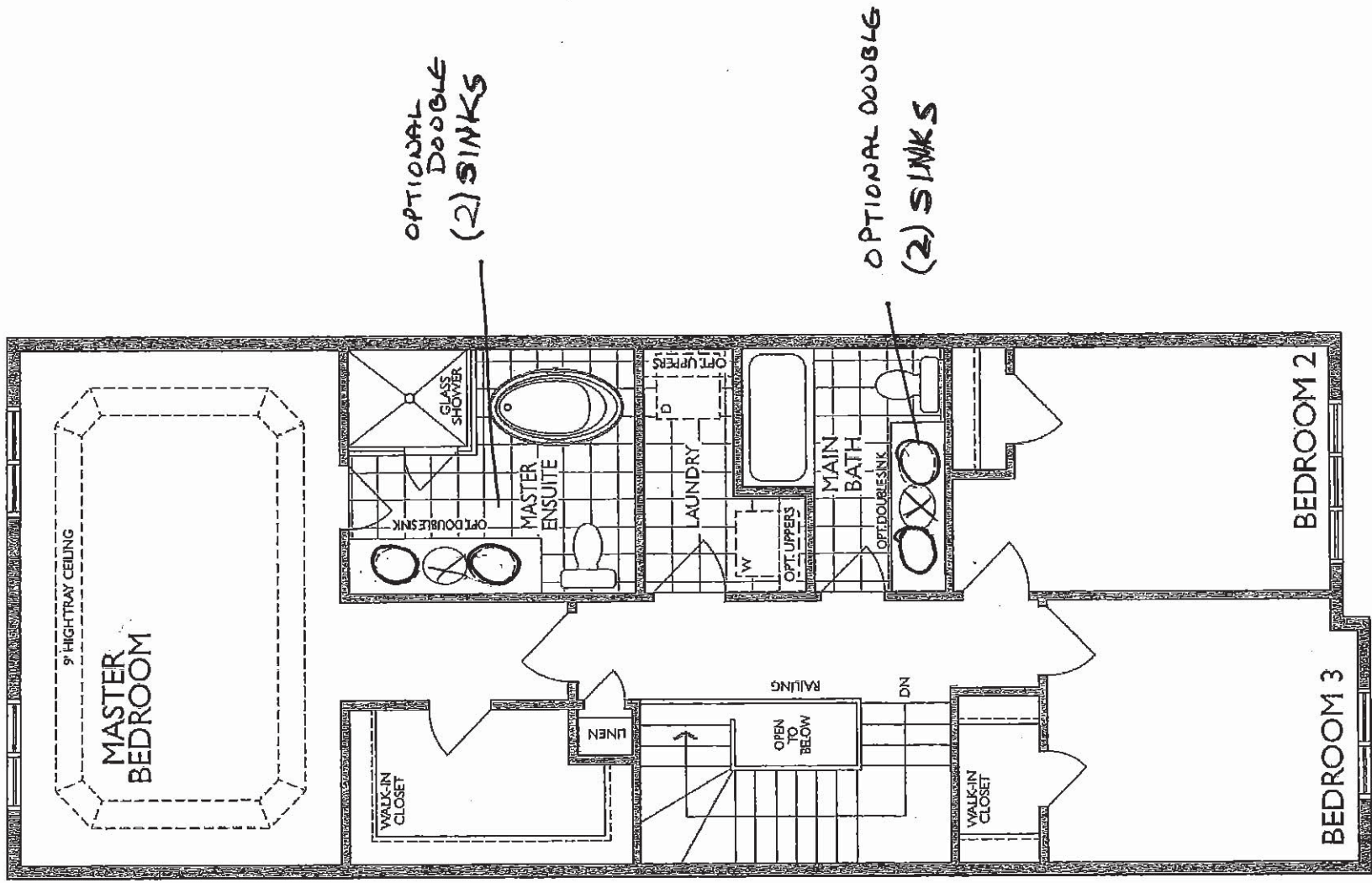

SECOND FLOOR
ELEVATION A

UK-75 WALLACETON
LOT 286B-15
20-1790 ELEV. A
THE DUNMORE

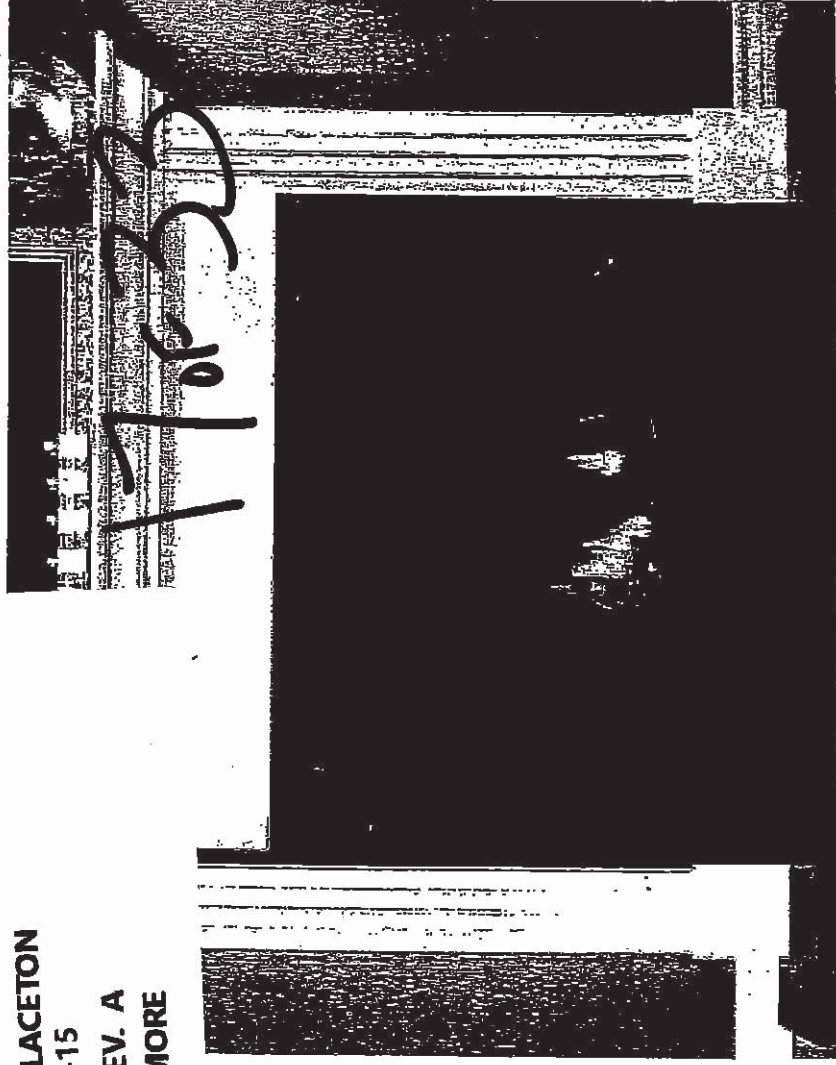

STANDARD NF 15 Mantel X

Clean apron finish with fluted legs

WHITE PAINT GRADE FINISH

(PICTURE SHOWN WITH UPGRADE SURROUND AND HEARTH -PRICED SEPARATELY)

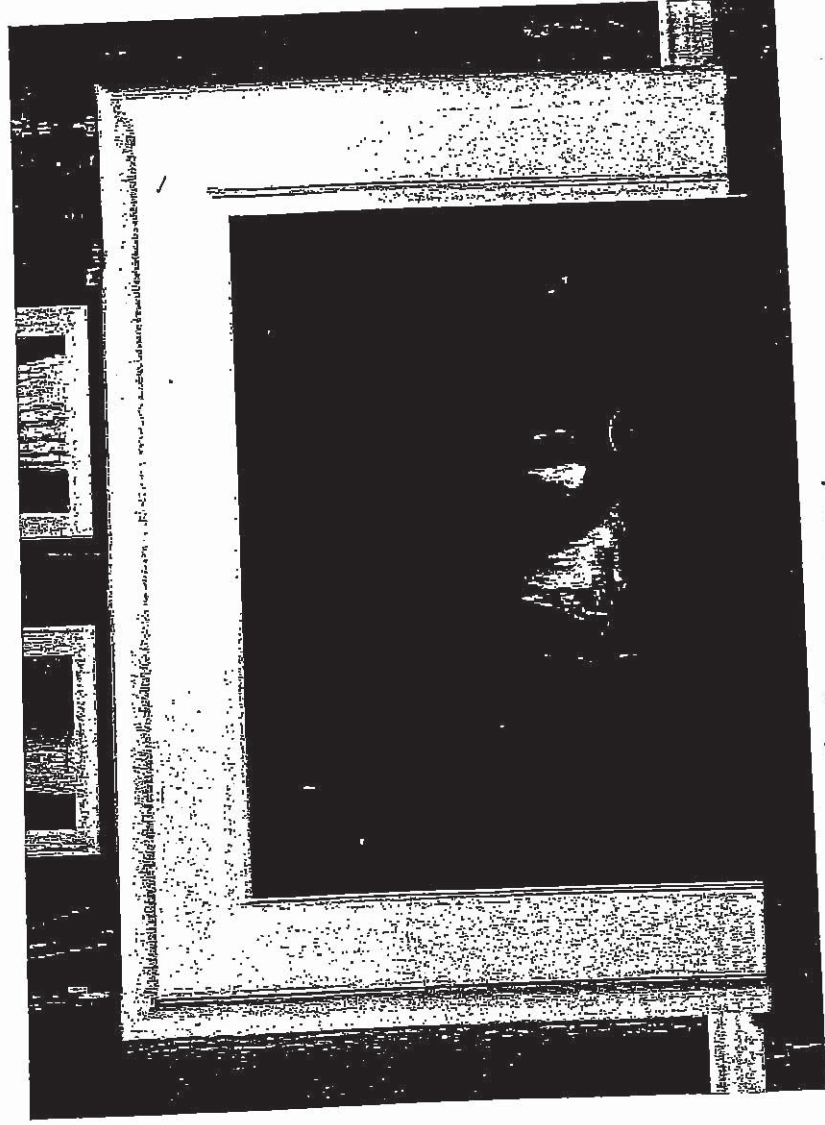

' CABINET ' ✓

STANDARD NF 17 Mantel ✓

WHITE PAINT GRADE FINISH

(PICTURE SHOWN WITH UPGRADE SURROUND AND HEARTH -PRICED SEPARATELY)

UK-75 WALLACETON
 LOT 286B-15
 20-1790 ELEV. A
 THE DUNMORE

8 of 33

STANDARD KITCHEN SINK

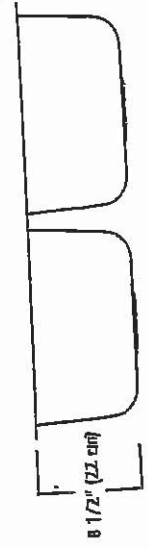
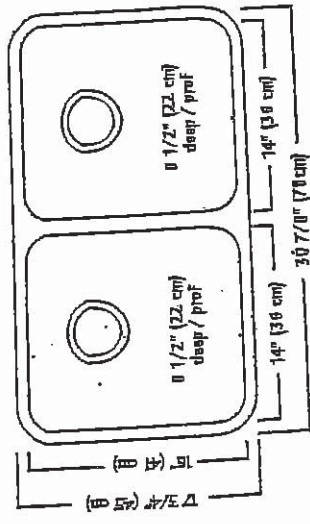
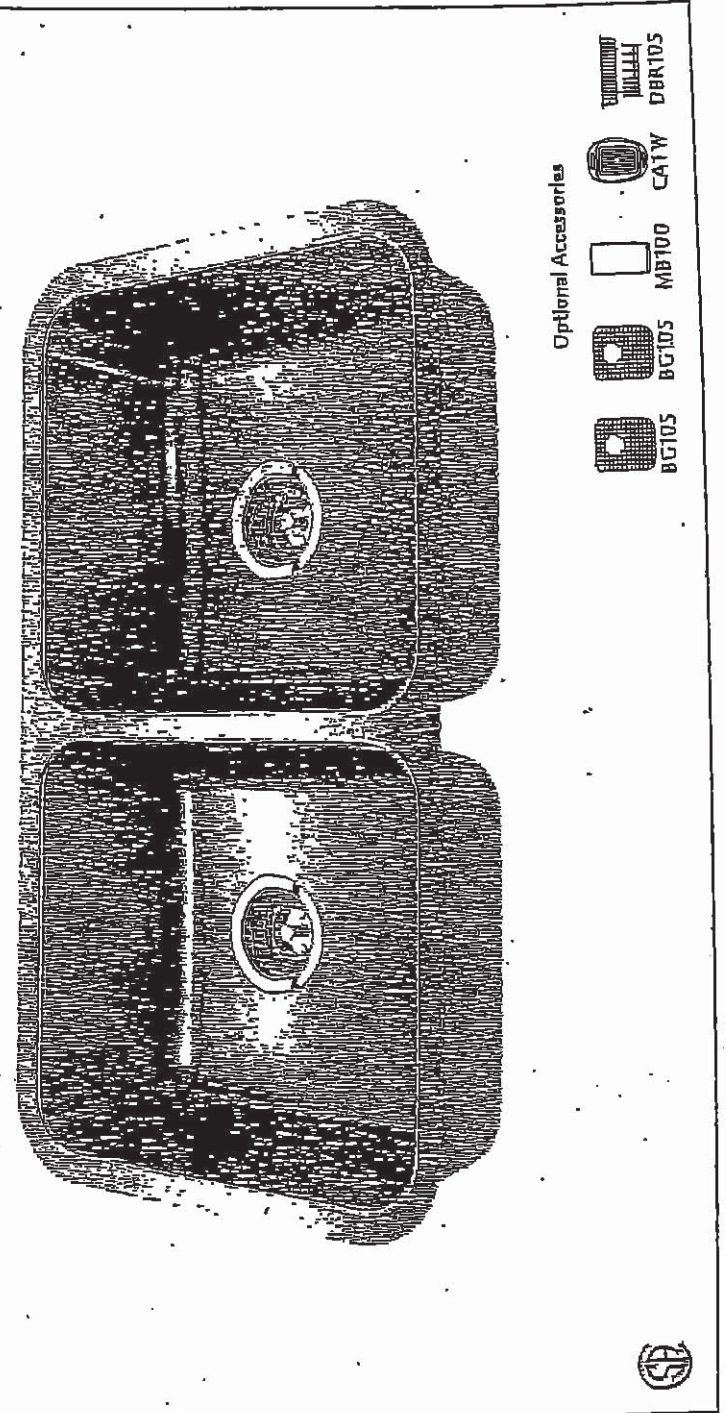

ND1831UA/9 SPECIFICATION

Model ND1831UA/9 is a double (two equal size) bowl undermount sink manufactured by Franke Kindred Canada Limited from 18 gauge stainless steel. Product has silk finished rims and linear brush-finished bowls. Sink is fully undercoated. Basket-strainer waste fittings (3 1/2\"

- * O.D. 17 3/4" x 30 7/8" x 8 1/2" (45 x 78 x 22 cm)
- * Recommended for minimum 36" cabinet

Franke Kindred Canada Limited
 P.O. Box 190, 1000 Franke Kindred Road, Midland, Ontario, Canada, L4R 4K9 Phone: 866-687-7465 Fax: 800-361-8408

K.Y.
gs

UK-75 WALLACETON
LOT 286B-15
20-1790 ELEV. A
THE DUNMORE

19 of 33

STANDARD KITCHEN FAUCET

Align

Modern

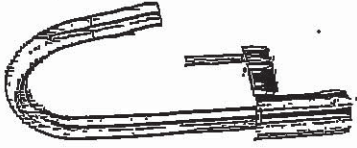

Single Handle Pull-Down Kitchen
Faucet*

Model 7565+

Handwritten initials or signature.

UK-75 WALLACETON
LOT 286B-15
20-1790 ELEV. A
THE DUNMORE

20 of 33

Chateau

Transitional

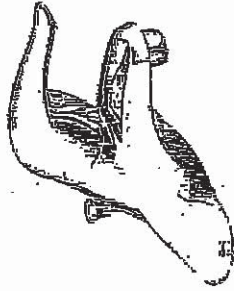

Lavatory Faucet with Pop-Up Drain
Model L46Z1+

VANITY SINKS AND PEDESTAL

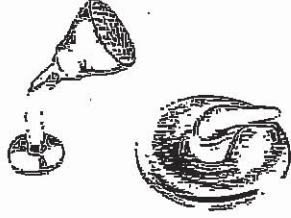

Posi-Temp® Pressure Balancing Tub/Shower
Model 62320 / TL183+

OR

Posi-Temp Valve and Tub/Shower Trim
with Eco-Performance Easy Clean® XL
Model 62320 / TL183EP+
(TL183EP not available in BC)

SHOWER AND 5' TUB FAUCETS

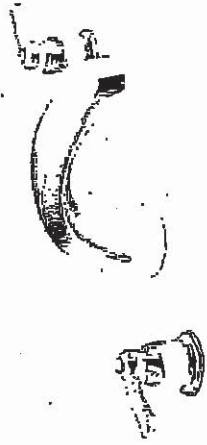

2 Handle Roman Tub with 9" Spout
Model 4796 / T990+

FREESTANDING TUB FAUCETS

g



FOR THE WAY IT'S MADE.
FOR THE WAY IT'S MADE!

MODEL: KQWB600DSS

30-in. Width | Wall-Mount Canopy | 600 CFM Motor

This 3-speed vent hood has power to effectively vent an output of up to 65K BTUs. Auto speed sensing keeps the vent at the proper fan speed by sensing the amount of heat coming from the cooktop. This 30-inch wall-mount canopy hood has both LED and halogen lights to brighten almost any work area.

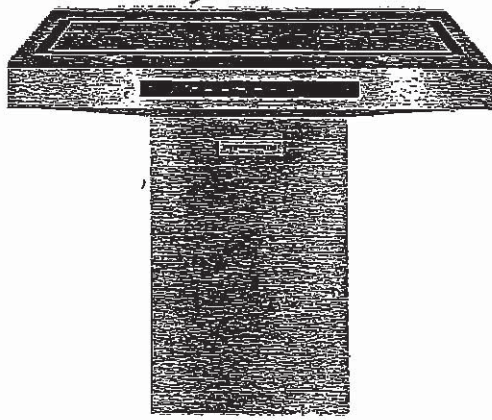

PRODUCT FEATURES

600 CFM/65K BTU Threshold
Allows installation over any kitchen's regular 30-inch range or cooktop, and some commercial-style cooking surfaces with outputs up to 65K BTU

Perimeter Ventilation

Increases ventilation system efficiency by pulling air from

the edges of the hood and speeding up the movement of air

at the center, allowing it to efficiently handle up to a 65K

BTU total output

Auto Speed Setting

Takes the guesswork out of protecting cabinets from steam,

grease, and moisture by automatically adjusting fan speed

to ventilation needs depending on the heat being produced

LED Task Lights

Provide extra lighting over the cooking surface to help in the

cooking process

Halogen Night Lights

Enhances the style-of the ventilation system by providing

soft, accent lighting in the kitchen

IMPORTANT:

Minimum distance "X": 24" (61.0 cm) from electric cooking surface.
Minimum distance "X": 27" (68.6 cm) from gas cooking surfaces.

Suggested maximum distance "X": 36" (91.4 cm)

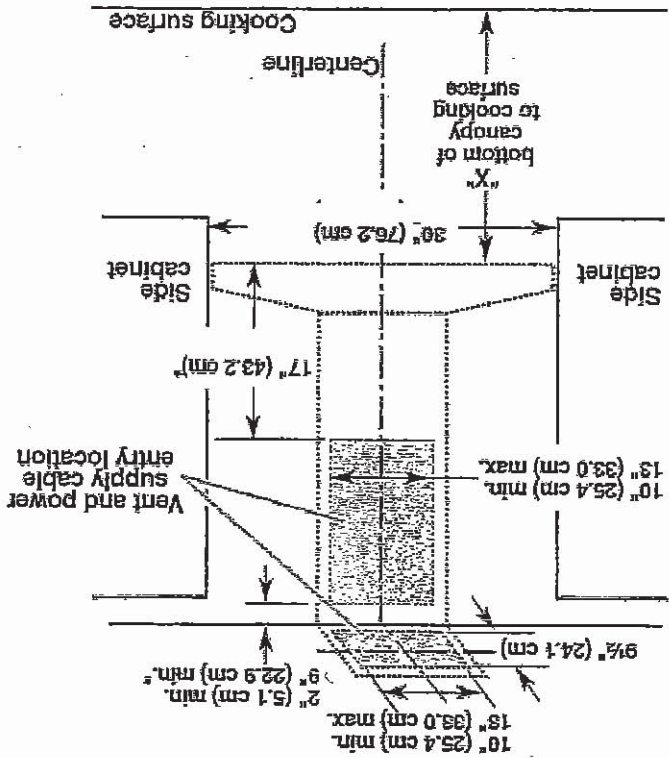

PERFORMANCE

Round
6"

ELECTRICAL

15amp, 60 Hz, 120 V.

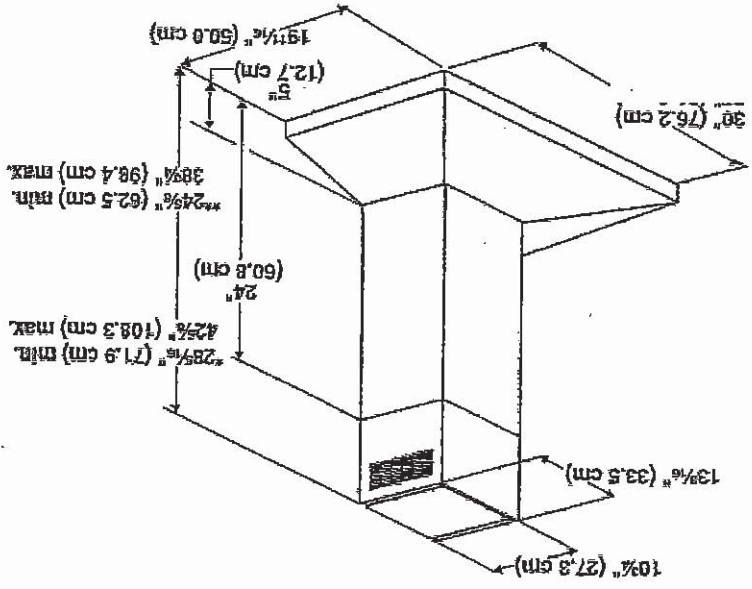

*For non-vented (recirculating) installations
***For vented installations

88

21 of 33

UK-75 WALLACETON
LOT: 286B-15
20-1790 ELEV. A
THE DUNMORE

UK-75 WALLACETON
 LOT 286B-15
 20-1790 ELEV. A
 THE DUNMORE

34
 22 of 33

Whirlpool® Top Mount Refrigerator

PRODUCT MODEL NUMBERS

WRT311FZD
 WRT611SZD

PRODUCT DIMENSIONS

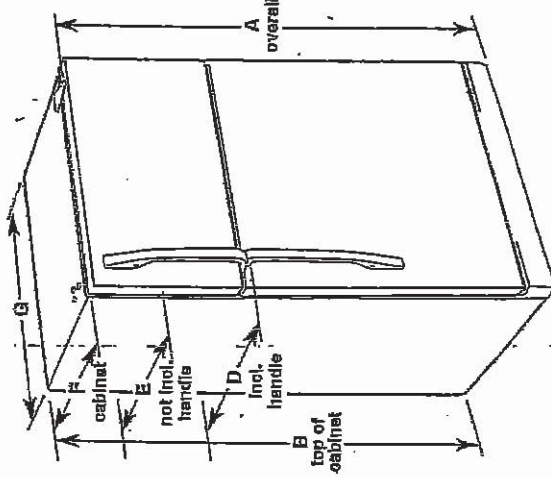

Electrical: A 115-volt, 60-Hz, AC-only, 15- or 20-amp fused, grounded electrical supply is required. It is recommended that a separate circuit serving only your refrigerator be provided. Use an outlet that cannot be turned off by a switch. Do not use an extension cord.

NOTE: Before performing any type of installation, cleaning, or removing a light bulb, turn the control (Thermostat, Refrigerator or Freezer Control depending on the model) to OFF and then disconnect the refrigerator from the electrical source. When you are finished, reconnect the refrigerator to the electrical source and reset the control (Thermostat, Refrigerator or Freezer Control depending on the model) to the desired setting. See "Using the Controls."

Water: A cold water supply with water pressure between 30 and 120 psi (207 and 827 kPa) is required to operate ice maker and water dispenser. If you have questions about your water pressure, call a licensed, qualified plumber.

IMPORTANT: The pressure of the water coming out of a reverse osmosis system going to the water inlet valve of the refrigerator needs to be between 30 and 120 psi (207 and 827 kPa).

Reverse Osmosis Water Supply: If a reverse osmosis water filtration system is connected to your cold water supply, the water pressure to the reverse osmosis system needs to be a minimum of 40 to 80 psi (276 to 414 kPa).

Model Number	Model Size	Reversible Door	Height - Overall "A"	Height - Top of Cabinet "B"	Depth - Door Open 90° "C"	Depth - With Handles "D"	Depth - Without Handles "E"	Depth - Cabinet Only "F"	Width - Cabinet "G"
WRT311FZD	20.6 cu. ft.	Yes	66 1/4" (168.3 cm)	65 1/2" (166.4 cm)	62 1/4" (158.1 cm)	32 1/4" (83.5 cm)	30 3/8" (77.5 cm)	26 1/2" (72.4 cm)	32 3/4" (83.2 cm)
WRT611SZD	21.3 cu. ft.	Yes	66 1/4" (168.3 cm)	65 1/2" (166.4 cm)	62 1/4" (158.1 cm)	34" (86.4 cm)	32 1/8" (82.3 cm)	26 1/4" (72.4 cm)	32 3/4" (83.2 cm)

LOCATION REQUIREMENTS

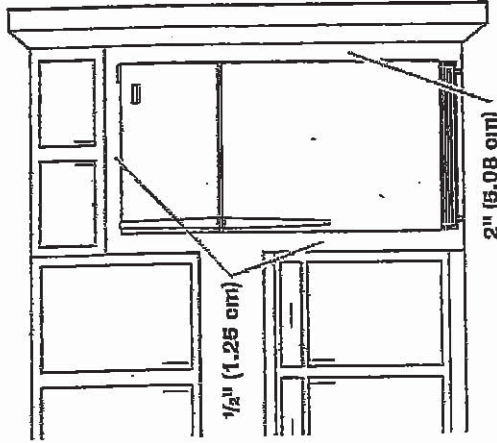

To ensure proper ventilation for your refrigerator, allow for a 1/2" (1.25 cm) space on each and between overhead cabinets and refrigerator top. Allow at least 1" (2.5 cm) between back of cabinet and the wall. If your refrigerator has an ice maker, make sure you leave some extra space at the back for the water line connections.

If you are installing your refrigerator next to a fixed wall, leave 2" (5 cm) minimum on the hinge side (depending on your model) to allow for the door to swing open.

NOTE: This refrigerator is intended for use in a location where the temperature ranges from a minimum of 55°F (13°C) to a maximum of 110°F (43°C). The preferred room temperature range for optimum performance, which reduces electricity usage and provides superior cooling, is between 60°F (15°C) and 90°F (32°C). It is recommended that you do not install the refrigerator near a heat source, such as an oven or radiator.

Because Whirlpool Corporation policy includes a continuous commitment to improve our products, we reserve the right to change materials and specifications without notice.

Dimensions are for planning purposes only. For complete details, see Installation Instructions packed with product. Specifications subject to change without notice.

Ref. WRT0974109
 10/29/14

8

UK-75 WALLACETON
LOT 286B-15
20-1790 ELEV. A
THE DUNMORE

21 of 33

Refrigerator Door Swing Verification

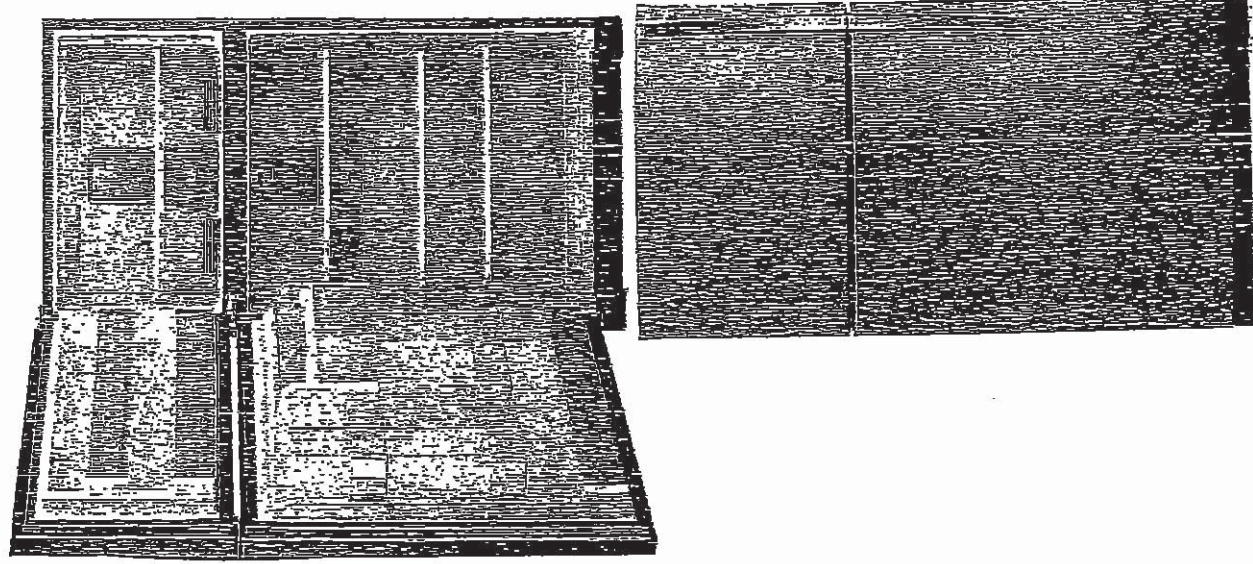
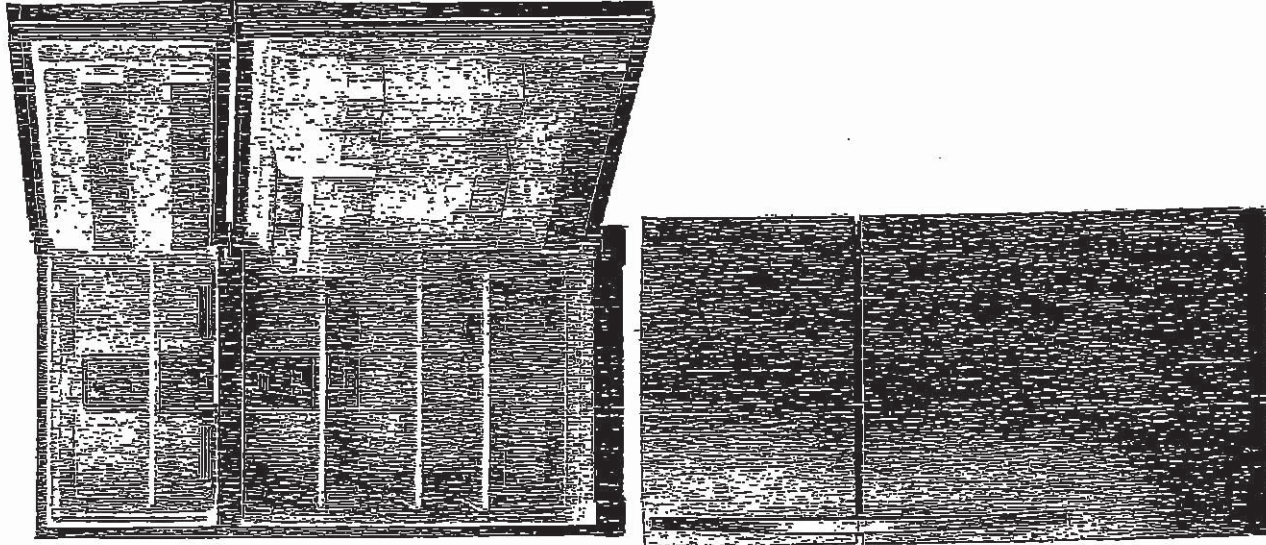

When facing the refrigerator

RIGHT HAND
DOOR OPENING

- Hinges on right
- Handle on left

INITIAL

LEFT HAND
DOOR OPENING

- Hinges on left
- Handle on right

mfreen
INITIAL

GARAGE LIGHT

Please check and INITIAL your door swing selection.

es

UK-75 WALLACETON
LOT 286B-15
20-1790 ELEV. A
THE DUNMORE

22 of 33

WHIRLPOOL 30" (76.0 CM) FREESTANDING ELECTRIC RANGES
Model YWFE515S0JS

5.3 cu. ft. Whirlpool® electric range with Frozen
Bake™ technology

YWFE515S0JS

Whirlpool

Home > Kitchen Appliances > Cooking Appliances > Ranges > Single Oven Ranges > YWFE515S0JS

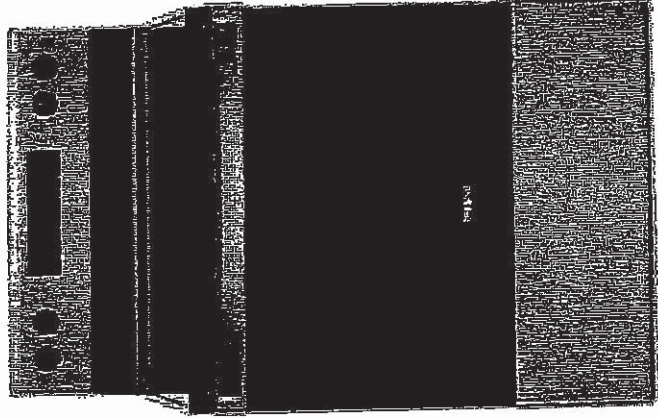

30"
6A



85

UK-75 WALLACETON
 LOT 286B-15
 20-1790 ELEV. A
 THE DUNMORE

WHIRLPOOL 30" (76.0 CM) FREESTANDING ELECTRIC RANGES
 Model YWFE5150JS

Product Dimensions

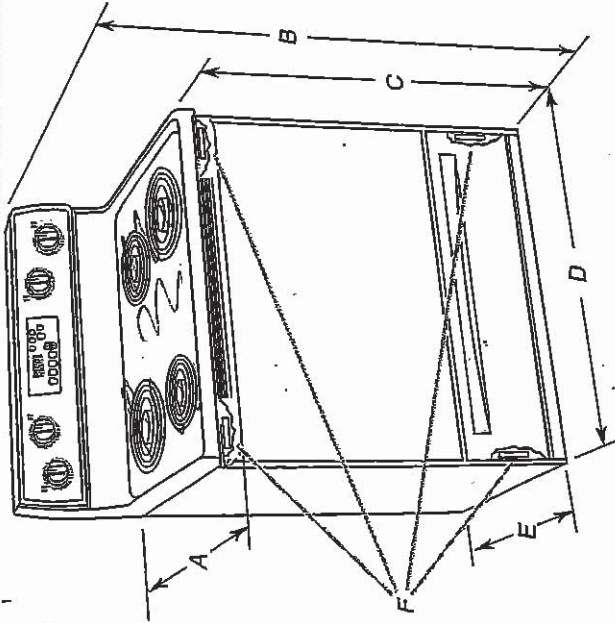

- A. 27³/₄" (70.5 cm) max. depth with handle
- B. 46⁷/₈" (119.1 cm) overall height (max.) with leveling legs screwed all the way in*
- C. 36" (91.4 cm) cooktop height (max.) with leveling legs screwed all the way in*
- D. 29⁷/₈" (75.9 cm) width
- E. 25⁵/₁₆" (64.3 cm) depth - back of range to front of cooktop**
- F. Model/serial/rating plate (located on the frame behind a top corner of the door or either side of the drawer)

IMPORTANT: Range must be level after installation. Follow the instructions in the "Level Range" section. Using the cooktop as a reference for leveling the range is not recommended.

*Range can be raised approximately 1" (2.5 cm) by adjusting the leveling legs.

**Front of door and drawer may extend further forward depending on styling.

Cabinet Dimensions

Cabinet opening dimensions shown are for 25" (64.0 cm) countertop depth, 24" (61.0 cm) base cabinet depth and 36" (91.4 cm) countertop height.

IMPORTANT: If installing a range hood or microwave hood combination above the cooking surface, follow the range hood or microwave hood combination installation instructions for dimensional clearances above the cooktop surface.

A freestanding range may be installed next to combustible walls with zero clearance.

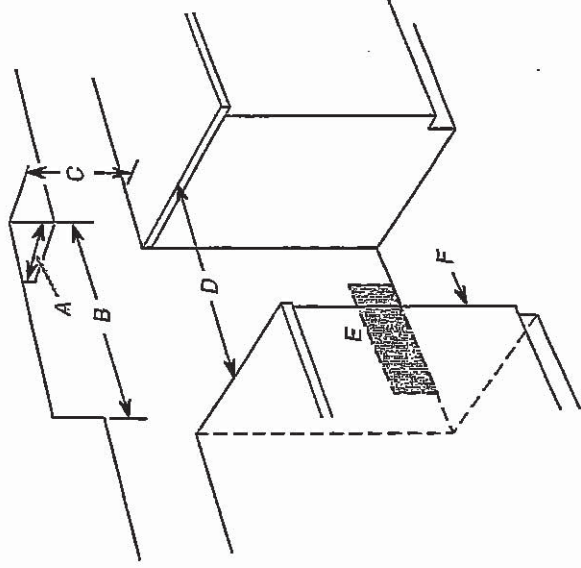

- A. 13" (33.0 cm) max. upper cabinet depth
- B. 30" (76.2 cm) min. opening width
- C. For minimum clearance to top of cooktop, see NOTE*
- D. 30" (76.2 cm) min. opening width
- E. Outlet - 8" (20.3 cm) to 22" (55.9 cm) from either cabinet, 7" (17.8 cm) max. from floor.
- F. Cabinet door or hinges should not extend into the cutout.

*NOTE: 24" (61.0 cm) minimum when bottom of wood or metal cabinet is covered by not less than 1/4" (6.4 mm) flame retardant millboard covered with not less than No. 28 MSG sheet steel, 0.015" (0.4 mm) stainless steel, 0.024" (0.6 mm) aluminum or 0.020" (0.5 mm) copper.
 30" (76.2 cm) minimum clearance between the top of the cooking platform and the bottom of an uncovered wood or metal cabinet.

[Handwritten signature]

JAN 28/20

23 of 33

UK-75 WALLACETON
LOT 286B-15
20-1790 ELEV. A
THE DUNMORE

24 of 33

WHIRLPOOL 30" (76.0 CM) FREESTANDING ELECTRIC RANGES
Model YWFE515S0JS

Install Anti-Tip Bracket

!WARNING



Tip Over Hazard

A child or adult can tip the range and be killed.

Install anti-tip bracket to floor or wall per installation instructions.

Slide range back so rear range foot is engaged in the slot of the anti-tip bracket.

Re-engage anti-tip bracket if range is moved.

Do not operate range without anti-tip bracket installed and engaged.

Failure to follow these instructions can result in death or serious burns to children and adults.

1. Remove the anti-tip bracket from where it is taped inside the storage drawer or warming drawer.
2. Determine which mounting method to use: floor or wall. If you have a stone or masonry floor, you can use the wall mounting method. If you are installing the range in a mobile home, you must secure the range to the floor.
3. Determine and mark centerline of the cutout space. The mounting can be installed on either the left-side or right-side of the cutout. Position mounting bracket against the wall in the cutout so that the V-notch of the bracket is 12⁷/₁₆" (31.9 cm) from centerline as shown.

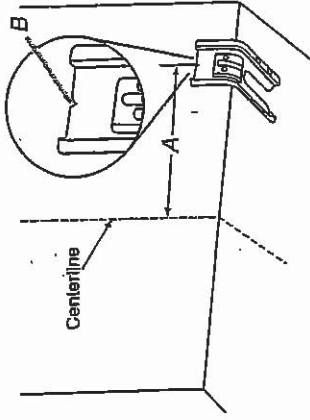

A. 12⁷/₁₆" (31.9 cm)
B. Bracket V-notch

4. Drill two 1/8" (3 mm) holes that correspond to the bracket holes of the determined mounting method. See the following illustrations.

Floor Mounting

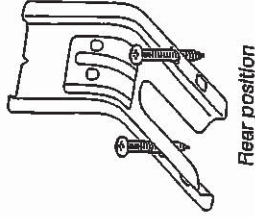

Rear position

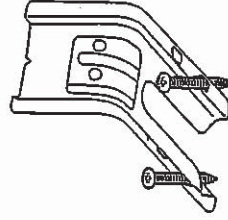

Front position

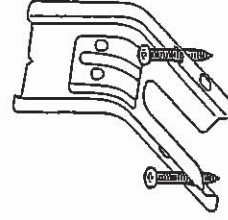

Diagonal (2 options)

Wall Mounting

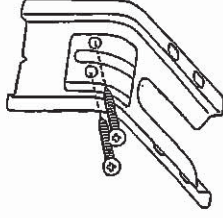

5. Using the Phillips screwdriver, mount anti-tip bracket to the wall or floor with the two #12 x 1¹/₈" (4.1 cm) screws provided.
6. Move range close enough to opening to allow for final electrical connections. Remove shipping base, cardboard or hardboard from under range.
7. Move range into its final location, making sure rear leveling leg slides into anti-tip bracket.

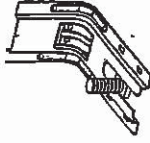

8. Move range forward onto shipping base, cardboard or hardboard to continue installing the range using the following Installation Instructions.

8

UK-75 WALLACETON
 LOT 286B-15
 20-1790 ELEV. A
 THE DUNMORE



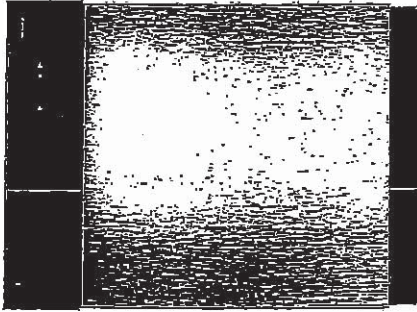

25 of 33



WDF310PAAS
Black-on-Stainless



OTHER AVAILABLE COLORS

-  Black
Model: WDF310PAAB
-  Black-on-Stainless
Model: WDF310PAAT
-  White
Model: WDF310PAAW
-  Universal Silver
Model: WDF310PAAD

DIMENSIONS		KEY FEATURES
Maximum Height	34 1/2 inches	ENERGY STAR® Qualified No One Has Fewer Repairs 17 Years In A Row Resource - Efficient Wash System GEE Tier 1 qualified Tall Tub Design White Plastic Interior Gulet Partner(TM) Sound Package Auto Soil Sensor Electronic Controls 3 Automatic Cycles 1-Hour Wash Cycle Heavy Wash Cycle Normal Cycle 4 Options High Temperature Wash System Heated Dry Option 4 Hour Delay Wash Option 4-Tier SheerClear® Direct Feed Wash System Control Lock Vinyl Raofs In-Rack Silverware Basket
Minimum Height	33 1/2 inches	
Height	34 1/2 inches	
Depth	24 1/2 inches	
Width	23 7/8 inches	
Dimensions shown are for planning purposes only. For complete information, see installation instructions packaged with product.		
ELECTRICAL		
15 Amps Amps, 60 Hz, 120 V, 15,		
Before purchasing this appliance, read important information about the estimated annual energy consumption or energy efficiency rating that is available from your dealer.		

88

UK-75 WALLACETON
 LOT 286B-15
 20-1790 ELEV. A
 THE DUNMORE

26 of 33



Undercounter Dishwasher

PRODUCT MODEL NUMBERS

- | | | |
|-----------|-----------|-----------|
| WDF110PAB | WDE310DLA | WDF530PSY |
| WDF111PAB | WDF320PAD | WDF840PAD |
| WDF120PAF | WDF330PAP | WDF730PAY |
| WDF121PAF | WDF520PAD | WDI710PAY |
| WDF310PAA | WDF530PAY | WDT720PAD |
| WDF310PCA | WDF530PLY | WDT770PAY |

Electrical Requirements: 120-volt, 60-Hz, AC only, 15- or 20-amp, fused electrical supply. Copper wire only. A time delay fuse or circuit breaker and separate circuit is recommended.

If direct wiring dishwasher: Use flexible, armored, or nonmetallic, sheathed copper wire with grounding wire that meets the wiring requirements for your home and local codes and ordinances.

Use a UL-listed or CSA approved conduit connector.

If connecting dishwasher with a power supply cord:

Use Power Supply Cord Kit (Part No. 4317824) marked for use with dishwashers. Follow the kit instructions for installing the power supply cord.



Power supply cord must plug into a grounded 3-prong, outlet, located in the cabinet next to the dishwasher opening. Outlet must meet all local codes and ordinances.

Water Supply Requirements: A hot water line with 20 to 120 psi (138 to 862 kPa) water pressure. Water temperature must be 120°F (49°C) water at dishwasher. Use 3/8" O.D. copper tubing with compression fitting or flexible braided water supply line (1/2" minimum plastic tubing is not recommended). Use a 90° elbow with 3/4" N.P.T. external pipe threads on one end. Do not solder within 8" (15.2 cm) from water inlet valve.

Drain Requirements: A new drain hose is supplied with your dishwasher. If this is not long enough, use a new drain hose with a maximum length of 12' (3.7 m) (Part No. 3385568) that meets all current AHAM/JAPMO test standards, is resistant to heat and detergent, and fits the 1" (2.5 cm) drain connector of the dishwasher.

Make sure to connect the drain hose to waste tee or disposer inlet above drain trap in house plumbing and 20" (50.8 cm) minimum above the floor. It is recommended that the drain hose either be looped up and securely fastened to the underside of the counter or be connected to an air gap.

Make sure to use an air gap if the drain hose is connected to house plumbing lower than 20" (50.8 cm) above subfloor or floor.

If required, the air gap should be installed in accordance with the air gap installation instructions. When connecting the air gap, a rubber hose (not provided) will be needed to connect to the waste tee or disposer inlet.

Use 1/2" (1.3 cm) minimum I.D. drain line fittings. If required, the air gap should be installed in accordance with the air gap installation instructions. When connecting the air gap, a rubber hose (not provided) will be needed to connect to the waste tee or disposer inlet.

Because Whirlpool Corporation policy includes a continuous commitment to improve our products, we reserve the right to change materials and specifications without notice.

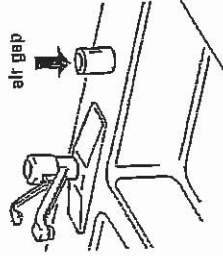

Use 1/2" (1.3 cm) minimum I.D. drain line fittings. If required, the air gap should be installed in accordance with the air gap installation instructions. When connecting the air gap, a rubber hose (not provided) will be needed to connect to the waste tee or disposer inlet.

PRODUCT DIMENSIONS

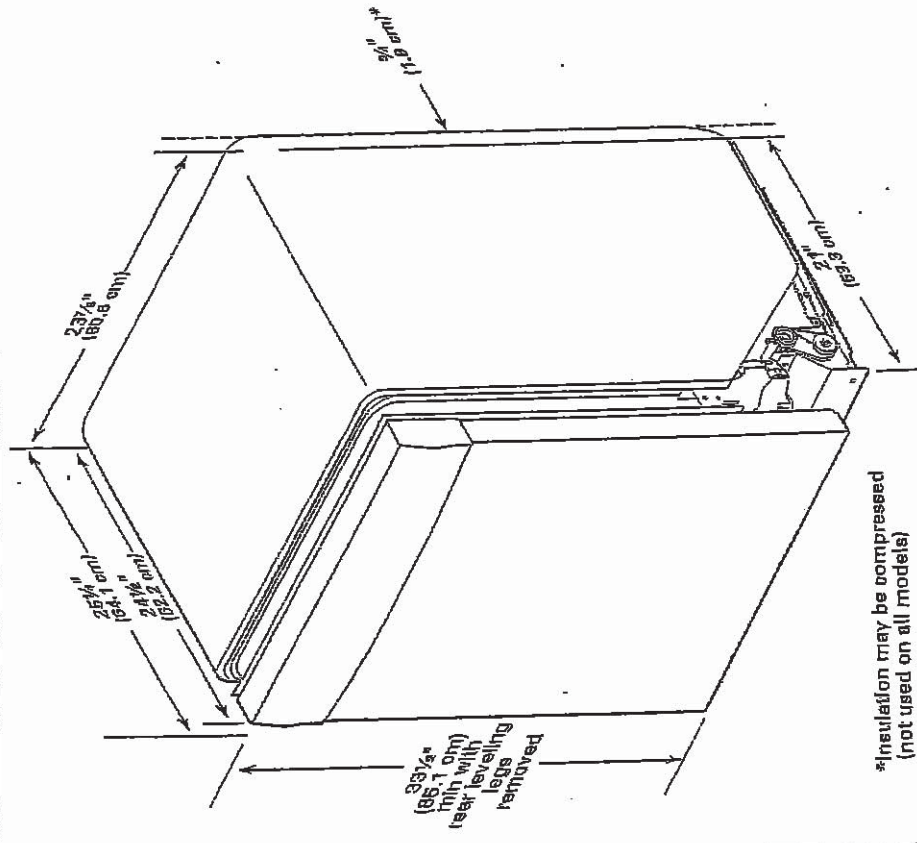

*Insulation may be compressed (not used on all models)

88

UK-75 WALLACETON
LOT 286B-15
20-1790 ELEV. A
THE DUNMORE

28 of 33

WHIRLPOOL WASHER Model #: WFW5620HW

Whirlpool Brand Certified English | Washer and Dryer | Washers | Front Load Washers | WFW5620HW

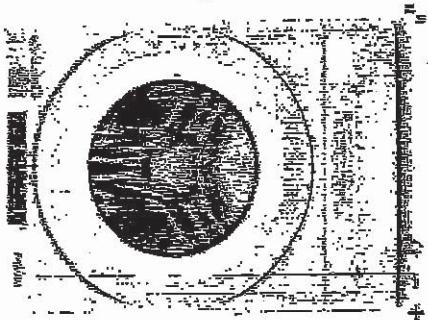

5.2 cu. ft. I.E.C. Closet-Depth
Front Load Washer with
Load & Go™ Dispenser



Whirlpool 5.2 cu. ft. I.E.C. Closet-Depth Front Load Washer with Load & Go™
Dispenser

Model #: WFW5620HW

Dimensions

Depth	80.17 cm, 31-5/8 in
Depth With Door Open 90 Degree	148.51 cm, 58-1/2 in
Minimum Height	96.11 cm, 38-5/8 in
Width	66.58 cm, 27.0 in

Appearance

LCD Touch Screen	No
Window	Yes

Details

Drain Material	Stainless Steel
----------------	-----------------

Cycles and Options

Number of Wash Cycles	67
-----------------------	----

Electrical

Hz	60
Power Cord Included	Yes

8

UK-75 WALLACETON
 LOT 286B-15
 20-1790 ELEV. A
 THE DUNMORE

29 of 33

WHIRLPOOL WASHER Model #: WFW5620HW

LOCATION REQUIREMENTS

Proper installation is your responsibility.

You will need:

- A water heater set to 120°F (49°C).
 - A grounded electrical outlet located within 6 ft (1.8 m) of power cord on back of washer.
 - Hot and cold water faucets located within 4 ft (1.2 m) of hot and cold water fill valves on washer, and water pressure of 20–100 psi (137.9–689.6 kPa).
 - A level floor with maximum slope of 1" (25 mm) under entire washer. Installing on carpet or surfaces with foam backing is not recommended.
 - Floor must support washer's total weight (with water and load) of 315 lbs (143 kg).
- IMPORTANT:** Do not install, store, or operate washer where it will be exposed to weather or in temperatures below 32°F (0°C). Water remaining in washer after use may cause damage in low temperatures. See "Washer Care" in your Use and Care Guide for winterizing information.

Whirlpool Models*

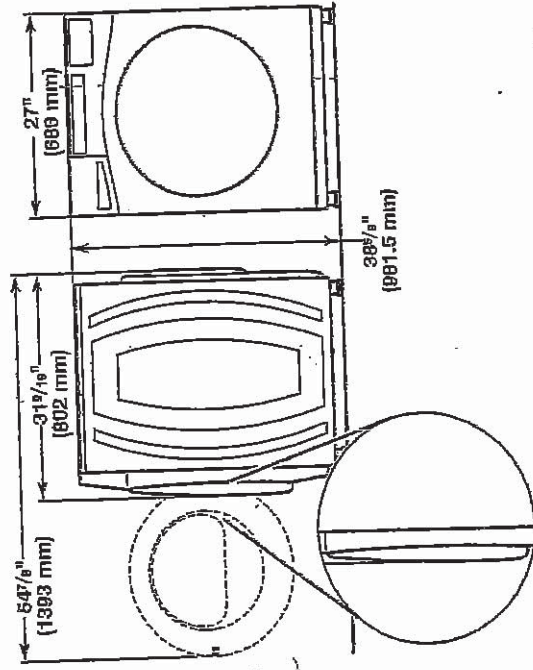
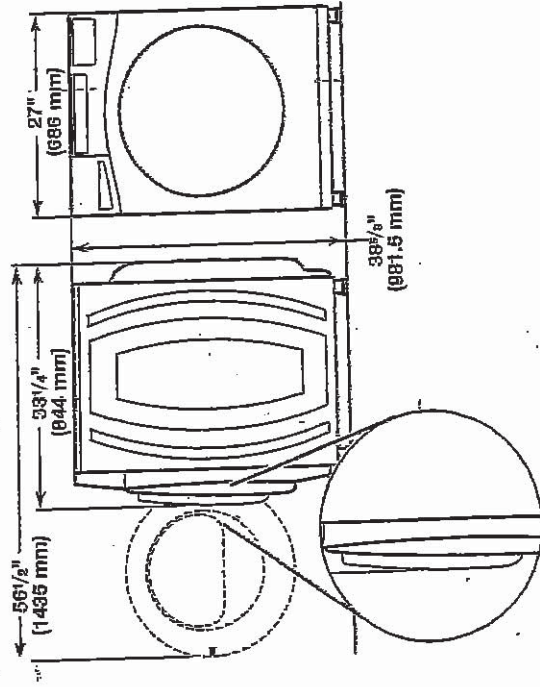

Maytag Models

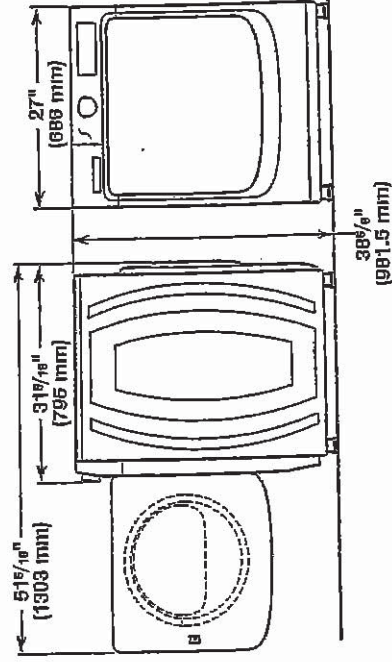
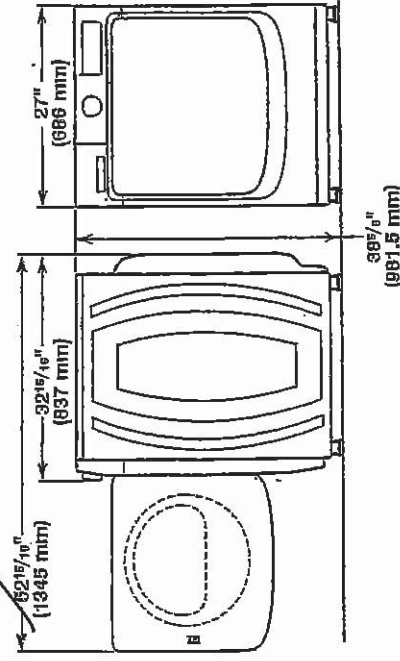

All dimensions show minimum spacing allowed. For each arrangement, consider allowing more space for ease of installation and servicing, and spacing for companion appliances and clearances for walls, doors, and floor moldings.

Space must be large enough to allow door to fully open. Add spacing of 1" (25 mm) on all sides of washer to reduce noise transfer. If a closet door or louvered door is installed, top and bottom air openings in door are required.

Recessed area or closet installation (stacked washer and dryer):

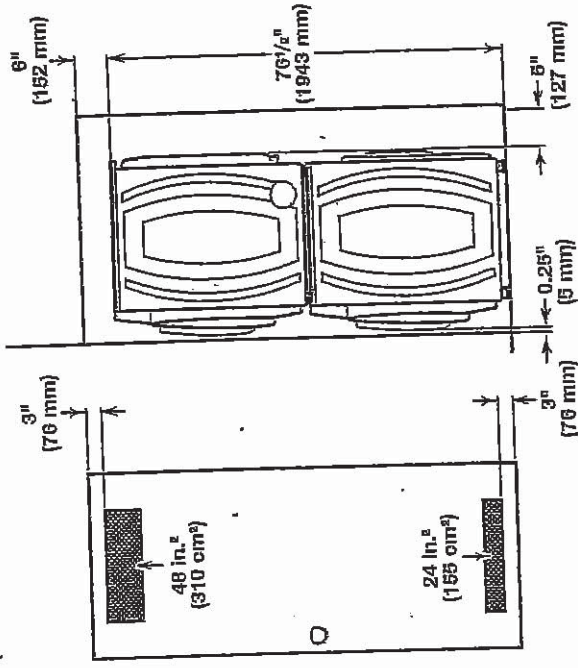

*For additional details (or information) specific to your model, refer to the 'Dimensions' listed for your model at www.whirlpool.com.

UK-75 WALLACETON
 LOT 286B-15
 20-1790 ELEV. A
 THE DUNMORE

30 of 33

WHIRLPOOL WASHER Model #: WFW5620HW

Custom under-counter installation:

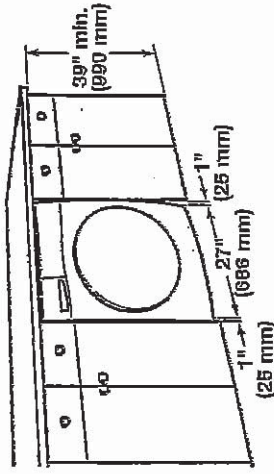

Recessed area or closet installation:

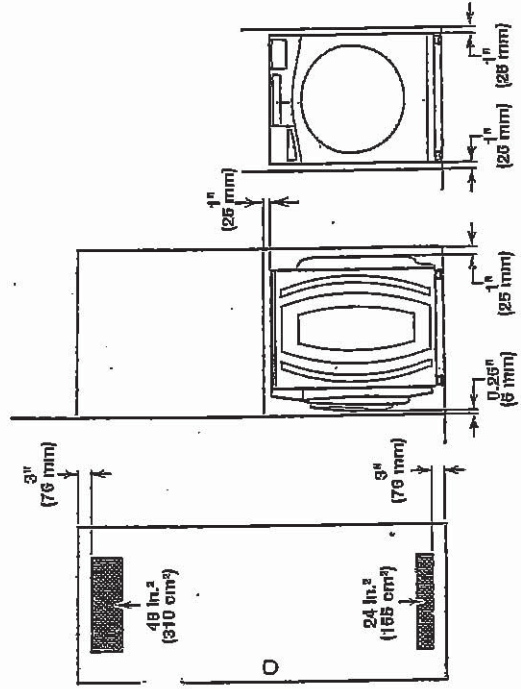

Custom cabinet installation:

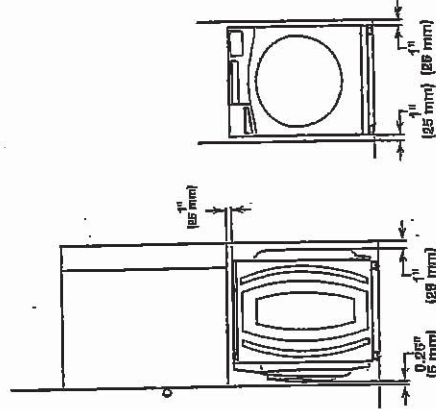

DRAIN SYSTEM

The drain system can be installed using a floor drain, wall standpipe, floor standpipe, or laundry tub. Select the method you need.

IMPORTANT: To avoid siphoning, only 4.5" (114 mm) of drain hose should be inside standpipe. Always secure drain hose with cable tie.

Floor standpipe drain system

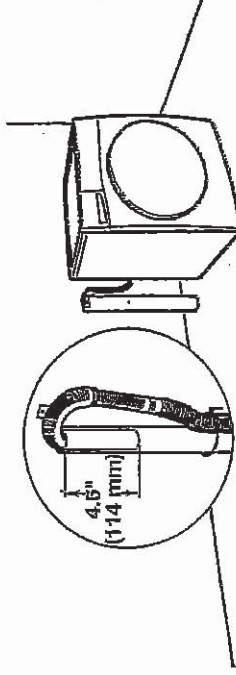

Minimum diameter for a standpipe drain: 2" (51 mm). Minimum carry-away capacity: 17 gal. (64 L) per minute. A 1/4" (6 mm) diameter to 1" (25 mm) diameter Standpipe Adapter Kit is available (Part Number 3393920). Top of standpipe must be at least 30" (762 mm) high; install no higher than 96" (2.44 m) from bottom of washer. If you have an overhead sewer and need to pump higher than 96" (2.44 m), a sump pump and associated hardware are needed. See "Alternate parts."

Wall standpipe drain system

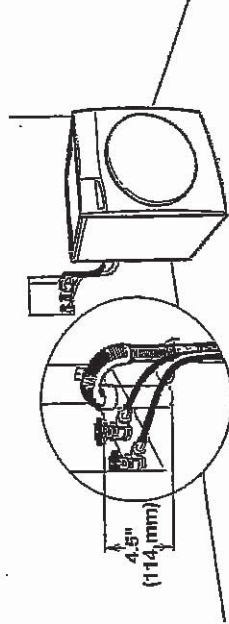

See requirements for floor standpipe drain system.

Laundry tub drain system

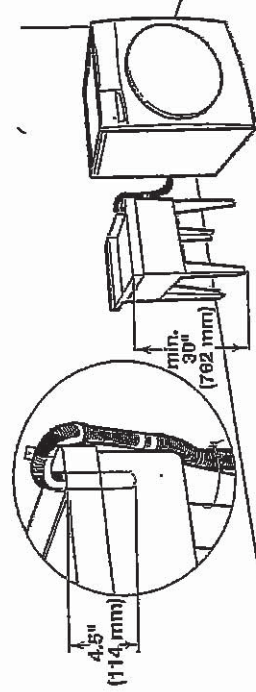

Minimum capacity: 20 gal. (76 L). Top of laundry tub must be at least 30" (762 mm) above floor; install no higher than 96" (2.44 m) from bottom of washer.

Handwritten signature or mark.

UK-75 WALLACETON
 LOT 286B-15
 20-1790 ELEV. A
 THE DUNMORE

31 of 33

WHIRLPOOL DRYER Model #: YWED5620HW

Whirlpool Brand Connected Equipment | Washer and Dryer | Dryer | Electric Dryer | YWED5620HW

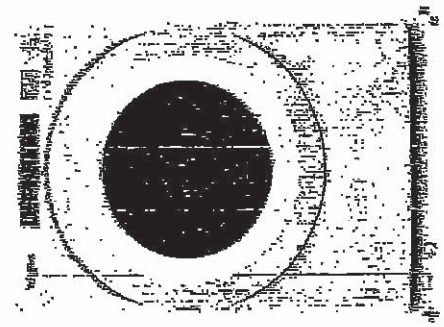

7.4 cu. ft. Front Load Electric Dryer with Intuitive Touch Controls



Whirlpool 7.4 cu. ft. Front Load Electric Dryer with Intuitive Touch Controls

Model #: YWED5620HW

Dimensions	
Depth	79.74 cm, 31.0 in.
Depth With Door Open 90 Degree	136.43 cm, 54-1/2 in.
Height	99.42 cm, 39-3/8 in.
Width	69.89 cm, 27.0 in.

Configuration and Overview	
Fuel Type	Electric

Cycles and Options	
Cycle Time Remaining	Yes
Lint Filter Indicator	No
Number of Dryer Cycles	88
Number of Dryness Levels	8

Ventilation System	
Lint Vent	No
Maximum Vent Length	64
Washing Direction	Left, Right, Bottom, Rear

Electrical	
Phase	60
Power Cord Included	Yes

ep

UK-75 WALLACETON
 LOT 286B-15
 20-1790 ELEV. A
 THE DUNMORE

32 of 33

WHIRLPOOL DRYER Model #: YWED5620HW

Back view:

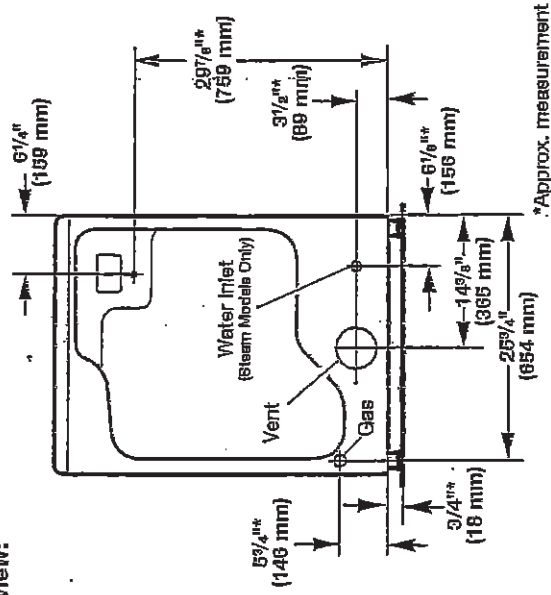

*Approx. measurement

NOTE: Most installations require a minimum of 5" (127 mm) clearance behind dryer for exhaust vent with elbow. See "Venting Requirements."

Installation Clearances

For each arrangement, consider allowing more space for ease of installation and servicing, spacing for companion appliances, and clearances for walls, doors, and floor moldings. Space must be large enough to allow door to fully open. Add spacing on all sides of dryer to reduce noise transfer. If a closet door or lowered door is installed, top and bottom air openings in door are required.

Check code requirements. Some codes limit, or do not permit, installation of the dryer in garages, closets, mobile homes, or sleeping quarters. Contact your local building inspector.

NOTE: No other fuel-burning appliance can be installed in the same closet as a dryer.

Installation spacing for recessed area or closet installation

All dimensions show recommended and minimum spacing allowed.

- Additional spacing should be considered for ease of installation and servicing.
- Additional clearances might be required for wall, door, floor moldings, dryer venting, and gas line.
- Additional spacing should be considered on all sides of the dryer to reduce noise transfer.
- For closet installation with a door, minimum ventilation openings in the top and bottom of the door are required. Lowered doors with equivalent ventilation openings are acceptable.
- Companion appliance spacing should also be considered.

Recommended Installation clearances (dryer only):

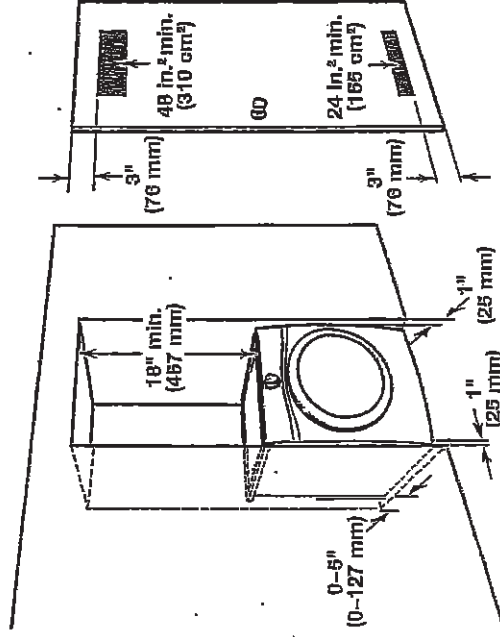

0" (0 mm) rear spacing is allowed for straight back venting only. For steam models only, inlet hose must not be kinked.

Custom under-counter installation:

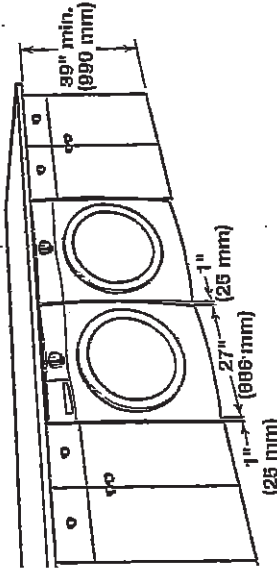

Mobile home -- Additional installation requirements:

This dryer is suitable for mobile home installations. The installation must conform to the Manufactured Home Construction and Safety Standard, Title 24 CFF, Part 3280 (formerly the Federal Standard for Mobile home construction and safety, Title 24, HUD Part 280) or Standard CAN/CSA-Z240 MH.

- **Mobile home installations require:**
 - Metal exhaust system hardware, available for purchase from your dealer. For further information, see "Assistance or Service" in your Use and Care Guide.
 - Special provisions must be made in mobile homes to introduce outside air into dryer. Openings (such as a nearby window) should be at least twice as large as dryer exhaust opening.
- **For mobile home installation of gas dryers:**
 - Mobile Home Installation Hold-down Kit Part Number 348764 is available to order. For further information, see "Assistance or Service" in your Use and Care Guide.

JS

UK-75 WALLACETON
LOT 286B-75
20-1790 ELEV. A
THE DUNMORE

33 of 33

WHIRLPOOL DRYER Model #: YWED5620HW

Additional parts may be required, depending on your installation. Check local codes. Check existing electrical supply and venting. Read "Electrical Requirements" and "Venting Requirements" before purchasing parts.

If using a power supply cord:

Use a UL Listed power supply cord kit marked for use with clothes dryers. The kit should contain:

- A UL Listed 30 amp power supply cord, rated 120/240 volt minimum. The cord should be type SRD or SRDT and be at least 4 ft. (1.22 m) long. The wires that connect to the dryer must end in ring terminals or spade terminals with upturned ends.
- A UL Listed strain relief.

Optional Equipment (not supplied with dryer):

Refer to your Use and Care Guide for information about accessories available for your dryer.

LOCATION REQUIREMENTS

Check code requirements. Some codes limit, or do not permit, installing dryer in garages, closets, mobile homes, or sleeping quarters. Contact your local building inspector.

⚠ WARNING



Explosion Hazard

Keep flammable materials and vapors, such as gasoline, away from dryer.

Place dryer at least 18 inches (460 mm) above the floor for a garage installation.

Failure to do so can result in death, explosion, or fire.

You will need:

- A location allowing for proper exhaust installation. See "Venting Requirements."
 - A separate 15 or 20 amp circuit for a gas dryer or 30 amp circuit for an electric dryer.
 - If using power supply cord, a grounded electrical outlet located within 2 ft. (610 mm) of either side of dryer. See "Electrical Requirements."
 - Floor must support dryer weight of 200 lbs. (90.7 kg). Also consider weight of companion appliance.
 - Cold water faucets located within 4 ft. (1.2 m) of the water fill valves, and water pressure of 20-120 psi (138-827 kPa). You may use your washer's water supply by purchasing the necessary parts noted in "Parts needed."
 - Level floor with maximum slope of 1" (25 mm) under entire dryer. If slope is greater than 1" (25 mm), install Extended Dryer Feet Kit, Part Number 279810. If not level, clothes may not tumble properly and automatic sensor cycles may not operate correctly.
 - For garage installation, place dryer at least 18" (460 mm) above floor. If using a pedestal, you will need 18" (460 mm) to bottom of dryer.
 - The dryer must not be installed or stored in an area where it will be exposed to water and/or weather.
- IMPORTANT:** Do not operate, install, or store dryer where it will be exposed to water, weather, or at temperatures below 40°F (4°C). Lower temperatures may cause dryer not to shut off at end of automatic sensor cycles, resulting in longer drying times.

DRYER DIMENSIONS

Front view:

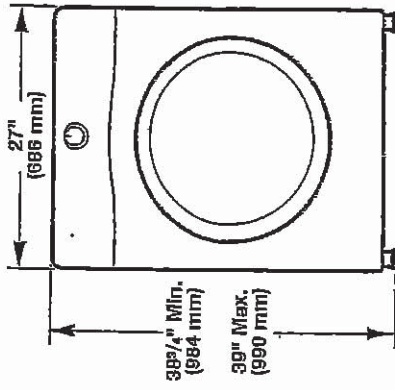

Side view:
Whirlpool Models

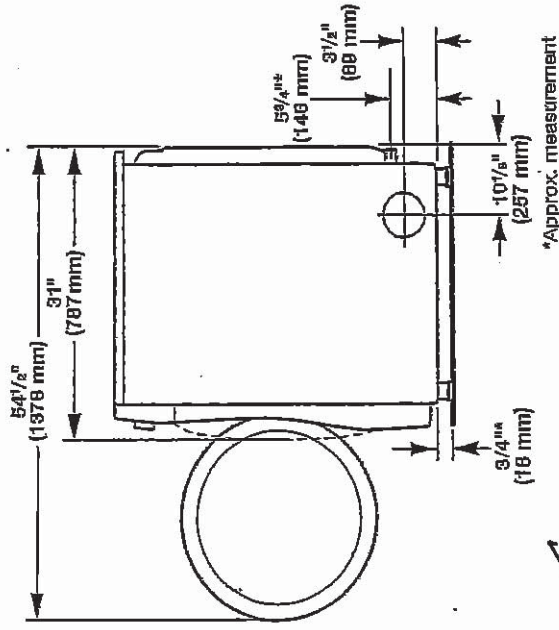

Maytag Models

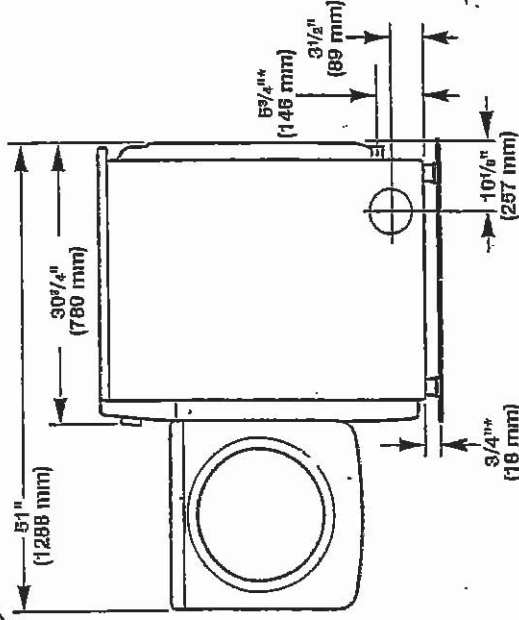

*Approx. measurement.