



Interior Finishing Selection Sheet

18-Jun-21

LOT050-5

20-2329 ELEV A THE ENGLEWOOD

PURCHASERS: GABRIELLE ANA WALKER  
CHRISTOPHER W. WALKER

CONTACT NO: 289-892-2395  
647-448-6332

VENDOR: HEATHWOOD HOMES (WHITBY) LIMITED - PHASE 4

Appliances

6-9117 Kitchen HoodFan

Cabinetry

1-6483 Kitchen Cabinet Colour/Style

3-9154 Kitchen Cabinet Hardware

25-6247 Main Bathroom Cabinet Colour/Style

29-2076 Main Bathroom Cabinet Hardware

28-8827 Main Bathroom Countertop

20-9166 Master Ensuite Cabinet Colour/Style

22-7672 Master Ensuite Cabinet Hardware

21-8797 Master Ensuite Countertop

Carpet

37-9252 Bedroom 2 Flooring

38-9252 Bedroom 3 Flooring

36-9252 Master Bedroom Flooring

52-1079 Throughout Underpad

Ceramics

16-9257 Foyer Flooring

17-2225 Foyer Grout

4-8103 Kitchen Backsplash

5-7704 Kitchen Backsplash Grout

66-9257 Laundry Room Flooring

67-2225 Laundry Room Grout

UPG

- ☒ CYCLONE 30" STAINLESS CHIMNEY/CANOPY HOODFAN  
STAINLESS STEEL SCB50030 UPG 30" SCB 51930 PAGE 28
- ☒ TORONTO WINTER WHITE Classic II PAINT ISLAND TO BE  
TORONTO NAVY BLUE (CLASSIC 2)
- ☒ HARDWARE 12805 SB GOLD UPG II
- ☐ CAMDEN SHALE GREY CL Viking III MAPLE
- ☐ HARDWARE 181 STD
- ☐ Countertop CALCUTTA MARBLE 4925K-07 Wilsonart
- ☐ CHARLESTON ORCHID Viking III STD 3DL
- ☐ HARDWARE 135 STD
- ☐ Countertop ARGENTO ROMANO ETCHINGS FINISH 6697-46  
Formica
- ☐ Dynasty Tex 40 oz Poly MYSTIC BEIGE DY 16787 STD
- ☐ Dynasty Tex 40 oz Poly MYSTIC BEIGE DY 16787 STD
- ☐ Dynasty Tex 40 oz Poly MYSTIC BEIGE DY 16787 STD
- ☐ Underpad 500 Series STD
- ☐ CARRARA White / Grey GE.CR.WHIT.1313.MT STD 13 x 13
- ☐ Grout (27) Silver STD
- ☒ ONTARIO HEXAGON MATTE SNOW WHITE  
OD.ON.SWT.02.HEX.MT UPG\_2
- ☐ Grout (19) Pearl Gray STD
- ☐ CARRARA White / Grey GE.CR.WHIT.1313.MT STD 13 x 13
- ☐ Grout (27) Silver STD

1. The Purchaser acknowledges these selections are subject to the terms and conditions of the applicable Agreement of Purchase and Sale.
2. The Purchaser acknowledges that the Vendor accepts no responsibility in the event the Vendor is unable to supply a selection. The Purchaser agrees to reselect from the currently available selections immediately upon request.
3. The Vendor reserves the right to substitute above materials and equipment with that of equal or better quality.
4. Purchaser acknowledges that items may not be exactly as shown. Variations from the Vendor's samples may occur in finished materials due to normal production processes. Vendor is not responsible for shade difference which may occur from different dye lots or wood grains. Variations from the Vendor's samples will occur with natural materials such as wood, marble, granite, hardwood and brick.
5. The Vendor reserves the right to select Grout & Thresholds that best suits the Tile selected.
6. Selections will not be processed unless signed by Heathwood Homes Head Office.
7. The colour selections made on the Colour Chart are final and cannot be changed once submitted.
8. The Purchaser has checked and acknowledges the accuracy of this Colour Chart.

June 18, 2021 Walker

June 18, 2021

Decor Consultant

Heathwood Homes (Whitby) Limited - Phase 4

Date

Purchaser

Date

Date Approved

HEATHWOOD HOMES (WHITBY) LIMITED - PHASE 4



18-Jun-21

# Interior Finishing Selection Sheet

20-2329 ELEV A THE ENGLEWOOD

LOT 050-5

PURCHASERS: GABRIELLE ANA WALKER  
CHRISTOPHER W. WALKER

CONTACT NO: 289-892-2395  
647-448-6332

VENDOR: HEATHWOOD HOMES (WHITBY) LIMITED - PHASE 4

UPG

## Granite

2-9121 Kitchen Countertop

☒ MSI Quartz ICED WHITE Group 1 UPG 3/4" with Mitered Edge

## Hardwood

99-9359 Dining Room Flooring

☐ Vintage Pioneered Solid Collection Select V : Red Oak Pearl BARISTA Red Oak Pearl 3/4" X 3 1/4"

14-9359 Family Room Flooring

☒ Vintage Pioneered Solid Collection Select V : Red Oak Pearl BARISTA Red Oak Pearl 3/4" X 3 1/4"

11-9359 Great Room Flooring

☐ Vintage Pioneered Solid Collection Select V : Red Oak Pearl BARISTA Red Oak Pearl 3/4" X 3 1/4"

338-9359 Kitchen Flooring

☒ Vintage Pioneered Solid Collection Select V : Red Oak Pearl BARISTA Red Oak Pearl 3/4" X 3 1/4"

366-9359 Optional Lower Level Hall Flooring

☒ Vintage Pioneered Solid Collection Select V : Red Oak Pearl BARISTA Red Oak Pearl 3/4" X 3 1/4"

78-9059 Stair Landing to Lower Level Flooring

☒ Red Oak-Vintage 3 1/4 inch Pre-Sanded Smooth Unfinished Red Oak-Unfinished-3/4 inch x 3 1/4inch Red Oak 3/4" x 3 1/4" STAIN SUMBUCCA- CCOLOUR IS DIFFERENT FROM HARDWOOD FLOOR

77-9059 Stair Landing to Upper Level Flooring

☐ Red Oak-Vintage 3 1/4 inch Pre-Sanded Smooth Unfinished Red Oak-Unfinished-3/4 inch x 3 1/4inch Red Oak 3/4" x 3 1/4" STAIN SUMBUCCA

## Interior Railings

49-8150 Stairs to Lower Level Handrail/Pickets/Posts Type

☐ Single Collar Alt. Plain w/ Shoes with 3 1/2" Square/Cap Post(s) GUN METAL COLOUR UPG

43-8150 Stairs to Upper Level Handrail/Pickets/Posts Type

☐ Single Collar Alt. Plain w/ Shoes with 3 1/2" Square/Cap Post(s) GUN METAL COLOUR UPG

## Interior Stairs

116-1714 Basement Stairs Type

☐ Carpet Grade Stairs STD INCLUDING LANDING

45-1712 Stairs to Lower Level Type

☐ Oak Stairs UPG\_1

39-1712 Stairs to Upper Level Type

☐ Oak Stairs UPG\_1

## Interior Trim

91-9374 Throughout Trim Size

☐ 4 1/4" Baseboards and 2 3/4" Integrated Backbend Casings STD

## Painting

1. The Purchaser acknowledges these selections are subject to the terms and conditions of the applicable Agreement of Purchase and Sale.
2. The Purchaser acknowledges that the Vendor accepts no responsibility in the event the Vendor is unable to supply a selection. The Purchaser agrees to reselect from the currently available selections immediately upon request.
3. The Vendor reserves the right to substitute above materials and equipment with that of equal or better quality.
4. Purchaser acknowledges that items may not be exactly as shown. Variations from the Vendor's samples may occur in finished materials due to normal production processes. Vendor is not responsible for shade difference which may occur from different dye lots or wood grains. Variations from the Vendor's samples will occur with natural materials such as wood, marble, granite, hardwood and brick.
5. The Vendor reserves the right to select Grout & Thresholds that best suits the Tile selected.
6. Selections will not be processed unless signed by Heathwood Homes Head Office.
7. The colour selections made on the Colour Chart are final and cannot be changed once submitted.
8. The Purchaser has checked and acknowledges the accuracy of this Colour Chart.

Date

Purchaser

Date

Décor Consultant

Date

Purchaser

Date Approved

HEATHWOOD HOMES (WHITBY)  
LIMITED - PHASE 4



Interior Finishing Selection Sheet

12 OF 12

18-Jun-21

LOT 050-5

20-2329 ELEV A THE ENGLEWOOD

PURCHASERS: GABRIELLE ANA WALKER  
CHRISTOPHER W. WALKER  
VENDOR: HEATHWOOD HOMES (WHITBY) LIMITED - PHASE 4

CONTACT NO: 289-892-2395  
647-448-6332

Ceramics

- 30-9255 Main Bathroom Flooring
- 31-7704 Main Bathroom Grout
- 112-8833 Main Bathroom Tub Wall Tile
- 113-2226 Main Bathroom Tub Wall Tile Grout
- 23-8627 Master Ensuite Floor Tile
- 24-7704 Master Ensuite Floor Tile Grout
- 73-8665 Master Ensuite Shower Floor Tile
- 74-7704 Master Ensuite Shower Floor Tile Grout
- 147-8923 Master Ensuite Shower Jamb(s) and Sill(s)
- 104-8833 Master Ensuite Shower Wall Tile
- 105-2226 Master Ensuite Shower Wall Tile Grout
- 32-9257 Powder Room Flooring
- 33-2225 Powder Room Grout
- 369-9257 Powder Room Lower Level Flooring
- 370-2225 Powder Room Lower Level Grout
- 53-2232 Throughout Thresholds

Electrical

- 90-5796 Throughout Switches and Plug

Fireplace

- 136-9114 Great Room Fireplace Mantle
- 135-8865 Great Room Fireplace Type

Granite

UPG

- ☐ SEMPRE White Matte TR.SP.WHITE.1313 STD 13" x 13"
- ☐ Grout (19) Pearl Gray STD
- ☐ Uniwall White QT.UW.WHT.0810 STD 8 x 10 TO BE INSTALLED HORIZONTAL
- ☐ Grout (00) White STD
- ☐ Andes Black TR.AD.BLK.1313 STD 13 x 13
- ☐ Grout (19) Pearl Gray STD
- ☒ Ontario Series Mosaic Taupe Matte OD.ON.TPE.0202.MT.N UPG 1 2 x 2
- ☐ Grout (19) Pearl Gray STD
- ☐ Shower Jamb / Sill Thassos White STD
- ☐ Uniwall White QT.UW.WHT.0810 STD 8 x 10 TO BE INSTALL VERTICALLY
- ☐ Grout (00) White STD
- ☐ CARRARA White / Grey GE.CR.WHIT.1313.MT STD 13 x 13
- ☐ Grout (27) Silver STD
- ☐ CARRARA White / Grey GE.CR.WHIT.1313.MT STD 13 x 13
- ☐ Grout (27) Silver STD
- ☐ Metal Thresholds STD
- ☐ Decora White Switches and Plugs STD
- ☐ Paint Grade Mantel- Cabinet (Per Plan) WHITE NF 15 STD
- ☒ Dimplex FP3033HL Electric Fireplace

PAGE 21

- The Purchaser acknowledges these selections are subject to the terms and conditions of the applicable Agreement of Purchase and Sale.
- The Purchaser acknowledges that the Vendor accepts no responsibility in the event the Vendor is unable to supply a selection. The Purchaser agrees to reselect from the currently available selections immediately upon request.
- The Vendor reserves the right to substitute above materials and equipment with that of equal or better quality.
- Purchaser acknowledges that items may not be exactly as shown. Variations from the Vendor's samples may occur in finished materials due to normal production processes. Vendor is not responsible for shade difference which may occur from different dye lots or wood grains. Variations from the Vendor's samples will occur with natural materials such as wood, marble, granite, hardwood and brick.
- The Vendor reserves the right to select Grout & Thresholds that best suits the Tile selected.
- Selections will not be processed unless signed by Heathwood Homes Head Office.
- The colour selections made on the Colour Chart are final and cannot be changed once submitted.
- The Purchaser has checked and acknowledges the accuracy of this Colour Chart.

June 18, 2021  
Date Purchaser  
June 18<sup>th</sup>, 2021  
Date Purchaser

June 22, 21  
Date  
DÉCOR CONSULTANT  
HEATHWOOD HOMES (WHITBY) LIMITED - PHASE 4



18-Jun-21

# 13 of 12 Interior Finishing Selection Sheet

LOT	050-5	20-2329 ELEV A THE ENGLEWOOD
PURCHASERS: GABRIELLE ANA WALKER CHRISTOPHER W. WALKER		CONTACT NO: 289-892-2395 647-448-6332
VENDOR: HEATHWOOD HOMES (WHITBY) LIMITED - PHASE 4		

UPG

## Painting

46-7761 Stairs to Lower Level Colour

50-7761 Stairs to Lower Level Handrail/Pickets/Posts Colour

40-7761 Stairs to Upper Level Colour

44-7761 Stairs to Upper Level Handrail/Pickets/Posts Colour

240-1716 Throughout Trim - Paint Colour

51-1717 Throughout Walls - Paint Colour

## Plumbing

266-1737 Main Bathroom Plumbing Fixture (Colour)

149-1737 Master Ensuite Plumbing Fixture (colour)

34-1737 Powder Room Plumbing Fixture (Colour)

371-1737 Powder Room Lower Level Plumbing Fixture (Colour)

☐ Stain handrail, stringers, treads,risers, nosing & posts. (Metal pickets) STAIN SUMBUCCA- CCOLOUR IS DIFFERENT FROM HARDWOOD FLOOR

☐ Stain handrail, stringers, treads,risers, nosing & posts. (Metal pickets) STAIN SUMBUCCA- CCOLOUR IS DIFFERENT FROM HARDWOOD FLOOR

☐ Stain handrail, stringers, treads,risers, nosing & posts. (Metal pickets) STAIN SUMBUCCA- CCOLOUR IS DIFFERENT FROM HARDWOOD FLOOR

☐ Stain handrail, stringers, treads,risers, nosing & posts. (Metal pickets)

☐ Trim WHITE STD

☐ Wall WARM GREY 22 STD

☐ Plumbing Fixtures WHITE STD

☐ Plumbing Fixtures WHITE STD

☐ Plumbing Fixtures WHITE STD

☐ Plumbing Fixtures WHITE STD

1. The Purchaser acknowledges these selections are subject to the terms and conditions of the applicable Agreement of Purchase and Sale.
2. The Purchaser acknowledges that the Vendor accepts no responsibility in the event the Vendor is unable to supply a selection. The Purchaser agrees to reselect from the currently available selections immediately upon request.
3. The Vendor reserves the right to substitute above materials and equipment with that of equal or better quality.
4. Purchaser acknowledges that items may not be exactly as shown. Variations from the Vendor's samples may occur in finished materials due to normal production processes. Vendor is not responsible for shade difference which may occur from different dye lots or wood grains. Variations from the Vendor's samples will occur with natural materials such as wood, marble, granite, hardwood and brick.
5. The Vendor reserves the right to select Grout & Thresholds that best suits the Tile selected.
6. Selections will not be processed unless signed by Heathwood Homes Head Office.
7. The colour selections made on the Colour Chart are final and cannot be changed once submitted.
8. The Purchaser has checked and acknowledges the accuracy of this Colour Chart.

June 18, 2021  
Date Purchaser  
June 18<sup>th</sup>, 2021  
Date Purchaser

June 18, 21  
Date Décor Consultant  
HEATHWOOD HOMES (WHITBY)  
LIMITED - PHASE 4



18-Jun-21

Sales Selection Sheet  
OF 2

LOT 050-5

20-2329 ELEV A THE ENGLEWOOD

PURCHASERS: GABRIELLE ANA WALKER  
CHRISTOPHER W. WALKER

CONTACT NO: 289-892-2395  
647-448-6332

VENDOR: HEATHWOOD HOMES (WHITBY) LIMITED - PHASE 4

HST #

It is herein understood and agreed between the undersigned parties hereto that the following changes shall be made to the above mentioned Agreement of Purchase and Sale in accordance with the agreement and except for such changes noted below, all other terms and conditions in the Agreement of Purchase and Sale shall remain as stated herein: It is further understood that and agreed that all changes and additions shall be installed as per builder's specifications, location and available selections. The Purchaser hereby agrees to purchase the following extras:

### Appliances

2171	Cyclone 30" Wall Mount Chimney Hood SS SCB51930	KITCHEN	Qty: 1
------	--	---------	--------

PAGE 28

### Cabinetry

1295	Optional Extras 12B- Pots and pans drawers (width min. 60cm/max. 90cm) (size subject to floor plan) Classic SEE SKETCH # 7	KITCHEN	Qty: 1
1329	Optional Extras 03G- Cabinet hardware upgrade II display board for Kitchen Viking	Kitchen	Qty: 1
1490	Optional Upgrade CLASSIC II	Kitchen	Qty: 1

PAGE 19

### Ceramics

1966	Optional Extras Supply and install additional backsplash due to chimney hoodfan installation Upgrade 2	Kitchen	Qty: 1
1836	Upgrade 2 Tile	Kitchen Optional Backsplash	Qty: 1
1826	Upgrade 1 Tile	M. Ensuite Shower Floor	Qty: 1

1. This Sales Selection Sheet when properly executed forms part of our Agreement of Purchase and Sale.
2. All extras and upgrades listed above are subject to Construction Progress and Architectural and Municipal requirements.
3. In the event the Vendor is unable to incorporate the work approved above in the construction of the house for any reason whatsoever, the Vendor will not be liable to the Purchaser in any way. The monies paid for any changes or optional extras not proceeded with shall be returned to the Purchaser, without interest. The cost of options or extras is non-refundable in all other circumstances. If for any reason whatsoever the Agreement of Purchase and Sale is not completed, the total cost of work approved above will be retained by the Vendor.
4. The Vendor reserves the right to substitute above materials and equipment with that of equal or better quality.
5. Purchaser acknowledges that items may not be exactly as shown. Variations from the Vendor's samples may occur in finished materials due to normal production processes. Vendor is not responsible for shade difference which may occur from different dye lots or wood grains. Variations from the Vendor's samples will occur with natural materials such as wood, marble, granite, hardwood and brick.
6. The Vendor reserves the right to select Grout & Thresholds that best suits the Tile selected.
7. Selections will not be processed unless signed by Heathwood Homes Head Office.
8. The selections made on this schedule are final and cannot be changed once submitted.
9. The Purchaser has checked and acknowledges the accuracy of this schedule.

June 18<sup>th</sup> 2021

Date

Purchaser

June 18<sup>th</sup> 2021

Date

Purchaser

June 18<sup>th</sup> 2021

Date

Décor Consultant

Date Approved

HEATHWOOD HOMES (WHITBY)  
LIMITED - PHASE 4



18-Jun-21

Sales Selection Sheet  
15 of 42

LOT 050-5

20-2329 ELEV A THE ENGLEWOOD

PURCHASERS: GABRIELLE ANA WALKER  
CHRISTOPHER W. WALKER

CONTACT NO: 289-892-2395  
647-448-6332

VENDOR: HEATHWOOD HOMES (WHITBY) LIMITED - PHASE 4

HST #

It is herein understood and agreed between the undersigned parties hereto that the following changes shall be made to the above mentioned Agreement of Purchase and Sale in accordance with the agreement and except for such changes noted below, all other terms and conditions in the Agreement of Purchase and Sale shall remain as stated herein: It is further understood that and agreed that all changes and additions shall be installed as per builder's specifications, location and available selections. The Purchaser hereby agrees to purchase the following extras:

### Electrical

344 Optional Extras KITCHEN Qty: 1  
Ceiling rough-in (Capped)  
TO BE INSTALLED ABOVE THE ISLAND - USE STD, KITCHEN LIGHT SWITCH  
SEE SKETCH # 7 PAGE # 19 IN ADDITIONAL TO RELOCATED KITCHEN  
LIGHT TO ISLAND AS PER PRE-SSS TOTAL OF 2 CAPPED CEILING

### Granite

839 Optional Upgrade Kitchen Qty: 1  
Countertop 3/4" GROUP 1 with double edge

### Hardwood

1083 Vintage FAMILY Qty: 1  
3-1/4" Red Oak Select-V  
1090 Vintage KITCHEN Qty: 1  
3-1/4" Red Oak Select-V  
1088 Vintage LOWER HALL pow Qty: 1  
3-1/4" Red Oak Select-V

### Painting

531 Optional Extras - PAINT / STAIN - Custom LANDING Qty: 1  
Stain stair landing less than 25sq/ft in sambucca. For stair with metal pickets only.  
5" (Unfinished Pre-sanded) smooth hardwood will be installed and to be stained in sambucca to match the stairs

### Plumbing

1. This Sales Selection Sheet when properly executed forms part of our Agreement of Purchase and Sale.
2. All extras and upgrades listed above are subject to Construction Progress and Architectural and Municipal requirements.
3. In the event the Vendor is unable to incorporate the work approved above in the construction of the house for any reason whatsoever, the Vendor will not be liable to the Purchaser in any way. The monies paid for any changes or optional extras not proceeded with shall be returned to the Purchaser, without interest. The cost of options or extras is non-refundable in all other circumstances. If for any reason whatsoever the Agreement of Purchase and Sale is not completed, the total cost of work approved above will be retained by the Vendor.
4. The Vendor reserves the right to substitute above materials and equipment with that of equal or better quality.
5. Purchaser acknowledges that items may not be exactly as shown. Variations from the Vendor's samples may occur in finished materials due to normal production processes. Vendor is not responsible for shade difference which may occur from different dye lots or wood grains. Variations from the Vendor's samples will occur with natural materials such as wood, marble, granite, hardwood and brick.
6. The Vendor reserves the right to select Grout & Thresholds that best suits the Tile selected.
7. Selections will not be processed unless signed by Heathwood Homes Head Office.
8. The selections made on this schedule are final and cannot be changed once submitted.
9. The Purchaser has checked and acknowledges the accuracy of this schedule.

June 18, 2021

*Walker*

Date

Purchaser

Date

June 18 21

*Walker*  
D cor Consultant

June 18<sup>th</sup>, 2021

*Walker*

Date

Purchaser

Date Approved

HEATHWOOD HOMES (WHITBY)  
LIMITED - PHASE 4



18-Jun-21

Sales Selection Sheet  
16 of 12

LOT	050-5	20-2329 ELEV A THE ENGLEWOOD
PURCHASERS: GABRIELLE ANA WALKER CHRISTOPHER W. WALKER		CONTACT NO: 289-892-2395 647-448-6332
VENDOR: HEATHWOOD HOMES (WHITBY) LIMITED - PHASE 4		HST #

It is herein understood and agreed between the undersigned parties hereto that the following changes shall be made to the above mentioned Agreement of Purchase and Sale in accordance with the agreement and except for such changes noted below, all other terms and conditions in the Agreement of Purchase and Sale shall remain as stated herein: It is further understood that and agreed that all changes and additions shall be installed as per builder's specifications, location and available selections. The Purchaser hereby agrees to purchase the following extras:

268	Kitchen Sink Upgrade	KITCHEN	Qty: 1
	Blanco Kitchen Sink Quatrus U 2 #401247 (32" x 18") Undermount 2 Bowl Equal Size 9" Deep in Stainless Steel		

PAGE 22

1. This Sales Selection Sheet when properly executed forms part of our Agreement of Purchase and Sale.
2. All extras and upgrades listed above are subject to Construction Progress and Architectural and Municipal requirements.
3. In the event the Vendor is unable to incorporate the work approved above in the construction of the house for any reason whatsoever, the Vendor will not be liable to the Purchaser in any way. The monies paid for any changes or optional extras not proceeded with shall be returned to the Purchaser, without interest. The cost of options or extras is non-refundable in all other circumstances. If for any reason whatsoever the Agreement of Purchase and Sale is not completed, the total cost of work approved above will be retained by the Vendor.
4. The Vendor reserves the right to substitute above materials and equipment with that of equal or better quality.
5. Purchaser acknowledges that items may not be exactly as shown. Variations from the Vendor's samples may occur in finished materials due to normal production processes. Vendor is not responsible for shade difference which may occur from different dye lots or wood grains. Variations from the Vendor's samples will occur with natural materials such as wood, marble, granite, hardwood and brick.
6. The Vendor reserves the right to select Grout & Thresholds that best suits the Tile selected.
7. Selections will not be processed unless signed by Heathwood Homes Head Office.
8. The selections made on this schedule are final and cannot be changed once submitted.
9. The Purchaser has checked and acknowledges the accuracy of this schedule.

June 18, 2021	<i>C Walker</i>	June 18, 2021	<i>[Signature]</i>
Date	Purchaser	Date	Décor Consultant
June 18 <sup>th</sup> , 2021	<i>C Walker</i>		<i>[Signature]</i>
Date	Purchaser		
		Date Approved	HEATHWOOD HOMES (WHITBY) LIMITED - PHASE 4

C2 COUNTRY LANE  
LOT 50-5  
20-2329 ELEV A  
THE ENGLEWOOD

17 OF 42  
*The Englewood*

20-2329 ELEV. A

ELEVATION A: 2,329 SQ FT  
Sketch #5

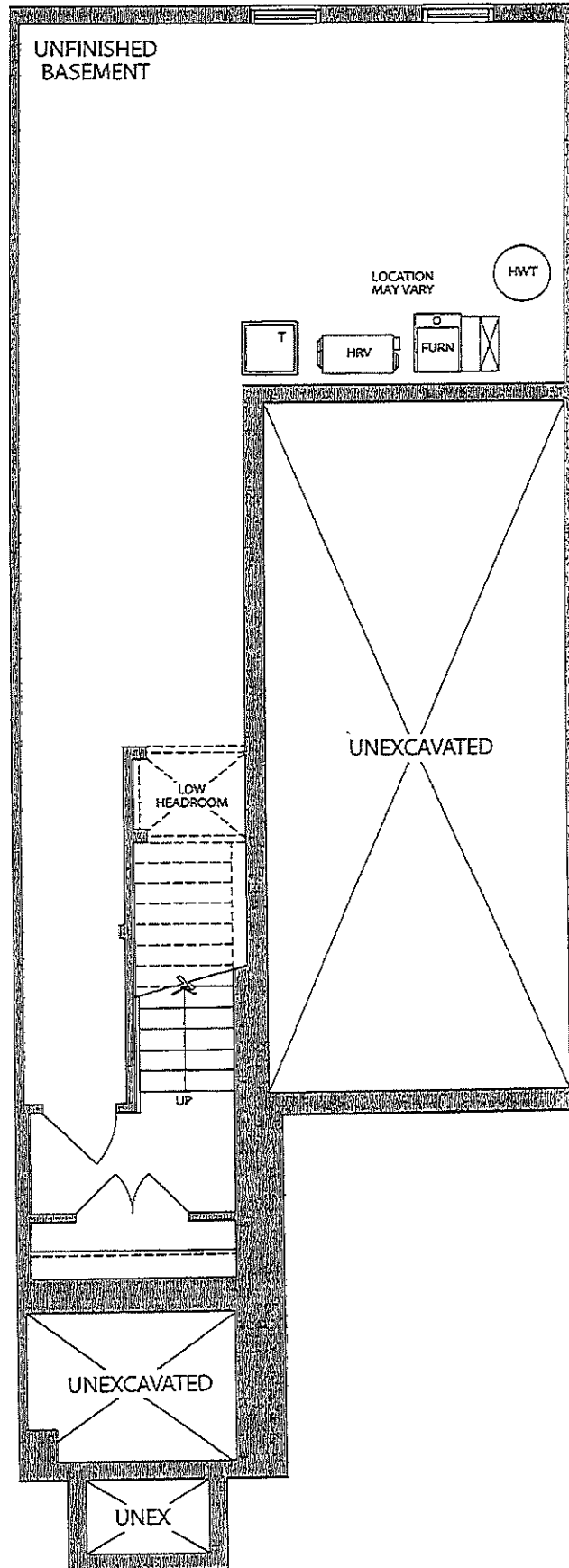

*Handwritten signature*  
C.W.

BASEMENT  
ELEVATION A & B



C2 COUNTRY LANE  
LOT 50-5  
20-2329 ELEV A  
THE ENGLEWOOD

18 of 42

# The Englewood

20-2329 ELEV. A

ELEVATION A: 2,329 SQ FT

Sketch # 6

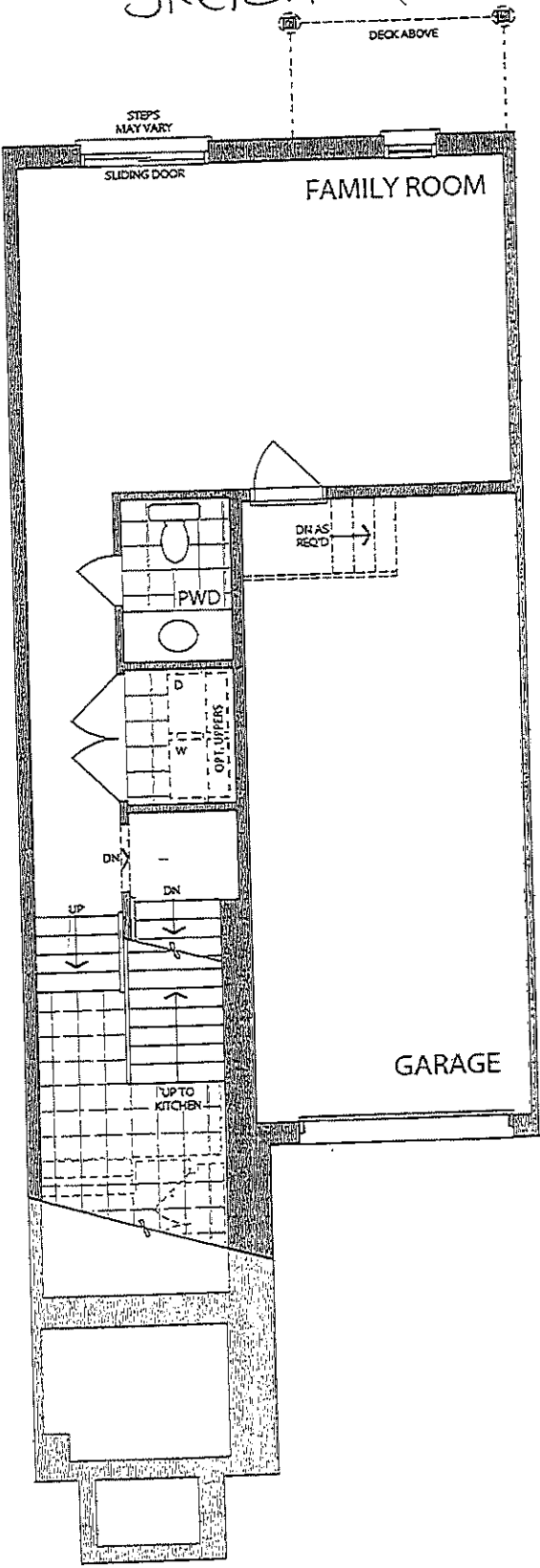

*Handwritten signature*  
C.W.

LOWER LEVEL  
ELEVATION A

C2 COUNTRY LANE  
LOT 50-5  
20-2329 ELEV A  
THE ENGLEWOOD

# 19 of 42 The Englewood

20-2329 ELEV. A

ELEVATION A: 2,329 SQ FT

Sketch #7

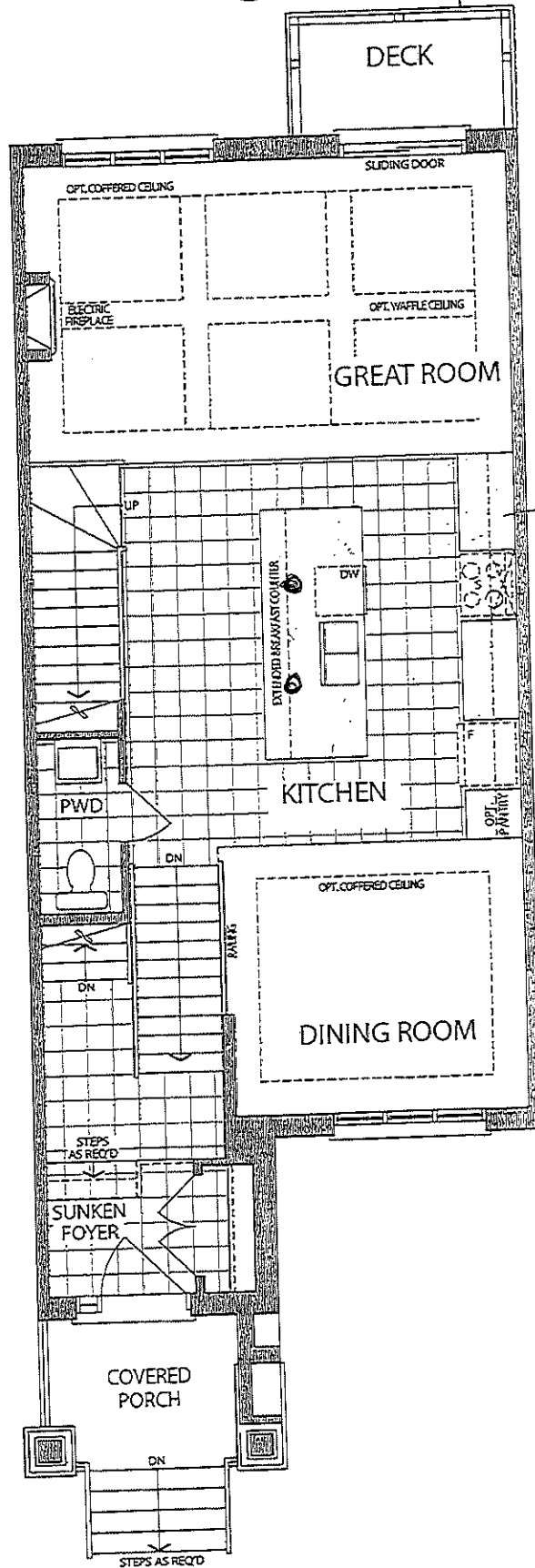

POT & PAN

1x R/I CDP LIGHT  
ADDITIONAL TO PRE SSS

OPT.  
PANTRY

MAIN LEVEL  
ELEVATION A

C2 COUNTRY LANE  
LOT 50-5  
20-2329 ELEV A  
THE ENGLEWOOD

20 of 42  
The Englewood

20-2329 ELEV. A

ELEVATION A: 2,329 SQ FT

Sketch #8

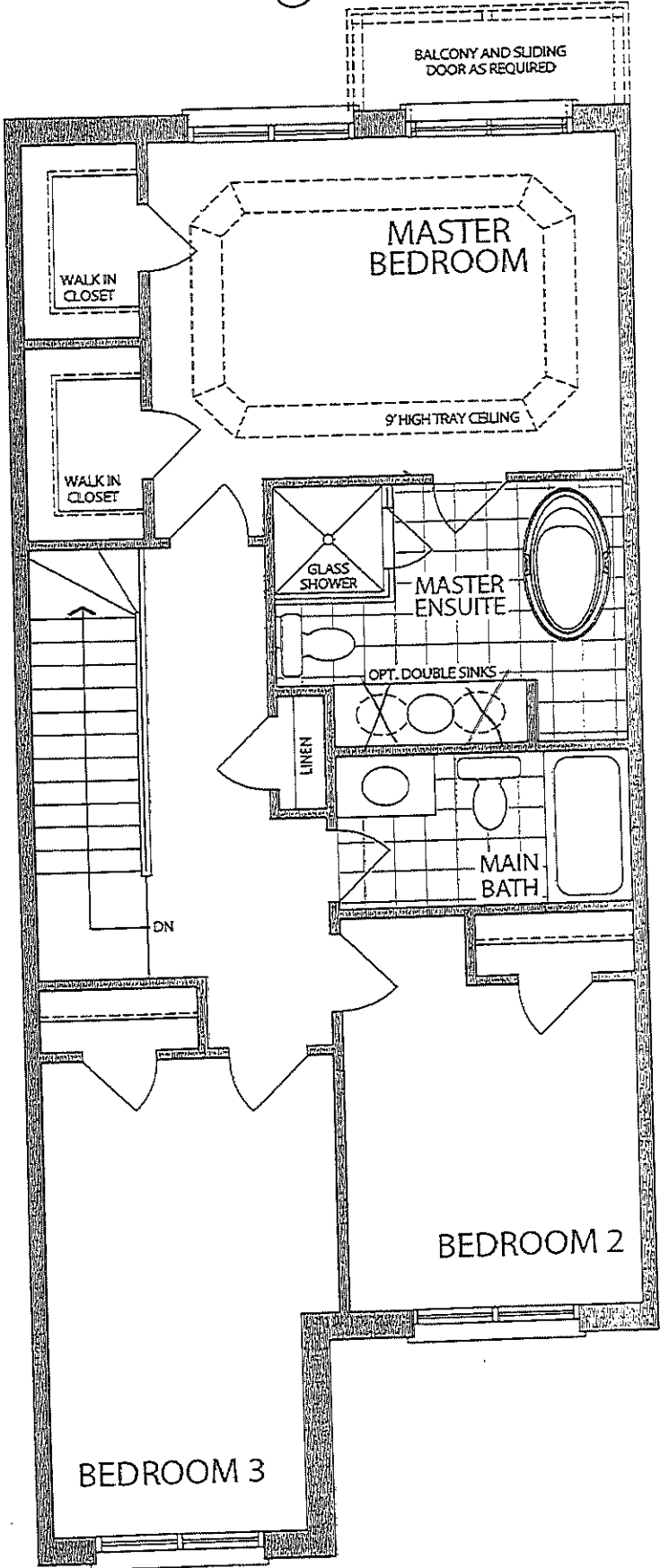

4/10  
C.W.

UPPER LEVEL  
ELEVATION A

C2 COUNTRY LANE  
LOT 50-5  
20-2329 ELEV A  
THE ENGLEWOOD

21 OF 42



no

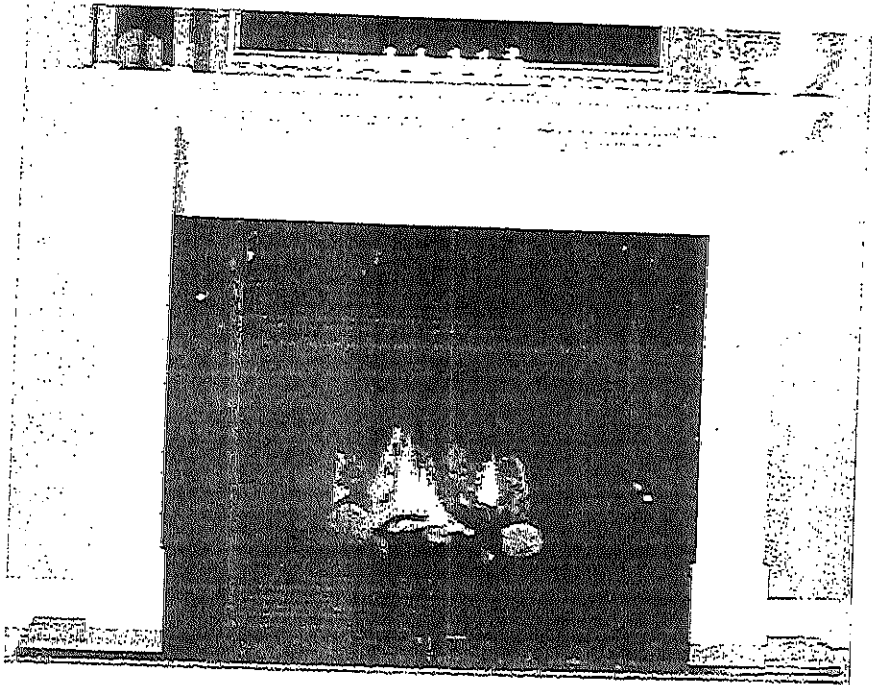

' CABINET '

NFAS NF15 Mantel

C.W.

21

C2 COUNTRY LANE  
LOT 50-5  
20-2329 ELEV A  
THE ENGLEWOOD

22 of 42

BLANCO

BLANCO QUATRUS U2  
Stainless Steel  
Undermount Sink

This new German-engineered sink from BLANCO features 9-inch bowl depths and zero-radius bowl corners. Made of durable 18 gauge stainless steel.

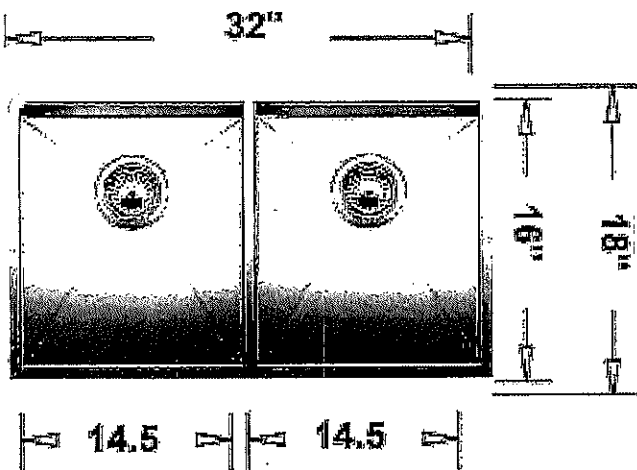
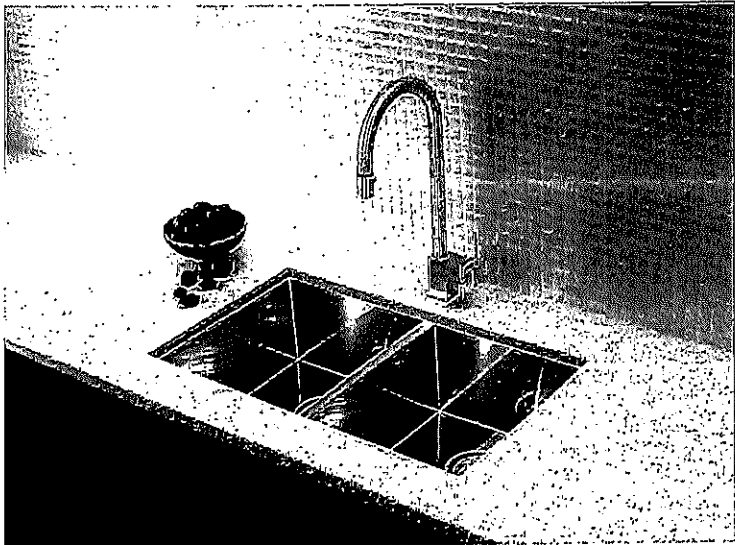

Model No.	Bowl Depth	
	Main	Secondary
401247	9" (230 mm)	9" (230 mm)

Material
Durable 18 gauge stainless steel
Brushed finish

Specifications
Minimum Cabinet Size: 33" (840 mm)
Undermount installation
Rear positioned drain holes for maximum usable bowl and cabinet storage space
Zero-radius corners and x-pattern drain grooves
Sound deadening system included
Template included
3 1/2" stainless steel strainers included

Accessories	
Stainless Steel Grid	224403

BLANCO CANADA INC.  
100 Corporation Drive, Brampton, ON L4V 1R3  
Tel: 905-494-2400 Toll Free: 1-877-425-2626  
Fax: 905-494-2425 Toll Free: 1-877-825-2626  
[www.blancocanada.com](http://www.blancocanada.com)

C2 COUNTRY LANE  
LOT 50-5  
20-2329 ELEV A  
THE ENGLEWOOD

23 OF 42

STANDARD KITCHEN FAUCET

Align

Modern

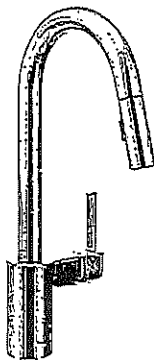

Single Handle Pull-Down Kitchen  
Faucet\*

Model 7565†

2.00  
6.00  
2.00

C2 COUNTRY LANE  
LOT 50-5  
20-2329 ELEV A  
THE ENGLEWOOD

24 of 42

*American  
Standard*

**BOULEVARD®**  
**PEDESTAL SINK**  
VITREOUS CHINA

**BOULEVARD® PEDESTAL SINK**

- ☐ 0641.800 Faucet holes on 8" (203mm) centers (Illustrated).
- ☒ 0641.400 Faucet holes on 4" (102mm) centers
- ☐ 0641.100 Center hole only
  - Classic styled rectangular pedestal lavatory
  - Vitreous china
  - Rear overflow
  - Supplied with mounting kit
  - Right Height® for greater comfort during use
  - Faucet ledge with large deck area (faucet not included)
  - Design coordinates with Boulevard® Toilet
  - Basin has flat bottom to also allow use as an above counter sink or a drop-in sink (with u-shaped cut out)

**Nominal Dimensions:**

24" x 19" x 35-1/2"  
(610 x 483 x 902mm)

- ☐ 0641.008 Pedestal top-8" (203mm) centers
- ☐ 0641.004 Pedestal top-4" (102mm) centers
- ☐ 0641.001 Pedestal top-center hole only
- ☐ 0010.000 Pedestal only

**Bowl sizes:**

17" (432mm) wide,  
12-1/2" (318mm) front to back,  
5" (127mm) deep

**Compliance Certifications -**

**Meets or Exceeds the Following Specifications:**

- ASME A112.19.2 - 2008/CSA B45.1-08

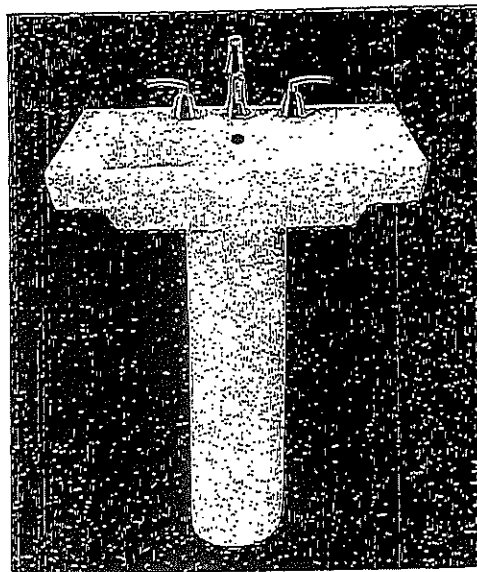

SEE REVERSE FOR ROUGHING-IN DIMENSIONS

**To Be Specified:**

- ☐ Color: ☐ White ☐ Linen
- ☐ Faucet Finish:
- ☐ Supplies:
- ☐ 1-1/4" Trap:
- ☐ Nipple:

\* See faucet section for additional models available

C2 COUNTRY LANE  
LOT 50-5  
20-2329 ELEV A  
THE ENGLEWOOD

25 of 42

#### COUNTERTOP SINK

- Vitreous china
- Self-rimming
- Front overflow
- Supplied with template
- Faucet deck
- (Faucet shown not included)



- ☒ 0346 803  
Faucet holes on 203mm (8") centres
- ☐ 0346 403 (Illustrated)  
Faucet holes on 102mm (4") centres
- ☐ 0346 001  
Centre hole only

Nominal Dimensions:  
521 x 448mm (20-1/2" x 17-5/8")

Bowl sizes:  
422mm (16-5/8") wide, 279mm (11") front to  
back, 143mm (5-5/8") deep

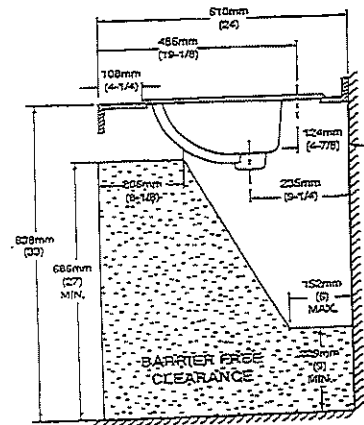
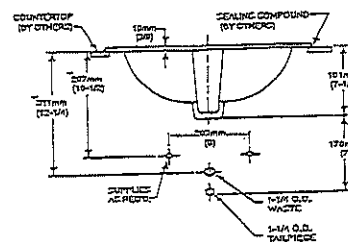
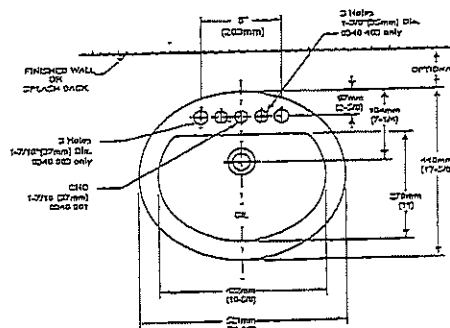

#### COMPLIANCE CERTIFICATIONS –

- Meets or exceeds the following Specifications:
- ASME A112.19.2M for Vitreous China Fixtures.
  - CAN/CSA B45 Series.

#### To Be Specified

- ☐ Colour: ☒ White ☐ Bone ☐ Silver Gray  
☐ Linen
- ☐ Faucet\*:
- ☐ Faucet Finish:
- ☐ Supplies & Stops:
- ☐ Trap 1-1/4" (32 mm):

NOTES:  
\* DIMENSIONS SHOWN FOR LOCATION OF SUPPLIES AND "P" TRAP ARE SUGGESTED.  
FOR COUNTERTOP CUTOUT AND INSTALLATION INSTRUCTIONS USE TEMPLATE  
SUPPLIED WITH SINK.  
FAUCETS NOT INCLUDED AND MUST BE ORDERED SEPARATELY.  
IMPORTANT: Dimensions of fixtures are nominal and may vary within the range of tolerances  
established by ANSI Standard A112.19.2.  
These measurements are subject to change or cancellation. No responsibility is assumed for use  
of superseded or voided pages.

\* See faucet section for additional models available



C2 COUNTRY LANE  
LOT 50-5  
20-2329 ELEV A  
THE ENGLEWOOD

26 of 42



Demi CF2007

gt. 2007

C2 COUNTRY LANE  
LOT 50-5  
20-2329 ELEV A  
THE ENGLEWOOD

27 of 42

## Chateau

Transitional

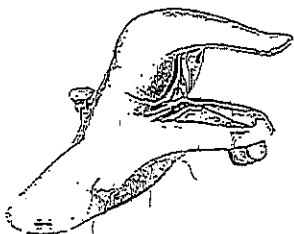

Lavatory Faucet with Pop-Up Drain  
Model L4621+

VANITY SINKS AND PEDESTAL



Posi-Temp® Pressure Balancing Tub/Shower  
Model 62320 / TL183+

OR

Posi-Temp Valve and Tub/Shower Trim  
with Eco-Performance Easy Clean® XL  
Model 62320 / TL183EP+  
(TL183EP not available in BC)

SHOWER AND 5' TUB FAUCETS



2 Handle Roman Tub with 9" Spout  
Model 4796 / T990+

FREESTANDING TUB FAUCETS

glw  
ciw

C2 COUNTRY LANE  
LOT 50-5  
20-2329 ELEV A  
THE ENGLEWOOD

28 of 42

**Cyclone**<sup>®</sup>  
Breathe Better

## SCB930 ALITO Collection

\*SCB51930\*

### Features

- Wall mount range hood
- 6" round duct adapter
- Non-stick aluminum fan blades
- 3 speed push button control
- 2 LED lights (2 x 1.4W)
- Dishwasher-safe mesh or baffle filters
- Standard chimney fits up to 9 ft. ceiling
- Up to 9 minute time-delay OFF feature
- Plug-in connection

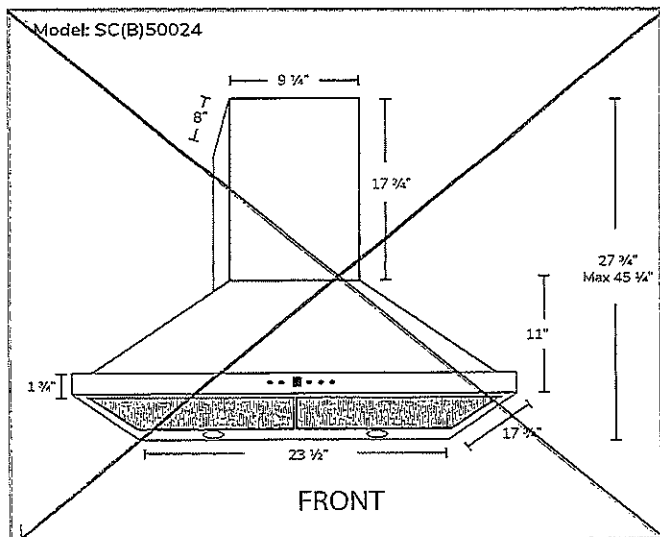
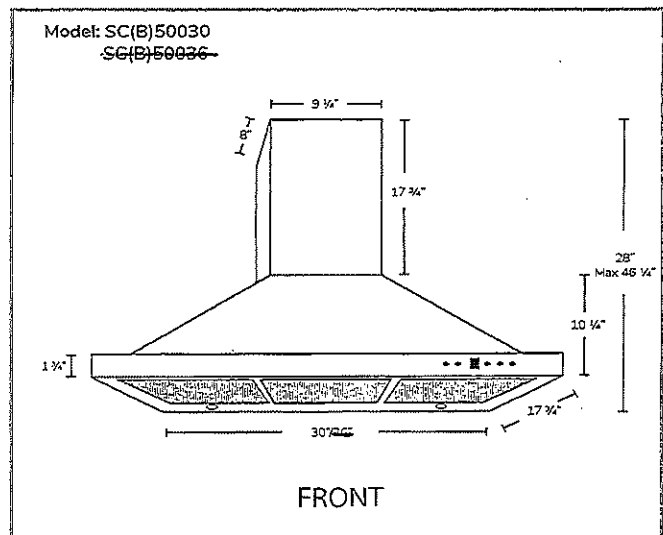

### Options

- Filters: SC500 - Quick Release Aluminum Mesh Filters  
SCB500 - Quick Release Stainless Steel Baffle Filters
- Available Chimney Flues:  
Short (7 ft. - 8 ft. A1.CH10)  
Standard (8 ft. - 9 ft. A1.CH18)  
Extended (9 ft. - 11 ft. A1.CH30)
- Widths: 24", 30", 36"

### Specifications

- Air Flow Volume: 550 CFM
- Electrical Connection: 120V/60Hz
- Power Consumption: 210 Watts
- Current: 2.5 Amps
- Fan Speed: 1600RPM
- Fan Type: Centrifugal Blower

- Finishes: Stainless Steel
- Ducting: 6" Round
- Dimensions: Width: 24" 30" 36"  
Height: 46"  
Depth: 18"

- Noise Level: Min. 2 Sones  
Max. 6 Sones



Toronto • Vancouver • Boston

[www.CycloneRangeHoods.com](http://www.CycloneRangeHoods.com)

C2 COUNTRY LANE  
LOT 50-5  
20-2329 ELEV A  
THE ENGLEWOOD

29 of 42

Whirlpool® Top Mount Refrigerator

PRODUCT MODEL NUMBERS

WRT311FZD  
WRT511SZD  
WRT541SZD

PRODUCT DIMENSIONS

**Electrical:** A 115-volt, 60-Hz, AC-only, 15- or 20-amp fused, grounded electrical supply is required. It is recommended that a separate circuit serving only your refrigerator be provided. Use an outlet that cannot be turned off by a switch. Do not use an extension cord.

**NOTE:** Before performing any type of installation, cleaning, or removing a light bulb, turn the control (Thermostat, Refrigerator or Freezer Control depending on the model) to OFF and then disconnect the refrigerator from the electrical source. When you are finished, reconnect the refrigerator to the electrical source and reset the control (Thermostat, Refrigerator or Freezer Control depending on the model) to the desired setting. See "Using the Controls."

**Water:** A cold water supply with water pressure between 30 and 120 psi (207 and 827 kPa) is required to operate ice maker and water dispenser. If you have questions about your water pressure, call a licensed, qualified plumber.

**IMPORTANT:** The pressure of the water coming out of a reverse osmosis system going to the water inlet valve of the refrigerator needs to be between 30 and 120 psi (207 and 827 kPa).

**Reverse Osmosis Water Supply:** If a reverse osmosis water filtration system is connected to your cold water supply, the water pressure to the reverse osmosis system needs to be a minimum of 40 to 60 psi (276 to 414 kPa).

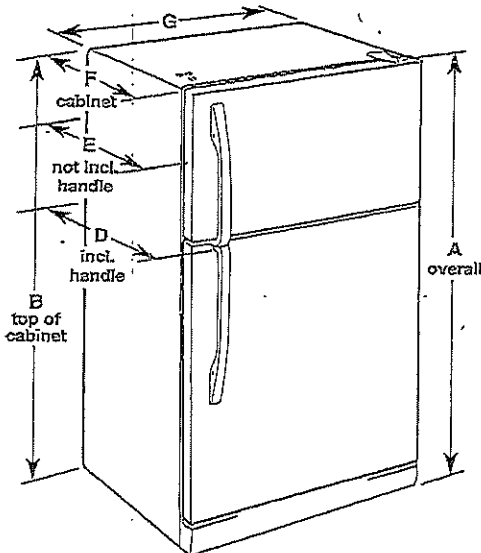

Model Number	Model Size	Reversible Door	Height - Overall "A"	Height - Top of Cabinet "B"	Depth - Door Open 90° "C"	Depth - With Handles "D"	Depth - Without Handles "E"	Depth - Cabinet Only "F"	Width - Cabinet "G"
WRT311FZD	20.5 cu. ft.	Yes	66 1/4" (168.3 cm)	65 1/2" (166.4 cm)	62 1/4" (158.1 cm)	32 1/4" (83.5 cm)	30 5/8" (77.8 cm)	28 1/2" (72.4 cm)	32 3/4" (83.2 cm)
WRT511SZD WRT541SZD	21.3 cu. ft.	Yes	66 1/4" (168.3 cm)	65 1/2" (166.4 cm)	62 1/4" (158.1 cm)	34" (86.4 cm)	32 1/2" (82.3 cm)	28 1/2" (72.4 cm)	32 3/4" (83.2 cm)

LOCATION REQUIREMENTS

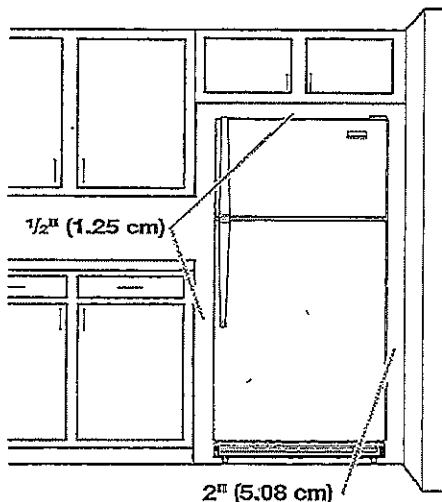

To ensure proper ventilation for your refrigerator, allow for a 1/2" (1.25 cm) space on each and between overhead cabinets and refrigerator top. Allow at least 1" (2.5 cm) between back of cabinet and the wall. If your refrigerator has an ice maker, make sure you leave some extra space at the back for the water line connections.

If you are installing your refrigerator next to a fixed wall, leave 2" (5 cm) minimum on the hinge side (depending on your model) to allow for the door to swing open.

**NOTE:** This refrigerator is intended for use in a location where the temperature ranges from a minimum of 55°F (13°C) to a maximum of 110°F (43°C). The preferred room temperature range for optimum performance, which reduces electricity usage and provides superior cooling, is between 60°F (15°C) and 90°F (32°C). It is recommended that you do not install the refrigerator near a heat source, such as an oven or radiator.

Because Whirlpool Corporation policy includes a continuous commitment to improve, our products, we reserve the right to change materials and specifications without notice.

Dimensions are for planning purposes only. For complete details, see Installation Instructions packed with product. Specifications subject to change without notice.

Ref. W10674106  
10/29/14

Handwritten signature or initials.

C2 COUNTRY LANE  
LOT 50-5  
20-2329 ELEV A  
THE ENGLEWOOD

30 of 42

Refrigerator Door Swing Verification

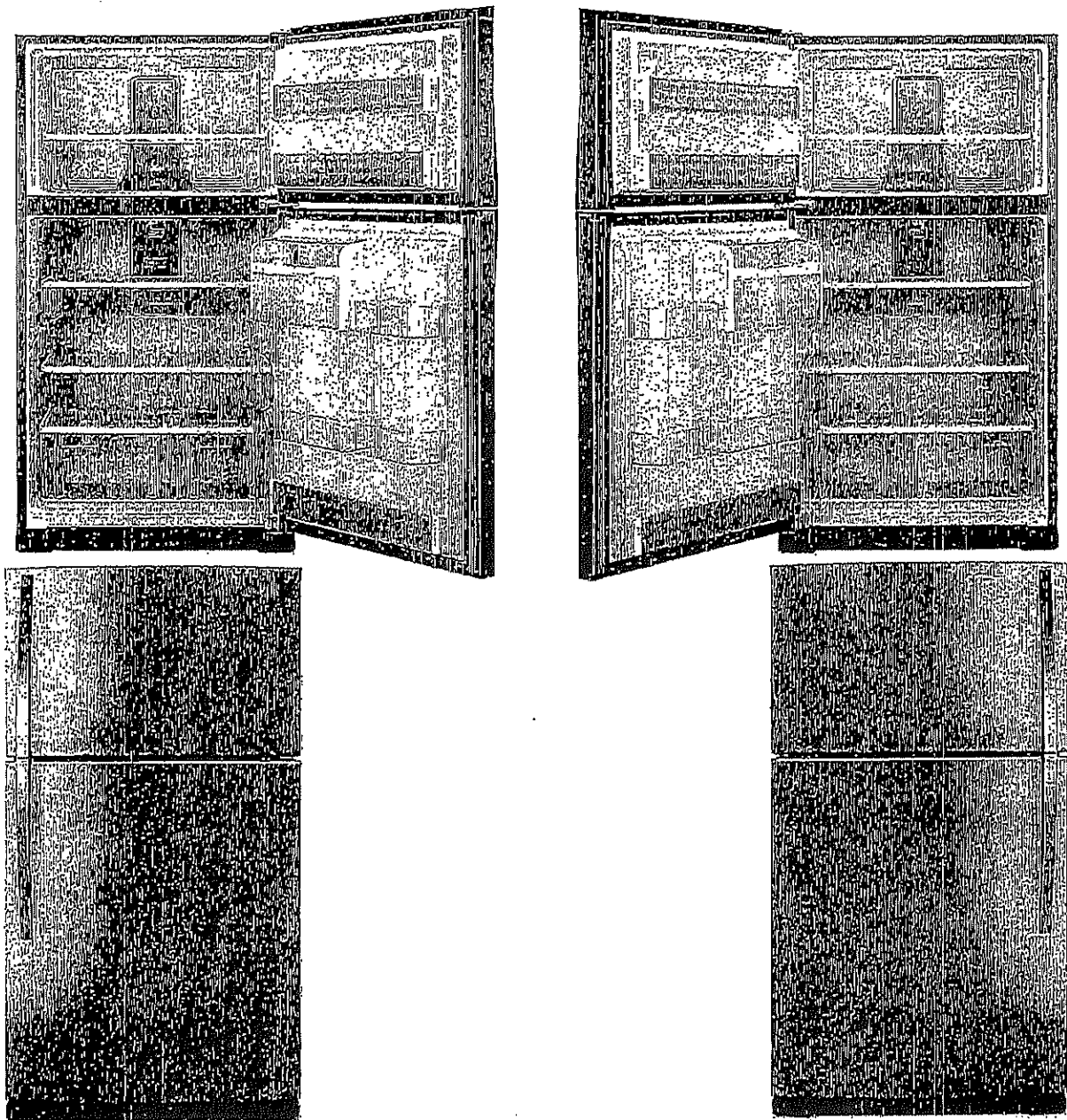

When facing the refrigerator



RIGHT HAND  
DOOR OPENING

- Hinges on right
- Handle on left

*C.W.*  
INITIAL

LEFT HAND  
DOOR OPENING

- Hinges on left
- Handle on right



INITIAL

Please check and INITIAL your door swing selection.

C2 COUNTRY LANE  
LOT 50-5  
20-2329 ELEV A  
THE ENGLEWOOD

31 OF 42

Whirlpool

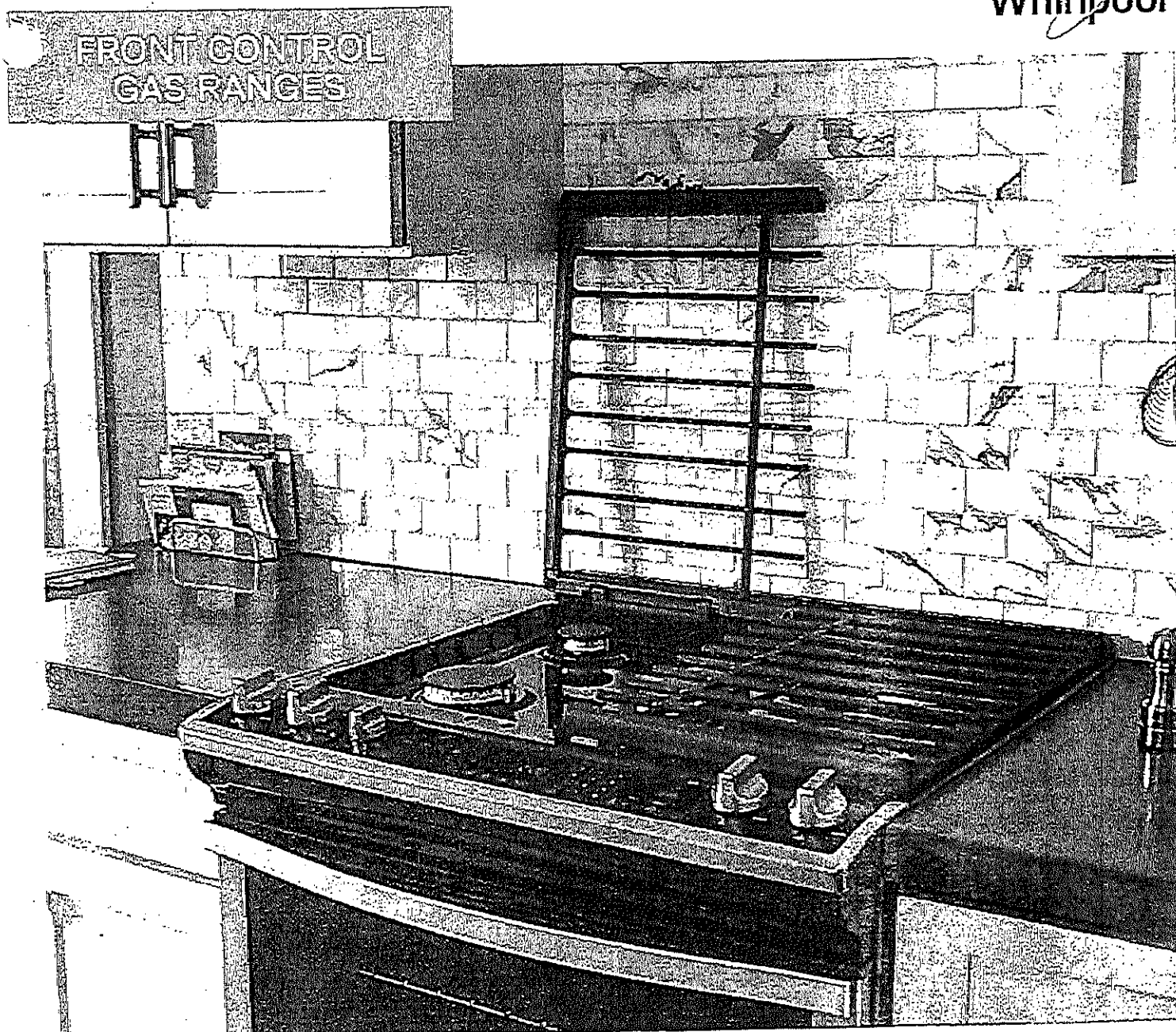

## FEATURING



### TimeSaver™ system

The TimeSaver™ system's Frozen Bake Technology allows you to skip preheating for favorites like pizza, lasagna, chicken nuggets, fries or pies so you can cook frozen foods faster.\*



### HeatRight™ system

The HeatRight™ system's True convection helps you to cook food faster with a rear fan and third heating element to circulate hot air over, under, and around food



### CompleteClean™ system

The CompleteClean™ system's EZ-2-Lit™ hinged grates give you quick access to spills on the cooktop. The industry first hinged design allows you to wipe up under them without removing them entirely. For a more thorough clean, the grates are also dishwasher-safe.

# Every day, care.™

From the #1 Selling Appliance brand in the USA†

gfw  
C W

C2 COUNTRY LANE  
LOT 50-5  
20-2329 ELEV A  
THE ENGLEWOOD

32 of 42

## Front Control Gas Ranges

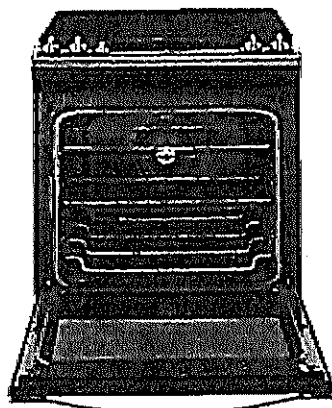
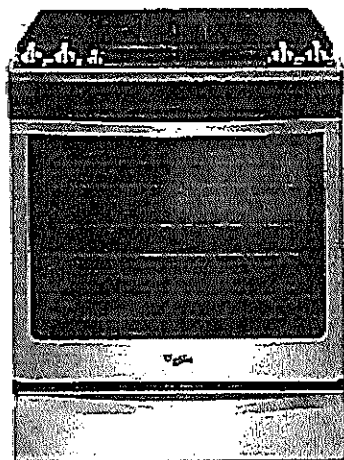

**WEG745HOF**

NEW

30" Freestanding Range - 5.8 cu. ft.



**TimeSaver™ system**  
• Frozen Bake™ Technology



**HeatRight™ system**  
• True Convection  
• Convection Conversion  
• AccuSimmer™ burner  
• Center Oval burner  
• Temperature Sensor



**CompleteClean System**  
• EZ-2-Lift™ Hinged Grates  
• AquaLift® Self-cleaning Technology  
• Dishwasher-safe knobs



**ReadySet™ system**  
• (2) SpeedHeat™ burners  
• Rapid Preheat  
• Keep Warm  
• Delay Cook

### Available colors



**S**  
Stainless  
Steel



**H**  
White  
Ice



**E**  
Black  
Ice

### PRODUCT DIMENSIONS

This manual covers several models. Your model may appear different from the model's depicted. Dimensions given are approximate and subject to change without notice.

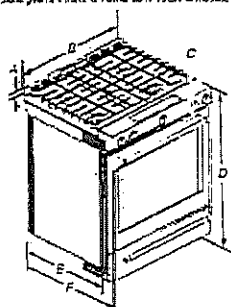

- A. 35 1/2" (903 mm) height from floor to top of oven door
- B. 20 1/2" (519 mm) depth
- C. 24 1/2" (619 mm) width
- D. 36 1/2" (927 mm) height from floor to top of cooktop
- E. 24 1/2" (619 mm) width from handle to back of range
- F. 24 1/2" (619 mm) width from handle to back of range

**IMPORTANT:** Range must be level after installation. Follow the instructions in the "Level Range" section. Using the leveling legs at the rear of the range is not recommended.  
\* Range can be leveled across the top (1/8" only) by adjusting the leveling legs.

### Type of Gas

#### Natural gas:

W. This range is factory set for use with natural gas. See "Gas Conversions" section. The model shown is a factory set for use with natural gas. The burner orifice is set for use with natural gas. The burner orifice is set for use with natural gas. The burner orifice is set for use with natural gas.

#### LP gas conversion:

Conversion must be done by a qualified service technician. No attempt should be made to convert the appliance from the gas specified on the model nameplate. (Using plate for use with a different gas without consulting the service gas supplier. See "Gas Conversions" section.)

### CABINET OPENING DIMENSIONS

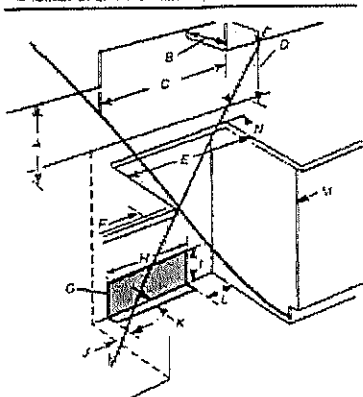

**IMPORTANT:** A minimum clearance of 1/8" (3 mm) is required between the range and the cabinet. The range must be installed in a cabinet opening that is at least 24 1/2" (619 mm) wide. The range must be installed in a cabinet opening that is at least 24 1/2" (619 mm) wide. The range must be installed in a cabinet opening that is at least 24 1/2" (619 mm) wide.

- A. 24 1/2" (619 mm) width from handle to back of range
- B. 24 1/2" (619 mm) width from handle to back of range
- C. 24 1/2" (619 mm) width from handle to back of range
- D. 24 1/2" (619 mm) width from handle to back of range
- E. 24 1/2" (619 mm) width from handle to back of range
- F. 24 1/2" (619 mm) width from handle to back of range
- G. 24 1/2" (619 mm) width from handle to back of range
- H. 24 1/2" (619 mm) width from handle to back of range
- I. 24 1/2" (619 mm) width from handle to back of range
- J. 24 1/2" (619 mm) width from handle to back of range
- K. 24 1/2" (619 mm) width from handle to back of range

\* NOTE: 24 1/2" (619 mm) minimum when cabinet is 24 1/2" (619 mm) wide. The range must be installed in a cabinet opening that is at least 24 1/2" (619 mm) wide. The range must be installed in a cabinet opening that is at least 24 1/2" (619 mm) wide. The range must be installed in a cabinet opening that is at least 24 1/2" (619 mm) wide.

### ACCESSORIES & REPLACEMENT PARTS

- Part number 8273828A Anti-Tip Kit for Range
- Part number 4378577 Brick Baking Stone
- Part number 4386923 Porcelain Broiler Pan & Grid
- Part number W10123240 Premium Broil Pan & Roasting Rack
- Part number 8009 Appliance Light Bulb - 40 Watt

**Whirlpool®**

\*Compared to a traditional preheat and bake cycle for pizza, nuggets/fries, pies and lasagna. \*\*Compared to thermal-bake cycle on the same model. †Based on 12-month average of unit sales. Refrigeration, Cooking, Dishwashers, and Laundry appliances. Trends, 2014.

©2016 Whirlpool. All rights reserved. SPS Form No. WC160099B

2/16  
C.W.



C2 COUNTRY LANE  
LOT 50-5  
20-2329 ELEV A  
THE ENGLEWOOD

33 of 42

# Whirlpool® 30" (76.2 cm) Slide-in Gas Range

## PRODUCT MODEL NUMBERS

WEG780H0D

WEG780H0D

WEG745H0F

## GAS SUPPLY REQUIREMENTS

### Gas supply line:

- Provide a gas supply line of 3/4" (1.9 cm) rigid pipe to the range location. A smaller size pipe on longer runs may result in insufficient gas supply. With LP gas, piping or tubing size can be 1/2" (1.3 cm) minimum. Usually, LP gas suppliers determine the size and materials used in the system.

NOTE: Pipe-joint compounds that resist the action of LP gas must be used. Do not use TEFLON® tape.

### Flexible metal appliance connector:

- If local codes permit, a new CSA design-certified, 4 to 5 ft (122 to 152.4 cm) long, 1/2" (1.3 cm) or 3/4" (1.9 cm) I.D., flexible metal appliance connector may be used for connecting range to the gas supply line.



- A 1/2" (1.3 cm) male pipe thread is needed for connection to the female pipe-threads of the inlet to the appliance pressure regulator.
- Do not kink or damage the flexible metal tubing when moving the range.
- Must include a shutoff valve:  
The supply line must be equipped with a manual shutoff valve. This valve should be located in the same room but external to the range opening, such as an adjacent cabinet. It should be in a location that allows ease of opening and closing. Do not block access to shutoff valve. The valve is for turning on or shutting off gas to the range.

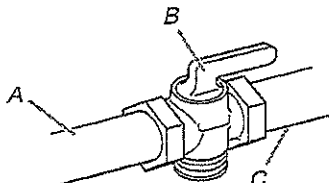

A. Gas supply line  
B. Shutoff valve "open" position  
C. To range

## Gas Pressure Regulator

The gas pressure regulator supplied with this range must be used. The inlet pressure to the regulator should be as follows for proper operation:

### Natural gas:

Minimum pressure: 5" WCP  
Maximum pressure: 14" WCP

### LP gas:

Minimum pressure: 11" WCP  
Maximum pressure: 14" WCP

Contact local gas supplier if you are not sure about the inlet pressure.

## PRODUCT DIMENSIONS

This manual covers several models. Your model may appear different from the models depicted. Dimensions given are maximum dimensions across all models.

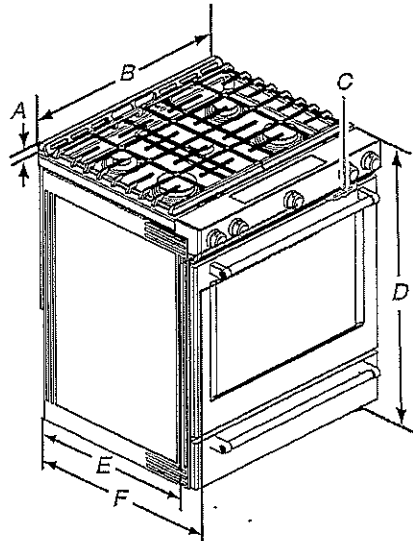

- A. 1 1/8" (3.0 cm) height from cooktop to top of vent
- B. 29 7/8" (75.9 cm)
- C. Model/serial number plate (located behind the oven door on the top right-hand side of the oven frame)
- D. 36" (91.4 cm) height to top of cooktop edge with leveling legs screwed all the way in\*
- E. 28 1/8" (71.9 cm) max. depth from front of console to back of range.
- F. 28 3/8" (73.3 cm) max. depth from handle to back of range.

**IMPORTANT:** Range must be level after installation. Follow the instructions in the "Level Range" section. Using the cooktop as a reference for leveling the range is not recommended.

\* Range can be raised approximately 1" (2.5 cm) by adjusting the leveling legs.

## Type of Gas

### Natural gas:

- This range is factory set for use with Natural gas. See "Gas Conversions" section. The model/serial rating plate located behind the control panel has information on the types of gas that can be used. If the types of gas listed do not include the type of gas available, check with the local gas supplier.

### LP gas conversion:

Conversion must be done by a qualified service technician. No attempt shall be made to convert the appliance from the gas specified on the model/serial rating plate for use with a different gas without consulting the serving gas supplier. See "Gas Conversions" section.

®TEFLON is a registered trademark of Chemours.



C2 COUNTRY LANE  
LOT 50-5  
20-2329 ELEV A  
THE ENGLEWOOD

34 of 42

Whirlpool® Dishwasher with ENERGY STAR® qualification



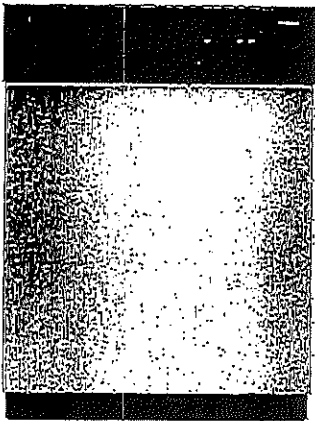



WDF310PAAS  
Black-on-Stainless

OTHER AVAILABLE COLORS

Black  
Model: WDF310PAAB

Biscuit-on-Biscuit  
Model: WDF310PAAT

White  
Model: WDF310PAAW

Universal Silver  
Model: WDF310PAAD



DIMENSIONS		KEY FEATURES
Maximum Height	34 1/2 Inches	ENERGY STAR® Qualified No One Has Fewer Repairs 17 Years in A Row Resource - Efficient Wash System CEE Tier 1 qualified Tall Tub Design White Plastic Interior Quiet Partner(TM) I Sound Package Auto Soil Sensor Electronic Controls 3 Automatic Cycles 1-Hour Wash Cycle Heavy Wash Cycle Normal Cycle 4 Options High Temperature Wash System Heated Dry Option 4 Hour Delay Wash Option 4-Tier SheerClean Direct Feed Wash System Control Lock Vinyl Racks In-Rack Silverware Basket
Minimum Height	33 1/2 Inches	
Height	34 1/2 Inches	
Depth	24 1/2 Inches	
Width	23 7/8 Inches	
Dimensions shown are for planning purposes only. For complete information, see Installation Instructions packaged with product.		
ELECTRICAL		
15 Amps Amps. 60 Hz. 120 V. 15,		
Before purchasing this appliance, read important information about its estimated annual energy consumption or energy efficiency rating that is available from your dealer.		

W.  
glw

C2 COUNTRY LANE  
LOT 50-5  
20-2329 ELEV A  
THE ENGLEWOOD

35 of 42

# Whirlpool® Undercounter Dishwasher

## PRODUCT MODEL NUMBERS

WDF110PAB	WDF310PLA	WDF530PSY
WDF111PAB	WDF320PAD	WDF540PAD
WDF120PAF	WDF510PAY	WDF730PAY
WDF121PAF	WDF520PAD	WDT710PAY
WDF310PAA	WDF530PAY	WDT720PAD
WDF310PCA	WDF530PLY	WDT770PAY

**Electrical Requirements:** 120-volt, 60-Hz, AC only, 15- or 20-amp. fused electrical supply. Copper wire only. A time delay fuse or circuit breaker and separate circuit is recommended.

**If direct wiring dishwasher:** Use flexible, armored, or nonmetallic, sheathed copper wire with grounding wire that meets the wiring requirements for your home and local codes and ordinances. Use a UL listed or CSA approved conduit connector.

**If connecting dishwasher with a power supply cord:**

Use Power Supply Cord Kit (Part No. 4317824) marked for use with dishwashers. Follow the kit instructions for installing the power supply cord.

Power supply cord must plug into a grounded 3 prong, outlet, located in the cabinet next to the dishwasher opening. Outlet must meet all local codes and ordinances.

**Water Supply Requirements:** A hot water line with 20 to 120 psi (138 to 862 kPa) water pressure. Water temperature must be 120°F (49°C) water at dishwasher. Use 3/8" O.D. copper tubing with compression fitting or flexible braided water supply line (1/2" minimum plastic tubing is not recommended). Use a 90° elbow with 3/4" N.P.T. external pipe threads on one end. Do not solder within 6" (15.2 cm) from water inlet valve.

**Drain Requirements:** A new drain hose is supplied with your dishwasher. If this is not long enough, use a new drain hose with a maximum length of 12' (3.7 m) (Part No. 3385556) that meets all current AHAM/IAPMO test standards, is resistant to heat and detergent, and fits the 1" (2.5 cm) drain connector of the dishwasher.

Make sure to connect the drain hose to waste tee or disposer inlet above drain trap in house plumbing and 20" (50.8 cm) minimum above the floor. It is recommended

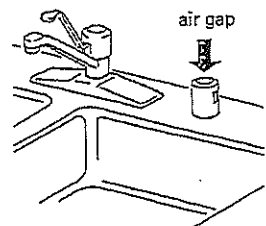

that the drain hose either be looped up and securely fastened to the underside of the counter or be connected to an air gap.

Make sure to use an air gap if the drain hose is connected to house plumbing lower than 20" (50.8 cm) above subfloor or floor.

Use 1/2" (1.3 cm) minimum I.D. drain line fittings.

If required, the air gap should be installed in accordance with the air gap installation instructions. When connecting the air gap, a rubber hose (not provided) will be needed to connect to the waste tee or disposer inlet.

## PRODUCT DIMENSIONS

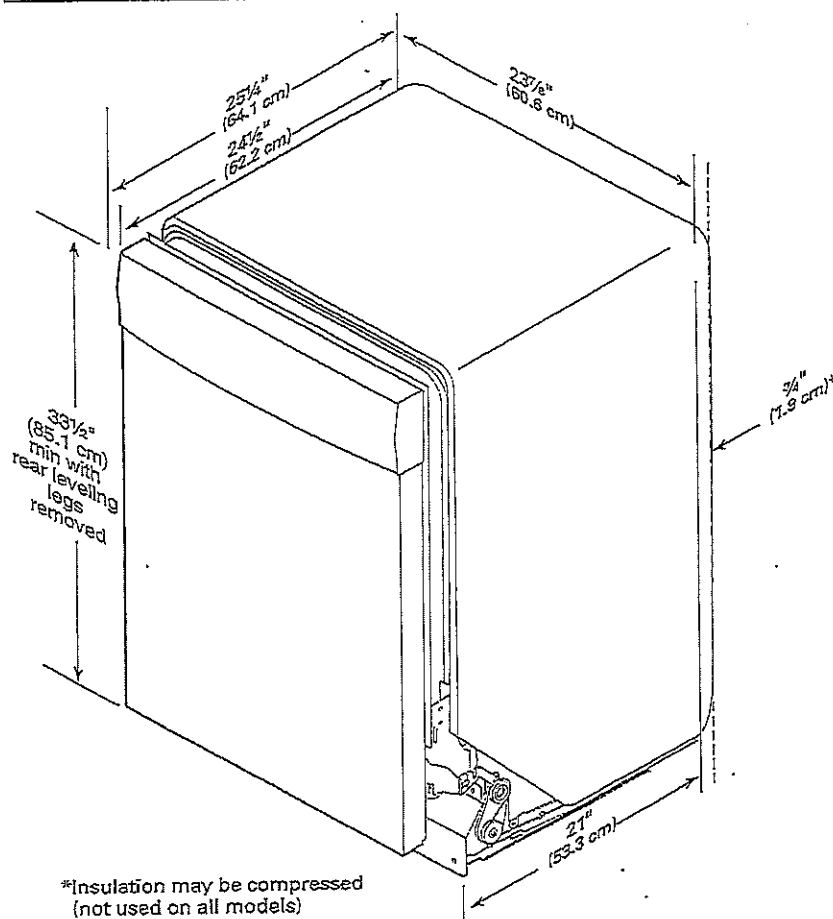

\*Insulation may be compressed (not used on all models)

Because Whirlpool Corporation policy includes a continuous commitment to improve our products, we reserve the right to change materials and specifications without notice.

Dimensions are for planning purposes only. For complete details, see Installation Instructions packed with product. Specifications subject to change without notice.

Page 1 of 2  
W10435040C-D-WH  
5/1/16

Handwritten note: "See C-20"

C2 COUNTRY LANE  
LOT 50-5  
20-2329 ELEV A  
THE ENGLEWOOD

36 of 42

#### CABINET CUTOUT DIMENSIONS

WDF320PWH

**NOTE:** Shaded areas of cabinet walls show where utility connections may be installed.

\*Measure from the lowest point on the underside of the countertop. May be reduced to 33½" (85.1 cm) by removing the rear leveling legs from dishwasher.

\*\*Minimum, measured from narrowest point of opening.

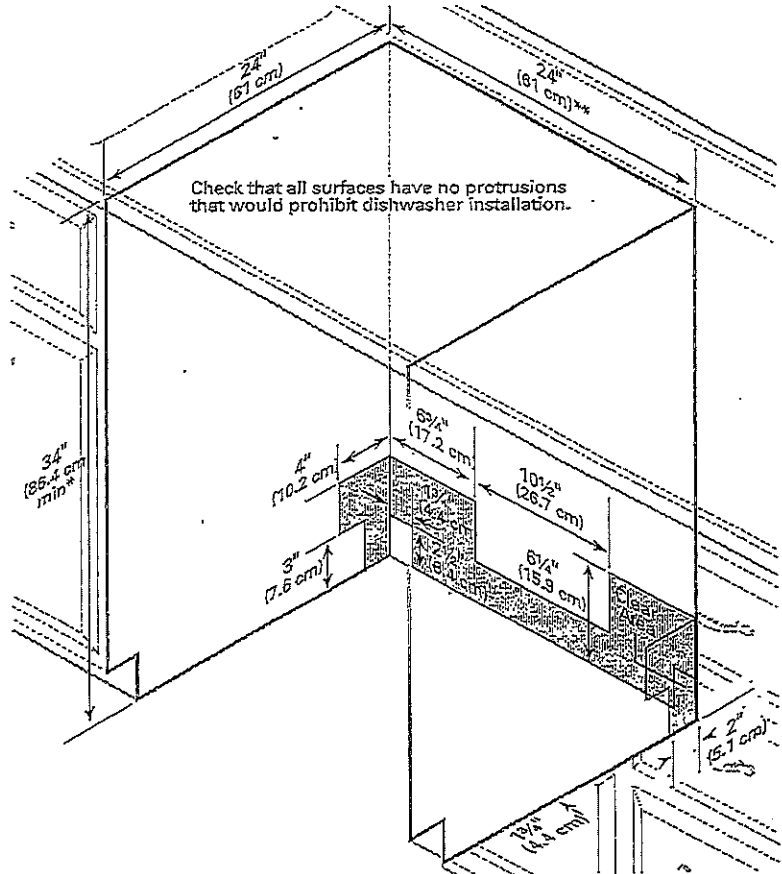

C2 COUNTRY LANE  
LOT 50-5  
20-2329 ELEV A  
THE ENGLEWOOD

37 of 42

WHIRLPOOL WASHER Model #: WFW5620HW

Whirlpool Brand Canada English | Washer and Dryers | Washers | Front Load Washers | WFW5620HW

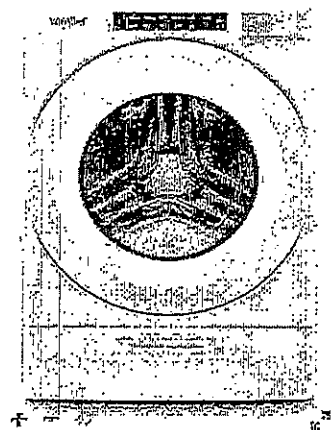

5.2 cu. ft. I.E.C. Closet-Depth  
Front Load Washer with  
Load & Go™ Dispenser



Whirlpool 5.2 cu. ft. I.E.C. Closet-Depth Front Load Washer with Load & Go™  
Dispenser  
Model #: WFW5620HW

Dimensions

Depth	90.17 cm, 31-9/16 in
Depth With Door Open 90 Degree	143.51 cm, 56-1/2 in
Minimum Height	98.11 cm, 38-5/8 in
Width	69.53 cm, 27.0 in

Appearance

LCD Touch Screen	No
Window	Yes

Details

Drum Material	Stainless Steel
---------------	-----------------

Cycles and Options

Number of Wash Cycles	37
-----------------------	----

Electrical

Hz	60
Power Cord Included	Yes

C2 COUNTRYLANE  
 LOT 50-5  
 20-2329 ELEVA  
 THE ENGLEWOOD

38 of 42

WHIRLPOOL WASHER Model #: WFW5620HW

## LOCATION REQUIREMENTS

Proper installation is your responsibility.

### You will need:

- A water heater set to 120°F (49°C).
- A grounded electrical outlet located within 6 ft (1.8 m) of power cord on back of washer.
- Hot and cold water faucets located within 4 ft (1.2 m) of hot and cold water fill valves on washer, and water pressure of 20–100 psi (137.9–689.6 kPa).
- A level floor with maximum slope of 1" (25 mm) under entire washer. Installing on carpet or surfaces with foam backing is not recommended.
- Floor must support washer's total weight (with water and load) of 315 lbs (143 kgs).

**IMPORTANT:** Do not install, store, or operate washer where it will be exposed to weather or in temperatures below 32°F (0°C). Water remaining in washer after use may cause damage in low temperatures. See "Washer Care" in your Use and Care Guide for winterizing information.

### Whirlpool Models\*

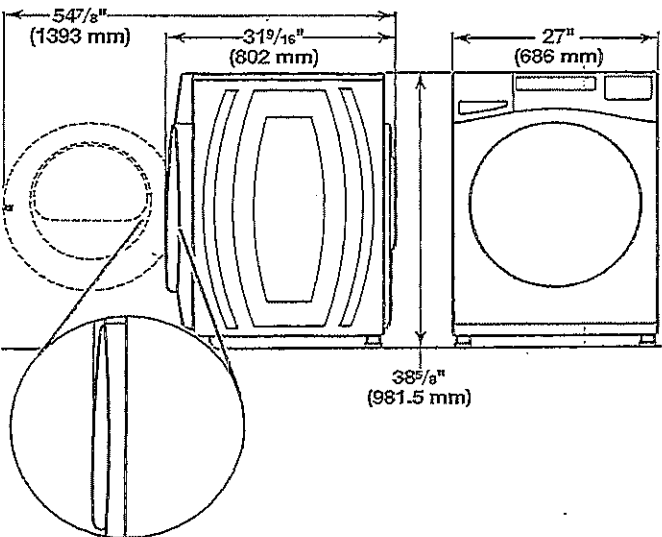
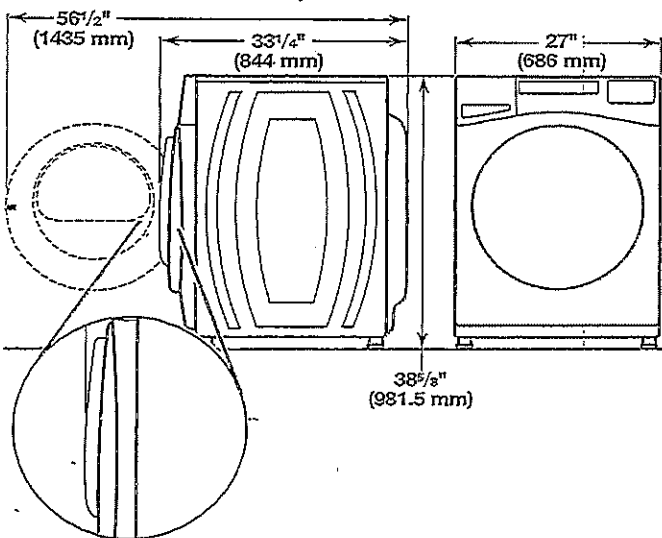

\*For additional details (or information) specific to your model, refer to the 'Dimensions' listed for your model at [www.whirlpool.com](http://www.whirlpool.com).

### Maytag Models

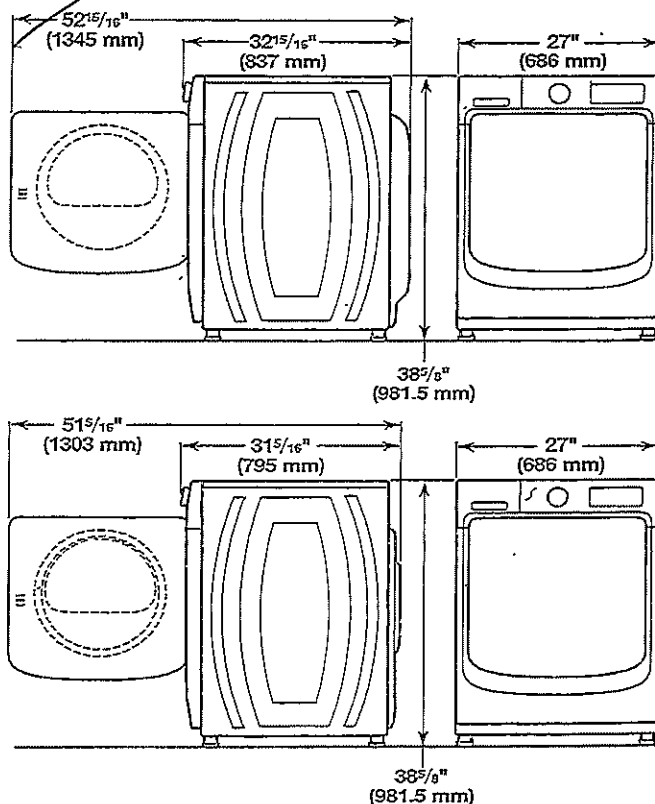

All dimensions show minimum spacing allowed. For each arrangement, consider allowing more space for ease of installation and servicing, and spacing for companion appliances and clearances for walls, doors, and floor moldings.

Space must be large enough to allow door to fully open. Add spacing of 1" (25 mm) on all sides of washer to reduce noise transfer. If a closet door or louvered door is installed, top and bottom air openings in door are required.

### Recessed area or closet installation (stacked washer and dryer):

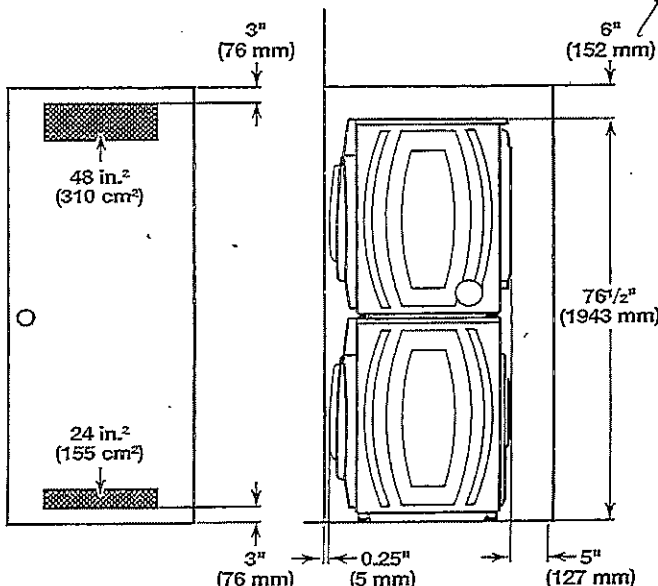

C.W. [Signature]

C2 COUNTRY LANE  
 LOT 50-5  
 20-2329 ELEV A  
 THE ENGLEWOOD

39 OF 42

WHIRLPOOL WASHER Model #: WFW5620HW

Custom under-counter installation:

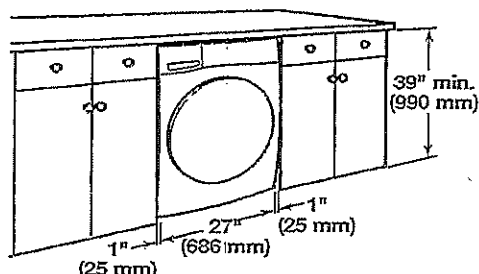

DRAIN SYSTEM

The drain system can be installed using a floor drain, wall standpipe, floor standpipe, or laundry tub. Select the method you need.

**IMPORTANT:** To avoid siphoning, only 4.5" (114 mm) of drain hose should be inside standpipe. Always secure drain hose with cable tie.

Floor standpipe drain system

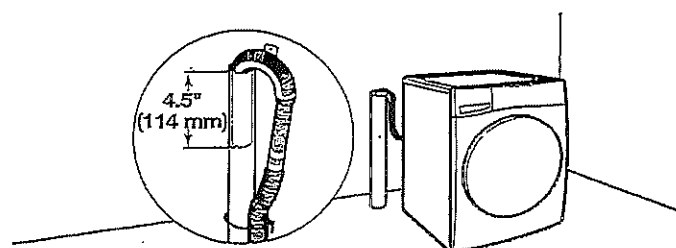

Minimum diameter for a standpipe drain: 2" (51 mm). Minimum carry-away capacity: 17 gal. (64 L) per minute. A 1/4" (6 mm) diameter to 1" (25 mm) diameter Standpipe Adapter Kit is available (Part Number 3363920). Top of standpipe must be at least 30" (762 mm) high; install no higher than 96" (2.44 m) from bottom of washer. If you have an overhead sewer and need to pump higher than 96" (2.44 m), a sump pump and associated hardware are needed. See "Alternate parts."

Wall standpipe drain system

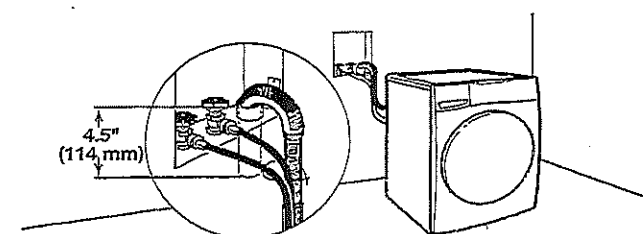

See requirements for floor standpipe drain system.

Laundry tub drain system

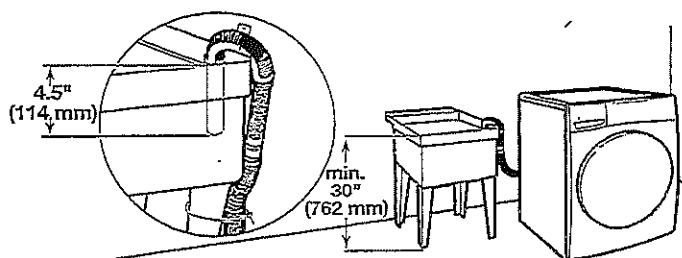

Minimum capacity: 20 gal. (76 L). Top of laundry tub must be at least 30" (762 mm) above floor; install no higher than 96" (2.44 m) from bottom of washer.

Recessed area or closet installation:

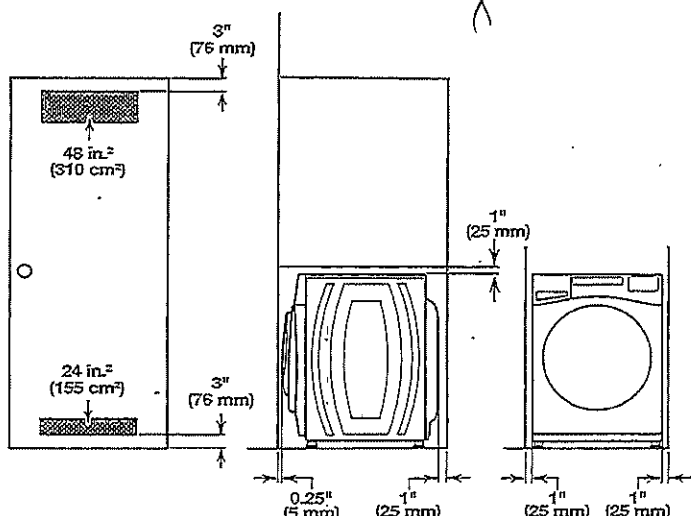

Custom cabinet installation:

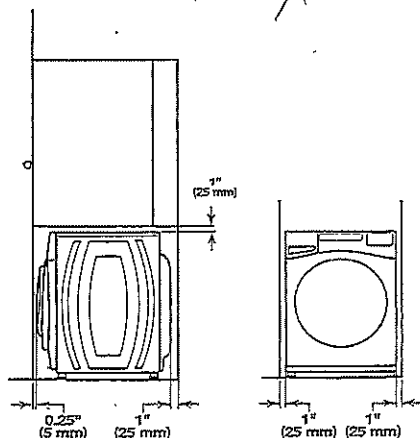

C.W.  
 J.W.

C2 COUNTRY LANE  
LOT 50-S  
20-2329 ELEVA  
THE ENGLEWOOD

40 of 42

# WHIRLPOOL DRYER Model #: YWED5620HW

Whirlpool Brand Canada English | Washer and Dryers | Dryers | Electric Dryers | YWED5620HW

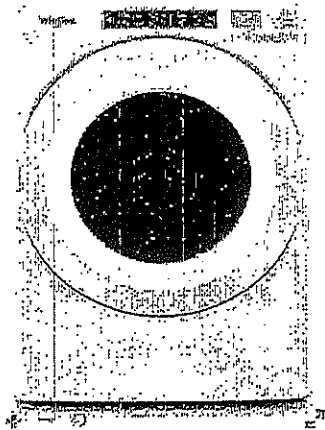

7.4 cu. ft. Front Load Electric  
Dryer with Intuitive Touch  
Controls



Whirlpool 7.4 cu. ft. Front Load Electric Dryer with Intuitive Touch Controls  
Model #: YWED5620HW

## Dimensions

Depth	78.74 cm, 31.0 in
Depth With Door Open 90 Degrees	138.43 cm, 54-1/2 in
Height	98.42 cm, 38-3/4 in
Width	69.58 cm, 27.0 in

## Configuration and Overview

Fuel Type	Electric
-----------	----------

## Cycles and Options

Cycle Time Remaining	Yes
Lint Filter Indicator	No
Number of Dryer Cycles	36
Number of Dryness Levels	3

## Ventilation System

Long Vent	No
Maximum Vent Length	64
Venting Direction	Left, Right, Bottom, Rear

## Electrical

Hz	60
Power Cord Included	Yes

C.W. C.W.

C2 COUNTRY LANE  
 LOT 50-5  
 20-2329 ELEVA  
 THE ENGLEWOOD

41.42

WHIRLPOOL DRYER Model #: YWED5620HW

Back view:

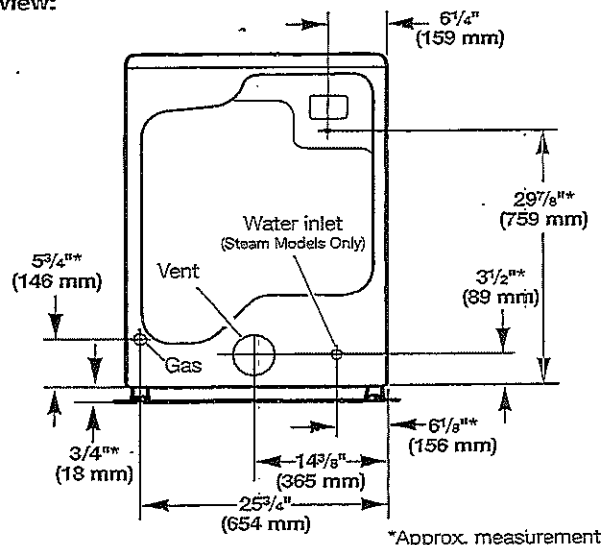

**NOTE:** Most installations require a minimum of 5" (127 mm) clearance behind dryer for exhaust vent with elbow. See "Venting Requirements."

#### Installation Clearances

For each arrangement, consider allowing more space for ease of installation and servicing, spacing for companion appliances, and clearances for walls, doors, and floor moldings. Space must be large enough to allow door to fully open. Add spacing on all sides of dryer to reduce noise transfer. If a closet door or louvered door is installed, top and bottom air openings in door are required.

Check code requirements. Some codes limit, or do not permit, installation of the dryer in garages, closets, mobile homes, or sleeping quarters. Contact your local building inspector.

**NOTE:** No other fuel-burning appliance can be installed in the same closet as a dryer.

#### Installation spacing for recessed area or closet installation

All dimensions show recommended and minimum spacing allowed.

- Additional spacing should be considered for ease of installation and servicing.
- Additional clearances might be required for wall, door, floor moldings, dryer venting, and gas line.
- Additional spacing should be considered on all sides of the dryer to reduce noise transfer.
- For closet installation with a door, minimum ventilation openings in the top and bottom of the door are required. Louvered doors with equivalent ventilation openings are acceptable.
- Companion appliance spacing should also be considered.

#### Recommended installation clearances (dryer only):

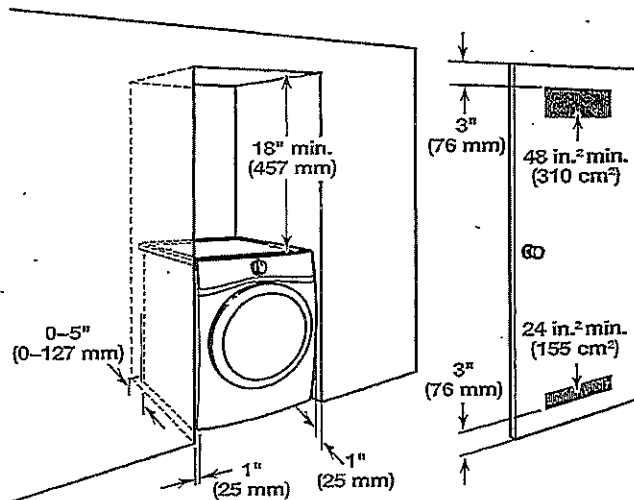

0" (0 mm) rear spacing is allowed for straight back venting only. For steam models only, inlet hose must not be kinked.

#### Custom under-counter installation:

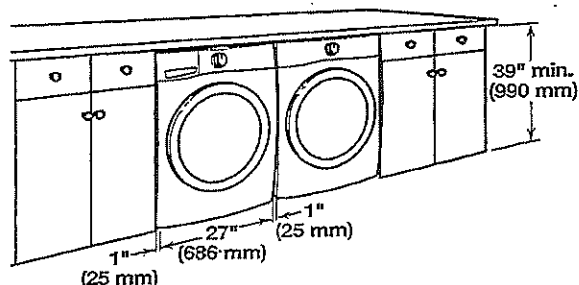

#### Mobile home - Additional installation requirements:

This dryer is suitable for mobile home installations. The installation must conform to the Manufactured Home Construction and Safety Standard, Title 24 CFR, Part 3280 (formerly the Federal Standard for Mobile home construction and Safety, Title 24, HUD Part 280) or Standard CAN/CSA-Z240 MH.

#### Mobile home installations require:

- Metal exhaust system hardware, available for purchase from your dealer. For further information, see "Assistance or Service" in your Use and Care Guide.
- Special provisions must be made in mobile homes to introduce outside air into dryer. Openings (such as a nearby window) should be at least twice as large as dryer exhaust opening.

#### For mobile home installation of gas dryers:

- Mobile Home Installation Hold-down Kit Part Number 346764 is available to order. For further information, see "Assistance or Service" in your Use and Care Guide.



C2 COUNTRY LAKE  
LOT 50-5  
20-2329 ELEVA  
THE ENGLEWOOD

42 OF 42

# WHIRLPOOL DRYER Model #: YWED5620HW

Additional parts may be required, depending on your installation. Check local codes. Check existing electrical supply and venting. Read "Electrical Requirements" and "Venting Requirements" before purchasing parts.

## If using a power supply cord:

Use a UL Listed power supply cord kit marked for use with clothes dryers. The kit should contain:

- A UL Listed 30 amp power supply cord, rated 120/240 volt minimum. The cord should be type SRD or SRDT and be at least 4 ft. (1.22 m) long. The wires that connect to the dryer must end in ring terminals or spade terminals with upturned ends.
- A UL Listed strain relief.

## Optional Equipment (not supplied with dryer):

Refer to your Use and Care Guide for information about accessories available for your dryer.

## LOCATION REQUIREMENTS

Check code requirements. Some codes limit, or do not permit, installing dryer in garages, closets, mobile homes, or sleeping quarters. Contact your local building inspector.

**⚠ WARNING**



**Explosion Hazard**

Keep flammable materials and vapors, such as gasoline, away from dryer.

Place dryer at least 18 inches (460 mm) above the floor for a garage installation.

Failure to do so can result in death, explosion, or fire.

### You will need:

- A location allowing for proper exhaust installation. See "Venting Requirements."
- A separate 15 or 20 amp circuit for a gas dryer or 30 amp circuit for an electric dryer.
- If using power supply cord, a grounded electrical outlet located within 2 ft. (610 mm) of either side of dryer. See "Electrical Requirements."
- Floor must support dryer weight of 200 lbs. (90.7 kg). Also consider weight of companion appliance.
- Cold water faucets located within 4 ft. (1.2 m) of the water fill valves, and water pressure of 20–120 psi (138–827 kPa). You may use your washer's water supply by purchasing the necessary parts noted in "Parts needed."
- Level floor with maximum slope of 1" (25 mm) under entire dryer. If slope is greater than 1" (25 mm), install Extended Dryer Feet Kit, Part Number 279810. If not level, clothes may not tumble properly and automatic sensor cycles may not operate correctly.
- For garage installation, place dryer at least 18" (460 mm) above floor. If using a pedestal, you will need 18" (460 mm) to bottom of dryer.
- The dryer must not be installed or stored in an area where it will be exposed to water and/or weather.

**IMPORTANT:** Do not operate, install, or store dryer where it will be exposed to water, weather, or at temperatures below 40°F (4°C). Lower temperatures may cause dryer not to shut off at end of automatic sensor cycles, resulting in longer drying times.

## DRYER DIMENSIONS

### Front view:

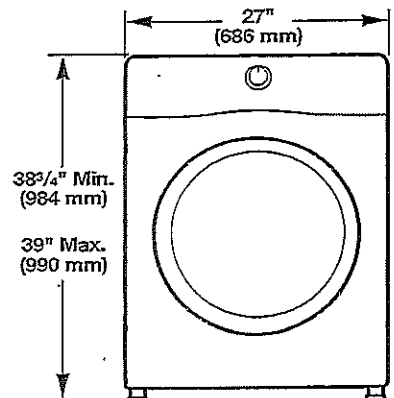

### Side view:

#### Whirlpool Models

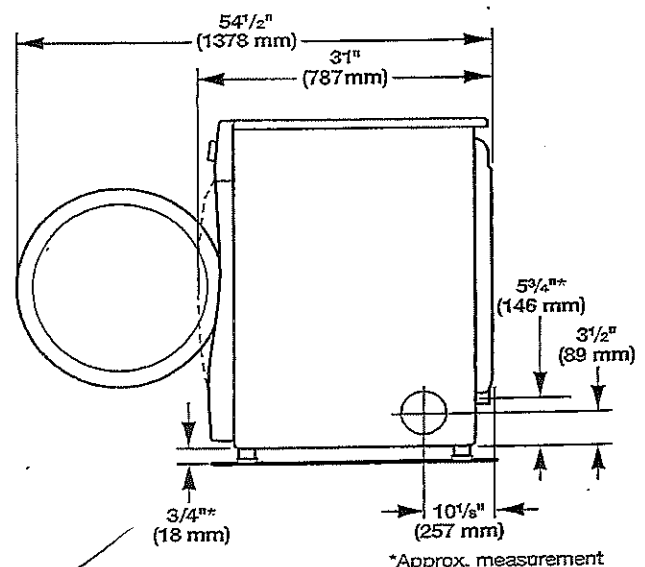

\*Approx. measurement

#### Maytag Models

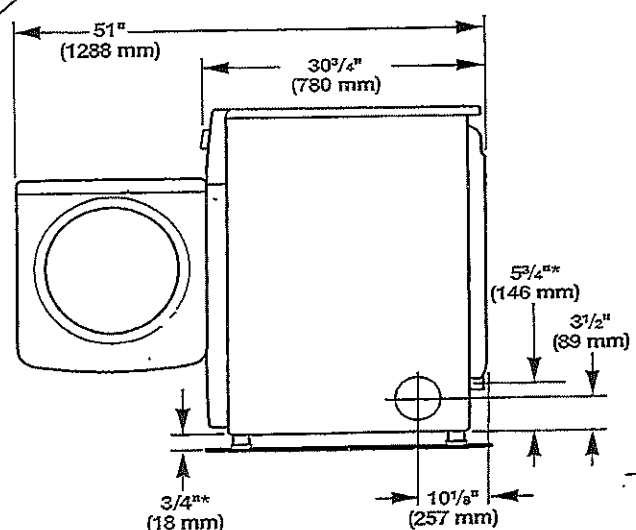

\*Approx. measurement

C.W. 