



07-Jul-21

Interior Finishing Selection Sheet

LOT	052-4	20-1895 ELEV A THE KELLERTON
PURCHASERS:	KEVIN ROMANO ALIE CALLISTA CHRISTINE SELVARAJAN	CONTACT NO: 289-200-2521 647-461-2326
VENDOR:	HEATHWOOD HOMES (WHITBY) LIMITED - PHASE 4	

Appliances

6-4 Kitchen HoodFan

Cabinetry

1-9167 Kitchen Cabinet Colour/Style

3-2086 Kitchen Cabinet Hardware

25-9166 Main Bathroom Cabinet Colour/Style

29-2076 Main Bathroom Cabinet Hardware

28-8826 Main Bathroom Countertop

20-9168 Master Ensuite Cabinet Colour/Style

22-7672 Master Ensuite Cabinet Hardware

21-8796 Master Ensuite Countertop

Carpet

52-1079 Throughout Underpad

Ceramics

16-9257 Foyer Flooring

17-2225 Foyer Grout

7-9257 Kitchen/Breakfast Flooring

8-2225 Kitchen/Breakfast Grout

348-9257 Laundry Mud Room Flooring

349-2225 Laundry Mud Room Grout

30-9257 Main Bathroom Flooring

31-2225 Main Bathroom Grout

112-9020 Main Bathroom Tub Wall Tile

UPG

☒ Whirlpool Over-The-Range Microwave Hood Combination
STAINLESS STEEL YWMH31017AS 30" PAGES 25-28

☐ CHARLESTON RAIN CLOUD Viking III STD 3DL

☐ HARDWARE 9677 STD

☐ CHARLESTON ORCHID Viking III STD 3DL

☐ HARDWARE 181 STD

☐ Countertop BLACK ALICANTE 4926K-07 Wilsonart

☐ CHARLESTON MOONLIGHT Viking III STD 3DL

☐ HARDWARE 135 STD

☐ Countertop PALOMA POLAR ETCHINGS FINISH 6698-46
Formica

☐ Underpad 500 Series STD

☐ CARRARA White / Grey GE.CR.WHIT.1313.MT STD 13 x 13

☐ Grout (27) Silver STD

☐ CARRARA White / Grey GE.CR.WHIT.1313.MT STD 13 x 13

☐ Grout (27) Silver STD

☐ CARRARA White / Grey GE.CR.WHIT.1313.MT STD 13 x 13

☐ Grout (27) Silver STD

☐ CARRARA White / Grey GE.CR.WHIT.1313.MT STD 13 x 13

☐ Grout (27) Silver STD

☐ Weave White QT.WV.WHT.0810 STD 8 x 10 INSTALL
STACKED HORIZONTALLY

1. The Purchaser acknowledges these selections are subject to the terms and conditions of the applicable Agreement of Purchase and Sale.
2. The Purchaser acknowledges that the Vendor accepts no responsibility in the event the Vendor is unable to supply a selection. The Purchaser agrees to reselect from the currently available selections immediately upon request.
3. The Vendor reserves the right to substitute above materials and equipment with that of equal or better quality.
4. Purchaser acknowledges that items may not be exactly as shown. Variations from the Vendor's samples may occur in finished materials due to normal production processes. Vendor is not responsible for shade difference which may occur from different dye lots or wood grains. Variations from the Vendor's samples will occur with natural materials such as wood, marble, granite, hardwood and brick.
5. The Vendor reserves the right to select Grout & Thresholds that best suits the Tile selected.
6. Selections will not be processed unless signed by Heathwood Homes Head Office.
7. The colour selections made on the Colour Chart are final and cannot be changed once submitted.
8. The Purchaser has checked and acknowledges the accuracy of this Colour Chart.

July 7th 2021

Date

K. Romano

Purchaser

July 7/21
APPROVED

Date

Décor Consultant

July 7th 2021

Date

K. Romano

Purchaser

-07- 12 2021

Date Approved

HEATHWOOD HOMES (WHITBY)
LIMITED - PHASE 4



07-Jul-21

Interior Finishing Selection Sheet

LOT 052-4

20-1895 ELEV A THE KELLERTON

PURCHASERS: KEVIN ROMANO ALIE
CALLISTA CHRISTINE SELVARAJAN

CONTACT NO: 289-200-2521
647-461-2326

VENDOR: HEATHWOOD HOMES (WHITBY) LIMITED - PHASE 4

Ceramics

113-2226 Main Bathroom Tub Wall Tile Grout
23-9257 Master Ensuite Floor Tile
24-2225 Master Ensuite Floor Tile Grout
73-8666 Master Ensuite Shower Floor Tile
74-2226 Master Ensuite Shower Floor Tile Grout
147-8923 Master Ensuite Shower Jamb(s) and Sill(s)
104-9020 Master Ensuite Shower Wall Tile
105-2226 Master Ensuite Shower Wall Tile Grout
32-9257 Powder Room Flooring
33-2225 Powder Room Grout
53-2232 Throughout Thresholds

Electrical

90-5796 Throughout Switches and Plug

Fireplace

136-9114 Great Room Fireplace Mantle
135-8865 Great Room Fireplace Type

Granite

2-9069 Kitchen Countertop

Hardwood

37-7502 Bedroom 2 Flooring
38-7502 Bedroom 3 Flooring
14-7502 Family Room Flooring

UPG

- ☐ Grout (00) White STD
- ☐ CARRARA White / Grey GE.CR.WHIT.1313.MT STD 13 x 13
- ☐ Grout (27) Silver STD
- ☒ Ontario Series Mosaic Dark Grey OD.ON.DGR.0202.MT.N UPG 1 2 x 2
- ☐ Grout (00) White STD
- ☐ Shower Jamb / Sill Thassos White STD
- ☐ Weave White QT.WV.WHT.0810 STD 8 x 10 INSTALL STACKED HORIZONTALLY
- ☐ Grout (00) White STD
- ☐ CARRARA White / Grey GE.CR.WHIT.1313.MT STD 13 x 13
- ☐ Grout (27) Silver STD
- ☐ Metal Thresholds STD
- ☐ Decora White Switches and Plugs STD
- ☐ Paint Grade Mantel- Cabinet (Per Plan) WHITE NF 15 STD
- ☐ Dimplex FP3033HL Electric Fireplace
- ☐ MSI Quartz ICED WHITE Group 1 STD 3/4"
- ☒ Vintage Northern Solid Sawn Engineered Select V : Red Oak Pearl PEWTER Red Oak Pearl 3/4" x 3 1/4"
- ☒ Vintage Northern Solid Sawn Engineered Select V : Red Oak Pearl PEWTER Red Oak Pearl 3/4" x 3 1/4"
- ☒ Vintage Northern Solid Sawn Engineered Select V : Red Oak Pearl PEWTER Red Oak Pearl 3/4" x 3 1/4"

- The Purchaser acknowledges these selections are subject to the terms and conditions of the applicable Agreement of Purchase and Sale.
- The Purchaser acknowledges that the Vendor accepts no responsibility in the event the Vendor is unable to supply a selection. The Purchaser agrees to reselect from the currently available selections immediately upon request.
- The Vendor reserves the right to substitute above materials and equipment with that of equal or better quality.
- Purchaser acknowledges that items may not be exactly as shown. Variations from the Vendor's samples may occur in finished materials due to normal production processes. Vendor is not responsible for shade difference which may occur from different dye lots or wood grains. Variations from the Vendor's samples will occur with natural materials such as wood, marble, granite, hardwood and brick.
- The Vendor reserves the right to select Grout & Thresholds that best suits the Tile selected.
- Selections will not be processed unless signed by Heathwood Homes Head Office.
- The colour selections made on the Colour Chart are final and cannot be changed once submitted.
- The Purchaser has checked and acknowledges the accuracy of this Colour Chart.

July 7th 2021

Date

Purchaser

July 7th, 2021

Date

Purchaser

July 7/21

Date

Decor Consultant

07-12-2021

Date Approved HEATHWOOD HOMES (WHITBY) LIMITED - PHASE 4



07-Jul-21

Interior Finishing Selection Sheet

LOT 052-4

20-1895 ELEV A THE KELLERTON

PURCHASERS: KEVIN ROMANO ALIE
CALLISTA CHRISTINE SELVARAJAN

CONTACT NO: 289-200-2521
647-461-2326

VENDOR: HEATHWOOD HOMES (WHITBY) LIMITED - PHASE 4

Hardwood

11-7502 Great Room Flooring

367-7502 Lower Level Hall Flooring

98-7502 Main Hall Flooring

36-7502 Master Bedroom Flooring

78-7502 Stair Landing to Lower Level Flooring

77-7502 Stair Landing to Upper Level Flooring

35-7502 Upper Hall Flooring

Interior Railings

49-8148 Stairs to Lower Level Handrail/Pickets/Posts Type

43-8148 Stairs to Upper Level Handrail/Pickets/Posts Type

Interior Stairs

45-1712 Stairs to Lower Level Type

39-1712 Stairs to Upper Level Type

Interior Trim

91-9374 Throughout Trim Size

Painting

46-7761 Stairs to Lower Level Colour

40-7761 Stairs to Upper Level Colour

240-1716 Throughout Trim - Paint Colour

UPG

- ☐ Vintage Northern Solid Sawn Engineered Select V : Red Oak Pearl PEWTER Red Oak Pearl 3/4" x 3 1/4"
- ☒ Vintage Northern Solid Sawn Engineered Select V : Red Oak Pearl PEWTER Red Oak Pearl 3/4" x 3 1/4"
- ☐ Vintage Northern Solid Sawn Engineered Select V : Red Oak Pearl PEWTER Red Oak Pearl 3/4" x 3 1/4"
- ☒ Vintage Northern Solid Sawn Engineered Select V : Red Oak Pearl PEWTER Red Oak Pearl 3/4" x 3 1/4"
- ☐ Vintage Northern Solid Sawn Engineered Select V : Red Oak Pearl PEWTER Red Oak Pearl 3/4" x 3 1/4"
- ☐ Vintage Northern Solid Sawn Engineered Select V : Red Oak Pearl PEWTER Red Oak Pearl 3/4" x 3 1/4"
- ☐ Vintage Northern Solid Sawn Engineered Select V : Red Oak Pearl PEWTER Red Oak Pearl 3/4" x 3 1/4"
- ☐ Single Collar Alt. Plain w/ Shoes with 3 1/2" Square/Cap Post(s) BLACK METAL STD
- ☐ Single Collar Alt. Plain w/ Shoes with 3 1/2" Square/Cap Post(s) BLACK METAL STD
- ☐ Oak Stairs UPG_1
- ☐ Oak Stairs UPG_1
- ☐ 4 1/4" Baseboards and 2 3/4" Integrated Backbend Casings STD-Towns
- ☐ Stain handrail, stringers, treads, risers, nosing & posts. (Metal pickets) STAIRS TO BE STAINED TO COMPLIMENT PEWTER HARDWOOD. STAIRS WILL VARY FROM FLOORS
- ☐ Stain handrail, stringers, treads, risers, nosing & posts. (Metal pickets) STAIR TO BE STAINED TO COMPLIMENT PEWTER HARDWOOD. STAIRS WILL VARY FROM FLOORS
- ☐ Trim WHITE STD

- The Purchaser acknowledges these selections are subject to the terms and conditions of the applicable Agreement of Purchase and Sale.
- The Purchaser acknowledges that the Vendor accepts no responsibility in the event the Vendor is unable to supply a selection. The Purchaser agrees to reselect from the currently available selections immediately upon request.
- The Vendor reserves the right to substitute above materials and equipment with that of equal or better quality.
- Purchaser acknowledges that items may not be exactly as shown. Variations from the Vendor's samples may occur in finished materials due to normal production processes. Vendor is not responsible for shade difference which may occur from different dye lots or wood grains. Variations from the Vendor's samples will occur with natural materials such as wood, marble, granite, hardwood and brick.
- The Vendor reserves the right to select Grout & Thresholds that best suits the Tile selected.
- Selections will not be processed unless signed by Heathwood Homes Head Office.
- The colour selections made on the Colour Chart are final and cannot be changed once submitted.
- The Purchaser has checked and acknowledges the accuracy of this Colour Chart.

July 7th 2021

Date

Ka Alie

Purchaser

July 12 2021

Date

Décor Consultant

July 7th, 2021

Date

Purchaser

Date Approved

HEATHWOOD HOMES (WHITBY)
LIMITED - PHASE 4



12 of 11
Interior Finishing Selection Sheet

07-Jul-21

LOT	052-4	20-1895 ELEV A THE KELLERTON
PURCHASERS: KEVIN ROMANO ALIE CALLISTA CHRISTINE SELVARAJAN		CONTACT NO: 289-200-2521 647-461-2326
VENDOR: HEATHWOOD HOMES (WHITBY) LIMITED - PHASE 4		

Painting

51-1717 Throughout Walls - Paint Colour

Plumbing

266-1737 Main Bathroom Plumbing Fixture (Colour)

149-1737 Master Ensuite Plumbing Fixture (colour)

34-1737 Powder Room Plumbing Fixture (Colour)

UPG

☐ Wall WARM GREY 22 STD

☐ Plumbing Fixtures WHITE STD

☐ Plumbing Fixtures WHITE STD

☐ Plumbing Fixtures WHITE STD

1. The Purchaser acknowledges these selections are subject to the terms and conditions of the applicable Agreement of Purchase and Sale.
2. The Purchaser acknowledges that the Vendor accepts no responsibility in the event the Vendor is unable to supply a selection. The Purchaser agrees to reselect from the currently available selections immediately upon request.
3. The Vendor reserves the right to substitute above materials and equipment with that of equal or better quality.
4. Purchaser acknowledges that items may not be exactly as shown. Variations from the Vendor's samples may occur in finished materials due to normal production processes. Vendor is not responsible for shade difference which may occur from different dye lots or wood grains. Variations from the Vendor's samples will occur with natural materials such as wood, marble, granite, hardwood and brick.
5. The Vendor reserves the right to select Grout & Thresholds that best suits the Tile selected.
6. Selections will not be processed unless signed by Heathwood Homes Head Office.
7. The colour selections made on the Colour Chart are final and cannot be changed once submitted.
8. The Purchaser has checked and acknowledges the accuracy of this Colour Chart.

July 7th 2021

Date

Callista

Purchaser

July 7/21
APPROVED

Date

-07- 12 2021

Décor Consultant

Mr. Rosen

July 7th, 2021

Date

Callista

Purchaser

Date Approved HEATHWOOD HOMES (WHITBY)
LIMITED - PHASE 4



07-Jul-21

Sales Selection Sheet

3 of 4

LOT 052-4

20-1895 ELEV A THE KELLERTON

PURCHASERS: KEVIN ROMANO ALIE

CONTACT NO: 289-200-2521

CALLISTA CHRISTINE SELVARAJAN

647-461-2326

VENDOR: HEATHWOOD HOMES (WHITBY) LIMITED - PHASE 4

HST #

It is herein understood and agreed between the undersigned parties hereto that the following changes shall be made to the above mentioned Agreement of Purchase and Sale in accordance with the agreement and except for such changes noted below, all other terms and conditions in the Agreement of Purchase and Sale shall remain as stated herein: It is further understood that and agreed that all changes and additions shall be installed as per builder's specifications, location and available selections. The Purchaser hereby agrees to purchase the following extras:

Appliances

2173 WHIRLPOOL OTR SS KITCHEN Qty: 1
YWMH31017HZ PAGES 25-28

Cabinetry

1260 Optional Extras KITCHEN Qty: 1
11A- Upper angle corner per unit Viking
SKETCH #7 PAGE 17

Ceramics

1703 M. Ensuite Shower Floor Qty: 1
Upgrade 1 Tile

Electrical

344 Optional Extras KITCHEN Qty: 1
Ceiling rough-in (Capped) Upg 1 Before June 1, 2021
TO BE CENTERED ON ISLAND OVER THE EXTENDED BREAKFAST BAR. SEE SKETCH
7 PAGE 17 FOR LOCATION

Fireplace

81 Qty: 1
Purchasers have been advised: heat from the FP can damage TV above a FP and items placed on mantle. Purchasers acknowledge: Heathwood Homes and its contractors will not be liable for any damage on items placed/installed above a FP after closing

Hardwood

1. This Sales Selection Sheet when properly executed forms part of our Agreement of Purchase and Sale.
2. All extras and upgrades listed above are subject to Construction Progress and Architectural and Municipal requirements.
3. In the event the Vendor is unable to incorporate the work approved above in the construction of the house for any reason whatsoever, the Vendor will not be liable to the Purchaser in any way. The monies paid for any changes or optional extras not proceeded with shall be returned to the Purchaser, without interest. The cost of options or extras is non-refundable in all other circumstances. If for any reason whatsoever the Agreement of Purchase and Sale is not completed, the total cost of work approved above will be retained by the Vendor.
4. The Vendor reserves the right to substitute above materials and equipment with that of equal or better quality.
5. Purchaser acknowledges that items may not be exactly as shown. Variations from the Vendor's samples may occur in finished materials due to normal production processes. Vendor is not responsible for shade difference which may occur from different dye lots or wood grains. Variations from the Vendor's samples will occur with natural materials such as wood, marble, granite, hardwood and brick.
6. The Vendor reserves the right to select Grout & Thresholds that best suits the Tile selected.
7. Selections will not be processed unless signed by Heathwood Homes Head Office.
8. The selections made on this schedule are final and cannot be changed once submitted.
9. The Purchaser has checked and acknowledges the accuracy of this schedule.

July 7th 2021
Date Purchaser

July 7/21
Date Decor Consultant

July 7th, 2021
Date Purchaser

APPROVED
-07- 12 2021
Date Approved HEATHWOOD HOMES (WHITBY)
LIMITED - PHASE 4



07-Jul-21

Sales Selection Sheet OF 4

LOT 052-4

20-1895 ELEV A THE KELLERTON

PURCHASERS: KEVIN ROMANO ALIE

CONTACT NO: 289-200-2521

CALLISTA CHRISTINE SELVARAJAN

647-461-2326

VENDOR: HEATHWOOD HOMES (WHITBY) LIMITED - PHASE 4

HST #

It is herein understood and agreed between the undersigned parties hereto that the following changes shall be made to the above mentioned Agreement of Purchase and Sale in accordance with the agreement and except for such changes noted below, all other terms and conditions in the Agreement of Purchase and Sale shall remain as stated herein: It is further understood that and agreed that all changes and additions shall be installed as per builder's specifications, location and available selections. The Purchaser hereby agrees to purchase the following extras:

994	Vintage 3-1/4" Red Oak Select-V	B/2	Qty: 1
995	Vintage 3-1/4" Red Oak Select-V	B/3	Qty: 1
992	Vintage 3-1/4" Red Oak Select-V	FAMILY	Qty: 1
993	Vintage 3-1/4" Red Oak Select-V	M/B	Qty: 1

Plumbing

278	STANDARD Kitchen Sink Option KINDRED Kitchen Sink Collection - Reginox NS1930U/9 Stainless Kitchen Single Bowl Undermount Sink (or equivalent)	KITCHEN	Qty: 1
-----	---	---------	--------

PAGE 20

1. This Sales Selection Sheet when properly executed forms part of our Agreement of Purchase and Sale.
2. All extras and upgrades listed above are subject to Construction Progress and Architectural and Municipal requirements.
3. In the event the Vendor is unable to incorporate the work approved above in the construction of the house for any reason whatsoever, the Vendor will not be liable to the Purchaser in any way. The monies paid for any changes or optional extras not proceeded with shall be returned to the Purchaser, without interest. The cost of options or extras is non-refundable in all other circumstances. If for any reason whatsoever the Agreement of Purchase and Sale is not completed, the total cost of work approved above will be retained by the Vendor.
4. The Vendor reserves the right to substitute above materials and equipment with that of equal or better quality.
5. Purchaser acknowledges that items may not be exactly as shown. Variations from the Vendor's samples may occur in finished materials due to normal production processes. Vendor is not responsible for shade difference which may occur from different dye lots or wood grains. Variations from the Vendor's samples will occur with natural materials such as wood, marble, granite, hardwood and brick.
6. The Vendor reserves the right to select Grout & Thresholds that best suits the Tile selected.
7. Selections will not be processed unless signed by Heathwood Homes Head Office.
8. The selections made on this schedule are final and cannot be changed once submitted.
9. The Purchaser has checked and acknowledges the accuracy of this schedule.

July 7th 2021

Date

Kim Lito

Purchaser

July 7/21

Date APPROVED

Décor Consultant

July 7th 2021

Date

Purchaser

-07- 12 2021

Date Approved HEATHWOOD HOMES (WHITBY)
LIMITED - PHASE 4

C2-COUNTRY LANE
LOT 52-4
20-1895 ELEV A
THE KELLERTON

15 of 41

The Kellerton

ELEVATION A: 1,895 SQUARE
FEET

20-1895 ELEV. A

Sketch #5

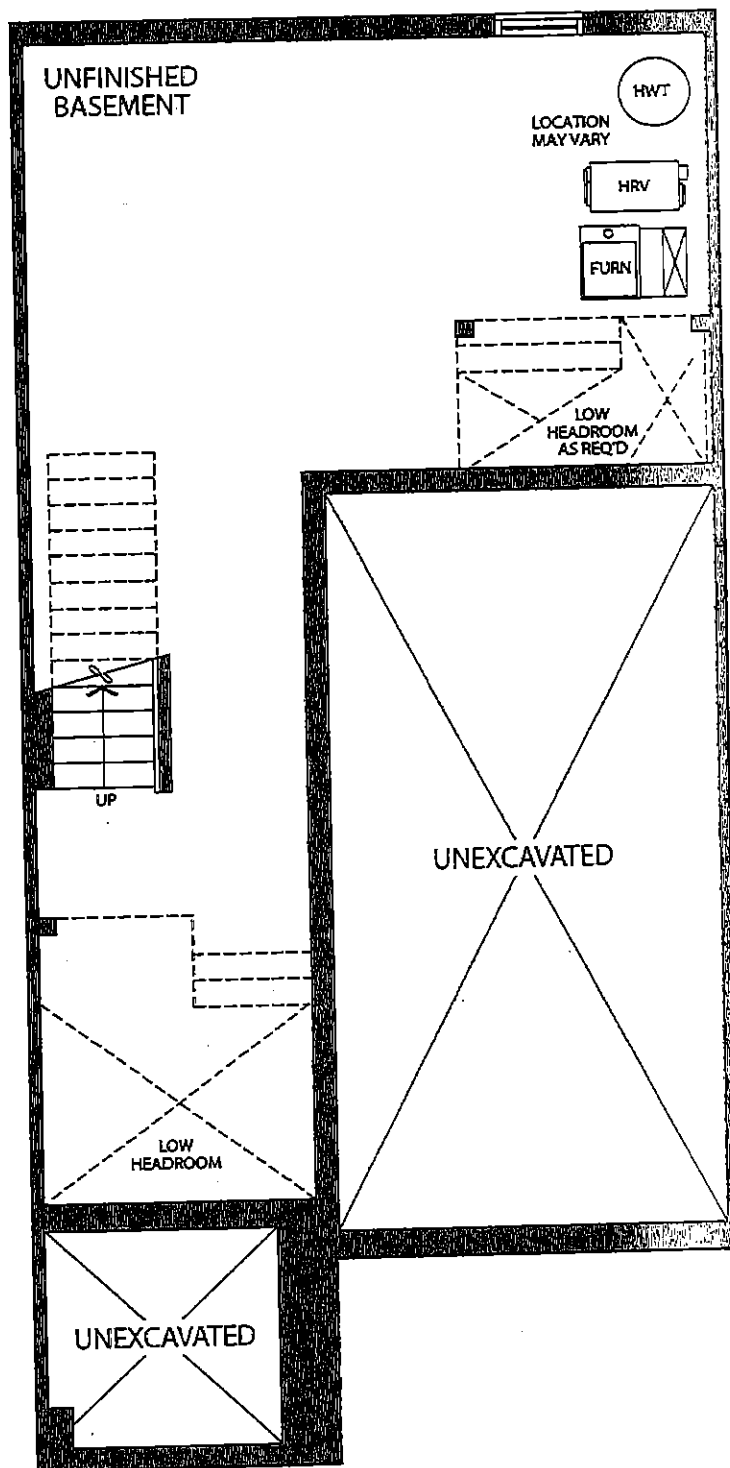

BASEMENT
ELEVATION A

CS Kell

C2-COUNTRY LANE
LOT 52-4
20-1895 ELEV A
THE KELLERTON

16 of 41

The Kellerton

20-1895 ELEV. A

Sketch #6

ELEVATION A: 1,895 SQUARE
FEET

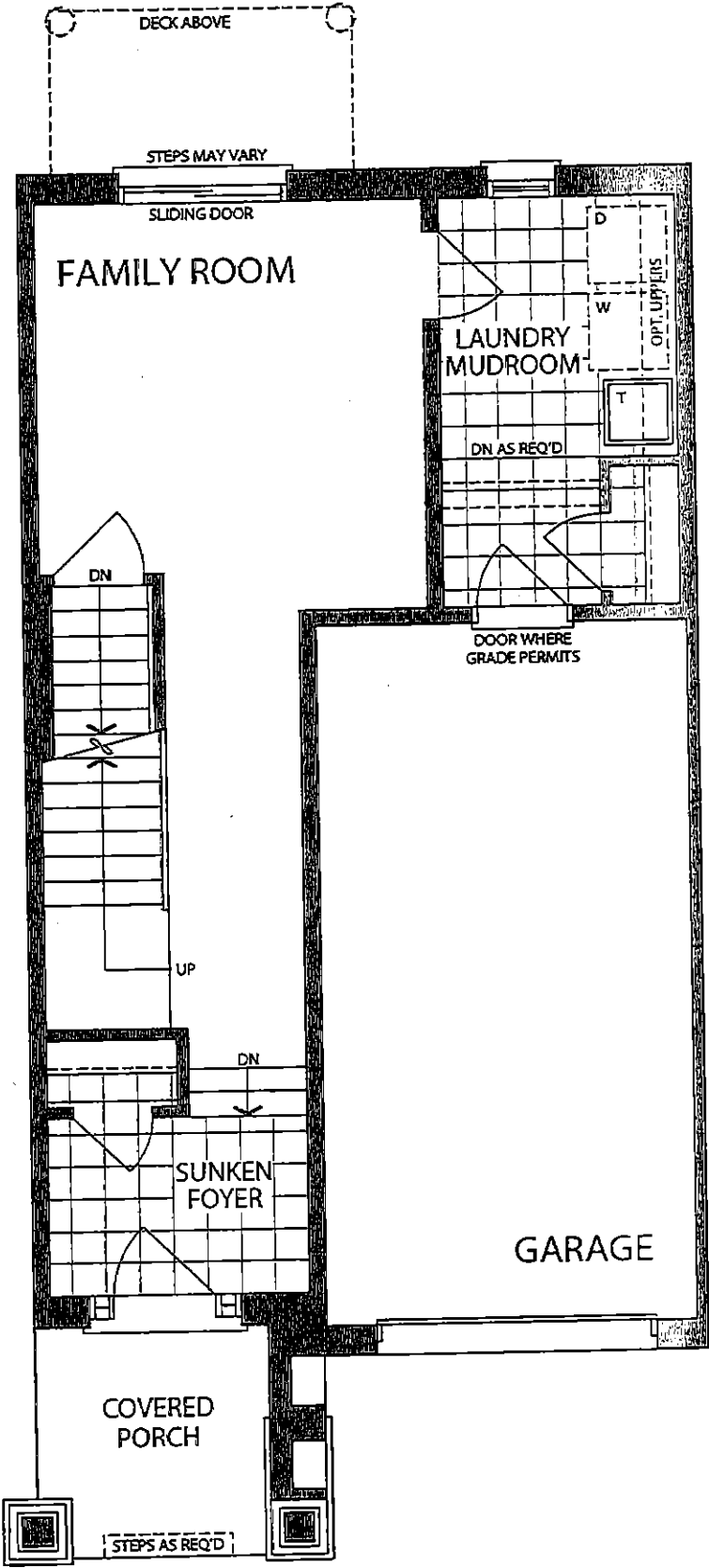

LOWER LEVEL
ELEVATION A.

CS/Kat

C2-COUNTRY LANE
LOT 52-4
20-1895 ELEV A
THE KELLERTON

17 of 41
The Kellerton

20-1895 ELEV. A

ELEVATION A: 1,895 SQUARE
FEET

Sketch #7

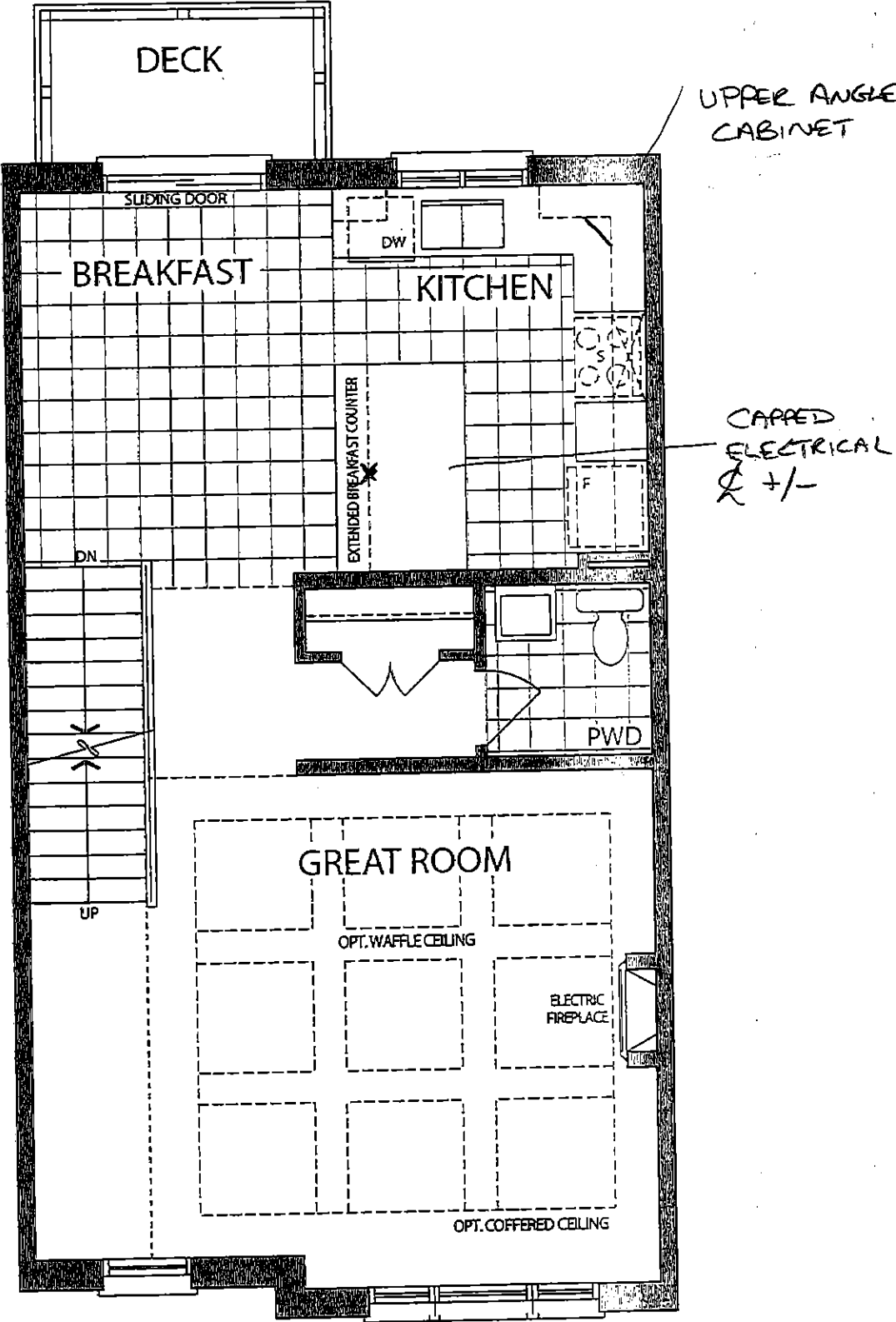

MAIN LEVEL
ELEVATION A

CS/HA

C2-COUNTRY LANE
LOT 52-4
20-1895 ELEV A
THE KELLERTON

18 of 41
The Kellerton

20-1895 ELEV. A

ELEVATION A: 1,895 SQUARE
FEET

Sketch #8

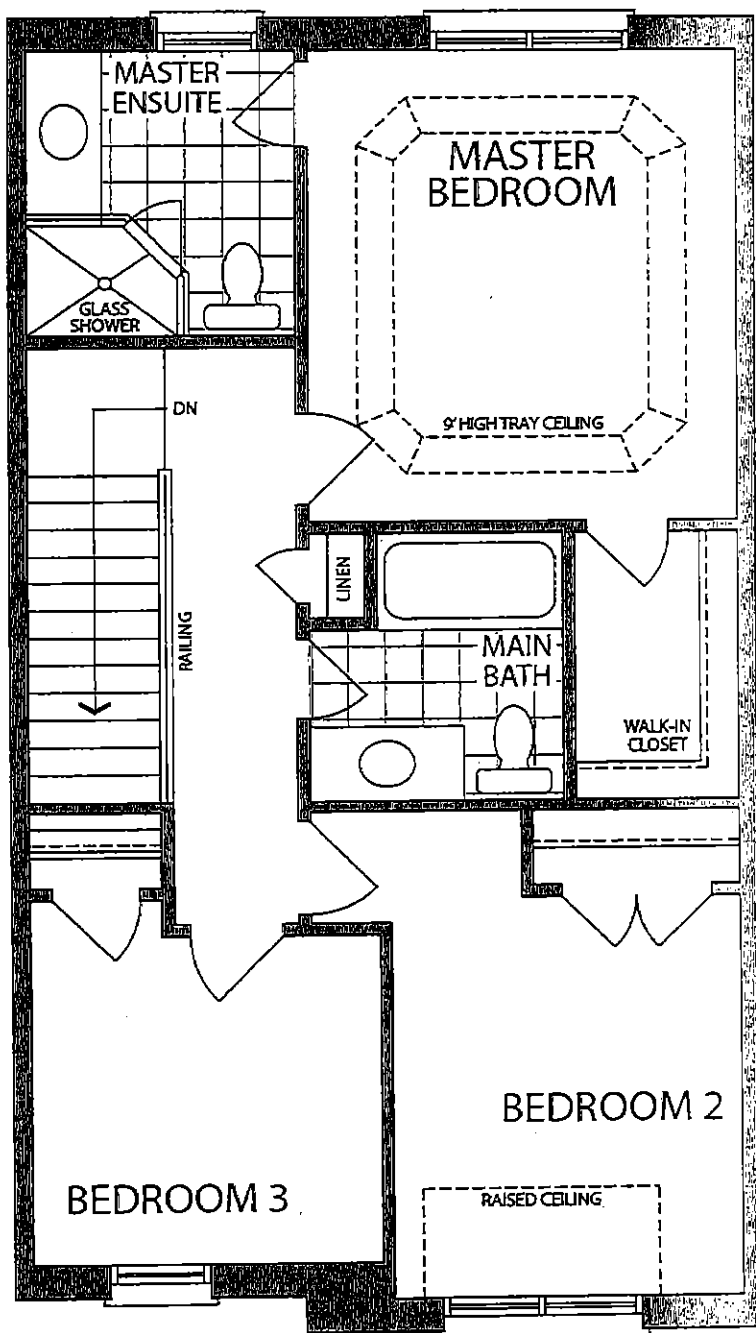

UPPER LEVEL
ELEVATION A

C.S.I. / *[Signature]*

C2-COUNTRY LANE
LOT 52-4
20-1895 ELEV A
THE KELLERTON

19 of 41

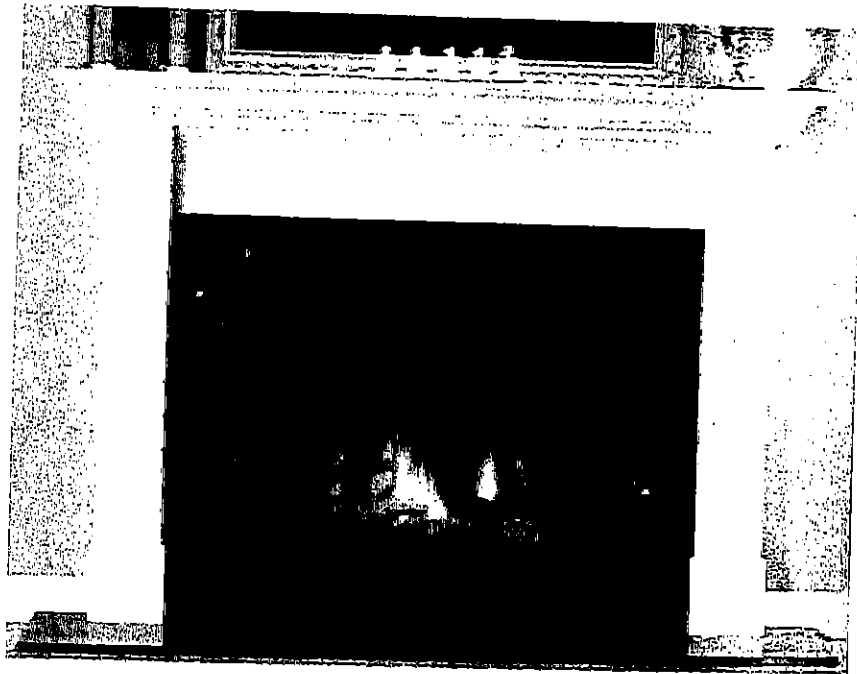

'CABINET'

NFAS NF15 Mantel

CS/KJ

C2-COUNTRY LANE
LOT 52-4
20-1895 ELEV A
THE KELLERTON

20 of 41.

Stainless Steel | 122.0264.716
FAMILY : Sinks | SERIES : Reginox | MODEL : NS1930U/9 | FINISH : Stainless Steel | INSTALLATION TYPE : Undermount

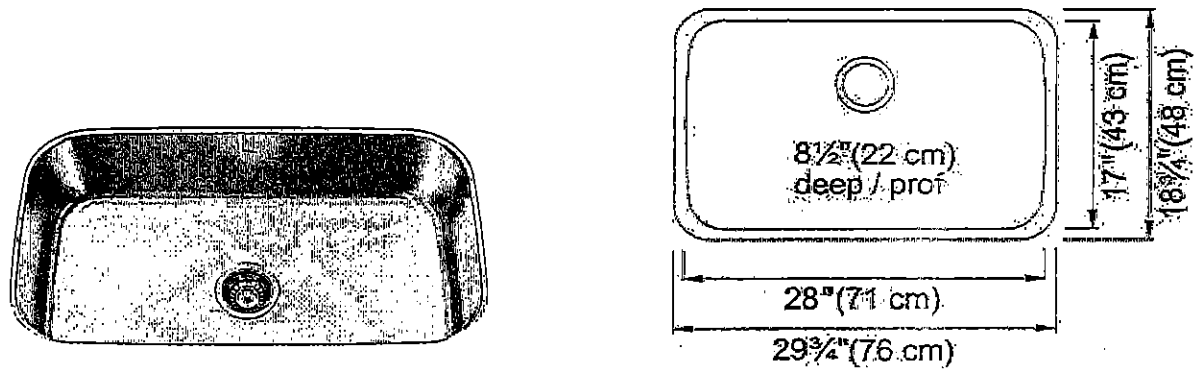

TECHNICAL DATA	
Width overall	18 3/4"
Length overall	29 3/4"
Width of large bowl	17"
Length of large bowl	28"
Depth of large bowl	8 1/2"
Cabinet Size	36"
Number of Bowls	1
Waste Outlet Diameter	3 1/2"
Cut-Out Template	Yes
Faucet Hole	None
Type of Material	18 Gauge Stainless Steel
Surface Finish	SILK
Special feature	Rear Drain Waste Hole Location
Waste Kit Included	YES

CS/ JKF

C2-COUNTRY LANE
LOT 52-4
20-1895 ELEV A
THE KELLERTON

21 of 41

STANDARD KITCHEN FAUCET

Align

Modern

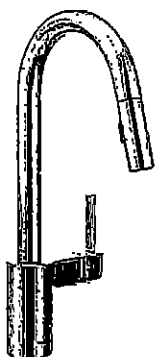

Single Handle Pull-Down Kitchen
Faucet*

Model 7565†

C.S./K.A.

C2-COUNTRY LANE
LOT 52-4
20-1895 ELEV A
THE KELLERTON

22 of 41

*American
Standard*

BOULEVARD®
PEDESTAL SINK
VITREOUS CHINA

BOULEVARD® PEDESTAL SINK

- ☐ 0641.800 Faucet holes on 8" (203mm) centers (Illustrated).
- * ☐ 0641.400 Faucet holes on 4" (102mm) centers
- ☐ 0641.100 Center hole only
 - Classic styled rectangular pedestal lavatory
 - Vitreous china
 - Rear overflow
 - Supplied with mounting kit
 - Right Height® for greater comfort during use
 - Faucet ledge with large deck area (faucet not included)
 - **Design coordinates with Boulevard® Toilet**
 - Basin has flat bottom to also allow use as an above counter sink or a drop-in sink (with u-shaped cut out)

Nominal Dimensions:

24" x 19" x 35-1/2"
(610 x 483 x 902mm)

- ☐ 0641.008 Pedestal top-8" (203mm) centers
- ☐ 0641.004 Pedestal top-4" (102mm) centers
- ☐ 0641.001 Pedestal top-center hole only
- ☐ 0010.000 Pedestal only

Bowl sizes:

17" (432mm) wide,
12-1/2" (318mm) front to back,
5" (127mm) deep

Compliance Certifications -

Meets or Exceeds the Following Specifications:

- ASME A112.19.2 - 2008/CSA B45.1-08

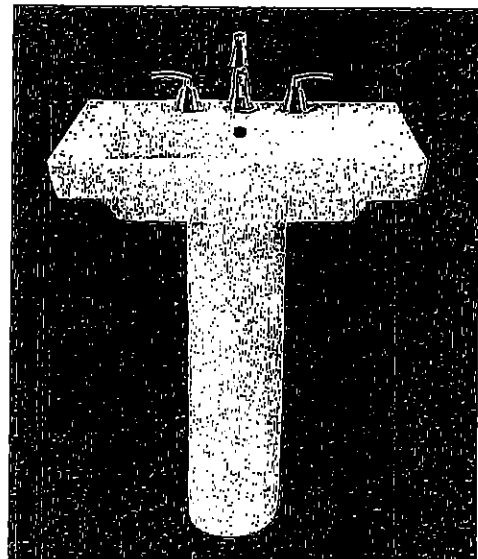

SEE REVERSE FOR ROUGHING-IN DIMENSIONS

To Be Specified:

- ☐ Color: ☐ White ☐ Linen
- ☐ Faucet Finish:
- ☐ Supplies:
- ☐ 1-1/4" Trap:
- ☐ Nipple:

* See faucet section for additional models available

CS/Kaf

C2-COUNTRY LANE
 LOT 52-4
 20-1895 ELEV A
 THE KELLERTON

23 of 41 COLONY™
 COUNTERTOP SINK
 VITREOUS CHINA

COLONY COUNTERTOP SINK

- Vitreous china
- Self-rimming
- Front overflow
- Supplied with template
- Faucet deck
- (Faucet shown not included)

- ☒ 0346 803
 Faucet holes on 203mm (8") centres
- ☐ 0346 403 (Illustrated)
 Faucet holes on 102mm (4") centres
- ☐ 0346 001
 Centre hole only

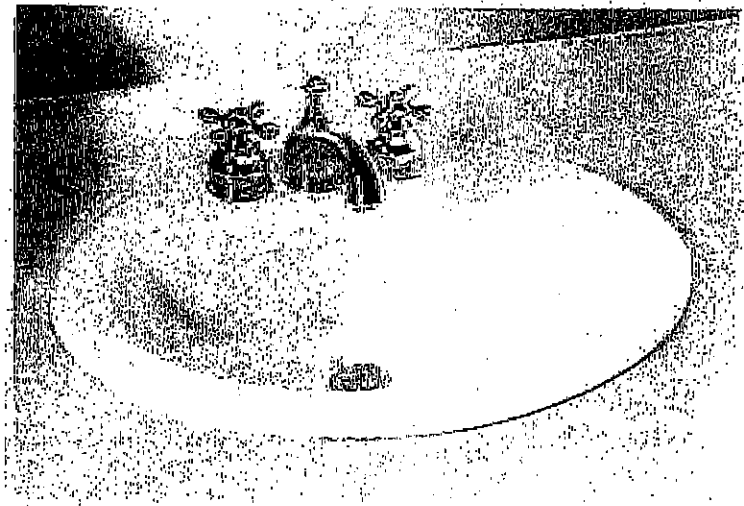

Nominal Dimensions:
 521 x 448mm (20-1/2" x 17-5/8")

Bowl sizes:
 422mm (16-5/8") wide, 279mm (11") front to back, 143mm (5-5/8") deep

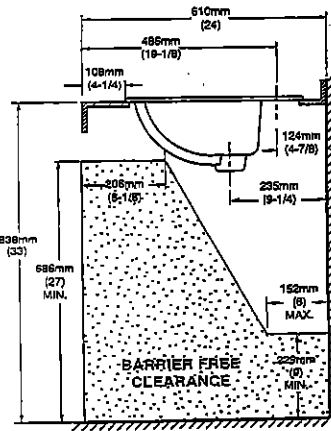
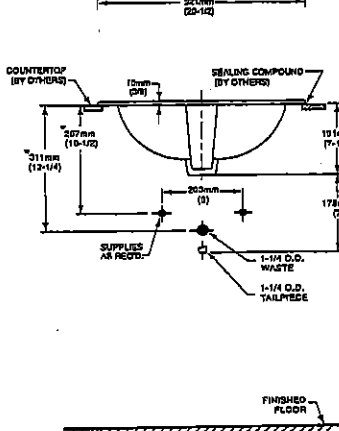
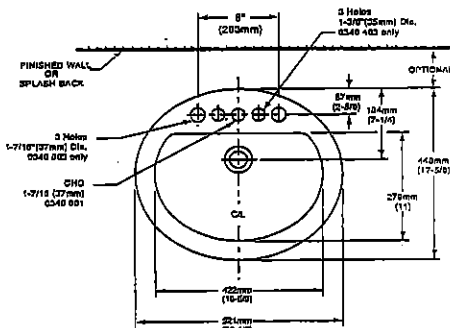

COMPLIANCE CERTIFICATIONS –
 Meets or exceeds the following Specifications:
 • ASME A112.19.2M for Vitreous China Fixtures.
 • CAN/CSA B45 Series.

- To Be Specified
- ☐ Colour: ☒ White ☐ Bone ☐ Silver Gray ☐ Linen
 - ☐ Faucet*:
 - ☐ Faucet Finish:
 - ☐ Supplies & Stops:
 - ☐ Trap 1-1/4" (32 mm):

NOTES:
 * DIMENSIONS SHOWN FOR LOCATION OF SUPPLIES AND "P" TRAP ARE SUGGESTED. FOR COUNTERTOP CUTOUT AND INSTALLATION INSTRUCTIONS USE TEMPLATE SUPPLIED WITH SINK.
 FAUCETS NOT INCLUDED AND MUST BE ORDERED SEPARATELY.
 IMPORTANT: Dimensions of fixtures are nominal and may vary within the range of tolerances established by ANSI Standard A112.19.2.
 These measurements are subject to change or cancellation. No responsibility is assumed for use of superseded or voided pages.

* See faucet section for additional models available

C.S. / J.A.

C2-COUNTRY LANE
LOT 52-4
20-1895 ELEV A
THE KELLERTON

24 of 41

Chateau

Transitional

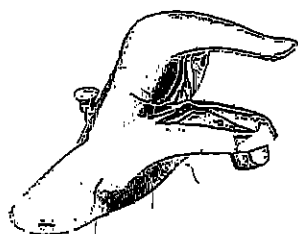

Lavatory Faucet with Pop-Up Drain
Model L4621†

VANITY SINKS AND PEDESTAL

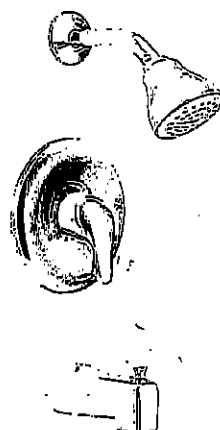

Posi-Temp® Pressure Balancing Tub/Shower
Model 62320 / TL183†

OR

Posi-Temp Valve and Tub/Shower Trim
with Eco-Performance Easy Clean® XL

Model 62320 / TL183EP†

[TL183EP not available in BC]

SHOWER AND TUB FAUCETS



2 Handle Roman Tub with 9" Spout
Model 4796 / T990†

FREESTANDING TUB FAUCETS

CS/KF

C2-COUNTRY LANE
LOT 52-4
20-1895 ELEV A
THE KELLERTON

25 of 41

WMH31017H
OVER-THE-RANGE MICROWAVE

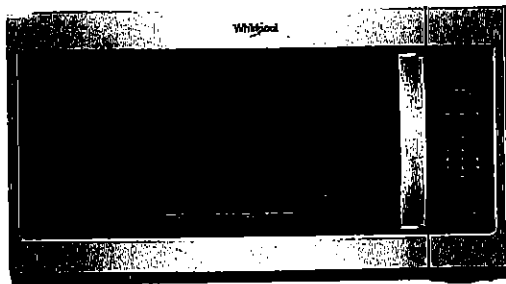

DISHWASHER-SAFE TURNTABLE PLATE

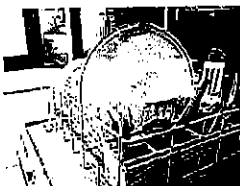

Clean up spills on the turntable by simply putting it in the dishwasher.

2-SPEED, 800 CFM MOTOR CAPABILITY



Match the right amount of ventilation to the dish being prepared and quickly get rid of cooking odors with two different fan speed settings.

MICROWAVE PRESETS



Get just the right amount of heat and time, whether you're cooking or defrosting, with specific preset options.

OTHER FEATURES

- Add 30 seconds option
- Electronic touch controls
- Adjustable cooktop lighting



White
(W)



Black
(B)

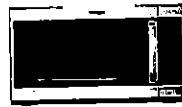

Fingerprint Resistant
Stainless Steel (Z)



Silver
(S)

MODEL	WMH31017HW	WMH31017HE	WMH31017HS	WMH31017HS
Max height (in)	17-1/8"	17-1/8"	17-1/8"	17-1/8"
Width (in)	29-15/16"	29-15/16"	29-15/16"	29-15/16"
Depth (in)	15-9/16"	15-9/16"	15-9/16"	15-9/16"

Whirlpool®

CS/K

C2-COUNTRY LANE
LOT 52-4
20-1895 ELEV A
THE KELLERTON

26 of 41

Whirlpool® MICROWAVE HOOD INSTALLATION INSTRUCTIONS

PRODUCT MODEL NUMBERS

WMH31017H

LOCATION REQUIREMENTS

Installation Dimensions

NOTE: The grounded 3 prong outlet must be inside the upper cabinet.
See the "Electrical Requirements" section.

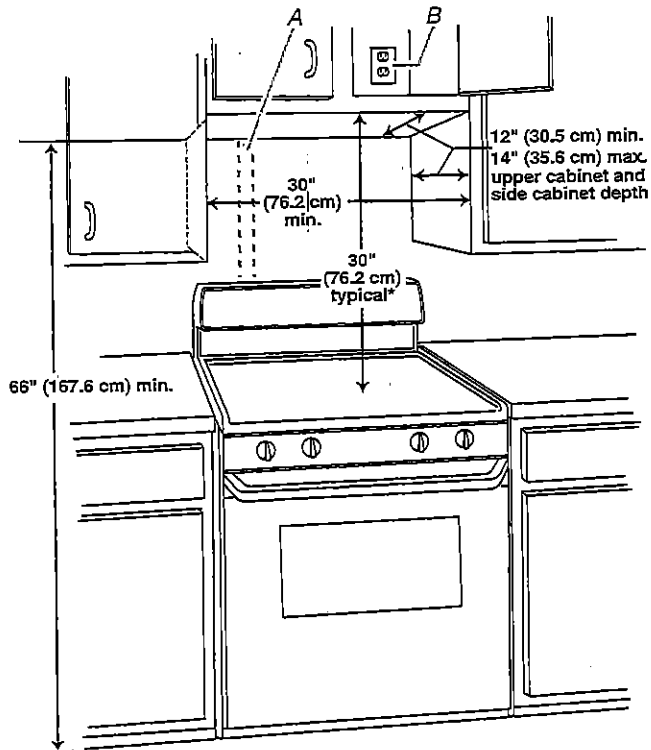

A. 2" x 4" wall stud
B. Grounded 3 prong outlet

*30" (76.2 cm) is typical for 66" (167.6 cm) installation height. Exact dimensions may vary depending on type of range/cooktop below.

PRODUCT DIMENSIONS

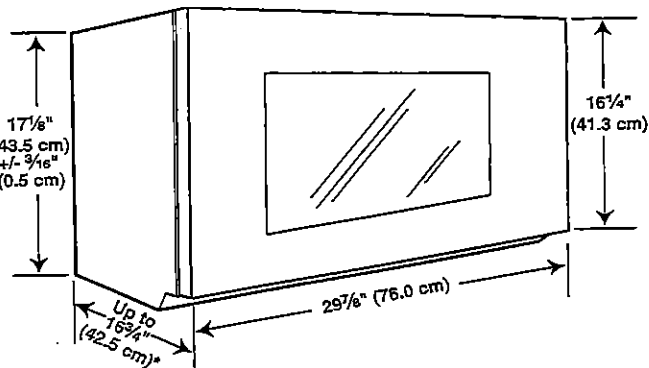

*Overall depth of product will vary slightly depending on door design.

PRODUCT DIMENSIONS

ELECTRICAL REQUIREMENTS

⚠ WARNING



Electrical Shock Hazard

Plug into a grounded 3 prong outlet.

Do not remove ground prong.

Do not use an adapter.

Do not use an extension cord.

Failure to follow these instructions can result in death, fire, or electrical shock.

Observe all governing codes and ordinances.

Required:

- A 120-volt, 60 Hz, AC-only, 15- or 20-amp electrical supply with a fuse or circuit breaker

Recommended:

- A time-delay fuse or time-delay circuit breaker
- A separate circuit serving only this microwave oven

Because Whirlpool Corporation includes a continuous commitment to improve our products, we reserve the right to change materials and specifications without notice.

Dimensions are for planning purposes only. For complete details, see Installation Instructions packed with product. Specifications subject to change without notice.

col/KD

C2-COUNTRY LANE
LOT 52-4
20-1895 ELEV A
THE KELLERTON

27 of 41

VENTING DESIGN SPECIFICATIONS

This section is intended for architectural designer and builder/ contractor reference only.

NOTES:

- Vent materials needed for installation are not provided with microwave hood combination.
- We do not recommend using a flexible metal vent.
- To avoid possible product damage, be sure to vent air outside, unless using recirculation installation. Do not vent exhaust air into concealed spaces, such as spaces within walls or ceilings, attics, crawl spaces, or garages.

For optimal venting installation, we recommend:

- Using roof or wall caps that have back draft dampers
 - Using a rigid metal vent
 - Using the most direct route by minimizing the length of the vent and number of elbows to provide efficient performance
 - Using uniformly sized vents
 - Using duct tape to seal all joints in the vent system
 - Using caulking compound to seal exterior wall or roof opening around cap
 - Not installing 2 elbows together for optimal hood performance
- If venting through the wall, be sure that there is proper clearance within the wall for the damper to open fully.

If venting through the roof, and rectangular-to-round transition is used, be sure there are at least 3" (7.6 cm) of clearance between the top of the microwave oven and the transition piece. See "Rectangular-to-Round Transition" illustration.

Rectangular-to-Round Transition

NOTE: The minimum 3" (7.6 cm) clearance must exist between the top of the microwave oven and the rectangular to round transition piece so that the damper can open freely and fully.

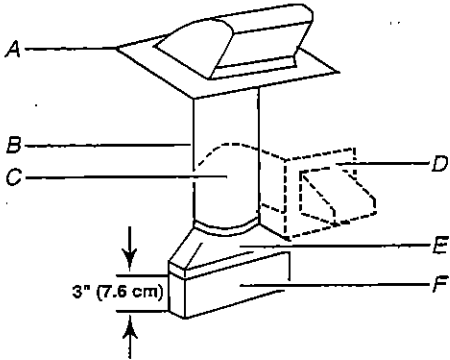

- A. Roof cap
- B. 6" (15.2 cm) min. diameter round vent
- C. Elbow (for wall venting only)
- D. Wall cap
- E. 3 1/4" x 10" to 6" (8.3 x 25.4 cm to 15.2 cm) rectangular to round transition piece
- F. Vent extension piece, at least 3" (7.6 cm) high

Recommended Standard Fittings

The following length equivalents are for use when figuring vent length. See the examples in "Recommended Vent Length."

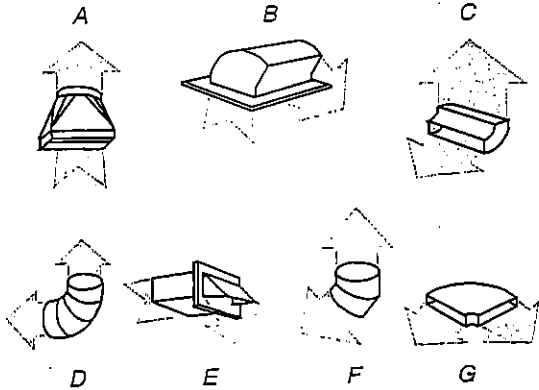
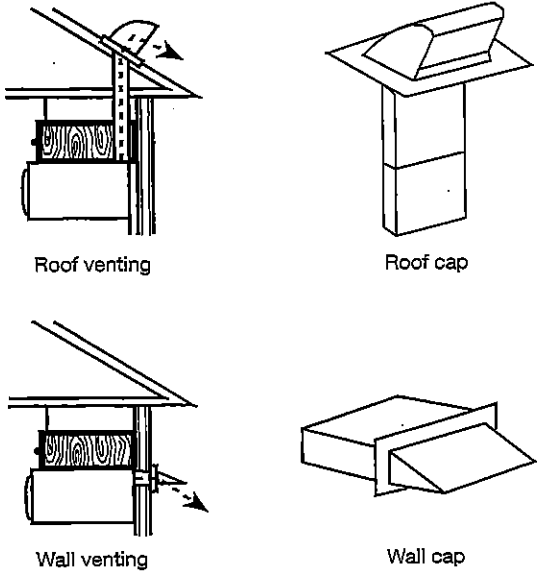

- A. Rectangular-to-round transition piece: 3 1/4" x 10" to 6" = 5 ft (8.3 x 25.4 cm to 15.2 cm = 1.5 m)
- B. Roof cap: 3 1/4" x 10" = 24 ft (8.3 x 25.4 cm = 7.3 m)
- C. 90° elbow: 3 1/4" x 10" = 25 ft (8.3 x 25.4 cm = 7.6 m)
- D. 90° elbow: 6" = 10 ft (15.2 cm = 3 m)
- E. Wall cap: 3 1/4" x 10" = 40 ft (8.3 x 25.4 cm = 12.2 m)
- F. 45° elbow: 6" = 5 ft (15.2 cm = 1.5 m)
- G. 90° flat elbow: 3 1/4" x 10" = 10 ft (8.3 x 25.4 cm = 3 m)

C-51/K-1

**C2-COUNTRY LANE
LOT 52-4
20-1895 ELEV A
THE KELLERTON**

28 of 41

Recommended Vent Length

A 3 1/4" x 10" (8.3 x 25.4 cm) rectangular or 6" (15.2 cm) round vent should be used.

The total length of the vent system including straight vent, elbow(s), transitions, and wall or roof caps must not exceed the equivalent of 140 ft (42.7 m) for either type of vent. See the "Recommended Standard Fittings" section for equivalent lengths.

For best performance, use no more than three 90° elbows.

To calculate the length of the system you need, add the equivalent lengths of each vent piece used in the system.

See the following examples:

3 1/4" x 10" (8.3 x 25.4 cm) vent system = 73 ft (22.2 m) total

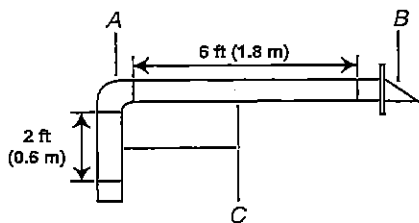

- A. One 3 1/4" x 10" (8.3 x 25.4 cm) 90° elbow = 25 ft (7.6 m)
- B. 1 wall cap = 40 ft (12.2 m)
- C. 2 ft (0.6 m) + 6 ft (1.8 m) straight = 8 ft (2.4 m)

6" (15.2 cm) vent system = 73 ft (22.2 m) total

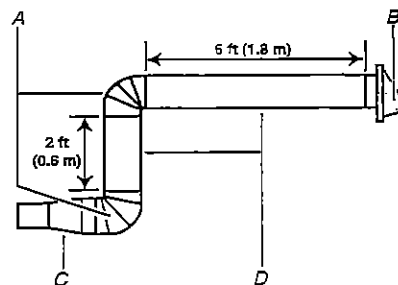

- A. Two 90° elbows = 20 ft (6.1 m)
- B. 1 wall cap = 40 ft (12.2 m)
- C. 1 rectangular-to-round transition piece = 5 ft (1.5 m)
- D. 2 ft (0.6 m) + 6 ft (1.8 m) straight = 8 ft (2.4 m)

If the existing vent is round, a rectangular-to-round transition piece must be used. In addition, a rectangular 3" (7.6 cm) extension vent between the damper assembly and rectangular-to-round transition piece must be installed to keep the damper from sticking.

CS/Ked

C2-COUNTRY LANE
LOT 52-4
20-1895 ELEV A
THE KELLERTON

29 of 41

Whirlpool® Bottom Mount Refrigerator

PRODUCT MODEL NUMBERS

WRF532SMB
WRF535SMB

WRF535SWB
WRF540CWB

Electrical: A 115-volt, 60-Hz, AC-only, 15- or 20-amp fused, grounded electrical supply is required. It is recommended that a separate circuit serving only your refrigerator be provided. Use an outlet that cannot be turned off by a switch. Do not use an extension cord.

NOTE: Before performing any type of installation, cleaning, or removing a light bulb, turn the control (Thermostat, Refrigerator or Freezer Control depending on the model) to OFF and then disconnect the refrigerator from the electrical source. When you are finished, reconnect the refrigerator to the electrical source and reset the control (Thermostat, Refrigerator or Freezer Control depending on the model) to the desired setting. See "Using the Controls."

Water: A cold water supply with water pressure between 30 and 120 psi (207 and 827 kPa) is required to operate the ice maker and water dispenser. If you have questions about your water pressure, call a licensed, qualified plumber.

IMPORTANT: The pressure of the water coming out of a reverse osmosis system going to the water inlet valve of the refrigerator needs to be between 35 and 120 psi (241 and 827 kPa).

Reverse Osmosis Water Supply: If a reverse osmosis water filtration system is connected to your cold water supply, the water pressure to the reverse osmosis system needs to be a minimum of 40 to 60 psi (276 to 414 kPa).

PRODUCT DIMENSIONS

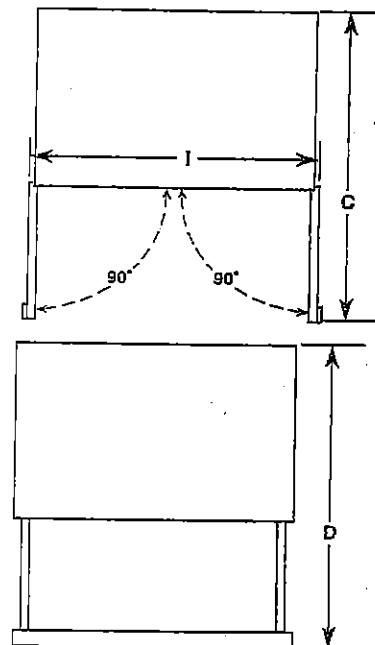
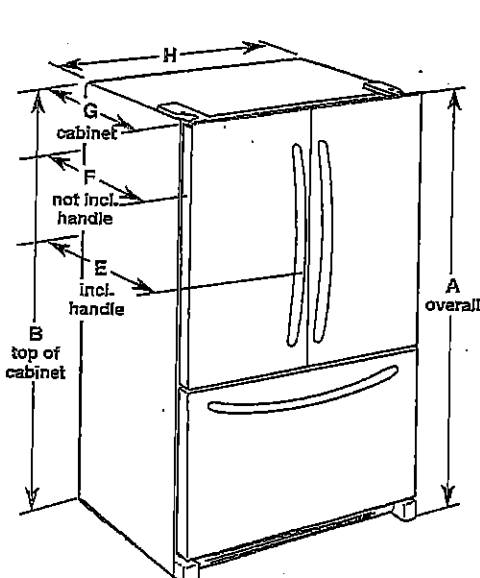

Model Number/Size	Height - Overall "A"	Height - Top of Cabinet "B"	Depth - Doors Open 90° "C"	Depth - Drawer Open "D"	Depth - With Handles "E"	Depth - Without Handles "F"	Depth - Cabinet Only "G"	Width - Cabinet "H"	Width - Door Open 90° "I"
WRF535SWB 25.2 cu. ft.	70 $\frac{1}{8}$ " (178.1 cm)	68 $\frac{1}{8}$ " (174.8 cm)	48 $\frac{1}{8}$ " (122.1 cm)	53 $\frac{1}{8}$ " (135 cm)	35 $\frac{1}{8}$ " (90 cm)	32 $\frac{1}{8}$ " (83.7 cm)	29 $\frac{1}{8}$ " (74 cm)	35 $\frac{1}{8}$ " (90.5 cm)	43 $\frac{1}{8}$ " (110.2 cm)
WRF535SMB 25.2 cu. ft.	70 $\frac{1}{8}$ " (178.1 cm)	68 $\frac{1}{8}$ " (174.8 cm)	48 $\frac{1}{8}$ " (122.1 cm)	53 $\frac{1}{8}$ " (135 cm)	35 $\frac{1}{8}$ " (90 cm)	32 $\frac{1}{8}$ " (83.7 cm)	29 $\frac{1}{8}$ " (74 cm)	35 $\frac{1}{8}$ " (90.5 cm)	43 $\frac{1}{8}$ " (110.2 cm)
WRF532SMB 22.1 cu. ft.	70 $\frac{1}{8}$ " (178.1 cm)	68 $\frac{1}{8}$ " (174.8 cm)	47 $\frac{1}{8}$ " (119.5 cm)	52 $\frac{1}{8}$ " (132.4 cm)	34 $\frac{1}{8}$ " (87.5 cm)	31 $\frac{1}{8}$ " (81.1 cm)	28 $\frac{1}{8}$ " (71.4 cm)	32 $\frac{1}{8}$ " (82.9 cm)	42 $\frac{1}{8}$ " (107.6 cm)
WRF540CWB 20 cu. ft.	70 $\frac{1}{8}$ " (178.1 cm)	68 $\frac{1}{8}$ " (174.8 cm)	48" (121.9 cm)	44 $\frac{1}{8}$ " (113.0 cm)	29 $\frac{1}{8}$ " (74.6 cm)	28" (71.1 cm)	24 $\frac{1}{8}$ " (61.3 cm)	35 $\frac{1}{8}$ " (90.5 cm)	39 $\frac{1}{8}$ " (100.0 cm)

LOCATION REQUIREMENTS

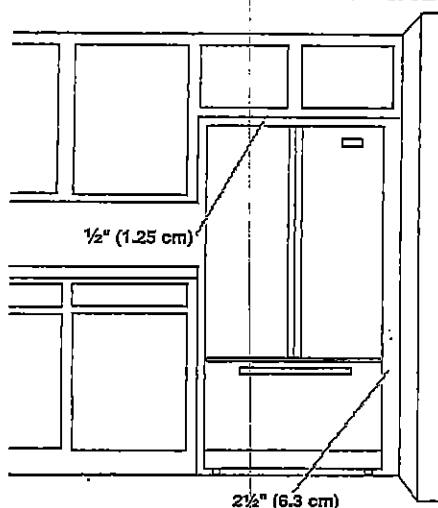

To ensure proper ventilation for your refrigerator, allow for a $\frac{1}{2}$ " (1.25 cm) space on each side and at the top. Allow for 1" (2.54 cm) of space behind the refrigerator. If your refrigerator has an ice maker, make sure you leave some extra space at the back for the water line connections.

If you are installing your refrigerator next to a fixed wall, leave $2\frac{1}{2}$ " (6.3 cm) minimum on the hinge side (some models require more) to allow for the door to swing open.

NOTE: This refrigerator is intended for use in a location where the temperature ranges from a minimum of 55°F (13°C) to a maximum of 110°F (43°C). The preferred room temperature range for optimum performance, which reduces electricity usage and provides superior cooling, is between 60°F (15°C) and 90°F (32°C). It is recommended that you do not install the refrigerator near a heat source, such as an oven or radiator.

Because Whirlpool Corporation policy includes a continuous commitment to improve our products, we reserve the right to change materials and specifications without notice.

Dimensions are for planning purposes only. For complete details, see Installation Instructions packed with product. Specifications subject to change without notice.

Ref. W10597594B
10/1/14

C. J. K.

C2-COUNTRY LANE
LOT 52-4
20-1895 ELEV A
THE KELLERTON

30 of 41

WHIRLPOOL 30" (76.0 CM) FREESTANDING ELECTRIC RANGES
Model YWFE515S0JS

5.3 cu. ft. Whirlpool® electric range with Frozen
Bake™ technology

YWFE515S0JS

Whirlpool®

Home > Kitchen Appliances > Cooking Appliances > Ranges > Single Oven Ranges > YWFE515S0JS

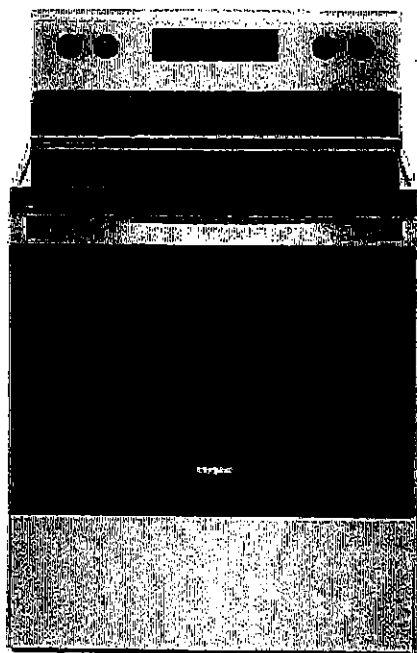

12



C.S./Kest

C2-COUNTRY LANE
LOT 52-4
20-1895 ELEV A
THE KELLERTON

31-41

WHIRLPOOL 30" (76.0 CM) FREESTANDING ELECTRIC RANGES
Model YWFE515S0JS

Product Dimensions

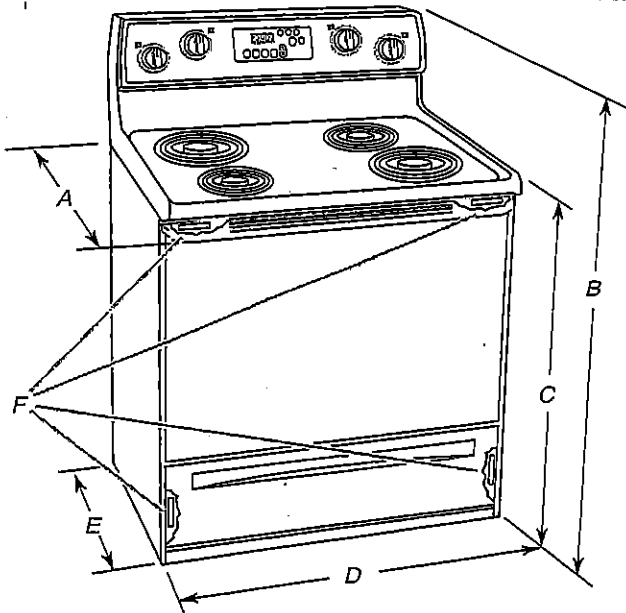

- A. 27³/₄" (70.5 cm) max. depth with handle
- B. 46⁷/₈" (119.1 cm) overall height (max.) with leveling legs screwed all the way in*
- C. 36" (91.4 cm) cooktop height (max.) with leveling legs screwed all the way in*
- D. 29⁷/₈" (75.9 cm) width
- E. 25⁵/₁₆" (64.3 cm) depth - back of range to front of cooktop**
- F. Model/serial/rating plate (located on the frame behind a top corner of the door or either side of the drawer)

IMPORTANT: Range must be level after installation. Follow the instructions in the "Level Range" section. Using the cooktop as a reference for leveling the range is not recommended.

*Range can be raised approximately 1" (2.5 cm) by adjusting the leveling legs.

**Front of door and drawer may extend further forward depending on styling.

Cabinet Dimensions

Cabinet opening dimensions shown are for 25" (64.0 cm) countertop depth, 24" (61.0 cm) base cabinet depth and 36" (91.4 cm) countertop height.

IMPORTANT: If installing a range hood or microwave hood combination above the cooking surface, follow the range hood or microwave hood combination installation instructions for dimensional clearances above the cooktop surface.

A freestanding range may be installed next to combustible walls with zero clearance.

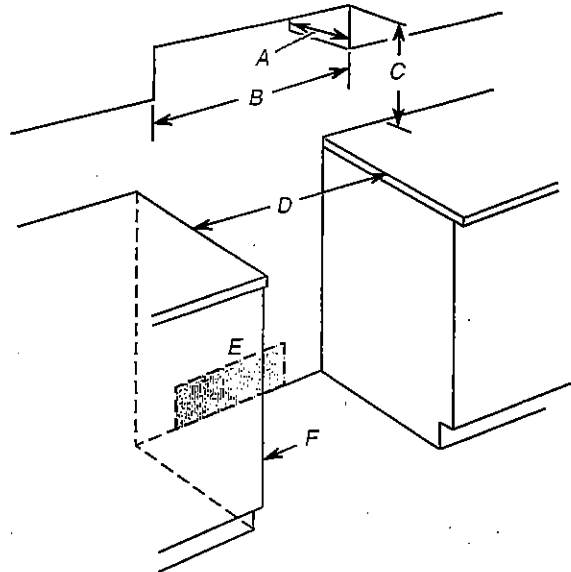

- A. 13" (33.0 cm) max. upper cabinet depth
- B. 30" (76.2 cm) min. opening width
- C. For minimum clearance to top of cooktop, see NOTE*
- D. 30" (76.2 cm) min. opening width
- E. Outlet - 8" (20.3 cm) to 22" (55.9 cm) from either cabinet, 7" (17.8 cm) max. from floor.
- F. Cabinet door or hinges should not extend into the cutout.

***NOTE:** 24" (61.0 cm) minimum when bottom of wood or metal cabinet is covered by not less than 1/4" (6.4 mm) flame retardant millboard covered with not less than No. 28 MSG sheet steel, 0.015" (0.4 mm) stainless steel, 0.024" (0.6 mm) aluminum or 0.020" (0.5 mm) copper.

30" (76.2 cm) minimum clearance between the top of the cooking platform and the bottom of an uncovered wood or metal cabinet.

C. J. H. A.

JAN 28/20

C2-COUNTRY LANE
LOT 52-4
20-1895 ELEV A
THE KELLERTON

32 of 41

WHIRLPOOL 30" (76.0 CM) FREESTANDING ELECTRIC RANGES
Model YWFE515S0JS

Install Anti-Tip Bracket

WARNING



Tip Over Hazard

A child or adult can tip the range and be killed.

Install anti-tip bracket to floor or wall per installation instructions.

Slide range back so rear range foot is engaged in the slot of the anti-tip bracket.

Re-engage anti-tip bracket if range is moved.

Do not operate range without anti-tip bracket installed and engaged.

Failure to follow these instructions can result in death or serious burns to children and adults.

1. Remove the anti-tip bracket from where it is taped inside the storage drawer or warming drawer.
2. Determine which mounting method to use: floor or wall.
If you have a stone or masonry floor, you can use the wall mounting method. If you are installing the range in a mobile home, you must secure the range to the floor.
3. Determine and mark centerline of the cutout space. The mounting can be installed on either the left-side or right-side of the cutout. Position mounting bracket against the wall in the cutout so that the V-notch of the bracket is $12\frac{9}{16}$ " (31.9 cm) from centerline as shown.

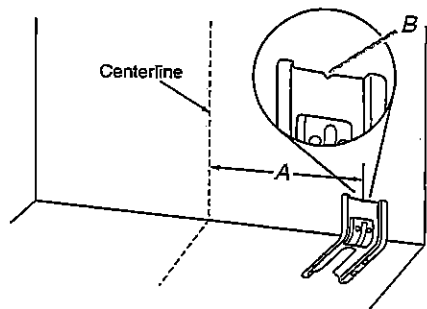

A. $12\frac{9}{16}$ " (31.9 cm)
B. Bracket V-notch

4. Drill two $\frac{1}{8}$ " (3 mm) holes that correspond to the bracket holes of the determined mounting method. See the following illustrations.

Floor Mounting

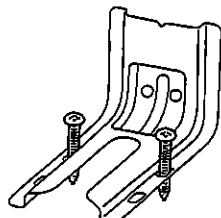

Rear position

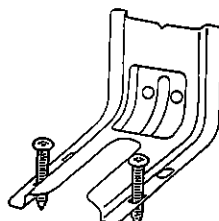

Front position

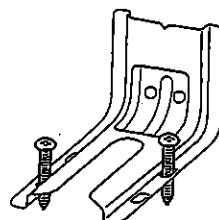

Diagonal (2 options)

Wall Mounting

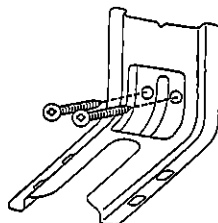

5. Using the Phillips screwdriver, mount anti-tip bracket to the wall or floor with the two #12 x $1\frac{5}{8}$ " (4.1 cm) screws provided.
6. Move range close enough to opening to allow for final electrical connections. Remove shipping base, cardboard or hardboard from under range.
7. Move range into its final location, making sure rear leveling leg slides into anti-tip bracket.
8. Move range forward onto shipping base, cardboard or hardboard to continue installing the range using the following installation instructions.

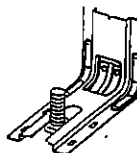

C. J. K. K.

C2-COUNTRY LANE
LOT 52-4
20-1895 ELEV A
THE KELLERTON

33 of 41

Whirlpool® Dishwasher with ENERGY STAR® qualification



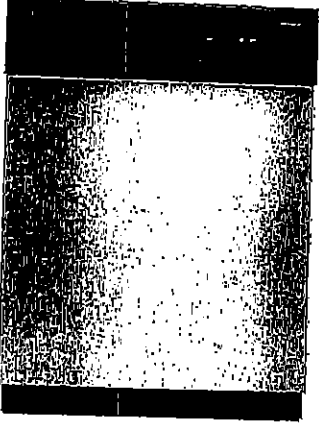



WDF310PAAS
Black-on-Stainless

OTHER AVAILABLE COLORS

**Black**
Model: WDF310PAAB

**Biscuit-on-Biscuit**
Model: WDF310PAAT

**White**
Model: WDF310PAAW

**Universal Silver**
Model: WDF310PAAD



DIMENSIONS		KEY FEATURES:
Maximum Height	34 1/2 Inches	ENERGY STAR® Qualified
Minimum Height	33 1/2 Inches	No One Has Fewer Repairs 17 Years In A Row
Height	34 1/2 Inches	Resource - Efficient Wash System
Depth	24 1/2 Inches	CEE Tier 1 qualified
Width	23 7/8 Inches	Tall Tub Design
Dimensions shown are for planning purposes only. For complete information, see Installation Instructions packaged with product.		White Plastic Interior
		Quiet Partner(TM) I Sound Package
ELECTRICAL		Auto Soil Sensor
		Electronic Controls
Before purchasing this appliance, read important information about its estimated annual energy consumption or energy efficiency rating that is available from your dealer.		3 Automatic Cycles
		1-Hour Wash Cycle
		Heavy Wash Cycle
		Normal Cycle
		4 Options
		High Temperature Wash System
		Heated Dry Option
		4 Hour Delay Wash Option
		4-Tier SheerClean Direct Feed Wash System
		Control Lock
Vinyl Racks		
In-Rack Silverware Basket		

C.S/Kof

C2-COUNTRY LANE
LOT 52-4
20-1895 ELEV A
THE KELLERTON

34 of 41

Whirlpool® Undercounter Dishwasher

PRODUCT MODEL NUMBERS

WDF110PAB	WDF310PLA	WDF530PSY
WDF111PAB	WDF320PAD	WDF540PAD
WDF120PAF	WDF510PAY	WDF730PAY
WDF121PAF	WDF520PAD	WDT710PAY
WDF310PAA	WDF530PAY	WDT720PAD
WDF310PCA	WDF530PLY	WDT770PAY

Electrical Requirements: 120-volt, 60-Hz, AC only, 15- or 20-amp. fused electrical supply. Copper wire only. A time delay fuse or circuit breaker and separate circuit is recommended.

If direct wiring dishwasher: Use flexible, armored, or nonmetallic, sheathed copper wire with grounding wire that meets the wiring requirements for your home and local codes and ordinances.

Use a UL listed or CSA approved conduit connector.

If connecting dishwasher with a power supply cord:

Use Power Supply Cord Kit (Part No. 4317824) marked for use with dishwashers. Follow the kit instructions for installing the power supply cord.

Power supply cord must plug into a grounded 3 prong, outlet, located in the cabinet next to the dishwasher opening. Outlet must meet all local codes and ordinances.

Water Supply Requirements: A hot water line with 20 to 120 psi (138 to 862 kPa) water pressure. Water temperature must be 120°F (49°C) water at dishwasher. Use 3/8" O.D. copper tubing with compression fitting or flexible braided water supply line (1/2" minimum plastic tubing is not recommended). Use a 90° elbow with 3/4" N.P.T. external pipe threads on one end. Do not solder within 6" (15.2 cm) from water inlet valve.

Drain Requirements: A new drain hose is supplied with your dishwasher. If this is not long enough, use a new drain hose with a maximum length of 12' (3.7 m) (Part No. 3385556) that meets all current AHAM/IAPMO test standards, is resistant to heat and detergent, and fits the 1" (2.5 cm) drain connector of the dishwasher.

Make sure to connect the drain hose to waste tee or disposer inlet above drain trap in house plumbing and 20" (50.8 cm) minimum above the floor. It is recommended

that the drain hose either be looped up and securely fastened to the underside of the counter or be connected to an air gap.

Make sure to use an air gap if the drain hose is connected to house plumbing lower than 20" (50.8 cm) above subfloor or floor.

Use 1/2" (1.3 cm) minimum I.D. drain line fittings.

If required, the air gap should be installed in accordance with the air gap installation instructions. When connecting the air gap, a rubber hose (not provided) will be needed to connect to the waste tee or disposer inlet.

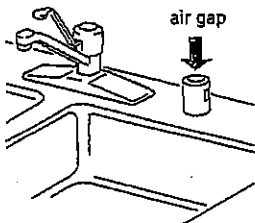

PRODUCT DIMENSIONS

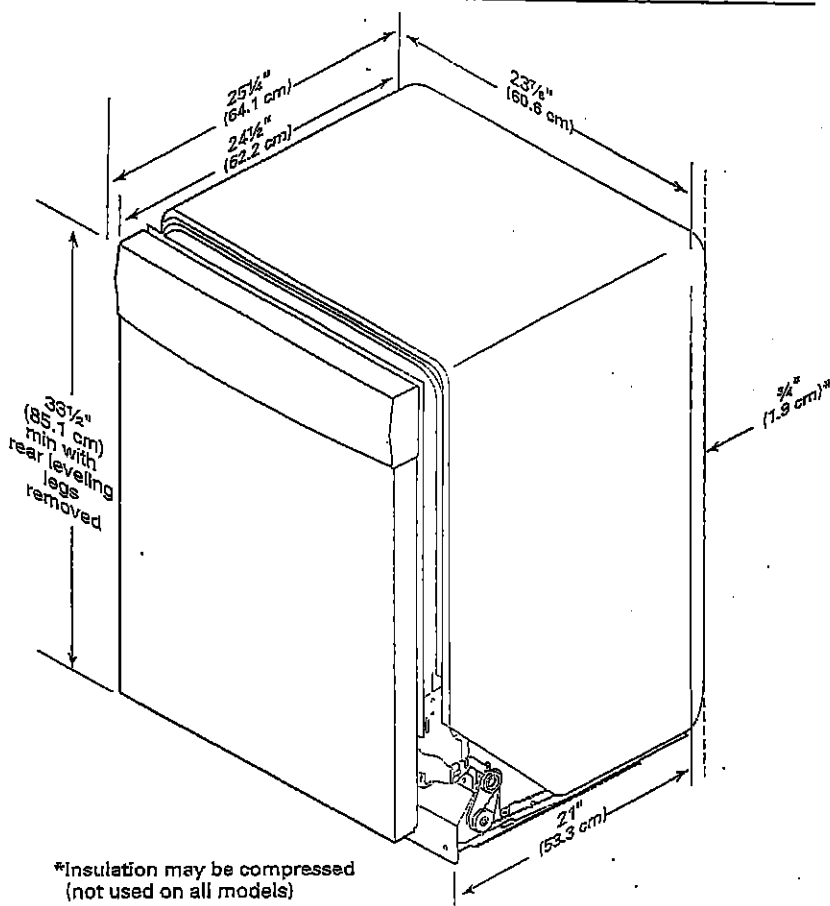

C.S/LA

C2-COUNTRY LANE
LOT 52-4
20-1895 ELEV A
THE KELLERTON

35 of 41

CABINET CUTOUT DIMENSIONS

WDF320PAB

NOTE: Shaded areas of cabinet walls show where utility connections may be installed.

*Measure from the lowest point on the underside of the countertop. May be reduced to 33½" (85.1 cm) by removing the rear leveling legs from dishwasher.

**Minimum, measured from narrowest point of opening.

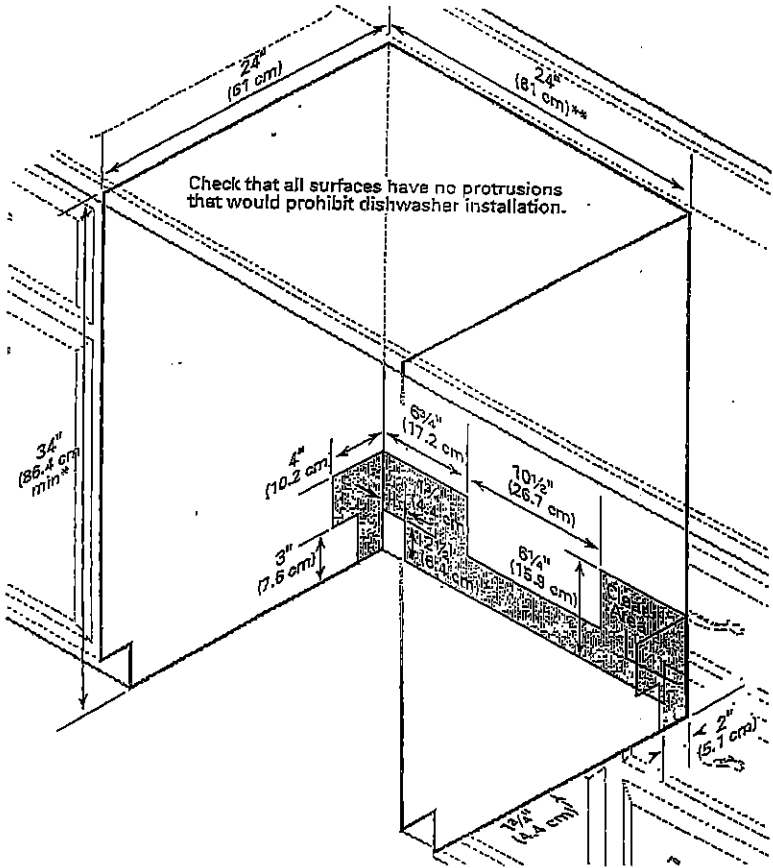

CS/MS

C2-COUNTRY LANE
LOT 52-4
20-1895 ELEV A
THE KELLERTON

36 of 41

WHIRLPOOL WASHER Model #: WFW5620HW

Whirlpool Brand Canada English | Washer and Dryer | Washers | Front Load Washers | WFW5620HW

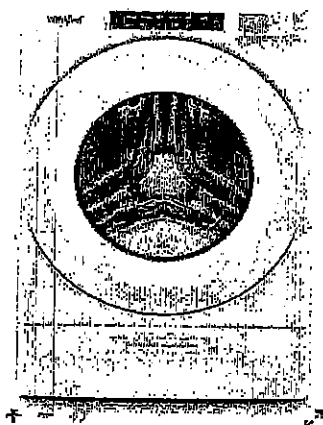

5.2 cu. ft. I.E.C. Closet-Depth
Front Load Washer with
Load & Go™ Dispenser



5.2 cu. ft. I.E.C. Closet-Depth Front Load Washer with Load & Go™
Dispenser

Model #: WFW5620HW

Dimensions

Depth	80.17 cm, 31-9/16 in
Depth With Door Open 90 Degree	143.51 cm, 56-1/2 in
Minimum Height	98.11 cm, 38-5/8 in
Width	68.58 cm, 27.0 in

Appearance

LCD Touch Screen	No
Window	Yes

Details

Drum Material	Stainless Steel
---------------	-----------------

Cycles and Options

Number of Wash Cycles	37
-----------------------	----

Electrical

Hz	60
Power Cord Included	Yes

CSI/KH

C2-COUNTRY LANE
 LOT 52-4
 20-1895 ELEV A
 THE KELLERTON

37 OF 41

WHIRLPOOL WASHER Model #: WFW5620HW

LOCATION REQUIREMENTS

Proper installation is your responsibility.

You will need:

- A water heater set to 120°F (49°C).
- A grounded electrical outlet located within 6 ft (1.8 m) of power cord on back of washer.
- Hot and cold water faucets located within 4 ft (1.2 m) of hot and cold water fill valves on washer, and water pressure of 20–100 psi (137.9–689.6 kPa).
- A level floor with maximum slope of 1" (25 mm) under entire washer. Installing on carpet or surfaces with foam backing is not recommended.
- Floor must support washer's total weight (with water and load) of 315 lbs (143 kgs).

IMPORTANT: Do not install, store, or operate washer where it will be exposed to weather or in temperatures below 32°F (0°C). Water remaining in washer after use may cause damage in low temperatures. See "Washer Care" in your Use and Care Guide for winterizing information.

Whirlpool Models*

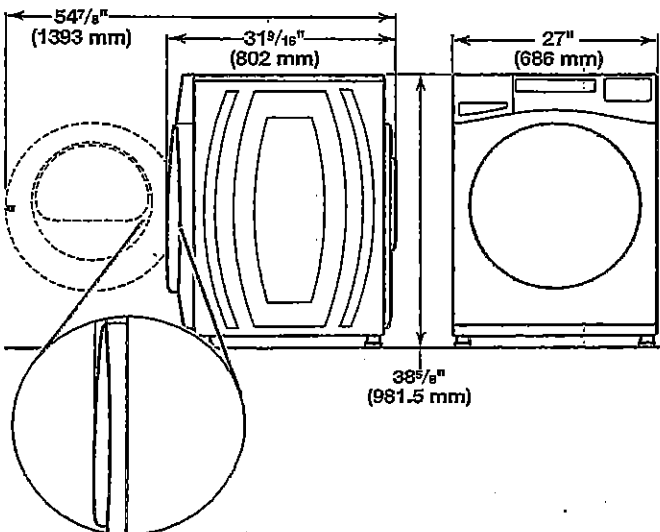
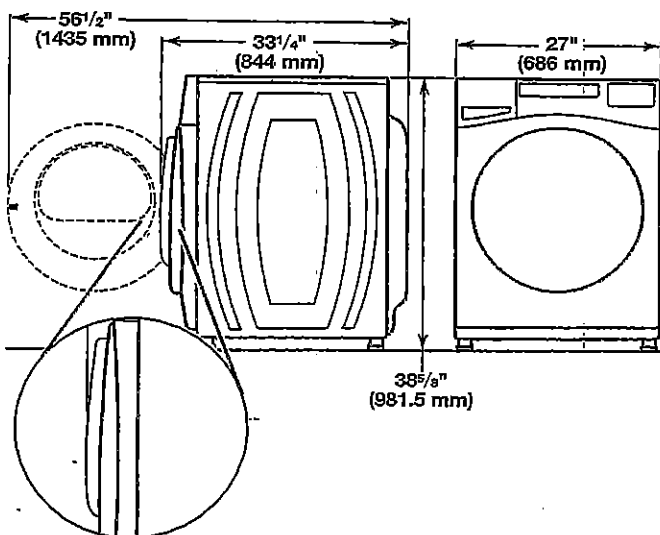

*For additional details (or information) specific to your model, refer to the 'Dimensions' listed for your model at www.whirlpool.com.

Maytag Models

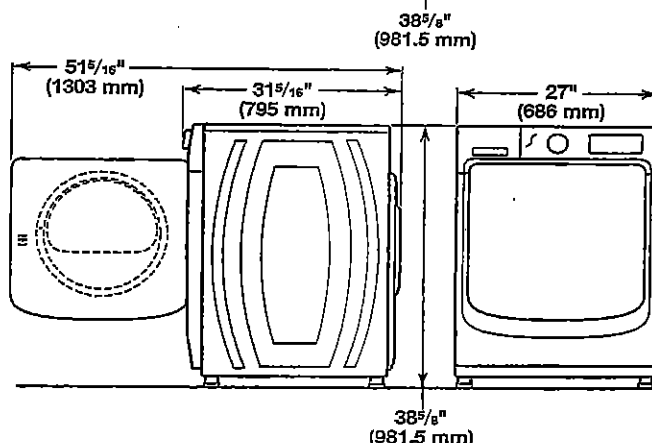
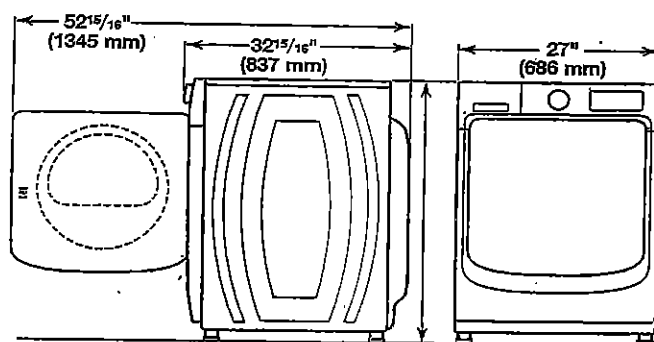

All dimensions show minimum spacing allowed.

For each arrangement, consider allowing more space for ease of installation and servicing, and spacing for companion appliances and clearances for walls, doors, and floor moldings.

Space must be large enough to allow door to fully open. Add spacing of 1" (25 mm) on all sides of washer to reduce noise transfer. If a closet door or louvered door is installed, top and bottom air openings in door are required.

Recessed area or closet installation (stacked washer and dryer):

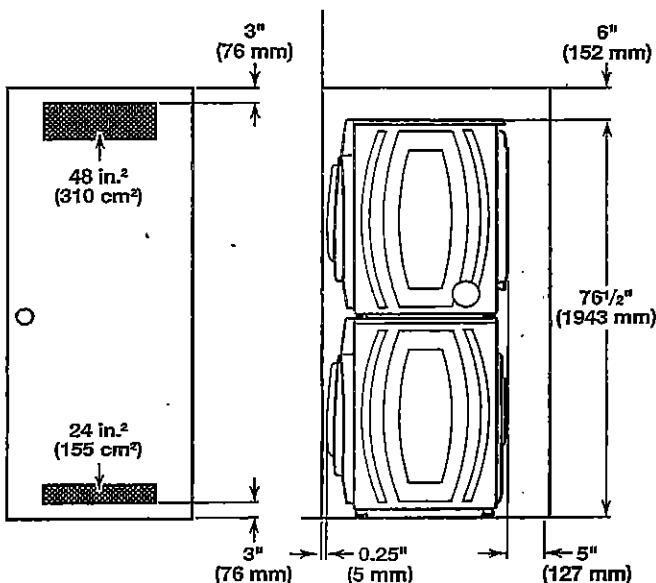

C.S./K24

C2-COUNTRY LANE
 LOT 52-4
 20-1895 ELEV A
 THE KELLERTON

38 of 41

WHIRLPOOL WASHER Model #: WFW5620HW

Custom under-counter installation:

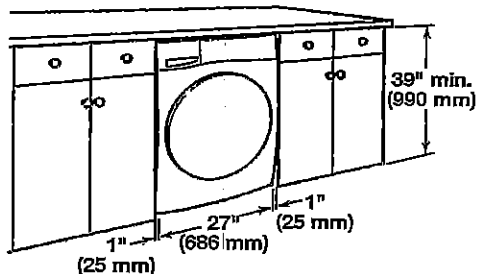

Recessed area or closet installation:

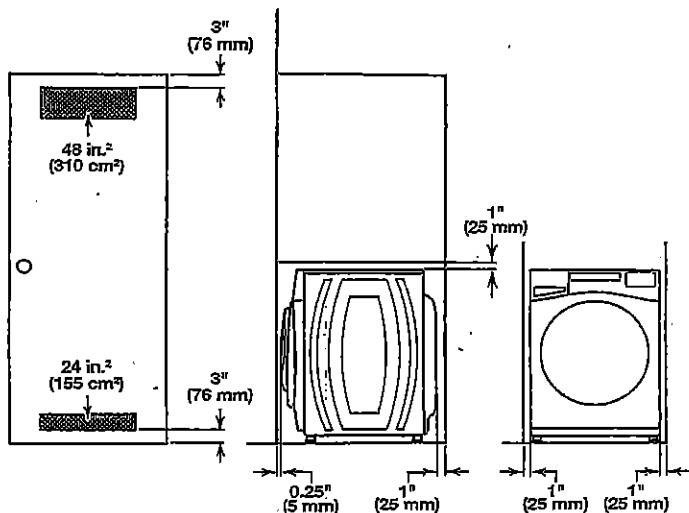

Custom cabinet installation:

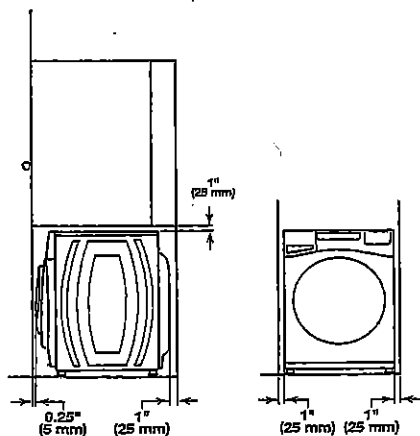

DRAIN SYSTEM

The drain system can be installed using a floor drain, wall standpipe, floor standpipe, or laundry tub. Select the method you need.

IMPORTANT: To avoid siphoning, only 4.5" (114 mm) of drain hose should be inside standpipe. Always secure drain hose with cable tie.

Floor standpipe drain system

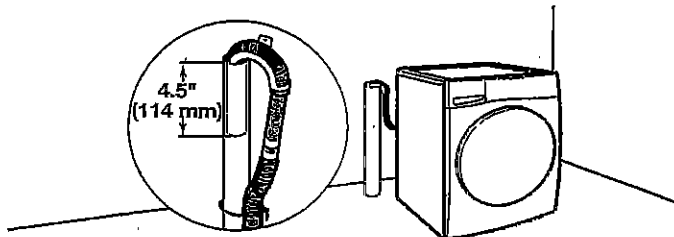

Minimum diameter for a standpipe drain: 2" (51 mm). Minimum carry-away capacity: 17 gal. (64 L) per minute. A 1/4" (6 mm) diameter to 1" (25 mm) diameter Standpipe Adapter Kit is available (Part Number 3363920). Top of standpipe must be at least 30" (762 mm) high; install no higher than 96" (2.44 m) from bottom of washer. If you have an overhead sewer and need to pump higher than 96" (2.44 m), a sump pump and associated hardware are needed. See "Alternate parts."

Wall standpipe drain system

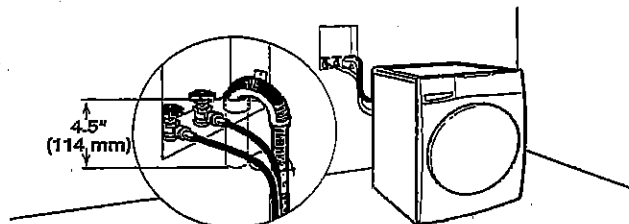

See requirements for floor standpipe drain system.

Laundry tub drain system

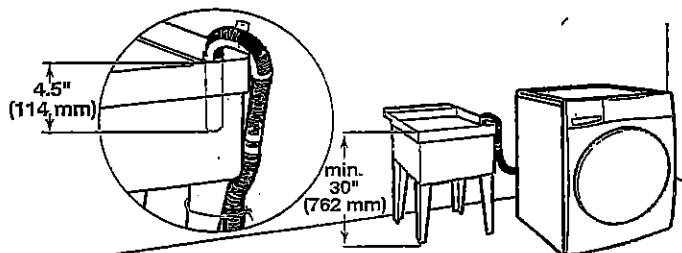

Minimum capacity: 20 gal. (76 L). Top of laundry tub must be at least 30" (762 mm) above floor; install no higher than 96" (2.44 m) from bottom of washer.

C.S/K.H.

C2-COUNTRY LANE
LOT 52-4
20-1895 ELEV A
THE KELLERTON

39 OF 41

WHIRLPOOL DRYER Model #: YWED5620HW

Whirlpool Brand Canada English | Washers and Dryers | Dryers | Electric Dryers | YWED5620HW

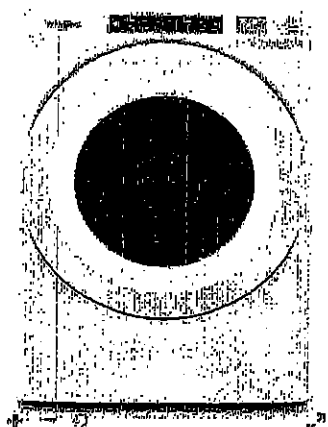

7.4 cu. ft. Front Load Electric
Dryer with Intuitive Touch
Controls



Whirlpool 7.4 cu. ft. Front Load Electric Dryer with Intuitive Touch Controls

Model #: YWED5620HW

Dimensions

Depth	78.74 cm, 31.0 in
Depth With Door Open 90 Degrees	138.43 cm, 54-1/2 in
Height	98.42 cm, 38-3/4 in
Width	69.53 cm, 27.0 in

Configuration and Overview

Fuel Type	Electric
-----------	----------

Cycles and Options

Cycle Time Remaining	Yes
Last Filter Indicator	No
Number of Dryer Cycles	36
Number of Dryness Levels	3

Ventilation System

Long Vent	No
Maximum Vent Length	64
Venting Direction	Left, Right, Bottom, Rear

Electrical

Hz	60
Power Cord Included	Yes

C.S/K.A

C2-COUNTRY LANE
LOT 52-4
20-1895 ELEV A
THE KELLERTON

40 of 41

WHIRLPOOL DRYER Model #: YWED5620HW

Back view:

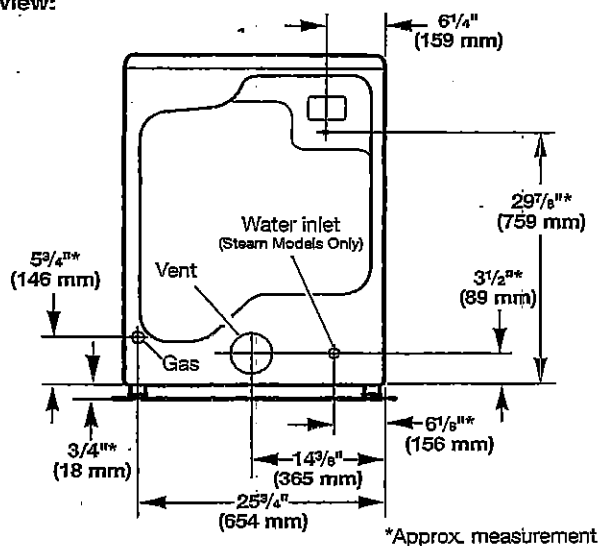

NOTE: Most installations require a minimum of 5" (127 mm) clearance behind dryer for exhaust vent with elbow. See "Venting Requirements."

Installation Clearances

For each arrangement, consider allowing more space for ease of installation and servicing, spacing for companion appliances, and clearances for walls, doors, and floor moldings. Space must be large enough to allow door to fully open. Add spacing on all sides of dryer to reduce noise transfer. If a closet door or louvered door is installed, top and bottom air openings in door are required.

Check code requirements. Some codes limit, or do not permit, installation of the dryer in garages, closets, mobile homes, or sleeping quarters. Contact your local building inspector.

NOTE: No other fuel-burning appliance can be installed in the same closet as a dryer.

Installation spacing for recessed area or closet installation

All dimensions show recommended and minimum spacing allowed.

- Additional spacing should be considered for ease of installation and servicing.
- Additional clearances might be required for wall, door, floor moldings, dryer venting, and gas line.
- Additional spacing should be considered on all sides of the dryer to reduce noise transfer.
- For closet installation with a door, minimum ventilation openings in the top and bottom of the door are required. Louvered doors with equivalent ventilation openings are acceptable.
- Companion appliance spacing should also be considered.

Recommended installation clearances (dryer only):

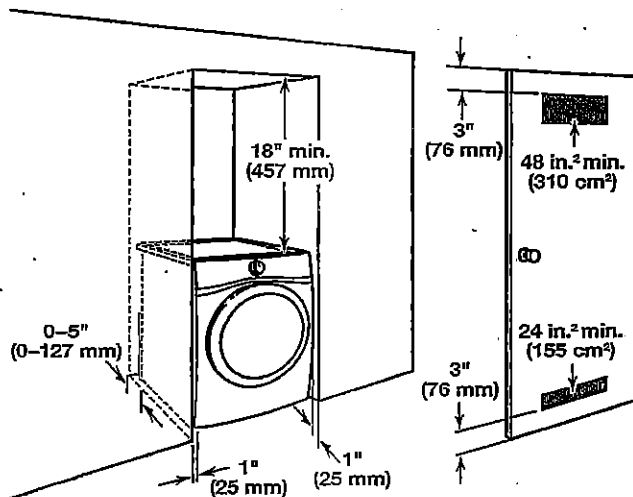

0" (0 mm) rear spacing is allowed for straight back venting only. For steam models only, inlet hose must not be kinked.

Custom under-counter installation:

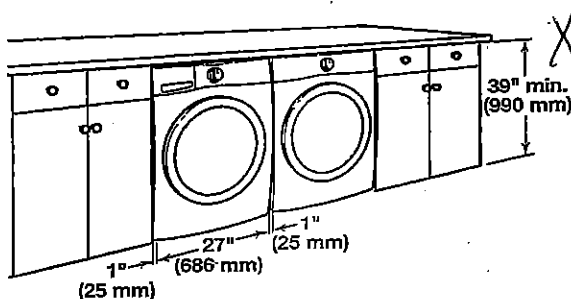

Mobile home - Additional installation requirements:

This dryer is suitable for mobile home installations. The installation must conform to the Manufactured Home Construction and Safety Standard, Title 24 CFR, Part 3280 (formerly the Federal Standard for Mobile home construction and Safety, Title 24, HUD Part 280) or Standard CAN/CSA-Z240 MH.

Mobile home installations require:

- Metal exhaust system hardware, available for purchase from your dealer. For further information, see "Assistance or Service" in your Use and Care Guide.
- Special provisions must be made in mobile homes to introduce outside air into dryer. Openings (such as a nearby window) should be at least twice as large as dryer exhaust opening.

For mobile home installation of gas dryers:

- Mobile Home Installation Hold-down Kit Part Number 346764 is available to order. For further information, see "Assistance or Service" in your Use and Care Guide.

C.S./Kuf

C2-COUNTRY LANE
LOT 52-4
20-1895 ELEV A
THE KELLERTON

41 of 41

WHIRLPOOL DRYER Model #: YWED5620HW

Additional parts may be required, depending on your installation. Check local codes. Check existing electrical supply and venting. Read "Electrical Requirements" and "Venting Requirements" before purchasing parts.

If using a power supply cord:

Use a UL Listed power supply cord kit marked for use with clothes dryers. The kit should contain:

- A UL Listed 30 amp power supply cord, rated 120/240 volt minimum. The cord should be type SRD or SRDT and be at least 4 ft. (1.22 m) long. The wires that connect to the dryer must end in ring terminals or spade terminals with upturned ends.
- A UL Listed strain relief.

Optional Equipment (not supplied with dryer):

Refer to your Use and Care Guide for information about accessories available for your dryer.

LOCATION REQUIREMENTS

Check code requirements. Some codes limit, or do not permit, installing dryer in garages, closets, mobile homes, or sleeping quarters. Contact your local building inspector.

⚠ WARNING



Explosion Hazard

Keep flammable materials and vapors, such as gasoline, away from dryer.

Place dryer at least 18 inches (460 mm) above the floor for a garage installation.

Failure to do so can result in death, explosion, or fire.

You will need:

- A location allowing for proper exhaust installation. See "Venting Requirements."
- A separate 15 or 20 amp circuit for a gas dryer or 30 amp circuit for an electric dryer.
- If using power supply cord, a grounded electrical outlet located within 2 ft. (610 mm) of either side of dryer. See "Electrical Requirements."
- Floor must support dryer weight of 200 lbs. (90.7 kg). Also consider weight of companion appliance.
- Cold water faucets located within 4 ft. (1.2 m) of the water fill valves, and water pressure of 20–120 psi (138–827 kPa). You may use your washer's water supply by purchasing the necessary parts noted in "Parts needed."
- Level floor with maximum slope of 1" (25 mm) under entire dryer. If slope is greater than 1" (25 mm), install Extended Dryer Feet Kit, Part Number, 279810. If not level, clothes may not tumble properly and automatic sensor cycles may not operate correctly.
- For garage installation, place dryer at least 18" (460 mm) above floor. If using a pedestal, you will need 18" (460 mm) to bottom of dryer.
- The dryer must not be installed or stored in an area where it will be exposed to water and/or weather.

IMPORTANT: Do not operate, install, or store dryer where it will be exposed to water, weather, or at temperatures below 40°F (4°C). Lower temperatures may cause dryer not to shut off at end of automatic sensor cycles, resulting in longer drying times.

DRYER DIMENSIONS

Front view:

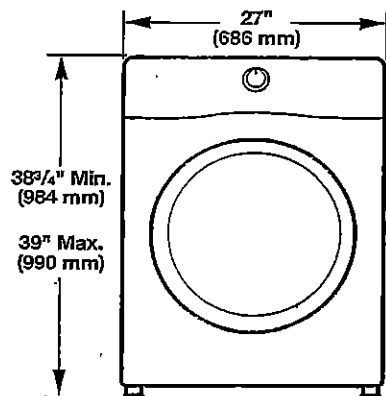

Side view:

Whirlpool Models ✓

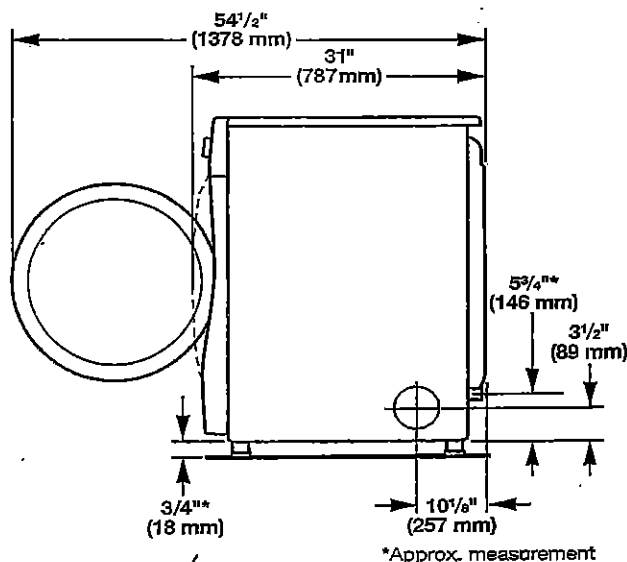

Maytag Models ✗

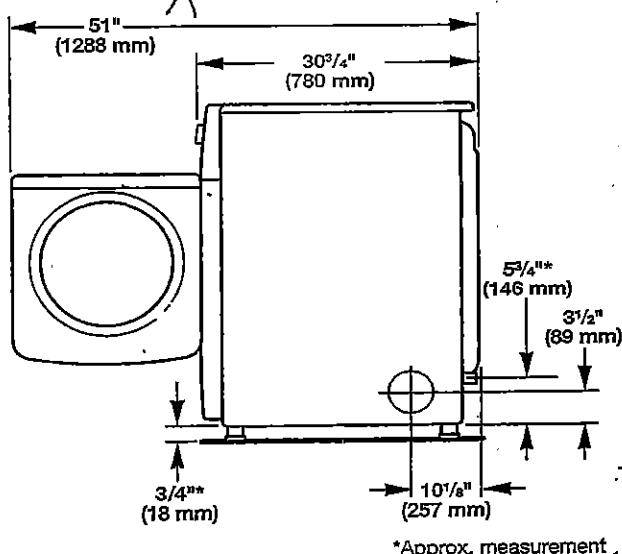

CS/1/10/11