



# Interior Finishing Selection Sheet

21-Jun-21

LOT 053-1

20-2447-UG ELEV B THE BARRINGTON

PURCHASERS: MUHAMMAD AZAM QURESHI  
HUMAIRA AZAM

CONTACT NO: 647-773-6075  
647-261-6686

VENDOR: HEATHWOOD HOMES (WHITBY) LIMITED - PHASE 4

## Appliances

6-8894 Kitchen HoodFan

## Cabinetry

1-9111 Kitchen Cabinet Colour/Style

3-2086 Kitchen Cabinet Hardware

25-9157 Main Bathroom Cabinet Colour/Style

29-2076 Main Bathroom Cabinet Hardware

28-8796 Main Bathroom Countertop

20-9167 Master Ensuite Cabinet Colour/Style

22-7672 Master Ensuite Cabinet Hardware

21-8822 Master Ensuite Countertop

359-6319 Optional Lower Level Bath Cabinet Colour/Style

360-2086 Optional Lower Level Bath Cabinet Hardware

361-8822 Optional Lower Level Bath Countertop

## Carpet

37-9246 Bedroom 2 Flooring

38-9246 Bedroom 3 Flooring

363-9246 Bedroom 4 (Optional Lower Level) Flooring

367-9246 Lower Level Hall Flooring

36-9246 Master Bedroom Flooring

52-1079 Throughout Underpad

## Ceramics

16-8913 Foyer Flooring

UPG

☒ CYCLONE 30" CANOPY CHIMNEY HOODFAN (Standard for  
Singles Only) STAINLESS STEEL SCB51430 STD PAGE 29

☐ SIMCOE ORCHID VIKING III STD 3DL

☐ HARDWARE 9677 STD

☐ SIMCOE MOONLIGHT Viking III STD 3DL

☐ HARDWARE 181 STD

☐ Countertop PALOMA POLAR ETCHINGS FINISH 6698-46  
Formica

☐ CHARLESTON RAIN CLOUD Viking III STD 3DL

☐ HARDWARE 135 STD

☐ Countertop WHITE CARRARA 4924-38 Wilsonart

☐ MANCHESTER CAVIAR CL Viking III MAPLE

☐ HARDWARE 9677 STD

☐ Countertop WHITE CARRARA 4924-38 Wilsonart

☐ Dynasty Tex 40 oz Poly BEACH SHELL DY 84558 STD

☐ Dynasty Tex 40 oz Poly BEACH SHELL DY 84558 STD

☐ Dynasty Tex 40 oz Poly BEACH SHELL DY 84558 STD

☐ Dynasty Tex 40 oz Poly BEACH SHELL DY 84558 STD

☐ Dynasty Tex 40 oz Poly BEACH SHELL DY 84558 STD

☐ Underpad 500 Series STD

☒ Biel Bianco (White) UN.BL.BIA.1224 UPG\_2 12 x 24 SEE  
SKETCH # 8 PAGE 20 FOR 12 X 24 TILE  
DIRECTION

1. The Purchaser acknowledges these selections are subject to the terms and conditions of the applicable Agreement of Purchase and Sale.
2. The Purchaser acknowledges that the Vendor accepts no responsibility in the event the Vendor is unable to supply a selection. The Purchaser agrees to reselect from the currently available selections immediately upon request.
3. The Vendor reserves the right to substitute above materials and equipment with that of equal or better quality.
4. Purchaser acknowledges that items may not be exactly as shown. Variations from the Vendor's samples may occur in finished materials due to normal production processes. Vendor is not responsible for shade difference which may occur from different dye lots or wood grains. Variations from the Vendor's samples will occur with natural materials such as wood, marble, granite, hardwood and brick.
5. The Vendor reserves the right to select Grout & Thresholds that best suits the Tile selected.
6. Selections will not be processed unless signed by Heathwood Homes Head Office.
7. The colour selections made on the Colour Chart are final and cannot be changed once submitted.
8. The Purchaser has checked and acknowledges the accuracy of this Colour Chart.

June 21, 2021

Date Purchaser

June 21/21

Date Decor Consultant

June 21, 2021

Date Purchaser

-07-08-2021

Date Approved HEATHWOOD HOMES (WHITBY)  
LIMITED - PHASE 4





21-Jun-21

# Interior Finishing Selection Sheet

2 of 11

LOT 053-1

20-2447-UG ELEV B THE BARRINGTON

PURCHASERS: MUHAMMAD AZAM QURESHI  
HUMAIRA AZAM

CONTACT NO: 647-773-6075  
647-261-6686

VENDOR: HEATHWOOD HOMES (WHITBY) LIMITED - PHASE 4

## Ceramics

### UPG

17-2225 Foyer Grout

4-8104 Kitchen Backsplash

5-2226 Kitchen Backsplash Grout

7-8913 Kitchen/Breakfast Flooring

8-2225 Kitchen/Breakfast Grout

348-9257 Laundry Mud Room Flooring

349-2225 Laundry Mud Room Grout

30-9257 Main Bathroom Flooring

31-2225 Main Bathroom Grout

112-9020 Main Bathroom Tub Wall Tile

113-2226 Main Bathroom Tub Wall Tile Grout

23-9106 Master Ensuite Floor Tile

24-2225 Master Ensuite Floor Tile Grout

73-8104 Master Ensuite Shower Floor Tile

74-2226 Master Ensuite Shower Floor Tile Grout

147-8923 Master Ensuite Shower Jamb(s) and Sill(s)

104-8833 Master Ensuite Shower Wall Tile

105-2226 Master Ensuite Shower Wall Tile Grout

350-9257 Optional Lower Level Bath Flooring

351-2225 Optional Lower Level Bath Grout

354-8109 Optional Lower Level Bath Opt. Shower Floor Tile

☐ Grout (27) Silver STD

☒ ONTARIO HEXAGON MATTE TAUPE OD.ON.TPE.02.HEX.MT UPG\_2

☐ Grout (00) White STD

☒ Biel Bianco (White) UN.BL.BIA.1224 UPG\_2 12 x 24 SEE SKETCH # 8 PAGE 20 FOR 12 X 24 TILE DIRECTION

☐ Grout (27) Silver STD

☐ CARRARA White / Grey GE.CR.WHIT.1313.MT STD 13 x 13

☐ Grout (27) Silver STD

☐ CARRARA White / Grey GE.CR.WHIT.1313.MT STD 13 x 13

☐ Grout (27) Silver STD

☐ Weave White QT.WV.WHT.0810 STD 8 x 10 INSTALL STACKED HORIZONTALLY

☐ Grout (00) White STD

☒ Madison Series White Matte GE.MD.WHT.1818.MT UPG 1 18" X 18" Matte

☐ Grout (27) Silver STD

☒ ONTARIO HEXAGON MATTE TAUPE OD.ON.TPE.02.HEX.MT UPG\_2

☐ Grout (00) White STD

☐ Shower Jamb / Sill Thassos White STD

☐ Uniwall White QT.UW.WHT.0810 STD 8 x 10 STAKED HORIZONTALLY

☐ Grout (00) White STD

☐ CARRARA White / Grey GE.CR.WHIT.1313.MT STD 13 x 13

☐ Grout (27) Silver STD

☒ ONTARIO HEXAGON MATTE BLACK OD.ON.BLK.02.HEX.MT UPG\_2

1. The Purchaser acknowledges these selections are subject to the terms and conditions of the applicable Agreement of Purchase and Sale.
2. The Purchaser acknowledges that the Vendor accepts no responsibility in the event the Vendor is unable to supply a selection. The Purchaser agrees to reselect from the currently available selections immediately upon request.
3. The Vendor reserves the right to substitute above materials and equipment with that of equal or better quality.
4. Purchaser acknowledges that items may not be exactly as shown. Variations from the Vendor's samples may occur in finished materials due to normal production processes. Vendor is not responsible for shade difference which may occur from different dye lots or wood grains. Variations from the Vendor's samples will occur with natural materials such as wood, marble, granite, hardwood and brick.
5. The Vendor reserves the right to select Grout & Thresholds that best suits the Tile selected.
6. Selections will not be processed unless signed by Heathwood Homes Head Office.
7. The colour selections made on the Colour Chart are final and cannot be changed once submitted.
8. The Purchaser has checked and acknowledges the accuracy of this Colour Chart.

June 21, 2021

Date

Purchaser

Date

APPROVED

Décor Consultant

June 21, 2021

Date

Purchaser

Date Approved

HEATHWOOD HOMES (WHITBY)  
LIMITED - PHASE 4





08-Jul-21

# Interior Finishing Selection Sheet

13 OF 14

LOT	053-1	20-2447-UG ELEV B. THE BARRINGTON
PURCHASERS: MUHAMMAD AZAM QURESHI HUMAIRA AZAM		CONTACT NO: 647-773-6075 647-261-6686
VENDOR: HEATHWOOD HOMES (WHITBY) LIMITED - PHASE 4		

## Ceramics

- 355-2226 Optional Lower Level Bath Opt. Shower Floor Tile Grout
- 358-8923 Optional Lower Level Bath Opt. Shower Sill(s) and Jamb(s)
- 357-2226 Optional Lower Level Bath Opt. Shower Wall Grout
- 356-8833 Optional Lower Level Bath Opt. Shower Wall Tile
- 32-8913 Powder Room Flooring
- 33-2225 Powder Room Grout
- 53-2232 Throughout Thresholds

## Electrical

- 90-5796 Throughout Switches and Plug

## Fireplace

- 136-8891 Great Room Fireplace Mantle
- 135-8865 Great Room Fireplace Type

## Granite

- 2-9069 Kitchen Countertop

## Hardwood

- 11-7502 Great Room Flooring
- 12-7502 Living Room Flooring
- 98-7502 Main Hall Flooring
- 78-7502 Stair Landing to Lower Level Flooring
- 77-7502 Stair Landing to Upper Level Flooring

## UPG

- ☐ Grout (00) White STD
- ☐ Shower Jamb / Sill Thassos White STD
- ☐ Grout (00) White STD
- ☐ Uniwall White QT.UW.WHT.0810 STD 8 x 10 INSTALL STACKED HORIZONTALLY
- ☒ Biel Bianco (White) UN.BL.BIA.1224 UPG\_2 12 x 24 SEE SKETCH # 8 PAGE 20 FOR 12 X 24 TILE DIRECTION
- ☐ Grout (27) Silver STD
- ☐ Metal Thresholds STD
- ☐ Decora White Switches and Plugs STD
- ☐ Paint Grade Mantle- Cabinet (Per Plan) WHITE NF-17 STD PAGE 22
- ☐ Dimplex FP3033HL Electric Fireplace
- ☐ MSI Quartz ICED WHITE Group 1 STD 3/4"
- ☐ Vintage Northern Solid Sawn Engineered Select V : Red Oak Pearl PEWTER Red Oak Pearl 3/4" x 3 1/4"
- ☐ Vintage Northern Solid Sawn Engineered Select V : Red Oak Pearl PEWTER Red Oak Pearl 3/4" x 3 1/4"
- ☐ Vintage Northern Solid Sawn Engineered Select V : Red Oak Pearl PEWTER Red Oak Pearl 3/4" x 3 1/4"
- ☐ Vintage Northern Solid Sawn Engineered Select V : Red Oak Pearl PEWTER Red Oak Pearl 3/4" x 3 1/4"
- ☐ Vintage Northern Solid Sawn Engineered Select V : Red Oak Pearl PEWTER Red Oak Pearl 3/4" x 3 1/4"

- The Purchaser acknowledges these selections are subject to the terms and conditions of the applicable Agreement of Purchase and Sale.
- The Purchaser acknowledges that the Vendor accepts no responsibility in the event the Vendor is unable to supply a selection. The Purchaser agrees to reselect from the currently available selections immediately upon request.
- The Vendor reserves the right to substitute above materials and equipment with that of equal or better quality.
- Purchaser acknowledges that items may not be exactly as shown. Variations from the Vendor's samples may occur in finished materials due to normal production processes. Vendor is not responsible for shade difference which may occur from different dye lots or wood grains. Variations from the Vendor's samples will occur with natural materials such as wood, marble, granite, hardwood and brick.
- The Vendor reserves the right to select Grout & Thresholds that best suits the Tile selected.
- Selections will not be processed unless signed by Heathwood Homes Head Office.
- The colour selections made on the Colour Chart are final and cannot be changed once submitted.
- The Purchaser has checked and acknowledges the accuracy of this Colour Chart.

Date	June 21/21	Signatures	June 21/21	APPROVED	Tina he fur
		Purchaser	Date		Décor Consultant
		on file	-07-08-2021		m Rosen
Date		Purchaser	Date Approved	HEATHWOOD HOMES (WHITBY) LIMITED - PHASE 4	





08-Jul-21

# Interior Finishing Selection Sheet

11/4/21  
OF

LOT	053-1	20-2447-UG ELEV B THE BARRINGTON
PURCHASERS: MUHAMMAD AZAM QURESHI HUMAIRA AZAM		CONTACT NO: 647-773-6075 647-261-6686
VENDOR: HEATHWOOD HOMES (WHITBY) LIMITED - PHASE 4		

## Hardwood

35-7502 Upper Hall Flooring

## Interior Railings

49-8148 Stairs to Lower Level Handrail/Pickets/Posts Type

43-8148 Stairs to Upper Level Handrail/Pickets/Posts Type

## Interior Stairs

116-1713 Basement Stairs Type

45-1712 Stairs to Lower Level Type

39-1712 Stairs to Upper Level Type

## Interior Trim

91-9374 Throughout Trim Size

## Painting

45-7761 Stairs to Lower Level Type

40-7761 Stairs to Upper Level Colour

240-1716 Throughout Trim - Paint Colour

51-1717 Throughout Walls - Paint Colour

## Plumbing

266-1737 Main Bathroom Plumbing Fixture (Colour)

149-1737 Master Ensuite Plumbing Fixture (colour)

362-1737 Optional Lower Level Bath Plumbing Fixture (Colour)

34-1737 Powder Room Plumbing Fixture (Colour)

UPG

☐ Vintage Northern Solid Sawn Engineered Select V : Red Oak Pearl PEWTER Red Oak Pearl 3/4" x 3 1/4"

☐ Single Collar Alt. Plain w/ Shoes with 3 1/2" Square/Cap Post(s) BLACK METAL STD

☐ Single Collar Alt. Plain w/ Shoes with 3 1/2" Square/Cap Post(s) BLACK METAL STD

☐ Paint Grade Stairs STD

☐ Oak Stairs UPG\_1

☐ Oak Stairs UPG\_1

☐ 4 1/4" Baseboards and 2 3/4" Integrated Backbend Casings STD-Towns

☐ Stain handrail, stringers, treads, risers, nosing & posts. (Metal pickets) STAIRS TO BE STAINED TO COMPLIMENT PEWTER HARDWOOD. STAIRS WILL VARY FROM HARDWOOD FLOORS

☐ Stain handrail, stringers, treads, risers, nosing & posts. (Metal pickets) STAIRS TO BE STAINED PEWTER TO COMPLIMENT PEWTER HARDWOOD. STAIRS WILL VARY FROM HARDWOOD FLOORS

☐ Trim WHITE STD

☐ Wall WARM GREY 22 STD

☐ Plumbing Fixtures WHITE STD

☐ Plumbing Fixtures WHITE STD

☐ Plumbing Fixtures WHITE STD

☐ Plumbing Fixtures WHITE STD

1. The Purchaser acknowledges these selections are subject to the terms and conditions of the applicable Agreement of Purchase and Sale.
2. The Purchaser acknowledges that the Vendor accepts no responsibility in the event the Vendor is unable to supply a selection. The Purchaser agrees to reselect from the currently available selections immediately upon request.
3. The Vendor reserves the right to substitute above materials and equipment with that of equal or better quality.
4. Purchaser acknowledges that items may not be exactly as shown. Variations from the Vendor's samples may occur in finished materials due to normal production processes. Vendor is not responsible for shade difference which may occur from different dye lots or wood grains. Variations from the Vendor's samples will occur with natural materials such as wood, marble, granite, hardwood and brick.
5. The Vendor reserves the right to select Grout & Thresholds that best suits the Tile selected.
6. Selections will not be processed unless signed by Heathwood Homes Head Office.
7. The colour selections made on the Colour Chart are final and cannot be changed once submitted.
8. The Purchaser has checked and acknowledges the accuracy of this Colour Chart.

Date

Purchaser

Date

Décor Consultant

Date

Purchaser

Date Approved

HEATHWOOD HOMES (WHITBY)  
LIMITED - PHASE 4





Sales Selection Sheet  
156P 41

21-Jun-21

20-2447-UG ELEV B THE BARRINGTON

LOT 053-1

PURCHASERS: MUHAMMAD AZAM QURESHI  
HUMAIRA AZAM

CONTACT NO: 647-773-6075  
647-261-6686

VENDOR: HEATHWOOD HOMES (WHITBY) LIMITED - PHASE 4

HST #

It is herein understood and agreed between the undersigned parties hereto that the following changes shall be made to the above mentioned Agreement of Purchase and Sale in accordance with the agreement and except for such changes noted below, all other terms and conditions in the Agreement of Purchase and Sale shall remain as stated herein: It is further understood that and agreed that all changes and additions shall be installed as per builder's specifications, location and available selections. The Purchaser hereby agrees to purchase the following extras:

### Appliances

2151 Laundry Pair Stacking Kit  
Supply and Install Laundry Pair Stacking Kit

Qty: 1

2160 Cyclone 30" Wall Mount Chimney Hood SS  
SCB51430

KITCHEN

Qty: 1

PAGE 29

### Cabinetry

1338 Optional Extras  
30H- Wall cabinet with shelf for microwave (finished interior) (opening 24"W x 13 3/4"H x 17"D) \* electrical priced separately Before June 1, 2021 VIKING  
SEE SKETCH # 8 PAGE 20 FOR LOCATION

KITCHEN

Qty: 1

1319 Optional Extras  
04D- Increase vanity to kitchen height greater than 3' (90cm high, maintains vanity depth) Before June 1, 2021 VIKING

MASTER ENSUITE

Qty: 1

### Ceramics

1933 Upgrade 2 Tile  
SEE SKETCH # 8 PAGE 20 FOR 12 X 24 TILE  
DIRECTION

FOYER/VESTIBULE

Qty: 1

1937 Upgrade 2 Tile  
SEE SKETCH # 8 PAGE 20 FOR 12 X 24 TILE  
DIRECTION

KITCHEN

Qty: 1

1. This Sales Selection Sheet when properly executed forms part of our Agreement of Purchase and Sale.
2. All extras and upgrades listed above are subject to Construction Progress and Architectural and Municipal requirements.
3. In the event the Vendor is unable to incorporate the work approved above in the construction of the house for any reason whatsoever, the Vendor will not be liable to the Purchaser in any way. The monies paid for any changes or optional extras not proceeded with shall be returned to the Purchaser, without interest. The cost of options or extras is non-refundable in all other circumstances. If for any reason whatsoever the Agreement of Purchase and Sale is not completed, the total cost of work approved above will be retained by the Vendor.
4. The Vendor reserves the right to substitute above materials and equipment with that of equal or better quality.
5. Purchaser acknowledges that items may not be exactly as shown. Variations from the Vendor's samples may occur in finished materials due to normal production processes. Vendor is not responsible for shade difference which may occur from different dye lots or wood grains. Variations from the Vendor's samples will occur with natural materials such as wood, marble, granite, hardwood and brick.
6. The Vendor reserves the right to select Grout & Thresholds that best suits the Tile selected.
7. Selections will not be processed unless signed by Heathwood Homes Head Office.
8. The selections made on this schedule are final and cannot be changed once submitted.
9. The Purchaser has checked and acknowledges the accuracy of this schedule.

Jun 21, 2021

Date

Purchaser

June 21/21

Date APPROVED

Décor Consultant

June 21, 2021

Date

Purchaser

-05- 29 2021

Date Approved HEATHWOOD HOMES (WHITBY)  
LIMITED - PHASE 4





21-Jun-21

# Sales Selection Sheet

16 of 11

LOT	053-1	20-2447-UG ELEV B THE BARRINGTON	
PURCHASERS: MUHAMMAD AZAM QURESHI		CONTACT NO: 647-773-6075	
HUMAIRA AZAM		647-261-6686	
VENDOR:	HEATHWOOD HOMES (WHITBY) LIMITED - PHASE 4		HST #

It is herein understood and agreed between the undersigned parties hereto that the following changes shall be made to the above mentioned Agreement of Purchase and Sale in accordance with the agreement and except for such changes noted below, all other terms and conditions in the Agreement of Purchase and Sale shall remain as stated herein: It is further understood that and agreed that all changes and additions shall be installed as per builder's specifications, location and available selections. The Purchaser hereby agrees to purchase the following extras:

1966	Optional Extras	Kitchen	Qty: 1
	Supply and install additional backsplash due to chimney hoodfan installation Upgrade 2		
1941		KITCHEN BACKSPLASH	Qty: 1
	Upgrade 2 Tile		
1934		MAIN FLOOR POWDER ROOM	Qty: 1
	Upgrade 2 Tile		
	SEE SKETCH # 8	PAGE 20	FOR 12 X 24 TILE
	DIRECTION		
1938		MASTER ENSUITE FLOOR	Qty: 1
	Upgrade 1 Tile		
1932		MASTER ENSUITE SHOWER FLOOR	Qty: 1
	Upgrade 2 Tile		
1969	Upgrade Shower Floor	MODIFIED LOWER LEVEL Shower Floor	Qty: 1
	Upgrade 2 Tile		

## Electrical

342	Optional Extras	LAUNDRY ROOM	Qty: 1
	Extra wall interior outlet on Existing Circuit (does not include kitchen outlets) Upg 1 Before June 1, 2021		
	SEE SKETCH # 7	PAGE 19	FOR LOCATION

## Fireplace

1. This Sales Selection Sheet when properly executed forms part of our Agreement of Purchase and Sale.
2. All extras and upgrades listed above are subject to Construction Progress and Architectural and Municipal requirements.
3. In the event the Vendor is unable to incorporate the work approved above in the construction of the house for any reason whatsoever, the Vendor will not be liable to the Purchaser in any way. The monies paid for any changes or optional extras not proceeded with shall be returned to the Purchaser, without interest. The cost of options or extras is non-refundable in all other circumstances. If for any reason whatsoever the Agreement of Purchase and Sale is not completed, the total cost of work approved above will be retained by the Vendor.
4. The Vendor reserves the right to substitute above materials and equipment with that of equal or better quality.
5. Purchaser acknowledges that items may not be exactly as shown. Variations from the Vendor's samples may occur in finished materials due to normal production processes. Vendor is not responsible for shade difference which may occur from different dye lots or wood grains. Variations from the Vendor's samples will occur with natural materials such as wood, marble, granite, hardwood and brick.
6. The Vendor reserves the right to select Grout & Thresholds that best suits the Tile selected.
7. Selections will not be processed unless signed by Heathwood Homes Head Office.
8. The selections made on this schedule are final and cannot be changed once submitted.
9. The Purchaser has checked and acknowledges the accuracy of this schedule.

JUN 21, 2021

Date

Purchaser

JUNE 21/21

Date APPROVED

Décor Consultant

June 21, 2021

Date

Purchaser

-06- 29 2021

Date Approved HEATHWOOD HOMES (WHITBY) LIMITED - PHASE 4





21-Jun-21

# Sales Selection Sheet

LOT 053-1

20-2447-UG ELEV B THE BARRINGTON

PURCHASERS: MUHAMMAD AZAM QURESHI  
HUMAIRA AZAM

CONTACT NO: 647-773-6075  
647-261-6686

VENDOR: HEATHWOOD HOMES (WHITBY) LIMITED - PHASE 4

HST #

It is herein understood and agreed between the undersigned parties hereto that the following changes shall be made to the above mentioned Agreement of Purchase and Sale in accordance with the agreement and except for such changes noted below, all other terms and conditions in the Agreement of Purchase and Sale shall remain as stated herein: It is further understood that and agreed that all changes and additions shall be installed as per builder's specifications, location and available selections. The Purchaser hereby agrees to purchase the following extras:

81

Qty: 1

Purchasers have been advised: heat from the FP can damage TV above a FP and items placed on mantle. Purchasers acknowledge: Heathwood Homes and its contractors will not be liable for any damage on items placed/installed above a FP after closing

## Mirrors/Glass Products

551

Shower Upgrade

MASTER ENSUITE

Qty: 1

Upgrade to Frameless clear glass with D-Ring Handle in chrome

SKETCH # 9 PAGE 21

1. This Sales Selection Sheet when properly executed forms part of our Agreement of Purchase and Sale.
2. All extras and upgrades listed above are subject to Construction Progress and Architectural and Municipal requirements.
3. In the event the Vendor is unable to incorporate the work approved above in the construction of the house for any reason whatsoever, the Vendor will not be liable to the Purchaser in any way. The monies paid for any changes or optional extras not proceeded with shall be returned to the Purchaser, without interest. The cost of options or extras is non-refundable in all other circumstances. If for any reason whatsoever the Agreement of Purchase and Sale is not completed, the total cost of work approved above will be retained by the Vendor.
4. The Vendor reserves the right to substitute above materials and equipment with that of equal or better quality.
5. Purchaser acknowledges that items may not be exactly as shown. Variations from the Vendor's samples may occur in finished materials due to normal production processes. Vendor is not responsible for shade difference which may occur from different dye lots or wood grains. Variations from the Vendor's samples will occur with natural materials such as wood, marble, granite, hardwood and brick.
6. The Vendor reserves the right to select Grout & Thresholds that best suits the Tile selected.
7. Selections will not be processed unless signed by Heathwood Homes Head Office.
8. The selections made on this schedule are final and cannot be changed once submitted.
9. The Purchaser has checked and acknowledges the accuracy of this schedule.

Jun 21, 2021

Date

Purchaser

June 21/21

Date APPROVED

Décor Consultant

Jun 21, 2021

Date

Purchaser

-06- 29 2021

Date Approved HEATHWOOD HOMES (WHITBY)  
LIMITED - PHASE 4



C2-COUNTRY LANE  
LOT 53-1  
20-2447-UG ELEV B  
THE BARRINGTON

18 of 41

# The Barrington

20-2447 END ELEV. B

Sketch #6

ELEVATION A & B END:  
2,504 SQ FT

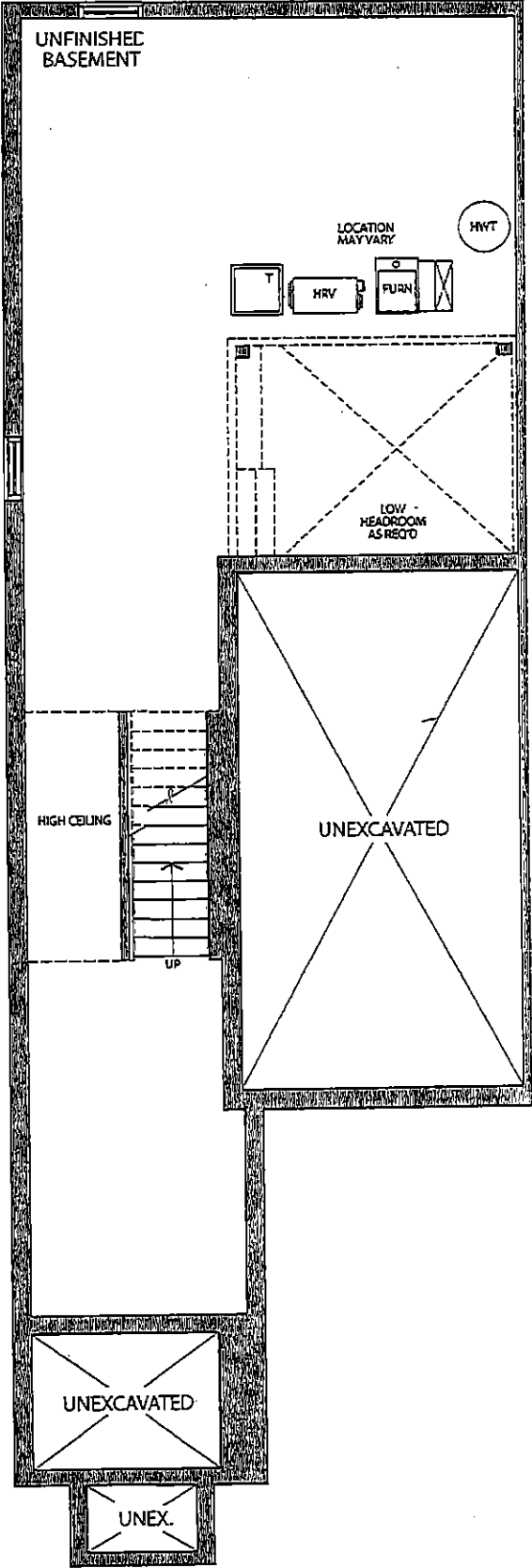

ELEVATION A & B  
END  
BASEMENT

8

A-A



19 OF 41

20-2447 END ELEV. B

Sketch # 7

DECK ABOVE

STEPS MAY VARY

SLIDING DOOR

BEDROOM 4

MAIN BATH

WALK-IN CLOSET

WALK-IN CLOSET

LAUNDRY MUD ROOM

DOOR WHERE GRADE PERMITS

GARAGE

SUNKEN FOYER  
HIGH CEILING

UP

DN

UP

DN

TO FRONT DOOR

TO LIVING ROOM

HALF WALL

DN IF REQ'D

DN IF REQ'D

W

D

ST. UPPER

→ STACKABLE W/D  
ADDITIONAL PLUG

H.A.



C2-COUNTRY LANE  
LOT 53-1  
20-2447-UG ELEV B  
THE BARRINGTON

20 of 41

# The Barrington

20-2447 END ELEV. B

Sketch #8 ELEVATION A & B END:  
2,504 SQ FT

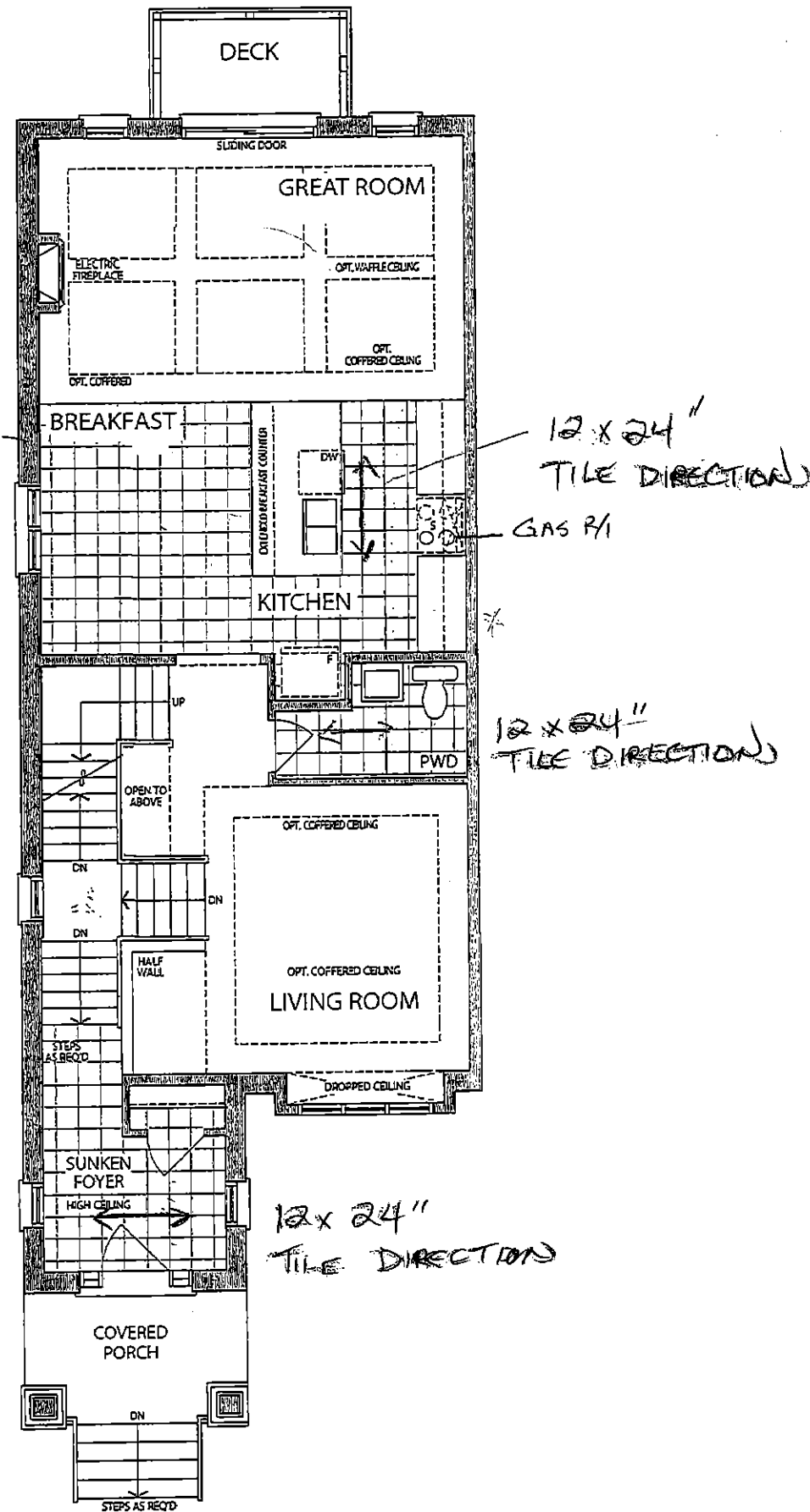

MAIN LEVEL  
ELEVATION B END



C2-COUNTRY LANE  
LOT 53-1  
20-2447-UG ELEV B  
THE BARRINGTON

21 OF 41

# The Barrington

20-2447 END ELEV. B

Sketch #9

ELEVATION A & B END:  
2,504 SQ FT

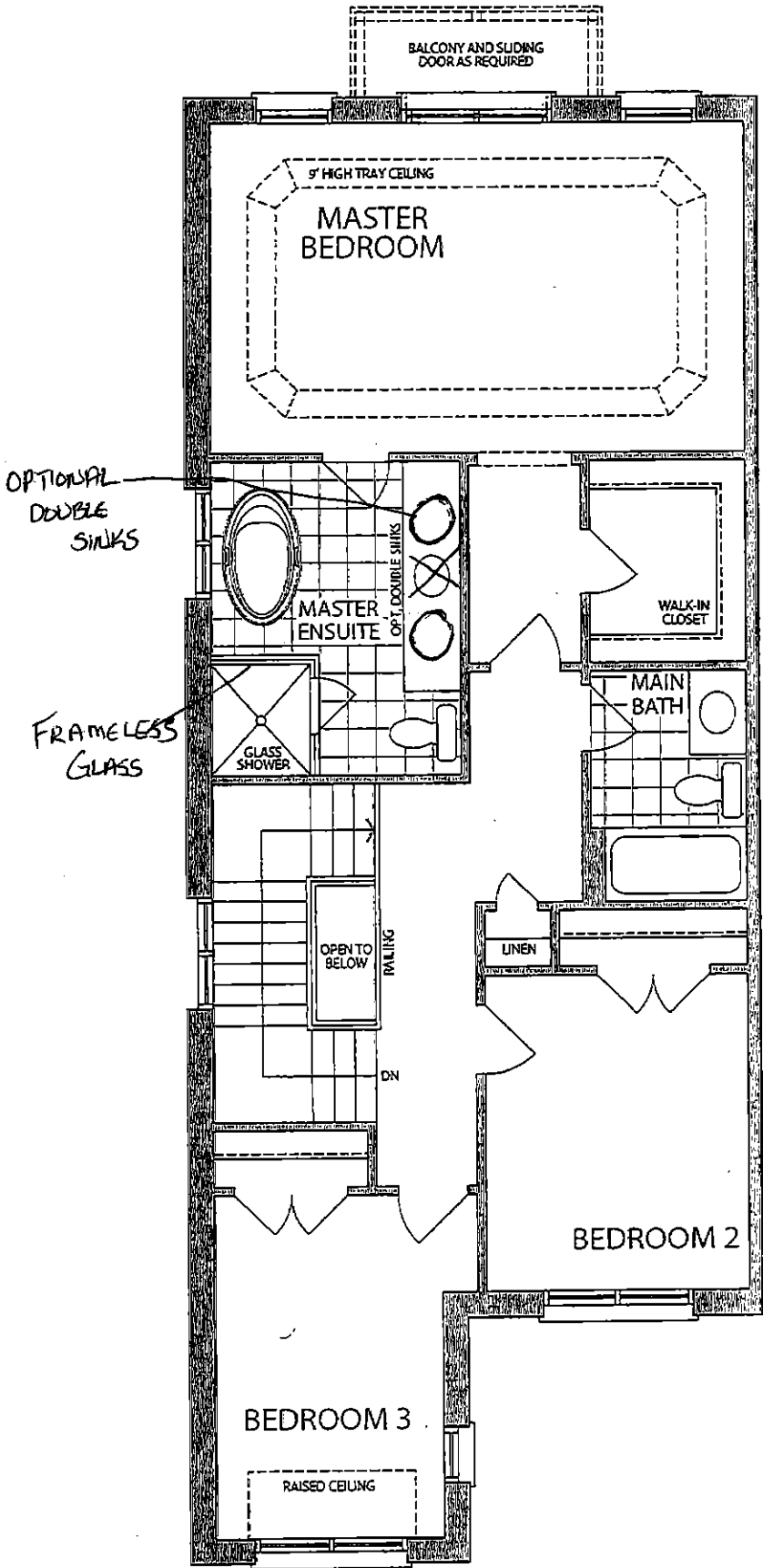

UPPER LEVEL  
ELEVATION B END

①

H.A.



C2-COUNTRY LANE  
LOT 53-1  
20-2447-UG ELEV B  
THE BARRINGTON

22 OF 41

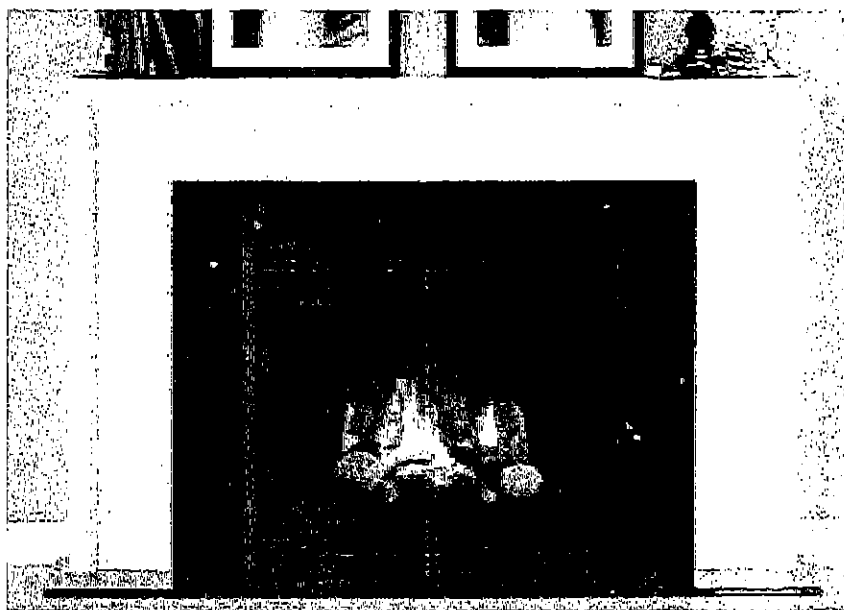

'CABINET'

NEAS NF17 Mantel



A-A-



C2-COUNTRY LANE  
LOT 53-1  
20-2447-UG ELEV B  
THE BARRINGTON

23 of 41

*Regina*

STANDARD KITCHEN SINK

ND1831UA/9

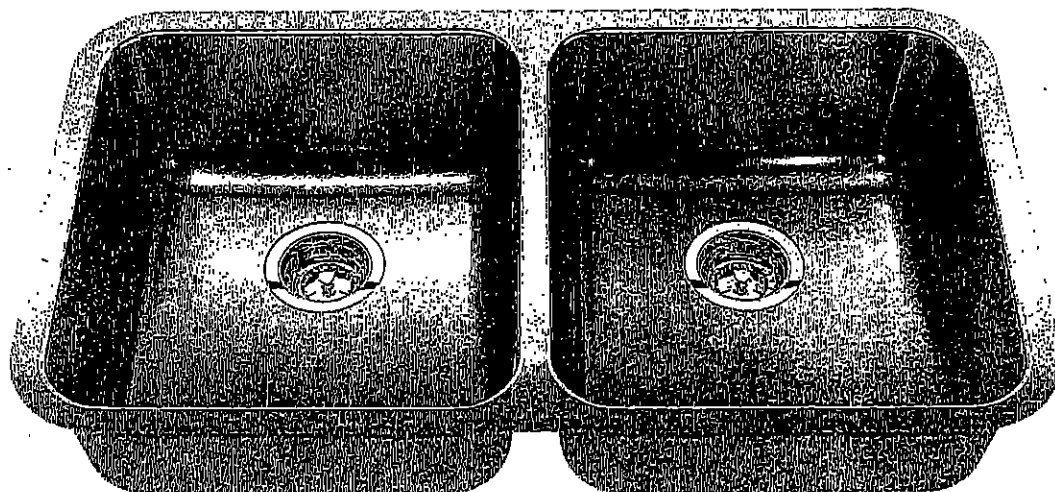

Optional Accessories



BG105



BG10S



MB100



CATW



DBR10S



HA

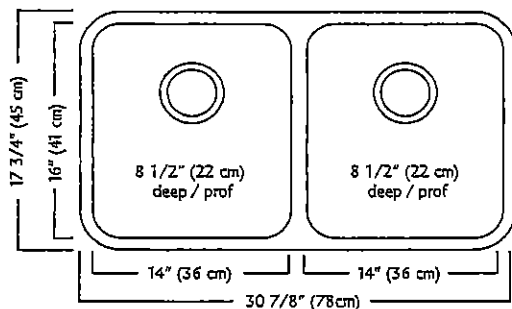

ND1831UA/9 SPECIFICATION

Model ND1831UA/9 is a double (two equal size) bowl undermount sink manufactured by Franke Kindred Canada Limited from 18 gauge stainless steel. Product has silk finished rims and linear brush finished bowls. Sink is fully undercoated. Basket strainer waste fittings (3 1/2", 89 mm) are included. Sink is backed with a limited lifetime warranty.

- O.D. 17 3/4" x 30 7/8" x 8 1/2" (45 x 78 x 22 cm)
- Recommended for minimum 36" cabinet

Franke Kindred Canada Limited  
P.O. Box 190, 1000 Franke Kindred Road, Midland, Ontario, Canada, L4R 4K9 Phone: 866-687-7465 Fax: 800-361-8408



C2-COUNTRY LANE  
LOT 53-1  
20-2447-UG ELEV B  
THE BARRINGTON

24 of 41

STANDARD KITCHEN FAUCET

Align

Modern

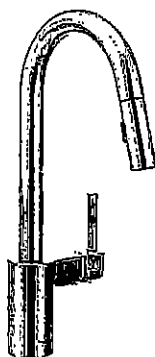

Single Handle Pull-Down Kitchen  
Faucet\*

Model 7565†



11-A



C2-COUNTRY LANE  
LOT 53-1  
20-2447-UG ELEV B  
THE BARRINGTON

25 of 41

*American  
Standard*

**BOULEVARD®**  
**PEDESTAL SINK**  
VITREOUS CHINA

**BOULEVARD® PEDESTAL SINK**

- ☐ 0641.800 Faucet holes on 8" (203mm) centers (Illustrated).
- \* ☐ 0641.400 Faucet holes on 4" (102mm) centers
- ☐ 0641.100 Center hole only
  - Classic styled rectangular pedestal lavatory
  - Vitreous china
  - Rear overflow
  - Supplied with mounting kit
  - Right Height® for greater comfort during use
  - Faucet ledge with large deck area (faucet not included)
  - **Design coordinates with Boulevard® Toilet**
  - Basin has flat bottom to also allow use as an above counter sink or a drop-in sink (with u-shaped cut out)

**Nominal Dimensions:**

24" x 19" x 35-1/2"  
(610 x 483 x 902mm)

- ☐ 0641.008 Pedestal top-8" (203mm) centers
- ☐ 0641.004 Pedestal top-4" (102mm) centers
- ☐ 0641.001 Pedestal top-center hole only
- ☐ 0010.000 Pedestal only

**Bowl sizes:**

17" (432mm) wide,  
12-1/2" (318mm) front to back,  
5" (127mm) deep

**Compliance Certifications -**

**Meets or Exceeds the Following Specifications:**

- ASME A112.19.2 - 2008/CSA B45.1-08

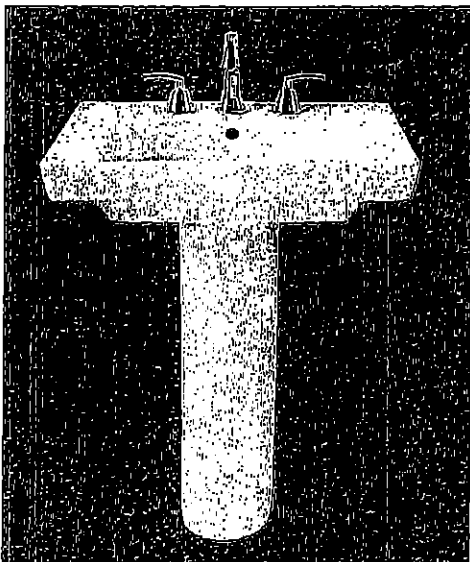

SEE REVERSE FOR ROUGHING-IN DIMENSIONS

**To Be Specified:**

- ☐ Color: ☐ White ☐ Linen
- ☐ Faucet Finish:
- ☐ Supplies:
- ☐ 1-1/4" Trap:
- ☐ Nipple:

\* See faucet section for additional models available

HA



C2-COUNTRY LANE  
LOT 53-1  
20-2447-UG ELEV B  
THE BARRINGTON

COLONY COUNTERTOP SINK

- Vitreous china
- Self-rimming
- Front overflow
- Supplied with template
- Faucet deck
- (Faucet shown not included)

- ☒ 0346 803  
Faucet holes on 203mm (8") centres
- ☐ 0346 403 (Illustrated)  
Faucet holes on 102mm (4") centres
- ☐ 0346 001  
Centre hole only

Nominal Dimensions:  
521 x 448mm (20-1/2" x 17-5/8")

Bowl sizes:  
422mm (16-5/8") wide, 279mm (11") front to  
back, 143mm (5-5/8") deep

COMPLIANCE CERTIFICATIONS –  
Meets or exceeds the following Specifications:  
• ASME A112.19.2M for Vitreous China Fixtures.  
• CAN/CSA B45 Series.

- To Be Specified
- ☐ Colour: ☒ White ☐ Bone ☐ Silver Gray  
☐ Linen
- ☐ Faucet\*:
- ☐ Faucet Finish:
- ☐ Supplies & Stops:
- ☐ Trap 1-1/4" (32 mm):

\* See faucet section for additional models available

BAS-198

26 of 41 COLONY™  
COUNTERTOP SINK  
VITREOUS CHINA

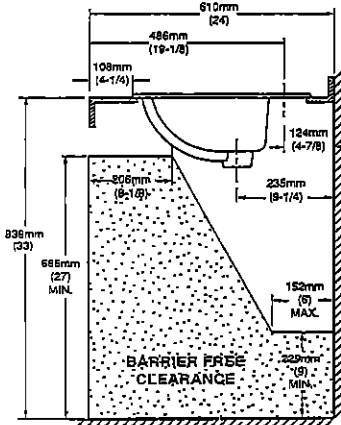
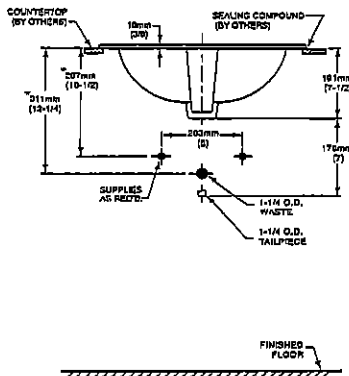
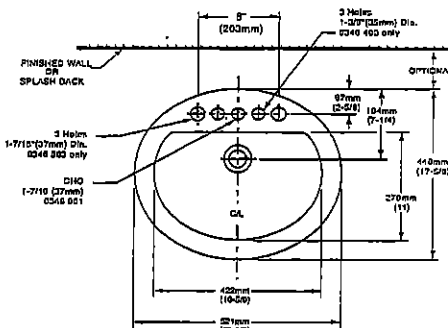
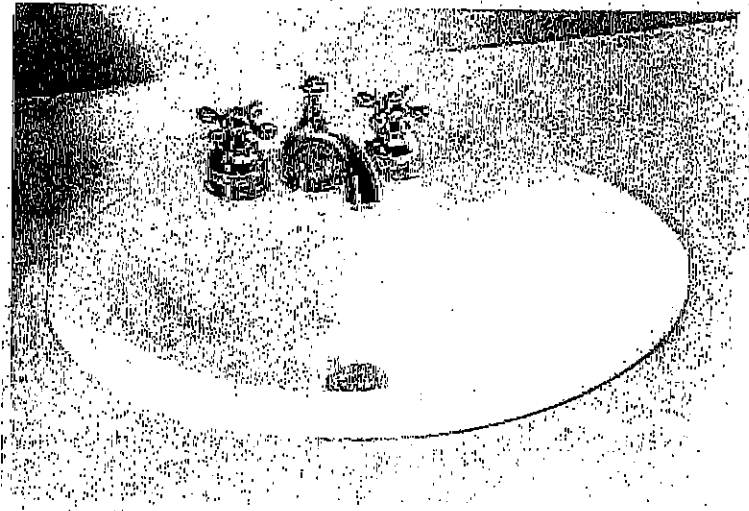

NOTES:  
\* DIMENSIONS SHOWN FOR LOCATION OF SUPPLIES AND "P" TRAP ARE SUGGESTED.  
FOR COUNTERTOP CUTOUT AND INSTALLATION INSTRUCTIONS USE TEMPLATE  
SUPPLIED WITH SINK.  
FAUCETS NOT INCLUDED AND MUST BE ORDERED SEPARATELY.  
IMPORTANT: Dimensions of fixtures are nominal and may vary within the range of tolerances  
established by ANSI Standard A112.19.2.  
These measurements are subject to change or cancellation. No responsibility is assumed for use  
of superseded or voided pages.

H.A.



C2-COUNTRY LANE  
LOT 53-1  
20-2447-UG ELEV B  
THE BARRINGTON

27 of 41



Demi CF2007



C2-COUNTRY LANE  
LOT 53-1  
20-2447-UG ELEV B  
THE BARRINGTON

28 of 41

## Chateau

Transitional

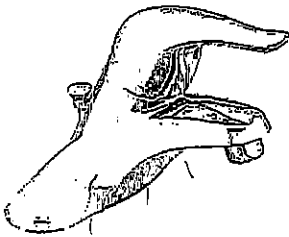

Lavatory Faucet with Pop-Up Drain  
Model L4621†

VANITY SINKS AND PEDESTAL

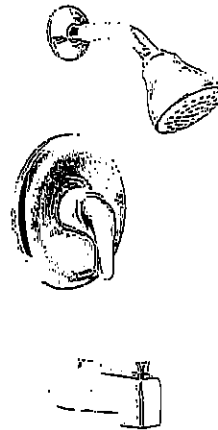

Posi-Temp® Pressure Balancing Tub/Shower  
Model 62320 / TL183†

OR

Posi-Temp Valve and Tub/Shower Trim  
with Eco-Performance Easy Clean® XL

Model 62320 / TL183EP†  
(TL183EP not available in BC)

SHOWER AND 5' TUB FAUCETS



2 Handle Roman Tub with 9" Spout  
Model 4796 / T990†

FREESTANDING TUB FAUCETS



Cyclone®

## SCB51430 Canopy Hood

### Alito Collection

Makes a statement of strength and power as the stainless steel frame gleams under your kitchen lights. It features baffle filters, tow bright LED lights in each corner, a three speed control panel, and a quiet, powerful motor. The bold design and strong stainless steel frame encasing the fan will make this machine the focus of your kitchen. Fitted with time-delay "OFF" options up to nine minutes.

#### Specifications

Air Flow Volume: 550 CFM

Colours: Stainless Steel

Dimensions: W:30" H:44.5" D:19.5"

Electrical Connection: 120V/60Hz

Electrical Consumption: 200 watts

Fan Speed: 1254 RPM

Sones: Min. at 2 and Max at 6

Venting: 6" Round (Top Only)

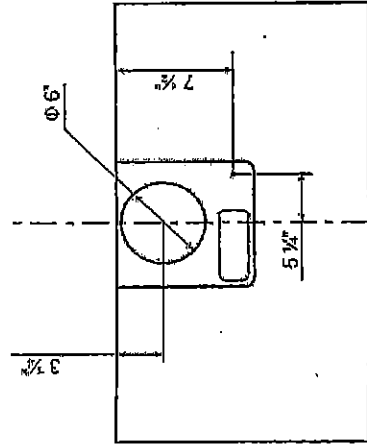

TOP

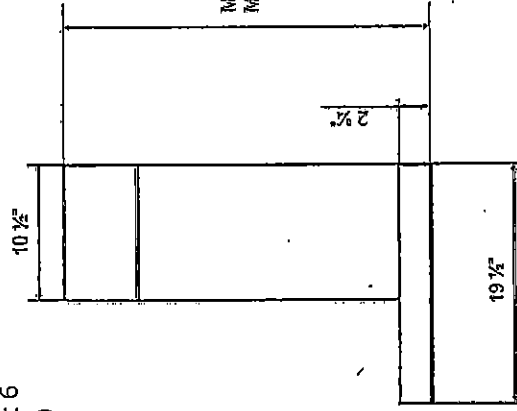

SIDE

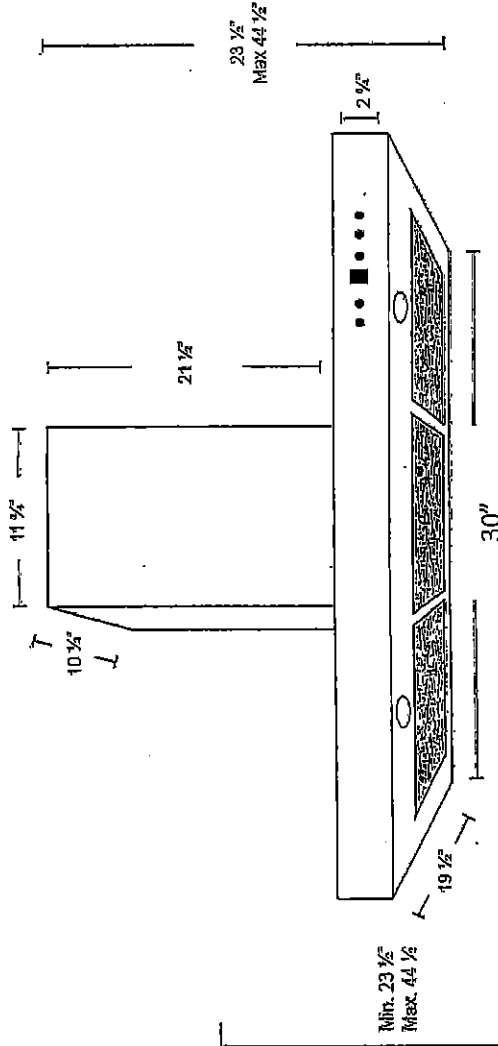

C2-COUNTRY LANE  
LOT 53-1  
20-2447-UG ELEV B  
THE BARRINGTON

29 OF 41



C2-COUNTRY LANE  
LOT 53-1  
20-2447-UG ELEV B  
THE BARRINGTON

30 of 41

**Whirlpool** Bottom Mount Refrigerator

**PRODUCT MODEL NUMBERS**

- WRF532SMB  
WRF535SMB
- WRF535SWB  
WRF540CWB

**Electrical:** A 115-volt, 60-Hz, AC-only, 15- or 20-amp fused, grounded electrical supply is required. It is recommended that a separate circuit serving only your refrigerator be provided. Use an outlet that cannot be turned off by a switch. Do not use an extension cord.

**NOTE:** Before performing any type of installation, cleaning, or removing a light bulb, turn the control (Thermostat, Refrigerator or Freezer Control depending on the model) to OFF and then disconnect the refrigerator from the electrical source. When you are finished, reconnect the refrigerator to the electrical source and reset the control (Thermostat, Refrigerator or Freezer Control depending on the model) to the desired setting. See "Using the Controls."

**Water:** A cold water supply with water pressure between 30 and 120 psi (207 and 827 kPa) is required to operate the ice maker and water dispenser. If you have questions about your water pressure, call a licensed, qualified plumber.

**IMPORTANT:** The pressure of the water coming out of a reverse osmosis system going to the water inlet valve of the refrigerator needs to be between 35 and 120 psi (241 and 827 kPa).

**Reverse Osmosis Water Supply:** If a reverse osmosis water filtration system is connected to your cold water supply, the water pressure to the reverse osmosis system needs to be a minimum of 40 to 60 psi (276 to 414 kPa).

**PRODUCT DIMENSIONS**

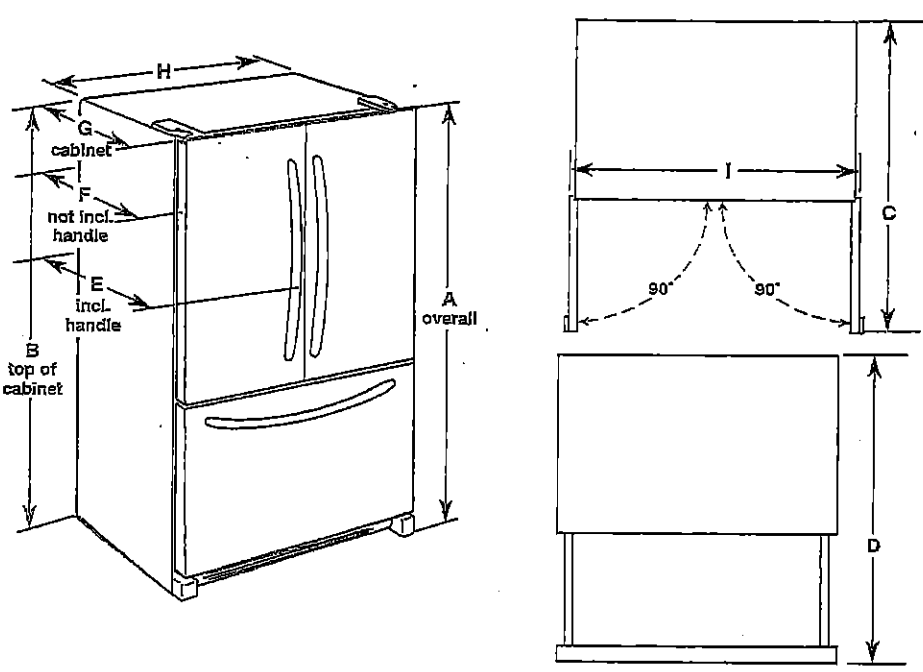

Model Number/Size	Height - Overall "A"	Height - Top of Cabinet "B"	Depth - Doors Open 90° "C"	Depth - Drawer Open "D"	Depth - With Handles "E"	Depth - Without Handles "F"	Depth - Cabinet Only "G"	Width - Cabinet "H"	Width - Door Open 90° "I"
WRF535SWB 25.2 cu. ft.	70 1/8" (178.1 cm)	68 3/8" (174.8 cm)	48 3/8" (122.1 cm)	53 3/8" (135 cm)	35 3/8" (90 cm)	32 3/8" (83.7 cm)	29" (74 cm)	35 3/8" (90.5 cm)	43 3/8" (110.2 cm)
WRF535SMB 25.2 cu. ft.	70 1/8" (178.1 cm)	68 3/8" (174.8 cm)	48 3/8" (122.1 cm)	53 3/8" (135 cm)	35 3/8" (90 cm)	32 3/8" (83.7 cm)	29" (74 cm)	35 3/8" (90.5 cm)	43 3/8" (110.2 cm)
WRF532SMB 22.1 cu. ft.	70 1/8" (178.1 cm)	68 3/8" (174.8 cm)	47 1/8" (119.5 cm)	52 1/8" (132.4 cm)	34 1/8" (87.5 cm)	31 1/8" (81.1 cm)	28 1/8" (71.4 cm)	32 1/8" (82.9 cm)	42 1/8" (107.6 cm)
WRF540CWB 20 cu. ft.	70 1/8" (178.1 cm)	68 3/8" (174.8 cm)	48" (121.9 cm)	44 1/8" (113.0 cm)	29 1/8" (74.6 cm)	28" (71.1 cm)	24 1/8" (61.3 cm)	35 3/8" (90.5 cm)	39 3/8" (100.0 cm)

**LOCATION REQUIREMENTS**

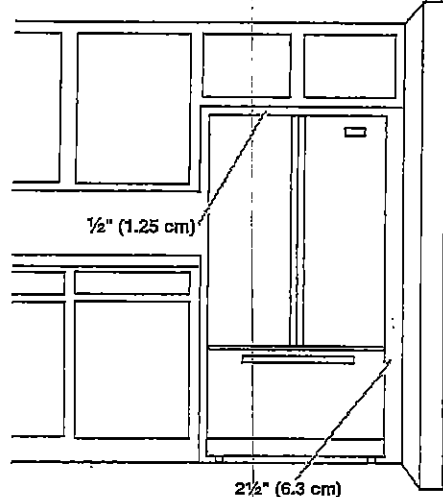

To ensure proper ventilation for your refrigerator, allow for a 1/2" (1.25 cm) space on each side and at the top. Allow for 1" (2.54 cm) of space behind the refrigerator. If your refrigerator has an ice maker, make sure you leave some extra space at the back for the water line connections.

If you are installing your refrigerator next to a fixed wall, leave 2 1/2" (6.3 cm) minimum on the hinge side (some models require more) to allow for the door to swing open.

**NOTE:** This refrigerator is intended for use in a location where the temperature ranges from a minimum of 55°F (13°C) to a maximum of 110°F (43°C). The preferred room temperature range for optimum performance, which reduces electricity usage and provides superior cooling, is between 60°F (15°C) and 90°F (32°C). It is recommended that you do not install the refrigerator near a heat source, such as an oven or radiator.

HA



C2-COUNTRY LANE  
LOT 53-1  
20-2447-UG ELEV B  
THE BARRINGTON

31 of 41

Whirlpool®

FRONT CONTROL  
GAS RANGES

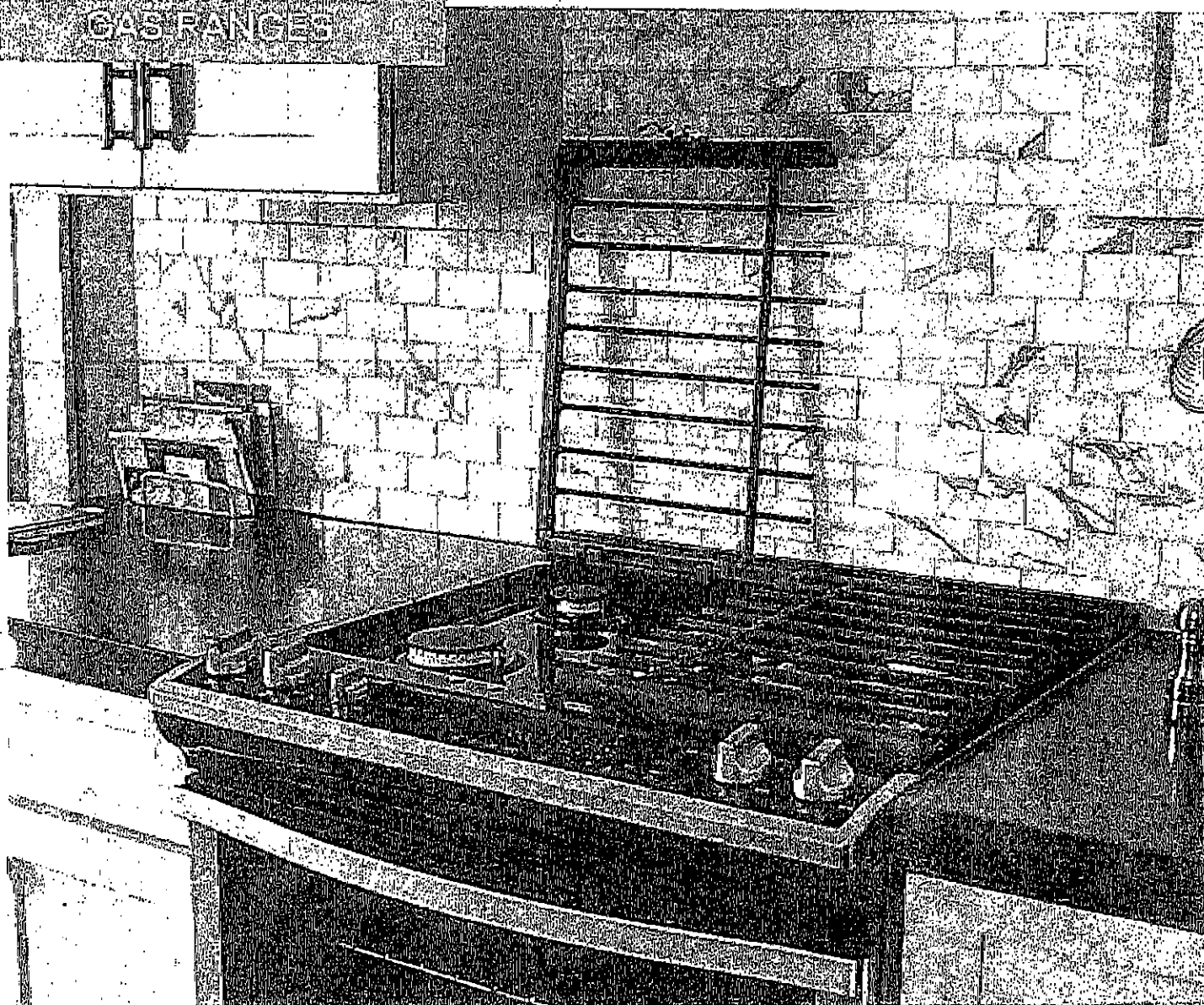

## FEATURING



### TimeSaver™ system

The TimeSaver™ system's Frozen Bake Technology allows you to skip preheating for favorites like pizza, lasagna, chicken nuggets, fries or pies so you can cook frozen foods faster.\*



### HeatRight™ system

The HeatRight™ system's True convection helps you to cook food faster\*\* with a rear fan and third heating element to circulate hot air over, under, and around food.



### CompleteClean™ system

The CompleteClean™ system's EZ-2-Lift™ hinged grates give you quick access to spills on the cooktop. The industry first hinged design allows you to wipe up under them without removing them entirely. For a more thorough clean, the grates are also dishwasher-safe.

# Every day, care.™

From the #1 Selling Appliance brand in the USA†

H-A



32 of 41

**WEG745HOF**

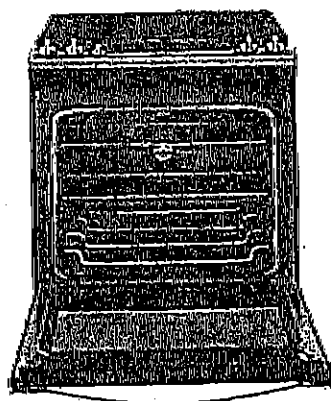

H.  
White,  
Pres.



ଶ୍ରୀ  
ଶ୍ରୀ  
ଶ୍ରୀ

This manual covers several models. Your model may appear different from the model's pictured. Consult your owner's manual for model-specific information.

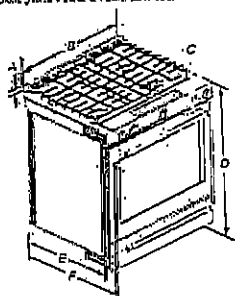

- |   |   |
|---|---|
| <p>A. 15-16 (12) and 16-17 (13) must come from 1st half of year</p> <p>B. 17-18 (13) and 18-19 (14)</p> <p>C. All 20 individual numbers above described learning to know about on the day right-hand side of the year forms</p> <p>D. 19-20 (14) and 20-21 (15) of 2012-13 and 2013-14 must be known by 18th Nov 2013</p> | <p>E. 21-22 (15) and 22-23 (16) must come from 2nd half of year</p> <p>F. 23-24 (16) and 24-25 (17) must come from 2nd half of year</p> |
|---|---|

IMPORTANT: Large sum of local stimulation for the functions in the  
"Large Range" section. Using it is also an indicator for having the camp in the  
recommended

**ജാലിയൻ വാള:**

10 This sample is history information on natural gas. See "Gas Conversion" section. If a residential rating plate located behind the control panel has information on the rating of your unit can be used. If the rating is not listed, do not provide the type of gas you use. Check with the local gas company.

LP 034 000-010000

Comparison must be done by a qualified service technician. An adjustment must be made to correct the appliance from the gas supplied at the model's original design place for use with a different gas without modifying the existing gas lines in. See "Gas Conversion" section.

[illegible]

IMPORTATION, including a large number of imported goods, particularly those for  
luxury, which are a large part of the country's trade. The Government has  
conducted a campaign to reduce the number of imports, and to  
reduce the number of imports to a level which is as low as possible.  
The Government has also conducted a campaign to reduce the number of  
imports, and to reduce the number of imports to a level which is as low as possible.

- [illegible]

[illegible]

- » Part number 8273888A Anti-Tip Kit for Range
- » Part number 4378577 Brick Baking Stone
- » Part number 4396923 Porcelain Broiler Pan & Grid
- » Part number W10123240 Premium Broil Pan & Roasting Rack
- » Part number 8003 Appliance Light Bulb - 40 Watt



**Whirlpool**

\*Compared to a traditional preheat and bake cycle for pizza, mugger/sfiza, plet and krapna. \*\*Compared to thermal-bake cycle on the same product using Balmain/Grill, Cooktop, Dishwasher, and Laundry appliances. TracFone, 2014.

© 2016 Whilpool. All rights reserved. S76. Form No. WCTEC0095



C2-COUNTRY LANE  
LOT 53-1  
20-2447-UG ELEV B  
THE BARRINGTON

33 of 41

Whirlpool® 30" (76.2 cm) Slide-in Gas Range

PRODUCT MODEL NUMBERS

WEG750H0D

WEG760H0D

WEG745H0F

GAS SUPPLY REQUIREMENTS

Gas supply line:

- Provide a gas supply line of 3/4" (1.9 cm) rigid pipe to the range location. A smaller size pipe on longer runs may result in insufficient gas supply. With LP gas, piping or tubing size can be 1/2" (1.3 cm) minimum. Usually, LP gas suppliers determine the size and materials used in the system.

NOTE: Pipe-joint compounds that resist the action of LP gas must be used. Do not use TEFLON® tape.

Flexible metal appliance connector:

- If local codes permit, a new CSA design-certified, 4 to 5 ft (122 to 152.4 cm) long, 1/2" (1.3 cm) or 3/4" (1.9 cm) I.D., flexible metal appliance connector may be used for connecting range to the gas supply line.



- A 1/2" (1.3 cm) male pipe thread is needed for connection to the female pipe threads of the inlet to the appliance pressure regulator.
- Do not kink or damage the flexible metal tubing when moving the range.
- Must include a shutoff valve:  
The supply line must be equipped with a manual shutoff valve. This valve should be located in the same room but external to the range opening, such as an adjacent cabinet. It should be in a location that allows ease of opening and closing. Do not block access to shutoff valve. The valve is for turning on or shutting off gas to the range.

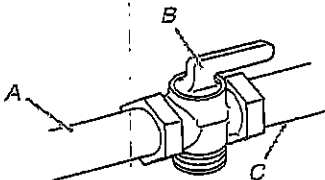

A. Gas supply line  
B. Shutoff valve "open" position  
C. To range

Gas Pressure Regulator

The gas pressure regulator supplied with this range must be used. The inlet pressure to the regulator should be as follows for proper operation:

Natural gas:

Minimum pressure: 5" WCP  
Maximum pressure: 14" WCP

LP gas:

Minimum pressure: 11" WCP  
Maximum pressure: 14" WCP

Contact local gas supplier if you are not sure about the inlet pressure.

PRODUCT DIMENSIONS

This manual covers several models. Your model may appear different from the models depicted. Dimensions given are maximum dimensions across all models.

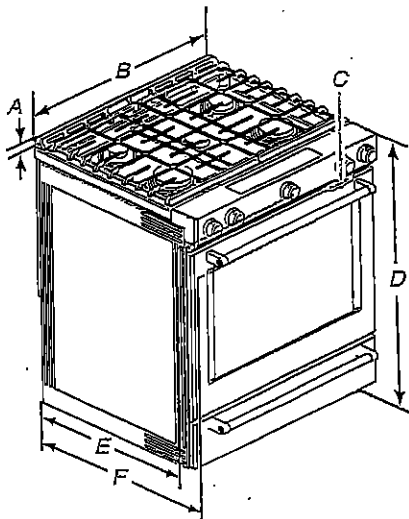

- A. 1 1/8" (3.0 cm) height from cooktop to top of vent
- B. 29 1/8" (75.9 cm)
- C. Model/serial number plate (located behind the oven door on the top right-hand side of the oven frame)
- D. 36" (91.4 cm) height to top of cooktop edge with leveling legs screwed all the way in
- E. 28 1/8" (71.9 cm) max. depth from front of console to back of range.
- F. 28 1/4" (73.3 cm) max. depth from handle to back of range.

IMPORTANT: Range must be level after installation. Follow the instructions in the "Level Range" section. Using the cooktop as a reference for leveling the range is not recommended.

\* Range can be raised approximately 1" (2.5 cm) by adjusting the leveling legs.

Type of Gas

Natural gas:

- This range is factory set for use with Natural gas. See "Gas Conversions" section. The model/serial rating plate located behind the control panel has information on the types of gas that can be used. If the types of gas listed do not include the type of gas available, check with the local gas supplier.

LP gas conversion:

Conversion must be done by a qualified service technician. No attempt shall be made to convert the appliance from the gas specified on the model/serial rating plate for use with a different gas without consulting the serving gas supplier. See "Gas Conversions" section.

®TEFLON is a registered trademark of Chemours.



C2-COUNTRY LANE  
LOT 53-1  
20-2447-UG ELEV B  
THE BARRINGTON

34 of 41

# Whirlpool® Undercounter Dishwasher

## PRODUCT MODEL NUMBERS

WDF110PAB	WDE310PLA	WDF530PSY
WDF111PAB	WDF320PAD	WDF540PAD
WDF120PAF	WDF310PAY	WDF730PAY
WDF121PAF	WDF520PAD	WDT710PAY
WDF310PAA	WDF530PAY	WDT720PAD
WDF310PCA	WDF530PLY	WDT770PAY

**Electrical Requirements:** 120-volt, 60-Hz, AC only, 15- or 20-amp. fused electrical supply. Copper wire only. A time delay fuse or circuit breaker and separate circuit is recommended.

**If direct wiring dishwasher:** Use flexible, armored, or nonmetallic, sheathed copper wire with grounding wire that meets the wiring requirements for your home and local codes and ordinances. Use a UL listed or CSA approved conduit connector.

**If connecting dishwasher with a power supply cord:** Use Power Supply Cord Kit (Part No. 4317824) marked for use with dishwashers. Follow the kit instructions for installing the power supply cord.

Power supply cord must plug into a grounded 3 prong, outlet, located in the cabinet next to the dishwasher opening. Outlet must meet all local codes and ordinances.

**Water Supply Requirements:** A hot water line with 20 to 120 psi (138 to 862 kPa) water pressure. Water temperature must be 120°F (49°C) water at dishwasher. Use 3/8" O.D. copper tubing with compression fitting or flexible braided water supply line (1/2" minimum plastic tubing is not recommended). Use a 90° elbow with 1/4"N.P.T. external pipe threads on one end. Do not solder within 6" (15.2 cm) from water inlet valve.

**Drain Requirements:** A new drain hose is supplied with your dishwasher. If this is not long enough, use a new drain hose with a maximum length of 12' (3.7 m) (Part No. 3385556) that meets all current AHAM/IAPMO test standards, is resistant to heat and detergent, and fits the 1" (2.5 cm) drain connector of the dishwasher.

Make sure to connect the drain hose to waste tee or disposer inlet above drain trap in house plumbing and 20" (50.8 cm) minimum above the floor. It is recommended

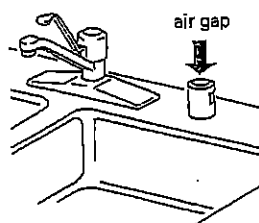

that the drain hose either be looped up and securely fastened to the underside of the counter or be connected to an air gap.

Make sure to use an air gap if the drain hose is connected to house plumbing lower than 20" (50.8 cm) above subfloor or floor.

Use 1/2" (1.3 cm) minimum I.D. drain line fittings.

If required, the air gap should be installed in accordance with the air gap installation instructions. When connecting the air gap, a rubber hose (not provided) will be needed to connect to the waste tee or disposer inlet.

## PRODUCT DIMENSIONS

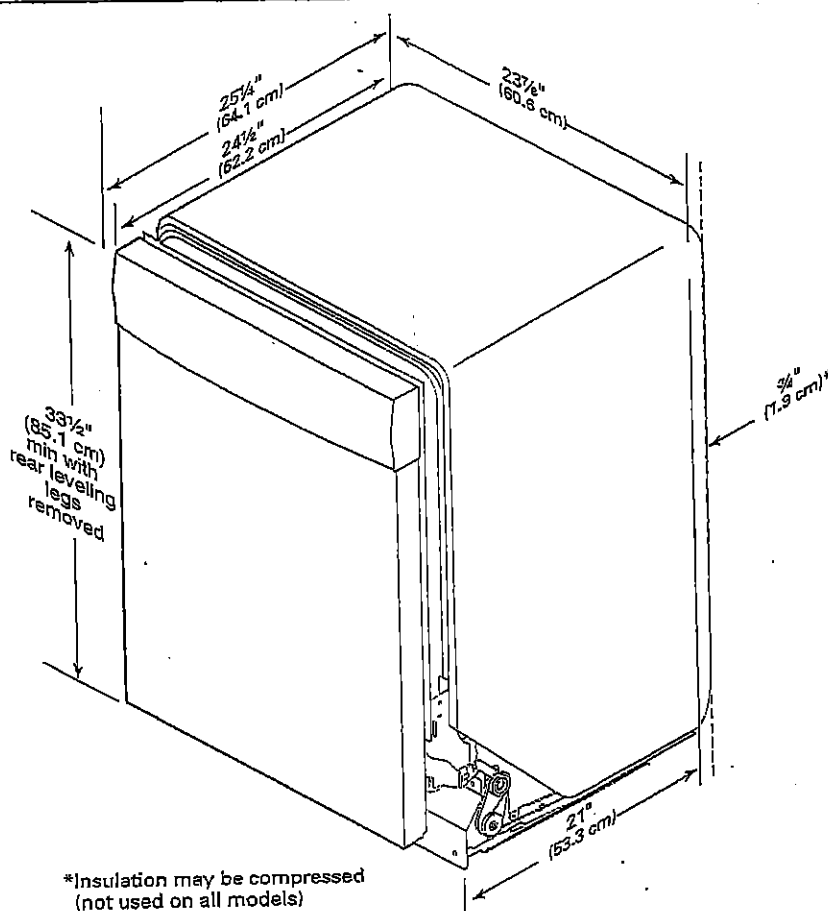

H-A

Because Whirlpool Corporation policy includes a continuous commitment to improve our products, we reserve the right to change materials and specifications without notice.

Dimensions are for planning purposes only. For complete details, see installation instructions packed with product. Specifications subject to change without notice.



C2-COUNTRY LANE  
 LOT 53-1  
 20-2447-UG ELEV B  
 THE BARRINGTON

35 of 41

CABINET CUTOUT DIMENSIONS

WDF320PDD

NOTE: Shaded areas of cabinet walls show where utility connections may be installed.

\*Measure from the lowest point on the underside of the countertop. May be reduced to 33½" (85.1 cm) by removing the rear leveling legs from dishwasher.

\*\*Minimum, measured from narrowest point of opening.

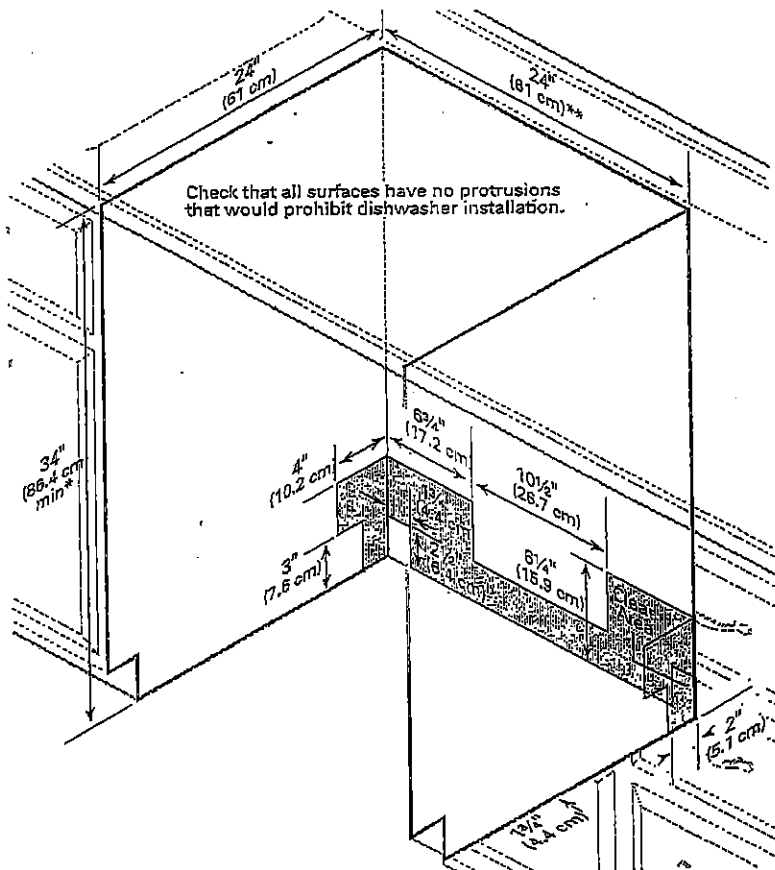

H-2



C2-COUNTRY LANE  
LOT 53-1  
20-2447-UG ELEV B  
THE BARRINGTON

36041

WHIRLPOOL WASHER Model #: WFW5620HW

Whirlpool Brand Canada English | Washer and Dryer | Washers | Front Load Washers | WFW5620HW

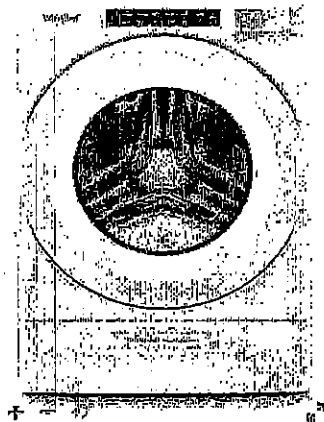

5.2 cu. ft. I.E.C. Closet-Depth  
Front Load Washer with  
Load & Go™ Dispenser



Whirlpool

5.2 cu. ft. I.E.C. Closet-Depth Front Load Washer with Load & Go™  
Dispenser

Model #: WFW5620HW

#### Dimensions

Depth	90.17 cm, 31-9/16 in
Depth With Door Open 90 Degree	143.51 cm, 56-1/2 in
Minimum Height	98.11 cm, 38-5/8 in
Width	68.58 cm, 27.0 in

#### Appearance

LCD Touch Screen	No
Window	Yes

#### Details

Drum Material	Stainless Steel
---------------	-----------------

#### Cycles and Options

Number of Wash Cycles	37
-----------------------	----

#### Electrical

Hz	60
Power Cord Included	Yes

Ⓢ

H.A.



C2-COUNTRY LANE  
LOT 53-1  
20-2447-UG ELEV B  
THE BARRINGTON

37 of 41

WHIRLPOOL WASHER Model #: WFW5620HW

## LOCATION REQUIREMENTS

Proper installation is your responsibility.

### You will need:

- A water heater set to 120°F (49°C).
- A grounded electrical outlet located within 6 ft (1.8 m) of power cord on back of washer.
- Hot and cold water faucets located within 4 ft (1.2 m) of hot and cold water fill valves on washer, and water pressure of 20–100 psi (137.9–689.6 kPa).
- A level floor with maximum slope of 1" (25 mm) under entire washer. Installing on carpet or surfaces with foam backing is not recommended.
- Floor must support washer's total weight (with water and load) of 315 lbs (143 kgs).

**IMPORTANT:** Do not install, store, or operate washer where it will be exposed to weather or in temperatures below 32°F (0°C). Water remaining in washer after use may cause damage in low temperatures. See "Washer Care" in your Use and Care Guide for winterizing information.

### Whirlpool Models\*

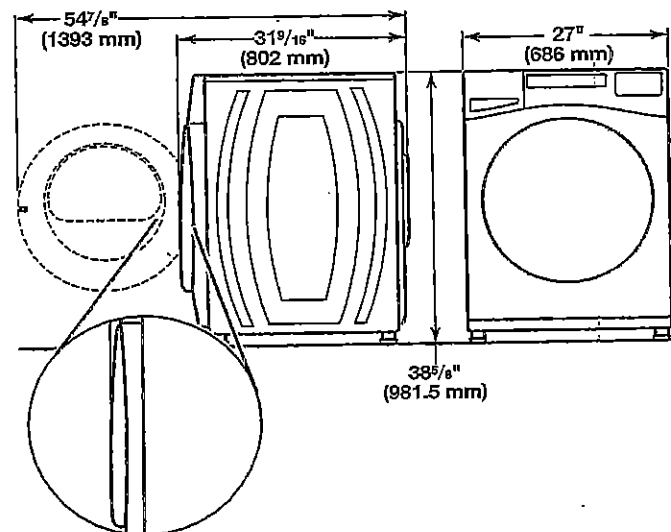
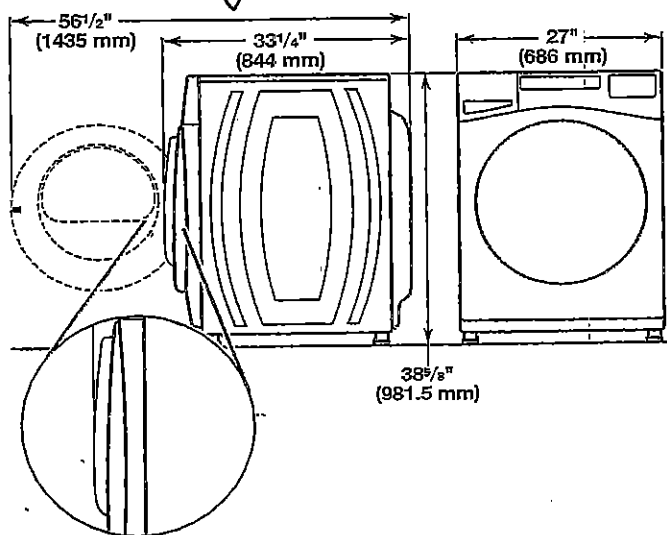

\*For additional details (or information) specific to your model, refer to the 'Dimensions' listed for your model at [www.whirlpool.com](http://www.whirlpool.com).

### Maytag Models

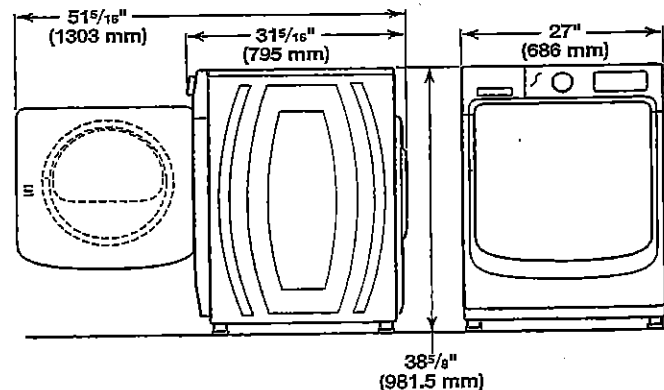
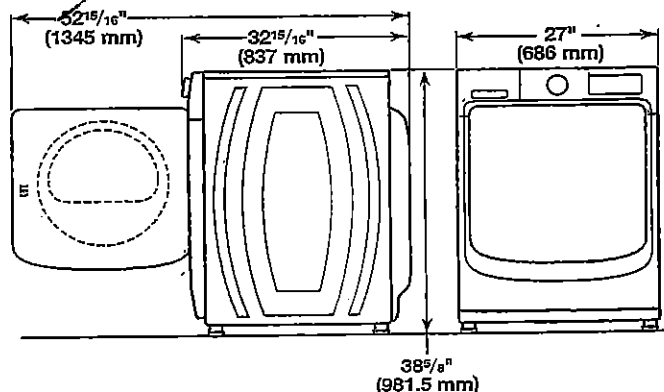

All dimensions show minimum spacing allowed.

For each arrangement, consider allowing more space for ease of installation and servicing, and spacing for companion appliances and clearances for walls, doors, and floor moldings.

Space must be large enough to allow door to fully open. Add spacing of 1" (25 mm) on all sides of washer to reduce noise transfer. If a closet door or louvered door is installed, top and bottom air openings in door are required.

### Recessed area or closet installation (stacked washer and dryer):

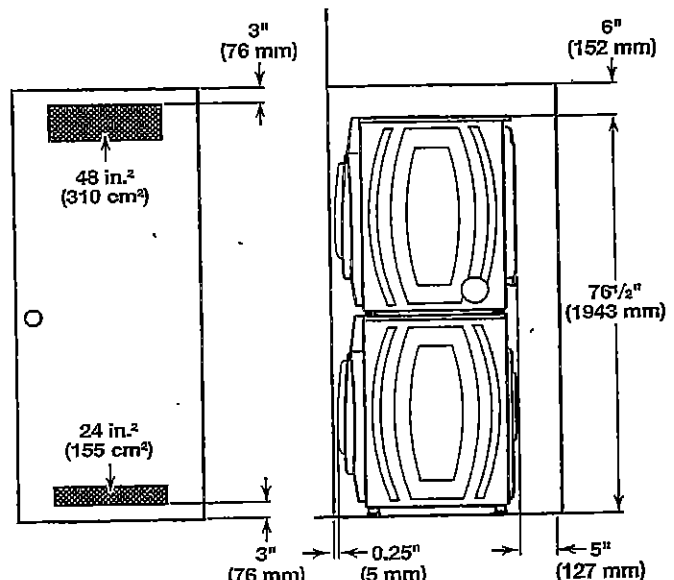

H-A



C2-COUNTRY LANE  
LOT 53-1  
20-2447-UG ELEV B  
THE BARRINGTON

38 of 41

WHIRLPOOL WASHER Model #: WFW5620HW

Custom under-counter installation:

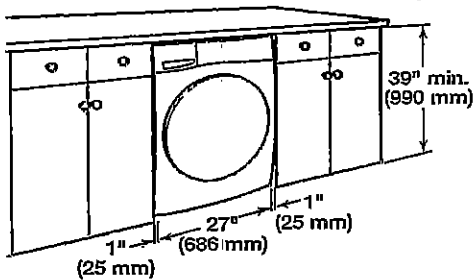

Recessed area or closet installation:

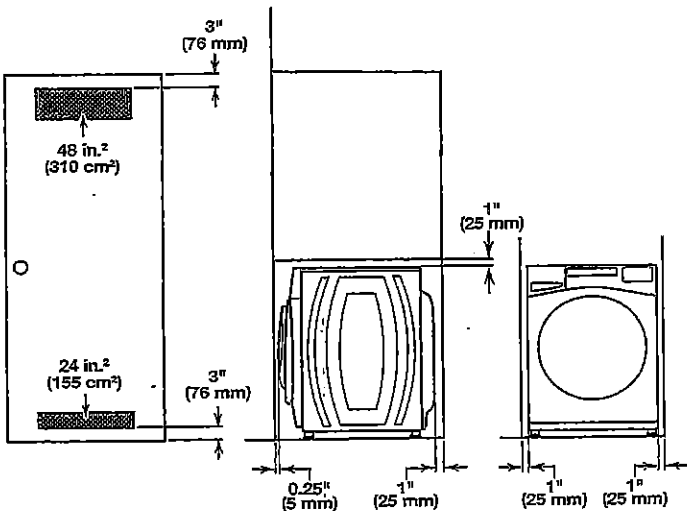

Custom cabinet installation:

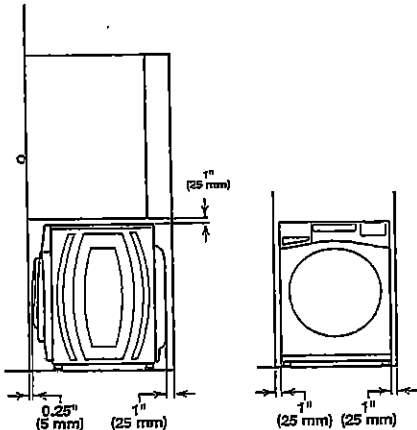

DRAIN SYSTEM

The drain system can be installed using a floor drain, wall standpipe, floor standpipe, or laundry tub. Select the method you need.

**IMPORTANT:** To avoid siphoning, only 4.5" (114 mm) of drain hose should be inside standpipe. Always secure drain hose with cable tie.

Floor standpipe drain system

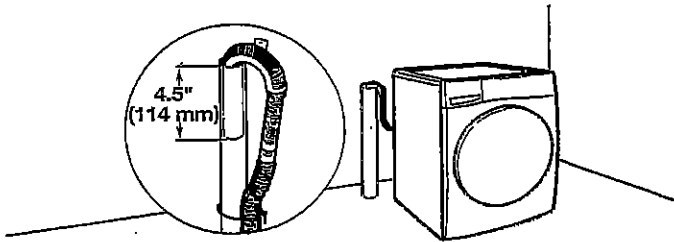

Minimum diameter for a standpipe drain: 2" (51 mm). Minimum carry-away capacity: 17 gal. (64 L) per minute. A 1/4" (6 mm) diameter to 1" (25 mm) diameter Standpipe Adapter Kit is available (Part Number 3363920). Top of standpipe must be at least 30" (762 mm) high; install no higher than 96" (2.44 m) from bottom of washer. If you have an overhead sewer and need to pump higher than 96" (2.44 m), a sump pump and associated hardware are needed. See "Alternate parts."

Wall standpipe drain system

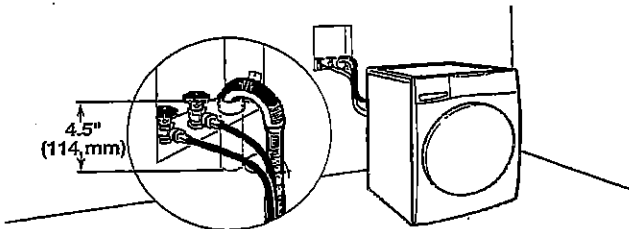

See requirements for floor standpipe drain system.

Laundry tub drain system

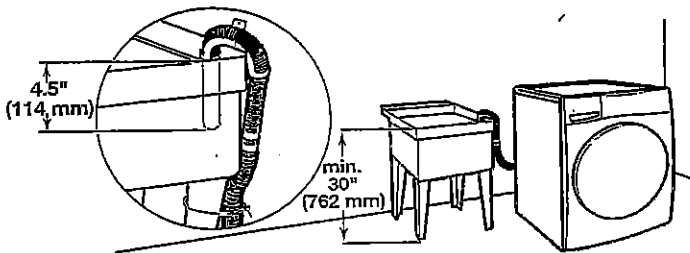

Minimum capacity: 20 gal. (76 L). Top of laundry tub must be at least 30" (762 mm) above floor; install no higher than 96" (2.44 m) from bottom of washer.

H-A



C2-COUNTRY LANE  
LOT 53-1  
20-2447-UG ELEV B  
THE BARRINGTON

39 of 41

WHIRLPOOL DRYER Model #: YWED5620HW

Whirlpool Brand Canada English | Washers and Dryers | Dryers | Electric Dryers | YWED5620HW

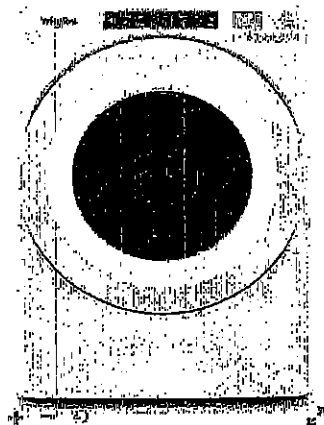

7.4 cu. ft. Front Load Electric  
Dryer with Intuitive Touch  
Controls



**Whirlpool** 7.4 cu. ft. Front Load Electric Dryer with Intuitive Touch Controls  
Model #: YWED5620HW

Dimensions

Depth	78.74 cm, 31.0 in
Depth With Door Open 90 Degree	133.43 cm, 54-1/2 in
Height	98.42 cm, 38-3/4 in
Width	68.53 cm, 27.0 in

Configuration and Overview

Fuel Type	Electric
-----------	----------

Cycles and Options

Cycle Time Remaining	Yes
Lint Filter Indicator	No
Number of Dryer Cycles	36
Number of Dryness Levels	2

Ventilation System

Long Vent	No
Maximum Vent Length	64
Venting Direction	Left, Right, Bottom, Rear

Electrical

Hz	60
Power Cord Included	Yes

46



C2-COUNTRY LANE  
LOT 53-1  
20-2447-UG ELEV B  
THE BARRINGTON

40 of 41

WHIRLPOOL DRYER Model #: YWED5620HW

Back view:

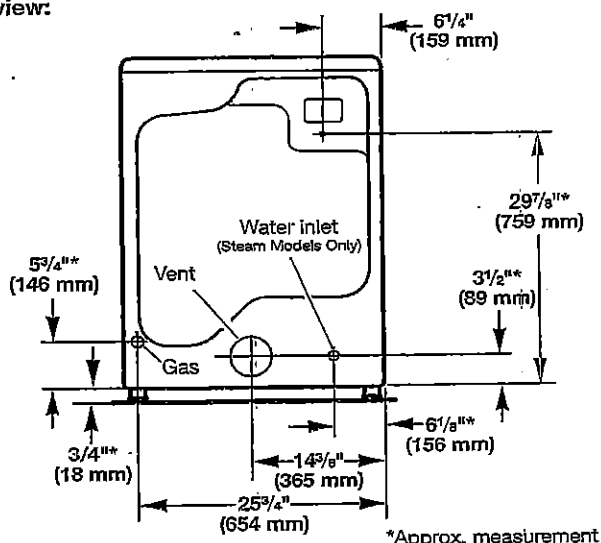

**NOTE:** Most installations require a minimum of 5" (127 mm) clearance behind dryer for exhaust vent with elbow. See "Venting Requirements."

#### Installation Clearances

For each arrangement, consider allowing more space for ease of installation and servicing, spacing for companion appliances, and clearances for walls, doors, and floor moldings. Space must be large enough to allow door to fully open. Add spacing on all sides of dryer to reduce noise transfer. If a closet door or louvered door is installed, top and bottom air openings in door are required.

Check code requirements. Some codes limit, or do not permit, installation of the dryer in garages, closets, mobile homes, or sleeping quarters. Contact your local building inspector.

**NOTE:** No other fuel-burning appliance can be installed in the same closet as a dryer.

#### Installation spacing for recessed area or closet installation

All dimensions show recommended and minimum spacing allowed.

- Additional spacing should be considered for ease of installation and servicing.
- Additional clearances might be required for wall, door, floor moldings, dryer venting, and gas line.
- Additional spacing should be considered on all sides of the dryer to reduce noise transfer.
- For closet installation with a door, minimum ventilation openings in the top and bottom of the door are required. Louvered doors with equivalent ventilation openings are acceptable.
- Companion appliance spacing should also be considered.

#### Recommended installation clearances (dryer only):

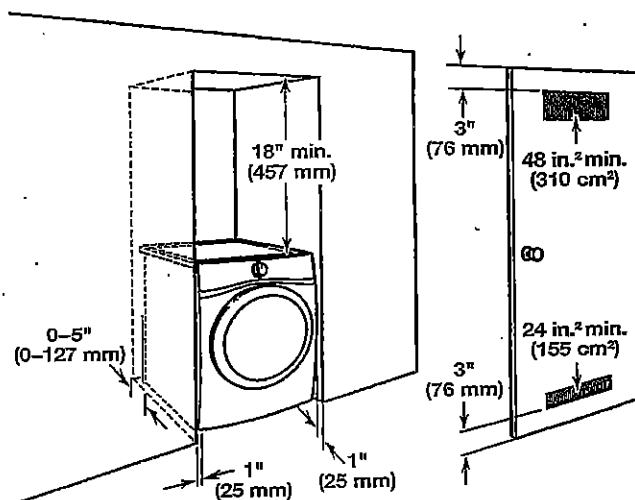

0" (0 mm) rear spacing is allowed for straight back venting only. For steam models only, inlet hose must not be kinked.

#### Custom under-counter installation:

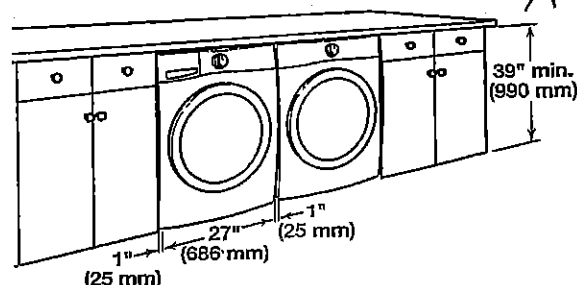

#### Mobile home - Additional installation requirements:

This dryer is suitable for mobile home installations. The installation must conform to the Manufactured Home Construction and Safety Standard, Title 24 CFR, Part 3280 (formerly the Federal Standard for Mobile home construction and Safety, Title 24, HUD Part 280) or Standard CAN/CSA-Z240 MH.

#### Mobile home installations require:

- Metal exhaust system hardware, available for purchase from your dealer. For further information, see "Assistance or Service" in your Use and Care Guide.
- Special provisions must be made in mobile homes to introduce outside air into dryer. Openings (such as a nearby window) should be at least twice as large as dryer exhaust opening.

#### For mobile home installation of gas dryers:

- Mobile Home Installation Hold-down Kit Part Number 346764 is available to order. For further information, see "Assistance or Service" in your Use and Care Guide.

H-A



C2-COUNTRY LANE  
LOT 53-1  
20-2447-UG ELEV B  
THE BARRINGTON

41 OF 41

WHIRLPOOL DRYER Model #: YWED5620HW

Additional parts may be required, depending on your installation. Check local codes. Check existing electrical supply and venting. Read "Electrical Requirements" and "Venting Requirements" before purchasing parts.

#### If using a power supply cord:

Use a UL Listed power supply cord kit marked for use with clothes dryers. The kit should contain:

- A UL Listed 30 amp power supply cord, rated 120/240 volt minimum. The cord should be type SRD or SRDT and be at least 4 ft. (1.22 m) long. The wires that connect to the dryer must end in ring terminals or spade terminals with upturned ends.
- A UL Listed strain relief.

#### Optional Equipment (not supplied with dryer):

Refer to your Use and Care Guide for information about accessories available for your dryer.

## LOCATION REQUIREMENTS

Check code requirements. Some codes limit, or do not permit, installing dryer in garages, closets, mobile homes, or sleeping quarters. Contact your local building inspector.

### ⚠ WARNING



#### Explosion Hazard

Keep flammable materials and vapors, such as gasoline, away from dryer.

Place dryer at least 18 inches (460 mm) above the floor for a garage installation.

Failure to do so can result in death, explosion, or fire.

#### You will need:

- A location allowing for proper exhaust installation. See "Venting Requirements."
- A separate 15 or 20 amp circuit for a gas dryer or 30 amp circuit for an electric dryer.
- If using power supply cord, a grounded electrical outlet located within 2 ft. (610 mm) of either side of dryer. See "Electrical Requirements."
- Floor must support dryer weight of 200 lbs. (90.7 kg). Also consider weight of companion appliance.
- Cold water faucets located within 4 ft. (1.2 m) of the water fill valves, and water pressure of 20–120 psi (138–827 kPa). You may use your washer's water supply by purchasing the necessary parts noted in "Parts needed."
- Level floor with maximum slope of 1" (25 mm) under entire dryer. If slope is greater than 1" (25 mm), install Extended Dryer Feet Kit, Part Number 279810. If not level, clothes may not tumble properly and automatic sensor cycles may not operate correctly.
- For garage installation, place dryer at least 18" (460 mm) above floor. If using a pedestal, you will need 18" (460 mm) to bottom of dryer.
- The dryer must not be installed or stored in an area where it will be exposed to water and/or weather.

**IMPORTANT:** Do not operate, install, or store dryer where it will be exposed to water, weather, or at temperatures below 40°F (4°C). Lower temperatures may cause dryer not to shut off at end of automatic sensor cycles, resulting in longer drying times.

## DRYER DIMENSIONS

Front view:

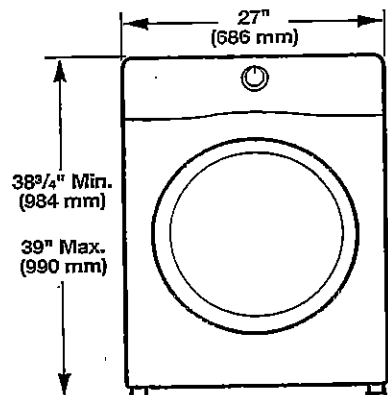

Side view:

Whirlpool Models

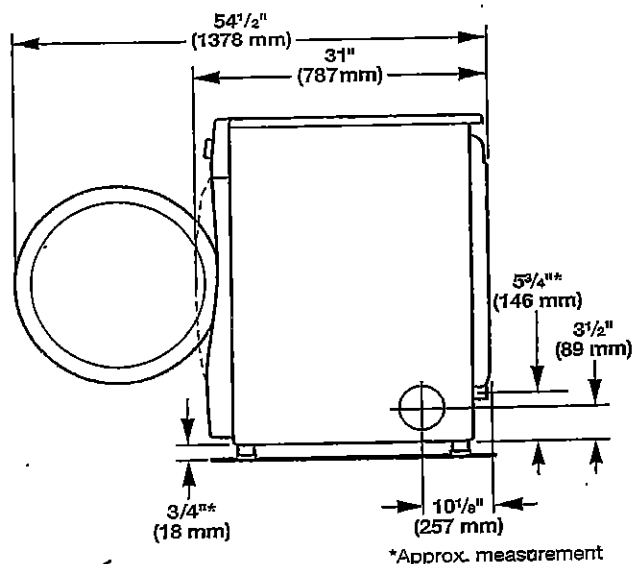

Maytag Models

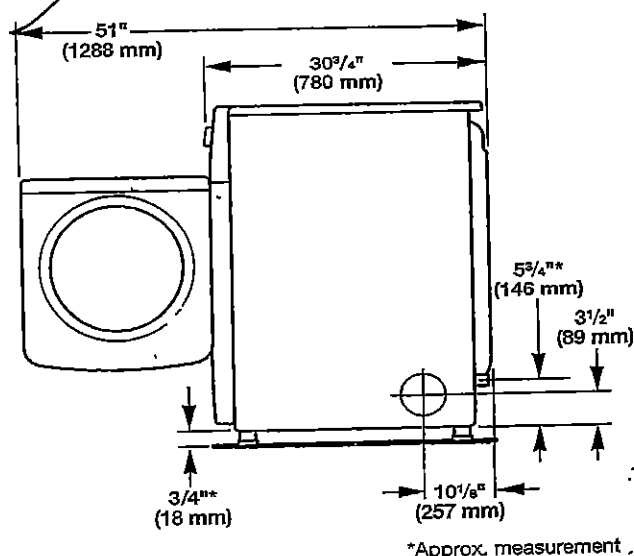

H-A