



14-Jun-21

Interior Finishing Selection Sheet

LOT 00543

20-2337-AL ELEV A THE SPRUCEWOOD

PURCHASERS: ANADVIR GILL
DIPALI-PATEL GILL

CONTACT NO: 647-300-4698

VENDOR: HEATHWOOD HOMES (WHITBY) LIMITED - PHASE 4

UPG

Appliances

6-8894 Kitchen HoodFan

CYCLONE 30" CANOPY CHIMNEY HOODFAN (Standard for Singles Only) STAINLESS STEEL SCB51430 STD PAGE 34

Cabinetry

122-9158 Finished Basement Bathroom Cabinet Colour/ Styles

SIMCOE NAVY BLUE Viking III STD 3DL

124-7672 Finished Basement Bathroom Cabinet Hardware

HARDWARE 135 STD

123-8796 Finished Basement Bathroom Countertop

Countertop PALOMA POLAR ETCHINGS FINISH 6698-46 Formica

150-6261 Kitchen/Servery Cabinet Colour/Style

MANCHESTER OYSTER CL Viking III MAPLE

152-2086 Kitchen/Servery Cabinet Hardware

HARDWARE 9677 STD

25-9111 Main Bathroom Cabinet Colour/Style

SIMCOE ORCHID VIKING III STD 3DL

29-7672 Main Bathroom Cabinet Hardware

HARDWARE 135 STD

20-9111 Master Ensuite Cabinet Colour/Style

SIMCOE ORCHID VIKING III STD 3DL

22-7672 Master Ensuite Cabinet Hardware

HARDWARE 135 STD

380-6261 Servery Opt. Uppers Cabinet Colour/Style

MANCHESTER OYSTER CL Viking III MAPLE

381-2086 Servery Opt. Uppers Cabinet Hardware

HARDWARE 9677 STD

Carpet

37-9248 Bedroom 2 Flooring

Dynasty Tex 40 oz Poly BLACK ICE DY 89418 STD

38-9248 Bedroom 3 Flooring

Dynasty Tex 40 oz Poly BLACK ICE DY 89418 STD

111-9248 Bedroom 4 Flooring

Dynasty Tex 40 oz Poly BLACK ICE DY 89418 STD

377-9248 Finished Basement Bedroom Flooring

Dynasty Tex 40 oz Poly BLACK ICE DY 89418 STD

285-9248 Finished Basement Rec/Hall Flooring

Dynasty Tex 40 oz Poly BLACK ICE DY 89418 STD

36-9248 Master Bedroom Flooring

Dynasty Tex 40 oz Poly BLACK ICE DY 89418 STD

52-1079 Throughout Underpad

Underpad 500 Series STD

Ceramics

125-9255 Finished Basement Bathroom Flooring

SEMPRE White Matte TR.SP.WHITE.1313 STD 13" x 13"

- The Purchaser acknowledges these selections are subject to the terms and conditions of the applicable Agreement of Purchase and Sale.
- The Purchaser acknowledges that the Vendor accepts no responsibility in the event the Vendor is unable to supply a selection. The Purchaser agrees to reselect from the currently available selections immediately upon request.
- The Vendor reserves the right to substitute above materials and equipment with that of equal or better quality.
- Purchaser acknowledges that items may not be exactly as shown. Variations from the Vendor's samples may occur in finished materials due to normal production processes. Vendor is not responsible for shade difference which may occur from different dye lots or wood grains. Variations from the Vendor's samples will occur with natural materials such as wood, marble, granite, hardwood and brick.
- The Vendor reserves the right to select Grout & Thresholds that best suits the Tile selected.
- Selections will not be processed unless signed by Heathwood Homes Head Office.
- The colour selections made on the Colour Chart are final and cannot be changed once submitted.
- The Purchaser has checked and acknowledges the accuracy of this Colour Chart.

14 June 2021 *[Signature]*

Date

Purchaser

[Signature]

Décor Consultant

14 June 2021 *[Signature]*

Date

Purchaser

Date

Purchaser

Date Approved: HEATHWOOD HOMES (WHITBY) LIMITED - PHASE 4



14-Jun-21

Interior Finishing Selection Sheet

LOT 00543

20-2337-AL ELEV A THE SPRUCEWOOD

PURCHASERS: ANADVIR GILL
DIPALI-PATEL GILL

CONTACT NO: 647-300-4698

VENDOR: HEATHWOOD HOMES (WHITBY) LIMITED - PHASE 4



UPG

Ceramics

- 126-2225 Finished Basement Bathroom Grout Grout (27) Silver STD
- 127-9020 Finished Basement Bathroom Wall Tile Weave White QT.WV.WHT.0810 STD 8 x 10 INSTALL STACKED HORIZONTALLY
- 128-2226 Finished Basement Bathroom Wall Tile Grout Grout (00) White STD
- 16-9242 Foyer Flooring Eterna Volkas Polished OV.ET.VLK.1224.PL UPG_5 12 x 24 SEE SKETCH # 5 PAGE 19 FOR 12 X 24 TILE DIRECTION
- 17-2222 Foyer Grout Grout (105) Driftwood STD
- 4-8637 Kitchen Backsplash Chess Bevelled Arctic White QT.CH.ARW.0412.BR UPG 3 4 x 12
- 5-2226 Kitchen Backsplash Grout Grout (00) White STD
- 66-9255 Laundry Room Flooring SEMPRE White Matte TR.SP.WHITE.1313 STD 13" x 13"
- 67-2225 Laundry Room Grout Grout (27) Silver STD
- 30-9106 Main Bathroom Flooring Madison Series White Matte GE.MD.WHT.1818.MT UPG 1 18" X 18" Matte
- 31-2225 Main Bathroom Grout Grout (27) Silver STD
- 112-9020 Main Bathroom Tub Wall Tile Weave White QT.WV.WHT.0810 STD 8 x 10 INSTALL STACKED HORIZONTALLY
- 113-2226 Main Bathroom Tub Wall Tile Grout Grout (00) White STD
- 23-9056 Master Ensuite Floor Tile Eterna Series Imperial Grey OV.ET.IGY.2424PL UPG 6 24" x 24" Polished
- 24-2225 Master Ensuite Floor Tile Grout Grout (27) Silver STD
- 73-8103 Master Ensuite Shower Floor Tile ONTARIO HEXAGON MATTE SNOW WHITE OD.ON.SWT.02.HEX.MT UPG_2
- 74-2226 Master Ensuite Shower Floor Tile Grout Grout (00) White STD
- 147-8923 Master Ensuite Shower Jamb(s) and Sill(s) Shower Jamb / Sill Thassos White STD
- 104-9018 Master Ensuite Shower Wall Tile Brick Series White Glossy TH.BR.WHT.0812.GL UPG_2 8 x 12 INSTALL STACKED HORIZONTALLY
- 105-2226 Master Ensuite Shower Wall Tile Grout Grout (00) White STD

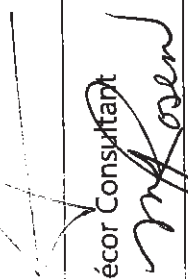
1. The Purchaser acknowledges these selections are subject to the terms and conditions of the applicable Agreement of Purchase and Sale.
2. The Purchaser acknowledges that the Vendor accepts no responsibility in the event the Vendor is unable to supply a selection. The Purchaser agrees to reselect from the currently available selections immediately upon request.
3. The Vendor reserves the right to substitute above materials and equipment with that of equal or better quality.
4. Purchaser acknowledges that items may not be exactly as shown. Variations from the Vendor's samples may occur in finished materials due to normal production processes. Vendor is not responsible for shade difference which may occur from different dye lots or wood grains. Variations from the Vendor's samples will occur with natural materials such as wood, marble, granite, hardwood and brick.
5. The Vendor reserves the right to select Grout & Thresholds that best suits the Tile selected.
6. Selections will not be processed unless signed by Heathwood Homes Head Office.
7. The colour selections made on the Colour Chart are final and cannot be changed once submitted.
8. The Purchaser has checked and acknowledges the accuracy of this Colour Chart.

14 June 2021  Purchaser Date June 14/21  Décor Consultant

14 June 2021  Purchaser Date 06-27-2021  Décor Consultant

Date Approved HEATHWOOD HOMES (WHITBY) LIMITED - PHASE 4



14-Jun-21

Interior Finishing Selection Sheet

LOT 00543

20-2337-AL ELEV A THE SPRUCEWOOD

PURCHASERS: ANADVIR GILL
DIPALI-PATEL GILL

CONTACT NO: 647-300-4698

VENDOR: HEATHWOOD HOMES (WHITBY) LIMITED - PHASE 4

Ceramics

190-5609 Mud Room Flooring

191-2222 Mud Room Grout

32-9242 Powder Room Flooring

33-2222 Powder Room Grout

378-8637 Servery Only Backsplash

379-2226 Servery Only Backsplash Grout

53-2232 Throughout Thresholds

Electrical

90-5796 Throughout Switches and Plug

Fireplace

136-8891 Great Room Fireplace Mantle

138-8874 Great Room Fireplace Surround

135-5529 Great Room Fireplace Type

Granite

151-8897 Kitchen/Servery Countertop

28-9069 Main Bathroom Countertop

21-8903 Master Ensuite Countertop

Hardwood

99-9011 Dining Room Flooring

11-9011 Great Room Flooring

156-9011 Kitchen/Servery/Breakfast Flooring

UPG

Sauble Grey GE.SU.GRY.1313 STD 13" X 13"

Grout (105) Driftwood STD

Eterna Volkas Polished OV.ET.VLK.1224.PL UPG_5 12 x 24
SEE SKETCH # 5
DIRECTION PAGE 9 FOR 12 X 24 TILE

Grout (105) Driftwood STD

Chess Bevelled Arctic White QT.CH.AR.W.0412.BR UPG 3 4 x 12

Grout (00) White STD

Metal Thresholds STD

Decora White Switches and Plugs STD

Paint Grade Mantle- Cabinet (Per Plan) WHITE NF-17 STD
PAGE 23

3 pc- 4" Marble Surround Grigio Carnico STD

36" Direct Vent Gas Fireplace

Quartz-Caesarstone ORGANIC WHITE # 4600 Group 4 UPG
3/4" with Mitered Edge

MSI Quartz ICED WHITE Group 1 STD 3/4"

Quartz-Caesarstone MISTY CARRERA # 4141 Group 4 UPG
3/4" with Mitered Edge

Vintage Red Oak Solid Sculpted Character PEARL PEWTER Red
Oak PEARL 3/4" x 5"

Vintage Red Oak Solid Sculpted Character PEARL PEWTER Red
Oak PEARL 3/4" x 5"

Vintage Red Oak Solid Sculpted Character PEARL PEWTER Red
Oak PEARL 3/4" x 5"

1. The Purchaser acknowledges these selections are subject to the terms and conditions of the applicable Agreement of Purchase and Sale.
2. The Purchaser acknowledges that the Vendor accepts no responsibility in the event the Vendor is unable to supply a selection. The Purchaser agrees to reselect from the currently available selections immediately upon request.

3. The Vendor reserves the right to substitute above materials and equipment with that of equal or better quality.
4. Purchaser acknowledges that items may not be exactly as shown. Variations from the Vendor's samples may occur in finished materials due to normal production processes. Vendor is not responsible for shade difference which may occur from different dye lots or wood grains. Variations from the Vendor's samples will occur with natural materials such as wood, marble, granite, hardwood and brick.

5. The Vendor reserves the right to select Grout & Thresholds that best suits the Tile selected.

6. Selections will not be processed unless signed by Heathwood Homes Head Office.

7. The colour selections made on the Colour Chart are final and cannot be changed once submitted.

8. The Purchaser has checked and acknowledges the accuracy of this Colour Chart.

14 June 2021

[Signature]

Date

Purchaser

Date APPROVED

Décor Consultant

14 June 2021

[Signature]

Date

Purchaser

Date Approved

HEATHWOOD HOMES (WHITBY)

LIMITED - PHASE 4



Interior Finishing Selection Sheet

14-Jun-21

LOT 00543

20-2337-AL ELEV A THE SPRUCEWOOD

PURCHASERS: ANADVIR GILL

CONTACT NO: 647-300-4698

DIPALI-PATEL GILL

VENDOR: HEATHWOOD HOMES (WHITBY) LIMITED - PHASE 4

UPG

Hardwood

- 98-9011 Main Hall Flooring Vintage Red Oak Solid Sculpted Character PEARL PEWTER Red Oak PEARL 3/4" x 5"
- 78-9011 Stair Landing to Lower Level Flooring Vintage Red Oak Solid Sculpted Character PEARL PEWTER Red Oak PEARL 3/4" x 5"
- 77-9011 Stair Landing to Upper Level Flooring Vintage Red Oak Solid Sculpted Character PEARL PEWTER Red Oak PEARL 3/4" x 5"
- 35-9011 Upper Hall Flooring Vintage Red Oak Solid Sculpted Character PEARL PEWTER Red Oak PEARL 3/4" x 5"

Interior Railings

- 49-8148 Stairs to Lower Level Handrail/Pickets/Posts Type Single Collar Alt. Plain w/ Shoes with 3 1/2" Square/Cap Post(s) BLACK METAL STD
- 43-8148 Stairs to Upper Level Handrail/Pickets/Posts Type Single Collar Alt. Plain w/ Shoes with 3 1/2" Square/Cap Post(s) BLACK METAL STD

Interior Stairs

- 45-1712 Stairs to Lower Level Type Oak Stairs UPG_1
- 39-1712 Stairs to Upper Level Type Oak Stairs UPG_1

Interior Trim

- 90-8704 Throughout Switches and Plug 5 1/4" Baseboards and 3" Integrated Backband Casings STD

Painting

- 46-7761 Stairs to Lower Level Colour Stain handrail, stringers, treads, risers, nosing & posts. (Metal pickets) STAIRS TO BE STAINED TO COMPLIMENT PEWTER HARDWOOD. STAIRS WILL VARY FROM FLOORS
- 40-7761 Stairs to Upper Level Colour Stain handrail, stringers, treads, risers, nosing & posts. (Metal pickets) STAIN STAIRS TO COMPLIMENT PEWTER HARDWOOD FLOORING. STAIRS WILL VARY FROM FLOORS
- 240-1716 Throughout Trim - Paint Colour Trim WHITE STD
- 51-1717 Throughout Walls - Paint Colour Wall WARM GREY 22 STD

Plumbing

- 268-1737 Finished Basement Bathroom Plumbing Fixture (Colour) Plumbing Fixtures WHITE STD

1. The Purchaser acknowledges these selections are subject to the terms and conditions of the applicable Agreement of Purchase and Sale.
2. The Purchaser acknowledges that the Vendor accepts no responsibility in the event the Vendor is unable to supply a selection. The Purchaser agrees to reselect from the currently available selections immediately upon request.
3. The Vendor reserves the right to substitute above materials and equipment with that of equal or better quality.
4. Purchaser acknowledges that items may not be exactly as shown. Variations from the Vendor's samples may occur in finished materials due to normal production processes. Vendor is not responsible for shade difference which may occur from different dye lots or wood grains. Variations from the Vendor's samples will occur with natural materials such as wood, marble, granite, hardwood and brick.
5. The Vendor reserves the right to select Grout & Thresholds that best suits the Tile selected.
6. Selections will not be processed unless signed by Heathwood Homes Head Office.
7. The colour selections made on the Colour Chart are final and cannot be changed once submitted.
8. The Purchaser has checked and acknowledges the accuracy of this Colour Chart.

14 June 2021

[Signature]

Date Purchaser

Date

Décor Consultant

14 June 2021

[Signature]

Date Purchaser

Date Approved HEATHWOOD HOMES (WHITBY) LIMITED - PHASE 4



Interior Finishing Selection Sheet

14-JUN-21

LOT 00543

20-2337-AL ELEV A THE SPRUCEWOOD

PURCHASERS: ANADVIR GILL
DIPALI-PATEL GILL

CONTACT NO: 647-300-4698

VENDOR: HEATHWOOD HOMES (WHITBY) LIMITED - PHASE 4

UPG

Plumbing

266-1737 Main Bathroom Plumbing Fixture (Colour)

Plumbing Fixtures WHITE STD

149-1737 Master Ensuite Plumbing Fixture (colour)

Plumbing Fixtures WHITE STD

34-1737 Powder Room Plumbing Fixture (Colour)

Plumbing Fixtures WHITE STD

1. The Purchaser acknowledges these selections are subject to the terms and conditions of the applicable Agreement of Purchase and Sale.
2. The Purchaser acknowledges that the Vendor accepts no responsibility in the event the Vendor is unable to supply a selection. The Purchaser agrees to reslect from the currently available selections immediately upon request.
3. The Vendor reserves the right to substitute above materials and equipment with that of equal or better quality.
4. Purchaser acknowledges that items may not be exactly as shown. Variations from the Vendor's samples may occur in finished materials due to normal production processes. Vendor is not responsible for shade difference which may occur from different dye lots or wood grains. Variations from the Vendor's samples will occur with natural materials such as wood, marble, granite, hardwood and brick.
5. The Vendor reserves the right to select Grout & Thresholds that best suits the Tile selected.
6. Selections will not be processed unless signed by Heathwood Homes Head Office.
7. The colour selections made on the Colour Chart are final and cannot be changed once submitted.
8. The Purchaser has checked and acknowledges the accuracy of this Colour Chart.

Date	14 June 2021	Purchaser	<i>[Signature]</i>	Date	14 June 2021	Décor Consultant	<i>[Signature]</i>
Date	14 June 2021	Purchaser	<i>[Signature]</i>	Date	14 June 2021	Décor Consultant	<i>[Signature]</i>

Date Approved: 14 June 2021 HEATHWOOD HOMES (WHITBY) LIMITED - PHASE 4



Sales Selection Sheet

14-Jun-21

LOT **00543** 20-2337-AL ELEV A THE SPRUCEWOOD

PURCHASERS: ANADVIR GILL CONTACT NO: 647-300-4698

DIPALI-PATEL GILL

VENDOR: **HEATHWOOD HOMES (WHITBY) LIMITED - PHASE 4** HST #

It is herein understood and agreed between the undersigned parties hereto that the following changes shall be made to the above mentioned Agreement of Purchase and Sale in accordance with the agreement and except for such changes noted below, all other terms and conditions in the Agreement of Purchase and Sale shall remain as stated herein: It is further understood that and agreed that all changes and additions shall be installed as per builder's specifications, location and available selections. The Purchaser hereby agrees to purchase the following extras:

AMOUNT:

Cabinetry

1362 **Optional Extras** **KITCHEN** Qty: 7.5

22B- Base Cabinet 30cm (12") deep price per foot (to fill in under flush breakfast bar) Before June 1, 2021 VIKING **SKETCH # 6 PAGE 20**

1338 **Optional Extras** **KITCHEN** Qty: 1

30H- Wall cabinet with shelf for microwave (finished interior) (opening 24"W x 13 3/4"H x 17"D) * electrical priced separately Before June 1, 2021 VIKING
SEE SKETCH # **6** PAGE **20** FOR LOCATION

1514 **Optional Upgrade** **Ldry Upper** Qty: 1

Optional Upgrade VIKING I/II/III **SKETCH # 8 PAGE 20**

1294 **Optional Extras** **MASTER** Qty: 2

11B- Bank of drawers (max. width 55cm) (size subject to floor plan) Before June 1, 2021 VIKING
SEE SKETCH # **8** PAGE **22** FOR LOCATION

1319 **Optional Extras** **MASTER** Qty: 2

04D- Increase vanity to kitchen height greater than 3' (90cm high, maintains vanity depth) Before June 1, 2021 VIKING
SEE SKETCH # **8** PAGE **22**

2369 **Optional Upgrade** **Servery Upper** Qty: 1

Optional Upgrade VIKING I/II/III **SKETCH # 5 AND 6 PAGES 19 AND 20**

Ceramics

- This Sales Selection Sheet when properly executed forms part of our Agreement of Purchase and Sale.
- All extras and upgrades listed above are subject to Construction Progress and Architectural and Municipal requirements.
- In the event the Vendor is unable to incorporate the work approved above in the construction of the house for any reason whatsoever, the Vendor will not be liable to the Purchaser in any way. The monies paid for any changes or optional extras not proceeded with shall be returned to the Purchaser, without interest. The cost of options or extras is non-refundable in all other circumstances. If for any reason whatsoever the Agreement of Purchase and Sale is not completed, the total cost of work approved above will be retained by the Vendor.
- The Vendor reserves the right to substitute above materials and equipment with that of equal or better quality.
- Purchaser acknowledges that items may not be exactly as shown. Variations from the Vendor's samples may occur in finished materials due to normal production processes. Vendor is not responsible for shade difference which may occur from different dye lots or wood grains. Variations from the Vendor's samples will occur with natural materials such as wood, marble, granite, hardwood and brick.
- The Vendor reserves the right to select Grout & Thresholds that best suits the Tile selected.
- Selections will not be processed unless signed by Heathwood Homes Head Office.
- The selections made on this schedule are final and cannot be changed once submitted.
- The Purchaser has checked and acknowledges the accuracy of this schedule.

14 June 2021 **APPROVED -** Décor Consultant

14 June 2021 **APPROVED -** Purchaser

Date Approved **HEATHWOOD HOMES (WHITBY) LIMITED - PHASE 4**



14-Jun-21

Sales Selection Sheet
1 of 2

LOT 00543

20-2337-AL ELEV A THE SPRUCEWOOD

PURCHASERS: ANADVIR GILL
DIPALI-PATEL GILL

CONTACT NO: 647-300-4698

VENDOR: HEATHWOOD HOMES (WHITBY) LIMITED - PHASE 4

HST #

It is herein understood and agreed between the undersigned parties hereto that the following changes shall be made to the above mentioned Agreement of Purchase and Sale in accordance with the agreement and except for such changes noted below, all other terms and conditions in the Agreement of Purchase and Sale shall remain as stated herein. It is further understood that and agreed that all changes and additions shall be installed as per builder's specifications, location and available selections. The Purchaser hereby agrees to purchase the following extras:



AMOUNT:



1856	Upgrade 5 Tile SEE SKETCH # 5 PAGE 19	FOR 12 X 24 TILE DIRECTION	Foyer Floor	Qty: 1
1863	Upgrade 3 Tile		Kit. Basplash	Qty: 1
1860	Upgrade 1 Tile		Main/Shrd Bath Floor	Qty: 1
1861	Upgrade 6 Tile		Master Bath Floor	Qty: 1
1854	Upgrade 2 Tile		Master Shower Shower Floor	Qty: 1
1853	Upgrade 2 Tile INSTALL STACKED HORIZONTALLY		Master Shower Wall	Qty: 1
2373	Upgrade 3 Tile		Optional Servery Basplash	Qty: 1
1857	Upgrade 5 Tile SEE SKETCH # 5 24 TILE DIRECTION		Powder Floor	Qty: 1

PAGE 19 FOR 12 X

Electrical

- This Sales Selection Sheet when properly executed forms part of our Agreement of Purchase and Sale.
- All extras and upgrades listed above are subject to Construction Progress and Architectural and Municipal requirements.
- In the event the Vendor is unable to incorporate the work approved above in the construction of the house for any reason whatsoever, the Vendor will not be liable to the Purchaser in any way. The monies paid for any changes or optional extras not proceeded with shall be returned to the Purchaser, without interest. The cost of options or extras is non-refundable in all other circumstances. If for any reason whatsoever the Agreement of Purchase and Sale is not completed, the total cost of work approved above will be retained by the Vendor.
- The Vendor reserves the right to substitute above materials and equipment with that of equal or better quality.
- The Purchaser acknowledges that items may not be exactly as shown. Variations from the Vendor's samples may occur in finished materials due to normal production processes. Vendor is not responsible for shade difference which may occur from different dye lots or wood grains. Variations from the Vendor's samples will occur with natural materials such as wood, marble, granite, hardwood and brick.
- The Vendor reserves the right to select Grout & Thresholds that best suits the Tile selected.
- Selections will not be processed unless signed by Heathwood Homes Head Office.
- The selections made on this schedule are final and cannot be changed once submitted.
- The Purchaser has checked and acknowledges the accuracy of this schedule.

14 June 2021  DATE APPROVED -  Décor Consultant

14 June 2021  DATE APPROVED -  Décor Consultant

Date Approved HEATHWOOD HOMES (WHITBY) LIMITED - PHASE 4

20-2337-AL ELEV A THE SPRUCEWOOD

LOT 00543

PURCHASERS: ANADVIR GILL CONTACT NO: 647-300-4698

DIPALI-PATEL GILL

VENDOR: HEATHWOOD HOMES (WHITBY) LIMITED - PHASE 4

HST #

It is herein understood and agreed between the undersigned parties hereto that the following changes shall be made to the above mentioned Agreement of Purchase and Sale in accordance with the agreement and except for such changes noted below, all other terms and conditions in the Agreement of Purchase and Sale shall remain as stated herein: It is further understood that and agreed that all changes and additions shall be installed as per builder's specifications, location and available selections. The Purchaser hereby agrees to purchase the following extras:

AMOUNT:

379 **Optional Extras** Qty: 1
 Extra wall interior outlet (120V/15A) on a Separate Circuit (on arcfault) Upg 1
 Before June 1, 2021
 SEE SKETCH # 6 PAGE 20 FOR LOCATION

Fireplace

81 Qty: 1
 Purchasers have been advised: heat from the FP can damage TV above a FP and items placed on mantle. Purchasers acknowledge: Heathwood Homes and its contractors will not be liable for any damage on items placed/installed above a FP after closing

Granite

849 **Optional Upgrade** Qty: 1
 Countertop 3/4" GROUP 4 with double edge
Kitchen/Servery

851 **Optional Upgrade** Qty: 1
 Countertop upgrade with 4" backsplash 3/4" GROUP 1 with single edge
Main Bathroom

850 **Optional Upgrade** Qty: 1
 Countertop upgrade with 4" backsplash 3/4" GROUP 4 with double edge
Master Ensuite

763 **Optional Extras** Qty: 4
MASTER ENSUITE/SHARED BATH

Hardwood

Granite cutout w/ straight edge polish to accommodate under mount vanity sink
 SINK SPEC PAGES 27 ADD 28

1. This Sales Selection Sheet when properly executed forms part of our Agreement of Purchase and Sale.
2. All extras and upgrades listed above are subject to Construction Progress and Architectural and Municipal requirements.
3. In the event the Vendor is unable to incorporate the work approved above in the construction of the house for any reason whatsoever, the Vendor will not be liable to the Purchaser in any way. The monies paid for any changes or optional extras not proceeded with shall be returned to the Purchaser, without interest. The cost of options or extras is non-refundable in all other circumstances. If for any reason whatsoever the Agreement of Purchase and Sale is not completed, the total cost of work approved above will be retained by the Vendor.
4. The Vendor reserves the right to substitute above materials and equipment with that of equal or better quality.
5. Purchaser acknowledges that items may not be exactly as shown. Variations from the Vendor's samples may occur in finished materials due to normal production processes. Vendor is not responsible for shade difference which may occur from different dye lots or wood grains. Variations from the Vendor's samples will occur with natural materials, such as wood, marble, granite, hardwood and brick.
6. The Vendor reserves the right to select Grout & Thresholds that best suits the Tile selected.
7. Selections will not be processed unless signed by Heathwood Homes Head Office.
8. The selections made on this schedule are final and cannot be changed once submitted.
9. The Purchaser has checked and acknowledges the accuracy of this schedule.

14 June 2021 *[Signature]* Purchaser
 Date **APPROVED** - *[Signature]* Décor Consultant
 14 June 2021 *[Signature]* Purchaser
 Date 07-27-2021 *[Signature]* M. Owen



14-Jun-21

Sales Selection Sheet
10 of

LOT 00543

20-2337-AL ELEV A THE SPRUCEWOOD

PURCHASERS: ANADVIR GILL

CONTACT NO: 647-300-4698

DIPALI-PATEL GILL

VENDOR: HEATHWOOD HOMES (WHITBY) LIMITED - PHASE 4

HST #

It is herein understood and agreed between the undersigned parties hereto that the following changes shall be made to the above mentioned Agreement of Purchase and Sale in accordance with the agreement and except for such changes noted below, all other terms and conditions in the Agreement of Purchase and Sale shall remain as stated herein: It is further understood that and agreed that all changes and additions shall be installed as per builder's specifications, location and available selections. The Purchaser hereby agrees to purchase the following extras:

AMOUNT:

1114 Vintage KIT / BREAK Qty: 1
Before June 1, 2021

Plumbing

268 Kitchen Sink Upgrade KITCHEN Qty: 1
Blanco Kitchen Sink Quatrus U 2 #401247 (32" x 18") Undermount 2 Bowl Equal Size
9" Deep in Stainless Steel Before June 1, 2021 PAGE 24

107 AMERICAN STANDARD - SINK OPTIONS - MAIN BATH Qty: 2
Undermount Sink
OVALYN Model 0496 221 020 (19 1/2" x 16 1/4") Before June 1, 2021 PAGE 28

318 Moen -METHOD MAIN BATHROOM Qty: 2
Chrome one-handle low arc bathroom faucet Single-Hole Faucet (no plate)-
(Model: 6810) Before June 1, 2021 PAGE 32

110 AMERICAN STANDARD - SINK OPTIONS - MASTER ENSUITE Qty: 2
Undermount Sink
BOXE - White - Model 0315 000 020 Before June 1, 2021 PAGE 27

161 Moen -CHATEAU MASTER ENSUITE/POWDER ROOM Qty: 3

2 Handle Widespread Lavatory Chrome Faucet with Pop-Up Drain (Model#4945) in lieu of standard single lever Before June 1, 2021 PAGE 31

Waffle Ceiling

497 Optional Extra Qty: 1
Install Waffle Ceiling in main floor great room Before June 1, 2021

1. This Sales Selection Sheet when properly executed forms part of our Agreement of Purchase and Sale.
2. All extras and upgrades listed above are subject to Construction Progress and Architectural and Municipal requirements.
3. In the event the Vendor is unable to incorporate the work approved above in the construction of the house for any reason whatsoever, the Vendor will not be liable to the Purchaser in any way. The monies paid for any changes or optional extras not proceeded with shall be returned to the Purchaser, without interest. The cost of options or extras is non-refundable in all other circumstances. If for any reason whatsoever the Agreement of Purchase and Sale is not completed, the total cost of work approved above will be retained by the Vendor.
4. The Vendor reserves the right to substitute above materials and equipment with that of equal or better quality.
5. Purchaser acknowledges that items may not be exactly as shown. Variations from the Vendor's samples may occur in finished materials due to normal production processes. Vendor is not responsible for shade difference which may occur from different dye lots or wood grains. Variations from the Vendor's samples will occur with natural materials such as wood, marble, granite, hardwood and brick.
6. The Vendor reserves the right to select Grout & Thresholds that best suits the Tile selected.
7. Selections will not be processed unless signed by Heathwood Homes Head Office.
8. The selections made on this schedule are final and cannot be changed once submitted.
9. The Purchaser has checked and acknowledges the accuracy of this schedule.

14 June 2021 [Signature] Purchaser
 Date: APPROVED - [Signature] Décor Consultant
 14 June 2021 [Signature] Purchaser
 Date: 14 June 2021 [Signature] Purchaser

Date Approved HEATHWOOD HOMES (WHITBY) LIMITED - PHASE 4



14-Jun-21

Sales Selection Sheet of 50

LOT 00543 20-2337-AL ELEV A THE SPRUCEWOOD

PURCHASERS: ANADVIR GILL CONTACT NO: 647-300-4698
 DIPALI-PATEL GILL

VENDOR: HEATHWOOD HOMES (WHITBY) LIMITED - PHASE 4 HST #

It is herein understood and agreed between the undersigned parties hereto that the following changes shall be made to the above mentioned Agreement of Purchase and Sale in accordance with the agreement and except for such changes noted below, all other terms and conditions in the Agreement of Purchase and Sale shall remain as stated herein. It is further understood that and agreed that all changes and additions shall be installed as per builder's specifications, location and available selections. The Purchaser hereby agrees to purchase the following extras:

AMOUNT:

1. This Sales Selection Sheet when properly executed forms part of our Agreement of Purchase and Sale.
2. All extras and upgrades listed above are subject to Construction Progress and Architectural and Municipal requirements.
3. In the event the Vendor is unable to incorporate the work approved above in the construction of the house for any reason whatsoever, the Vendor will not be liable to the Purchaser in any way. The monies paid for any changes or optional extras not proceeded with shall be returned to the Purchaser, without interest. The cost of options or extras is non-refundable in all other circumstances. If for any reason whatsoever the Agreement of Purchase and Sale is not completed, the total cost of work approved above will be retained by the Vendor.
4. The Vendor reserves the right to substitute above materials and equipment with that of equal or better quality.
5. Purchaser acknowledges that items may not be exactly as shown. Variations from the Vendor's samples may occur in finished materials due to normal production processes. Vendor is not responsible for shade difference which may occur from different dye lots or wood grains. Variations from the Vendor's samples will occur with natural materials such as wood, marble, granite, hardwood and brick.
6. The Vendor reserves the right to select Grout & Thresholds that best suits the Tile selected.
7. Selections will not be processed unless signed by Heathwood Homes Head Office.
8. The selections made on this schedule are final and cannot be changed once submitted.
9. The Purchaser has checked and acknowledges the accuracy of this schedule.

14 June 2021		Purchaser	14 June 2021		Decor Consultant
Date			Date		
14 June 2021		Purchaser	14 June 2021		Decor Consultant
Date			Date		

Date Approved HEATHWOOD HOMES (WHITBY)
 LIMITED - PHASE 4

C2-COUNTRY LANE
LOT 543
20-2337-AL-ELEV A
THE SPRUCEWOOD

18 of 50

The Sprucewood

20-2337 ALT ELEV. A

ELEVATION A: 3,027 SQUARE FEET
{ Includes 690 square feet of finished Lower Level }

Sketch # 4

WALL & CLOSET
DELETED →

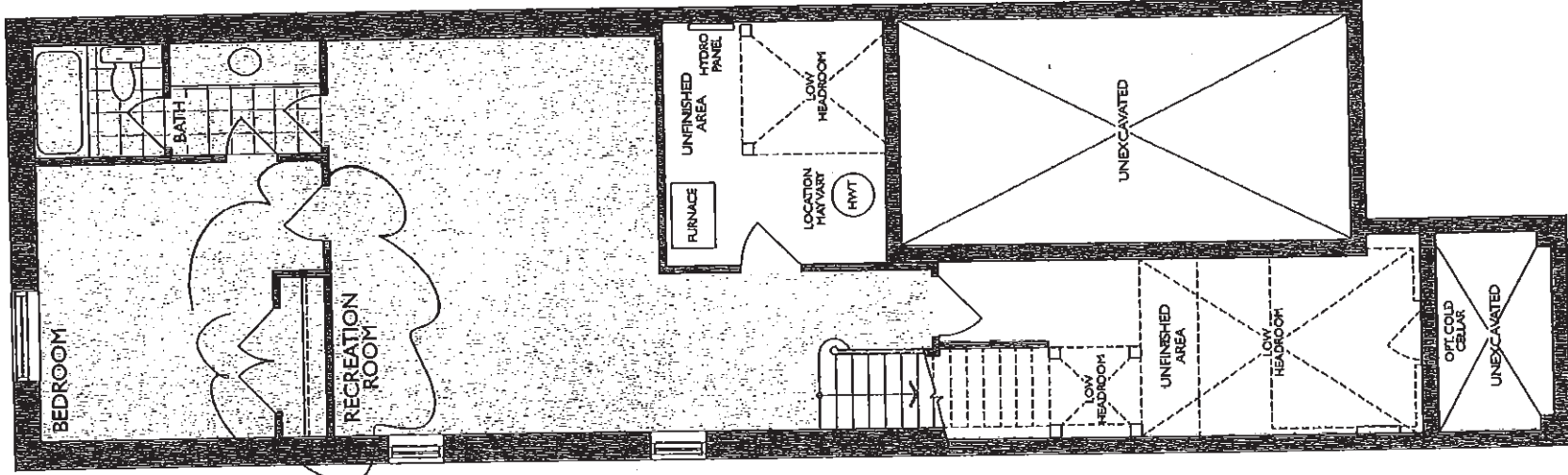

AL
BB

FINISHED LOWER LEVEL
ELEV. A & B

C2-COUNTRY LANE
LOT 543
20-2337-AL-ELEV A
THE SPRUCEWOOD

19 of 50 The Sprucewood

20-2337 ALT ELEV. A

ELEVATION A: 3,027 SQUARE FEET
{ Includes 690 square feet of finished Lower Level }

Sketch # 5

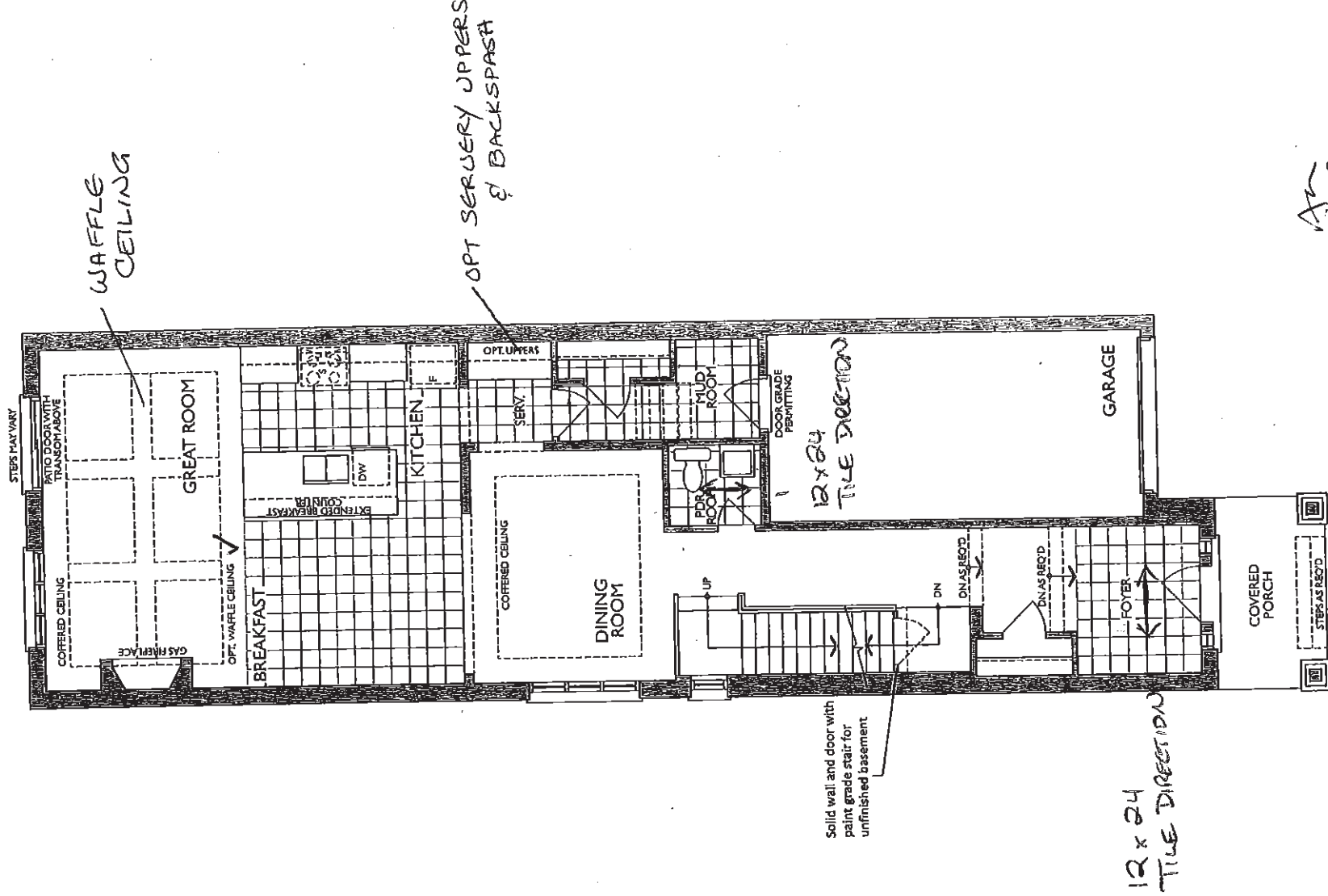

AR
OP

GROUND FLOOR
ELEV. A

C2-COUNTRY LANE
 LOT 543
 20-2337-AL-ELEV A
 THE SPRUCEWOOD



Heathwood
 Country Lane
 Mode
 20-2337 ALT. (2)
 The Classic

Standard Feature

- Tandem Box So
- Drawers
- Blumotion Hing
- Crown Mouldin
- Top Drawer Co
- Deep Fridge Uf
- W/Deep Panel
- Tall upper Cabine

20 of 50

Drawn By: Sepideh B

Date: May 23, 2019

Revision:

Scale: Not To Scale

Approved By Builder:

Date:

Sketch #6

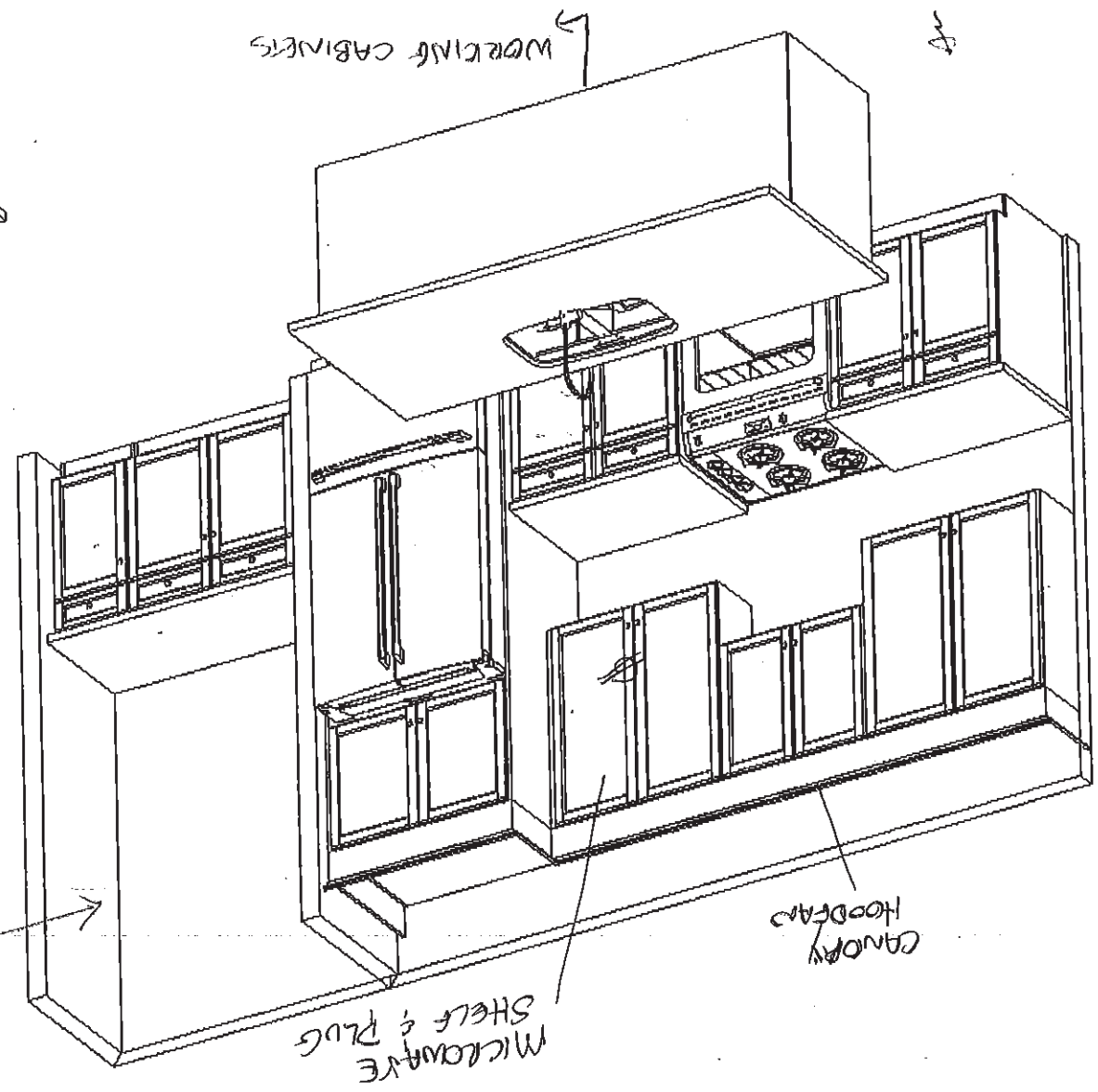
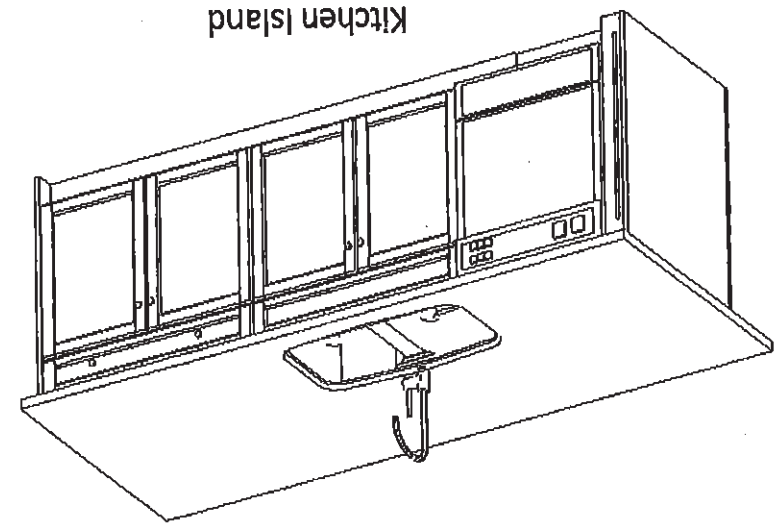

This sketch is for DESIGN PURPOSES ONLY - It is not meant to

Kitchen-The Classic Series

C2-COUNTRY LANE
LOT 543
20-2337-AL-ELEV A
THE SPRUCEWOOD

21 of 50

The Sprucewood

20-2337 ALT ELEV. A

ELEVATION A: 3,027 SQUARE FEET
{ Includes 690 square feet of finished Lower Level }

Sketch #7

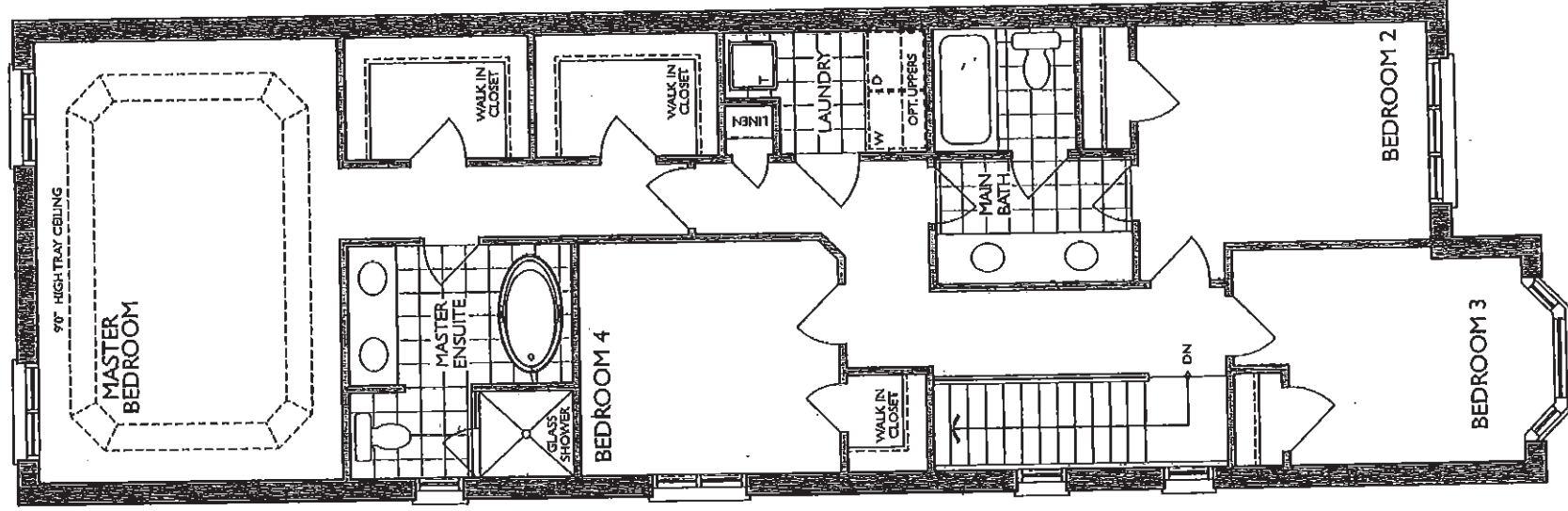

As
Rep

SECOND FLOOR
ELEV. A

C2-COUNTRY LANE
 LOT 543
 20-2337-AL-ELEV A
 THE SPRUCEWOOD



Heathwood
 Country Lane
 Mod
 20-2337 ALT. (The Classic)

- Standard Features:
- Blum Metabox
 - Blum Clip On Front
 - Top drawer in
 - Ensuite

22 of 50

Drawn By: Sepideh B
 Date: May 23, 2019
 Revision:
 Scale: Not To Scale

Approved By Builder:

Date:

Vanities & Laundry - The Classic Series

Sketch #8

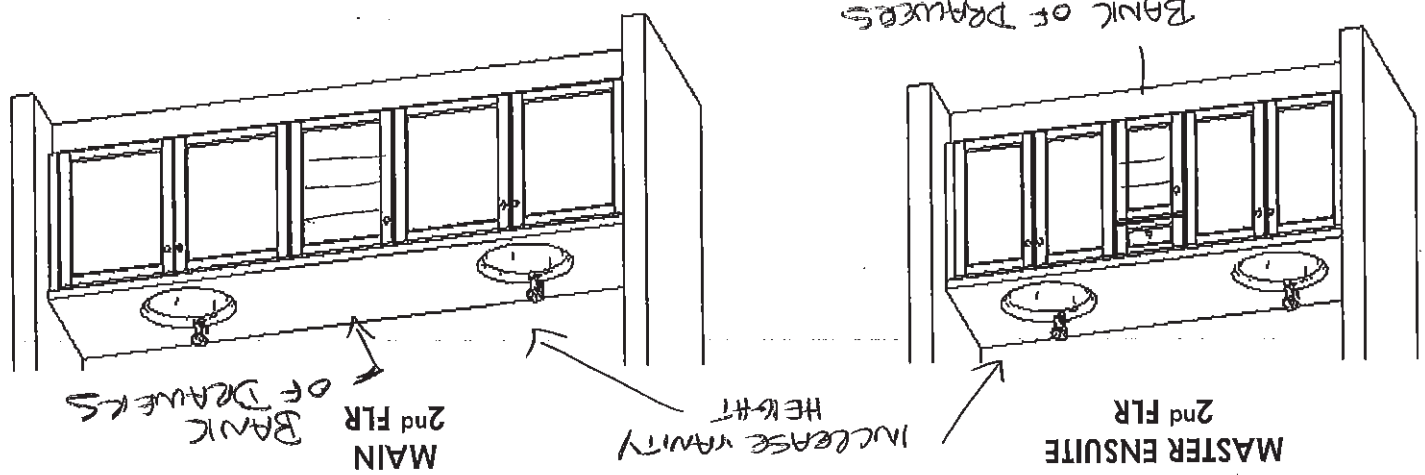
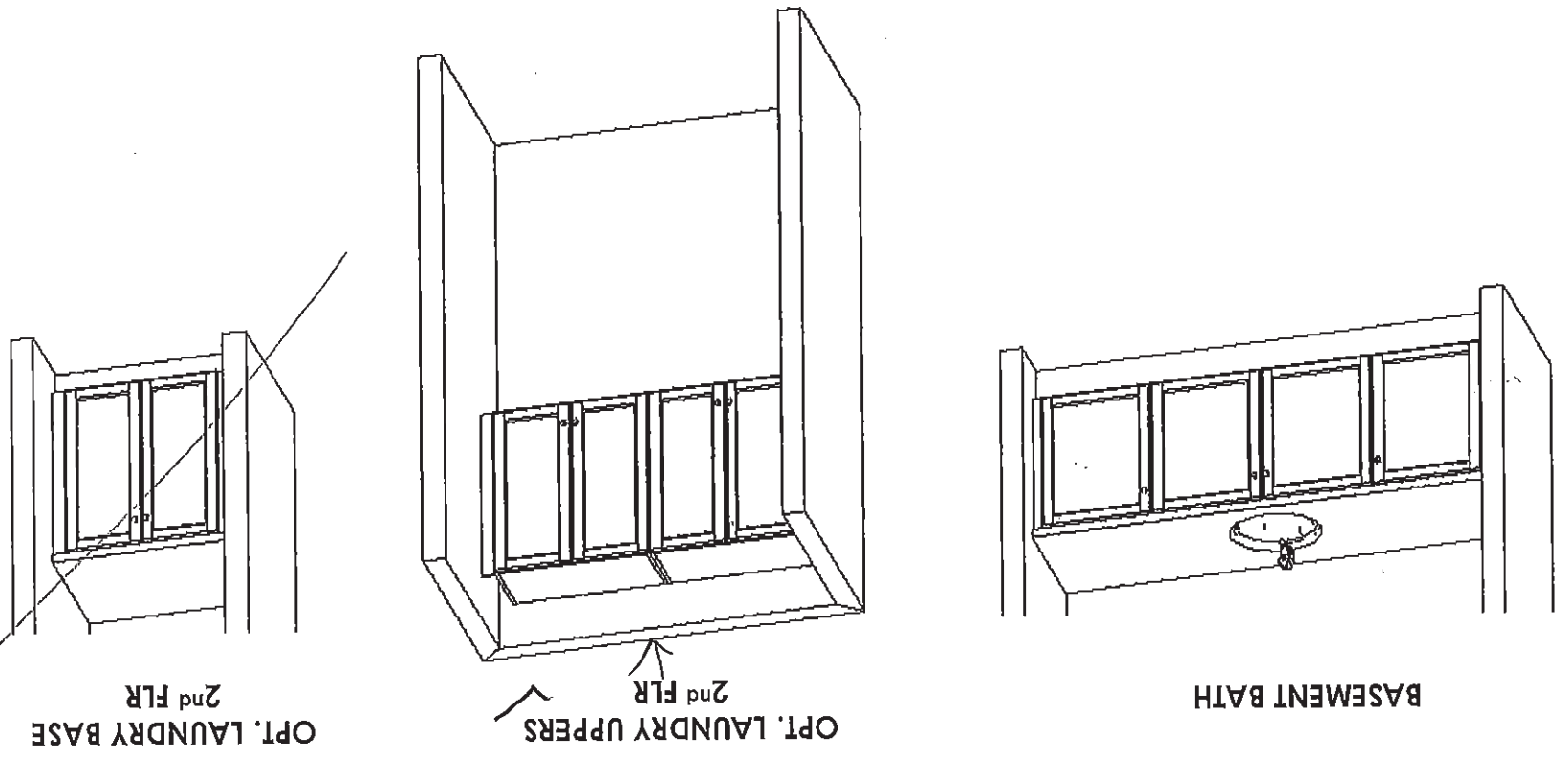

AK
 RB

This sketch is for DESIGN PURPOSES ONLY - It is not meant to be an exact rendition

C2-COUNTRY LANE
LOT 543
20-2337-AL-ELEV A
THE SPRUCEWOOD

23 of 50

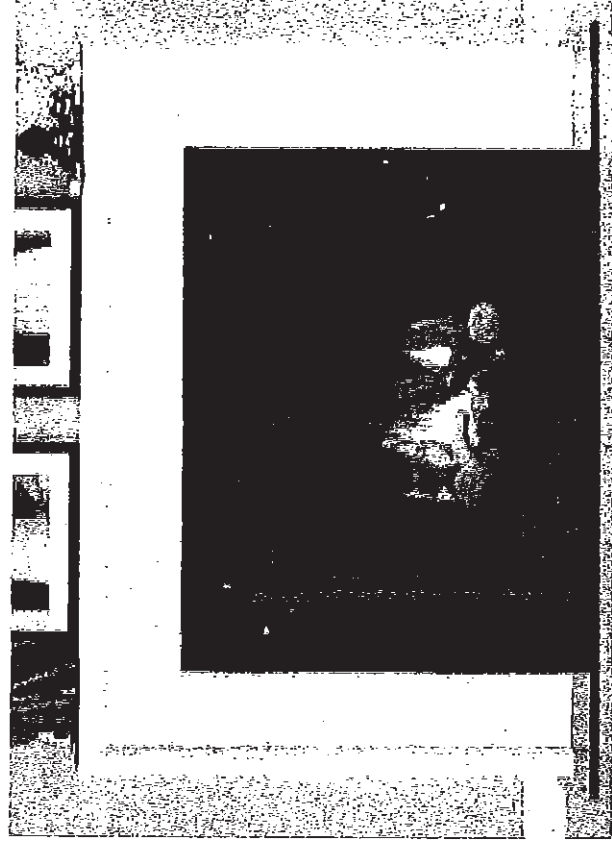

CABINET

NEAS NF17 Mantel

Ar
APP

C2-COUNTRY LANE
LOT 543
20-2337-AL-ELEV A
THE SPRUCEWOOD

24 of 50

BLANCO

BLANCO QUATRUS U2 Stainless Steel Undermount Sink

This new German-engineered sink from BLANCO features 9-inch bowl depths and zero-radius bowl corners. Made of durable 18 gauge stainless steel.

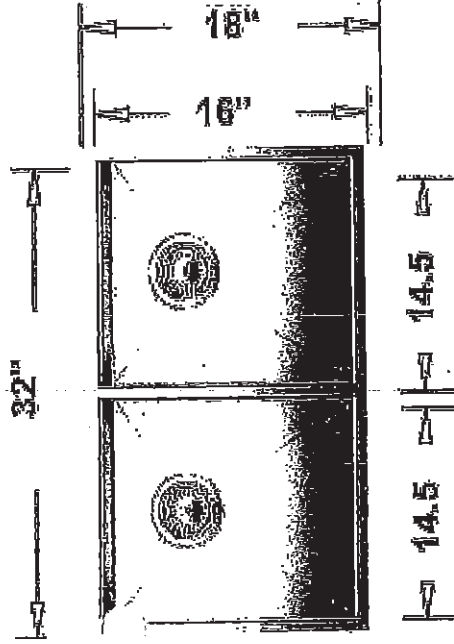
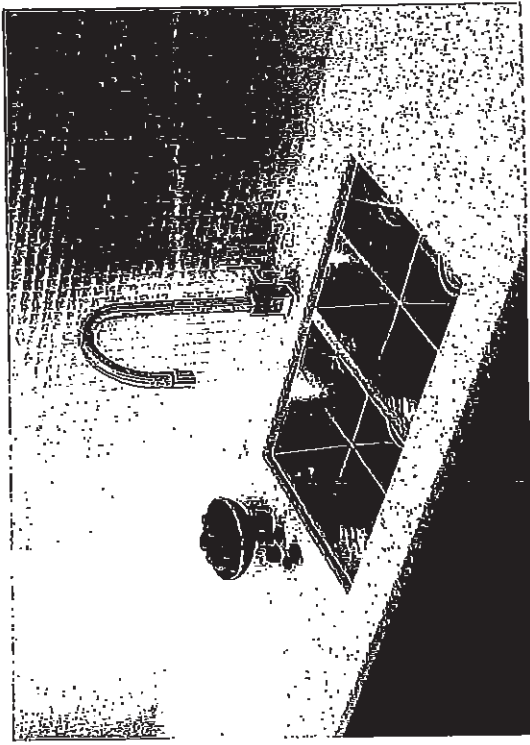

Model No.
401247

Min. Cabinet Depth
9" (230 mm)

Min. Cabinet Depth
9" (230 mm)

Material

Durable 18 gauge stainless steel
Brushed finish

Specifications

Minimum Cabinet Size: 33" (840 mm)

Undermount installation

Rear positioned drain holes for maximum usable bowl and cabinet storage space

Zero-radius corners and x-pattern drain grooves

Sound deadening system included

Template included

3 1/2" stainless steel strainers included

Accessories

Stainless Steel Grid

224403

BLANCO CANADA INC.
100 Corporation Drive, Brampton, ON L4V 1R3
Tel: 905-494-2400 Toll Free: 1-877-425-2626
Fax: 905-494-2425 Toll Free: 1-877-825-2626
www.blancocanada.com

AS
BB

C2-COUNTRY LANE
LOT 543
20-2337-AL-ELEV A
THE SPRUCEWOOD

25 of 50

STANDARD KITCHEN FAUCET

Align
Modern

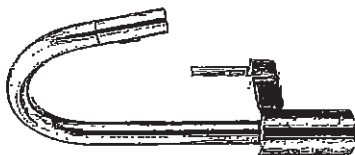

Single Handle Pull-Down Kitchen
Faucet*

Model 7565+

for
RSP

C2-COUNTRY LANE
LOT 543
20-2337-AL-ELEV A
THE SPRUCEWOOD

26 of 50

*American
Standard*

**BOULEVARD®
PEDESTAL SINK**
VITREOUS CHINA

BOULEVARD® PEDESTAL SINK

- 0641.800 Faucet holes on 8" (203mm) centers (illustrated).
- 0641.400 Faucet holes on 4" (102mm) centers
- 0641.100 Center hole only
 - Classic styled rectangular pedestal lavatory
 - Vitreous china
 - Rear overflow
 - Supplied with mounting kit
 - Right Height® for greater comfort during use
 - Faucet ledge with large deck area (faucet not included)
 - Design coordinates with Boulevard® Toilet
 - Basin has flat bottom to also allow use as an above counter sink or a drop-in sink (with u-shaped cut out)

Nominal Dimensions:

24" x 19" x 35-1/2"
(610 x 483 x 902mm)

- 0641.008 Pedestal top-8" (203mm) centers
- 0641.004 Pedestal top-4" (102mm) centers
- 0641.001 Pedestal top-center hole only
- 0010.000 Pedestal only

Bowl sizes:

17" (432mm) wide,
12-1/2" (318mm) front to back,
5" (127mm) deep

Compliance Certifications *

Meets or Exceeds the Following Specifications:
• ASME A112.19.2 - 2008/CSA B45.1-08

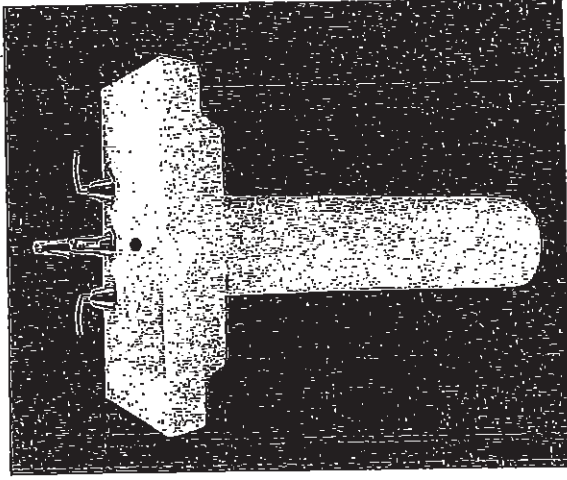

SEE REVERSE FOR ROUGHING-IN DIMENSIONS

To Be Specified:

- Color: White Linen
- Faucet Finish:
- Supplies:
- 1-1/4" Trap:
- Nipple:

* See faucet section for additional models available

J7

Revised 6/12

© 2014 AS America Inc.

Ar
HDP

C2-COUNTRY LANE
 LOT 543
 20-2337-AL-ELEV A
 THE SPRUCEWOOD

27 of 50

American Standard

Style That Works Better



BOXE UNDERCOUNTER SINK

- Vitreous china
- Rectangular undercounter mount sink with rectangular interior and flat bottom design bowl
- Unglazed rim
- Front overflow
- Supplied with template
- Meets OBC requirement when sink is installed with overflow to the rear
- Mounting clips available separately (P031006000) (Faucet not included)

- 0315 000 Unglazed Rim
 508 x 406mm (20" x 16")
 Bowl size:
 438mm (17-1/4") wide,
 337mm (13-1/4") front to back,
 127mm (5") deep

COMPLIANCE CERTIFICATIONS -

- Meets or exceeds the following Specifications:
- ASME A112.19.2M for Vitreous China Fixtures.
- CAN/CSA B45 Series.

To Be Specified

- Colour: White
- Faucet*
- Faucet Finish:
- Supplies & Stops:
- Trap 1-1/4" (32 mm):

* See faucet section for additional models available



• Countertop 864mm (34") from finished floor. Sink installed 102mm (4") from front edge of countertop. Countertop thickness to be 25mm (1") maximum. MEETS THE AMERICAN DISABILITIES ACT GUIDELINES AND ANSI A117.1 ACCESSIBLE AND USEABLE BUILDINGS AND FACILITIES - CHECK LOCAL CODES.

NOTES:
 WE RECOMMEND USING SINK AS A TEMPLATE TO DETERMINE PROPER COUNTOUR, CUT COUNTERTOP 38MM (1-1/2") INSIDE SINK COUNTOUR. FAUCETS NOT INCLUDED AND MUST BE ORDERED SEPARATELY.
 * DIMENSIONS SHOWN FOR LOCATION OF SUPPLIES AND 1" TRAP ARE SUGGESTED.
 † UNDERCOUNTER MOUNTING KIT SUPPLIED SEPARATELY.
IMPORTANT: Dimensions of fixtures are nominal and may vary within the range of tolerances established by ANSI Standard A112.19.2. These measurements are subject to change or cancellation. No responsibility is assumed for use of superseded or voided pages.

BOXE UNDERCOUNTER SINK
 VITREOUS CHINA

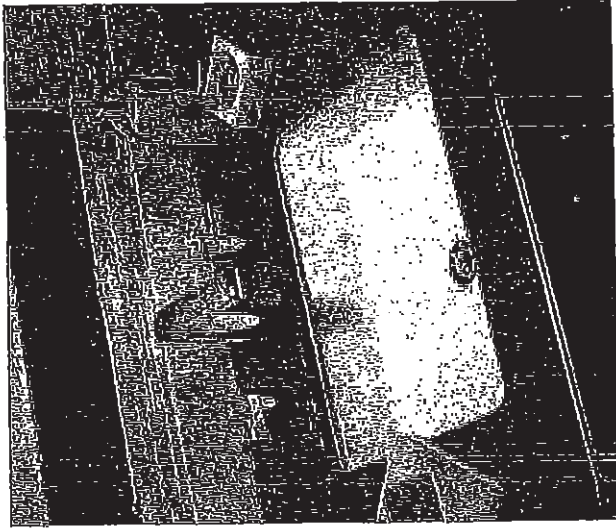

MASTER
 ENSUITE
 x 2

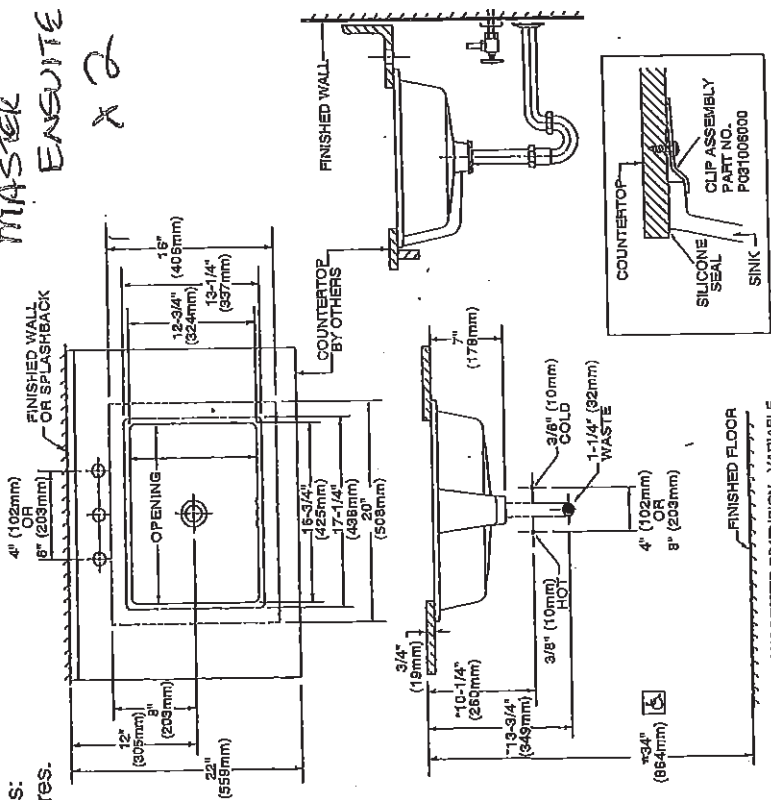

NOTE - SUGGESTED DIMENSION - VARIABLE DEPENDING ON TYPE OF SUPPLY AND WASTE

* To comply with ADA standards, overflow hole must face basic

Ar
 BDP

C2-COUNTRY LANE
 LOT 543
 20-2337-AL-ELEV A
 THE SPRUCEWOOD

28 of 50

American Standard

Style That Works Better



OVALYN™
 UNDERCOUNTER SINK
 VITREOUS CHINA

OVALYN™ UNDERCOUNTER SINK

- Classic oval undermount sink
- Made from vitreous china
- Front overflow
- Supplied with mounting kit (047194-0070A) and template

- 0496.221 Unglazed rim
 489 x 413mm
 (19-1/4" x 16-1/4")

Bowl size:
 492mm (17") wide
 356mm (14") front to back
 140mm (5-1/2") deep

Compliance Certifications -
 Meets or Exceeds the Following Specifications:
 • ASME A112.19.2M for Vitreous China Fixtures
 • CAN/CSA B45 series

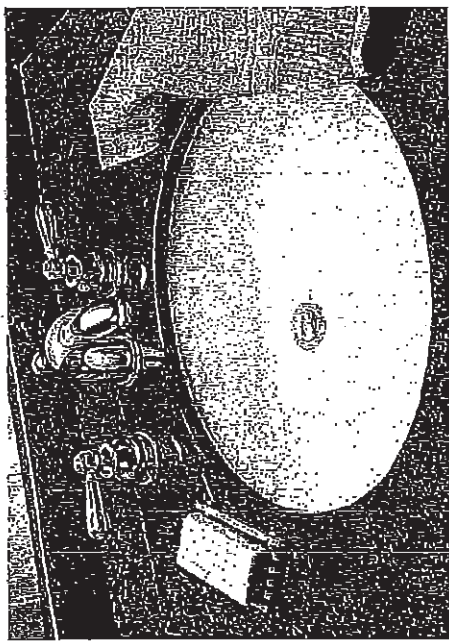

MAIN BATH x 2

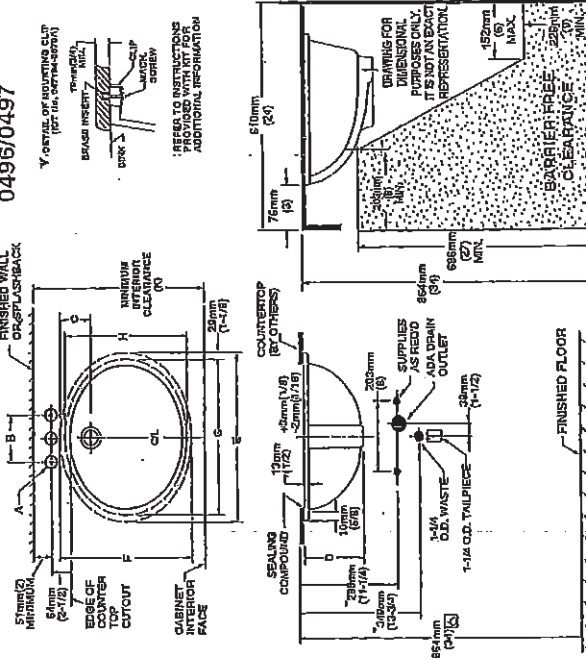

FITTING	A	B
CENTERSET	1-1/4" (32mm)	4" (102mm)
SPREAD	1-3/8" (35mm)	6" (152mm)

CAT. NO.	E	F	G	H	C	D	J	K
0496.221	489mm (19-1/4")	473mm (18-1/4")	432mm (17")	356mm (14")	103mm (4-1/8")	182mm (7-1/8")	16mm (5/8")	500mm (19-3/4")
0497.221	546mm (21-1/2")	441mm (17-3/8")	168mm (6 5/8")	281mm (11-1/8")	98mm (3 7/8")	191mm (7 5/8")	16mm (5/8")	594mm (23-3/8")

NOTES:
 * DIMENSIONS SHOWN FOR LOCATION OF SUPPLIED AND "P" TRAP ARE SUGGESTED.
 ▼ UNDERCOUNTER MOUNTING KIT SUPPLIED WITH SINK. PLEASE NOTE MINIMUM INTERIOR CLEARANCE DIMENSION (K). FITTINGS NOT INCLUDED AND MUST BE ORDERED SEPARATELY. USE ENCLOSED TEMPLATE FOR COUNTERTOP CUTOUT SEALING COMPOUND SUPPLIED BY OTHERS.
 IMPORTANT: Dimensions of fixtures are nominal and may vary within the range of tolerances established by ANSI Standard A117.1.2. These measurements are subject to change or cancellation. No responsibility is assumed for use of superseded or voided pages.



MEETS THE AMERICANS WITH DISABILITIES ACT GUIDELINES AND ANSI A117.1. ACCESSIBLE AND USEABLE BUILDINGS AND FACILITIES - CHECK LOCAL CODES.
 Countertop 864mm (34") from finished floor. Lavatory installed 76mm (3") from front edge of countertop. Countertop thickness to be 25mm (1") maximum.

AL
 100

C2-COUNTRY LANE
 LOT 543
 20-2337-AL-ELEV A
 THE SPRUCEWOOD

29 of 5
 COLONY™
 COUNTERTOP SINK
 VITREOUS CHINA

COLONY COUNTERTOP SINK

- Vitreous china
 - Self-rimming
 - Front overflow
 - Supplied with template
 - Faucet deck
- (Faucet shown not included)

- 0346 803
Faucet holes on 203mm (8") centres
- 0346 403 (Illustrated)
Faucet holes on 102mm (4") centres
- 0346 001
Centre hole only

Nominal Dimensions:
 521 x 448mm (20-1/2" x 17-5/8")
 Bowl sizes:
 422mm (16-5/8") wide, 279mm (11") front to
 back, 143mm (5-5/8") deep

COMPLIANCE CERTIFICATIONS –
 Meets or exceeds the following Specifications:
 • ASME A112.19.2M for Vitreous China Fixtures.
 • CAN/CSA B45 Series.

- To Be Specified
- Colour: White Bone Silver Gray
 - Linen
 - Faucet*:
 - Faucet Finish:
 - Supplies & Stops:
 - Trap 1-1/4" (32 mm):

* See faucet section for additional models available

BAS-198

© 2000 American Standard Inc.

01/07

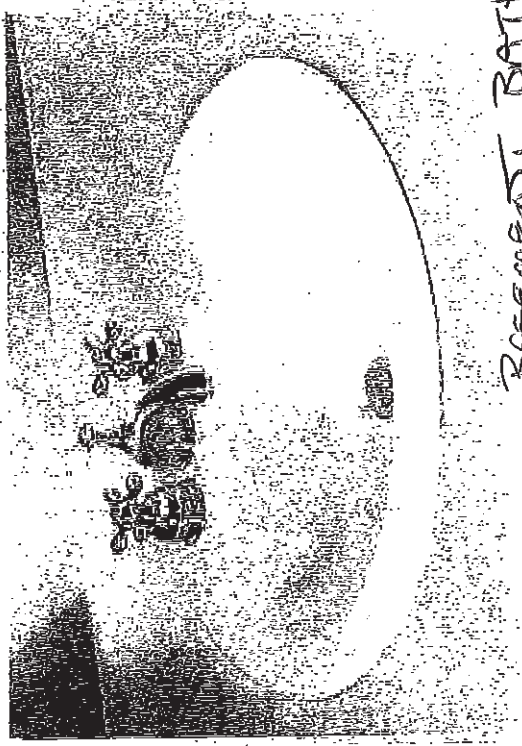

BASINETS BATH ONLY

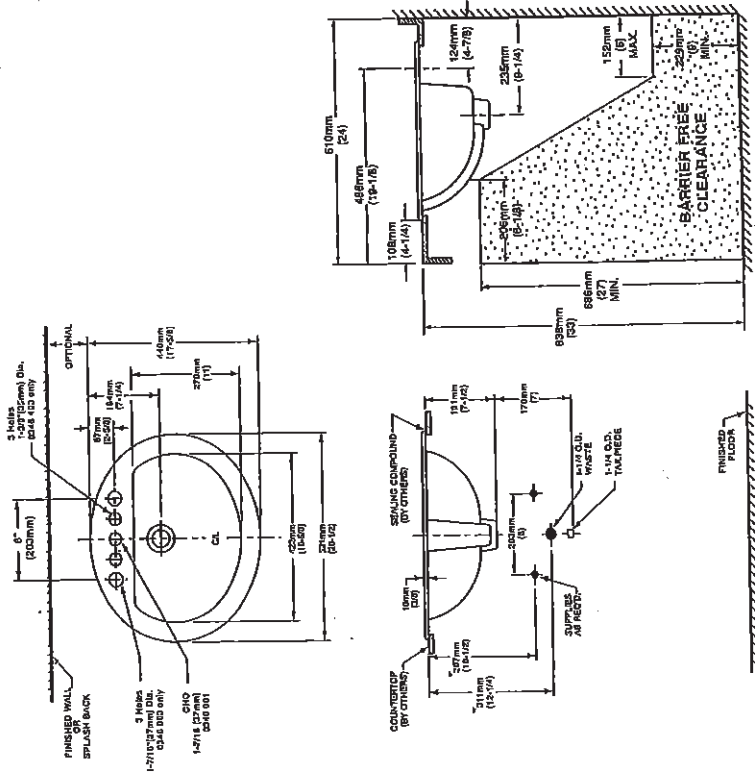

NOTES:
 * DIMENSIONS SHOWN FOR LOCATION OF SUPPLIES AND "P" TRAP ARE SUGGESTED.
 FOR COUNTERTOP CUTOUT AND INSTALLATION INSTRUCTIONS USE TEMPLATE
 SUPPLIED WITH SINK.
 FAUCETS NOT INCLUDED AND MUST BE ORDERED SEPARATELY.
 IMPORTANT: Dimensions of fixtures are nominal and may vary within the range of tolerances
 established by ANSI Standard A112.19.2.
 These measurements are subject to change or cancellation. No responsibility is assumed for use
 of superseded or voided pages.

Ar
ADP

C2-COUNTRY LANE
LOT 543
20-2337-AL-ELEV A
THE SPRUCEWOOD

30 of 50

MASTER ENSUITE

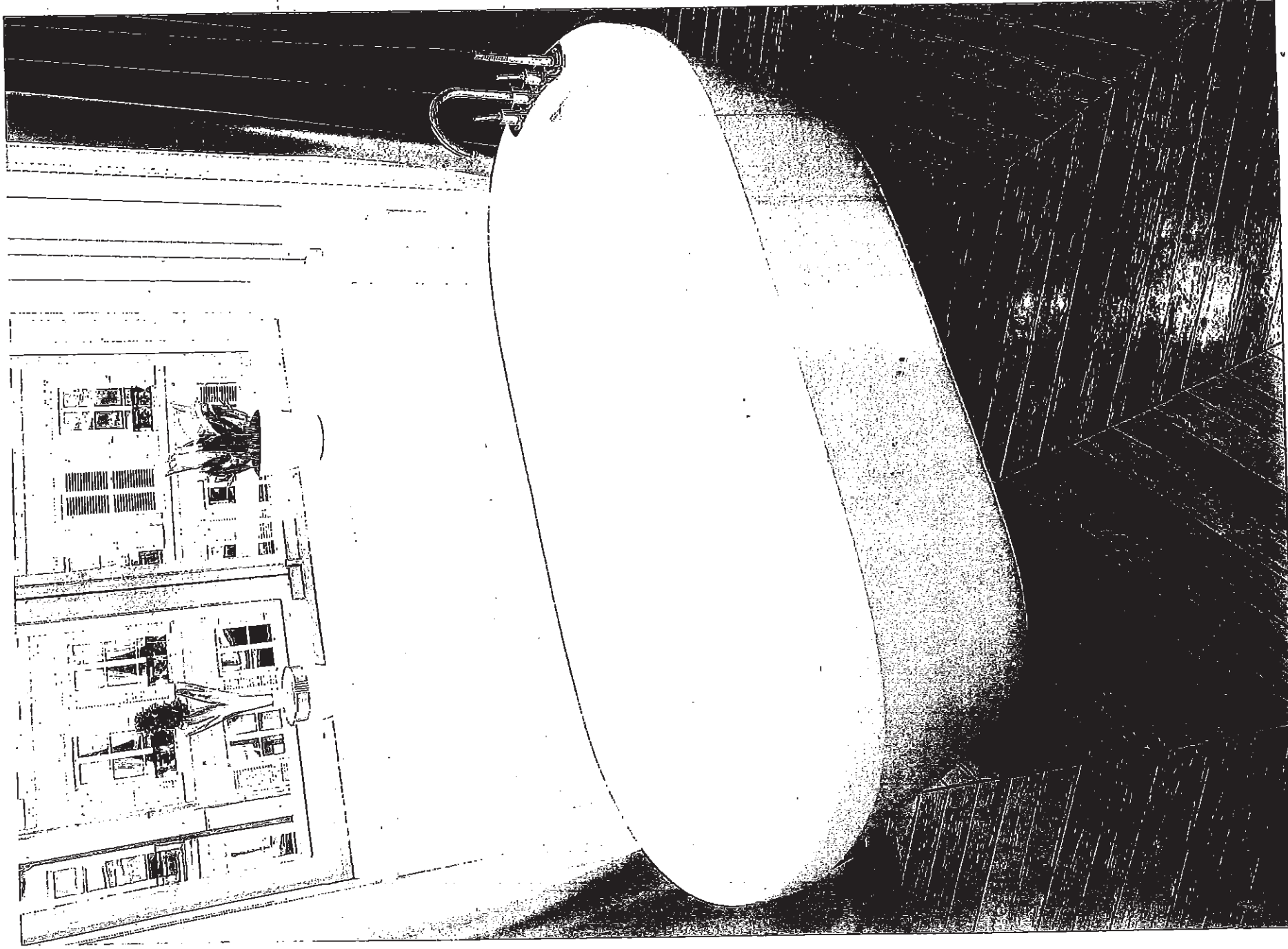

Demi CF2007

AL

TOP

C2-COUNTRY LANE
 LOT 543
 20-2337-AL-ELEV A
 THE SPRUCEWOOD



Buy it for looks. Buy it for life.®

Specifications

DESCRIPTION

- Quick connect system
- Metal construction with various finishes identified by suffix
- 1/2" IPS shanks
- Designed to be installed on 8" to 16" centers
- Includes metal pop-up type waste assembly

OPERATION

- Lever style handles with hot and cold color indicators
- Hot side counterclockwise to open (clockwise to close)
- Cold side clockwise to open (counterclockwise to close)

FLOW

- Flow is limited to 1.5 gpm max (5.7 L/min) at 60 psi, for products made before October 2008 flow is limited to 2.2 gpm max (8.3 L/min)

CARTRIDGE

- 1224 cartridge design
- Nonmetallic and stainless steel material

STANDARDS

- Third party certified to WaterSense®, ASME A112.18.1/CSA B125.1 and all applicable requirements referenced therein
- Certified to NSF 61/9 & 372
- Complies with California Proposition 65 and with the Federal Safe Drinking Water Act

- ADA  for lever handles

WARRANTY

- Lifetime limited warranty against leaks, drips and finish defects to the original consumer purchaser
- 5 year warranty if used in commercial installations

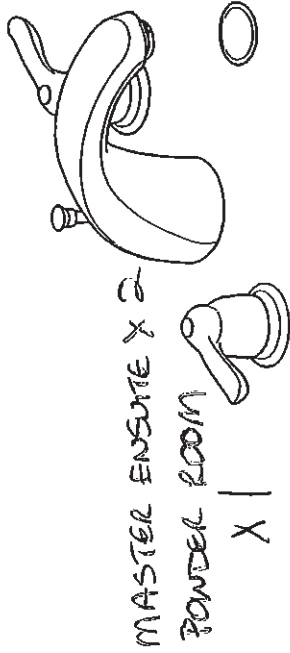

CHATEAU® Two-Handle Widespread Lavatory Faucet

Models: 4945 series

NOTE: SPOUT DESIGNED TO BE INSTALLED THROUGH 1" MIN. DIA. HOLE. VALVES INSTALL THROUGH 1-1/8" MIN. DIA. HOLE. FOR DECK THICKNESS 1-1/2" to 3" USE SERVICE KIT #115001. VALVES INSTALL THROUGH 1-1/4" DIA. HOLE.

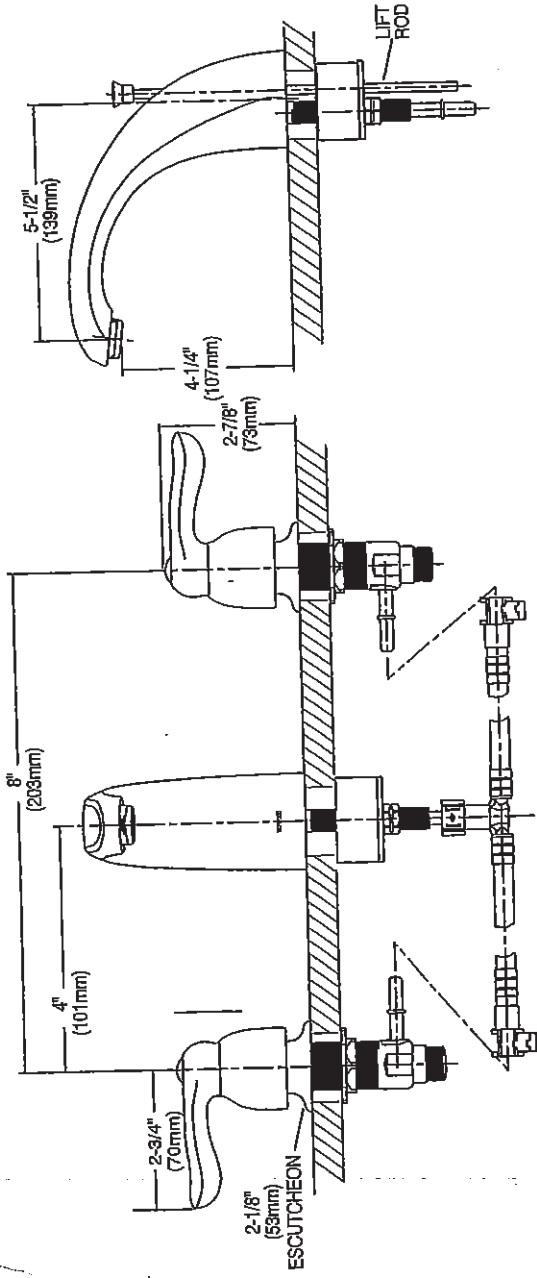

CRITICAL DIMENSIONS

(DO NOT SCALE)

Rev. 8/15

FORM 0779 5
 12x18

FOR MORE INFORMATION CALL: 1-800-BUY-MOEN
 www.moen.com

Handwritten initials and a signature.

C2-COUNTRY LANE
 LOT 543
 20-2337-AL-ELEV A
 THE SPRUCEWOOD

32 of 50

Method™

Traditional | Transitional | Modern
 A modern blend of flat planes and curves
 gives Method faucets and accessories an chic look.

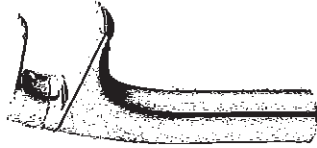

Single Handle Vessel Lav
 Faucet with Lift Rod Drain
 and Grid Drain Kit

Model 6810 / A2020

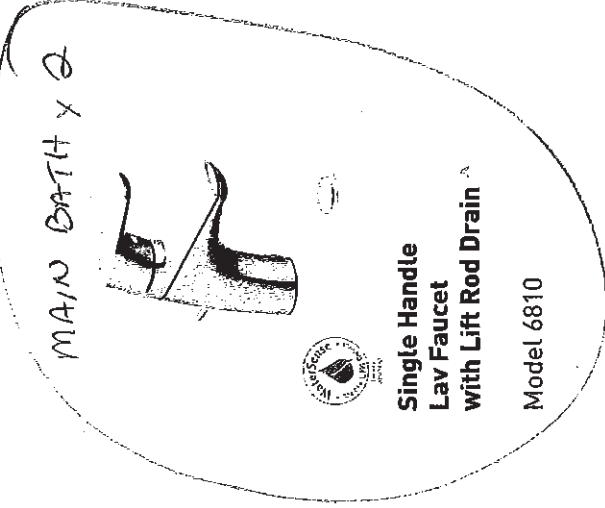

MAIN BATH x 2



Single Handle
 Lav Faucet
 with Lift Rod Drain

Model 6810



Two Handle Adjustable Widespread
 (8" - 16") Lav Faucet
 with Lift Rod Drain

Model T6820 / 69000

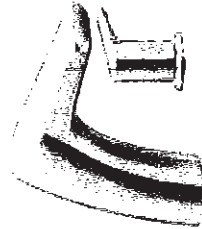

Two Handle
 Roman Tub Faucet

Model T986 / 4796



Two Handle Roman Tub
 with Hand Shower

Model T987 / 9796

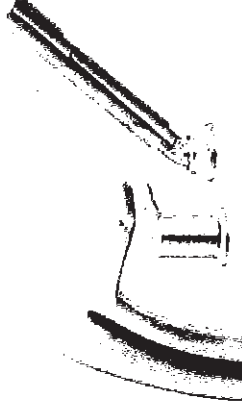

Tub Drain Half Kits Available**



Tub Drain Half Kits Available**



C BN

FINISH OPTIONS:

To order, combine the model number with one of these finish letter(s):
 LifeShine® Brushed Nickel (BN).

To order Chrome (C) model, use model number only.

^ Deckplate included

** T90331 / 140680

A-6 100

C2-COUNTRY LANE
LOT 543
20-2337-AL-ELEV A
THE SPRUCEWOOD

33 of 50

Chateau

Transitional

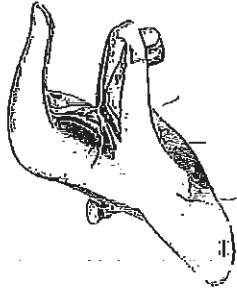

Lavatory Faucet with Pop-Up Drain
Model L4621T

VANITY SINKS AND PEDESTAL

BASEMENTS BATH ONLY

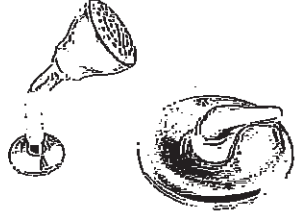

Posi-Temp® Pressure Balancing Tub/Shower
Model 62320 / TL183T

OR

Posi-Temp Valve and Tub/Shower Trim
with Eco-Performance Easy Clean® XL

Model 62320 / TL183EP+
(TL183EP not available in BC)

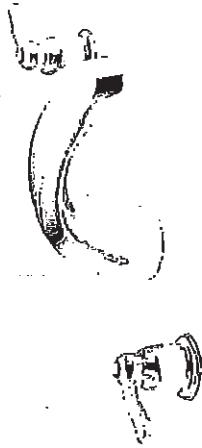

2 Handle Roman Tub with 9" Spout
Model 4796 / T990T

FREESTANDING TUB FAUCETS

SHOWER AND 5' TUB FAUCETS

A 188

C2-COUNTRY LANE
 LOT 543
 20-2337-AL-ELEV A
 THE SPRUCEWOOD

34 of 50

Cyclone

SCB51430 Canopy Hood

Alto Collection

Makes a statement of strength and power as the stainless steel frame gleams under your kitchen lights. It features baffle filters, tow bright LED lights in each corner, a three speed control panel, and a quiet, powerful motor. The bold design and strong stainless steel frame encasing the fan will make this machine the focus of your kitchen. Fitted with time-delay "OFF" options up to nine minutes.

- Specifications**
- Air Flow Volume: 550 CFM
 - Colours: Stainless Steel
 - Dimensions: W:30" H:44.5" D:19.5"
 - Electrical Connection: 120V/60HZ
 - Electrical Consumption: 200 watts
 - Fan Speed: 1254 RPM
 - Sones: Min. at 2 and Max at 6
 - Venting: 6" Round (Top Only)

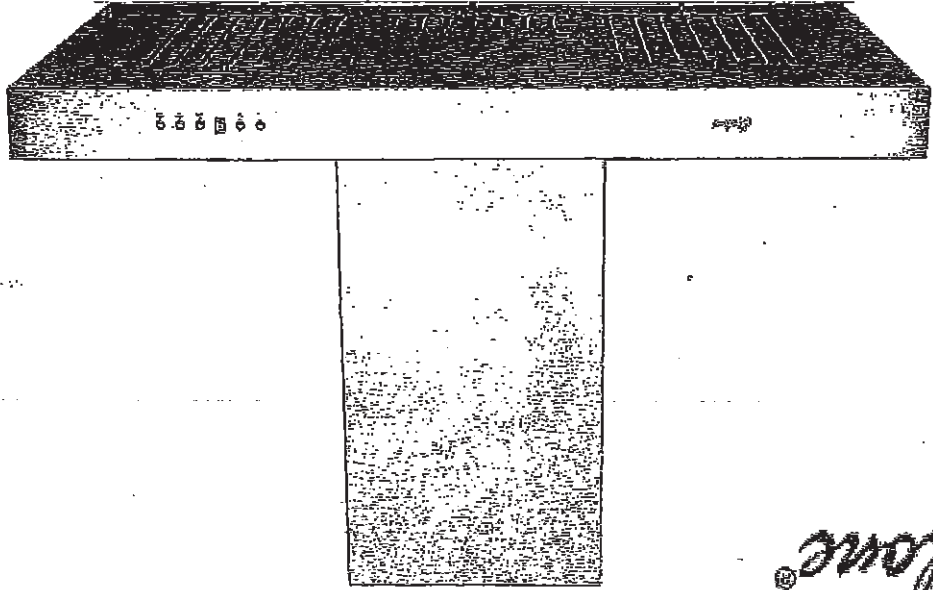
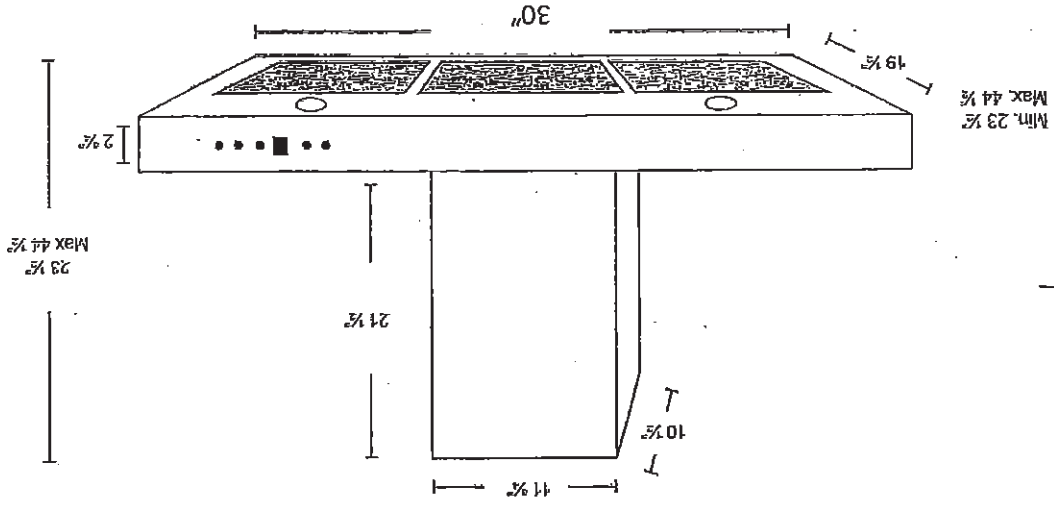
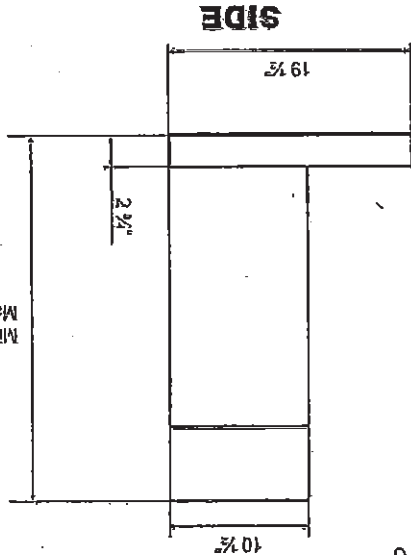
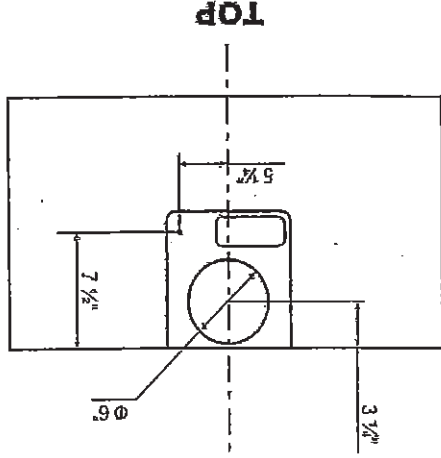

46 MB

C2-COUNTRY LANE
 LOT 543
 20-2337-AL-ELEV A
 THE SPRUCEWOOD

35 of 50



Bottom Mount Refrigerator

PRODUCT MODEL NUMBERS

WRF532SMB
 WRF535SMB

WBE535SMB
 WRF540CWB

Electrical: A 115-volt, 60-Hz, AC-only, 15- or 20-amp fused, grounded electrical supply is required. It is recommended that a separate circuit serving only your refrigerator be provided. Use an outlet that cannot be turned off by a switch. Do not use an extension cord.

NOTE: Before performing any type of installation, cleaning, or removing a light bulb, turn the control (Thermostat/ Refrigerator or Freezer Control depending on the model) to OFF and then disconnect the refrigerator from the electrical source. When you are finished, reconnect the refrigerator to the electrical source and reset the control (Thermostat, Refrigerator or Freezer Control depending on the model) to the desired setting. See "Using the Controls."

Water: A cold water supply with water pressure between 30 and 120 psi (207 and 827 kPa) is required to operate the ice maker and water dispenser. If you have questions about your water pressure, call a licensed, qualified plumber.

IMPORTANT: The pressure of the water coming out of a reverse osmosis system going to the water inlet valve of the refrigerator needs to be between 35 and 120 psi (241 and 827 kPa).

Reverse Osmosis Water Supply: If a reverse osmosis water filtration system is connected to your cold water supply, the water pressure to the reverse osmosis system needs to be a minimum of 40 to 60 psi (276 to 414 kPa).

PRODUCT DIMENSIONS

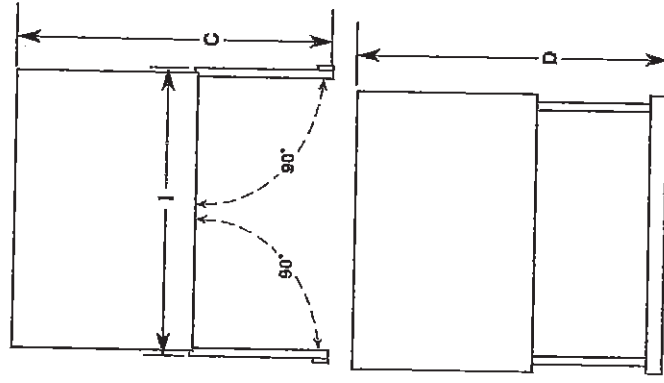
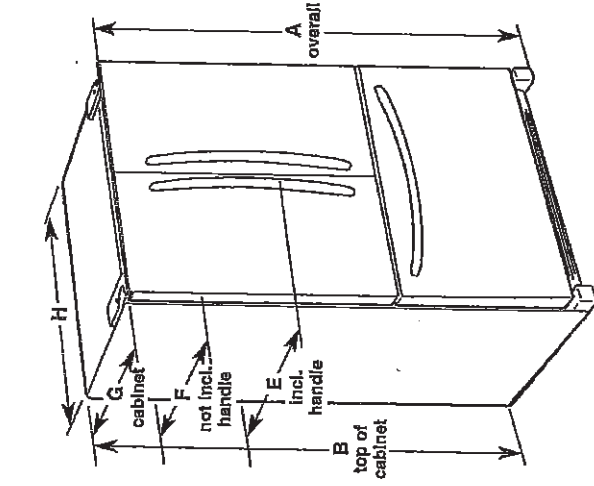

Model Number/Size	Height - Overall "A"	Height - Top of Cabinet "B"	Depth - Doors Open "C"	Depth - Drawer Open "D"	Depth - With Handles "E"	Depth - Without Handles "F"	Depth - Cabinet Only "G"	Width - Cabinet "H"	Width - Door Open 90° "I"
WRF535SMB 25.2 cu. ft.	70 1/2" (178.1 cm)	68 3/4" (174.8 cm)	48 1/4" (122.1 cm)	53 1/2" (135 cm)	35 1/4" (90 cm)	32 3/8" (83.7 cm)	29 1/4" (74 cm)	35 1/2" (90.5 cm)	43 3/4" (110.2 cm)
WRF535SMB 25.2 cu. ft.	70 1/2" (178.1 cm)	68 3/4" (174.8 cm)	48 1/4" (122.1 cm)	53 1/2" (135 cm)	35 1/4" (90 cm)	32 3/8" (83.7 cm)	29 1/4" (74 cm)	35 1/2" (90.5 cm)	43 3/4" (110.2 cm)
WRF532SMB 22.1 cu. ft.	70 1/2" (178.1 cm)	68 3/4" (174.8 cm)	47 1/2" (119.5 cm)	52 1/2" (133.3 cm)	34 1/4" (87.5 cm)	31 1/4" (79.1 cm)	28 1/4" (71.6 cm)	32 1/2" (82.9 cm)	42 1/4" (107.6 cm)
WRF540CWB 20 cu. ft.	70 1/2" (178.1 cm)	68 3/4" (174.8 cm)	48" (121.9 cm)	44 1/2" (113.0 cm)	29 3/4" (74.6 cm)	28" (71.1 cm)	24 1/4" (61.3 cm)	35 1/2" (90.5 cm)	39 3/4" (100.0 cm)

LOCATION REQUIREMENTS

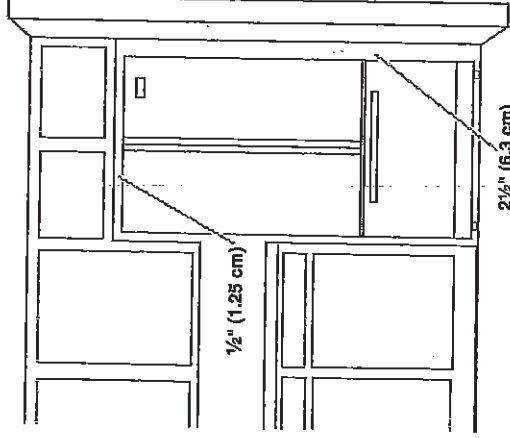

To ensure proper ventilation for your refrigerator, allow for a 1/2" (1.25 cm) space on each side and at the top. Allow for 1" (2.54 cm) of space behind the refrigerator. If your refrigerator has an ice maker, make sure you leave some extra space at the back for the water line connections.

If you are installing your refrigerator next to a fixed wall, leave 2 1/4" (6.3 cm) minimum on the hinge side (some models require more) to allow for the door to swing open.

NOTE: This refrigerator is intended for use in a location where the temperature ranges from a minimum of 55°F (13°C) to a maximum of 110°F (43°C). The preferred room temperature range for optimum performance, which reduces electricity usage and provides superior cooling, is between 60°F (15°C) and 90°F (32°C). It is recommended that you do not install the refrigerator near a heat source, such as an oven or radiator.

Because Whirlpool Corporation policy includes a continuous commitment to improve our products, we reserve the right to change materials and specifications without notice.

Dimensions are for planning purposes only. For complete details, see Installation Instructions packed with product. Specifications subject to change without notice.

Ref. W10597594B
 10/17/14

C2-COUNTRY LANE
LOT 543
20-2337-AL-ELEV A
THE SPRUCEWOOD

36 of 50

4.8 cu. ft. guided Electric Front Control Range
with the easy-wipe ceramic glass cooktop

YWEE510S0FS

Whirlpool

Home > Kitchen Appliances > Cooking Appliances > Ranges > Slide-In Ranges > YWEE510S0FS

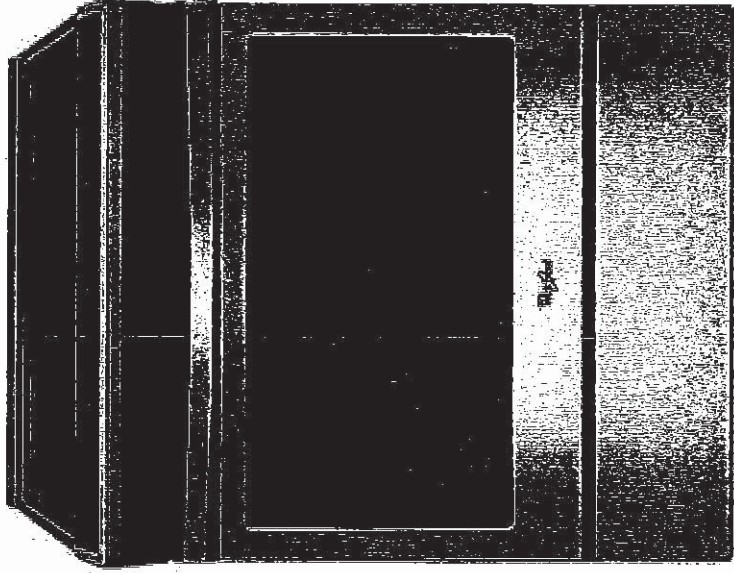

C2-COUNTRY LANE
 LOT 543
 20-2337-AL-ELEV A
 THE SPRUCEWOOD

37 of 50

Cabinet Dimensions

Cabinet opening dimensions shown are for 25" (64.0 cm) countertop depth, 24" (61.0 cm) base cabinet depth and 36" (91.4 cm) countertop height.

IMPORTANT: If installing a range hood or microwave hood combination above the range, follow the range hood or microwave hood combination installation instructions for dimensional clearances above the cooktop surface. Range may be installed next to combustible walls with zero clearance.

NOTE: When installed in a slide-in cutout, the front of oven door may protrude beyond the base cabinet.

Slide-In Cutout

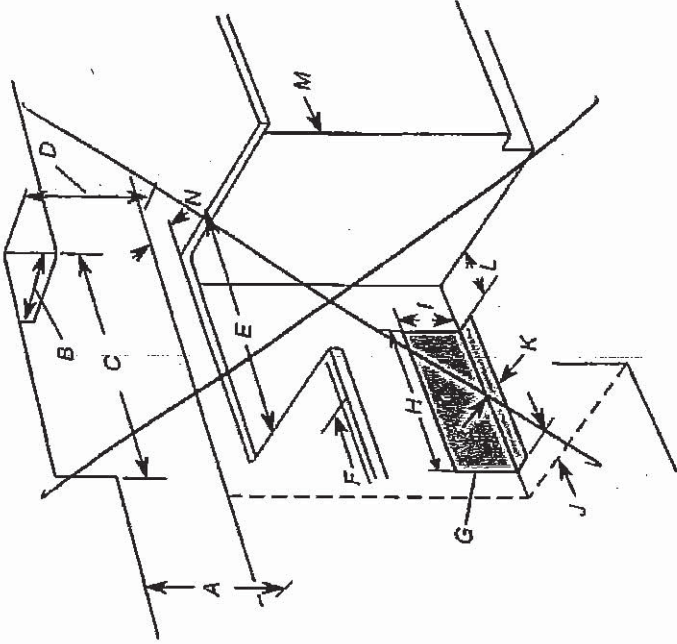

- A. 18" (45.7 cm) upper side cabinet to countertop
- B. 13" (33 cm) max. upper cabinet depth
- C. 30" (76.2 cm) min. opening width
- D. For minimum clearance to top of cooktop, see NOTE*
- E. 30" (76.2 cm) min. opening width
- F. 3" (7.6 cm) min. clearance from both sides of range to side wall or other combustible material
- G. The shaded area is recommended for installation of rigid gas pipe and grounded outlet.
- H. 13 1/8" (33.3 cm)
- I. 7 1/8" (19.5 cm)
- J. 4 3/8" (12.2 cm)
- K. 3 1/8" (9.4 cm) plus measurement of N
- L. 12" (30.5 cm)
- M. Cabinet door or hinges should not extend into the cutout.
- N. Remaining counter depth should not exceed 2 1/4" (5.7 cm).

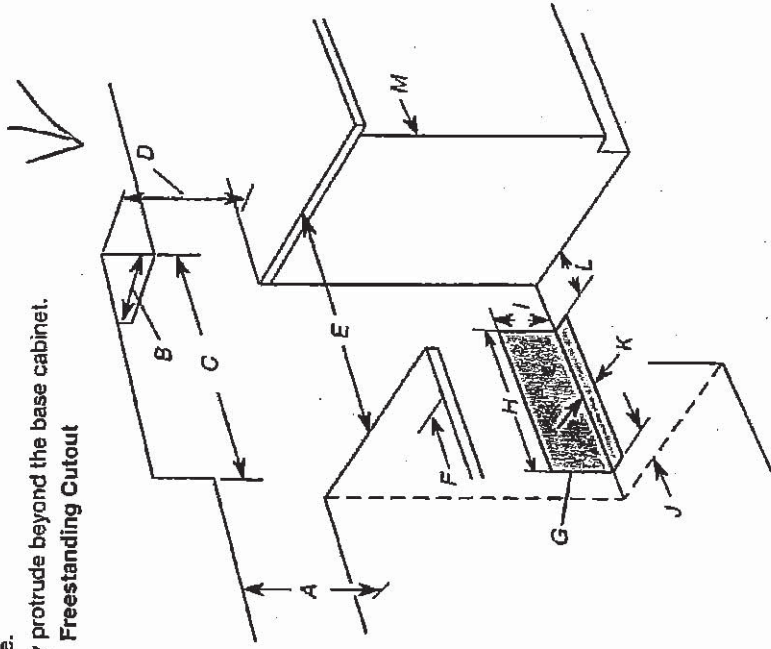

- A. 18" (45.7 cm) upper side cabinet to countertop
- B. 13" (33 cm) max. upper cabinet depth
- C. 30" (76.2 cm) min. opening width
- D. For minimum clearance to top of cooktop, see NOTE*
- E. 30" (76.2 cm) min. opening width
- F. 3" (7.6 cm) min. clearance from both sides of range to side wall or other combustible material
- G. The shaded area is recommended for installation of rigid gas pipe and grounded outlet.
- H. 13 1/8" (33.3 cm)
- I. 7 1/8" (19.5 cm)
- J. 4 3/8" (12.2 cm)
- K. 3 1/8" (9.4 cm)
- L. 12" (30.5 cm)
- M. Cabinet door or hinges should not extend into the cutout.

*NOTE: 24" (61.0 cm) minimum when bottom of wood or metal cabinet is shielded by not less than 1/2" (0.64 cm) flame retardant millboard covered with not less than No. 28 MSG sheet steel, 0.015" (0.4 mm) stainless steel, 0.024" (0.6 mm) aluminum or 0.020" (0.5 mm) copper.

30" (76.2 cm) minimum clearance between the top of the cooking platform and the bottom of an uncovered wood or metal cabinet.

C2-COUNTRY LANE
LOT 543
20-2337-AL-ELEV A
THE SPRUCEWOOD

38 of 50

WHIRLPOOL YWEE510S0FS

4.8 cu. ft. guided Electric Front Control Range with the easy-wipe ceramic glass cooktop

INSTALLATION REQUIREMENTS

Tools and Parts

Gather the required tools and parts before starting installation. Read and follow the instructions provided with any tools listed here.

Tools Needed

- Tape measure
- Phillips screwdriver
- Level
- Hand or electric drill
- Wrench or pliers
- Marker or pencil
- 1/4" (3.2 mm) drill bit (for wood floors)
- Flashlight

Parts Supplied

Check that all parts are included.

- #10 x 1 1/2" (4.1 cm) screws (for mounting anti-tip bracket) (2)
 - Anti-tip bracket (inside oven cavity)
- Anti-tip bracket must be securely mounted to the back wall or floor. Thickness of flooring may require longer screws to anchor bracket to subfloor. Longer screws are available from your local hardware store.

Location Requirements

IMPORTANT: Observe all governing codes and ordinances.

- It is the installer's responsibility to comply with installation clearances specified on the model/serial/rating plate. The model/serial/rating plate is located behind the oven door on the top right-hand side of the oven frame.
- The range should be located for convenient use in the kitchen.
- Recessed installations must provide complete enclosure of the sides and rear of the range.
- To eliminate the risk of burns or fire by reaching over the heated surface units, cabinet storage space located above the surface units should be avoided. If cabinet storage is to be provided, the risk can be reduced by installing a range hood or microwave hood combination that projects horizontally a minimum of 5" (12.7 cm) beyond the bottom of the cabinets.
- All openings in the wall or floor where range is to be installed must be sealed.
- Cabinet opening dimensions that are shown must be used. Given dimensions are minimum clearances.
- The anti-tip bracket must be installed. To install the anti-tip bracket shipped with the range, see "Install Anti-Tip Bracket" section.
- Grounded electrical supply is required. See the appropriate "Electrical Requirements" section.
- Contact a qualified floor covering installer to check that the floor covering can withstand at least 200°F (93°C).
- Use an insulated pad or 1/4" (0.64 cm) plywood under range if installing range over carpeting.

IMPORTANT: To avoid damage to your cabinets, check with your builder or cabinet supplier to make sure that the materials used will not discolor, delaminate, or sustain other damage. This oven has been designed in accordance with the requirements of UL and CSA International and complies with the maximum allowable wood cabinet temperatures of 194°F (90°C).

C2-COUNTRY LANE
LOT 543
20-2337-AL-ELEV A
THE SPRUCEWOOD

39 of 50

WHIRLPOOL YWEE510S0FS

4.8 cu. ft. guided Electric Front Control Range with the Mobile Home - Additional Installation Requirements

The installation of this range must conform to the Manufactured Home Construction and Safety Standard, Title 24 CFR, Part 3280 (formerly the Federal Standard for Mobile Home Construction and Safety, Title 24, HUD Part 280). When such standard is not applicable, use the Standard for Manufactured Home Installations, ANSI A225.1/NFPA 501A or with local codes. In Canada, the installation of this range must conform with the current standards CAN/CSA-A240-latest edition, or with local codes.

Mobile Home Installations Require:

- When this range is installed in a mobile home, it must be secured to the floor during transit. Any method of securing the range is adequate as long as it conforms to the standards listed above.

Product Dimensions

This manual covers several models. Your model may appear different from the models depicted. Dimensions given are maximum dimensions across all models.

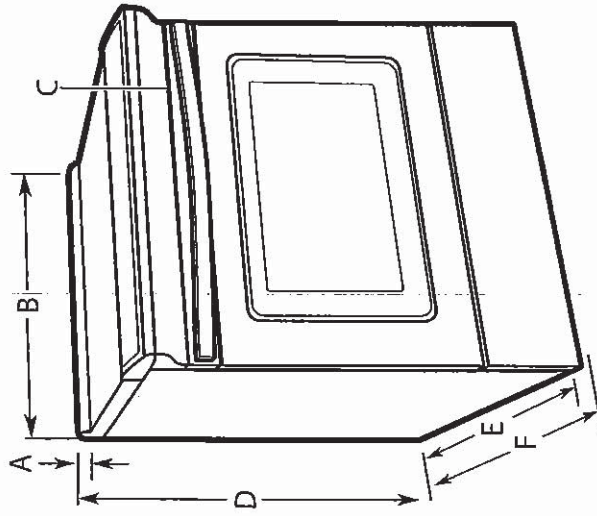

- A. 1 $\frac{1}{8}$ " (3.0 cm) height from cooktop to top of vent
- B. 29 $\frac{1}{8}$ " (75.9 cm) height from back of console to back of range
- C. 29 $\frac{1}{4}$ " (73.7 cm) max. depth from handle to back of range
- D. 36" (91.4 cm) height to top of cooktop edge with leveling legs screwed all the way in*

IMPORTANT: Range must be level after installation. Follow the instructions in the "Level Range" section. Using the cooktop as a reference for leveling the range is not recommended.

*Range can be raised approximately 1" (2.5 cm) by adjusting the leveling legs.

the easy-wipe ceramic glass cooktop

Cabinet Dimensions

Cabinet opening dimensions shown are for 25" (64.0 cm) countertop depth, 24" (61.0 cm) base cabinet depth, and 36" (91.4 cm) countertop height.

IMPORTANT: If installing a range hood or microwave hood combination above the range, follow the range hood or microwave hood combination installation instructions for dimensional clearances above the cooktop surface.

Range may be installed next to combustible walls with zero clearance.

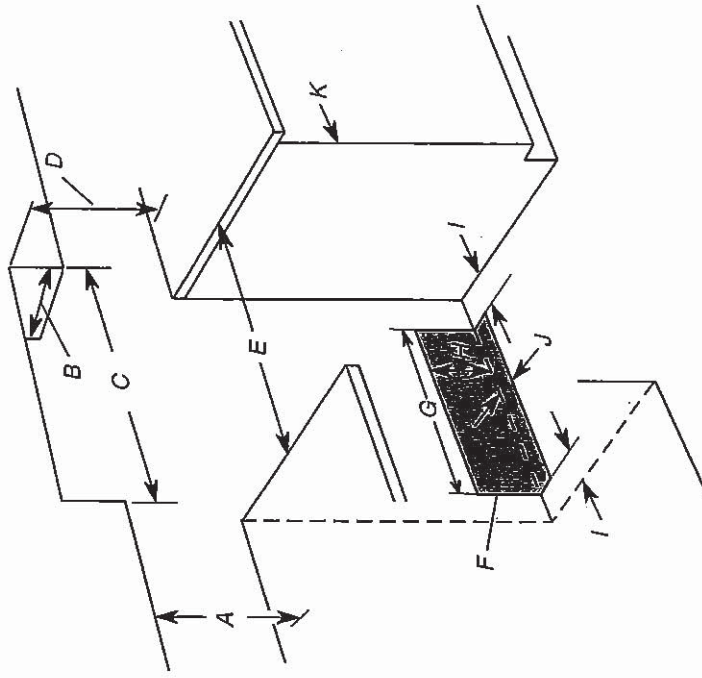

- A. 18" (45.7 cm) upper side cabinet to countertop
- B. 13" (33 cm) max. upper cabinet depth
- C. 30" (76.2 cm) min. opening width
- D. For minimum clearance to top of cooktop, see NOTE*.
- E. 30" (76.2 cm) min. opening width
- F. The shaded area is recommended for installation of grounded outlet.
- G. 13 $\frac{1}{8}$ " (33.3 cm)
- H. 7 $\frac{1}{8}$ " (19.5 cm)
- I. 4 $\frac{1}{8}$ " (12.2 cm)
- J. 3 $\frac{1}{8}$ " (9.4 cm)
- K. Cabinet door or hinges should not extend into the cutout.

*NOTE: 24" (61.0 cm) minimum when bottom of wood or metal cabinet is shielded by not less than $\frac{1}{4}$ " (0.64 cm) flame retardant millboard covered with not less than No. 28 MSG sheet steel, 0.015" (0.4 mm) stainless steel, 0.024" (0.6 mm) aluminum or 0.020" (0.5 mm) copper.

30" (76.2 cm) minimum clearance between the top of the cooking platform and the bottom of an uncovered wood or metal cabinet.

C2-COUNTRY LANE
LOT 543
20-2337-AL-ELEV A
THE SPRUCEWOOD

WHIRLPOOL YWEE510S0FS

4.8 cu. ft. guided Electric Front Control Range with the easy-wipe ceramic glass cooktop

Electrical Requirements - Canada Only

 !WARNING
Electrical Shock Hazard
Electrically ground range. Failure to do so can result in death, fire, or electrical shock.

If codes permit and a separate ground wire is used, it is recommended that a qualified electrical installer determine that the ground path is adequate and wire gauge are in accordance with local codes.

Be sure that the electrical connection and wire size are adequate and in conformance with CSA Standard C22.1, Canadian Electrical Code, Part 1 - latest edition, and all local codes and ordinances.

A copy of the above code standards can be obtained from:
Canadian Standards Association
178 Rexdale Blvd.
Toronto, ON M9W 1R3 CANADA

- Check with a qualified electrical installer if you are not sure the range is properly grounded.

Range Rating*		Specified Rating of Power Supply Cord Kit and Circuit Protection	
120/240 Volts	120/208 Volts	Volts	Amps
8.8 - 16.5 KW	7.8 - 12.5 KW	40 or 50**	
16.6 - 22.5 KW	12.6 - 18.5 KW	50	

*The NEC calculated load is less than the total connected load listed on the model/serial/rating plate.

**If connecting to a 50-amp circuit, use a 50-amp rated cord with kit. For 50-amp rated cord kits, use kits that specify use with a nominal 1 3/8" (3.5 cm) diameter connection opening.

- A circuit breaker is recommended.
- This range is equipped with a CSA International Certified Power Cord intended to be plugged into a standard 14-50R wall receptacle. Be sure the wall receptacle is within reach of range's final location.

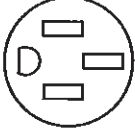

- Do not use an extension cord.
- The tech sheet and wiring diagram are located on the back of the range in a plastic bag.

40 of 50

C2-COUNTRY LANE
LOT 543
20-2337-AL-ELEV A
THE SPRUCEWOOD

41 of 50

WHIRLPOOL YWEE510S0FS

4.8 cu. ft. guided Electric Front Control Range with the easy-wipe ceramic glass cooktop

INSTALLATION INSTRUCTIONS

Unpack Range

! WARNING

Excessive Weight Hazard

Use two or more people to move and install range.
Failure to do so can result in back or other injury.

1. Remove shipping materials, tape, and film from the range. Keep cardboard bottom under range. Do not dispose of anything until the installation is complete.
2. Remove oven racks and parts package from oven and shipping materials.
3. To remove cardboard bottom, first take 4 cardboard corners from the carton. Stack 1 cardboard corner on top of another. Repeat with the other 2 corners. Place them lengthwise on the floor behind the range to support the range when it is laid on its back.
4. Using 2 or more people, firmly grasp the range and gently lay it on its back on the cardboard corners.
5. Remove cardboard bottom.

The leveling legs can be adjusted while the range is on its back. See the "Adjust Leveling Legs" section.

NOTE: To place range back up into a standing position, put a sheet of cardboard or hardboard on the floor in front of range to protect the flooring. Using 2 or more people, stand range back up onto the cardboard or hardboard.

Install Anti-Tip Bracket

! WARNING



Tip Over Hazard

A child or adult can tip the range and be killed.
Install anti-tip bracket to floor or wall per installation instructions.
Slide range back so rear range foot is engaged in the slot of the anti-tip bracket.
Re-engage anti-tip bracket if range is moved.
Do not operate range without anti-tip bracket installed and engaged.
Failure to follow these instructions can result in death or serious burns to children and adults.

1. Remove the anti-tip bracket from the inside of the oven.
2. Determine which mounting method to use: floor or wall.
If you have a stone or masonry floor, you can use the wall mounting method. If you are installing the range in a mobile home, you must secure the range to the floor.
This anti-tip bracket and screws can be used with wood or metal studs.
3. Determine and mark centerline of the cutout space. The mounting bracket can be installed on either the left-hand or right-hand side of the cutout. Position mounting bracket against the wall in the cutout so that the V-notch of the bracket is 12½" (31.8 cm) from centerline as shown.

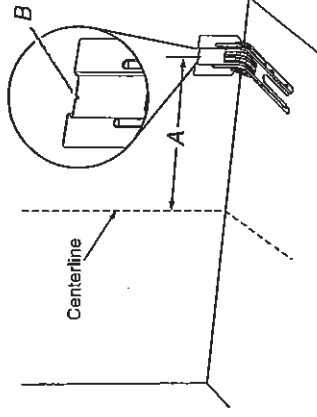

A. 12½" (31.8 cm)
B. Bracket V-notch

C2-COUNTRY LANE
 LOT 543
 20-2337-AL-ELEV A
 THE SPRUCEWOOD

42 of 50

WHIRLPOOL YWEE510S0FS

4.8 cu. ft. guided Electric Front Control Range with the easy-wipe ceramic glass cooktop

- Drill two 1/8" (3 mm) holes that correspond to the bracket holes of the determined mounting method. See the following illustrations.

Floor Mounting

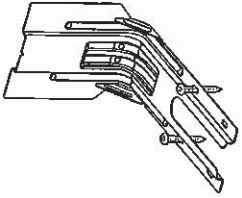

Rear position

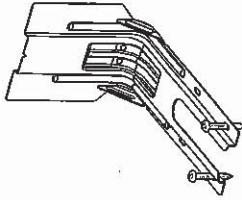

Front position

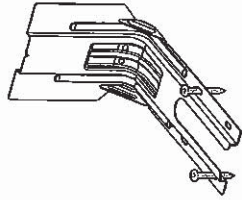

Diagonal (2 options)

Wall Mounting

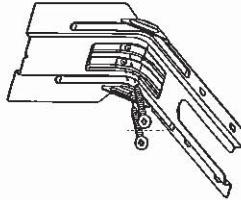

- Using the two #10 x 1 1/2" (4.1 cm) Phillips-head screws provided, mount anti-tip bracket to the wall or floor.
- Move range close enough to opening to allow for final electrical connections. Remove shipping base, cardboard, or hardboard from under range.
- Move range into its final location, making sure rear leveling leg slides into anti-tip bracket.

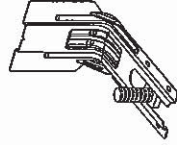

! WARNING



Tip Over Hazard

A child or adult can tip the range and be killed.

Install anti-tip bracket to floor or wall per installation instructions.

Slide range back so rear range foot is engaged in the slot of the anti-tip bracket.

Re-engage anti-tip bracket if range is moved.

Do not operate range without anti-tip bracket installed and engaged.

Failure to follow these instructions can result in death or serious burns to children and adults.

- Measure the distance from the top of the counter to the floor.
- Measure the distance from the top of the cooktop to the bottom of the leveling legs. This distance should be the same. If it is not, adjust the leveling legs to the correct height. The leveling legs can be loosened to add up to a maximum of 1" (2.5 cm). A minimum of 3/8" (5 mm) is needed to engage the anti-tip bracket.

NOTE: If height adjustment is made when range is standing, tilt the range back to adjust the front legs, and then tilt forward to adjust the rear legs.

- When the range is at the correct height, check that there is adequate clearance under the range for the anti-tip bracket. Before sliding range into its final location, check that the anti-tip bracket will slide under the range and onto the rear leveling leg prior to anti-tip bracket installation.

NOTE: If a Trim Kit will be used, the top of the cooktop should be higher than the counter. See the Installation Instructions included with the Trim Kit for the correct height.

Adjust Leveling Legs

- If range height adjustment is necessary, use a wrench or pliers to loosen the 4 leveling legs. This may be done with the range on its back or with the range supported on 2 legs after the range has been placed back to a standing position.

Level Range

- Place level on the oven bottom, as indicated in one of the 2 figures below, depending on the size of the level. Check with the level side to side and front to back.

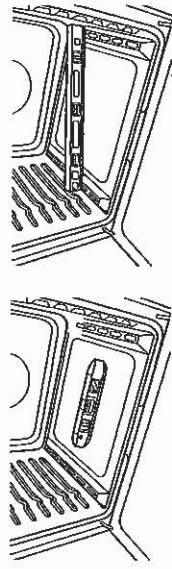

- If range is not level, use a wrench or pliers to adjust leveling legs up or down until the range is level.

C2-COUNTRY LANE
 LOT 543
 20-2337-AL-ELEV A
 THE SPRUCEWOOD

43 of 50



Undercounter Dishwasher

PRODUCT MODEL NUMBERS

WDF110PAB	WDJES30PSY
WDF111PAB	WDF320PAD
WDF120PAF	WDF510PAY
WDF121PAF	WDT710PAY
WDF310PAA	WDT720PAD
WDF310PCA	WDT770PAY

Electrical Requirements: 120-volt, 60-Hz, AC only, 15- or 20-amp. fused electrical supply. Copper wire only. A time delay fuse or circuit breaker and separate circuit is recommended.

If direct wiring dishwasher: Use flexible, armored, or nonmetallic, sheathed copper wire with grounding wire that meets the wiring requirements for your home and local codes and ordinances. Use a UL listed or CSA approved conduit connector.

If connecting dishwasher with a power supply cord: Use Power Supply Cord Kit (Part No. 4317824) marked for use with dishwashers. Follow the kit instructions for installing the power supply cord.

Power supply cord must plug into a grounded 3 prong, outlet, located in the cabinet next to the dishwasher opening. Outlet must meet all local codes and ordinances.

Water Supply Requirements: A hot water line with 20 to 120 psi (138 to 862 kPa) water pressure. Water temperature must be 120°F (49°C) water at dishwasher. Use 3/8" O.D. copper tubing with compression fitting or flexible braided water supply line (1/2" minimum plastic tubing is not recommended). Use a 90° elbow with 1/4"N.P.T. external pipe threads on one end. Do not solder within 6" (15.2 cm) from water inlet valve.

Drain Requirements: A new drain hose is supplied with your dishwasher. If this is not long enough, use a new drain hose with a maximum length of 12' (3.7 m) (Part No. 3385556) that meets all current AHAM/APMO test standards, is resistant to heat and detergent, and fits the 1" (2.5 cm) drain connector of the dishwasher.

Make sure to connect the drain hose to waste tee or disposer inlet above drain trap in house plumbing and 20" (50.8 cm) minimum above the floor. It is recommended that the drain hose either be looped up and securely fastened to the underside of the counter or be connected to an air gap.

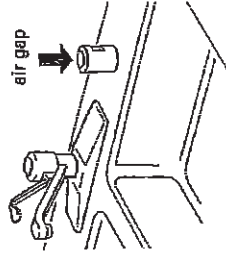

Make sure to use an air gap if the drain hose is connected to house plumbing lower than 20" (50.8 cm) above subfloor or floor.

Use 1/2" (1.3 cm) minimum I.D. drain line fittings.

If required, the air gap should be installed in accordance with the air gap installation instructions. When connecting the air gap, a rubber hose (not provided) will be needed to connect to the waste tee or disposer inlet.

PRODUCT DIMENSIONS

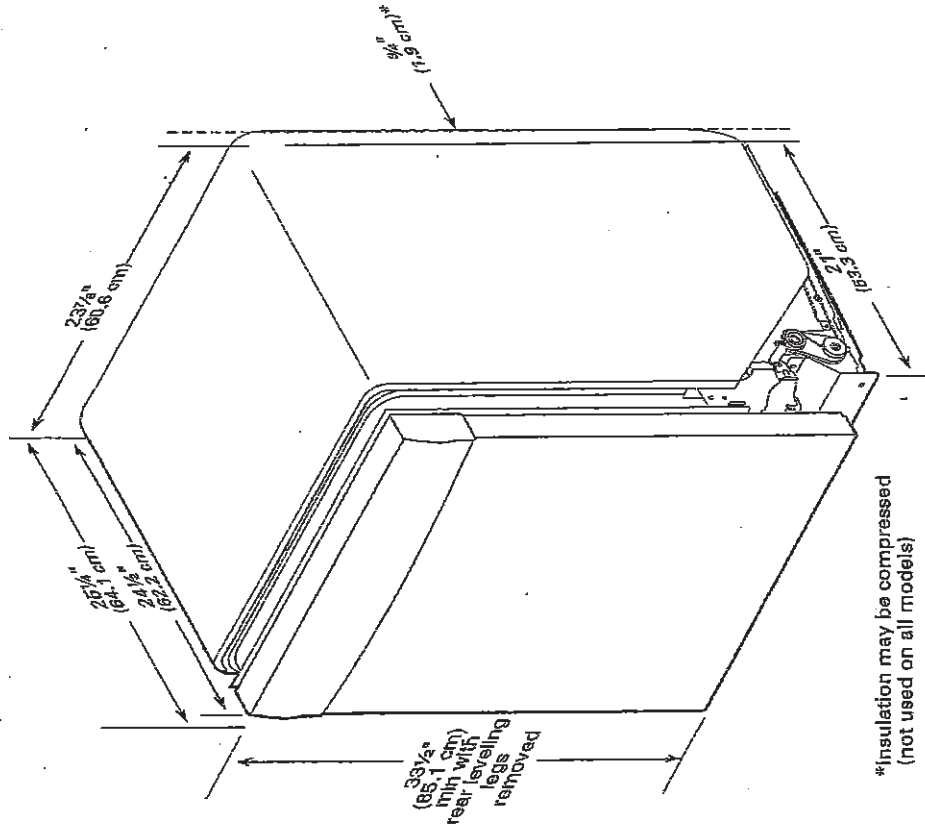

*Insulation may be compressed (not used on all models)

C2-COUNTRY LANE
LOT 543
20-2337-AL-ELEV A
THE SPRUCEWOOD

44 of 50
1, 2

CABINET CUTOUT DIMENSIONS

NOTE: Shaded areas of cabinet walls show where utility connections may be installed.

*Measure from the lowest point on the underside of the countertop. May be reduced to 33 $\frac{1}{2}$ " (85.1 cm) by removing the rear leveling legs from dishwasher.

**Minimum, measured from narrowest point of opening.

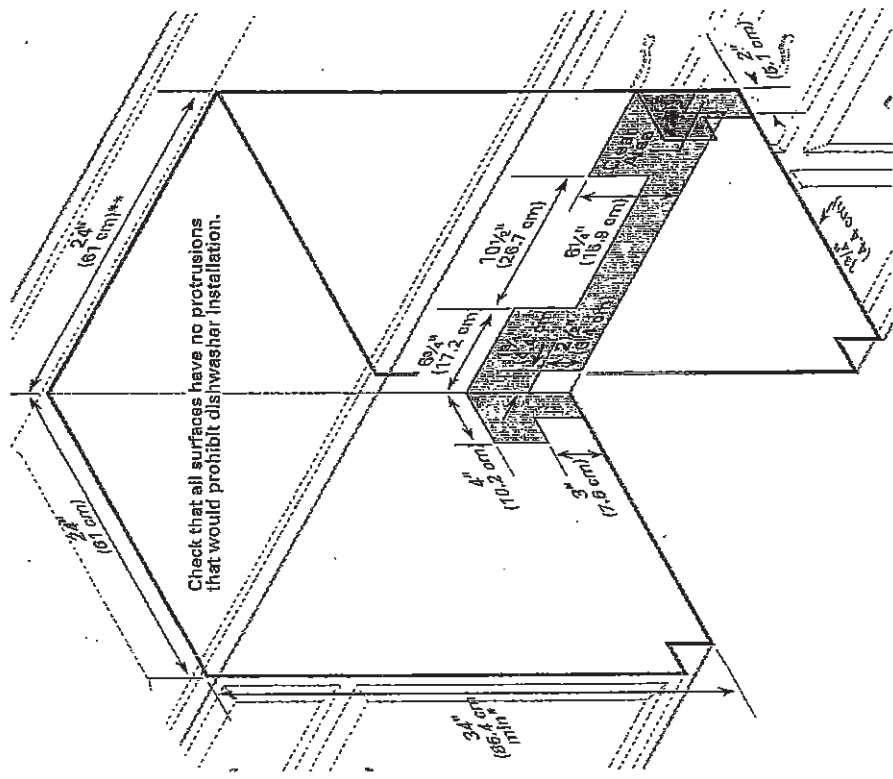

C2-COUNTRY LANE
LOT 543
20-2337-AL-ELEV A
THE SPRUCEWOOD

45 of 50

WHIRLPOOL WASHER Model #: WFW5620HW

Whirlpool Brand Canada English | Washers and Dryers | Washers | Front Load Washers | WFW5620HW

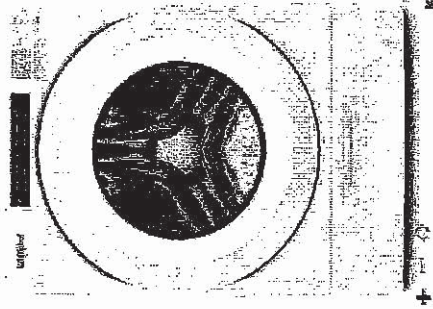

5.2 cu. ft. I.E.C. Closet-Depth
Front Load Washer with
Load & Go™ Dispenser



Whirlpool

5.2 cu. ft. I.E.C. Closet-Depth Front Load Washer with Load & Go™
Dispenser

Model #: WFW5620HW

Dimensions

Depth	80.17 cm, 31-9/16 in
Depth With Door Open 90 Degree	143.51 cm, 56-1/2 in
Minimum Height	98.11 cm, 38-5/8 in
Width	68.58 cm, 27.0 in

Appearance

LCD Touch Screen	No
------------------	----

Window

Yes

Details

Drum Material	Stainless Steel
---------------	-----------------

Cycles and Options

Number of Wash Cycles	37
-----------------------	----

Electrical

Hz	60
----	----

Power Card Included

Yes

C2-COUNTRY LANE
 LOT 543
 20-2337-AL-ELEV A
 THE SPRUCEWOOD

46 of 50

WHIRLPOOL WASHER Model #: WFW5620HW

LOCATION REQUIREMENTS

Proper installation is your responsibility.

You will need:

- A water heater set to 120°F (49°C).
- A grounded electrical outlet located within 6 ft (1.8 m) of power cord on back of washer.
- Hot and cold water faucets located within 4 ft (1.2 m) of hot and cold water fill valves on washer, and water pressure of 20–100 psi (137.9–689.6 kPa).
- A level floor with maximum slope of 1" (25 mm) under entire washer. Installing on carpet or surfaces with foam backing is not recommended.
- Floor must support washer's total weight (with water and load) of 315 lbs (143 kgs).

IMPORTANT: Do not install, store, or operate washer where it will be exposed to weather or in temperatures below 32°F (0°C). Water remaining in washer after use may cause damage in low temperatures. See "Washer Care" in your Use and Care Guide for winterizing information.

Whirlpool Models*

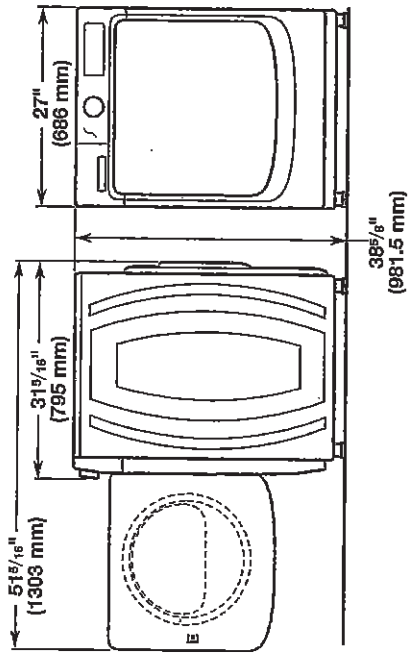
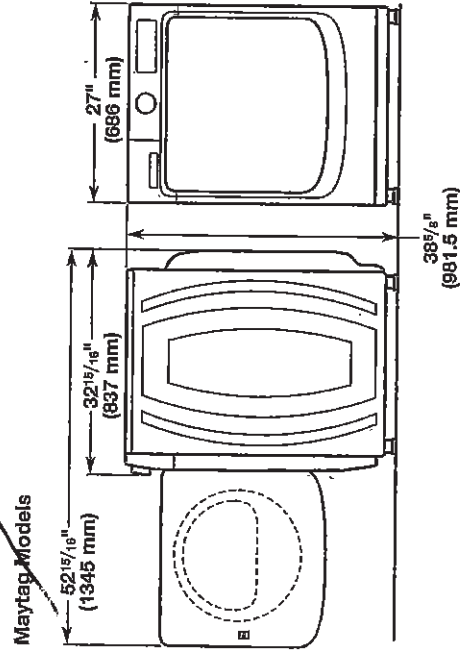
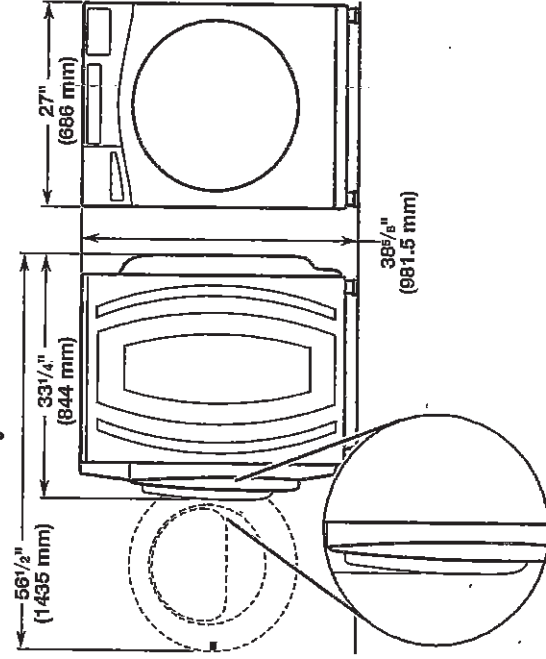

All dimensions show minimum spacing allowed. For each arrangement, consider allowing more space for ease of installation and servicing, and spacing for companion appliances and clearances for walls, doors, and floor moldings. Space must be large enough to allow door to fully open. Add spacing of 1" (25 mm) on all sides of washer to reduce noise transfer. If a closet door or louvered door is installed, top and bottom air openings in door are required.

Recessed area or closet installation (stacked washer and dryer):

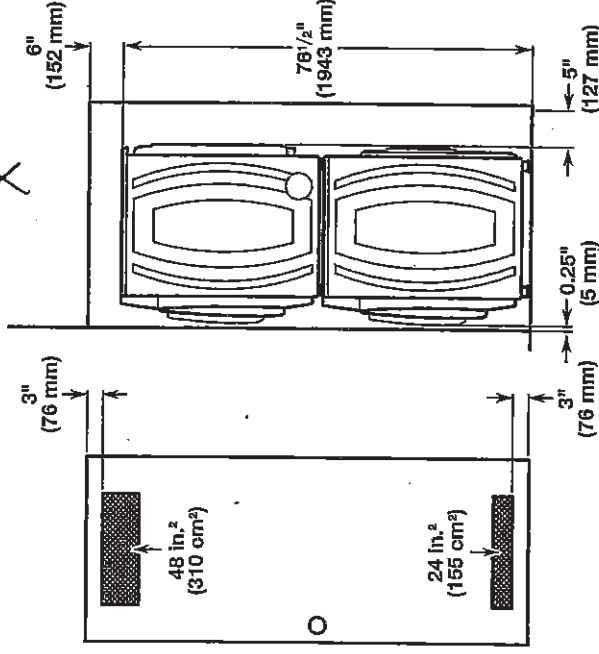

*For additional details (or information) specific to your model, refer to the "Dimensions" listed for your model at www.whirlpool.com.

C2-COUNTRY LANE
 LOT 543
 20-2337-AL-ELEV A
 THE SPRUCEWOOD

47 of 50

WHIRLPOOL WASHER Model #: WFW5620HW

Custom under-counter installation: X

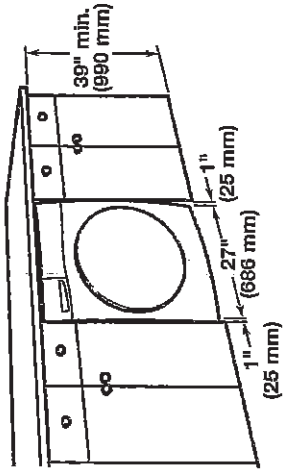

Recessed area or closet installation: X

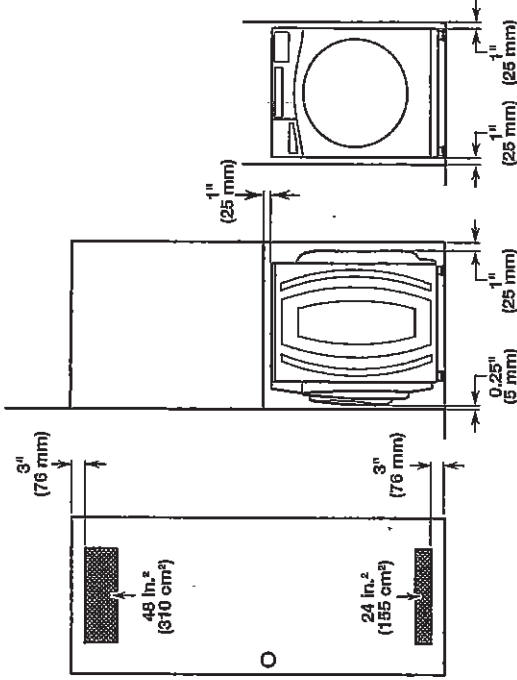

Custom cabinet installation: X

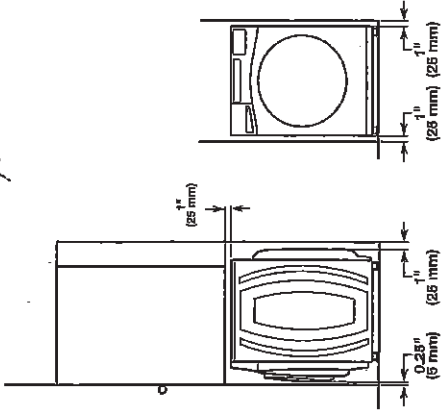

DRAIN SYSTEM

The drain system can be installed using a floor drain, wall standpipe, floor standpipe, or laundry tub. Select the method you need.

IMPORTANT: To avoid siphoning, only 4.5" (114 mm) of drain hose should be inside standpipe. Always secure drain hose with cable tie.

Floor standpipe drain system

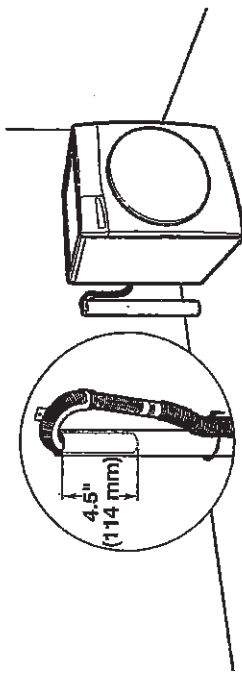

Minimum diameter for a standpipe drain: 2" (51 mm). Minimum carry-away capacity: 17 gal. (64 L) per minute. A 1/4" (6 mm) diameter to 1" (25 mm) diameter Standpipe Adapter Kit is available (Part Number 3863920). Top of standpipe must be at least 30" (762 mm) high; install no higher than 96" (2.44 m) from bottom of washer. If you have an overhead sewer and need to pump higher than 96" (2.44 m), a sump pump and associated hardware are needed. See "Alternate parts."

Wall standpipe drain system

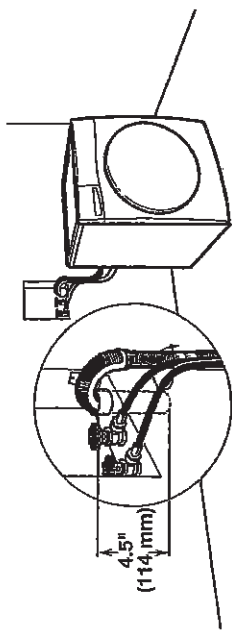

See requirements for floor standpipe drain system.

Laundry tub drain system

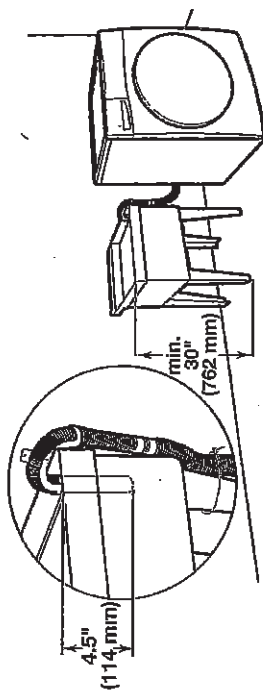

Minimum capacity: 20 gal. (76 L). Top of laundry tub must be at least 30" (762 mm) above floor; install no higher than 96" (2.44 m) from bottom of washer.

C2-COUNTRY LANE
LOT 543
20-2337-AL-ELEV A
THE SPRUCEWOOD

48 of 50

WHIRLPOOL DRYER Model #: YWED5620HW

Whirlpool Brand Canada (English) | Washers and Dryers | Dryers | Electric Dryers | YWED5620HW

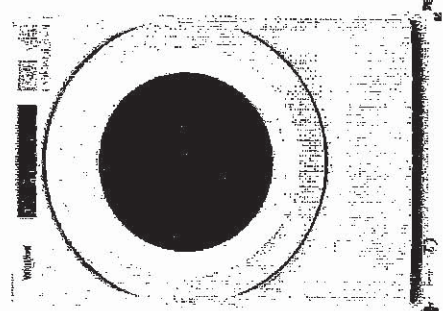

7.4 cu. ft. Front Load Electric
Dryer with Intuitive Touch
Controls



Whirlpool® 7.4 cu. ft. Front Load Electric Dryer with Intuitive Touch Controls

Model #: YWED5620HW

Dimensions

Depth	78.74 cm, 31.0 in
Depth With Door Open 90 Degree	138.43 cm, 54-1/2 in
Height	98.42 cm, 38-3/4 in
Width	68.58 cm, 27.0 in

Configuration and Overview

Fuel Type	Electric
-----------	----------

Cycles and Options

Cycle Time Remaining	Yes
Lint Filter Indicator	No
Number of Dryer Cycles	36
Number of Dryness Levels	3

Ventilation System

Long Vent	No
Maximum Vent Length	64
Venting Direction	Left, Right, Bottom, Rear

Electrical

Hz	60
Power Cord Included	Yes

C2-COUNTRY LANE
 LOT 543
 20-2337-AL-ELEV A
 THE SPRUCEWOOD

49 of 50

WHIRLPOOL DRYER Model #: YWED5620HW

Back view:

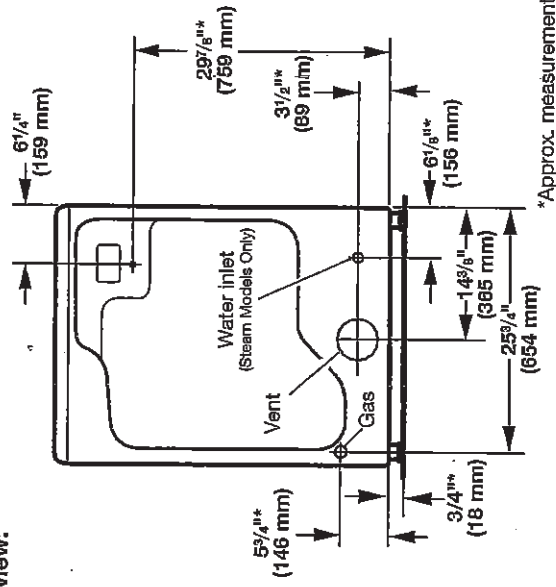

*Approx. measurement

NOTE: Most installations require a minimum of 5" (127 mm) clearance behind dryer for exhaust vent with elbow. See "Venting Requirements."

Installation Clearances

For each arrangement, consider allowing more space for ease of installation and servicing, spacing for companion appliances, and clearances for walls, doors, and floor moldings. Space must be large enough to allow door to fully open. Add spacing on all sides of dryer to reduce noise transfer. If a closet door or louvered door is installed, top and bottom air openings in door are required.

Check code requirements. Some codes limit, or do not permit, installation of the dryer in garages, closets, mobile homes, or sleeping quarters. Contact your local building inspector:

NOTE: No other fuel-burning appliance can be installed in the same closet as a dryer.

Installation spacing for recessed area or closet installation

All dimensions show recommended and minimum spacing allowed.

- Additional spacing should be considered for ease of installation and servicing.
- Additional clearances might be required for wall, door, floor moldings, dryer venting, and gas line.
- Additional spacing should be considered on all sides of the dryer to reduce noise transfer.
- For closet installation with a door, minimum ventilation openings in the top and bottom of the door are required. Louvered doors with equivalent ventilation openings are acceptable.
- Companion appliance spacing should also be considered.

Recommended installation clearances (dryer only):

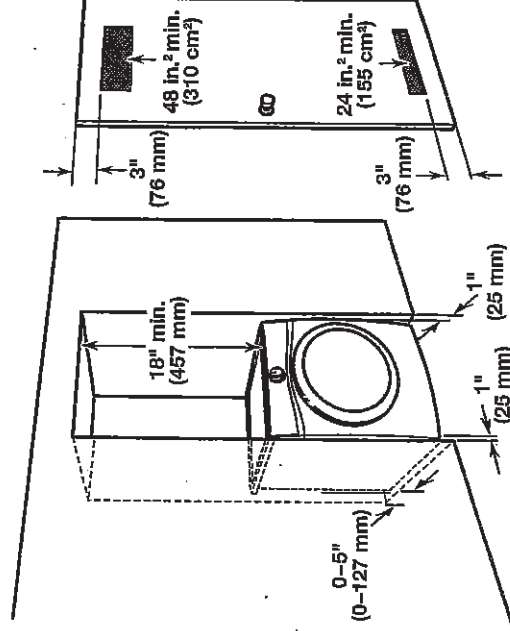

0" (0 mm) rear spacing is allowed for straight back venting only. For steam models only, inlet hose must not be kinked.

Custom under-counter installation:

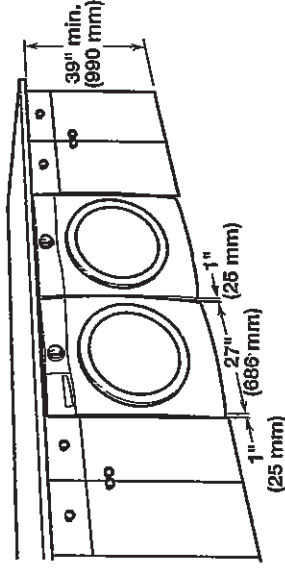

Mobile home - Additional installation requirements:

This dryer is suitable for mobile home installations. The installation must conform to the Manufactured Home Construction and Safety Standard, Title 24 CFR, Part 3280 (formerly the Federal Standard for Mobile home construction and Safety, Title 24, HUD Part 280) or Standard CAN/CSA-Z240 MH.

Mobile home installations require:

- Metal exhaust system hardware, available for purchase from your dealer. For further information, see "Assistance or Service" in your Use and Care Guide.
- Special provisions must be made in mobile homes to introduce outside air into dryer. Openings (such as a nearby window) should be at least twice as large as dryer exhaust opening.

For mobile home installation of gas dryers:

- Mobile Home Installation Hold-down Kit Part Number 346764 is available to order. For further information, see "Assistance or Service" in your Use and Care Guide.

C2- COUNTRY LANE
 LOT 543
 20-2337 AL-ELEV A
 THE SPRUCEWOOD

50 of 50

WHIRLPOOL DRYER Model #: YWED5620HW

Additional parts may be required, depending on your installation. Check local codes. Check existing electrical supply and venting. Read "Electrical Requirements" and "Venting Requirements" before purchasing parts.

If using a power supply cord:

Use a UL Listed power supply cord kit marked for use with clothes dryers. The kit should contain:

- A UL Listed 30 amp power supply cord, rated 120/240 volt minimum. The cord should be type SRD or SRDT and be at least 4 ft. (1.22 m) long. The wires that connect to the dryer must end in ring terminals or spade terminals with upturned ends.
- A UL Listed strain relief.

Optional Equipment (not supplied with dryer):

Refer to your Use and Care Guide for information about accessories available for your dryer.

LOCATION REQUIREMENTS

Check code requirements. Some codes limit, or do not permit, installing dryer in garages, closets, mobile homes, or sleeping quarters. Contact your local building inspector.

!WARNING

<p>Explosion Hazard</p> <p>Keep flammable materials and vapors, such as gasoline, away from dryer.</p> <p>Place dryer at least 18 inches (460 mm) above the floor for a garage installation.</p> <p>Failure to do so can result in death, explosion, or fire.</p>

You will need:

- A location allowing for proper exhaust installation. See "Venting Requirements."
 - A separate 15 or 20 amp circuit for a gas dryer or 30 amp circuit for an electric dryer.
 - If using power supply cord, a grounded electrical outlet located within 2 ft. (610 mm) of either side of dryer. See "Electrical Requirements."
 - Floor must support dryer weight of 200 lbs. (90.7 kg). Also consider weight of companion appliance.
 - Cold water faucets located within 4 ft. (1.2 m) of the water fill valves, and water pressure of 20–120 psi (138–827 kPa). You may use your washer's water supply by purchasing the necessary parts noted in "Parts needed."
 - Level floor with maximum slope of 1" (25 mm) under entire dryer. If slope is greater than 1" (25 mm), install Extended Dryer Feet Kit, Part Number 279810. If not level, clothes may not tumble properly and automatic sensor cycles may not operate correctly.
 - For garage installation, place dryer at least 18" (460 mm) above floor. If using a pedestal, you will need 18" (460 mm) to bottom of dryer.
 - The dryer must not be installed or stored in an area where it will be exposed to water and/or weather.
- IMPORTANT:** Do not operate, install, or store dryer where it will be exposed to water, weather, or at temperatures below 40°F (4°C). Lower temperatures may cause dryer not to shut off at end of automatic sensor cycles, resulting in longer drying times.

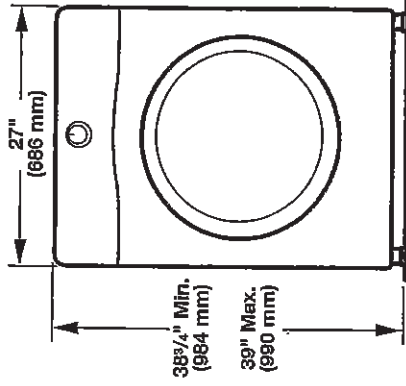
DRYER DIMENSIONS
 Front view:



Side view:
 Whirlpool Models ✓

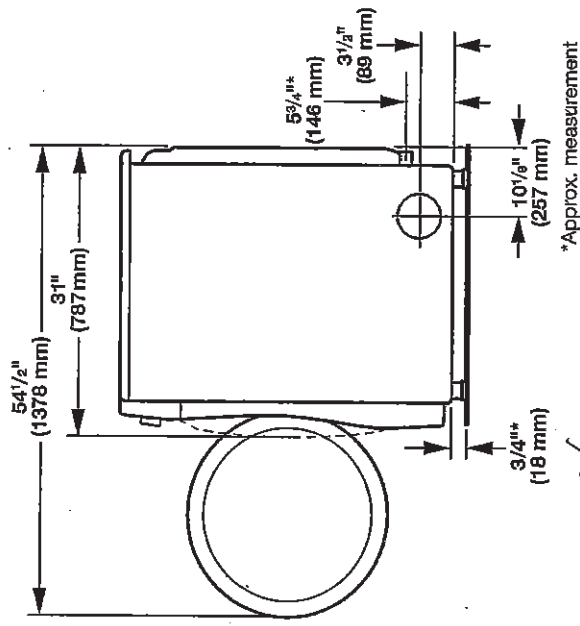

Maytag Models ✗

