



14-Jul-21

# Interior Finishing Selection Sheet

LOT 00535

20-1783-AL ELEV A THE ROSEWOOD

PURCHASERS: ELMIRA MADANI

CONTACT NO: 647-612-6115

VENDOR: HEATHWOOD HOMES (WHITBY) LIMITED - PHASE 4

UPG

## Appliances

6-8894 Kitchen HoodFan

☐ CYCLONE 30" CANOPY CHIMNEY HOODFAN (Standard for Singles Only) STAINLESS STEEL SCB51430 STD PAGE 33

## Cabinetry

122-9166 Finished Basement Bathroom Cabinet Colour/ Styles

☐ CHARLESTON ORCHID Viking III STD 3DL

124-7672 Finished Basement Bathroom Cabinet Hardware

☐ HARDWARE 135 STD

123-8796 Finished Basement Bathroom Countertop

☐ Countertop PALOMA POLAR ETCHINGS FINISH 6698-46 Formica

1-9180 Kitchen Cabinet Colour/Style

☒ ANNEX DHGL ARCTICO GLOSS Classic Plus UPG

3-9147 Kitchen Cabinet Hardware

☒ HARDWARE 12817 BN NICKEL UPG II

25-9166 Main Bathroom Cabinet Colour/Style

☐ CHARLESTON ORCHID Viking III STD 3DL

29-7672 Main Bathroom Cabinet Hardware

☐ HARDWARE 135 STD

28-8796 Main Bathroom Countertop

☐ Countertop PALOMA POLAR ETCHINGS FINISH 6698-46 Formica

20-9166 Master Ensuite Cabinet Colour/Style

☐ CHARLESTON ORCHID Viking III STD 3DL

22-7672 Master Ensuite Cabinet Hardware

☐ HARDWARE 135 STD

21-8796 Master Ensuite Countertop

☐ Countertop PALOMA POLAR ETCHINGS FINISH 6698-46 Formica

## Carpet

37-9246 Bedroom 2 Flooring

☐ Dynasty Tex 40 oz Poly BEACH SHELL DY 84558 STD

38-9246 Bedroom 3 Flooring

☐ Dynasty Tex 40 oz Poly BEACH SHELL DY 84558 STD

377-9246 Finished Basement Bedroom Flooring

☐ Dynasty Tex 40 oz Poly BEACH SHELL DY 84558 STD

285-9246 Finished Basement Rec/Hall Flooring

☐ Dynasty Tex 40 oz Poly BEACH SHELL DY 84558 STD

52-1079 Throughout Underpad

☐ Underpad 500 Series STD

## Ceramics

125-9257 Finished Basement Bathroom Flooring

☒ CARRARA White / Grey GE.CR.WHIT.1313.MT STD 13 x 13 TO BE INSTALLED AT A 45 DEGREE ANGLE.

126-7705 Finished Basement Bathroom Grout

☒ Upgrade Grout (01) Alabaster U/G

1. The Purchaser acknowledges these selections are subject to the terms and conditions of the applicable Agreement of Purchase and Sale.
2. The Purchaser acknowledges that the Vendor accepts no responsibility in the event the Vendor is unable to supply a selection. The Purchaser agrees to reselect from the currently available selections immediately upon request.
3. The Vendor reserves the right to substitute above materials and equipment with that of equal or better quality.
4. Purchaser acknowledges that items may not be exactly as shown. Variations from the Vendor's samples may occur in finished materials due to normal production processes. Vendor is not responsible for shade difference which may occur from different dye lots or wood grains. Variations from the Vendor's samples will occur with natural materials such as wood, marble, granite, hardwood and brick.
5. The Vendor reserves the right to select Grout & Thresholds that best suits the Tile selected.
6. Selections will not be processed unless signed by Heathwood Homes Head Office.
7. The colour selections made on the Colour Chart are final and cannot be changed once submitted.
8. The Purchaser has checked and acknowledges the accuracy of this Colour Chart.

07/14/2021

Date

Purchaser

Date

APPROVED

Décor Consultant

Date

Purchaser

Date Approved

HEATHWOOD HOMES (WHITBY)  
LIMITED - PHASE 4



14-Jul-21

# Interior Finishing Selection Sheet

LOT 00535

20-1783-AL ELEV A THE ROSEWOOD

PURCHASERS: ELMIRA MADANI

CONTACT NO: 647-612-6115

VENDOR: HEATHWOOD HOMES (WHITBY) LIMITED - PHASE 4

## Ceramics

127-8833 Finished Basement Bathroom Wall Tile

128-2226 Finished Basement Bathroom Wall Tile Grout

16-8683 Foyer Flooring

17-2222 Foyer Grout

4-8640 Kitchen Backsplash

5-2226 Kitchen Backsplash Grout

140-5618 Landing at Garage Entry Flooring

141-2222 Landing at Garage Entry Grout

30-9242 Main Bathroom Flooring

31-7705 Main Bathroom Grout

112-8833 Main Bathroom Tub Wall Tile

113-2226 Main Bathroom Tub Wall Tile Grout

23-9244 Master Ensuite Floor Tile

24-7705 Master Ensuite Floor Tile Grout

73-8640 Master Ensuite Shower Floor Tile

74-2226 Master Ensuite Shower Floor Tile Grout

147-8923 Master Ensuite Shower Jamb(s) and Sill(s)

104-8640 Master Ensuite Shower Wall Tile

105-2226 Master Ensuite Shower Wall Tile Grout

32-5696 Powder Room Flooring

## UPG

☐ Uniwall White QT.UW.WHT.0810 STD 8 x 10 INSTALL STACKED HORIZONTALLY

☐ Grout (00) White STD

☒ Regal Polished Light Mocha Polished NY.RG.LTM.2424.PL UPG 6 24 x 24

☐ Grout (105) Driftwood STD

☒ Penny Rounds Snow White Glossy WB.PR.SWT.1212.GL UPG 4 12 x 12

☐ Grout (00) White STD

☒ Regal Polished Light Mocha NY.RG.LTM.1212 UPG\_3 12 x 12

☐ Grout (105) Driftwood STD

☒ Eterna Volkas Polished OV.ET.VLK.1224.PL UPG\_5 12 x 24 SEE SKETCH # 8 PAGE 23 FOR 12 X 24 TILE DIRECTION

☒ Upgrade Grout (01) Alabaster U/G

☐ Uniwall White QT.UW.WHT.0810 STD 8 x 10 INSTALL STACKED HORIZONTALLY

☐ Grout (00) White STD

☒ Eterna Volkas Polished OV.ET.VLK.2424.PL UPG\_6 24 x 24

☒ Upgrade Grout (01) Alabaster U/G

☒ Penny Rounds Snow White Glossy WB.PR.SWT.1212.GL UPG 4 12 x 12

☐ Grout (00) White STD

☐ Shower Jamb / Sill Thassos White STD

☒ Penny Rounds Snow White Glossy WB.PR.SWT.1212.GL UPG 4 12 x 12

☐ Grout (00) White STD

☒ Regal Polished Light Mocha NY.RG.LTM.1224.PL UPG\_4 12 x 24 SEE SKETCH # 6 PAGE 21 FOR 12 X 24 TILE DIRECTION

1. The Purchaser acknowledges these selections are subject to the terms and conditions of the applicable Agreement of Purchase and Sale.
2. The Purchaser acknowledges that the Vendor accepts no responsibility in the event the Vendor is unable to supply a selection. The Purchaser agrees to reselect from the currently available selections immediately upon request.
3. The Vendor reserves the right to substitute above materials and equipment with that of equal or better quality.
4. Purchaser acknowledges that items may not be exactly as shown. Variations from the Vendor's samples may occur in finished materials due to normal production processes. Vendor is not responsible for shade difference which may occur from different dye lots or wood grains. Variations from the Vendor's samples will occur with natural materials such as wood, marble, granite, hardwood and brick.
5. The Vendor reserves the right to select Grout & Thresholds that best suits the Tile selected.
6. Selections will not be processed unless signed by Heathwood Homes Head Office.
7. The colour selections made on the Colour Chart are final and cannot be changed once submitted.
8. The Purchaser has checked and acknowledges the accuracy of this Colour Chart.

Date

Date

Purchaser

Purchaser

Date

Date Approved

Décor Consultant

HEATHWOOD HOMES (WHITBY) LIMITED - PHASE 4



14-Jul-21

# Interior Finishing Selection Sheet

20-1783-AL ELEV A THE ROSEWOOD

LOT 00535

PURCHASERS: ELMIRA MADANI

CONTACT NO: 647-612-6115

VENDOR: HEATHWOOD HOMES (WHITBY) LIMITED - PHASE 4

## Ceramics

33-2222 Powder Room Grout

53-2232 Throughout Thresholds

## Electrical

90-5796 Throughout Switches and Plug

## Fireplace

136-8892 Great Room Fireplace Mantle

138-8873 Great Room Fireplace Surround

135-5529 Great Room Fireplace Type

## Granite

2-9131 Kitchen Countertop

## Hardwood

11-9060 Great Room Flooring

7-9060 Kitchen/Breakfast Flooring

98-9060 Main Hall Flooring

36-9060 Master Bedroom Flooring

78-8906 Stair Landing to Lower Level Flooring

77-8906 Stair Landing to Upper Level Flooring

35-9060 Upper Hall Flooring

UPG

☐ Grout (105) Driftwood STD

☐ Metal Thresholds STD

☐ Decora White Switches and Plugs STD

☐ Paint Grade Mantle- 6" Deep Mantle WHITE NF-17 STD

☐ 3 pc- 4" Marble Surround Nero Marquina STD

☐ 36" Direct Vent Gas Fireplace

☒ Quartz-Caesarstone EMPIRA WHITE #5151 Group 7 UPG 3/4" with Mitered Edge ISLAND TO HAVE 2 SIDED WATERFALL

☒ White Oak PEARL-Vintage Northern Solid Sawn : White Oak : Sculpted Pearl-APOLLO-3/4 inch x 5 inch APOLLO White Oak PEARL 3/4" X 5"

☒ White Oak PEARL-Vintage Northern Solid Sawn : White Oak : Sculpted Pearl-APOLLO-3/4 inch x 5 inch APOLLO White Oak PEARL 3/4" X 5"

☒ White Oak PEARL-Vintage Northern Solid Sawn : White Oak : Sculpted Pearl-APOLLO-3/4 inch x 5 inch APOLLO White Oak PEARL 3/4" X 5"

☒ White Oak PEARL-Vintage Northern Solid Sawn : White Oak : Sculpted Pearl-APOLLO-3/4 inch x 5 inch APOLLO White Oak PEARL 3/4" X 5"

☒ Vintage 5" Pre-Sanded Smooth Unfinished Red Oak Unfinished Red Oak 3/4" x 5" TO BE STAINED SAMBUCCA TO MATCH STAIRCASE

☒ Vintage 5" Pre-Sanded Smooth Unfinished Red Oak Unfinished Red Oak 3/4" x 5" TO STAINED SMBUCCA TO MATCH STAIRCASE

☒ White Oak PEARL-Vintage Northern Solid Sawn : White Oak : Sculpted Pearl-APOLLO-3/4 inch x 5 inch APOLLO White Oak PEARL 3/4" X 5"

1. The Purchaser acknowledges these selections are subject to the terms and conditions of the applicable Agreement of Purchase and Sale.
2. The Purchaser acknowledges that the Vendor accepts no responsibility in the event the Vendor is unable to supply a selection. The Purchaser agrees to reselect from the currently available selections immediately upon request.
3. The Vendor reserves the right to substitute above materials and equipment with that of equal or better quality.
4. Purchaser acknowledges that items may not be exactly as shown. Variations from the Vendor's samples may occur in finished materials due to normal production processes. Vendor is not responsible for shade difference which may occur from different dye lots or wood grains. Variations from the Vendor's samples will occur with natural materials such as wood, marble, granite, hardwood and brick.
5. The Vendor reserves the right to select Grout & Thresholds that best suits the Tile selected.
6. Selections will not be processed unless signed by Heathwood Homes Head Office.
7. The colour selections made on the Colour Chart are final and cannot be changed once submitted.
8. The Purchaser has checked and acknowledges the accuracy of this Colour Chart.

07/14/2021

Date

Purchaser

Date

Décor Consultant

Date

Purchaser

Date Approved

HEATHWOOD HOMES (WHITBY)  
LIMITED - PHASE 4



14-Jul-21

# Interior Finishing Selection Sheet

20-1783-AL ELEV A THE ROSEWOOD

LOT 00535

PURCHASERS: ELMIRA MADANI

CONTACT NO: 647-612-6115

VENDOR: HEATHWOOD HOMES (WHITBY) LIMITED - PHASE 4

UPG

## Interior Railings

49-8148 Stairs to Lower Level Handrail/Pickets/Posts Type

☐ Single Collar Alt. Plain w/ Shoes with 3 1/2" Square/Cap Post(s) BLACK METAL STD

43-8148 Stairs to Upper Level Handrail/Pickets/Posts Type

☐ Single Collar Alt. Plain w/ Shoes with 3 1/2" Square/Cap Post(s) BLACK METAL STD

## Interior Stairs

45-1712 Stairs to Lower Level Type

☐ Oak Stairs UPG\_1

39-1712 Stairs to Upper Level Type

☐ Oak Stairs UPG\_1

## Interior Trim

91-8704 Throughout Trim Size

☐ 5 1/4" Baseboards and 3" Integrated Backbend Casings STD-Singles

## Painting

46-7761 Stairs to Lower Level Colour

☐ Stain handrail, stringers, treads, risers, nosing & posts. (Metal pickets) STAIRS TO BE STAINED SAMBUCCA

40-7761 Stairs to Upper Level Colour

☐ Stain handrail, stringers, treads, risers, nosing & posts. (Metal pickets) STAIRS TO BE STAINED SAMBUCCA

240-1716 Throughout Trim - Paint Colour

☐ Trim WHITE STD

51-1717 Throughout Walls - Paint Colour

☐ Wall WARM GREY 22 STD

## Plumbing

268-1737 Finished Basement Bathroom Plumbing Fixture (Colour)

☐ Plumbing Fixtures WHITE STD

266-1737 Main Bathroom Plumbing Fixture (Colour)

☐ Plumbing Fixtures WHITE STD

149-1737 Master Ensuite Plumbing Fixture (colour)

☐ Plumbing Fixtures WHITE STD

34-1737 Powder Room Plumbing Fixture (Colour)

☐ Plumbing Fixtures WHITE STD

1. The Purchaser acknowledges these selections are subject to the terms and conditions of the applicable Agreement of Purchase and Sale.
2. The Purchaser acknowledges that the Vendor accepts no responsibility in the event the Vendor is unable to supply a selection. The Purchaser agrees to reselect from the currently available selections immediately upon request.
3. The Vendor reserves the right to substitute above materials and equipment with that of equal or better quality.
4. Purchaser acknowledges that items may not be exactly as shown. Variations from the Vendor's samples may occur in finished materials due to normal production processes. Vendor is not responsible for shade difference which may occur from different dye lots or wood grains. Variations from the Vendor's samples will occur with natural materials such as wood, marble, granite, hardwood and brick.
5. The Vendor reserves the right to select Grout & Thresholds that best suits the Tile selected.
6. Selections will not be processed unless signed by Heathwood Homes Head Office.
7. The colour selections made on the Colour Chart are final and cannot be changed once submitted.
8. The Purchaser has checked and acknowledges the accuracy of this Colour Chart.

07/14/2021

Date

Purchaser

Date

APPROVED

Décor Consultant

Date

Purchaser

Date Approved

HEATHWOOD HOMES (WHITBY) LIMITED - PHASE 4



Sales Selection Sheet

14-Jul-21

LOT 00535

20-1783-AL ELEV A THE ROSEWOOD

PURCHASERS: ELMIRA MADANI

CONTACT NO: 647-612-6115

VENDOR: HEATHWOOD HOMES (WHITBY) LIMITED - PHASE 4

HST #

It is herein understood and agreed between the undersigned parties hereto that the following changes shall be made to the above mentioned Agreement of Purchase and Sale in accordance with the agreement and except for such changes noted below, all other terms and conditions in the Agreement of Purchase and Sale shall remain as stated herein: It is further understood that and agreed that all changes and additions shall be installed as per builder's specifications, location and available selections. The Purchaser hereby agrees to purchase the following extras:

Appliances

2151 Laundry Pair Stacking Kit Qty: 1  
Supply and Install Laundry Pair Stacking Kit Before June 1, 2021

Cabinetry

2257 Optional Upgrade Classic Kitchen Qty: 1  
CLASSIC PLUS

1377 Optional Extras KITCHEN Qty: 1  
Combo: 12B+10B- Pots and pans drawers (width min. 60cm/max. 90cm) (size subject to floor plan) with upgraded drawers from Metabox to Tandembox Before June 1, 2021 VIKING  
SEE SKETCH # 7 PAGE 22 FOR LOCATION

1299 Optional Extras KITCHEN Qty: 1  
27B- Base pie-cut corner with lazy-Susan (includes [2] white 270-degree plastic trays) Classic SKETCH # 7 PAGE 22

1329 Optional Extras Kitchen Qty: 1  
03G- Cabinet hardware upgrade II display board for Kitchen Before June 1, 2021 VIKING

1294 Optional Extras MASTER ENSUITE/MAIN BATH Qty: 2  
11B- Bank of drawers (max. width 55cm) (size subject to floor plan) Classic SKETCH # 9 PAGE 24

1. This Sales Selection Sheet when properly executed forms part of our Agreement of Purchase and Sale.
2. All extras and upgrades listed above are subject to Construction Progress and Architectural and Municipal requirements.
3. In the event the Vendor is unable to incorporate the work approved above in the construction of the house for any reason whatsoever, the Vendor will not be liable to the Purchaser in any way. The monies paid for any changes or optional extras not proceeded with shall be returned to the Purchaser, without interest. The cost of options or extras is non-refundable in all other circumstances. If for any reason whatsoever the Agreement of Purchase and Sale is not completed, the total cost of work approved above will be retained by the Vendor.
4. The Vendor reserves the right to substitute above materials and equipment with that of equal or better quality.
5. Purchaser acknowledges that items may not be exactly as shown. Variations from the Vendor's samples may occur in finished materials due to normal production processes. Vendor is not responsible for shade difference which may occur from different dye lots or wood grains. Variations from the Vendor's samples will occur with natural materials such as wood, marble, granite, hardwood and brick.
6. The Vendor reserves the right to select Grout & Thresholds that best suits the Tile selected.
7. Selections will not be processed unless signed by Heathwood Homes Head Office.
8. The selections made on this schedule are final and cannot be changed once submitted.
9. The Purchaser has checked and acknowledges the accuracy of this schedule.

Date

Purchaser

Date APPROVED

Décor Consultant

Date

Purchaser

-07- 19 2021

Date Approved HEATHWOOD HOMES (WHITBY)  
LIMITED - PHASE 4



14-Jul-21

# Sales Selection Sheet

15 of 19

LOT 00535

20-1783-AL ELEV A THE ROSEWOOD

PURCHASERS: ELMIRA MADANI

CONTACT NO: 647-612-6115

VENDOR: HEATHWOOD HOMES (WHITBY) LIMITED - PHASE 4

HST #

It is herein understood and agreed between the undersigned parties hereto that the following changes shall be made to the above mentioned Agreement of Purchase and Sale in accordance with the agreement and except for such changes noted below, all other terms and conditions in the Agreement of Purchase and Sale shall remain as stated herein: It is further understood that and agreed that all changes and additions shall be installed as per builder's specifications, location and available selections. The Purchaser hereby agrees to purchase the following extras:

## Optional Extras

MASTER  
ENSUITE/MAIN/BASE  
MENT

Qty: 3

04D- Increase vanity to kitchen height greater than 3' (90cm high, maintains vanity depth)

ALL VANITIES TO BE EXTENDED HEIGHT AS PER AGREEMENT OF PURCHASE AND SALE - NO CHARGE

SKETCH # 9 PAGE 24

## Ceramics

2198

Upgrade Grout

Basement Bath Floor

Qty: 1

2198

Install in Specified Pattern

INSTALL STD 13 X 13 ON 45 DEGREE ANGLE

Basement Bath Floor

Qty: 1

2199

Upgrade 6 Tile

Foyer Floor

Qty: 1

2205

Upgrade 4 Tile

Kit. Basplash

Qty: 1

2203

Upgrade Grout

Main/Shrd Bath Floor

Qty: 1

2203

Upgrade 5 Tile

SEENSKETCH # 8  
X 24 TILE DIRECTION

Main/Shrd Bath Floor

Qty: 1

PAGE

23

FOR 12

1. This Sales Selection Sheet when properly executed forms part of our Agreement of Purchase and Sale.
2. All extras and upgrades listed above are subject to Construction Progress and Architectural and Municipal requirements.
3. In the event the Vendor is unable to incorporate the work approved above in the construction of the house for any reason whatsoever, the Vendor will not be liable to the Purchaser in any way. The monies paid for any changes or optional extras not proceeded with shall be returned to the Purchaser, without interest. The cost of options or extras is non-refundable in all other circumstances. If for any reason whatsoever the Agreement of Purchase and Sale is not completed, the total cost of work approved above will be retained by the Vendor.
4. The Vendor reserves the right to substitute above materials and equipment with that of equal or better quality.
5. Purchaser acknowledges that items may not be exactly as shown. Variations from the Vendor's samples may occur in finished materials due to normal production processes. Vendor is not responsible for shade difference which may occur from different dye lots or wood grains. Variations from the Vendor's samples will occur with natural materials such as wood, marble, granite, hardwood and brick.
6. The Vendor reserves the right to select Grout & Thresholds that best suits the Tile selected.
7. Selections will not be processed unless signed by Heathwood Homes Head Office.
8. The selections made on this schedule are final and cannot be changed once submitted.
9. The Purchaser has checked and acknowledges the accuracy of this schedule.

Date

Purchaser

Date

Décor Consultant

Date

Purchaser

Date Approved

HEATHWOOD HOMES (WHITBY)  
LIMITED - PHASE 4



14-Jul-21

Sales Selection Sheet

LOT 00535

20-1783-AL ELEV A THE ROSEWOOD

PURCHASERS: ELMIRA MADANI

CONTACT NO: 647-612-6115

VENDOR: HEATHWOOD HOMES (WHITBY) LIMITED - PHASE 4

HST #

It is herein understood and agreed between the undersigned parties hereto that the following changes shall be made to the above mentioned Agreement of Purchase and Sale in accordance with the agreement and except for such changes noted below, all other terms and conditions in the Agreement of Purchase and Sale shall remain as stated herein: It is further understood that and agreed that all changes and additions shall be installed as per builder's specifications, location and available selections. The Purchaser hereby agrees to purchase the following extras:

2204	Master Bath Floor	Qty: 1
Upgrade 6 Tile		
2204	Master Bath Floor	Qty: 1
Upgrade Grout		
2197	Master Shower Shower Floor	Qty: 1
Upgrade 6 Tile		
2196	Master Shower Wall	Qty: 1
Upgrade 4 Tile		
2201	Mud Room Floor	Qty: 1
Upgrade 3 Tile		
2200	Powder Floor	Qty: 1
Upgrade 5 Tile		
SEE SKETCH # 6	PAGE 21	FOR 12 X 24
TILE DIRECTION		

Fireplace

81	Purchasers have been advised: heat from the FP can damage TV above a FP and items placed on mantle. Purchasers acknowledge: Heathwood Homes and its contractors will not be liable for any damage on items placed/installed above a FP after closing	Qty: 1
----	--	--------

Granite

1. This Sales Selection Sheet when properly executed forms part of our Agreement of Purchase and Sale.
2. All extras and upgrades listed above are subject to Construction Progress and Architectural and Municipal requirements.
3. In the event the Vendor is unable to incorporate the work approved above in the construction of the house for any reason whatsoever, the Vendor will not be liable to the Purchaser in any way. The monies paid for any changes or optional extras not proceeded with shall be returned to the Purchaser, without interest. The cost of options or extras is non-refundable in all other circumstances. If for any reason whatsoever the Agreement of Purchase and Sale is not completed, the total cost of work approved above will be retained by the Vendor.
4. The Vendor reserves the right to substitute above materials and equipment with that of equal or better quality.
5. Purchaser acknowledges that items may not be exactly as shown. Variations from the Vendor's samples may occur in finished materials due to normal production processes. Vendor is not responsible for shade difference which may occur from different dye lots or wood grains. Variations from the Vendor's samples will occur with natural materials such as wood, marble, granite, hardwood and brick.
6. The Vendor reserves the right to select Grout & Thresholds that best suits the Tile selected.
7. Selections will not be processed unless signed by Heathwood Homes Head Office.
8. The selections made on this schedule are final and cannot be changed once submitted.
9. The Purchaser has checked and acknowledges the accuracy of this schedule.

07/14/2021

Date

Purchaser

Date

APPROVED

Décor Consultant

Date

Purchaser

Date Approved

HEATHWOOD HOMES (WHITBY)  
LIMITED - PHASE 4



14-Jul-21

Sales Selection Sheet  
17 of 19

LOT 00535

20-1783-AL ELEV A THE ROSEWOOD

PURCHASERS: ELMIRA MADANI

CONTACT NO: 647-612-6115

VENDOR: HEATHWOOD HOMES (WHITBY) LIMITED - PHASE 4

HST #

It is herein understood and agreed between the undersigned parties hereto that the following changes shall be made to the above mentioned Agreement of Purchase and Sale in accordance with the agreement and except for such changes noted below, all other terms and conditions in the Agreement of Purchase and Sale shall remain as stated herein: It is further understood that and agreed that all changes and additions shall be installed as per builder's specifications, location and available selections. The Purchaser hereby agrees to purchase the following extras:

2282	<b>Optional Upgrade</b> Countertop 3/4" GROUP 7 with double edge TO HAVE WATERFALL ON BOTH SIDES	<b>Kitchen</b>	Qty: 1
2165	<b>Optional Extras *</b> Waterfall End 3' Island TWO sides 1 1/2" Mitered Edge GROUP 7 SKETCH # 7 PAGE 22	<b>Kitchen Island</b>	Qty: 1
2170	<b>Optional Extras *</b> Granite cutout for electrical plug on island due to waterfall end Before June 1, 2021	<b>Kitchen Island</b>	Qty: 1

#### Hardwood

2329	<b>Vintage</b> 5" WHITE OAK SCULPTED NSS UV-Oil or Pearl	<b>GREAT</b>	Qty: 1
2337	<b>Vintage</b> 5" WHITE OAK SCULPTED NSS UV-Oil or Pearl	<b>KIT / BREAK</b>	Qty: 1
2330	<b>Vintage</b> 5" WHITE OAK SCULPTED NSS UV-Oil or Pearl	<b>M. HALL</b>	Qty: 1
2334	<b>Vintage</b> 5" WHITE OAK SCULPTED NSS UV-Oil or Pearl	<b>M/B</b>	Qty: 1
2331	<b>Vintage</b> 5" WHITE OAK SCULPTED NSS UV-Oil or Pearl	<b>UPPER HALL</b>	Qty: 1

#### Mirrors/Glass Products

533	Delete ALL bathroom mirrors throughout (including mirror in powder room)	Qty: 1
-----	--	--------

1. This Sales Selection Sheet when properly executed forms part of our Agreement of Purchase and Sale.
2. All extras and upgrades listed above are subject to Construction Progress and Architectural and Municipal requirements.
3. In the event the Vendor is unable to incorporate the work approved above in the construction of the house for any reason whatsoever, the Vendor will not be liable to the Purchaser in any way. The monies paid for any changes or optional extras not proceeded with shall be returned to the Purchaser, without interest. The cost of options or extras is non-refundable in all other circumstances. If for any reason whatsoever the Agreement of Purchase and Sale is not completed, the total cost of work approved above will be retained by the Vendor.
4. The Vendor reserves the right to substitute above materials and equipment with that of equal or better quality.
5. Purchaser acknowledges that items may not be exactly as shown. Variations from the Vendor's samples may occur in finished materials due to normal production processes. Vendor is not responsible for shade difference which may occur from different dye lots or wood grains. Variations from the Vendor's samples will occur with natural materials such as wood, marble, granite, hardwood and brick.
6. The Vendor reserves the right to select Grout & Thresholds that best suits the Tile selected.
7. Selections will not be processed unless signed by Heathwood Homes Head Office.
8. The selections made on this schedule are final and cannot be changed once submitted.
9. The Purchaser has checked and acknowledges the accuracy of this schedule.

07/14/2021

Date

Purchaser

DATE APPROVED

Décor Consultant

Date

Purchaser

07-19-2021

Date Approved HEATHWOOD HOMES (WHITBY)  
LIMITED - PHASE 4





14-Jul-21

# Sales Selection Sheet

18 of 19

LOT 00535

20-1783-AL ELEV A THE ROSEWOOD

PURCHASERS: ELMIRA MADANI

CONTACT NO: 647-612-6115

VENDOR: HEATHWOOD HOMES (WHITBY) LIMITED - PHASE 4

HST #

It is herein understood and agreed between the undersigned parties hereto that the following changes shall be made to the above mentioned Agreement of Purchase and Sale in accordance with the agreement and except for such changes noted below, all other terms and conditions in the Agreement of Purchase and Sale shall remain as stated herein: It is further understood that and agreed that all changes and additions shall be installed as per builder's specifications, location and available selections. The Purchaser hereby agrees to purchase the following extras:

## Painting

### 531 Optional Extras - PAINT / STAIN - Custom

Qty: 2

Stain stair landing less than 25sq/ft in sambucca. For stair with metal pickets only.  
5" (Unfinished Pre-sanded) smooth hardwood will be installed and to be stained in sambucca to match the stairs

## Plumbing

### 311 Kitchen Sink Upgrade

KITCHEN

Qty: 1

Blanco Kitchen Sink PRECIS U 1 3/4 (33" x 18") Undermount Large/Medium Bowl 9-1/2" Deep COLOUR: WHITE Model#401706 PAGE 26

### 161 Moen -CHATEAU

POWDER ROOM

Qty: 1

2 Handle Widespread Lavatory Chrome Faucet with Pop-Up Drain (Model#4945) in lieu of standard single lever PAGE 29

## Waffle Ceiling

### 2190 Optional Extra

GREAT ROOM

Qty: 1

Install Waffle Ceiling in main floor great room

SKETCH # 6 PAGE 21

1. This Sales Selection Sheet when properly executed forms part of our Agreement of Purchase and Sale.
2. All extras and upgrades listed above are subject to Construction Progress and Architectural and Municipal requirements.
3. In the event the Vendor is unable to incorporate the work approved above in the construction of the house for any reason whatsoever, the Vendor will not be liable to the Purchaser in any way. The monies paid for any changes or optional extras not proceeded with shall be returned to the Purchaser, without interest. The cost of options or extras is non-refundable in all other circumstances. If for any reason whatsoever the Agreement of Purchase and Sale is not completed, the total cost of work approved above will be retained by the Vendor.
4. The Vendor reserves the right to substitute above materials and equipment with that of equal or better quality.
5. Purchaser acknowledges that items may not be exactly as shown. Variations from the Vendor's samples may occur in finished materials due to normal production processes. Vendor is not responsible for shade difference which may occur from different dye lots or wood grains. Variations from the Vendor's samples will occur with natural materials such as wood, marble, granite, hardwood and brick.
6. The Vendor reserves the right to select Grout & Thresholds that best suits the Tile selected.
7. Selections will not be processed unless signed by Heathwood Homes Head Office.
8. The selections made on this schedule are final and cannot be changed once submitted.
9. The Purchaser has checked and acknowledges the accuracy of this schedule.

6/7/14/2021

Date

Purchaser

Date APPROVED

Décor Consultant

07-10-2021

Date

Purchaser

Date Approved HEATHWOOD HOMES (WHITBY)  
LIMITED - PHASE 4



14-Jul-21

Sales Selection Sheet

OF 49

LOT 00535

20-1783-AL ELEV A THE ROSEWOOD

PURCHASERS: ELMIRA MADANI

CONTACT NO: 647-612-6115

VENDOR: HEATHWOOD HOMES (WHITBY) LIMITED - PHASE 4

HST #

It is herein understood and agreed between the undersigned parties hereto that the following changes shall be made to the above mentioned Agreement of Purchase and Sale in accordance with the agreement and except for such changes noted below, all other terms and conditions in the Agreement of Purchase and Sale shall remain as stated herein: It is further understood that and agreed that all changes and additions shall be installed as per builder's specifications, location and available selections. The Purchaser hereby agrees to purchase the following extras:

1. This Sales Selection Sheet when properly executed forms part of our Agreement of Purchase and Sale.
2. All extras and upgrades listed above are subject to Construction Progress and Architectural and Municipal requirements.
3. In the event the Vendor is unable to incorporate the work approved above in the construction of the house for any reason whatsoever, the Vendor will not be liable to the Purchaser in any way. The monies paid for any changes or optional extras not proceeded with shall be returned to the Purchaser, without interest. The cost of options or extras is non-refundable in all other circumstances. If for any reason whatsoever the Agreement of Purchase and Sale is not completed, the total cost of work approved above will be retained by the Vendor.
4. The Vendor reserves the right to substitute above materials and equipment with that of equal or better quality.
5. Purchaser acknowledges that items may not be exactly as shown. Variations from the Vendor's samples may occur in finished materials due to normal production processes. Vendor is not responsible for shade difference which may occur from different dye lots or wood grains. Variations from the Vendor's samples will occur with natural materials such as wood, marble, granite, hardwood and brick.
6. The Vendor reserves the right to select Grout & Thresholds that best suits the Tile selected.
7. Selections will not be processed unless signed by Heathwood Homes Head Office.
8. The selections made on this schedule are final and cannot be changed once submitted.
9. The Purchaser has checked and acknowledges the accuracy of this schedule.

07/14/2021

Date

Purchaser

Date

APPROVED

Décor Consultant

07-18-2021

myRosen

Date

Purchaser

Date Approved HEATHWOOD HOMES (WHITBY)  
LIMITED - PHASE 4

C2-COUNTRY LANE  
LOT 535  
20-1783 AL ELEV A  
THE APPLEDALE

20 of 49  
The Rosewood

20-1783 ALT ELEV. A

ELEVATION A: 2,332 SQUARE FEET  
{ Includes 549 square feet of finished Lower Level }

Sketch #5

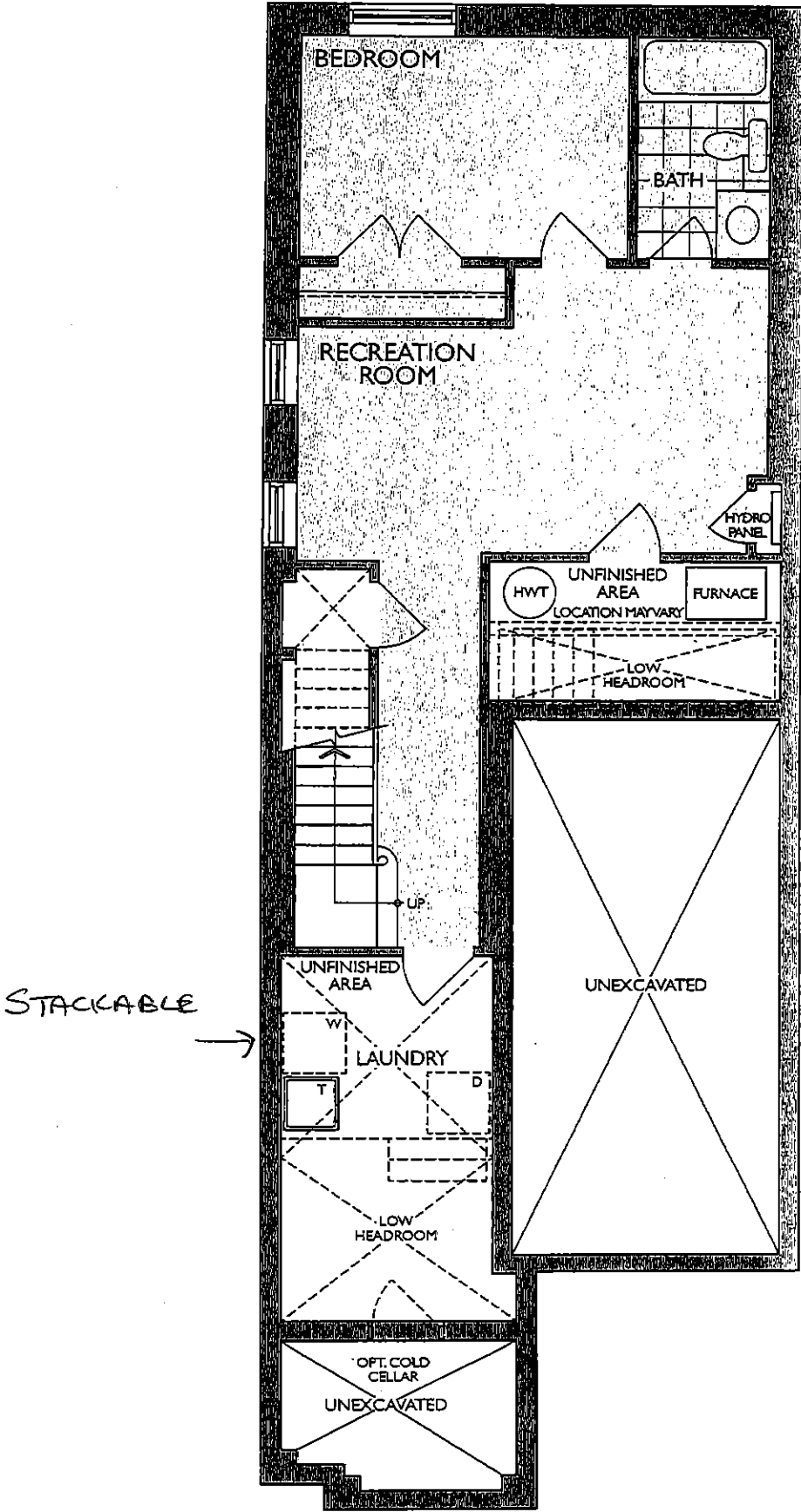

LOWER LEVEL  
ELEV. A

✓

C2-COUNTRY LANE  
LOT 535  
20-1783 AL ELEV A  
THE APPLIEDALE

21 of 49

# The Rosewood

20-1783 ALT ELEV. A

ELEVATION A: 2,332 SQUARE FEET  
{ Includes 549 square feet of finished Lower Level }

Sketch #6

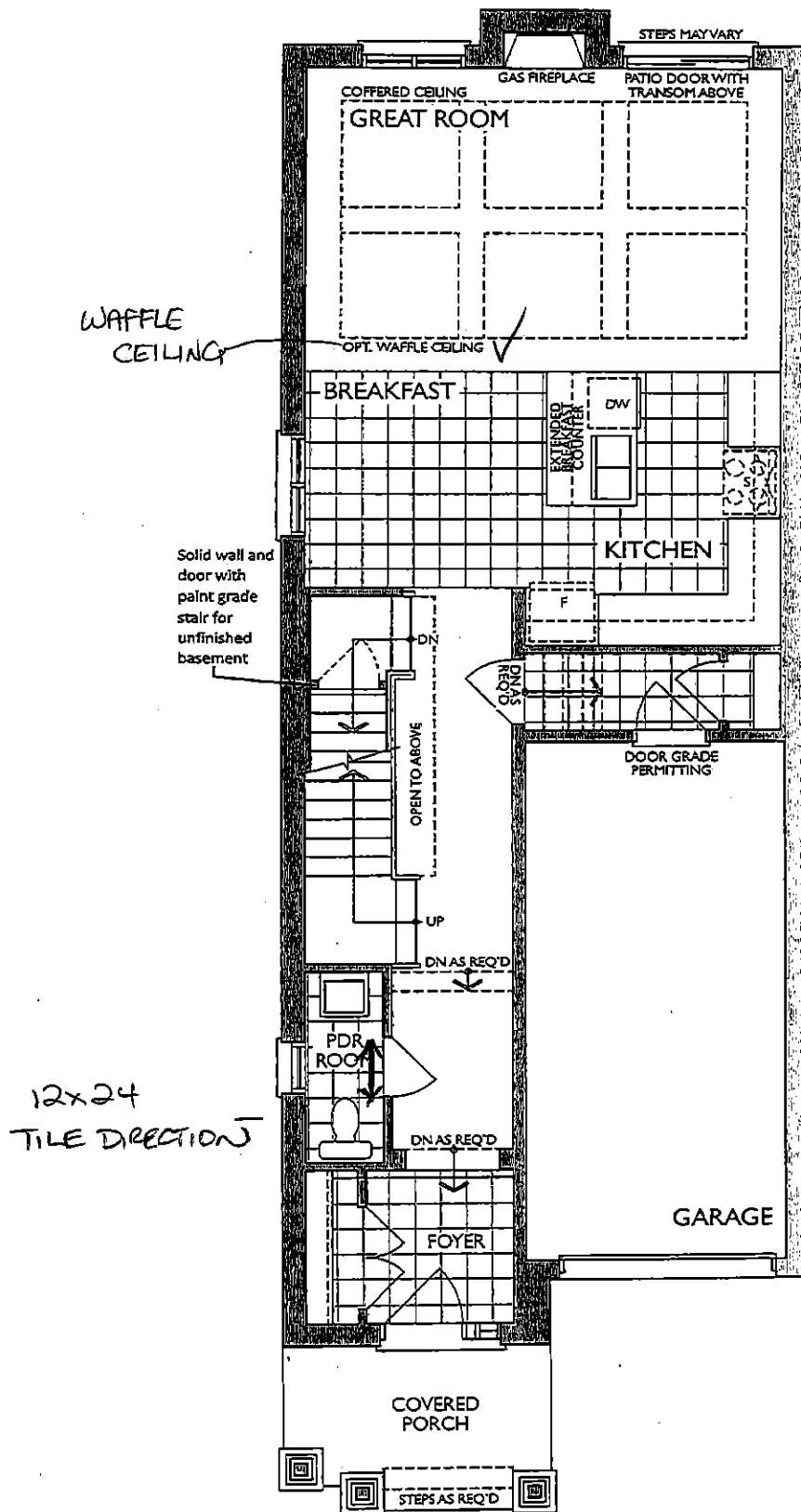

GROUND FLOOR  
ELEV. A

*[Signature]*



FRANKLIN  
KITCHEN  
1990

C2-COUNTRY LANE  
LOT 535  
20-1783 AL ELEV A  
THE APPLEDALE

Heathw  
Country

20-1783,  
The C

Standard F

- Tandem I
- Drawers
- Blumotion
- Crown M
- Top Draw
- Deep Fric
- w/Deep
- Tall uppe.

22 OF 49

Drawn By: Sepideh B  
Date: May 23, 2019  
Revision:  
Scale: Not To Scale

Approved By Builder:

Date:

Sketch # 7

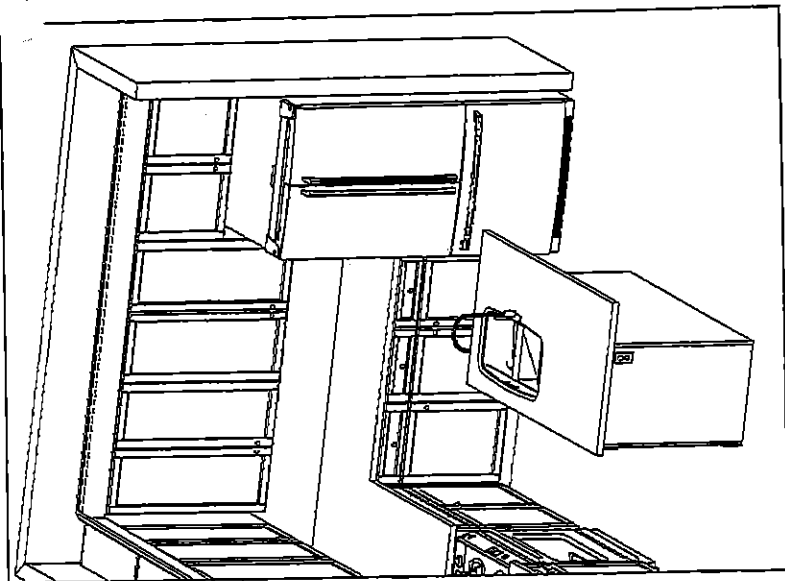

DEEP UPPER  
STANDARD AS  
PER CLASSIC / DRAUSEY

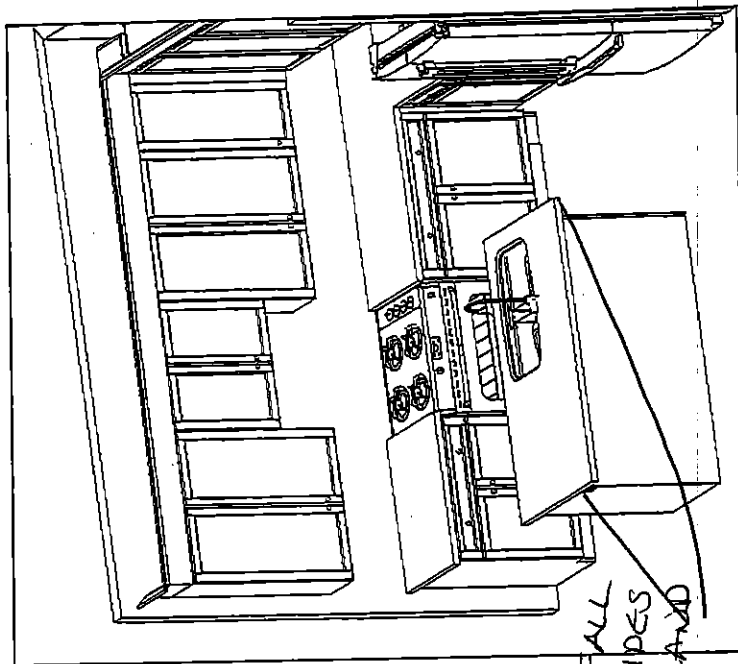

WATERFALL  
BOTH SIDES  
OF ISLAND

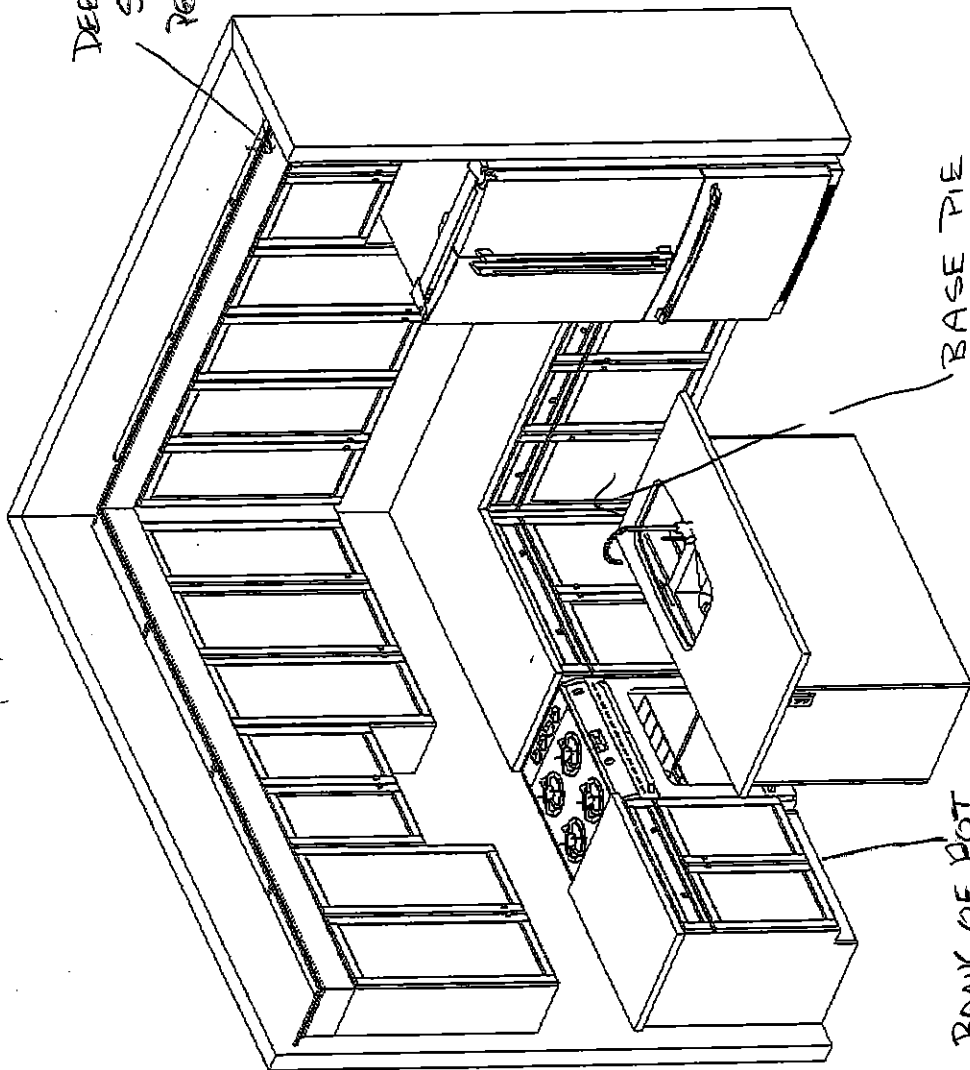

BASE PIE  
WITH LAZY  
SUEAN

BANK OF POT  
DRAWERS

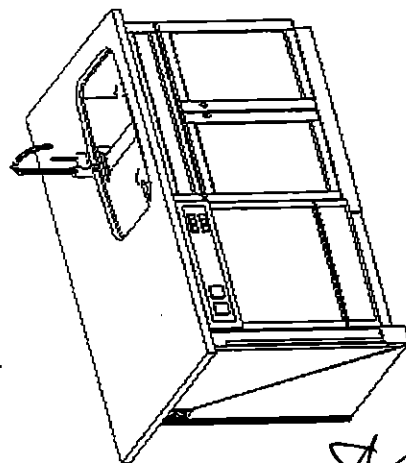

This sketch is for DESIGN PURPOSES ONLY - It is not  
meant to be an exact rendition.

23 OF 49

## 20-1783 ALT ELEV. A.

Sketch # 8



SECOND FLOOR  
ELEV. A

✓

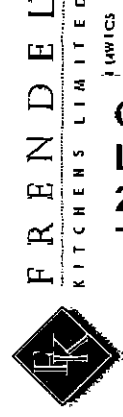

C2-COUNTRY LANE  
LOT 535  
20-1783 AL ELEV A  
THE APPLEDALE

Heath  
Coun  
20-178  
The  
Standard  
• Blum M  
• Blum C  
• Top dic  
Ensuite

24 of 49

Drawn By: Sepideh B  
Date: May 23, 2019  
Revision:  
Scale: Not To Scale

Approved By Builder:

Date:

Sketch #9

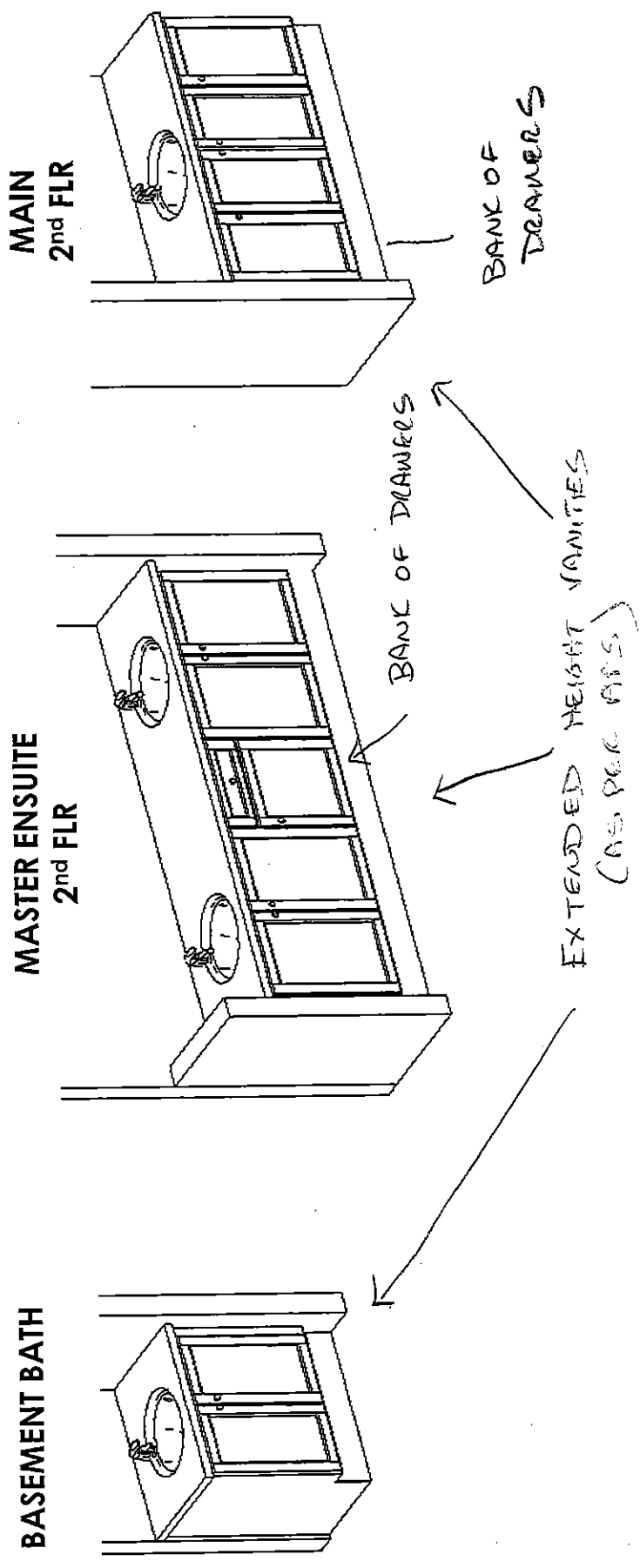

C2-COUNTRY LANE  
LOT 535  
20-1783 AL ELEV A  
THE APPLEDALE

25 of 49

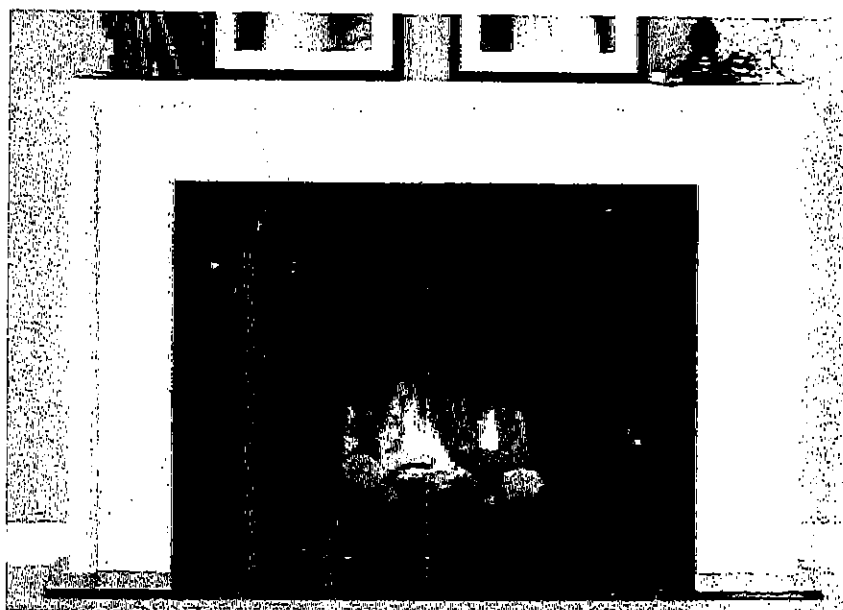

6" DEEP.

NEAS NF17 Mantel

✓



C2-COUNTRY LANE  
LOT 535  
20-17 1/2 AL ELEV A  
THE APPLEDALE

26 of 49

Product Specification Sheet

PRECIS U 1 3/4

SILGRANIT®

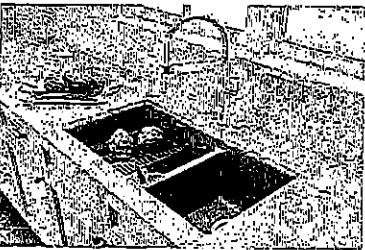

PRODUCT DIMENSIONS

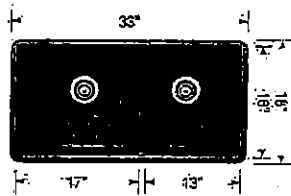

PRECIS U 1 3/4

Colour/Finish

Model No.

FEATURES / SPECIFICATIONS



White

Main bowl left  
401706

- PreciS kitchen sinks are made in Canada and Germany
- Double bowl configuration allows for easy multi-tasking in busy kitchens
- Made of SILGRANIT, a high-quality granite composite
- Heat, scratch and stain resistant
- Non-porous surface is anti-bacterial and easy to clean



Truffle

Main bowl left  
401142

DESIGN AND PLANNING TIPS

Cabinet Size: 36" (915 mm)  
Bowl depth: 9 1/2" (240 mm) / 9 1/2" (240 mm)  
Depending on cabinet construction, a different cabinet size may be required.  
Consult the cabinet manufacturer.



Metallic Gray

Main bowl left  
401682

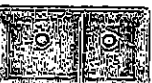

Concrete Gray

Main bowl left  
402263



Cinder

Main bowl left  
401396



Café

Main bowl left  
400585



Biscuit

Main bowl left  
401817



Anthracite

Main bowl left  
400583

WARRANTY

Limited Lifetime warranty

Code/Standards Compliance

BLANCO sinks and faucets are third-party tested and certified to CSA, cUPC, ANSI/ASME and NSF standards and listed by applicable certification bodies. For more information on individual product listings, contact our office or listing organization.

BLANCO CANADA  
100 Corporation Drive  
Brampton, ON L6S 6B5

Tel: 905 494 2400  
Fax: 905 494 2425  
www.blancocanada.com

Toll Free: 1 877 425 2626  
Toll Free: 1 877 825 2626

© 2016 BLANCO CANADA

C2-COUNTRY LANE  
LOT 535  
20-1783 AL ELEV A  
THE APPLEDALE

27 of 49

STANDARD KITCHEN FAUCET

Align

Modern

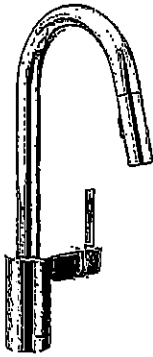

Single Handle Pull-Down Kitchen  
Faucet\*

Model 7565†

✓

C2-COUNTRY LANE  
LOT 535  
20-1783 AL ELEV A  
THE APPLEDALE

28 OF 49

*American  
Standard*

**BOULEVARD®  
PEDESTAL SINK**  
VITREOUS CHINA

**BOULEVARD® PEDESTAL SINK**

- ☒ 0641.800 Faucet holes on 8" (203mm) centers (Illustrated).
- ☐ 0641.400 Faucet holes on 4" (102mm) centers
- ☒ 0641.100 Center hole only
  - Classic styled rectangular pedestal lavatory
  - Vitreous china
  - Rear overflow
  - Supplied with mounting kit
  - Right Height® for greater comfort during use
  - Faucet ledge with large deck area (faucet not included)
  - Design coordinates with Boulevard® Toilet
  - Basin has flat bottom to also allow use as an above counter sink or a drop-in sink (with u-shaped cut out)

**Nominal Dimensions:**

24" x 19" x 35-1/2"  
(610 x 483 x 902mm)

- ☐ 0641.008 Pedestal top-8" (203mm) centers
- ☐ 0641.004 Pedestal top-4" (102mm) centers
- ☐ 0641.001 Pedestal top-center hole only
- ☐ 0010.000 Pedestal only

**Bowl sizes:**

17" (432mm) wide,  
12-1/2" (318mm) front to back,  
5" (127mm) deep

**Compliance Certifications -**

**Meets or Exceeds the Following Specifications:**

- ASME A112.19.2 - 2008/CSA B45.1-08

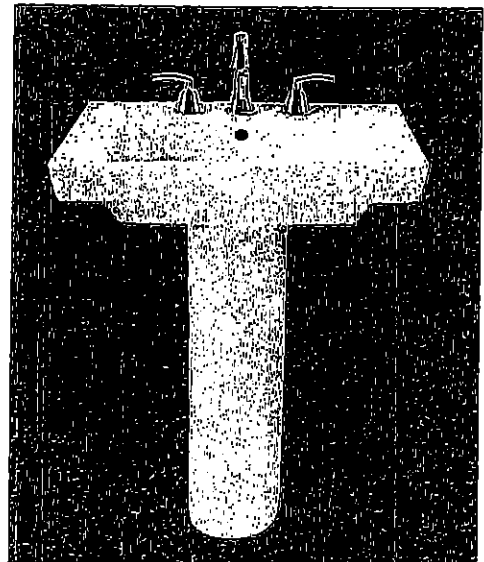

SEE REVERSE FOR ROUGHING-IN DIMENSIONS

**To Be Specified:**

- ☐ Color: ☐ White ☐ Linen
- ☐ Faucet Finish:
- ☐ Supplies:
- ☐ 1-1/4" Trap:
- ☐ Nipple:

\* See faucet section for additional models available

*[Handwritten signature]*

C2-COUNTRY LANE  
LOT 535  
20-1783 AL ELEV A  
THE APPLEDALE

29 of 49



Buy it for looks. Buy it for life.®

#### DESCRIPTION

- Quick connect system
- Metal construction with various finishes identified by suffix
- 1/2" IPS shanks
- Designed to be installed on 8" to 16" centers
- Includes metal pop-up type waste assembly

#### OPERATION

- Lever style handles with hot and cold color indicators
- Hot side counterclockwise to open (clockwise to close)
- Cold side clockwise to open (counterclockwise to close)

#### FLOW

- Flow is limited to 1.5 gpm max (5.7L/min) at 60 psi, for products made before October 2008 flow is limited to 2.2 gpm max (8.3 L/min)

#### CARTRIDGE

- 1224 cartridge design
- Nonmetallic and stainless steel material

#### STANDARDS

- Third party certified to WaterSense®, ASME A112.18.1/CSA B125.1 and all applicable requirements referenced therein
- Certified to NSF 61/9 & 372
- Complies with California Proposition 65 and with the Federal Safe Drinking Water Act

- ADA  for lever handles

#### WARRANTY

- Lifetime limited warranty against leaks, drips and finish defects to the original consumer purchaser
- 5 year warranty if used in commercial installations

## Specifications

*Powder Room*

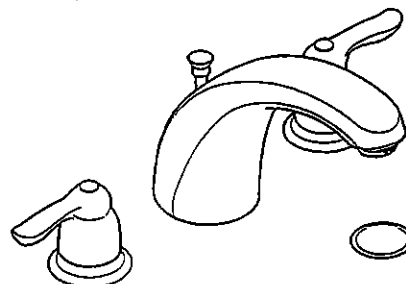

### CHATEAU® Two-Handle Widespread Lavatory Faucet

Models: 4945 series

- NOTE:** SPOUT DESIGNED TO BE INSTALLED THROUGH 1" MIN. DIA. HOLE. VALVES INSTALL THROUGH 1-1/8" MIN. DIA. HOLE.
- NOTE:** FOR DECK THICKNESS 1-1/2" to 3", USE SERVICE KIT #115001. VALVES INSTALL THROUGH 1-1/4" DIA. HOLE.

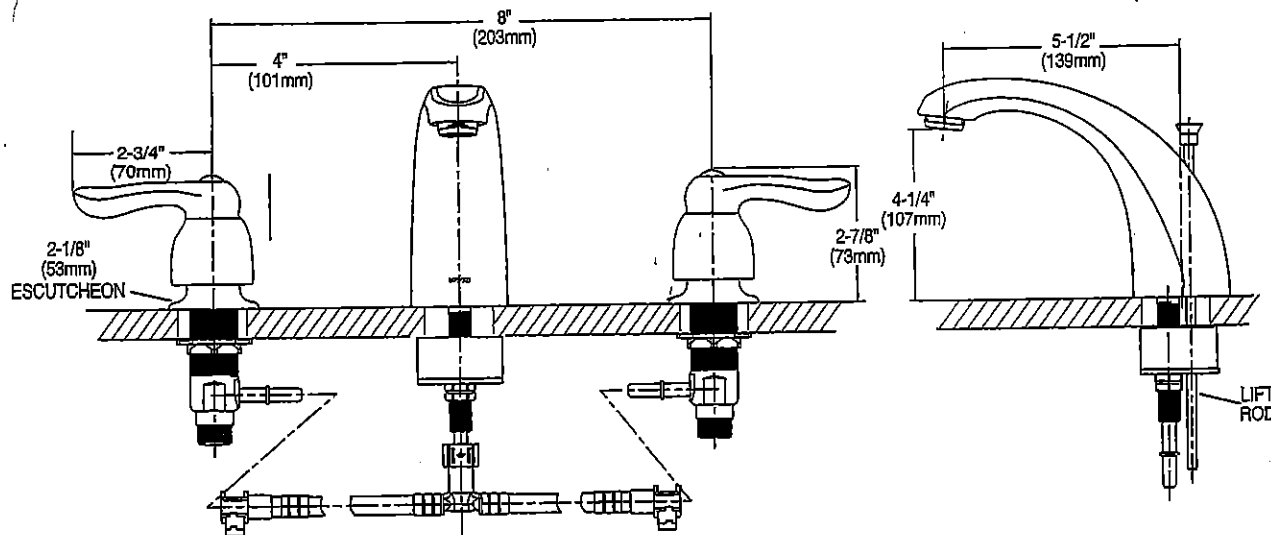

### CRITICAL DIMENSIONS

(DO NOT SCALE)

FOR MORE INFORMATION CALL: 1-800-BUY-MOEN  
[www.moen.com](http://www.moen.com)

Rev. 8/15

7 C2-COUNTRY LANE  
 LOT 535  
 20-1783 AL ELEV A  
 THE APPLEDALE

COLONY COUNTERTOP SINK

- Vitreous china
- Self-rimming
- Front overflow
- Supplied with template
- Faucet deck
- (Faucet shown not included)

- ☒ 0346 803  
 Faucet holes on 203mm (8") centres
- ☐ 0346 403 (Illustrated)  
 Faucet holes on 102mm (4") centres
- ☐ 0346 001  
 Centre hole only

Nominal Dimensions:  
 521 x 448mm (20-1/2" x 17-5/8")

Bowl sizes:  
 422mm (16-5/8") wide, 279mm (11") front to back, 143mm (5-5/8") deep

COMPLIANCE CERTIFICATIONS –  
 Meets or exceeds the following Specifications:  
 • ASME A112.19.2M for Vitreous China Fixtures.  
 • CAN/CSA B45 Series.

To Be Specified

- ☐ Colour: ☒ White ☐ Bone ☐ Silver Gray  
☐ Linen
- ☐ Faucet\*:
- ☐ Faucet Finish:
- ☐ Supplies & Stops:
- ☐ Trap 1-1/4" (32 mm):

\* See faucet section for additional models available

BAS-198

30.4 409 COLONY™  
 COUNTERTOP SINK  
 VITREOUS CHINA

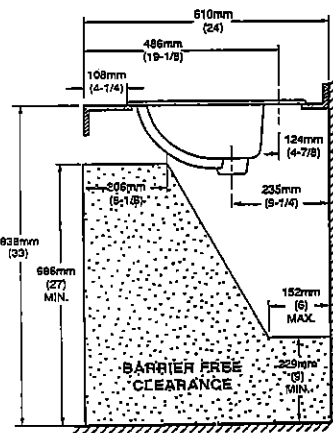
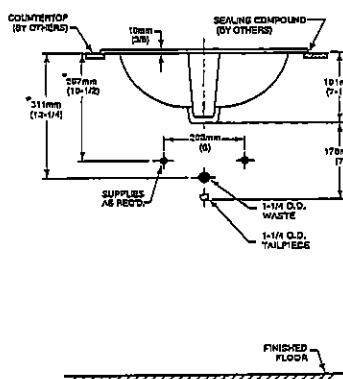
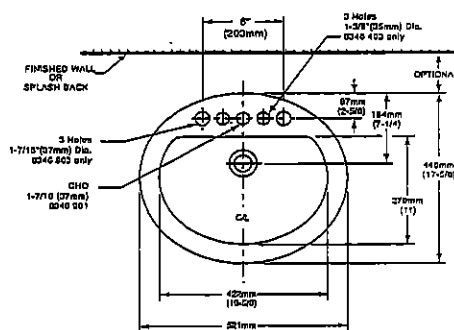
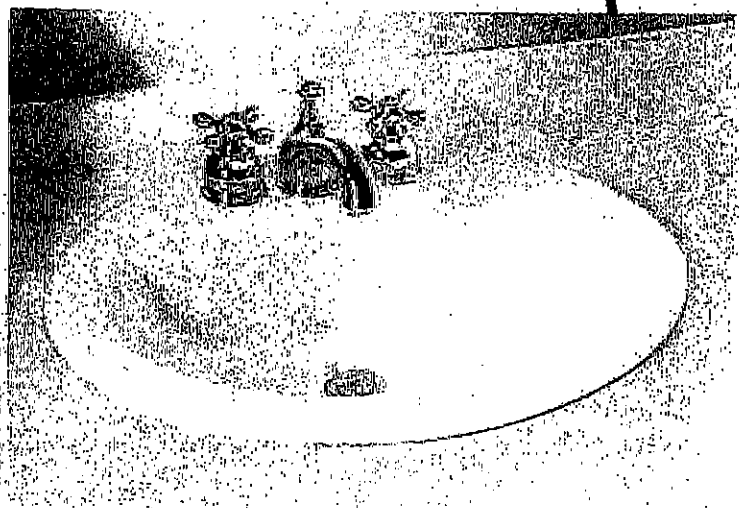

NOTES:  
 \* DIMENSIONS SHOWN FOR LOCATION OF SUPPLIES AND "P" TRAP ARE SUGGESTED. FOR COUNTERTOP CUTOUT AND INSTALLATION INSTRUCTIONS USE TEMPLATE SUPPLIED WITH SINK.  
 FAUCETS NOT INCLUDED AND MUST BE ORDERED SEPARATELY.  
 IMPORTANT: Dimensions of fixtures are nominal and may vary within the range of tolerances established by ANSI Standard A112.19.2.  
 These measurements are subject to change or cancellation. No responsibility is assumed for use of superseded or voided pages.

Handwritten signature or mark.

C2-COUNTRY LANE  
LOT 535  
20-1783 AL ELEV A  
THE APPLEDALE

31 OF 49



Demi CF2007

✓

C2-COUNTRY LANE  
LOT 535  
20-1783 AL ELEV A  
THE APPLEDALE

32 OF 49

## Chateau

Transitional

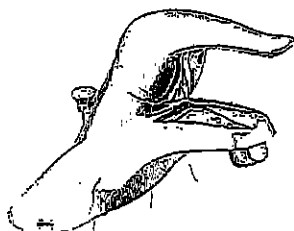

Lavatory Faucet with Pop-Up Drain  
Model L4621+

VANITY SINKS AND PEDESTAL

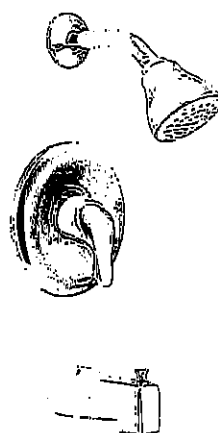

Posi-Temp® Pressure Balancing Tub/Shower  
Model 62320 / TL183+

OR

Posi-Temp Valve and Tub/Shower Trim  
with Eco-Performance Easy Clean® XL

Model 62320 / TL183EP+

(TL183EP not available in BC)

SHOWER AND 5" TUB FAUCETS



2 Handle Roman Tub with 9" Spout  
Model 4796 / T990+

FREESTANDING TUB FAUCETS

A handwritten signature or mark, possibly a stylized 'A' or a similar symbol, located in the bottom right corner of the page.

33 of 49

Cyclone®

## SCB51430 Canopy Hood

### Alito Collection

Makes a statement of strength and power as the stainless steel frame gleams under your kitchen lights. It features baffle filters, tow bright LED lights in each corner, a three speed control panel, and a quiet, powerful motor. The bold design and strong stainless steel frame encasing the fan will make this machine the focus of your kitchen. Fitted with time-delay "OFF" options up to nine minutes.

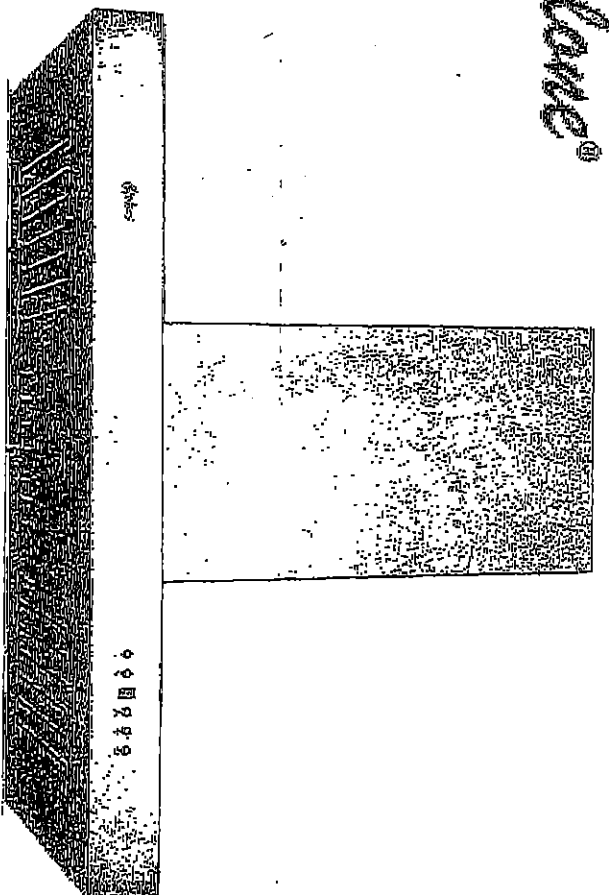

#### Specifications

Air Flow Volume: 550 CFM  
Colours: Stainless Steel  
Dimensions: W:30" H:44.5" D:19.5"  
Electrical Connection: 120V/60Hz  
Electrical Consumption: 200 watts  
Fan Speed: 1254 RPM  
Sones: Min. at 2 and Max at 6  
Venting: 6" Round (Top Only)

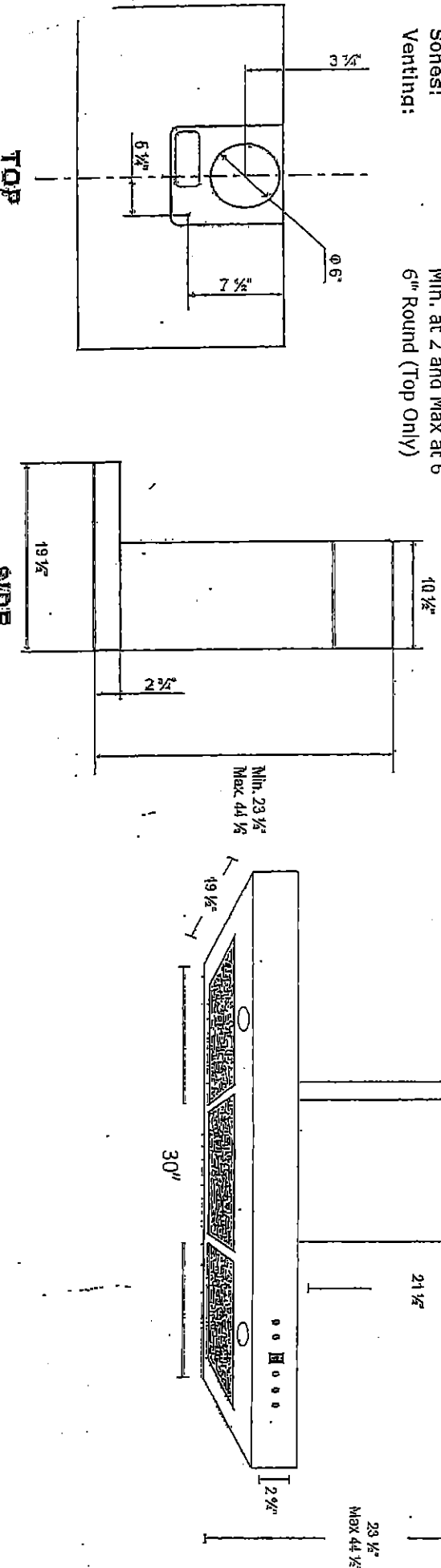

C2-COUNTRY LANE  
LOT 535  
20-1783 AL ELEV A  
THE APPLEDALE



C2-COUNTRY LANE  
LOT 535  
20-1783 AL ELEV A  
THE APPLEDALE

34 of 49

**Whirlpool®** Bottom Mount Refrigerator

**PRODUCT MODEL NUMBERS**

WRF532SMB      WRF535SWB  
WRF535SMB      WRF540CWB

**Electrical:** A 115-volt, 60-Hz, AC-only, 15- or 20-amp fused, grounded electrical supply is required. It is recommended that a separate circuit serving only your refrigerator be provided. Use an outlet that cannot be turned off by a switch. Do not use an extension cord.

**NOTE:** Before performing any type of installation, cleaning, or removing a light bulb, turn the control (Thermostat, Refrigerator or Freezer Control depending on the model) to OFF and then disconnect the refrigerator from the electrical source. When you are finished, reconnect the refrigerator to the electrical source and reset the control (Thermostat, Refrigerator or Freezer Control depending on the model) to the desired setting. See "Using the Controls."

**Water:** A cold water supply with water pressure between 30 and 120 psi (207 and 827 kPa) is required to operate the ice maker and water dispenser. If you have questions about your water pressure, call a licensed, qualified plumber.

**IMPORTANT:** The pressure of the water coming out of a reverse osmosis system going to the water inlet valve of the refrigerator needs to be between 35 and 120 psi (241 and 827 kPa).

**Reverse Osmosis Water Supply:** If a reverse osmosis water filtration system is connected to your cold water supply, the water pressure to the reverse osmosis system needs to be a minimum of 40 to 60 psi (276 to 414 kPa).

**PRODUCT DIMENSIONS**

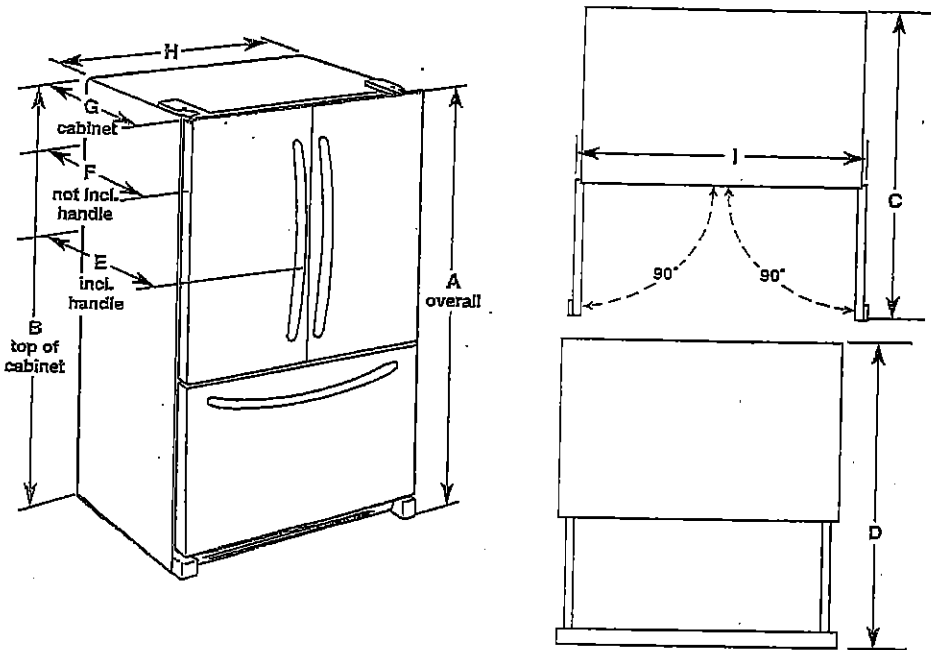

Model Number/Size	Height - Overall "A"	Height - Top of Cabinet "B"	Depth - Doors Open 90° "C"	Depth - Drawer Open "D"	Depth - With Handles "E"	Depth - Without Handles "F"	Depth - Cabinet Only "G"	Width - Cabinet "H"	Width - Door Open 90° "I"
WRF535SWB 25.2 cu. ft.	70 1/4" (178.1 cm)	68 3/4" (174.8 cm)	48 1/2" (122.1 cm)	53 1/2" (135 cm)	35 3/4" (90 cm)	32 1/4" (83.7 cm)	29 1/2" (74 cm)	35 3/4" (90.5 cm)	43 3/4" (110.2 cm)
WRF535SMB 25.2 cu. ft.	70 1/4" (178.1 cm)	68 3/4" (174.8 cm)	48 1/2" (122.1 cm)	53 1/2" (135 cm)	35 3/4" (90 cm)	32 1/4" (83.7 cm)	29 1/2" (74 cm)	35 3/4" (90.5 cm)	43 3/4" (110.2 cm)
WRF532SMB 22.1 cu. ft.	70 1/4" (178.1 cm)	68 3/4" (174.8 cm)	47 1/2" (119.5 cm)	52 1/2" (132.4 cm)	34 3/4" (87.5 cm)	31 1/4" (81.1 cm)	28 1/2" (71.4 cm)	32 3/4" (82.9 cm)	42 3/4" (107.6 cm)
WRF540CWB 20 cu. ft.	70 1/4" (178.1 cm)	68 3/4" (174.8 cm)	48" (121.9 cm)	44 1/2" (113.0 cm)	29 3/4" (74.6 cm)	28" (71.1 cm)	24 1/2" (61.3 cm)	35 3/4" (90.5 cm)	39 3/4" (100.0 cm)

**LOCATION REQUIREMENTS**

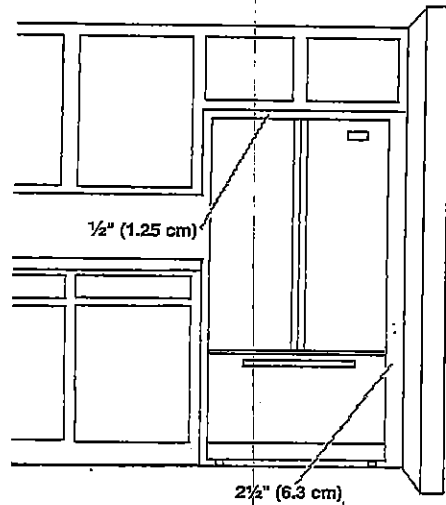

To ensure proper ventilation for your refrigerator, allow for a 1/2" (1.25 cm) space on each side and at the top. Allow for 1" (2.54 cm) of space behind the refrigerator. If your refrigerator has an ice maker, make sure you leave some extra space at the back for the water line connections.

If you are installing your refrigerator next to a fixed wall, leave 2 1/4" (6.3 cm) minimum on the hinge side (some models require more) to allow for the door to swing open.

**NOTE:** This refrigerator is intended for use in a location where the temperature ranges from a minimum of 55°F (13°C) to a maximum of 110°F (43°C). The preferred room temperature range for optimum performance, which reduces electricity usage and provides superior cooling, is between 60°F (15°C) and 90°F (32°C). It is recommended that you do not install the refrigerator near a heat source, such as an oven or radiator.

C2-COUNTRY LANE  
LOT 535  
20-1783 AL ELEV A  
THE APPLEDALE

35 of 49

4.8 cu. ft. guided Electric Front Control Range  
with the easy-wipe ceramic glass cooktop

YWEE510S0FS

Whirlpool

---

[Home](#) > [Kitchen Appliances](#) > [Cooking Appliances](#) > [Ranges](#) > [Slide-In Ranges](#) > YWEE510S0FS

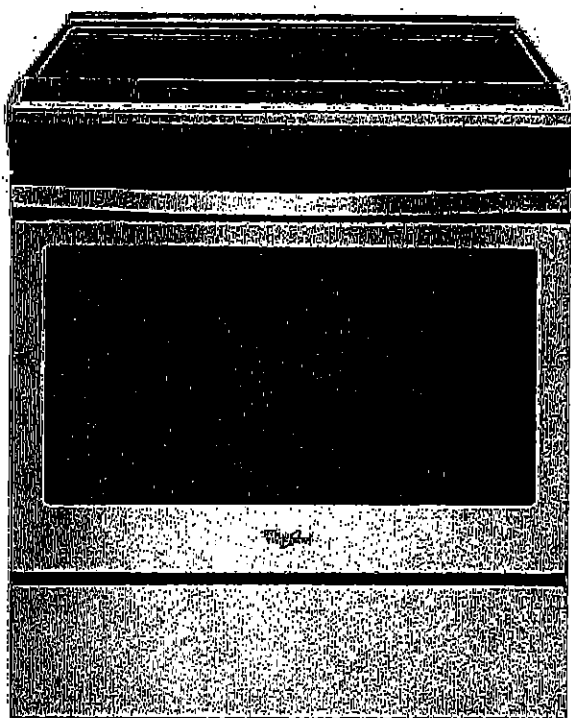

☆

C2-COUNTRY LANE  
 LOT 535  
 20-1783 AL ELEV A  
 THE APPLEDALE

36 of 49

# Cabinet Dimensions

Cabinet opening dimensions shown are for 25" (64.0 cm) countertop depth, 24" (61.0 cm) base cabinet depth and 36" (91.4 cm) countertop height.

**IMPORTANT:** If installing a range hood or microwave hood combination above the range, follow the range hood or microwave hood combination installation instructions for dimensional clearances above the cooktop surface.

Range may be installed next to combustible walls with zero clearance.

**NOTE:** When installed in a slide-in cutout, the front of oven door may protrude beyond the base cabinet.

Slide-In Cutout

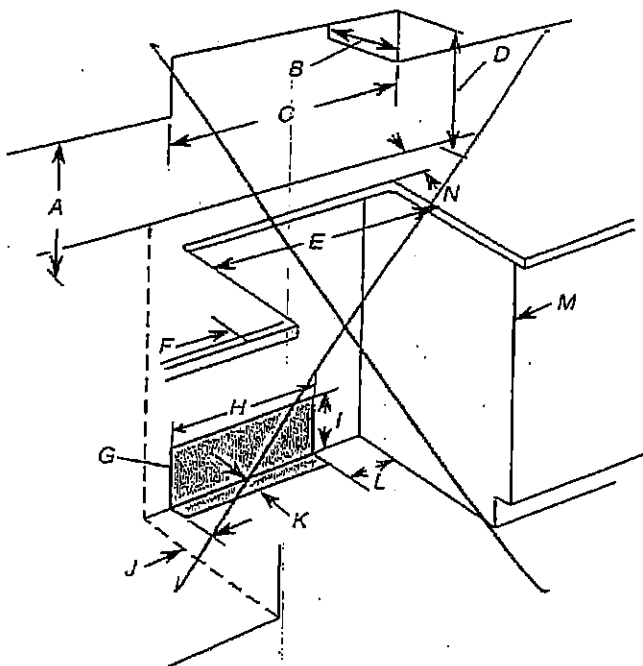

Freestanding Cutout

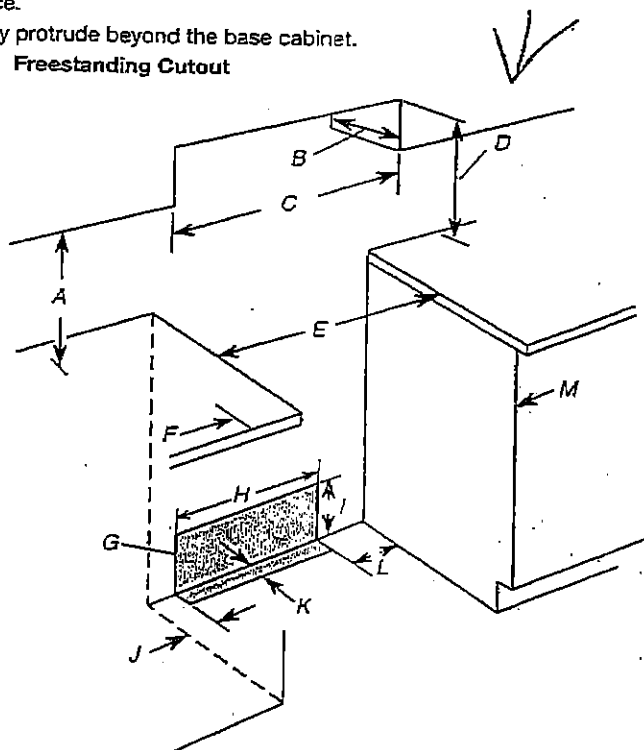

- A. 18" (45.7 cm) upper side cabinet to countertop
- B. 13" (33 cm) max. upper cabinet depth
- C. 30" (76.2 cm) min. opening width
- D. For minimum clearance to top of cooktop, see NOTE.
- E. 30" (76.2 cm) min. opening width
- F. 3" (7.6 cm) min. clearance from both sides of range to side wall or other combustible material
- G. The shaded area is recommended for installation of rigid gas pipe and grounded outlet.
- H. 13 1/8" (33.3 cm)
- I. 7 1/8" (19.5 cm)
- J. 4 7/8" (12.2 cm)
- K. 3 1/8" (9.4 cm) plus measurement of N
- L. 12" (30.5 cm)
- M. Cabinet door or hinges should not extend into the cutout.
- N. Remaining counter depth should not exceed 2 1/4" (5.7 cm).

- A. 18" (45.7 cm) upper side cabinet to countertop
- B. 13" (33 cm) max. upper cabinet depth
- C. 30" (76.2 cm) min. opening width
- D. For minimum clearance to top of cooktop, see NOTE.
- E. 30" (76.2 cm) min. opening width
- F. 3" (7.6 cm) min. clearance from both sides of range to side wall or other combustible material
- G. The shaded area is recommended for installation of rigid gas pipe and grounded outlet.
- H. 13 1/8" (33.3 cm)
- I. 7 1/8" (19.5 cm)
- J. 4 7/8" (12.2 cm)
- K. 3 1/8" (9.4 cm)
- L. 12" (30.5 cm)
- M. Cabinet door or hinges should not extend into the cutout.

**\*NOTE:** 24" (61.0 cm) minimum when bottom of wood or metal cabinet is shielded by not less than 1/4" (0.64 cm) flame retardant millboard covered with not less than No. 28 MSG sheet steel, 0.015" (0.4 mm) stainless steel, 0.024" (0.6 mm) aluminum or 0.020" (0.5 mm) copper.

30" (76.2 cm) minimum clearance between the top of the cooking platform and the bottom of an uncovered wood or metal cabinet.

✓

C2-COUNTRY LANE  
LOT 535  
20-1783 AL ELEV A  
THE APPLEDALE

37 of 49

WHIRLPOOL YWEE510S0FS

4.8 cu. ft. guided Electric Front Control Range with the easy-wipe ceramic glass cooktop

## INSTALLATION REQUIREMENTS

### Tools and Parts

Gather the required tools and parts before starting installation. Read and follow the instructions provided with any tools listed here.

#### Tools Needed

- Tape measure
- Phillips screwdriver
- Level
- Hand or electric drill
- Wrench or pliers
- Marker or pencil
- 1/8" (3.2 mm) drill bit (for wood floors)
- Flashlight

#### Parts Supplied

Check that all parts are included.

- #10 x 1 1/2" (4.1 cm) screws (for mounting anti-tip bracket) (2)
- Anti-tip bracket (inside oven cavity)

Anti-tip bracket must be securely mounted to the back wall or floor. Thickness of flooring may require longer screws to anchor bracket to subfloor. Longer screws are available from your local hardware store.

### Location Requirements

**IMPORTANT:** Observe all governing codes and ordinances.

- It is the installer's responsibility to comply with installation clearances specified on the model/serial/rating plate. The model/serial/rating plate is located behind the oven door on the top right-hand side of the oven frame.
- The range should be located for convenient use in the kitchen.
- Recessed installations must provide complete enclosure of the sides and rear of the range.
- To eliminate the risk of burns or fire by reaching over the heated surface units, cabinet storage space located above the surface units should be avoided. If cabinet storage is to be provided, the risk can be reduced by installing a range hood or microwave hood combination that projects horizontally a minimum of 5" (12.7 cm) beyond the bottom of the cabinets.
- All openings in the wall or floor where range is to be installed must be sealed.
- Cabinet opening dimensions that are shown must be used. Given dimensions are minimum clearances.
- The anti-tip bracket must be installed. To install the anti-tip bracket shipped with the range, see "Install Anti-Tip Bracket" section.
- Grounded electrical supply is required. See the appropriate "Electrical Requirements" section.
- Contact a qualified floor covering installer to check that the floor covering can withstand at least 200°F (93°C).
- Use an insulated pad or 1/4" (0.64 cm) plywood under range if installing range over carpeting.

**IMPORTANT:** To avoid damage to your cabinets, check with your builder or cabinet supplier to make sure that the materials used will not discolor, delaminate, or sustain other damage. This oven has been designed in accordance with the requirements of UL and CSA International and complies with the maximum allowable wood cabinet temperatures of 194°F (90°C).

38 of 49

**WHIRLPOOL YWEE510S0FS**

4.8 cu. ft. guided Electric Front Control Range with the easy-wipe ceramic glass cooktop

**Mobile Home - Additional Installation Requirements**

The installation of this range must conform to the Manufactured Home Construction and Safety Standard, Title 24 CFR, Part 3280 (formerly the Federal Standard for Mobile Home Construction and Safety, Title 24, HUD Part 280). When such standard is not applicable, use the Standard for Manufactured Home Installations, ANSI A225.1/NFPA 501A or with local codes. In Canada, the installation of this range must conform with the current standards CAN/CSA-A240-latest edition, or with local codes.

**Mobile Home Installations Require:**

- When this range is installed in a mobile home, it must be secured to the floor during transit. Any method of securing the range is adequate as long as it conforms to the standards listed above.

**Product Dimensions**

This manual covers several models. Your model may appear different from the models depicted. Dimensions given are maximum dimensions across all models.

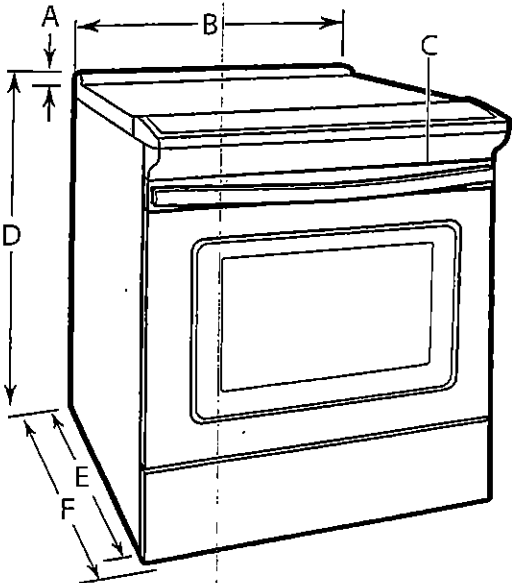

- A. 1<sup>1</sup>/<sub>16</sub>" (3.0 cm) height from cooktop to top of vent
- B. 29<sup>7</sup>/<sub>16</sub>" (75.9 cm)
- C. Model/serial/rating plate (located behind the oven door on the top right-hand side of the oven frame)
- D. 36" (91.4 cm) height to top of cooktop edge with leveling legs screwed all the way in\*
- E. 28<sup>25</sup>/<sub>16</sub>" (72.1 cm) max. depth from front of console to back of range
- F. 29<sup>7</sup>/<sub>16</sub>" (73.7 cm) max. depth from handle to back of range

**IMPORTANT:** Range must be level after installation. Follow the instructions in the "Level Range" section. Using the cooktop as a reference for leveling the range is not recommended.

\*Range can be raised approximately 1" (2.5 cm) by adjusting the leveling legs.

**Cabinet Dimensions**

Cabinet opening dimensions shown are for 25" (64.0 cm) countertop depth, 24" (61.0 cm) base cabinet depth, and 36" (91.4 cm) countertop height.

**IMPORTANT:** If installing a range hood or microwave hood combination above the range, follow the range hood or microwave hood combination installation instructions for dimensional clearances above the cooktop surface.

Range may be installed next to combustible walls with zero clearance.

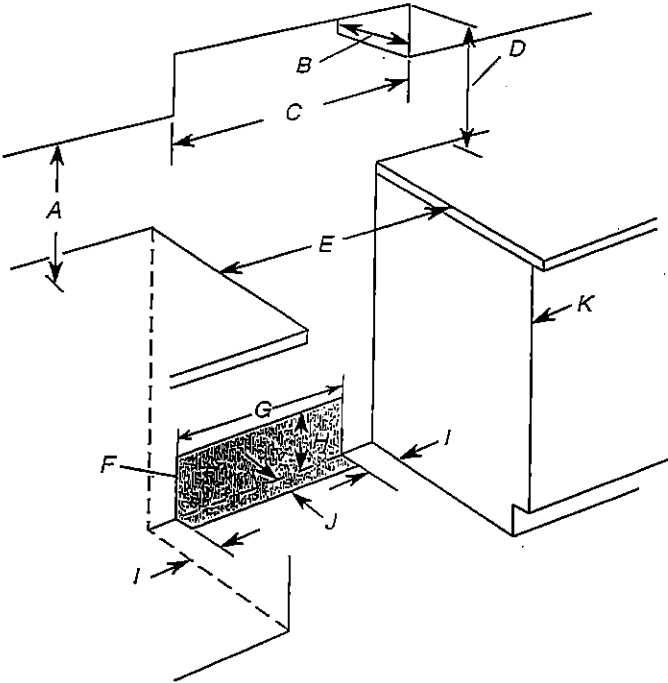

- A. 18" (45.7 cm) upper side cabinet to countertop
- B. 13" (33 cm) max. upper cabinet depth
- C. 30" (76.2 cm) min. opening width
- D. For minimum clearance to top of cooktop, see NOTE\*
- E. 30" (76.2 cm) min. opening width
- F. The shaded area is recommended for installation of grounded outlet.
- G. 13<sup>1</sup>/<sub>16</sub>" (33.3 cm)
- H. 7<sup>1</sup>/<sub>16</sub>" (19.5 cm)
- I. 4<sup>3</sup>/<sub>16</sub>" (12.2 cm)
- J. 3<sup>1</sup>/<sub>16</sub>" (9.4 cm)
- K. Cabinet door or hinges should not extend into the cutout.

\*NOTE: 24" (61.0 cm) minimum when bottom of wood or metal cabinet is shielded by not less than 1/4" (0.64 cm) flame retardant millboard covered with not less than No. 28 MSG sheet steel, 0.015" (0.4 mm) stainless steel, 0.024" (0.6 mm) aluminum or 0.020" (0.5 mm) copper.

30" (76.2 cm) minimum clearance between the top of the cooking platform and the bottom of an uncovered wood or metal cabinet.

Handwritten signature or mark.

C2-COUNTRY LANE  
LOT 535  
20-1783 AL ELEV A  
THE APPLEDALE

39.49

WHIRLPOOL YWEE510S0FS

4.8 cu. ft. guided Electric Front Control Range with the easy-wipe ceramic glass cooktop

Electrical Requirements - Canada Only



**Electrical Shock Hazard**

Electrically ground range.

Failure to do so can result in death, fire, or electrical shock.

If codes permit and a separate ground wire is used, it is recommended that a qualified electrical installer determine that the ground path is adequate and wire gauge are in accordance with local codes.

Be sure that the electrical connection and wire size are adequate and in conformance with CSA Standard C22.1, Canadian Electrical Code, Part 1 - latest edition, and all local codes and ordinances.

A copy of the above code standards can be obtained from:  
Canadian Standards Association  
178 Rexdale Blvd.  
Toronto, ON M9W 1R3 CANADA

- Check with a qualified electrical installer if you are not sure the range is properly grounded.

Range Rating*		Specified Rating of Power Supply Cord Kit and Circuit Protection
120/240 Volts	120/208 Volts	Amps
8.8 - 16.5 KW	7.8 - 12.5 KW	40 or 50**
16.6 - 22.5 KW	12.6 - 18.5 KW	50

\*The NEC calculated load is less than the total connected load listed on the model/serial/rating plate.

\*\*If connecting to a 50-amp circuit, use a 50-amp rated cord with kit. For 50-amp rated cord kits, use kits that specify use with a nominal 1 3/8" (3.5 cm) diameter connection opening.

- A circuit breaker is recommended.
- This range is equipped with a CSA International Certified Power Cord intended to be plugged into a standard 14-50R wall receptacle. Be sure the wall receptacle is within reach of range's final location.

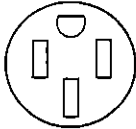

- Do not use an extension cord.
- The tech sheet and wiring diagram are located on the back of the range in a plastic bag.



C2-COUNTRY LANE  
LOT 535  
20-1783 AL ELEV A  
THE APPLEDALE

40 of 49

WHIRLPOOL YWEE510S0FS

4.8 cu. ft. guided Electric Front Control Range with the easy-wipe ceramic glass cooktop

## INSTALLATION INSTRUCTIONS

### Unpack Range

#### ⚠ WARNING

##### Excessive Weight Hazard

Use two or more people to move and install range.  
Failure to do so can result in back or other injury.

1. Remove shipping materials, tape, and film from the range. Keep cardboard bottom under range. Do not dispose of anything until the installation is complete.
2. Remove oven racks and parts package from oven and shipping materials.
3. To remove cardboard bottom, first take 4 cardboard corners from the carton. Stack 1 cardboard corner on top of another. Repeat with the other 2 corners. Place them lengthwise on the floor behind the range to support the range when it is laid on its back.
4. Using 2 or more people, firmly grasp the range and gently lay it on its back on the cardboard corners.
5. Remove cardboard bottom.

The leveling legs can be adjusted while the range is on its back. See the "Adjust Leveling Legs" section.

**NOTE:** To place range back up into a standing position, put a sheet of cardboard or hardboard on the floor in front of range to protect the flooring. Using 2 or more people, stand range back up onto the cardboard or hardboard.

### Install Anti-Tip Bracket

#### ⚠ WARNING



##### Tip Over Hazard

A child or adult can tip the range and be killed.

Install anti-tip bracket to floor or wall per installation instructions.

Slide range back so rear range foot is engaged in the slot of the anti-tip bracket.

Re-engage anti-tip bracket if range is moved.

Do not operate range without anti-tip bracket installed and engaged.

Failure to follow these instructions can result in death or serious burns to children and adults.

1. Remove the anti-tip bracket from the inside of the oven.
2. Determine which mounting method to use: floor or wall.  
If you have a stone or masonry floor, you can use the wall mounting method. If you are installing the range in a mobile home, you must secure the range to the floor.  
This anti-tip bracket and screws can be used with wood or metal studs.
3. Determine and mark centerline of the cutout space. The mounting bracket can be installed on either the left-hand or right-hand side of the cutout. Position mounting bracket against the wall in the cutout so that the V-notch of the bracket is 12½" (31.8 cm) from centerline as shown.

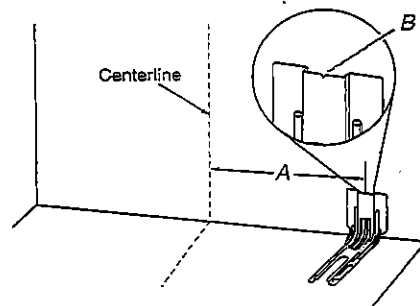

A. 12½" (31.8 cm)  
B. Bracket V-notch

*[Handwritten signature]*

C2-COUNTRY LANE  
LOT 535  
20-1783 AL ELEV A  
THE APPLEDALE

41 of 49

## WHIRLPOOL YWEE510S0FS

4.8 cu. ft. guided Electric Front Control Range with the easy-wipe ceramic glass cooktop

4. Drill two  $\frac{1}{8}$ " (3 mm) holes that correspond to the bracket holes of the determined mounting method. See the following illustrations.

### Floor Mounting

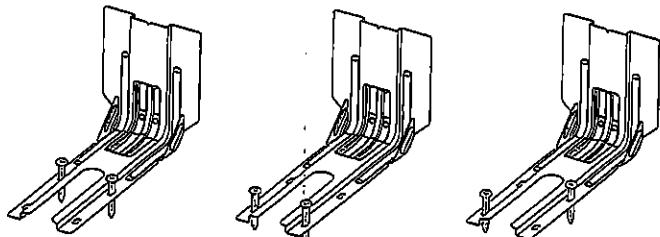

Rear position

Front position

Diagonal (2 options)

### Wall Mounting

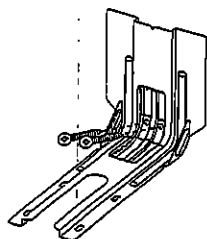

- Using the two #10 x  $1\frac{1}{4}$ " (4.1 cm) Phillips-head screws provided, mount anti-tip bracket to the wall or floor.
- Move range close enough to opening to allow for final electrical connections. Remove shipping base, cardboard, or hardboard from under range.
- Move range into its final location, making sure rear leveling leg slides into anti-tip bracket.

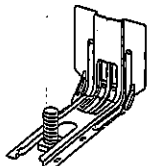

- Move range forward onto shipping base, cardboard, or hardboard to continue installing the range, using the following installation instructions.

### Adjust Leveling Legs

- If range height adjustment is necessary, use a wrench or pliers to loosen the 4 leveling legs. This may be done with the range on its back or with the range supported on 2 legs after the range has been placed back to a standing position.

**NOTE:** To place range back up into a standing position, put a sheet of cardboard or hardboard in front of range. Using 2 or more people, stand range back up onto the cardboard or hardboard.

## WARNING

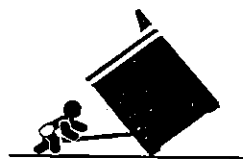

### Tip Over Hazard

A child or adult can tip the range and be killed.

Install anti-tip bracket to floor or wall per installation instructions.

Slide range back so rear range foot is engaged in the slot of the anti-tip bracket.

Re-engage anti-tip bracket if range is moved.

Do not operate range without anti-tip bracket installed and engaged.

Failure to follow these instructions can result in death or serious burns to children and adults.

- Measure the distance from the top of the counter to the floor.
  - Measure the distance from the top of the cooktop to the bottom of the leveling legs. This distance should be the same. If it is not, adjust the leveling legs to the correct height. The leveling legs can be loosened to add up to a maximum of 1" (2.5 cm). A minimum of  $\frac{3}{16}$ " (5 mm) is needed to engage the anti-tip bracket.
- NOTE:** If height adjustment is made when range is standing, tilt the range back to adjust the front legs, and then tilt forward to adjust the rear legs.

- When the range is at the correct height, check that there is adequate clearance under the range for the anti-tip bracket. Before sliding range into its final location, check that the anti-tip bracket will slide under the range and onto the rear leveling leg prior to anti-tip bracket installation.

**NOTE:** If a Trim Kit will be used, the top of the cooktop should be higher than the counter. See the Installation Instructions included with the Trim Kit for the correct height.

### Level Range

- Place level on the oven bottom, as indicated in one of the 2 figures below, depending on the size of the level. Check with the level side to side and front to back.

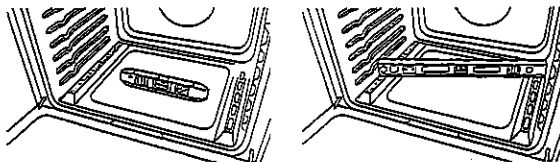

- If range is not level, use a wrench or pliers to adjust leveling legs up or down until the range is level.



C2-COUNTRY LANE  
LOT 535  
20-1783 AL ELEV A  
THE APPLEDALE

42 of 49

# Whirlpool® Undercounter Dishwasher

## PRODUCT MODEL NUMBERS

WDF110PAB  
WDF111PAB  
WDF120PAF  
WDF121PAF  
WDF310PAA  
WDF310PCA

WDF310PLA  
WDF320PAD  
WDF510PAY  
WDF520PAD  
WDF530PAY  
WDF530PLY

WDE530PSY  
WDF540PAD  
WDF730PAY  
WDT710PAY  
WDT720PAD  
WDT770PAY

**Electrical Requirements:** 120-volt, 60-Hz, AC only, 15- or 20-amp. fused electrical supply. Copper wire only. A time delay fuse or circuit breaker and separate circuit is recommended.

**If direct wiring dishwasher:** Use flexible, armored, or nonmetallic, sheathed copper wire with grounding wire that

meets the wiring requirements for your home and local codes and ordinances.

Use a UL listed or CSA approved conduit connector.

**If connecting dishwasher with a power supply cord:**

Use Power Supply Cord Kit (Part No. 4317824) marked for use

with dishwashers. Follow the kit instructions for installing the power supply cord.

Power supply cord must plug into a grounded 3 prong, outlet, located in the cabinet next to the dishwasher opening. Outlet must meet all local codes and ordinances.

**Water Supply Requirements:** A hot water line with 20 to 120 psi (138 to 862 kPa) water pressure. Water temperature must be 120°F (49°C) water at dishwasher. Use 3/8" O.D. copper tubing with compression fitting or flexible braided water supply line (1/2" minimum plastic tubing is not recommended). Use a 90° elbow with 1/4" N.P.T. external pipe threads on one end. Do not solder within 6" (15.2 cm) from water inlet valve.

**Drain Requirements:** A new drain hose is supplied with your dishwasher. If this is not long enough, use a new drain hose with a maximum length of 12' (3.7 m) (Part No. 3395556) that meets all current AHAM/IAPMO test standards, is resistant to heat and detergent, and fits the 1" (2.5 cm) drain connector of the dishwasher.

Make sure to connect the drain hose to waste tee or disposer inlet above drain trap in house plumbing and 20" (50.8 cm) minimum above the floor. It is recommended

that the drain hose either be looped up and securely fastened to the underside of the counter or be connected to an air gap.

Make sure to use an air gap if the drain hose is connected to house plumbing lower than 20" (50.8 cm) above subfloor or floor.

Use 1/2" (1.3 cm) minimum I.D. drain line fittings.

If required, the air gap should be installed in accordance with the air gap installation instructions. When connecting the air gap, a rubber hose (not provided) will be needed to connect to the waste tee or disposer inlet.

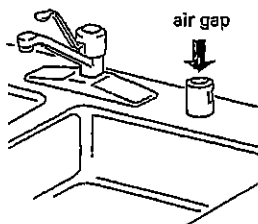

## PRODUCT DIMENSIONS

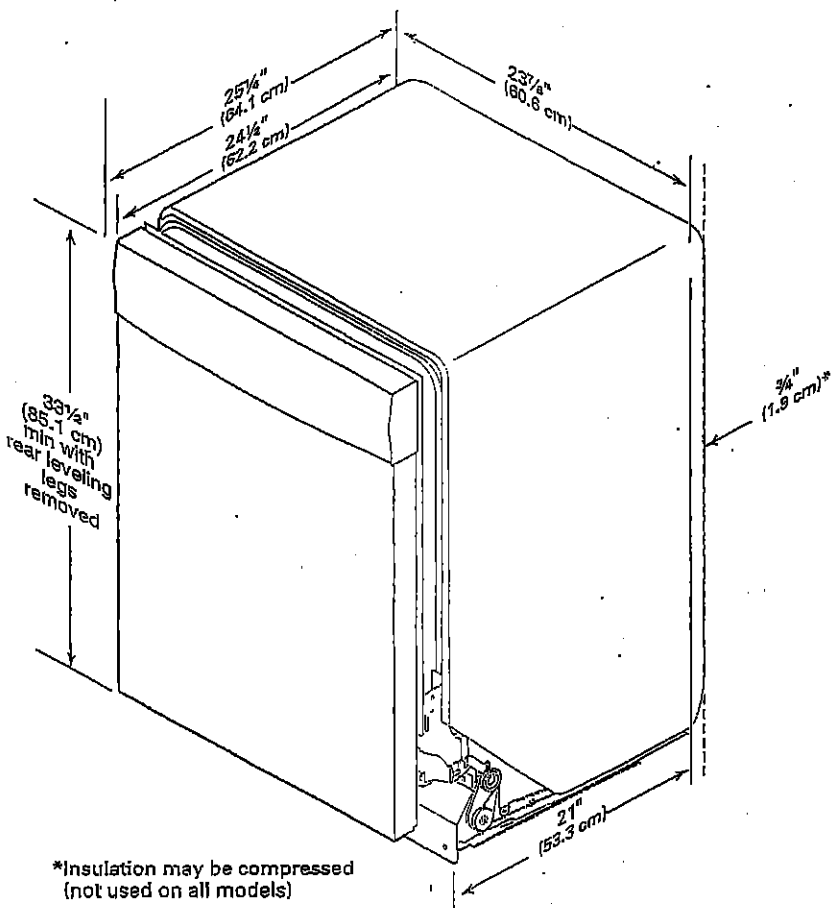

C2-COUNTRY LANE  
LOT 535  
20-1783 AL ELEV A  
THE APPLEDALE

43 OF 49

CABINET CUTOUT DIMENSIONS

NOTE: Shaded areas of cabinet walls show where utility connections may be installed.

\*Measure from the lowest point on the underside of the countertop. May be reduced to 33½" (85.1 cm) by removing the rear leveling legs from dishwasher.

\*\*Minimum, measured from narrowest point of opening.

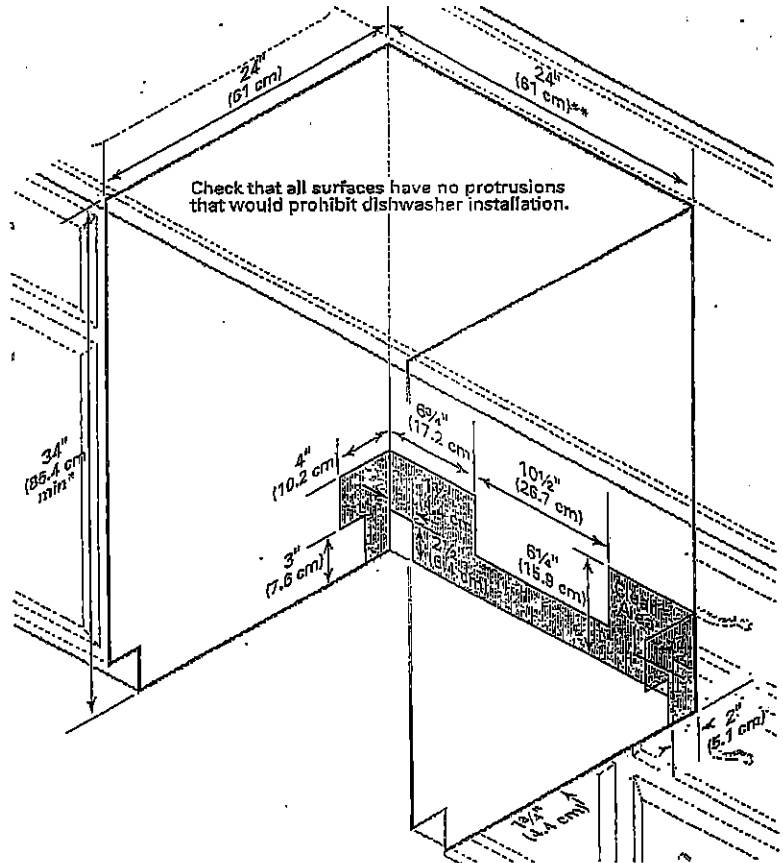

✓

C2-COUNTRY LANE  
LOT 535  
20-1783 AL ELEV A  
THE APPLEDALE

44 of 49

WHIRLPOOL WASHER Model #: WFW5620HW

Whirlpool Brand Canada English | Washer and Dryers | Washers | Front Load Washers | WFW5620HW

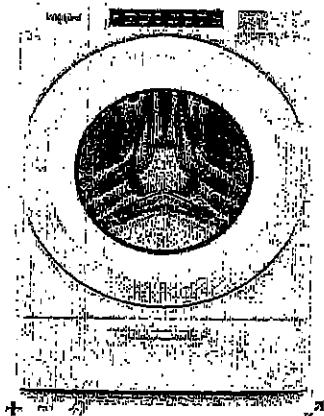

5.2 cu. ft. I.E.C. Closet-Depth  
Front Load Washer with  
Load & Go™ Dispenser



Whirlpool

5.2 cu. ft. I.E.C. Closet-Depth Front Load Washer with Load & Go™  
Dispenser

Model #: WFW5620HW

#### Dimensions

Depth	89.17 cm, 31-9/16 in
Depth With Door Open 90 Degree	143.51 cm, 56-1/2 in
Minimum Height	96.11 cm, 38-5/8 in
Width	68.58 cm, 27.0 in

#### Appearance

LCD Touch Screen	No
Window	Yes

#### Details

Drum Material	Stainless Steel
---------------	-----------------

#### Cycles and Options

Number of Wash Cycles	37
-----------------------	----

#### Electrical

Hz	60
Power Cord Included	Yes

✓

C2-COUNTRY LANE  
LOT 535  
20-1783 AL ELEV A  
THE APPLEDALE

45 of 49

WHIRLPOOL WASHER Model #: WFW5620HW

## LOCATION REQUIREMENTS

Proper installation is your responsibility.

### You will need:

- A water heater set to 120°F (49°C).
- A grounded electrical outlet located within 6 ft (1.8 m) of power cord on back of washer.
- Hot and cold water faucets located within 4 ft (1.2 m) of hot and cold water fill valves on washer, and water pressure of 20–100 psi (137.9–689.6 kPa).
- A level floor with maximum slope of 1" (25 mm) under entire washer. Installing on carpet or surfaces with foam backing is not recommended.
- Floor must support washer's total weight (with water and load) of 315 lbs (143 kgs).

**IMPORTANT:** Do not install, store, or operate washer where it will be exposed to weather or in temperatures below 32°F (0°C). Water remaining in washer after use may cause damage in low temperatures. See "Washer Care" in your Use and Care Guide for winterizing information.

### Whirlpool Models\*

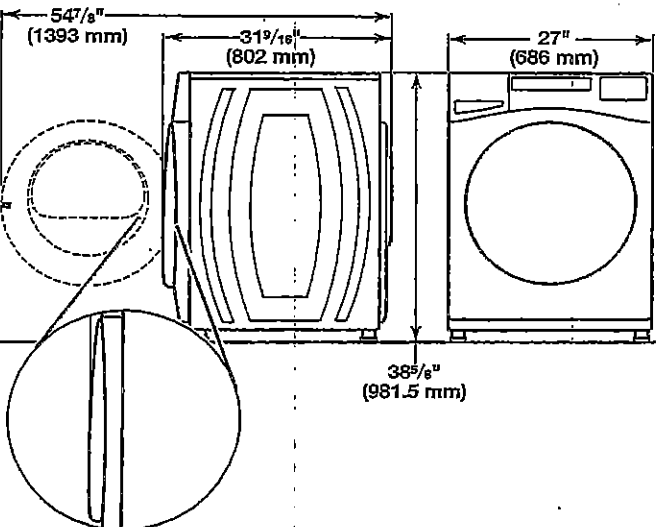
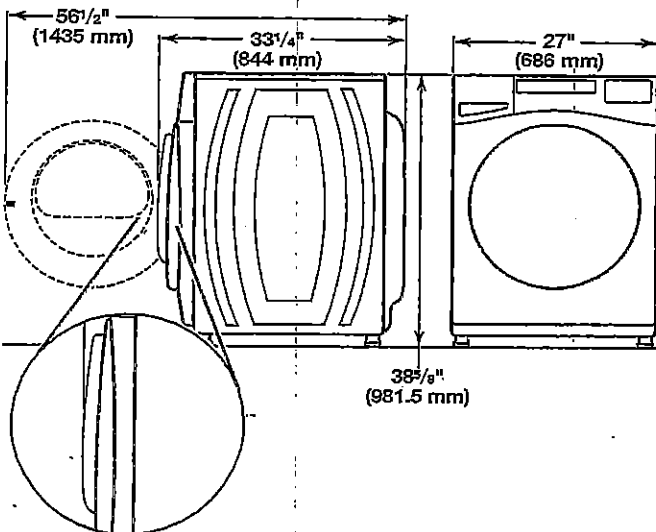

\*For additional details (or information) specific to your model, refer to the 'Dimensions' listed for your model at [www.whirlpool.com](http://www.whirlpool.com).

### Maytag Models

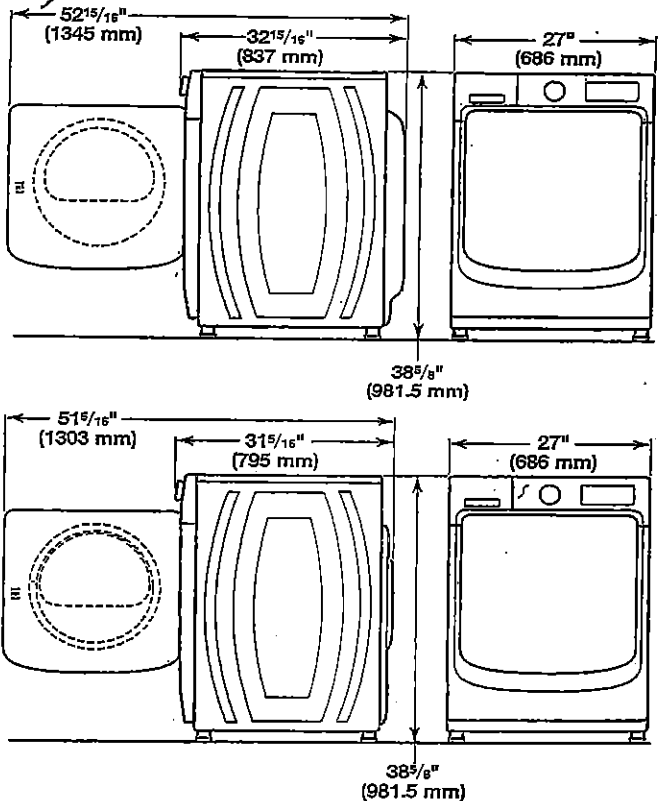

All dimensions show minimum spacing allowed. For each arrangement, consider allowing more space for ease of installation and servicing, and spacing for companion appliances and clearances for walls, doors, and floor moldings. Space must be large enough to allow door to fully open. Add spacing of 1" (25 mm) on all sides of washer to reduce noise transfer. If a closet door or louvered door is installed, top and bottom air openings in door are required.

### Recessed area or closet installation (stacked washer and dryer):

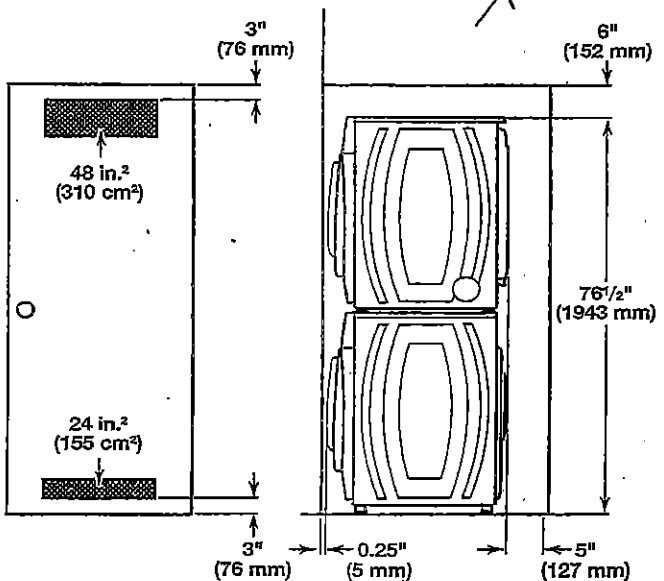

C2-COUNTRY LANE  
 LOT 535  
 20-1783 AL ELEV A  
 THE APPLEDALE

46 of 49

WHIRLPOOL WASHER Model #: WFW5620HW

### Custom under-counter installation:

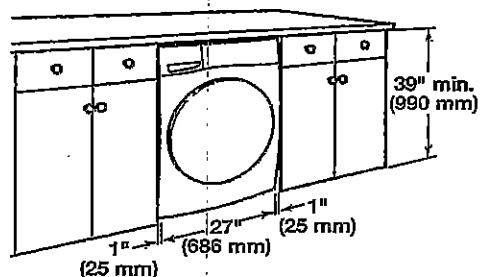

### Recessed area or closet installation:

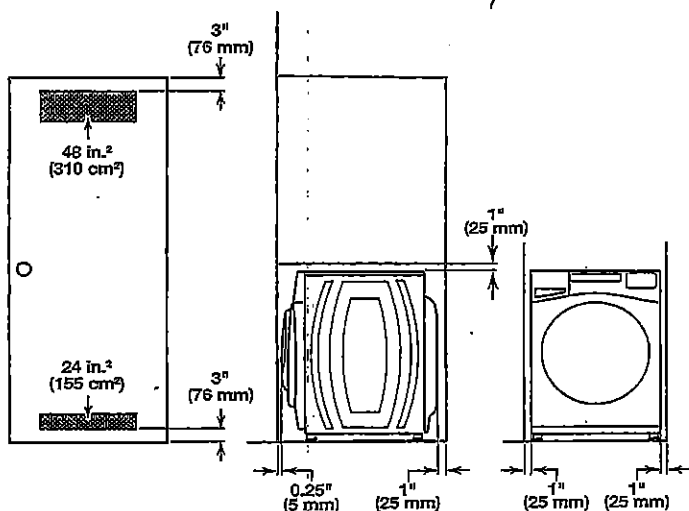

### Custom cabinet installation:

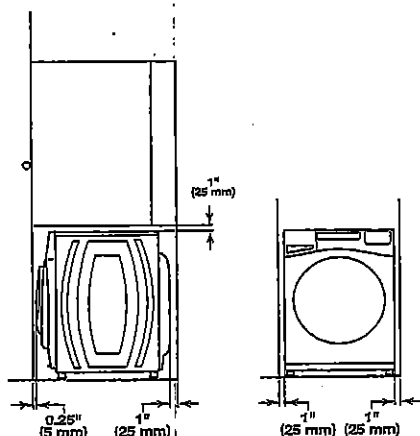

## DRAIN SYSTEM

The drain system can be installed using a floor drain, wall standpipe, or laundry tub. Select the method you need.

**IMPORTANT:** To avoid siphoning, only 4.5" (114 mm) of drain hose should be inside standpipe. Always secure drain hose with cable tie.

### Floor standpipe drain system

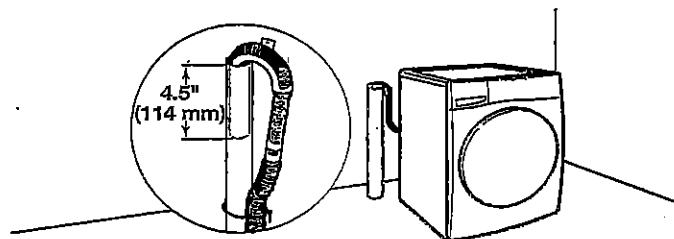

Minimum diameter for a standpipe drain: 2" (51 mm). Minimum carry-away capacity: 17 gal. (64 L) per minute. A 1/4" (6 mm) diameter to 1" (25 mm) diameter Standpipe Adapter Kit is available (Part Number 3363920). Top of standpipe must be at least 30" (762 mm) high; install no higher than 96" (2.44 m) from bottom of washer. If you have an overhead sewer and need to pump higher than 96" (2.44 m), a sump pump and associated hardware are needed. See "Alternate parts."

### Wall standpipe drain system

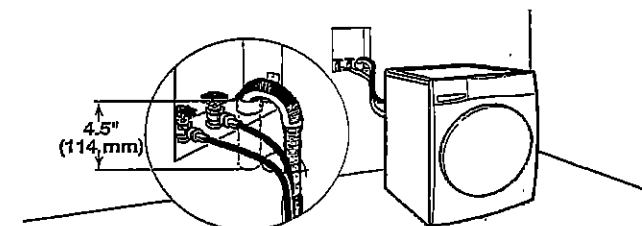

See requirements for floor standpipe drain system.

### Laundry tub drain system

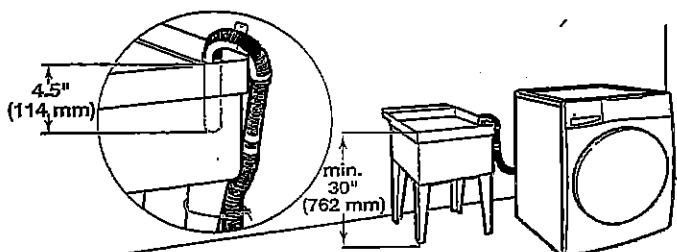

Minimum capacity: 20 gal. (76 L). Top of laundry tub must be at least 30" (762 mm) above floor; install no higher than 96" (2.44 m) from bottom of washer.

Handwritten signature or mark.

C2-COUNTRY LANE  
LOT 535  
20-1783 AL ELEV A  
THE APPLEDALE

47 of 49

WHIRLPOOL DRYER Model #: YWED5620HW

Whirlpool Brand Canada English | Washer and Dryers | Dryers | Electric Dryers | YWED5620HW

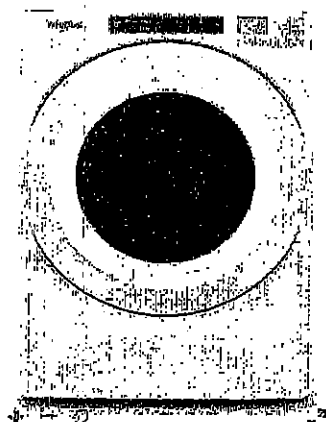

7.4 cu. ft. Front Load Electric  
Dryer with Intuitive Touch  
Controls



Whirlpool 7.4 cu. ft. Front Load Electric Dryer with Intuitive Touch Controls

Model #: YWED5620HW

Dimensions

Depth	78.74 cm, 31.0 in
Depth With Door Open 90 Degree	138.43 cm, 54-1/2 in
Height	98.42 cm, 38-3/4 in
Width	68.58 cm, 27.0 in

Configuration and Overview

Fuel Type	Electric
-----------	----------

Cycles and Options

Cycle Time Remaining	Yes
Lint Filter Indicator	No
Number of Dryer Cycles	36
Number of Dryness Levels	3

Ventilation System

Long Vent	No
Maximum Vent Length	64
Venting Direction	Left, Right, Bottom, Rear

Electrical

Hz	60
Power Cord Included	Yes

C2-COUNTRY LANE  
LOT 535  
20-1783 AL ELEV A  
THE APPLEDALE

48 of 49

WHIRLPOOL DRYER Model #: YWED5620HW

Back view:

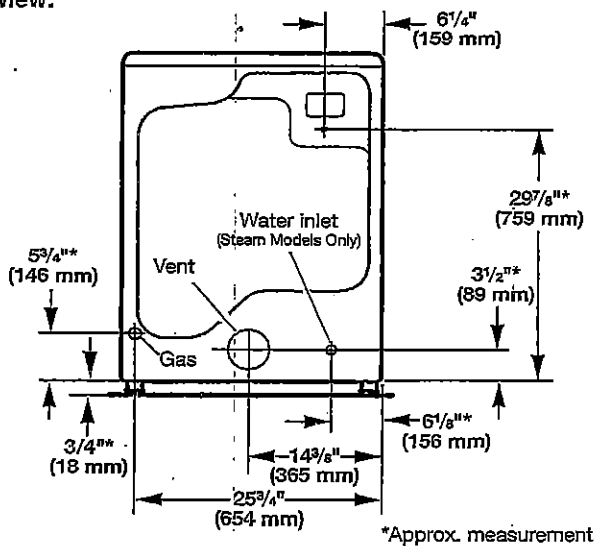

**NOTE:** Most installations require a minimum of 5" (127 mm) clearance behind dryer for exhaust vent with elbow. See "Venting Requirements."

#### Installation Clearances

For each arrangement, consider allowing more space for ease of installation and servicing, spacing for companion appliances, and clearances for walls, doors, and floor moldings. Space must be large enough to allow door to fully open. Add spacing on all sides of dryer to reduce noise transfer. If a closet door or louvered door is installed, top and bottom air openings in door are required.

Check code requirements. Some codes limit, or do not permit, installation of the dryer in garages, closets, mobile homes, or sleeping quarters. Contact your local building inspector:

**NOTE:** No other fuel-burning appliance can be installed in the same closet as a dryer.

#### Installation spacing for recessed area or closet installation

All dimensions show recommended and minimum spacing allowed.

- Additional spacing should be considered for ease of installation and servicing.
- Additional clearances might be required for wall, door, floor moldings, dryer venting, and gas line.
- Additional spacing should be considered on all sides of the dryer to reduce noise transfer.
- For closet installation with a door, minimum ventilation openings in the top and bottom of the door are required. Louvered doors with equivalent ventilation openings are acceptable.
- Companion appliance spacing should also be considered.

#### Recommended installation clearances (dryer only):

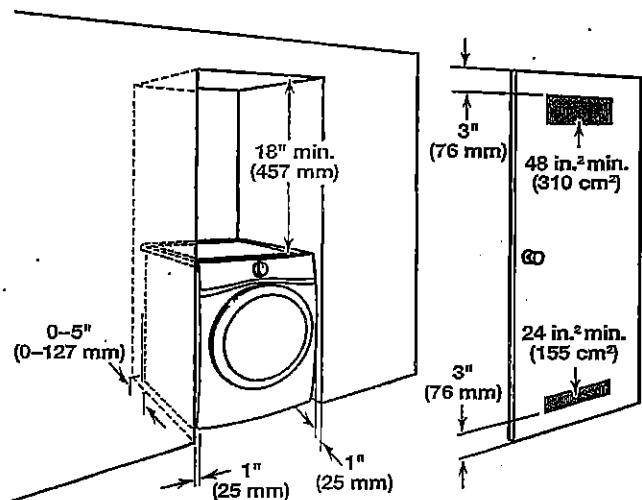

0" (0 mm) rear spacing is allowed for straight back venting only. For steam models only, inlet hose must not be kinked.

#### Custom under-counter installation:

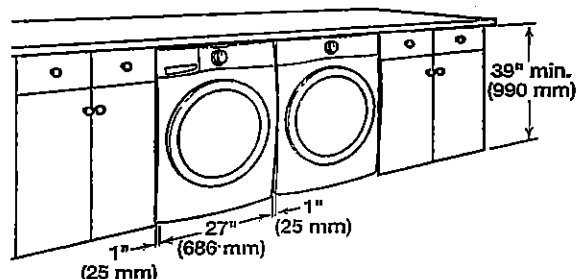

#### Mobile home - Additional installation requirements:

This dryer is suitable for mobile home installations. The installation must conform to the Manufactured Home Construction and Safety Standard, Title 24 CFR, Part 3280 (formerly the Federal Standard for Mobile home construction and Safety, Title 24, HUD Part 280) or Standard CAN/CSA-Z240 MH.

#### Mobile home installations require:

- Metal exhaust system hardware, available for purchase from your dealer. For further information, see "Assistance or Service" in your Use and Care Guide.
- Special provisions must be made in mobile homes to introduce outside air into dryer. Openings (such as a nearby window) should be at least twice as large as dryer exhaust opening.

#### For mobile home installation of gas dryers:

- Mobile Home Installation Hold-down Kit Part Number 346764 is available to order. For further information, see "Assistance or Service" in your Use and Care Guide.

*[Handwritten signature]*

C2-COUNTRY LANE  
LOT 535  
20-1783 AL ELEV A  
THE APPLEDALE

49.49

WHIRLPOOL DRYER Model #: YWED5620HW

Additional parts may be required, depending on your installation. Check local codes. Check existing electrical supply and venting. Read "Electrical Requirements" and "Venting Requirements" before purchasing parts.

#### If using a power supply cord:

Use a UL Listed power supply cord kit marked for use with clothes dryers. The kit should contain:

- A UL Listed 30 amp power supply cord, rated 120/240 volt minimum. The cord should be type SRD or SRDT and be at least 4 ft. (1.22 m) long. The wires that connect to the dryer must end in ring terminals or spade terminals with upturned ends.
- A UL Listed strain relief.

#### Optional Equipment (not supplied with dryer):

Refer to your Use and Care Guide for information about accessories available for your dryer.

## LOCATION REQUIREMENTS

Check code requirements. Some codes limit, or do not permit, installing dryer in garages, closets, mobile homes, or sleeping quarters. Contact your local building inspector.

### ⚠ WARNING



#### Explosion Hazard

Keep flammable materials and vapors, such as gasoline, away from dryer.

Place dryer at least 18 inches (460 mm) above the floor for a garage installation.

Failure to do so can result in death, explosion, or fire.

#### You will need:

- A location allowing for proper exhaust installation. See "Venting Requirements."
- A separate 15 or 20 amp circuit for a gas dryer or 30 amp circuit for an electric dryer.
- If using power supply cord, a grounded electrical outlet located within 2 ft. (610 mm) of either side of dryer. See "Electrical Requirements."
- Floor must support dryer weight of 200 lbs. (90.7 kg). Also consider weight of companion appliance.
- Cold water faucets located within 4 ft. (1.2 m) of the water fill valves, and water pressure of 20–120 psi (138–827 kPa). You may use your washer's water supply by purchasing the necessary parts noted in "Parts needed."
- Level floor with maximum slope of 1" (25 mm) under entire dryer. If slope is greater than 1" (25 mm), install Extended Dryer Feet Kit, Part Number 279810. If not level, clothes may not tumble properly and automatic sensor cycles may not operate correctly.
- For garage installation, place dryer at least 18" (460 mm) above floor. If using a pedestal, you will need 18" (460 mm) to bottom of dryer.
- The dryer must not be installed or stored in an area where it will be exposed to water and/or weather.

**IMPORTANT:** Do not operate, install, or store dryer where it will be exposed to water, weather, or at temperatures below 40°F (4°C). Lower temperatures may cause dryer not to shut off at end of automatic sensor cycles, resulting in longer drying times.

## DRYER DIMENSIONS

### Front view:

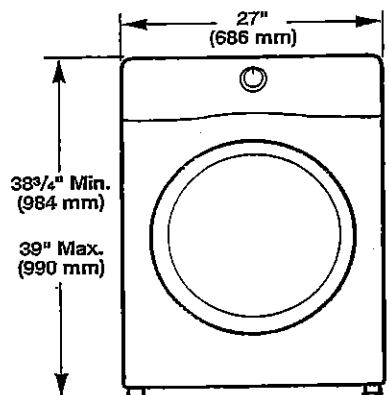

### Side view:

Whirlpool Models ✓

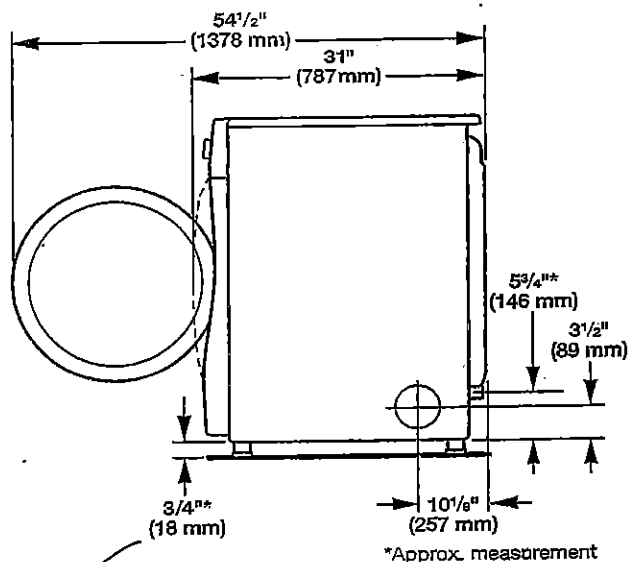

### Maytag Models

