



12-Jul-21

Interior Finishing Selection Sheet

10 of 13

LOT 057-5

20-1957 ELEV A THE BRAXTON

PURCHASERS: RAJENDRA BAMANIA

CONTACT NO: 416-756-4055

VENDOR: HEATHWOOD HOMES (WHITBY) LIMITED - PHASE 4

UPG

Appliances

6-9117 Kitchen HoodFan

☒ CYCLONE 30" STAINLESS CHIMNEY/CANOPY HOODFAN
STAINLESS STEEL SCB51930 UPG 30" PAGES 29-30

Cabinetry

1-9111 Kitchen Cabinet Colour/Style

3-2086 Kitchen Cabinet Hardware

25-9157 Main Bathroom Cabinet Colour/Style

29-2076 Main Bathroom Cabinet Hardware

20-9158 Master Ensuite Cabinet Colour/Style

22-7672 Master Ensuite Cabinet Hardware

☐ SIMCOE ORCHID VIKING III STD 3DL

☐ HARDWARE 9677 STD

☐ SIMCOE MOONLIGHT Viking III STD 3DL

☐ HARDWARE 181 STD

☐ SIMCOE NAVY BLUE Viking III STD 3DL

☐ HARDWARE 135 STD

Carpet

37-9248 Bedroom 2 Flooring

38-9248 Bedroom 3 Flooring

14-9248 Family Room Flooring

36-9248 Master Bedroom Flooring

52-1079 Throughout Underpad

☐ Dynasty Tex 40 oz Poly BLACK ICE DY 89418 STD

☐ Dynasty Tex 40 oz Poly BLACK ICE DY 89418 STD

☐ Dynasty Tex 40 oz Poly BLACK ICE DY 89418 STD

☐ Dynasty Tex 40 oz Poly BLACK ICE DY 89418 STD

☐ Underpad 500 Series STD

Ceramics

16-9106 Foyer Flooring

17-2225 Foyer Grout

4-8108 Kitchen Backsplash

5-2226 Kitchen Backsplash Grout

7-9106 Kitchen/Breakfast Flooring

8-2225 Kitchen/Breakfast Grout

30-9106 Main Bathroom Flooring

☒ Madison Series White Matte GE.MD.WHT.1818.MT UPG 1
18" X 18" Matte

☐ Grout (27) Silver STD

☒ ONTARIO HEXAGON MATTE DARK GREY
OD.ON.DGR.02.HEX.MT UPG_2

☐ Grout (00) White STD

☒ Madison Series White Matte GE.MD.WHT.1818.MT UPG 1
18" X 18" Matte

☐ Grout (27) Silver STD

☒ Madison Series White Matte GE.MD.WHT.1818.MT UPG 1
18" X 18" Matte

1. The Purchaser acknowledges these selections are subject to the terms and conditions of the applicable Agreement of Purchase and Sale.
2. The Purchaser acknowledges that the Vendor accepts no responsibility in the event the Vendor is unable to supply a selection. The Purchaser agrees to reselect from the currently available selections immediately upon request.
3. The Vendor reserves the right to substitute above materials and equipment with that of equal or better quality.
4. Purchaser acknowledges that items may not be exactly as shown. Variations from the Vendor's samples may occur in finished materials due to normal production processes. Vendor is not responsible for shade difference which may occur from different dye lots or wood grains. Variations from the Vendor's samples will occur with natural materials such as wood, marble, granite, hardwood and brick.
5. The Vendor reserves the right to select Grout & Thresholds that best suits the Tile selected.
6. Selections will not be processed unless signed by Heathwood Homes Head Office.
7. The colour selections made on the Colour Chart are final and cannot be changed once submitted.
8. The Purchaser has checked and acknowledges the accuracy of this Colour Chart.

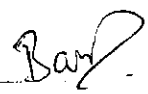
12th July 2021 
Date Purchaser

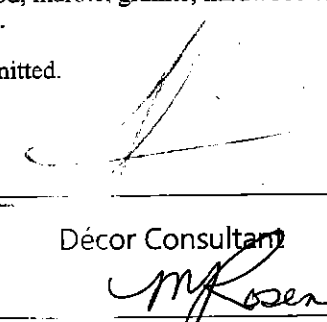
12th July 2021 
Date APPROVED Décor Consultant

Date Purchaser

Date Approved HEATHWOOD HOMES (WHITBY)
LIMITED - PHASE 4



12-Jul-21

LOT 057-5

Interior Finishing Selection Sheet

20-1957 ELEV A THE BRAXTON

PURCHASERS: RAJENDRA BAMANIA

CONTACT NO: 416-756-4055

VENDOR: HEATHWOOD HOMES (WHITBY) LIMITED - PHASE 4

UPG

Ceramics

- 31-2225 Main Bathroom Grout
- 112-9020 Main Bathroom Tub Wall Tile
- 113-2226 Main Bathroom Tub Wall Tile Grout
- 23-9106 Master Ensuite Floor Tile
- 24-2225 Master Ensuite Floor Tile Grout
- 73-8661 Master Ensuite Shower Floor Tile
- 74-2226 Master Ensuite Shower Floor Tile Grout
- 147-8923 Master Ensuite Shower Jamb(s) and Sill(s)
- 104-9020 Master Ensuite Shower Wall Tile
- 105-2226 Master Ensuite Shower Wall Tile Grout
- 190-5607 Mud Room Flooring
- 191-7704 Mud Room Grout
- 32-9106 Powder Room Flooring
- 33-2225 Powder Room Grout
- 53-2232 Throughout Thresholds

- ☐ Grout (27) Silver STD
- ☐ Weave White QT.WV.WHT.0810 STD 8 x 10 INSTALL STACKED HORIZONTALLY
- ☐ Grout (00) White STD
- ☒ Madison Series White Matte GE.MD.WHT.1818.MT UPG 1 18" X 18" Matte
- ☐ Grout (27) Silver STD
- ☐ Ontario Series Mosaic Snow White Matte OD.ON.SWT.0202.MT.N STD 2 x 2
- ☐ Grout (00) White STD
- ☐ Shower Jamb / Sill Thassos White STD
- ☐ Weave White QT.WV.WHT.0810 STD 8 x 10 INSATLL STACKED HORIZONTALLY
- ☐ Grout (00) White STD
- ☐ Sauble Anthracite (Black) GE.SU.ATR.1313 STD 13" X 13"
- ☐ Grout (19) Pearl Gray STD
- ☒ Madison Series White Matte GE.MD.WHT.1818.MT UPG 1 18" X 18" Matte
- ☐ Grout (27) Silver STD
- ☐ Metal Thresholds STD

Electrical

- 90-5796 Throughout Switches and Plug

- ☐ Decora White Switches and Plugs STD

Fireplace

- 136-8891 Great Room Fireplace Mantle
- 135-8865 Great Room Fireplace Type

- ☐ Paint Grade Mantle- Cabinet (Per Plan) WHITE NF-17 STD
- ☐ Dimplex FP3033HL Electric Fireplace

Granite

- 2-9069 Kitchen Countertop

- ☐ MSI Quartz ICED WHITE Group 1 STD 3/4"

1. The Purchaser acknowledges these selections are subject to the terms and conditions of the applicable Agreement of Purchase and Sale.
2. The Purchaser acknowledges that the Vendor accepts no responsibility in the event the Vendor is unable to supply a selection. The Purchaser agrees to reselect from the currently available selections immediately upon request.
3. The Vendor reserves the right to substitute above materials and equipment with that of equal or better quality.
4. Purchaser acknowledges that items may not be exactly as shown. Variations from the Vendor's samples may occur in finished materials due to normal production processes. Vendor is not responsible for shade difference which may occur from different dye lots or wood grains. Variations from the Vendor's samples will occur with natural materials such as wood, marble, granite, hardwood and brick.
5. The Vendor reserves the right to select Grout & Thresholds that best suits the Tile selected.
6. Selections will not be processed unless signed by Heathwood Homes Head Office.
7. The colour selections made on the Colour Chart are final and cannot be changed once submitted.
8. The Purchaser has checked and acknowledges the accuracy of this Colour Chart.

12 July - 2021

Ben

7/12/21

APPROVED

Date Purchaser

Date Décor Consultant

Date Purchaser

Date Approved HEATHWOOD HOMES (WHITBY) LIMITED - PHASE 4



12-Jul-21

Interior Finishing Selection Sheet

LOT 057-5

20-1957 ELEV A THE BRAXTON

PURCHASERS: RAJENDRA BAMANIA

CONTACT NO: 416-756-4055

VENDOR: HEATHWOOD HOMES (WHITBY) LIMITED - PHASE 4

Granite

28-9069 Main Bathroom Countertop

21-9069 Master Ensuite Countertop

Hardwood

11-7498 Great Room Flooring

334-7498 Powder Room Landing Flooring

78-7498 Stair Landing to Lower Level Flooring

77-7498 Stair Landing to Upper Level Flooring

35-7498 Upper Hall Flooring

Interior Railings

49-8148 Stairs to Lower Level Handrail/Pickets/Posts Type

43-8148 Stairs to Upper Level Handrail/Pickets/Posts Type

Interior Stairs

116-1713 Basement Stairs Type

45-1712 Stairs to Lower Level Type

39-1712 Stairs to Upper Level Type

Interior Trim

91-9374 Throughout Trim Size

Painting

46-7761 Stairs to Lower Level Colour

40-7761 Stairs to Upper Level Colour

UPG

☒ MSI Quartz ICED WHITE Group 1 STD 3/4"

☒ MSI Quartz ICED WHITE Group 1 STD 3/4"

☐ Vintage Northern Solid Sawn Engineered Select V : Red Oak Pearl GRYPHON Red Oak Pearl 3/4" x 3 1/4"

☐ Vintage Northern Solid Sawn Engineered Select V : Red Oak Pearl GRYPHON Red Oak Pearl 3/4" x 3 1/4"

☐ Vintage Northern Solid Sawn Engineered Select V : Red Oak Pearl GRYPHON Red Oak Pearl 3/4" x 3 1/4"

☐ Vintage Northern Solid Sawn Engineered Select V : Red Oak Pearl GRYPHON Red Oak Pearl 3/4" x 3 1/4"

☐ Vintage Northern Solid Sawn Engineered Select V : Red Oak Pearl GRYPHON Red Oak Pearl 3/4" x 3 1/4"

☐ Single Collar Alt. Plain w/ Shoes with 3 1/2" Square/Cap Post(s) BLACK METAL STD

☐ Single Collar Alt. Plain w/ Shoes with 3 1/2" Square/Cap Post(s) BLACK METAL STD

☐ Paint Grade Stairs STD

☐ Oak Stairs UPG_1

☐ Oak Stairs UPG_1

☐ 4 1/4" Baseboards and 2 3/4" Integrated Backbend Casings STD-Towns

☐ Stain handrail, stringers, treads, risers, nosing & posts. (Metal pickets) STAIRS TO BE STAINED TO COMPLEMENT GRYPHON HARDWOOD. STAIRS WILL VARY FROM FLOORS

☒ Stain handrail, stringers, treads, risers, nosing & posts. (Metal pickets) STAIRS TO BE STAINED TO COMPLEMENT GRYPHON HARDWOOD. STAIRS WILL VARY FROM FLOORS

1. The Purchaser acknowledges these selections are subject to the terms and conditions of the applicable Agreement of Purchase and Sale.
2. The Purchaser acknowledges that the Vendor accepts no responsibility in the event the Vendor is unable to supply a selection. The Purchaser agrees to reselect from the currently available selections immediately upon request.
3. The Vendor reserves the right to substitute above materials and equipment with that of equal or better quality.
4. Purchaser acknowledges that items may not be exactly as shown. Variations from the Vendor's samples may occur in finished materials due to normal production processes. Vendor is not responsible for shade difference which may occur from different dye lots or wood grains. Variations from the Vendor's samples will occur with natural materials such as wood, marble, granite, hardwood and brick.
5. The Vendor reserves the right to select Grout & Thresholds that best suits the Tile selected.
6. Selections will not be processed unless signed by Heathwood Homes Head Office.
7. The colour selections made on the Colour Chart are final and cannot be changed once submitted.
8. The Purchaser has checked and acknowledges the accuracy of this Colour Chart.

12th July 2021

Date Purchaser

Bany

Date

APPROVED

Décor Consultant

My Rosen

Date Purchaser

Date Approved HEATHWOOD HOMES (WHITBY) LIMITED - PHASE 4



12-Jul-21

Interior Finishing Selection Sheet

13.05.21

LOT 057-5

20-1957 ELEV A THE BRAXTON

PURCHASERS: RAJENDRA BAMANIA

CONTACT NO: 416-756-4055

VENDOR: HEATHWOOD HOMES (WHITBY) LIMITED - PHASE 4

Painting

240-1716 Throughout Trim - Paint Colour

51-1717 Throughout Walls - Paint Colour

Plumbing

266-1737 Main Bathroom Plumbing Fixture (Colour)

149-1737 Master Ensuite Plumbing Fixture (colour)

34-1737 Powder Room Plumbing Fixture (Colour)

UPG

☐ Trim WHITE STD

☐ Wall WARM GREY 22 STD

☐ Plumbing Fixtures WHITE STD

☐ Plumbing Fixtures WHITE STD

☐ Plumbing Fixtures WHITE STD

1. The Purchaser acknowledges these selections are subject to the terms and conditions of the applicable Agreement of Purchase and Sale.
2. The Purchaser acknowledges that the Vendor accepts no responsibility in the event the Vendor is unable to supply a selection. The Purchaser agrees to reselect from the currently available selections immediately upon request.
3. The Vendor reserves the right to substitute above materials and equipment with that of equal or better quality.
4. Purchaser acknowledges that items may not be exactly as shown. Variations from the Vendor's samples may occur in finished materials due to normal production processes. Vendor is not responsible for shade difference which may occur from different dye lots or wood grains. Variations from the Vendor's samples will occur with natural materials such as wood, marble, granite, hardwood and brick.
5. The Vendor reserves the right to select Grout & Thresholds that best suits the Tile selected.
6. Selections will not be processed unless signed by Heathwood Homes Head Office.
7. The colour selections made on the Colour Chart are final and cannot be changed once submitted.
8. The Purchaser has checked and acknowledges the accuracy of this Colour Chart.

12th July - 2021

Date

Purchaser

[Signature]

Date

7/12/21

Décor Consultant

[Signature]

Date

Purchaser

Date Approved

HEATHWOOD HOMES (WHITBY)
LIMITED - PHASE 4



12-Jul-21

Sales Selection Sheet
14 OF 43

LOT 057-5

20-1957 ELEV A THE BRAXTON

PURCHASERS: RAJENDRA BAMANIA

CONTACT NO: 416-756-4055

VENDOR: HEATHWOOD HOMES (WHITBY) LIMITED - PHASE 4

HST #

It is herein understood and agreed between the undersigned parties hereto that the following changes shall be made to the above mentioned Agreement of Purchase and Sale in accordance with the agreement and except for such changes noted below, all other terms and conditions in the Agreement of Purchase and Sale shall remain as stated herein: It is further understood that and agreed that all changes and additions shall be installed as per builder's specifications, location and available selections. The Purchaser hereby agrees to purchase the following extras:

Appliances

2171	Cyclone 30" Wall Mount Chimney Hood SS SCB51930	KITCHEN	Qty: 1
------	--	---------	--------

PAGES 29-30

Cabinetry

1338	Optional Extras 30H- Wall cabinet with shelf for microwave (finished interior) (opening 24"W x 13 3/4"H x 17"D) * electrical priced separately Viking SEE SKETCH # 7	KITCHEN	Qty: 1
------	--	---------	--------

PAGE 19

FOR LOCATION

Ceramics

1733	Upgrade 1 Tile	Foyer Floor	Qty: 1
------	----------------	-------------	--------

1737	Upgrade 1 Tile	Kit/Brk Floor	Qty: 1
------	----------------	---------------	--------

1966	Optional Extras Supply and install additional backsplash due to chimney hoodfan installation Upgrade 2	Kitchen	Qty: 1
------	--	---------	--------

1742	Upgrade 2 Tile	Kitchen Optional Backsplash	Qty: 1
------	----------------	--------------------------------	--------

1738	Upgrade 1 Tile	M. Ensuite Floor	Qty: 1
------	----------------	------------------	--------

1. This Sales Selection Sheet when properly executed forms part of our Agreement of Purchase and Sale.
2. All extras and upgrades listed above are subject to Construction Progress and Architectural and Municipal requirements.
3. In the event the Vendor is unable to incorporate the work approved above in the construction of the house for any reason whatsoever, the Vendor will not be liable to the Purchaser in any way. The monies paid for any changes or optional extras not proceeded with shall be returned to the Purchaser, without interest. The cost of options or extras is non-refundable in all other circumstances. If for any reason whatsoever the Agreement of Purchase and Sale is not completed, the total cost of work approved above will be retained by the Vendor.
4. The Vendor reserves the right to substitute above materials and equipment with that of equal or better quality.
5. Purchaser acknowledges that items may not be exactly as shown. Variations from the Vendor's samples may occur in finished materials due to normal production processes. Vendor is not responsible for shade difference which may occur from different dye lots or wood grains. Variations from the Vendor's samples will occur with natural materials such as wood, marble, granite, hardwood and brick.
6. The Vendor reserves the right to select Grout & Thresholds that best suits the Tile selected.
7. Selections will not be processed unless signed by Heathwood Homes Head Office.
8. The selections made on this schedule are final and cannot be changed once submitted.
9. The Purchaser has checked and acknowledges the accuracy of this schedule.

12th July 2021

Purchaser

Date

7/12/21

Décor Consultant

TINA LEFUR

Date

Purchaser

-07- 19 2021

Date Approved HEATHWOOD HOMES (WHITBY)
LIMITED - PHASE 4



12-Jul-21

Sales Selection Sheet
S.F. 43

LOT 057-5

20-1957 ELEV A THE BRAXTON

PURCHASERS: RAJENDRA BAMANIA

CONTACT NO: 416-756-4055

VENDOR: HEATHWOOD HOMES (WHITBY) LIMITED - PHASE 4

HST #

It is herein understood and agreed between the undersigned parties hereto that the following changes shall be made to the above mentioned Agreement of Purchase and Sale in accordance with the agreement and except for such changes noted below, all other terms and conditions in the Agreement of Purchase and Sale shall remain as stated herein: It is further understood that and agreed that all changes and additions shall be installed as per builder's specifications, location and available selections. The Purchaser hereby agrees to purchase the following extras:

1739 Main Bth Floor Qty: 1
Upgrade 1 Tile

1735 Powder Floor Qty: 1
Upgrade 1 Tile

Electrical

379 Optional Extras KITCHEN Qty: 1
Extra wall interior outlet (120V/15A) on a Separate Circuit (on arc fault)
SEE SKETCH # 7 PAGE 19 FOR LOCATION FOR UPPER MICROWAVE SHELF

Fireplace

81 Qty: 1
Purchasers have been advised: heat from the FP can damage TV above a FP and items placed on mantle. Purchasers acknowledge: Heathwood Homes and its contractors will not be liable for any damage on items placed/installed above a FP after closing

Granite

813 Optional Upgrade Main Bathroom Qty: 1
Countertop upgrade with 4" backsplash 3/4" GROUP 1 with single edge

812 Optional Upgrade Master Ensuite Qty: 1
Countertop upgrade with 4" backsplash 3/4" GROUP 1 with single edge

763 Optional Extras MASTER ENSUITE/MAIN BATH Qty: 2
Granite cutout w/ straight edge polish to accommodate under mount vanity sink
SINK SPECS PAGE 25

1. This Sales Selection Sheet when properly executed forms part of our Agreement of Purchase and Sale.
2. All extras and upgrades listed above are subject to Construction Progress and Architectural and Municipal requirements.
3. In the event the Vendor is unable to incorporate the work approved above in the construction of the house for any reason whatsoever, the Vendor will not be liable to the Purchaser in any way. The monies paid for any changes or optional extras not proceeded with shall be returned to the Purchaser, without interest. The cost of options or extras is non-refundable in all other circumstances. If for any reason whatsoever the Agreement of Purchase and Sale is not completed, the total cost of work approved above will be retained by the Vendor.
4. The Vendor reserves the right to substitute above materials and equipment with that of equal or better quality.
5. Purchaser acknowledges that items may not be exactly as shown. Variations from the Vendor's samples may occur in finished materials due to normal production processes. Vendor is not responsible for shade difference which may occur from different dye lots or wood grains. Variations from the Vendor's samples will occur with natural materials such as wood, marble, granite, hardwood and brick.
6. The Vendor reserves the right to select Grout & Thresholds that best suits the Tile selected.
7. Selections will not be processed unless signed by Heathwood Homes Head Office.
8. The selections made on this schedule are final and cannot be changed once submitted.
9. The Purchaser has checked and acknowledges the accuracy of this schedule.

12th July 2021

Date

Purchaser

Ban

Date

APPROVED

TINA LEFUR
Décor Consultant

Date

Purchaser

-07- 19 2021

Date Approved HEATHWOOD HOMES (WHITBY)
LIMITED - PHASE 4



12-Jul-21

Sales Selection Sheet
16 of 43

LOT 057-5

20-1957 ELEV A THE BRAXTON

PURCHASERS: RAJENDRA BAMANIA

CONTACT NO: 416-756-4055

VENDOR: HEATHWOOD HOMES (WHITBY) LIMITED - PHASE 4

HST #

It is herein understood and agreed between the undersigned parties hereto that the following changes shall be made to the above mentioned Agreement of Purchase and Sale in accordance with the agreement and except for such changes noted below, all other terms and conditions in the Agreement of Purchase and Sale shall remain as stated herein: It is further understood that and agreed that all changes and additions shall be installed as per builder's specifications, location and available selections. The Purchaser hereby agrees to purchase the following extras:

Mirrors/Glass Products

541 Shower Upgrade Master Ensuite Qty: 1
Upgrade to Frameless clear glass with D-Ring Handle in chrome

Plumbing

276 STANDARD Kitchen Sink Option KITCHEN Qty: 1
KINDRED Kitchen Sink Collection - Reginox ND1831 UA/9 Stainless Kitchen Double
(equal size) Bowl Undermount Sink (or equivalent) PAGE 22

104 AMERICAN STANDARD - SINK OPTIONS - MASTER Qty: 2
~~Above Counter Sink~~ Undermount ENSUITE/MAIN BATH
BOXE - White ONLY Model 0504001.020 - Centre faucet hole
0315000 PAGE 25 SEE REVISED SSS FOR CREDIT

318 Moen -METHOD MASTER Qty: 2
ENSUITE/MAIN BATH
Chrome one-handle low arc bathroom faucet Single-Hole Faucet (no plate)-
(Model: 6810) SPEC PAGE 27

1. This Sales Selection Sheet when properly executed forms part of our Agreement of Purchase and Sale.
2. All extras and upgrades listed above are subject to Construction Progress and Architectural and Municipal requirements.
3. In the event the Vendor is unable to incorporate the work approved above in the construction of the house for any reason whatsoever, the Vendor will not be liable to the Purchaser in any way. The monies paid for any changes or optional extras not proceeded with shall be returned to the Purchaser, without interest. The cost of options or extras is non-refundable in all other circumstances. If for any reason whatsoever the Agreement of Purchase and Sale is not completed, the total cost of work approved above will be retained by the Vendor.
4. The Vendor reserves the right to substitute above materials and equipment with that of equal or better quality.
5. Purchaser acknowledges that items may not be exactly as shown. Variations from the Vendor's samples may occur in finished materials due to normal production processes. Vendor is not responsible for shade difference which may occur from different dye lots or wood grains. Variations from the Vendor's samples will occur with natural materials such as wood, marble, granite, hardwood and brick.
6. The Vendor reserves the right to select Grout & Thresholds that best suits the Tile selected.
7. Selections will not be processed unless signed by Heathwood Homes Head Office.
8. The selections made on this schedule are final and cannot be changed once submitted.
9. The Purchaser has checked and acknowledges the accuracy of this schedule.

12th July 2021

Date Purchaser

Bamania

Date

APPROVED

Décor Consultant

TINA LEFUR

Date Purchaser

-07-19-2021

Date Approved HEATHWOOD HOMES (WHITBY)
LIMITED - PHASE 4

C2-COUNTRY LANE
LOT 57-5
20-1957 ELEV A
THE BRAXTON

17 of 43

The Braxton

20-1957 ELEV. A

ELEVATION A & B: 1,957 SQ. FT.
Sketch #5

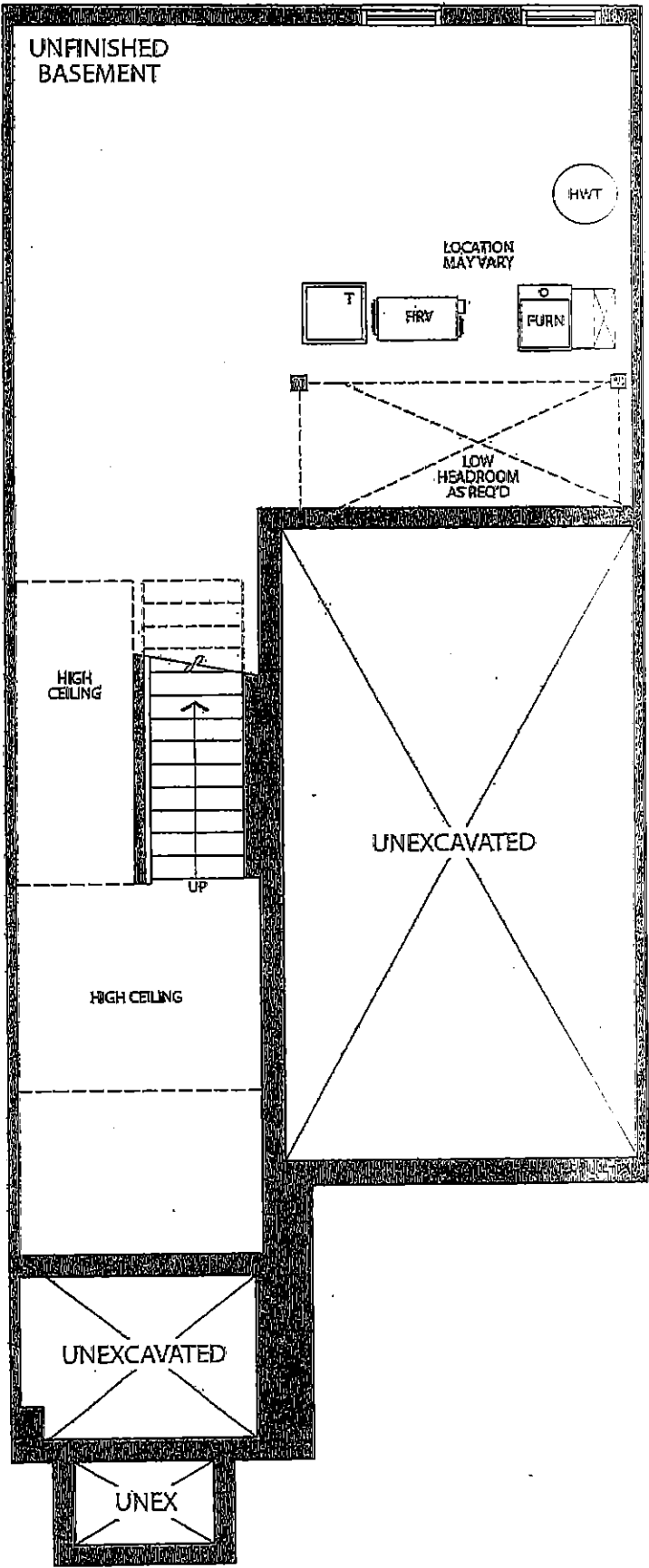

BASEMENT
ELEVATION A & B

A

C2-COUNTRY LANE
LOT 57-5
20-1957 ELEV A
THE BRAXTON

18 of 43

The Braxton

20-1957 ELEV. A

ELEVATION A & B: 1,957 SQ. FT.

Sketch #6

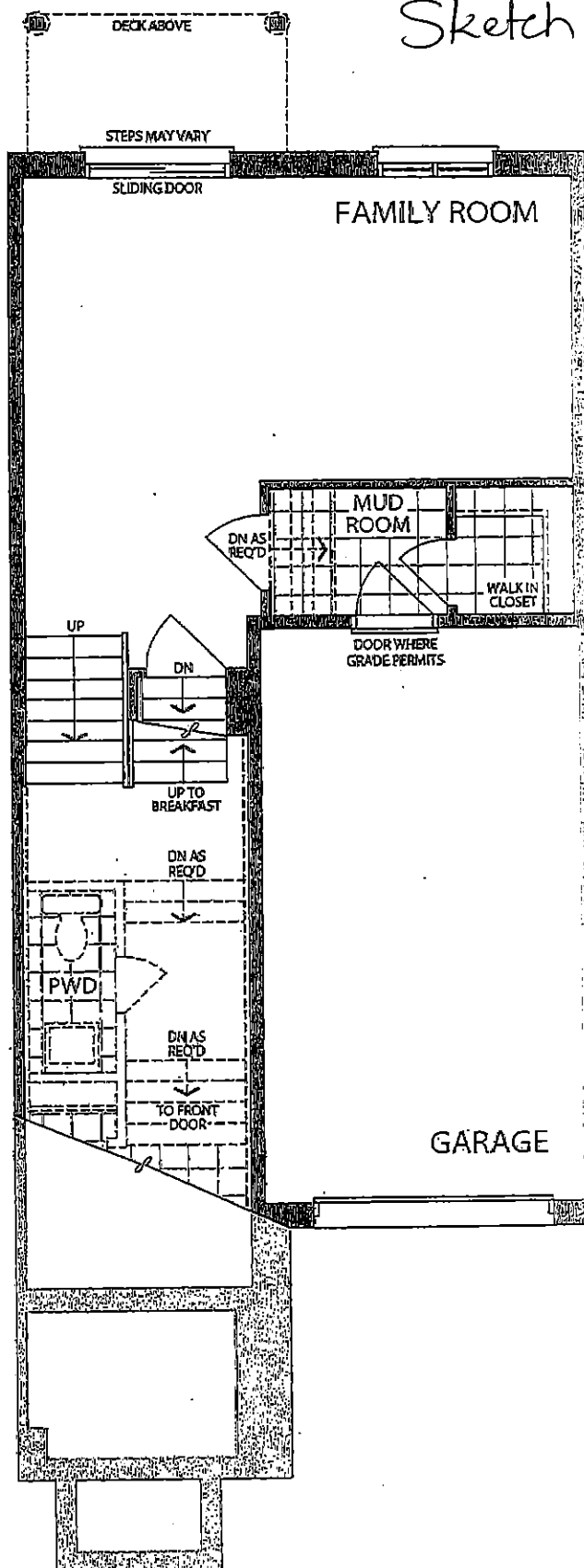

LOWER LEVEL
ELEVATION A & B

C2-COUNTRY LANE
LOT 57-5
20-1957 ELEV A
THE BRAXTON

19 of 43

The Braxton

20-1957 ELEV. A ELEVATION A & B: 1,957 SQ. FT.

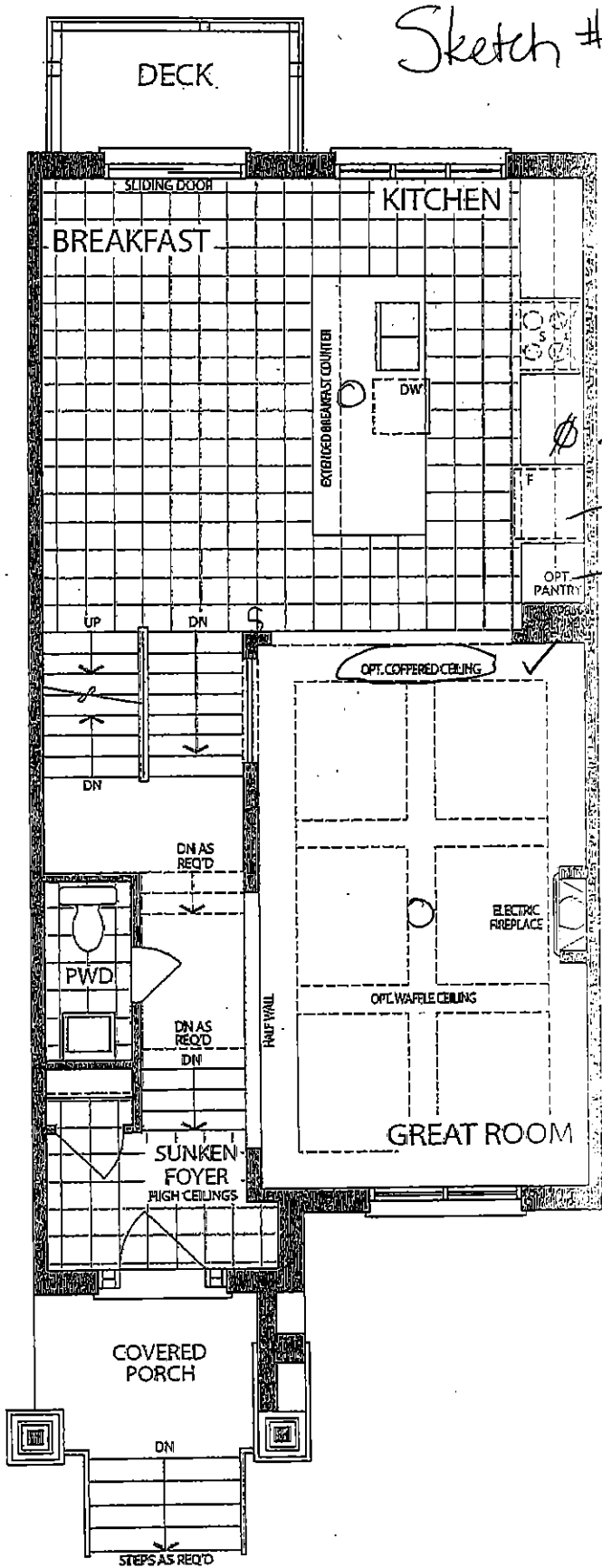

UPPER
MICROWAVE SHELF
& PLUG

DEEP FRIDGE UPPER
(PRE SSS)

OPTIONAL PANTRY
(PRE SSS)

70 1/4" +/-
HDMI - ELECTRICAL
PLUG AS PER PRE SSS

MAIN LEVEL
ELEVATION A

C2-COUNTRY LANE
LOT 57-5
20-1957 ELEV A
THE BRAXTON

20 of 43

The Braxton

20-1957 ELEV. A

ELEVATION A & B: 1,957 SQ. FT.

Sketch #8

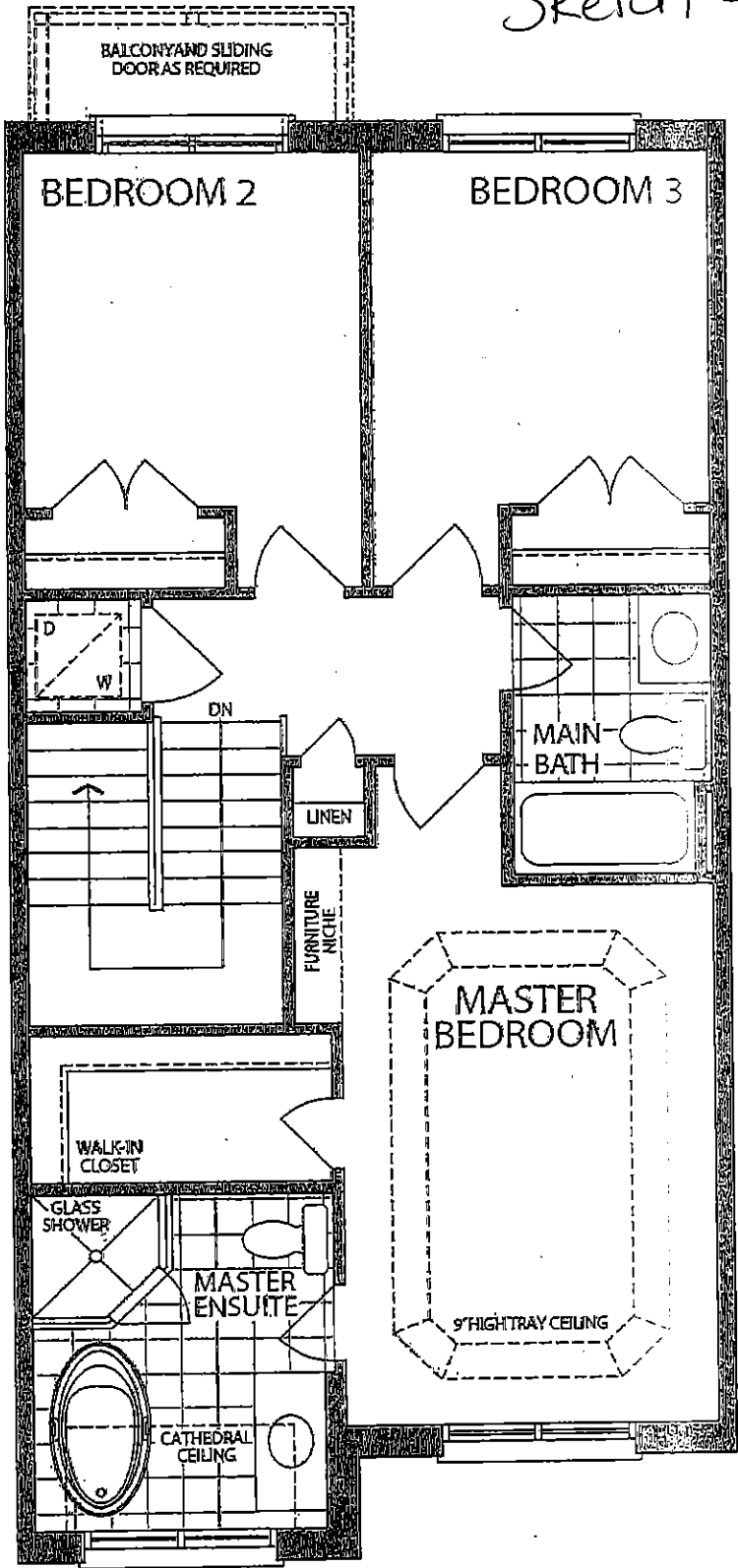

UPPER LEVEL
ELEVATION A

C2-COUNTRY LANE
LOT 57-5
20-1957 ELEV A
THE BRAXTON

21 of 43

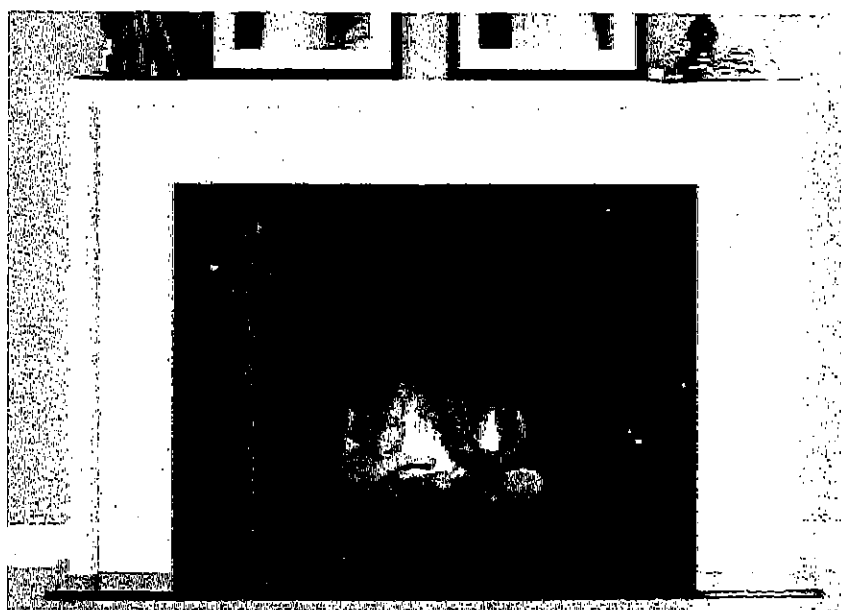

'CABINET'

NEAS NF17 Mantel

✓

C2-COUNTRY LANE
 LOT 57-5
 20-1957 ELEV A
 THE BRAXTON

22 of 43



STANDARD KITCHEN SINK

ND1831UA/9







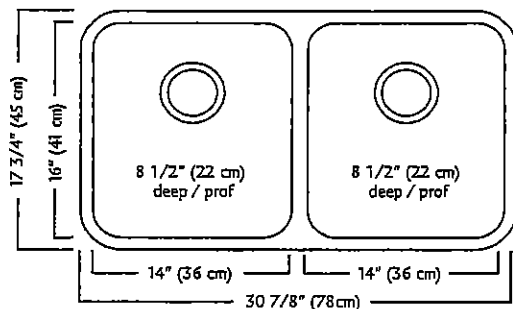

ND1831UA/9 SPECIFICATION

Model ND1831UA/9 is a double (two equal size) bowl undermount sink manufactured by Franke Kindred Canada Limited from 18 gauge stainless steel. Product has silk finished rims and linear brush finished bowls. Sink is fully undercoated. Basket strainer waste fittings (3 1/2", 89 mm) are included. Sink is backed with a limited lifetime warranty.

- O.D. 17 3/4" x 30 7/8" x 8 1/2" (45 x 78 x 22 cm)
- Recommended for minimum 36" cabinet

Franke Kindred Canada Limited
 P.O. Box 190, 1000 Franke Kindred Road, Midland, Ontario, Canada, L4R 4K9 Phone: 866-667-7465 Fax: 800-361-8408

C2-COUNTRY LANE
LOT 57-5
20-1957 ELEV A
THE BRAXTON

23.43

STANDARD KITCHEN FAUCET

Align

Modern



Single Handle Pull-Down Kitchen
Faucet*

Model 7565†

✓

C2-COUNTRY LANE
LOT 57-5
20-1957 ELEV A
THE BRAXTON

24.43

*American
Standard*

**BOULEVARD®
PEDESTAL SINK**
VITREOUS CHINA

BOULEVARD® PEDESTAL SINK

- ☐ 0641.800 Faucet holes on 8" (203mm) centers (Illustrated).
- * ☐ 0641.400 Faucet holes on 4" (102mm) centers
- ☐ 0641.100 Center hole only
 - Classic styled rectangular pedestal lavatory
 - Vitreous china
 - Rear overflow
 - Supplied with mounting kit
 - Right Height® for greater comfort during use
 - Faucet ledge with large deck area (faucet not included)
 - Design coordinates with Boulevard® Toilet
 - Basin has flat bottom to also allow use as an above counter sink or a drop-in sink (with u-shaped cut out)

Nominal Dimensions:

24" x 19" x 35-1/2"
(610 x 483 x 902mm)

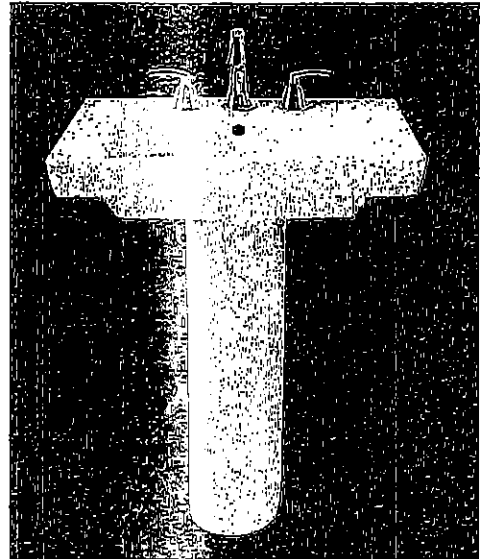

- ☐ 0641.008 Pedestal top-8" (203mm) centers
- ☐ 0641.004 Pedestal top-4" (102mm) centers
- ☐ 0641.001 Pedestal top-center hole only
- ☐ 0010.000 Pedestal only

SEE REVERSE FOR ROUGHING-IN DIMENSIONS

Bowl sizes:

17" (432mm) wide,
12-1/2" (318mm) front to back,
5" (127mm) deep

Compliance Certifications -

Meets or Exceeds the Following Specifications:

- ASME A112.19.2 - 2008/CSA B45.1-08

To Be Specified:

- ☐ Color: ☐ White ☐ Linen
- ☐ Faucet Finish:
- ☐ Supplies:
- ☐ 1-1/4" Trap:
- ☐ Nipple:

* See faucet section for additional models available

1/2

C2-COUNTRY LANE
LOT 57-5
20-1957 ELEV A
THE BRAXTON

25 of 43

X2 MASTER ENSUITE
AND MAIN BATHROOMS

American Standard

Style That Works Better

BARRIER FREE

BOXE
UNDERCOUNTER SINK
VITREOUS CHINA

BOXE UNDERCOUNTER SINK

- Vitreous china
- Rectangular undercounter mount sink with rectangular interior and flat bottom design bowl
- Unglazed rim
- Front overflow
- Supplied with template
- Meets OBC requirement when sink is installed with overflow to the rear
- Mounting clips available separately (P031006000) (Faucet not included)

0315 000 Unglazed Rim
508 x 406mm (20" x 16")

Bowl size:
438mm (17-1/4") wide,
337mm (13-1/4") front to back,
127mm (5") deep

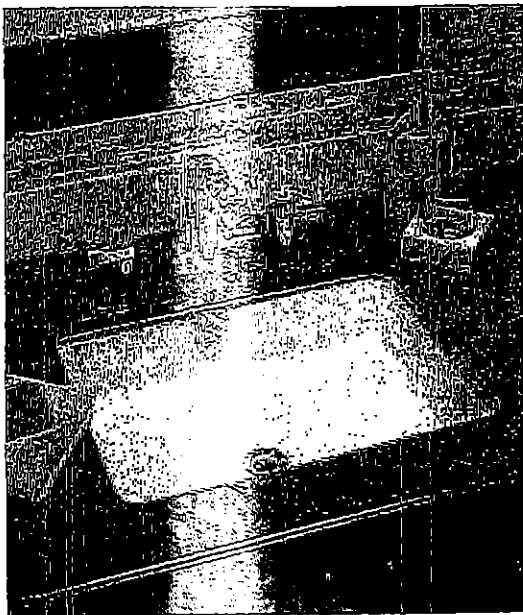

COMPLIANCE CERTIFICATIONS -

- Meets or exceeds the following Specifications:
- ASME A112.19.2M for Vitreous China Fixtures.
 - CAN/CSA B45 Series.

To Be Specified

- ☐ Colour: ☐ White
- ☐ Faucet*:
- ☐ Faucet Finish:
- ☐ Supplies & Stops:
- ☐ Trap 1-1/4" (32 mm):

* See faucet section for additional models available

- ☐ * Countertop 864mm (34") from finished floor. Sink installed 102mm (4") from front edge of countertop. Countertop thickness to be 25mm (1") maximum. MEETS THE AMERICAN DISABILITIES ACT GUIDELINES AND ANSI A117.1 ACCESSIBLE AND USEABLE BUILDINGS AND FACILITIES - CHECK LOCAL CODES.

NOTES:
WE RECOMMEND USING SINK AS A TEMPLATE TO DETERMINE PROPER CONTOUR. CUT COUNTERTOP 38MM (1-1/2") INSIDE SINK CONTOUR. FAUCETS NOT INCLUDED AND MUST BE ORDERED SEPARATELY.
* DIMENSIONS SHOWN FOR LOCATION OF SUPPLIES AND "P" TRAP ARE SUGGESTED.
✓ UNDERCOUNTER MOUNTING KIT SUPPLIED SEPARATELY.
IMPORTANT: Dimensions of fixtures are nominal and may vary within the range of tolerances established by ANSI Standard A112.19.2. These measurements are subject to change or cancellation. No responsibility is assumed for use of superseded or voided pages.

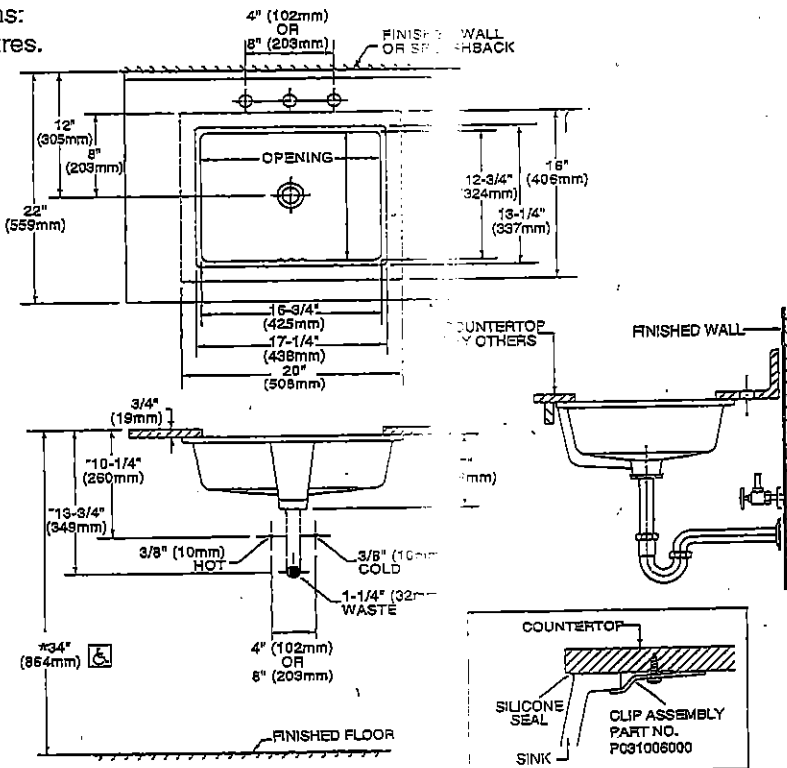

NOTE: *SUGGESTED DIMENSION - VARIABLE DEPENDING ON TYPE OF SUPPLY AND WASTE

* To comply with ADA standards, overflow hole must face back

C2-COUNTRY LANE
LOT 57-5
20-1957 ELEV A
THE BRAXTON

26 of 43



Demi CF2007

C2-COUNTRY LANE
LOT 57-5
20-1957 ELEV A
THE BRAXTON

27
104
13

Method™

Traditional | Transitional | Modern
A modern blend of flat planes and curves
gives Method faucets and accessories an chic look.

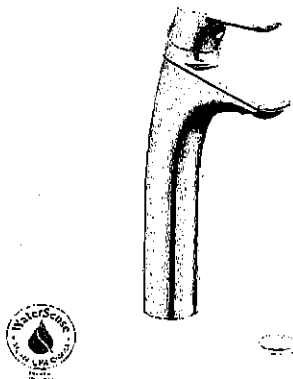

Single Handle Vessel Lav
Faucet with Lift Rod Drain
and Grid Drain Kit ^

Model 6810 / A2020

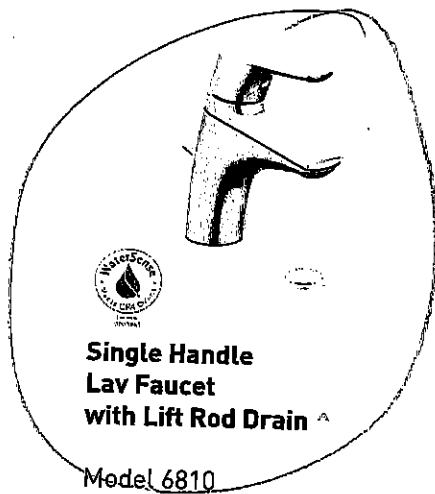

Single Handle
Lav Faucet
with Lift Rod Drain ^

Model 6810



Two Handle Adjustable Widespread
(8" - 16") Lav Faucet
with Lift Rod Drain

Model T6820 / 69000

MASTER ENSUITE &
MAIN BATH

METHOD

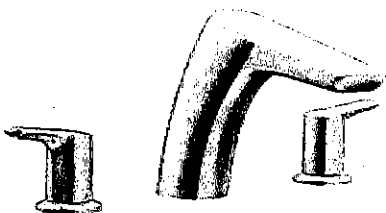

Two Handle
Roman Tub Faucet

Model T986 / 4796



Two Handle Roman Tub
with Hand Shower

Model T987 / 9796



Tub Drain Half Kits Available**



Tub Drain Half Kits Available**



FINISH OPTIONS:

To order, combine the model number with one of these finish letter(s):
LifeShine® Brushed Nickel (BN).

To order Chrome (C) model, use model number only.

^ Deckplate included

** T90331 / 140680

13

C2-COUNTRY LANE
LOT 57-5
20-1957 ELEV A
THE BRAXTON

28 of 43

Chateau

Transitional

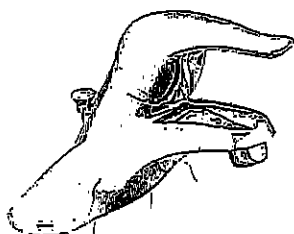

Lavatory Faucet with Pop-Up Drain
Model L4621+

VANITY SINKS AND PEDESTAL

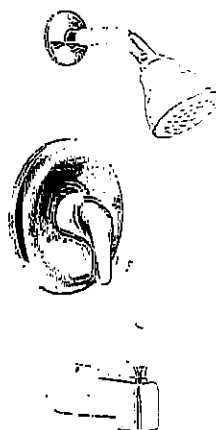

Posi-Temp® Pressure Balancing Tub/Shower
Model 62320 / TL183+

OR

Posi-Temp Valve and Tub/Shower Trim
with Eco-Performance Easy Clean® XL

Model 62320 / TL183EP+

(TL183EP not available in S.D.)

SHOWER AND 5' TUB FAUCETS

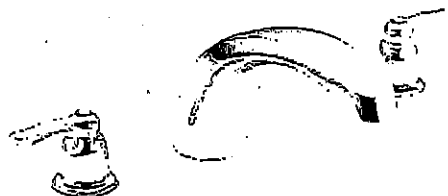

2 Handle Roman Tub with 9" Spout
Model 4796 / T990+

FREESTANDING TUB FAUCETS

D

C2-COUNTRY LANE
LOT 57-5
20-1957 ELEV A
THE BRAXTON

29 of 43

SC(B)500 | ALITO Collection

Cyclone®
Breathe Better

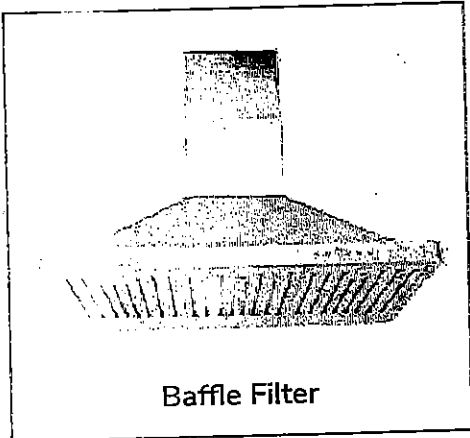

Wall Mount

Strong and sturdy with attractive lines and an imposing frame, the SC(B)500 is fitted with time-delay OFF feature up to nine minutes, 550 CFM fan, bright LED lights and a digital three-speed push button control panel.

Green Features



3 Speed Push Button
Control Panel



Dishwasher
Safe Filters



Long-Lasting
LED Light



Time-Delay
OFF Feature

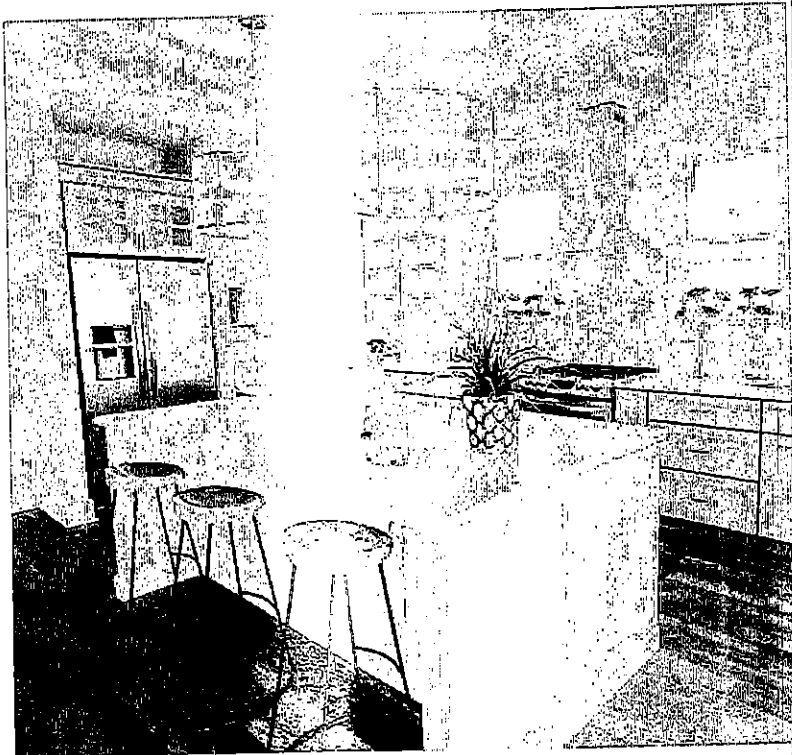

Model	Colour	Ducting	Filters	Size	CFM
SC50024	Stainless Steel	6"	Mesh	24"	550
SC50030	Stainless Steel	6"	Mesh	30"	550
SC50036	Stainless Steel	6"	Mesh	36"	550
SCB50024	Stainless Steel	6"	Baffle	24"	550
SCB50030	Stainless Steel	6"	Baffle	30"	550
SCB50036	Stainless Steel	6"	Baffle	36"	550

Cyclone Range Hoods Inc.

1361 Huntingwood Drive, Unit 16, Toronto, ON, M1S 3J1, Canada
Toll Free: 1-888-293-5662 Tel: (416) 293-0933 Fax: (416) 293-4793 Website: www.cyclonerangehoods.com

C2-COUNTRY LANE
 LOT 57-5
 20-1957 ELEV A
 THE BRAXTON

30 of 43

SC(B)500 | ALITO Collection

1215
Cyclone[®]
 Breathe Better

Features

- Wall mount range hood
- 6" round duct adapter
- Non-stick aluminum fan blades
- 3 speed push button control
- 2 LED lights (2 x 1.4W)
- Dishwasher-safe mesh or baffle filters
- Standard chimney fits up to 9 ft. ceiling
- Up to 9 minute time-delay OFF feature
- Plug-in connection

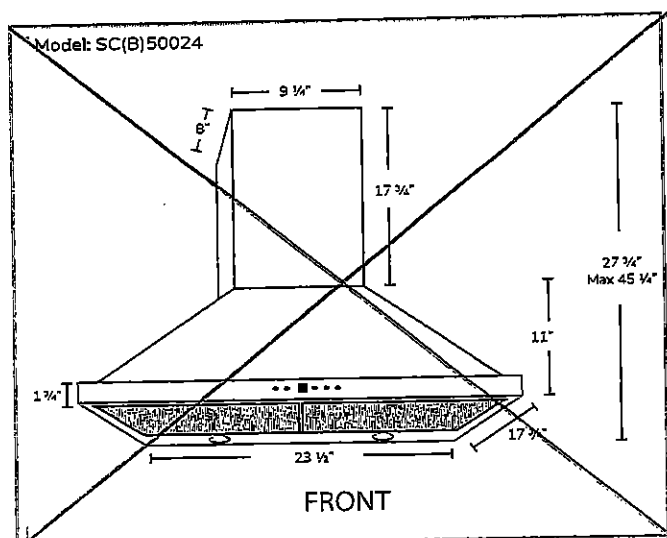
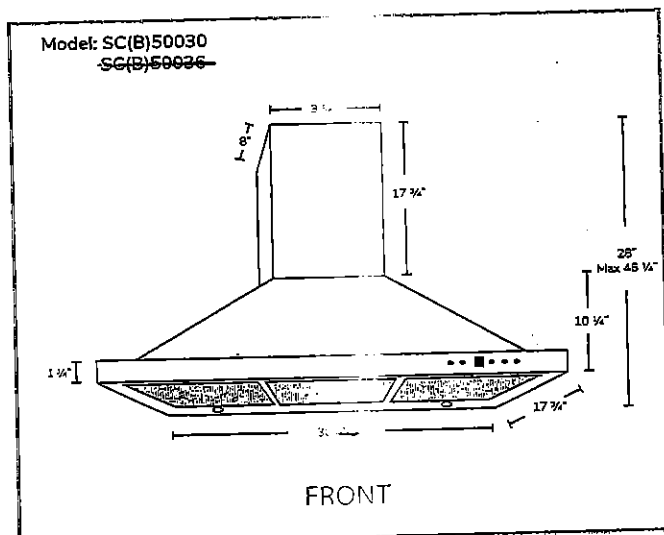

Options

- Filters: SC500 - Quick Release Aluminum Mesh Filters
 SCB500 - Quick Release Stainless Steel Baffle Filters
- Available Chimney Flues:
 Short (7 ft. - 8 ft. A1.CH10)
 Standard (8 ft. - 9 ft. A1.CH18)
 Extended (9 ft. - 11 ft. A1.CH30)
- Widths: 24", 30", 36"

Specifications

- Air Flow Volume: 550 CFM
- Electrical Connection: 120V/60Hz
- Power Consumption: 210 Watts
- Current: 2.5 Amps
- Fan Speed: 1600RPM
- Fan Type: Centrifugal Blower

- Finishes: Stainless Steel
- Ducting: 6" Round
- Dimensions: Width: 24", 30", 36"
 Height: 46"
 Depth: 18"

- Noise Level: Min. 2 Sones
 Max. 6 Sones



Toronto • Vancouver • Boston

www.CycloneRangeHoods.com

C2-COUNTRY LANE
LOT 57-5
20-1957 ELEV A
THE BRAXTON

31 of 43

Whirlpool® Bottom Mount Refrigerator

PRODUCT MODEL NUMBERS

WRF532SMB WRF535SWB
WRF535SMB WRF540CWB

Electrical: A 115-volt, 60-Hz, AC-only, 15- or 20-amp fused, grounded electrical supply is required. It is recommended that a separate circuit serving only your refrigerator be provided. Use an outlet that cannot be turned off by a switch. Do not use an extension cord.

NOTE: Before performing any type of installation, cleaning, or removing a light bulb, turn the control (Thermostat, Refrigerator or Freezer Control depending on the model) to OFF and then disconnect the refrigerator from the electrical source. When you are finished, reconnect the refrigerator to the electrical source and reset the control (Thermostat, Refrigerator or Freezer Control depending on the model) to the desired setting. See "Using the Controls."

Water: A cold water supply with water pressure between 30 and 120 psi (207 and 827 kPa) is required to operate the ice maker and water dispenser. If you have questions about your water pressure, call a licensed, qualified plumber.

IMPORTANT: The pressure of the water coming out of a reverse osmosis system going to the water inlet valve of the refrigerator needs to be between 35 and 120 psi (241 and 827 kPa).

Reverse Osmosis Water Supply: If a reverse osmosis water filtration system is connected to your cold water supply, the water pressure to the reverse osmosis system needs to be a minimum of 40 to 60 psi (276 to 414 kPa).

PRODUCT DIMENSIONS

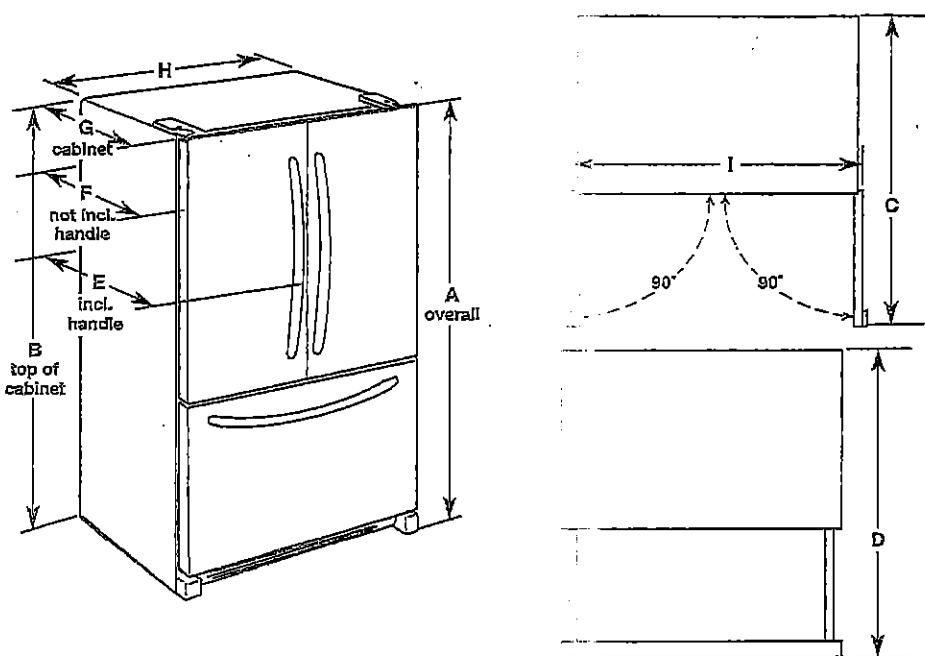

Model Number/Size	Height - Overall "A"	Height - Top of Cabinet "B"	Depth - Doors Open 90° "C"	Depth - Drawer Open "D"	Depth - With Handles "E"	Depth - Without Handles "F"	Depth - Cabinet Only "G"	Width - Cabinet "H"	Width - Door Open 90° "I"
WRF535SWB 25.2 cu. ft.	70 1/4" (178.1 cm)	68 1/4" (174.8 cm)	48 1/4" (122.1 cm)	53 1/4" (135 cm)	35 1/4" (90 cm)	32 1/4" (83.7 cm)	29 1/4" (74 cm)	35 1/4" (90.5 cm)	43 1/4" (110.2 cm)
WRF535SMB 25.2 cu. ft.	70 1/4" (178.1 cm)	68 1/4" (174.8 cm)	48 1/4" (122.1 cm)	53 1/4" (135 cm)	35 1/4" (90 cm)	32 1/4" (83.7 cm)	29 1/4" (74 cm)	35 1/4" (90.5 cm)	43 1/4" (110.2 cm)
WRF532SMB 22.1 cu. ft.	70 1/4" (178.1 cm)	68 1/4" (174.8 cm)	47 1/4" (119.5 cm)	52 1/4" (132.4 cm)	34 1/4" (87.5 cm)	31 1/4" (81.1 cm)	28 1/4" (71.4 cm)	32 1/4" (82.9 cm)	42 1/4" (107.6 cm)
WRF540CWB 20 cu. ft.	70 1/4" (178.1 cm)	68 1/4" (174.8 cm)	48" (121.9 cm)	44 1/2" (113.0 cm)	29 1/2" (74.6 cm)	28" (71.1 cm)	24 1/4" (61.3 cm)	35 1/4" (90.5 cm)	39 1/4" (100.0 cm)

LOCATION REQUIREMENTS

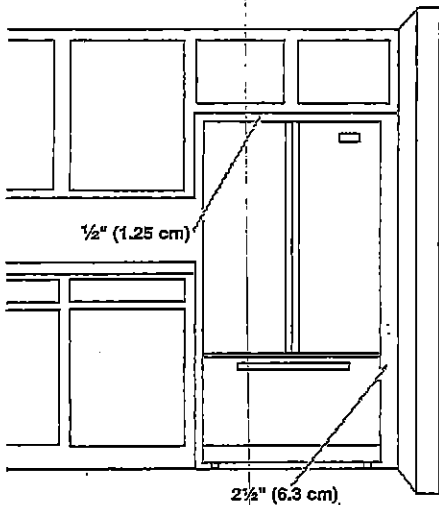

To ensure proper ventilation for your refrigerator, allow for a 1/2" (1.25 cm) space on each side and at the top. Allow for 1" (2.54 cm) of space behind the refrigerator. If your refrigerator has an ice maker, make sure you leave some extra space at the back for the water line connections.

If you are installing your refrigerator next to a fixed wall, leave 2 1/2" (6.3 cm) minimum on the hinge side (some models require more) to allow for the door to swing open.

NOTE: This refrigerator is intended for use in a location where the temperature ranges from a minimum of 55°F (13°C) to a maximum of 110°F (43°C). The preferred room temperature range for optimum performance, which reduces electricity usage and provides superior cooling, is between 60°F (15°C) and 90°F (32°C). It is recommended that you do not install the refrigerator near a heat source, such as an oven or radiator.

Because Whirlpool Corporation policy includes a continuous commitment to improve our products, we reserve the right to change materials and specifications without notice.

Dimensions are for planning purposes only. For complete details, see Installation Instructions packed with product. Specifications subject to change without notice.

Ref. W10597594B
10/1/14

C2-COUNTRY LANE
LOT 57-5
20-1957 ELEV A
THE BRAXTON

32 of 43

Whirlpool

FRONT CONTROL
GAS RANGES

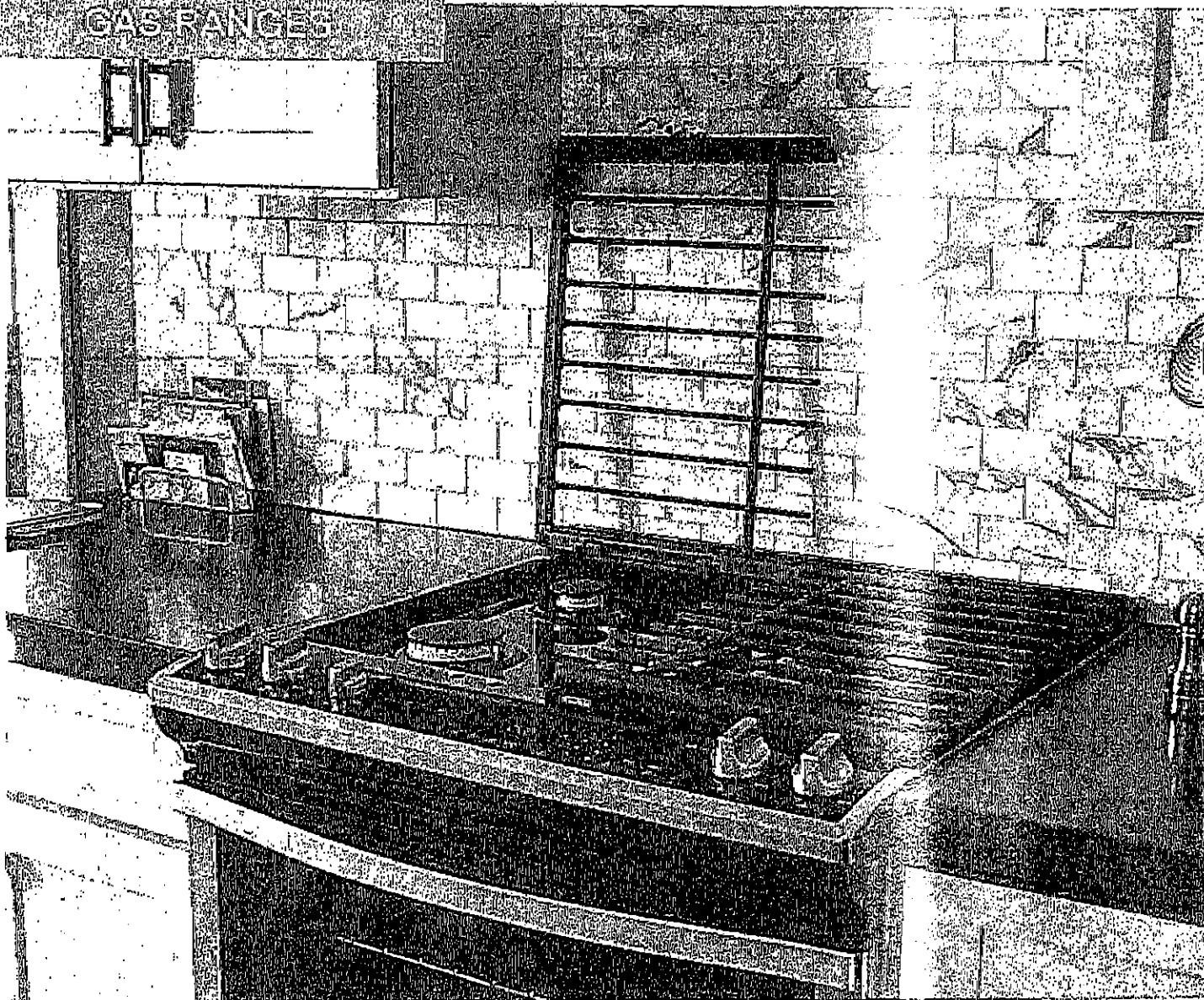

FEATURING



TimeSaver™ system

The TimeSaver™ system's Frozen Bake Technology allows you to skip preheating for favorites like pizza, lasagna, chicken nuggets, fries or pies so you can cook frozen foods faster.*



HeatRight™ system

The HeatRight™ system's True convection helps you to cook food faster** with a rear fan and third heating element to circulate hot air over, under, and around food.



CompleteClean™ system

The CompleteClean™ system's EZ-2-Lift™ hinged grates give you quick access to spills on the cooktop. The industry first hinged design allows you to wipe up under them without removing them entirely. For a more thorough clean, the grates are also dishwasher-safe.

Every day, care.™

From the #1 Selling Appliance brand in the USA†

C2-COUNTRY LANE
LOT 57-5
20-1957 ELEV A
THE BRAXTON

33 of 43

Front Control Gas Ranges

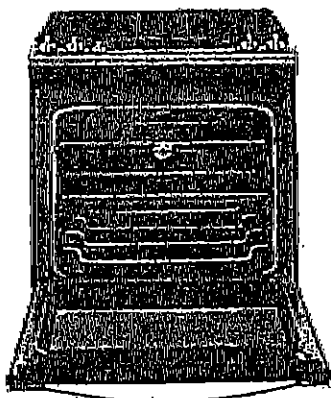
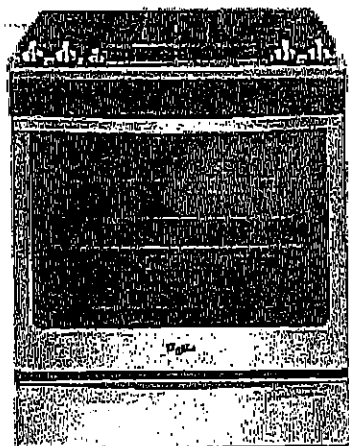

WEG745HOF

30" Freestanding Range - 5.8 cu. ft.



TimeSaver™ system
• Freeze Bake™ Technology



HeatRight™ system
• True Convection
• Convection Conversion
• Accu-Flame™ burner
• Center Oval burner
• Temperature Sensor



CompleteClean System
• EZ-LIFT™ Hinged Grates
• Accu-Clean™ Self-cleaning Technology
• Dishwasher-safe knobs



ReadySet™ system
• (2) SpeedHeat™ burners
• Rapid Preheat
• Keep Warm
• Done Cook

Available colors



S
Stainless
Steel



W
White



B
Black

PRODUCT DIMENSIONS

The control covers several models. Your model may appear different from the model shown. Dimensions given are maximum dimensions unless noted.

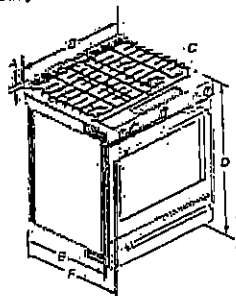

- A 12 1/4" (315 mm) height from countertop to top of front panel
- B 29 1/4" (743 mm) depth
- C 34 1/4" (875 mm) height from floor to top of front panel
- D 34 1/4" (875 mm) height from floor to top of front panel
- E 34 1/4" (875 mm) height from floor to top of front panel
- F 34 1/4" (875 mm) height from floor to top of front panel

IMPORTANT: Range must be level after installation. Follow the instructions in the "Level Range" section. Using the leveling legs to level the range is not recommended.

*Range can be leveled by adjusting the leveling legs.

Type of Gas

Natural gas

If this range is factory set for natural gas, see "Gas Conversion" section. The manufacturer's label is located behind the control panel. This label indicates the type of gas that can be used. If the label is not visible, do not install the range until a different gas without consulting the service gas technician. See "Gas Conversion" section.

LP gas conversion

Conversion must be done by a qualified service technician. No attempt should be made to convert the appliance from LP gas to natural gas. See "Gas Conversion" section.

CABINET OPENING DIMENSIONS

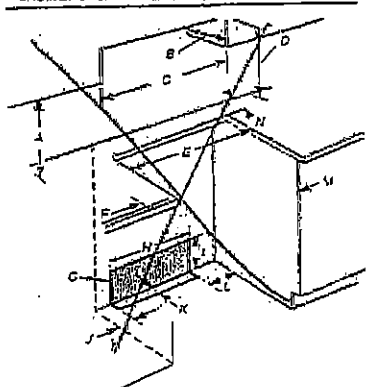

IMPORTANT: If installing a range into a cabinet, make sure that the range is properly supported. The range must be supported by the cabinet. The range may be installed in a cabinet with a depth of 30" or more. The range may be installed in a cabinet with a depth of 30" or more.

- A 30" (762 mm) width
- B 30" (762 mm) depth
- C 30" (762 mm) depth
- D 30" (762 mm) depth
- E 30" (762 mm) depth
- F 30" (762 mm) depth

NOTE: If the range is installed in a cabinet, the range must be supported by the cabinet. The range may be installed in a cabinet with a depth of 30" or more. The range may be installed in a cabinet with a depth of 30" or more.

ACCESSORIES & REPLACEMENT PARTS

- Part number 8273-00-00 Anti-Tip Kit for Range
- Part number 4373-00-00 Brick Baking Stone
- Part number 4395-00-00 Porcelain Broiler Pan & Grid
- Part number W10114000 Premium Broil Pan & Roasting Rack
- Part number 8000-00-00 Incandescent Light Bulb - 40 Watt



Compared to a traditional preheat and bake cycle for pizza, nuggets/fries, pies and lasagna. *Compared to the multi-bake cycle on the same model. †Based on 12-month average of unit sales. Refrigeration, Cooking, Dishwashers, and Laundry appliances. TruSonic™.

©2010 Whirlpool. All rights reserved. 576 Form No. W10100095

C2-COUNTRY LANE
LOT 57-5
20-1957 ELEV A
THE BRAXTON

34 OF 43

Whirlpool® 30" (76.2 cm) Slide-in Gas Range

PRODUCT MODEL NUMBERS

WEG790H0D

WEG760H0D

WEG745H0F

GAS SUPPLY REQUIREMENTS

Gas supply line:

- Provide a gas supply line of 3/4" (1.9 cm) rigid pipe to the range location. A smaller size pipe on longer runs may result in insufficient gas supply. With LP gas, piping or tubing size can be 1/2" (1.3 cm) minimum. Usually, LP gas suppliers determine the size and materials used in the system.

NOTE: Pipe-joint compounds that resist the action of LP gas must be used. Do not use TEFLON® tape.

Flexible metal appliance connector:

- If local codes permit, a new CSA design-certified, 4 to 5 ft (122 to 152.4 cm) long, 1/2" (1.3 cm) or 3/4" (1.9 cm) I.D., flexible metal appliance connector may be used for connecting range to the gas supply line.



- A 1/2" (1.3 cm) male pipe thread is needed for connection to the female pipe threads of the inlet to the appliance pressure regulator.

- Do not kink or damage the flexible metal tubing when moving the range.

Must include a shutoff valve:

The supply line must be equipped with a manual shutoff valve. This valve should be located in the same room but external to the range opening, such as an adjacent cabinet. It should be in a location that allows ease of opening and closing. Do not block access to shutoff valve. The valve is for turning on or shutting off gas to the range.

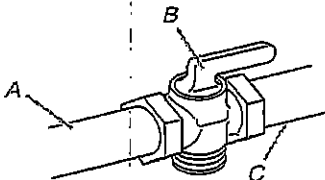

A. Gas supply line
B. Shutoff valve "open" position
C. To range

Gas Pressure Regulator

The gas pressure regulator supplied with this range must be used. The inlet pressure to the regulator should be as follows for proper operation:

Natural gas:

Minimum pressure: 5" WCP

Maximum pressure: 14" WCP

LP gas:

Minimum pressure: 11" WCP

Maximum pressure: 14" WCP

Contact local gas supplier if you are not sure about the inlet pressure.

PRODUCT DIMENSIONS

This manual covers several models. Your model may appear different from the models depicted. Dimensions given are maximum dimensions across all models.

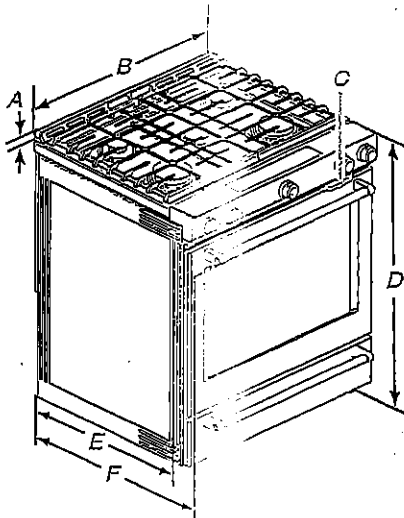

A. 1 7/8" (3.0 cm) height from cooktop to top of vent

B. 29 7/8" (75.9 cm)

C. Model/serial number plate (located behind the oven door on the top right-hand side of the oven frame)

D. 36" (91.4 cm) height to top of cooktop edge with leveling legs screwed all the way in*

E. 28 1/2" (71.9 cm) max. depth from front of console to back of range.

F. 28 3/4" (73.3 cm) max. depth from handle to back of range.

IMPORTANT: Range must be level after installation. Follow the instructions in the "Level Range" section. Using the cooktop as a reference for leveling the range is not recommended.

* Range can be raised approximately 1" (2.5 cm) by adjusting the leveling legs.

Type of Gas

Natural gas:

- This range is factory set for use with Natural gas. See "Gas Conversions" section. The model/serial rating plate located behind the control panel has information on the types of gas that can be used. If the types of gas listed do not include the type of gas available, check with the local gas supplier.

LP gas conversion:

Conversion must be done by a qualified service technician. No attempt shall be made to convert the appliance from the gas specified on the model/serial rating plate for use with a different gas without consulting the serving gas supplier. See "Gas Conversions" section.

®TEFLON is a registered trademark of Chemco.

C2-COUNTRY LANE
LOT 57-5
20-1957 ELEV A
THE BRAXTON



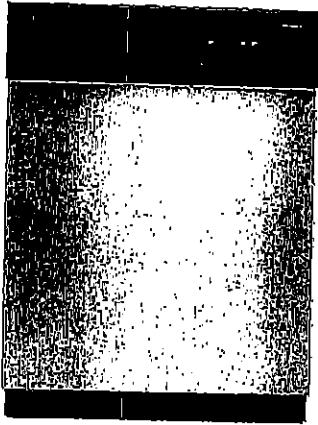

35 of 43

Whirlpool® Dishwasher with ENERGY STAR® qualification



WDF310PAAS
Black-on-Stainless

OTHER AVAILABLE COLORS

-  **Black**
Model: WDF310PAAB
-  **Biscuit-on-Biscuit**
Model: WDF310PAAT
-  **White**
Model: WDF310PAAW
-  **Universal Silver**
Model: WDF310PAAD



DIMENSIONS		KEY FEATURES
Maximum Height	34 1/2 Inches	ENERGY STAR® Qualified No One Has Fewer Repairs 17 Years In A Row Resource - Efficient Wash System CEE Tier 1 qualified Tall Tub Design White Plastic Interior Quiet Partner(TM) I Sound Package Auto Soil Sensor Electronic Controls 3 Automatic Cycles 1-Hour Wash Cycle Heavy Wash Cycle Normal Cycle 4 Options High Temperature Wash System Heated Dry Option 4 Hour Delay Wash Option 4-Tier SheerClean Direct Feed Wash System Control Lock Vinyl Racks In-Rack Silverware Basket
Minimum Height	33 1/2 Inches	
Height	34 1/2 Inches	
Depth	24 1/2 Inches	
Width	23 7/8 Inches	
Dimensions shown are for planning purposes only. For complete information, see installation instructions packaged with product.		
ELECTRICAL		
15 Amps Amps. 60 Hz. 120 V. 15,		
Before purchasing this appliance, read important information about its estimated annual energy consumption or energy efficiency rating that is available from your dealer.		

Whirlpool® Undercounter Dishwasher

PRODUCT MODEL NUMBERS

WDF110PAB	WDF310PLA	WDF530PSY
WDF111PAB	WDF320PAD	WDF540PAD
WDF120PAF	WDF510PAY	WDF730PAY
WDF121PAF	WDF520PAD	WDT710PAY
WDF310PAA	WDF530PAY	WDT720PAD
WDF310PCA	WDF530PLY	WDT770PAY

Electrical Requirements: 120-volt, 60-Hz, AC only, 15- or 20-amp. fused electrical supply. Copper wire only. A time delay fuse or circuit breaker and separate circuit is recommended.

If direct wiring dishwasher: Use flexible, armored, or nonmetallic, sheathed copper wire with grounding wire that meets the wiring requirements for your home and local codes and ordinances.

Use a UL listed or CSA approved conduit connector.

If connecting dishwasher with a power supply cord:

Use Power Supply Cord Kit (Part No. 4317824) marked for use with dishwashers. Follow the kit instructions for installing the power supply cord.

Power supply cord must plug into a grounded 3 prong, outlet, located in the cabinet next to the dishwasher opening. Outlet must meet all local codes and ordinances.

Water Supply Requirements: A hot water line with 20 to 120 psi (138 to 862 kPa) water pressure. Water temperature must be 120°F (49°C) water at dishwasher. Use 3/8" O.D. copper tubing with compression fitting or flexible braided water supply line (1/2" minimum plastic tubing is not recommended). Use a 90° elbow with 1/4" N.P.T. external pipe threads on one end. Do not solder within 6" (15.2 cm) from water inlet valve.

Drain Requirements: A new drain hose is supplied with your dishwasher. If this is not long enough, use a new drain hose with a maximum length of 12' (3.7 m) (Part No. 3385556) that meets all current AHAM/IAPMO test standards, is resistant to heat and detergent, and fits the 1" (2.5 cm) drain connector of the dishwasher.

Make sure to connect the drain hose to waste tee or disposer inlet above drain trap in house plumbing and 20" (50.8 cm) minimum above the floor. It is recommended

that the drain hose either be looped up and securely fastened to the underside of the counter or be connected to an air gap.

Make sure to use an air gap if the drain hose is connected to house plumbing lower than 20" (50.8 cm) above subfloor or floor.

Use 1/2" (1.3 cm) minimum I.D. drain line fittings.

If required, the air gap should be installed in accordance with the air gap installation instructions. When connecting the air gap, a rubber hose (not provided) will be needed to connect to the waste tee or disposer inlet.

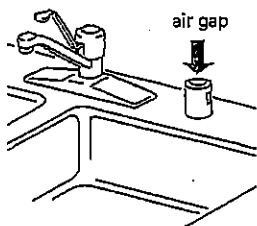

PRODUCT DIMENSIONS

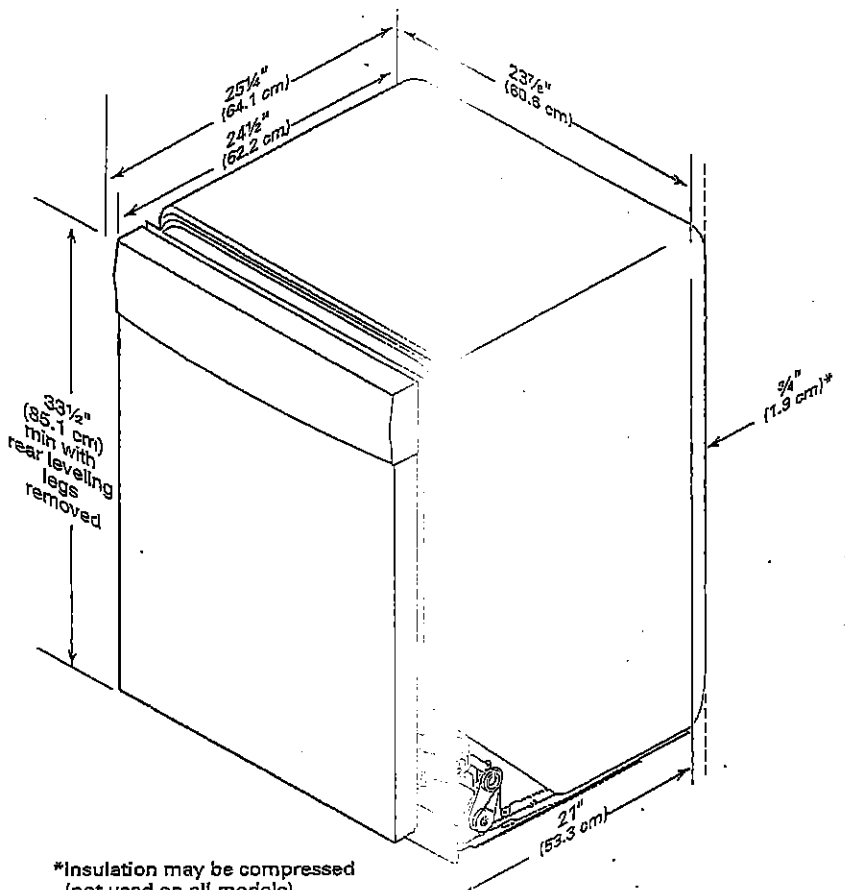

*Insulation may be compressed (not used on all models)

C2-COUNTRY LANE
LOT 57-5
20-1957 ELEV A
THE BRAXTON

37 of 43

CABINET CUTOUT DIMENSIONS

WDF320PAB

NOTE: Shaded areas of cabinet walls show where utility connections may be installed.

*Measure from the lowest point on the underside of the countertop. May be reduced to 33½" (85.1 cm) by removing the rear leveling legs from dishwasher.

**Minimum, measured from narrowest point of opening.

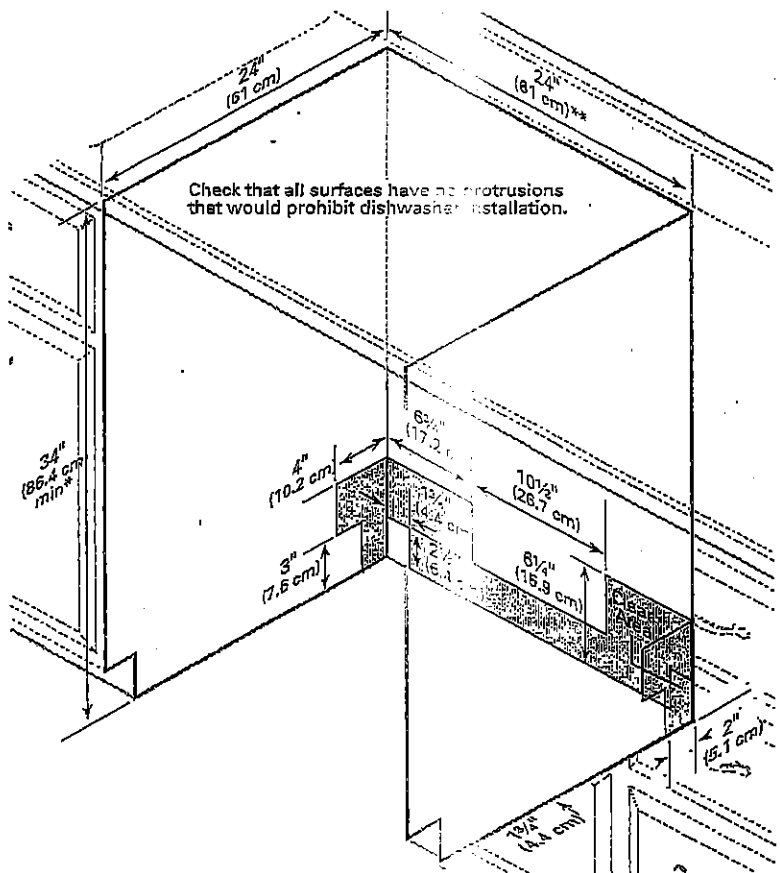

C2-COUNTRY LANE
LOT 57-5
20-1957 ELEV A
THE BRAXTON

38 OF 43

WHIRLPOOL WASHER Model #: WFW5620HW

STACKED PER PLAN

Whirlpool Brand Canada English | Washer and Dryer | Washers | Front Load Washers | WFW5620HW

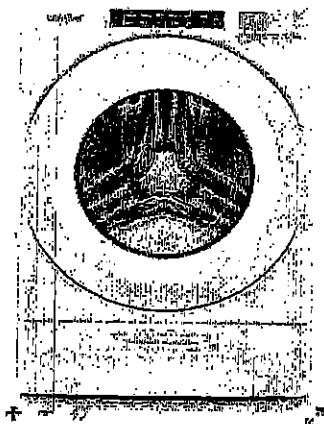

5.2 cu. ft. I.E.C. Closet-Depth
Front Load Washer with
Load & Go™ Dispenser



Whirlpool

5.2 cu. ft. I.E.C. Closet-Depth Front Load Washer with Load & Go™
Dispenser

Model #: WFW5620HW

Dimensions

Depth	80.17 cm, 31-9/16 in
Depth With Door Open 90 Degree	143.51 cm, 56-1/2 in
Minimum Height	99.11 cm, 39-5/8 in
Width	68.58 cm, 27.0 in

Appearance

LCD Touch Screen	No
Window	Yes

Details

Drum Material	Stainless Steel
---------------	-----------------

Cycles and Options

Number of Wash Cycles	37
-----------------------	----

Electrical

Hz	60
Power Cord Included	Yes

✓

C2-COUNTRY LANE
LOT 57-5
20-1957 ELEV A
THE BRAXTON

39 of 43

WHIRLPOOL WASHER Model #: WFW5620HW

LOCATION REQUIREMENTS

Proper installation is your responsibility.

You will need:

- A water heater set to 120°F (49°C).
- A grounded electrical outlet located within 6 ft (1.8 m) of power cord on back of washer.
- Hot and cold water faucets located within 4 ft (1.2 m) of hot and cold water fill valves on washer, and water pressure of 20-100 psi (137.9-689.6 kPa).
- A level floor with maximum slope of 1" (25 mm) under entire washer. Installing on carpet or surfaces with foam backing is not recommended.
- Floor must support washer's total weight (with water and load) of 315 lbs (143 kgs).

IMPORTANT: Do not install, store, or operate washer where it will be exposed to weather or in temperatures below 32°F (0°C). Water remaining in washer after use may cause damage in low temperatures. See "Washer Care" in your Use and Care Guide for winterizing information.

Whirlpool Models*

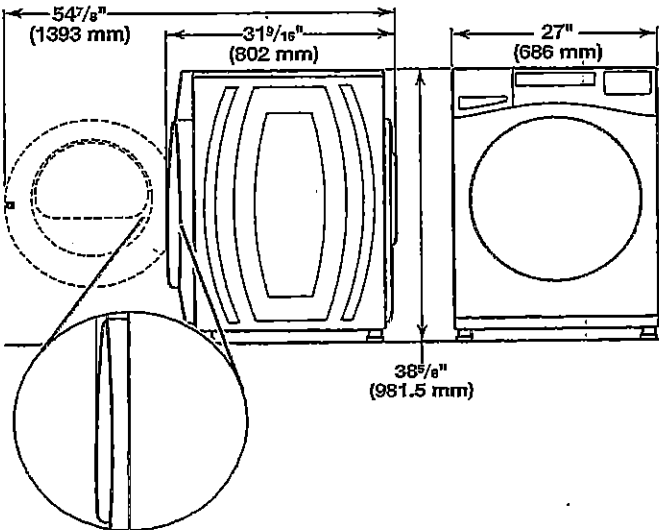
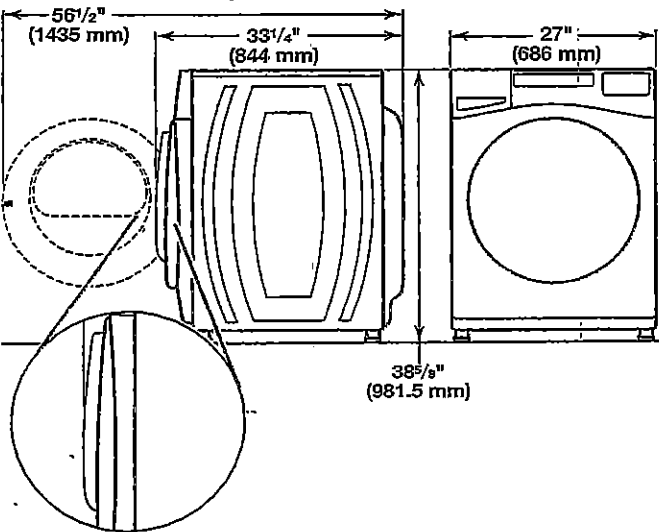

*For additional details (or information) specific to your model, refer to the 'Dimensions' listed for your model at www.whirlpool.com.

Maytag Models

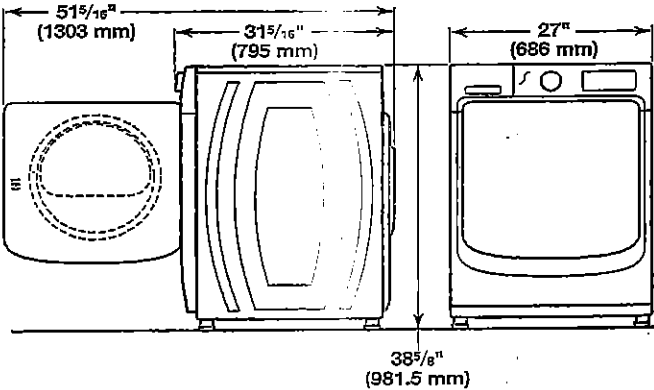
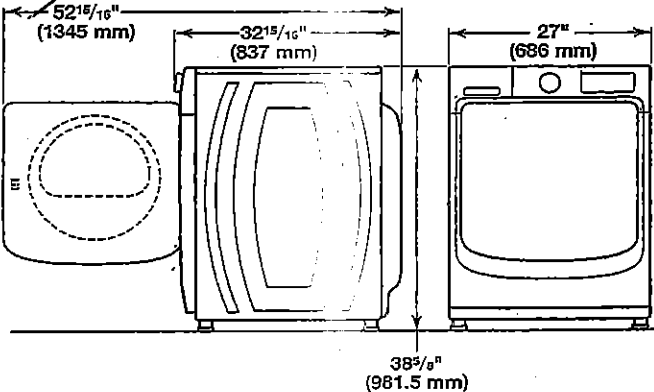

All dimensions show minimum spacing allowed. For each arrangement, consider allowing more space for ease of installation and servicing, and spacing for companion appliances and clearances for walls, doors, and floor moldings. Space must be large enough to allow door to fully open. Add spacing of 1" (25 mm) on all sides of washer to reduce noise transfer. If a closet door or louvered door is installed, top and bottom air openings in door are required.

Recessed area or closet installation (stacked washer and dryer):

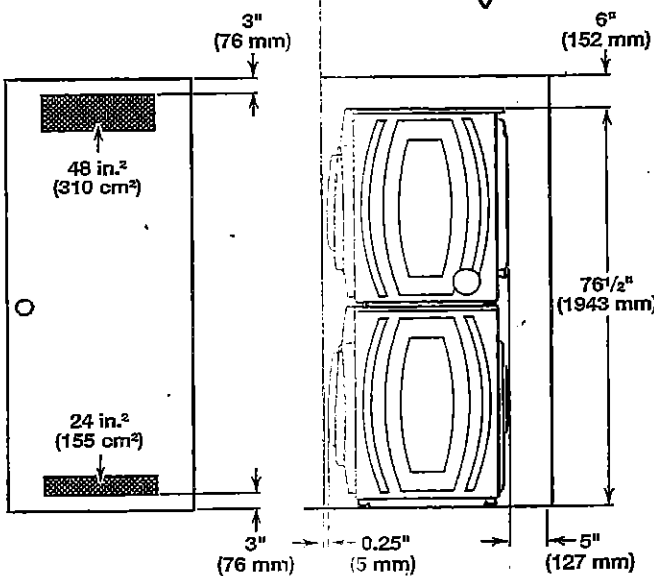

C2-COUNTRY LANE
LOT 57-5
20-1957 ELEV A
THE BRAXTON

40 of 43

WHIRLPOOL WASHER Model #: WFW5620HW

Custom under-counter installation:

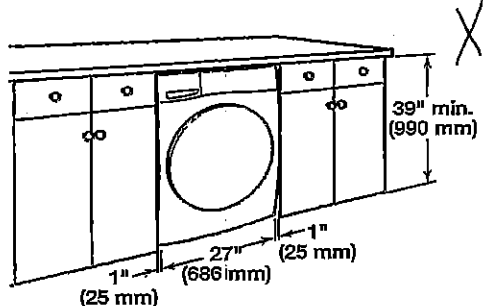

Recessed area or closet installation:

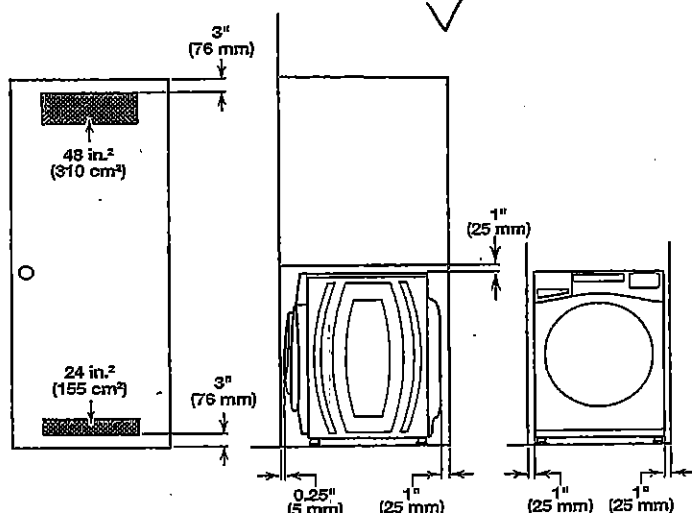

DRAIN SYSTEM

The drain system can be installed using a floor drain, wall standpipe, floor standpipe, or laundry tub. Select the method you need.

IMPORTANT: To avoid siphoning, only 4.5" (114 mm) of drain hose should be inside standpipe. Always secure drain hose with cable tie.

Floor standpipe drain system

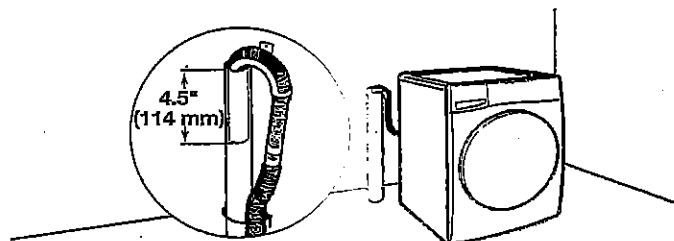

Minimum diameter for a standpipe drain: 2" (51 mm). Minimum carry-away capacity: 17 gal. (64 L) per minute. A 1/4" (6 mm) diameter to 1" (25 mm) diameter Standpipe Adapter Kit is available (Part Number 3363920). Top of standpipe must be at least 30" (762 mm) high; installing higher than 96" (2.44 m) from bottom of washer. If you have an overhead sewer and need to pump higher than 96" (2.44 m), a sump pump and associated hardware are needed. See "Alternate parts."

Wall standpipe drain system

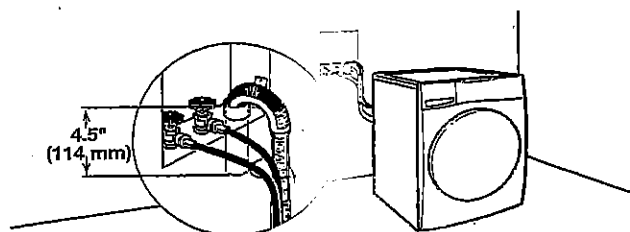

See requirements for floor standpipe drain system.

Laundry tub drain system

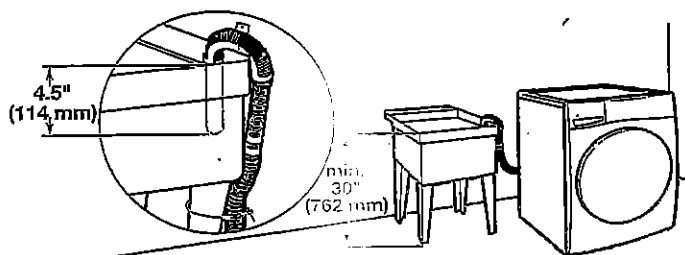

Minimum capacity: 20 gal. (76 L). Top of laundry tub must be at least 30" (762 mm) above floor; install no higher than 96" (2.44 m) from bottom of washer.

Custom cabinet installation:

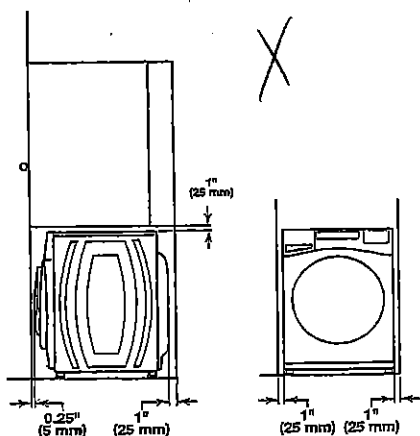

C2-COUNTRY LANE
LOT 57-5
20-1957 ELEV A
THE BRAXTON

41 of 43

WHIRLPOOL DRYER Model #: YWED5620HW

Whirlpool Brand Canada English | Washers and Dryers | Dryers | Electric Dryers | YWED5620HW

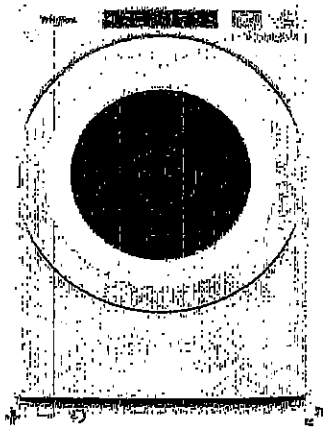

Define
Your Style
in White

7.4 cu. ft. Front Load Electric
Dryer with Intuitive Touch
Controls



Whirlpool 7.4 cu. ft. Front Load Electric Dryer with Intuitive Touch Controls
Model #: YWED5620HW

Dimensions

Depth	78.74 cm, 31.0 in
Depth With Door Open 90 Degree	138.43 cm, 54-1/2 in
Height	98.42 cm, 38-3/4 in
Width	68.58 cm, 27.0 in

Configuration and Overview

Fuel Type	Electric
-----------	----------

Cycles and Options

Cycle Time Remaining	Yes
Lint Filter Indicator	No
Number of Dryer Cycles	36
Number of Dryness Levels	3

Ventilation System

Long Vent	No
Maximum Vent Length	64
Venting Direction	Left, Right, Bottom, Rear

Electrical

Hz	60
Power Cord Included	Yes

✓

42 of 43

Back view:

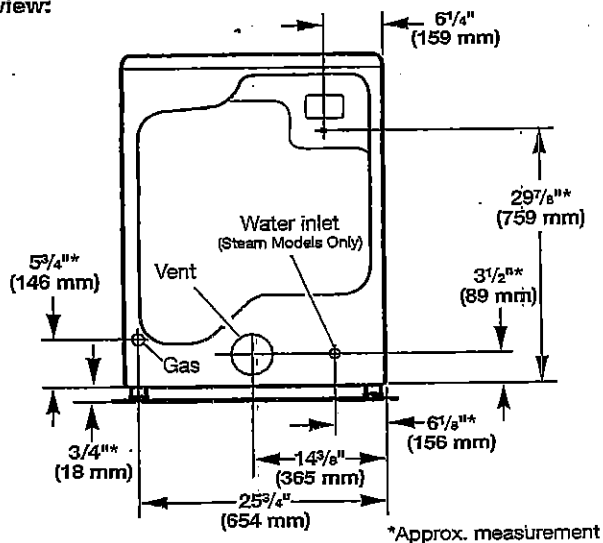

Installation Clearances

NOTE: No other fuel-burning appliance can be installed in the same closet as a dryer.

All dimensions show recommended and minimum spacing allowed.

- Additional spacing should be considered for ease of installation and servicing.
- Additional clearances might be required for wall, door, floor moldings, dryer venting, and gas line.
- Additional spacing should be considered on all sides of the dryer to reduce noise transfer.
- For closet installation with a door, minimum ventilation openings in the top and bottom of the door are required. Louvered doors with equivalent ventilation openings are acceptable.
- Companion appliance spacing should also be considered.

Diagram illustrating the required clearances for a front-loading washing machine installation:

- Top clearance: 18" min. (457 mm)
- Front clearance: 0-5" (0-127 mm)
- Bottom clearance: 1" (25 mm)
- Side clearance: 1" (25 mm)
- Top vent clearance: 3" (76 mm)
- Vent opening area: 48 in.² min. (310 cm²)
- Bottom vent clearance: 3" (76 mm)
- Bottom vent area: 24 in.² min. (155 cm²)

Custom under-counter installation:

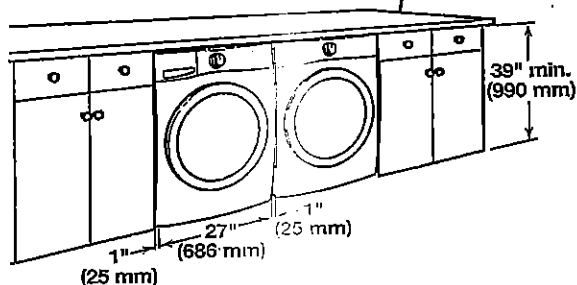

This dryer is suitable for mobile home installations. The installation must conform to the Manufactured Home Construction and Safety Standard, Title 24 CFR, Part 3280 (formerly the Federal Standard for Mobile home construction and Safety, Title 24, HUD Part 280) or Standard CAN/CSA-Z240 MH.

- Metal exhaust system hardware, available for purchase from your dealer. For further information, see "Assistance or Service" in your Use and Care Guide.
- Special provisions must be made in mobile homes to introduce outside air into dryer. Openings (such as a nearby window) should be at least twice as large as dryer exhaust opening.

For mobile home installation of gas dryers:

- Mobile Home Installation Hold-down Kit Part Number 346764 is available to order. For further information, see "Assistance or Service" in your Use and Care Guide.

C2-COUNTRY LANE
LOT 57-5
20-1957 ELEV A
THE BRAXTON

43 of 43

WHIRLPOOL DRYER Model #: YWED5620HW

Additional parts may be required, depending on your installation. Check local codes. Check existing electrical supply and venting. Read "Electrical Requirements" and "Venting Requirements" before purchasing parts.

If using a power supply cord:

Use a UL Listed power supply cord kit marked for use with clothes dryers. The kit should contain:

- A UL Listed 30 amp power supply cord, rated 120/240 volt minimum. The cord should be type SRD or SRDT and be at least 4 ft. (1.22 m) long. The wires that connect to the dryer must end in ring terminals or spade terminals with upturned ends.
- A UL Listed strain relief.

Optional Equipment (not supplied with dryer):

Refer to your Use and Care Guide for information about accessories available for your dryer.

LOCATION REQUIREMENTS

Check code requirements. Some codes limit, or do not permit, installing dryer in garages, closets, mobile homes, or sleeping quarters. Contact your local building inspector.

⚠ WARNING



Explosion Hazard

Keep flammable materials and vapors, such as gasoline, away from dryer.

Place dryer at least 18 inches (460 mm) above the floor for a garage installation.

Failure to do so can result in death, explosion, or fire.

You will need:

- A location allowing for proper exhaust installation. See "Venting Requirements."
- A separate 15 or 20 amp circuit for a gas dryer or 30 amp circuit for an electric dryer.
- If using power supply cord, a grounded electrical outlet located within 2 ft. (610 mm) of either side of dryer. See "Electrical Requirements."
- Floor must support dryer weight of 200 lbs. (90.7 kg). Also consider weight of companion appliance.
- Cold water faucets located within 4 ft. (1.2 m) of the water fill valves, and water pressure of 20–120 psi (138–827 kPa). You may use your washer's water supply by purchasing the necessary parts noted in "Parts needed."
- Level floor with maximum slope of 1" (25 mm) under entire dryer. If slope is greater than 1" (25 mm), install Extended Dryer Feet Kit, Part Number 279810. If not level, clothes may not tumble properly and automatic sensor cycles may not operate correctly.
- For garage installation, place dryer at least 18" (460 mm) above floor. If using a pedestal, you will need 18" (460 mm) to bottom of dryer.
- The dryer must not be installed or stored in an area where it will be exposed to water and/or weather.

IMPORTANT: Do not operate, install, or store dryer where it will be exposed to water, weather, or at temperatures below 40°F (4°C). Lower temperatures may cause dryer not to shut off at end of automatic sensor cycles, resulting in longer drying times.

DRYER DIMENSIONS

Front view:

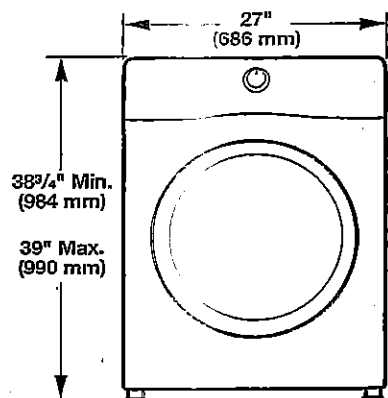

Side view:

Whirlpool Models

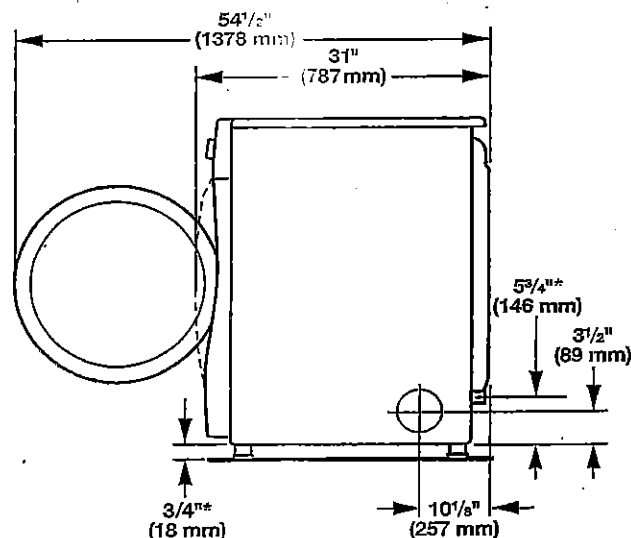

*Approx. measurement

Maytag Models

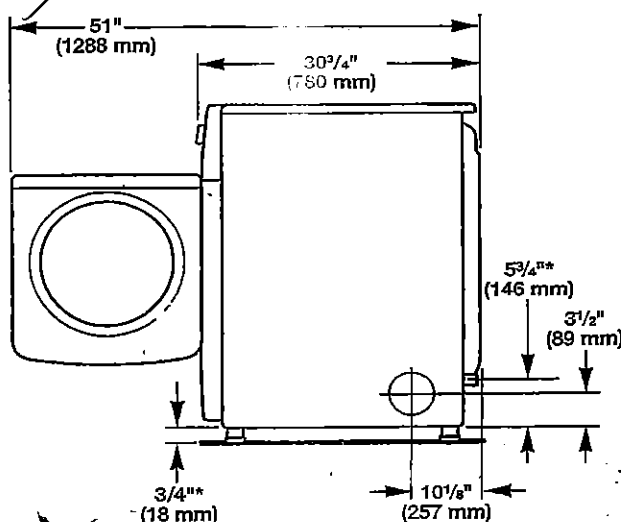

*Approx. measurement