

Sales Selection Sheet  
Checklist

1 of 31

LOT 3189B-11 Model: 20-1606 A The Grassfield

PURCHASERS: KIRAN, NAEEM ARAIN/

VENDOR: Heathwood Homes (Huron) Limited

- ☒ FINISHED BASEMENT  
☐ COLD CELLAR

UPGRADED / MODIFIED ELEVATION

- ☐ CORNER UPGRADE  
☐ REAR UPGRADE

CEILING UPGRADE - SMOOTH

- ☐ MAIN FLOOR  
☐ SECOND FLOOR  
☐ BASEMENT

ADDITIONAL ROUGH-INS

- ☐ 200 AMP SERVICE  
☐ WET BAR ROUGH-IN  
☐ HUMIDIFIER  
☒ AIR CONDITIONING

GAS ROUGH-IN

- ☐ STOVE  
☐ DRYER  
☐ BBQ  
☐ ADDITIONAL FIREPLACE

KITCHEN: HOODFAN VENTING SIZE

- ☒ 6 IN ROUND DUCT  
☐ 7 IN ROUND DUCT

FULL BASEMENT STAIRS:

N/A

UPPER BASEMENT STAIRS:

All Oak

LOWER BASEMENT STAIRS:

Carpet Grade

MAIN STAIRS:

All Oak

MEDIA STAIRS (if applicable):

N/A

LOFT STAIRS (if applicable):

N/A

JAN 27/22

Date

Purchaser:

Signature on file

JAN 27/22

Date

Decor Consultant:

TINA LEFUR

Date

Purchaser:

APPROVED

-01- 27 2022

Date

Heathwood Homes (Huron) Limited

Signature

Approved

Locked Date:

KIRAN, NAEEM ARAIN/  
Project: Wallacetown  
Unit: 3189B-11, Phase: 3  
Model: 20-1606 A The Grassfield

Created: 10/29/2021 13:46:02  
Locked:  
Closed:

2 of 31

Kitchen

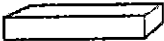
Cabinet Colour/Style	9156	Viking III-SIMCOE-RAIN CLOUD-3DL ***STD***
Countertop	9069	MSI Quartz GROUP 1 ICED WHITE ***STD***
Countertop Edge	4010	SINGLE POLISHED STRAIGHT EDGE 3/4 INCH ***STD*** 
Cabinet Hardware	7667	12881-HARDWARE ***STD***
Island Cabinet Colour/Style	9156	Viking III-SIMCOE-RAIN CLOUD-3DL ***STD***
Island Countertop	9069	MSI Quartz GROUP 1 ICED WHITE ***STD***
Backsplash	1111	N/A *****
Backsplash Grout	1111	N/A *****
Backsplash Tile Pattern	1111	N/A *****
HoodFan	9904	YWMH31017HZ-Whirlpool Over-The-Range Microwave Hood Combination-SS-30 inch SPECS PAGES 29-31
Appliance	9904	Purchasers have been advised: standard fridge opening is a minimum 37 3/8 x 73 3/8". Ice Waterline Rough-In is included.
Appliance	9904	Standard stove opening is 30" and standard dishwasher opening is 24". Any gas stove will require backsplash or stainless steel backing to avoid fire hazards.
Appliance	9904	Purchasers acknowledge: Heathwood Homes and its contractors will not be responsible for any kitchen cabinet changes due to appliances dimension changes after
Comment		

Kitchen/Breakfast

Flooring	9904	GE.MD.WHT.1818.MT Madison Series White Matte 18
Floor Tile Grout	2225	Grout-(27) Silver ***STD***
Floor Tile Pattern	3000	STANDARD SQUARE ***STD*** 

KIRAN, NAEEM ARAIN/  
Project: Wallaceton  
Unit: 3189B-11, Phase: 3  
Model: 20-1606 A The Grassfield

Created: 10/29/2021 13:46:02  
Locked:  
Closed:

3 of 31



Comment

Foyer

Flooring3000GE.MD.WHT.1818.MT Madison Series White Matte 18

Floor Tile Grout2225Grout-(27) Silver \*\*\*STD\*\*\*

Floor Tile Pattern3000STANDARD SQUARE \*\*\*STD\*\*\*

Comment

Laundry Room

Flooring3000GE.BY.AZR.1313 New Byzantine Azzuro 13

Floor Tile Grout2225Grout-(27) Silver \*\*\*STD\*\*\*

Floor Tile Pattern3000STANDARD SQUARE \*\*\*STD\*\*\*

Comment

Mud Room

Flooring3000GE.MD.WHT.1818.MT Madison Series White Matte 18

Floor Tile Grout2225Grout-(27) Silver \*\*\*STD\*\*\*

Floor Tile Pattern3000STANDARD SQUARE \*\*\*STD\*\*\*

Comment

KIRAN, NAEEM ARAIN/  
Project: Wallaceton  
Unit: 3189B-11, Phase: 3  
Model: 20-1606 A The Grassfield

Created: 10/29/2021 13:46:02  
Locked:  
Closed:

4 of 31

Powder Room

Flooring	3000	GE.MD.WHT.1818.MT Madison Series White Matte 18									
Floor Tile Grout	2225	Grout-(27) Silver ***STD***									
Floor Tile Pattern	3000	STANDARD SQUARE ***STD*** <table><tr><td></td><td></td><td></td></tr><tr><td></td><td></td><td></td></tr><tr><td></td><td></td><td></td></tr></table>									
Plumbing Fixture (Colour)	1737	Plumbing Fixtures-WHITE ***STD***									

Comment

Hall

Flooring	1737	GE.MD.WHT.1818.MT Madison Series White Matte 18									
Grout	2225	Grout-(27) Silver ***STD***									
Floor Tile Pattern	3000	STANDARD SQUARE ***STD*** <table><tr><td></td><td></td><td></td></tr><tr><td></td><td></td><td></td></tr><tr><td></td><td></td><td></td></tr></table>									

Comment

Great Room

Flooring	7502	Red Oak Pearl-Vintage Engineered-ECLIPSE-3/4 inch x 3 1/4 inch ***STD***
----------	------	--------------------------------------------------------------------------

Comment

Upper Hall

Flooring	9248	DY 89418 -Dynasty Tex-BLACK ICE-40 oz Poly***CUSTOM ***
----------	------	---------------------------------------------------------

Comment

KIRAN, NAEEM ARAIN/  
Project: Wallaceton  
Unit: 3189B-11, Phase: 3  
Model: 20-1606 A The Grassfield

Created: 10/29/2021 13:46:02  
Locked:  
Closed:

5 of 31

Finished Basement (Rec) Room/Hall

Flooring	9248	DY 89418 -Dynasty Tex-BLACK ICE-40 oz Poly***STD***
Comment		

Master Bedroom

Flooring	9248	DY 89418 -Dynasty Tex-BLACK ICE-40 oz Poly***STD ***
Comment		

Bedroom 2

Flooring	9248	DY 89418 -Dynasty Tex-BLACK ICE-40 oz Poly***STD ***
Comment		

Bedroom 3

Flooring	9248	DY 89418 -Dynasty Tex-BLACK ICE-40 oz Poly***STD ***
Comment		

Master Ensuite

Cabinet Colour/Style	9157	Viking III-SIMCOE-MOONLIGHT-3DL ***STD***
Countertop	8796	6698-46-Countertop-PALOMA POLAR ETCHINGS FINISH-Formica ***STD***
Countertop Edge	1111	N/A *****
Cabinet Hardware	2093	9671-HARDWARE ***STD***
Floor Tile	2093	GE.BY.AZR.1313 New Byzantine Azzuro 13
Floor Tile Grout	2225	Grout-(27) Silver ***STD***

Created: 10/29/2021 13:46:02

**Locked:**

**Closed:**

6 of 31

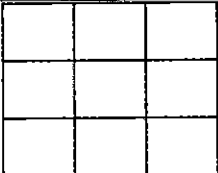
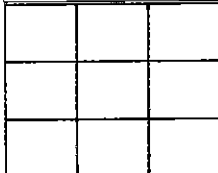
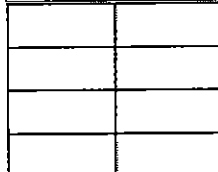
Floor Tile Pattern	3000	STANDARD SQUARE ***STD*** 
Shower Floor Tile	8661	OD.ON.SWT.0202.MT.N-Ontario Series Mosaic-Snow White Matte-2 x 2 ***STD***
Shower Floor Tile Grout	2226	Grout-(00) White ***STD***
Shower Floor Tile Pattern	3000	STANDARD SQUARE ***STD*** 
Shower Wall Tile	9020	QT.WV.WHT.0810-Weave-White-8 x 10 ***STD***
Shower Wall Tile Grout	2226	Grout-(00) White ***STD***
Shower Wall Tile Pattern	3070	HORIZONTAL STACKED ***STD*** 
Shower Jamb(s) and Sill(s)	8923	Shower Jamb / Sill-Thassos White ***STD***
Plumbing Fixture (colour)	1737	Plumbing Fixtures-WHITE ***STD***
Comment		

## Main Bathroom

Cabinet Colour/Style	9111	VIKING III SIMCOE ORCHID 3DL ***STD***
Countertop	8796	6698-46-Countertop-PALOMA POLAR ETCHINGS FINISH-Formica ***STD***
Countertop Edge	1111	N/A *****
Cabinet Hardware	2093	9671-HARDWARE ***STD***
Flooring	9071	GE.BY.AZR.1313 New Byzantine Azzuro 13
Floor Tile Grout	2225	Grout-(27) Silver ***STD***
Floor Tile Pattern	3000	STANDARD SQUARE ***STD***

KIRAN, NAEEM ARAIN/  
Project: Wallaceton  
Unit: 3189B-11, Phase: 3  
Model: 20-1606 A The Grassfield

Created: 10/29/2021 13:46:02  
Locked:  
Closed:

7 of 31

			<table><tr><td></td><td></td><td></td></tr><tr><td></td><td></td><td></td></tr></table>								
Wall Tile	5411	QT.SP.WHT.0810-Splendour-White-8 inch x 10 inch ***STD***									
Wall Tile Grout	2226	Grout-(00) White ***STD***									
Main Bathroom Tile Pattern	3070	HORIZONTAL STACKED ***STD*** <table><tr><td></td><td></td></tr><tr><td></td><td></td></tr><tr><td></td><td></td></tr><tr><td></td><td></td></tr></table>									
Plumbing Fixture (Colour)	1737	Plumbing Fixtures-WHITE ***STD***									
Comment											

Finished Basement Bathroom

Cabinet Colour/Style	9156	Viking III-SIMCOE-RAIN CLOUD-3DL ***STD***									
Countertop	8796	6698-46-Countertop-PALOMA POLAR ETCHINGS FINISH-Formica ***STD***									
Countertop Edge	1111	N/A *****									
Cabinet Hardware	2093	9671-HARDWARE ***STD***									
Flooring	9071	GE.BY.AZR.1313 New Byzantine Azzuro 13									
Floor Tile Grout	2225	Grout-(27) Silver ***STD***									
Floor Tile Pattern	3000	STANDARD SQUARE ***STD*** <table><tr><td></td><td></td><td></td></tr><tr><td></td><td></td><td></td></tr><tr><td></td><td></td><td></td></tr></table>									
Shower Floor Tile	8661	OD.ON.SWT.0202.MT.N-Ontario Series Mosaic-Snow White Matte-2 x 2 ***STD***									
Shower Floor Tile Grout	2226	Grout-(00) White ***STD***									
Shower Floor Tile Pattern	3000	STANDARD SQUARE ***STD*** <table><tr><td></td><td></td><td></td></tr><tr><td></td><td></td><td></td></tr><tr><td></td><td></td><td></td></tr></table>									
Shower Wall Tile	9020	QT.WV.WHT.0810-Weave-White-8 x 10 ***STD***									

KIRAN, NAEEM ARAIN/  
Project: Wallaceton  
Unit: 3189B-11, Phase: 3  
Model: 20-1606 A The Grassfield

Created: 10/29/2021 13:46:02  
Locked:  
Closed:

8 of 31

Shower Wall Tile Grout	2226	Grout-(00) White ***STD***								
Shower Wall Tile Pattern	3070	HORIZONTAL STACKED ***STD*** <table><tr><td></td><td></td></tr><tr><td></td><td></td></tr><tr><td></td><td></td></tr><tr><td></td><td></td></tr></table>								
Shower Jamb(s)	8923	Shower Jamb / Sill-Thassos White ***STD***								
Plumbing Fixture (Colour)	1737	Plumbing Fixtures-WHITE ***STD***								
Comment										

Great Room Fireplace

Type	8865	Dimplex-Electric Fireplace-PF3033HL ***STD***
Mantle	8891	NF-17-Paint Grade Mantle- Cabinet (Per Plan)-WHITE ***STD*** PAGE 18
Surround Opt.	1111	N/A *****
Disclaimer		
Disclaimer	0	Heathwood and its contractors will not be liable for any damage on items placed/installed above a FP after closing.
Comment		

Basement Stairs

Type	1714	Carpet Grade Stairs ***STD BASEMENT STAIRS***
Colour	7922	Eclipse (Pewter) STAIN TO COMPLIMENT HARDWOOD AND WILL VARY FROM FLOORING ***99***
Carpet Runner	1111	N/A *****
Handrail/Pickets/Post Type	7652	1 5/16 inch Square pickets with 3 1/2" Square/Cap Post(s)-ALL OAK ***STD***
Handrail/Pickets/Post Colours	1729	Carpet Grade-Stain handrail, pickets, stringers, nosing _pos
Carpet	9248	DY 89418 -Dynasty Tex-BLACK ICE-40 oz Poly***STD***
Custom Stain/Paint	1111	N/A *****
Comment		

KIRAN, NAEEM ARAIN/  
Project: Wallaceton  
Unit: 3189B-11, Phase: 3  
Model: 20-1606 A The Grassfield

Created: 10/29/2021 13:46:02  
Locked:  
Closed:

9 of 31

Comment

Basement Stairs Landings (Upper and Lower)

Flooring7502

Red Oak Pearl-Vintage Engineered-ECLIPSE-3/4 inch x 3 1/4 inch \*\*\*3\*\*\*

Comment

Main Stairs

Type1712

Oak Stairs \*\*\*STD MAIN STAIRS\*\*\*

Colour7922

Eclipse (Pewter) STAIN TO COMPLIMENT HARDWOOD AND WILL VARY FROM FLOORING \*\*\*99\*\*\*

Carpet Runner1111

N/A \*\*\*\*\*

Handrail/Pickets/Posts Type7652

1 5/16 inch Square pickets with 3 1/2" Square/Cap Post(s)-ALL OAK \*\*\*STD\*\*\*

Handrail/Pickets/Posts Colour1728

Oak Grade-Stain handrail,oak pickets,stringers,treads,risers

Custom Stain/Paint1111

N/A \*\*\*\*\*

Comment

Main Stairs Landing(s)

Flooring7502

Red Oak Pearl-Vintage Engineered-ECLIPSE-3/4 inch x 3 1/4 inch \*\*\*STD\*\*\*

Comment

Throughout

Walls - Paint Colour1717

22-Wall-WARM GREY \*\*\*STD\*\*\*

Underpad1079

500 Series-Underpad \*\*\*STD\*\*\*

Thresholds2232

Metal Thresholds \*\*\*STD\*\*\*

Switches and Plug5796

Decora White Switches and Plugs \*\*\*STD\*\*\*

Trim Size8705

4 1/4 Baseboard and 2 3/4 Casings \*\*\*STD\*\*\*

Trim - Paint Colour1716

Trim - WHITE \*\*\*STD\*\*\*

KIRAN, NAEEM ARAIN/  
Project: Wallaceton  
Unit: 3189B-11, Phase: 3  
Model: 20-1606 A The Grassfield

Created: 10/29/2021 13:46:02  
Locked:  
Closed:

10 of 31

Trim - Paint Colour	1716	Trim-White	STD
---------------------	------	------------	-----

Comment

Purchaser:

M. Naeem  
KIRAN, NAEEM ARAIN

NOV 01, 2021  
Date

*[Signature]*  
Decor Consultant

11/01/21  
Date

Purchaser:

Date

*[Signature]*  
Wallaceton

APPROVED  
-01- 27 2022  
Date Approved





CONSTRUCTION SUMMARY

11 of 31

Lot: 3189B-11  
Model: 20-1606 A The Grassfield  
Project/Phase: Wallaceton / 3

Offer	SCHEDULE X: ITEM #5 ADJUSTMENTS (e) AND (f) COMBINED TO BE CAPPED AT \$5,000
Worksheet	Note:

Offer	Five Thousand Dollars (\$5,000) at D?cor. (No Cash Value) Townhomes
Worksheet	Note:

Offer	The Purchaser(s) acknowledge that they have NOT been referred by an existing Heathwood Homeowner and therefor are not entitled to a referral fee under Heathwood Homes Referral program.
Worksheet	Note:



CONSTRUCTION SUMMARY

12 of 31

Lot: 3189B-11  
Model: 20-1606 A The Grassfield  
Project/Phase: Wallaceton / 3

ADMIN FEE

Invoice	Qty.	Description
891 27Jan22 NoCat	1	- FIVE THOUSAND AT DECOR(\$5,000.00) NO CASH VALUE

APPLIANCES

Invoice	Qty.	Description
891 313,492 27Jan22	1	- APPLIANCES - WHIRLPOOL OTR SS - YWMH31017HZ  CABINETRY - notification; ELECTRICAL - delete std range hood; HEATING/AIR CONDITIONING - Duct Size to 6"

CABINETRY

Invoice	Qty.	Description
891 313,492 27Jan22 **	1	- APPLIANCES - WHIRLPOOL OTR SS - YWMH31017HZ  CABINETRY - notification; ELECTRICAL - delete std range hood; HEATING/AIR CONDITIONING - Duct Size to 6"
891 313,624 27Jan22	1	KITCHEN - 04H-66cm deep fridge enclosure (counter depth) with (1) wall ([1] 66cm deep gable and [1] 66cm deep cabinet) (This is not a zero clearance enclosure. Standard heights and widths will be used.) Viking SKETCH # 3
891 313,768 27Jan22	1	KITCHEN - 11A-Upper angle corner per unit Viking SKETCH # 3

CERAMICS

Invoice	Qty.	Description
891 308,181 27Jan22	1	- CERAMICS - FLOOR - KITCHEN - UPGRADE 1
891 308,165 27Jan22	1	- CERAMICS - FLOOR - FOYER - UPGRADE 1
891 308,209 27Jan22	1	- CERAMICS - FLOOR - MUD ROOM - UPGRADE 1
891 308,216 27Jan22	1	- CERAMICS - FLOOR - POWDER ROOM - UPGRADE 1
891 308,202 27Jan22	1	- CERAMICS - FLOOR - MAIN HALL - UPGRADE 1

ELECTRICAL

Invoice	Qty.	Description
891 313,492 27Jan22 **	1	- APPLIANCES - WHIRLPOOL OTR SS - YWMH31017HZ  CABINETRY - notification; ELECTRICAL - delete std range hood; HEATING/AIR CONDITIONING - Duct Size to 6"
891 314,224 27Jan22	2	- ELECTRICAL - CEILING ROUGH-IN (CAPPED)  1) TO BE CENTERED +/- ON GREAT ROOM CEILING ON EXISTING SWITCH 2) TO BE CENTERED ON ISLAND +/- ON EXISTING SWITCH SKETCH # 2
891 314,232 27Jan22	1	GREAT ROOM - ELECTRICAL - EXTRA WALL INTERIOR OUTLET ON EXISTING CIRCUIT (DOES NOT INCLUDE KITCHEN OUTLETS) TOBE INSTALLED CENTERED ABOVE FIREPLACE 70" +/- FROM FLOOR  SKETCH # 2

HEATING / AIR CONDITIONING

Invoice	Qty.	Description
891 313,492 27Jan22 **	1	- APPLIANCES - WHIRLPOOL OTR SS - YWMH31017HZ  CABINETRY - notification; ELECTRICAL - delete std range hood; HEATING/AIR CONDITIONING - Duct Size to 6"

UK 3 WALLACETON  
LOT 3189B-11  
20-16-6 ELEV A  
THE GRASSFIELD

14 of 31

THE GRASSFIELD

Sketch #1

ELEVATION B | 1,986 SQ. FT.  
Includes 380 sq. ft. of Finished Lower Level

20-1606 ELEV. B

WALLACETON  
EST. 1870

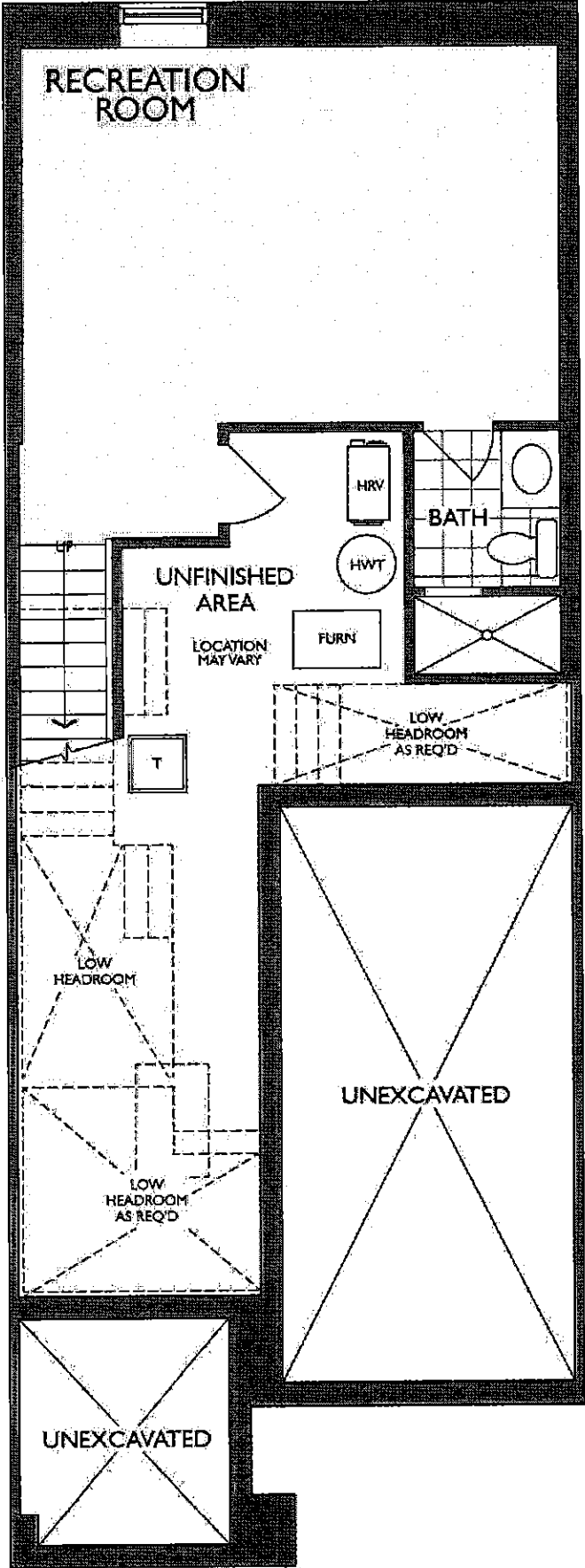

M. H.

UK 3 WALLACETON  
LOT 3189B-11  
20-16-6 ELEV A  
THE GRASSFIELD

15 of 31

THE GRASSFIELD

Sketch # 2

ELEVATION B | 1,986 SQ. FT.

Includes 380 sq. ft. of Finished Lower Level

20-1606 ELEV. B

WALLACETON  
EST. 1870

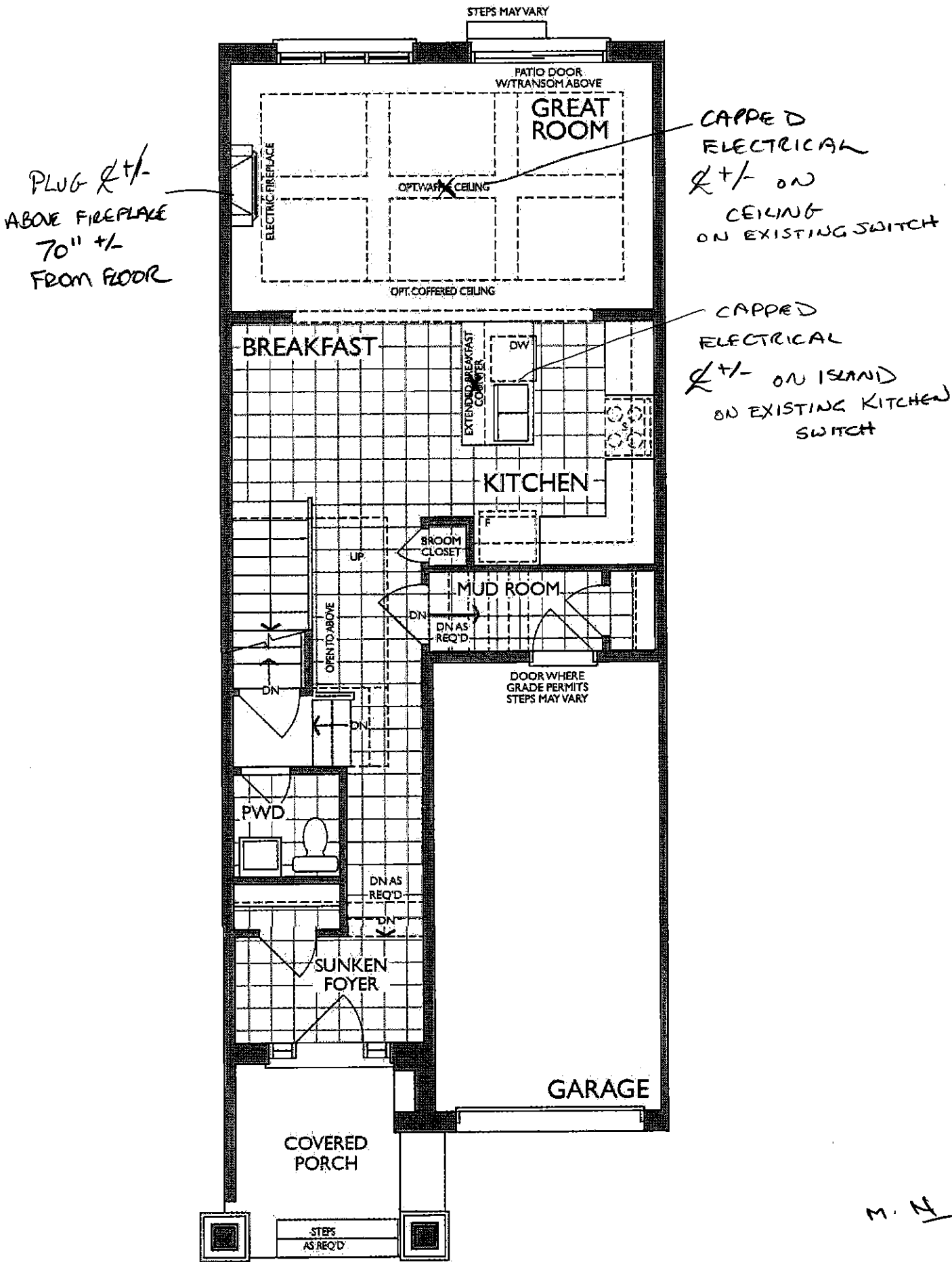

M. N.

KITCHEN  
(GROUND FLOOR)

UPPER ANGLE

DEEP FRIDGE  
UPPER

Sketch #3

16 of 31

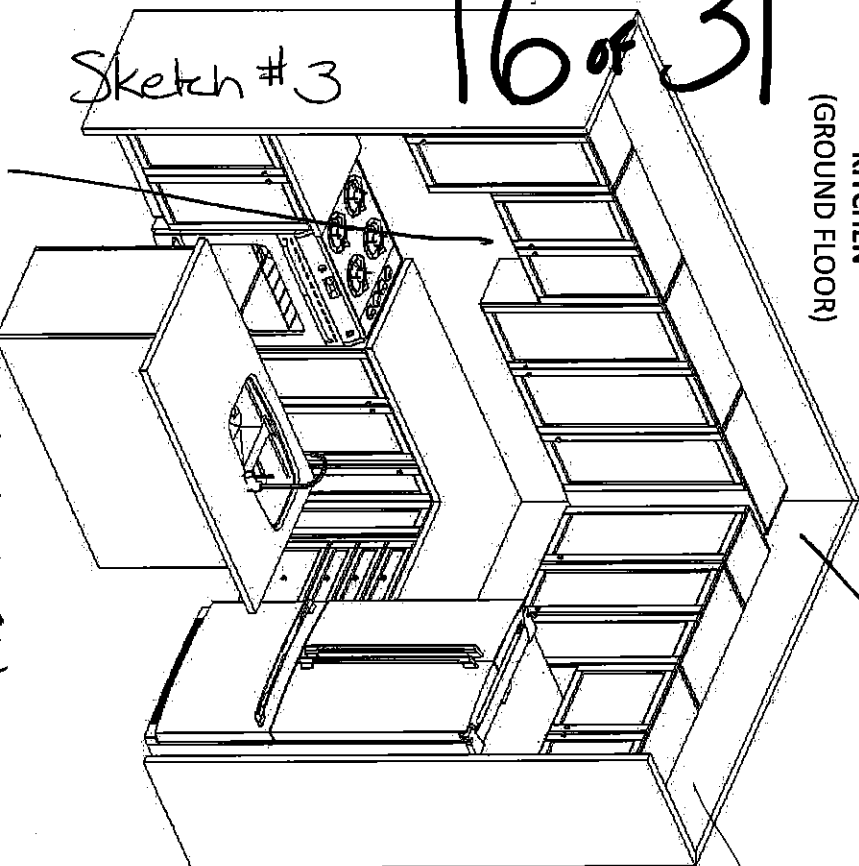

MICROWAVE HOOD-AN

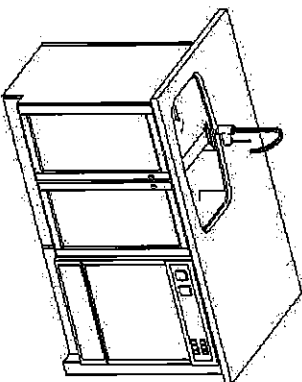

STD. BASEMENT BATH

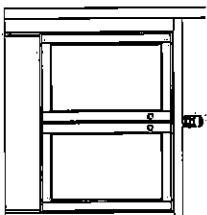

MASTER ENSUITE  
(2ND FLR)

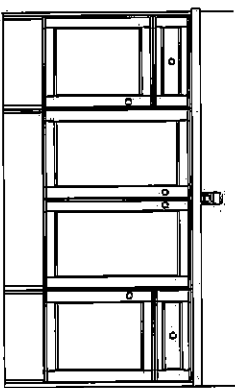

MAIN BATH  
(2ND FLR)

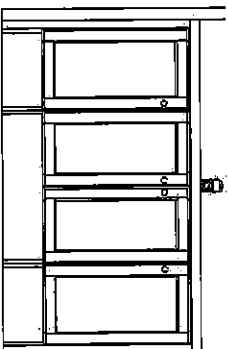

UK 3 WALLACETON  
LOT 3189B-11  
20-16-6 ELEV A  
THE GRASSFIELD

2/2021

3.21



F R E N D L E  
KITCHENS LIMITED  
1350 Brimcom Drive, Mississauga, ON L4W 1C5

HEATHWOOD HOMES  
WALLACETON, KITCHENER ON  
MODEL: 20-1606 (2003)

STANDARD CONTRACT INCLUDES:

**Appliance Openings**

- Hood Opening: 30"W Std. hood
- Fridge Opening: 37 3/8 "W X 73 3/8" H
- 30cm deep cabinet over fridge
- Stove Opening: 30" Freestanding
- Dishwasher Opening: 24"

**Standard Kitchens Scope:**

- 100cm H wall cabinets
- Std. Blumotion Hinges- **soft close doors**
- Std. Metabox Drawers- **not soft close**
- Min 40cm W drawer
- Base pie cut corner cabinets
- Backing on all cabinets
- Countertop by others
- Upgrade applied paneled fridge & dishwashers supply only (appliance hardware by others)

**Standard Vanity & Laundry Scope:**

- Powder by others, pedestal
- All vanities include laminate counter
- Std. Blumotion Hinges- **not soft close**
- Tandem Box Drawers- **soft close**
- Master Ensuite: Top drawers (Full height doors at sink)
- Mains: Full height doors (top drawers added if Masters can't accommodate)
- Optional laundry base & wall cabinets

THIS DRAWING IS FOR DESIGN PURPOSES ONLY.

IT IS NOT AN EXACT RENDITION.

UK 3 WALLACETON  
LOT 3189B-11  
20-16-6 ELEV A  
THE GRASSFIELD

17 of 31

Sketch # 4

THE GRASSFIELD

ELEVATION B | 1,986 SQ. FT.

Includes 380 sq. ft. of Finished Lower Level

20-1606 ELEV. B

WALLACETON  
EST. 1870

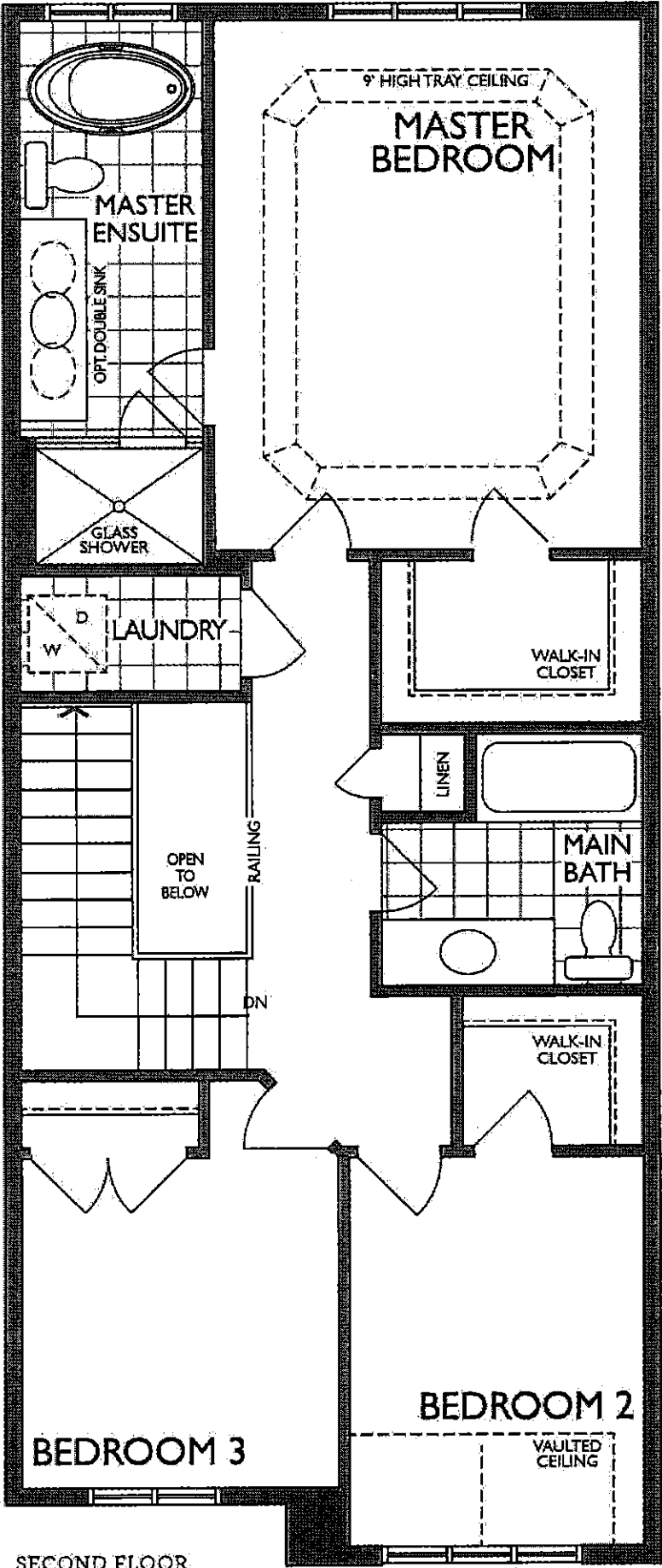

SECOND FLOOR  
ELEVATION B

M. N.

UK 3 WALLACETON  
LOT 3189B-11  
20-16-6 ELEV A  
THE GRASSFIELD

18 of 31

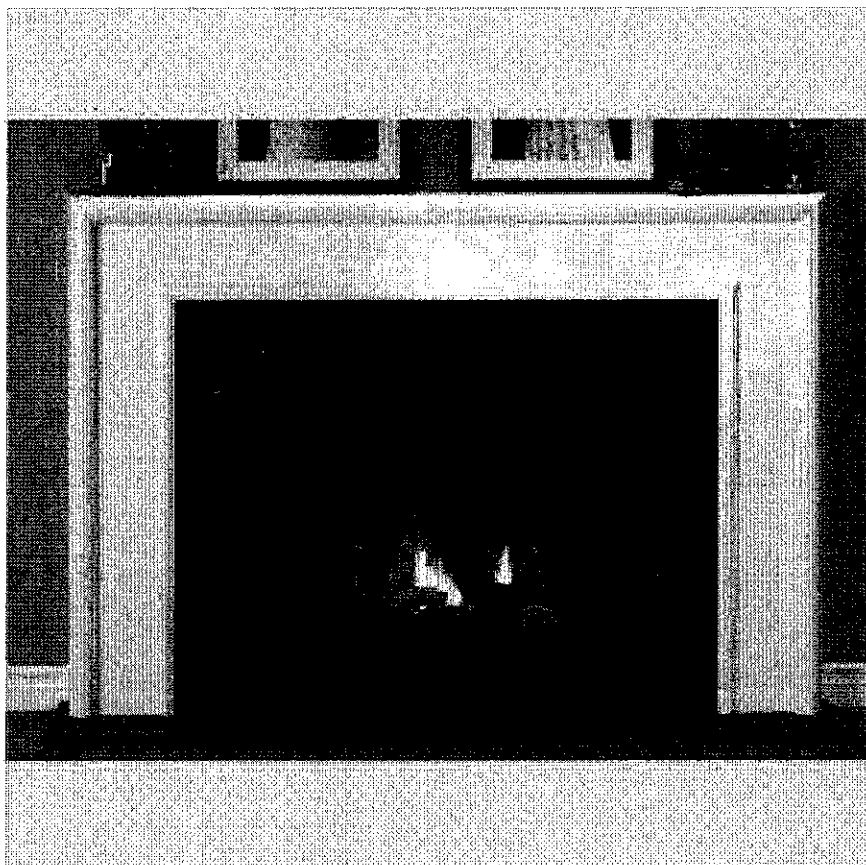

NEAS NF17 Mantel - CABINET

M. N.

UK 3 WALLACETON  
LOT 3189B-11  
20-16-6 ELEV A  
THE GRASSFIELD

19 of 31



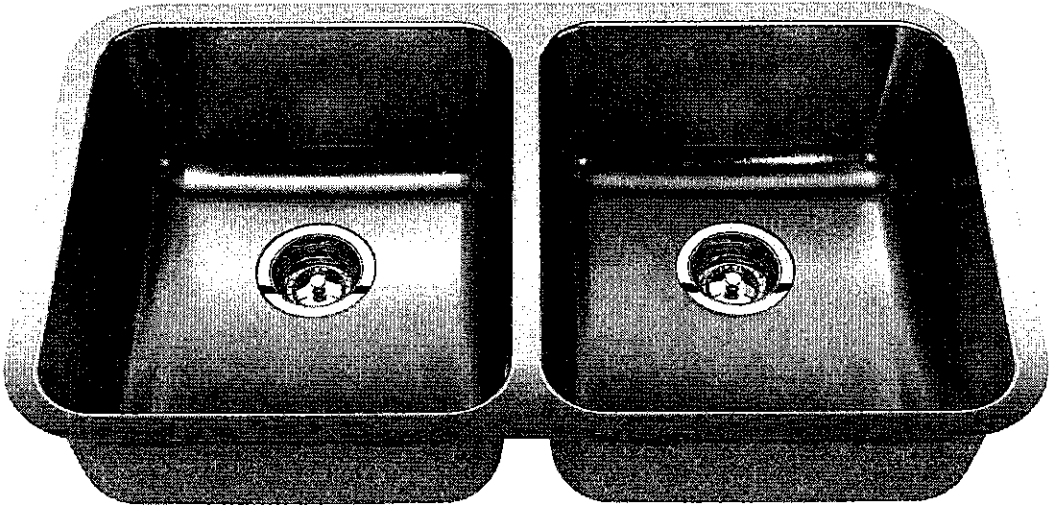

ND1831UA/9







Optional Accessories

  
BG10S

  
BG10S

  
MB100

  
CA1W

  
DBR10S

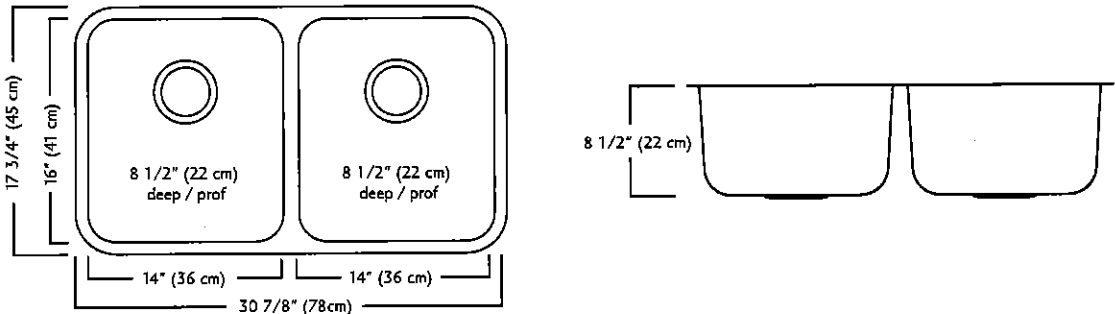

ND1831UA/9 SPECIFICATION

Model ND1831UA/9 is a double (two equal size) bowl undermount sink manufactured by Franke Kindred Canada Limited from 18 gauge stainless steel. Product has silk finished rims and linear brush finished bowls. Sink is fully undercoated. Basket strainer waste fittings (3 1/2", 89 mm) are included. Sink is backed with a limited lifetime warranty.

- O.D. 17 3/4" x 30 7/8" x 8 1/2" (45 x 78 x 22 cm)
- Recommended for minimum 36" cabinet

Franke Kindred Canada Limited  
P.O. Box 190, 1000 Franke Kindred Road, Midland, Ontario, Canada, L4R 4K9 Phone: 866-687-7465 Fax: 800-361-8408

Plumbing Fixture / Kitchen Sinks 15410

Franke Kindred Canada Limited Printed in Canada 1117

M.N.

UK 3 WALLACETON  
LOT 3189B-11  
20-16-6 ELEV A  
THE GRASSFIELD

20 of 31

MOEN®

There is more than 1 version of this model.  
Page down to identify the version you have.

FAUCET DESCRIPTION

- Reflex™ pulldown system offers smooth operation, easy movement and secure docking
- Power Clean™ spray technology
- Metal construction with various finishes identified by suffix
- Duralock™ connect installation
- Pulldown spray with 68" braided hose
- Flexible supply lines with 3/8" compression fittings
- High arc spout provides height and reach to fill or clean large pots while pulldown wand provides the maneuverability for cleaning or rinsing
- 360° rotating spout
- Faucet designed for handle to be mounted on right side only

OPERATION

- Lever style handle
- Temperature controlled by 100° arc of handle travel
- Operates with less than 5 lbs. of force
- Operates in stream or spray mode in the pullout or retracted position

FLOW

- Flow is limited to 1.5 gpm (5.7 L/min) max at 60 psi

CARTRIDGE

- 1255™ Duralast™ cartridge

STANDARDS

- Third party certified to IAPMO Green, ASME A112.18.1/CSA B125.1 and all applicable requirements therein including NSF 61/9G & 372
- Meets CalGreen and Georgia SB370 requirements
- Complies with California Proposition 65 and with the Federal Safe Drinking Water Act
- The backflow protection system in the device consists of two independently operating check valves, a primary and a secondary which prevent backflow

- ADA  for lever handle

WARRANTY

- Lifetime limited warranty against leaks, drips and finish defects to the original homeowner
  - 10 year limited warranty when used in a multifamily installation
  - 5 year limited warranty when used in a commercial installation
- Visit [www.moen.com/support](http://www.moen.com/support) for complete details and limitations

Specifications

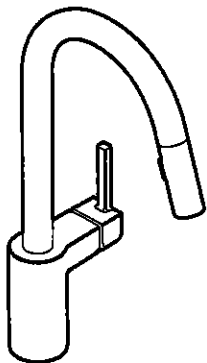

ALIGN™  
Single Handle High Arc  
Pulldown Kitchen Faucet

Models: 7565 series

NOTE: THIS FAUCET IS DESIGNED TO BE INSTALLED  
THROUGH 1 HOLE, 1-1/2" (38mm) MIN. DIA.  
(OPTIONAL 3-HOLE ESCUTCHEON 141002 AVAILABLE)

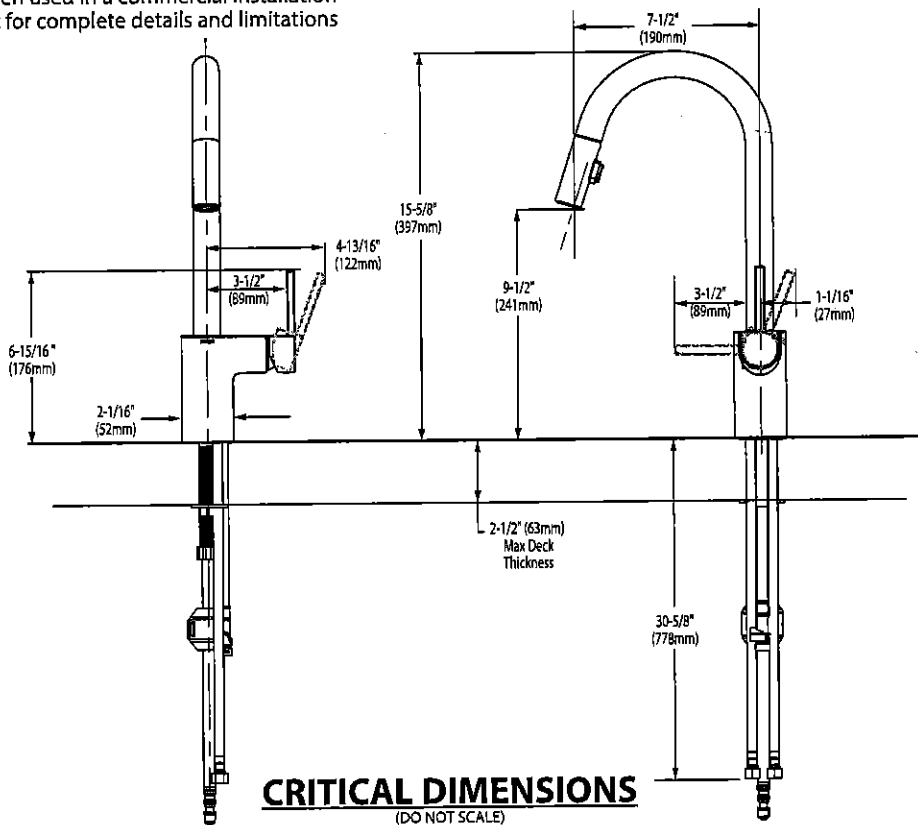

M.N.

21 of 31

UK 3 WALLACETON  
LOT 3189B-11  
20-16-6 ELEV A  
THE GRASSFIELD



BARRIER FREE (ABOVE COUNTER OR DROP-IN ONLY)

BOULEVARD®  
PEDESTAL SINK  
VITREOUS CHINA

BOULEVARD® PEDESTAL SINK

- ☐ 0641.800 Faucet holes on 8" (203mm) centers (Illustrated)
- ☒ 0641.400 Faucet holes on 4" (102mm) centers
- ☐ 0641.100 Center hole only
  - Classic styled rectangular pedestal lavatory
  - Vitreous china
  - Rear overflow
  - Supplied with mounting kit
  - Right Height® for greater comfort during use
  - Faucet ledge with large deck area (faucet not included)
  - **Design coordinates with Boulevard® Toilet**
  - Basin has flat bottom to also allow use as an **above counter sink** or a **drop-in sink** (with u-shaped cut out)

Nominal Dimensions:  
24" x 19" x 35-1/2"  
(610 x 483 x 902mm)

- ☐ 0641.008 Pedestal top-8" (203mm) centers
- ☐ 0641.004 Pedestal top-4" (102mm) centers
- ☐ 0641.001 Pedestal top-center hole only
- ☐ 0010.000 Pedestal only

Bowl sizes:  
17" (432mm) wide,  
12-1/2" (318mm) front to back,  
5" (127mm) deep

Compliance Certifications -  
Meets or Exceeds the Following Specifications:  
• ASME A112.19.2 - 2008/CSA B45.1-08

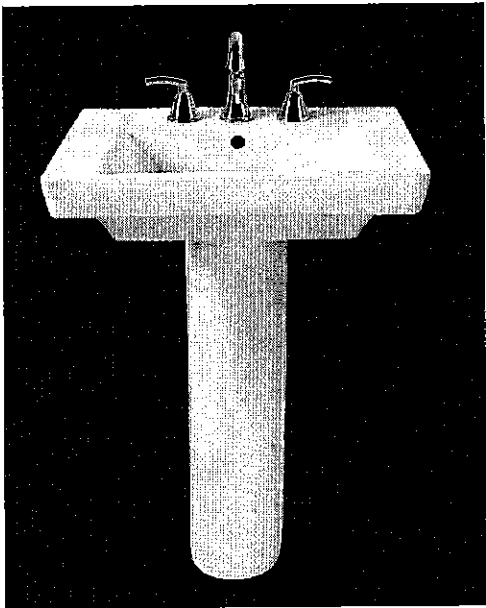

SEE REVERSE FOR ROUGHING-IN DIMENSIONS

To Be Specified:

- ☐ Color: ☐ White ☐ Linen
- ☐ Faucet Finish:
- ☐ Supplies:
- ☐ 1-1/4" Trap:
- ☐ Nipple:

\* See faucet section for additional models available

m. M

UK 3 WALLACETON  
LOT 3189B-11  
20-16-6 ELEV A  
THE GRASSFIELD

22 of 31



BARRIER FREE (ABOVE COUNTER OR DROP-IN ONLY)

**BOULEVARD®  
PEDESTAL SINK**  
VITREOUS CHINA

TOP VIEW (ALL THREE CONFIGURATIONS)

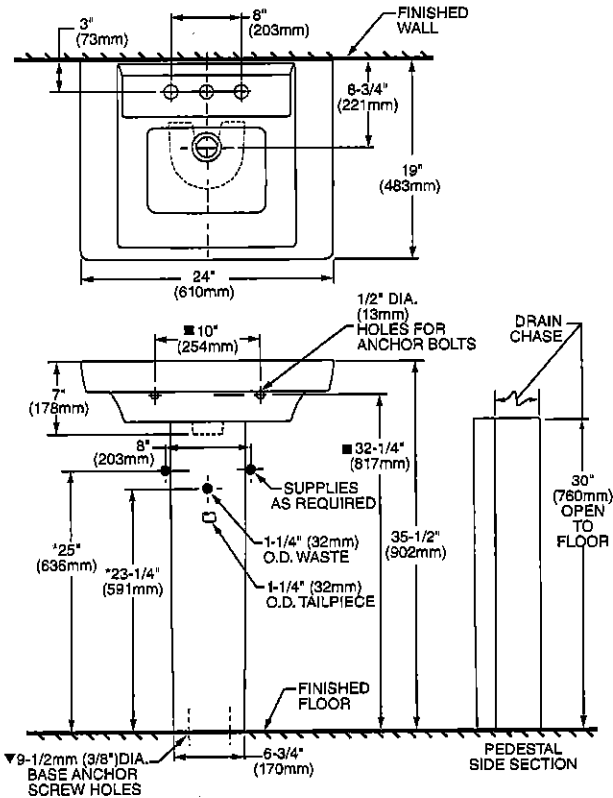

PEDESTAL CONFIGURATION  
(NOT ADA COMPLIANT)

ABOVE COUNTER CONFIGURATION

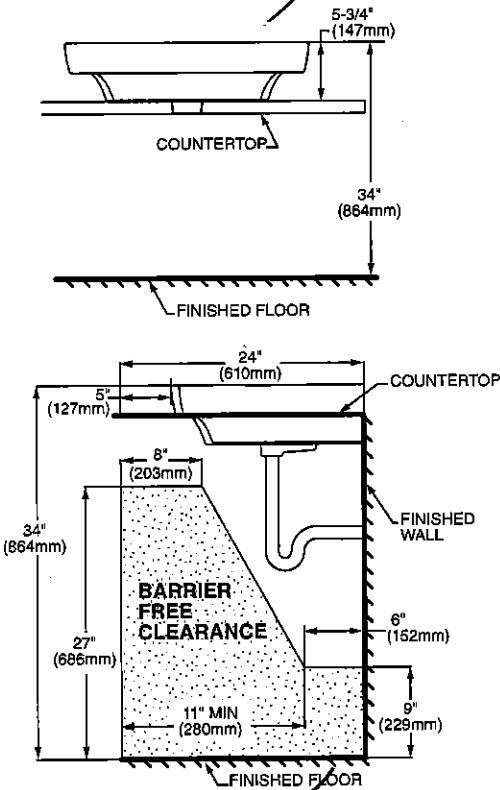

DROP-IN SINK CONFIGURATION



ABOVE COUNTER AND DROP-IN SINK CONFIGURATIONS  
MEET THE AMERICANS WITH DISABILITIES ACT GUIDELINES  
AND ANSI A117.1 ACCESSIBLE AND USABLE  
BUILDINGS AND FACILITIES - CHECK LOCAL CODES.  
Top of sink installed at 34" (864mm) height from finished floor.  
Sink installed 5" (127mm) minimum from front edge of countertop.  
Provide 27" (686mm) knee clearance area.

NOTES:  
\* DIMENSIONS SHOWN FOR LOCATION OF SUPPLIES AND "P" TRAPS ARE SUGGESTED.  
▼ PEDESTAL ANCHORING SCREWS NOT INCLUDED.  
■ SUITABLE FOR REINFORCEMENT ONLY. ACTUAL DIMENSIONS MUST BE TAKEN FROM FIXTURE.  
FITTING NOT INCLUDED AND MUST BE ORDERED SEPARATELY.  
PROVIDE SUITABLE REINFORCEMENT FOR ALL WALL SUPPORTS.  
INSTALLATION INSTRUCTIONS SUPPLIED WITH LAVATORY.

IMPORTANT: Dimensions of fixtures are nominal and may vary within the range of tolerance established by ANSI Standard A112.19.2  
These measurements are subject to change or cancellation. No responsibility is assumed for use of superseded or voided pages.

M.N.

UK 3 WALLACETON  
LOT 3189B-11  
20-16-6 ELEV A  
THE GRASSFIELD

23.31

American Standard



BARRIER FREE

COLONY™  
COUNTERTOP SINK  
VITREOUS CHINA

COLONY COUNTERTOP SINK

- Vitreous china
- Self-rimming
- Front overflow
- Supplied with template
- Faucet deck  
(Faucet shown not included)

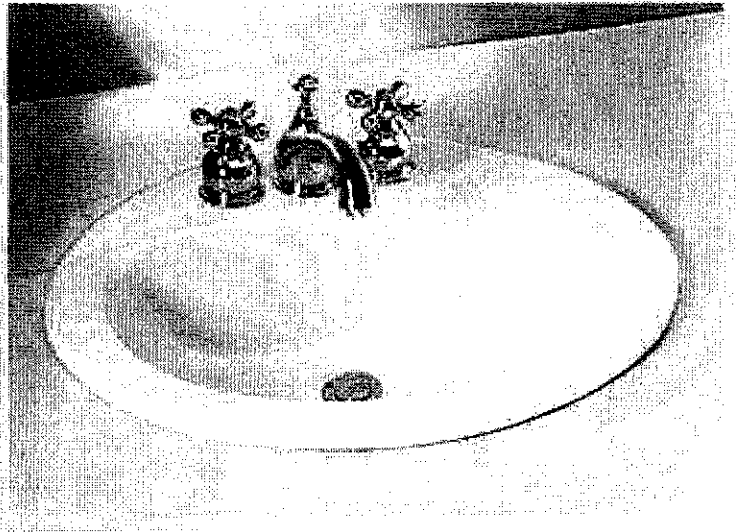

- ☐ 0346 803  
Faucet holes on 203mm (8") centres
- ☒ 0346 403 (Illustrated)  
Faucet holes on 102mm (4") centres
- ☐ 0346 001  
Centre hole only

Nominal Dimensions:  
521 x 448mm (20-1/2" x 17-5/8")

Bowl sizes:  
422mm (16-5/8") wide, 279mm (11") front to back, 143mm (5-5/8") deep

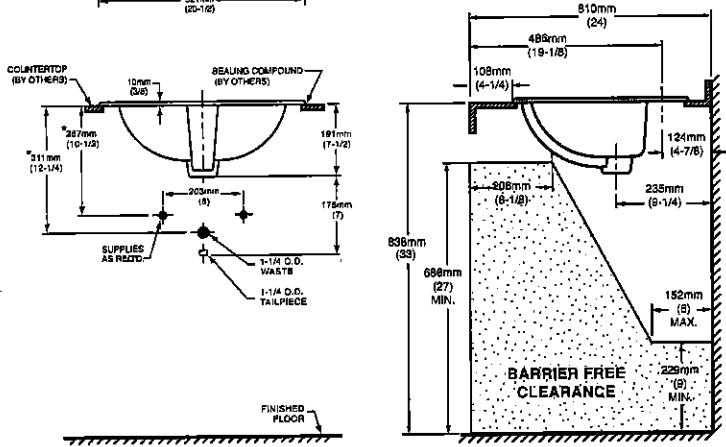
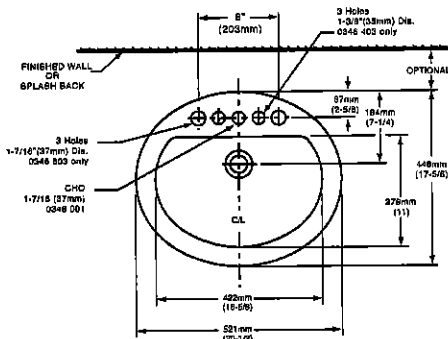

COMPLIANCE CERTIFICATIONS –  
Meets or exceeds the following Specifications:  
• ASME A112.19.2M for Vitreous China Fixtures.  
• CAN/CSA B45 Series.

To Be Specified

- ☐ Colour: ☐ White ☐ Bone ☐ Silver Gray  
☐ Linen
- ☐ Faucet\*:
- ☐ Faucet Finish:
- ☐ Supplies & Stops:
- ☐ Trap 1-1/4" (32 mm):

\* See faucet section for additional models available

M.N.

UK 3 WALLACETON  
LOT 3189B-11  
20-16-6 ELEV A  
THE GRASSFIELD

24 of 31



DEMI™  
Product Specification Sheet

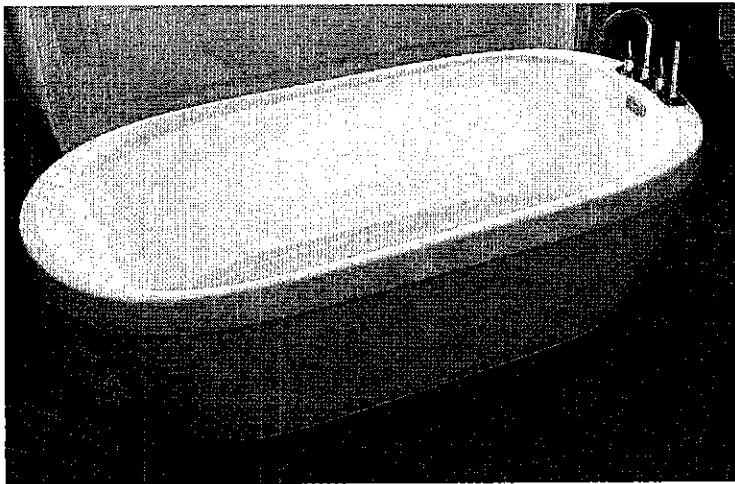

Two Piece Freestanding Collection

CF2007	Two Piece Freestanding Soaker
Size:	60" x 32" x 22" 1524 mm x 813 mm x 559 mm

PRODUCT FEATURES & BENEFITS

- Vacuum formed acrylic reinforced with fiberglass
- Scratch, stain and fade resistant high gloss finish
- Installation friendly two piece design
- Accepts deck mounted faucet
- Includes integral pop up drain and rectangular overflow
- Includes levelling feet

TWO PIECE ASSEMBLY

FRONT VIEW

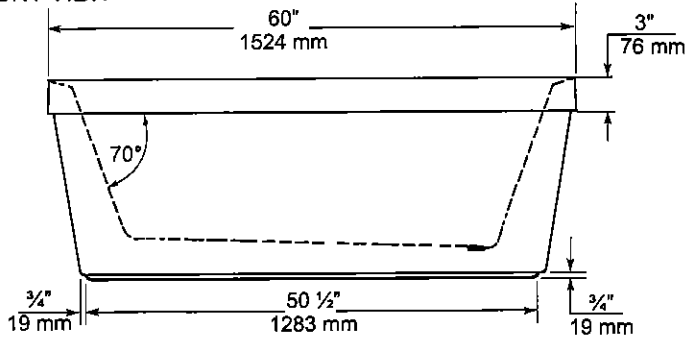

END VIEW

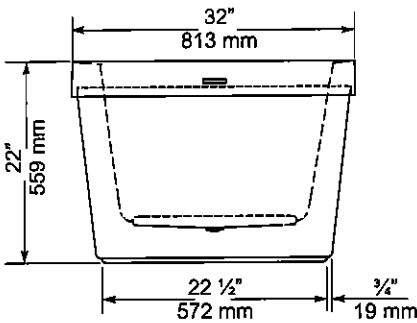

TOP VIEW

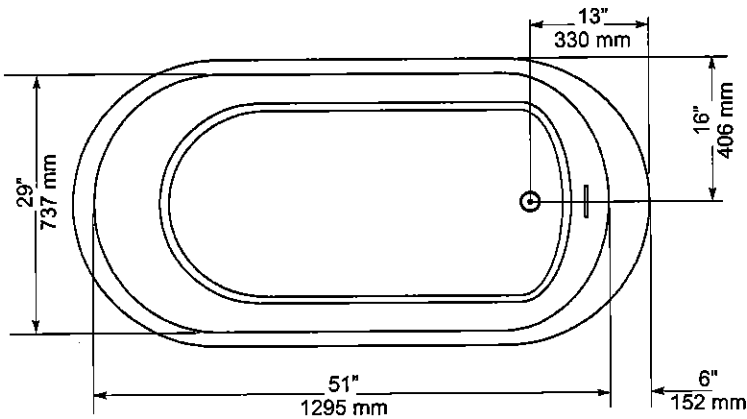

GENERAL SPECIFICATIONS		
Average Weight	90 lb	41 kg
Bathing Well at bottom	43"x 20"	1092 x 508 mm
Capacity Drain to Overflow		195 litres
Water Depth Drain to Overflow	16"	406 mm
Drain Opening (dia.)	2"	51 mm
Overflow Opening	2 1/4"x 1/2"	57 x 13 mm
Drain to Floor Clearance	3 1/4"	83 mm

**NOTES:** Please confirm measurements on actual product to ensure proper identification. Bathtub to be installed on the floor supported by 5 self levelling feet. Adjust if required to level the bathtub for adequate drainage. Refer to installation instructions for additional information.

**IMPORTANT:** Dimensions of fixtures are nominal and may vary  $\pm \frac{1}{4}$ " (6 mm). Weight may vary  $\pm 5$  lb (2.3 kg). Drawing is not to scale. These measurements are subject to change at manufacturer's discretion.

Compliance Certifications -  
Meets or Exceeds the following Specifications:  
• CAN/CSA - B45 Series



M.N.

UK 3 WALLACETON  
LOT 3189B-11  
20-16-6 ELEV A  
THE GRASSFIELD

*American Standard*  
Style That Works Better

25 of 31

FloWise™ DUAL FLUSH  
ELONGATED TOILET

VITREOUS CHINA

FloWise™ DUAL FLUSH ELONGATED TOILET

☐ 2476 216

- Vitreous china
- Low-consumption Dual Flush  
Full flush 6.0 Lpf/1.3 gpf,  
Partial flush 3.0 Lpf/0.66 gpf.
- Elongated wash down bowl
- Internal trapway fully-glazed,  
2-1/4" (57mm) ballpass
- Concealed trapway bowl
- Chrome-plated top mounted  
push button actuator
- Easy to clean sanitary dam on bowl
- Includes Elongated Slow Close Seat
- 100% factory flush tested
- 2 bolt caps

Separate Component Parts:

- ☐ 3067 316 Elongated Bowl with Slow Close Seat
- ☐ 4035 216 Unlined Tank

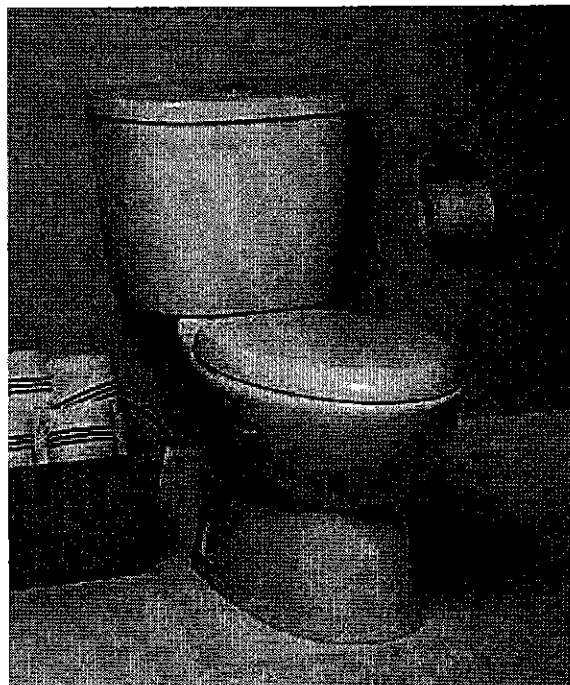

☐ 2476 516 Same as above with Lined tank

- ☐ 3067 316 Elongated Bowl
- ☐ 4035 516 Lined Tank

Nominal Dimensions:  
794 x 432 x 765mm  
(31-1/4" x 17" x 30-1/8")

Compliance Certifications -  
Meets or Exceeds the Following Specifications:  
• ASME A112.19.2M (and 19.6M)  
• CAN/CSA B45 series

To Be Specified

- ☐ Colour: 020 White
- ☐ Supply with stop:

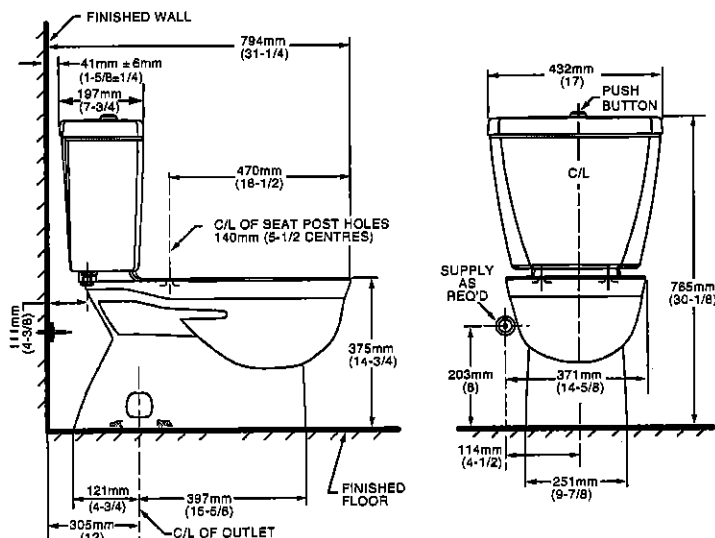

NOTES:  
THIS TOILET IS DESIGNED TO ROUGH-IN AT A MINIMUM DIMENSION OF 305MM (12") FROM FINISHED WALL TO C/L OF OUTLET.  
SUPPLY NOT INCLUDED WITH FIXTURE AND MUST BE ORDERED SEPARATELY.  
\* DIMENSION SHOWN FOR LOCATION OF SUPPLY IS SUGGESTED.  
FOR ADDITIONAL INFORMATION REFER TO INSTALLATION INSTRUCTIONS SUPPLIED.  
IMPORTANT: Dimensions of fixtures are nominal and may vary within the range of tolerance established by ANSI Standard A112.19.2  
These measurements are subject to change or cancellation. No responsibility is assumed for use of superseded or voided pages.

**UPGRADED VALUE ADDED FEATURES AT NO EXTRA CHARGE**

M.N.

UK 3 WALLACETON  
 LOT 3189B-11  
 20-16-6 ELEV A  
 THE GRASSFIELD

26 of 31

**MOEN®**

## Specifications

There is more than 1 version of this model.  
 Page down to identify the version you have.

### DESCRIPTION

- Metal construction with various finishes identified by suffix
- Flexible supplies with 3/8" compression fittings
- Includes metal or 50/50 pop-up type waste assembly where noted

### OPERATION

- Pivot action lever style handle
- Temperature controlled through 100° degree arc of handle travel

### FLOW

- Water usage is limited to these maximum flow rates as indicated by the corresponding product markings

° 1.2 gpm max (4.5L/min) at 60 psi

° 1.5 gpm max (5.7L/min) at 60 psi

### CARTRIDGE

- 1255™ Duralast™ cartridge
- Nonmetallic/nonferrous and stainless steel material

### STANDARDS

- Third party certified to WaterSense®, ASME A112.18.1/CSA B125.1 and all applicable requirements referenced therein
- Certified to NSF 61/9 & 372
- Products marked with 1.2 gpm are compliant with California water efficiency regulations
- Complies with California Proposition 65 and with the Federal Safe Drinking Water Act

- **ADA**  for lever handle

### WARRANTY

- Lifetime limited warranty against leaks, drips and finish defects to the original consumer purchaser
- 5 year warranty if used in commercial installations

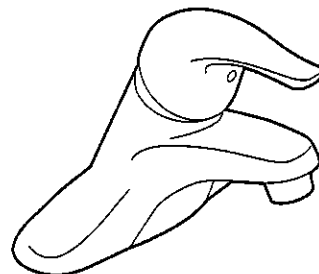

### CHATEAU® Single-Handle Lavatory Faucet

#### with Metal Waste Assembly

Model: L4625 series

L4631BC

**Bulk Packed (12 per carton):**

L64624 series

#### with 50/50 Waste Assembly

**Bulk Packed (12 per carton):**

L64625 series

#### Less Waste

**Bulk Packed (12 per carton):**

L64600 series

**NOTE:** THIS FAUCET IS DESIGNED TO BE  
 INSTALLED THRU 3-1" DIA. HOLES, 2" ON CENTER

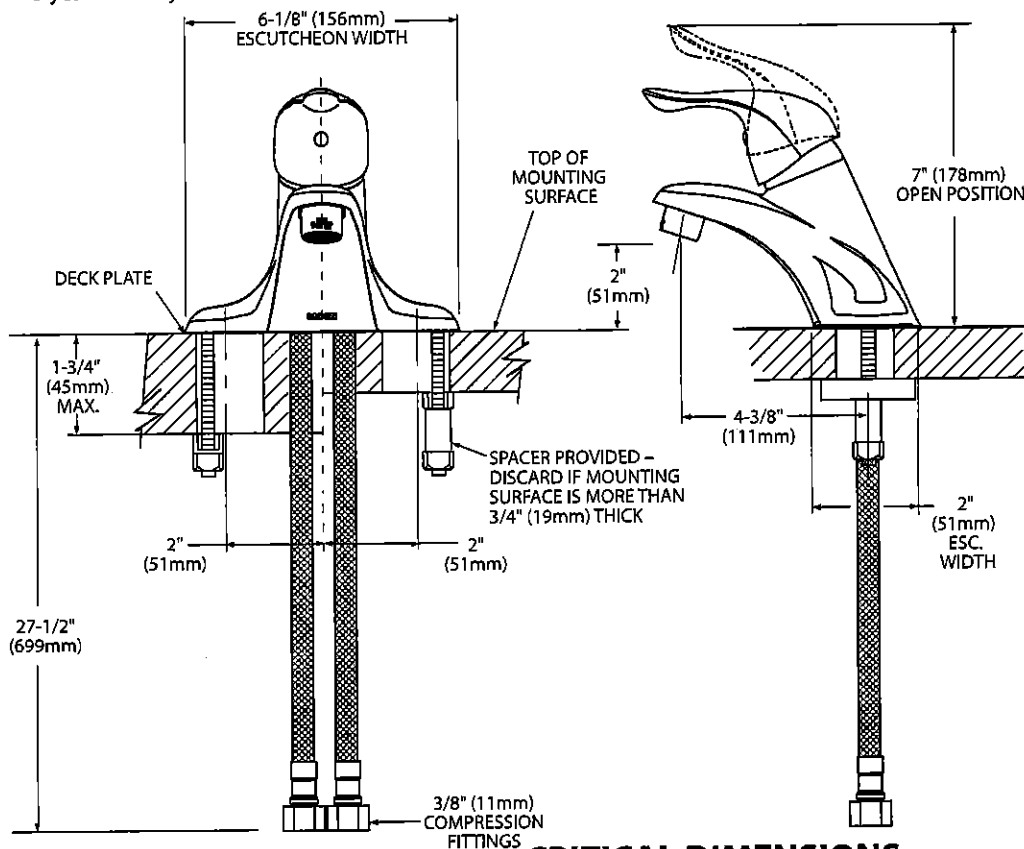

### CRITICAL DIMENSIONS (DO NOT SCALE)



M.N.

UK 3 WALLACETON  
LOT 3189B-11  
20-16-6 ELEV A  
THE GRASSFIELD

27 of 31



Specifications

DESCRIPTION

- Metal construction with various finishes identified by suffix
- Includes non-metallic showerhead, arm, flange and non-metallic diverter tub spout

OPERATION

- Handle operates counterclockwise through a 270° arc with off at 6 o'clock and maximum hot at the 9 o'clock position. Shut off in clockwise direction
- Adjustable temperature limit stop to control maximum hot water temperature
- Pressure balancing mechanism maintains selected discharge temperature to ± 3°

FLOW

- Showerhead is limited to 2.5 gpm (9.5 L/min) at 80 psi
- EP suffix models are limited to 1.75 gpm (6.6 L/min) at 80 psi
- NH suffix models contain no showerhead

CARTRIDGE

- 1222 cartridge design
- Accommodates back to back installations
- Nonmetallic/nonferrous and stainless steel material

STANDARDS

- Third party certified to meet ASME A112.18.1/CSA B125.1 and all applicable requirements referenced therein
- EP suffix models are third party certified to WaterSense®
- ADA ♿ for lever handle

WARRANTY

- Lifetime limited warranty against leaks, drips and finish defects to the original consumer purchaser
- 5 year warranty if used in commercial installations

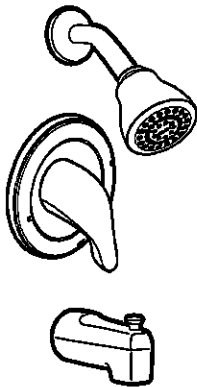

CHATEAU® POSI-TEMP®  
Single-Handle Tub/Shower Trim Kit

Models: TL181 series - valve trim only  
(Bulk Packed 12 per carton)  
TL182 series - shower trim only  
(Bulk Packed 12 per carton)  
TL183 series - tub/shower trim  
(Bulk Packed 12 per carton)

Valves: 62300 series  
2500 series

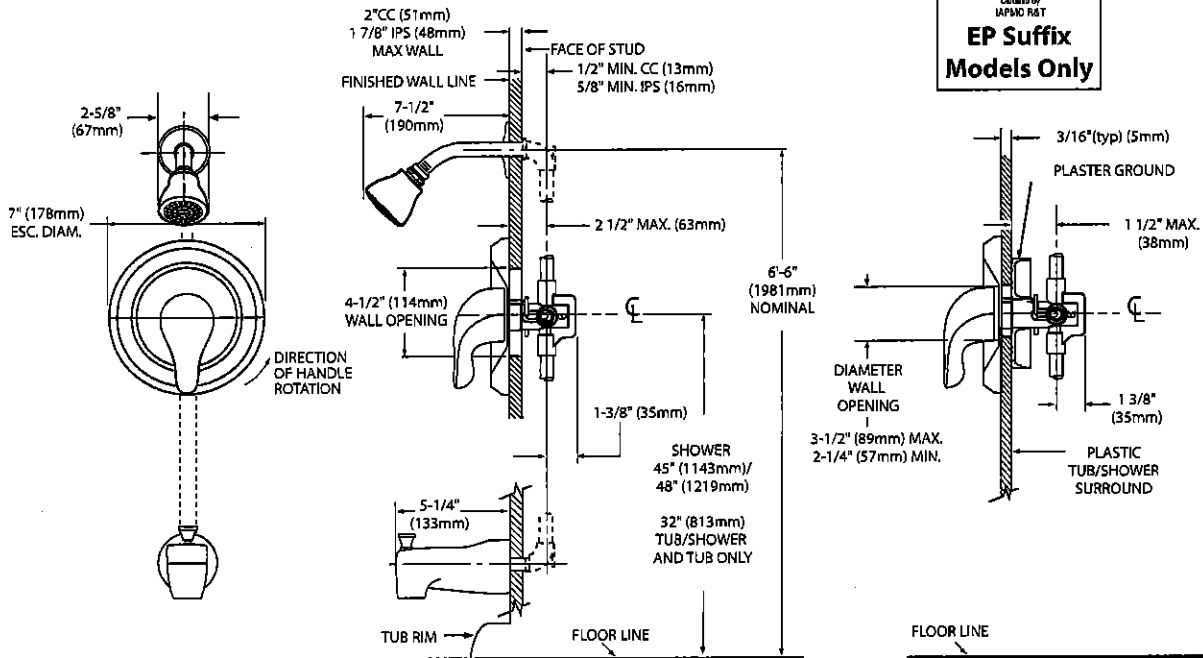

CRITICAL DIMENSIONS

(DO NOT SCALE)

M.N.

UK 3 WALLACETON  
LOT 3189B-11  
20-16-6 ELEV A  
THE GRASSFIELD

28 of 31

MOEN®

Specifications

DESCRIPTION

- Metal construction with various finishes identified by suffix

OPERATION

- Lever style handles with hot and cold color indicator
- Rotate hot side handle counterclockwise to open (clockwise to close) and the cold side handle (clockwise to open) and (counterclockwise to close)

STANDARDS

- Third party certified to: ASME A112.18.1/CSA B-125.1, and all applicable requirements referenced therein
- ADA  for lever handles

WARRANTY

- Lifetime limited warranty against leaks, drips and finish defects to the original homeowner
  - 10 year limited warranty when used in a multi-family installation
  - 5 year limited warranty when used in a commercial installation
- Visit [www.moen.com/support](http://www.moen.com/support) for complete details and limitations

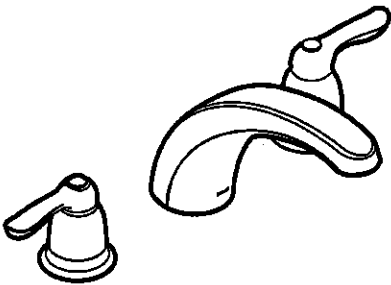

CHATEAU®  
Two-Handle Garden Tub Trim

Models: T994 series

Valves: 4792, 4793, 4794, 4796, 4797, 4798

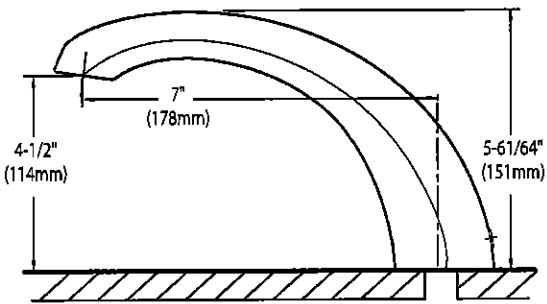
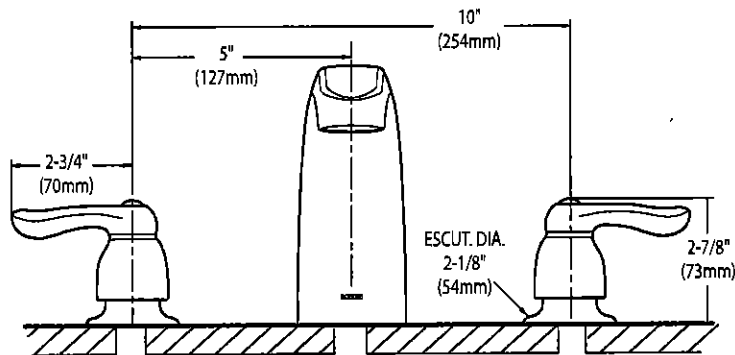

CRITICAL DIMENSIONS  
(DO NOT SCALE)

M. N.

UK 3 WALLACETON  
LOT 3189B-11  
20-16-6 ELEV A  
THE GRASSFIELD

29 of 31

WMH31017H  
OVER-THE-RANGE MICROWAVE

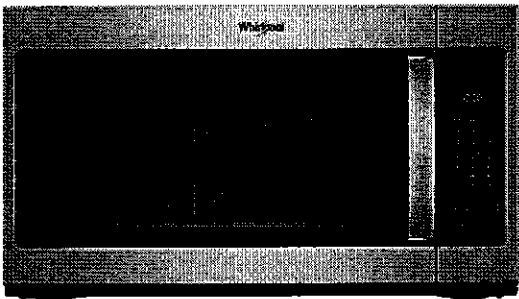

DISHWASHER-SAFE TURNTABLE PLATE



Clean up spills on the turntable by simply putting it in the dishwasher.

2-SPEED, 300 CFM MOTOR CLASS\*



Match the right amount of ventilation to the dish being prepared and quickly get rid of cooking odors with two different fan speed settings.

MICROWAVE PRESETS



Get just the right amount of heat and time, whether you're cooking or defrosting, with specific preset options.

OTHER FEATURES

- Add 30 seconds option
- Electronic touch controls
- Adjustable cooktop lighting



White  
(W)



Black  
(B)

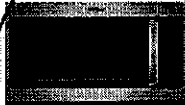

Fingerprint Resistant  
Stainless Steel (Z)



Silver  
(S)

MODEL	WMH31017HW	WMH31017HB	WMH31017HZ	WMH31017HS
Max height (in)	17-1/8"	17-1/8"	17-1/8"	17-1/8"
Width (in)	29-15/16"	29-15/16"	29-15/16"	29-15/16"
Depth (in)	15-9/16"	15-9/16"	15-9/16"	15-9/16"

Whirlpool®

\*Performance varies based on installation.  
©/™ ©2018 Whirlpool. All rights reserved. 1/18. WC170107A

M.N

VENTING DESIGN SPECIFICATIONS

This section is intended for architectural designer and builder/contractor reference only.

NOTES:

- Vent materials needed for installation are not provided with microwave hood combination.
- We do not recommend using a flexible metal vent.
- To avoid possible product damage, be sure to vent air outside, unless using recirculation installation. Do not vent exhaust air into concealed spaces, such as spaces within walls or ceilings, attics, crawl spaces, or garages.

For optimal venting installation, we recommend:

- Using roof or wall caps that have backdraft dampers
- Using a rigid metal vent
- Using the most direct route by minimizing the length of the vent and number of elbows to provide efficient performance
- Using uniformly sized vents
- Using duct tape to seal all joints in the vent system
- Using caulking compound to seal exterior wall or roof opening around cap
- Not installing 2 elbows together for optimal hood performance

If venting through the wall, be sure that there is proper clearance within the wall for the damper to open fully.

If venting through the roof, and rectangular-to-round transition is used, be sure there are at least 3" (7.6 cm) of clearance between the top of the microwave oven and the transition piece. See "Rectangular-to-Round Transition" illustration.

Rectangular-to-Round Transition

NOTE: The minimum 3" (7.6 cm) clearance must exist between the top of the microwave oven and the rectangular to round transition piece so that the damper can open freely and fully.

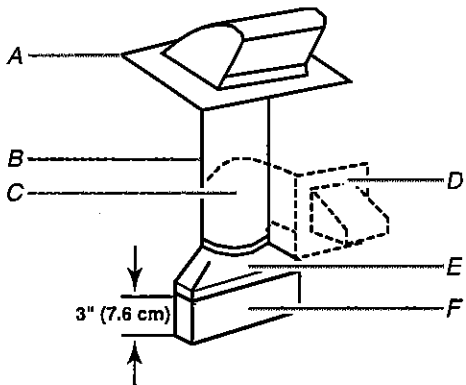

- A. Roof cap
- B. 6" (15.2 cm) min. diameter round vent
- C. Elbow (for wall venting only)
- D. Wall cap
- E. 3 1/4" x 10" to 6" (8.3 x 25.4 cm to 15.2 cm) rectangular to round transition piece
- F. Vent extension piece, at least 3" (7.6 cm) high

Recommended Standard Fittings

The following length equivalents are for use when figuring vent length. See the examples in "Recommended Vent Length".

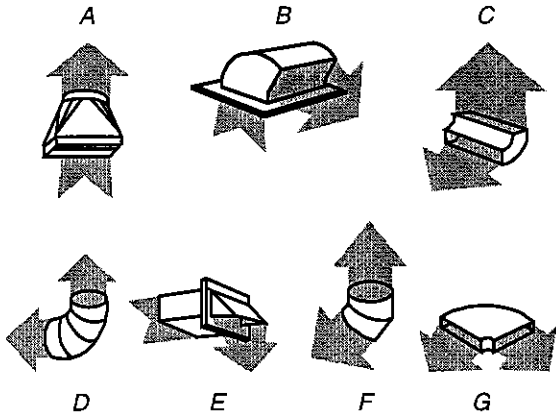

- A. Rectangular-to-round transition piece: 3 1/4" x 10" to 6" = 5 ft (8.3 x 25.4 cm to 15.2 cm = 1.5 m)
- B. Roof cap: 3 1/4" x 10" = 24 ft (8.3 x 25.4 cm = 7.3 m)
- C. 90° elbow: 3 1/4" x 10" = 25 ft (8.3 x 25.4 cm = 7.6 m)
- D. 90° elbow: 6" = 10 ft (15.2 cm = 3 m)
- E. Wall cap: 3 1/4" x 10" = 40 ft (8.3 x 25.4 cm = 12.2 m)
- F. 45° elbow: 6" = 5 ft (15.2 cm = 1.5 m)
- G. 90° flat elbow: 3 1/4" x 10" = 10 ft (8.3 x 25.4 cm = 3 m)

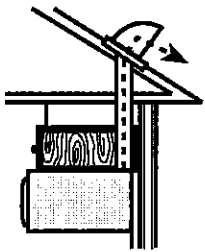

Roof venting

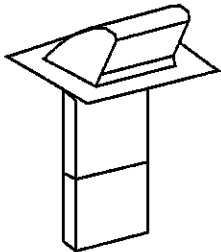

Roof cap

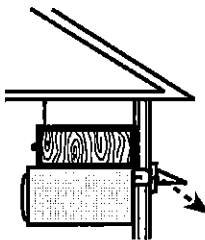

Wall venting



Wall cap

31 of 31

Recommended Vent Length

A 3¼" x 10" (8.3 x 25.4 cm) rectangular or 6" (15.2 cm) round vent should be used.

The total length of the vent system including straight vent, elbow(s), transitions, and wall or roof caps must not exceed the equivalent of 140 ft (42.7 m) for either type of vent. See the "Recommended Standard Fittings" section for equivalent lengths.

For best performance, use no more than three 90° elbows.

To calculate the length of the system you need, add the equivalent lengths of each vent piece used in the system. See the following examples:

3¼" x 10" (8.3 x 25.4 cm) vent system = 73 ft (22.2 m) total

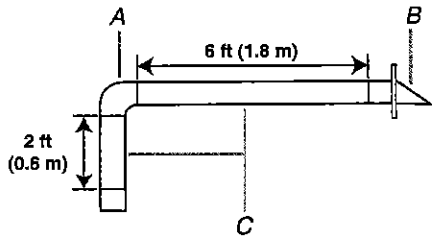

- A. One 3¼" x 10" (8.3 x 25.4 cm) 90° elbow = 25 ft (7.6 m)
- B. 1 wall cap = 40 ft (12.2 m)
- C. 2 ft (0.6 m) + 6 ft (1.8 m) straight = 8 ft (2.4 m)

6" (15.2 cm) vent system = 73 ft (22.2 m) total

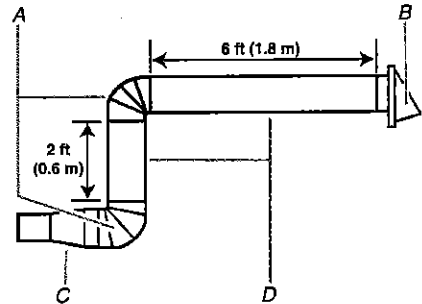

- A. Two 90° elbows = 20 ft (6.1 m)
- B. 1 wall cap = 40 ft (12.2 m)
- C. 1 rectangular-to-round transition piece = 5 ft (1.5 m)
- D. 2 ft (0.6 m) + 6 ft (1.8 m) straight = 8 ft (2.4 m)

If the existing vent is round, a rectangular-to-round transition piece must be used. In addition, a rectangular 3" (7.6 cm) extension vent between the damper assembly and rectangular-to-round transition piece must be installed to keep the damper from sticking.

M. N