

Sales Selection Sheet  
Checklist

1 of 43

LOT 381 Model: 27-2587 CRN B The Maxwell

PURCHASERS: NAJAM UL HASSAN/

VENDOR: Heathwood Homes (Huron) Limited

COFFERED CEILING IN GREAT ROOM

- ☐ FINISHED BASEMENT  
☐ COLD CELLAR

UPGRADED / MODIFIED ELEVATION

- ☐ CORNER UPGRADE  
☐ REAR UPGRADE

CEILING UPGRADE - SMOOTH

- ☐ MAIN FLOOR  
☐ SECOND FLOOR  
☐ BASEMENT

ADDITIONAL ROUGH-INS

- ☒ 200 AMP SERVICE  
☐ WET BAR ROUGH-IN  
☐ HUMIDIFIER  
☒ AIR CONDITIONING

GAS ROUGH-IN

- ☒ STOVE  
☐ DRYER  
☒ BBQ  
☐ ADDITIONAL FIREPLACE

KITCHEN: HOODFAN VENTING SIZE

- ☒ 6 IN ROUND DUCT  
☐ 7 IN ROUND DUCT

FULL BASEMENT STAIRS:

Paint Grade

UPPER BASEMENT STAIRS:

N/A

LOWER BASEMENT STAIRS:

N/A

MAIN STAIRS:

All Oak

MEDIA STAIRS (if applicable):

N/A

LOFT STAIRS (if applicable):

N/A

March 3/22 *Signature on file*

Date

Purchaser:

March 3/22 *TINA LEFUR*

Date

Decor Consultant:

Date Purchaser:

-03- 03 2022

Date

Heathwood Homes (Huron) Limited

Locked Date:

Approved

NAJAM UL HASSAN/  
Project: Wallaceton  
Unit: 381, Phase: 3  
Model: 27-2587 CRN B The Maxwell

Created: 11/8/2021 11:40:23  
Locked:  
Closed: 2043

Kitchen

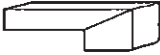
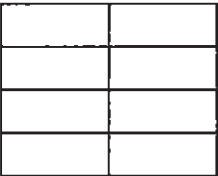
Cabinet Colour/Style	8362	Viking II-MANCHESTER-OREGANO-OAK ***STD***
Countertop	9121	MSI Quartz GROUP 1 ICED WHITE 3/4 inch with double mitre edge ***1***
Countertop Edge	4005	DOUBLE MITRE 1 1/2 INCH ***UPG*** 
Cabinet Hardware	2086	9677-HARDWARE ***STD***
Island Cabinet Colour/Style	8362	Viking II-MANCHESTER-OREGANO-OAK ***STD***
Island Countertop	9121	MSI Quartz GROUP 1 ICED WHITE 3/4 inch with double mitre edge ***1***
Backsplash	1111	N/A *****
Backsplash Grout	1111	N/A *****
Backsplash Tile Pattern	1111	N/A *****
HoodFan	8896	SCB51436-CYCLONE 36 inch STAINLESS CANOPY CHIMNEY HOODFAN-STAINLESS STEEL ***Upg*** PAGES 34-35
Appliance	8896	Purchasers have been advised: standard fridge opening is a minimum 37 3/8 x 73 3/8". Ice Waterline Rough-In is included.
Appliance	8896	Standard stove opening is 30" and standard dishwasher opening is 24". Any gas stove will require backsplash or stainless steel backing to avoid fire hazards.
Appliance	8896	Purchasers acknowledge: Heathwood Homes and its contractors will not be responsible for any kitchen cabinet changes due to appliances dimension changes after
Flooring	8916	OV.CH.WHT.1224-Chambray-White-12 x 24 See Tile Direction on Sketch 2 Page 18 ***2***
Floor Tile Grout	7705	Grout-(01) Alabaster ***UPG***
Floor Tile Pattern	3050	SIDE TO SIDE ***STD*** 

Foyer

Flooring	8916	OV.CH.WHT.1224-Chambray-White-12 x 24 See Tile Direction on Sketch 2 Page 18 ***2***
----------	------	--------------------------------------------------------------------------------------

NAJAM UL HASSAN/  
Project: Wallaceton  
Unit: 381, Phase: 3  
Model: 27-2587 CRN B The Maxwell

Created: 11/8/2021 11:40:23  
Locked:  
Closed:

3 of 43

		Direction on Sketch	Page	2								
Floor Tile Grout	7705	Grout-(01) Alabaster ***UPG***										
Floor Tile Pattern	3040	FRONT TO BACK ***STD***										
<table><tr><td></td><td></td><td></td><td></td></tr><tr><td></td><td></td><td></td><td></td></tr></table>												
Comment												

Laundry Room

Flooring	8913	UN.BL.BIA.1224-Biel-Bianco (White)-12 x 24 See Tile Direction on Sketch 4 Page 20 ***2***								
Floor Tile Grout	2225	Grout-(27) Silver ***STD***								
Floor Tile Pattern	3050	SIDE TO SIDE ***STD***								
<table><tr><td></td><td></td></tr><tr><td></td><td></td></tr><tr><td></td><td></td></tr><tr><td></td><td></td></tr></table>										
Comment										

Laundry Room Opt.

Cabinet - Uppers	1111	N/A *****
Cabinet Hardware	1111	N/A *****
Comment		

Mud Room

Flooring	8916	OV.CH.WHT.1224-Chambray-White-12 x 24 See Tile Direction on Sketch 2 Page 18 ***2***								
Floor Tile Grout	7705	Grout-(01) Alabaster ***UPG***								
Floor Tile Pattern	3050	SIDE TO SIDE ***STD***								
<table><tr><td></td><td></td></tr><tr><td></td><td></td></tr><tr><td></td><td></td></tr><tr><td></td><td></td></tr></table>										
Comment										

NAJAM UL HASSAN/  
Project: Wallaceton  
Unit: 381, Phase: 3  
Model: 27-2587 CRN B The Maxwell

Created: 11/8/2021 11:40:23  
Locked:  
Closed:

4 of 43

Powder Room

Flooring	8916	OV.CH.WHT.1224-Chambray-White-12 x 24 See Tile Direction on Sketch 2 Page 18***2***								
Floor Tile Grout	7705	Grout-(01) Alabaster ***UPG***								
Floor Tile Pattern	3050	SIDE TO SIDE ***STD*** <table><tr><td></td><td></td></tr><tr><td></td><td></td></tr><tr><td></td><td></td></tr><tr><td></td><td></td></tr></table>								
Plumbing Fixture (Colour)	1737	Plumbing Fixtures-WHITE ***STD***								

Comment

Dining Room

Flooring	7502	Red Oak Pearl-Vintage Engineered-PEWTER/ECLIPSE-3/4 inch x 3 1/4 inch
----------	------	-----------------------------------------------------------------------

Comment

Great Room

Flooring	7502	Red Oak Pearl-Vintage Engineered-PEWTER/ECLIPSE-3/4 inch x 3 1/4 inch
----------	------	-----------------------------------------------------------------------

Comment

Upper Hall

Flooring	7502	Red Oak Pearl-Vintage Engineered-PEWTER/ECLIPSE-3/4 inch x 3 1/4 inch ***3***
----------	------	-------------------------------------------------------------------------------

Comment

Study

Flooring	7502	Red Oak Pearl-Vintage Engineered-PEWTER/ECLIPSE-3/4 inch x 3 1/4 inch
----------	------	-----------------------------------------------------------------------

Comment



NAJAM UL HASSAN/  
Project: Wallaceton  
Unit: 381, Phase: 3  
Model: 27-2587 CRN B The Maxwell

Created: 11/8/2021 11:40:23  
Locked:  
Closed:

5 of 43

Opt. Finished Basement (Rec) Room/Hall

Flooring 1111 N/A \*\*\*\*\*

Comment

Master Bedroom

Flooring 9248 DY 89418 -Dynasty Tex-BLACK ICE-40 oz Poly\*\*\*STD \*\*\*

Comment

Bedroom 2

Flooring 9248 DY 89418 -Dynasty Tex-BLACK ICE-40 oz Poly\*\*\*STD \*\*\*

Comment

Bedroom 3

Flooring 9248 DY 89418 -Dynasty Tex-BLACK ICE-40 oz Poly\*\*\*STD \*\*\*

Comment

Bedroom 4

Flooring 9248 DY 89418 -Dynasty Tex-BLACK ICE-40 oz Poly\*\*\*STD \*\*\*

Comment

Ensuite 4

Cabinet Colour/Style 9111 VIKING III SIMCOE ORCHID 3DL \*\*\*STD\*\*\*

Countertop 8797 6697-46-Countertop-ARGENTO ROMANO ETCHINGS  
FINISH-Formica \*\*\*STD\*\*\*

NAJAM UL HASSAN/  
Project: Wallaceston  
Unit: 381, Phase: 3  
Model: 27-2587 CRN B The Maxwell

Created: 11/8/2021 11:40:23  
Locked:  
Closed:

6 of 43

Countertop Edge	1111	N/A *****
Cabinet Hardware	7666	96650-HARDWARE ***STD***
Floor Tile	8913	UN.BL.BIA.1224-Biel-Bianco (White)-12 x 24 See Tile Direction on Sketch 4 Page 20 ***2***
Floor Tile Grout	2225	Grout-(27) Silver ***STD***
Floor Tile Pattern	3040	FRONT TO BACK ***STD*** <div><div></div></div>
Plumbing Fixture (colour)	1737	Plumbing Fixtures-WHITE ***STD***
Wall Tile	9020	QT.WV.WHT.0810-Weave-White-8 x 10 ***STD***
Wall Tile Grout	2226	Grout-(00) White ***STD***
Wall Tile Pattern	3090	VERTICAL STACKED ***STD*** <div><div></div></div>
Comment		

Master Ensuite

Cabinet Colour/Style	9156	Viking III-SIMCOE-RAIN CLOUD-3DL ***STD***
Countertop	9069	MSI Quartz GROUP 1 ICED WHITE ***STD***
Countertop Edge	4010	GROUP 1 - SINGLE POLISHED STRAIGHT EDGE 3/4 INCH ***1*** <div><div></div></div>
Cabinet Hardware	7666	96650-HARDWARE ***STD***
Floor Tile	8913	UN.BL.BIA.1224-Biel-Bianco (White)-12 x 24 See Tile Direction on Sketch 4 Page 20 ***2***
Floor Tile Grout	2225	Grout-(27) Silver ***STD***
Floor Tile Pattern	3050	SIDE TO SIDE ***STD*** <div><div></div></div>

NAJAM UL HASSAN/  
Project: Wallaceon  
Unit: 381, Phase: 3  
Model: 27-2587 CRN B The Maxwell

Created: 11/8/2021 11:40:23  
Locked:  
Closed:

7 of 43

Shower Floor Tile	8661	OD.ON.SWT.0202.MT.N-Ontario Series Mosaic-Snow White Matte-2 x 2 ***STD***
Shower Floor Tile Grout	2226	Grout-(00) White ***STD***
Shower Floor Tile Pattern	3000	STANDARD SQUARE ***STD*** <div><div></div><div></div><div></div><div></div><div></div><div></div><div></div><div></div><div></div></div>
Shower Wall Tile	9020	QT.WV.WHT.0810-Weave-White-8 x 10 ***STD***
Shower Wall Tile Grout	2226	Grout-(00) White ***STD***
Shower Wall Tile Pattern	3090	VERTICAL STACKED ***STD*** <div><div></div><div></div><div></div><div></div><div></div><div></div><div></div><div></div><div></div></div>
Shower Jamb(s) and Sill(s)	8923	Shower Jamb / Sill-Thassos White ***STD***
Plumbing Fixture (colour)	1737	Plumbing Fixtures-WHITE ***STD***
Comment		

Shared Bathroom

Cabinet Colour/Style	9156	Viking III-SIMCOE-RAIN CLOUD-3DL ***STD***
Countertop	8796	6698-46-Countertop-PALOMA POLAR ETCHINGS FINISH-Formica ***STD***
Countertop Edge	1111	N/A *****
Cabinet Hardware	7666	96650-HARDWARE ***STD***
Flooring	8913	UN.BL.BIA.1224-Biel-Bianco (White)-12 x 24 See Tile Direction on Sketch 4 Page 20 ***2***
Floor Tile Grout	2225	Grout-(27) Silver ***STD***
Floor Tile Pattern	3040	FRONT TO BACK ***STD*** <div><div></div><div></div><div></div><div></div><div></div><div></div><div></div><div></div><div></div></div>
Wall Tile	9020	QT.WV.WHT.0810-Weave-White-8 x 10 ***STD***

NAJAM UL HASSAN/  
Project: Wallaceton  
Unit: 381, Phase: 3  
Model: 27-2587 CRN B The Maxwell

Created: 11/8/2021 11:40:23  
Locked:  
Closed:

8 of 43



Wall Tile Grout	2226	Grout-(00) White ***STD***								
Shared Bathroom Floor Tile Pattern	3090	VERTICAL STACKED ***STD*** <table><tr><td></td><td></td><td></td><td></td></tr><tr><td></td><td></td><td></td><td></td></tr></table>								
Plumbing Fixture (Colour)	1737	Plumbing Fixtures-WHITE ***STD***								
Shower Floor Tile	8661	OD.ON.SWT.0202.MT.N-Ontario Series Mosaic-Snow White Matte-2 x 2 ***STD***								
Shower Floor Tile Grout	2226	Grout-(00) White ***STD***								
Shower Floor Tile Pattern	3090	VERTICAL STACKED ***STD*** <table><tr><td></td><td></td><td></td><td></td></tr><tr><td></td><td></td><td></td><td></td></tr></table>								
Shower Jamb(s)	8923	Shower Jamb / Sill-Thassos White ***STD***								
Comment										

Opt. Finished Basement Bathroom	111	N/A *****
Shower Floor Tile Grout	1111	N/A *****
Shower Floor Tile Pattern	1111	N/A *****
Shower Wall Tile	1111	N/A *****
Shower Wall Tile Grout	1111	N/A *****
Shower Wall Tile Pattern	1111	N/A *****
Shower Jamb(s)	1111	N/A *****
Cabinet Colour/Style	1111	N/A *****
Countertop	1111	N/A *****





NAJAM UL HASSAN/  
Project: Wallaceton  
Unit: 381, Phase: 3  
Model: 27-2587 CRN B The Maxwell

Created: 11/8/2021 11:40:23  
Locked:  
Closed:

9 of 43

Countertop Edge	1111	N/A *****
Cabinet Hardware	1111	N/A *****
Flooring	1111	N/A *****
Floor Tile Grout	1111	N/A *****
Floor Tile Pattern	1111	N/A *****
Plumbing Fixture (Colour)	1111	N/A *****
Comment		

Great Room Fireplace

Type	8869	Majestic MERC32 ***STD***
Mantle	8891	NF-17-Paint Grade Mantle- Cabinet (Per Plan)-WHITE ***STD*** PAGE 21
Surround Opt.	1111	N/A *****
Disclaimer	1111	Purchasers have been advised: heat from the FP can damage TV above a FP and items placed on mantle.
Disclaimer	1111	Heathwood and its contractors will not be liable for any damage on items placed/installed above a FP after closing.
Comment		

Basement Stairs

Type	1713	Paint Grade Stairs ***STD BASEMENT STAIR ***
Colour	1111	N/A *****
Carpet Runner	1111	N/A *****
Handrail/Pickets/Post Type	9119	Handrail only on closed walls (one or two sides per building code) ***STD***
Handrail/Pickets/Post Colours	1111	N/A *****
Carpet	1111	N/A *****

Customer Colours

356

NAJAM UL HASSAN/  
Project: Wallaceton  
Unit: 381, Phase: 3  
Model: 27-2587 CRN B The Maxwell

Created: 11/8/2021 11:40:23  
Locked:  
Closed:

10 of 43

Custom Stain/Paint

Comment

Main Stairs

Type	1712	Oak Stairs ***STD MAIN STAIRS***
Colour	7922	Eclipse (Pewter) STAIN TO COMPLIMENT HARDWOOD AND WILL VARY FROM FLOORING ***99***
Carpet Runner	1111	N/A *****
Handrail/Pickets/Posts Type	8149	Double Collar Alt. Plain w/ Shoes with 3 1/2" Square/Cap Post(s)-BLACK
Handrail/Pickets/Posts Colour	7761	Oak Grade-Stain handrail,stringers,treads,risers,nosingpost
Custom Stain/Paint	1111	N/A *****
Comment		

Throughout

Walls - Paint Colour	1717	22-Wall-WARM GREY ***STD***
Underpad	1079	500 Series-Underpad ***STD***
Thresholds	2232	Metal Thresholds ***STD***
Switches and Plug	5796	Decora White Switches and Plugs ***STD***
Trim Size	8705	4 1/4 Baseboard and 2 3/4 Casings ***STD***
Trim - Paint Colour	1716	Trim-WHITE ***STD***
Comment		

Purchaser:



NAJAM UL HASSAN

Nov 10/21

Date

TINA LEFUR

Nov 10/21

Decor Consultant

Date



-03- 0 2 2022



CONSTRUCTION SUMMARY

Lot: 381  
Model: 27-2587 CRN B The Maxwell  
Project/Phase: Wallaceton / 3

Offer Worksheet	Ten Thousand Dollars (\$10,000) At D?cor. (No Cash Value) Singles Note:
Offer Worksheet	The Purchaser(s) acknowledge that they have NOT been referred by an existing Heathwood Homeowner and therefor are not entitled to a referral fee under Heathwood Homes Referral program. Note:
Offer Worksheet	SCHEDULE X: ITEM #5 ADJUSTMENTS (e) AND (f) COMBINED TO BE CAPPED AT \$5,000 Note:



CONSTRUCTION SUMMARY

Lot: 381  
Model: 27-2587 CRN B The Maxwell  
Project/Phase: Wallaceton / 3

ADMIN FEE

Invoice	Qty.	Description
914  03Mar22 NoCat	1	- TEN THOUSAND DOLLARS (\$10,000.00) AT DECOR. (NO CASH VALUE)

APPLIANCES

Invoice	Qty.	Description
914 313,485 03Mar22	1	KITCHEN - APPLIANCES - CYCLONE 36 INCH WALL MOUNT CHIMNEY HOOD SS - SCB51436  SPECS PAGES 34-35 <b>CABINETRY - delete stove uppers; ELECTRICAL - delete std range hood; HEATING/AIR CONDITIONING - D change to 6"</b>
914 314,277 03Mar22 **	1	KITCHEN - GRANITE - GRANITE CUTOUT W/ STRAIGHT EDGE POLISH TO ACCOMMODATE COOK TOP  COOKTOP SPECS PAGES 38-39

CABINETRY

Invoice	Qty.	Description
914 313,485 03Mar22 **	1	KITCHEN - APPLIANCES - CYCLONE 36 INCH WALL MOUNT CHIMNEY HOOD SS - SCB51436  SPECS PAGES 34-35 <b>CABINETRY - delete stove uppers; ELECTRICAL - delete std range hood; HEATING/AIR CONDITIONING - D change to 6"</b>
914 334,744 03Mar22	1	KITCHEN - CABINETRY - VIKING I/II/III KITCHEN BUILT IN - KITCHEN - UPG  SKETCH # 3 SPECS PAGES 36-43 <b>GRANITE - delete partial countertop due to Built-in</b>
914 314,277 03Mar22 **	1	KITCHEN - GRANITE - GRANITE CUTOUT W/ STRAIGHT EDGE POLISH TO ACCOMMODATE COOK TOP  COOKTOP SPECS PAGES 38-39

CARPET

Invoice	Qty.	Description
914 331,672 03Mar22 **	1	- HARDWOOD - VINTAGE - 3-1/4" RED OAK ENGINEERED - UPPER HALL - STANDARD SERIES  <b>CARPET - delete std CARPET; INTERIOR TRIM - supply and install quarter rounds; PAINTING - paint quarter</b>





CONSTRUCTION SUMMARY

Lot: 381  
Model: 27-2587 CRN B The Maxwell  
Project/Phase: Wallaceton / 3

CERAMICS

Invoice	Qty.	Description
914 331,493 03Mar22	1	- CERAMICS - FLOOR - KITCHEN - UPGRADE 2
914 331,470 03Mar22	1	- CERAMICS - FLOOR - FOYER - UPGRADE 2
914 331,514 03Mar22	1	- CERAMICS - FLOOR - POWDER ROOM - UPGRADE 2
914 331,477 03Mar22	1	- CERAMICS - FLOOR - GARAGE ENTRY / MUD ROOM - UPGRADE 2
914 331,463 03Mar22	1	- CERAMICS - FLOOR - ENSUITE MASTER - UPGRADE 2
914 331,456 03Mar22	1	- CERAMICS - FLOOR - ENSUITE 4 - UPGRADE 2
914 331,500 03Mar22	1	- CERAMICS - FLOOR - LAUNDRY ROOM - UPGRADE 2
914 331,521 03Mar22	1	- CERAMICS - FLOOR - SHARED ENSUITE - UPGRADE 2
914 331,529 03Mar22	1	- CERAMICS - FLOOR GROUT - FOYER - GROUT
914 331,530 03Mar22	1	- CERAMICS - FLOOR GROUT - GARAGE ENTRY / MUD ROOM - GROUT
914 331,531 03Mar22	1	- CERAMICS - FLOOR GROUT - KITCHEN - GROUT
914 331,534 03Mar22	1	- CERAMICS - FLOOR GROUT - POWDER ROOM - GROUT



CONSTRUCTION SUMMARY

Lot: 381  
Model: 27-2587 CRN B The Maxwell  
Project/Phase: Wallaceton / 3

COFFERED CEILING

Invoice	Qty.	Description
914 331,622 03Mar22	1	- COFFERED CEILING - OPT. COFFERED CEILING - GREAT ROOM  DRYWALL - notification; PAINTING- notification

DRYWALL

Invoice	Qty.	Description
914 334,744 03Mar22 **	1	KITCHEN - CABINETRY - VIKING I/II/III KITCHEN BUILT IN - KITCHEN - UPG  SKETCH # 3    SPECS PAGES 36-43 GRANITE - delete partial countertop due to Built-in
914 331,622 03Mar22 **	1	- COFFERED CEILING - OPT. COFFERED CEILING - GREAT ROOM  DRYWALL - notification; PAINTING- notification

ELECTRICAL

Invoice	Qty.	Description
914 313,485 03Mar22 **	1	KITCHEN - APPLIANCES - CYCLONE 36 INCH WALL MOUNT CHIMNEY HOOD SS - SCB51436  SPECS PAGES 34-35 CABINETRY - delete stove uppers; ELECTRICAL - delete std range hood; HEATING/AIR CONDITIONING - D change to 6"
914 314,223 03Mar22	2	- ELECTRICAL - ADDITIONAL SWITCH  1) TO BE LOCATED WITH CAPPED ELCTRICAL IN GREAT ROOM 2) TO BE LOCATED WITH CAPPED ELCTRICAL ON ISLAND   SKETCH # 2
914 314,224 03Mar22	2	- ELECTRICAL - CEILING ROUGH-IN (CAPPED)  1) TO BE CENTERED +/- ON GREAT ROOM CEILING ON SEPERATE SWITCH 2) TO BE CENTERED +/- ON ISLAND ON SEPERATE SWITCH. SEE SKETCH # 2
914 314,232 03Mar22	1	GREAT ROOM - ELECTRICAL - EXTRA WALL INTERIOR OUTLET ON EXISTING CIRCUIT (DOES NOT INCLUDE KITCHEN OUTLETS)  TO BE CENTERED +/- ABOVE THE FIREPLACE APPROX. 70" +/- FROM FLOOR. SEE SKETCH # 2
914 314,242 03Mar22	1	KITCHEN - ELECTRICAL - RELOCATION OF SWITCHES/LIGHTS (MUST SPECIFY LOCATION) - NOTE: PLUGS CANNOT BE RELOCATED- MUST PURCHASE ADDITIONAL OUTLET.  240V 40 AMP ELECTRICAL PLUG TO BE RELOCATED TO BUILT-IN MICRO/OVEN LOCATION SKETCH # 3 SPEC PAGES 40-41

FRAMING

Invoice	Qty.	Description
914 334,744 03Mar22 **	1	KITCHEN - CABINETRY - VIKING I/II/III KITCHEN BUILT IN - KITCHEN - UPG  SKETCH # 3    SPECS PAGES 36-43 GRANITE - delete partial countertop due to Built-in



CONSTRUCTION SUMMARY

Lot: 381  
Model: 27-2587 CRN B The Maxwell  
Project/Phase: Wallaceton / 3

GRANITE

Invoice	Qty.	Description
914 334,744 03Mar22 **	1	KITCHEN - CABINETRY - VIKING I/II/III KITCHEN BUILT IN - KITCHEN - UPG  SKETCH # 3    SPECS PAGES 36-43 <b>GRANITE - delete partial countertop due to Built-in</b>
914 314,277 03Mar22	1	KITCHEN - GRANITE - GRANITE CUTOUT W/ STRAIGHT EDGE POLISH TO ACCOMMODATE COOK TOP  COOKTOP SPECS PAGES  38-39
914 314,524 03Mar22 **	1	MASTER ENSUITE - PLUMBING - MOEN - VICHY - LAV SINGLE HANDLE FAUCET WITH LIFT ROD DRAIN - CHROME (MODEL: 6710) -  SPEC PAGE  30 <b>GRANITE - Cut to accomodate Faucet</b>
914 314,411 03Mar22 **	1	- PLUMBING - KITCHEN SINK UPGRADE - BLANCO KITCHEN SINK QUATRUS U 2 #401247 (32 INCH X 18 INCH ) UNDERMOUNT 2 BOWL EQUAL SIZE 9 INCH DEEP IN STAINLESS STEEL -  SPEC PAGE 22 <b>GRANITE - upgraded kitchen sink</b>
914 331,629 03Mar22	1	- GRANITE - COUNTERTOP - 3/4" GROUP 1 WITH MITRE EDGE - KITCHEN / ISLAND - UPG

HARDWOOD

Invoice	Qty.	Description
914 331,672 03Mar22	1	- HARDWOOD - VINTAGE - 3-1/4" RED OAK ENGINEERED - UPPER HALL - STANDARD SERIES  <b>CARPET - delete std CARPET; INTERIOR TRIM - supply and install quarter rounds; PAINTING - paint quarter</b>

HEATING / AIR CONDITIONING

Invoice	Qty.	Description
914 313,485 03Mar22 **	1	KITCHEN - APPLIANCES - CYCLONE 36 INCH WALL MOUNT CHIMNEY HOOD SS - SCB51436  SPECS PAGES  34-35 <b>CABINETRY - delete stove uppers; ELECTRICAL - delete std range hood; HEATING/AIR CONDITIONING - D change to 6"</b>
914 314,340 03Mar22	1	KITCHEN - HEATING/AIR - ROUGH-IN GAS LINE FOR GAS STOVE AT MAIN FLOOR (SEE SPECS) (HOOK-UP NOT INCLUDED) LEAVE STANDARD 120 VOLT ELECTRICAL OUTLET ON A SEPARATE CIRCUIT. *  STANDARD 220V WILL  BE RELOCATED TO BUILT-IN MICRO/OVEN LOCATION SKETCH #  3  SPECS PAGES 38-39 <b>ELECTRICAL - notification</b>
914 314,337 03Mar22	1	- HEATING/AIR - ROUGH-IN GAS LINE FOR BBQ AT MAIN FLOOR UP TO 40 FT (QUICK CONNECT NOT INCLUDED); ELECTR ICAL OUTLET PRICED SEPARATELY IF REQUIRED  SEE SKETCH #  2  FOR LOCATION

INTERIOR RAILINGS

Invoice	Qty.	Description
914 334,709 03Mar22	1	- Interior Railings - BLACK METAL - DOUBLE COLLAR SPOON ALT. PLAIN W/ SHOES WITH 3 1/2” SQUARE/CAP POST(S) AS PER PLAN - Main Stair - UPG



CONSTRUCTION SUMMARY

Lot: 381  
Model: 27-2587 CRN B The Maxwell  
Project/Phase: Wallaceton / 3

INTERIOR TRIM AND DOORS

Invoice	Qty.	Description
914 331,672 03Mar22 **	1	- HARDWOOD - VINTAGE - 3-1/4" RED OAK ENGINEERED - UPPER HALL - STANDARD SERIES  CARPET - delete std CARPET; INTERIOR TRIM - supply and install quarter rounds; PAINTING - paint quarter

PAINTING

Invoice	Qty.	Description
914 334,744 03Mar22 **	1	KITCHEN - CABINETRY - VIKING I/II/III KITCHEN BUILT IN - KITCHEN - UPG  SKETCH # 3    SPECS PAGES 36-43 GRANITE - delete partial countertop due to Built-in
914 331,622 03Mar22 **	1	- COFFERED CEILING - OPT. COFFERED CEILING - GREAT ROOM  DRYWALL - notification; PAINTING- notification
914 331,672 03Mar22 **	1	- HARDWOOD - VINTAGE - 3-1/4" RED OAK ENGINEERED - UPPER HALL - STANDARD SERIES  CARPET - delete std CARPET; INTERIOR TRIM - supply and install quarter rounds; PAINTING - paint quarter

PLUMBING

Invoice	Qty.	Description
914 314,524 03Mar22	1	MASTER ENSUITE - PLUMBING - MOEN -VICHY - LAV SINGLE HANDLE FAUCET WITH LIFT ROD DRAIN - CHROME (MODEL: 6710) -  SPEC PAGE 30 GRANITE - Cut to accomodate Faucet
914 314,411 03Mar22	1	- PLUMBING - KITCHEN SINK UPGRADE - BLANCO KITCHEN SINK QUATRUS U 2 #401247 (32 INCH X 18 INCH ) UNDERMOUNT 2 BOWL EQUAL SIZE 9 INCH DEEP IN STAINLESS STEEL -  SPEC PAGE 22 GRANITE - upgraded kitchen sink



UK 3 WALLACETON  
LOT 381  
27-2587 CRN ELEV B  
THE MAXWELL

17 of 43

Sketch #1

THE MAXWELL

27-2587 ELEV. B

ELEVATION B | 2,593 SQ. FT.  
Includes 735 sq. ft. of opt. finished Lower Level  
WALLACETON  
EST. 1870

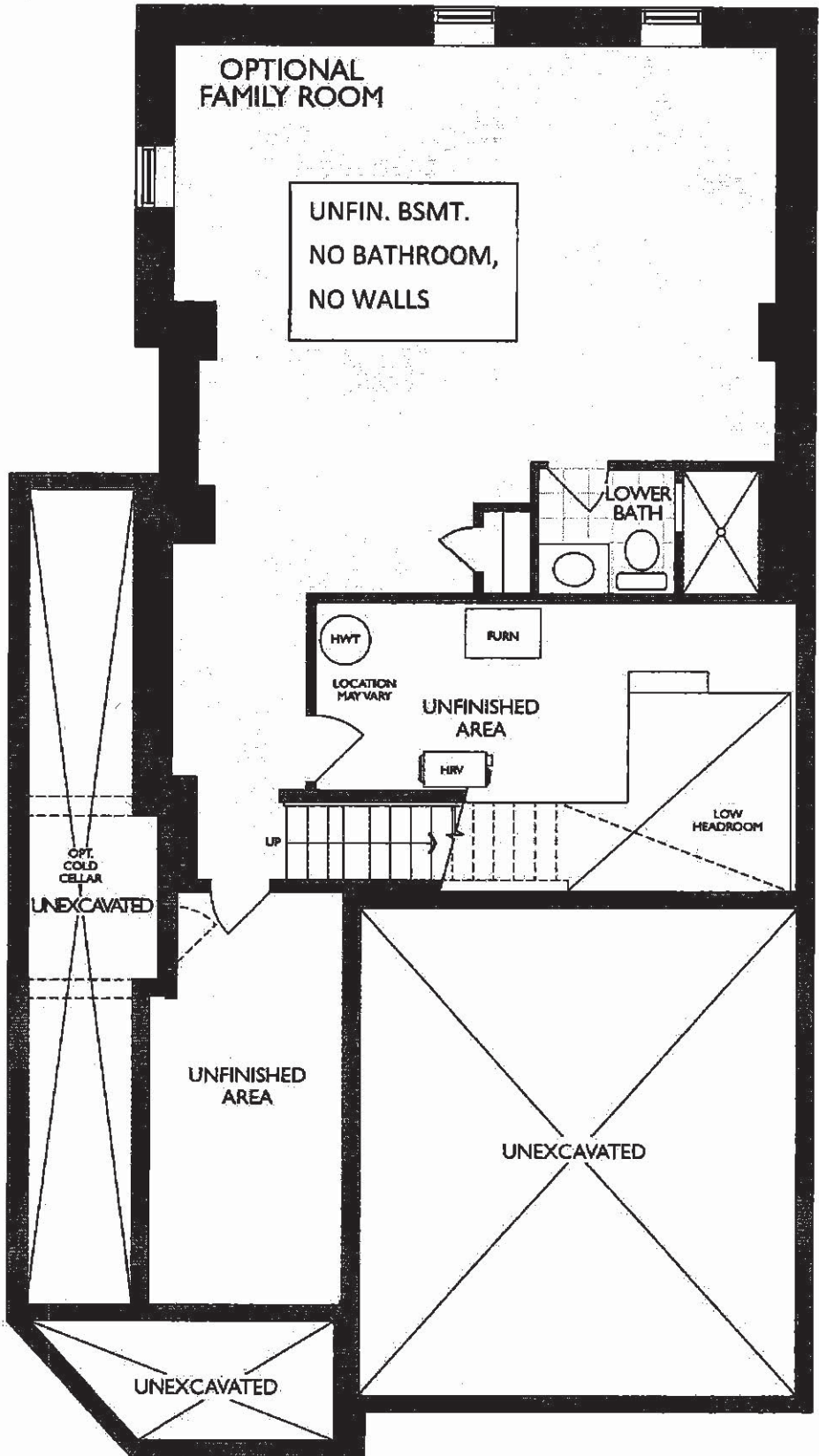

LOWER LEVEL  
ELEVATION B

N H

UK 3 WALLACETON  
LOT 381  
27-2587 CRN ELEV B  
THE MAXWELL

18 of 43

Sketch #2

THE MAXWELL

27-2587 ELEV. B

ELEVATION B | 2,593 SQ. FT.  
Includes 735 sq. ft. of opt. finished Lower Level  
WALLACETON  
EST. 1870

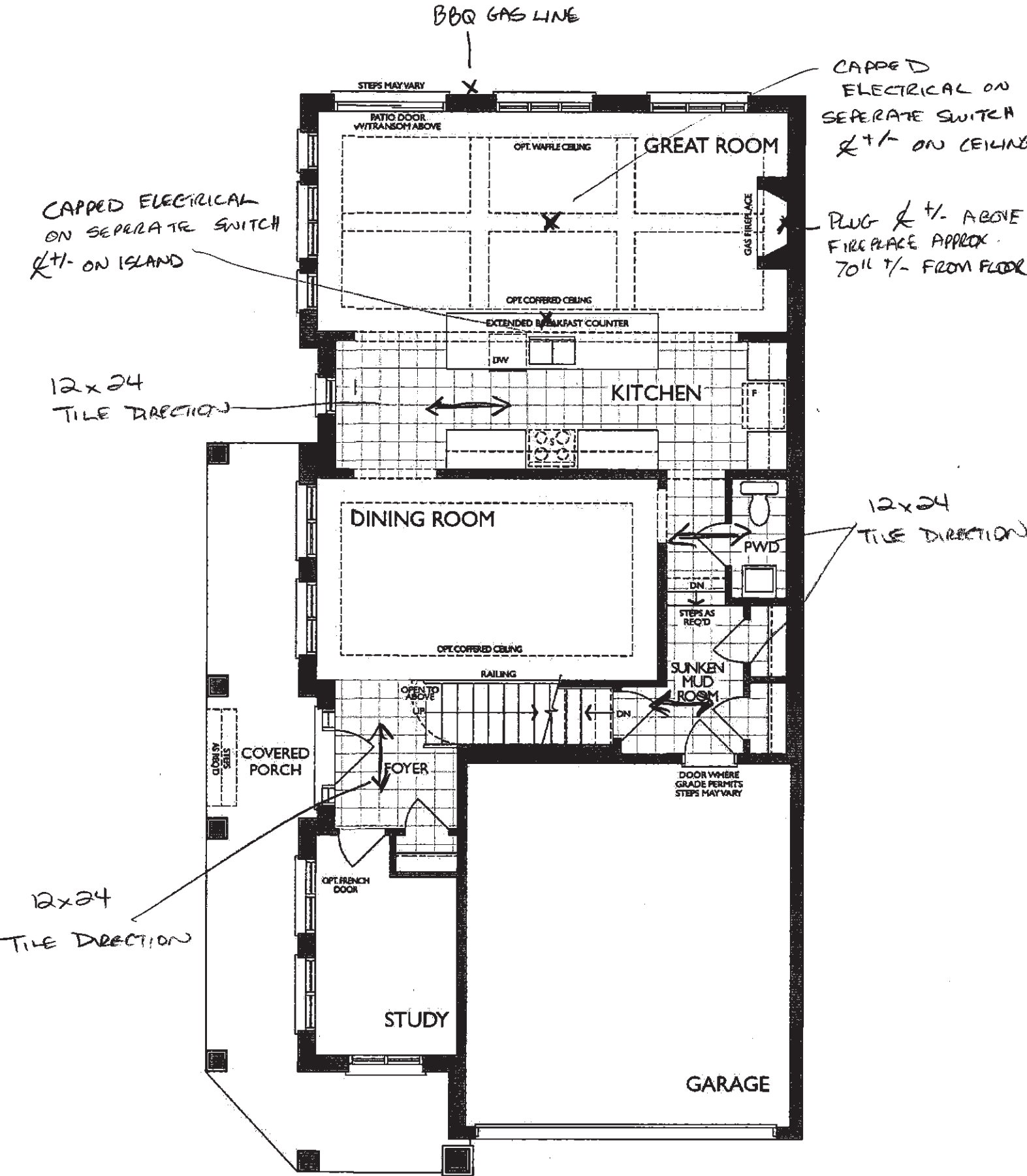

MAIN FLOOR  
ELEVATION B

PT. DBL SINK V90+LT90+V90)  
2/12/2021

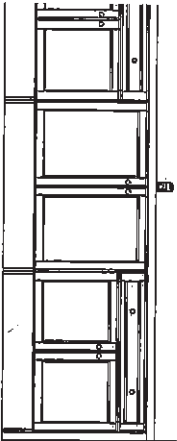

MASTER ENSUITE  
(2ND FLR)

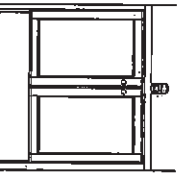

BED 4 BATH  
(2ND FLR)

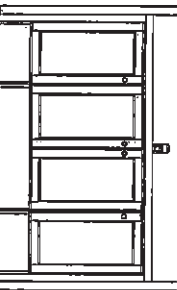

SHARED BATH A  
(2ND FLR - ELEV. A)

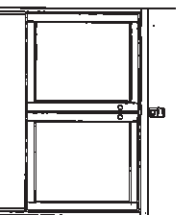

OR  
ALT. SHARED BATH B  
(2ND FLR - ELEV. B)

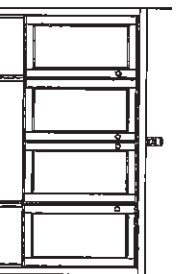

ALT. SHARED BATH C & D  
(2ND FLR - ELEV. C)

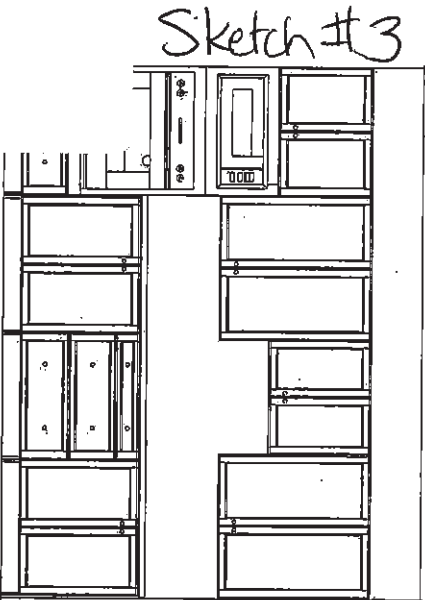

Sketch #3

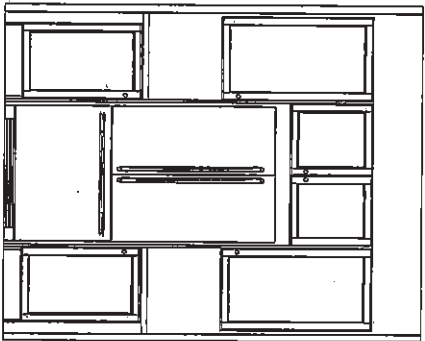

KITCHEN  
(GROUND FLOOR)

DEEP FRIDGE  
UPPERS  
STD.

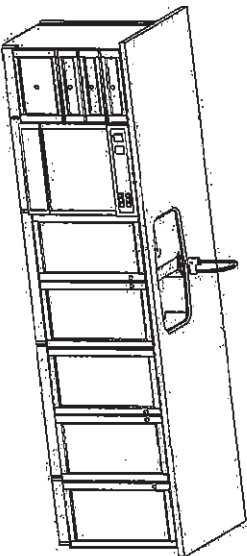

OPT. LAUNDRY UPPERS  
OPT. LAUNDRY BASE  
(2ND FLR)

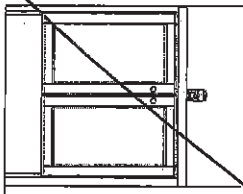
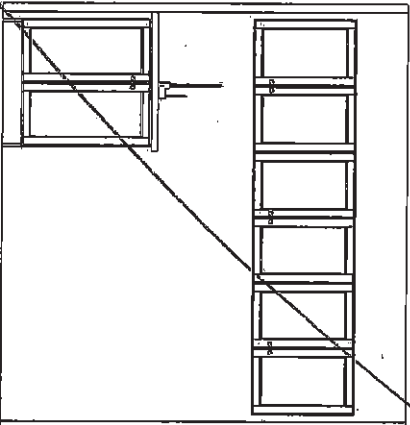

OPT. BASEMENT BATH

36" CHIMNEY HOOD (FAN)



F R E N D L E  
K I T C H E N S L I M I T E D  
1350 Stevenson Drive, Mississippi, ON L4W 1G9

HEATHWOOD HOMES  
WALLACETON, KITCHENER ON  
MODEL: 27-2587 CRN (3106)

STANDARD CONTRACT INCLUDES:

Appliance Openings

- Hood: 30"W builder hood
- Fridge Opening: 37 3/8 "W X 73 3/8"
- Fridge cabinet & gables: 66cm Deep
- Cooktop: 30"W - Tall Wall Oven: 30"W
- Dishwasher Opening: 24"

Standard Kitchens Scope:

- 100cm H wall cabinets
- Std. Blumotion Hinges- **soft close doors**
- Std. Metabox Drawers- **not soft close**
- Min 40cm W drawer
- Base pie cut corner cabinets
- Backing on all cabinets
- Countertop by others
- Upgrade applied paneled fridge & dishwashers supply only (appliance hardware by others)

Standard Vanity & Laundry Scope:

- Powder by others, pedestal
- Master Ens. - Top by others
- Remaining vanities inc. laminate top
- Std. Blumotion Hinges- **not soft close**
- Std. Metabox Drawers- **not soft close**
- Master Ens: Top drawers (Sink Full height)
- Mains: Full height doors (top drawers added if Masters can't accommodate)
- Optional laundry base & wall cabinets

UK 3 WALLACETON  
LOT 381  
27-2587 CRN ELEV B  
THE MAXWELL

20 of 43

Sketch # 4

# THE MAXWELL

ELEVATION B | 2,593 SQ. FT.

Includes 735 sq. ft. of opt. finished Lower Level

## WALLACETON

EST. 1870

27-2587 ELEV. B

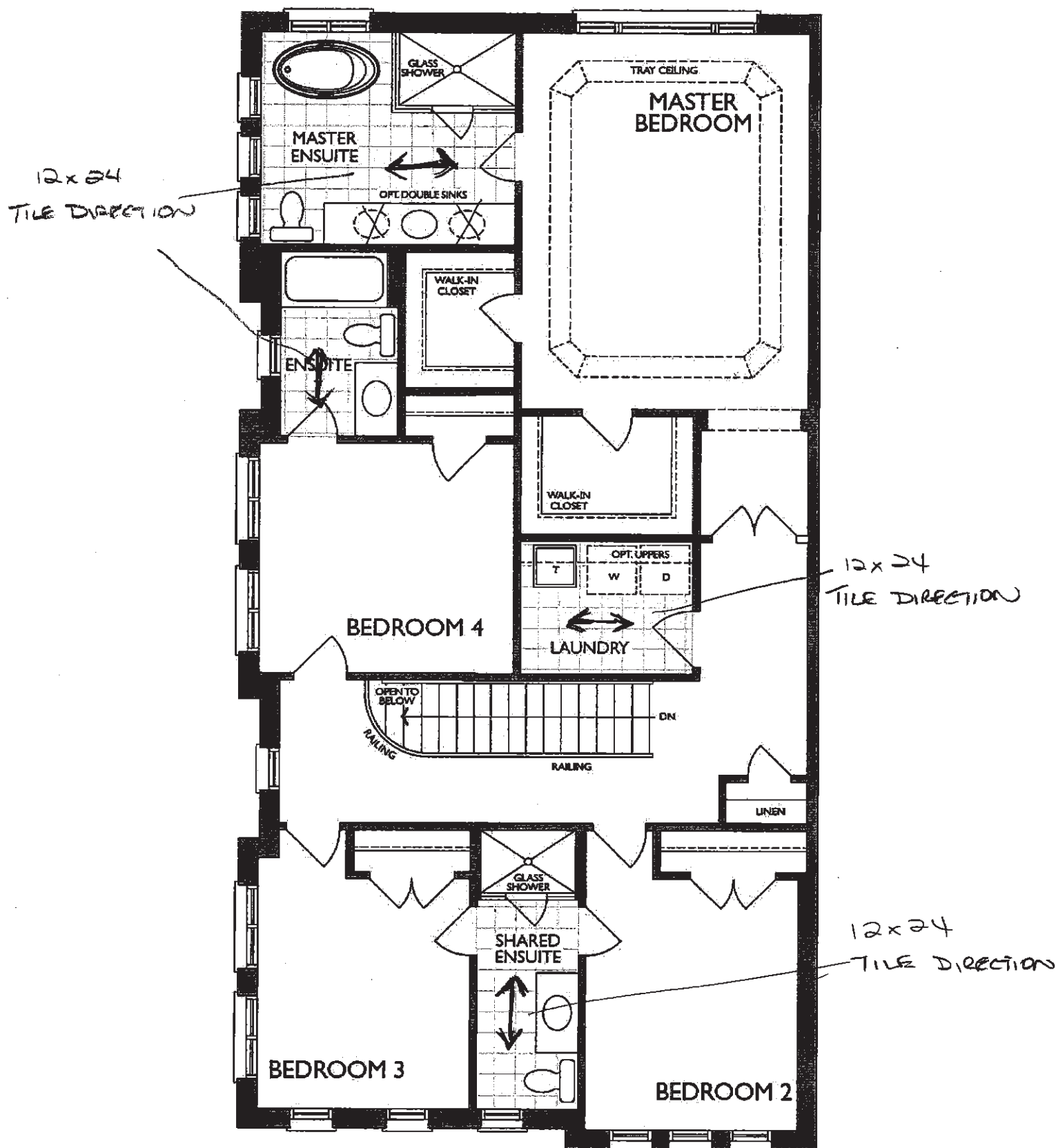

SECOND FLOOR  
ELEVATION B

N.A

Legal Plan Jan. 8, 2021



H.N

UK 3 WALLACETON  
LOT 381  
27-2587 CRN ELEV B  
THE MAXWELL

21 of 43

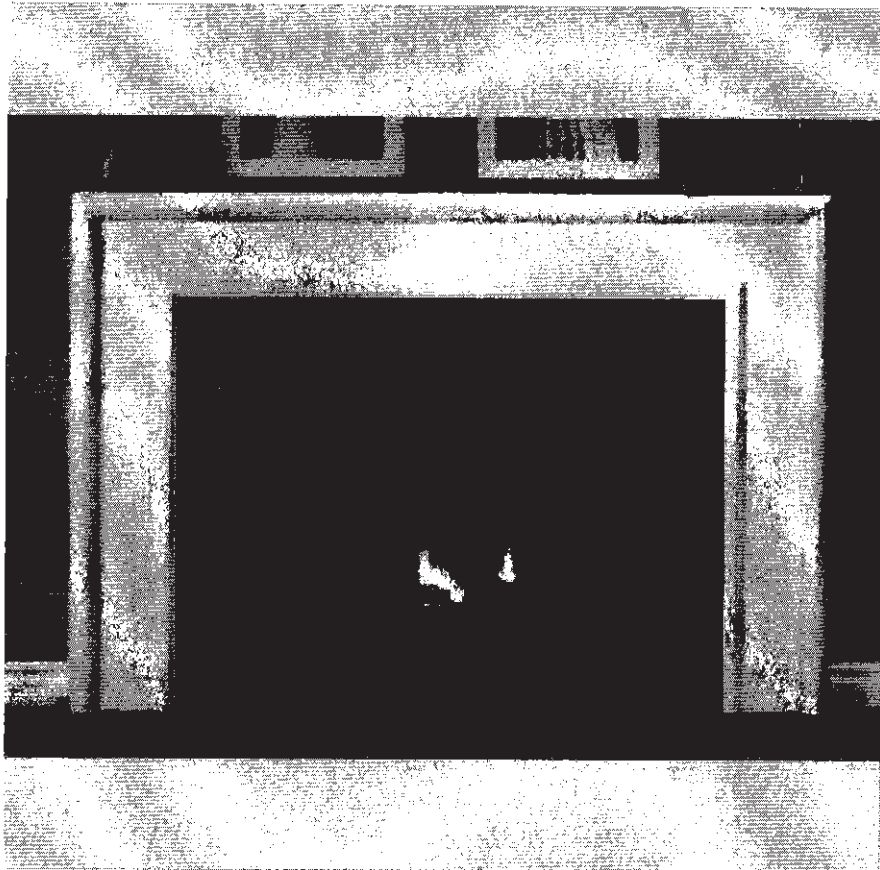

NEAS NF17 Mantel — CABINET

2 H

UK 3 WALLACETON  
LOT 381  
27-2587 CRN ELEV B  
THE MAXWELL

22 of 43

# BLANCO

## Sink Specifications

Colour	SKU
brushed finish	401247

## QUATRUS U 2

Stainless steel brushed finish

### Design and planning tips

- Min cabinet size: 36 in ( 915 mm )
- Bowl Depth: 9 in ( 230.0 mm )

Specifications:  
Installation clips, Sink template, Installation instructions, 3  
½" (90 mm) stainless steel strainers

Depending on cabinet construction, a different cabinet  
size may be required. Consult the cabinet manufacturer.  
Codes/Standards: ASME A112.19.3-2017/ CSA B45.4-17

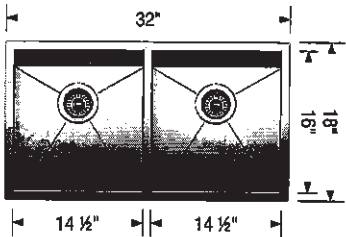

### Optional Accessories

CapFlow Strainer Cover	517666
Workstation	406344
Ash Cutting Board	406345
Sink Grid	406349

**Warranty**  
Limited lifetime warranty on all sinks and faucets. One-year warranty on all accessories and soap dispensers.

**Code/Standards Compliance**  
BLANCO sinks and faucets are third-party tested and certified to CSA, cUPC, ANSI/ASME, IAPMO and NSF standards and listed by applicable certification bodies. For more information on individual product listings, contact our office or listing organization.

 Need support? Learn more by watching our sink & faucet How-to videos:  
<https://www.blanco.com/ca-en/support/how-to-videos/how-to-videos-for-sinks/>

	BLANCO Canada Inc 100 Corporation Drive Brampton ON L6S 6B5	Tel & Fax Tel: 905-494-2400 Toll free: 1-877-425-2626 Fax: 905-494-2425 Toll free: 1-877-825-2626
-------------------------------------------------------------------------------------	-------------------------------------------------------------------	---------------------------------------------------------------------------------------------------------

While BLANCO strives to provide accurate information, all images and dimensions in this document are intended for reference only and are subject to change at any time without notice. This document is not intended for use as an installation guide. For technical installation details, refer to installation instructions provided with the product. BLANCO assumes no responsibility for the use of superseded or voided specifications.

2 H

UK 3 WALLACETON  
LOT 381  
27-2587 CRN ELEV B  
THE MAXWELL

23 of 43

**MOEN®**

There is more than 1 version of this model.  
Page down to identify the version you have.

**FAUCET DESCRIPTION**

- Reflex™ pulldown system offers smooth operation, easy movement and secure docking
- Power Clean™ spray technology
- Metal construction with various finishes identified by suffix
- Duralock™ connect installation
- Pulldown spray with 68" braided hose
- Flexible supply lines with 3/8" compression fittings
- High arc spout provides height and reach to fill or clean large pots while pulldown wand provides the maneuverability for cleaning or rinsing
- 360° rotating spout
- Faucet designed for handle to be mounted on right side only

**OPERATION**

- Lever style handle
- Temperature controlled by 100° arc of handle travel
- Operates with less than 5 lbs. of force
- Operates in stream or spray mode in the pullout or retracted position

**FLOW**

- Flow is limited to 1.5 gpm (5.7 L/min) max at 60 psi

**CARTRIDGE**

- 1255™ Duralast™ cartridge

**STANDARDS**

- Third party certified to IAPMO Green, ASME A112.18.1/CSA B125.1 and all applicable requirements therein including NSF 61/9G & 372
- Meets CalGreen and Georgia SB370 requirements
- Complies with California Proposition 65 and with the Federal Safe Drinking Water Act
- The backflow protection system in the device consists of two independently operating check valves, a primary and a secondary which prevent backflow

- **ADA**  for lever handle

**WARRANTY**

- Lifetime limited warranty against leaks, drips and finish defects to the original homeowner
  - 10 year limited warranty when used in a multifamily installation
  - 5 year limited warranty when used in a commercial installation
- Visit [www.moen.com/support](http://www.moen.com/support) for complete details and limitations

*Specifications*

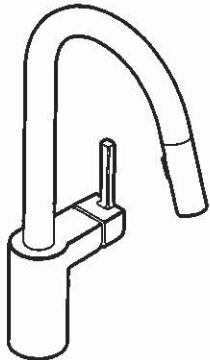

**ALIGN™**  
**Single Handle High Arc  
Pulldown Kitchen Faucet**

**Models:** 7565 series

**NOTE:** THIS FAUCET IS DESIGNED TO BE INSTALLED  
THROUGH 1 HOLE, 1-1/2" (38mm) MIN. DIA.  
(OPTIONAL 3-HOLE ESCUTCHEON 141002 AVAILABLE)

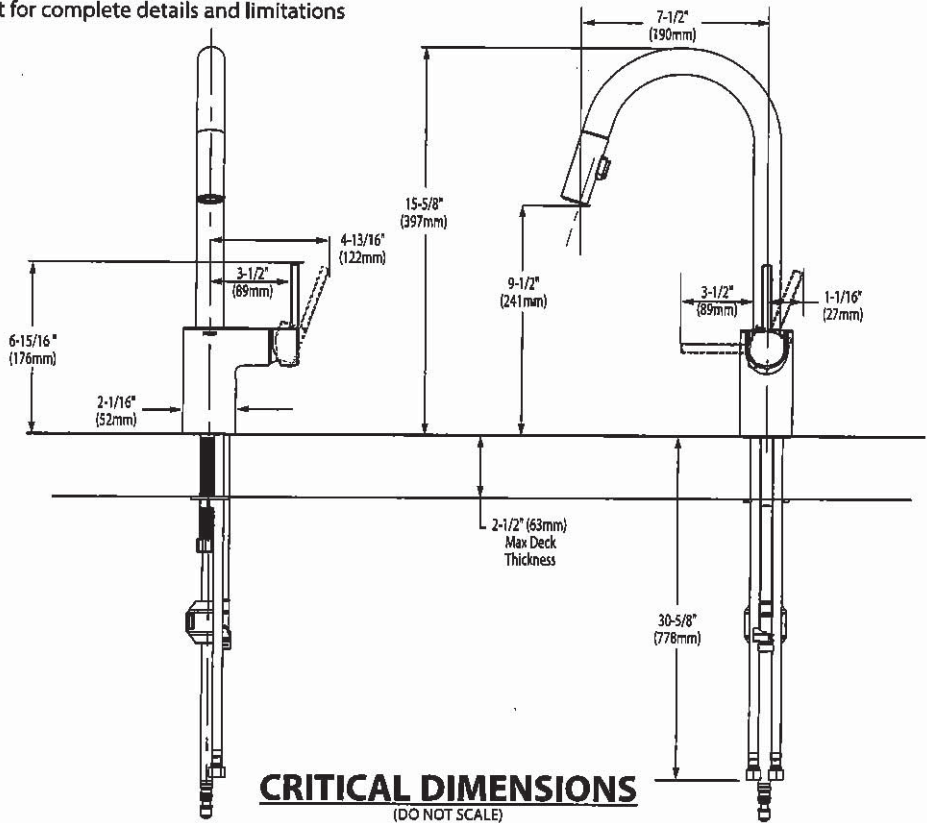

2-7

UK 3 WALLACETON  
LOT 381  
27-2587 CRN ELEV B  
THE MAXWELL

24 of 43

*American  
Standard*

 **BARRIER FREE (ABOVE COUNTER OR DROP-IN ONLY)**

**BOULEVARD®  
PEDESTAL SINK**  
VITREOUS CHINA

**BOULEVARD® PEDESTAL SINK**

- STD ☒ **0641.800** Faucet holes on 8" (203mm) centers (Illustrated)
- ☒ **0641.400** Faucet holes on 4" (102mm) centers
- ☐ **0641.100** Center hole only
- Classic styled rectangular pedestal lavatory
  - Vitreous china
  - Rear overflow
  - Supplied with mounting kit
  - Right Height® for greater comfort during use
  - Faucet ledge with large deck area (faucet not included)
  - **Design coordinates with Boulevard® Toilet**
  - Basin has flat bottom to also allow use as an **above counter** sink or a **drop-in** sink (with u-shaped cut out)

**Nominal Dimensions:**

24" x 19" x 35-1/2"  
(610 x 483 x 902mm)

- ☐ **0641.008** Pedestal top-8" (203mm) centers
- ☐ **0641.004** Pedestal top-4" (102mm) centers
- ☐ **0641.001** Pedestal top-center hole only
- ☐ **0010.000** Pedestal only

**Bowl sizes:**

17" (432mm) wide,  
12-1/2" (318mm) front to back,  
5" (127mm) deep

**Compliance Certifications -**

**Meets or Exceeds the Following Specifications:**

- ASME A112.19.2 - 2008/CSA B45.1-08

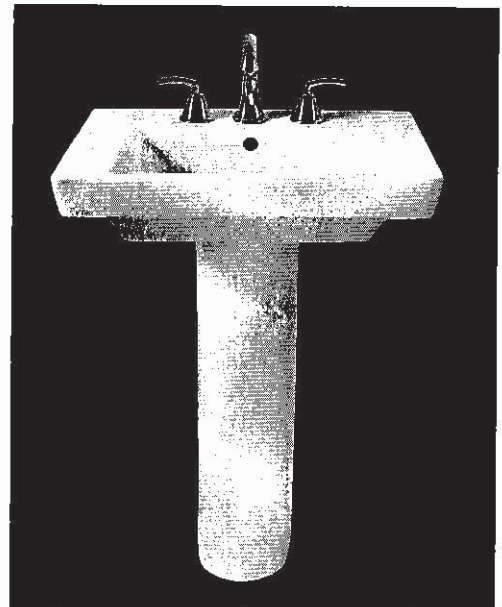

SEE REVERSE FOR ROUGHING-IN DIMENSIONS

**To Be Specified:**

- ☐ Color: ☐ White ☐ Linen
- ☐ Faucet Finish:
- ☐ Supplies:
- ☐ 1-1/4" Trap:
- ☐ Nipple:

\* See faucet section for additional models available

NH



UK 3 WALLACETON  
LOT 381  
27-2587 CRN ELEV B  
THE MAXWELL

25 of 43



Ovalyn™  
Undercounter Sink  
VITREOUS CHINA



Ovalyn™ Undercounter Sink

- ☐ 0495.221 Unglazed rim
- ☐ 0495.300 Glazed underside (made to order)
  - Classic oval undermount sink
  - Unglazed rim
  - Made from vitreous china
  - Front overflow
  - Supplied with mounting kit (047194-0070A) and template

Nominal Dimensions  
17-1/8" x 14-1/8" (435 x 359mm)

Bowl size:  
15-1/16" (382mm) wide  
12-1/16" (306mm) front to back  
5-1/2" (140mm) deep

- ☒ 0496.221 Unglazed rim
- ☐ 0496.300 Glazed underside (made to order)

Nominal Dimensions  
19-1/4" x 16" (489 x 406mm)

Bowl size:  
17" (432mm) wide  
14" (356mm) front to back  
5-1/2" (140mm) deep

- ☐ 0497.221 Unglazed rim
- ☐ 0497.300 Glazed underside

Nominal Dimensions  
21-1/2" x 17-3/8" (546 x 441mm)

Bowl size:  
19" (483mm) wide  
15-3/8" (391mm) front to back  
5-1/2" (140mm) deep

Compliance Certifications -  
Meets or Exceeds the Following Specifications:

- ASME A112.19.2M for Vitreous China Fixtures
- CAN/CSA B45 series

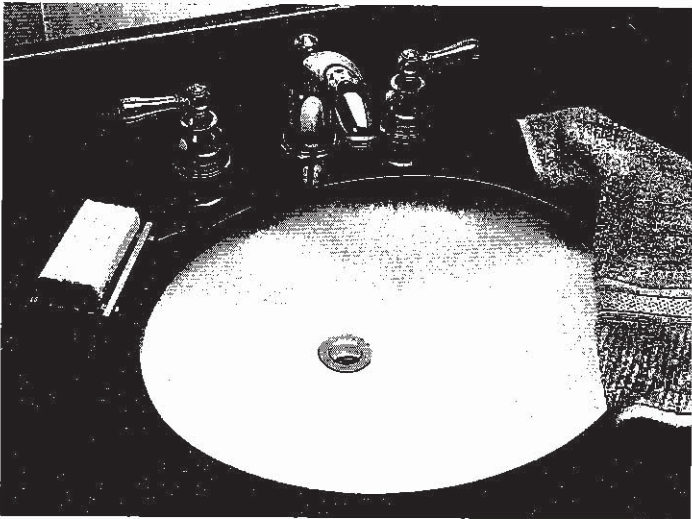

SEE REVERSE FOR ROUGHING-IN DIMENSIONS

MASTER ENSUITE

To Be Specified:

- ☐ Color: ☒ White ☐ Bone ☐ Linen
- ☐ Faucet:
- ☐ Faucet Finish:
- ☐ Supplies:
- ☐ 1-1/4" Trap:

\* See faucet section for additional models available

2-11

UK 3 WALLACETON  
LOT 381  
27-2587 CRN ELEV B  
THE MAXWELL

26 of 43



Ovalyn™  
Undercounter Sink  
VITREOUS CHINA

BARRIER FREE

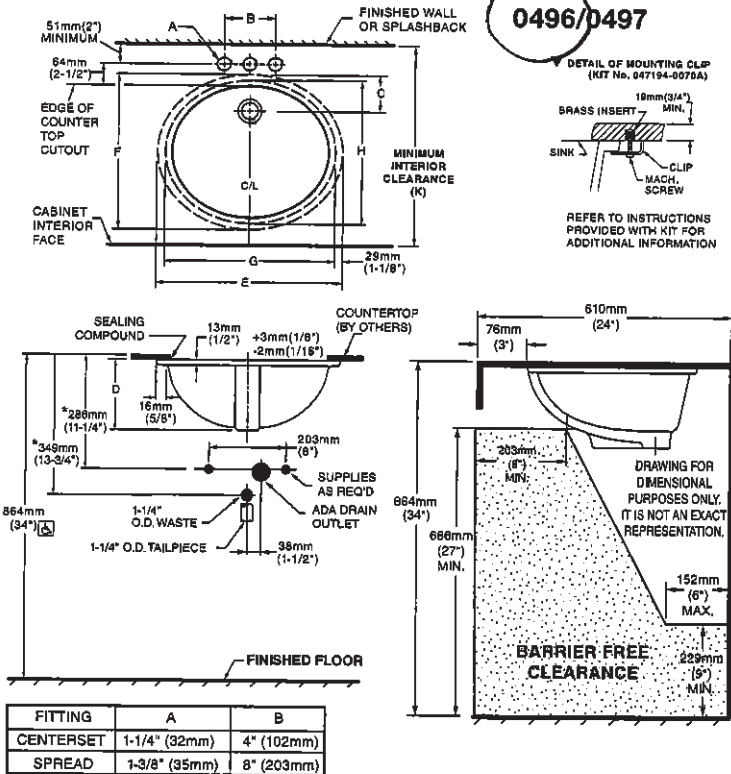

FITTING	A	B
CENTERSET	1-1/4" (32mm)	4" (102mm)
SPREAD	1-3/8" (35mm)	8" (203mm)

CAT. NO.	E	F	G	H	C	D	J	K
0496.221/ 0496.300	489mm (19-1/4")	406mm (16")	432mm (17")	356mm (14")	103mm (4-1/16")	182mm (7-3/16")	16mm (5/8")	500mm (19-11/16")
0497.221/ 0497.300	546mm (21-1/2")	441mm (17-3/8")	483mm (19")	391mm (15-3/8")	95mm (3-3/4")	191mm (7-1/2")	19mm (3/4")	534mm (21-1/16")

NOTES:  
\* DIMENSIONS SHOWN FOR LOCATION OF SUPPLIED AND "P" TRAP ARE SUGGESTED.  
▼ UNDERCOUNTER MOUNTING KIT SUPPLIED WITH SINK.  
**PLEASE NOTE MINIMUM INTERIOR CLEARANCE DIMENSION (K).**  
FITTINGS NOT INCLUDED AND MUST BE ORDERED SEPARATELY. USE ENCLOSED TEMPLATE FOR COUNTERTOP CUTOUT SEALING COMPOUND SUPPLIED BY OTHERS.  
**IMPORTANT:** Dimensions of fixtures are nominal and may vary within the range of tolerances established by ANSI Standard A112.19.2. These measurements are subject to change or cancellation. No responsibility is assumed for use of superseded or voided pages.



MEETS THE AMERICANS WITH DISABILITIES ACT GUIDELINES AND ANSI A117.1 ACCESSIBLE AND USEABLE BUILDINGS AND FACILITIES - CHECK LOCAL CODES.  
Countertop 864mm (34") from finished floor. Lavatory installed 76mm (3") from front edge of countertop. Countertop thickness to be 25mm (1") maximum.

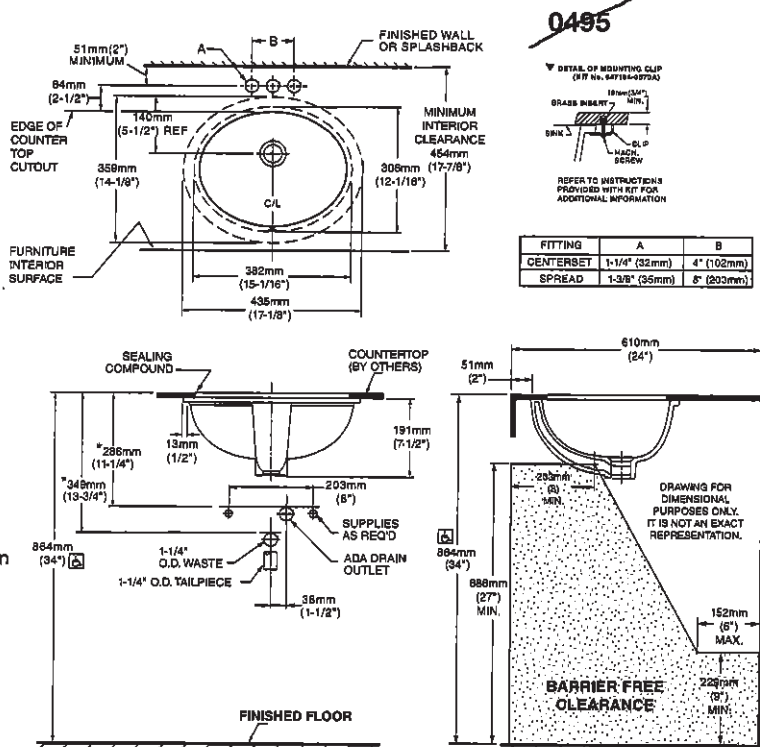

NOTES:  
USE ENCLOSED TEMPLATE FOR COUNTER TOP CUTOUT. FITTINGS NOT INCLUDED WITH FIXTURE AND MUST BE ORDERED SEPARATELY.  
\* DIMENSIONS SHOWN FOR LOCATION OF SUPPLIED AND "P" TRAP ARE SUGGESTED.  
▼ UNDERCOUNTER MOUNTING KIT SUPPLIED WITH SINK.  
**PLEASE NOTE MINIMUM INTERIOR CLEARANCE DIMENSION (K).**  
SEALING COMPOUND SUPPLIED BY OTHERS.

**IMPORTANT:** Dimensions of fixtures are nominal and may vary within the range of tolerances established by ANSI Standard A112.19.2. These measurements are subject to change or cancellation. No responsibility is assumed for use of superseded or voided pages



MEETS THE AMERICANS WITH DISABILITIES ACT GUIDELINES AND ANSI A117.1 ACCESSIBLE AND USABLE BUILDINGS AND FACILITIES - CHECK LOCAL CODES.  
Countertop 864mm (34") from finished floor. Lavatory installed 51mm (2") from front edge of countertop. Countertop thickness to be 25mm (1") maximum.

24



UK 3 WALLACETON  
LOT 381  
27-2587 CRN ELEV B  
THE MAXWELL

27 of 43



COLONY™  
COUNTERTOP SINK  
VITREOUS CHINA

COLONY COUNTERTOP SINK

- Vitreous china
  - Self-rimming
  - Front overflow
  - Supplied with template
  - Faucet deck  
(Faucet shown not included)
- ☐ 0346 803  
Faucet holes on 203mm (8") centres
- ☐ 0346 403 (Illustrated)  
Faucet holes on 102mm (4") centres
- ☐ 0346 001  
Centre hole only

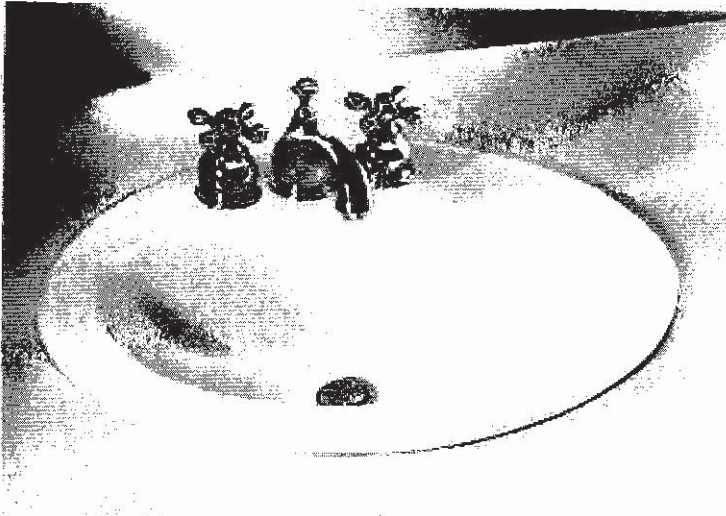

Nominal Dimensions:  
521 x 448mm (20-1/2" x 17-5/8")

Bowl sizes:  
422mm (16-5/8") wide, 279mm (11") front to back, 143mm (5-5/8") deep

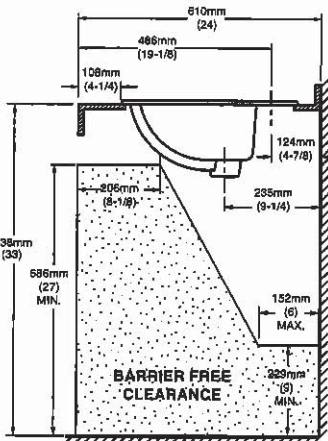
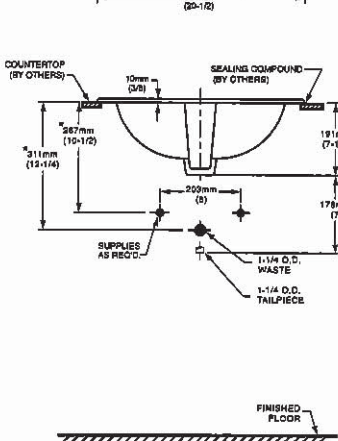
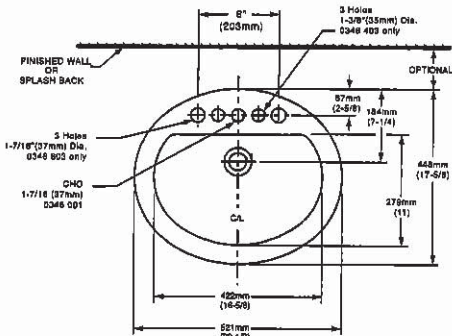

COMPLIANCE CERTIFICATIONS –  
Meets or exceeds the following Specifications:  
• ASME A112.19.2M for Vitreous China Fixtures.  
• CAN/CSA B45 Series.

To Be Specified

☐ Colour: ☐ White ☐ Bone ☐ Silver Gray ☐ Linen

☐ Faucet\*:

☐ Faucet Finish:

☐ Supplies & Stops:

☐ Trap 1-1/4" (32 mm):

NOTES:  
\* DIMENSIONS SHOWN FOR LOCATION OF SUPPLIES AND "P" TRAP ARE SUGGESTED. FOR COUNTERTOP CUTOUT AND INSTALLATION INSTRUCTIONS USE TEMPLATE SUPPLIED WITH SINK.  
FAUCETS NOT INCLUDED AND MUST BE ORDERED SEPARATELY.  
IMPORTANT: Dimensions of fixtures are nominal and may vary within the range of tolerances established by ANSI Standard A112.19.2.  
These measurements are subject to change or cancellation. No responsibility is assumed for use of superseded or voided pages.

\* See faucet section for additional models available

UK 3 WALLACETON  
LOT 381  
27-2587 CRN ELEV B  
THE MAXWELL

28 of 43



DEMI™  
Product Specification Sheet

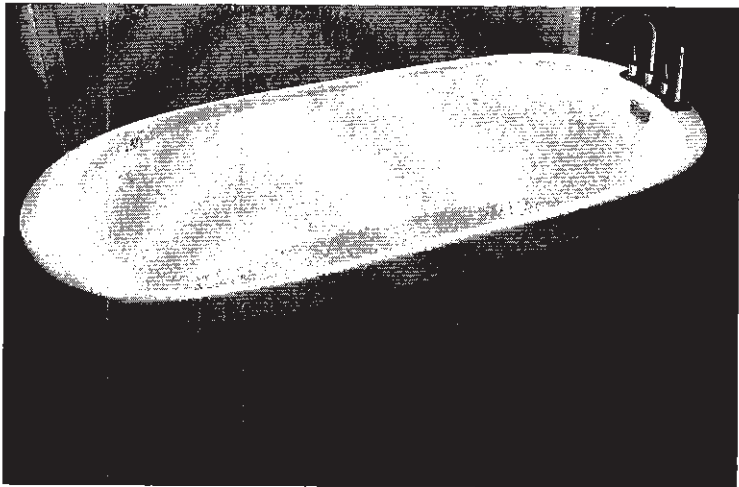

Two Piece Freestanding Collection

CF2007 Two Piece Freestanding Soaker

Size: 60" x 32" x 22"  
1524 mm x 813 mm x 559 mm

PRODUCT FEATURES & BENEFITS

- Vacuum formed acrylic reinforced with fiberglass
- Scratch, stain and fade resistant high gloss finish
- Installation friendly two piece design
- Accepts deck mounted faucet
- Includes integral pop up drain and rectangular overflow
- Includes levelling feet

TWO PIECE ASSEMBLY

FRONT VIEW

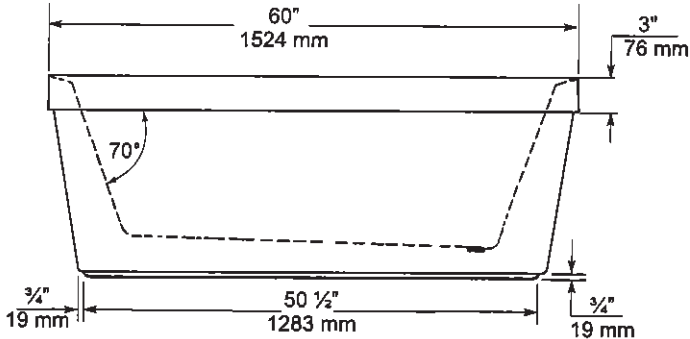

END VIEW

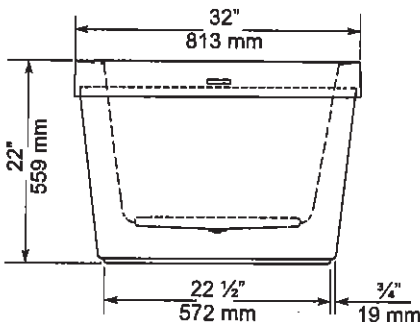

TOP VIEW

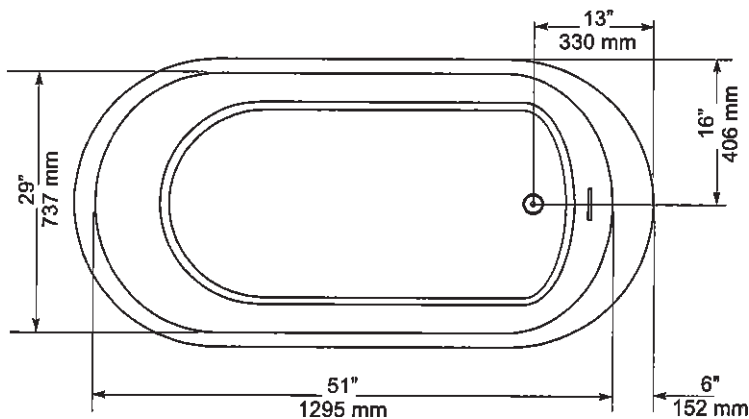

GENERAL SPECIFICATIONS		
Average Weight	90 lb	41 kg
Bathing Well at Bottom	43"x 20"	1092 x 508 mm
Capacity Drain to Overflow		195 litres
Water Depth Drain to Overflow	16"	406 mm
Drain Opening (dia.)	2"	51 mm
Overflow Opening	2 1/4"x 1/2"	57 x 13 mm
Drain to Floor Clearance	3 1/4"	83 mm

**NOTES:** Please confirm measurements on actual product to ensure proper identification. Bathtub to be installed on the floor supported by 5 self levelling feet. Adjust if required to level the bathtub for adequate drainage. Refer to installation instructions for additional information.

**IMPORTANT:** Dimensions of fixtures are nominal and may vary  $\pm 1/4"$  (6 mm). Weight may vary  $\pm 5$  lb (2.3 kg). Drawing is not to scale. These measurements are subject to change at manufacturer's discretion.

Compliance Certifications -  
Meets or Exceeds the following Specifications:  
• CAN/CSA - B45 Series



28 of 43

UK 3 WALLACETON  
LOT 381  
27-2587 CRN ELEV B  
THE MAXWELL

29 of 43

*American Standard*  
Style That Works Better

FloWise™ DUAL FLUSH  
ELONGATED TOILET  
VITREOUS CHINA

FloWise™ DUAL FLUSH ELONGATED TOILET

- ☐ 2476 216
  - Vitreous china
  - Low-consumption Dual Flush
    - Full flush 6.0 Lpf/1.3 gpf,
    - Partial flush 3.0 Lpf/0.66 gpf.
  - Elongated wash down bowl
  - Internal trapway fully-glazed,
    - 2-1/4" (57mm) ballpass
  - Concealed trapway bowl
  - Chrome-plated top mounted push button actuator
  - Easy to clean sanitary dam on bowl
  - Includes Elongated Slow Close Seat
  - 100% factory flush tested
  - 2 bolt caps

Separate Component Parts:

- ☐ 3067 316 Elongated Bowl with Slow Close Seat
- ☐ 4035 216 Unlined Tank



- ☐ 2476 516 Same as above with Lined tank
  - ☐ 3067 316 Elongated Bowl
  - ☐ 4035 516 Lined Tank

Nominal Dimensions:  
794 x 432 x 765mm  
(31-1/4" x 17" x 30-1/8")

Compliance Certifications -  
Meets or Exceeds the Following Specifications:  
• ASME A112.19.2M (and 19.6M)  
• CAN/CSA B45 series

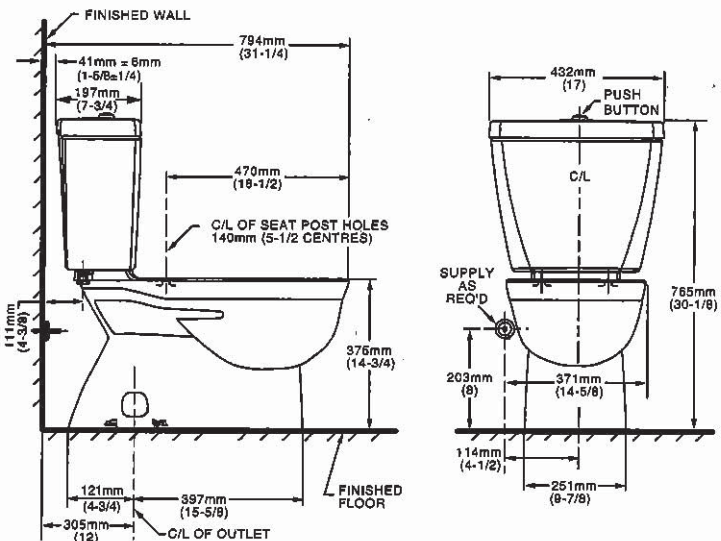

NOTES:  
THIS TOILET IS DESIGNED TO ROUGH-IN AT A MINIMUM DIMENSION OF 305MM (12") FROM FINISHED WALL TO C/L OF OUTLET.  
SUPPLY NOT INCLUDED WITH FIXTURE AND MUST BE ORDERED SEPARATELY.  
\* DIMENSION SHOWN FOR LOCATION OF SUPPLY IS SUGGESTED.  
FOR ADDITIONAL INFORMATION REFER TO INSTALLATION INSTRUCTIONS SUPPLIED.  
IMPORTANT: Dimensions of fixtures are nominal and may vary within the range of tolerance established by ANSI Standard A112.19.2  
These measurements are subject to change or cancellation. No responsibility is assumed for use of superseded or voided pages.

To Be Specified

- ☐ Colour: 020 White
- ☐ Supply with stop:

UPGRADED VALUE ADDED FEATURES AT NO EXTRA CHARGE

2-11



UK 3 WALLACETON  
LOT 381  
27-2587 CRN ELEV B  
THE MAXWELL

30 of 43



Buy it for looks. Buy it for life.®

**FAUCET DESCRIPTION**

- Metal construction with chrome finish
- Flexible supply lines with 3/8" compression fittings
- Includes metal pop-up waste assembly
- Optional 3 hole deck plate (escutcheon) available

**OPERATION**

- Lever style handle
- Temperature controlled by 100° arc of handle travel
- Includes hot & cold temperature indicators

**FLOW**

- Flow is limited to 1.2 gpm max (4.5 L/min) at 60 psi

**CARTRIDGE**

- 1255™ Duralast™ cartridge
- Nonmetallic/nonferrous and ceramic material

**STANDARDS**

- Third party certified to WaterSense,® ASME A112.18.1/CSA B125.1, and all applicable requirements referenced therein
- Certified to NSF 61/9 & 372
- Compliant with California water efficiency regulations
- Complies with California Proposition 65 and with the Federal Safe Drinking Water Act
- ADA ♿ for lever handle

**WARRANTY**

- Lifetime limited warranty against leaks, drips and finish defects to the original consumer purchaser
- 5 year warranty if used in commercial installations

MASTER ENSUITE  
ONLY

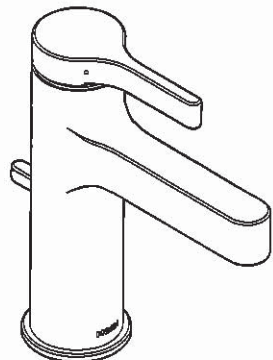

**Vichy™**  
**Single-Handle Lavatory Faucet**

**Model: 6710**

**NOTE:** THIS FAUCET IS DESIGNED TO BE  
INSTALLED THRU 1 HOLE, 1-1/4" MIN. DIA.

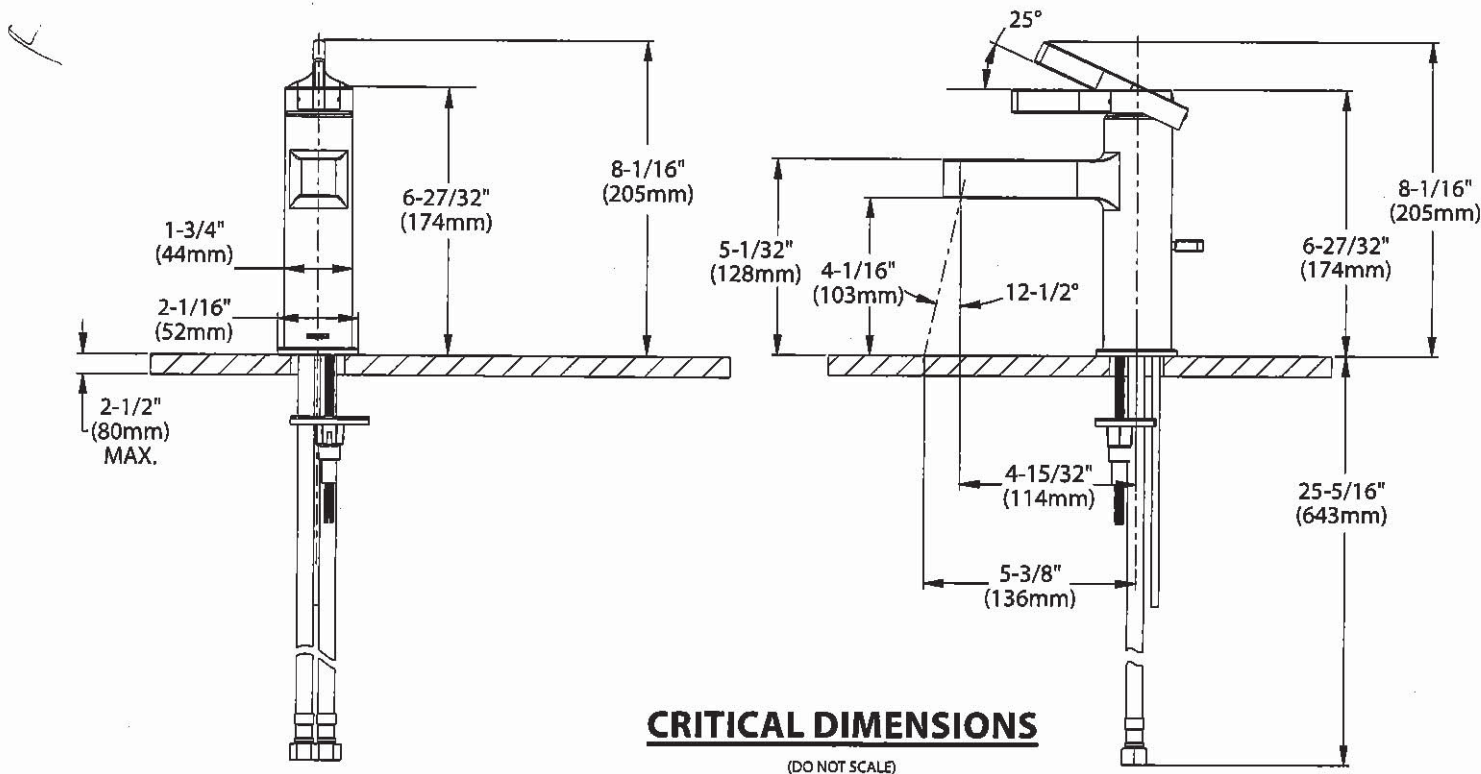

N.H

UK 3 WALLACETON  
LOT 381  
27-2587 CRN ELEV B  
THE MAXWELL

31 of 43

MOEN®

Specifications

There is more than 1 version of this model.  
Page down to identify the version you have.

DESCRIPTION

- Metal construction with various finishes identified by suffix
- Flexible supplies with 3/8" compression fittings
- Includes metal or 50/50 pop-up type waste assembly where noted

OPERATION

- Pivot action lever style handle
- Temperature controlled through 100° degree arc of handle travel

FLOW

- Water usage is limited to these maximum flow rates as indicated by the corresponding product markings
- ° 1.2 gpm max (4.5L/min) at 60 psi
- ° 1.5 gpm max (5.7L/min) at 60 psi

CARTRIDGE

- 1255™ Duralast™ cartridge
- Nonmetallic/nonferrous and stainless steel material

STANDARDS

- Third party certified to WaterSense®, ASME A112.18.1/CSA B125.1 and all applicable requirements referenced therein
- Certified to NSF 61/9 & 372
- Products marked with 1.2 gpm are compliant with California water efficiency regulations
- Complies with California Proposition 65 and with the Federal Safe Drinking Water Act

- **ADA**  for lever handle

WARRANTY

- Lifetime limited warranty against leaks, drips and finish defects to the original consumer purchaser
- 5 year warranty if used in commercial installations

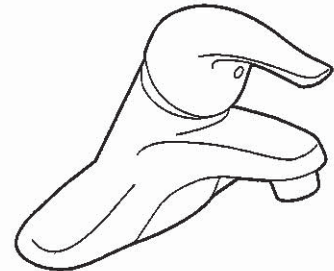

**CHATEAU®**  
Single-Handle Lavatory Faucet

with Metal Waste Assembly

Model: L4625 series  
L4631BC

**Bulk Packed (12 per carton):**  
L64624 series

with 50/50 Waste Assembly

**Bulk Packed (12 per carton):**  
L64625 series

Less Waste

**Bulk Packed (12 per carton):**  
L64600 series

**NOTE:** THIS FAUCET IS DESIGNED TO BE  
INSTALLED THRU 3-1" DIA. HOLES, 2" ON CENTER

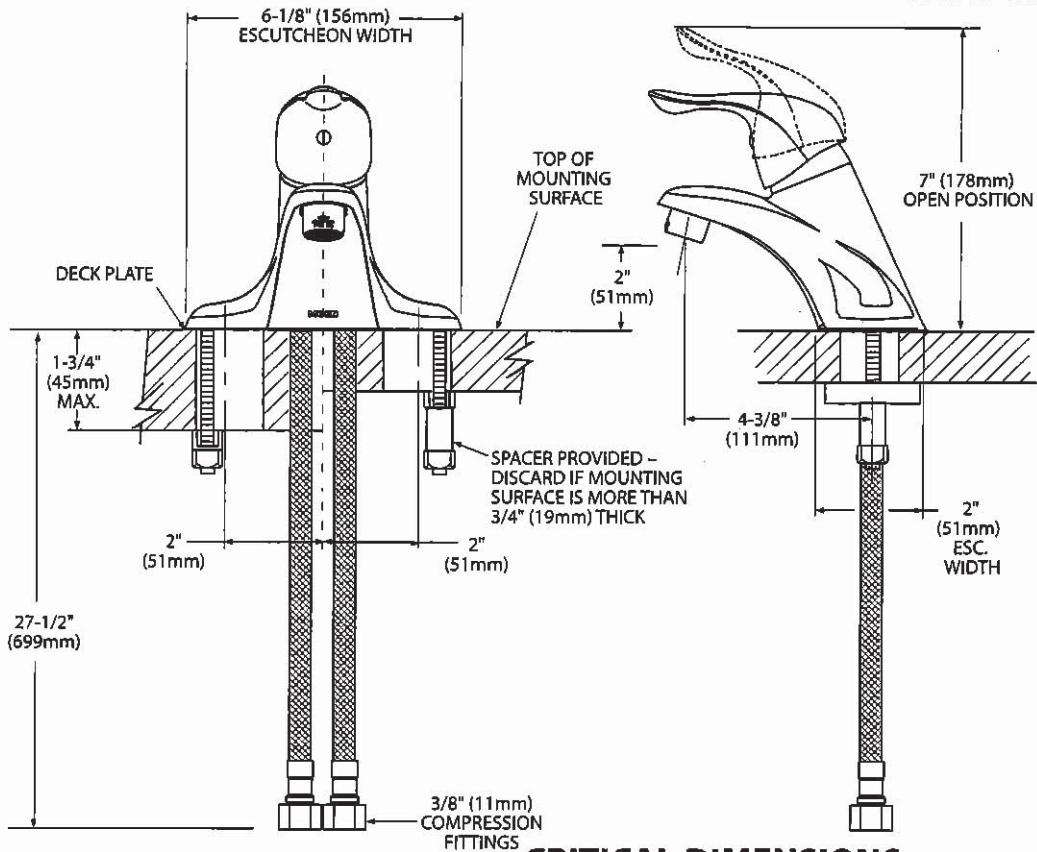

**CRITICAL DIMENSIONS**  
(DO NOT SCALE)

2.17



UK 3 WALLACETON  
LOT 381  
27-2587 CRN ELEV B  
THE MAXWELL

32 of 43



Buy it for looks. Buy it for life.®

There is more than 1 version of this model.  
Page down to identify the version you have.

DESCRIPTION

- Metal construction with various finishes identified by suffix
- Includes non-metallic showerhead, arm, flange and non-metallic diverter tub spout

OPERATION

- Handle operates counterclockwise through a 270° arc with off at 6 o'clock and maximum hot at the 9 o'clock position. Shut off in clockwise direction
- Adjustable temperature limit stop to control maximum hot water temperature
- Pressure balancing mechanism maintains selected discharge temperature to ± 3°

FLOW

- Showerhead is limited to 2.5 gpm (9.5 L/min) at 80 psi
- EP suffix models are limited to 1.75 gpm (6.6 L/min) at 80 psi
- NH suffix models contain no showerhead

CARTRIDGE

- 1222 cartridge design
- Accommodates back to back installations
- Nonmetallic/nonferrous and stainless steel material

STANDARDS

- Third party certified to meet ASME A112.18.1/CSA B125.1 and all applicable requirements referenced therein
- EP suffix models are third party certified to WaterSense®

- ADA for lever handle

WARRANTY

- Lifetime limited warranty against leaks, drips and finish defects to the original consumer purchaser
- 5 year warranty if used in commercial installations

Specifications

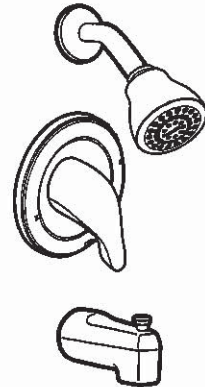

CHATEAU' POSI-TEMP'  
Single-Handle Tub/Shower Trim Kit

Models: TL181 series - valve trim only  
(Bulk Packed 12 per carton)  
TL182 series - shower trim only  
(Bulk Packed 12 per carton)  
TL183 series - tub/shower trim  
(Bulk Packed 12 per carton)

Valves: 62300 series  
2500 series

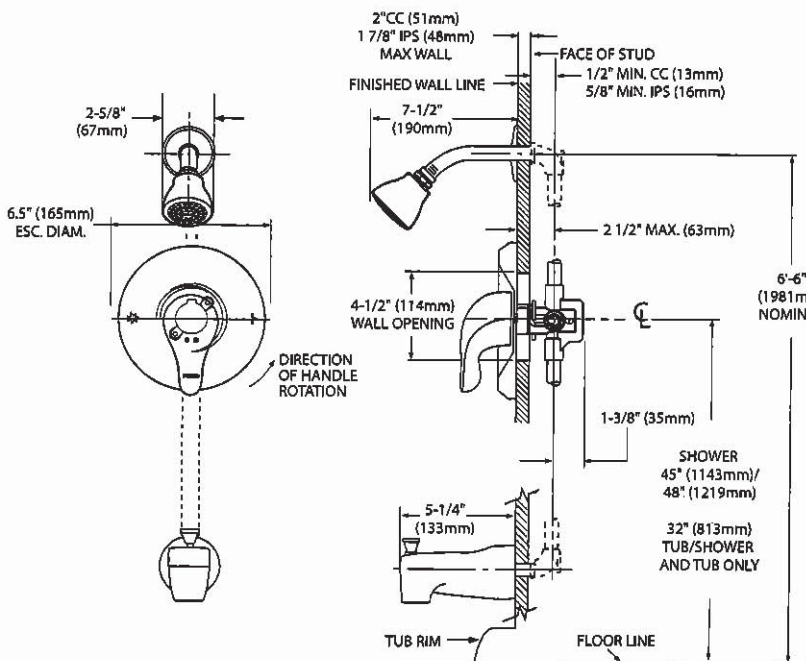

THICK WALL APPLICATION

CRITICAL DIMENSIONS

(DO NOT SCALE)

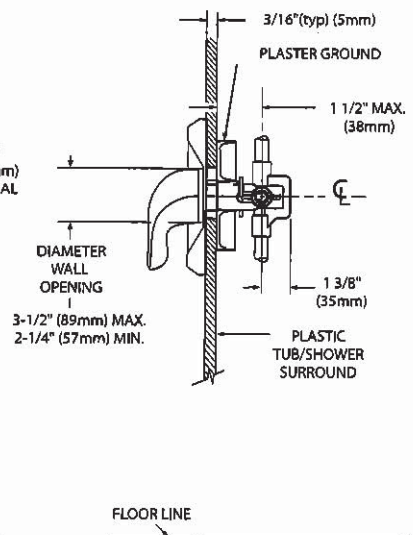

THIN WALL APPLICATION



UK 3 WALLACETON  
LOT 381  
27-2587 CRN ELEV B  
THE MAXWELL

33 of 43

MOEN®

Specifications

DESCRIPTION

- Metal construction with various finishes identified by suffix

OPERATION

- Lever style handles with hot and cold color indicator
- Rotate hot side handle counterclockwise to open (clockwise to close) and the cold side handle (clockwise to open) and (counterclockwise to close)

STANDARDS

- Third party certified to: ASME A112.18.1/CSA B-125.1, and all applicable requirements referenced therein
- ADA  for lever handles

WARRANTY

- Lifetime limited warranty against leaks, drips and finish defects to the original homeowner
  - 10 year limited warranty when used in a multi-family installation
  - 5 year limited warranty when used in a commercial installation
- Visit [www.moen.com/support](http://www.moen.com/support) for complete details and limitations

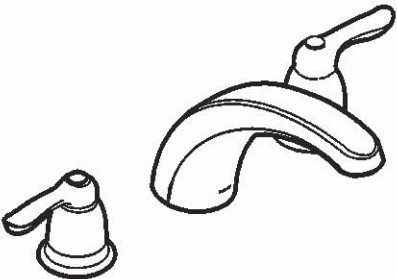

CHATEAU®  
Two-Handle Garden Tub Trim

Models: T994 series

Valves: 4792, 4793, 4794, 4796, 4797, 4798

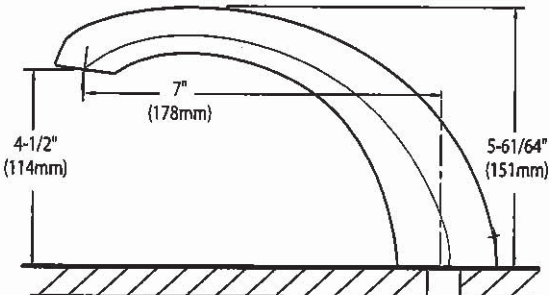
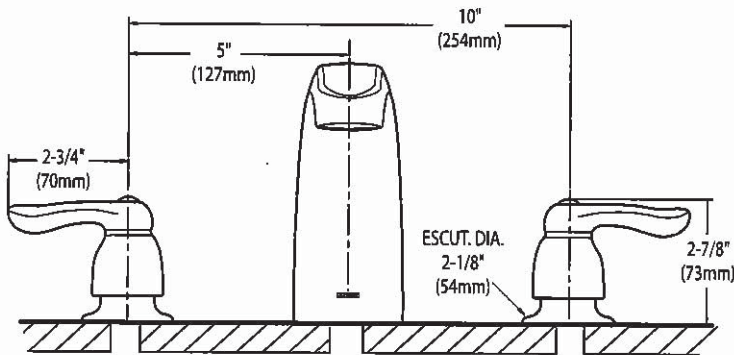

CRITICAL DIMENSIONS  
(DO NOT SCALE)

UK 3 WALLACETON  
LOT 381  
27-2587 CRN ELEV B  
THE MAXWELL

34 of 43

SC(B)514 | ALITO Collection

Cyclone®  
Breathe Better

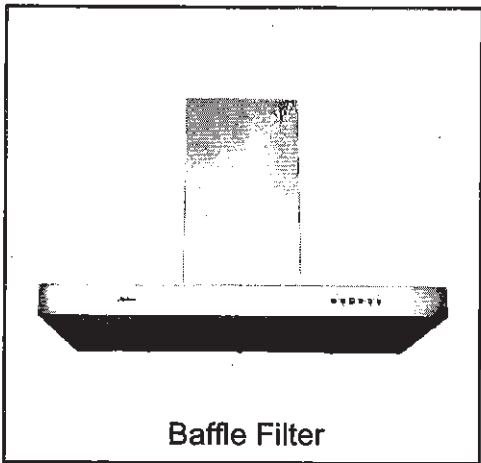

Wall Mount

The SC(B)514 makes a statement of strength and power with a bold frame and 550 CFM fan. Features mesh or baffle filters, two bright LED lights and a three-speed panel for total control. It is also fitted with a time-delay OFF feature up to nine minutes.

Green Features



3 Speed Push Button  
Control Panel



Long-Lasting  
LED Lights



Time-Delay  
OFF Feature



Grease Cup

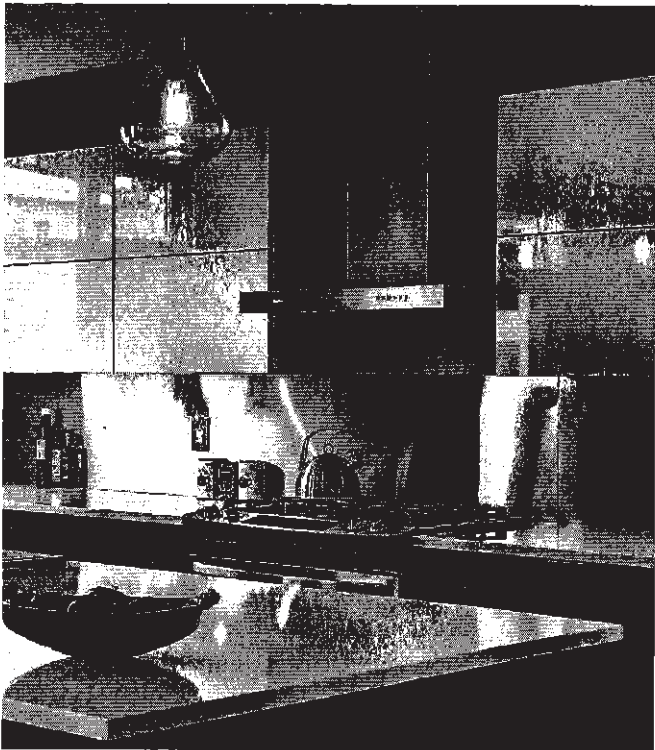

Model	Colour	Ducting	Filters	Size	CFM
SCB51430	Stainless Steel	6"	Baffle	30"	550
SCB51436	Stainless Steel	6"	Baffle	36"	550

Cyclone Range Hoods Inc.

1361 Huntingwood Drive, Unit 16, Toronto, ON, M1S 3J1, Canada.

Toll Free: 1-888-293-5662 Tel: (416) 293-0933 Fax: (416) 293-4793 Website: [www.CycloneRangeHoods.com](http://www.CycloneRangeHoods.com)

N. H

UK 3 WALLACETON  
LOT 381  
27-2587 CRN ELEV B  
THE MAXWELL

35 of 43

SC(B)514 | ALITO Collection

Cyclone®  
Breathe Better

Features

- Wall mount range hood
- 6" round duct adapter
- Non-stick aluminum fan blades
- 3 speed push button control
- 2 LED lights (2 x 1.4W, 4000K)
- Quick release aluminum mesh filters
- Standard chimney fits up to 9 ft. ceiling
- Up to 9 minutes time-delay OFF feature
- Plug-in connection

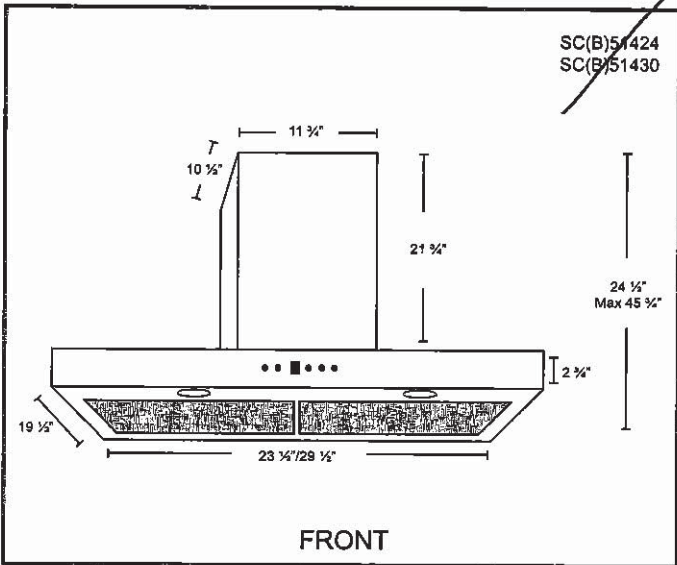
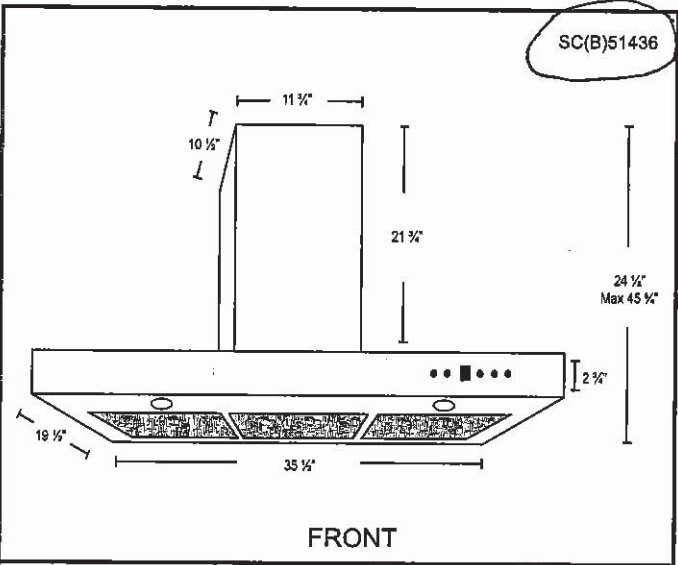

Options

- Filters:  
  
SCB514 - Quick Release Stainless Steel Baffle Filters
- Chimney Flues:  
B2.CH16 - short (7'-8' ceilings)  
B2.CH22 - standard (8'-9' ceilings)  
B2.CH32 - extended (9'-11' ceilings)
- Widths: 30" 36"

Specifications

- |                                                                                                                                                                |                                                                                                                                          |                                                                                                                                                              |
|----------------------------------------------------------------------------------------------------------------------------------------------------------------|------------------------------------------------------------------------------------------------------------------------------------------|--------------------------------------------------------------------------------------------------------------------------------------------------------------|
| <ul style="list-style-type: none"><li>• Air Flow Volume: 550 CFM</li><li>• Electrical Connection: 120 V/60 Hz</li><li>• Power Consumption: 300 Watts</li></ul> | <ul style="list-style-type: none"><li>• Current: 2.5 Amps</li><li>• Fan Speed: 1599 RPM</li><li>• Fan Type: Centrifugal Blower</li></ul> | <ul style="list-style-type: none"><li>• Finishes: Stainless Steel</li><li>• Ducting: 6" Round</li><li>• Noise Level: Min. 2 Sones<br/>Max. 6 Sones</li></ul> |
|----------------------------------------------------------------------------------------------------------------------------------------------------------------|------------------------------------------------------------------------------------------------------------------------------------------|--------------------------------------------------------------------------------------------------------------------------------------------------------------|



Toronto • Vancouver • Boston  
[www.CycloneRangeHoods.com](http://www.CycloneRangeHoods.com)

2. 11



UK 3 WALLACETON  
LOT 381  
27-2587 CRN ELEV B  
THE MAXWELL

36 of 43

HOME APPLIANCES

LG REFRIGERATION

LFXC22596S

22 cu.ft. French Door Refrigerator with InstaView®



21.9 cu.ft.  
InstaView Door-in-Door® with ColdSaver Panel  
Smudge Resistant Finish  
Slim SpacePlus® Ice System  
Inverter Linear Compressor with 10 Year Warranty  
Fresh Air Filter  
Door Cooling+  
Glide N' Serve Pantry Drawer  
SmartThinQ® WiFi Connectivity  
ENERGY STAR®



CAPACITY	
Refrigerator (cu.ft.)	14.6 cu. ft.
Freezer (cu.ft.)	7.3 cu. ft.
Total (cu.ft.)	21.9 cu. ft.
FEATURES	
Energy Consumption (kWh/Year)	664
ENERGY STAR® Qualified	Yes
WATER & ICE SYSTEM	
Tall Ice & Water Dispens	Yes
Dispenser T	Tall Integrated
Daily Ice Production (lbs)	3.5
IcePlus™ Production (lbs)	3.8
Ice Storage Capacity (lbs)	2.5 + 4.0
Ice System	Slim SpacePlus®
Dispenser Light	Yes
Water Filter	LT1000P
COOLING	
Inverter Linear Compresso	Yes
Smart Cooling® System	Yes
Multi-Air Flow Cooling	Yes
Temperature Sensors	6
Fresh Air Filter	Yes
Evaporator	Yes
CONVENIENCE	
Display Type	Membrane / White LED
Temperature Controls	Electronic/Digital
Door Alarm	Yes
Child Lock	Yes
Auto Closing Door Hinge	Yes
LoDecibel™ Quiet Operation	Yes
REFRIGERATOR	
No. of Shelves	4 Split
Folding She	No
Cantilevered Shelves	Hybrid Cantilevered
Shelf Construction	Spill Protector™ Tempered Glass
Crisper Bins	2 Humidity Crispers
Glide N' Serve® Drawer	Yes
Refrigerator Light	Ceiling LED

REFRIGERATOR DOOR	
No. of Bins	7 Total
Door Bin Construction	1 Piece (Clear)
FREEZER	
Door Type	Pull Drawer
Drawers	2-Tier Organization
DuraBase™ Solid Drawer Base	Yes
Drawer Divider	Yes
Freezer Light	LED Lighting
Freezer Handle	SmarPull™ Handle
SMARTTHINQ®	
SmartDiagnosis™	Yes
MATERIALS AND FINISHES	
Contour Door	Yes
Hidden Hinges	Yes
Surface	Smooth
Back	Flush & Metal Cover Over Mechanical Parts
Handles	Matching Commercial Handles
All Available Colours	Smudge Resistant Stainless Steel
DIMENSIONS/CLEARANCES/WEIGHTS	
Depth with Handles	31 1/4"
Depth without Handles	28 3/4"
Depth without Door	24 1/8"
Depth (Total with Door Open)	43 1/4"
Height to Top of Case	68 3/8"
Height to Top of Door Hinge	69 3/4"
Width	35 3/4"
Width (Door Open 90° with Handle)	44 1/4"
Width (Door Open 90° without Handle)	39 1/4"
Installati	Sides 1/8", Top 1", Back 2"
Weight (Unit/Carton)	289 lbs. / 319lbs.
Carton Dimensions (WxHxD)	38" x 73" x 36"
LIMITED WARRANTY	
Parts & Labour	1 Year
Sealed System	7 Years
Inverter Linear Compressor	10 Years
UPC CODES	
LFXC22596S (Smudge Resistant Stainless Steel)	048231797214

© 2019 LG Electronics Canada, Inc. All rights reserved. "LG Life's Good" is a registered trademark of LG Corp. All other product and brand names are trademarks or registered trademarks of their respective owners. Design, features and specifications are subject to change without notice. Non-metric weights and measurements are approximate. Some features may require Internet access. Content and services may vary by product and are subject to change without notice. 08/16/2017

UK 3 WALLACETON  
LOT 381  
27-2587 CRN ELEV B  
THE MAXWELL

37 of 43

HOME APPLIANCES

LG REFRIGERATION

LFXC22596

3-Door Refrigerator with InstaView  
Door-in-Door®



QUICK INSTALL & CLEARANCES

For full installation directions/clearances please refer to the corresponding User Manual and Installation Guide.

DIMENSIONS/CLEARANCES/WEIGHTS	
A Depth without Handles	28 3/4"
B Width	35 3/4"
C Height to Top of Case	68 3/8"
D Height to Top of Door Hinge	69 3/4"
E Back Clearance	2"
F Depth without Door	24 1/8"
G Depth (Total with Door Open)	43 1/4"
M Depth with Handles	31 1/4"
Width (Door Open 90° with Handle)	44 1/4"
Width (Door Open 90° without Handle)	39 1/4"
Door Edge Clearance with Handle	4 1/2"
Door Edge Clearance without Handle	1 1/3"
Installation Clearance	Sides 1/8", Top 1", Back 2"
Carton Dimensions (WxHxD)	38" x 73" x 39"

CHOOSING THE PROPER LOCATION

WATER

Select a place where a water supply can be easily connected for the automatic

NOTE

- The water pressure must be 20 – 120 psi or 138 – 827 kPa or 1.4 – 8.4 kgf/cm². If the refrigerator is installed in an area with low water pressure (below 20 psi), you can install a booster pump to compensate for the low pressure.

ELECTRICITY

The refrigerator should always be plugged into its own individual properly grounded electrical outlet rated for 115 Volts, 60 Hz, AC only, and fused at 15 or 20 amperes. This provides the best performance and also prevents overloading house wiring circuits which could cause a fire hazard from overheated wires. It is recommended that a separate circuit serving only this appliance be provided.

WARNING

- To reduce the risk of electric shock, do not install the refrigerator in a wet or damp area.

FLOORING

To avoid noise and vibration, the unit must be leveled and installed on a solidly constructed floor. If required, adjust the leveling legs to compensate for the unevenness of the floor. The front should be slightly higher than the rear to aid in door closing. Leveling legs can be turned easily by tipping the cabinet slightly. Turn the leveling legs to the left to raise the unit or to the right to lower it.

NOTE

- Installing on carpeting, soft tile surfaces, a platform or weakly supported structure is not recommended.

AMBIENT TEMPERATURE

Install this appliance in an area where the temperature is between 55°F (13°C) and 110°F (43°C). If the temperature around the appliance is too low or high, cooling ability may be adversely affected.

PRODUCT DIMENSIONS

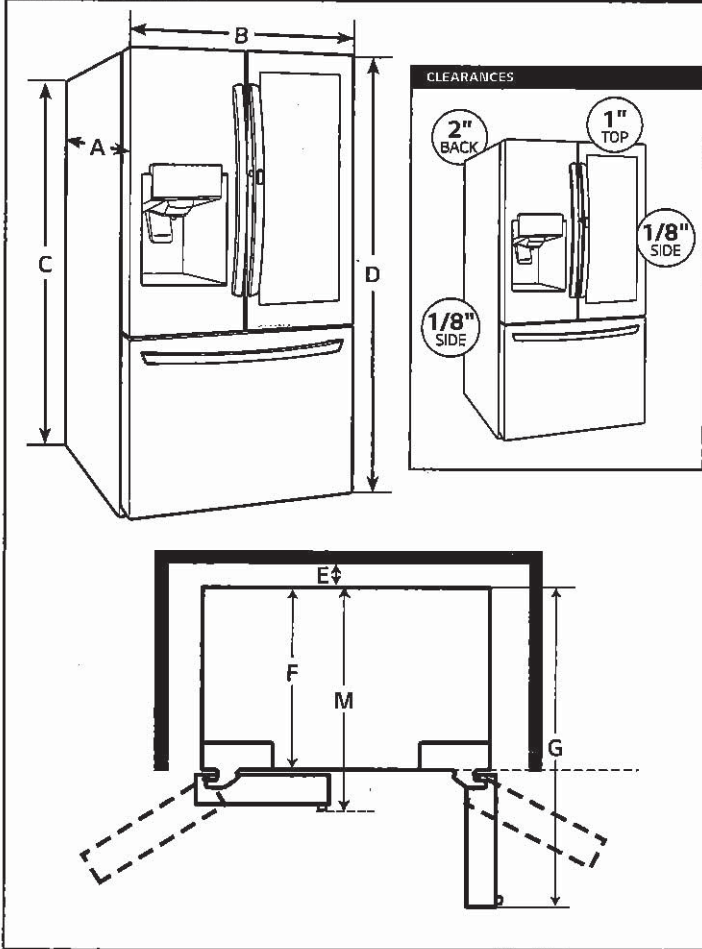

CONNECTING POWER AND SECURING SPACE FOR WATER SUPPLY PIPE

- Make sure the location of the water supply pipe is within the marked range.
- Before connecting the power, always make sure to ground the product. (If the product is not grounded, the user may be able to feel the electricity due to the minute leakage current when touching the refrigerator door handle or side corner even when there is no issue with the product.)
- Do not ground the product to gas pipe, plastic water pipe or telephone wire etc. It can cause electric shock and explosion.

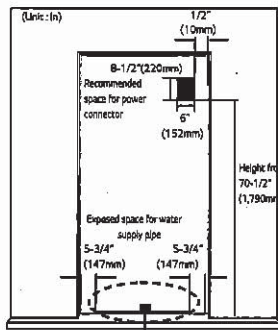

Power connection

The location of the 115V 60Hz power connector must be located on the rear side of the product as shown in the picture.

When installing the product, make sure to check whether the cord is hung on the hook on the rear side so that it is not pressed on the refrigerator. Damaged power cord can cause a fire.

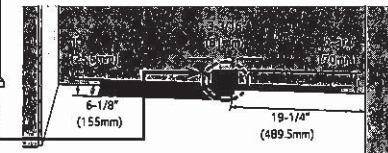

Installation space for water supply pipe

Place the water hose for ice maker and copper dispenser as shown in the picture, and prepare hose to come up from the floor. (Copper dispenser with diameter of 5/16 inch (8mm) is recommended for the water hose.) If the water pipe and water hose is located far from the product, bury the water hose on the floor and provide appropriate treatment.





UK 3 WALLACETON  
LOT 381  
27-2587 CRN ELEV B  
THE MAXWELL  
COOKTOP 400 SERIES 36"



CODE ID

F4GK36S1

36" GAS COOKTOP

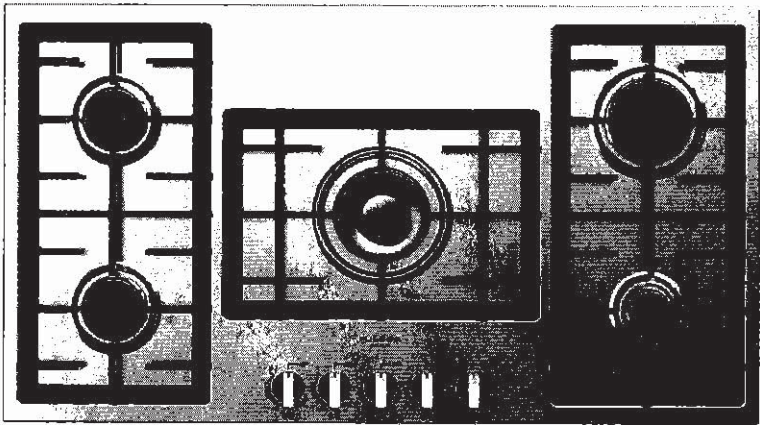

Heavy Duty Grates



Continuous Grate Surface



Dual Burner



Stainless Steel

**GAS COOKTOP**

5 gas burners with 1 Dual Flame burner  
Electric Re-ignition system  
Flame-out Sensing  
Heavy duty cast iron grates

**OPTIONAL ACCESSORIES**

FMWOK	Wok ring
FMSIM	Simmer plate
FMSPR	Small Pot Adapter



UK 3 WALLACETON  
LOT 381  
27-2587 CRN ELEV B  
THE MAXWELL

39 of 43

DISTINTO

36" GAS COOKTOP

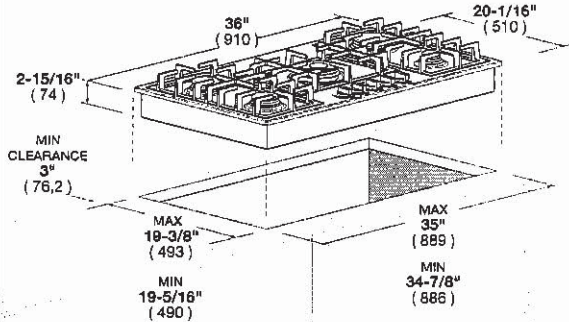
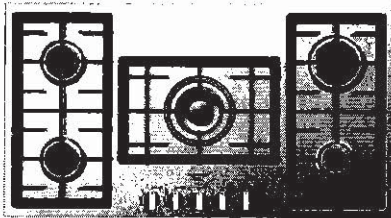

CODE ID	F4GK36S1 - 36" GAS COOKTOP	
Series and Finish	400 Series - Stainless Steel	
CONTROL PANEL		
Control Type	Knobs	
COOKTOP		
Type	GAS (NG or LP)	
Cooking Surface	Matte Black Enamel	
GAS COOKTOP FEATURES		
Electric Re-ignition system	•	
Flame-out sensing	•	
Dual Flame Burner	•	
Simmer Plate	Optional	
Small Pot Insert (for single burners only)	Optional	
Wok Ring (for dual burner only)	Optional	
Heavy Duty Cast Iron Grates	3	
Cooking Zones	5	
Burners types	Sealed Burners (all) - Dual Flame/Simmer Burner (only Center)	
Power (Max/Min) (Left)		
Power (Max/Min) (Front-L)	6300 (BTU/h) - 1850W / 1300 (BTU/h) - 380W	
Power (Max/Min) (Rear-L)	9000 (BTU/h) - 2640W / 1300 (BTU/h) - 380W	
Power (Max/Min) (L Center)		
Power (Max/Min) (Front Center)	18000 (BTU/h) - 5275W / 700 (BTU/h) - 205W	
Power (Max/Min) (R Center)		
Power (Max/Min) (Front-R)	4000 (BTU/h) - 1175W / 1000 (BTU/h) - 295W	
Power (Max/Min) (Rear-R)	12000 (BTU/h) - 3520W / 2200 (BTU/h) - 645W	
Power (Max/Min) (Right)		
DIMENSIONS/WEIGHT		
Overall dim - Width	36"	(910 mm)
Overall dim - Height	5 - 3/16"	(132 mm)
Overall dim - Depth	20 - 1/16"	(510 mm)
Cut-out - Width (min - max)	34 - 7/8", 35"	(886 mm) - (889 mm)
Cut-out - Height (min)	2 - 15/16"	(74 mm)
Cut-out - Depth (min - max)	19 - 5/16", 19 - 3/8"	(490 mm) - (493 mm)
Gross Weight	55 lbs	(25 kg)
POWER / RATINGS (120 V, 60 HZ)		
Amps	0.1A	
Max Power	52300 (BTU/h) - 15320W	
Power Cable	Nema 5 - 15P	
INSTRUCTIONS FOR USE		
Use & Care Manual / Installation Manual	English / French / Spanish	

40 of 43

UK 3 WALLACETON  
LOT 381  
27-2587 CRN ELEV B  
THE MAXWELL

HOME APPLIANCES

LG COOKING

LWC3063\_

Combi Wall Oven

1.7 cu.ft. Microwave (Speed Oven)

Infrared Heating™

4.7 cu.ft. Oven

True Convection

Steam Cooking

Self+EasyClean

SmartThinQ® Technology



Enjoy new ways to control your home with LG smart appliances

- Start or stop your Oven remotely
- Set your Monitor Status from your smartphone
- Works with the LG SmartThinQ® app

SmartThinQ®

works with the Google Assistant

WORKS WITH alexa

innit

SIDECHEF



SUMMARY	
Total Oven Capacity (cu. ft.)	6.4 (Upper & Lower)
Colors	Stainless Steel / Black Stainless Steel
UPPER OVEN FEATURES	
Capacity (cu.ft)	1.7
Interior(Cavity) - Upper MWO / Lower Oven	Stainless / Enamel Coating
Microwave Power output	950W
Microwave mode power consumption	1650W
Convection Bake mode power consumption	1600W
Broil mode power consumption	1300W
Convection Element (W)	1500W (Sheath heater)
Broil Upper Element (W)	1200W (500W + 700W)
Broil Lower Element (W)	375W
Microwave	Yes
Convection Bake	Yes
Broil	Yes
Speed cook	Yes
- = of Defrost (4 Menu)	Meat / Poultry / Fish / Bread
- = of Sensor cook (9Menu)	Beverage / Casserole / Chicken / Pasta / Pizza / Plate of food / Rice / Soup / Vegetable
- = of Auto cook (28Menu)	Bacon(regular sliced) / Bagels(frozen) / Baked potatoes(7-9oz/ea) / Brownie / Cod filets(1 lb) / Corn dog(frozen) / Fresh vegetable / Frozen chicken wings / Frozen fries / Frozen chicken nuggets / Frozen pizza(regular crust) / Frozen soft pretzels / Hamburger(1/2" thick) / Lamb chops(1/2" thick, 6-7oz) / Meat loaf(9" x 5") / Nachos / Oatmeal / Pork chops(1/2" thick, 6-7oz) / Quinoa / Ribeye steak(1" thick 14-15oz) / Rice / Salmon steak(1" thick) / Sausage / Sirloin steak(1" thick, 18-21oz) / Tenderloin / Vegetable-canned
- = of Soften (4Menu)	Butter / Cream Cheese/ Frosting / Ice Cream
- = of Melt (5Menu)	Butter / Caramel / Cheese / Chocolate / Marshmallow
LOWER OVEN FEATURES	
Capacity (cu.ft)	4.7
EasyClean®	Yes
Self Clean	Yes (3,4,5 hours)
Variable cleaning time	Yes (3,4,5 hours)
Variable broil	Yes (Full,Center / High,Med,Low)
Broil element	2,500 watts inner / 1,500 watts outer
Bake element	2,500 watts
Bake element type	Hidden (8 pass)
- = of rack position	5
12 hrs. shut-off	Yes
- = of light	2 (Halogen Lamp)
Convection conversion	Yes
-Convection element	Yes (2,000 watts Sheath heater)
Convection System/Mode/Cooking System	True Convection
Convection Fan	Single Speed
Oven Cooking mode	Conv.Bake / Conv.Roast / Bake / Broil / Steam Bake / Steam Roast / Probe / more mode (Favorite/Warm/Proof)
Oven Control Features	Glass Touch (SmoothTouch™)
Door Lock	Yes

CONTROL	
Oven Control Type	Glass Touch (SmoothTouch™)
Display	White VFD
Language	English / Spanish / French
Smart Function	Wi-Fi / Smart Buzzer
Clock	12 hr or 24 hr (option)
Kitchen Timer	Yes
Timed Cook	Yes
Temperature Unit of Measure	Fahrenheit / Celsius
Cooking Complete Reminder Volume	Beeper (1.Loud, 2.Low, 3.Mute)
'Sabbath Mode	Yes
APPEARANCE	
Available Colors	Stainless Steel / Black Stainless Steel
Handle/Knobs	Stainless Steel Finish (Aluminum) Black Stainless Steel Finish (Aluminum)
Oven Door Feature	WideView™ Window
Scratch-Resistant	Yes
PrintProof™ Finish	Yes (Black Stainless Steel Only)
SmartThinQ™ SMART FEATURES	
SmartDiagnosis™	Yes
Wi-Fi Connectivity	Yes
Works with	Google Assistant and Amazon Alexa
SmartThinQ® with Innit and SideChef	Yes
DIMENSIONS/CLEARANCES/WEIGHT	
Shipping Weight (lbs)	244 lbs
Product Weight (lbs)	194 lbs
Product (W x H x D)	29 3/4" x 43 9/11" x 24 1/2"
Cut-out (W x H x D)	28 1/2" x 43 7/16" x 23 1/2"
Overall Depth (in) - including handle	26 7/8"
Oven Interior Dimensions (Upper) (in) (W x H x D)	20 8/11" x 8 9/25" x 17 5/13"
Oven Interior Dimensions (Lower) (in) (W x H x D)	24 1/2" x 17 5/8" x 18 7/8"
Carton Dimensions (in) (W x H x D)	33" x 30" x 50"
POWER/RATINGS	
Max. Amp load	40A
Rating	7.8kW
Requirements	120 / 240 VAC, 120 / 208 VAC
ACCESSORIES	
Glass Tray(Upper)	Yes
Metal Tray(Upper)	Yes
Rack(Upper)	Yes
Broiler pan & Grid	Yes
Girdling Rack	1
Heavy Duty Rack	2
Meat probe	Yes
Scouring Pad	Yes
WARRANTY	
Parts & Labor	1 Year
UPC CODES	
LWC3063ST (Stainless Steel)	048231339810
LWC3063BD (Black Stainless Steel)	048231339827



41 of 43

UK 3 WALLACETON  
LOT 381  
27-2587 CRN ELEV B  
THE MAXWELL

HOME APPLIANCES

LG COOKING

LWC3063\_

Combi Wall Oven

QUICK INSTALL & CLEARANCES

For full installation directions/clearances please refer to the corresponding User Manual and Installation Guide.

DIMENSIONS / CLEARANCES / WEIGHT

Product Dimensions (in) (W x H x D)	29 3/4" x 43 9/11" x 24 1/2"
Cut-out (W x H x D)	28 1/2" x 43 7/16" x 23 1/2"
Overall Depth (in) - including handle	26 7/8"
Actual Depth w/lt Door Open (Upper) (in):	37.1"
Actual Depth w/lt Door Open (Lower) (in):	45.7"
Oven Interior Dimensions (Upper) (in) (W x H x D)	20 8/11" x 8 9/25" x 17 5/13"
Oven Interior Dimensions (Lower) (in) (W x H x D)	24 1/2" x 17 5/8" x 18 7/8"
Carton Dimensions (in) (W x H x D)	33" x 30" x 50"
POWER RATINGS	
Max. Amp load	40A
Rating	7.8kW
Requirements	120 / 240 VAC, 120 / 208 VAC

INSTALLATION REQUIREMENTS

- The cabinet base platform must be able to support 202 lbs (91.65 kg) for a Microwave Combination Wall Oven. If the cabinet does not have a solid bottom, two braces or runners must be installed level with the bottom of the cutout to support the weight of the oven. Make sure the base is level and the front of the cabinet is square. If the cabinet base is not level, the oven racks will tend to slide out when opening the door.
- If marks, blemishes or the cutout opening are visible above the installed oven, it may be necessary to add wood shims under the runners and front trim until the marks or opening are covered.
- If the cabinet does not have a front frame and the sides are less than 3/4" (1.9 cm) thick, shim both sides equally to establish the cutout width.
- The junction box must be flush with the rear wall of the cabinet as shown below.
- Allow at least a 23" clearance for the door depth when it is open.
- Kitchen cabinets in contact with the oven must be heat resistant up to 194°F (90°C), and fronts of nearby units up to at least 158°F (70°C).

CUTOUT DIMENSIONS

- Cabinet Width: 30" (762 mm)
- Recommended Minimum Cutout Location from Floor: 12" (304.8 mm)
- Cutout Depth: 23 1/2" Min. (596.9 mm)
- Cutout Width: 28 1/2" Min. (723.9 mm)  
28 5/8" Max. (727 mm)
- Cutout Height: 43 7/16" Min. (1103 mm)  
43 1/2" Max. (1106 mm)

PRODUCT DIMENSIONS



ELECTRICAL CONNECTIONS

- Be sure the wall oven is installed and grounded properly by a qualified installer or service technician.
- This wall oven must be electrically grounded in accordance with local codes or, in their absence, with the National Electrical Code ANSI/NFPA No.70- latest edition in United States, or with CSA Standard C22.1-1982 and C22.2 No.01982 (or latest edition), Canadian Electrical Code, Part1, and all local codes and ordinances.
- This wall oven must be supplied with the proper voltage and frequency, and connected to an individual, properly grounded branch circuit, protected by a circuit breaker or fuse. For the circuit breaker or fuse required by this model, see the rating plate to find the wattage consumption and refer to the table below to get the circuit breaker or fuse amperage.
- A Microwave Combination Wall Oven can consume up to 7,800 W at 240 VAC. A 50 Amp circuit breaker with wire gauge #8 AWG must be used.
- Do Not ground to a gas pipe.
- Do Not have a fuse in the neutral or grounding circuit.
- A U.L.-listed conduit connector must be provided at the junction box.
- Prepare the electrical connection as follows:
  - Turn off the circuit breaker or remove fuses to the oven branch circuit.
  - With the oven positioned directly in front of the cabinet opening, connect the flexible conduit to the electrical junction box as shown below. Position the conduit in such a manner that it will lie on top of the oven in a natural loop when the oven is installed.
  - If local codes permit connection of the frame grounding conductor to the neutral(white) wire, follow the instructions for a 3-wire circuit connection.
  - If used in mobile homes or new construction, or a recreational vehicle, or local codes do not permit connection of the frame grounding conductor to the neutral(white) wire, follow the instructions for a 4-wire circuit connection.

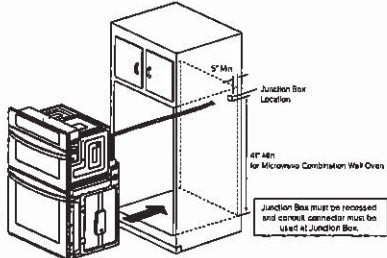

INSTALL THE OVEN

- Install the oven into the cabinet as follows:
  - Slide the oven into the opening.
    - Loop (do not tie) a 36" (91 cm) string around the conduit before the oven is slid into place. Lay the string over the top of the oven and use it to keep the conduit from falling behind the oven.
    - Lift oven into cabinet cutout using the oven opening as a grip. Carefully push against the oven front frame. Do not push against outside edges.
    - While sliding the oven back, pull the string so that the conduit lies on the top of the oven in a natural loop.
    - When you are sure the conduit is out of the way, slide the oven 3/4 way back into the opening. Remove the string by pulling on one end of the loop.
  - Secure the oven.
    - Using the mounting holes on the oven side trim as a guide, drill pilot holes for screws provided. (For securing the Combi Oven, use a minimum of 4 screws, one on each side in both the upper and lower ovens.)
    - Secure the oven to the cabinet with screws provided. If the cabinet is particle board, you must use 3/4" particle board screws. These may be purchased at any hardware store.
  - Install the metal bottom trim.
    - Place the metal bottom trim centered over the pre-drilled mounting holes on the lower base.
    - Using 3 screws provided, secure the bottom trim to the bottom edge of the cabinet.
  - Reinstall the oven door.

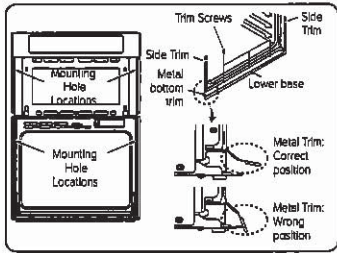

UK 3 WALLACETON  
LOT 381  
27-2587 CRN ELEV B  
THE MAXWELL

42 of 43

HOME APPLIANCES

LG DISHWASHERS

LDT7808\_

Top Control wi-fi Enabled Dishwasher with  
QuadWash™ and TrueSteam®

- 10 Wash Cycles
- QuadWash™
- TrueSteam®
- SmartThinQ® Technology with wi-fi
- LoDecibel™ Quiet Operation (42 dBA)
- Inverter Direct Drive™ Technology
- EasyRack™ Plus System
- Height Adjustable 3rd Rack
- Smooth Operating Racks
- LED Tub Light
- ENERGY STAR® Qualified
- Tub Material - NeveRust™ Stainless Steel



SmartThinQ®

Enjoy new ways to control your  
home with LG smart appliances

- Get notifications when dishes are clean
- Monitor the cycle time from your smartphone
- Works with the LG SmartThinQ® app



works with the  
Google Assistant



works with  
alexa

CAPACITY	
Total Place Settings	15
Upper Rack Dish Height Limit	7.1"
Lower Rack Dish Height Limit	12.5"
RACKS AND BASKETS	
EasyRack™ Plus System	Yes
Cutlery Baskets	Yes
Cup Rack	Yes
Stemware Holder	Yes
Fold Down Tines	Yes (Full Fold on Upper & Full Fold on Lower)
BPA-Free Nylon Coated Racks and Tines	Yes
Rack Handle	Yes (Upper) Yes (Lower)
Glide Rail (Upper Rack)	Yes
Wheel Bearing (Lower Rack)	Yes
Height Adjustable Upper Rack	Yes
Height-Adjustable 3rd Rack	Yes
STYLE AND DESIGN	
Control Panel Location	Top Control
Electronic Controls	Fully Integrated Control Panel
SignalLight™ Cycle Indicator Lights	3
Time Remaining Indicator	Yes (LED)
Tub Material	NeveRust™ Stainless Steel
Tub Light	Yes
Handle	Bar Handle
All Available Colors	Stainless Steel, Black Stainless Steel, Matte Black Stainless Steel, PrintProof™ Stainless Steel
Fingerprint Resistant	Yes (only LDT7808BM, LDT7808BD, & LDT7808SS)
FEATURES	
TrueSteam®	Yes
QuadWash™	Yes
Inverter Direct Drive Motor	Yes
LoDecibel™ Quiet Operation	42 dBA
Number of Wash Cycles	10 (Auto, Heavy, Delicate, Refresh, Normal, Turbo, Download Cycle, Machine Clean, Rinse, Express)
Number of Options	9 (Dual Zone, Half Load, Energy Saver, Steam, High Temp, Extra Dry, Delay Start, Control Lock, Night Dry)
Number of Spray Arms	3 (Top, Upper, Lower)
SenseClean™ Wash System	Yes
Vario Wash	Yes
Detergent and Rinse-Aid Dispenser	Yes

Hybrid Condensing Drying System	Yes
End of Cycle Indicator	Yes (Beeper + END indication on display)
Hidden Water Heater	Yes
Safety Float Switch (Leaks)	Yes
Soil (Turbidity) Sensor	Yes
Tub Insulation (Damping Sheet, Sound Absorbing Material (felt), Base)	Yes
BPA-Free Nylon Coated Racks and Tines	Yes
Anti-Bacterial Treatment (Sump, Inner / Outer filter, Drain pump case, Drain hose)	Yes
Balanced Door	Yes
3-Stage Filtration System	Yes
SmartThinQ® SMART FEATURES	
wi-fi Enabled	Yes
Voice Activation	Yes
Works with	Google Assistant and Amazon Alexa
SmartDiagnosis™	Yes
POWER RATINGS	
ENERGY STAR® Qualified	Yes
CEE Tier	1
Energy Use (kWh/Year)	258 kWh/Year
Water Factor (WF)	2.8
DIMENSIONS / CLEARANCES / WEIGHT	
Product Dimensions (in) (W x H x D)	23 3/4" x 33 5/8" x 24 5/8"
Product Weight (lbs)	92.2 lbs
Depth with Door Closed with Handle (in)	26 7/8"
Depth with Door Open (in)	50 1/2"
Carton Dimensions (in) (W x H x D)	28" x 34 3/4" x 29 5/8"
Shipping Weight with Carton (lbs)	104.3 lbs
LIMITED WARRANTY	
Labor	1 Year
Parts	1 Year
Control Board and Rack Parts	5 Years
Direct Drive Motor	10 Years
Stainless Steel Door Liner or Tub	Lifetime
UPC CODES	
LDT7808BM (Matte Black Stainless Steel)	048231339926
LDT7808BD (Black Stainless Steel)	048231339919
LDT7808ST (Stainless Steel)	048231339803
LDT7808SS (PrintProof™ Stainless Steel)	048231341165



UK 3 WALLACETON  
LOT 381  
27-2587 CRN ELEV B  
THE MAXWELL

43 of 43

HOME APPLIANCES

LG DISHWASHERS

LDT7808\_

Top Control wi-fi Enabled Dishwasher with  
QuadWash™ and TrueSteam®



QUICK INSTALL & CLEARANCES

For full installation directions/clearances please refer to  
the corresponding User Manual and Installation Guide.

DIMENSIONS / CLEARANCES / WEIGHT	
Product Dimensions (in) (W x H x D)	23 3/4" x 33 3/5" x 24 3/5"
Depth with Door Closed with Handle (in)	26 7/8"
Depth with Door Open (in)	50 1/2"
Carton Dimensions (in) (W x H x D)	28" x 34 7/10" x 29 3/5"
POWER RATINGS	
ENERGY STAR® Qualified	Yes
CEE Tier	1
Energy Use (kWh/Year)	258 kWh/Year
Water Factor (WF)	2.8

PREPARING CABINET OPENING

- This dishwasher is designed to fit a standard dishwasher opening. An opening may be needed on both sides to route plumbing and electrical connections.
- Select a location as close to the sink as possible for easy connections to water and drain lines.
- To ensure proper drainage, install the dishwasher no more than 12 ft. from the sink.
- If installing the dishwasher in a corner, leave a minimum of 2" between the dishwasher and the adjacent wall.
- To allow for proper clearance of plumbing and electrical, use the template included with the literature to determine the clearance on the side of the cabinet where the cabinet meets the back wall. Using a 2 1/2" diameter hole saw, drill a hole in the target area as shown on the template.

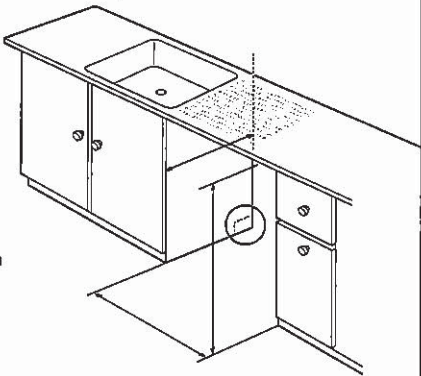

⚠ WARNING

Don't use existing holes unless they are in the target area. Otherwise, the water supply and drain hose may be damaged by being crushed or kinked.

⚠ CAUTION

Failure to properly locate the hole for the water and drain lines may prevent the dishwasher from installing flush with the cabinets and could result in kinked or damaged lines. Installation damage is not covered by the warranty, and leaks caused by improper installation may result in property damage.



PREPARING ELECTRICAL WIRING

- Operate this appliance with the correct voltage as shown in your User Manual and on the rating plate. Connect it to a dedicated, properly grounded branch circuit which is protected by a time delay fuse. Connect the appliance using 3-wires, including a ground wire.
- If an outlet and other power connector are used, it should be in an accessible location adjacent to and not behind the dishwasher and within 4 ft. of the dishwasher's side.
- The wiring must be grounded properly. If in doubt, have it checked by a qualified electrician. Do not connect any other appliance to the same outlet.
- Route the wiring.
- Make sure the electrical cable is oriented in the right side channel.

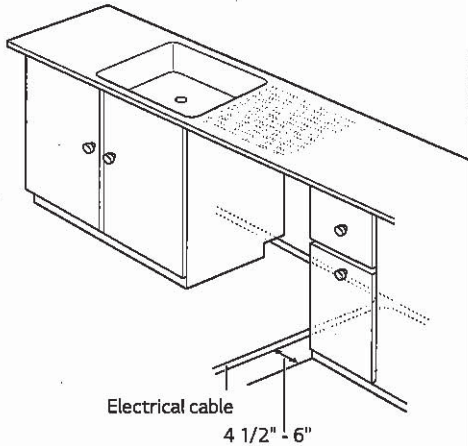

⚠ WARNING

- For personal safety, remove house fuse or open circuit breaker before installation.
- Do not use an extension cable or adapter with this dishwasher
- If you find any damage to the dishwasher, contact your retailer or contractor.

PREPARING WATER SUPPLY CONNECTION

- Make sure the house water supply is turned off before connecting the dishwasher water lines.
- Connect the dishwasher to a hot water supply with a temperature range between 120 °F (49 °C) and 149 °F (65 °C). This temperature range provides the best washing results and shortest cycle time. To prevent damage to dishes, the temperature should not exceed 149 °F (65 °C).
- When connecting the dishwasher water line, sealing tape or compound should be used on pipe threads to avoid leaks. Tape or compound should not be used on compression fittings.
- The water supply tube must be located in the left side channel.

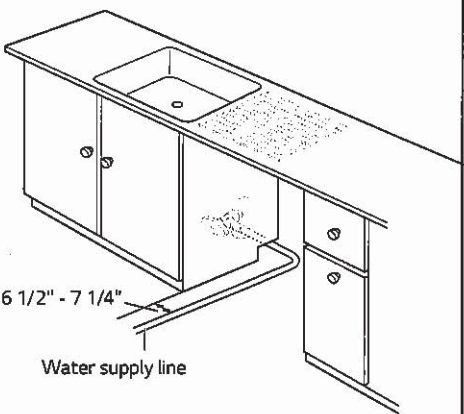

NOTE

Use new hoses when connecting to the water supply. Do not reuse old hoses.