

Sales Selection Sheet  
Checklist

1 of 39

LOT 3184B-7    Model: 20-1606 A The Grassfield  
PURCHASERS: GURBANI SABHARWAL/HARMEET, SINGH ANEJA  
VENDOR:        Heathwood Homes (Huron) Limited

DECK LOT  
OPTIONAL DOUBLE SINKS IN MASTER ENSUITE BATHROOM

- ☒ FINISHED BASEMENT  
☐ COLD CELLAR

- UPGRADED / MODIFIED ELEVATION
- ☐ CORNER UPGRADE  
☐ REAR UPGRADE

- CEILING UPGRADE - SMOOTH
- ☐ MAIN FLOOR  
☐ SECOND FLOOR  
☐ BASEMENT

- ADDITIONAL ROUGH-INS
- ☐ 200 AMP SERVICE  
☐ WET BAR ROUGH-IN  
☐ HUMIDIFIER  
☒ AIR CONDITIONING

- GAS ROUGH-IN
- ☐ STOVE  
☐ DRYER  
☐ BBQ  
☐ ADDITIONAL FIREPLACE

- KITCHEN: HOODFAN VENTING SIZE
- ☐ 6 IN ROUND DUCT  
☒ 7 IN ROUND DUCT

FULL BASEMENT STAIRS:	N/A
UPPER BASEMENT STAIRS:	All Oak
LOWER BASEMENT STAIRS:	Carpet Grade
MAIN STAIRS:	All Oak
MEDIA STAIRS (if applicable):	N/A
LOFT STAIRS (if applicable):	N/A

APRIL 7/22    *Signatures*  
Date    Purchaser: *on file*

APRIL 7/22    TINA LEFUR  
Date    Decor Consultant:

Date    Purchaser:

*APPROVED*  
-04- 07 2022    *m. Rosen*  
Date    Heathwood Homes (Huron) Limited  
Approved

Locked Date:

Customer Colours

GURBANI SABHARWAL/HARMEET, SINGH ANEJA  
Project: Wallaceton  
Unit: 3184B-7, Phase: 3  
Model: 20-1606 A The Grassfield

2 of 39

424

Created: 1/11/2022 09:02:02

Locked:

Closed:

Kitchen

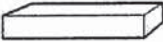
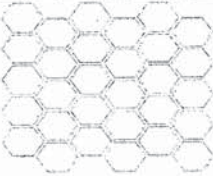
Cabinet Colour/Style	9156	Viking III-SIMCOE-RAIN CLOUD-3DL ***STD***
Countertop	7821	Group 1-Granite-GRIGIO SARDO-3/4 inch ***STD***
Countertop Edge	4010	SINGLE POLISHED STRAIGHT EDGE 3/4 INCH ***STD*** 
Cabinet Hardware	2086	9677-HARDWARE ***STD***
Island Cabinet Colour/Style	9156	Viking III-SIMCOE-RAIN CLOUD-3DL ***STD***
Island Countertop	7821	Group 1-Granite-GRIGIO SARDO-3/4 inch ***STD***
Backsplash	8103	OD.ON.SWT.02.HEX.MT-ONTARIO HEXAGON MATTE-SNOW WHITE ***2***
Backsplash Grout	2225	Grout-(27) Silver ***STD***
Backsplash Tile Pattern	3110	HORIZONTAL HEX ***STD*** 
HoodFan	3110	AV1308 Air King 30
Appliance	3110	Purchasers have been advised: standard fridge opening is a minimum 37 3/8 x 73 3/8". Ice Waterline Rough-In is included.
Appliance	3110	Standard stove opening is 30" and standard dishwasher opening is 24". Any gas stove will require backsplash or stainless steel backing to avoid fire hazards.
Appliance	3110	Purchasers acknowledge: Heathwood Homes and its contractors will not be responsible for any kitchen cabinet changes due to appliances dimension changes after
Comment		

PG 28

Kitchen/Breakfast

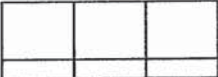
Flooring	3110	GE.BY.AZR.1313 New Byzantine Azzuro 13
Floor Tile Grout	2225	Grout-(27) Silver ***STD***
Floor Tile Pattern	3000	STANDARD SQUARE ***STD*** 



GURBANI SABHARWAL/HARMEET, SINGH ANEJA  
Project: Wallaceton  
Unit: 3184B-7, Phase: 3  
Model: 20-1606 A The Grassfield



Comment

Foyer

Flooring

3000

GE.BY.AZR.1313 New Byzantine Azzuro 13

Floor Tile Grout

2225

Grout-(27) Silver \*\*\*STD\*\*\*

Floor Tile Pattern

3000

STANDARD SQUARE \*\*\*STD\*\*\*

Comment

Laundry Room

Flooring

3000

GE.BY.AZR.1313 New Byzantine Azzuro 13

Floor Tile Grout

2225

Grout-(27) Silver \*\*\*STD\*\*\*

Floor Tile Pattern

3000

STANDARD SQUARE \*\*\*STD\*\*\*

Comment

Mud Room

Flooring

3000

GE.BY.AZR.1313 New Byzantine Azzuro 13

Floor Tile Grout

2225

Grout-(27) Silver \*\*\*STD\*\*\*

Floor Tile Pattern

3000

STANDARD SQUARE \*\*\*STD\*\*\*

Comment

Customer Colours

GURBANI SABHARWAL/HARMEET, SINGH ANEJA  
Project: Wallaceton  
Unit: 3184B-7, Phase: 3  
Model: 20-1606 A The Grassfield

Created: 1/11/2022 09:02:22

Locked:

Closed:

Powder Room

Flooring	3000	GE.BY.AZR.1313 New Byzantine Azzuro 13									
Floor Tile Grout	2225	Grout-(27) Silver ***STD***									
Floor Tile Pattern	3000	STANDARD SQUARE ***STD*** <table><tr><td></td><td></td><td></td></tr><tr><td></td><td></td><td></td></tr><tr><td></td><td></td><td></td></tr></table>									
Plumbing Fixture (Colour)	1737	Plumbing Fixtures-WHITE ***STD***									
Comment											

Hall

Flooring	1737	GE.BY.AZR.1313 New Byzantine Azzuro 13									
Grout	2225	Grout-(27) Silver ***STD***									
Floor Tile Pattern	3000	STANDARD SQUARE ***STD*** <table><tr><td></td><td></td><td></td></tr><tr><td></td><td></td><td></td></tr><tr><td></td><td></td><td></td></tr></table>									
Comment											

Great Room

Flooring	7502	Red Oak Pearl-Vintage Engineered-PEWTER/ECLIPSE-3/4 inch x 3 1/4 inch
Comment		

Upper Hall

Flooring	9248	DY 89418 -Dynasty Tex-BLACK ICE-40 oz Poly***STD ***
Comment		

Finished Basement (Rec) Room/Hall

Flooring	9248	DY 89418 -Dynasty Tex-BLACK ICE-40 oz Poly***STD***
Comment		

Master Bedroom

Flooring	9248	DY 89418 -Dynasty Tex-BLACK ICE-40 oz Poly***STD ***
Comment		

Bedroom 2

Flooring	9248	DY 89418 -Dynasty Tex-BLACK ICE-40 oz Poly***STD ***
Comment		

Bedroom 3

Flooring	9248	DY 89418 -Dynasty Tex-BLACK ICE-40 oz Poly***STD ***
Comment		

Master Ensuite

Cabinet Colour/Style	9111	VIKING III SIMCOE ORCHID 3DL ***STD***
Countertop	8796	6698-46-Countertop-PALOMA POLAR ETCHINGS FINISH-Formica ***STD***
Countertop Edge	1111	N/A *****
Cabinet Hardware	2086	9677-HARDWARE ***STD***
Floor Tile	2086	GE.SU.ATR.1313 Sauble Anthracite (Black) 13
Floor Tile Grout	7704	Grout-(19) Pearl Gray ***STD***



Customer Colours

GURBANI SABHARWAL/HARMEET, SINGH ANEJA  
Project: Wallaceton  
Unit: 3184B-7, Phase: 3  
Model: 20-1606 A The Grassfield

6 of 39

424

Created: 1/14/2022 09:02:22

Locked:

Closed:

Floor Tile Pattern	3000	STANDARD SQUARE ***STD*** <div><div></div><div></div><div></div><div></div><div></div><div></div><div></div><div></div><div></div></div>
Shower Floor Tile	8661	OD.ON.SWT.0202.MT.N-Ontario Series Mosaic-Snow White Matte-2 x 2 ***STD***
Shower Floor Tile Grout	7704	Grout-(19) Pearl Gray ***STD***
Shower Floor Tile Pattern	3000	STANDARD SQUARE ***STD*** <div><div></div><div></div><div></div><div></div><div></div><div></div><div></div><div></div><div></div></div>
Shower Wall Tile	9020	QT.WV.WHT.0810-Weave-White-8 x 10 ***STD***
Shower Wall Tile Grout	2226	Grout-(00) White ***STD***
Shower Wall Tile Pattern	3070	HORIZONTAL STACKED ***STD*** <div><div></div><div></div><div></div><div></div><div></div><div></div></div>
Shower Jamb(s) and Sill(s)	8923	Shower Jamb / Sill-Thassos White ***STD***
Plumbing Fixture (colour)	1737	Plumbing Fixtures-WHITE ***STD***
Comment		

Main Bathroom

Cabinet Colour/Style	6265	Viking III-MANCHESTER-SHALE GREY CL-MAPLE ***STD***
Countertop	8822	4924-38-Countertop-WHITE CARRARA-Wilsonart ***STD***
Countertop Edge	1111	N/A *****
Cabinet Hardware	2086	9677-HARDWARE ***STD***
Flooring	2086	GE.BY.AZR.1313 New Byzantine Azzuro 13
Floor Tile Grout	2225	Grout-(27) Silver ***STD***
Floor Tile Pattern	3000	STANDARD SQUARE ***STD*** <div><div></div><div></div><div></div><div></div><div></div><div></div></div>

Customer Colours

GURBANI SABHARWAL/HARMEET, SINGH ANEJA  
Project: Wallaceton  
Unit: 3184B-7, Phase: 3  
Model: 20-1606 A The Grassfield

Created: 1/11/2022 09:03:22  
Locked:  
Closed:

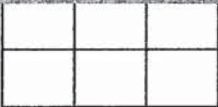

Wall Tile 9020 QT.WV.WHT.0810-Weave-White-8 x 10 \*\*\*STD\*\*\*

Wall Tile Grout 2226 Grout-(00) White \*\*\*STD\*\*\*

Main Bathroom Tile Pattern 3070 HORIZONTAL STACKED \*\*\*STD\*\*\*

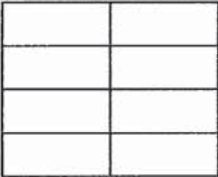

Plumbing Fixture (Colour) 1737 Plumbing Fixtures-WHITE \*\*\*STD\*\*\*

Comment

Finished Basement Bathroom

Cabinet Colour/Style 6265 Viking III-MANCHESTER-SHALE GREY CL-MAPLE \*\*\*STD\*\*\*

Countertop 8822 4924-38-Countertop-WHITE CARRARA-Wilsonart \*\*\*STD\*\*\*

Countertop Edge 1111 N/A \*\*\*\*\*

Cabinet Hardware 2086 9677-HARDWARE \*\*\*STD\*\*\*

Flooring 2086 GE.BY.AZR.1313 New Byzantine Azzuro 13

Floor Tile Grout 2225 Grout-(27) Silver \*\*\*STD\*\*\*

Floor Tile Pattern 3000 STANDARD SQUARE \*\*\*STD\*\*\*

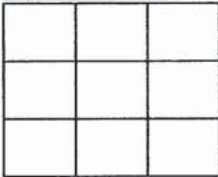

Shower Floor Tile 8661 OD.ON.SWT.0202.MT.N-Ontario Series Mosaic-Snow White Matte-2 x 2 \*\*\*STD\*\*\*

Shower Floor Tile Grout 7704 Grout-(19) Pearl Gray \*\*\*STD\*\*\*

Shower Floor Tile Pattern 3000 STANDARD SQUARE \*\*\*STD\*\*\*

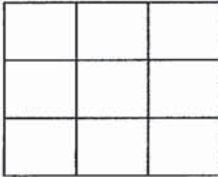

Shower Wall Tile 9020 QT.WV.WHT.0810-Weave-White-8 x 10 \*\*\*STD\*\*\*



Customer Colours

GURBANI SABHARWAL/HARMEET, SINGH ANEJA  
Project: Wallaceton  
Unit: 3184B-7, Phase: 3  
Model: 20-1606 A The Grassfield

Created: 1/11/2022 09:02:22  
Locked:  
Closed:

Shower Wall Tile Grout	2226	Grout-(00) White ***STD***								
Shower Wall Tile Pattern	3070	HORIZONTAL STACKED ***STD***								
		<table><tr><td></td><td></td></tr><tr><td></td><td></td></tr><tr><td></td><td></td></tr><tr><td></td><td></td></tr></table>								
Shower Jamb(s)	8923	Shower Jamb / Sill-Thassos White ***STD***								
Plumbing Fixture (Colour)	1737	Plumbing Fixtures-WHITE ***STD***								
Comment										

Great Room Fireplace

Type	8865	Dimplex-Electric Fireplace-PF3033HL ***STD***	
Mantle	9114	NF 15-Paint Grade Mantle- Cabinet (Per Plan)-WHITE ***STD***	PG 18
Surround Opt.	1111	N/A *****	
Disclaimer	1111	Purchasers have been advised: heat from the FP can damage TV above a FP and items placed on mantle.	
Disclaimer	1111	Heathwood and its contractors will not be liable for any damage on items placed/installed above a FP after closing.	
Comment			

Basement Stairs

Type	1714	Carpet Grade Stairs ***STD BASEMENT STAIRS***
Colour	7922	Eclipse (Pewter) STAIN TO COMPLIMENT HARDWOOD AND WILL VARY FROM FLOORING ***99***
Carpet Runner	1111	N/A *****
Handrail/Pickets/Post Type	9119	Handrail only on closed walls (one or two sides per building code) ***STD***
Handrail/Pickets/Post Colours	1729	Carpet Grade-Stain handrail, pickets, stringers, nosing .pos
Carpet	9248	DY 89418 -Dynasty Tex-BLACK ICE-40 oz Poly***STD***
Custom Stain/Paint	1111	N/A *****



Customer Colours

GURBANI SABHARWAL/HARMEET, SINGH ANEJA  
Project: Wallaceton  
Unit: 3184B-7, Phase: 3  
Model: 20-1606 A The Grassfield

Created: 1/11/2022 09:03:22  
Locked:  
Closed:

Comment	
---------	--

Basement Stairs Landings (Upper and Lower)

Flooring	1111	Red Oak Pearl-Vintage Engineered-PEWTER/ECLIPSE-3/4 inch x 3 1/4 inch ***3***
Comment		

Main Stairs

Type	1111	Oak Stairs ***STD MAIN STAIRS***
Colour	7922	Eclipse (Pewter) STAIN TO COMPLIMENT HARDWOOD AND WILL VARY FROM FLOORING ***99***
Carpet Runner	1111	N/A *****
Handrail/Pickets/Posts Type	1111	1 5/16 inch Square pickets with 3 1/2" Square/Cap Post(s)-ALL OAK ***STD***
Handrail/Pickets/Posts Colour	1728	Oak Grade-Stain handrail,oak pickets,stringers,treads,risers
Custom Stain/Paint	1111	N/A *****
Comment		

Main Stairs Landing(s)

Flooring	1111	Red Oak Pearl-Vintage Engineered-PEWTER/ECLIPSE-3/4 inch x 3 1/4 inch
Comment		

Throughout



Walls - Paint Colour	1111	22-Wall-WARM GREY ***STD***
Underpad	1111	500 Series-Underpad ***STD***
Thresholds	1111	Metal Thresholds ***STD***
Switches and Plug	1111	Decora White Switches and Plugs ***STD***
Trim Size	1111	4 1/4 Baseboard and 2 3/4 Casings ***STD***
Trim Colour	1111	Trim-WHITE ***STD***



GURBANI SABHARWAL/HARMEET, SINGH ANEJA  
Project: Wallaceton  
Unit: 3184B-7, Phase: 3  
Model: 20-1606 A The Grassfield

Created: 1/11/2022 09:03:22  
Locked:  
Closed:

Trim - Paint Colour	1716	Trim-WHITE STD
---------------------	------	----------------

Comment

Purchaser:			
	GURBANI SABHARWAL	Decor Consultant	
	29 <sup>th</sup> March 22		03/29/22
	Date		Date

Purchaser:			
	HARMEET, SINGH ANEJA	Wallaceton	
	29 Mar 22		-04- 07 2022
	Date		Date Approved





CONSTRUCTION SUMMARY

Lot: 3184B-7  
Model: 20-1606 A The Grassfield  
Project/Phase: Wallaceton / 3

Offer Worksheet	THIS IS A DECK LOT COMPLETE WITH A 4 FT. DEEP DECK WITH STAIRS TO GRADE AMENDMENT DATED MARCH 15, 2022 Note:
Offer Worksheet	Five Appliances: SS Fridge, Stove, Dishwasher: White Front Loader Washer/Dryer - Townhomes Note:
Offer Worksheet	The Purchaser(s) acknowledge that they have NOT been referred by an existing Heathwood Homeowner and therefor are not entitled to a referral fee under Heathwood Homes Referral program. Note:



CONSTRUCTION SUMMARY

Lot: 3184B-7  
Model: 20-1606 A The Grassfield  
Project/Phase: Wallaceton / 3

CABINETRY

Invoice	Qty.	Description
1028 313,768 07Apr22	1	KITCHEN - 11A-Upper angle corner per unit Viking  SKETCH # 3 <b>DRYWAL-Notify; FRAMING-Notify; PAINTING-Notify</b>
1028  07Apr22 ** NoCat	1	MASTER ENSUITE - PLUMBING - OPTION FROM ONE SINK TO DOUBLE SINKS INCLUDING STD CHATEAU FAUCET OVERMOUNT COLONY SINK ONE EXTRA VANITY LIGHT AND CABINET CONVERSION 2D VIKING SKETCH # 4 <b>CABINETRY-2D Convert Cabinetry Viking; ELECTRICAL-Additional Vanity Light</b>

CERAMICS

Invoice	Qty.	Description
1028 308,144 07Apr22	1	Kitchen - CERAMICS - BACKSPLASH - KITCHEN - UPGRADE 2

DRYWALL

Invoice	Qty.	Description
1028 313,768 07Apr22 **	1	KITCHEN - 11A-Upper angle corner per unit Viking  SKETCH # 3 <b>DRYWAL-Notify; FRAMING-Notify; PAINTING-Notify</b>

ELECTRICAL

Invoice	Qty.	Description
1028 314,223 07Apr22	1	GREAT ROOM - ELECTRICAL - ADDITIONAL SWITCH  1X WITH CAPPED ELECTRICAL CENTERED +/- ON GREAT ROOM CEILING
1028 314,224 07Apr22	1	GREAT ROOM - ELECTRICAL - CEILING ROUGH-IN (CAPPED)  1X CENTERED +/- ON GREAT ROOM CEILING ON SEPERATE SWITCH SKETCH # 2
1028  07Apr22 ** NoCat	1	MASTER ENSUITE - PLUMBING - OPTION FROM ONE SINK TO DOUBLE SINKS INCLUDING STD CHATEAU FAUCET OVERMOUNT COLONY SINK ONE EXTRA VANITY LIGHT AND CABINET CONVERSION 2D VIKING SKETCH # 4 <b>CABINETRY-2D Convert Cabinetry Viking; ELECTRICAL-Additional Vanity Light</b>
1028 314,232 07Apr22	1	GREAT ROOM - ELECTRICAL - EXTRA WALL INTERIOR OUTLET ON EXISTING CIRCUIT (DOES NOT INCLUDE KITCHEN OUTLETS)  GREAT ROOM - TO BE CENTERED +/- APPROXIAMTELY 70" FROM FLOOR ABOVE THE FIREPLACE SKETCH # 2

FRAMING

Invoice	Qty.	Description
1028 313,768 07Apr22 **	1	KITCHEN - 11A-Upper angle corner per unit Viking  SKETCH # 3 <b>DRYWAL-Notify; FRAMING-Notify; PAINTING-Notify</b>





CONSTRUCTION SUMMARY

Lot: 3184B-7  
Model: 20-1606 A The Grassfield  
Project/Phase: Wallaceton / 3

PAINTING

Invoice	Qty.	Description
1028 313,768 07Apr22 **	1	KITCHEN - 11A-Upper angle corner per unit Viking  SKETCH # 3 <b>DRYWAL-Notify; FRAMING-Notify; PAINTING-Notify</b>

PLUMBING

Invoice	Qty.	Description
1028  07Apr22 NoCat	1	MASTER ENSUITE - PLUMBING - OPTION FROM ONE SINK TO DOUBLE SINKS INCLUDING STD CHATEAU FAUCET OVERMOUNT COLONY SINK ONE EXTRA VANITY LIGHT AND CABINET CONVERSION 2D VIKING SKETCH # 4 <b>CABINETRY-2D Convert Cabinetry Viking; ELECTRICAL-Additional Vanity Light</b>

THE GRASSFIELD

ELEVATION A | 1,986 SQ. FT.

Includes 380 sq. ft. of Finished Lower Level

WALLACETON  
EST. 1870

20-1606 ELEV. A

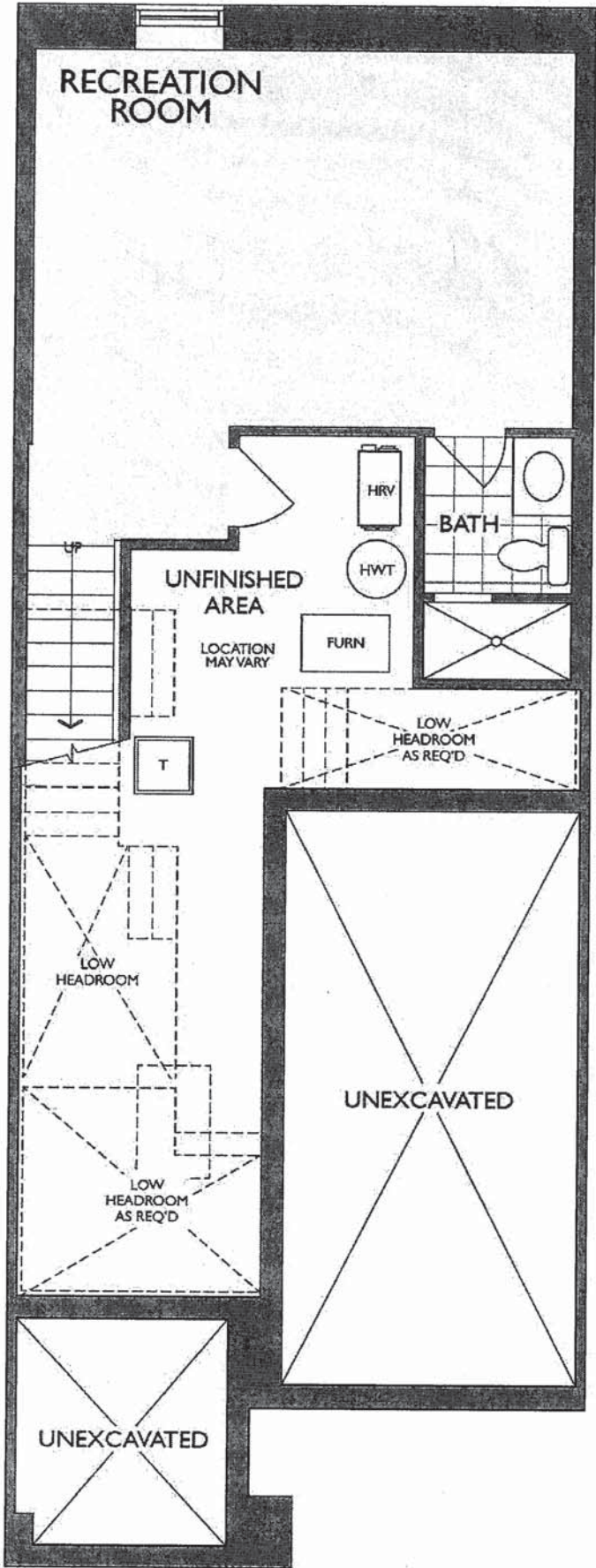

Handwritten signature/initials.



THE GRASSFIELD

ELEVATION A | 1,986 SQ. FT.

Includes 380 sq. ft. of Finished Lower Level

WALLACETON  
EST. 1870

20-1606 ELEV. A

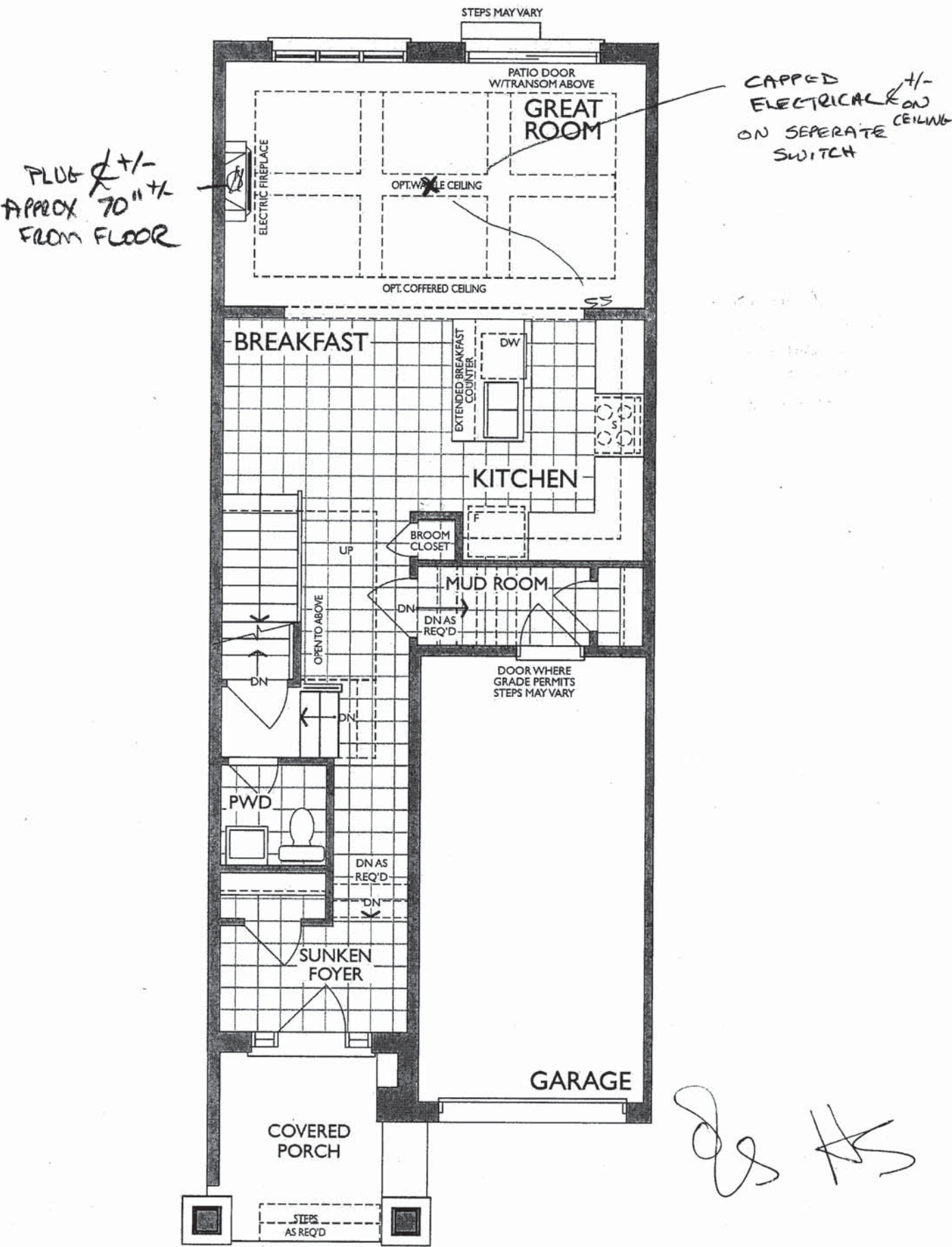

MAIN FLOOR  
ELEVATION A

KITCHEN  
(GROUND FLOOR)

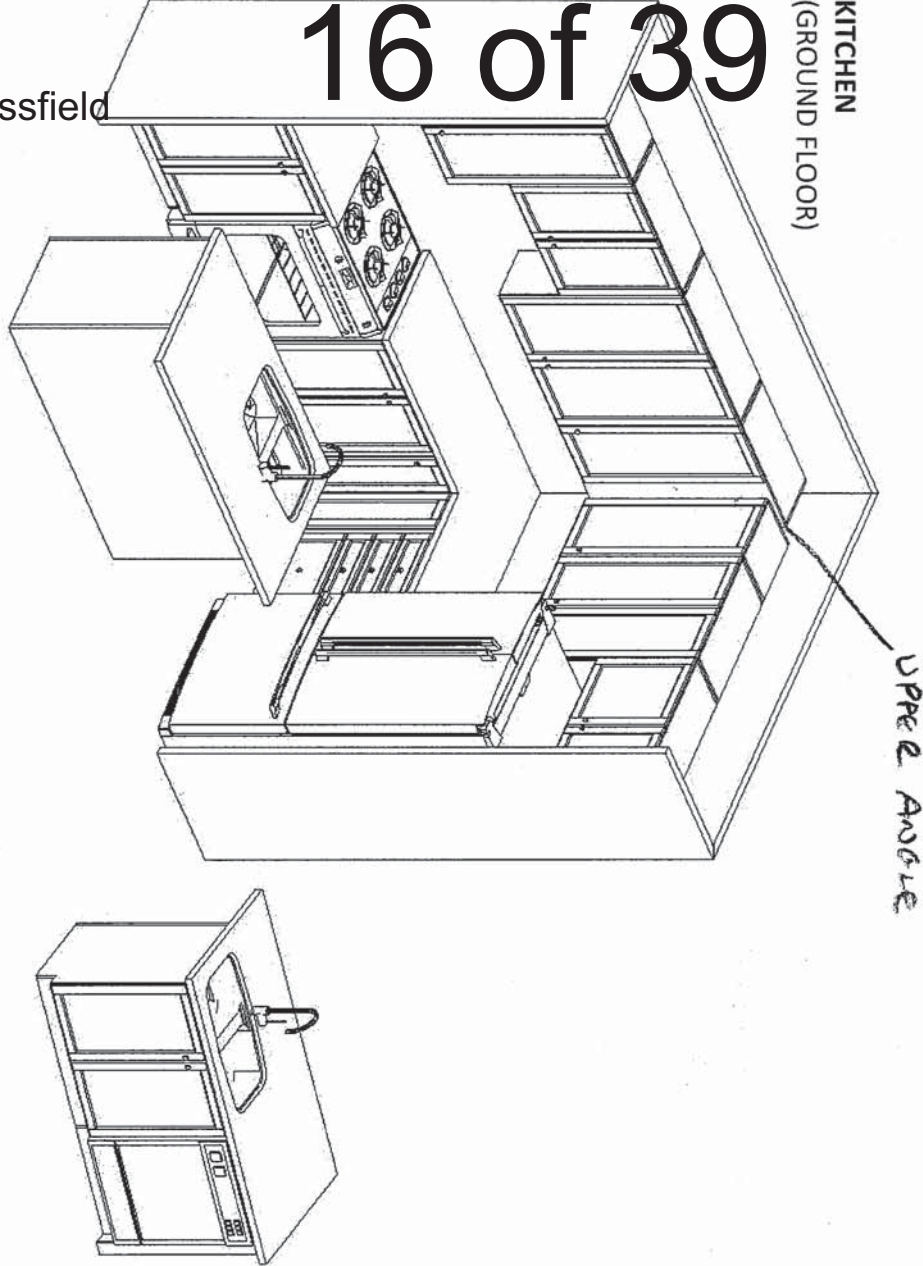

STD. BASEMENT BATH

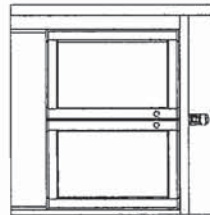

DOUBLE SINK

MASTER ENSUITE  
(2ND FLR)



88  
MAIN BATH  
(2ND FLR)

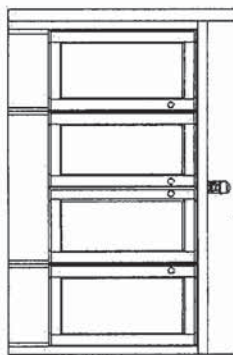

Project: Wallaceton  
Unit: 3184B-7, Phase: 3  
Model: 20-1606 A The Grassfield

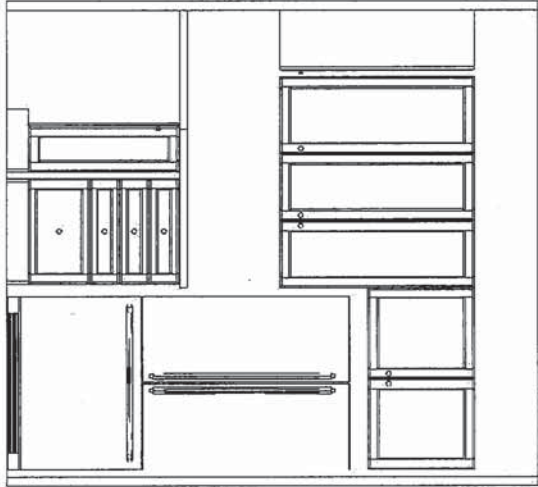
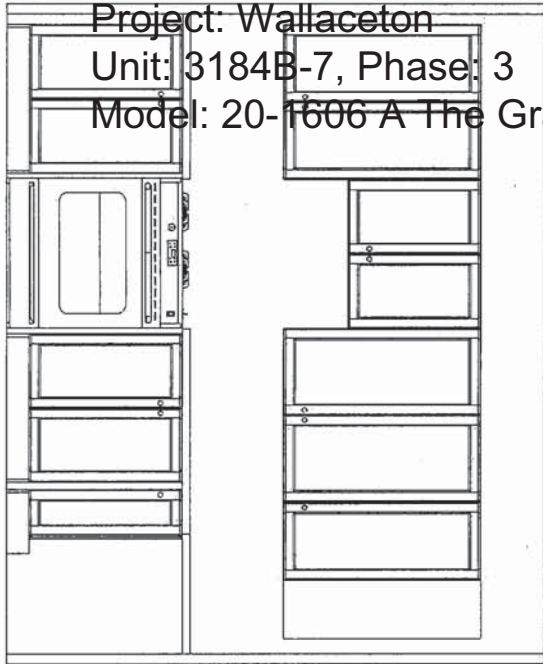

F R E N D E L  
K I T C H E N S L I M I T E D

1350 Shawson Drive, Mississauga, ON L4W 1C5

HEATHWOOD HOMES  
WALLACETON, KITCHENER ON  
MODEL: 20-1606 (2003)

STANDARD CONTRACT INCLUDES:

**Appliance Openings**

- Hood Opening: 30" W Std. hood
- Fridge Opening: 37 3/8 "W X 73 3/8" H
- 30cm deep cabinet over fridge
- Stove Opening: 30" Freestanding
- Dishwasher Opening: 24"

**Standard Kitchens Scope:**

- 100cm H wall cabinets
- Std. Blumotion Hinges- **soft close**
- Std. Metabox Drawers- **not soft close**
- Min 40cm W drawer
- Base pie cut corner cabinets
- Backing on all cabinets
- Countertop by others
- Upgrade applied paneled fridge & dishwashers supply only (appliance hardware by others)

**Standard Vanity & Laundry Scope:**

- Powder by others, pedestal
- All vanities include laminate counter
- Std. Blum Hinges- **not soft close**
- Tandem Box Drawers- **soft close**
- Master Ensuite: Top drawers (Full height doors at sink)
- Mains: Full height doors (top drawers added if Masters can't accommodate)
- Optional laundry base & wall cabinets



THE GRASSFIELD

ELEVATION A | 1,986 SQ. FT.

Includes 380 sq. ft. of Finished Lower Level

WALLACETON

EST. 1870

20-1606 ELEV. A

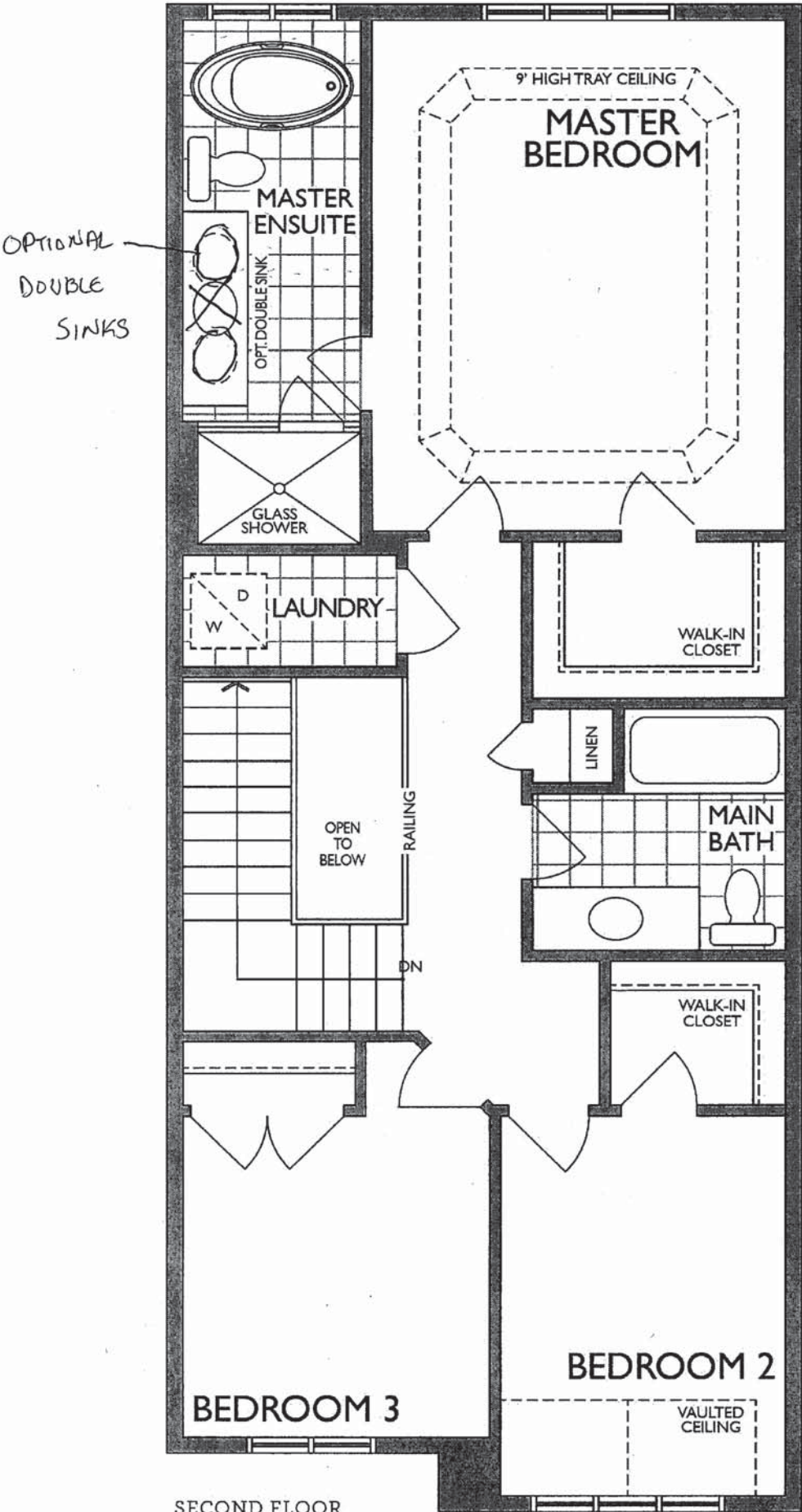

SECOND FLOOR  
ELEVATION A

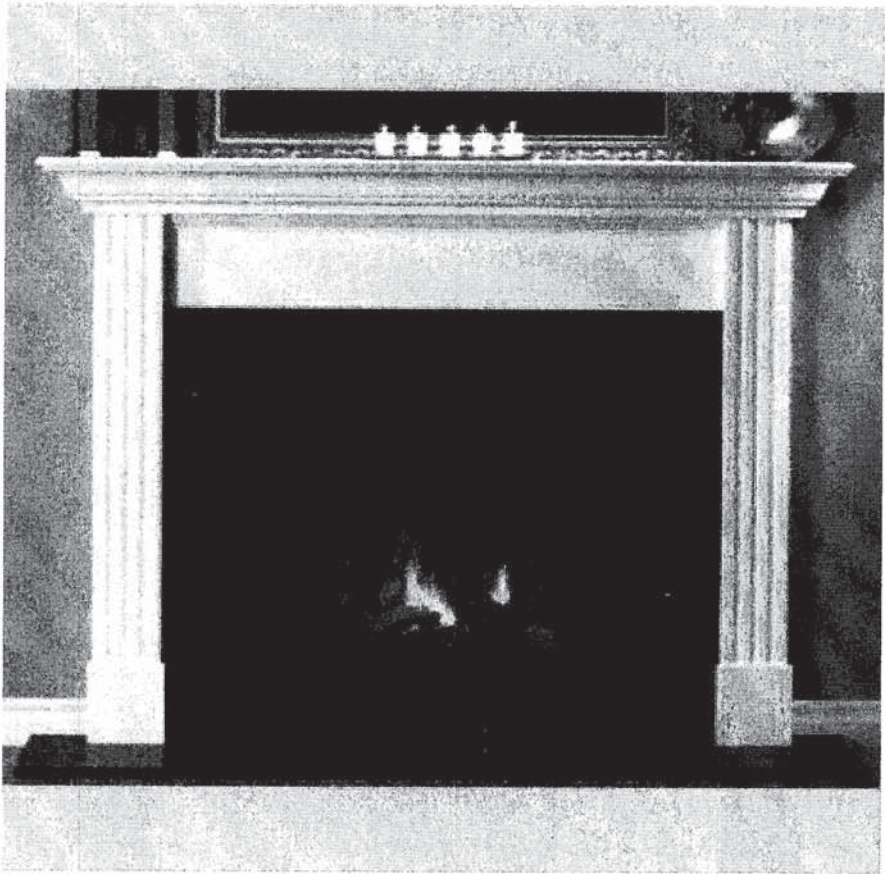

**NEAS NF15 Mantel**

HS. 82.



*Reginox*

ND1831UA/9

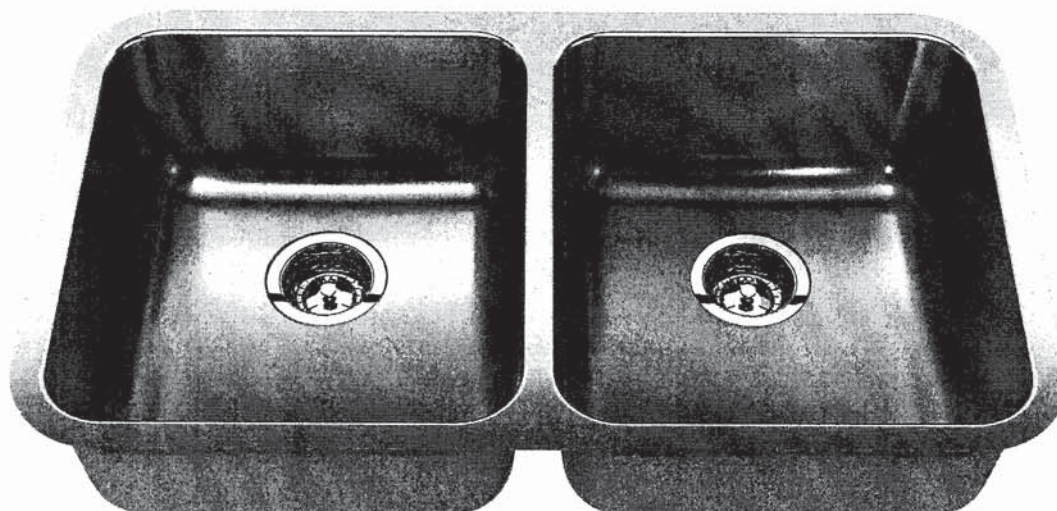

Optional Accessories

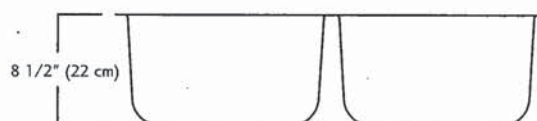
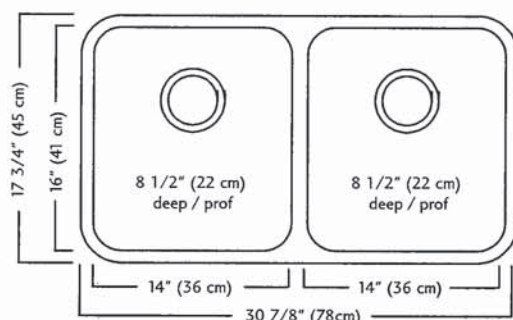

*ds. HS*

## ND1831UA/9 SPECIFICATION

Model ND1831UA/9 is a double (two equal size) bowl undermount sink manufactured by Franke Kindred Canada Limited from 18 gauge stainless steel. Product has silk finished rims and linear brush finished bowls. Sink is fully undercoated. Basket strainer waste fittings (3 1/2", 89 mm) are included. Sink is backed with a limited lifetime warranty.

- O.D. 17 3/4" x 30 7/8" x 8 1/2" (45 x 78 x 22 cm)
- **Recommended for minimum 36" cabinet**

Franke Kindred Canada Limited

P.O. Box 190, 1000 Franke Kindred Road, Midland, Ontario, Canada, L4R 4K9 Phone: 866-687-7465 Fax: 800-361-8408



# MOEN®

There is more than 1 version of this model.  
Page down to identify the version you have.

## FAUCET DESCRIPTION

- Reflex™ pulldown system offers smooth operation, easy movement and secure docking
- Power Clean™ spray technology
- Metal construction with various finishes identified by suffix
- Duralock™ connect installation
- Pulldown spray with 68" braided hose
- Flexible supply lines with 3/8" compression fittings
- High arc spout provides height and reach to fill or clean large pots while pulldown wand provides the maneuverability for cleaning or rinsing
- 360° rotating spout
- Faucet designed for handle to be mounted on right side only

## OPERATION

- Lever style handle
- Temperature controlled by 100° arc of handle travel
- Operates with less than 5 lbs. of force
- Operates in stream or spray mode in the pullout or retracted position

## FLOW

- Flow is limited to 1.5 gpm (5.7 L/min) max at 60 psi

## CARTRIDGE

- 1255™ Duralast™ cartridge

## STANDARDS

- Third party certified to IAPMO Green, ASME A112.18.1/CSA B125.1 and all applicable requirements therein including NSF 61/9G & 372
- Meets CalGreen and Georgia SB370 requirements
- Complies with California Proposition 65 and with the Federal Safe Drinking Water Act
- The backflow protection system in the device consists of two independently operating check valves, a primary and a secondary which prevent backflow

- ADA  for lever handle

## WARRANTY

- Lifetime limited warranty against leaks, drips and finish defects to the original homeowner
  - 10 year limited warranty when used in a multifamily installation
  - 5 year limited warranty when used in a commercial installation
- Visit [www.moen.com/support](http://www.moen.com/support) for complete details and limitations

## Specifications

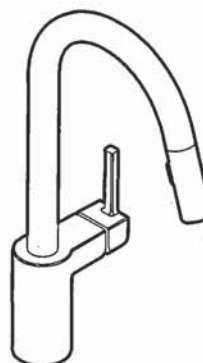

**ALIGN™**  
**Single Handle High Arc**  
**Pulldown Kitchen Faucet**

**Models:** 7565 series

**NOTE:** THIS FAUCET IS DESIGNED TO BE INSTALLED  
THROUGH 1 HOLE, 1-1/2" (38mm) MIN. DIA.  
(OPTIONAL 3-HOLE ESCUTCHEON 141002 AVAILABLE)

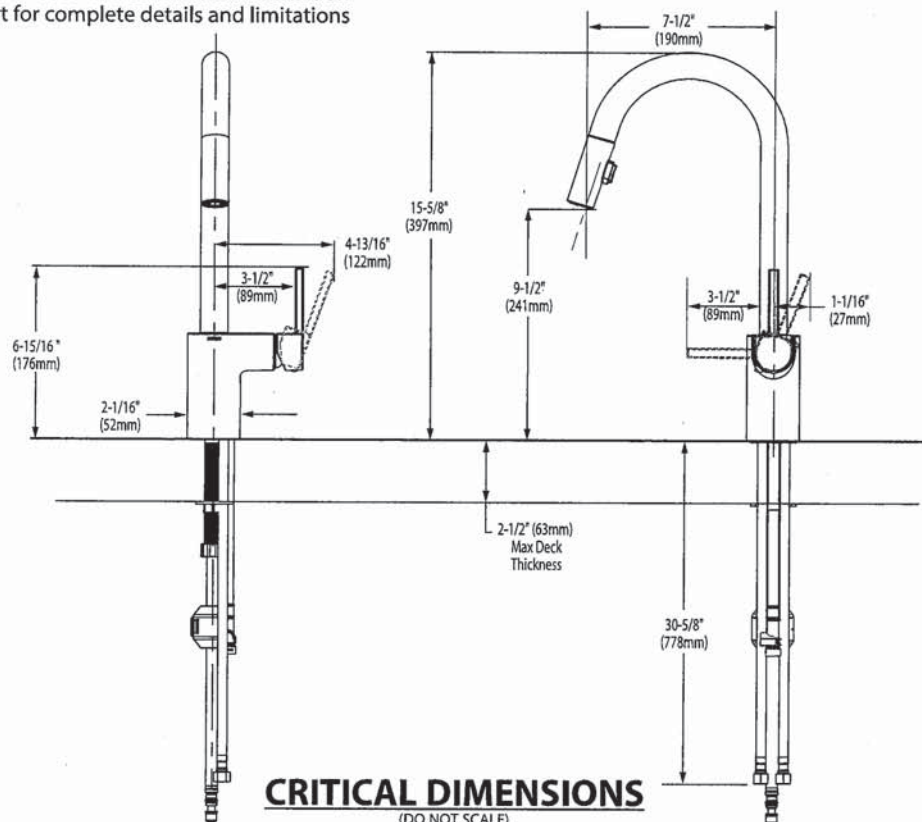



BARRIER FREE (ABOVE COUNTER OR DROP-IN ONLY)

**BOULEVARD®**  
**PEDESTAL SINK**  
VITREOUS CHINA

**BOULEVARD® PEDESTAL SINK**

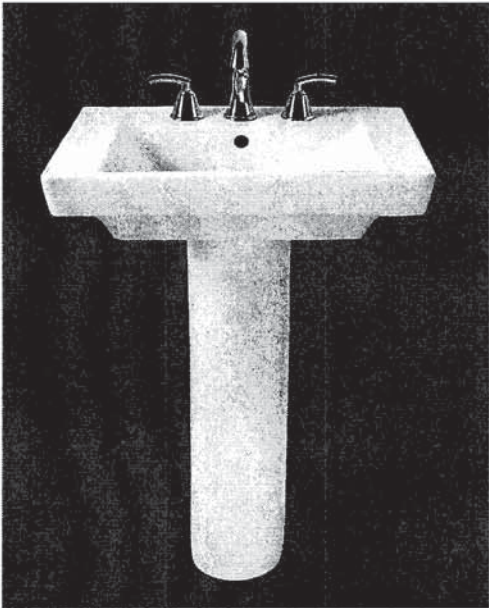

- STD ☒ **0641.800** Faucet holes on 8" (203mm) centers (Illustrated)
- ☒ **0641.400** Faucet holes on 4" (102mm) centers
- ☐ **0641.100** Center hole only
- Classic styled rectangular pedestal lavatory
  - Vitreous china
  - Rear overflow
  - Supplied with mounting kit
  - Right Height® for greater comfort during use
  - Faucet ledge with large deck area (faucet not included)
  - **Design coordinates with Boulevard® Toilet**
  - Basin has flat bottom to also allow use as an **above counter** sink or a **drop-in** sink (with u-shaped cut out)

**Nominal Dimensions:**

24" x 19" x 35-1/2"  
(610 x 483 x 902mm)

- ☐ **0641.008** Pedestal top-8" (203mm) centers
- ☐ **0641.004** Pedestal top-4" (102mm) centers
- ☐ **0641.001** Pedestal top-center hole only
- ☐ **0010.000** Pedestal only

SEE REVERSE FOR ROUGHING-IN DIMENSIONS

**Bowl sizes:**

17" (432mm) wide,  
12-1/2" (318mm) front to back,  
5" (127mm) deep

**Compliance Certifications -**

**Meets or Exceeds the Following Specifications:**

- ASME A112.19.2 - 2008/CSA B45.1-08

HS. 82.

**To Be Specified:**

- ☐ Color: ☐ White ☐ Linen
- ☐ Faucet Finish:
- ☐ Supplies:
- ☐ 1-1/4" Trap:
- ☐ Nipple:

\* See faucet section for additional models available





COLONY COUNTERTOP SINK

- Vitreous china
  - Self-rimming
  - Front overflow
  - Supplied with template
  - Faucet deck  
(Faucet shown not included)
- ☐ 0346 803  
Faucet holes on 203mm (8") centres
- ☒ 0346 403 (Illustrated)  
Faucet holes on 102mm (4") centres
- ☐ 0346 001  
Centre hole only

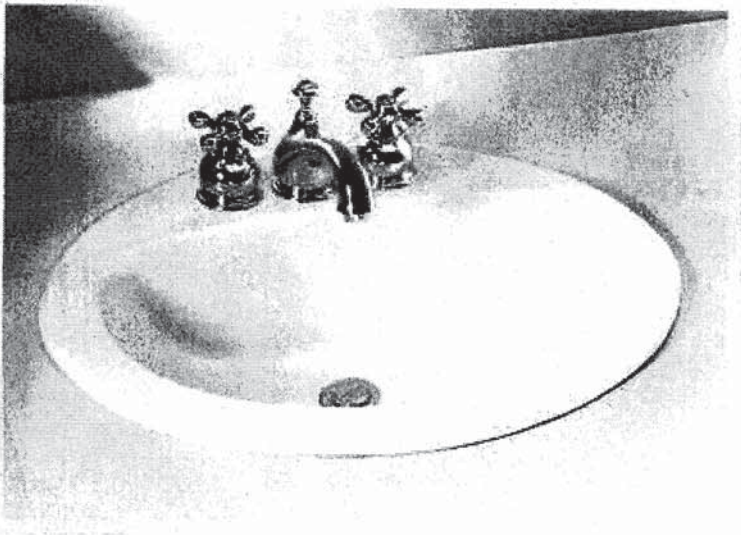

Nominal Dimensions:  
521 x 448mm (20-1/2" x 17-5/8")

Bowl sizes:  
422mm (16-5/8") wide, 279mm (11") front to back, 143mm (5-5/8") deep

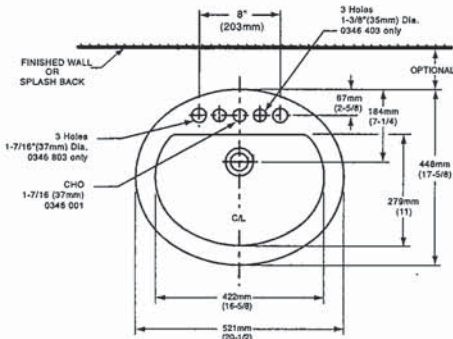

HS  
ds

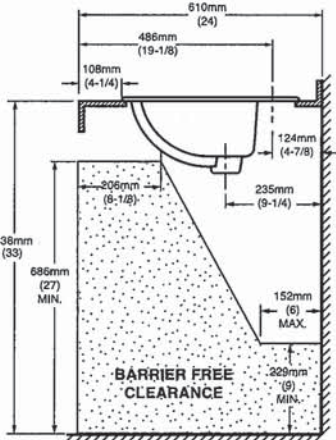
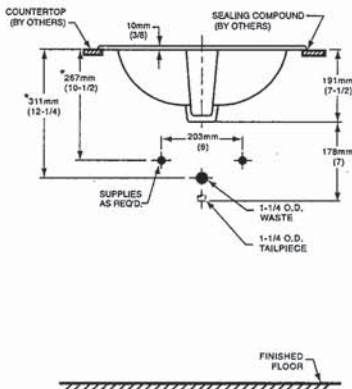

COMPLIANCE CERTIFICATIONS –  
Meets or exceeds the following Specifications:  
• ASME A112.19.2M for Vitreous China Fixtures.  
• CAN/CSA B45 Series.

- To Be Specified
- ☐ Colour: ☐ White ☐ Bone ☐ Silver Gray  
☐ Linen
- ☐ Faucet\*:
- ☐ Faucet Finish:
- ☐ Supplies & Stops:
- ☐ Trap 1-1/4" (32 mm):

NOTES:  
\* DIMENSIONS SHOWN FOR LOCATION OF SUPPLIES AND "P" TRAP ARE SUGGESTED. FOR COUNTERTOP CUTOUT AND INSTALLATION INSTRUCTIONS USE TEMPLATE SUPPLIED WITH SINK.  
FAUCETS NOT INCLUDED AND MUST BE ORDERED SEPARATELY.  
IMPORTANT: Dimensions of fixtures are nominal and may vary within the range of tolerances established by ANSI Standard A112.19.2.  
These measurements are subject to change or cancellation. No responsibility is assumed for use of superseded or voided pages.

\* See faucet section for additional models available





DEMI™  
Product Specification Sheet

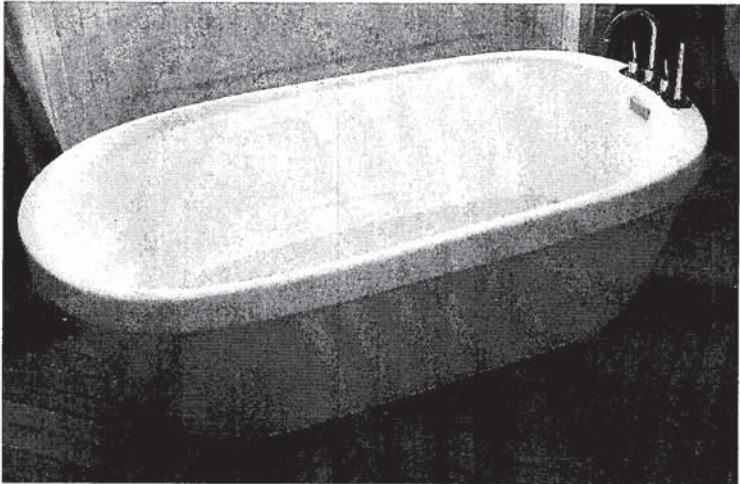

Two Piece Freestanding Collection

CF2007	Two Piece Freestanding Soaker
Size:	60" x 32" x 22" 1524 mm x 813 mm x 559 mm

PRODUCT FEATURES & BENEFITS

- Vacuum formed acrylic reinforced with fiberglass
- Scratch, stain and fade resistant high gloss finish
- Installation friendly two piece design
- Accepts deck mounted faucet
- Includes integral pop up drain and rectangular overflow
- Includes levelling feet

TWO PIECE ASSEMBLY

FRONT VIEW

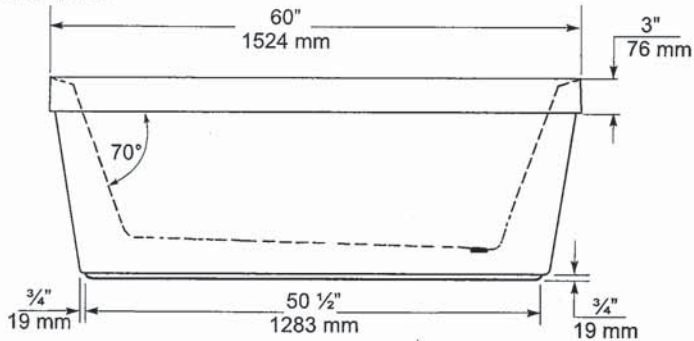

END VIEW

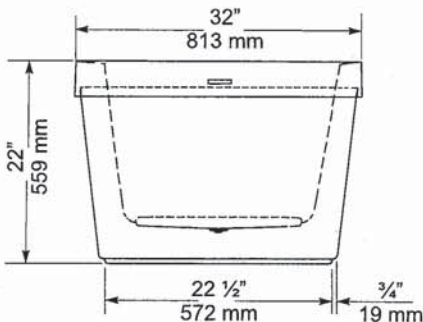

TOP VIEW

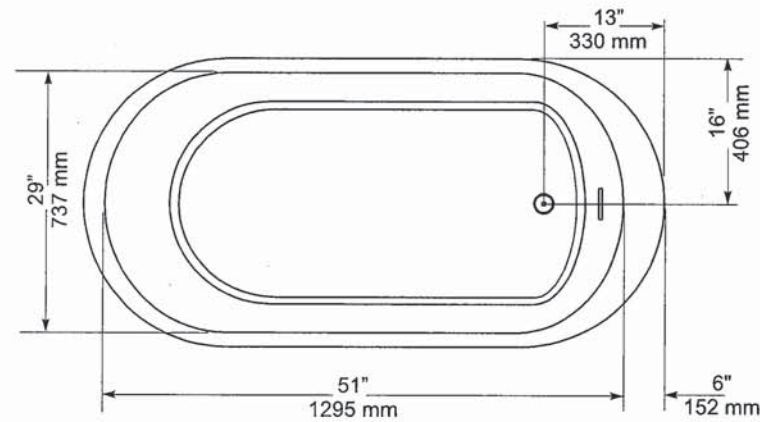

GENERAL SPECIFICATIONS		
Average Weight	90 lb	41 kg
Bathing Well at bottom	43"x 20"	1092 x 508 mm
Capacity Drain to Overflow		195 litres
Water Depth Drain to Overflow	16"	406 mm
Drain Opening (dia.)	2"	51 mm
Overflow Opening	2 1/4"x 1 1/2"	57 x 13 mm
Drain to Floor Clearance	3 1/4"	83 mm

**NOTES:** Please confirm measurements on actual product to ensure proper identification. Bathtub to be installed on the floor supported by 5 self levelling feet. Adjust if required to level the bathtub for adequate drainage. Refer to installation instructions for additional information.

**IMPORTANT:** Dimensions of fixtures are nominal and may vary  $\pm 1/4"$  (6 mm). Weight may vary  $\pm 5$  lb (2.3 kg). Drawing is not to scale. These measurements are subject to change at manufacturer's discretion.

**Compliance Certifications -**  
Meets or Exceeds the following Specifications:  
• CAN/CSA - B45 Series



*American Standard*  
Style That Works Better

FloWise™ DUAL FLUSH  
ELONGATED TOILET  
VITREOUS CHINA

FloWise™ DUAL FLUSH ELONGATED TOILET

- 2476 216
  - Vitreous china
  - Low-consumption Dual Flush
    - Full flush 6.0 Lpf/1.3 gpf,
    - Partial flush 3.0 Lpf/0.66 gpf.
  - Elongated wash down bowl
  - Internal trapway fully-glazed, 2-1/4" (57mm) ballpass
  - Concealed trapway bowl
  - Chrome-plated top mounted push button actuator
  - Easy to clean sanitary dam on bowl
  - Includes Elongated Slow Close Seat
  - 100% factory flush tested
  - 2 bolt caps

Separate Component Parts:

- 3067 316 Elongated Bowl with Slow Close Seat
- 4035 216 Unlined Tank

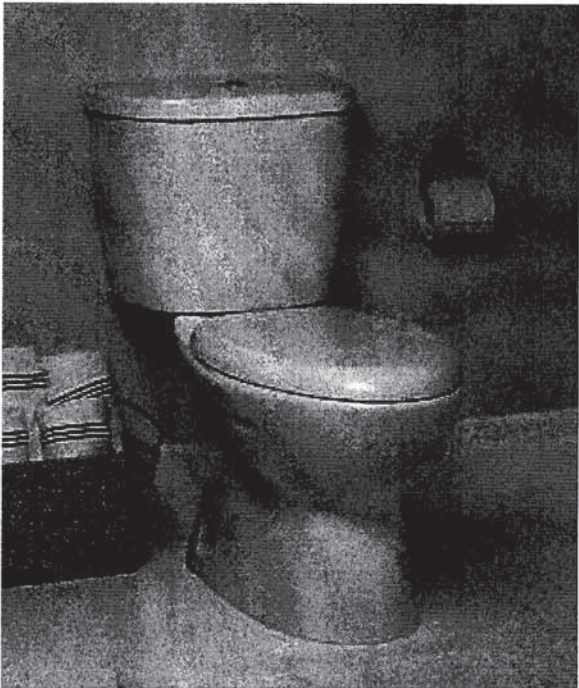

- 2476 516 Same as above with Lined tank
  - 3067 316 Elongated Bowl
  - 4035 516 Lined Tank

Nominal Dimensions:  
794 x 432 x 765mm  
(31-1/4" x 17" x 30-1/8")

Compliance Certifications -  
Meets or Exceeds the Following Specifications:

- ASME A112.19.2M (and 19.6M)
- CAN/CSA B45 series

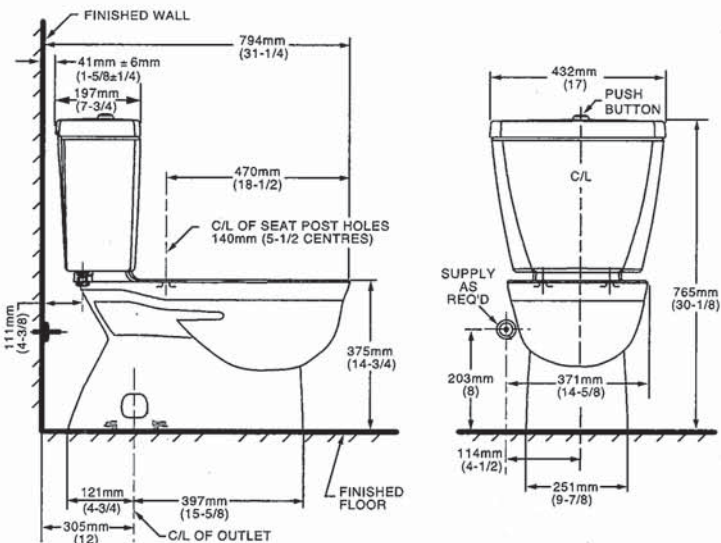

NOTES:  
THIS TOILET IS DESIGNED TO ROUGH-IN AT A MINIMUM DIMENSION OF 305MM (12") FROM FINISHED WALL TO C/L OF OUTLET.  
SUPPLY NOT INCLUDED WITH FIXTURE AND MUST BE ORDERED SEPARATELY.  
\* DIMENSION SHOWN FOR LOCATION OF SUPPLY IS SUGGESTED.  
FOR ADDITIONAL INFORMATION REFER TO INSTALLATION INSTRUCTIONS SUPPLIED.  
IMPORTANT: Dimensions of fixtures are nominal and may vary within the range of tolerance established by ANSI Standard A112.19.2  
These measurements are subject to change or cancellation. No responsibility is assumed for use of superseded or voided pages.

- To Be Specified
- Colour: 020 White
  - Supply with stop:

UPGRADED VALUE ADDED FEATURES AT NO EXTRA CHARGE

Handwritten initials and a signature.



## Specifications

**CHATEAU®**  
**Single-Handle Lavatory Faucet**

- with Metal Waste Assembly**  
**Model: L4625 series**  
**L4631BC**  
**Bulk Packed (12 per carton):**  
**L64624 series**

**with 50/50 Waste Assembly**  
**Bulk Packed (12 per carton):**  
L64625 series

- Less Waste**  
**Bulk Packed (12 per carton):**  
L64600 series

**NOTE:** THIS FAUCET IS DESIGNED TO BE  
INSTALLED THRU 3-1" DIA. HOLES, 2" ON CENTER

- 1255™ Duralast™ cartridge
- Nonmetallic/nonferrous and stainless steel material

- Third party certified to WaterSense®, ASME A112.18.1/CSA B125.1 and all applicable requirements referenced therein
- Certified to NSF 61/9 & 372
- Products marked with 1.2 gpm are compliant with California water efficiency regulations
- Complies with California Proposition 65 and with the Federal Safe Drinking Water Act

- ADA  for lever handle

- Lifetime limited warranty against leaks, drips and finish defects to the original consumer purchaser
- 5 year warranty if used in commercial installations



### CRITICAL DIMENSIONS





Buy it for looks. Buy it for life.®

There is more than 1 version of this model.  
Page down to identify the version you have.

#### DESCRIPTION

- Metal construction with various finishes identified by suffix
- Includes non-metallic showerhead, arm, flange and non-metallic diverter tub spout

#### OPERATION

- Handle operates counterclockwise through a 270° arc with off at 6 o'clock and maximum hot at the 9 o'clock position. Shut off in clockwise direction
- Adjustable temperature limit stop to control maximum hot water temperature
- Pressure balancing mechanism maintains selected discharge temperature to  $\pm 3^\circ$

#### FLOW

- Showerhead is limited to 2.5 gpm (9.5 L/min) at 80 psi
- EP suffix models are limited to 1.75 gpm (6.6 L/min) at 80 psi
- NH suffix models contain no showerhead

#### CARTRIDGE

- 1222 cartridge design
- Accommodates back to back installations
- Nonmetallic/nonferrous and stainless steel material

#### STANDARDS

- Third party certified to meet ASME A112.18.1/CSA B125.1 and all applicable requirements referenced therein
- EP suffix models are third party certified to WaterSense®
- ADA  for lever handle

#### WARRANTY

- Lifetime limited warranty against leaks, drips and finish defects to the original consumer purchaser
- 5 year warranty if used in commercial installations

## Specifications



### CHATEAU® POSI-TEMP® Single-Handle Tub/Shower Trim Kit

**Models:** TL181 series - valve trim only  
(Bulk Packed 12 per carton)  
TL182 series - shower trim only  
(Bulk Packed 12 per carton)  
TL183 series - tub/shower trim  
(Bulk Packed 12 per carton)

**Valves:** 62300 series  
2500 series

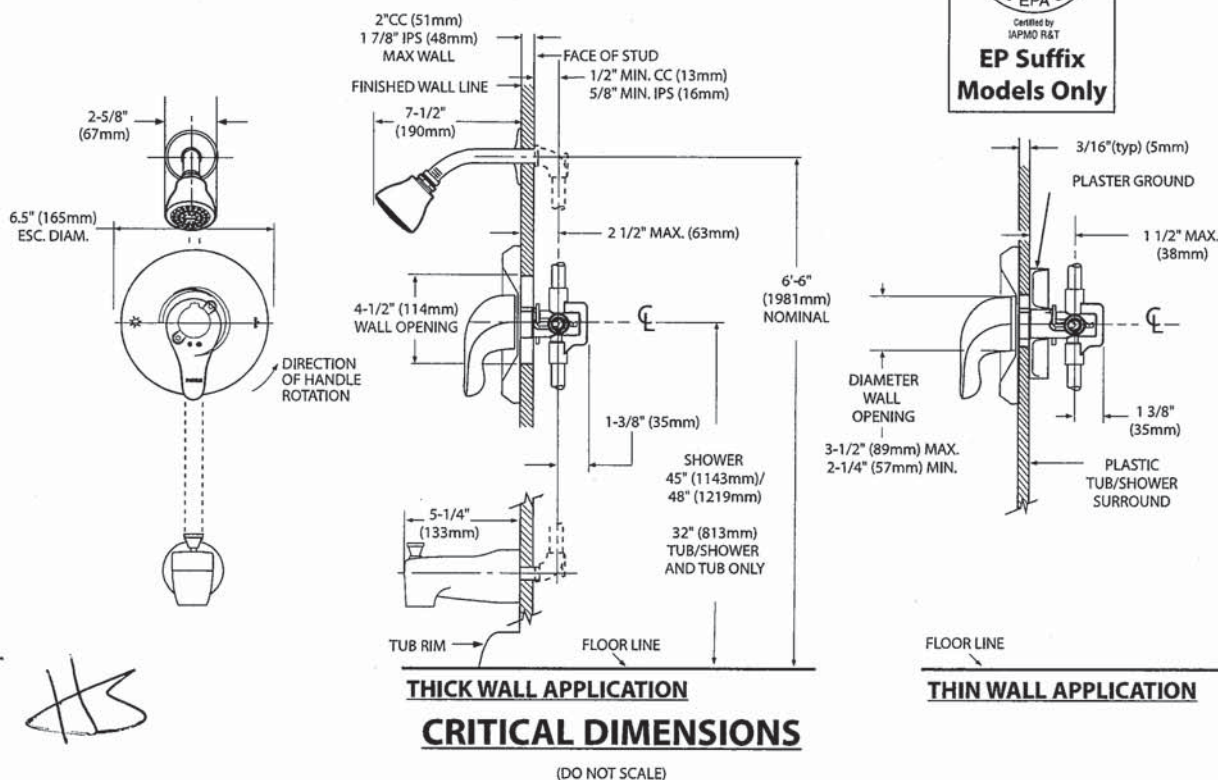



Specifications

DESCRIPTION

- Metal construction with various finishes identified by suffix

OPERATION

- Lever style handles with hot and cold color indicator
- Rotate hot side handle counterclockwise to open (clockwise to close) and the cold side handle (clockwise to open) and (counterclockwise to close)

STANDARDS

- Third party certified to: ASME A112.18.1/CSA B-125.1, and all applicable requirements referenced therein

- ADA  for lever handles

WARRANTY

- Lifetime limited warranty against leaks, drips and finish defects to the original homeowner
  - 10 year limited warranty when used in a multi-family installation
  - 5 year limited warranty when used in a commercial installation
- Visit [www.moen.com/support](http://www.moen.com/support) for complete details and limitations

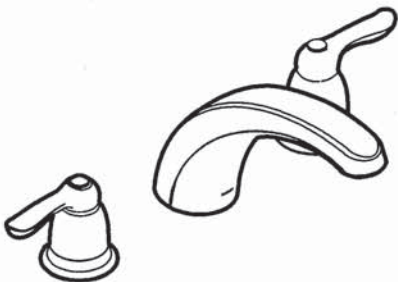

CHATEAU®  
Two-Handle Garden Tub Trim

Models: T994 series

Valves: 4792, 4793, 4794, 4796, 4797, 4798

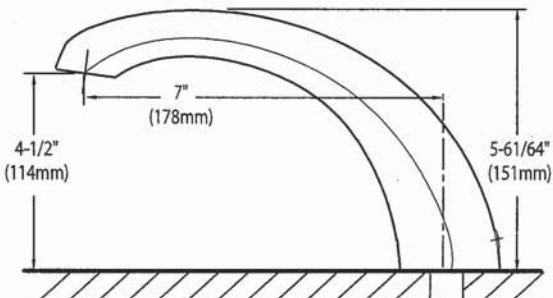
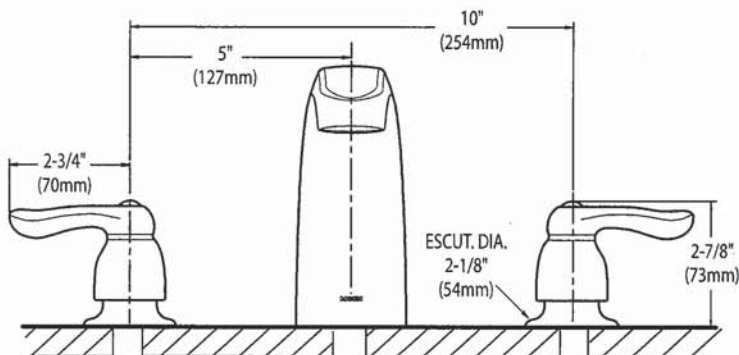

88. HS.

CRITICAL DIMENSIONS  
(DO NOT SCALE)





SPECIFICATIONS  
**AV SERIES**  
RANGE HOODS



**180 CFM/7.0 Sones @ 0.10" SP. Horizontal**  
**180 CFM/7.5 Sones @ 0.10" SP. Vertical**

- Dimensions**  
Overall bottom projection - 18<sup>3</sup>/<sub>8</sub>"  
Overall top projection -12"  
Height - 6"  
Available widths: 21", 24", 30", 36" & 42"
- Hood Body**  
Stainless Steel: 24 gauge, grade 430 stainless steel.  
Painted: 23 gauge cold rolled commercial grade (CRCQ) steel, auto welded, coated with a baked enamel finish.
- Motor**  
2 speed, single coil, thermally protected, permanently lubricated.  
Rated 120 volts, 60 hz. Complete with 200°C lead wires.
- Lighting**  
Single 60 watt cook light capacity (bulb not included).
- Ducting Options**  
Horizontal ducting: 3<sup>1</sup>/<sub>4</sub>"x10" (duct adapter and damper included).  
Vertical ducting: 3<sup>1</sup>/<sub>4</sub>"x10" (duct adapter and damper included).  
Vertical ducting: 7" round (duct adapter and damper not included).  
Ductless: removable front vent (charcoal filter not included).
- Fan Blade**  
One piece polymeric, electronically balanced blade. 6<sup>5</sup>/<sub>8</sub>" diameter with 5 paddles.
- Electrical connection**  
Hood top - 7/8" knockout hole for use with 1/2" cable clamp  
Hood back - 7/8" knockout hole for use with 1/2" cable clamp

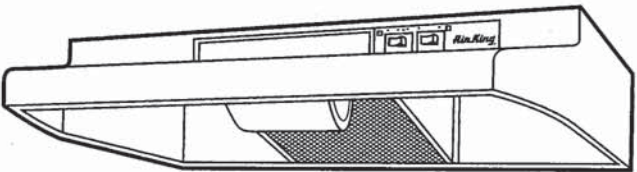

AV SERIES

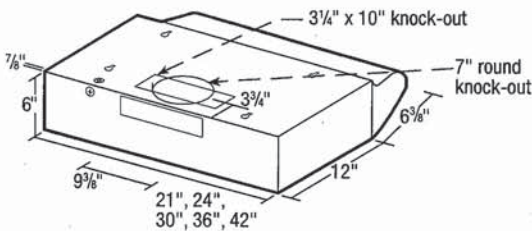

- Filters**  
UL rated, class 2 filter.  
Grease Filter: RF35 - 8<sup>7</sup>/<sub>8</sub>"x10<sup>3</sup>/<sub>8</sub>" (included).  
Charcoal Filter: RF34 (not included).  
Combo Grease/Charcoal: RF55 (not included).
- Available Finishes**  
White, Biscuit, Almond, Black & Stainless Steel.

EXPANDED PERFORMANCE										
Air Flow - CFM	Static Pressure (inches of w.g.)						Sones @ .1 SP	Fan Speed RPM	Power Watts	Amps
	0	0.05	0.1	0.15	0.2	0.25				
Vertical Ducting High	246	232	218	203	181	147	7.5	2973	87.0	2.1
Horizontal Ducting High	225	210	180	175	155	120	7.0	3024	87.0	2.1

PROJECT							ARCHITECT			
LOCATION							ENGINEER			
CONTRACTOR							SUBMITTED BY		DATE	
FAN NUMBER	MODEL NUMBER	CFM	IN W.C.	RPM	WATTS	AMPS	SONES	QTY	OPTIONAL EQUIPMENT & REMARKS	



Air King: 820 Lincoln Avenue  
West Chester, Pennsylvania 19380-4466  
Tel: (610) 692-7400 • 877-304-3785  
Fax: (610) 696-8048

Canada:  
Brampton, Ontario  
Tel: 905-456-2033  
Fax: (905) 456-1015

Handwritten initials: JS and AS



Whirlpool® 21 cu. ft. Top-Freezer Refrigerator  
WRT541SZD

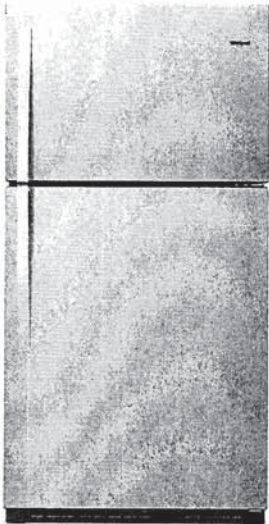

Fingerprint-Resistant Stainless  
WRT541SZDZ

Also available in:

- White WRT541SZDW
- Black WRT541SZDB
- Monochromatic Stainless Steel WRT541SZDM

Key Features & Benefits

- Frameless Glass Shelves**  
Store more items on wall-to-wall shelves for greater storage flexibility.
- Flexi-Slide™ Bin**  
Make space for tall items with the bin that quickly and easily moves side to side.
- Humidity-Controlled Crispers**  
Store fruits and vegetables in their ideal environment.

Capacity	
Total Capacity	21 cu. ft.
Refrigerator Capacity	15 cu. ft.
Freezer Capacity	6 cu. ft.

General Features & Properties	
EZ Connect Icemaker Kit	
LED Interior Lighting	
ENERGY STAR® Certified	
Electronic Temperature Controls	
Freezer Temperature Controls	
Clear Door Bins	
Adjustable Door Bins	
Quiet Cooling	
Fingerprint Resistant	

Electrical Details	
Amps	6.5
Volts	115

Certifications	
ADA Compliant	Yes
ENERGY STAR® Certified	Yes

Technical Details	
Refrigerator Type	Top-Freezer
Number of Doors	2
Number of Interior Refrigerator Shelves	3
Number of Refrigerator Door Bins	1 Fixed, 4 Adjustable
Number of Interior Freezer Shelves	1
Number of Freezer Door Bins	2 Fixed
Lighting Type	LED
Ice Maker	Optional
Ice Maker Location	Freezer
Dispenser Type	N/A

Dimensions	
Product Dimensions (H x W x D)	66-1/4" x 32-3/4" x 34"
Depth with Door Open 90°	62-1/4"
Cutout Dimensions	Allow extra 1/2" on sides and top Allow extra 1" on rear

- Reference Material
- [Dimension Guide](#)
  - [Use & Care Guide](#)
  - [Energy Guide](#)
  - [Warranty](#)

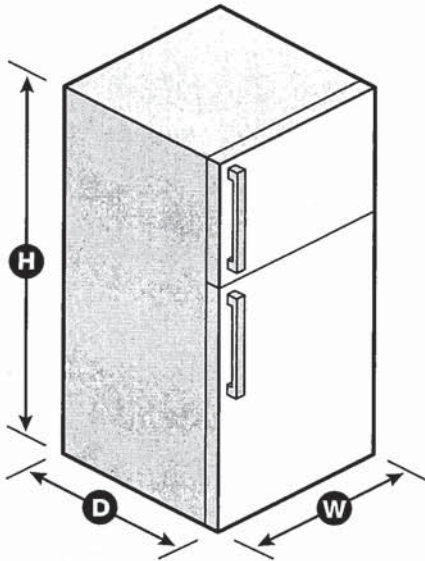

HINGES ON LEFT  
HANDLE ON RIGHT  
GARAGE LEFT

88. HS.

NOTE: Dimensions are for planning purposes only. For complete details, see Installation Instructions packed with product. Specifications subject to change without notice.  
©/™ © 2020. All rights reserved. Printed in the U.S.A. D200052XXC. WRT541SZDSPECSHEETV01.



**Whirlpool®** Top Mount Refrigerator

PRODUCT MODEL NUMBERS

WRT311FZD      WRT541SZD  
WRT511SZD

**Electrical:** A 115-volt, 60-Hz, AC-only, 15- or 20-amp fused, grounded electrical supply is required. It is recommended that a separate circuit serving only your refrigerator be provided. Use an outlet that cannot be turned off by a switch. Do not use an extension cord.

**NOTE:** Before performing any type of installation, cleaning, or removing a light bulb, turn the control (Thermostat, Refrigerator or Freezer Control depending on the model) to OFF and then disconnect the refrigerator from the electrical source. When you are finished, reconnect the refrigerator to the electrical source and reset the control (Thermostat, Refrigerator or Freezer Control depending on the model) to the desired setting. See "Using the Controls."

**Water:** A cold water supply with water pressure between 30 and 120 psi (207 and 827 kPa) is required to operate ice maker and water dispenser. If you have questions about your water pressure, call a licensed, qualified plumber.

**IMPORTANT:** The pressure of the water coming out of a reverse osmosis system going to the water inlet valve of the refrigerator needs to be between 30 and 120 psi (207 and 827 kPa).

**Reverse Osmosis Water Supply:** If a reverse osmosis water filtration system is connected to your cold water supply, the water pressure to the reverse osmosis system needs to be a minimum of 40 to 60 psi (276 to 414 kPa).

PRODUCT DIMENSIONS

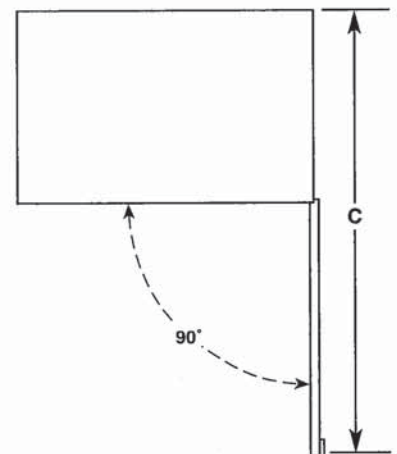
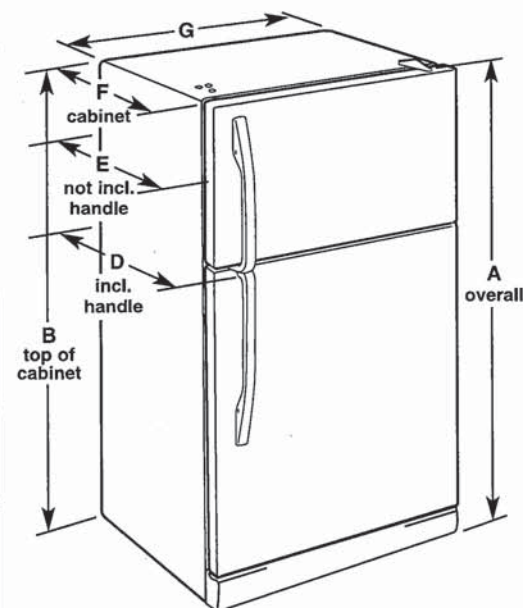

Model Number	Model Size	Reversible Door	Height - Overall "A"	Height - Top of Cabinet "B"	Depth - Door Open 90° "C"	Depth - With Handles "D"	Depth - Without Handles "E"	Depth - Cabinet Only "F"	Width - Cabinet "G"
WRT311FZD	20.5 cu. ft.	Yes	66¼" (168.3 cm)	65½" (166.4 cm)	62¼" (158.1 cm)	32⅞" (83.5 cm)	30⅝" (77.8 cm)	28½" (72.4 cm)	32¾" (83.2 cm)
WRT511SZD WRT541SZD	21.3 cu. ft.	Yes	66¼" (168.3 cm)	65½" (166.4 cm)	62¼" (158.1 cm)	34" (86.4 cm)	32½" (82.3 cm)	28½" (72.4 cm)	32¾" (83.2 cm)

LOCATION REQUIREMENTS

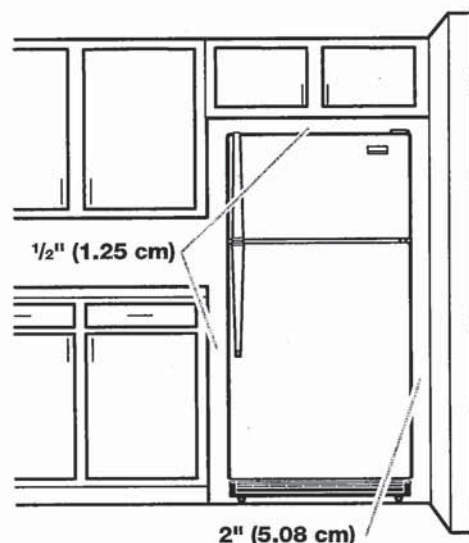

To ensure proper ventilation for your refrigerator, allow for a ½" (1.25 cm) space on each and between overhead cabinets and refrigerator top. Allow at least 1" (2.5 cm) between back of cabinet and the wall. If your refrigerator has an ice maker, make sure you leave some extra space at the back for the water line connections.

If you are installing your refrigerator next to a fixed wall, leave 2" (5 cm) minimum on the hinge side (depending on your model) to allow for the door to swing open.

**NOTE:** This refrigerator is intended for use in a location where the temperature ranges from a minimum of 55°F (13°C) to a maximum of 110°F (43°C). The preferred room temperature range for optimum performance, which reduces electricity usage and provides superior cooling, is between 60°F (15°C) and 90°F (32°C). It is recommended that you do not install the refrigerator near a heat source, such as an oven or radiator.





5.3 cu. ft. Whirlpool® electric range with Frozen Bake™ technology

YWFE515S0JS

This Whirlpool® electric range with a dual element stove top helps you get dinner to the table. Skip preheating for favorites like pizza with Frozen Bake™ technology. This self cleaning oven also prevents cooked food from getting cold with the Keep Warm setting. Closed door broiling helps keep the kitchen comfortable.



Available Finishes/Colours

-  YWFE515S0JB  
Black
-  YWFE515S0JS  
Stainless Steel
-  YWFE515S0JW  
White

Manuals & Literature:

-  [Installation Instructions](#)
-  [Use and Care](#)
-  [Warranty](#)

Top Features

**FlexHeat™ Dual Radiant Element**  
Get two elements in one with a 6" inner ring that's great for smaller pots and pans and a 9" expandable outer ring that makes room for larger cookware.

**Frozen Bake™ technology**  
Skip preheating and cook frozen favorites like pizza in fewer steps with preprogrammed settings that automatically adjust cooking times for you.

**Keep Warm setting**  
Keep dishes from getting cold with this setting that delivers low heat to the oven.

**Closed Door Broiling**  
Maintain the optimal cooking temperature for food while still keeping the kitchen comfortable and cool using this broiling temperature management system that helps prevent overheating.

Dimensions	
Depth	27 3/4
Height	36
Width	29 7/8

Exterior	
Handle Type	Reach-Through Handle

Configuration and Overview	
Range Type	Freestanding
Fuel Type	Electric
Size (IN,inches)	30

Features	
Hot Surface Indicator Light	Yes
Heating Element On Indicator Light	Yes
Power On Indicator Light	No
Griddle	NA
Automatic Convection Conversion Temperature Adjust	No
Power Outage Compatible	No

Exterior	
Door Removable	Yes
Drawer Type	Storage Drawer
Oven Door	Glass Window
Oven Window Size	Extra Large
Handle Color	Stainless Steel
Handle Material	Metal

HS. 82.



WHIRLPOOL 30" (76.0 CM) FREESTANDING ELECTRIC RANGES  
Model YWFE515S0JS

Product Dimensions

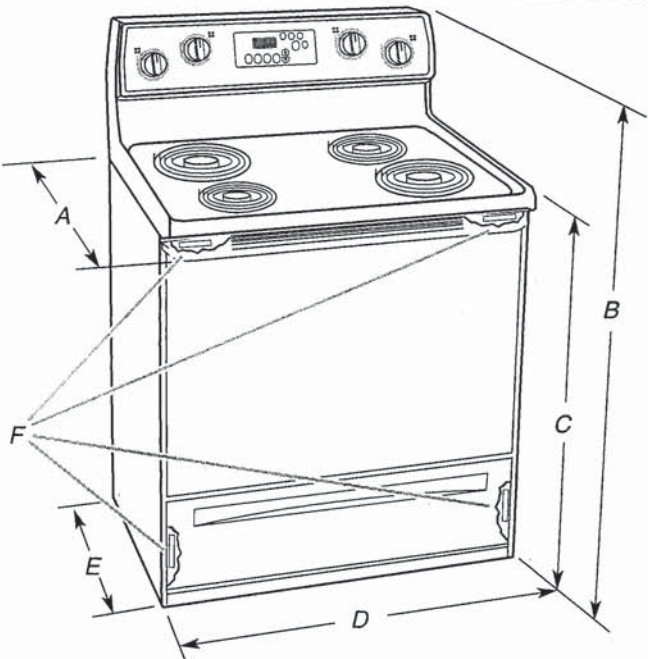

- A. 27<sup>3</sup>/<sub>4</sub>" (70.5 cm) max. depth with handle
- B. 46<sup>7</sup>/<sub>8</sub>" (119.1 cm) overall height (max.) with leveling legs screwed all the way in\*
- C. 36" (91.4 cm) cooktop height (max.) with leveling legs screwed all the way in\*
- D. 29<sup>7</sup>/<sub>8</sub>" (75.9 cm) width
- E. 25<sup>5</sup>/<sub>16</sub>" (64.3 cm) depth - back of range to front of cooktop\*\*
- F. Model/serial/rating plate (located on the frame behind a top corner of the door or either side of the drawer)

**IMPORTANT:** Range must be level after installation. Follow the instructions in the "Level Range" section. Using the cooktop as a reference for leveling the range is not recommended.

\*Range can be raised approximately 1" (2.5 cm) by adjusting the leveling legs.

\*\*Front of door and drawer may extend further forward depending on styling.

Cabinet Dimensions

Cabinet opening dimensions shown are for 25" (64.0 cm) countertop depth, 24" (61.0 cm) base cabinet depth and 36" (91.4 cm) countertop height.

**IMPORTANT:** If installing a range hood or microwave hood combination above the cooking surface, follow the range hood or microwave hood combination installation instructions for dimensional clearances above the cooktop surface.

A freestanding range may be installed next to combustible walls with zero clearance.

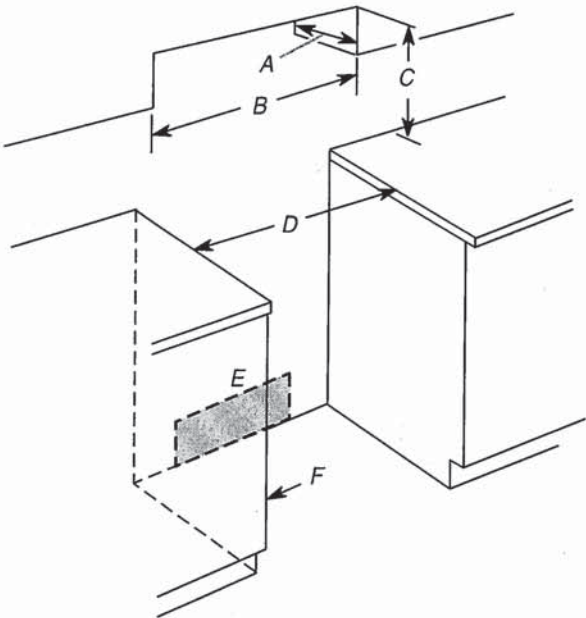

- A. 13" (33.0 cm) max. upper cabinet depth
- B. 30" (76.2 cm) min. opening width
- C. For minimum clearance to top of cooktop, see NOTE\*
- D. 30" (76.2 cm) min. opening width
- E. Outlet - 8" (20.3 cm) to 22" (55.9 cm) from either cabinet, 7" (17.8 cm) max. from floor.
- F. Cabinet door or hinges should not extend into the cutout.

**\*NOTE:** 24" (61.0 cm) minimum when bottom of wood or metal cabinet is covered by not less than 1/4" (6.4 mm) flame retardant millboard covered with not less than No. 28 MSG sheet steel, 0.015" (0.4 mm) stainless steel, 0.024" (0.6 mm) aluminum or 0.020" (0.5 mm) copper.

30" (76.2 cm) minimum clearance between the top of the cooking platform and the bottom of an uncovered wood or metal cabinet.

HS. Es.

WHIRLPOOL 30" (76.0 CM) FREESTANDING ELECTRIC RANGES  
Model YWFE515S0JS

Electrical Requirements - Canada Only

**⚠ WARNING**



**Electrical Shock Hazard**

Electrically ground range.

Failure to do so can result in death, fire, or electrical shock.

If codes permit and a separate ground wire is used, it is recommended that a qualified electrical installer determine that the ground path is adequate and wire gauge are in accordance with local codes.

Be sure that the electrical connection and wire size are adequate and in conformance with CSA Standard C22.1, Canadian Electrical Code, Part 1 - latest edition, and all local codes and ordinances.

A copy of the above code standards can be obtained from:

Canadian Standards Association  
178 Rexdale Blvd.  
Toronto, ON M9W 1R3 CANADA

- Check with a qualified electrical installer if you are not sure the range is properly grounded.

Range Rating*		Specified Rating of Power Supply Cord Kit and Circuit Protection
120/240 V	120/208 V	Amps
8.8 - 16.5 KW	7.8 - 12.5 KW	40 or 50**
16.6 - 22.5 KW	12.6 - 18.5 KW	50

\*The NEC calculated load is less than the total connected load listed on the model/serial/rating plate.

\*\*If connecting to a 50 A circuit, use a 50 A rated cord with kit. For 50 A rated cord kits, use kits that specify use with a nominal 1 3/8" (3.5 cm) diameter connection opening.

- A time-delay fuse or circuit breaker is recommended.
- This range is equipped with a CSA International Certified Power Cord intended to be plugged into a standard 14-50R wall receptacle. Be sure the wall receptacle is within reach of range's final location.

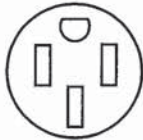

- Do not use an extension cord.

HS. 82.

INSTALLATION INSTRUCTIONS

Unpack Range

**⚠ WARNING**

**Excessive Weight Hazard**

Use two or more people to move and install range.

Failure to do so can result in back or other injury.

- Remove shipping materials, tape and film from range.
- Remove oven racks and parts package from inside oven.
- Do not remove the shipping base at this time.

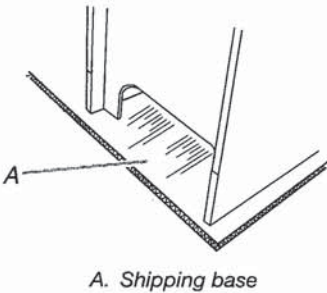

4. On Ranges Equipped with a Storage Drawer:
- Remove the storage drawer. See the "Storage Drawer" section. Use a 1/4" (6.4 mm) drive ratchet to lower the rear leveling legs one-half turn. Use a wrench or pliers to lower front leveling legs one-half turn.

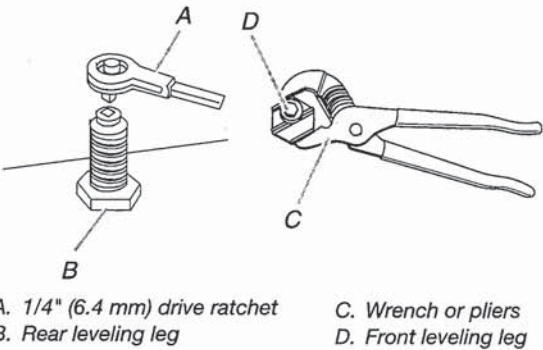

On Ranges Equipped with a Warming Drawer or Premium Storage Drawer:

On ranges equipped with a warming drawer or premium storage drawer, the rear legs cannot be accessed by removing the warming drawer or premium storage drawer. It will be necessary to adjust the rear legs from outside the range. Use wrench or pliers to lower the front and rear leveling legs one half turn.

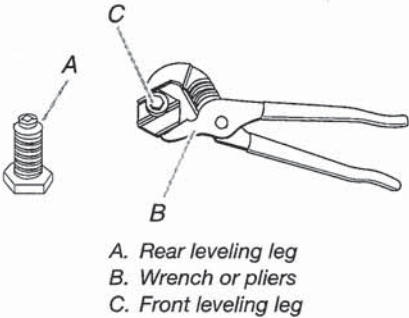



**WHIRLPOOL 30" (76.0 CM) FREESTANDING ELECTRIC RANGES**  
**Model YWFE515S0JS**

**Install Anti-Tip Bracket**

**⚠ WARNING**



**Tip Over Hazard**

A child or adult can tip the range and be killed.

Install anti-tip bracket to floor or wall per installation instructions.

Slide range back so rear range foot is engaged in the slot of the anti-tip bracket.

Re-engage anti-tip bracket if range is moved.

Do not operate range without anti-tip bracket installed and engaged.

Failure to follow these instructions can result in death or serious burns to children and adults.

1. Remove the anti-tip bracket from where it is taped inside the storage drawer or warming drawer.
2. Determine which mounting method to use: floor or wall.  
If you have a stone or masonry floor, you can use the wall mounting method. If you are installing the range in a mobile home, you must secure the range to the floor.
3. Determine and mark centerline of the cutout space. The mounting can be installed on either the left-side or right-side of the cutout. Position mounting bracket against the wall in the cutout so that the V-notch of the bracket is  $12\frac{9}{16}$ " (31.9 cm) from centerline as shown.

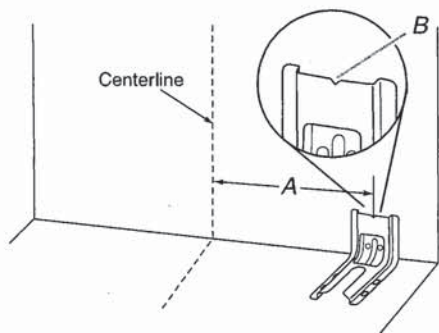

A.  $12\frac{9}{16}$ " (31.9 cm)  
B. Bracket V-notch

4. Drill two  $\frac{1}{8}$ " (3 mm) holes that correspond to the bracket holes of the determined mounting method. See the following illustrations.



**Floor Mounting**

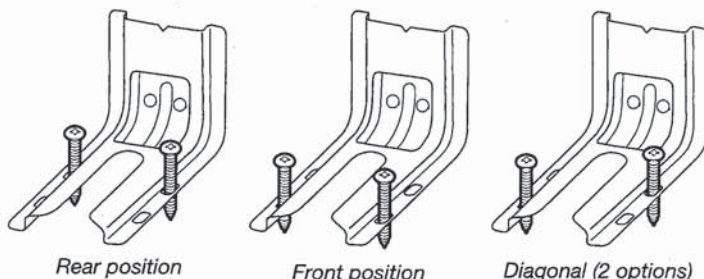

**Wall Mounting**

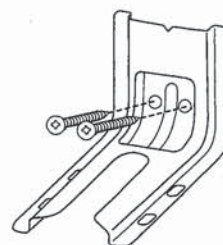

5. Using the Phillips screwdriver, mount anti-tip bracket to the wall or floor with the two #12 x  $1\frac{5}{8}$ " (4.1 cm) screws provided.
6. Move range close enough to opening to allow for final electrical connections. Remove shipping base, cardboard or hardboard from under range.
7. Move range into its final location, making sure rear leveling leg slides into anti-tip bracket.

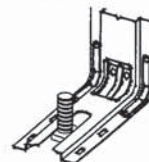

8. Move range forward onto shipping base, cardboard or hardboard to continue installing the range using the following installation instructions.





55 dBA\* Front Control Dishwasher  
WDF330PAH



Stainless Steel  
WDF330PAHS

Also available in:

- ☐ White
- WDF330PAHW
- ☐ Black
- WDF330PAHB

Capacity

Total Place Settings13

General Features & Properties

Heavy Cycle

High Temperature Wash Option

Heated Dry Option

ENERGY STAR® Certified

Industry's Best Selling Dishwasher Brand†

Designed, Engineered and Assembled in the U.S.A. with American Pride

Electrical Details

Amps10

Volts120

Hz60

Certifications

ENERGY STAR® CertifiedYes

Technical Details

Dishwasher TypeBuilt-in

Control LocationFront

Control TypePush Button

Number of Wash Cycles3

Number of Options4

dBA\*55

Number of Racks2

Tub MaterialPlastic

Wash SystemFilter

Wash System TypeRemovable Filter

Number of Wash Arms2

Dimensions

Product Dimensions (H x W x D)34-1/2" x 23-7/8" x 24-1/2"

Depth with Door Open 90°49-1/2"

Reference Material

[Dimension Guide](#)

[Install Guide](#)

[Use & Care Guide](#)

[Energy Guide](#)

[Warranty](#)

Key Features & Benefits

1-Hour Wash Cycle

Clean dishes in half the time so your plates, pans and glasses are thoroughly cleaned up and taken care of in just an hour.\*\*

Soil Sensor

Determines how dirty dishes are and adjusts the Normal cycle as needed to make sure dishes come out clean.

Normal Cycle

Use for normal amounts of food soil to clean up leftover messes from your day-to-day meals.

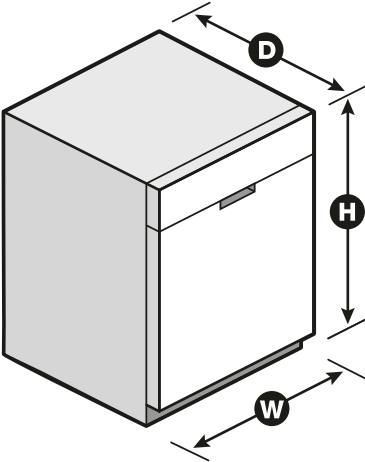

\*Per IEC standards. \*\*Compared to Normal cycle with lightly soiled loads. †Based on 12-month average of sales. TraQline 2018. NOTE: Dimensions are for planning purposes only. For complete details, see Installation Instructions packed with product. Specifications subject to change without notice. ®/™ © 2020. All rights reserved. Printed in the U.S.A. D200052XXA. WDF330PAHSPECSHEETV01.



Undercounter Dishwasher

PRODUCT MODEL NUMBERS

WDF110PAB	WDF320PAD	WDT710PAH
WDF111PAB	WDF330PAH	WDT720PAD
WDF120PAF	WDF331PAH	WDT730PAH
WDF121PAF	WDF520PAD	WDT735PAG
WDF130PAH	WDF540PAD	WDT735PAH
WDF131PAH	WDF545PAF	

DRAIN REQUIREMENTS

- A new drain hose is supplied with your dishwasher. If drain hose is not long enough, use a new drain hose with a maximum length of 12 ft (3.7 m) that meets all current AHAM/ IAPMO test standards, is resistant to heat and detergent, and fits the 1" (25 mm) drain connector of the dishwasher. See the "Tools and Parts" section at the front of the guide for part details and orders.
- Make sure to connect drain hose to waste tee or disposer inlet above drain trap in house plumbing and 20" (508 mm) minimum above the floor. It is recommended that the drain hose either be looped up and securely fastened to the underside of the counter or be connected to an air gap.
- Make sure to use an air gap if the drain hose is connected to house plumbing lower than 20" (508 mm) above subfloor or floor.

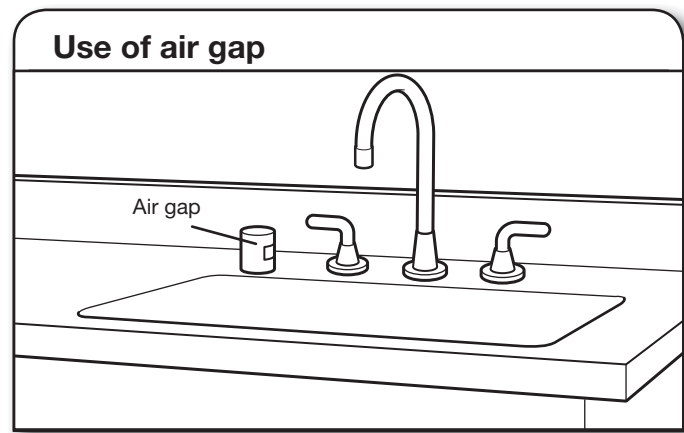

- If required, the air gap should be installed in accordance with the air gap installation instructions. When you are connecting the air gap, a rubber hose (not provided) will be needed to connect to the waste tee or disposer inlet.
- Use 1/2" minimum I.D. drain line fittings.

WATER SUPPLY REQUIREMENTS

- This dishwasher has a water heating feature and also requires a connection to a hot water supply line.
- A hot water line with 20 to 120 psi (138 to 862 kPa) water pressure can be verified by a licensed plumber.
- 120°F (49°C) water at dishwasher
- 3/8" O.D. copper tubing with compression fitting or flexible braided water supply line. See the "Tools and Parts" section at the front of the guide for part details and orders.

**NOTE:** 1/2" minimum plastic tubing is not recommended.

- A 90° elbow with 3/4" hose connection with rubber washer. See the "Tools and Parts" section at the front of the guide for part details and orders.
- Do not solder within 6" (152 mm) of the water inlet valve.
- If installed in new construction, make sure the house water supply lines have been flushed prior to connecting the dishwasher to remove any debris that may exist in the supply line.

**NOTE:** If replacing an existing dishwasher, it is recommended to install a new water line (see the "Tools and Parts" section at the front of the guide for part details) and drain hose (supplied) with the new dishwasher.

ELECTRICAL REQUIREMENTS

You Must Have:

- 120-volt, 60 Hz, AC-only, 15- or 20-amp, fused electrical supply
- Copper wire only
- A maximum of 2 field wiring supply conductors (12 AWG largest size) plus 1 grounding conductor are permitted in the terminal box.

We Recommend:

- A time-delay fuse or circuit breaker
- A separate circuit

If Connecting Dishwasher with a Power Cord:

- Use a UL Listed power cord kit marked for use with dishwasher. See the "Tools and Parts" section at the front of the guide for part details and orders.
- Plug into a grounded 3 prong outlet. Outlet must meet all local codes and ordinances.

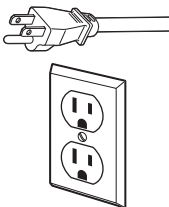

If Connecting Dishwasher with Direct Wiring:

- Use flexible, armored, or nonmetallic sheathed copper wire with grounding wire that meets the wiring requirements for your home and local codes and ordinances.
- Use a UL Listed/CSA Approved metallic strain relief.





PRODUCT AND CABINET OPENING DIMENSIONS

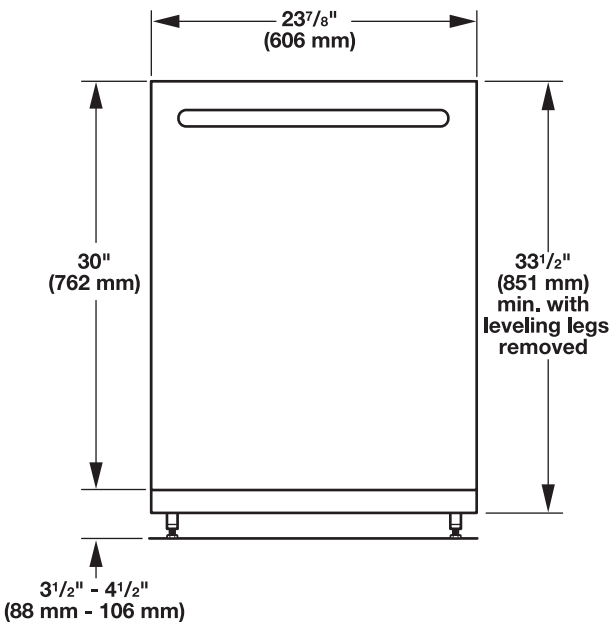

For 4" (100 mm) toe kick, height of cabinet opening is 34 1/2" (863 mm).

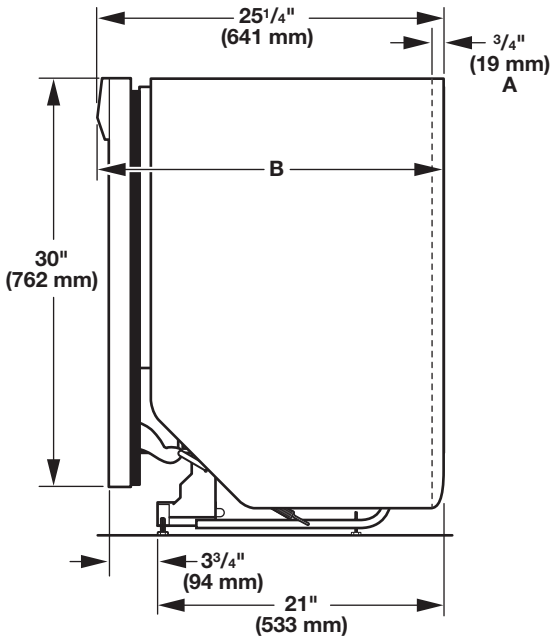

- A. Insulation may be compressed (not used on all models).
- B. Door handles may protrude forward of the face of the dishwasher, (varies by model).

Check that all surfaces have no protrusions that would prohibit dishwasher installation.

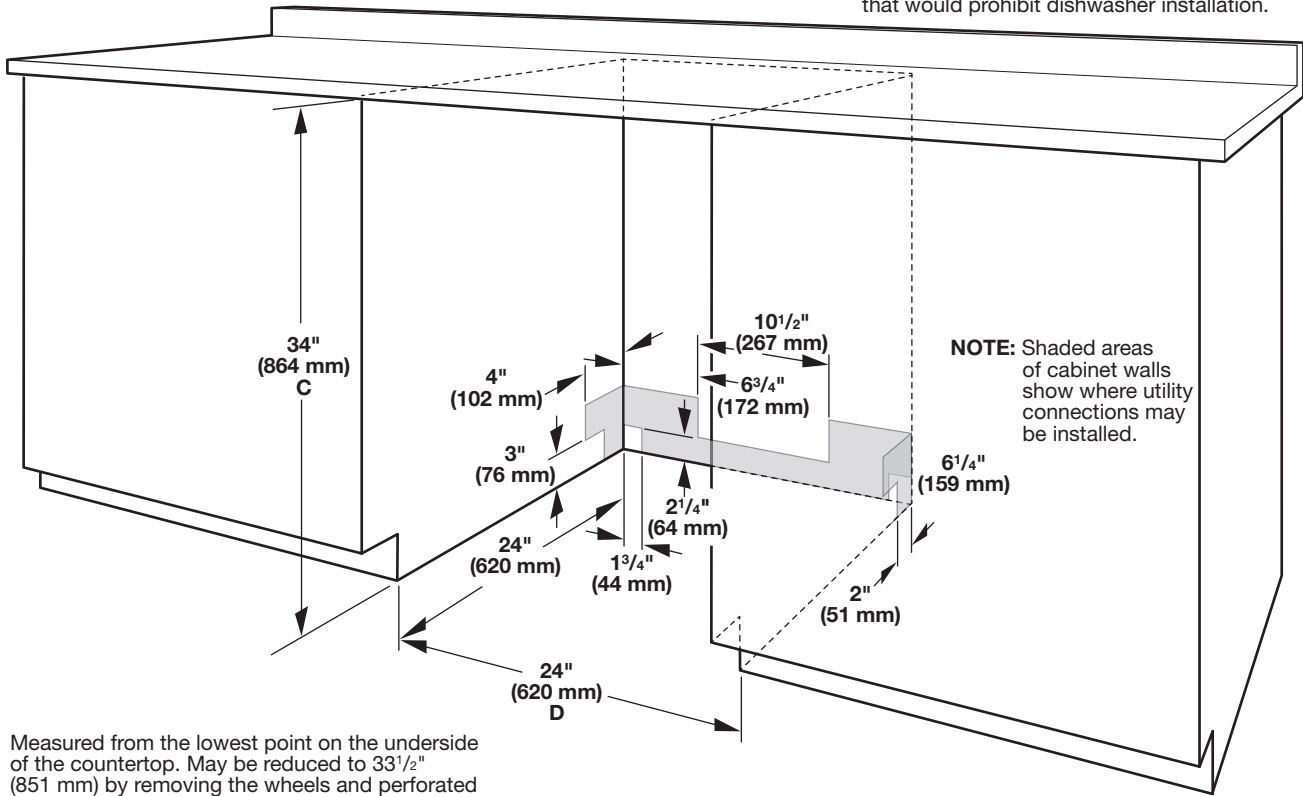

- C. Measured from the lowest point on the underside of the countertop. May be reduced to 33 1/2" (851 mm) by removing the wheels and perforated area of insulation (blanket) on dishwasher.
- D. Minimum, measured from narrowest point of opening.

NOTE: Shaded areas of cabinet walls show where utility connections may be installed.

WHIRLPOOL WASHER Model #: WFW5620HW

Whirlpool Brand Canada English | Washer and Dryers | Washers | Front Load Washers | WFW5620HW

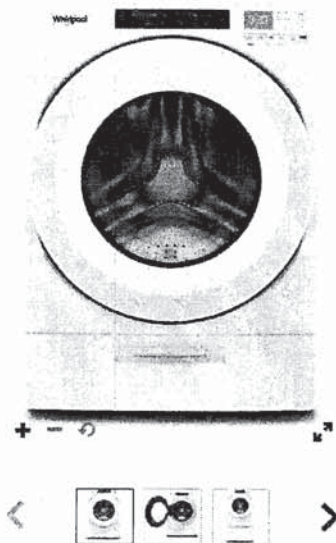

5.2 cu. ft. I.E.C. Closet-Depth  
Front Load Washer with  
Load & Go™ Dispenser

82. HS.

Whirlpool® 5.2 cu. ft. I.E.C. Closet-Depth Front Load Washer with Load & Go™ Dispenser  
Model #: WFW5620HW

Dimensions

Depth	80.17 cm, 31-9/16 in
Depth With Door Open 90 Degree	143.51 cm, 56-1/2 in
Minimum Height	98.11 cm, 38-5/8 in
Width	68.58 cm, 27.0 in

Appearance

LCD Touch Screen	No
Window	Yes

Details

Drum Material	Stainless Steel
---------------	-----------------

Cycles and Options

Number of Wash Cycles	37
-----------------------	----

Electrical

Hz	60
Power Cord Included	Yes



WHIRLPOOL DRYER Model #: YWED5620HW

Whirlpool Brand Canada English | Washer and Dryers | Dryers | Electric Dryers | YWED5620HW

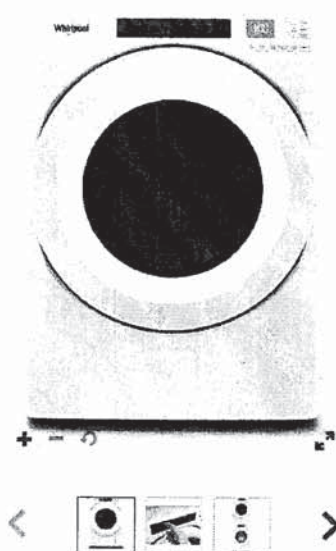

7.4 cu. ft. Front Load Electric  
Dryer with Intuitive Touch  
Controls

Whirlpool 7.4 cu. ft. Front Load Electric Dryer with Intuitive Touch Controls

Model #: YWED5620HW

Dimensions

Depth	78.74 cm, 31.0 in
Depth With Door Open 90 Degree	138.43 cm, 54-1/2 in
Height	98.42 cm, 38-3/4 in
Width	68.58 cm, 27.0 in

Configuration and Overview

Fuel Type	Electric
-----------	----------

Cycles and Options

Cycle Time Remaining	Yes
Lint Filter Indicator	No
Number of Dryer Cycles	36
Number of Dryness Levels	3

Ventilation System

Long Vent	No
Maximum Vent Length	64
Venting Direction	Left, Right, Bottom, Rear

Electrical

Hz	60
Power Cord Included	Yes