

Sales Selection Sheet
Checklist

1 of 43

LOT 3192D-23 Model: 20-1790 A The Dunmore
PURCHASERS: SYED, IMRAN HUSSAIN/
VENDOR: Heathwood Homes (Huron) Limited

- ☒ FINISHED BASEMENT
☐ COLD CELLAR

UPGRADED / MODIFIED ELEVATION

- ☐ CORNER UPGRADE
☐ REAR UPGRADE

CEILING UPGRADE - SMOOTH

- ☒ MAIN FLOOR
☐ SECOND FLOOR
☐ BASEMENT

ADDITIONAL ROUGH-INS

- ☐ 200 AMP SERVICE
☐ WET BAR ROUGH-IN
☐ HUMIDIFIER
☒ AIR CONDITIONING

GAS ROUGH-IN

- ☒ STOVE
☐ DRYER
☐ BBQ
☐ ADDITIONAL FIREPLACE

KITCHEN: HOODFAN VENTING SIZE

- ☐ 6 IN ROUND DUCT
☒ 7 IN ROUND DUCT

FULL BASEMENT STAIRS:	N/A
UPPER BASEMENT STAIRS:	All Oak
LOWER BASEMENT STAIRS:	Carpet Grade
MAIN STAIRS:	All Oak
MEDIA STAIRS (if applicable):	N/A
LOFT STAIRS (if applicable):	N/A

MARCH 13/23 *Signature on file*
Date Purchaser:

MARCH 13/23 TINA LEFUR
Date Decor Consultant:

~~RECEIVED~~

-03- 13 2023

Date Purchaser:

Date Heathwood Homes (Huron) Limited

Approved

Locked Date:

SYED, IMRAN HUSSAIN/
Project: Wallaceton
Unit: 3192D-23, Phase: 3
Model: 20-1790 A The Dunmore

Created: 2/5/2023 11:56:12
Locked:
Closed:

Kitchen

Cabinet Colour/Style	9111	Viking III-SIMCOE ORCHID 3DL ***STD***
Countertop	9069	MSI Quartz GROUP 1 ICED WHITE ***STD***
Countertop Edge	4010	SINGLE POLISHED STRAIGHT EDGE 3/4 INCH ***STD*** 
Cabinet Hardware	7667	12881-HARDWARE ***STD***
Island Cabinet Colour/Style	9111	Viking III-SIMCOE ORCHID 3DL ***STD***
Island Countertop	9069	MSI Quartz GROUP 1 ICED WHITE ***STD***
Backsplash	1111	N/A *****
Backsplash Grout	1111	N/A *****
Backsplash Tile Pattern	1111	N/A *****

HoodFan	34	AV1308 Air King 30 STAINLESS STEEL UNDER CABINET RANGE HOOD **STD**	PG 30
---------	----	---	-------

Comment

Kitchen/Breakfast

Flooring	8913	UN.BL.BIA.1224-Biel-Bianco (White)-12 x 24 See Tile Direction on Sketch Page ***2***	S 2
Floor Tile Grout	2225	Grout-(27) Silver ***STD***	
Floor Tile Pattern	3040	FRONT TO BACK ***STD*** 	

Comment

Foyer

SYED, IMRAN HUSSAIN/
Project: Wallaceton
Unit: 3192D-23, Phase: 3
Model: 20-1790 A The Dunmore

Created: 2/5/2023 11:56:12
Locked:
Closed:

Flooring	8913	UN.BL.BIA.1224-Biel-Bianco (White)-12 x 24 See Tile Direction on Sketch Page ***2***	3 2								
Floor Tile Grout	2225	Grout-(27) Silver ***STD***									
Floor Tile Pattern	3050	SIDE TO SIDE ***STD***									
<table><tr><td></td><td></td></tr><tr><td></td><td></td></tr><tr><td></td><td></td></tr><tr><td></td><td></td></tr></table>											
Comment											

Laundry Room

Flooring	9071	GE.BY.AZR.1313 New Byzantine Azzuro 13x13 ***STD***									
Floor Tile Grout	2225	Grout-(27) Silver ***STD***									
Floor Tile Pattern	3000	STANDARD SQUARE ***STD***									
<table><tr><td></td><td></td><td></td></tr><tr><td></td><td></td><td></td></tr><tr><td></td><td></td><td></td></tr></table>											
Comment											

Laundry Room Opt.

Cabinet - Uppers	1111	N/A *****
Cabinet Hardware	1111	N/A *****
Comment		

Mud Room

Flooring	9071	GE.BY.AZR.1313 New Byzantine Azzuro 13x13 ***STD***									
Floor Tile Grout	2225	Grout-(27) Silver ***STD***									
Floor Tile Pattern	3000	STANDARD SQUARE ***STD***									
<table><tr><td></td><td></td><td></td></tr><tr><td></td><td></td><td></td></tr><tr><td></td><td></td><td></td></tr></table>											

Customer Colours

SYED, IMRAN HUSSAIN/
Project: Wallaceton
Unit: 3192D-23, Phase: 3
Model: 20-1790 A The Dunmore

Created: 2/5/2023 11:56:12
Locked:
Closed:

Comment

Powder Room

Flooring8913UN.BL.BIA.1224-Biel-Bianco (White)-12 x 24 See Tile Direction on Sketch Page ***2***SZ

Floor Tile Grout2225Grout-(27) Silver ***STD***

Floor Tile Pattern3040FRONT TO BACK ***STD***

Plumbing Fixture (Colour)1737Plumbing Fixtures-WHITE ***STD***

Comment

Hall

Flooring7502Red Oak Pearl-Vintage Engineered-PEWTER/ECLIPSE-3/4 inch x 3 1/4 inch

Comment

Dining Room

Flooring7502Red Oak Pearl-Vintage Engineered-PEWTER/ECLIPSE-3/4 inch x 3 1/4 inch

Comment

Great Room

Flooring7502Red Oak Pearl-Vintage Engineered-PEWTER/ECLIPSE-3/4 inch x 3 1/4 inch

Comment

Upper Hall

Flooring7502Red Oak Pearl-Vintage Engineered-PEWTER/ECLIPSE-3/4 inch x 3 1/4 inch ***3***

Comment

SYED, IMRAN HUSSAIN/
Project: Wallaceton
Unit: 3192D-23, Phase: 3
Model: 20-1790 A The Dunmore

Created: 2/5/2023 11:56:12
Locked:
Closed:

Finished Basement (Rec) Room/Hall

Flooring9507DY 89418-MINOTAUR-BLACK ICE-40 oz Poly ***STD***

Comment

Master Bedroom

Flooring9507DY 89418-MINOTAUR-BLACK ICE-40 oz Poly ***STD***

Comment

Bedroom 2

Flooring9507DY 89418-MINOTAUR-BLACK ICE-40 oz Poly ***STD***

Comment

Bedroom 3

Flooring9507DY 89418-MINOTAUR-BLACK ICE-40 oz Poly ***STD***

Comment

Master Ensuite

Cabinet Colour/Style9111Viking III-SIMCOE ORCHID 3DL ***STD***

Countertop88224924-38-Countertop-WHITE CARRARA-Wilsonart ***STD***

Countertop Edge1111N/A *****

Cabinet Hardware766712881-HARDWARE ***STD***

Floor Tile8913UN.BL.BIA.1224-Biel-Bianco (White)-12 x 24 See Tile Direction on Sketch Page ***2***

34

SYED, IMRAN HUSSAIN/
Project: Wallaceton
Unit: 3192D-23, Phase: 3
Model: 20-1790 A The Dunmore

Created: 2/5/2023 11:56:12
Locked:
Closed:

Floor Tile Grout	2225	Grout-(27) Silver ***STD***									
Floor Tile Pattern	3040	FRONT TO BACK ***STD*** <table><tr><td></td><td></td><td></td><td></td></tr><tr><td></td><td></td><td></td><td></td></tr></table>									
Shower Floor Tile	8661	OD.ON.SWT.0202.MT.N-Ontario Series Mosaic-Snow White Matte-2 x 2 ***STD***									
Shower Floor Tile Grout	2226	Grout-(00) White ***STD***									
Shower Floor Tile Pattern	3000	STANDARD SQUARE ***STD*** <table><tr><td></td><td></td><td></td></tr><tr><td></td><td></td><td></td></tr><tr><td></td><td></td><td></td></tr></table>									
Shower Wall Tile	9020	QT.WV.WHT.0810-Weave-White-8 x 10 ***STD***									
Shower Wall Tile Grout	2226	Grout-(00) White ***STD***									
Shower Wall Tile Pattern	3070	HORIZONTAL STACKED ***STD*** <table><tr><td></td><td></td></tr><tr><td></td><td></td></tr><tr><td></td><td></td></tr><tr><td></td><td></td></tr></table>									
Shower Jamb(s) and Sill(s)	8923	Shower Jamb / Sill-Thassos White ***STD***									
Plumbing Fixture (colour)	1737	Plumbing Fixtures-WHITE ***STD***									
Comment											

Main Bathroom

Cabinet Colour/Style	9111	Viking III-SIMCOE ORCHID 3DL ***STD***	
Countertop	8796	6698-46-Countertop-PALOMA POLAR ETCHINGS FINISH-Formica ***STD***	
Countertop Edge	1111	N/A *****	
Cabinet Hardware	7667	12881-HARDWARE ***STD***	
Flooring	9071	GE.BY.AZR.1313 New Byzantine Azzuro 13x13 ***STD***	
Floor Tile Grout	2225	Grout-(27) Silver ***STD***	

SYED, IMRAN HUSSAIN/
Project: Wallaceton
Unit: 3192D-23, Phase: 3
Model: 20-1790 A The Dunmore

Created: 2/5/2023 11:56:12
Locked:
Closed:

Floor Tile Pattern	3000	STANDARD SQUARE ***STD*** <div><div><div></div><div></div><div></div><div></div><div></div><div></div><div></div><div></div><div></div></div></div>
Wall Tile	5411	QT.SP.WHT.0810-Splendour-White-8 inch x 10 inch ***STD***
Wall Tile Grout	2226	Grout-(00) White ***STD***
Main Bathroom Tile Pattern	3070	HORIZONTAL STACKED ***STD*** <div><div><div></div><div></div><div></div><div></div><div></div><div></div></div></div>
Plumbing Fixture (Colour)	1737	Plumbing Fixtures-WHITE ***STD***
Comment		

Finished Basement Bathroom

Cabinet Colour/Style	9111	Viking III-SIMCOE ORCHID 3DL ***STD***
Countertop	8796	6698-46-Countertop-PALOMA POLAR ETCHINGS FINISH-Formica ***STD***
Countertop Edge	1111	N/A *****
Cabinet Hardware	7667	12881-HARDWARE ***STD***
Flooring	9071	GE.BY.AZR.1313 New Byzantine Azzuro 13x13 ***STD*** <div></div>
Floor Tile Grout	2225	Grout-(27) Silver ***STD***
Floor Tile Pattern	3000	STANDARD SQUARE ***STD*** <div><div><div></div><div></div><div></div><div></div><div></div><div></div><div></div><div></div><div></div></div></div>
Shower Floor Tile	8661	OD.ON.SWT.0202.MT.N-Ontario Series Mosaic-Snow White Matte-2 x 2 ***STD***
Shower Floor Tile Grout	2226	Grout-(00) White ***STD***
Shower Floor Tile Pattern	3000	STANDARD SQUARE ***STD*** <div><div><div></div><div></div><div></div><div></div><div></div><div></div><div></div><div></div><div></div></div></div>

SYED, IMRAN HUSSAIN/
Project: Wallaceton
Unit: 3192D-23, Phase: 3
Model: 20-1790 A The Dunmore

Created: 2/5/2023 11:56:12
Locked:
Closed:

Shower Wall Tile	5411	QT.SP.WHT.0810-Splendour-White-8 inch x 10 inch ***STD***								
Shower Wall Tile Grout	2226	Grout-(00) White ***STD***								
Shower Wall Tile Pattern	3070	HORIZONTAL STACKED ***STD*** <table><tr><td></td><td></td></tr><tr><td></td><td></td></tr><tr><td></td><td></td></tr><tr><td></td><td></td></tr></table>								
Shower Jamb(s)	8923	Shower Jamb / Sill-Thassos White ***STD***								
Plumbing Fixture (Colour)	1737	Plumbing Fixtures-WHITE ***STD***								
Comment										

Great Room Fireplace

Type	8865	Dimplex-Electric Fireplace-PF3033HL ***STD***
Mantle	8891	NF-17-Paint Grade Mantle- Cabinet (Per Plan)-WHITE ***STD***
Surround Opt.	1111	N/A *****
Comment		

PG 17

Basement Stairs

Type	1711	Carpet Grade Stairs ***OPT. FINISHED BASEMENT***
Colour	7922	Eclipse (Pewter) STAIN TO COMPLIMENT HARDWOOD AND WILL VARY FROM FLOORING ***99***
Carpet Runner	1111	N/A *****
Handrail/Pickets/Post Type	9119	Handrail only on closed walls (one or two sides per building code) ***STD***
Handrail/Pickets/Post Colours	1729	Carpet Grade-Stain handrail, pickets, stringers, nosing_pos
Carpet	9507	DY 89418-MINOTAUR-BLACK ICE-40 oz Poly ***STD***
Custom Stain/Paint	1111	N/A *****
Comment		

SYED, IMRAN HUSSAIN/
Project: Wallaceton
Unit: 3192D-23, Phase: 3
Model: 20-1790 A The Dunmore

Created: 2/5/2023 11:56:12
Locked:
Closed:

Basement Stairs Landings (Upper and Lower)

Flooring	7502	Red Oak Pearl-Vintage Engineered-PEWTER/ECLIPSE-3/4 inch x 3 1/4 inch ***3***
Comment		

Main Stairs

Type	1712	Oak Stairs ***STD***
Colour	7922	Eclipse (Pewter) STAIN TO COMPLIMENT HARDWOOD AND WILL VARY FROM FLOORING ***99***
Carpet Runner	1111	N/A *****
Handrail/Pickets/Posts Type	7652	1 5/16 inch Square pickets with 3 1/2? Square/Cap Post(s)-ALL OAK ***STD***
Handrail/Pickets/Posts Colour	1728	Oak Grade-Stain handrail,oak pickets,stringers,treads,risers
Custom Stain/Paint	1111	N/A *****
Comment		

Main Stairs Landing(s)

Flooring	7502	Red Oak Pearl-Vintage Engineered-PEWTER/ECLIPSE-3/4 inch x 3 1/4 inch
Comment		





Throughout

Walls - Paint Colour	1717	22-Wall-WARM GREY ***STD***
Underpad	1079	500 Series-Underpad ***STD***
Thresholds	2232	Metal Thresholds ***STD***
Switches and Plug	5796	Decora White Switches and Plugs ***STD***
Trim Size	8705	4 1/4 Baseboard and 2 3/4 Casings ***STD***
Trim - Paint Colour	1716	Trim-WHITE ***STD***

SYED, IMRAN HUSSAIN/
Project: Wallaceton
Unit: 3192D-23, Phase: 3
Model: 20-1790 A The Dunmore

Created: 2/5/2023 11:56:12
Locked:
Closed:

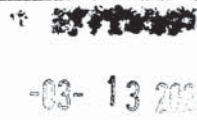
Comment	
---------	--

Purchaser:		<u>Feb 06, 2023</u>		<u>02/06/23</u>
	SYED, IMRAN HUSSAIN	Date	Decor Consultant	Date
				
Purchaser:				
		Date	Wallaceton	Date Approved



CONSTRUCTION SUMMARY

Lot: 3192D-23
Model: 20-1790 A The Dunmore
Project/Phase: Wallaceton / 3

Offer Worksheet	Five Appliances: SS Fridge, Stove, Dishwasher: White Front Loader Washer/Dryer - Townhomes Note:
Offer Worksheet	The Purchaser(s) acknowledge that they have NOT been referred by an existing Heathwood Homeowner and therefor are not entitled to a referral fee under Heathwood Homes Referral program. Note:



CONSTRUCTION SUMMARY

Lot: 3192D-23
Model: 20-1790 A The Dunmore
Project/Phase: Wallaceton / 3

CABINETRY

Invoice	Qty.	Description
1275 351,628 13Mar23	1	KITCHEN - CABINETRY - OPT. DEEP FR & GABLES - VIKING II/III - UPG KITCHEN SKETCH # 3 DRYWAL-Notify; FRAMING-Modify Bulkhead; PAINTING-Notify
1275 313,792 13Mar23	1	KITCHEN - A12-Upper pie-cut corner per unit Viking SKETCH # 3 DRYWAL-Notify; FRAMING-Modify Bulkhead; PAINTING-Notify
1275 314,040 13Mar23	1	KITCHEN - H34-Wall cabinet with shelf for microwave (finished interior) (opening 24 InchW x 13 3/4 InchH x 17 InchD) Viking SKETCH # 3

CARPET

Invoice	Qty.	Description
1275 353,783 13Mar23 **	1	- HARDWOOD - UPPER HALL - VINTAGE 3 1/4 IN - UPG CARPET-delete std carpet; INTERIOR TRIM-supply and install quarter rounds; PAINTING-paint quarter round

CERAMICS

Invoice	Qty.	Description
1275 348,605 13Mar23	1	KITCHEN / BREAKFAST - CERAMICS - KITCHEN / BREAKFAST - FLOOR - UG 2 KITCHEN
1275 348,601 13Mar23	1	FOYER - CERAMICS - FOYER - FLOOR - UG 2 FOYER
1275 348,602 13Mar23	1	POWDER - CERAMICS - POWDER - FLOOR - UG 2 POWDER ROOM
1275 348,607 13Mar23	1	MASTER ENSUITE - CERAMICS - MASTER ENSUITE - FLOOR - UG 2 MASTER ENSUITE



CONSTRUCTION SUMMARY

Lot: 3192D-23
Model: 20-1790 A The Dunmore
Project/Phase: Wallaceton / 3

DRYWALL

Invoice	Qty.	Description
1275 351,628 13Mar23 **	1	KITCHEN - CABINETRY - OPT. DEEP FR & GABLES - VIKING II/III - UPG KITCHEN SKETCH # 3 DRYWAL-Notify; FRAMING-Modify Bulkhead; PAINTING-Notify
1275 313,792 13Mar23 **	1	KITCHEN - A12-Upper pie-cut corner per unit Viking SKETCH # 3 DRYWAL-Notify; FRAMING-Modify Bulkhead; PAINTING-Notify
1275 352,880 13Mar23	1	- DRYWALL - SMOOTH CEILING IN MAIN FLOOR - UPG PAINTING-Notify

ELECTRICAL

Invoice	Qty.	Description
1275 314,340 13Mar23 **	1	KITCHEN - HEATING/AIR - ROUGH-IN GAS LINE FOR GAS STOVE AT MAIN FLOOR (SEE SPECS) (HOOK-UP NOT INCLUDED) LEAVE STANDARD 120 VOLT ELECTRICAL OUTLET ON A SEPARATE CIRCUIT. * SPECIFY IF STANDARD 220V WILL STAY OR BE RELOCATED STANDARD 240V TO REMAIN SKETCH # 3 ELECTRICAL-Notify
1275 314,224 13Mar23	2	- ELECTRICAL - CEILING ROUGH-IN (CAPPED) INCLUDING SWITCH 1X IN GREAT ROOM CENTERED +/- ON CEILING; 1X CENTERED +/- ON ISLAND. SEE SKETCH # 2
1275 314,232 13Mar23	1	GREAT ROOM - ELECTRICAL - EXTRA WALL INTERIOR OUTLET ON EXISTING CIRCUIT (DOES NOT INCLUDE KITCHEN OUTLETS) GREAT ROOM - TO BE CENTERED +/- ABOVE FIREPLACE APPROX 70" +/- FROM FLOOR. SEE SKETCH # 2
1275 314,229 13Mar23	1	KITCHEN - ELECTRICAL - EXTRA WALL INTERIOR OUTLET (120V/15A) ON A SEPARATE CIRCUIT (ON ARCFAULT) FOR MICROWAVE SHELF- SKETCH # 3

FRAMING

Invoice	Qty.	Description
1275 351,628 13Mar23 **	1	KITCHEN - CABINETRY - OPT. DEEP FR & GABLES - VIKING II/III - UPG KITCHEN SKETCH # 3 DRYWAL-Notify; FRAMING-Modify Bulkhead; PAINTING-Notify
1275 313,792 13Mar23 **	1	KITCHEN - A12-Upper pie-cut corner per unit Viking SKETCH # 3 DRYWAL-Notify; FRAMING-Modify Bulkhead; PAINTING-Notify

HARDWOOD

Invoice	Qty.	Description
1275 353,783 13Mar23	1	- HARDWOOD - UPPER HALL - VINTAGE 3 1/4 IN - UPG CARPET-delete std carpet; INTERIOR TRIM-supply and install quarter rounds; PAINTING-paint quarter round



CONSTRUCTION SUMMARY

Lot: 3192D-23
Model: 20-1790 A The Dunmore
Project/Phase: Wallaceton / 3

HEATING / AIR CONDITIONING

Invoice	Qty.	Description
1275 314,340 13Mar23	1	KITCHEN - HEATING/AIR - ROUGH-IN GAS LINE FOR GAS STOVE AT MAIN FLOOR (SEE SPECS) (HOOK-UP NOT INCLUDED) LEAVE STANDARD 120 VOLT ELECTRICAL OUTLET ON A SEPARATE CIRCUIT. * SPECIFY IF STANDARD 220V WILL STAY OR BE RELOCATED STANDARD 240V TO REMAIN SKETCH # 3 ELECTRICAL-Notify

INTERIOR TRIM AND DOORS

Invoice	Qty.	Description
1275 353,783 13Mar23 **	1	- HARDWOOD - UPPER HALL - VINTAGE 3 1/4 IN - UPG CARPET-delete std carpet; INTERIOR TRIM-supply and install quarter rounds; PAINTING-paint quarter round

PAINTING

Invoice	Qty.	Description
1275 351,628 13Mar23 **	1	KITCHEN - CABINETRY - OPT. DEEP FR & GABLES - VIKING II/III - UPG KITCHEN SKETCH # 3 DRYWAL-Notify; FRAMING-Modify Bulkhead; PAINTING-Notify
1275 313,792 13Mar23 **	1	KITCHEN - A12-Upper pie-cut corner per unit Viking SKETCH # 3 DRYWAL-Notify; FRAMING-Modify Bulkhead; PAINTING-Notify
1275 353,783 13Mar23 **	1	- HARDWOOD - UPPER HALL - VINTAGE 3 1/4 IN - UPG CARPET-delete std carpet; INTERIOR TRIM-supply and install quarter rounds; PAINTING-paint quarter round
1275 352,880 13Mar23 **	1	- DRYWALL - SMOOTH CEILING IN MAIN FLOOR - UPG PAINTING-Notify



Sales Selection Sheet
Wallaceton

PURCHASER: SYED, IMRAN HUSSAIN TEL:

LOT / UNIT 3192D-23	PHASE 3	MODEL 20-1790 A The Dunmore	
------------------------	------------	--------------------------------	--

PURCHASER:

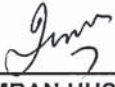

SYED, IMRAN HUSSAIN

06-Feb-23
DATE



Decor Consultant

06-Feb-23
DATE



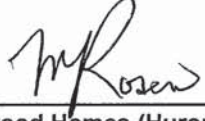

Date Approved Heathwood Homes (Huron) Limited

THE DUNMORE

ELEVATION A | 2,242 SQ. FT.

Includes 452 sq. ft. of Finished Lower Level

WALLACETON
EST. 1870

20-1790 ELEV. A

Sketch #1

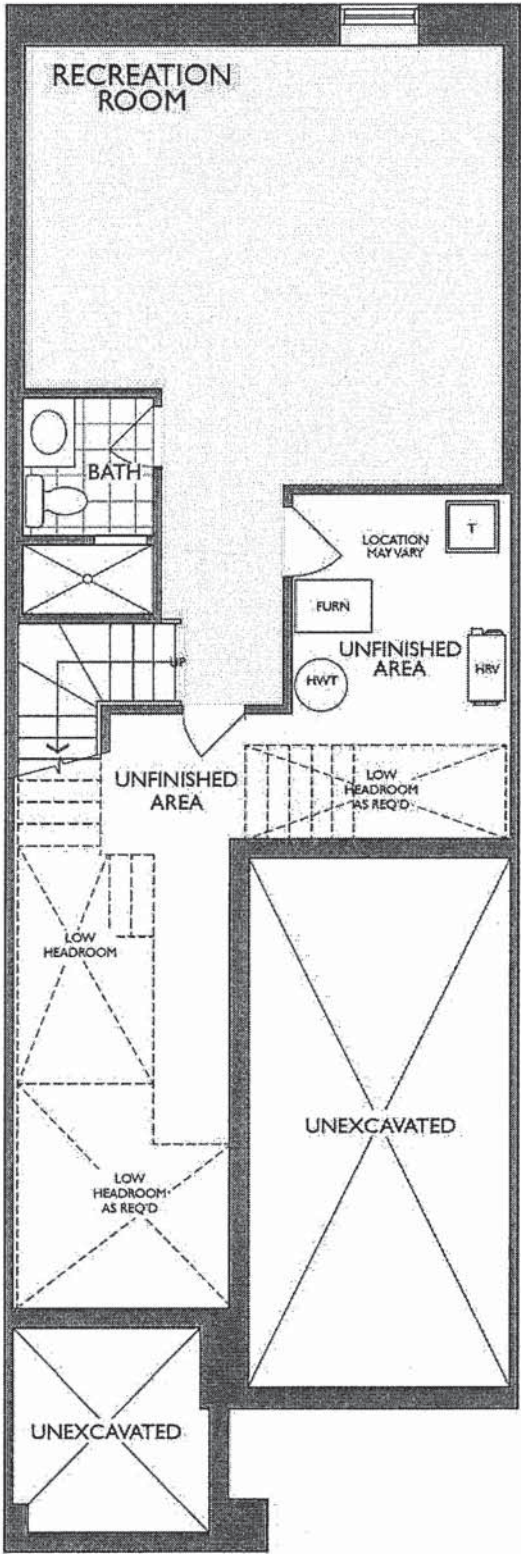

LOWER LEVEL
ELEVATION A

J

WALLACETON
EST. 1870

Legal Plan Dec. 3, 2020

KITCHEN
(GROUND FLOOR)

PIE-CUT CORNER

MICROWAVE
SHELF &
PLUG

R/I GAS LINE

DEEP FREEZE
UPPER

18 of 43

Project: Wallace-ton
Unit: 3192D-23, Phase: 3
Model: 20-1790 A The Dunmore

4/29/2022

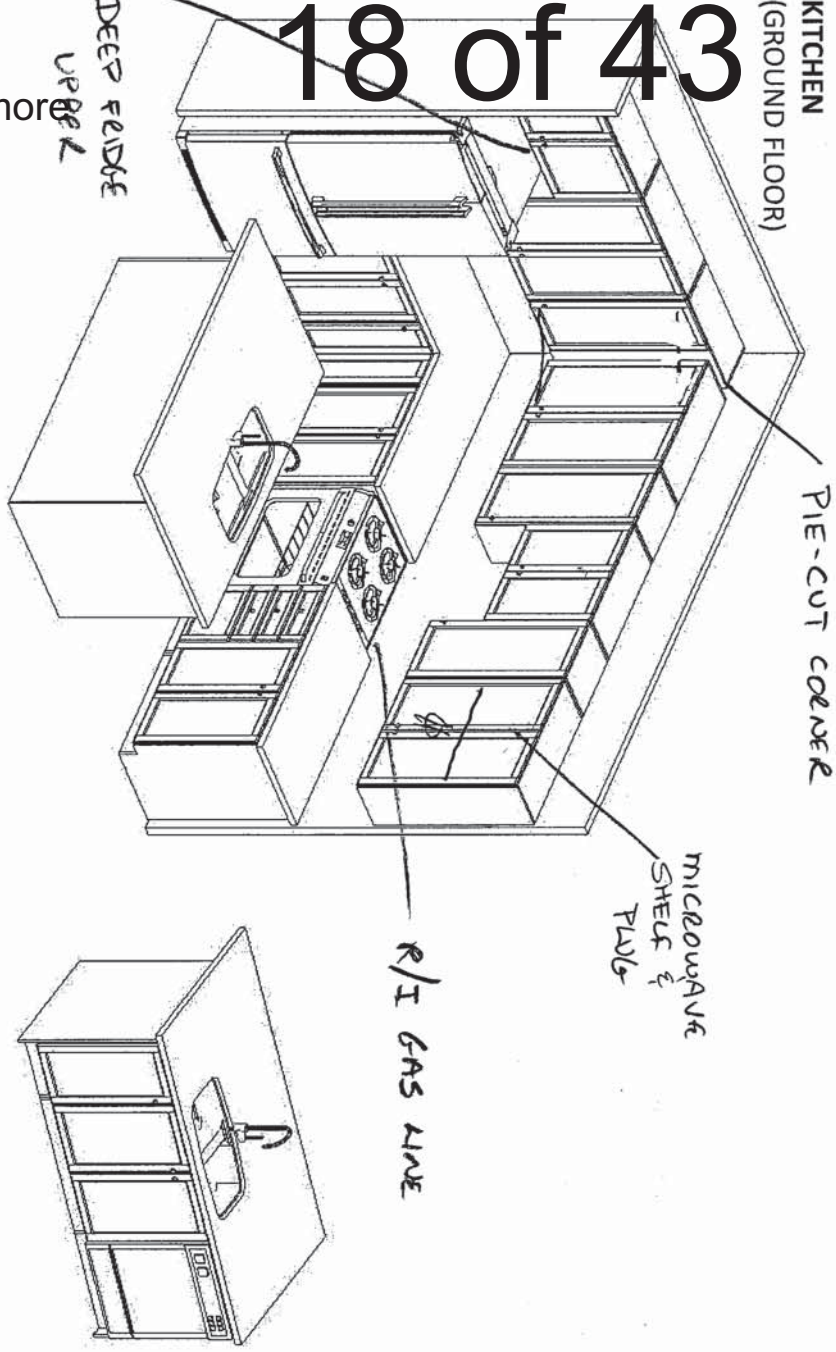
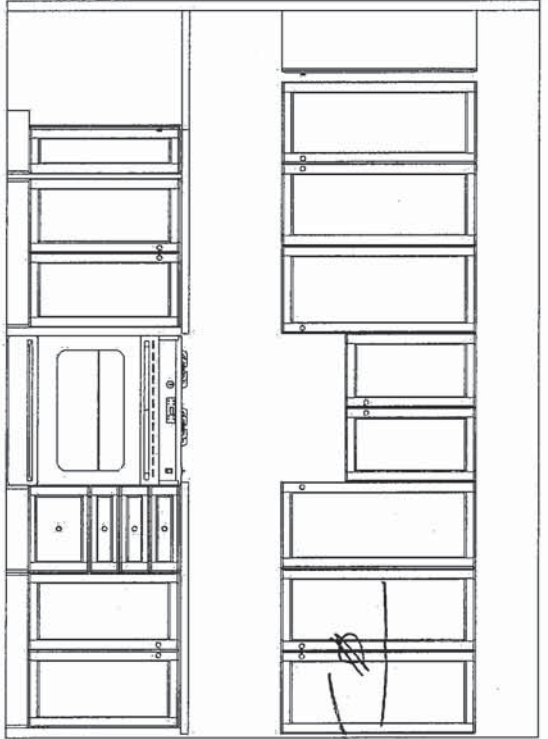
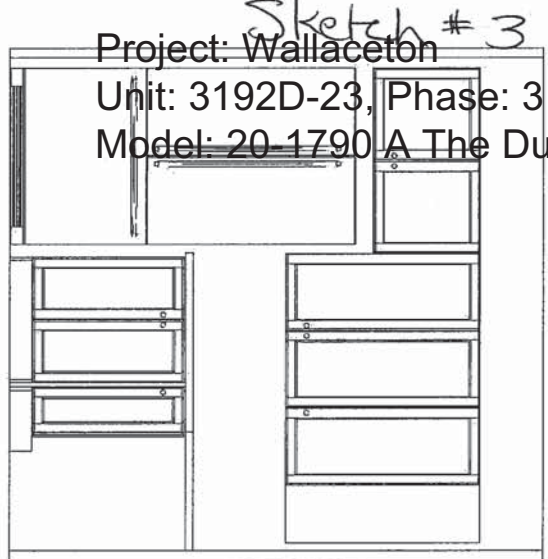

MASTER ENSUITE
(2ND FLR)

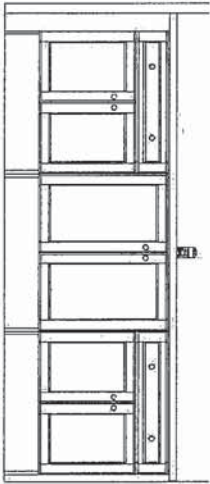

MAIN BATH
(2ND FLR)

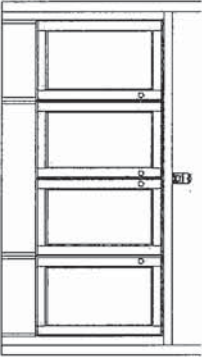

OPT. LAUNDRY UPPERS
(2ND FLR)

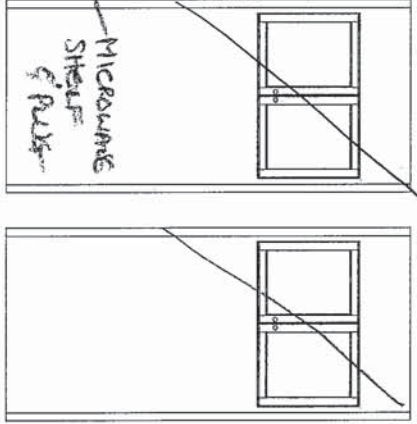

STD. BASEMENT BATH

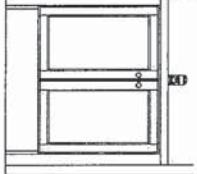

F R E N D E L
K I T C H E N S L I M I T E D
1350 Shawson Drive, Mississauga, ON L4W 1C5

HEATHWOOD HOMES
WALLACE-TON, KITCHENER ON
MODEL: 20-1790 (2004)

STANDARD CONTRACT INCLUDES:

Appliance Openings

- Hood Opening: 30"W std. hood
- Fridge Opening: 37 3/8 "W X 73 3/8" H
- 30cm deep cabinet over fridge
- Stove Opening: 30" Freestanding
- Dishwasher Opening: 24"

Standard Kitchens Scope:

- 100cm H wall cabinets
- Std. Blumotion Hinges- **soft close**
- Std. Metabox Drawers- **not soft close**
- Min 40cm W drawer
- Base pie cut corner cabinets
- Backing on all cabinets
- Countertop by others
- Upgrade applied paneled fridge & dishwashers supply only (appliance hardware by others)

Standard Vanity & Laundry Scope:

- Powder by others, pedestal
- All vanities include laminate counter
- Std. Blum Hinges- **not soft close**
- Metabox Drawers- **not soft close**
- Master Ensuite: Top drawers (Full height doors at sink)
- Mains: Full height doors (top drawers added if Masters can't accommodate)
- Optional laundry base & wall cabinets

THIS DRAWING IS FOR DESIGN PURPOSES ONLY.
IT IS NOT AN EXACT RENDITION.

THE DUNMORE

ELEVATION A | 2,242 SQ. FT.

Includes 452 sq. ft. of Finished Lower Level

20-1790 ELEV. A

WALLACETON
EST. 1870

Sketch #4

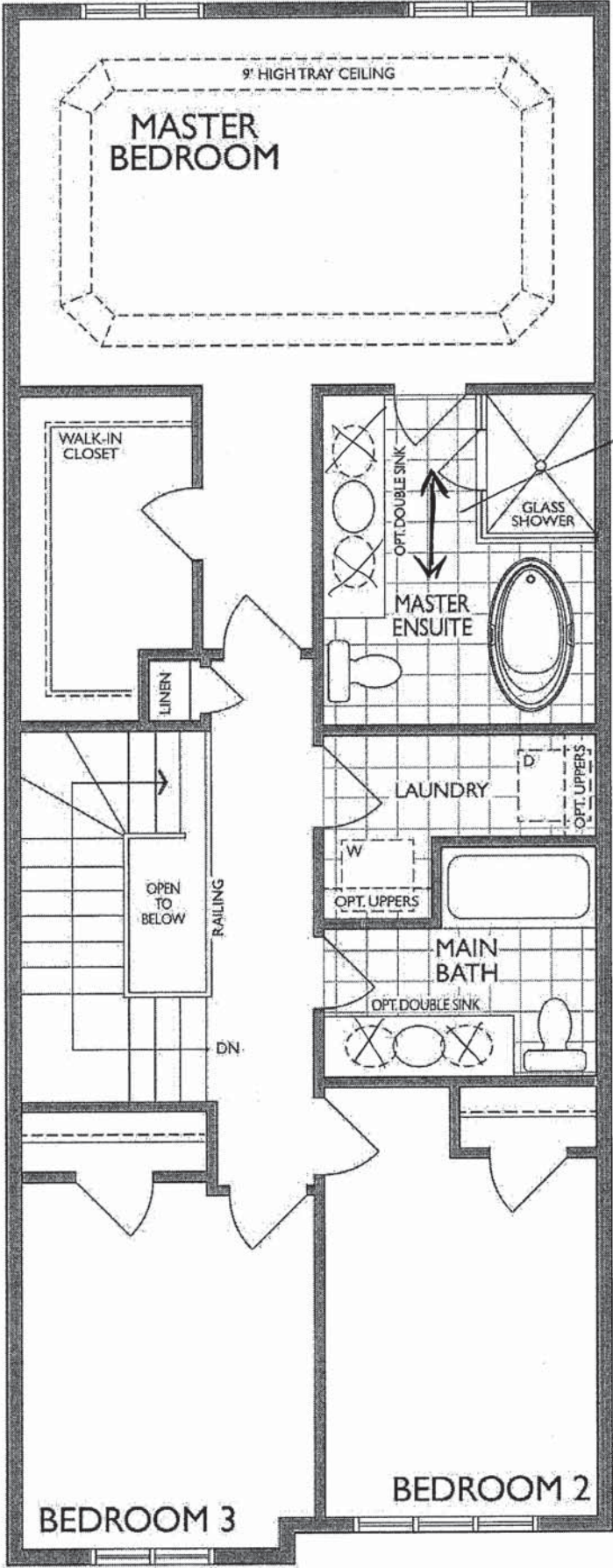

12x24
TILE DIRECTION

gr

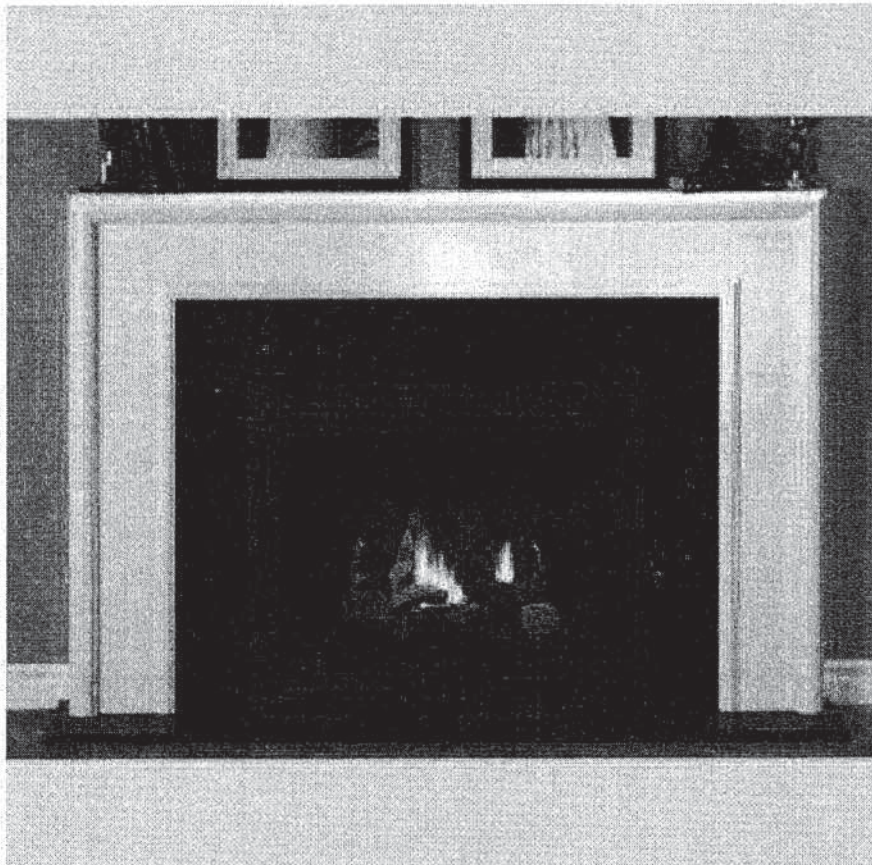

NEAS NF17 Mantel – Cabinet

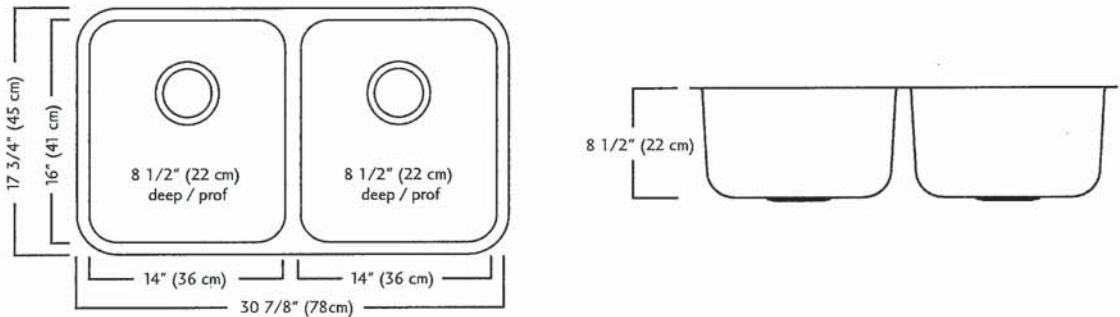

ND1831UA/9 SPECIFICATION

Model ND1831UA/9 is a double (two equal size) bowl undermount sink manufactured by Franke Kindred Canada Limited from 18 gauge stainless steel. Product has silk finished rims and linear brush finished bowls. Sink is fully undercoated. Basket strainer waste fittings (3 1/2", 89 mm) are included. Sink is backed with a limited lifetime warranty.

- O.D. 17 3/4" x 30 7/8" x 8 1/2" (45 x 78 x 22 cm)
- Recommended for minimum 36" cabinet

Franke Kindred Canada Limited
P.O. Box 190, 1000 Franke Kindred Road, Midland, Ontario, Canada, L4R 4K9 Phone: 866-687-7465 Fax: 800-361-8408

g



There is more than 1 version of this model.
Page down to identify the version you have.

FAUCET DESCRIPTION

- Reflex™ pulldown system offers smooth operation, easy movement and secure docking
- Power Clean™ spray technology
- Metal construction with various finishes identified by suffix
- Duralock™ connect installation
- Pulldown spray with 68" braided hose
- Flexible supply lines with 3/8" compression fittings
- High arc spout provides height and reach to fill or clean large pots while pulldown wand provides the maneuverability for cleaning or rinsing
- 360° rotating spout
- Faucet designed for handle to be mounted on right side only

OPERATION

- Lever style handle
- Temperature controlled by 100° arc of handle travel
- Operates with less than 5 lbs. of force
- Operates in stream or spray mode in the pullout or retracted position

FLOW

- Flow is limited to 1.5 gpm (5.7 L/min) max at 60 psi

CARTRIDGE

- 1255™ Duralast™ cartridge

STANDARDS

- Third party certified to IAPMO Green, ASME A112.18.1/CSA B125.1 and all applicable requirements therein including NSF 61/9G & 372
- Meets CalGreen and Georgia SB370 requirements
- Complies with California Proposition 65 and with the Federal Safe Drinking Water Act
- The backflow protection system in the device consists of two independently operating check valves, a primary and a secondary which prevent backflow

- ADA  for lever handle

WARRANTY

- Lifetime limited warranty against leaks, drips and finish defects to the original homeowner
 - 10 year limited warranty when used in a multifamily installation
 - 5 year limited warranty when used in a commercial installation
- Visit www.moen.com/support for complete details and limitations

Specifications

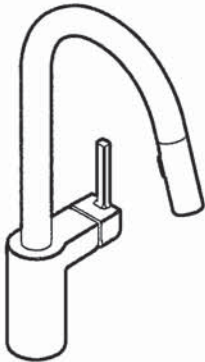

ALIGN™
Single Handle High Arc
Pulldown Kitchen Faucet

Models: 7565 series

NOTE: THIS FAUCET IS DESIGNED TO BE INSTALLED
THROUGH 1 HOLE, 1-1/2" (38mm) MIN. DIA.
(OPTIONAL 3-HOLE ESCUTCHEON 141002 AVAILABLE)

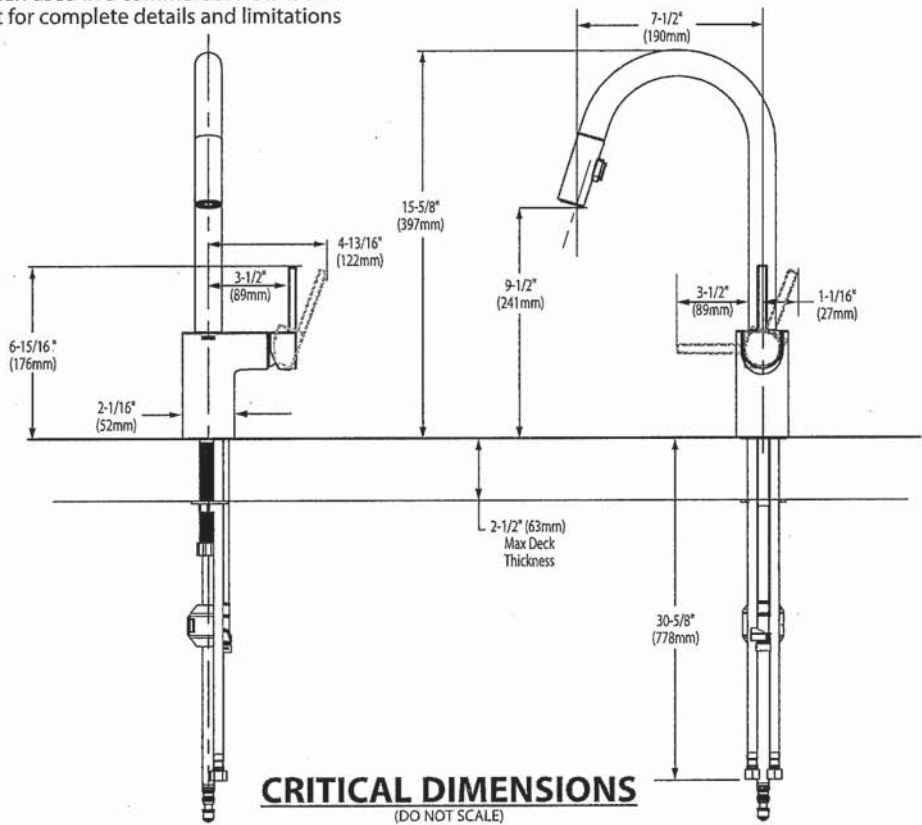

J



BARRIER FREE (ABOVE COUNTER OR DROP-IN ONLY)

BOULEVARD®
PEDESTAL SINK
VITREOUS CHINA

BOULEVARD® PEDESTAL SINK

- STD ☒ **0641.800** Faucet holes on 8" (203mm) centers (Illustrated)
- ☒ **0641.400** Faucet holes on 4" (102mm) centers
- ☐ **0641.100** Center hole only
- Classic styled rectangular pedestal lavatory
 - Vitreous china
 - Rear overflow
 - Supplied with mounting kit
 - Right Height® for greater comfort during use
 - Faucet ledge with large deck area (faucet not included)
 - **Design coordinates with Boulevard® Toilet**
 - Basin has flat bottom to also allow use as an **above counter** sink or a **drop-in** sink (with u-shaped cut out)

Nominal Dimensions:

24" x 19" x 35-1/2"
(610 x 483 x 902mm)

- ☐ **0641.008** Pedestal top-8" (203mm) centers
- ☐ **0641.004** Pedestal top-4" (102mm) centers
- ☐ **0641.001** Pedestal top-center hole only
- ☐ **0010.000** Pedestal only

Bowl sizes:

17" (432mm) wide,
12-1/2" (318mm) front to back,
5" (127mm) deep

Compliance Certifications -

Meets or Exceeds the Following Specifications:

- ASME A112.19.2 - 2008/CSA B45.1-08

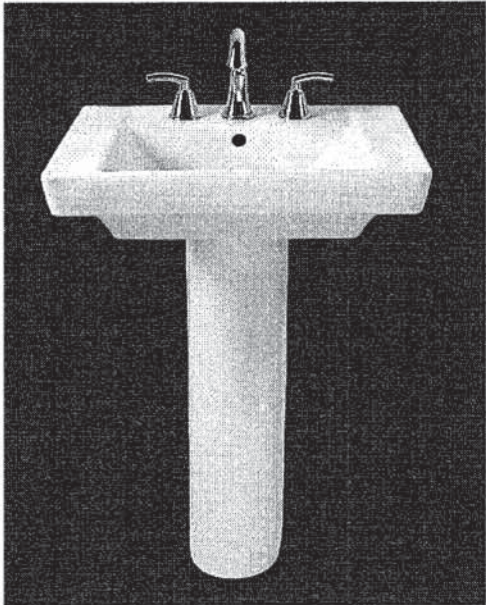

SEE REVERSE FOR ROUGHING-IN DIMENSIONS

To Be Specified:

- ☐ Color: ☒ White ☐ Linen
- ☐ Faucet Finish:
- ☐ Supplies:
- ☐ 1-1/4" Trap:
- ☐ Nipple:

* See faucet section for additional models available



BARRIER FREE

COLONY™
COUNTERTOP SINK
VITREOUS CHINA

COLONY COUNTERTOP SINK

- Vitreous china
- Self-rimming
- Front overflow
- Supplied with template
- Faucet deck
(Faucet shown not included)

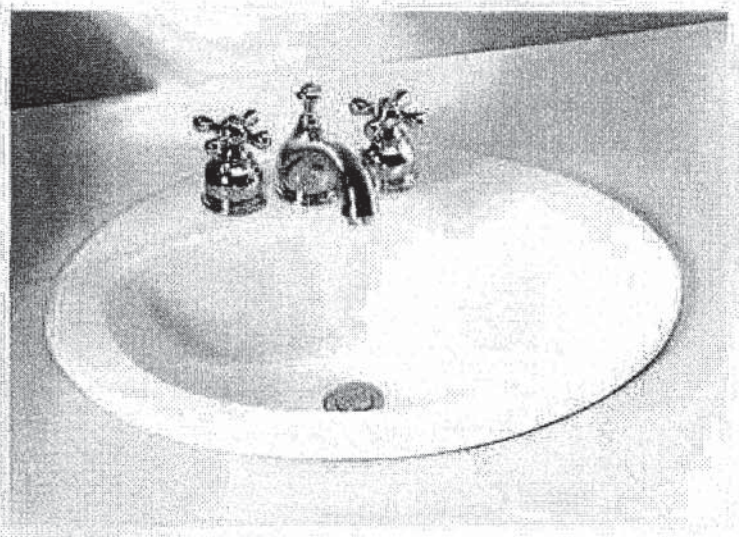

- ☐ **0346 803**
Faucet holes on 203mm (8") centres
- ☒ **0346 403 (Illustrated)**
Faucet holes on 102mm (4") centres
- ☐ **0346 001**
Centre hole only

Nominal Dimensions:
521 x 448mm (20-1/2" x 17-5/8")

Bowl sizes:
422mm (16-5/8") wide, 279mm (11") front to back, 143mm (5-5/8") deep

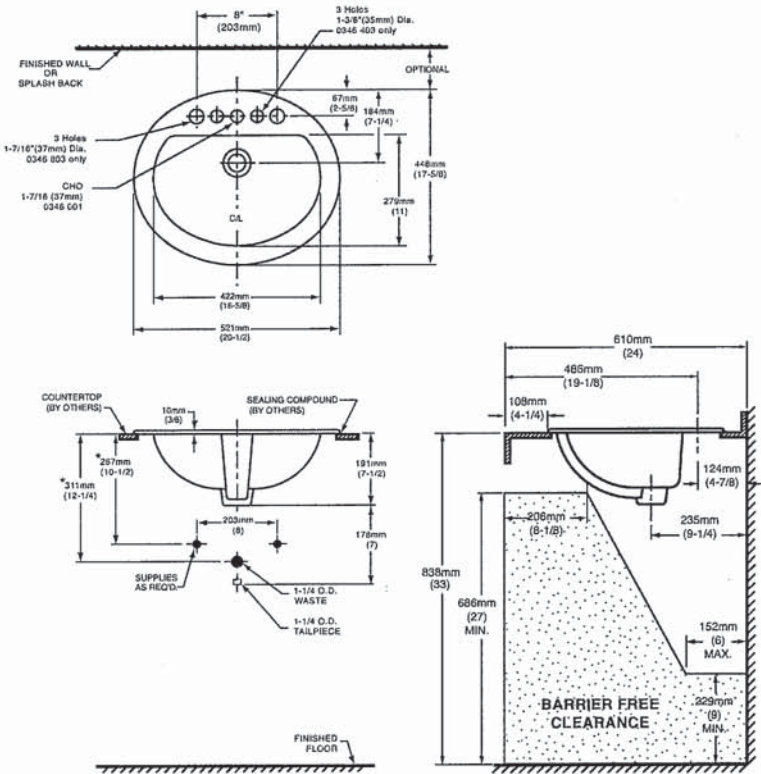

COMPLIANCE CERTIFICATIONS –
Meets or exceeds the following Specifications:
• ASME A112.19.2M for Vitreous China Fixtures.
• CAN/CSA B45 Series.

To Be Specified

☐ Colour: ☒ White ☐ Bone ☐ Silver Gray ☐ Linen

☐ Faucet*:

☐ Faucet Finish:

☐ Supplies & Stops:

☐ Trap 1-1/4" (32 mm):

NOTES:
* DIMENSIONS SHOWN FOR LOCATION OF SUPPLIES AND "P" TRAP ARE SUGGESTED. FOR COUNTERTOP CUTOUT AND INSTALLATION INSTRUCTIONS USE TEMPLATE SUPPLIED WITH SINK.
FAUCETS NOT INCLUDED AND MUST BE ORDERED SEPARATELY.
IMPORTANT: Dimensions of fixtures are nominal and may vary within the range of tolerances established by ANSI Standard A112.19.2.
These measurements are subject to change or cancellation. No responsibility is assumed for use of superseded or voided pages.

* See faucet section for additional models available



DEMI™
Product Specification Sheet



Two Piece Freestanding Collection

CF2007 Two Piece Freestanding Soaker

Size: 60" x 32" x 22"
1524 mm x 813 mm x 559 mm

PRODUCT FEATURES & BENEFITS

- Vacuum formed acrylic reinforced with fiberglass
- Scratch, stain and fade resistant high gloss finish
- Installation friendly two piece design
- Accepts deck mounted faucet
- Includes integral pop up drain and rectangular overflow
- Includes levelling feet

TWO PIECE ASSEMBLY

FRONT VIEW

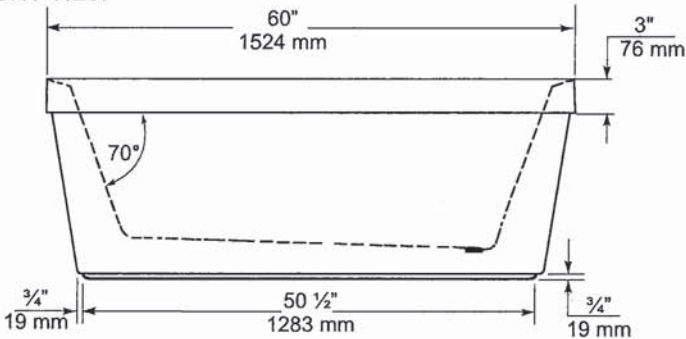

END VIEW

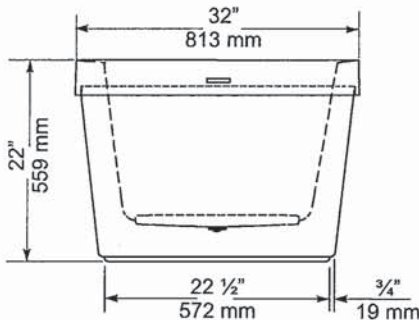

TOP VIEW

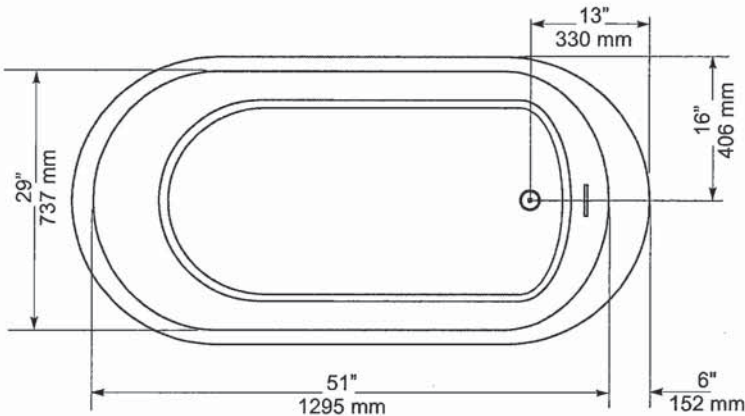

GENERAL SPECIFICATIONS		
Average Weight	90 lb	41 kg
Bathing Well at bottom	43"x 20"	1092 x 508 mm
Capacity Drain to Overflow		195 litres
Water Depth Drain to Overflow	16"	406 mm
Drain Opening (dia.)	2"	51 mm
Overflow Opening	2 1/4"x 1 1/2"	57 x 13 mm
Drain to Floor Clearance	3 1/4"	83 mm

NOTES: Please confirm measurements on actual product to ensure proper identification. Bathtub to be installed on the floor supported by 5 self levelling feet. Adjust if required to level the bathtub for adequate drainage. Refer to installation instructions for additional information.

IMPORTANT: Dimensions of fixtures are nominal and may vary ± 1/4" (6 mm). Weight may vary ± 5 lb (2.3 kg). Drawing is not to scale. These measurements are subject to change at manufacturer's discretion.

Compliance Certifications -
Meets or Exceeds the following Specifications:
• CAN/CSA - B45 Series



g

American Standard
Style That Works Better

FloWise™ DUAL FLUSH
ELONGATED TOILET
VITREOUS CHINA

FloWise™ DUAL FLUSH ELONGATED TOILET

- 2476 216
 - Vitreous china
 - Low-consumption Dual Flush
 - Full flush 6.0 Lpf/1.3 gpf,
 - Partial flush 3.0 Lpf/0.66 gpf.
 - Elongated wash down bowl
 - Internal trapway fully-glazed,
2-1/4" (57mm) ballpass
 - Concealed trapway bowl
 - Chrome-plated top mounted
push button actuator
 - Easy to clean sanitary dam on bowl
 - Includes Elongated Slow Close Seat
 - 100% factory flush tested
 - 2 bolt caps

Separate Component Parts:

- 3067 316 Elongated Bowl with Slow Close Seat
 - 4035 216 Unlined Tank
-
- 2476 516 Same as above with Lined tank
 - 3067 316 Elongated Bowl
 - 4035 516 Lined Tank

Nominal Dimensions:
794 x 432 x 765mm
(31-1/4" x 17" x 30-1/8")

Compliance Certifications -
Meets or Exceeds the Following Specifications:
• ASME A112.19.2M (and 19.6M)
• CAN/CSA B45 series

- To Be Specified
- Colour: 020 White
 - Supply with stop:

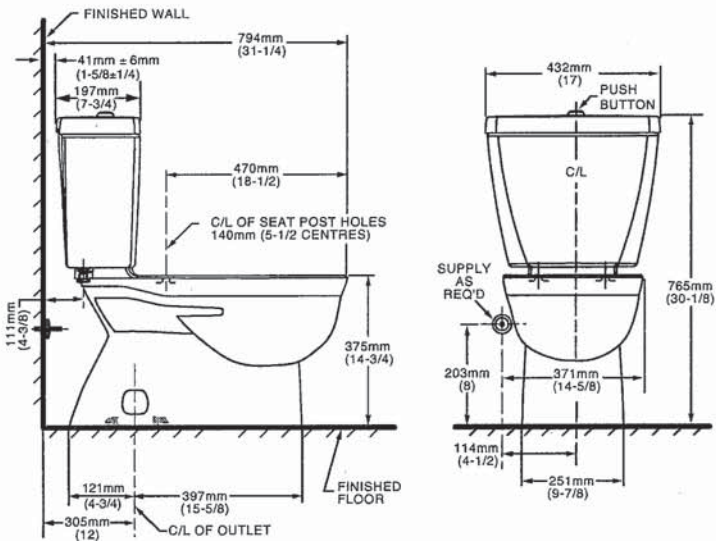

NOTES:
THIS TOILET IS DESIGNED TO ROUGH-IN AT A MINIMUM DIMENSION OF 305MM (12") FROM FINISHED WALL TO C/L OF OUTLET.
SUPPLY NOT INCLUDED WITH FIXTURE AND MUST BE ORDERED SEPARATELY.
* DIMENSION SHOWN FOR LOCATION OF SUPPLY IS SUGGESTED.
FOR ADDITIONAL INFORMATION REFER TO INSTALLATION INSTRUCTIONS SUPPLIED.
IMPORTANT: Dimensions of fixtures are nominal and may vary within the range of tolerance established by ANSI Standard A112.19.2
These measurements are subject to change or cancellation. No responsibility is assumed for use of superseded or voided pages.

UPGRADED VALUE ADDED FEATURES AT NO EXTRA CHARGE

2



Specifications

There is more than 1 version of this model.
Page down to identify the version you have.

DESCRIPTION

- Metal construction with various finishes identified by suffix
- Flexible supplies with 3/8" compression fittings
- Includes metal or 50/50 pop-up type waste assembly where noted

OPERATION

- Pivot action lever style handle
- Temperature controlled through 100° degree arc of handle travel

FLOW

- Water usage is limited to these maximum flow rates as indicated by the corresponding product markings
- ° 1.2 gpm max (4.5L/min) at 60 psi
- ° 1.5 gpm max (5.7L/min) at 60 psi

CARTRIDGE

- 1255™ Duralast™ cartridge
- Nonmetallic/nonferrous and stainless steel material

STANDARDS

- Third party certified to WaterSense®, ASME A112.18.1/CSA B125.1 and all applicable requirements referenced therein
- Certified to NSF 61/9 & 372
- Products marked with 1.2 gpm are compliant with California water efficiency regulations
- Complies with California Proposition 65 and with the Federal Safe Drinking Water Act
- ADA  for lever handle

WARRANTY

- Lifetime limited warranty against leaks, drips and finish defects to the original consumer purchaser
- 5 year warranty if used in commercial installations



CHATEAU®
Single-Handle Lavatory Faucet

with Metal Waste Assembly
Model: L4625 series
L4631BC
Bulk Packed (12 per carton):
L64624 series

with 50/50 Waste Assembly
Bulk Packed (12 per carton):
L64625 series

Less Waste
Bulk Packed (12 per carton):
L64600 series

NOTE: THIS FAUCET IS DESIGNED TO BE
INSTALLED THRU 3-1" DIA. HOLES, 2" ON CENTER

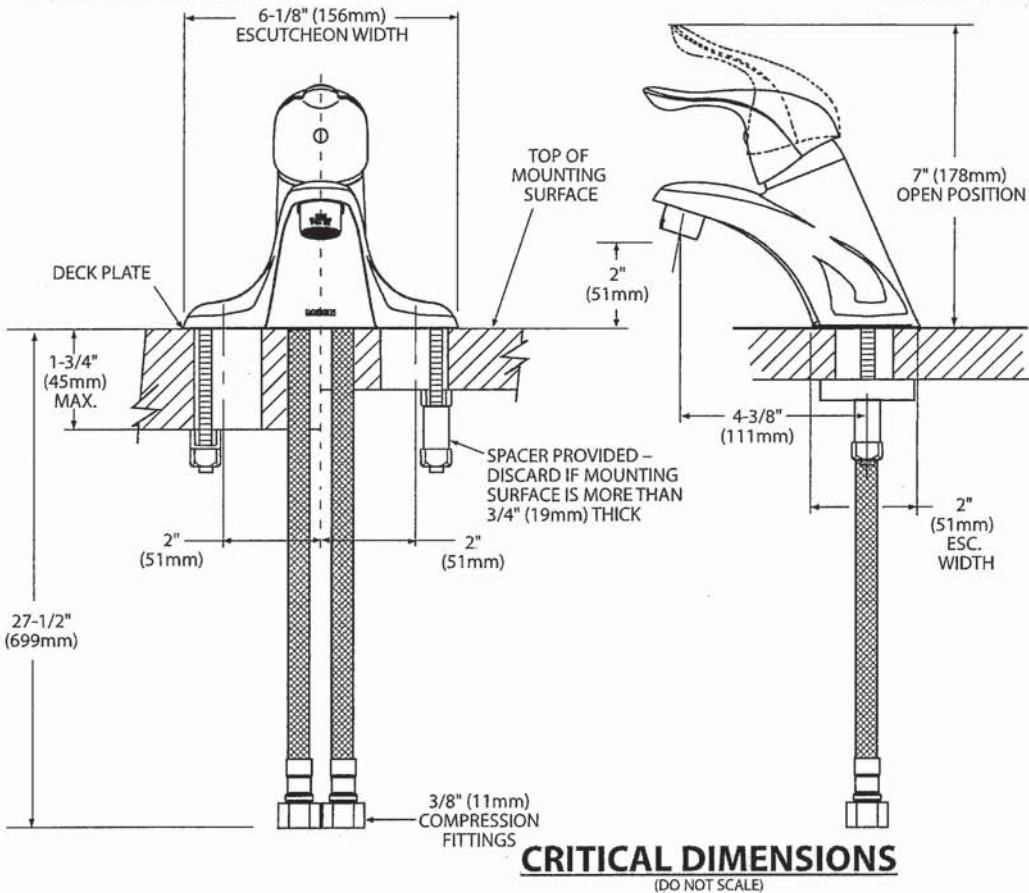

J



Buy it for looks. Buy it for life.®

There is more than 1 version of this model.
Page down to identify the version you have.

DESCRIPTION

- Metal construction with various finishes identified by suffix
- Includes non-metallic showerhead, arm, flange and non-metallic diverter tub spout

OPERATION

- Handle operates counterclockwise through a 270° arc with off at 6 o'clock and maximum hot at the 9 o'clock position. Shut off in clockwise direction
- Adjustable temperature limit stop to control maximum hot water temperature
- Pressure balancing mechanism maintains selected discharge temperature to $\pm 3^\circ$

FLOW

- Showerhead is limited to 2.5 gpm (9.5 L/min) at 80 psi
- EP suffix models are limited to 1.75 gpm (6.6 L/min) at 80 psi
- NH suffix models contain no showerhead

CARTRIDGE

- 1222 cartridge design
- Accommodates back to back installations
- Nonmetallic/nonferrous and stainless steel material

STANDARDS

- Third party certified to meet ASME A112.18.1/CSA B125.1 and all applicable requirements referenced therein
- EP suffix models are third party certified to WaterSense®
- ADA  for lever handle

WARRANTY

- Lifetime limited warranty against leaks, drips and finish defects to the original consumer purchaser
- 5 year warranty if used in commercial installations

Specifications



CHATEAU® POSI-TEMP® Single-Handle Tub/Shower Trim Kit

Models: TL181 series - valve trim only
(Bulk Packed 12 per carton)
TL182 series - shower trim only
(Bulk Packed 12 per carton)
TL183 series - tub/shower trim
(Bulk Packed 12 per carton)

Valves: 62300 series
2500 series

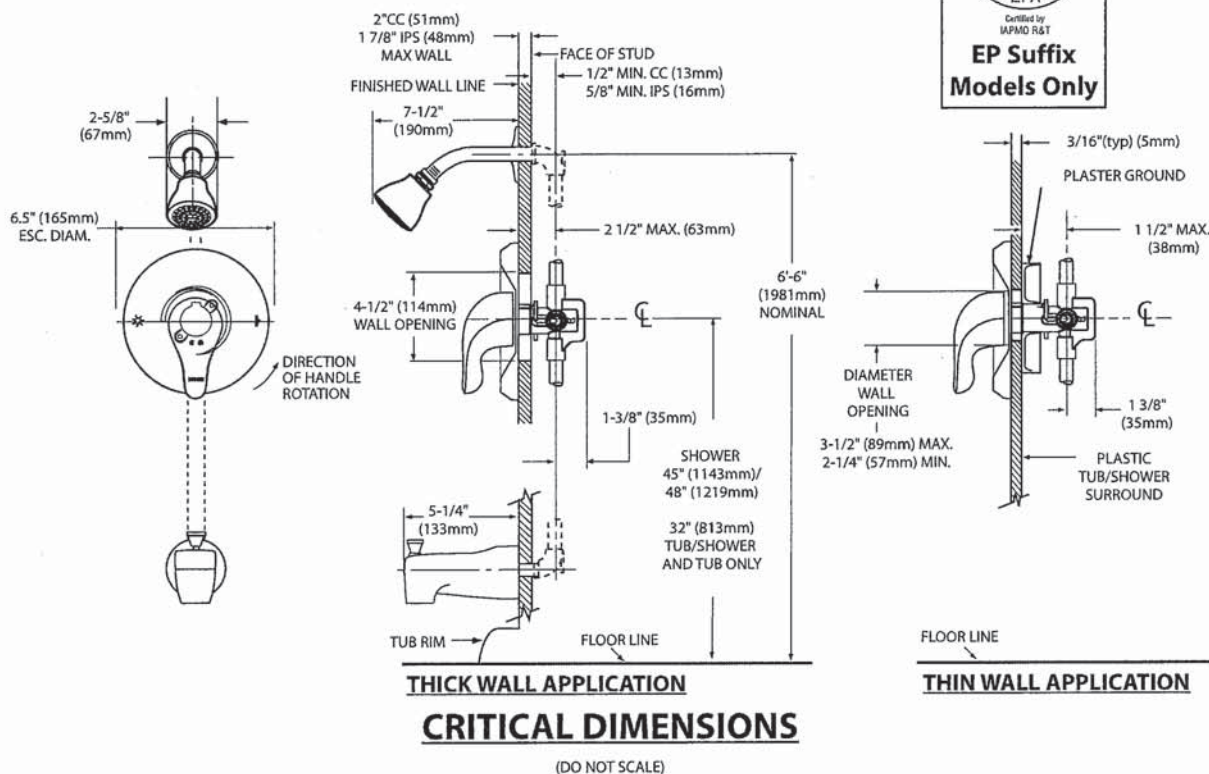

J



Specifications

DESCRIPTION

- Metal construction with various finishes identified by suffix

OPERATION

- Lever style handles with hot and cold color indicator
- Rotate hot side handle counterclockwise to open (clockwise to close) and the cold side handle (clockwise to open) and (counterclockwise to close)

STANDARDS

- Third party certified to: ASME A112.18.1/CSA B-125.1, and all applicable requirements referenced therein

- ADA  for lever handles

WARRANTY

- Lifetime limited warranty against leaks, drips and finish defects to the original homeowner
 - 10 year limited warranty when used in a multi-family installation
 - 5 year limited warranty when used in a commercial installation
- Visit www.moen.com/support for complete details and limitations

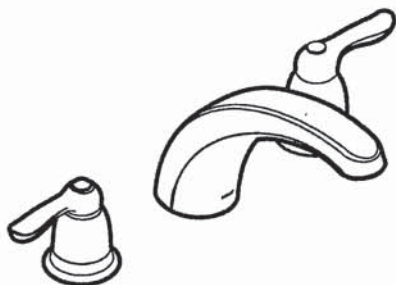

CHATEAU®
Two-Handle Garden Tub Trim

Models: T994 series

Valves: 4792, 4793, 4794, 4796, 4797, 4798

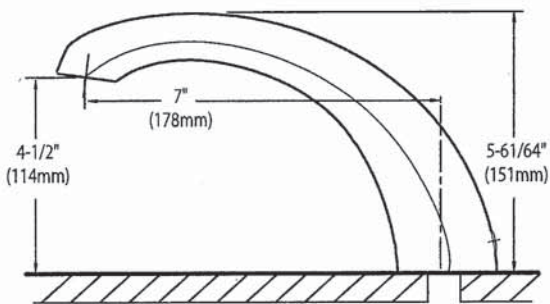
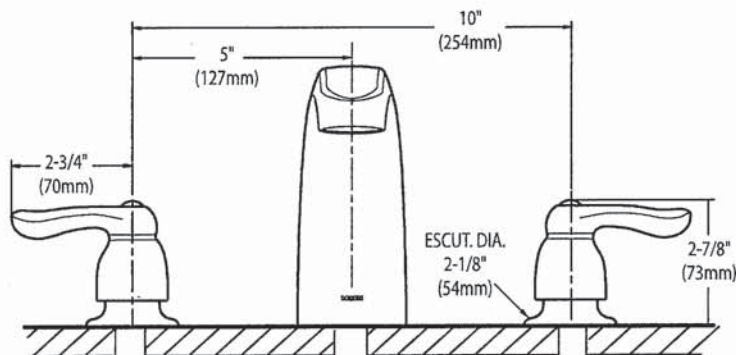

CRITICAL DIMENSIONS
(DO NOT SCALE)

g



SPECIFICATIONS
AV SERIES
RANGE HOODS



180 CFM/7.0 Sones @ 0.10" SP. Horizontal
180 CFM/7.5 Sones @ 0.10" SP. Vertical

- Dimensions**
Overall bottom projection - 18 3/8"
Overall top projection - 12"
Height - 6"
Available widths: 21", 24", 30", 36" & 42"
- Hood Body**
Stainless Steel: 24 gauge, grade 430 stainless steel.
Painted: 23 gauge cold rolled commercial grade (CRCQ) steel, auto welded, coated with a baked enamel finish.
- Motor**
2 speed, single coil, thermally protected, permanently lubricated.
Rated 120 volts, 60 hz. Complete with 200°C lead wires.
- Lighting**
Single 60 watt cook light capacity (bulb not included).
- Ducting Options**
Horizontal ducting: 3 1/4"x10" (duct adapter and damper included).
Vertical ducting: 3 1/4"x10" (duct adapter and damper included).
Vertical ducting: 7" round (duct adapter and damper not included).
Ductless: removable front vent (charcoal filter not included).
- Fan Blade**
One piece polymeric, electronically balanced blade. 6 5/8" diameter with 5 paddles.
- Electrical connection**
Hood top - 7/8" knockout hole for use with 1/2" cable clamp
Hood back - 7/8" knockout hole for use with 1/2" cable clamp

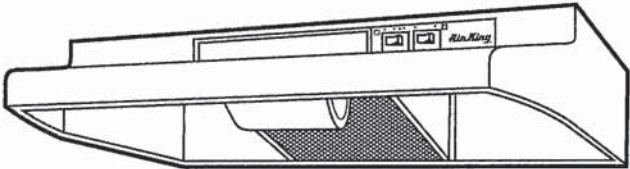

AV SERIES

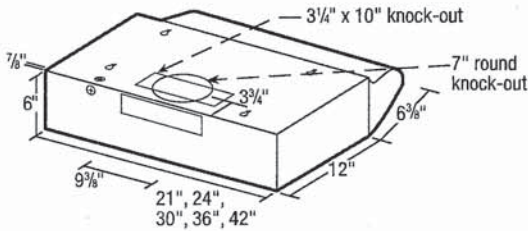

- Filters**
UL rated, class 2 filter.
Grease Filter: RF35 - 8 7/8"x10 3/8" (included).
Charcoal Filter: RF34 (not included).
Combo Grease/Charcoal: RF55 (not included).
- Available Finishes**
White, Biscuit, Almond, Black & Stainless Steel.

EXPANDED PERFORMANCE										
Air Flow - CFM	Static Pressure (inches of w.g.)						Sones @ .1 SP	Fan Speed RPM	Power Watts	Apms
	0	0.05	0.1	0.15	0.2	0.25				
Vertical Ducting High	246	232	218	203	181	147	7.5	2973	87.0	2.1
Horizontal Ducting High	225	210	180	175	155	120	7.0	3024	87.0	2.1

PROJECT							ARCHITECT			
LOCATION							ENGINEER			
CONTRACTOR							SUBMITTED BY		DATE	
FAN NUMBER	MODEL NUMBER	CFM	IN W.C.	RPM	WATTS	AMPS	SONES	QTY	OPTIONAL EQUIPMENT & REMARKS	



Air King: 820 Lincoln Avenue
West Chester, Pennsylvania 19380-4466
Tel: (610) 692-7400 • 877-304-3785
Fax: (610) 696-8048

Canada:
Brampton, Ontario
Tel: 905-456-2033
Fax: (905) 456-1015

9

Whirlpool®

21 cu. ft. Top-Freezer Refrigerator
WRT541SZD

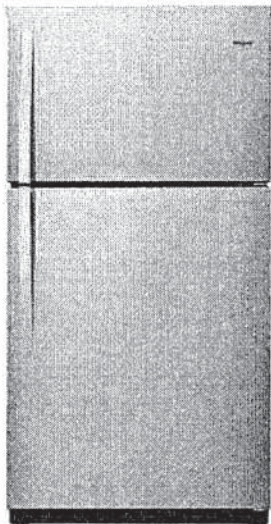

Fingerprint-Resistant Stainless
WRT541SZDZ

Capacity	
Total Capacity	21 cu. ft.
Refrigerator Capacity	15 cu. ft.
Freezer Capacity	6 cu. ft.
General Features & Properties	
EZ Connect Icemaker Kit	
LED Interior Lighting	
ENERGY STAR® Certified	
Electronic Temperature Controls	
Freezer Temperature Controls	
Clear Door Bins	
Adjustable Door Bins	
Quiet Cooling	
Fingerprint Resistant	
Electrical Details	
Amps	6.5
Volts	115
Certifications	
ADA Compliant	Yes
ENERGY STAR® Certified	Yes

Technical Details	
Refrigerator Type	Top-Freezer
Number of Doors	2
Number of Interior Refrigerator Shelves	3
Number of Refrigerator Door Bins	1 Fixed, 4 Adjustable
Number of Interior Freezer Shelves	1
Number of Freezer Door Bins	2 Fixed
Lighting Type	LED
Ice Maker	Optional
Ice Maker Location	Freezer
Dispenser Type	N/A
Dimensions	
Product Dimensions (H x W x D)	66-1/4" x 32-3/4" x 34"
Depth with Door Open 90°	62-1/4"
Cutout Dimensions	Allow extra 1/2" on sides and top Allow extra 1" on rear
Reference Material	
Dimension Guide	
Use & Care Guide	
Energy Guide	
Warranty	

- Also available in:
- White

WRT541SZDW
- Black

WRT541SZDB
- Monochromatic Stainless Steel

WRT541SZDM

Key Features & Benefits

- Frameless Glass Shelves

Store more items on wall-to-wall shelves for greater storage flexibility.
- Flexi-Slide™ Bin

Make space for tall items with the bin that quickly and easily moves side to side.
- Humidity-Controlled Crispers

Store fruits and vegetables in their ideal environment.

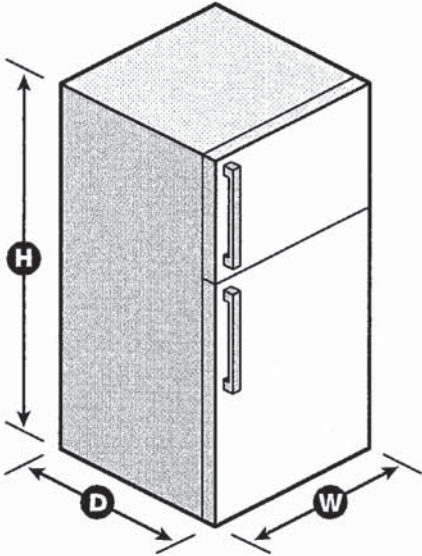

GARAGE LEFT.
HINGES ON RIGHT
HANDLE ON LEFT.

NOTE: Dimensions are for planning purposes only. For complete details, see Installation Instructions packed with product. Specifications subject to change without notice.

®/™ © 2020. All rights reserved. Printed in the U.S.A. D200052XXC. WRT541SZDSPECSHEETV01.

J

Whirlpool® Top Mount Refrigerator

PRODUCT MODEL NUMBERS

WRT311FZD WRT541SZD
WRT511SZD

Electrical: A 115-volt, 60-Hz, AC-only, 15- or 20-amp fused, grounded electrical supply is required. It is recommended that a separate circuit serving only your refrigerator be provided. Use an outlet that cannot be turned off by a switch. Do not use an extension cord.

NOTE: Before performing any type of installation, cleaning, or removing a light bulb, turn the control (Thermostat, Refrigerator or Freezer Control depending on the model) to OFF and then disconnect the refrigerator from the electrical source. When you are finished, reconnect the refrigerator to the electrical source and reset the control (Thermostat, Refrigerator or Freezer Control depending on the model) to the desired setting. See "Using the Controls."

Water: A cold water supply with water pressure between 30 and 120 psi (207 and 827 kPa) is required to operate ice maker and water dispenser. If you have questions about your water pressure, call a licensed, qualified plumber.

IMPORTANT: The pressure of the water coming out of a reverse osmosis system going to the water inlet valve of the refrigerator needs to be between 30 and 120 psi (207 and 827 kPa).

Reverse Osmosis Water Supply: If a reverse osmosis water filtration system is connected to your cold water supply, the water pressure to the reverse osmosis system needs to be a minimum of 40 to 60 psi (276 to 414 kPa).

PRODUCT DIMENSIONS

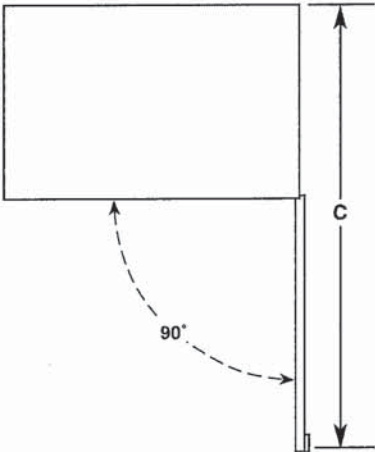
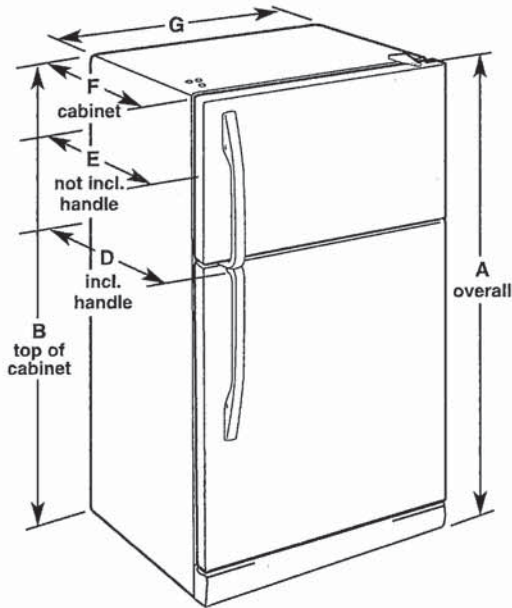

Model Number	Model Size	Reversible Door	Height - Overall "A"	Height - Top of Cabinet "B"	Depth - Door Open 90° "C"	Depth - With Handles "D"	Depth - Without Handles "E"	Depth - Cabinet Only "F"	Width - Cabinet "G"
WRT311FZD	20.5 cu. ft.	Yes	66¼" (168.3 cm)	65½" (166.4 cm)	62¼" (158.1 cm)	32⅞" (83.5 cm)	30⅝" (77.8 cm)	28½" (72.4 cm)	32¾" (83.2 cm)
WRT511SZD WRT541SZD	21.3 cu. ft.	Yes	66¼" (168.3 cm)	65½" (166.4 cm)	62¼" (158.1 cm)	34" (86.4 cm)	32½" (82.3 cm)	28½" (72.4 cm)	32¾" (83.2 cm)

LOCATION REQUIREMENTS

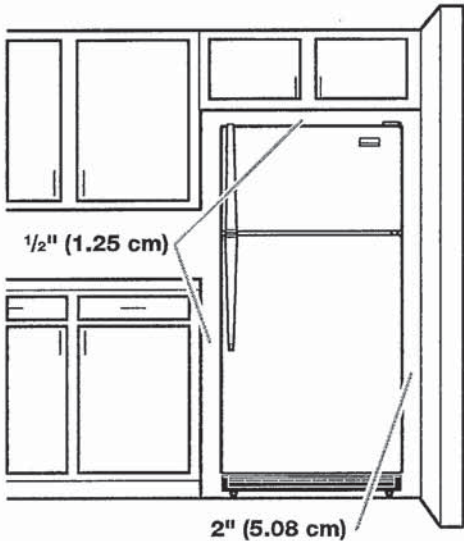

To ensure proper ventilation for your refrigerator, allow for a ½" (1.25 cm) space on each and between overhead cabinets and refrigerator top. Allow at least 1" (2.5 cm) between back of cabinet and the wall. If your refrigerator has an ice maker, make sure you leave some extra space at the back for the water line connections.

If you are installing your refrigerator next to a fixed wall, leave 2" (5 cm) minimum on the hinge side (depending on your model) to allow for the door to swing open.

NOTE: This refrigerator is intended for use in a location where the temperature ranges from a minimum of 55°F (13°C) to a maximum of 110°F (43°C). The preferred room temperature range for optimum performance, which reduces electricity usage and provides superior cooling, is between 60°F (15°C) and 90°F (32°C). It is recommended that you do not install the refrigerator near a heat source, such as an oven or radiator.

g



5.3 cu. ft. Whirlpool® electric range with Frozen Bake™ technology

YWFE515S0JS

This Whirlpool® electric range with a dual element stove top helps you get dinner to the table. Skip preheating for favorites like pizza with Frozen Bake™ technology. This self cleaning oven also prevents cooked food from getting cold with the Keep Warm setting. Closed door broiling helps keep the kitchen comfortable.



Available Finishes/Colours

- YWFE515S0JB
Black
- YWFE515S0JS
Stainless Steel
- YWFE515S0JW
White

Manuals & Literature:

- [Installation Instructions](#)
- [Use and Care](#)
- [Warranty](#)

Top Features

- FlexHeat™ Dual Radiant Element**
Get two elements in one with a 6" inner ring that's great for smaller pots and pans and a 9" expandable outer ring that makes room for larger cookware.
- Frozen Bake™ technology**
Skip preheating and cook frozen favorites like pizza in fewer steps with preprogrammed settings that automatically adjust cooking times for you.
- Keep Warm setting**
Keep dishes from getting cold with this setting that delivers low heat to the oven.
- Closed Door Broiling**
Maintain the optimal cooking temperature for food while still keeping the kitchen comfortable and cool using this broiling temperature management system that helps prevent overheating.

Dimensions	
Depth	27 3/4
Height	36
Width	29 7/8

Exterior	
Handle Type	Reach-Through Handle

Configuration and Overview	
Range Type	Freestanding
Fuel Type	Electric
Size (IN, inches)	30

Features	
Hot Surface Indicator Light	Yes
Heating Element On Indicator Light	Yes
Power On Indicator Light	No
Griddle	NA
Automatic Convection Conversion Temperature Adjust	No
Power Outage Compatible	No

Exterior	
Door Removable	Yes
Drawer Type	Storage Drawer
Oven Door	Glass Window
Oven Window Size	Extra Large
Handle Color	Stainless Steel
Handle Material	Metal

g

WHIRLPOOL 30" (76.0 CM) FREESTANDING ELECTRIC RANGES
Model YWFE515S0JS

Product Dimensions

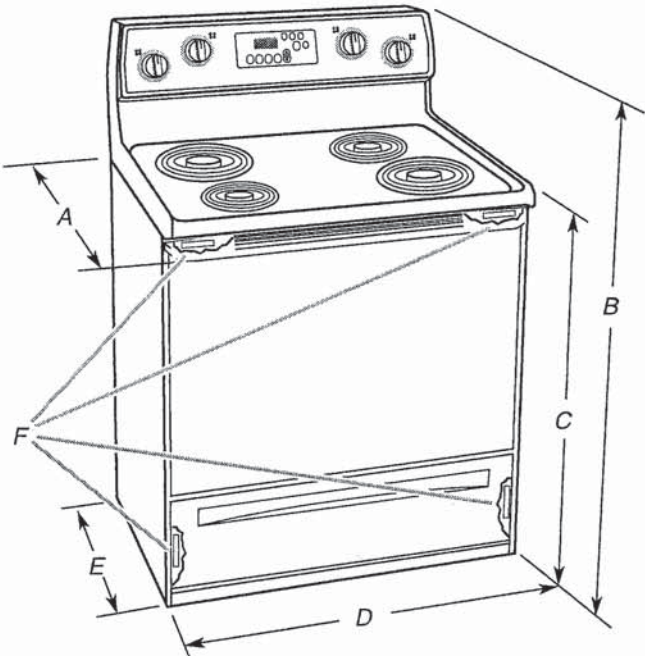

- A. 27³/₄" (70.5 cm) max. depth with handle
- B. 46⁷/₈" (119.1 cm) overall height (max.) with leveling legs screwed all the way in*
- C. 36" (91.4 cm) cooktop height (max.) with leveling legs screwed all the way in*
- D. 29⁷/₈" (75.9 cm) width
- E. 25⁵/₁₆" (64.3 cm) depth - back of range to front of cooktop**
- F. Model/serial/rating plate (located on the frame behind a top corner of the door or either side of the drawer)

IMPORTANT: Range must be level after installation. Follow the instructions in the "Level Range" section. Using the cooktop as a reference for leveling the range is not recommended.

*Range can be raised approximately 1" (2.5 cm) by adjusting the leveling legs.

**Front of door and drawer may extend further forward depending on styling.

Cabinet Dimensions

Cabinet opening dimensions shown are for 25" (64.0 cm) countertop depth, 24" (61.0 cm) base cabinet depth and 36" (91.4 cm) countertop height.

IMPORTANT: If installing a range hood or microwave hood combination above the cooking surface, follow the range hood or microwave hood combination installation instructions for dimensional clearances above the cooktop surface.

A freestanding range may be installed next to combustible walls with zero clearance.

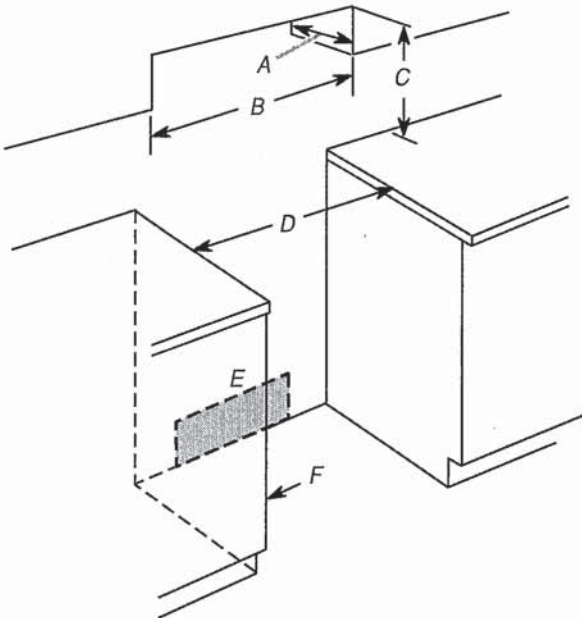

- A. 13" (33.0 cm) max. upper cabinet depth
- B. 30" (76.2 cm) min. opening width
- C. For minimum clearance to top of cooktop, see NOTE*
- D. 30" (76.2 cm) min. opening width
- E. Outlet - 8" (20.3 cm) to 22" (55.9 cm) from either cabinet, 7" (17.8 cm) max. from floor.
- F. Cabinet door or hinges should not extend into the cutout.

***NOTE:** 24" (61.0 cm) minimum when bottom of wood or metal cabinet is covered by not less than 1/4" (6.4 mm) flame retardant millboard covered with not less than No. 28 MSG sheet steel, 0.015" (0.4 mm) stainless steel, 0.024" (0.6 mm) aluminum or 0.020" (0.5 mm) copper.

30" (76.2 cm) minimum clearance between the top of the cooking platform and the bottom of an uncovered wood or metal cabinet.

J

WHIRLPOOL 30" (76.0 CM) FREESTANDING ELECTRIC RANGES
Model YWFE515S0JS

Electrical Requirements - Canada Only



WARNING

Electrical Shock Hazard

Electrically ground range.

Failure to do so can result in death, fire, or electrical shock.

If codes permit and a separate ground wire is used, it is recommended that a qualified electrical installer determine that the ground path is adequate and wire gauge are in accordance with local codes.

Be sure that the electrical connection and wire size are adequate and in conformance with CSA Standard C22.1, Canadian Electrical Code, Part 1 - latest edition, and all local codes and ordinances.

A copy of the above code standards can be obtained from:

Canadian Standards Association
178 Rexdale Blvd.
Toronto, ON M9W 1R3 CANADA

- Check with a qualified electrical installer if you are not sure the range is properly grounded.

Range Rating*		Specified Rating of Power Supply Cord Kit and Circuit Protection
120/240 V	120/208 V	Amps
8.8 - 16.5 KW	7.8 - 12.5 KW	40 or 50**
16.6 - 22.5 KW	12.6 - 18.5 KW	50

*The NEC calculated load is less than the total connected load listed on the model/serial/rating plate.

**If connecting to a 50 A circuit, use a 50 A rated cord with kit. For 50 A rated cord kits, use kits that specify use with a nominal 1 3/8" (3.5 cm) diameter connection opening.

- A time-delay fuse or circuit breaker is recommended.
- This range is equipped with a CSA International Certified Power Cord intended to be plugged into a standard 14-50R wall receptacle. Be sure the wall receptacle is within reach of range's final location.



- Do not use an extension cord.

INSTALLATION INSTRUCTIONS

Unpack Range



WARNING

Excessive Weight Hazard

Use two or more people to move and install range.

Failure to do so can result in back or other injury.

- Remove shipping materials, tape and film from range.
- Remove oven racks and parts package from inside oven.
- Do not remove the shipping base at this time.

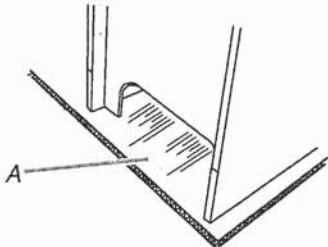

A. Shipping base

- On Ranges Equipped with a Storage Drawer:**
Remove the storage drawer. See the "Storage Drawer" section. Use a 1/4" (6.4 mm) drive ratchet to lower the rear leveling legs one-half turn. Use a wrench or pliers to lower front leveling legs one-half turn.

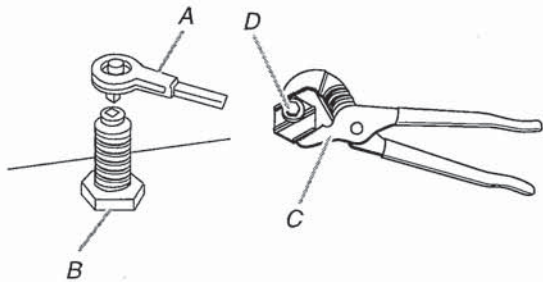

A. 1/4" (6.4 mm) drive ratchet
B. Rear leveling leg
C. Wrench or pliers
D. Front leveling leg

On Ranges Equipped with a Warming Drawer or Premium Storage Drawer:

On ranges equipped with a warming drawer or premium storage drawer, the rear legs cannot be accessed by removing the warming drawer or premium storage drawer. It will be necessary to adjust the rear legs from outside the range. Use wrench or pliers to lower the front and rear leveling legs one half turn.

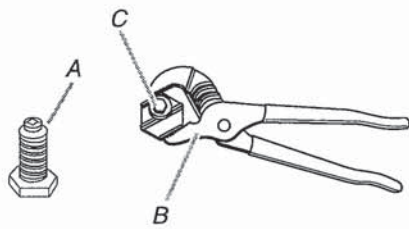

A. Rear leveling leg
B. Wrench or pliers
C. Front leveling leg

g

WHIRLPOOL 30" (76.0 CM) FREESTANDING ELECTRIC RANGES
Model YWFE515S0JS

Install Anti-Tip Bracket

⚠ WARNING



Tip Over Hazard

A child or adult can tip the range and be killed.
Install anti-tip bracket to floor or wall per installation instructions.
Slide range back so rear range foot is engaged in the slot of the anti-tip bracket.
Re-engage anti-tip bracket if range is moved.
Do not operate range without anti-tip bracket installed and engaged.
Failure to follow these instructions can result in death or serious burns to children and adults.

1. Remove the anti-tip bracket from where it is taped inside the storage drawer or warming drawer.
2. Determine which mounting method to use: floor or wall.
If you have a stone or masonry floor, you can use the wall mounting method. If you are installing the range in a mobile home, you must secure the range to the floor.
3. Determine and mark centerline of the cutout space. The mounting can be installed on either the left-side or right-side of the cutout. Position mounting bracket against the wall in the cutout so that the V-notch of the bracket is $12^{9}/_{16}$ " (31.9 cm) from centerline as shown.

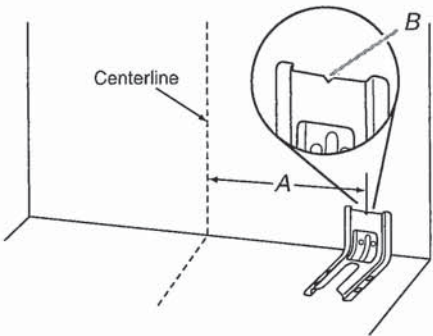

A. $12^{9}/_{16}$ " (31.9 cm)
B. Bracket V-notch

4. Drill two $1/8$ " (3 mm) holes that correspond to the bracket holes of the determined mounting method. See the following illustrations.

Floor Mounting

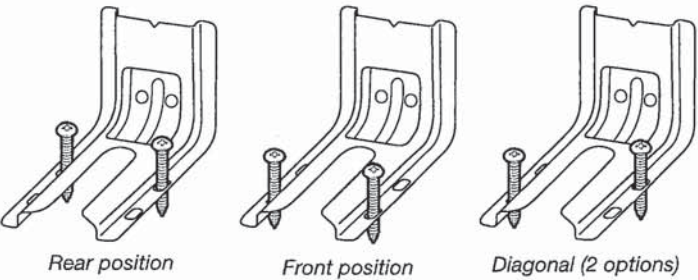

Wall Mounting

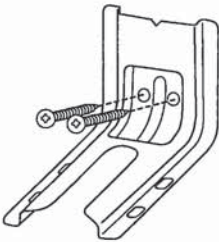

5. Using the Phillips screwdriver, mount anti-tip bracket to the wall or floor with the two #12 x $1^{5}/_{8}$ " (4.1 cm) screws provided.
6. Move range close enough to opening to allow for final electrical connections. Remove shipping base, cardboard or hardboard from under range.
7. Move range into its final location, making sure rear leveling leg slides into anti-tip bracket.
8. Move range forward onto shipping base, cardboard or hardboard to continue installing the range using the following installation instructions.

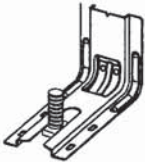

J

Whirlpool®

55 dBA* Front Control Dishwasher
WDF330PAH



Stainless Steel
WDF330PAHS

Capacity	
Total Place Settings	13
General Features & Properties	
Heavy Cycle	
High Temperature Wash Option	
Heated Dry Option	
ENERGY STAR® Certified	
Industry's Best Selling Dishwasher Brand†	
Designed, Engineered and Assembled in the U.S.A. with American Pride	
Electrical Details	
Amps	10
Volts	120
Hz	60
Certifications	
ENERGY STAR® Certified	Yes

Technical Details	
Dishwasher Type	Built-in
Control Location	Front
Control Type	Push Button
Number of Wash Cycles	3
Number of Options	4
dBA*	55
Number of Racks	2
Tub Material	Plastic
Wash System	Filter
Wash System Type	Removable Filter
Number of Wash Arms	2

Dimensions	
Product Dimensions (H x W x D)	34-1/2" x 23-7/8" x 24-1/2"
Depth with Door Open 90°	49-1/2"

Reference Material	
Dimension Guide	
Install Guide	
Use & Care Guide	
Energy Guide	
Warranty	

Key Features & Benefits

- 1-Hour Wash Cycle**

Clean dishes in half the time so your plates, pans and glasses are thoroughly cleaned up and taken care of in just an hour.**
- Soil Sensor**

Determines how dirty dishes are and adjusts the Normal cycle as needed to make sure dishes come out clean.
- Normal Cycle**

Use for normal amounts of food soil to clean up leftover messes from your day-to-day meals.

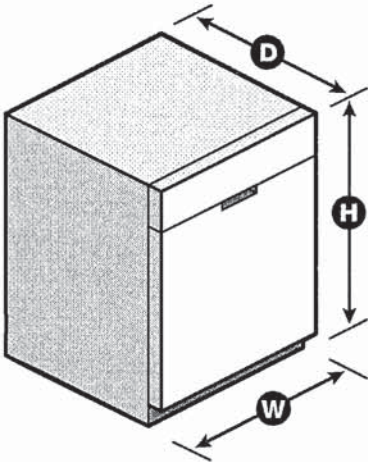

*Per IEC standards. **Compared to Normal cycle with lightly soiled loads. †Based on 12-month average of sales. TraQline 2018. NOTE: Dimensions are for planning purposes only. For complete details, see Installation Instructions packed with product. Specifications subject to change without notice.

®/™ © 2020. All rights reserved. Printed in the U.S.A. D200052XXA. WDF330PAHSPECSHEETV01.

J



Undercounter Dishwasher

PRODUCT MODEL NUMBERS

WDF110PAB	WDF320PAD	WDT710PAH
WDF111PAB	WDF330PAH	WDT720PAD
WDF120PAF	WDF331PAH	WDT730PAH
WDF121PAF	WDF520PAD	WDT735PAG
WDF130PAH	WDF540PAD	WDT735PAH
WDF131PAH	WDF545PAF	

DRAIN REQUIREMENTS

- A new drain hose is supplied with your dishwasher. If drain hose is not long enough, use a new drain hose with a maximum length of 12 ft (3.7 m) that meets all current AHAM/ IAPMO test standards, is resistant to heat and detergent, and fits the 1" (25 mm) drain connector of the dishwasher. See the "Tools and Parts" section at the front of the guide for part details and orders.
- Make sure to connect drain hose to waste tee or disposer inlet above drain trap in house plumbing and 20" (508 mm) minimum above the floor. It is recommended that the drain hose either be looped up and securely fastened to the underside of the counter or be connected to an air gap.
- Make sure to use an air gap if the drain hose is connected to house plumbing lower than 20" (508 mm) above subfloor or floor.

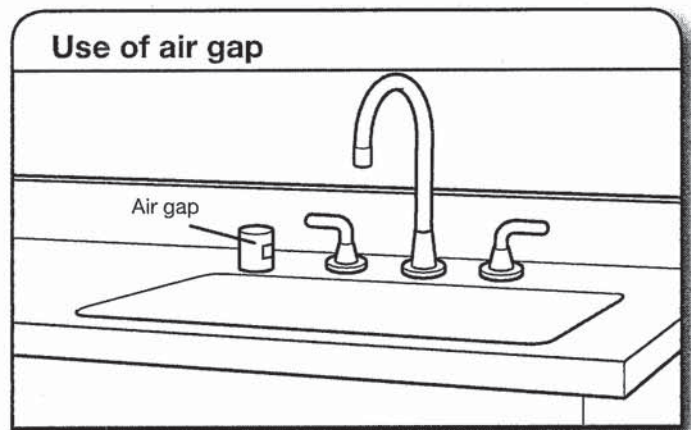

- If required, the air gap should be installed in accordance with the air gap installation instructions. When you are connecting the air gap, a rubber hose (not provided) will be needed to connect to the waste tee or disposer inlet.
- Use 1/2" minimum I.D. drain line fittings.

WATER SUPPLY REQUIREMENTS

- This dishwasher has a water heating feature and also requires a connection to a hot water supply line.
- A hot water line with 20 to 120 psi (138 to 862 kPa) water pressure can be verified by a licensed plumber.
- 120°F (49°C) water at dishwasher
- 3/8" O.D. copper tubing with compression fitting or flexible braided water supply line. See the "Tools and Parts" section at the front of the guide for part details and orders.

NOTE: 1/2" minimum plastic tubing is not recommended.

- A 90° elbow with 3/4" hose connection with rubber washer. See the "Tools and Parts" section at the front of the guide for part details and orders.
- Do not solder within 6" (152 mm) of the water inlet valve.
- If installed in new construction, make sure the house water supply lines have been flushed prior to connecting the dishwasher to remove any debris that may exist in the supply line.

NOTE: If replacing an existing dishwasher, it is recommended to install a new water line (see the "Tools and Parts" section at the front of the guide for part details) and drain hose (supplied) with the new dishwasher.

ELECTRICAL REQUIREMENTS

You Must Have:

- 120-volt, 60 Hz, AC-only, 15- or 20-amp, fused electrical supply
- Copper wire only
- A maximum of 2 field wiring supply conductors (12 AWG largest size) plus 1 grounding conductor are permitted in the terminal box.

We Recommend:

- A time-delay fuse or circuit breaker
- A separate circuit

If Connecting Dishwasher with a Power Cord:

- Use a UL Listed power cord kit marked for use with dishwasher. See the "Tools and Parts" section at the front of the guide for part details and orders.
- Plug into a grounded 3 prong outlet. Outlet must meet all local codes and ordinances.

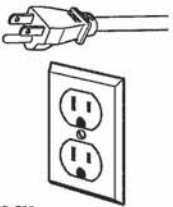

If Connecting Dishwasher with Direct Wiring:

- Use flexible, armored, or nonmetallic sheathed copper wire with grounding wire that meets the wiring requirements for your home and local codes and ordinances.
- Use a UL Listed/CSA Approved metallic strain relief.



J

PRODUCT AND CABINET OPENING DIMENSIONS

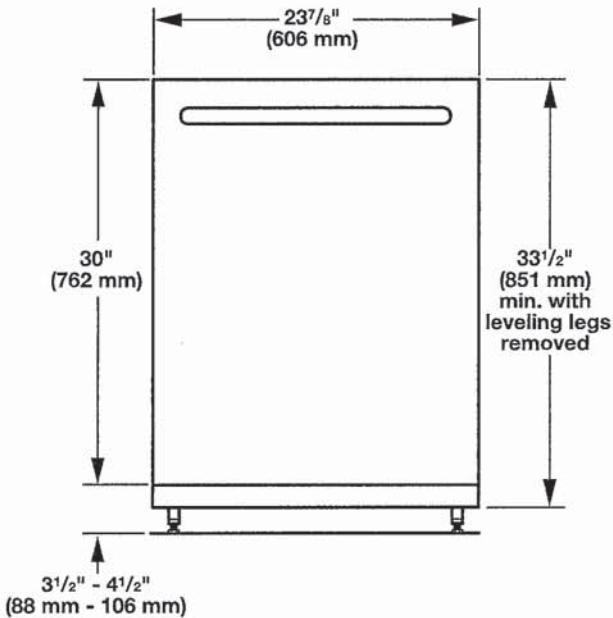

For 4" (100 mm) toe kick, height of cabinet opening is $34\frac{1}{2}$ " (863 mm).

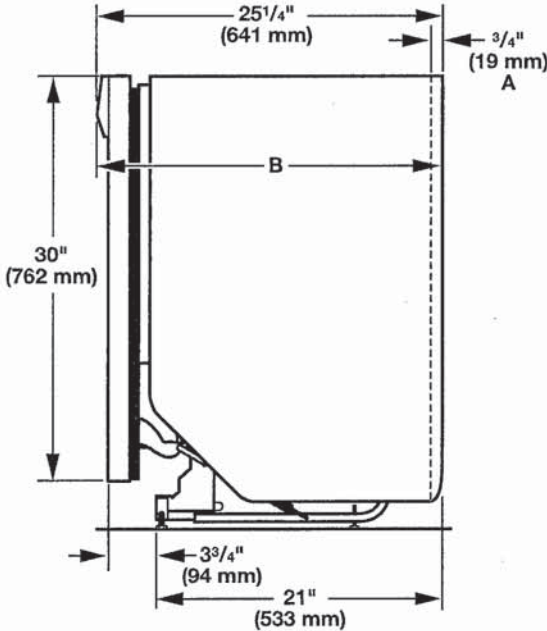

A. Insulation may be compressed (not used on all models).
B. Door handles may protrude forward of the face of the dishwasher, (varies by model).

Check that all surfaces have no protrusions that would prohibit dishwasher installation.

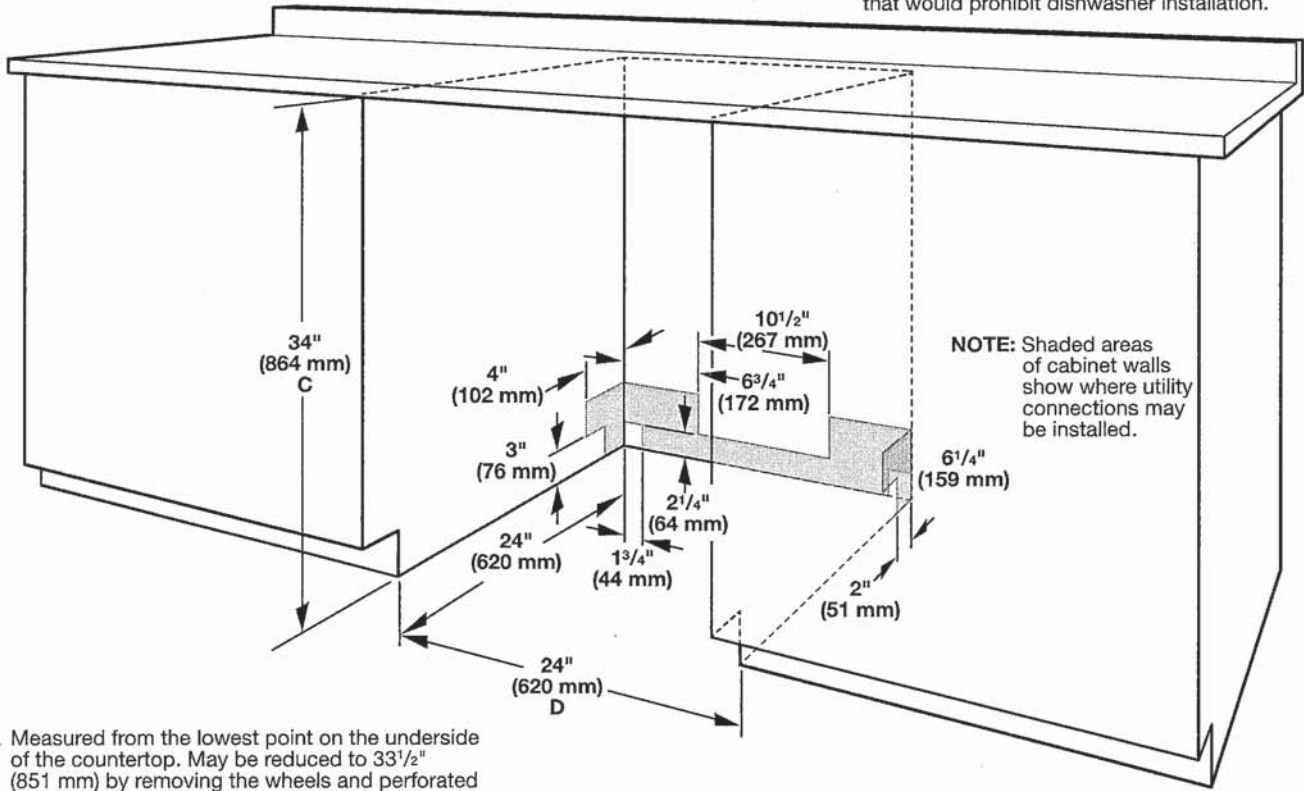

NOTE: Shaded areas of cabinet walls show where utility connections may be installed.

C. Measured from the lowest point on the underside of the countertop. May be reduced to $33\frac{1}{2}$ " (851 mm) by removing the wheels and perforated area of insulation (blanket) on dishwasher.
D. Minimum, measured from narrowest point of opening.





[Handwritten signature]

5.0 cu.ft I.E.C. Closet-Depth Front Load Washer with Intuitive Controls

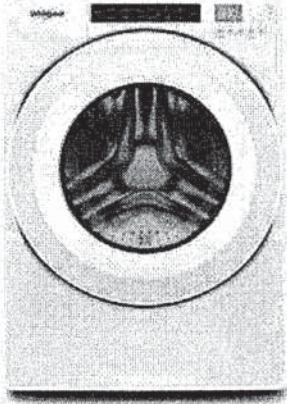
Model: WFW560CHW

- Overview
- Specifications
- Reviews
- You May Also Like
- Help And Resources
- Find In Store





Key Features

- #1 in Customer Satisfaction in the J.D. Power 2020 Laundry Appliances Satisfaction Study
- 5.0 cu. ft. I.E.C. Capacity
- ENERGY STAR® Certified
- Intuitive Controls
- Sanitize Cycle with Oxi

Color

White



Specifications

Width:	Depth:
6858.00, 27.0"	8016.88, 31-9/16"
Centimeters, Inches	Centimeters, Inches

Dimensions

Capacity	4-3/10
Depth	8016.88 cm, 31-9/16 in
Gross Weight	97068688.00 kg, 214 lbs
Net Weight	92532768.00 kg, 204 lbs
Width	8858.00 cm, 27.0 in

Appearance

LCD Touch Screen	No
Window	Yes

Details

Advanced Vibration Control™	No
Dispense System	Detergent, Fabric Softener & Bleach
Eco Monitor/Efficiency Monitor	No
Hoses Included	4ft 4in Drain Hose Included
Internal Heater	No
Maximum Spin Speed	1160
Out Of Balance Sensing	Yes
Water Factor	3-1/5

Cycles and Options

Number Of Wash Cycles	35
-----------------------	----

Electrical

Power Cord Included	Yes
---------------------	-----

Controls

Automatic Temperature Controls	Yes
Control Location	Front
LCD Touch Screen	No

Compatibility

Works With	No
------------	----

Options

Number Of Washer Options	7
--------------------------	---

Features

Stackable	Yes
Water Faucet	No

Cycles

Number Of Wash Cycles	35
-----------------------	----

Exterior

Lid/Door Lock	Yes
Lid/Door Swing	Left

Modifiers

Delay Start	No
Number Of Rinse Options	2
Number Of Soil Levels	3
Number Of Spin Speeds	4
Number Of Wash/Rinse Temperatures	4
Pre Soak	Yes
Temperature Selections	Hot, Cold, Cool, Warm

g

Recessed area or closet installation (stacked washer and dryer)

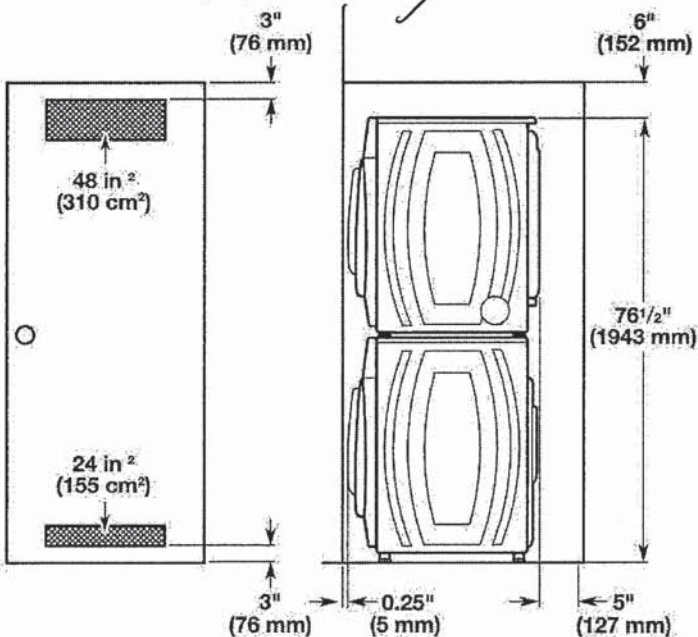

Custom under counter installation

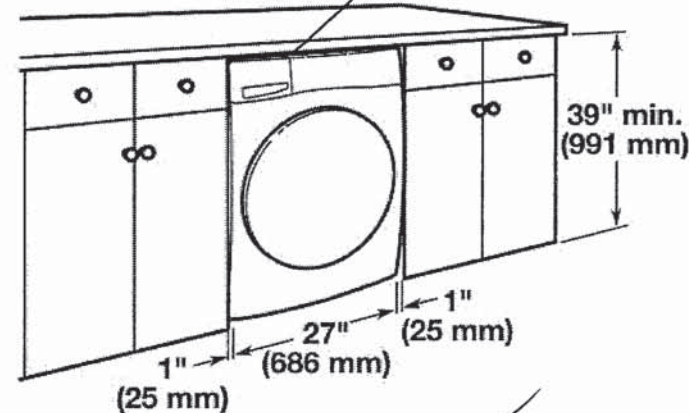

Recessed area or closet installation (washer only)

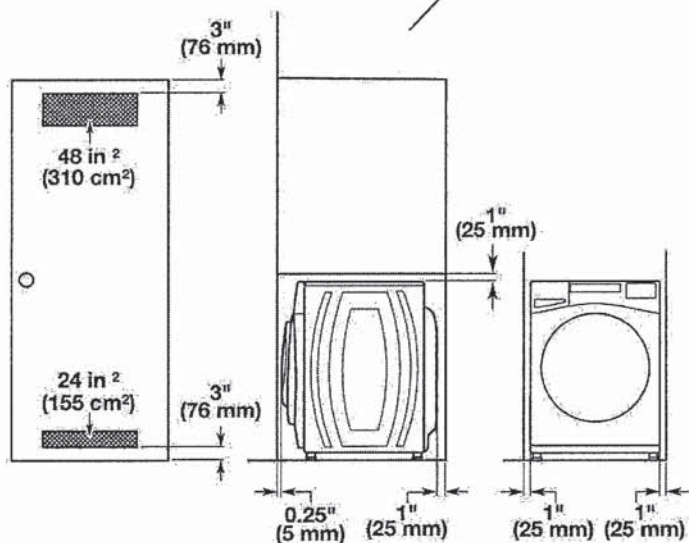

Custom cabinet installation

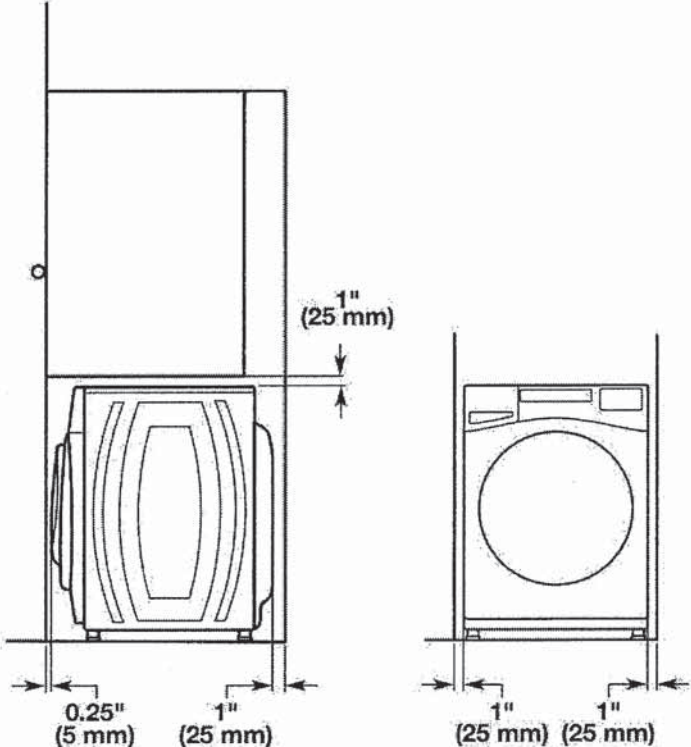

Drain System

It is the responsibility of the installer to install and secure the drain hose in to the provided plumbing/drain in a manner that will avoid the drain hose coming out of or leaking from the plumbing/drain.

Drain system can be installed using a floor drain, wall standpipe, floor standpipe, or laundry tub. Select the method you need.

IMPORTANT: To avoid siphoning, only 4.5" (114 mm) of drain hose should be inside standpipe. Always secure drain hose with cable tie.

Floor standpipe drain system

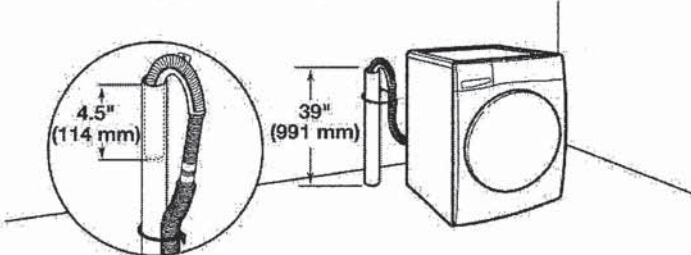

Minimum diameter for a standpipe drain: 2" (51 mm). Minimum carry-away capacity: 17 gallons (64 L) per minute. A 1/4" (6 mm) diameter to 1" (25 mm) diameter Standpipe Adapter Kit is available; refer to the Quick Start Guide for online ordering information. Top of standpipe must be at least 39" (762 mm) high; install no higher than 96" (2.4 m) from bottom of washer. If you have an overhead sewer and need to pump higher than 96" (2.4 m), a sump pump and associated hardware are needed. See "Alternate Parts."

g

Wall standpipe drain system

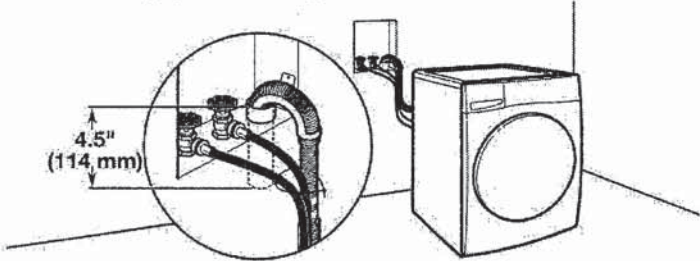

See requirements in "Floor standpipe drain system."

Laundry tub drain system

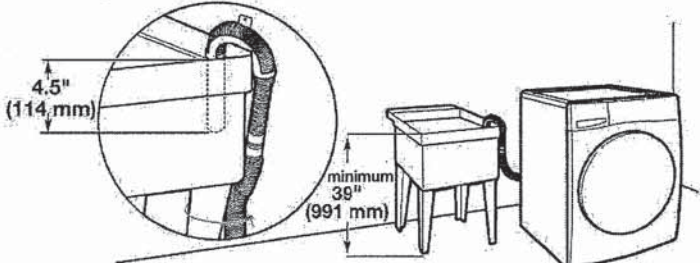

Minimum capacity: 20 gallons (76 L). Top of laundry tub must be at least 39" (991 mm) from the floor; install no higher than 96" (2.4 m) from bottom of washer.

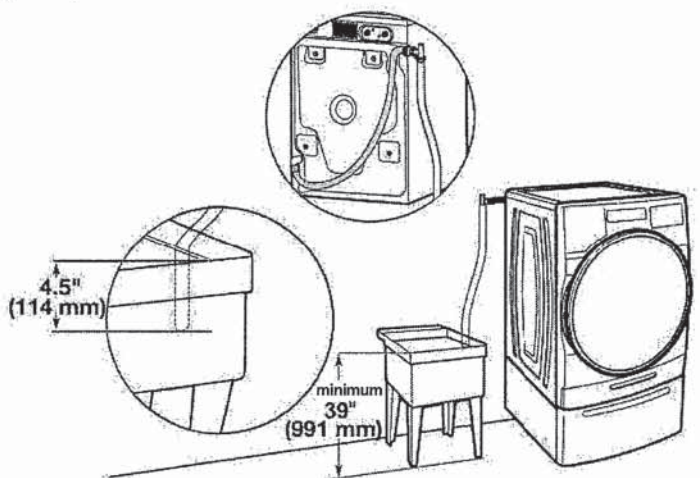

Floor drain system

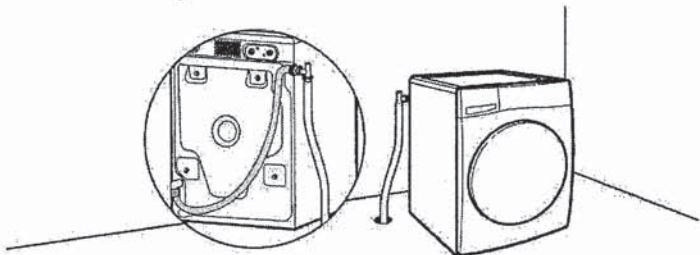

Floor drain system requires a Siphon Break Kit, 2 Connector Kits, and an Extension Drain Hose that may be purchased separately; refer to the Quick Start Guide for online ordering information. Minimum siphon break height: 28" (710 mm) from bottom of washer. (Additional hoses may be needed.)

Electrical Requirements

⚠WARNING

Electrical Shock Hazard

Plug into a grounded 3 prong outlet.

Do not remove ground prong.

Do not use an adapter.

Do not use an extension cord.

Failure to follow these instructions can result in death, fire, or electrical shock.

- A 120 V, 60 Hz, AC only, 15 or 20 A, fused electrical supply is required. A time-delay fuse or circuit breaker is recommended. It is recommended that a separate circuit breaker serving only this appliance be provided.
- This washer is equipped with a power supply cord having a 3-prong grounding plug.
- To minimize possible shock hazard, the cord must be plugged into a mating, 3-prong, grounding-type outlet, grounded in accordance with local codes and ordinances. If a mating outlet is not available, it is the personal responsibility and obligation of the customer to have the properly grounded outlet installed by a qualified electrician.
- If codes permit and a separate ground wire is used, it is recommended that a qualified electrician determine that the ground path is adequate.
- Do not ground to a gas pipe.
- Check with a qualified electrician if you are not sure the washer is properly grounded.
- Do not have a fuse in the neutral or ground circuit.

GROUNDING INSTRUCTIONS

For a grounded, cord-connected appliance:
This appliance must be grounded. In the event of a malfunction or breakdown, grounding will reduce the risk of electric shock by providing a path of least resistance for electric current. This appliance is equipped with a cord having an equipment-grounding conductor and a grounding plug. The plug must be plugged into an appropriate outlet that is properly installed and grounded in accordance with all local codes and ordinances.

WARNING: Improper connection of the equipment-grounding conductor can result in a risk of electric shock. Check with a qualified electrician or serviceman if you are in doubt as to whether the appliance is properly grounded. Do not modify the plug provided with the appliance: If it will not fit the outlet, have a proper outlet installed by a qualified electrician.

For a permanently connected appliance:
This appliance must be connected to a grounded metal, permanent wiring system, or an equipment-grounding conductor must be run with the circuit conductors and connected to the equipment-grounding terminal or lead on the appliance.

SAVE THESE INSTRUCTIONS

g

WHIRLPOOL DRYER Model #: YWED5620HW

Whirlpool Brand Canada English | Washer and Dryers | Dryers | Electric Dryers | YWED5620HW

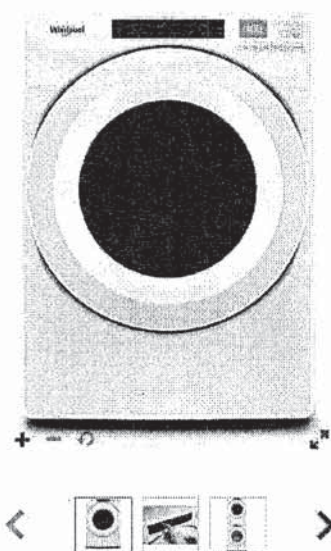

Define
Your Style

7.4 cu. ft. Front Load Electric
Dryer with Intuitive Touch
Controls

Whirlpool® 7.4 cu. ft. Front Load Electric Dryer with Intuitive Touch Controls
Model #: YWED5620HW

Dimensions

Depth	78.74 cm, 31.0 in
Depth With Door Open 90 Degree	138.43 cm, 54-1/2 in
Height	98.42 cm, 38-3/4 in
Width	68.58 cm, 27.0 in

Configuration and Overview

Fuel Type	Electric
-----------	----------

Cycles and Options

Cycle Time Remaining	Yes
Lint Filter Indicator	No
Number of Dryer Cycles	36
Number of Dryness Levels	3

Ventilation System

Long Vent	No
Maximum Vent Length	64
Venting Direction	Left, Right, Bottom, Rear

Electrical

Hz	60
Power Cord Included	Yes

[Handwritten signature]